



# WHITE PLAINS RD AT BURKE AVE

Bus Stop Under the EI Improvements  
December 2017

# EXISTING CONDITIONS

## White Plains Rd At Burke Ave, BX

### Injury Summary, 2010-2014 (5 Years)

	Total Injuries	Severe Injuries	Fatalities	KSI
Pedestrian	10	1	0	1
Bicyclist	2	0	0	0
Motor Vehicle Occupant	36	5	0	5
Total	48	6	0	6

Fatalities, 01/01/2010-3/3/2017 : None

Source: Fatalities: NYCDOT  
Injuries: NYSDOT  
KSI: Persons Killed or  
Severely Injured

- Bx39 and BxM11 bus service
- 2 and 5 trains stop at Burke Ave
- Commercial land use on White Plains Rd and Burke Ave
- Columns of elevated train on WPR separate moving/parking lanes and obstruct visibility

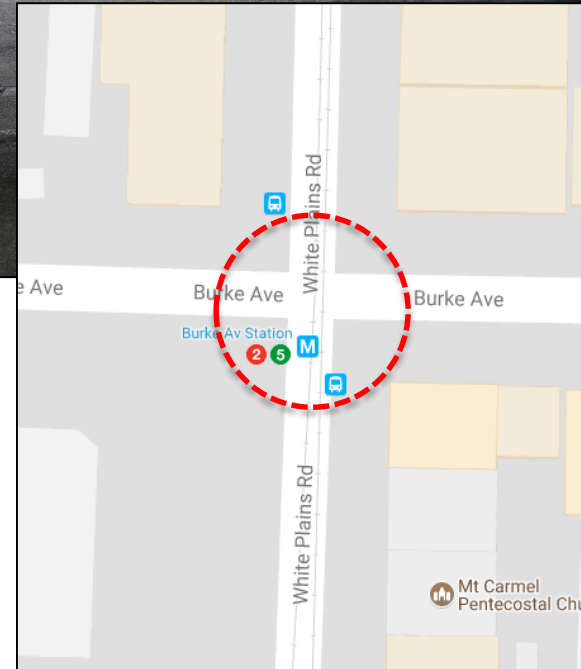



# EXISTING CONDITIONS

- Bus riders forced to wait for bus in roadway
- Roadway layout encourages unpredictable vehicle movements (e.g. attempting to pass stopped buses)
- Poor visibility for vehicles and pedestrians under elevated subway
- High bus ridership, proximity to the 2 & 5 trains



# BUS STOPS UNDER THE EL

- Program uses federal grants to construct bus boarding islands under elevated subway lines
- Benefits of bus islands:
  - Provides bus riders a safe space to wait
  - Shortens crossing distances for pedestrians
  - Accessible to bus riders with disabilities
  - Helps expedite bus operations
  - Prevents unsafe passing when bus is stopped
  - In-house construction allows for accelerated implementation



Broadway and W 228<sup>th</sup> St

# PLAN: WHITE PLAINS RD AND BURKE AVE

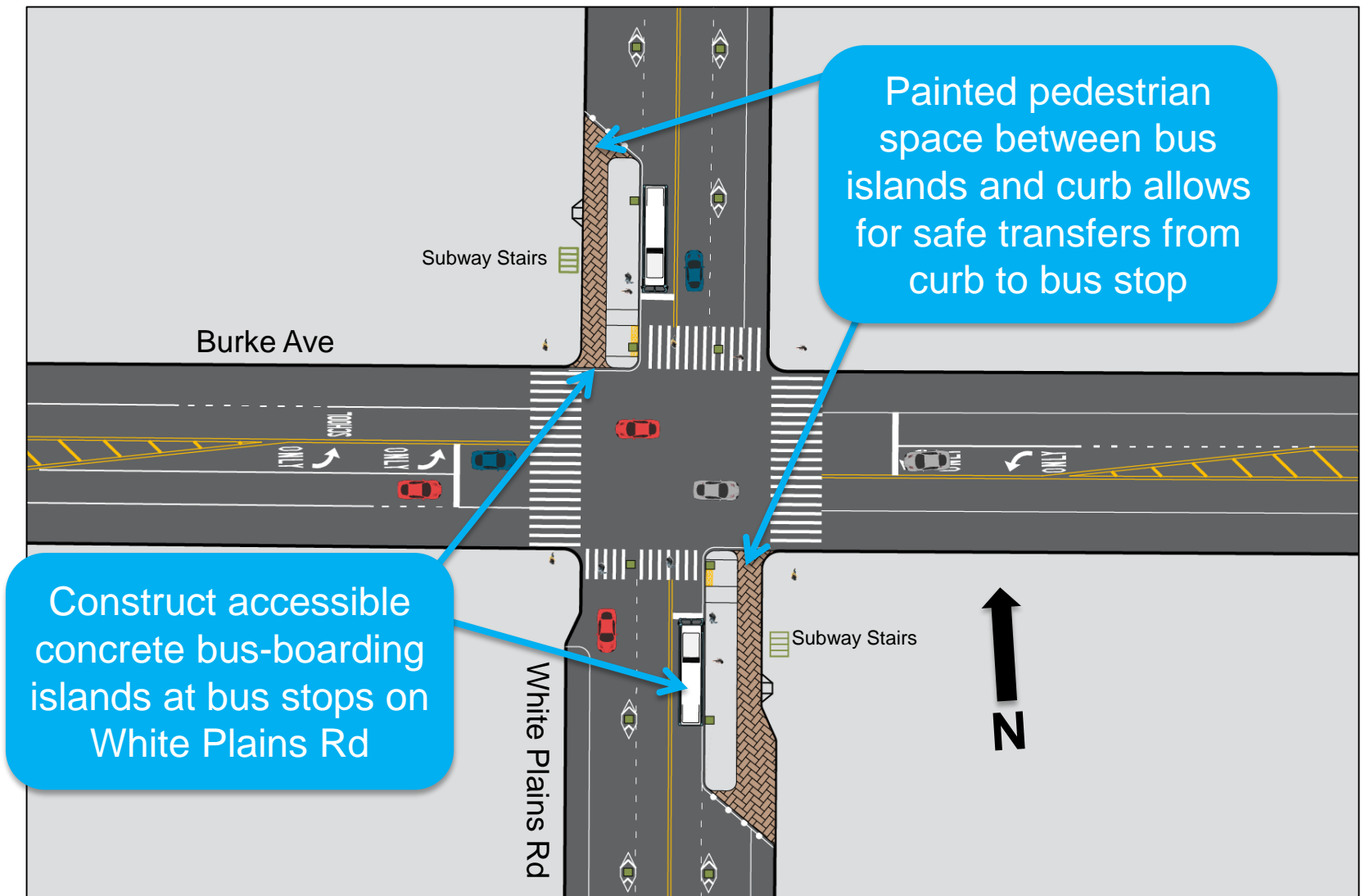



# BENEFITS OF PROPOSAL

---

- Bus islands create a safe place for riders to wait and board / exit bus
- Improves access for those most reliant on the bus service, and expedites bus operations
- Creates safer, shorter pedestrian crossing
- Clarifies vehicle movements and encourages safer right turns



# THANK YOU!

---

## Questions?



NYC DOT



NYC DOT



nyc\_dot



NYC DOT