



**VARICK ST,
FROM CLARKSON/CARMINE ST TO KING ST**

Manhattan CB 2
May 2, 2019



PROJECT LOCATION

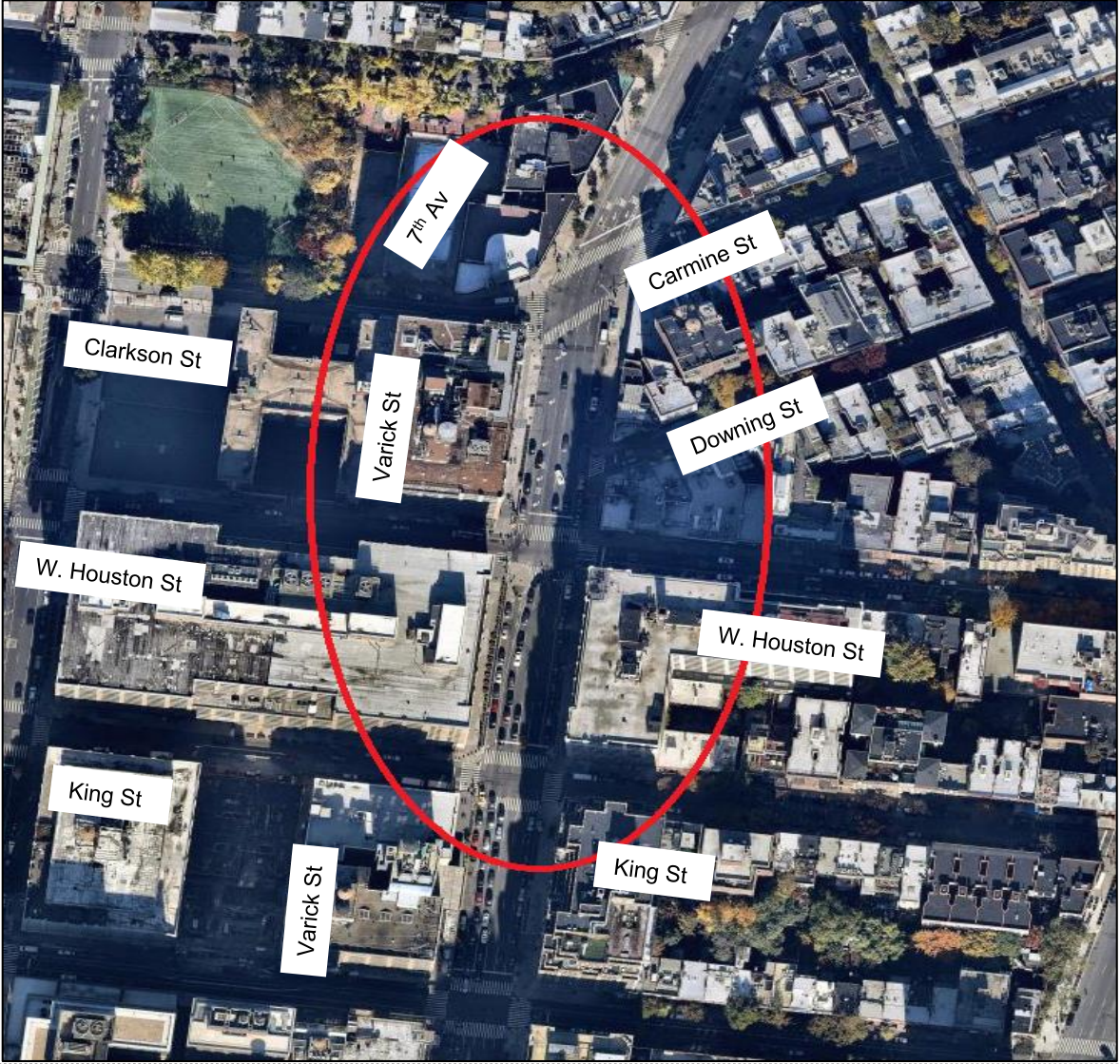
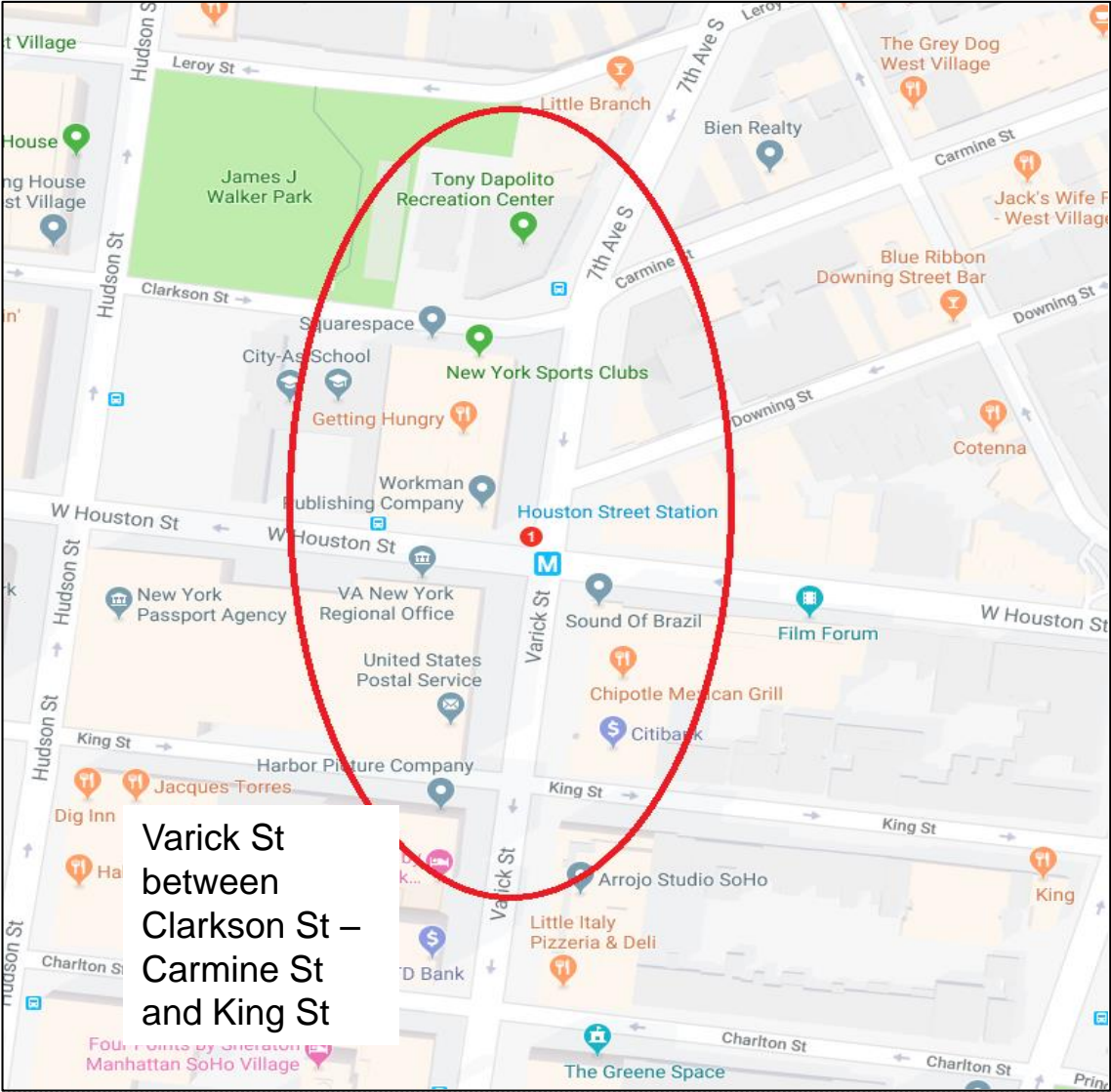

BACKGROUND

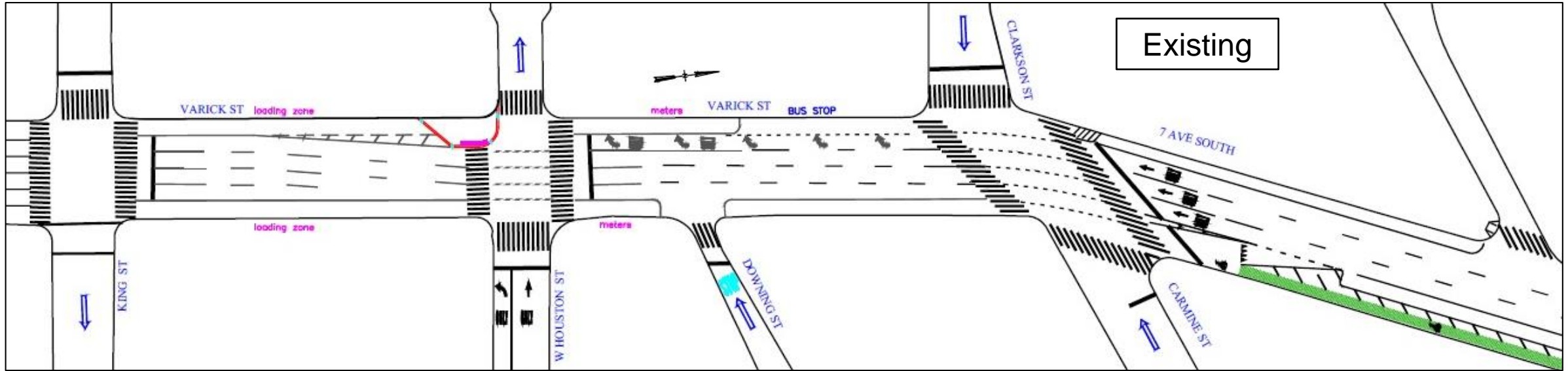

- Houston St & Varick St is a Vision Zero Priority intersection
 - From Jan 2012 through June 2016, 23 pedestrian injuries, including 3 severe injuries
- Spillback from Holland Tunnel often extends to this area
- In 2016, painted neckdown installed on southwest corner of Houston St & Varick St
 - Helps protect south crosswalk from heavy volume of westbound left-turning vehicles
 - Southbound right lane on Varick St approaching Houston St made right-turn-only
- In 2018, parking protected bike lane installed on 7 Ave S between W 11 St and Carmine St
 - No. of through lanes reduced from 4 to 3
- Motorists ignore southbound right-turn-only lane and drive through the neckdown

ISSUES

- Motorist ignore southbound right-turn-only lane and drive through the neckdown on the southwest corner of Houston St & Varick St



ISSUES

- Traffic signs at this intersection are inconspicuous
- Frequent queue spillback from Holland Tunnel



IMPROVEMENTS

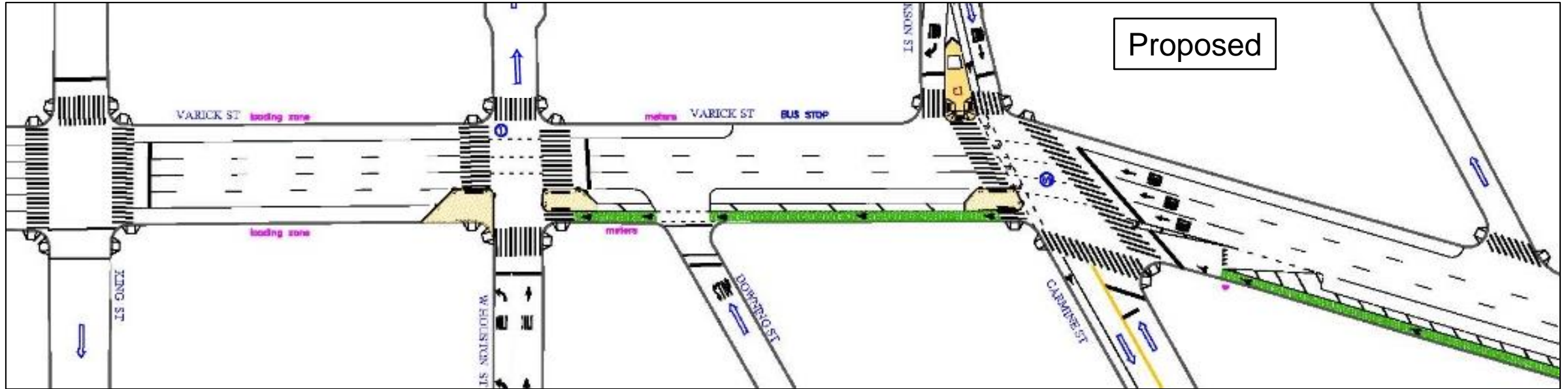

- Extend parking-protected bike lane 1 block south to Houston St
 - Painted islands at southeast corner of Carmine St and northeast corner of Houston St
- Install concrete splitter island on eastbound approach of Clarkson St
- Remove right-turn-only lane
- Relocate painted neckdown on Houston St and Varick St from southwest corner to southeast corner

BENEFITS

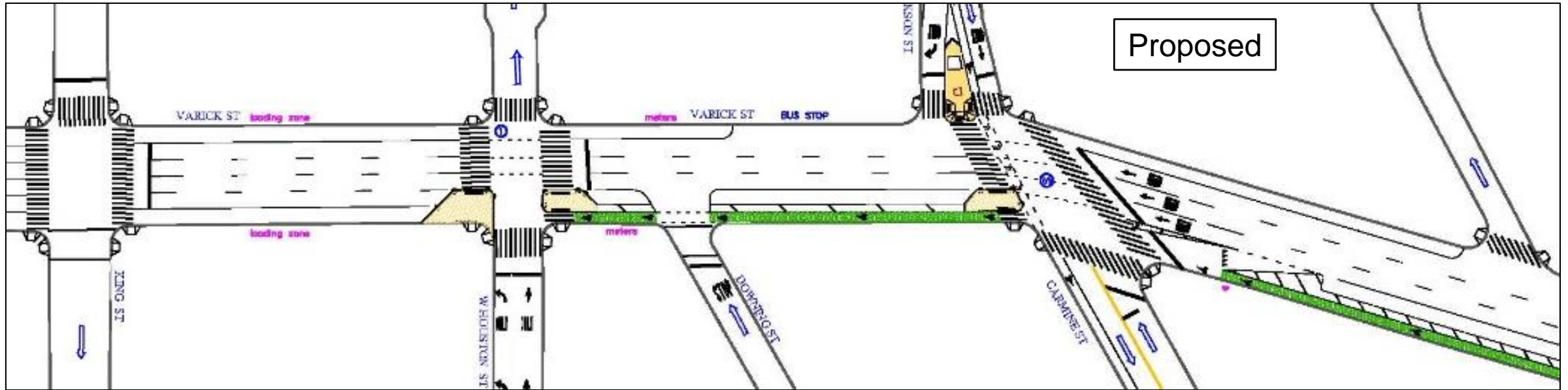

- South crosswalk at Carmine/Clarkson St:
 - Shortened crossing distance
 - Exposure to eastbound right turning vehicles eliminated
- North crosswalk at Houston St
 - Shortened crossing distance
- South crosswalk at Houston St
 - Maintains shortened crossing distance
 - Eliminates driver temptation to drive over neckdown
- Extends bike lane 1 block south
- Three continuous lanes of traffic on right side
 - Fourth lane on left side after Houston St

THANK YOU!

Questions?



NYCDOT



nyc_dot



nyc_dot



NYCDOT