

Pelham Bay Park Station Area

Presentation to Community Board 10

May 12, 2021



Better Buses

Better Buses

Better Buses Program

- **Mayor's 2019 State of the City:**
Improve bus speeds by 25%
- **Better Buses Action Plan**
Released April 2019
- **Bus Priority Projects**
 - 22 projects implemented in 2019
 - 16.3 miles of bus lanes installed 2020
 - 2 projects completed in the Bronx in 2020:
 - Edward L Grant Hwy
 - E 149 St



Better Buses

Bronx Bus Priority Corridors

- Analyzed major Bronx corridors to identify locations where treatments to improve bus speeds and reliability are needed
- Ranked potential bus-priority corridors using the following criteria:
 - Demand for bus service
 - Bus performance (speed and reliability)
 - Service levels proposed by MTA
 - Neighborhood demographics
 - Feasibility of implementation

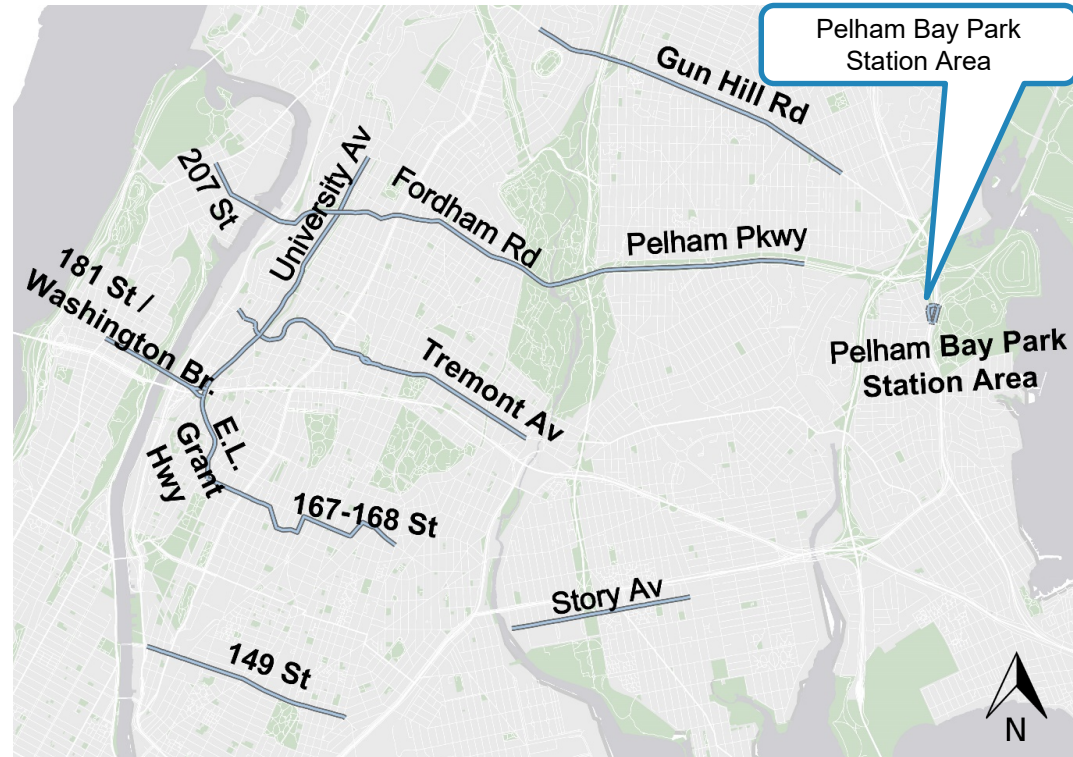

Pelham Bay Park Station Area

Background

- Serves Bx12 Local/SBS, the busiest bus route in the Bronx
- Also serves the Bx5, Bx23, Bx24, Bx29, and Q50
- ~55,000 pre-COVID weekday riders for all bus routes through area
- As the terminus for the 6 line, there are high volumes of passengers transferring to buses to continue their journey
- Area provides connections to destinations such as Co-op City, Pelham Bay Park, the Fordham Road commercial district

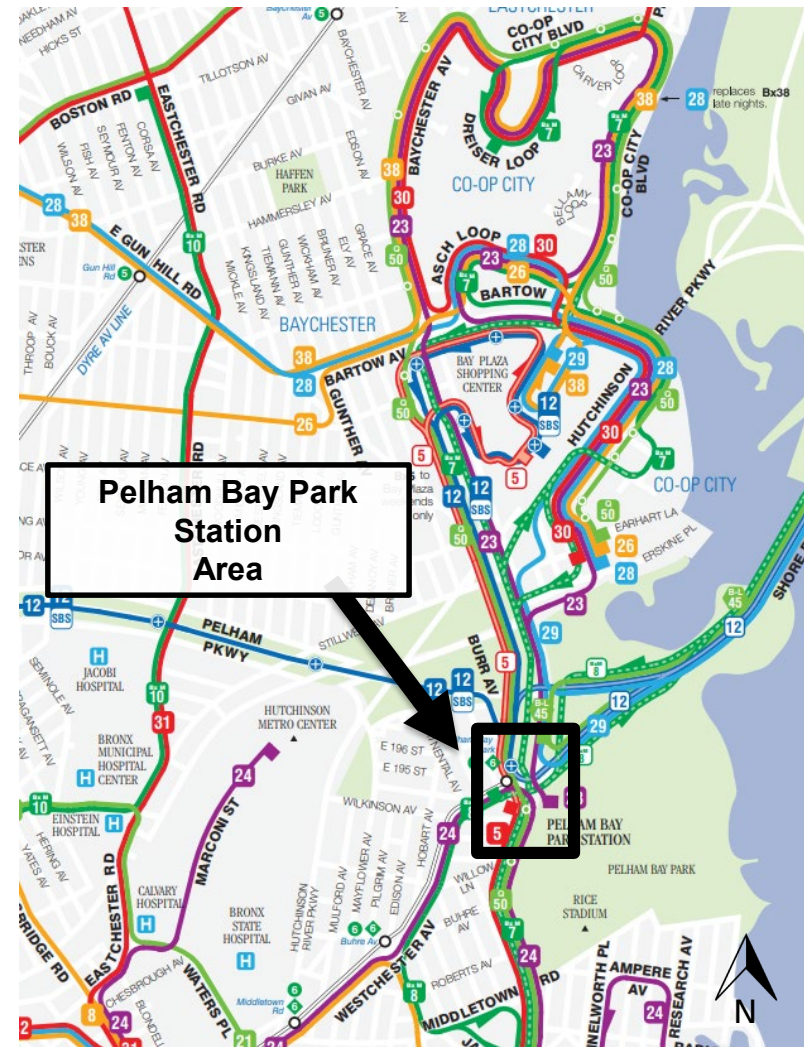

Existing Bx12 SBS Issues

- Manhattan-bound and Co-op City bound Bx12 SBS bus stops are on same block face, which can confuse riders
- Lack of crosswalks at Westchester and Burr Aves
- Due to the existing street geometry, bus routes are circuitous, often adding minutes to travel times

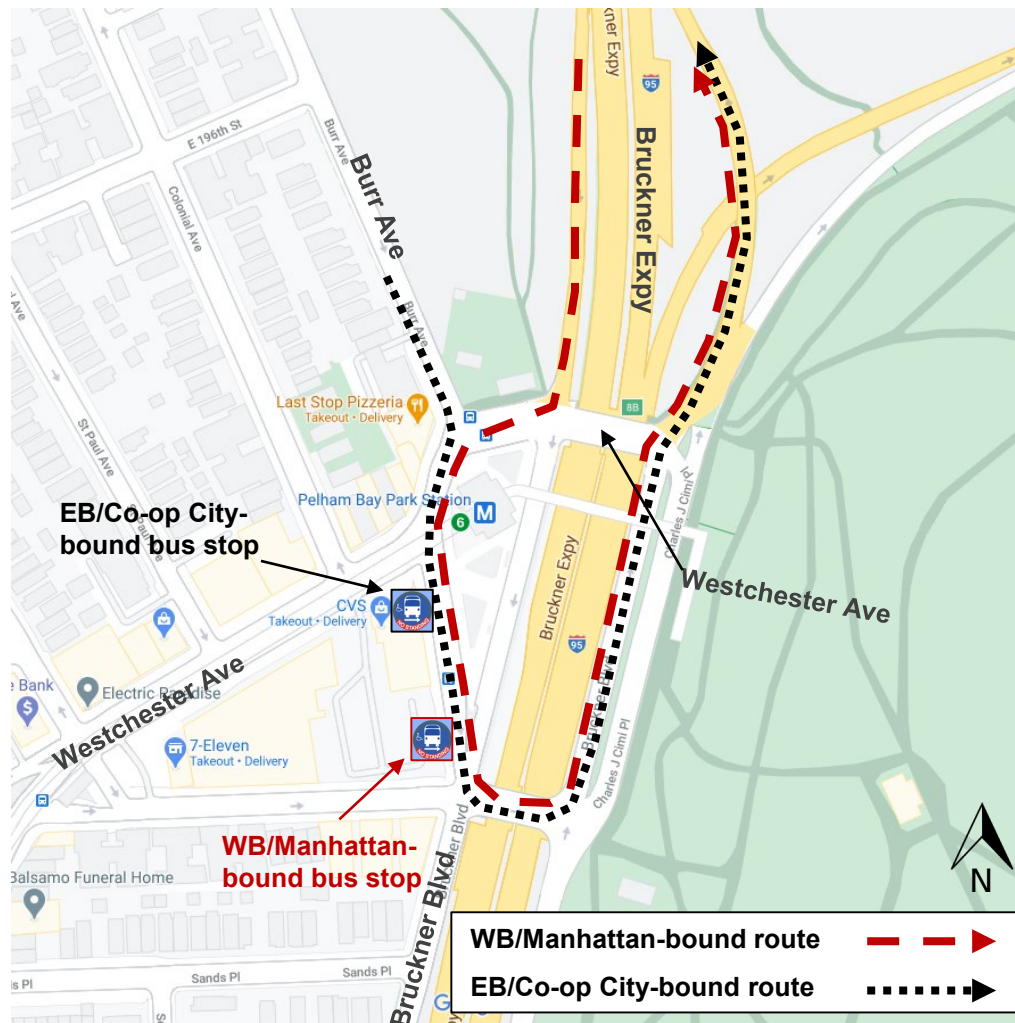

Proposed Improvements

- Re-route eastbound Bx12 SBS directly on Westchester Ave through an eastbound contraflow bus only lane
- Relocate eastbound SBS stop from Amendola Plaza to Westchester Ave at southbound Bruckner Blvd
- Better organize westbound vehicular movements on Westchester Ave approaching Burr Ave
- No directional changes for passenger vehicles, trucks, and other buses
- Emergency vehicles may use bus lane

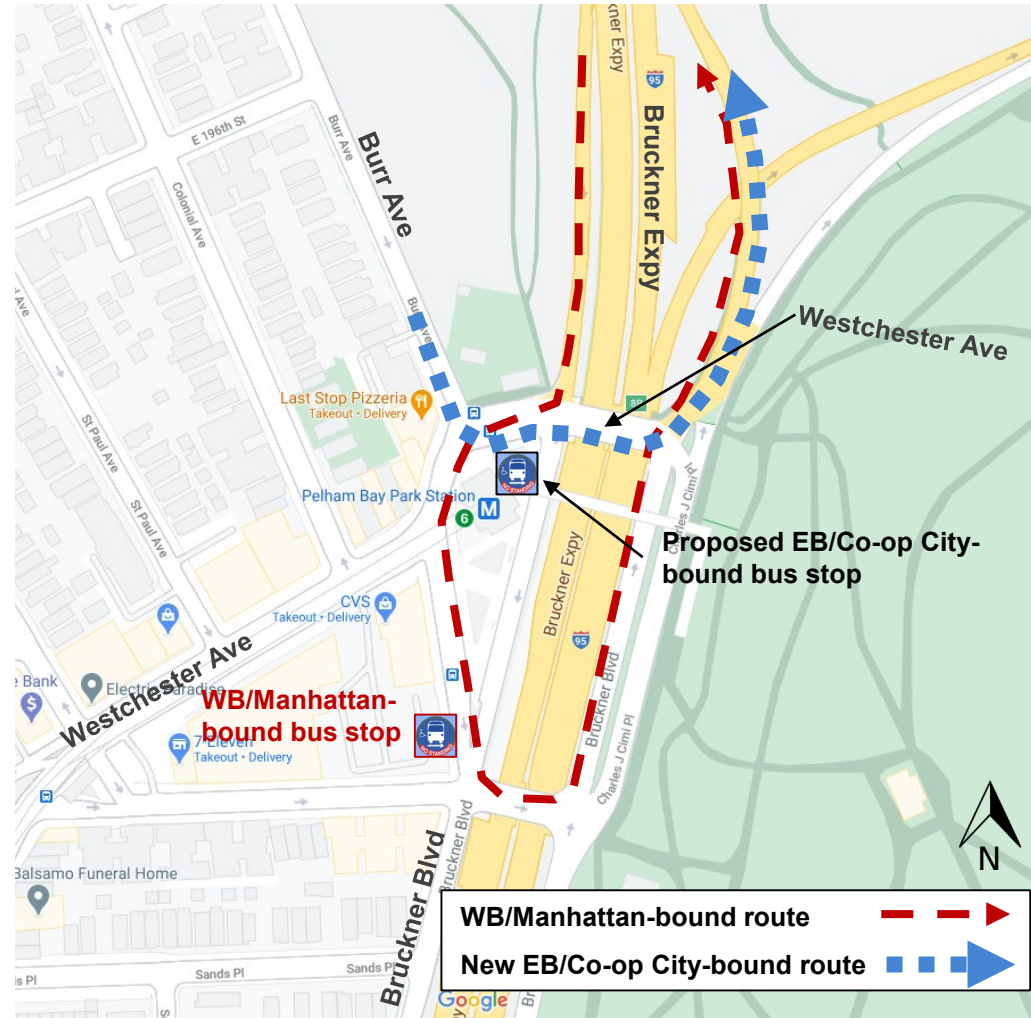

Proposed Improvements: Westchester Ave at Burr Ave

Existing Traffic Patterns

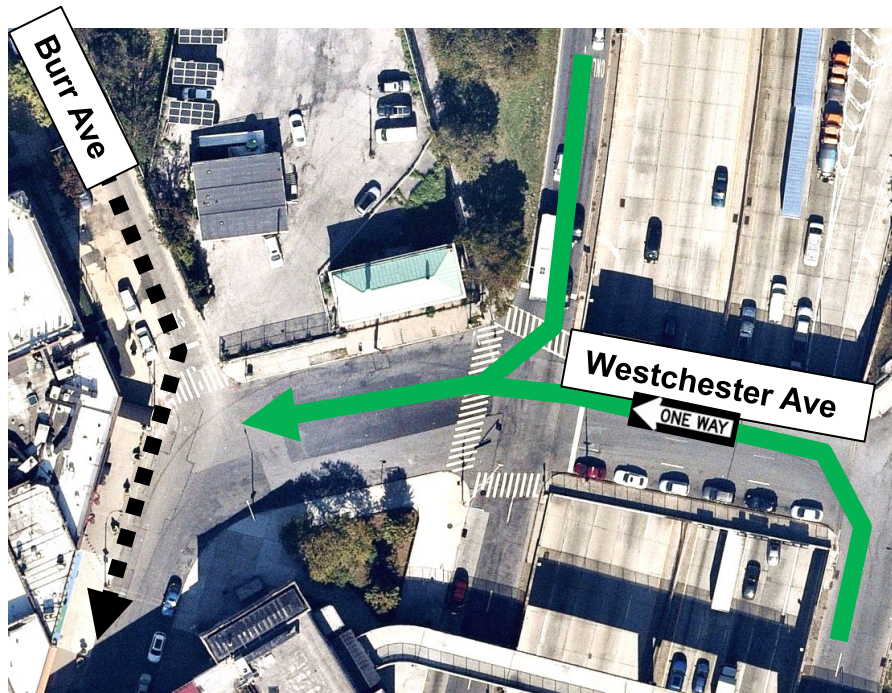

Proposed Traffic Patterns

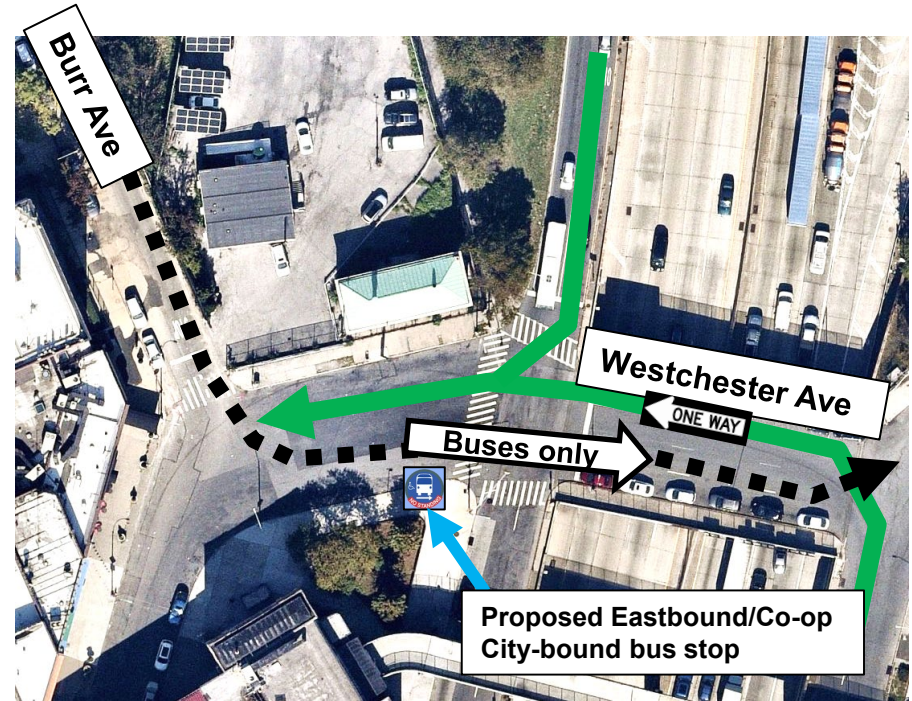

Eastbound/Co-op City-bound Bx12 SBS route

All other traffic, including buses/cars/trucks



Proposed Improvements

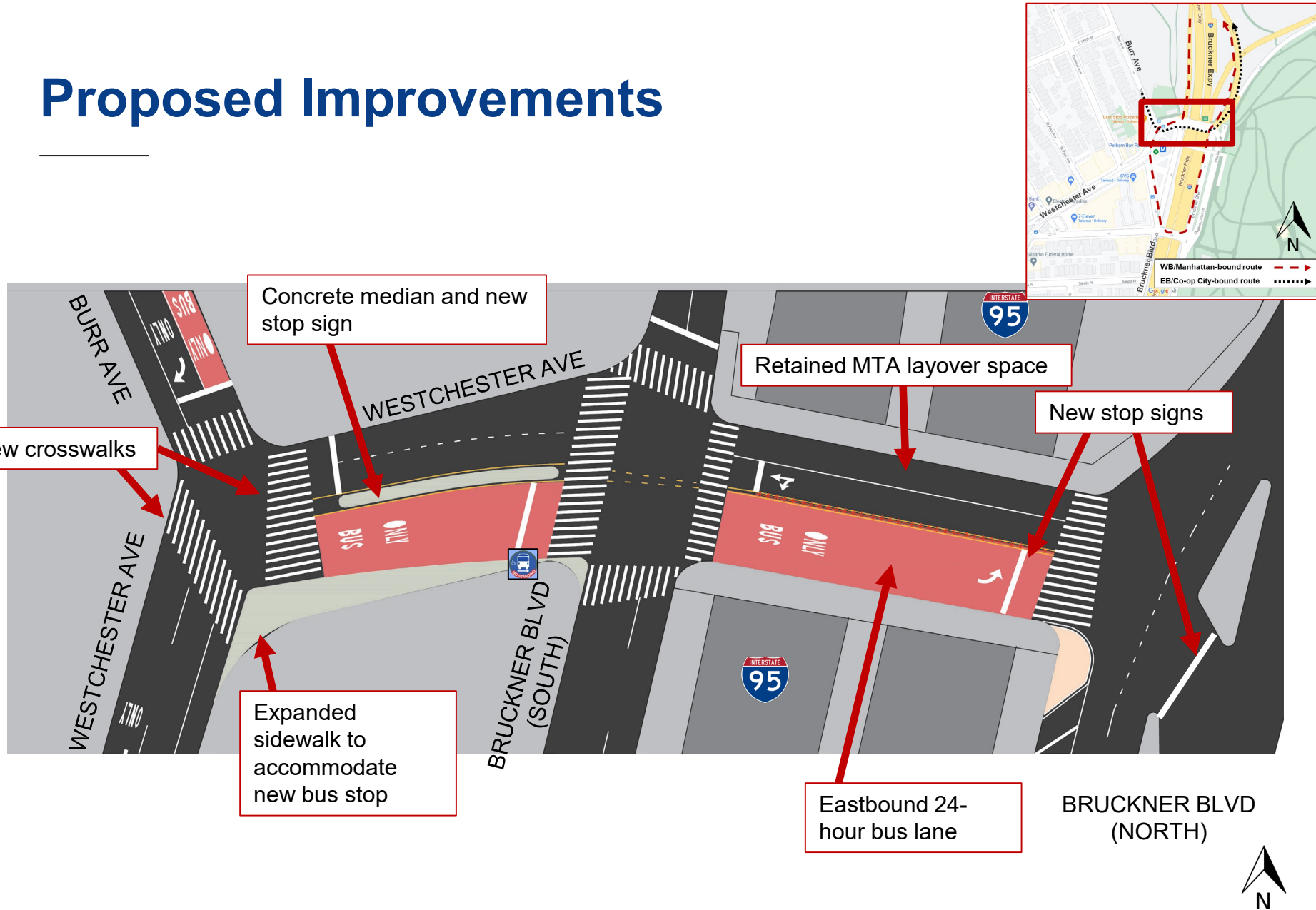

Proposed Improvements



Quick curb protection

New MTA layover space

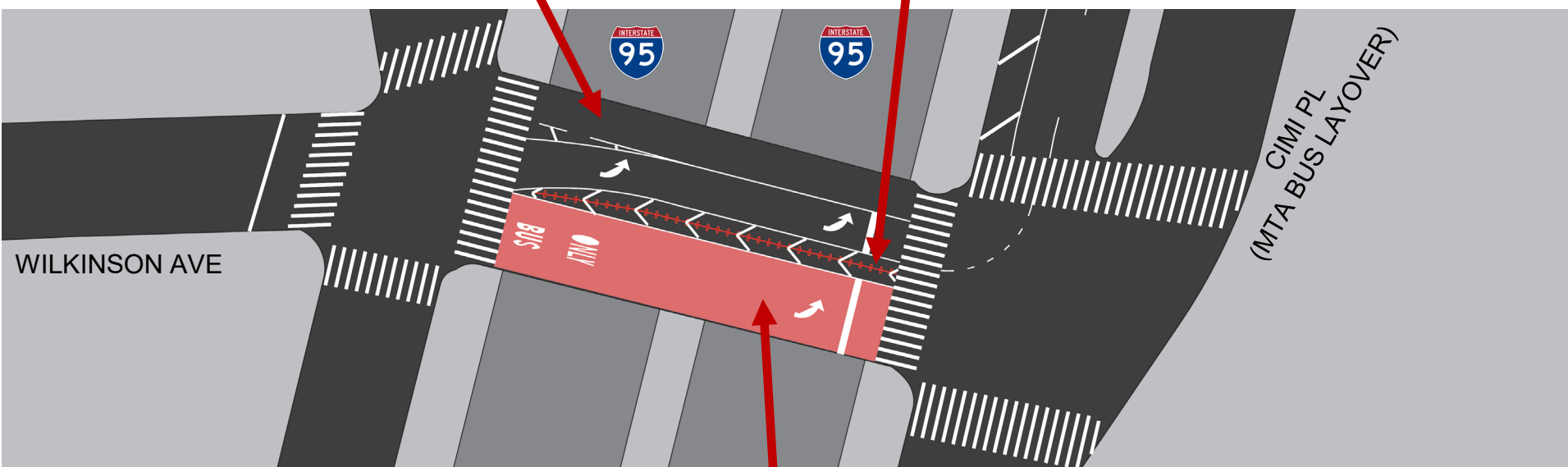
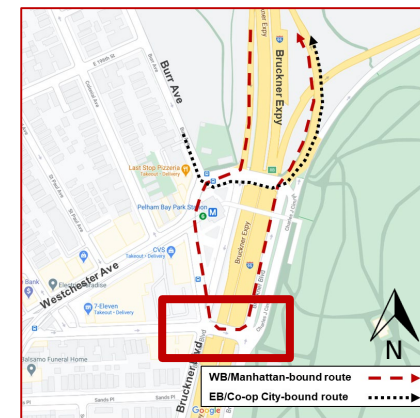

BRUCKNER BLVD
(SOUTH)

BRUCKNER BLVD
(NORTH)

Eastbound 24-
hour bus lane

Proposed Improvements: MTA Test Bus Run

- On December 10, 2020, DOT, MTA, and NYPD organized a test bus run to simulate bus operations with the new routing changes using cones to separate the test bus study area from existing traffic
- The bus was able to get to the proposed bus stop without issue
- The proposed lane configuration helped reduce weaving and improved organization of traffic



Benefits from Changes

- More direct routing for eastbound Bx12 SBS buses, saving as much as 2.5 minutes for 3,000 daily riders (125 total passenger hours daily)
- Reduced total Bx12 SBS end-to-end travel time by 5%
- Improved reliability for all Bx12 SBS riders
- Small but impactful project for bus riders, with organizational improvements to non-bus traffic

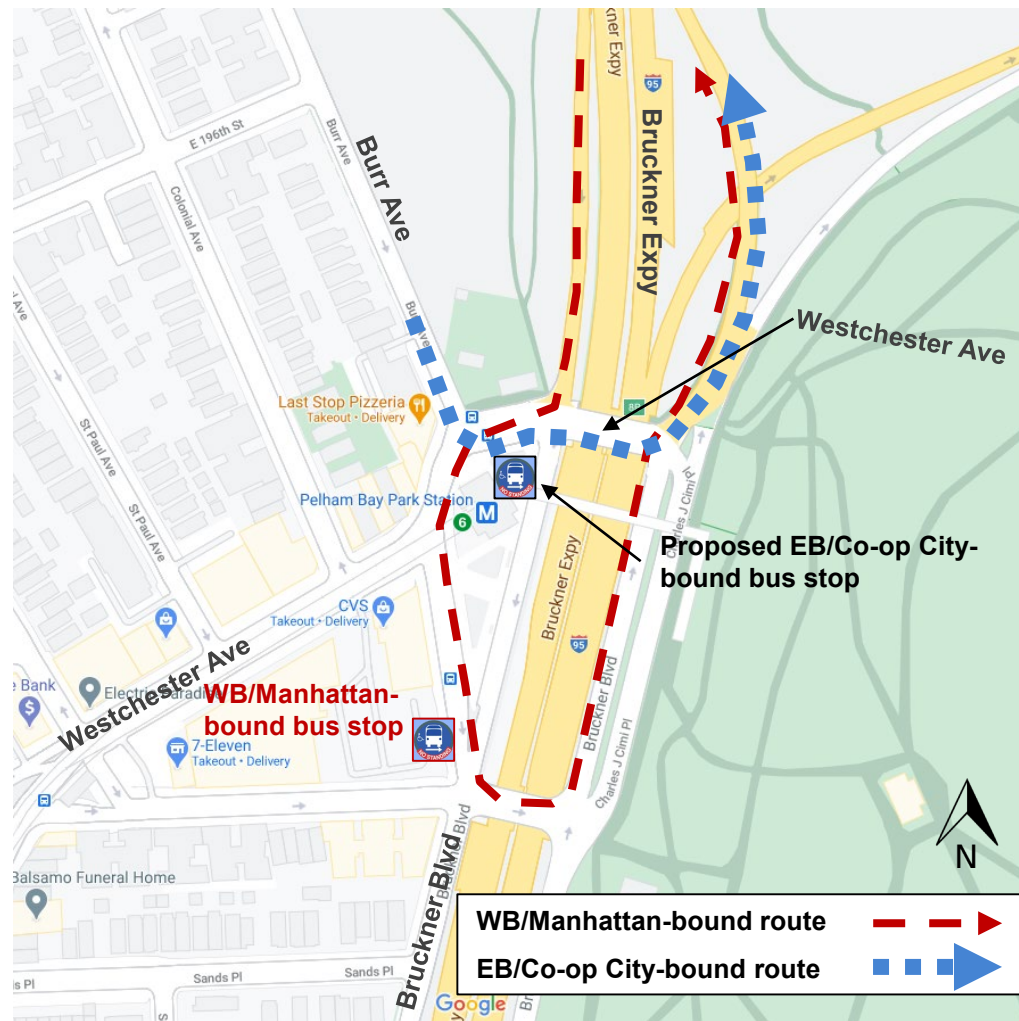

Next Steps

Summer 2021

- Build concrete sidewalk extension for relocated bus stop
- Relocate fare machines to new bus stop
- Install contraflow bus lane and re-route eastbound Bx12 SBS buses

Thank You!

Questions?



NYC DOT



NYC DOT



nyc_dot



NYC DOT

Appendix

Example Photo: “Quick Curb”



Example Photo: Contraflow Lane



© NYC DOT