



# PARK ROW AND BROADWAY

Presentation to Community Board 1  
Land Use, Zoning & Economic Development Committee  
November 13<sup>th</sup>, 2017

---

# Project Background

# 1

# PROJECT AREA

- Multiple, nearby pedestrian generators: Woolworth Building, City Hall Park, World Trade Center, Brooklyn Bridge
- Express busses pickup and drop off on Broadway
- 8 Subway Stations within a 5 min walk from intersection

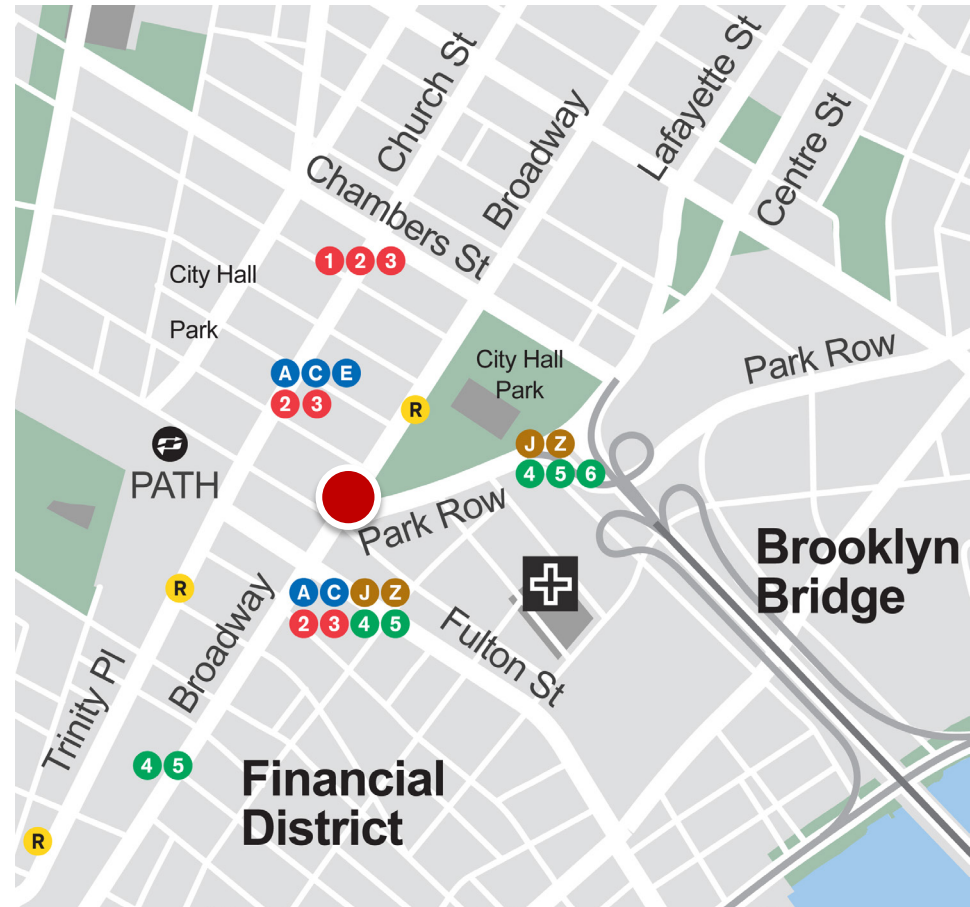



# SAFETY DATA

- 12 pedestrian injuries and one pedestrian KSI (killed or severely injured)
- One motorist KSI

## Park Row and Broadway, MH

Injury Summary, 2010-2014 (5 years)

	Total Injuries	Severe Injuries	Fatalities	KSI
Pedestrian	12	1	0	1
Bicyclists	3	0	0	0
Motor Vehicle Occupant	21	1	0	1
Total	36	2	0	2



---

## Existing Conditions

# 2

# EXISTING CONDITIONS – LONG, SKEWED CROSSINGS

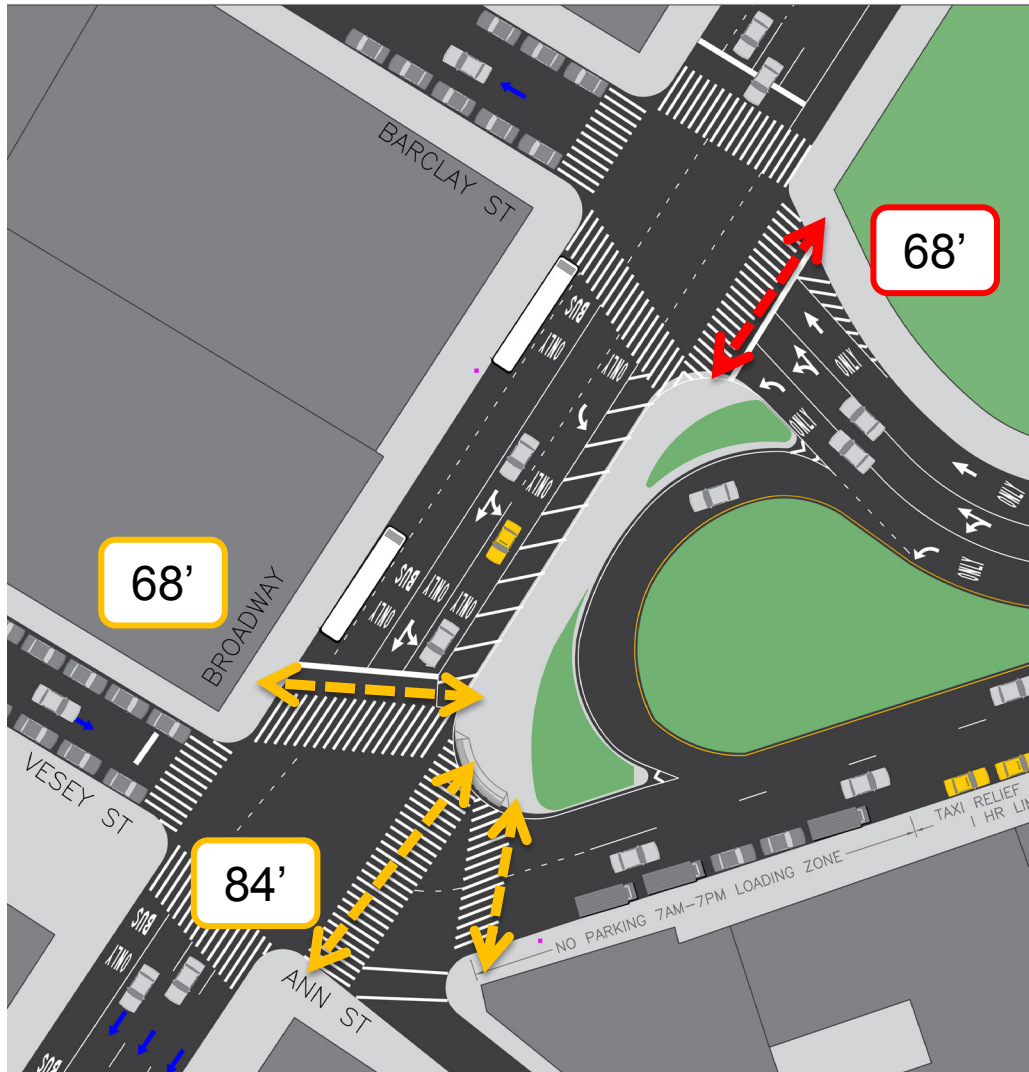



# EXISTING CONDITIONS – UNCLEAR LANE DESIGNATIONS

Two thru lanes  
merge to one  
receiving lane

Low volume left  
turn with two left  
turn lanes

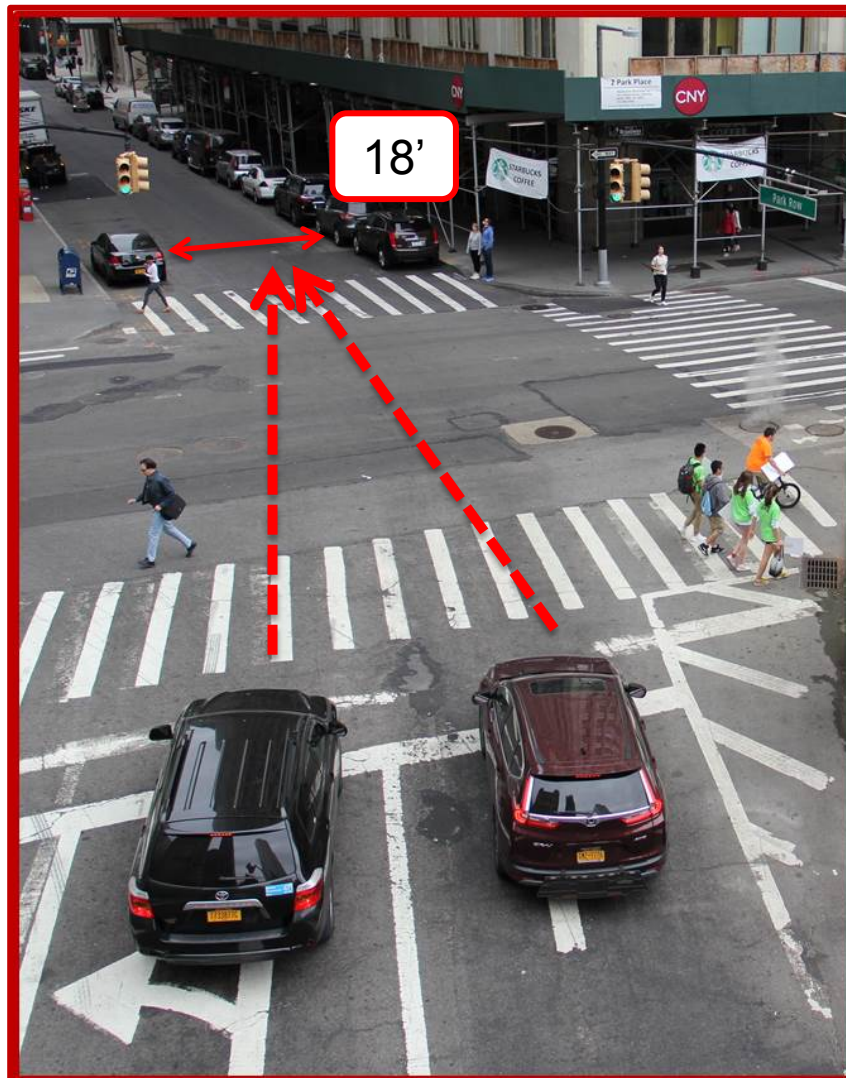

# EXISTING CONDITIONS – HEAVY TURNS

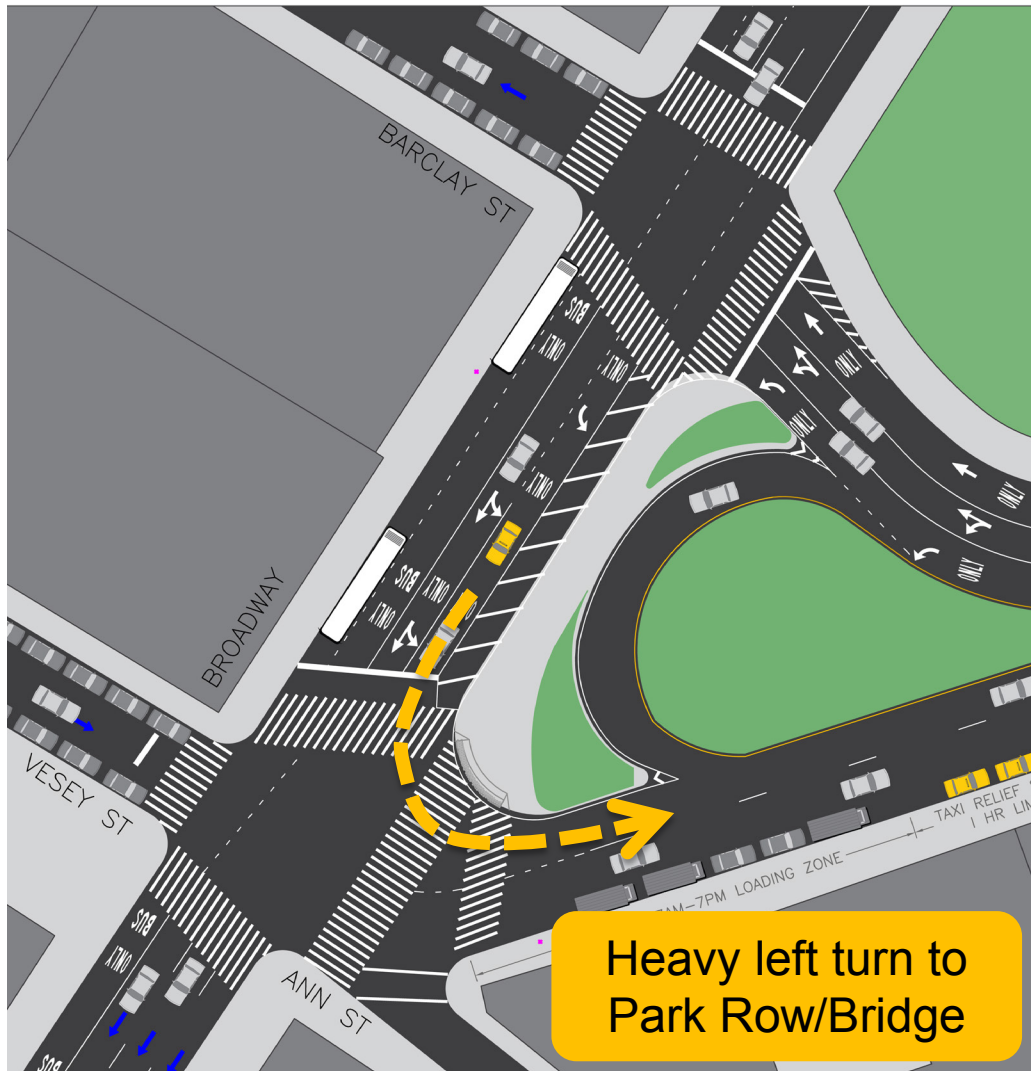



# EXISTING CONDITIONS – BARCLAY AND CHURCH ST

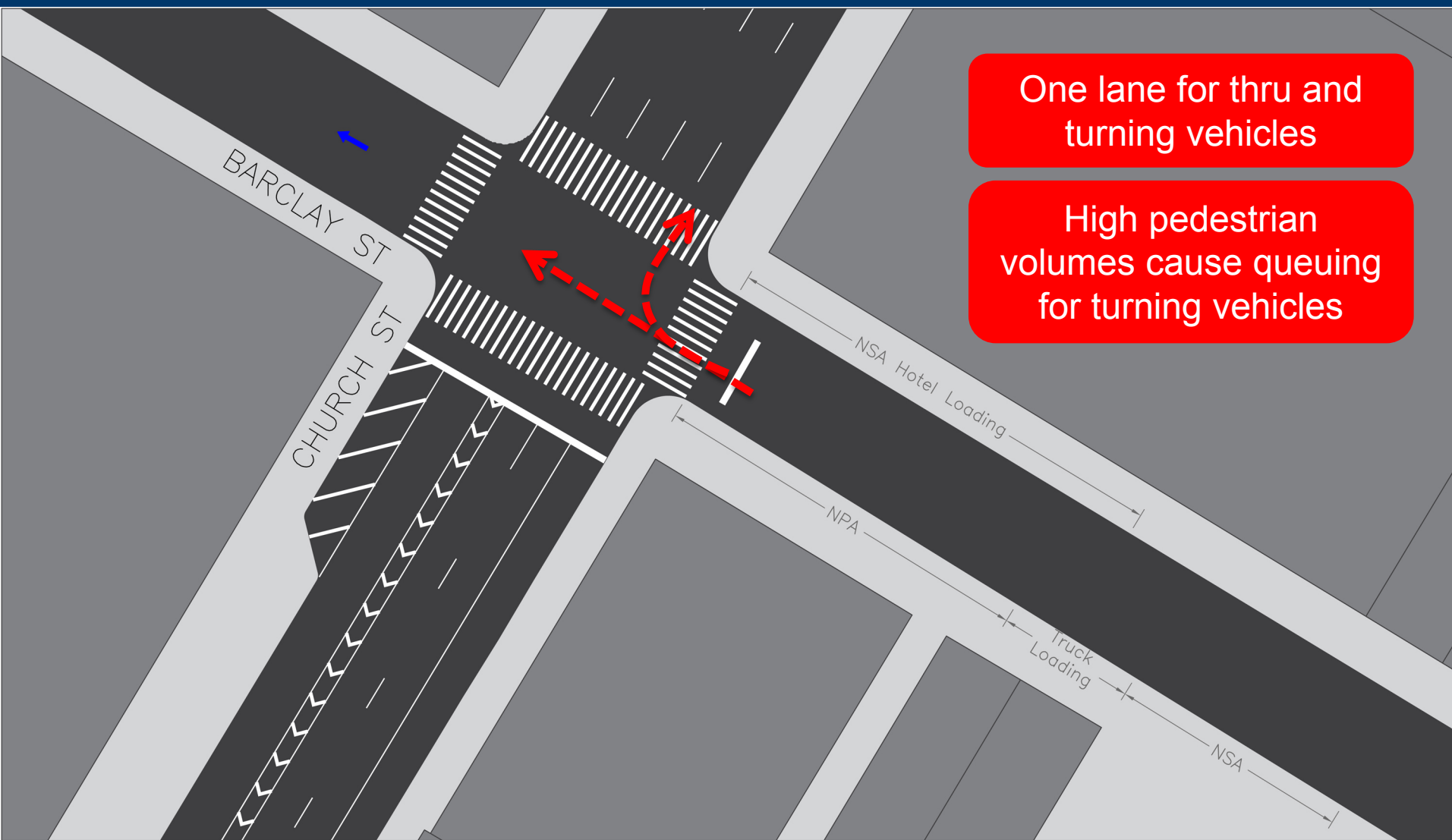

---

Proposal

3



# PROPOSAL

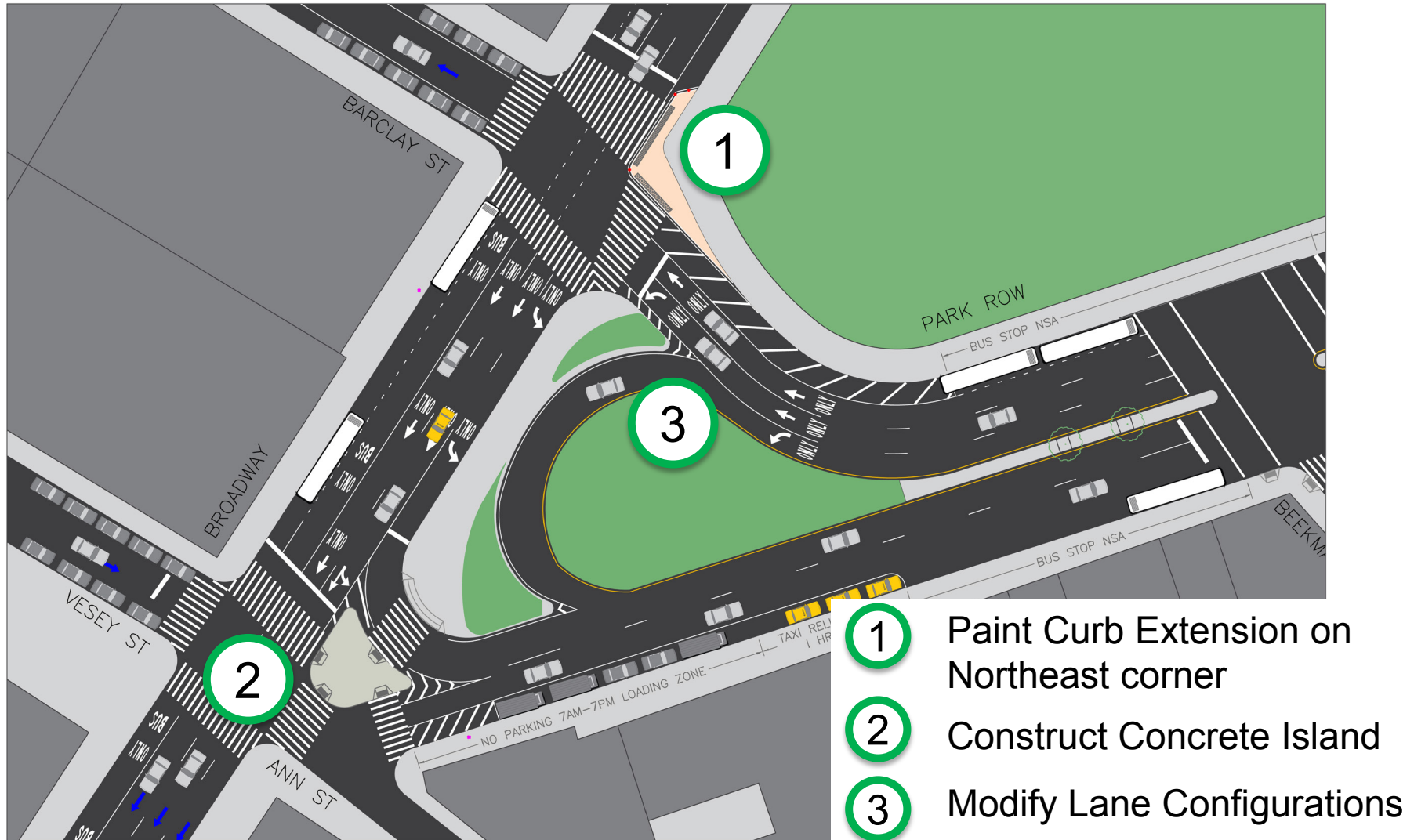

# PROPOSAL – SHORTER CROSSINGS

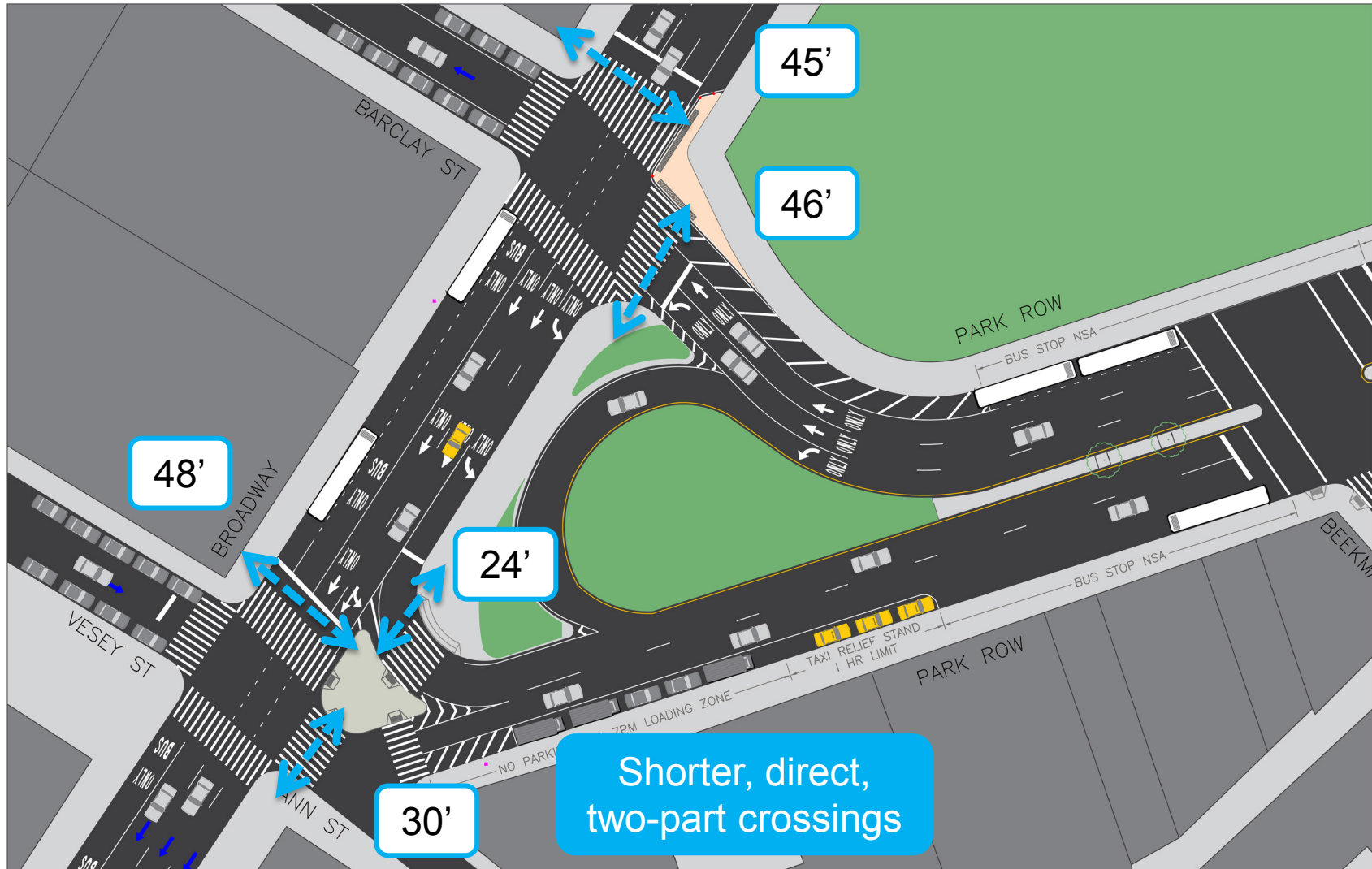



# PROPOSAL – CLARIFIED LANES

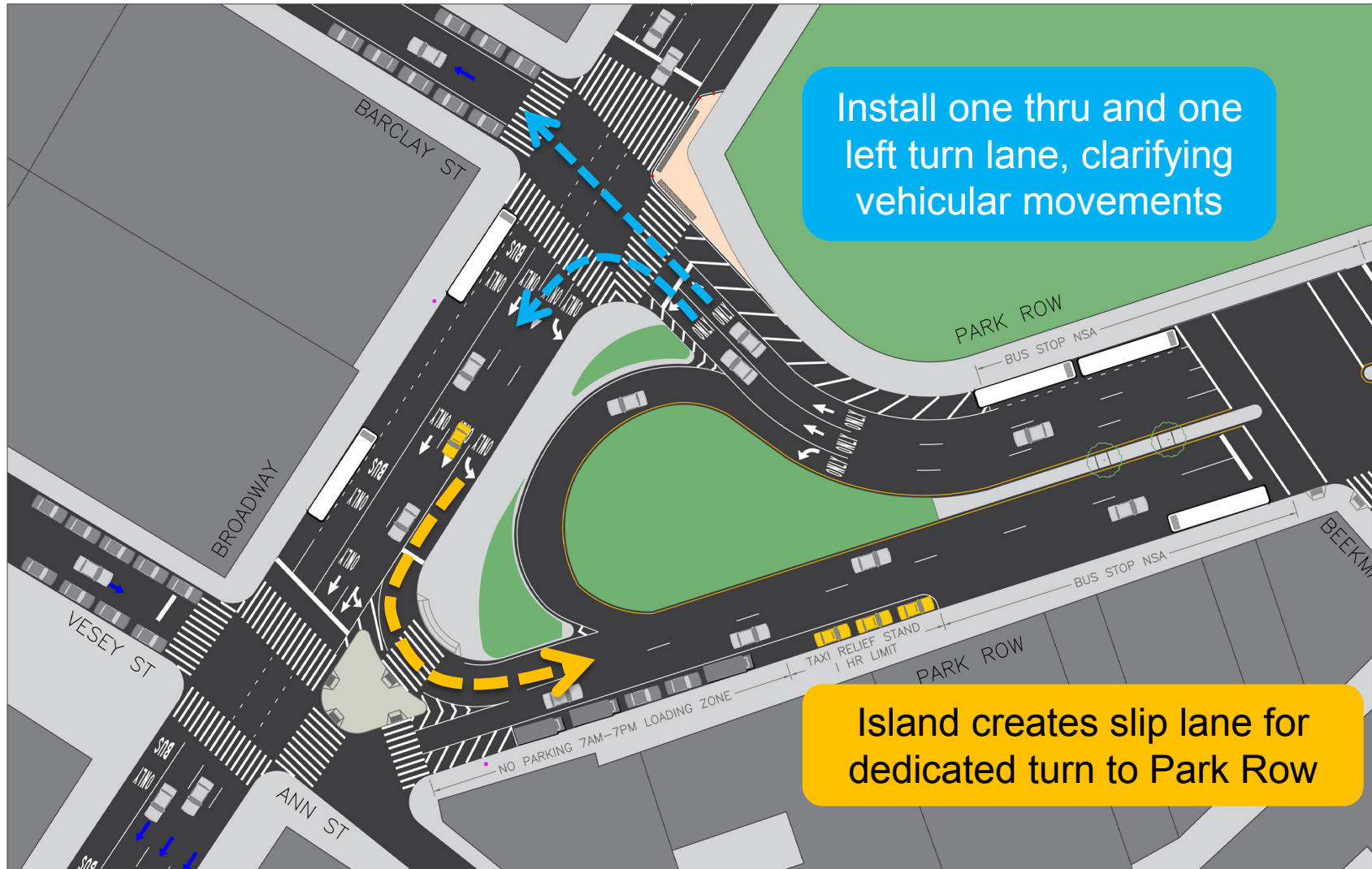

# PROPOSAL – BARCLAY AND CHURCH ST

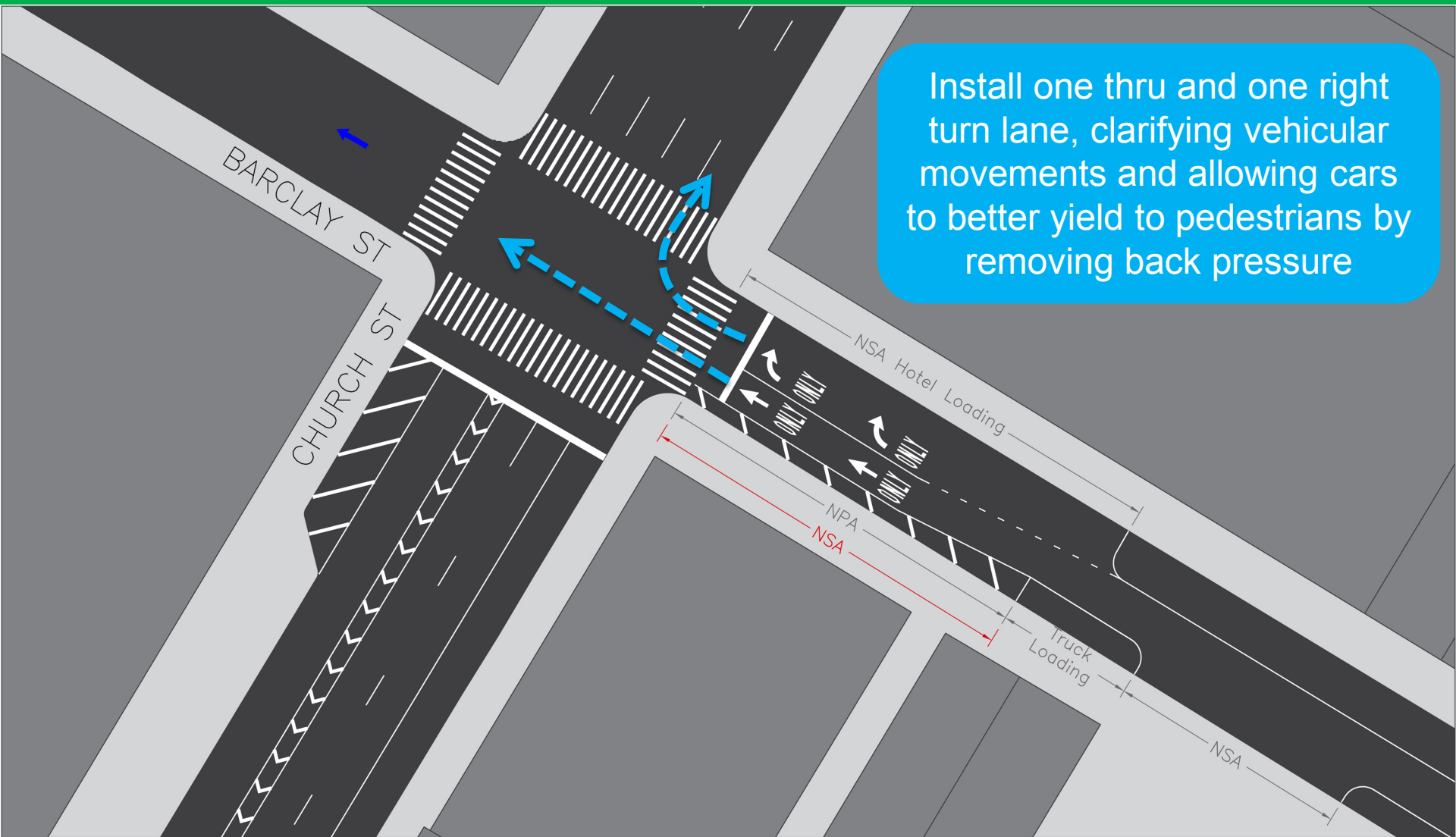

Install one thru and one right turn lane, clarifying vehicular movements and allowing cars to better yield to pedestrians by removing back pressure



# PROPOSAL SUMMARY

- Paint Curb Extension at Barclay St
- Construct Concrete Island at Vesey St
- Create slip lane from Broadway to Park Row
- Install one thru lane and one left turn lane for westbound Park Row approaching Broadway
- Install one thru lane and one right turn lane approaching Church St

## Benefits

- Shorter, more direct crossings
- Reduced pedestrian and vehicular conflicts
- Clear vehicular movements



# THANK YOU!

## Questions?



NYC DOT



NYC DOT



nyc\_dot



NYC DOT

# EXISTING - PROPOSED

