

Northern Blvd – Honeywell to Broadway

Corridor Safety Improvements

2016



Background

- Request from Council Member Van Bramer for safety improvements at the intersection of Northern and Broadway
- Additional request from Council Member Van Bramer for improvements at 41st St/36th Ave/Northern Blvd
- Request from community member for improvements at the intersection of 37th St/37th Ave/Northern Blvd

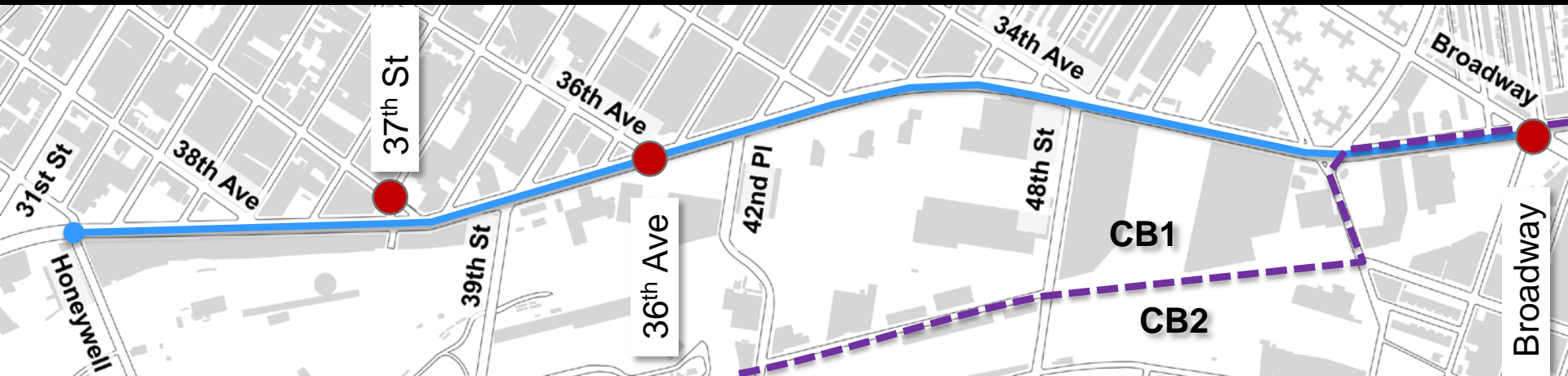

Safety Data

- Northern Blvd is a Vision Zero Priority Corridor
- 22 KSI (Killed or Severely Injured) in the project area

Northern Blvd - Honeywell St to Broadway, QN

Injury Summary, 2010-2014 (5 Years)

	Total Injuries	Severe Injuries	Fatalities	KSI
Pedestrian	43	9	1	10
Bicyclist	21	3	0	3
Motor Vehicle Occupant	265	9	0	9
Total	329	21	1	22

Fatalities, 01/01/2010-12/31/2016 : 1

Source: Fatalities: NYCDOT
Injuries: NYSDOT
KSI: Persons Killed or Severely Injured



Context

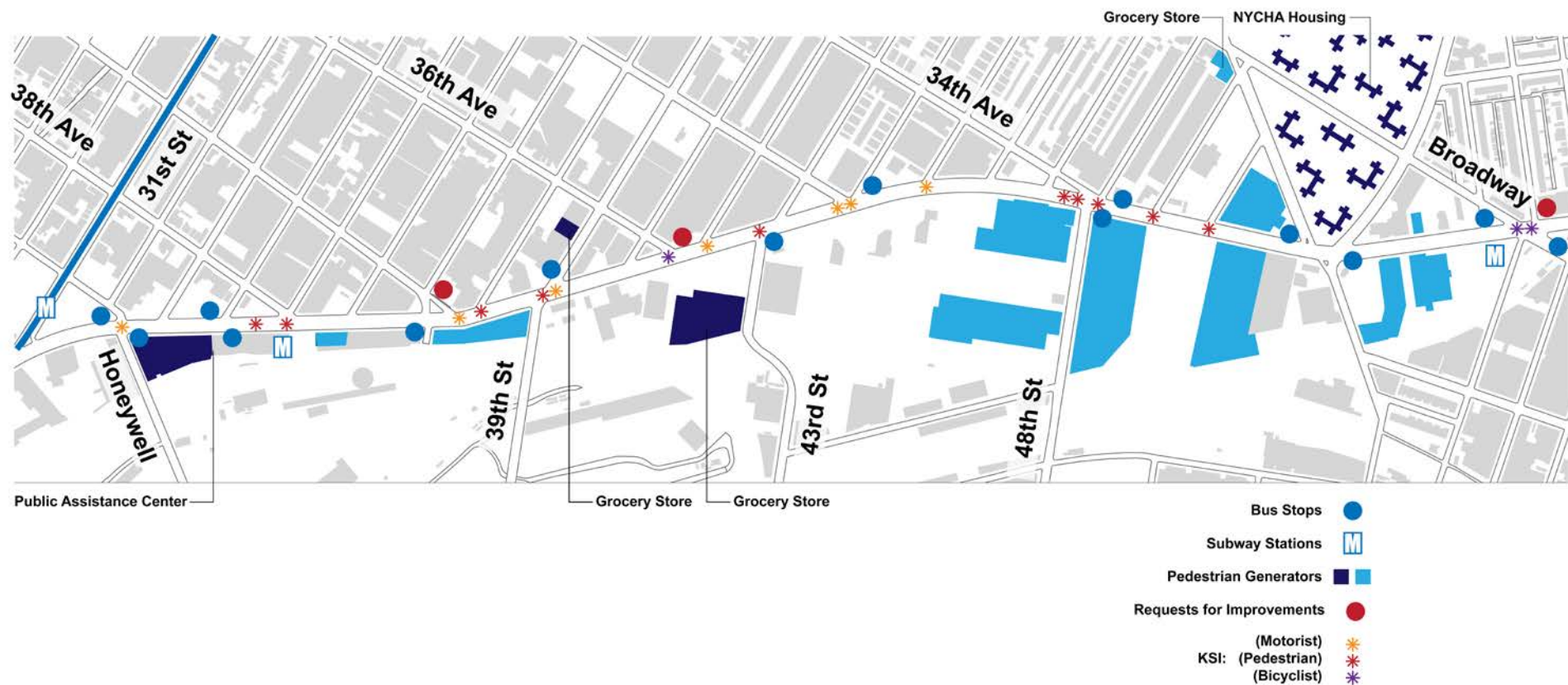

Primary Corridor Issue

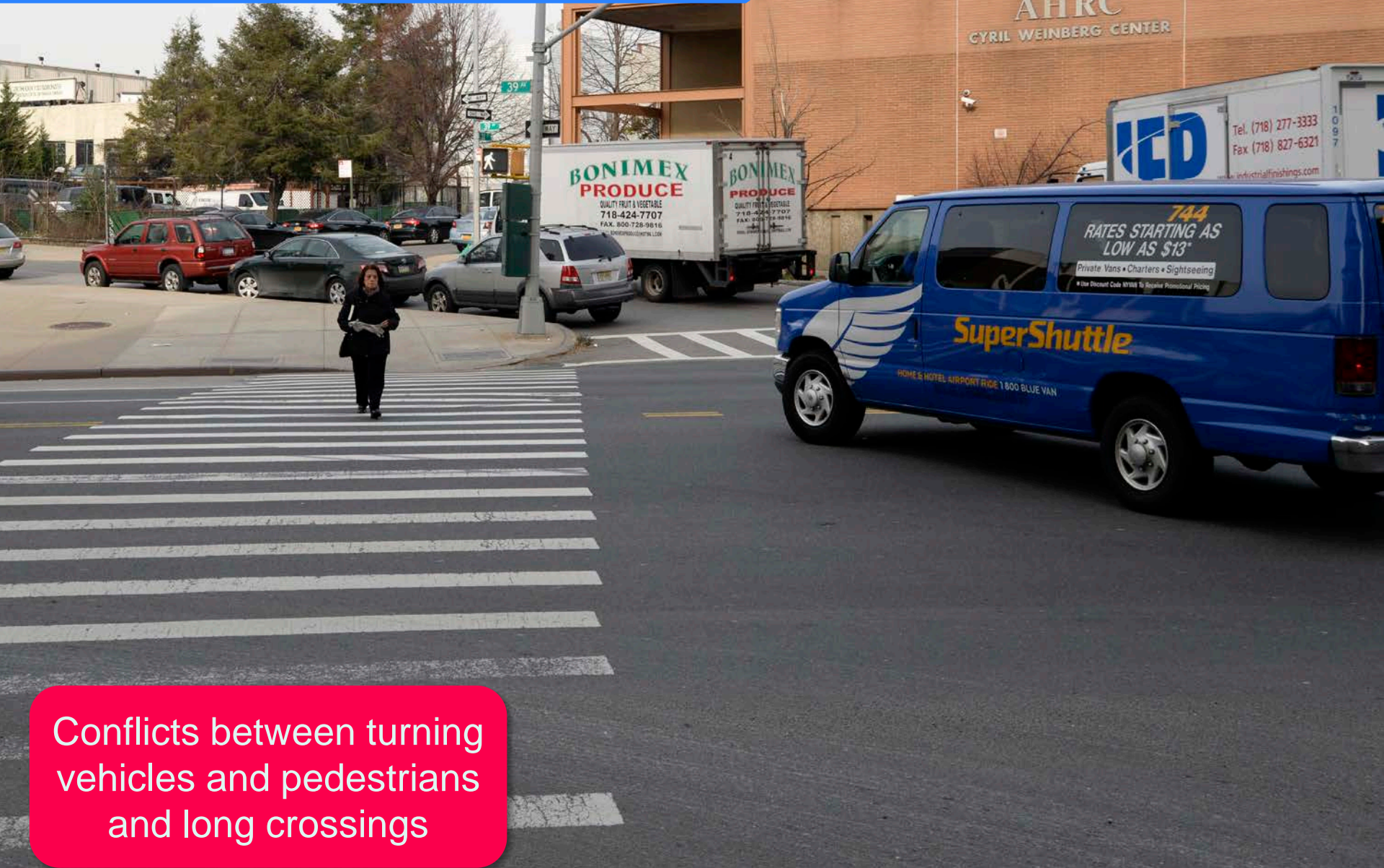

Conflicts between turning vehicles and pedestrians and long crossings

Proposal

- Construct 15 pedestrian safety islands

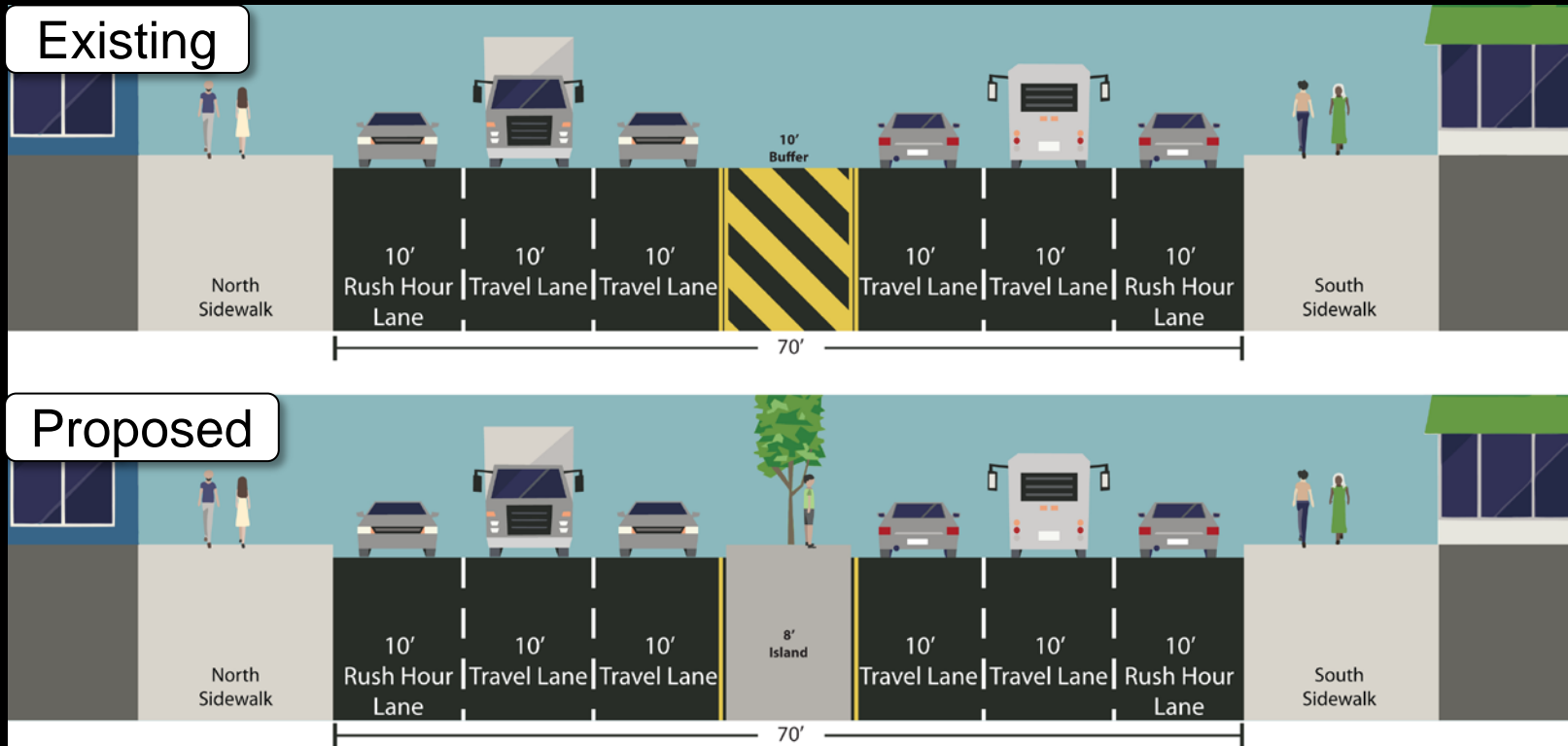

Proposal

- Improve operations at 8 locations
- Investigating possibility for signal changes along the corridor:
 - LPI
 - All Pedestrian Phase
 - Split phase left turn
- Investigating sidewalk treatment where driveways are signalized

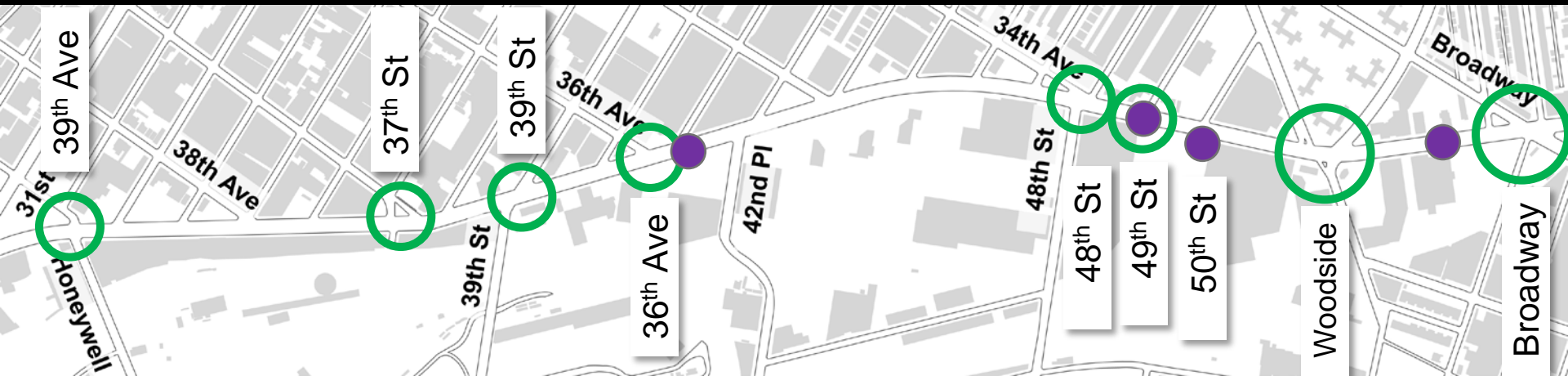

Existing Conditions – Honeywell St

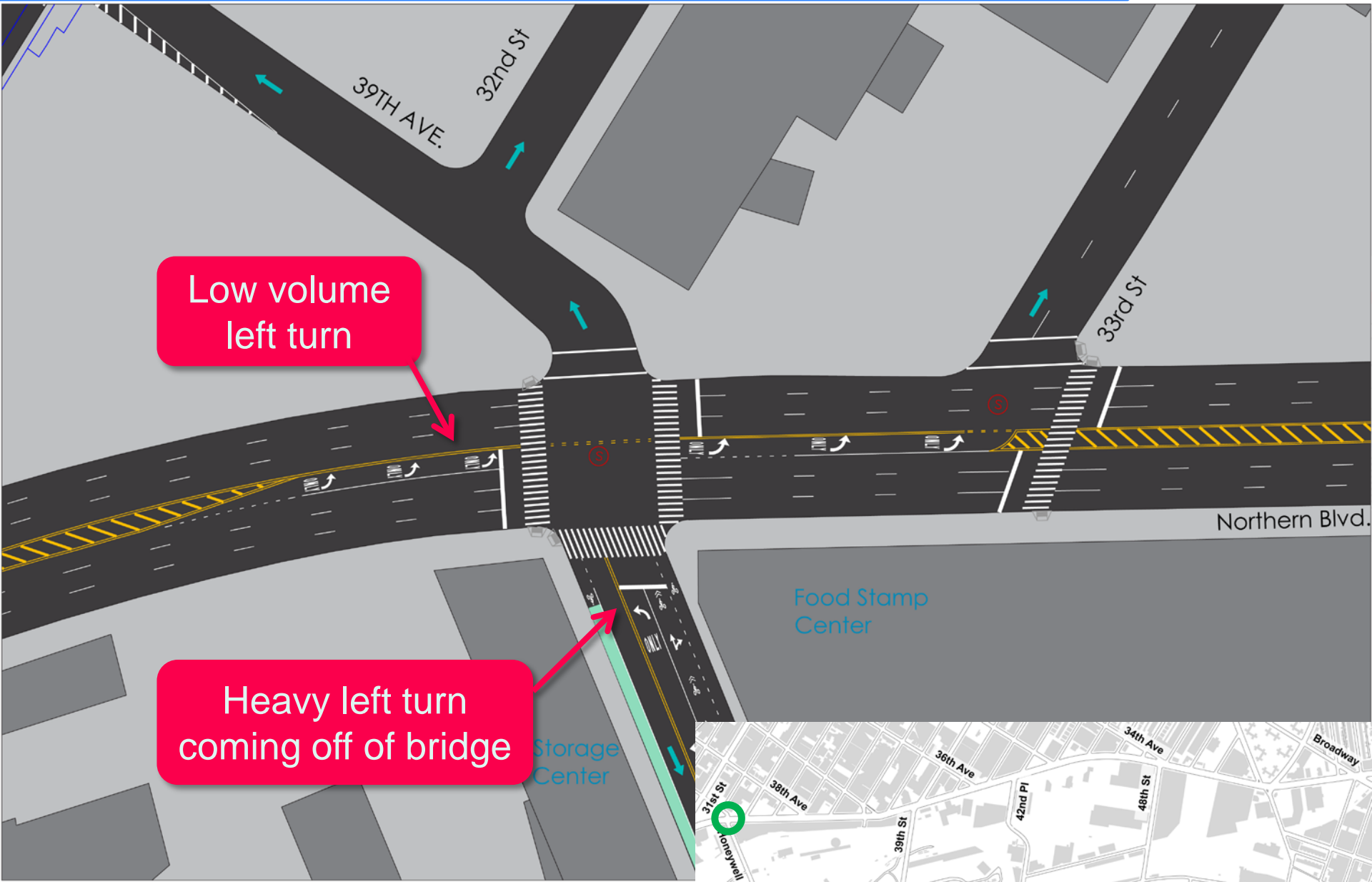

Proposed Conditions – Honeywell St

Close bay, ban turn and construct island

Construct island in channelization

Vehicles affected by ban:
35 cars in AM peak
15 cars in PM peak
Alternate route using 31st St



Proposed Conditions – 37th St



Vehicles affected by ban:
40 cars in AM peak
55 cars in PM peak
Alternate route using 35th St

Existing Conditions – Steinway St

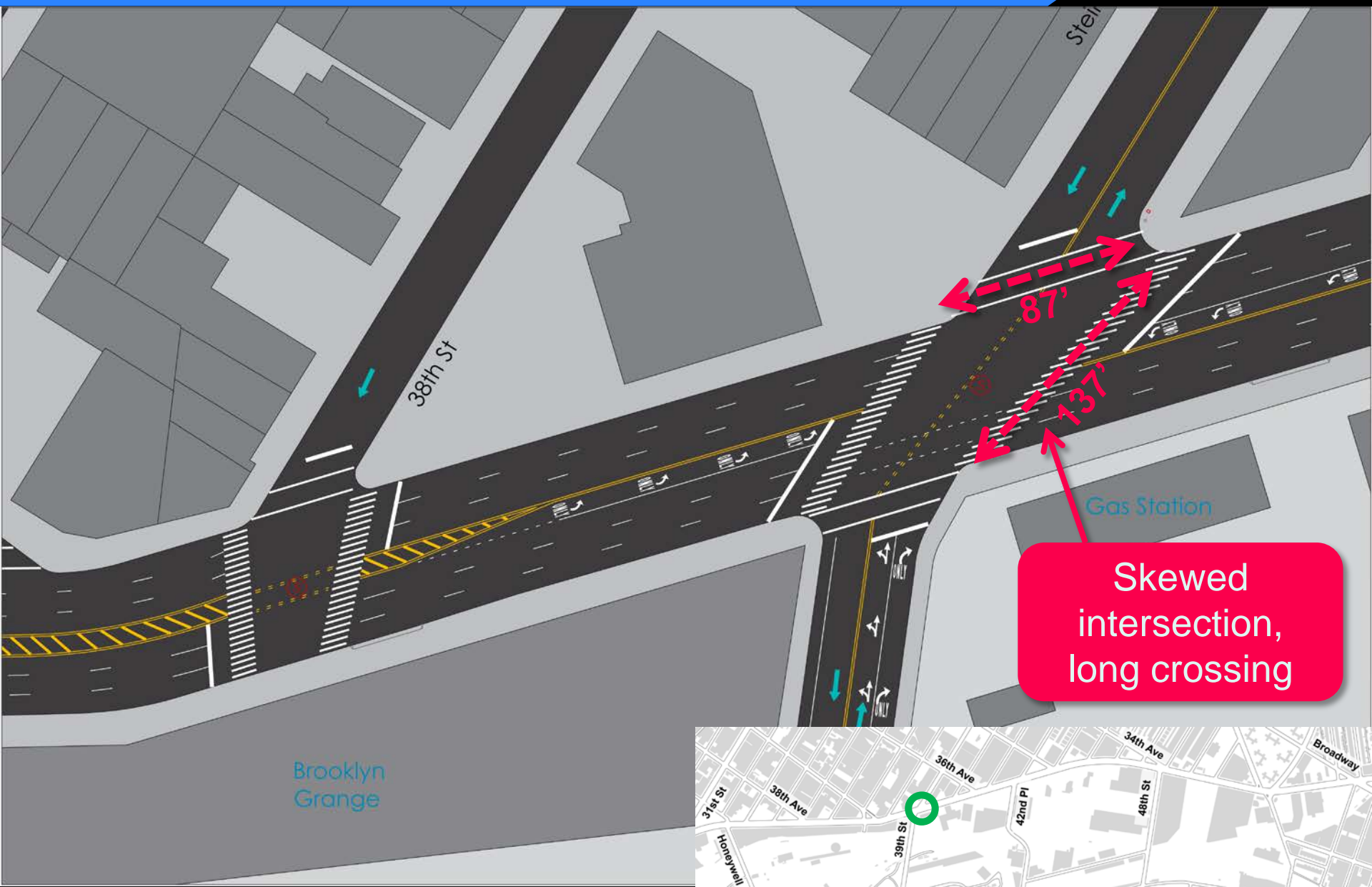

Proposed Conditions – Steinway St

Vehicles affected by ban:
15 cars in AM peak
20 cars in PM peak
Alternate route using 36th Ave

Construct curb extension
shortening
crosswalks, ban
right turn

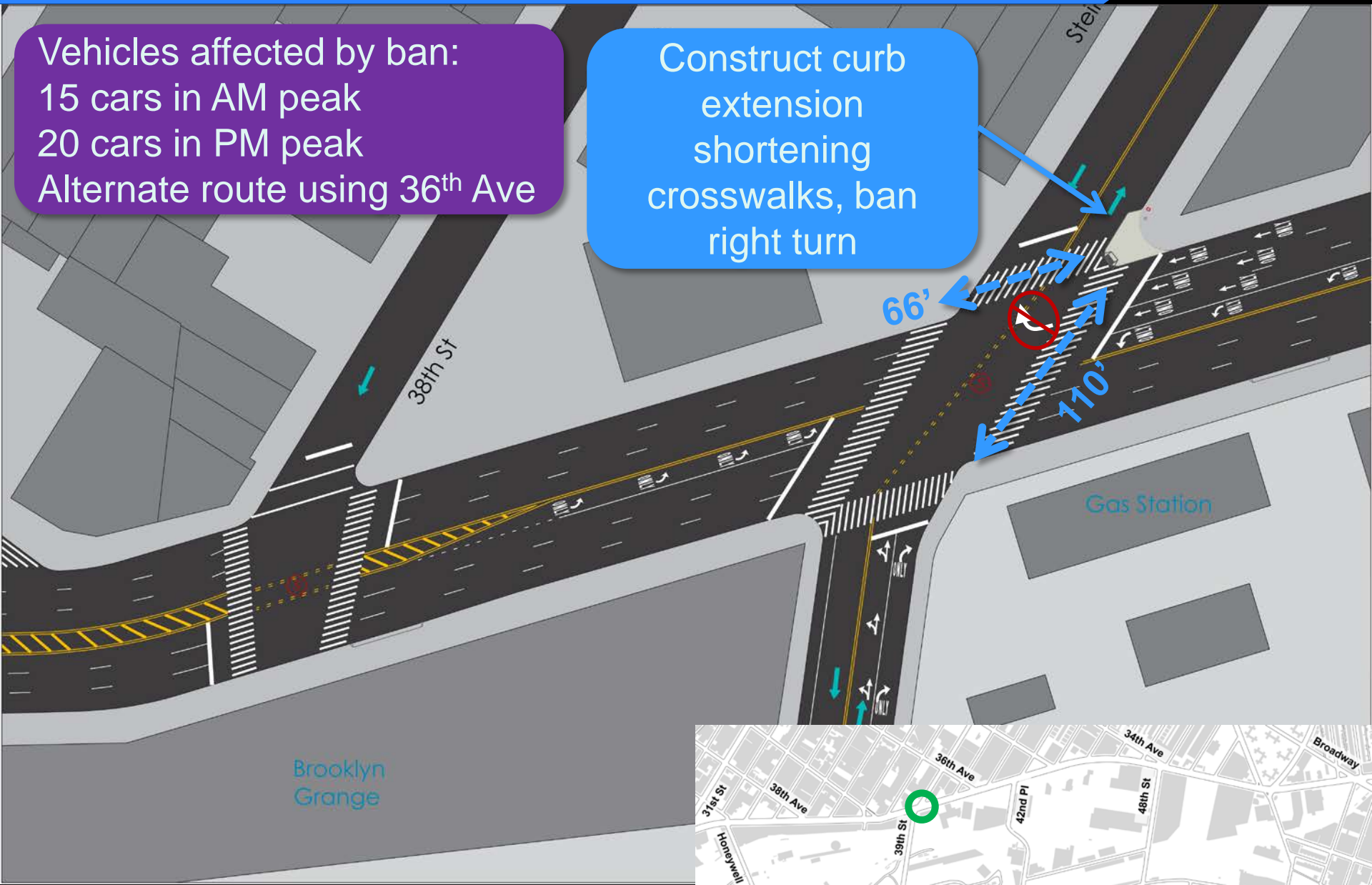

Alternate Routes – Steinway St

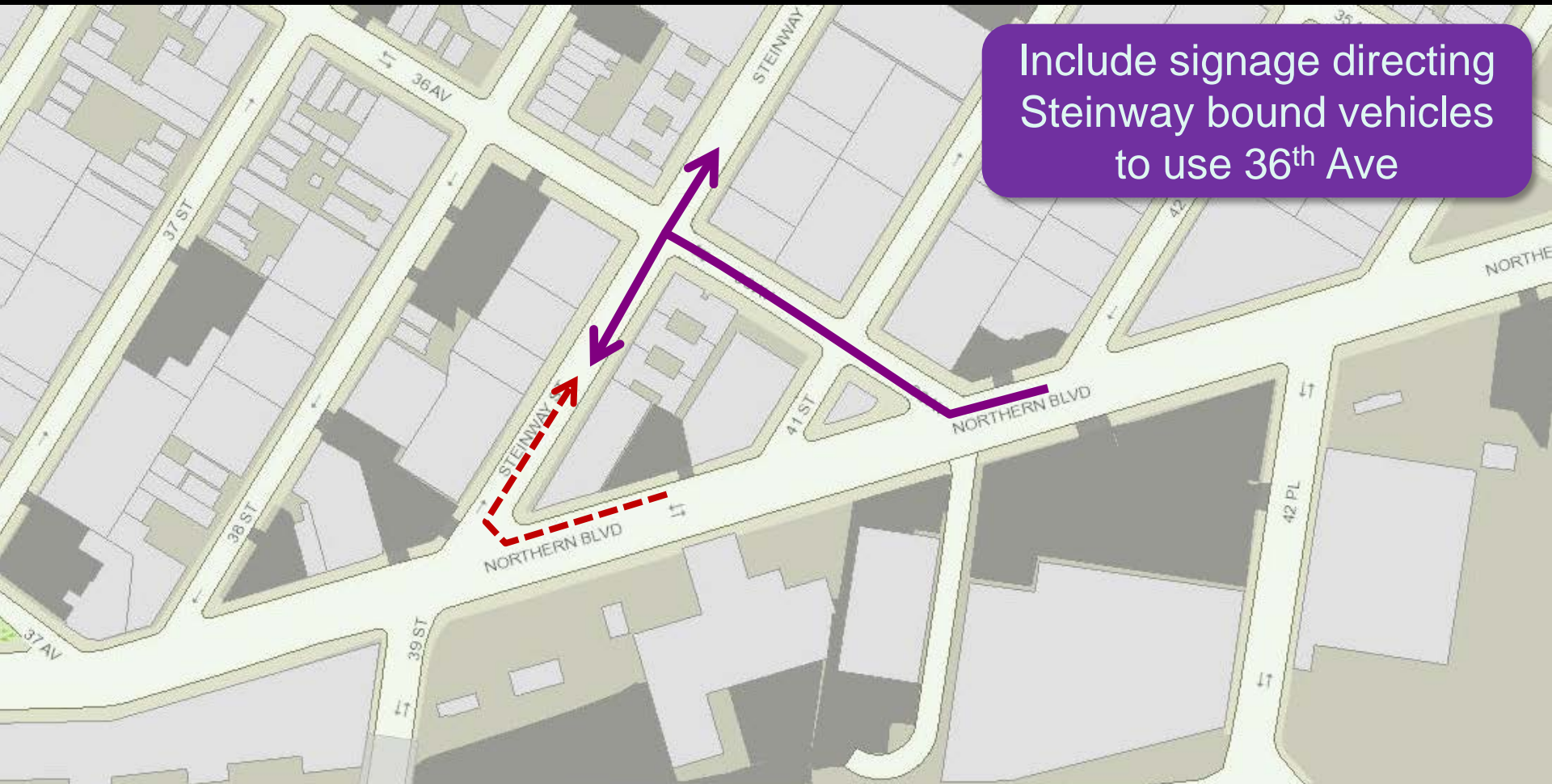

Include signage directing Steinway bound vehicles to use 36th Ave



Banned movements under proposal
Alternate Route

Vehicles affected by ban:
15 cars in AM peak
20 cars in PM peak

Existing Conditions – 41st St

Sharp left turn
into crosswalk

Low volume left
turn with
redundant bay

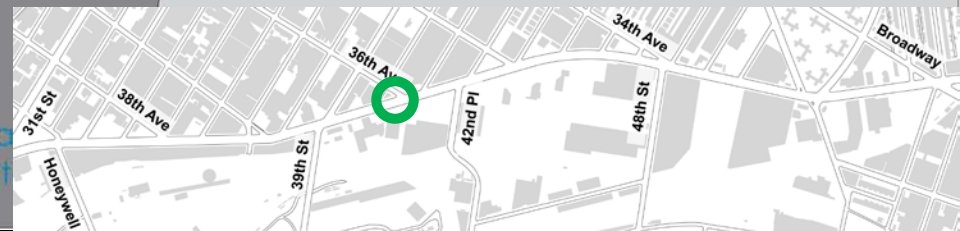

Proposed Conditions – 41st St

Vehicles affected by ban:
5 cars in AM peak
0 cars in PM peak
Alternate left turn at 41st St

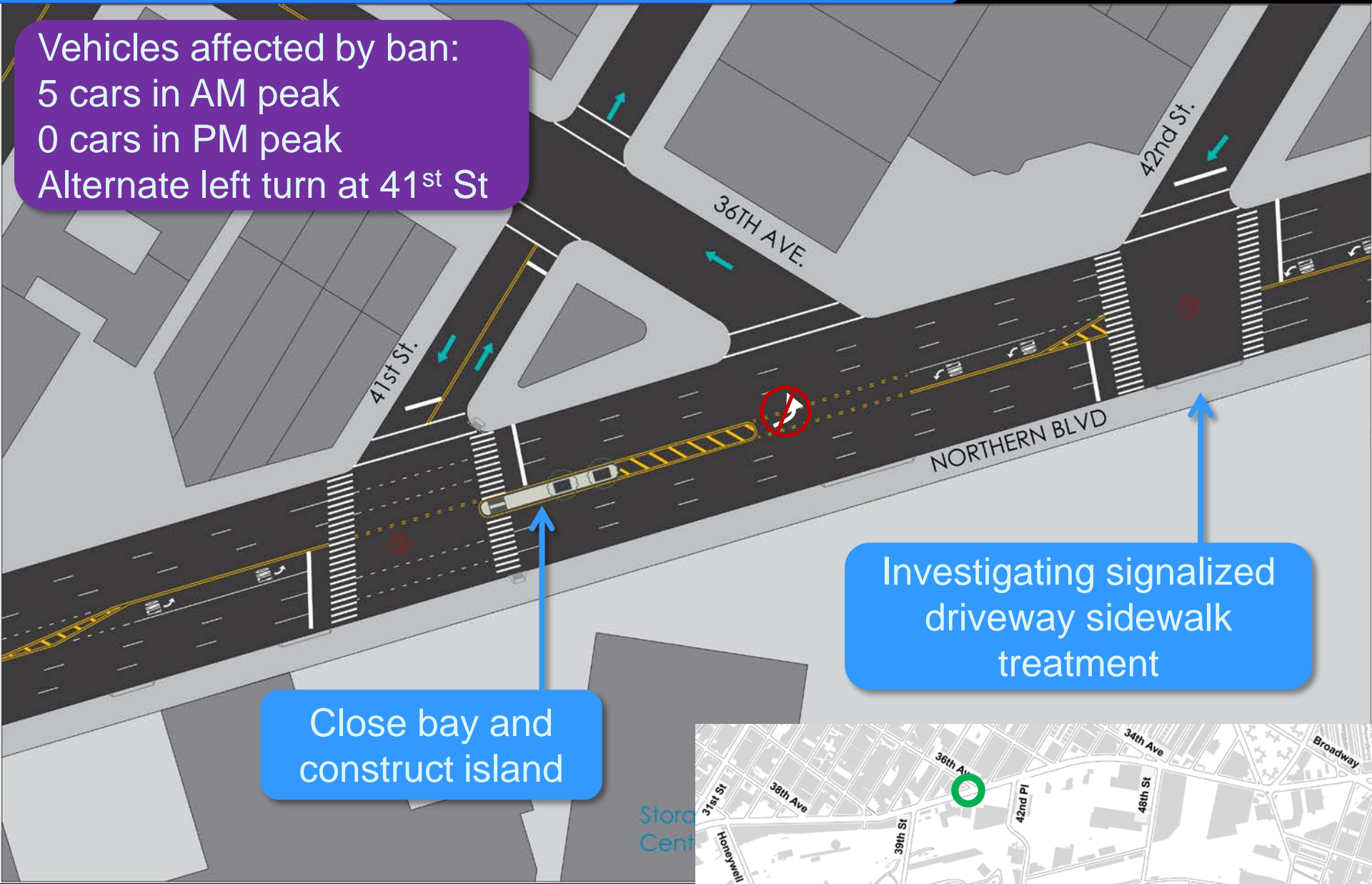

Close bay and
construct island

Investigating signalized
driveway sidewalk
treatment

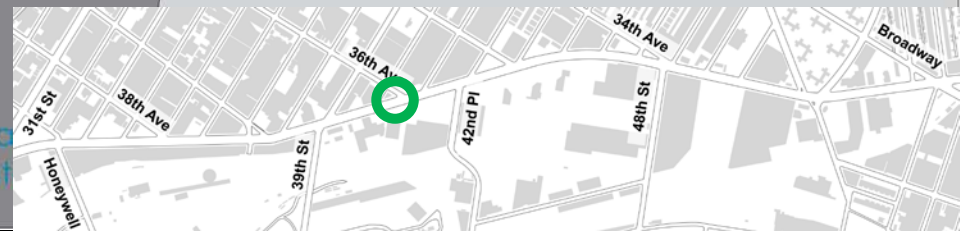

Existing Conditions – 48th St

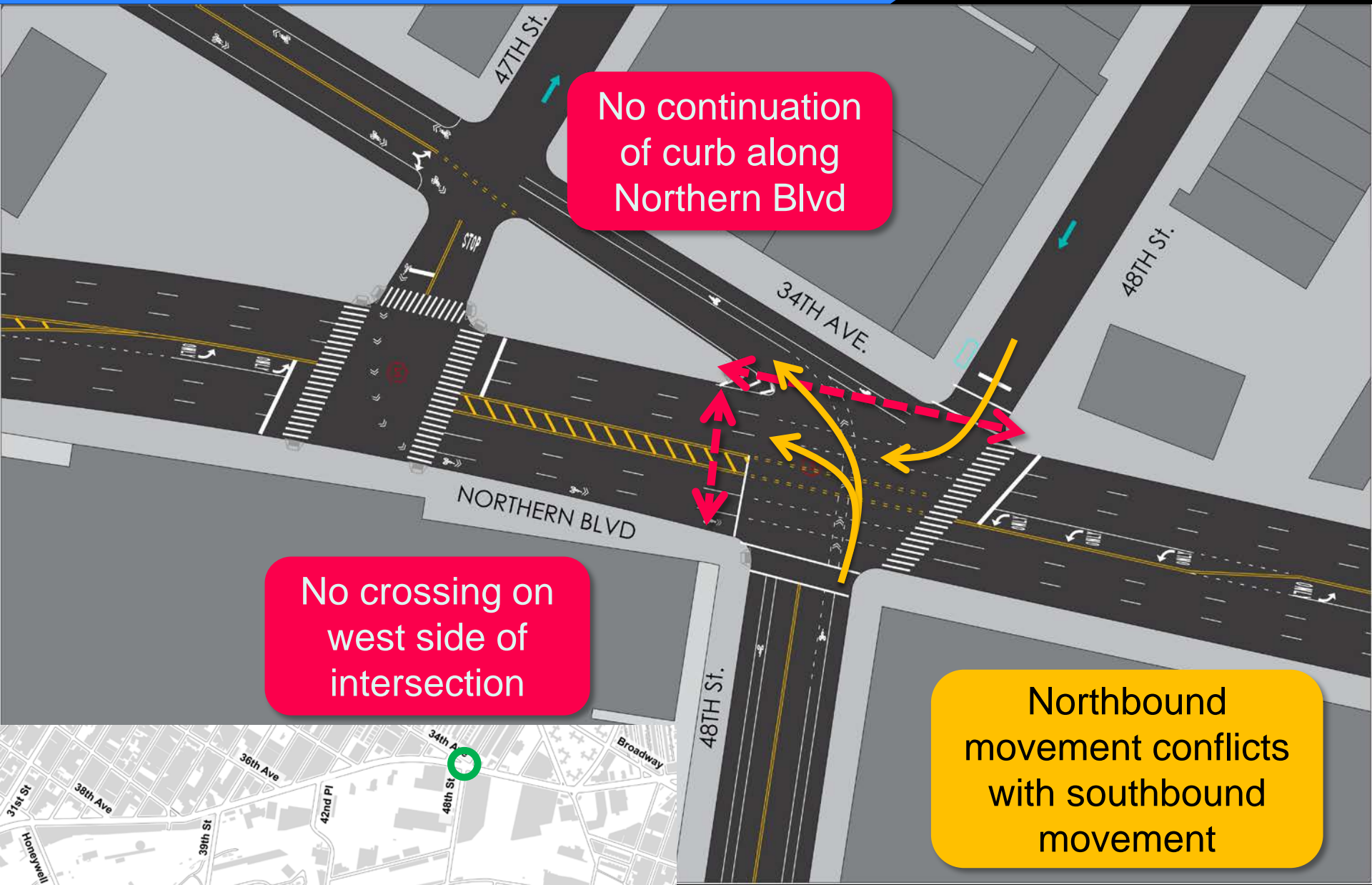

Proposed Conditions – 48th St

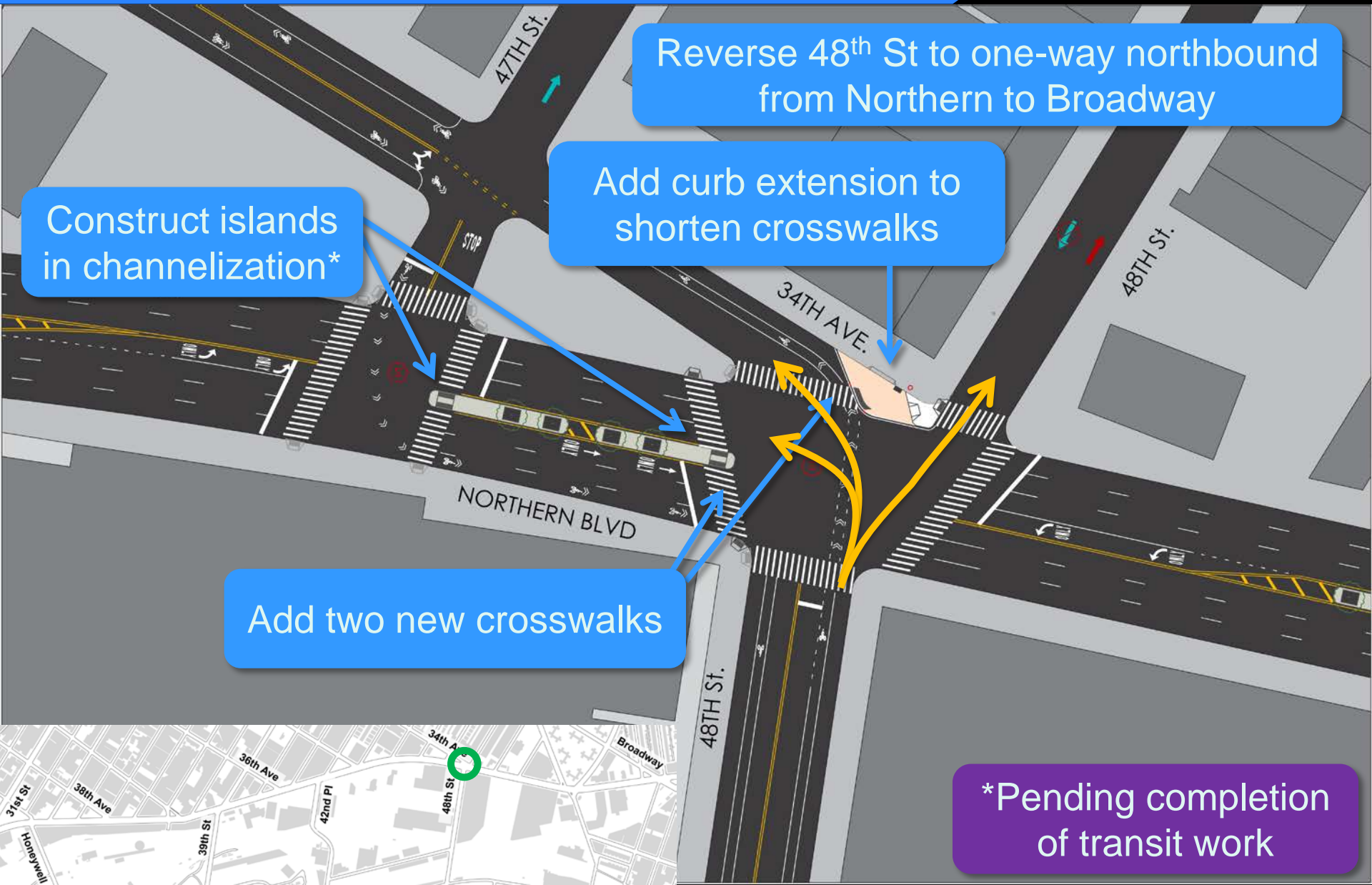

Reversal Proposal



Proposed Street Direction



Existing Street Direction

Existing

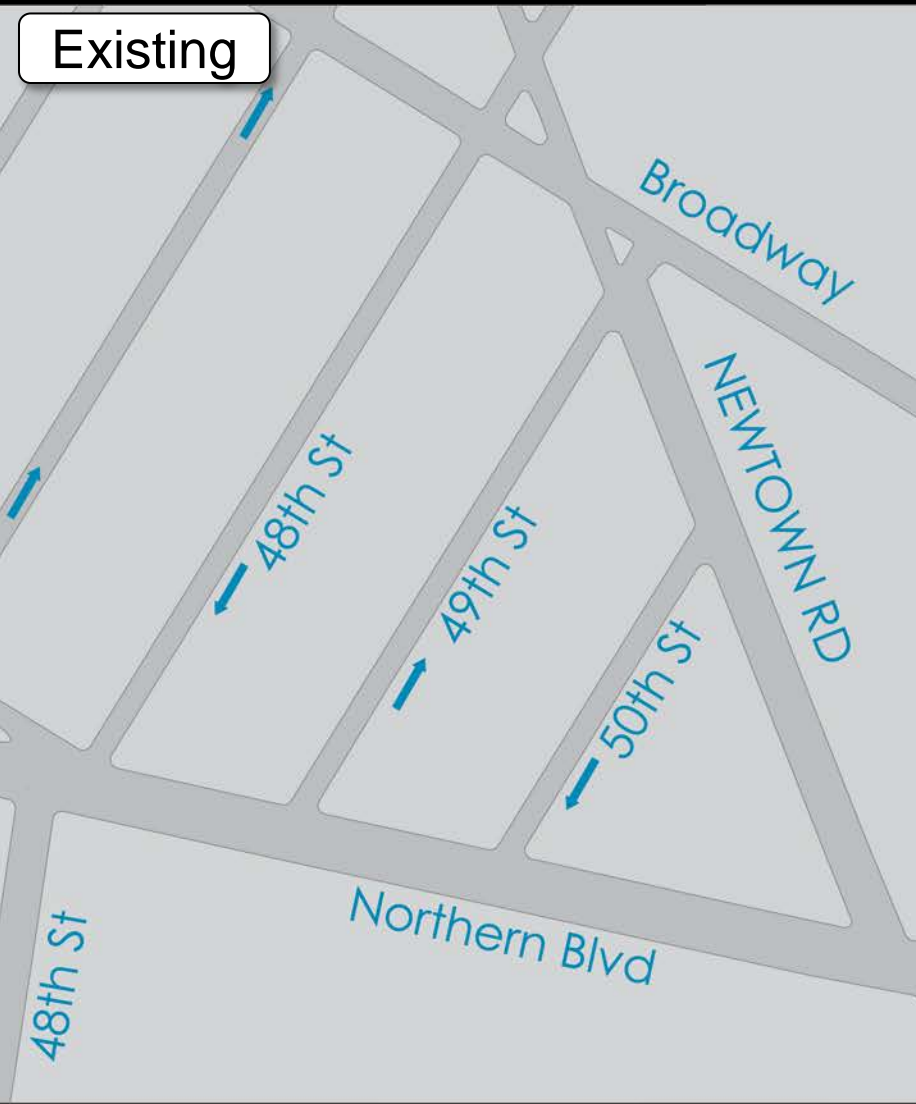

Proposed

Bus network
changes under
analysis by MTA

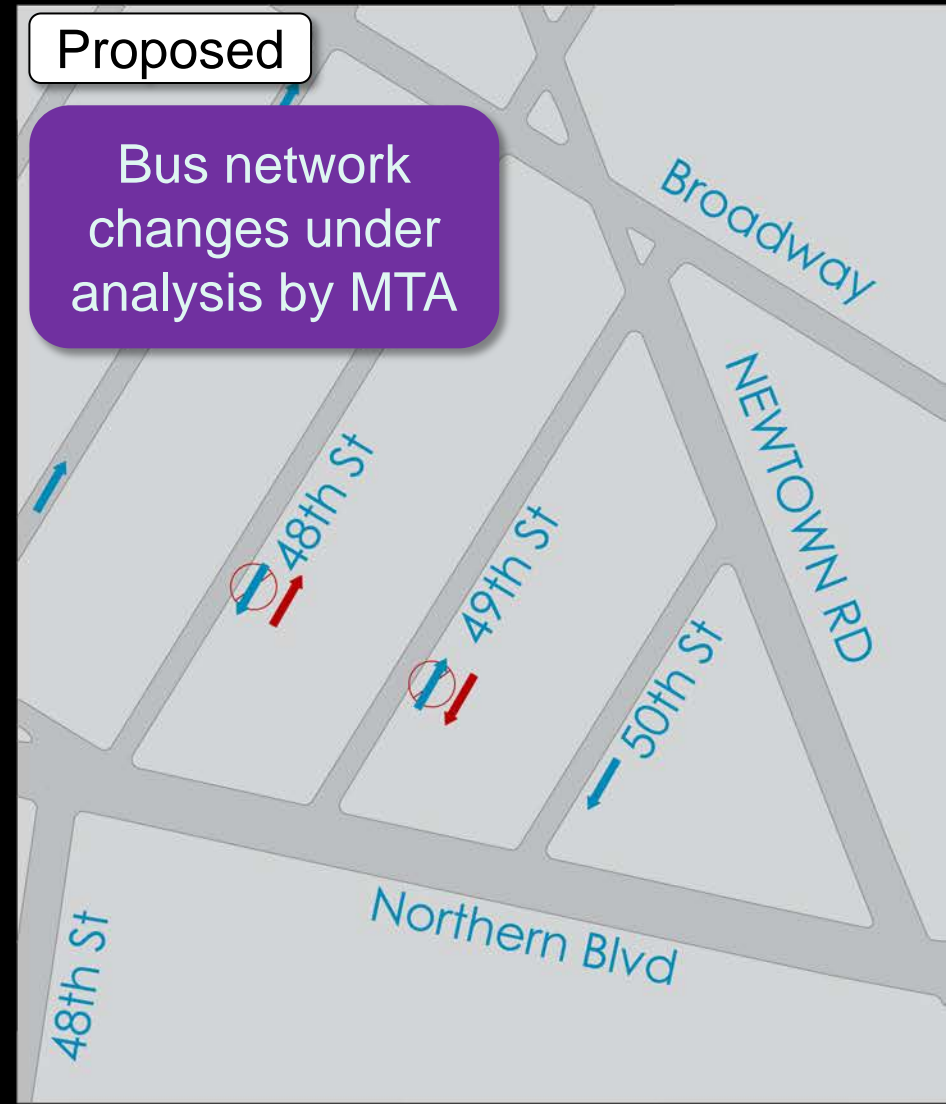

Existing Conditions – 50th St

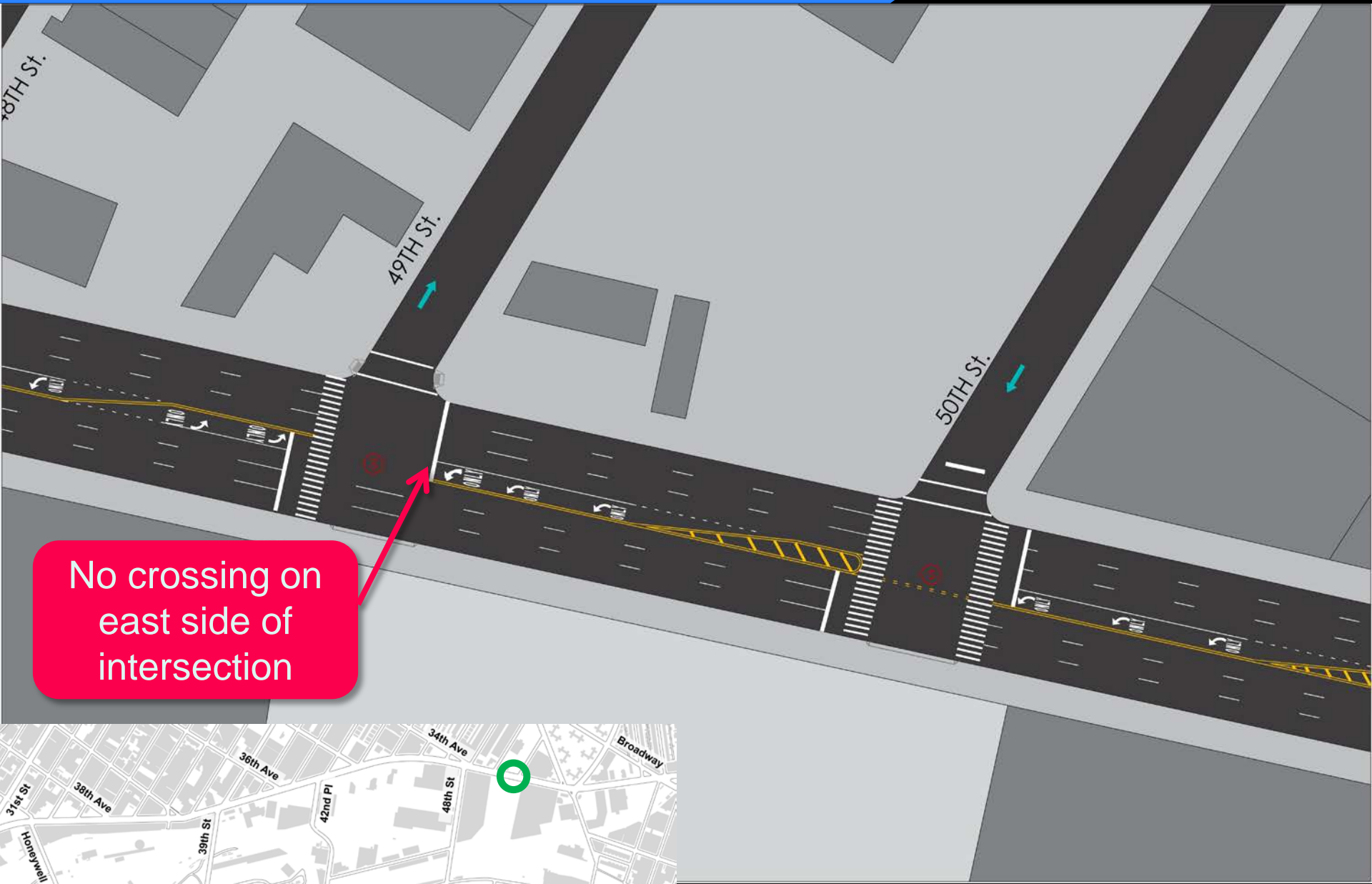

Proposed Conditions – 50th St

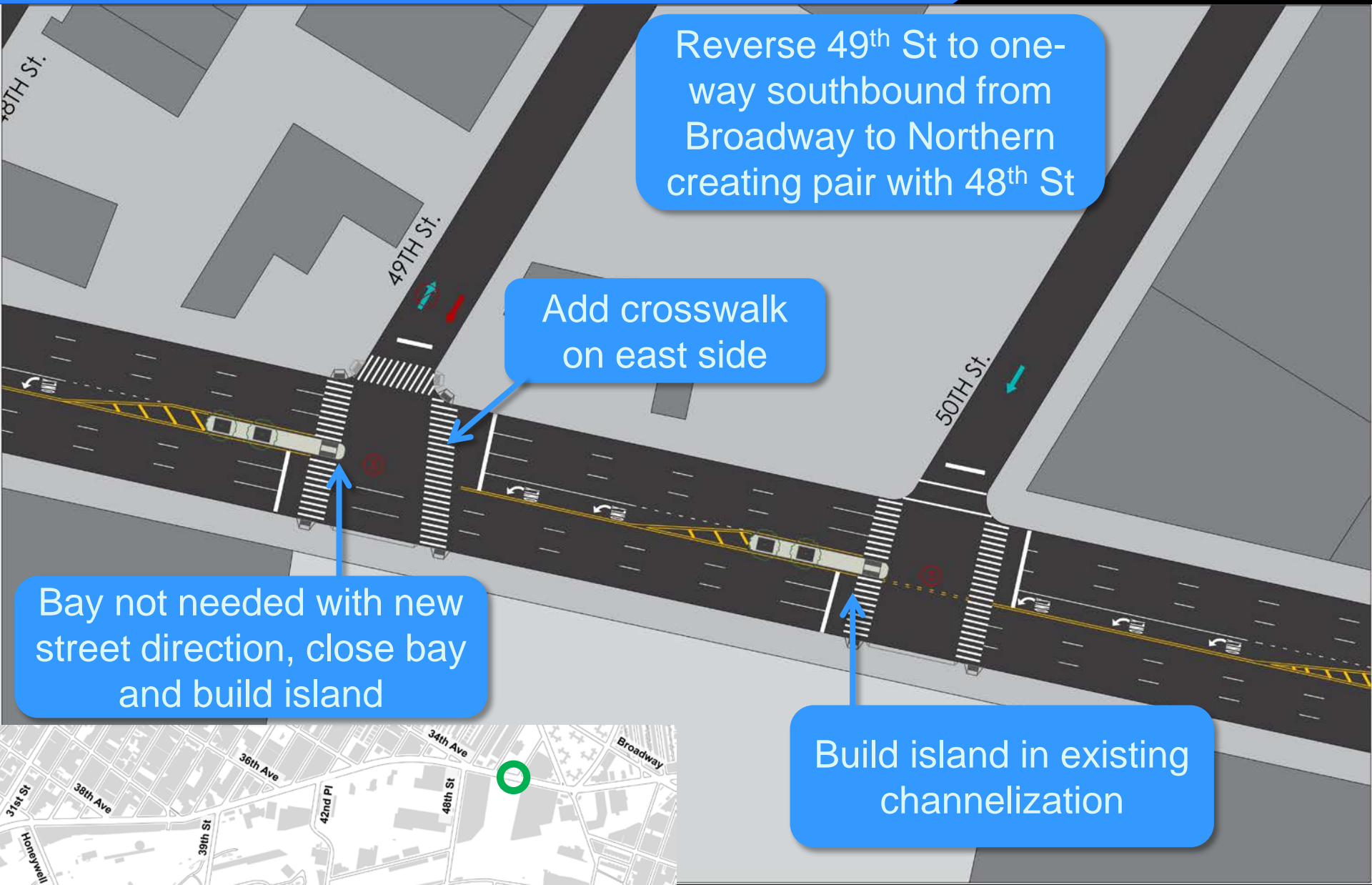

Existing Conditions – Woodside Ave

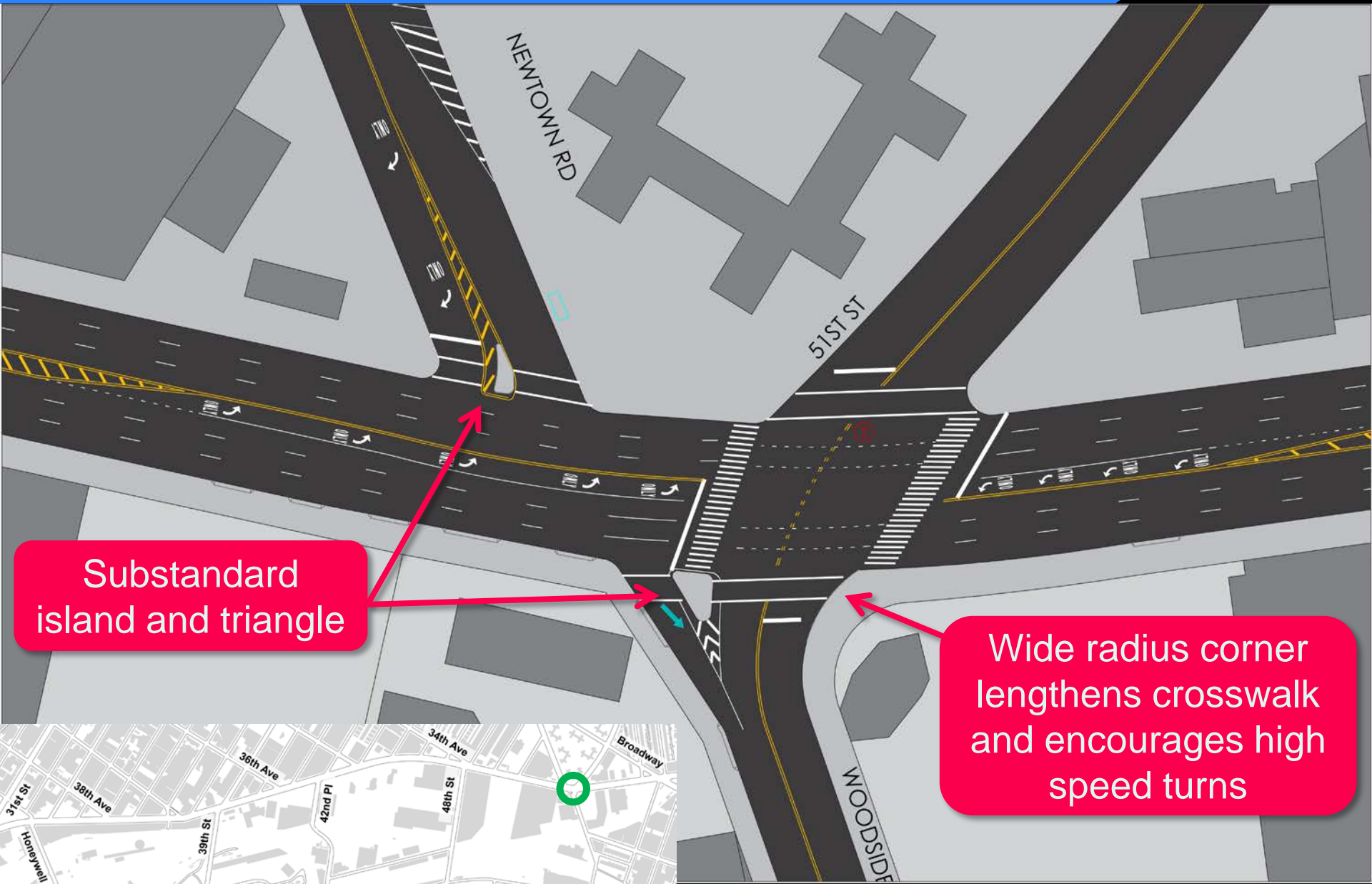

Proposed Conditions – Woodside Ave

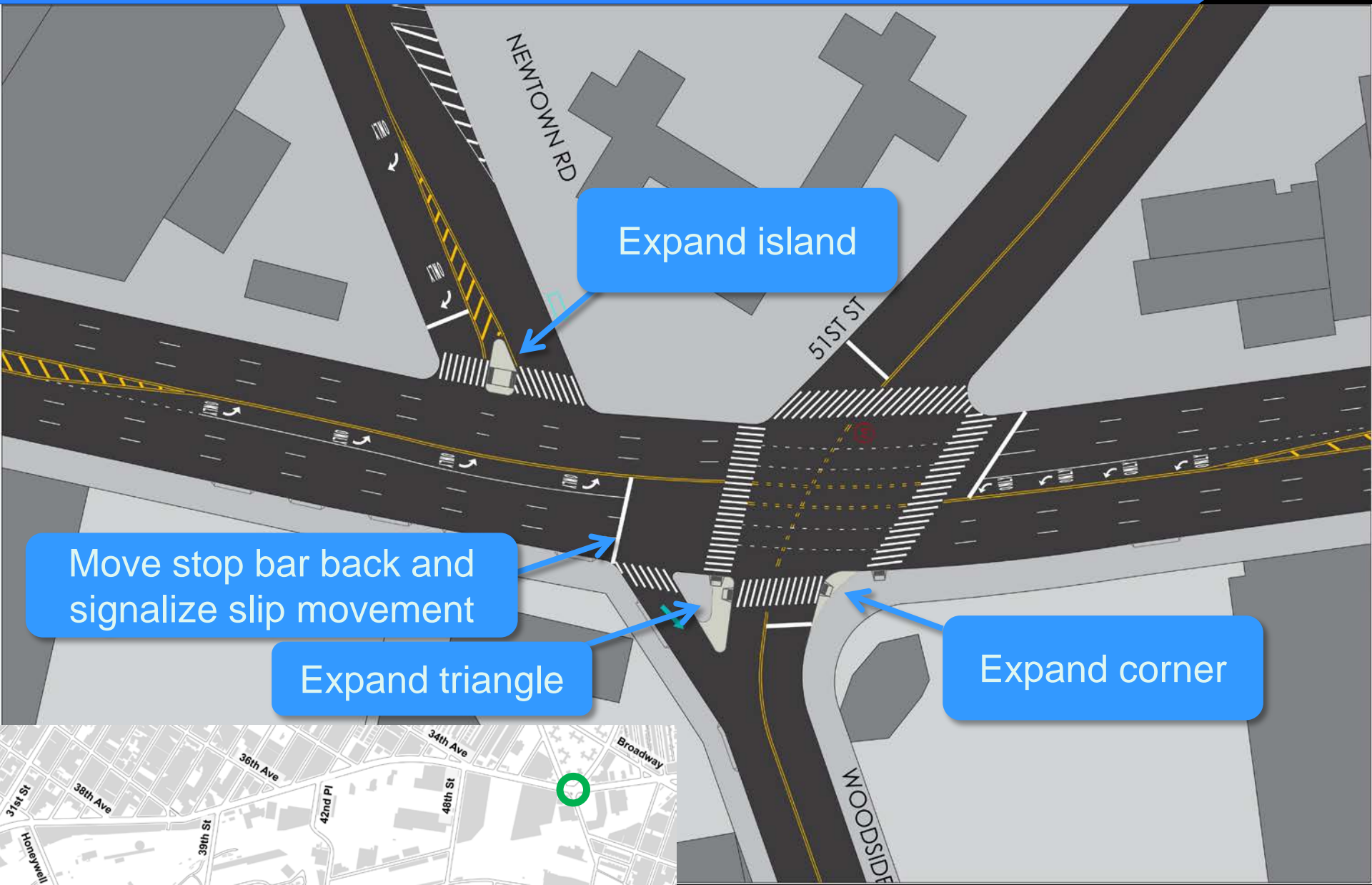

Existing Conditions – Broadway

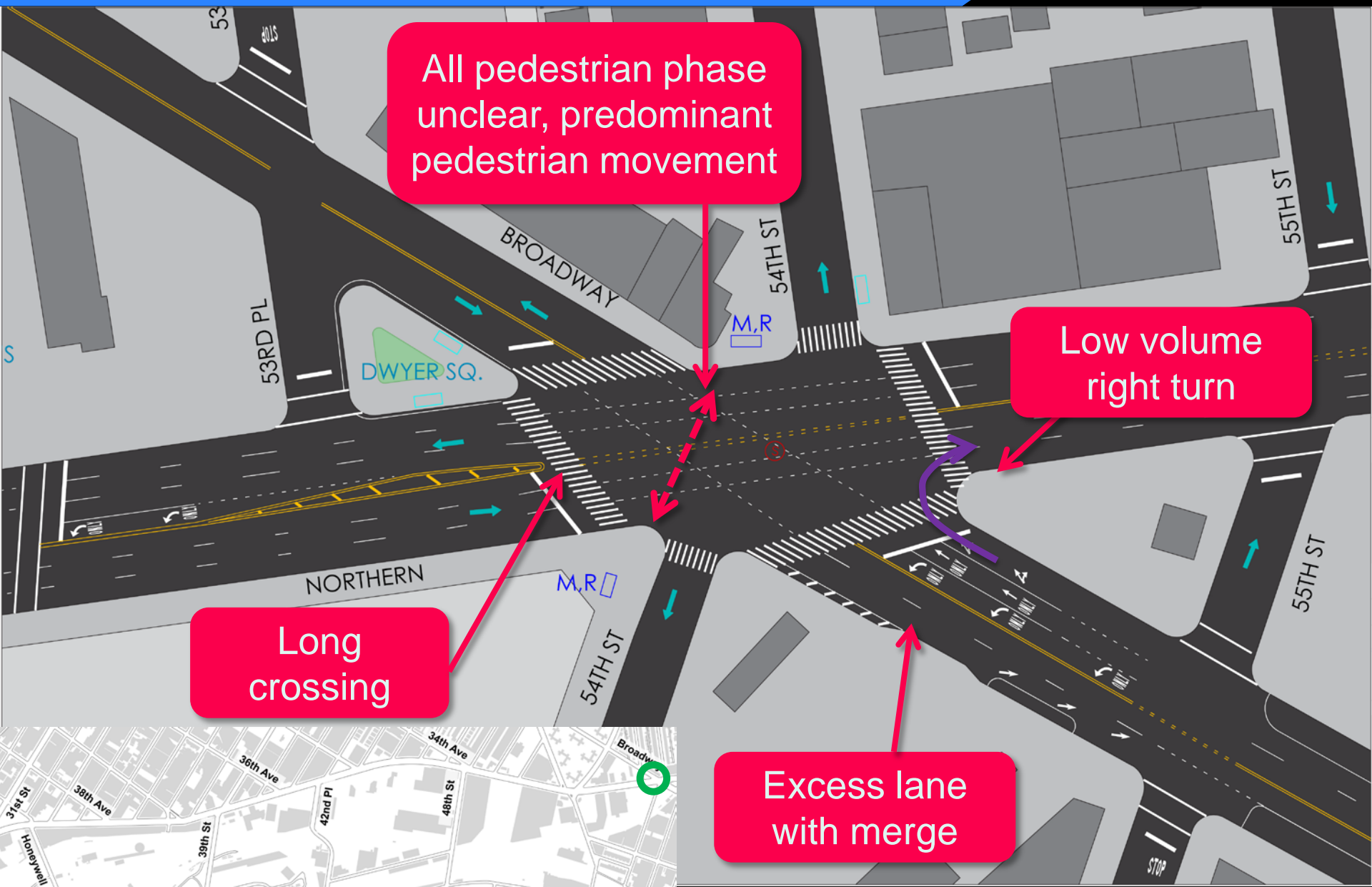

Proposed Conditions – Broadway

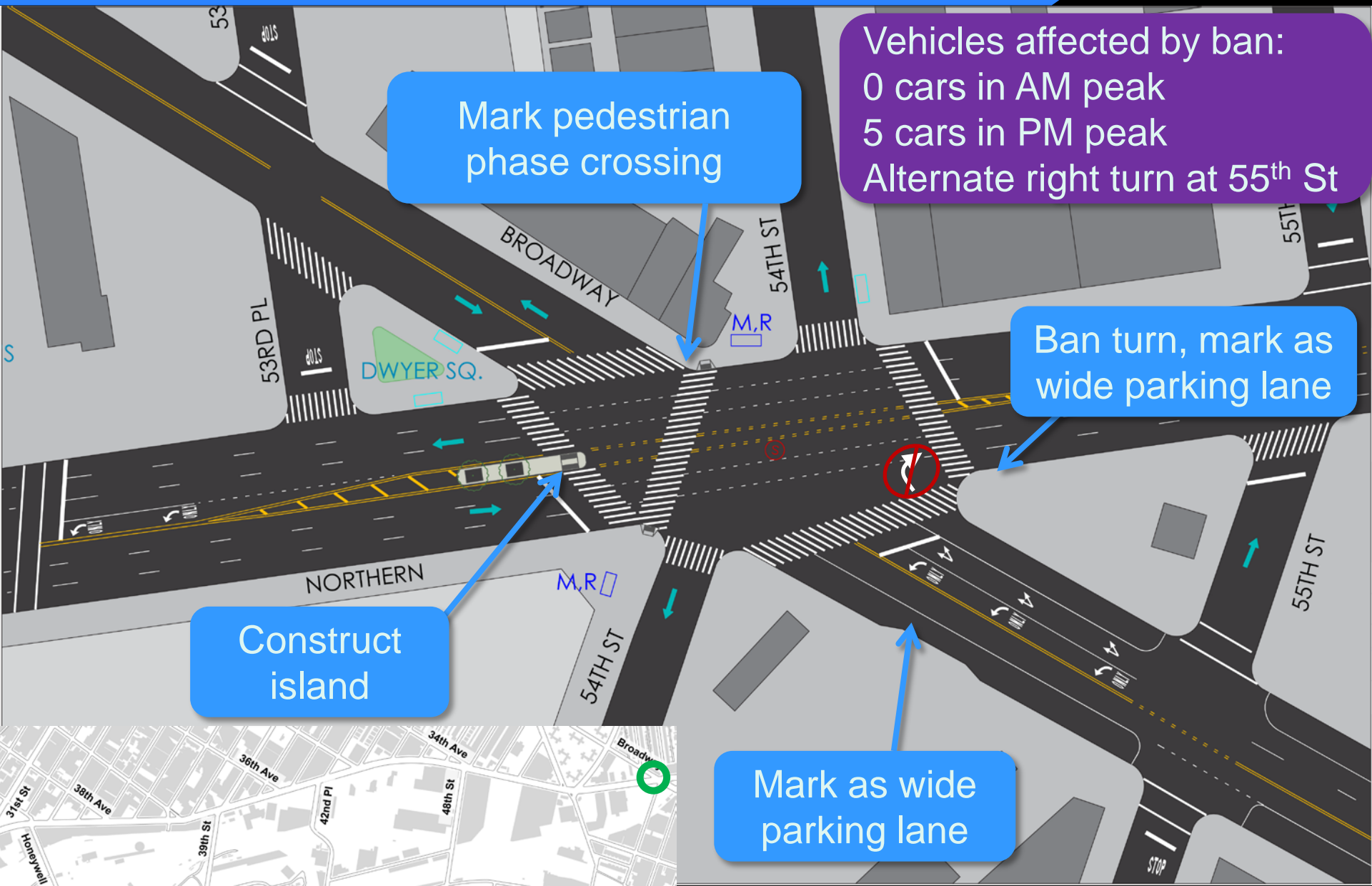

Proposal Summary

- Construct 15 Pedestrian Safety Islands
- Ban left turn at 39th Ave, 37th St, 36th Ave,
- Enlarge triangle at 37th St, converting one block of 37th St to one way SB from 37th Ave to Northern Blvd
- Construct curb extension, banning westbound right turn at Steinway St
- Reverse 48th St from southbound to northbound from Northern to Broadway
- Reverse 49th St from northbound to southbound from Northern to Broadway
- Add curb extension at 48th St
- Expand triangles and corner at Newtown/Woodside Ave
- Ban right turn for NB Broadway to Northern Blvd

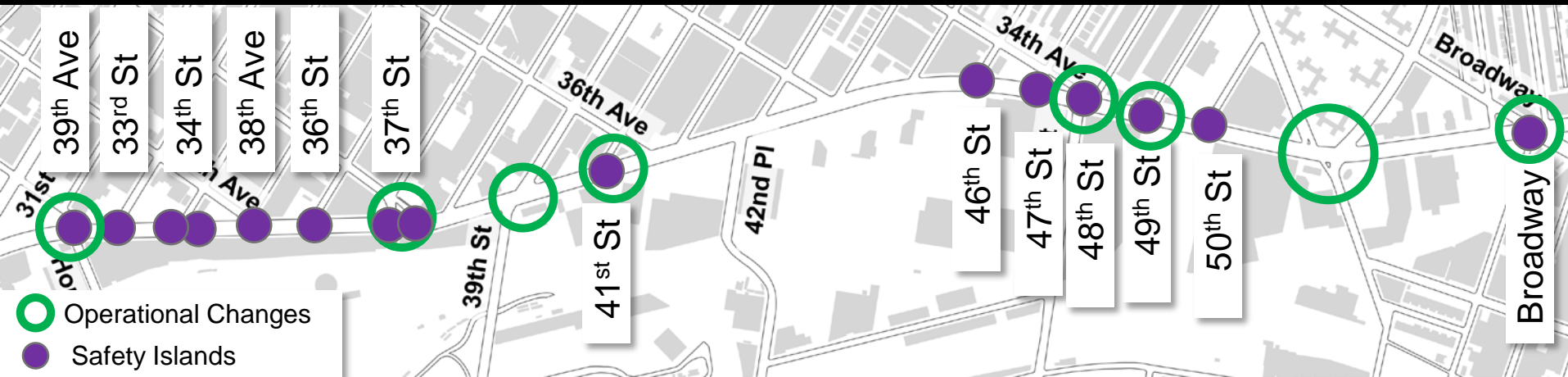



www.nyc.gov/dot

Thank
You