

# Hillside Ave: Sutphin Blvd to 179th Pl

## Corridor Safety Improvements

2016



**VISION  
ZERO**

NEW YORK CITY



New York City Department of Transportation  
Presented by the Office of Research, Implementation and Safety  
Queens Community Board 12—Tuesday, February 9, 2016

# Vision Zero Priority

## Vision Zero

- Multi-agency effort to reduce traffic fatalities in NYC
- Borough Action Plans released in 2015
- Priority Intersections, Corridors, and Areas identified
  - **Hillside Ave** is a Priority Corridor
  - 4 Priority Intersections
    - Parsons Blvd
    - 169<sup>th</sup> St & Homelawn St
    - Merrick Blvd/166<sup>th</sup> St
    - 172<sup>nd</sup> St

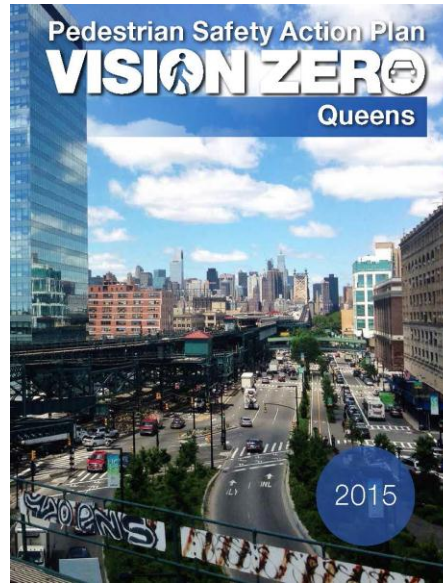

Queens Priority Map

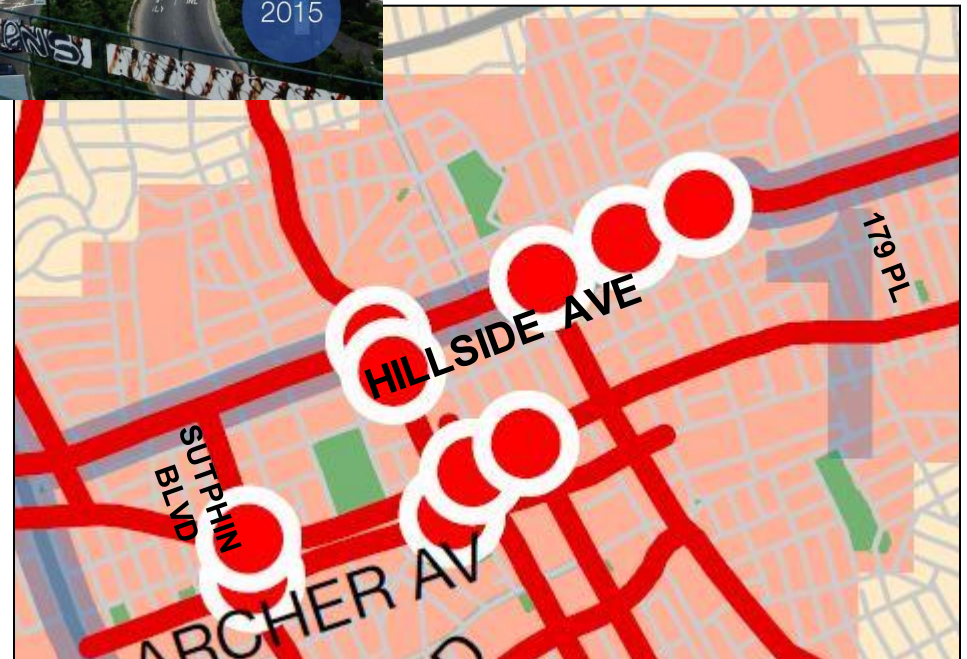



# Project Location

- Hillside Ave from Sutphin Blvd to 179 Pl; 1.4 miles
- Commercial and residential land use with high vehicular and pedestrian volumes
- **Buses:** Q1, Q2, Q3, Q17, Q25, Q30, Q31, Q34, Q36, Q43, Q65, Q76, Q77 **Subway:** E and F trains

## Recent Projects

- 2008—5 pedestrian islands on Hillside Ave in (178 St, 181 St (2), 182 St, 184 St)
- 2012—5 pedestrian islands installed on Hillside Ave in (172 St, 175 St, 187 St, 197 St, 199 St)
- 2014—Homelawn/169<sup>th</sup> St & Hillside Ave redesign



# Safety Data: Project Need

- 35 KSI (persons killed or severely injured) crashes
- 568 total injury crashes

Hillside Ave - Sutphin Blvd to 179 PI, QN

Injury Summary, 2010-2014 (5 Years)

	Total Injuries	Severe Injuries	Fatalities	KSI
Pedestrian	201	20	1	21
Bicyclist	12	1	0	1
Motor Vehicle Occupant	355	13	0	13
<b>Total</b>	<b>568</b>	<b>34</b>	<b>1</b>	<b>35</b>

Fatalities, 01/01/2010-11/16/2015 : 2

Source: Fatalities: NYCDOT  
Injuries: NYSDOT  
KSI: Persons Killed or Severely Injured

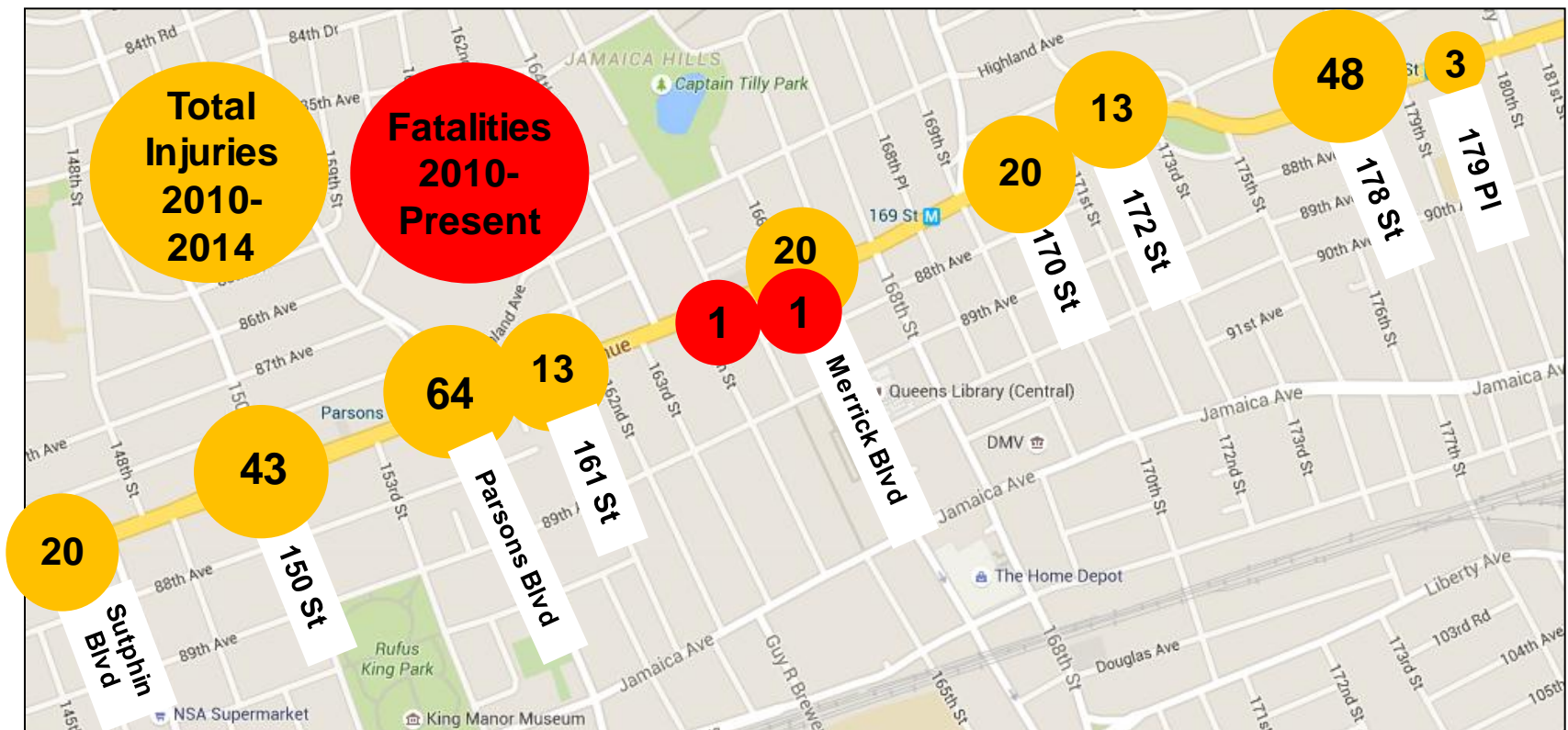

# Safety Data: Project Need

- Left turn pedestrian crashes from the cross streets have been identified as a particular problem on Hillside Ave
  - Left turns from cross street can be taken at a wider angle and at higher speeds than right turns



Hillside Ave at 178 St

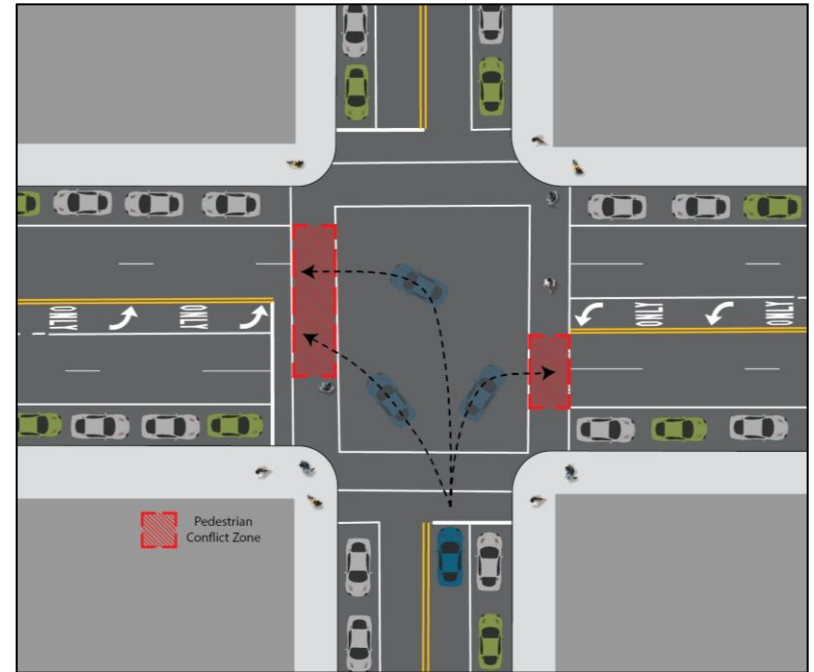



# Proposal: Pedestrian Islands

Pedestrian safety islands have been shown to\*

- Decrease pedestrian crashes by **46%**
- Reduce vehicle crashes by **39%**



Hillside Ave and 187 St—looking east

# Proposal: Hillside Ave Pedestrian Islands

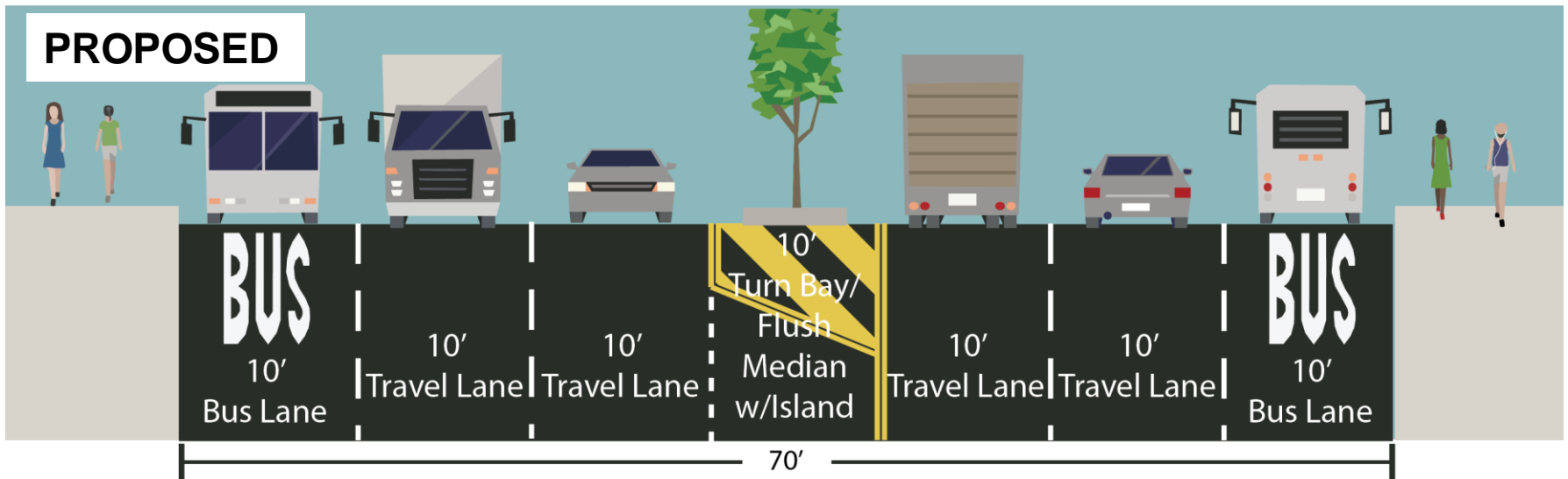
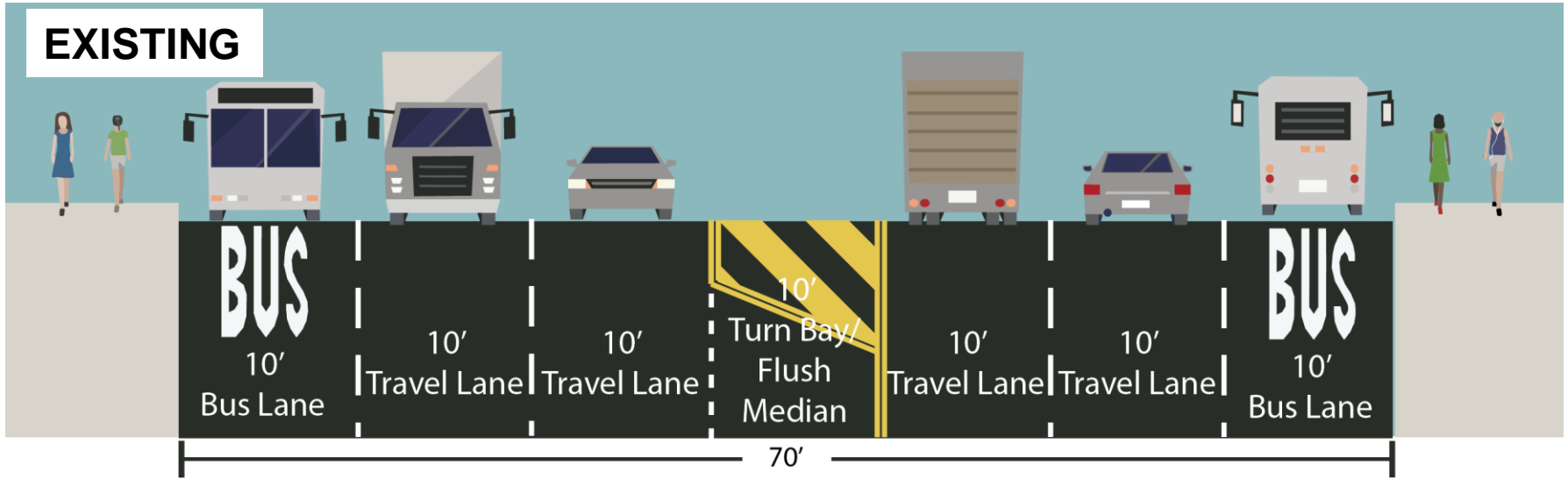

# Proposal: Hillside Ave Pedestrian Islands

- 7 Pedestrian Safety Islands are proposed on Hillside Ave at the following intersections:
  - Sutphin Blvd
  - 161<sup>st</sup> St (2)
  - 170<sup>th</sup> St
  - 172<sup>nd</sup> St,
  - 179<sup>th</sup> PI (2)
- At all intersections, islands will also create simpler, safer left turns onto Hillside Ave

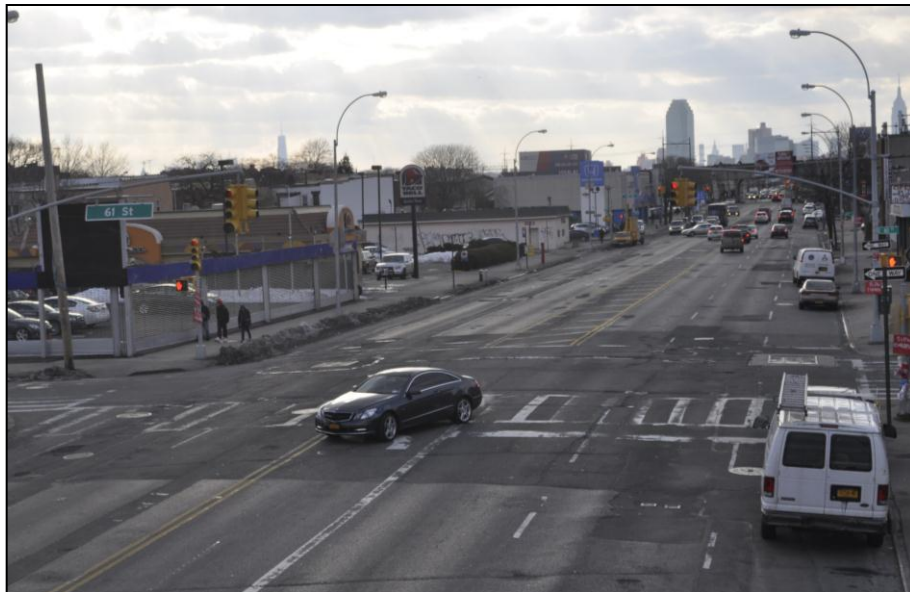

Northern Blvd at 61<sup>st</sup> St—Before



Northern Blvd at 61<sup>st</sup> St—After



# Proposal: Hillside Ave Hardened Centerline

- Where islands are not feasible, the Hardened Centerline will be used to create simpler, safer left turns onto Hillside Ave
  - 150 St
  - Parsons Blvd (Priority Intersection)
  - Merrick Blvd (Priority Intersection)
  - 178 St
- Allows traffic calming benefit without banning a turn

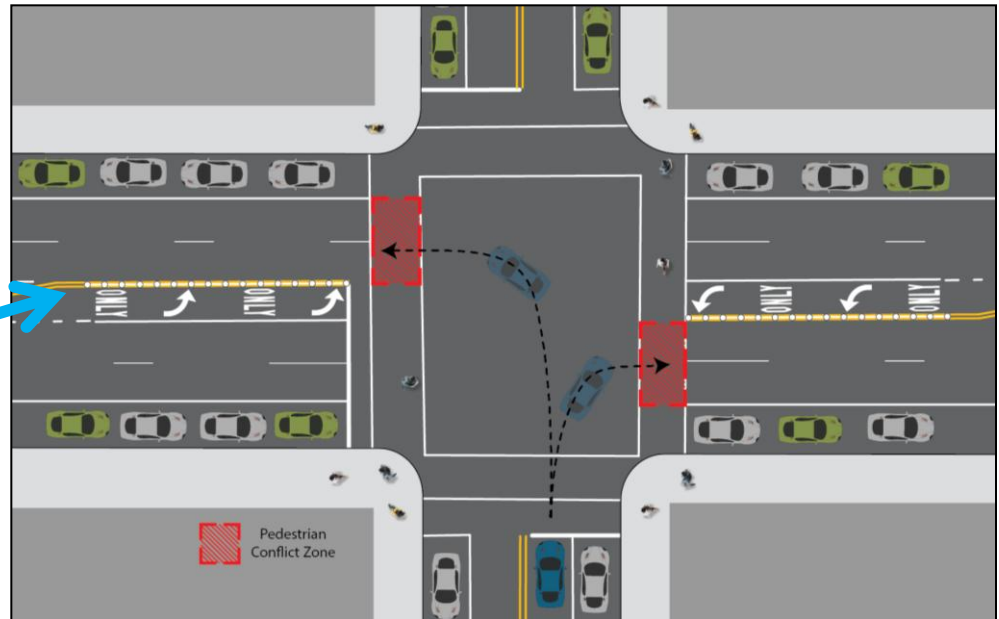

# Proposal: Hillside Ave

- Construct a total of 7 pedestrian safety islands at:
  - Sutphin Blvd, 161<sup>st</sup> St (2), 170<sup>th</sup> St, 172<sup>nd</sup> St, and 179<sup>th</sup> PI (2)
- Add high visibility crosswalks at all intersections
- Hardened Centerline at 150 St, Parsons Blvd, Merrick Blvd, and 178 St
- No changes in traffic capacity



# Benefits of Proposal

- No changes in traffic capacity
- Provides safer pedestrian crossings
- Creates simpler, safer left turns from cross streets
- Reduces motor vehicle and pedestrian conflict
- Redesigns 1.4 miles of a Vision Zero Priority corridor and three Priority Intersections



Hillside Ave and 187 St—looking east





Questions?



**Thank  
You**

Contact: NYCDOT Queens Borough Commissioner's Office – (212) 839-2510