

# Gun Hill Rd Bus & Pedestrian Improvements

Community Board 12 Transportation Committee

March 9<sup>th</sup>, 2023



# Table of Contents

---

1. Introduction
2. Proposal
  - Design
  - Curb regulations
  - Traffic analysis
3. Project Timeline

# Introduction

# Why Gun Hill Road?

- 40,000 daily bus passengers
- Critical crosstown service with key connections to **2** **5** **D**, many local bus routes, Montefiore Hospital, Co-Op City, Bay Plaza
- MTA Bronx Bus Network Redesign (implemented 2022)
  - 50+ outreach events
  - Community requests to improve Gun Hill Rd bus service
  - Named 1 of 10 key Bronx corridors for bus priority

## Bronx Bus Priority Corridors

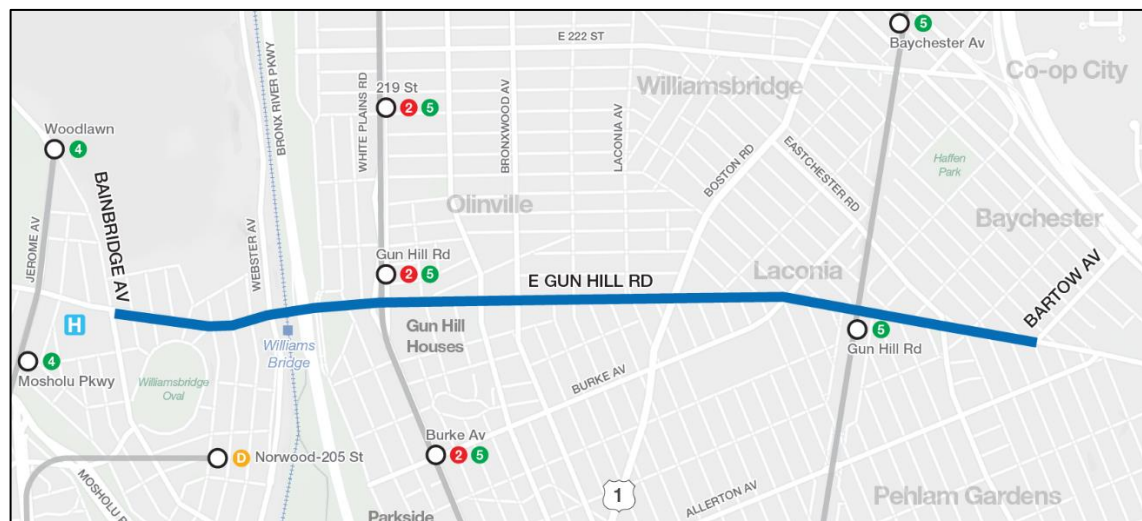
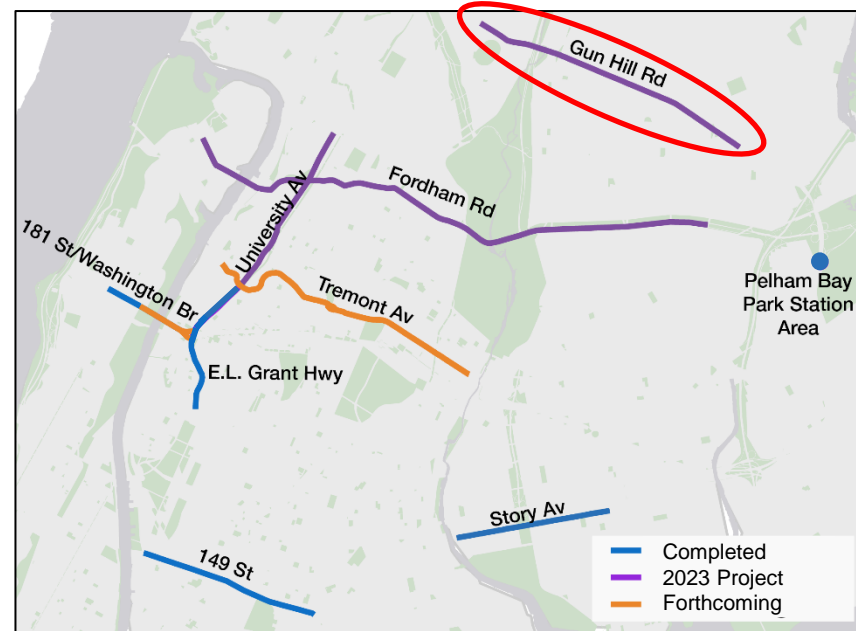

# Gun Hill Rd Bus Speeds

- **Slow and unreliable** bus service along Gun Hill Rd
- Buses move slow all day and **less than 5 mph** in the AM westbound, PM eastbound
- Peak-period trips take **15-17 minutes longer** than evening/overnight
- **Traffic congestion and double-parking** cause slowdowns
- Only **65%** of Bx28/38 trips completed within 5 min of scheduled time

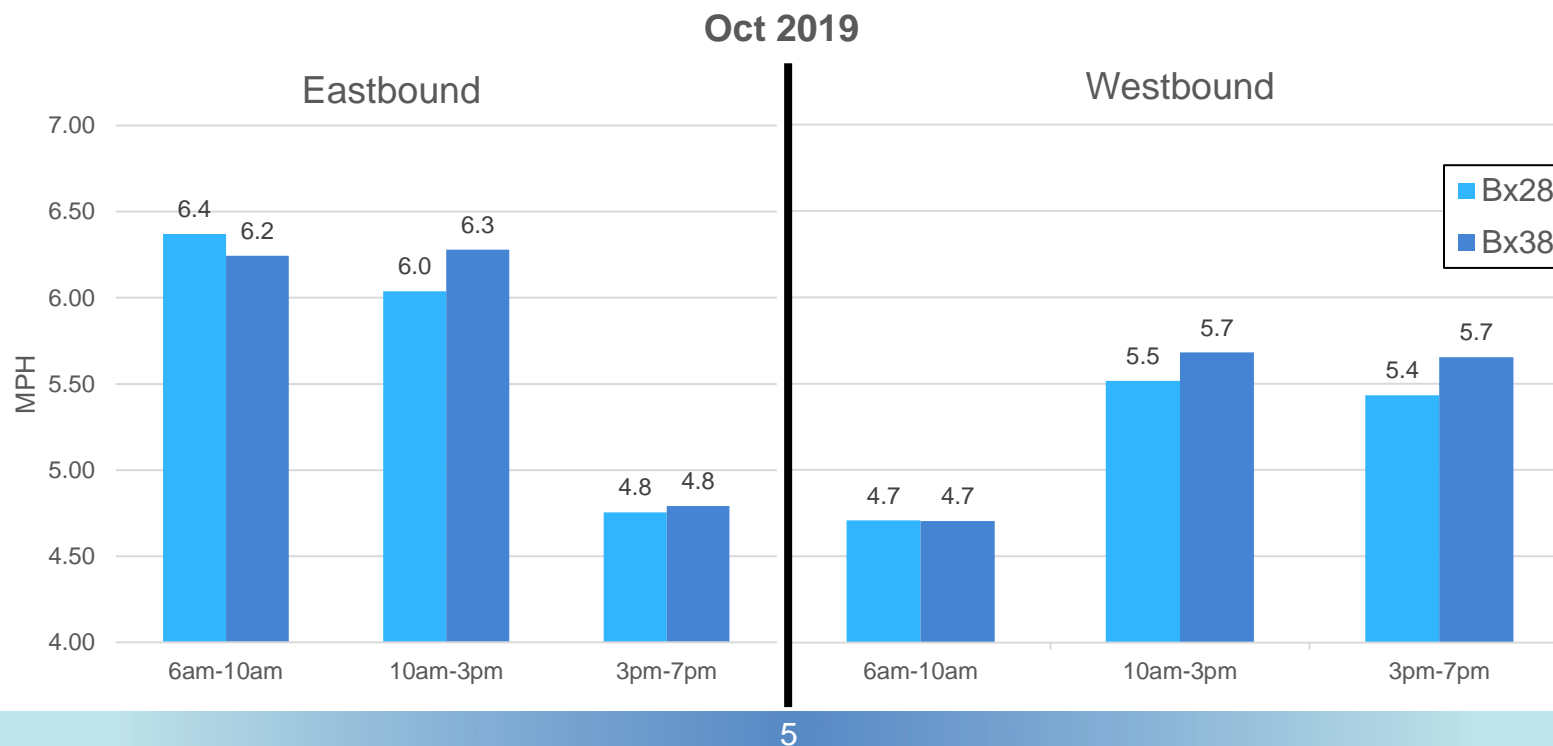



# Crash History

## Injuries & Fatalities 2015-2019

- On average, nearly 5 people every week are injured in crashes on Gun Hill Rd
- In top 10% of most dangerous Bronx streets
- 64 severe injuries + 2 fatalities
- Vision Zero Priority Corridor
- Safety solutions:
  - Fix wide-angle left turns
  - Discourage speeding
  - Improve driver-pedestrian visibility

Gun Hill Rd, Top 5 Most Injury-Prone Intersections, 2015-19

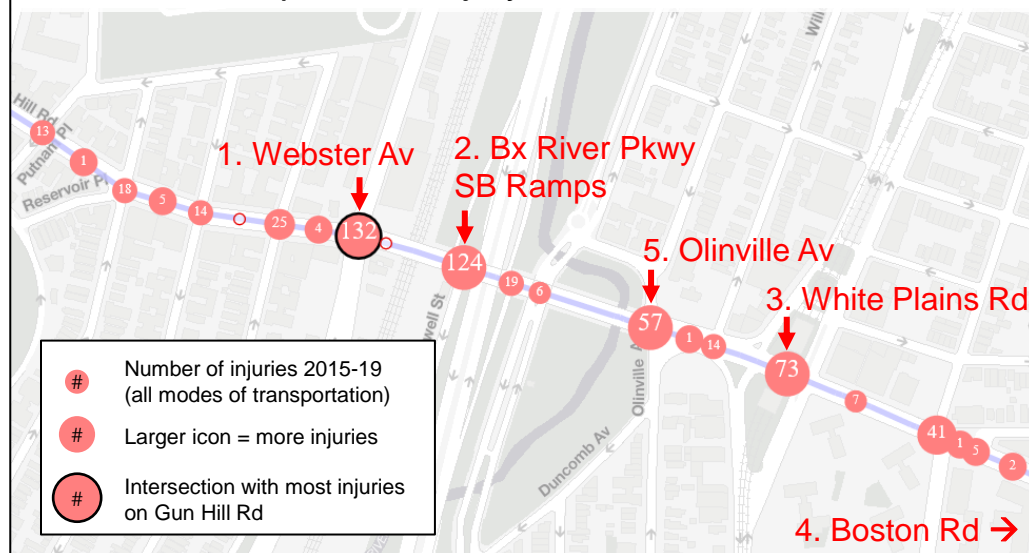

Gun Hill Rd & Boston Rd

# Community Feedback: On-Street Outreach

DOT held public outreach pop-ups and had conversations with **over 100 bus riders & community members**

- Wed, May 18 – Gun Hill Rd & Bainbridge Ave
- Fri, May 20 – Gun Hill Rd & White Plains Rd
- Mon, May 23 – Gun Hill Rd & Knapp St (5 train)

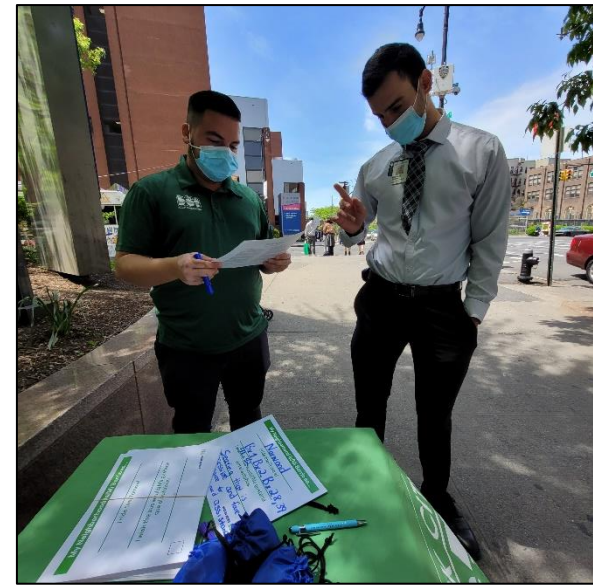
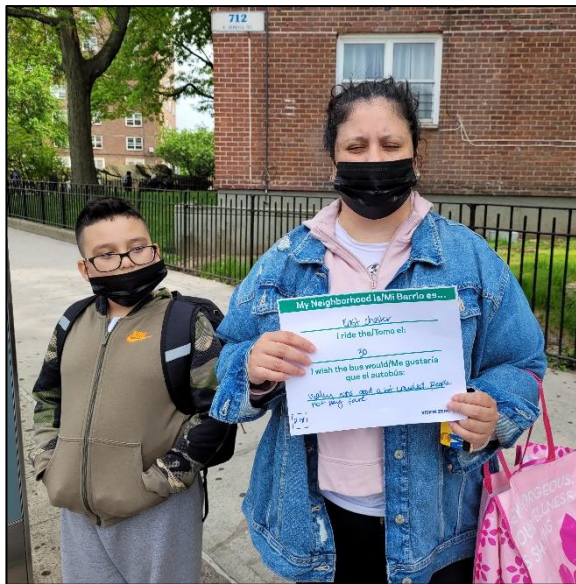



# On-Street Outreach

## Popular requests:

- Faster service
- More frequent, consistent service
- Less crowding on buses

Bus lanes can address all of these

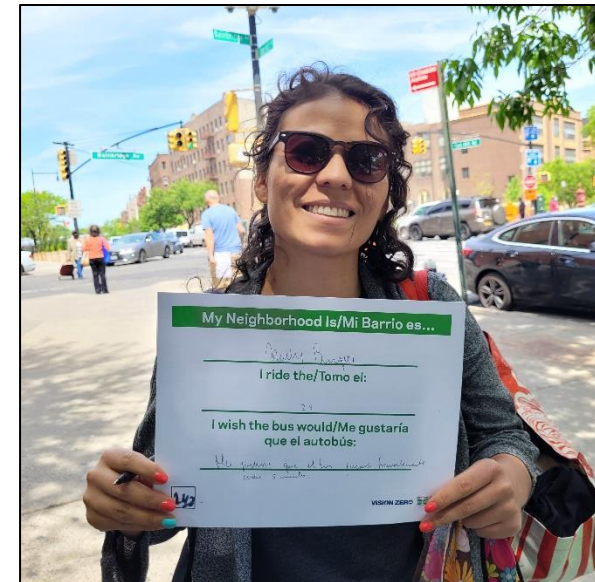
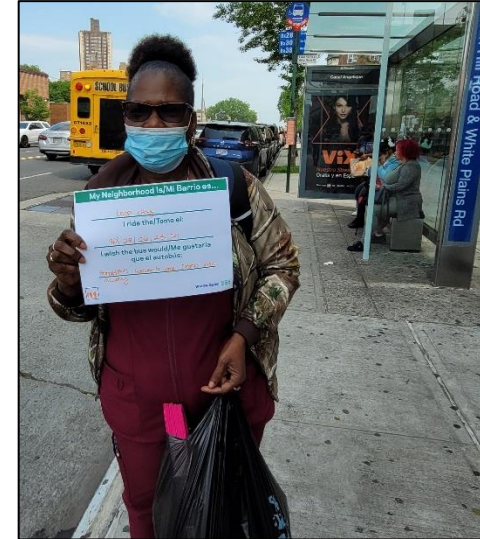



# On-Street Outreach: More Feedback

My Neighborhood Is/Mi Barrio es...

Wakefield

I ride the/Tomo el:

Bx28 Bx4455

I wish the bus would/Me gustaría que el autobús:

be more frequent & faster

180

VISION ZERO NEW YORK CITY DOT

My Neighborhood Is/Mi Barrio es...

Williamsbridge

I ride the/Tomo el:

Bx28, Bx30

I wish the bus would/Me gustaría que el autobús:

Timing and schedule

204

VISION ZERO NEW YORK CITY DOT

My Neighborhood Is/Mi Barrio es...

Bx28

I ride the/Tomo el:

Eastchester

I wish the bus would/Me gustaría que el autobús:

Being on Time

202

VISION ZERO NEW YORK CITY DOT

My Neighborhood Is/Mi Barrio es...

Norwood (work)

I ride the/Tomo el:

Bx30, 34 & 16

I wish the bus would/Me gustaría que el autobús:

The buses are on-time, it's the traffic.

164

VISION ZERO NEW YORK CITY DOT

My Neighborhood Is/Mi Barrio es...

Fremont

I ride the/Tomo el:

30

I wish the bus would/Me gustaría que el autobús:

very slow. wait too long for it.

207

VISION ZERO NEW YORK CITY DOT

My Neighborhood Is/Mi Barrio es...

Castle Hill- Bx

I ride the/Tomo el:

Bx28, Bx30

I wish the bus would/Me gustaría que el autobús:

Traffic and congestion

244

VISION ZERO NEW YORK CITY DOT

# Goals & Challenges

## Goals:

- Make bus service fast, reliable and on-time
- Reduce crashes, injuries & fatalities
- Organize traffic movements

## Challenges:

- Traffic congestion & double parking
- Broken street grid
- Bronx River Pkwy bottleneck

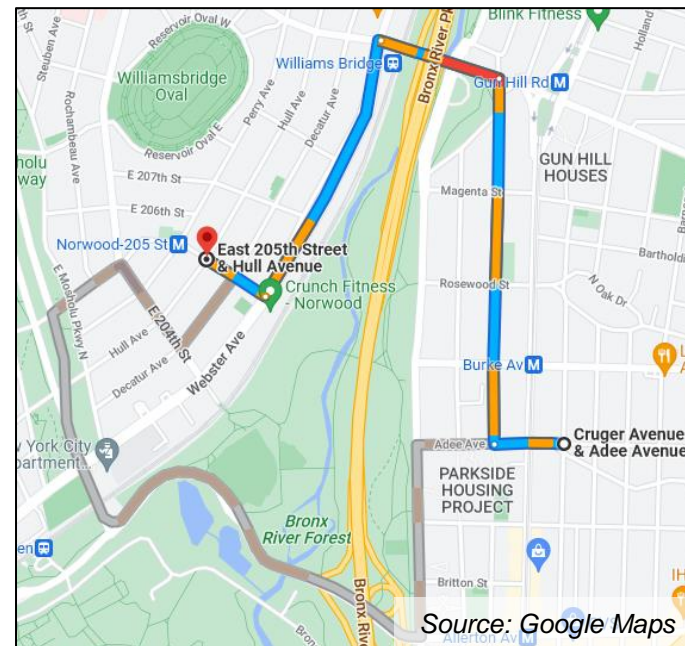

# Design



# Corridor Segments

## 1. Bainbridge Av to Webster Av

- Westbound center-running bus lane with 2 bus boarding islands
- Eastbound offset bus lane
- Implementation in Spring 2023

## 2. White Plains Rd to Bartow Av

- Offset bus lanes in both directions (curbside for some short segments)
- Pedestrian safety improvements at 20+ intersections
- Implementation in Spring 2023

## 3. Webster Av to White Plains Rd (Bronx River Pkwy area)

- Some implementation in Spring 2023 to complement rest of corridor
- Bus priority proposal coming soon; implementation in late 2023/2024



# Segment 2: Toolkit



Woodhaven Blvd, QN



Southern Blvd, BX



Meeker Av, BK



# White Plains Rd to Barnes Av

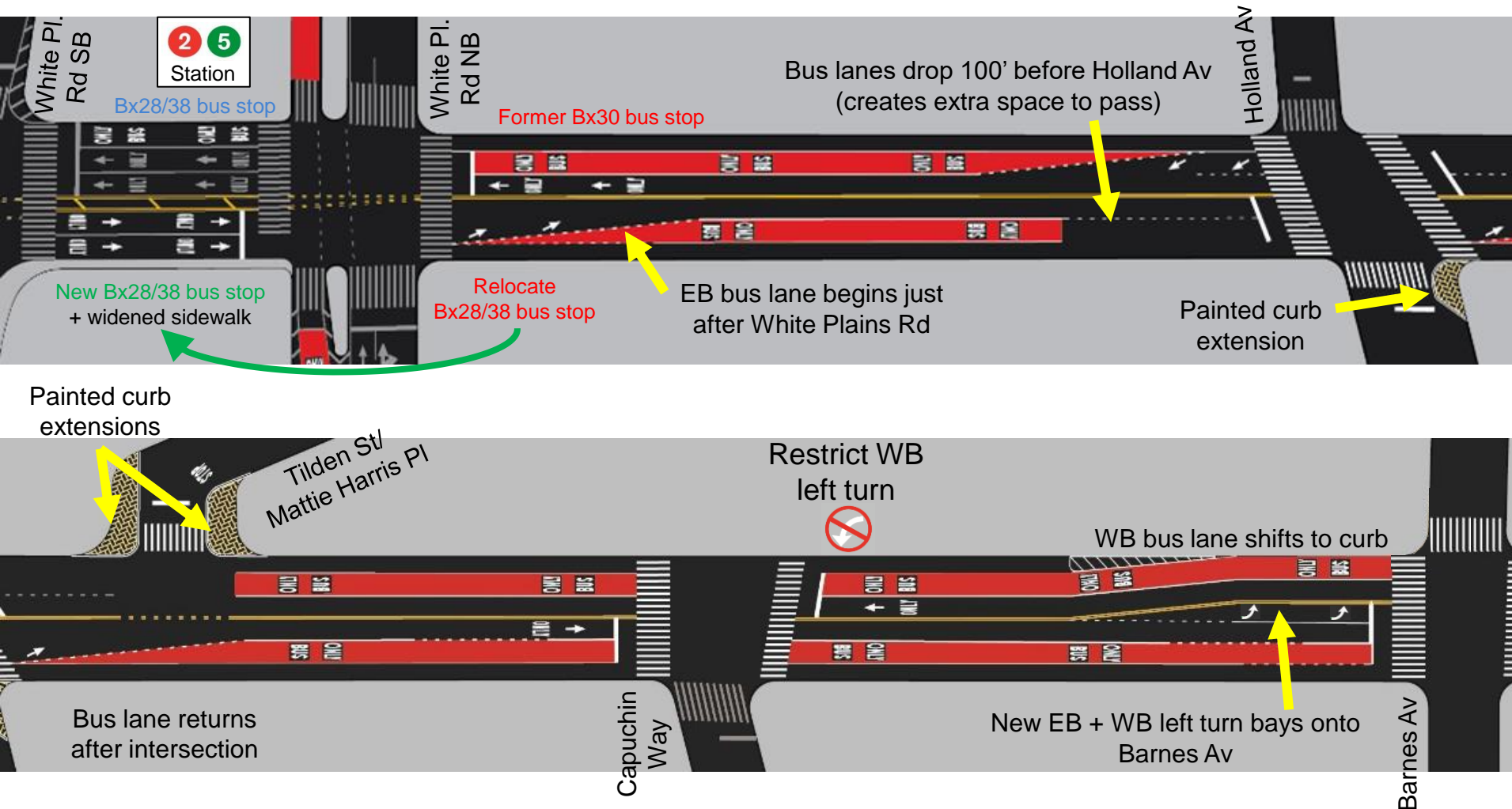



# Barnes Av to Hone Av

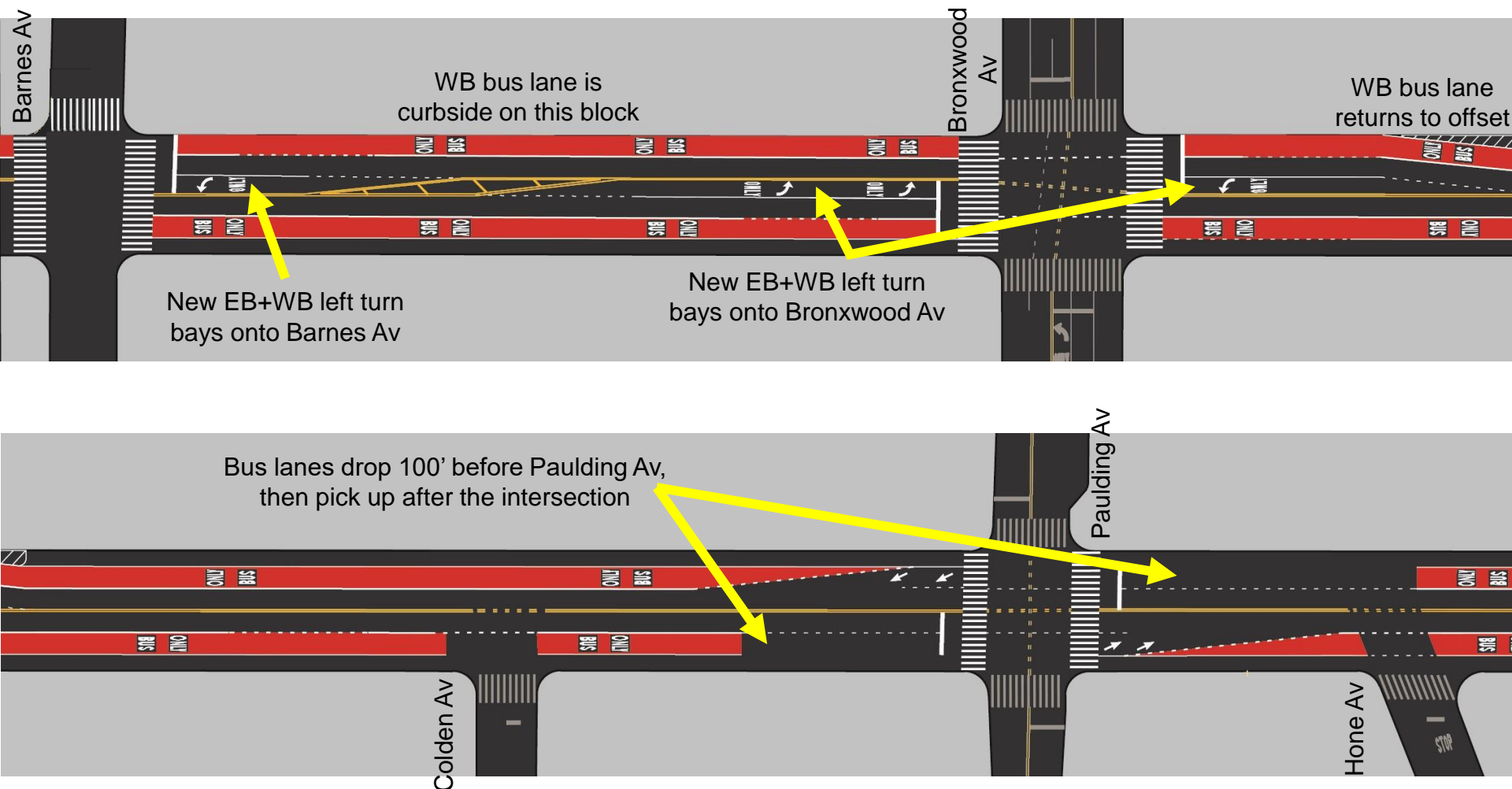

# Hone Av to Tenbroeck Av

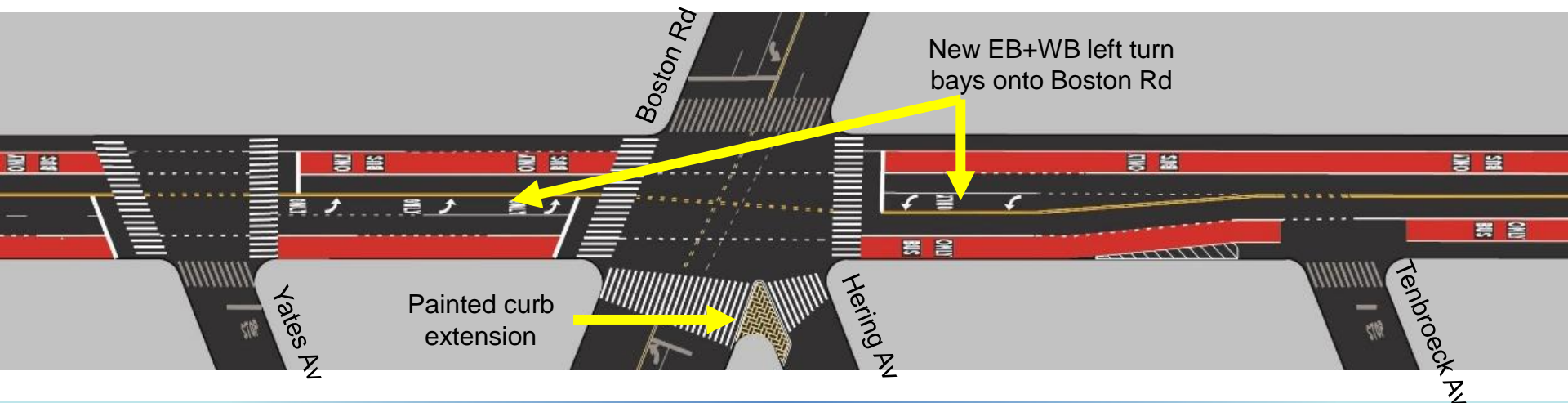
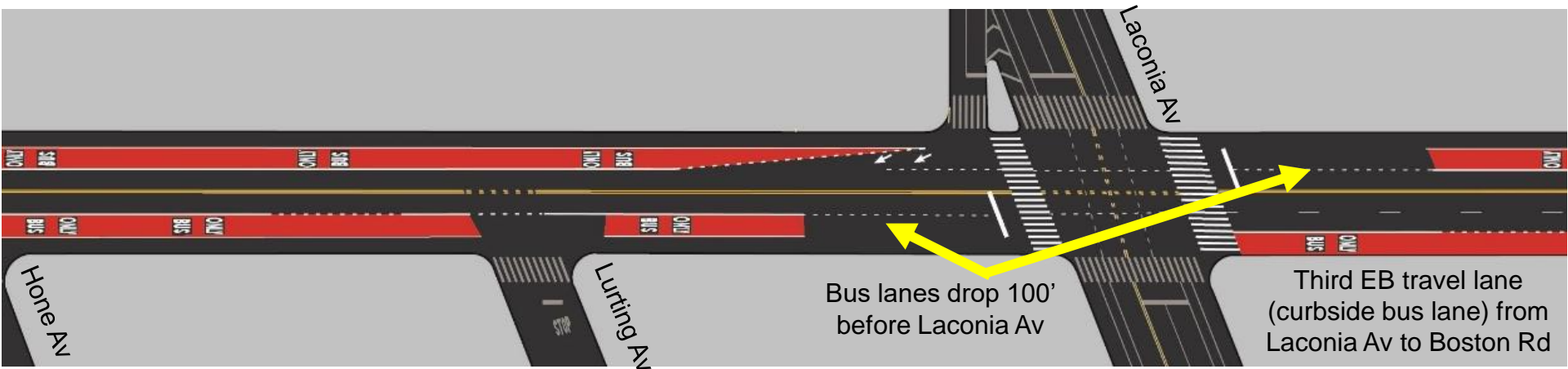

# Tenbroeck Av to Young Av

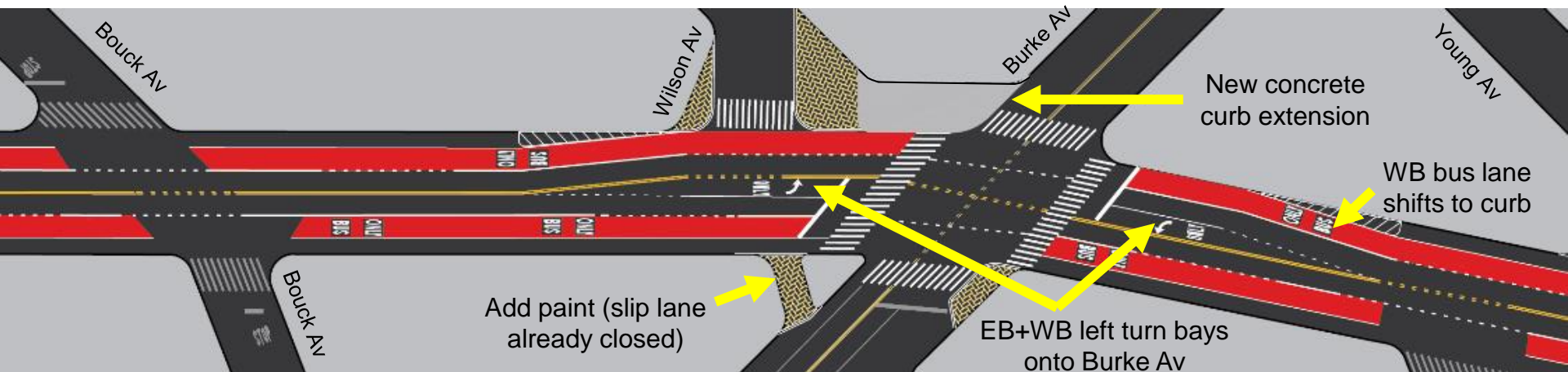
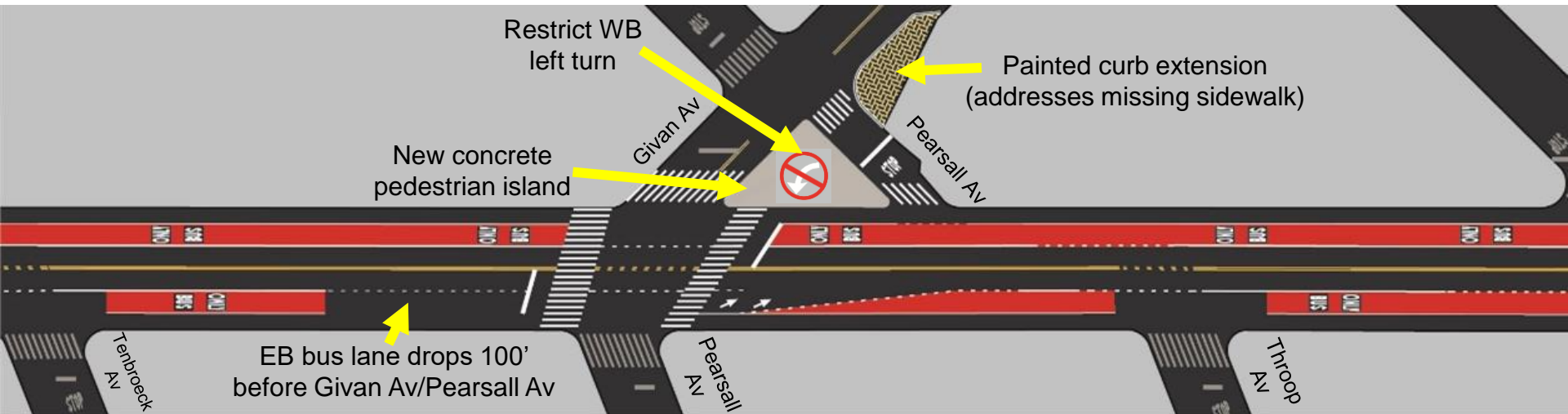



# Young Av to Adee Av

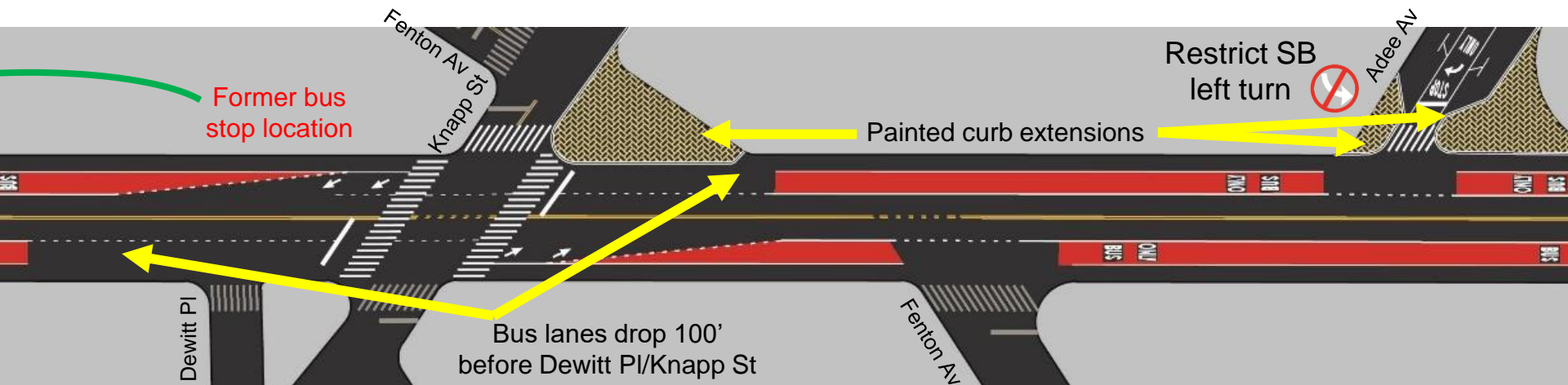
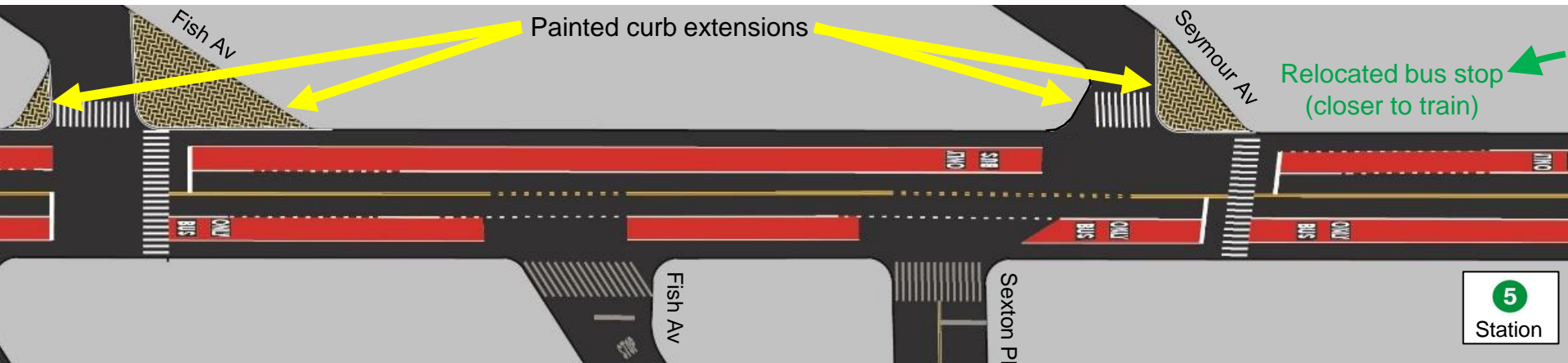

# Adee Av to Kingsland Av

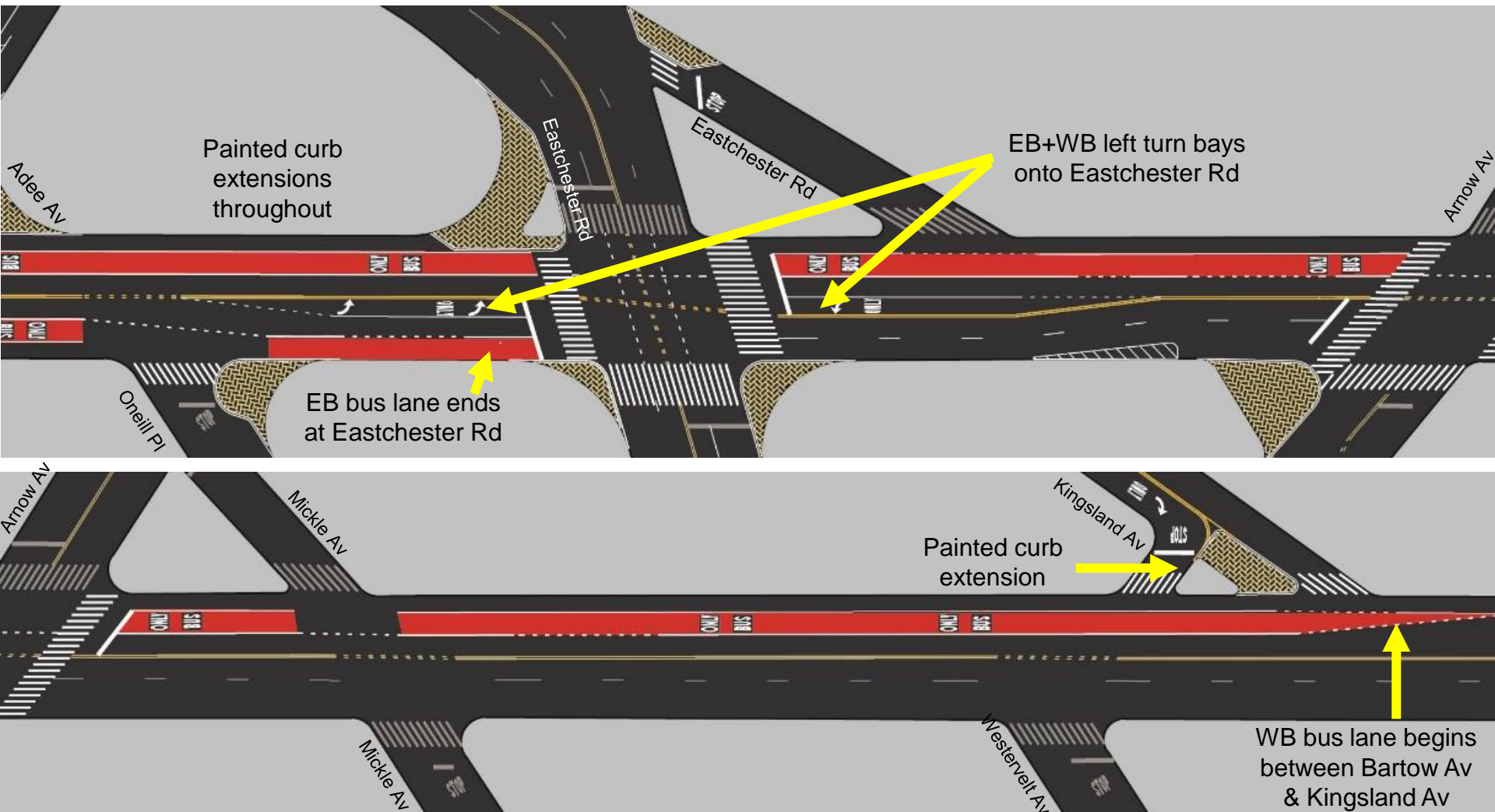

# Kingsland Av to Gunther Av

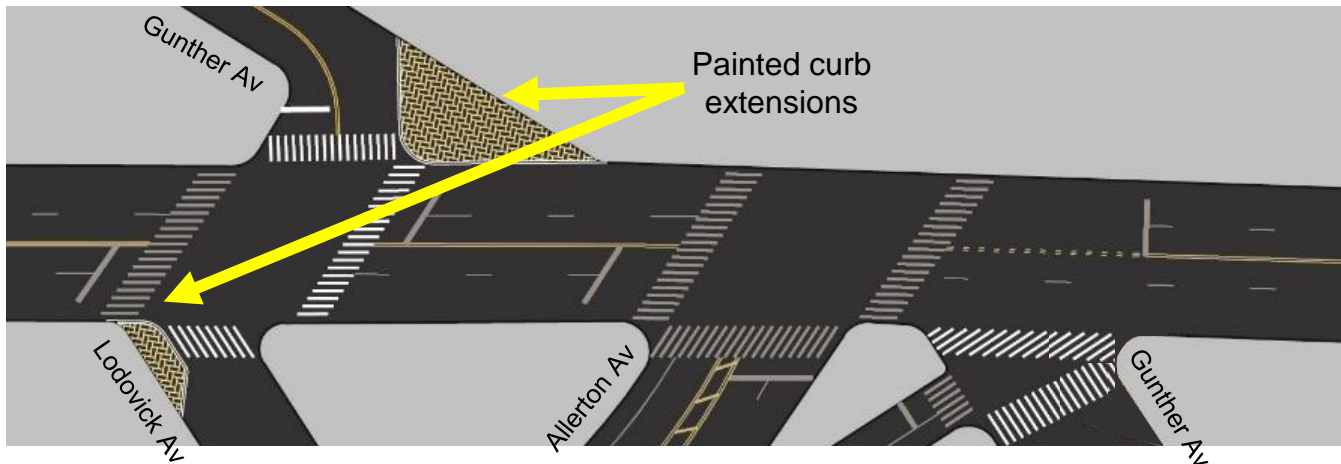
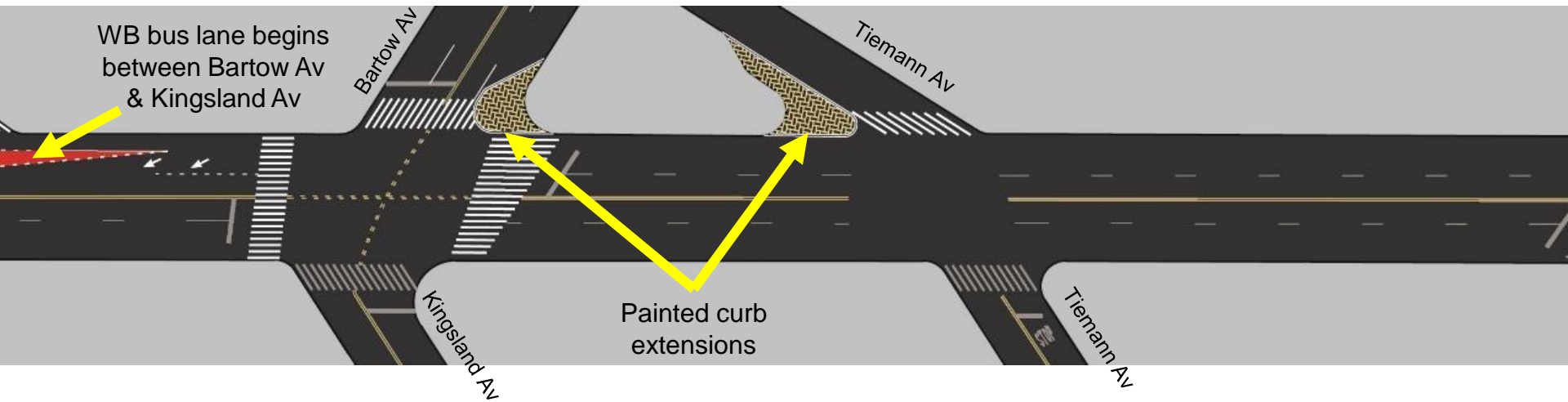



- Repurpose 34 parking spaces to accommodate curbside bus lanes and left turn lanes
- Add 3 new spaces in a former bus stop
- 1 truck loading zone for businesses (3 spaces)
  - These spaces available for resident parking off-hours
- 45 newly metered spaces on blocks with businesses
  - Ensure parking availability & reduce double parking



# Curb Regulations: Boston Rd to Eastchester Rd

- Repurpose 14 parking spaces to accommodate curbside bus lanes & passenger pickup/drop-off in front of the 5 train
- Add 7 new green spaces adjacent to new pedestrian space, former bus stop
- 31 newly metered spaces on blocks with businesses
  - Ensure parking availability & reduce double parking





# Curb Regulations: Eastchester Rd to Gunther Av

- Repurpose 8 parking spaces to accommodate new left turn bay onto Eastchester Rd
- Add 15 new spaces in former bus stops & adjacent to new pedestrian space





# Traffic Analysis: What to Expect

## White Plains Rd to Bartow Av

- Initially, notable congestion is likely as drivers adjust to Gun Hill Rd's new design
- This is typical for bus lane projects; conditions will improve over time
  - Some drivers will use alternate routes, travel at less busy times of day, or use other means of travel
- Gun Hill Rd will receive substantially more green time, benefiting traffic
  - Pedestrians still have 30+ seconds to cross Gun Hill Rd (down from 50 seconds)
- **During AM & PM rush hour:**
  - With 10% fewer vehicles (1.5 per minute), traffic would be comparable to today
- We will monitor traffic during and after implementation and will consider additional changes as needed

# Traffic Hotspots: White Plains Rd to Bartow Av

- Potential **traffic hotspot locations** for additional monitoring



# Traffic Accommodations: White Plains Rd to Bartow Av

1. Left turn bays at 5 intersections
2. Bus lanes drop 100' before 5 intersections
3. Left turn restrictions at 2 locations
4. Curb regulation improvements to reduce double parking
5. Third EB moving lane (curbside bus lane) from Laconia Av to Boston Rd
6. All vehicles use offset/curbside bus lane to turn right or access a driveway
7. Signal timing improvements

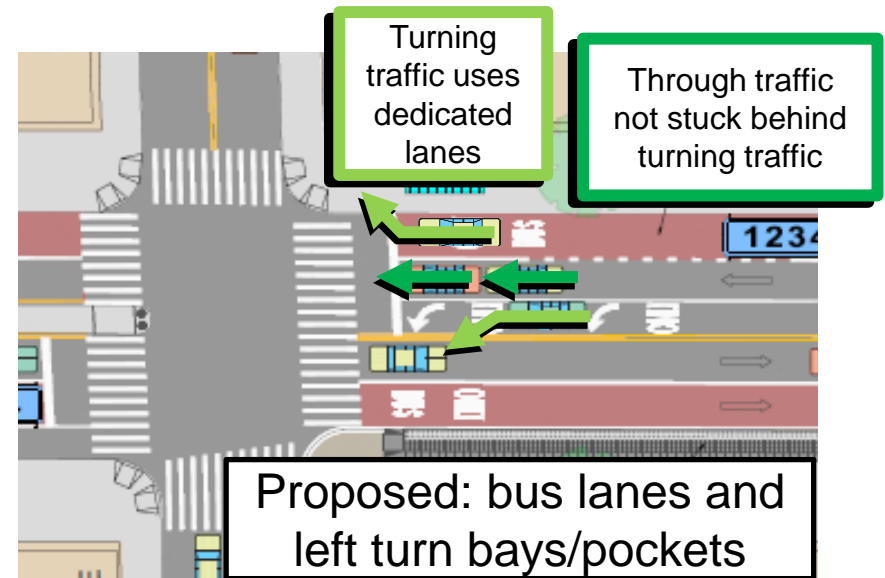
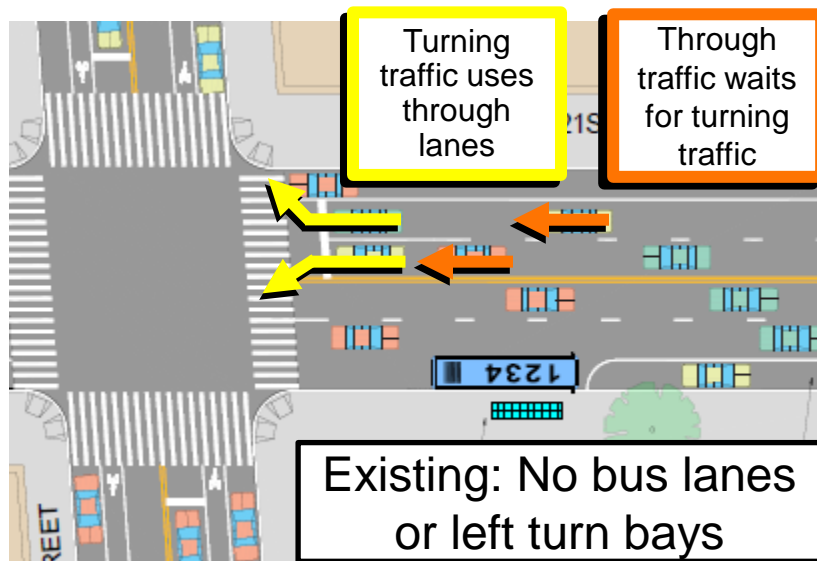



## Segment 3: Webster Av to Bronx River Pkwy

- Some implementation in Spring 2023 to complement rest of corridor; see below
- Implement remainder of this section in Late 2023/2024
  - Currently researching potential improvements; proposal coming soon

Westbound bus lane begins  
between Bronx River Pkwy  
and Webster Av

Westbound left turn  
lane approaching  
southbound ramps

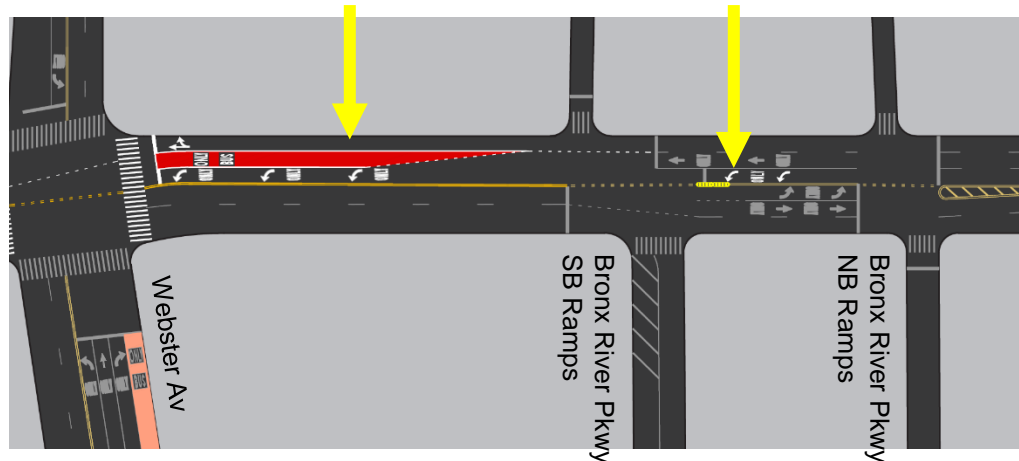

Painted pedestrian  
space

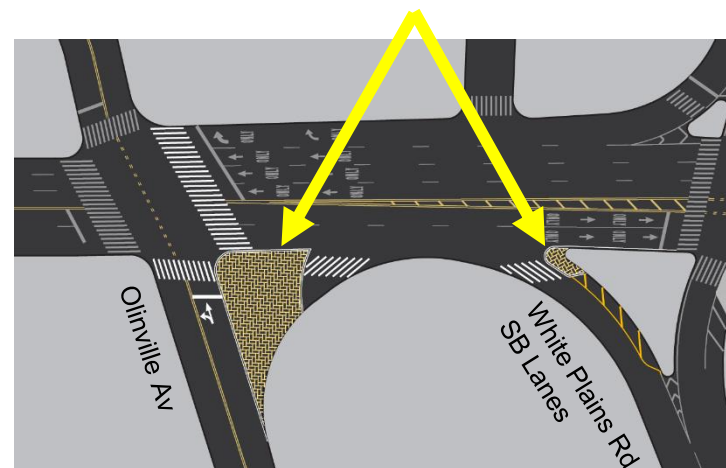

# Timeline

# Project Timeline

1. MTA Bronx Bus Network Redesign (implemented 2022): 50+ outreach events →
2. Merchant survey w/ Jerome Gun Hill BID
3. Field observations & traffic data
4. April 2022: discuss existing conditions & needs with Community Advisory Board (CAB) and Community Boards 7, 11 & 12
5. May/June 2022: present draft proposal to CAB and CBs
6. September 2022: Present updated proposal to CAB
7. **Winter 2023: Continue refining proposal; present updated proposal to elected officials, CAB & CBs**
8. Spring 2023: Begin implementation





# Thank You!

---

## Open Discussion & Questions



NYC DOT



NYC DOT



nyc\_dot



NYC DOT

# Appendix

# Past Projects: 161<sup>st</sup> St, Bx (Jerome Av to Melrose Av Only)

- Select Bus Service with center-running busway, including an eastbound bus-only tunnel under Grand Concourse + off-board fare collection
- **32-46% faster eastbound, 14-18% faster westbound**



Eastbound Bus Travel Time (Minutes)

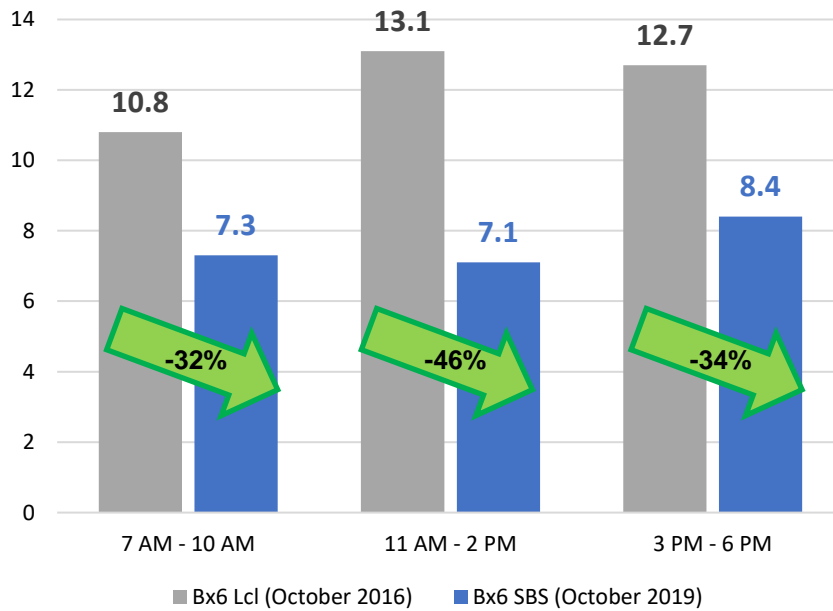

Westbound Bus Travel Time (Minutes)

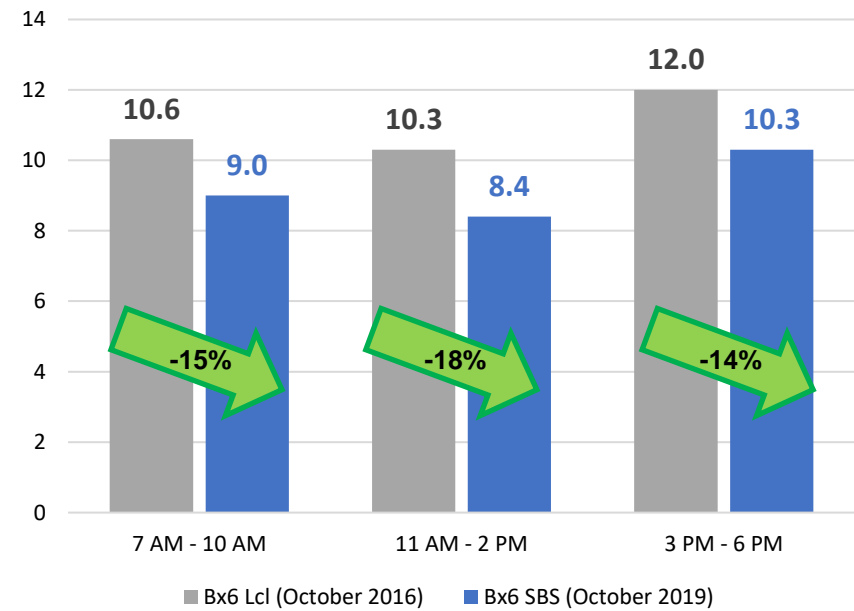

Source: MTA New York City Transit



# Past Projects: 161<sup>st</sup>/163<sup>rd</sup> St, Bx (Full Corridor)

- Improved on-time performance in both directions
- Reduced bus bunching in both directions

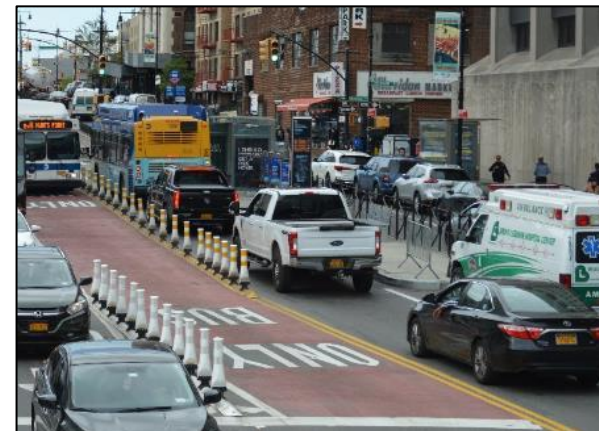

% of Buses Arriving Late

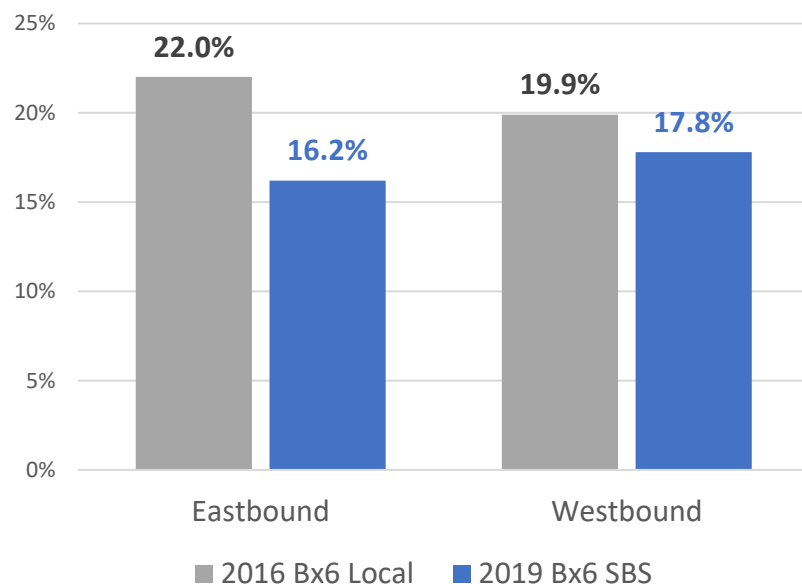

% of Buses Arriving Bunched

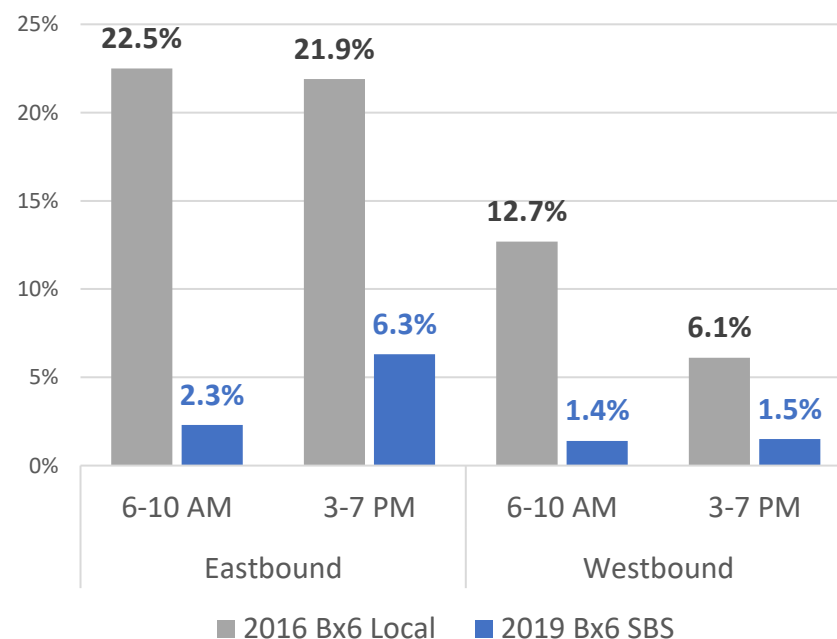

\*Late defined as arriving 5 minutes or more after scheduled arrival time

\*\*Bunching defined as two or more buses heading in the same direction departing a stop within 90 seconds of each other

Source: MTA NYCT

# Past Projects: EL Grant Hwy, Bx

- Center-running bus lanes
- **3-14% faster eastbound, 8-16% faster westbound**



EL Grant Hwy Travel Time, Jerome Av to University Av (Minutes)

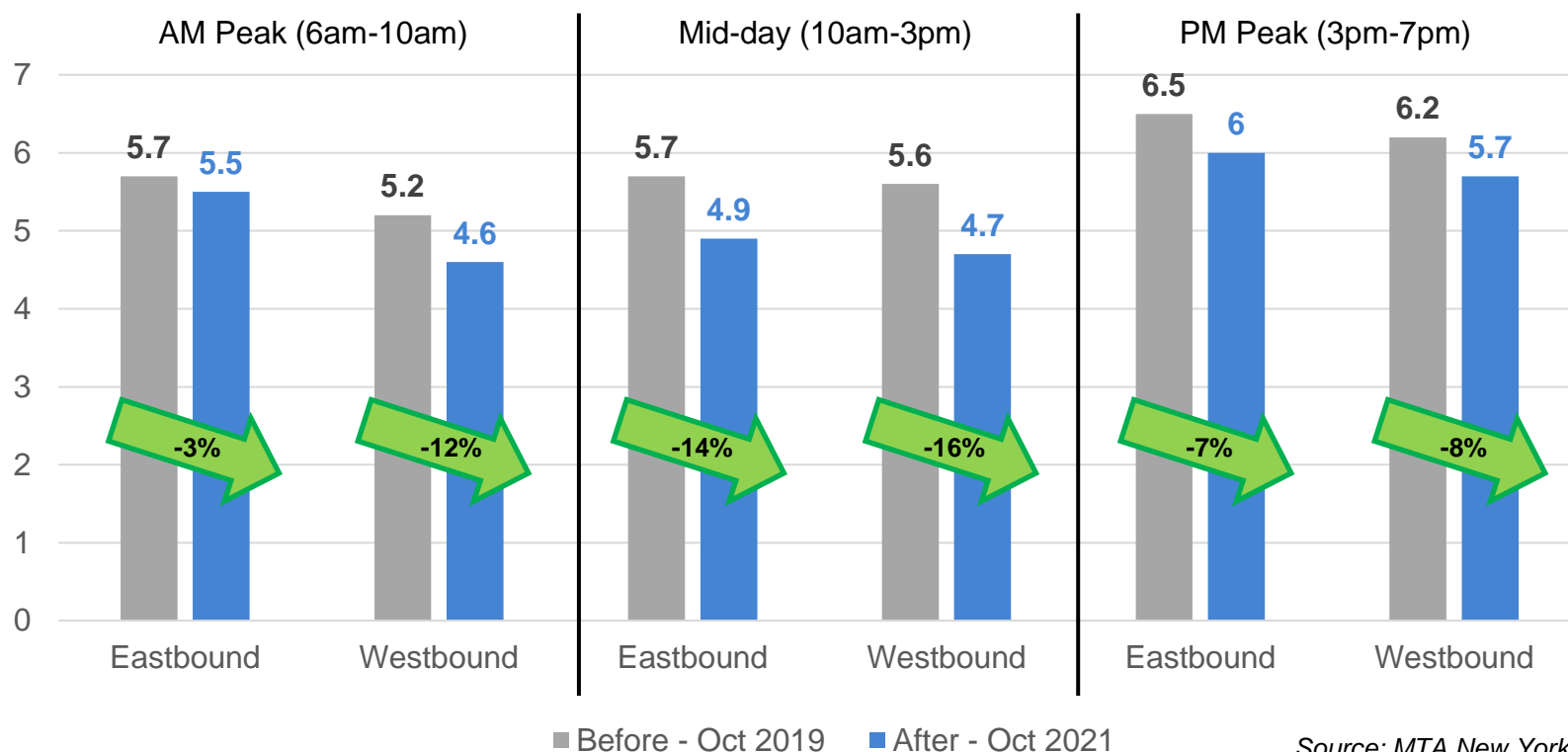

Source: MTA New York City Transit

# Past Projects: Webster Av, Bx

- Select Bus Service with offset bus lanes + offboard fare collection
- **19-23% faster northbound, 19-21% faster southbound**

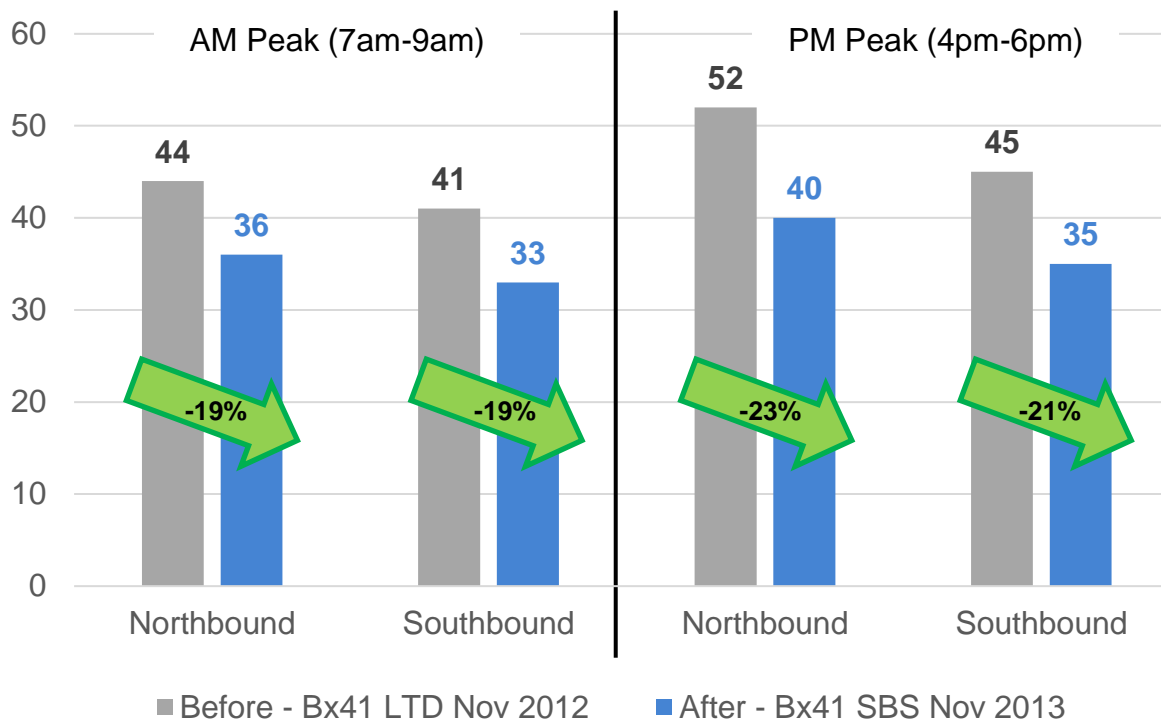

Source: MTA New York City Transit



# Past Projects: Allerton Av Road Diet

- Pedestrian injuries decreased by 50%
- Total injuries for all road users decreased by 35%



Each before year period is the 12-month period beginning July 1 and ending June 30. The 3-yr after period is September 1, 2009 to August 31, 2012. The implementation period of July 1, 2009 to August 31, 2009 is excluded. Source: NYPD AIS/TAMS Crash Database

## Crashes, Three-Year After Analysis

Allerton Ave Between Boston Rd and E Gun Hill Rd

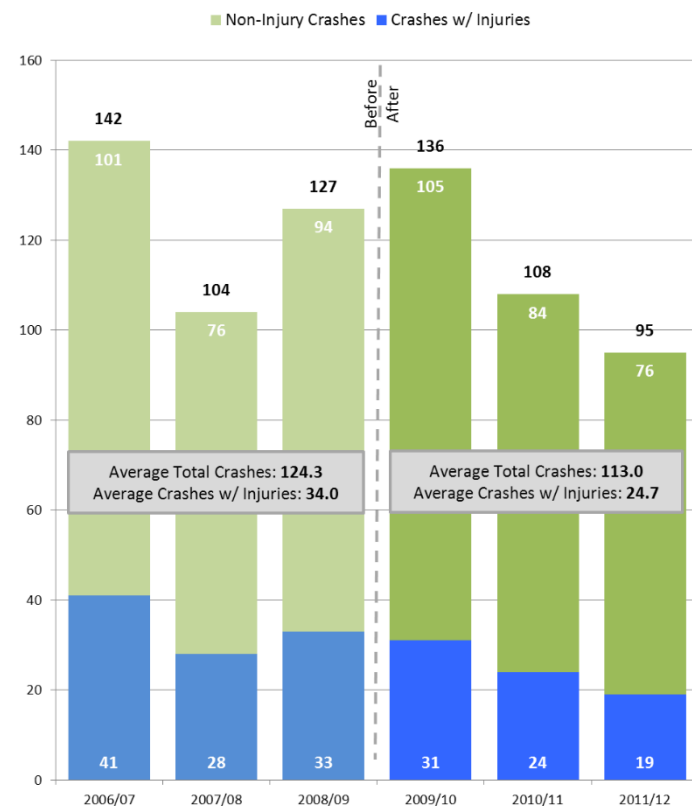

# Past Projects: E 180<sup>th</sup> St Road Diet

- Pedestrian injuries decreased by 31%
- Total injuries for all road users decreased by 18%

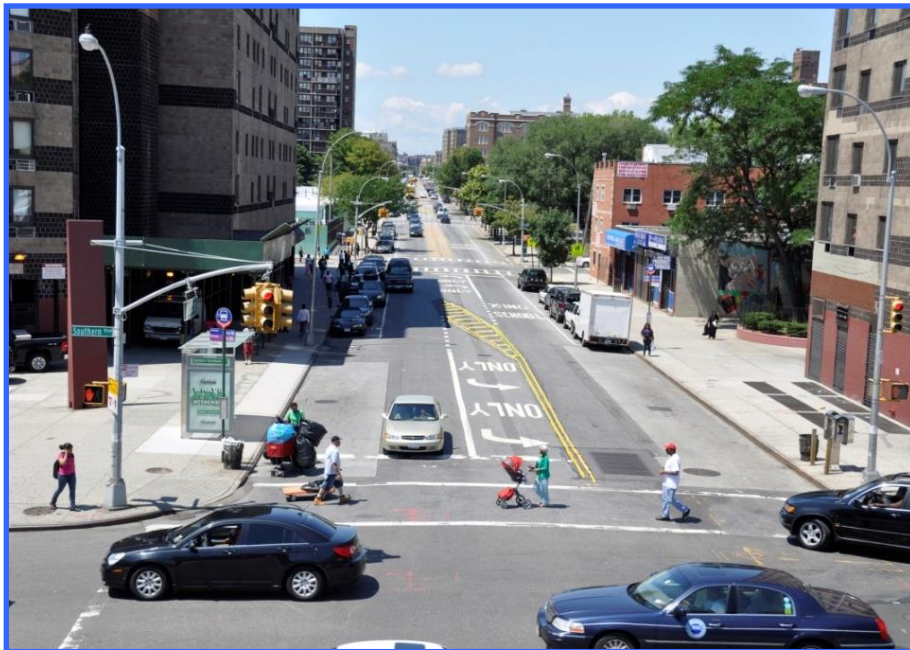

Each before year period is the 12-month period beginning October 1 and ending September 30. The 2-yr after period is November 1, 2010 to October 31, 2012. The implementation period of October 1, 2010 to October 31, 2010 is excluded. *Source: NYPD AIS/TAMS Crash Database*

## Crashes, Three-Year After Analysis E 180<sup>th</sup> St (Webster Avenue to Southern Boulevard)

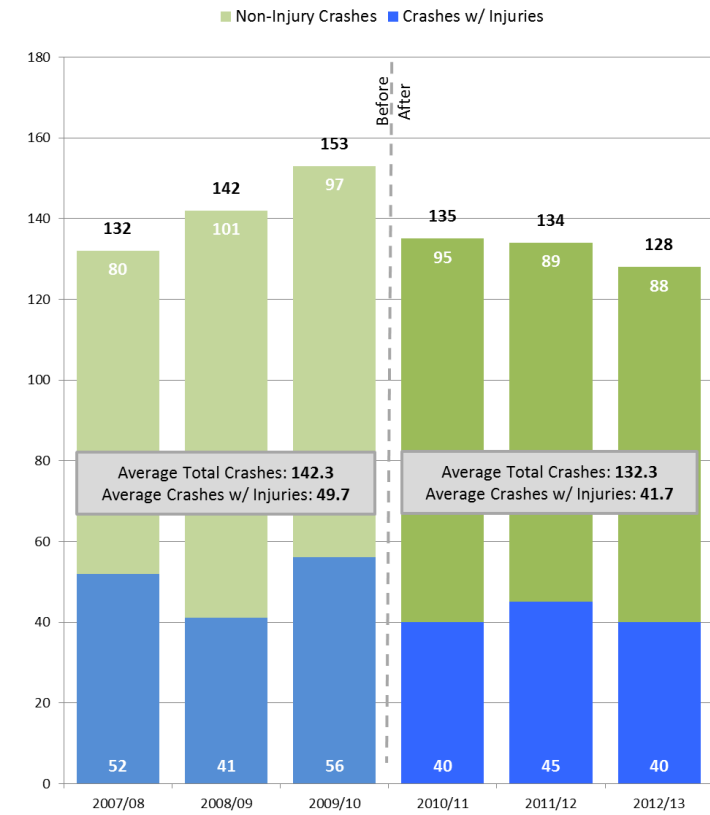

# Gun Hill Rd Merchant Survey

---

- In March 2021, DOT visited every business on Gun Hill Rd from Bainbridge Av to Bartow Av
  - Partnership with Jerome-Gun Hill BID
- 144 merchants took our survey on delivery schedules, challenges & needs
- Busiest sections for deliveries:
  - Tryon Av to Webster Av
  - Barnes Av to Laconia Av
- 29% of businesses say vehicles delivering to them need to double-park
  - Especially west of Webster Av & near the 5 train
- 71% of businesses don't control when their deliveries arrive





# Segment 1: Bainbridge Av to Webster Av

- Westbound center-running bus lane with 2 bus boarding islands
- Eastbound offset bus lane
- Safety improvements at 4 intersections
- Curb regulation & bus stop improvements
- Implementation in Spring 2023
  - Slight design changes may arise in implementation

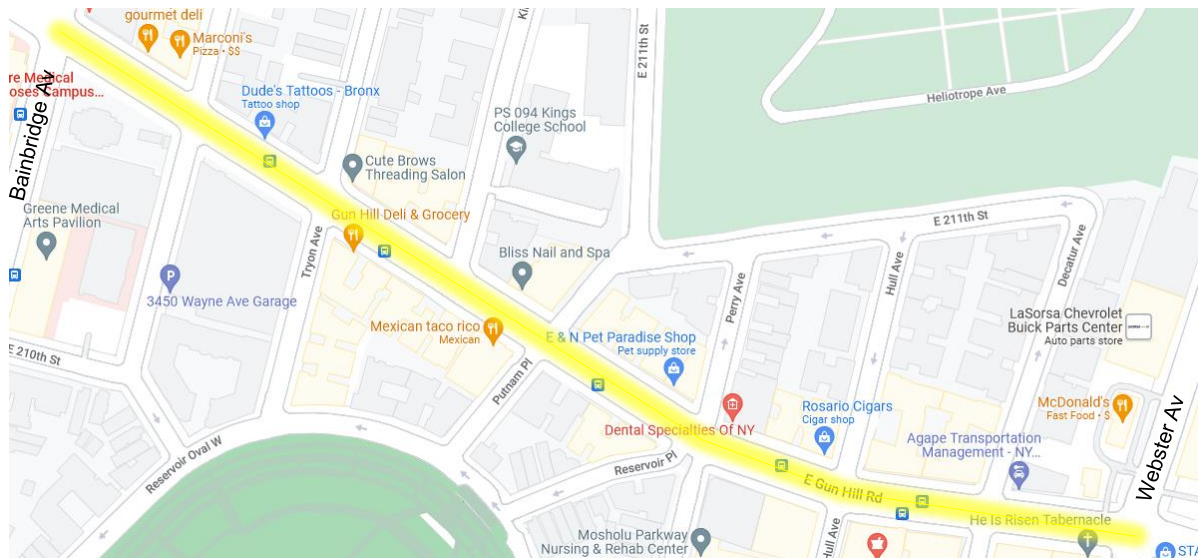

# Segment 1: Toolkit



Center Bus Lane

161<sup>st</sup> St, BX



Bus Boarding Island

Kings Hwy, BK



Metered Parking



Offset Bus Lane

Woodhaven Blvd, QN



Truck Loading Zones

© NYC DOT

# Bainbridge Av to Tryon Av

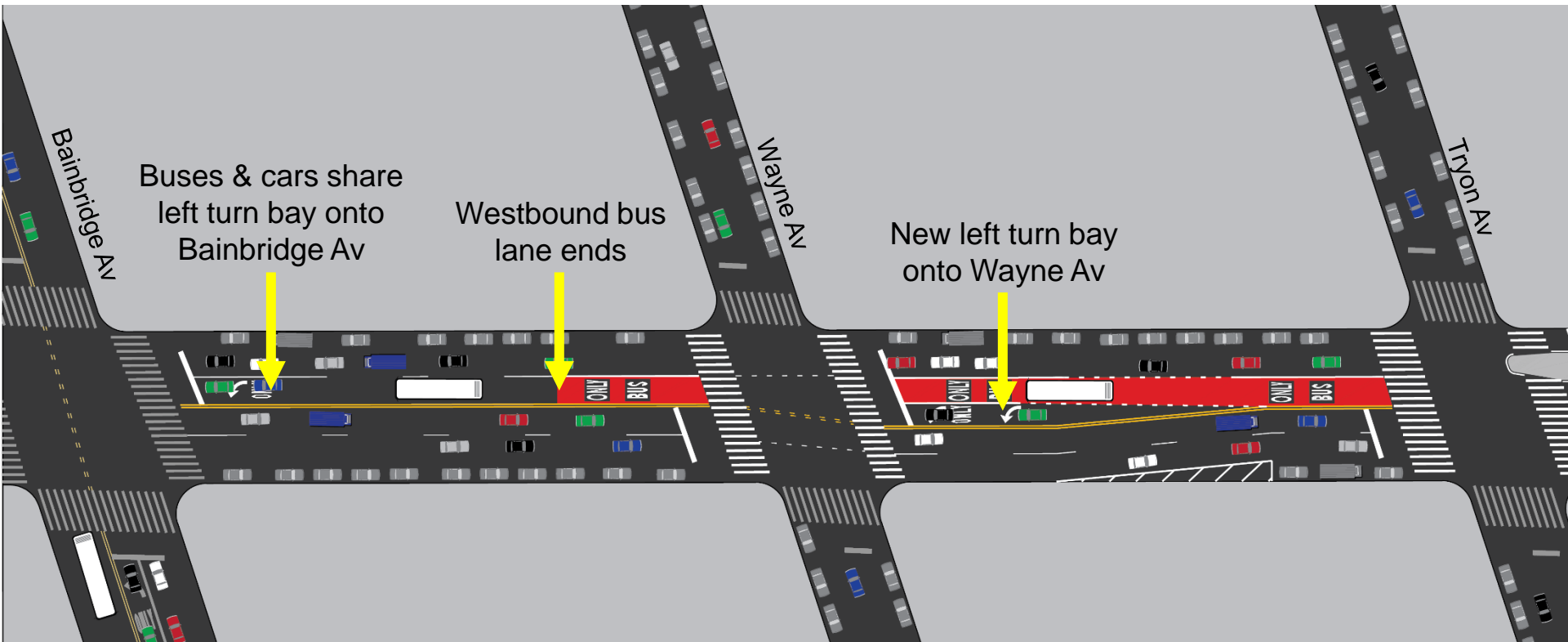



# Tryon Av to Putnam Pl

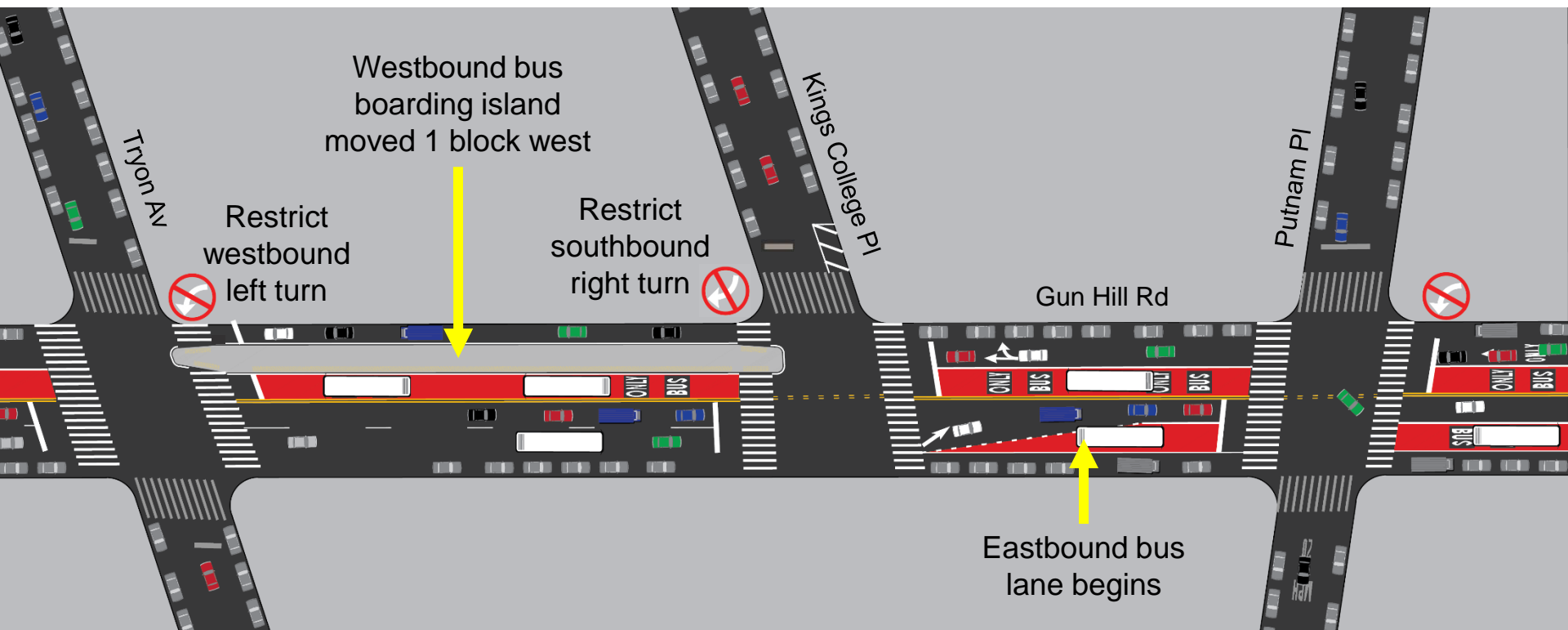

# Putnam Pl to Hull Av

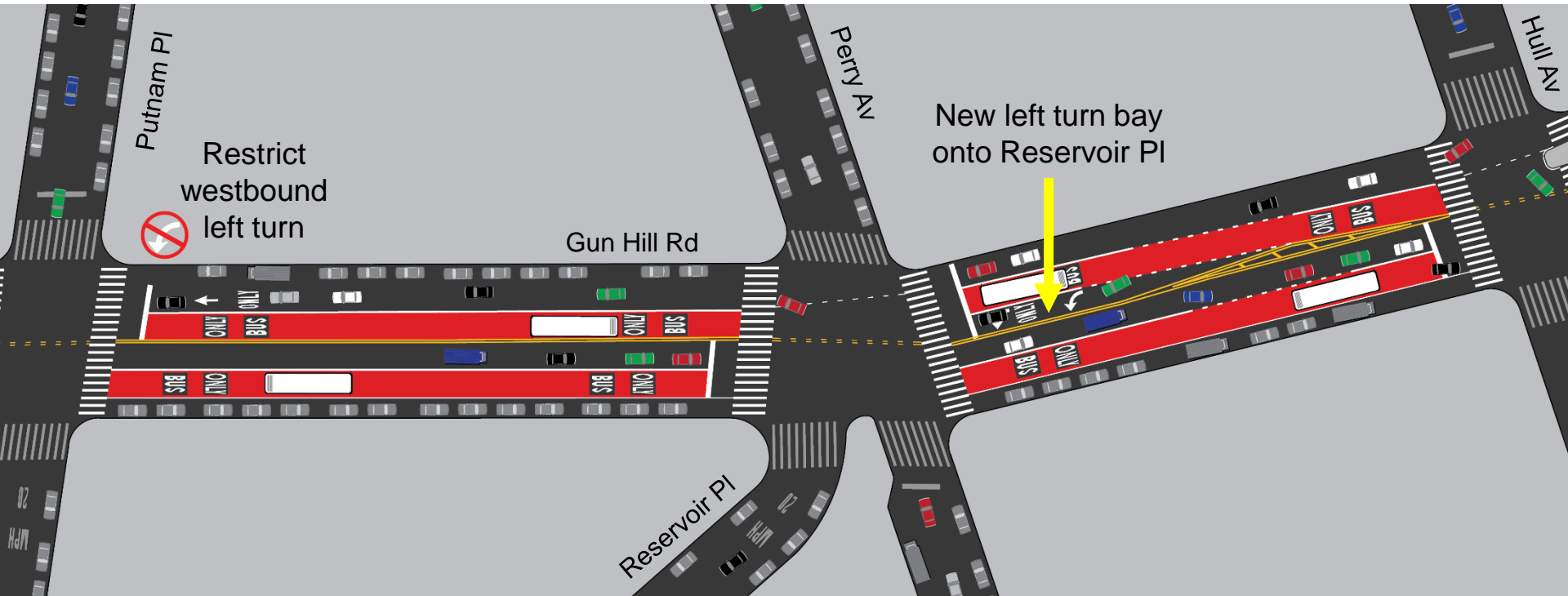

# Hull Av to Webster Av

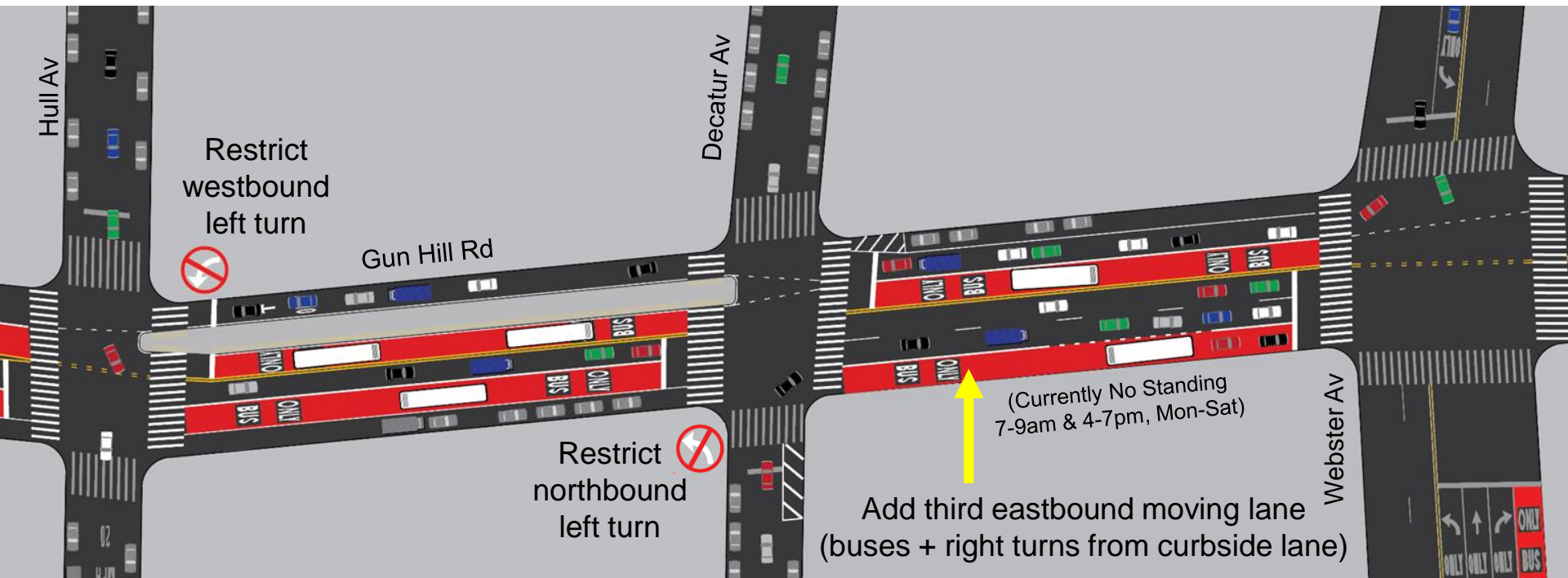



# Webster Av to Bronx River Pkwy

- Implement beginning of WB bus lane, left turn lane in Spring 2023
  - Organizes traffic and buses before center-running bus lane begins
- Implement remainder of this section in Late 2023/2024
  - Currently researching potential improvements; proposal coming soon

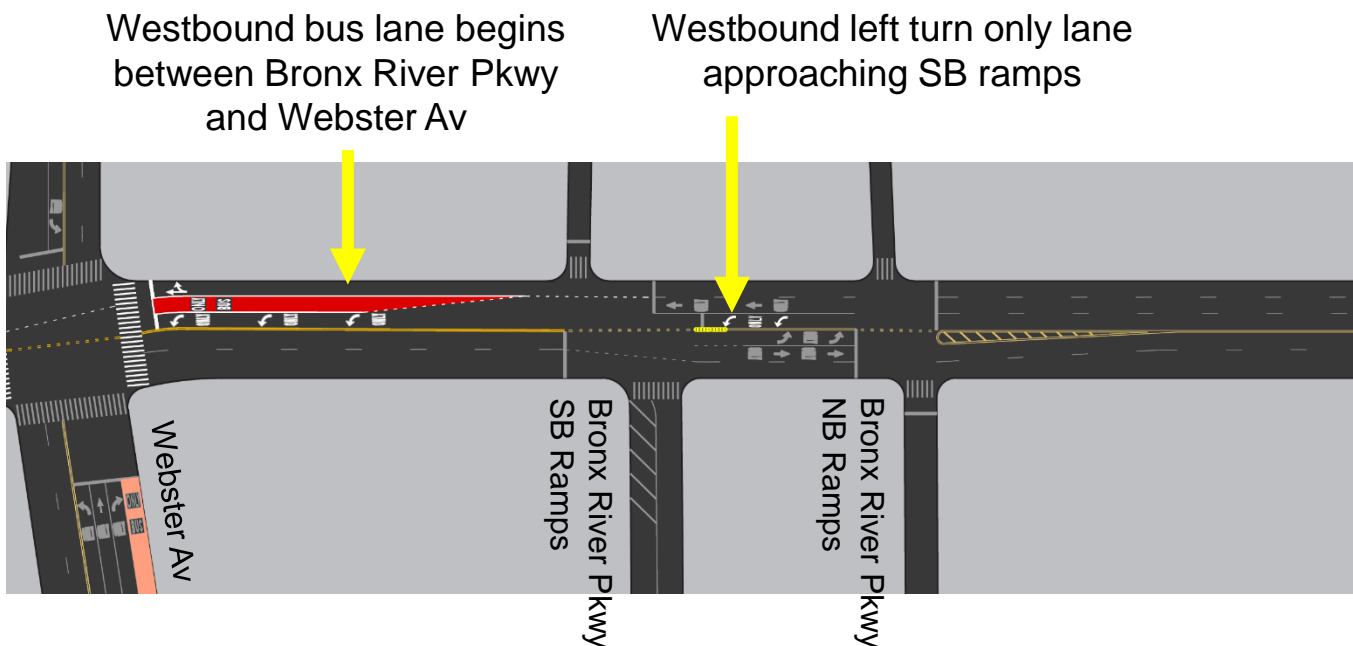

# Curb Regulations: Bainbridge Av to Webster Av

- Repurpose 31 full-time parking spaces to accommodate bus boarding islands, left turn bays
  - Plus 8 spaces where parking is currently allowed off-peak hours only\*
- Add 12 new spaces in former bus stops
- 4 truck loading zones (13 spaces) + 3 residential loading zones (6 spaces)
  - These spaces available for resident parking off-hours
- 49 newly metered spaces on blocks with businesses
  - Ensure parking availability & reduce double parking

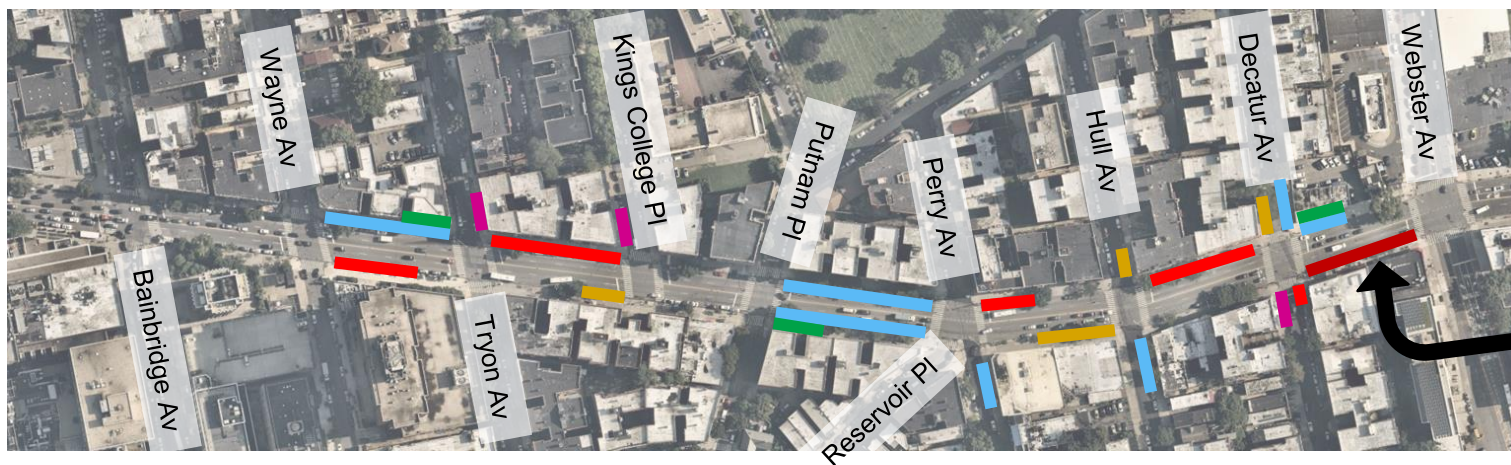

\* Existing  
No  
Standing  
7-9am &  
4-7pm,  
Mon-Sat

# Traffic Analysis: What to Expect

## Bainbridge Av to Webster Av

- Initially, notable congestion is likely as drivers adjust to Gun Hill Rd's new design
- This is typical for bus lane projects; conditions will improve over time
  - Some drivers will use alternate routes, travel at less busy times of day, or use other means of travel
- **During AM & PM rush hour:**
  - With 10% fewer vehicles (1.5 per minute), traffic would be comparable to today
- Gun Hill Rd will receive substantially more green time, benefiting traffic
  - Pedestrians still have 30+ seconds to cross Gun Hill Rd (down from 50 seconds)
- We will monitor traffic during and after implementation and will consider additional changes as needed



# Traffic Hotspots: Bainbridge Av to Webster Av

- Potential **traffic hotspot locations** for additional monitoring:

AM Rush Hour

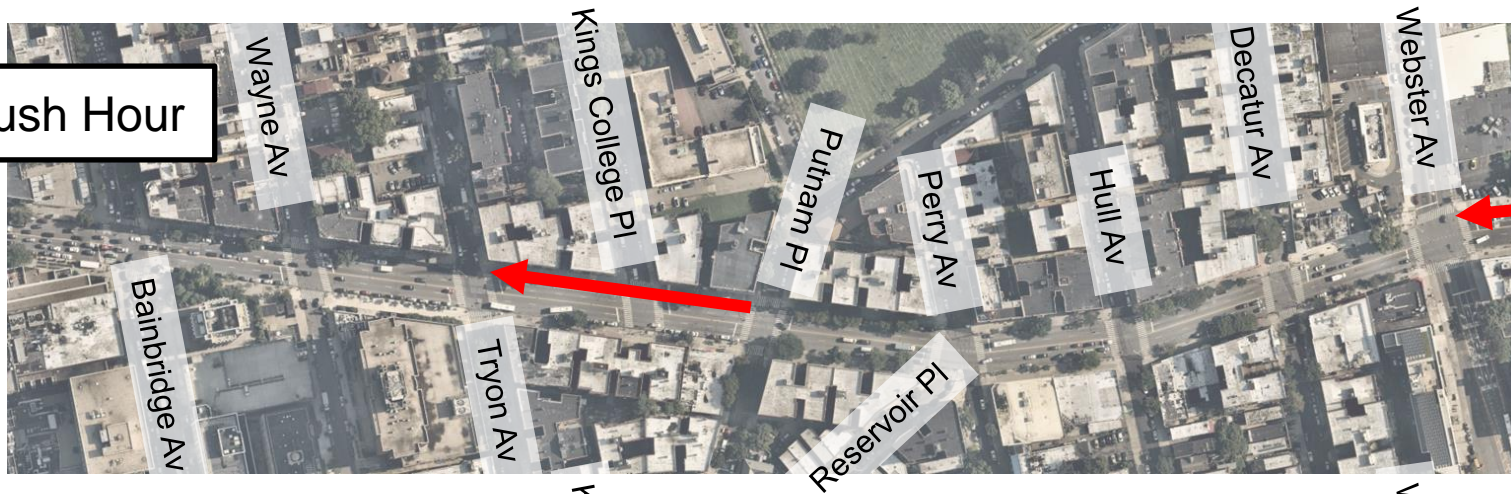

PM Rush Hour

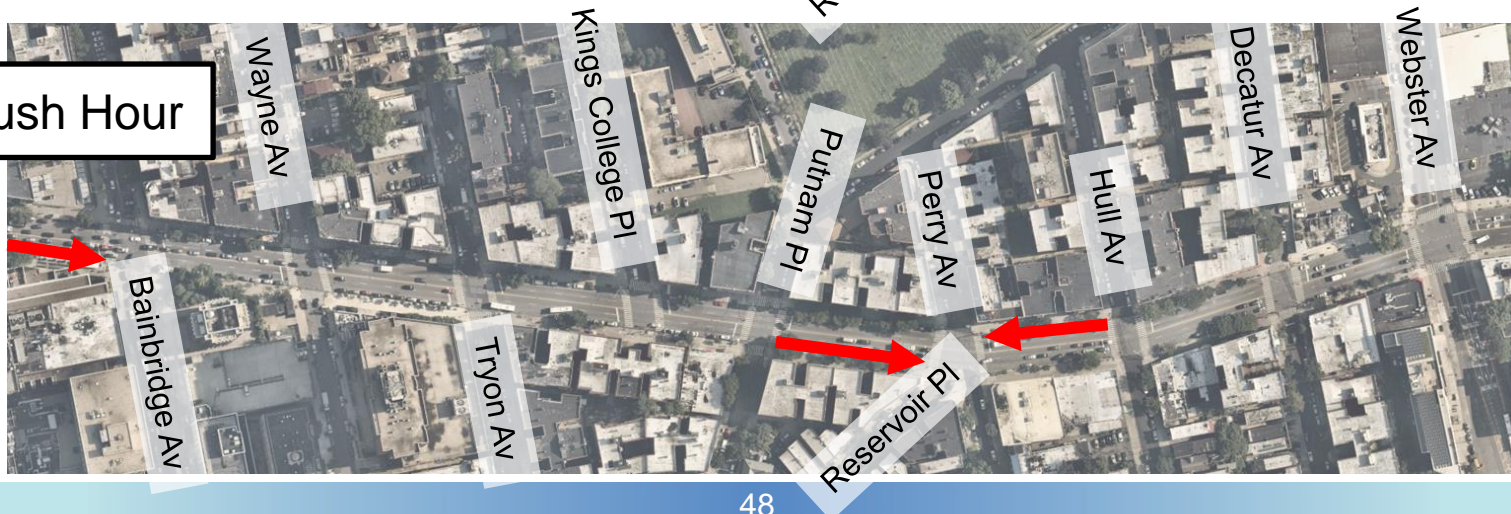

# Traffic Accommodations: Bainbridge Av to Webster Av

1. Left turn bays
2. Left turn restrictions
3. Curb regulation improvements to reduce double parking
4. Third eastbound moving lane (curbside bus lane) from Decatur Av to Webster Av
5. All vehicles use offset/curbside bus lane to turn right or access a driveway
6. Signal timing improvements

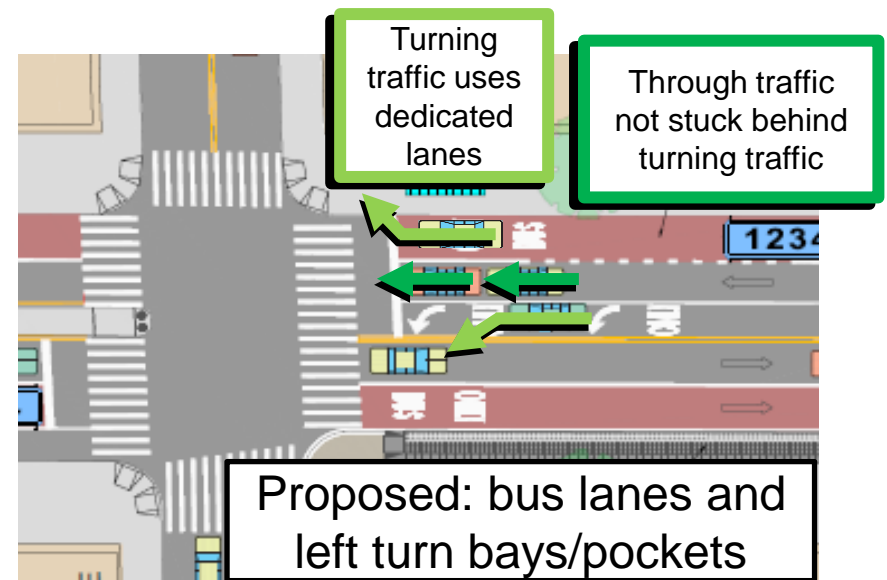
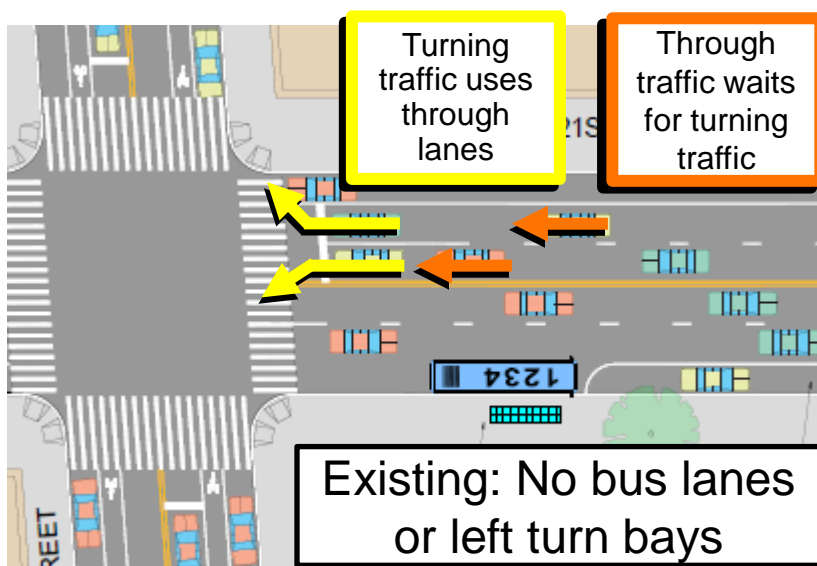



# Bainbridge Av Mid-Block Crossing

- New, signalized & marked, **mid-block crossing**
- Connects **main entrances** of Children's Hospital (3415 Bainbridge Av) & Greene Medical Arts Pavilion (3400 Bainbridge Av)
- Implementation: traffic & pedestrian signals in Winter 2023, roadway markings in Spring 2023

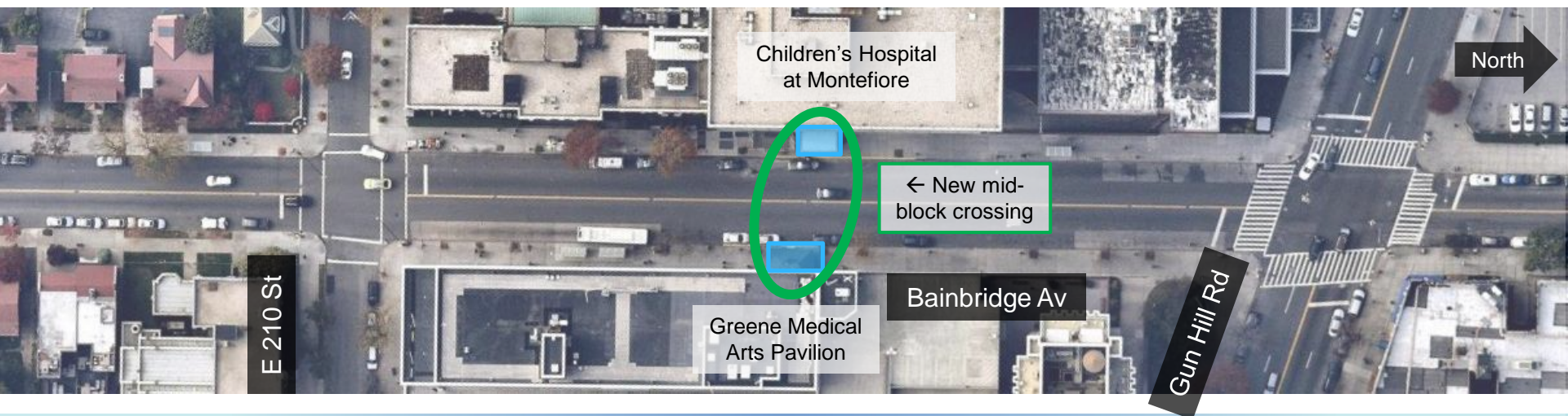



# Bainbridge Av Bus Stop Changes

- Busy bus corridor serving 6 routes
- Currently, southbound buses stop twice, one block apart
- **Consolidate two southbound stops to one stop at near side of 210<sup>th</sup> St**
- Retain stop at far side of 210<sup>th</sup> St for BxM4 Express Bus only
- Implementation: Spring 2023



# Bainbridge Av Curb Regulations

- Currently an inconsistent mix of No Standing Anytime, No Standing 7am-7pm Mon-Sat, No Parking Mon-Fri 8am-6pm, Ambulette Only
- Frequent double-parking blocks entrances & traffic
- No ambulance parking area near ER entrance
- **Strengthen No Standing rules & add ambulance parking near ER**

## Proposed

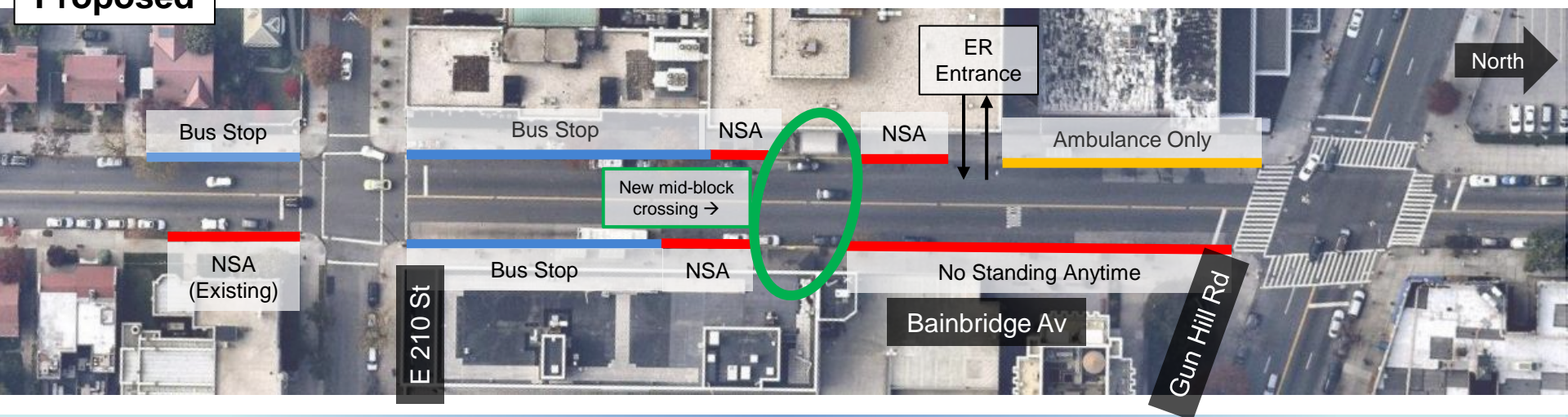



# Wayne Av Curb Regulations

- Narrow, 2-way street
- One double-parked vehicle can block garage access, back up traffic on Wayne Av, and cause spillbacks onto Gun Hill Rd
- Currently an inconsistent mix of No Standing Anytime, No Standing Mon-Fri 7am-7pm, alternate side parking
- **Strengthen No Standing rules** to reduce lane blockages, create easier access to garages and buildings

