

# Gun Hill Rd Bus & Pedestrian Improvements

Community Board 11 Transportation Committee

March 13<sup>th</sup>, 2023



# Table of Contents

---

1. Introduction
2. Proposal
  - Design
  - Curb regulations
  - Traffic analysis
3. Project Timeline

# Introduction

# Why Gun Hill Road?

- 40,000 daily bus passengers
- Critical crosstown service with key connections to **2** **5** **D**, many local bus routes, Montefiore Hospital, Co-Op City, Bay Plaza
- MTA Bronx Bus Network Redesign (implemented 2022)
  - 50+ outreach events
  - Community requests to improve Gun Hill Rd bus service
  - Named 1 of 10 key Bronx corridors for bus priority

## Bronx Bus Priority Corridors

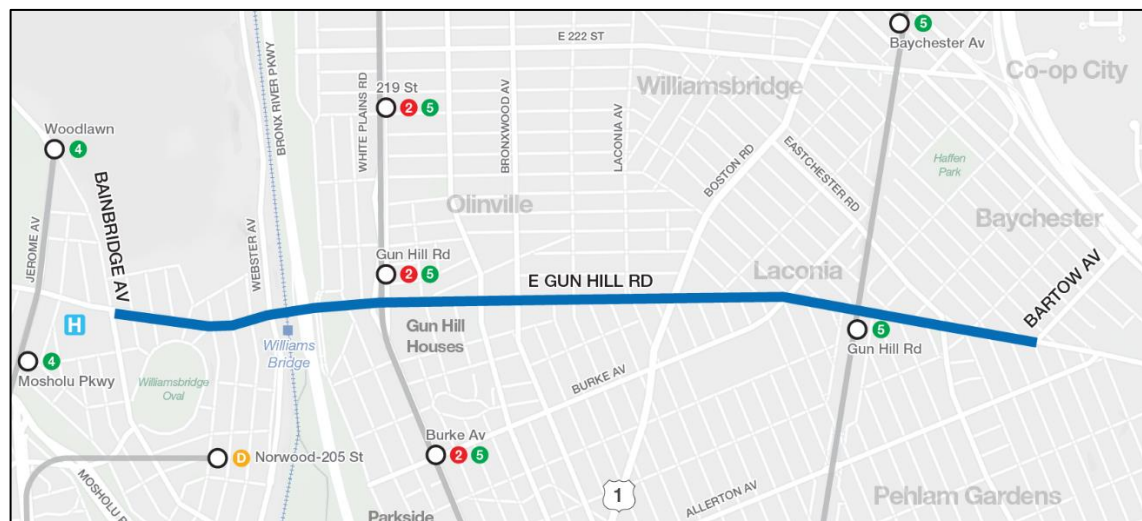
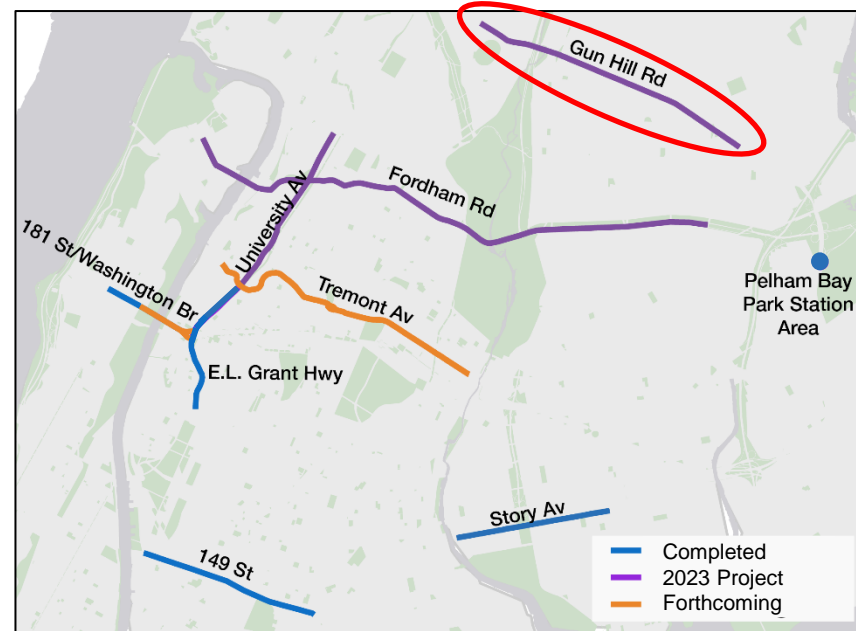

# Gun Hill Rd Bus Speeds

- **Slow and unreliable** bus service along Gun Hill Rd
- Buses move slow all day and **less than 5 mph** in the AM westbound, PM eastbound
- Peak-period trips take **15-17 minutes longer** than evening/overnight
- **Traffic congestion and double-parking** cause slowdowns
- Only **65%** of Bx28/38 trips completed within 5 min of scheduled time

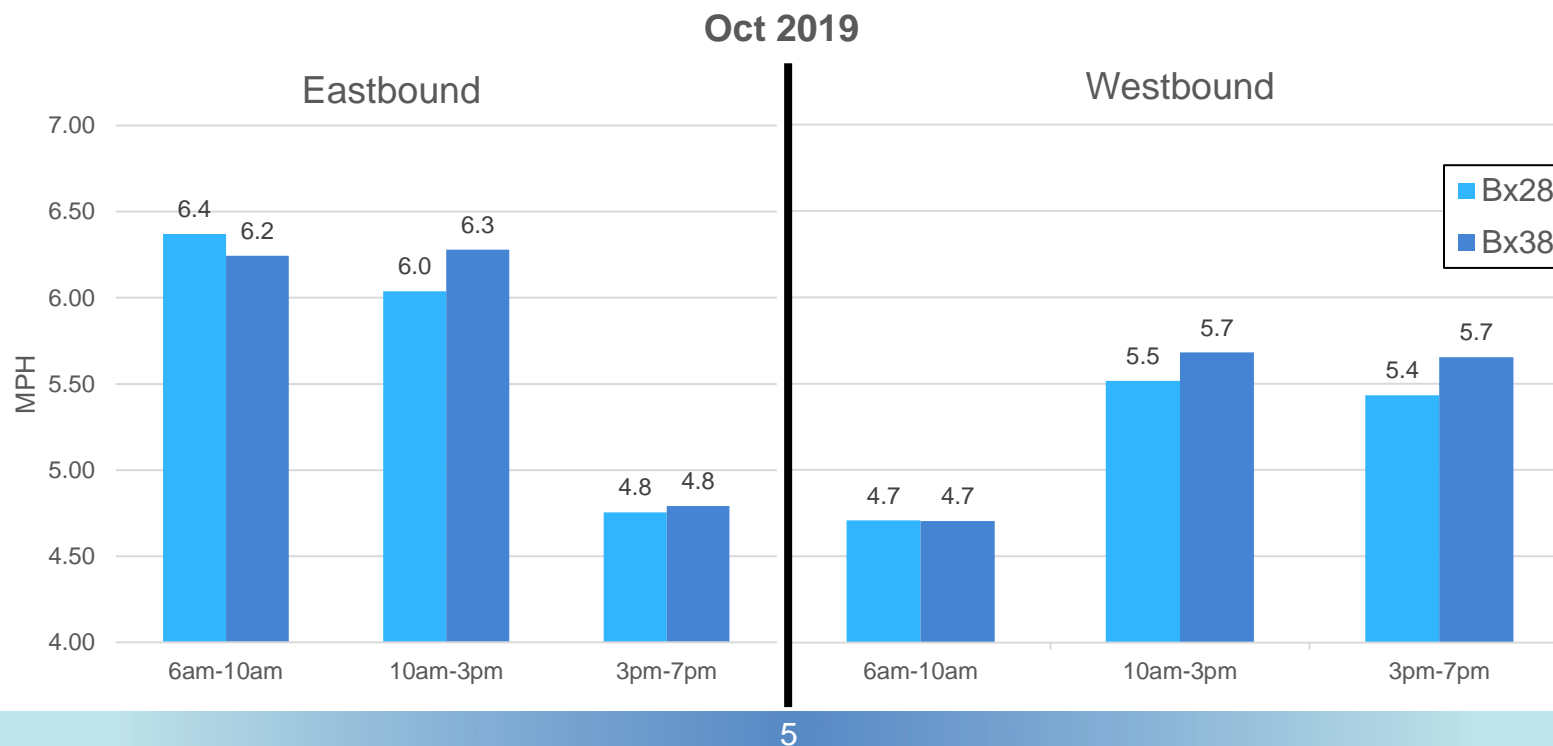



# Crash History

## Injuries & Fatalities 2015-2019

- On average, nearly 5 people every week are injured in crashes on Gun Hill Rd
- In top 10% of most dangerous Bronx streets
- 64 severe injuries + 2 fatalities
- Vision Zero Priority Corridor
- Safety solutions:
  - Fix wide-angle left turns
  - Discourage speeding
  - Improve driver-pedestrian visibility

### Gun Hill Rd, Top 5 Most Injury-Prone Intersections, 2015-19

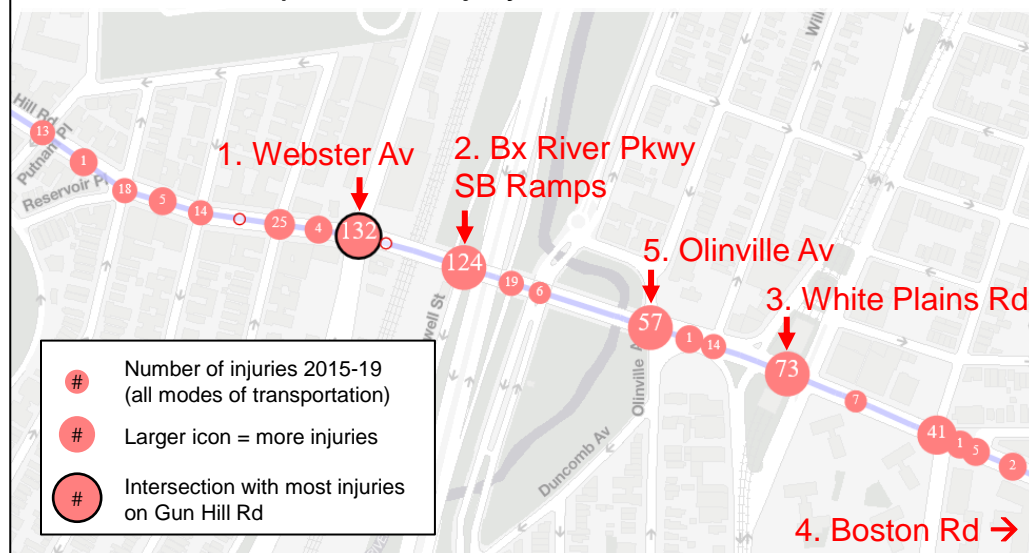

Gun Hill Rd & Boston Rd

# Community Feedback: On-Street Outreach

DOT held public outreach pop-ups and had conversations with **over 100 bus riders & community members**

- Wed, May 18 – Gun Hill Rd & Bainbridge Ave
- Fri, May 20 – Gun Hill Rd & White Plains Rd
- Mon, May 23 – Gun Hill Rd & Knapp St (5 train)

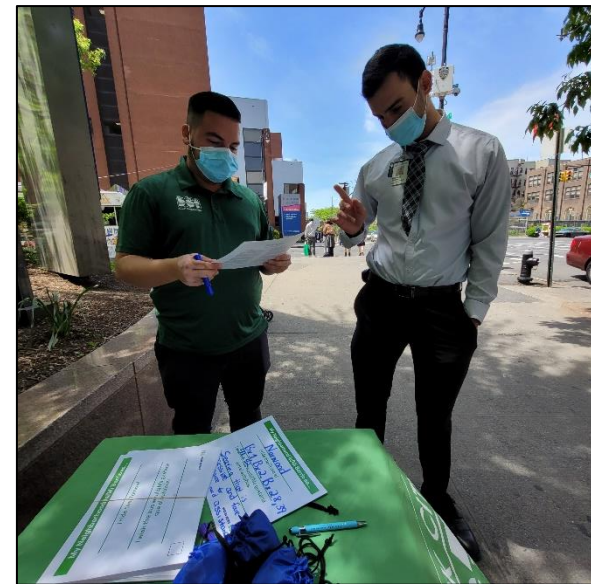
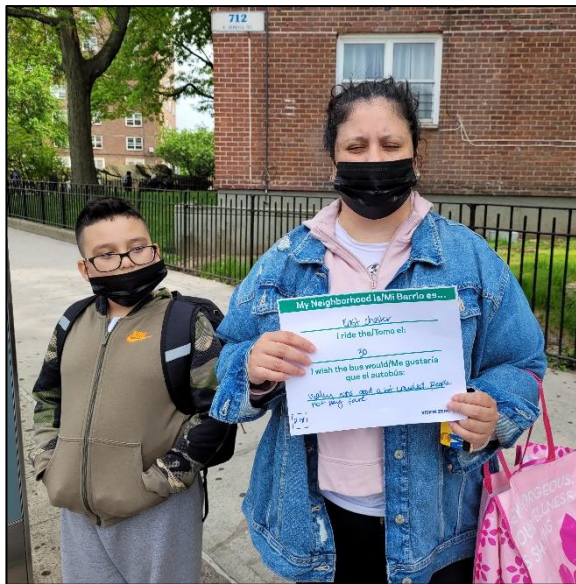



# On-Street Outreach

## Popular requests:

- Faster service
- More frequent, consistent service
- Less crowding on buses

Bus lanes can address all of these

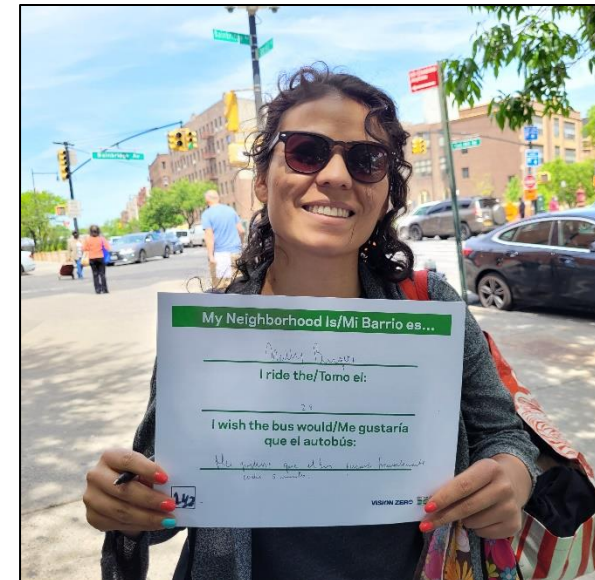
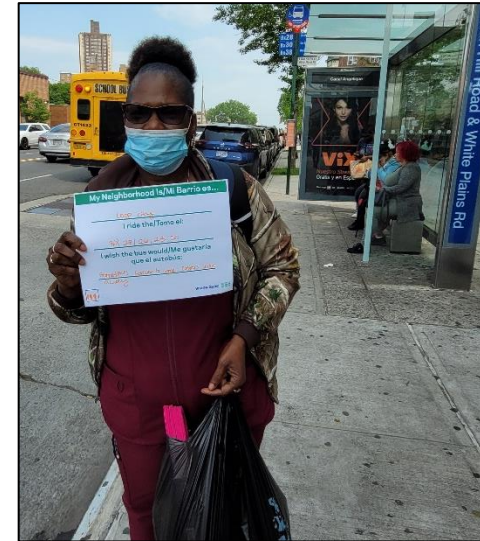



# On-Street Outreach: More Feedback

My Neighborhood Is/Mi Barrio es...

Wakefeild

I ride the/Tomo el:

Bx28 Bx4055

I wish the bus would/Me gustaría que el autobús:

be more frequent & faster

180

VISION ZERO NEW YORK CITY DOT

My Neighborhood Is/Mi Barrio es...

Williamsbridge

I ride the/Tomo el:

Bx28, Bx30

I wish the bus would/Me gustaría que el autobús:

Timing and schedule

204

VISION ZERO NEW YORK CITY DOT

My Neighborhood Is/Mi Barrio es...

Bx28

I ride the/Tomo el:

Eastchester

I wish the bus would/Me gustaría que el autobús:

Being on Time

202

VISION ZERO NEW YORK CITY DOT

My Neighborhood Is/Mi Barrio es...

Norwood (work)

I ride the/Tomo el:

Bx30, 34 & 16

I wish the bus would/Me gustaría que el autobús:

The buses are on-time, it's the traffic.

164

VISION ZERO NEW YORK CITY DOT

My Neighborhood Is/Mi Barrio es...

fremont

I ride the/Tomo el:

30

I wish the bus would/Me gustaría que el autobús:

very slow. wait too long for it.

207

VISION ZERO NEW YORK CITY DOT

My Neighborhood Is/Mi Barrio es...

Castle Hill- Bx

I ride the/Tomo el:

Bx28, Bx30

I wish the bus would/Me gustaría que el autobús:

Traffic and congestion

244

VISION ZERO NEW YORK CITY DOT

# Goals & Challenges

## Goals:

- Make bus service fast, reliable and on-time
- Reduce crashes, injuries & fatalities
- Organize traffic movements

## Challenges:

- Traffic congestion & double parking
- Broken street grid
- Bronx River Pkwy bottleneck

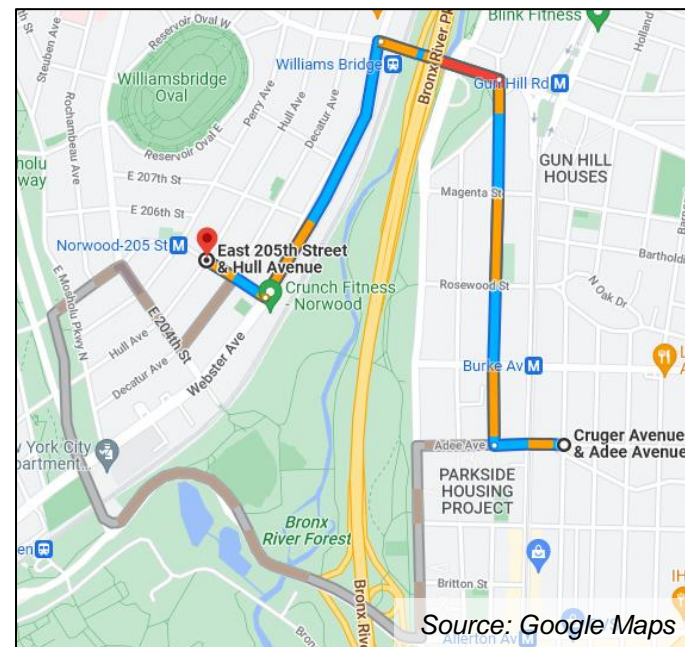

# Design



# Corridor Segments

## 1. Bainbridge Av to Webster Av

- Westbound center-running bus lane with 2 bus boarding islands
- Eastbound offset bus lane
- Implementation in Spring 2023

## 2. White Plains Rd to Bartow Av

- Offset bus lanes in both directions
- Pedestrian safety improvements at 20+ intersections
- Implementation in Spring 2023

## 3. Webster Av to White Plains Rd (Bronx River Pkwy area)

- Some implementation in Spring 2023 to complement rest of corridor
- Bus priority proposal coming soon; implementation in late 2023/2024



# Segment 2: Toolkit



Offset Bus Lane

Woodhaven Blvd, QN



Painted Pedestrian Space

Southern Blvd, BX



Concrete Pedestrian Space

Meeker Av, BK



Metered Parking

# Boston Rd to Bouck Av

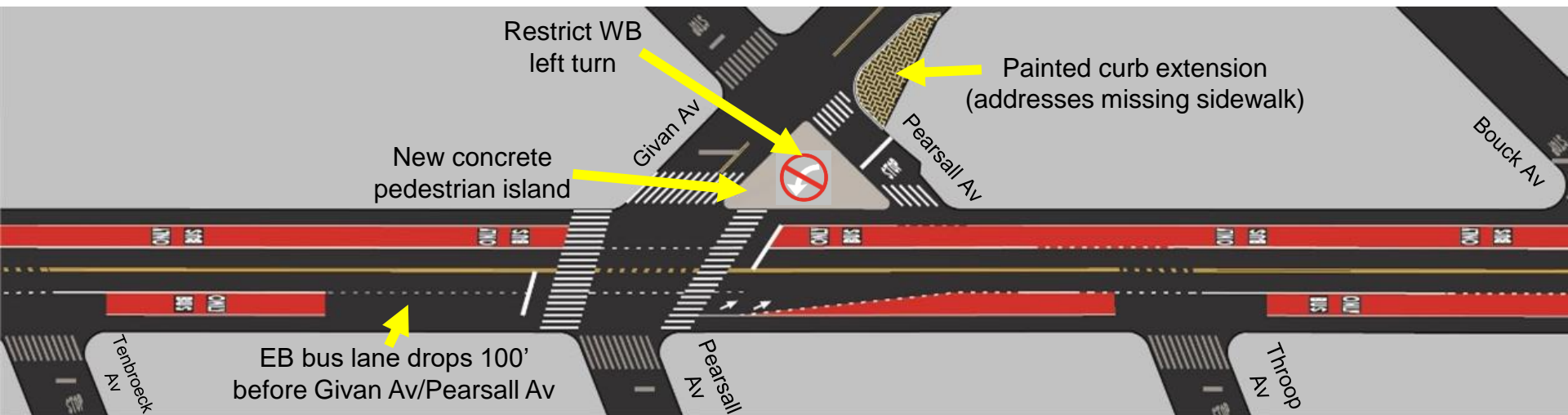
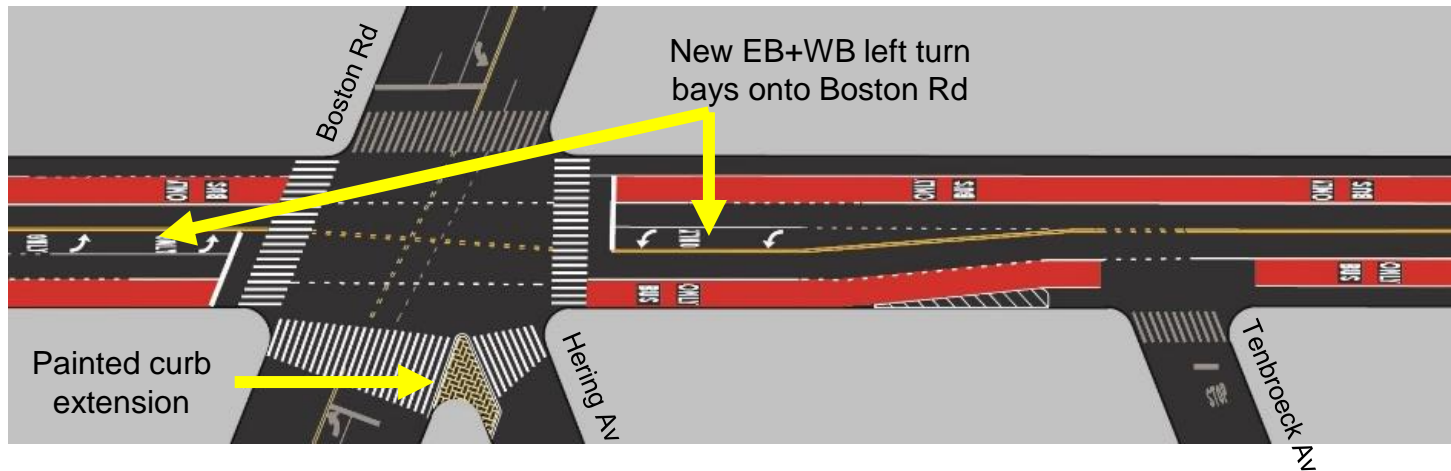



# Bouck Av to Seymour Av

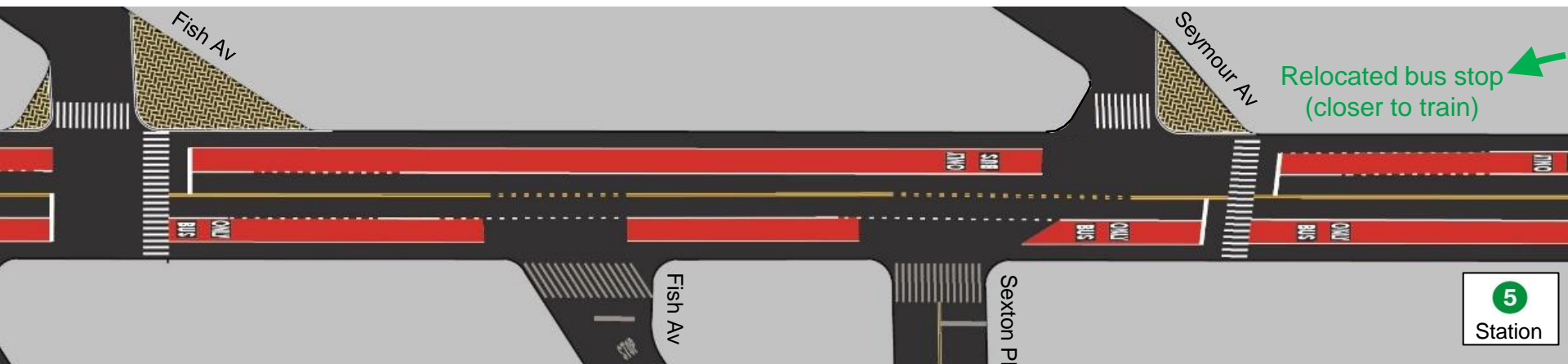
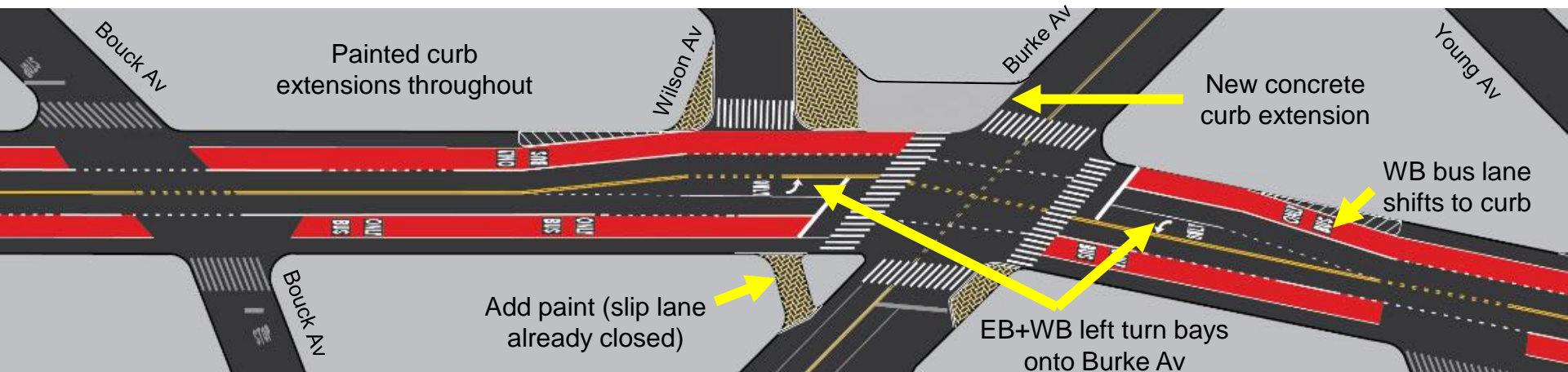

# Dewitt Pl to Arnow Av

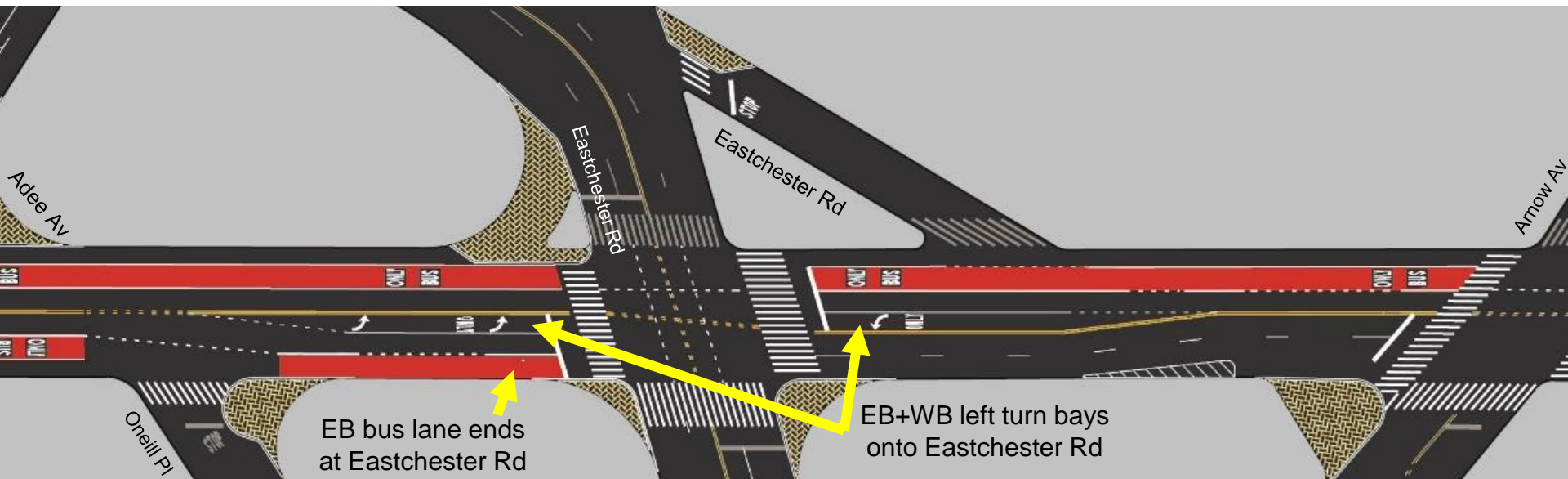
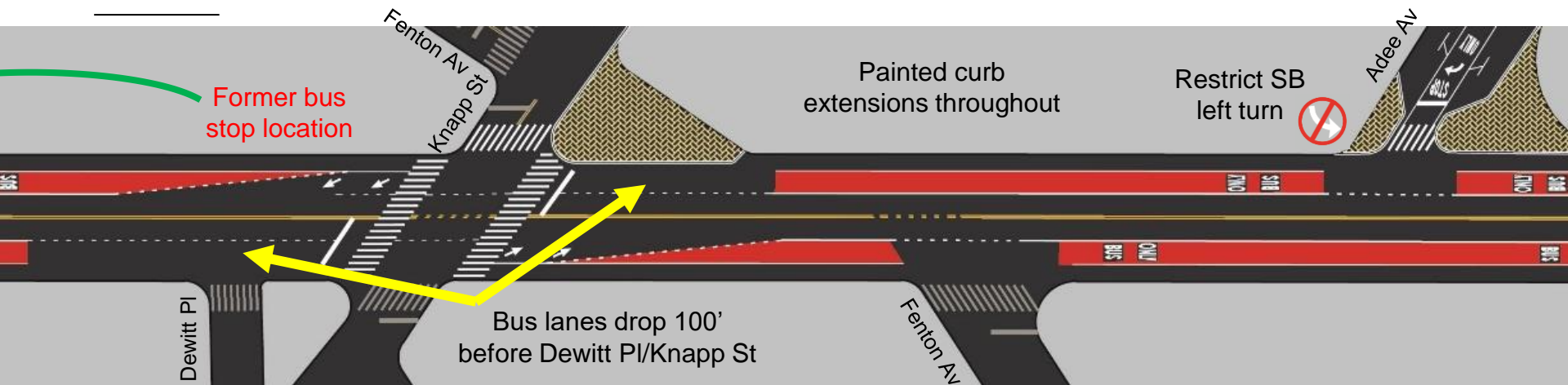

# Arnow Av to Gunther Av

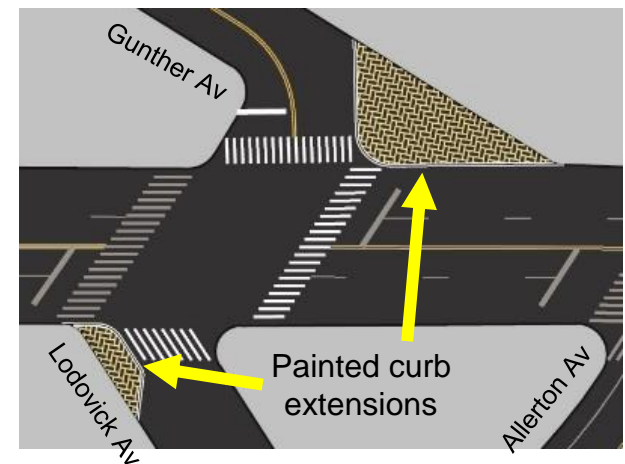
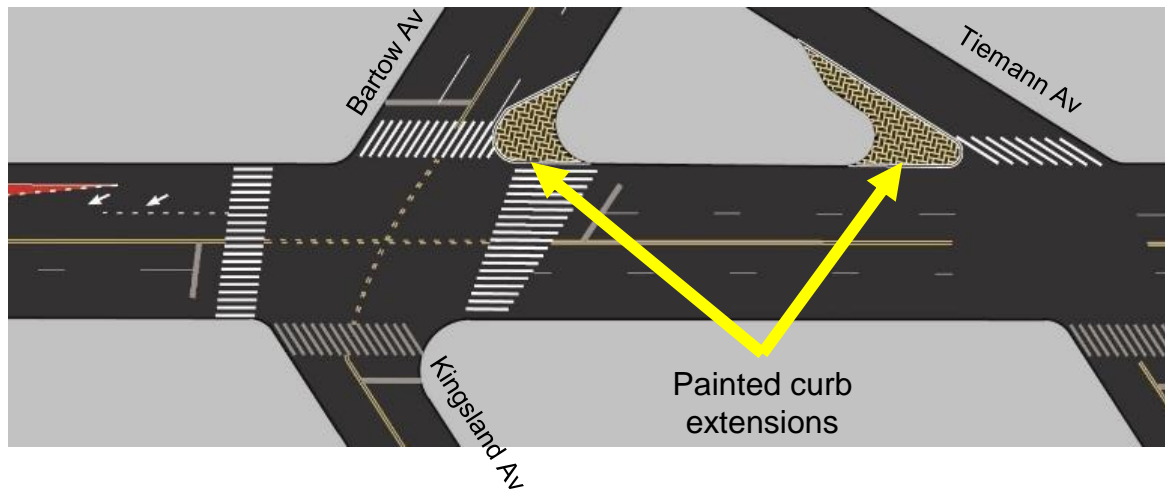
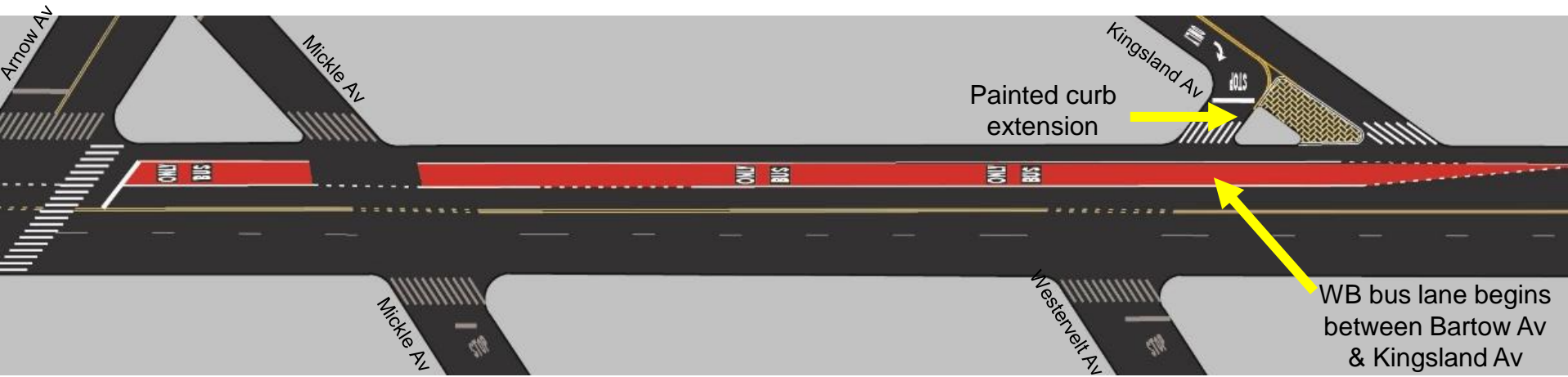



# Curb Regulations: Boston Rd to Eastchester Rd

- Repurpose 14 parking spaces to accommodate curbside bus lanes & passenger pickup/drop-off in front of the 5 train
- Add 7 new spaces adjacent to new pedestrian space, former bus stop
- 31 newly metered spaces on blocks with businesses
  - Ensure parking availability & reduce double parking



# Curb Regulations: Eastchester Rd to Gunther Av

- Repurpose 8 parking spaces to accommodate new left turn bay onto Eastchester Rd
- Add 15 new spaces in former bus stops & adjacent to new pedestrian space





# Traffic Analysis: What to Expect

## White Plains Rd to Bartow Av

- Initially, notable congestion is likely as drivers adjust to Gun Hill Rd's new design
- This is typical for bus lane projects; conditions will improve over time
  - Some drivers will use alternate routes, travel at less busy times of day, or use other means of travel
- Gun Hill Rd will receive substantially more green time, benefiting traffic
  - Pedestrians still have 30+ seconds to cross Gun Hill Rd (down from 50 seconds)
- **During AM & PM rush hour:**
  - With 10% fewer vehicles (1.5 per minute), traffic would be comparable to today
- We will monitor traffic during and after implementation and will consider additional changes as needed



# Traffic Hotspots: White Plains Rd to Bartow Av

- Potential **traffic hotspot locations** for additional monitoring



# Traffic Accommodations: White Plains Rd to Bartow Av

1. Left turn bays at 5 intersections
2. Bus lanes drop 100' before 5 intersections
3. Left turn restrictions at 2 locations
4. Curb regulation improvements to reduce double parking
5. Third EB moving lane (curbside bus lane) from Laconia Av to Boston Rd
6. All vehicles use offset/curbside bus lane to turn right or access a driveway
7. Signal timing improvements

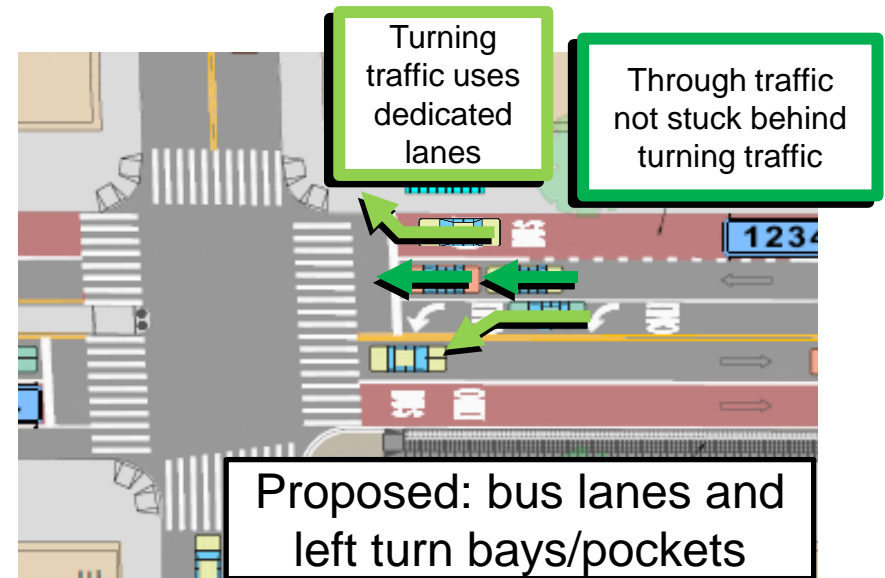
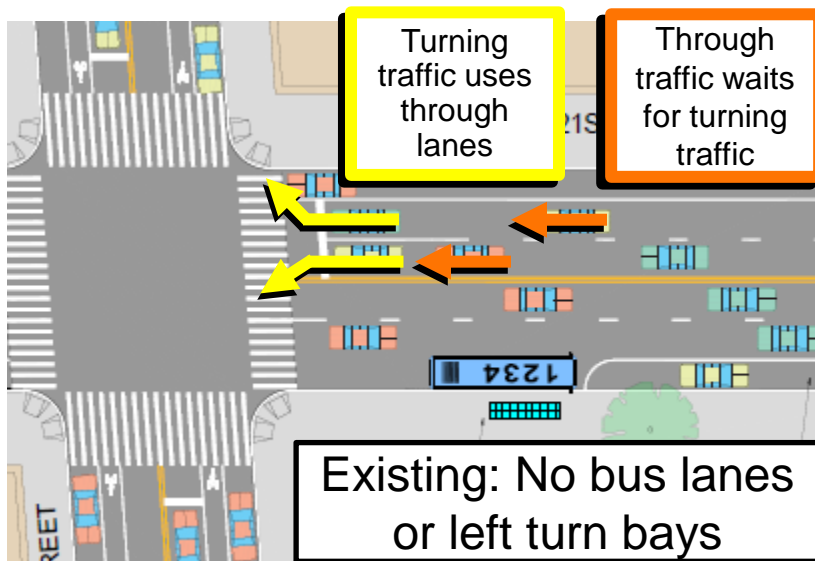

# Timeline



# Project Timeline

1. MTA Bronx Bus Network Redesign (implemented 2022): 50+ outreach events →
2. Merchant survey w/ Jerome Gun Hill BID
3. Field observations & traffic data
4. April 2022: discuss existing conditions & needs with Community Advisory Board (CAB) and Community Boards 7, 11 & 12
5. May/June 2022: present draft proposal to CAB and CBs
6. September 2022: Present updated proposal to CAB
7. **Winter 2023: Continue refining proposal; present updated proposal to elected officials, CAB & CBs**
8. Spring 2023: Begin implementation



# Thank You!

---

## Open Discussion & Questions



NYC DOT



NYC DOT



nyc\_dot



NYC DOT