

BRONX COMMUNITY BOARD No. 6

JANUARY 21, 2021

REHABILITATION OF EAST 188TH STREET BRIDGE
OVER METRO NORTH RAILROAD (MNR)



AGENDA

1. Project Overview
2. Existing Conditions
3. Proposed Bridge
4. Community Outreach & Stakeholder Coordination



1. PROJECT OVERVIEW

PROJECT OVERVIEW/SCOPE

- Reconstruct the 188th Street Bridge over Metro North Railroad (MNR) to obtain a design life of 75-years.
- Address existing deficiencies
- Provide ADA standard sidewalk ramps
- Provide standard sidewalk & curbs
- Provide standard PDC approved steel railing and fence

PROJECT LOCATION

EAST 188TH STREET over
Metro North Railroad (Harlem Line)
B.I.N. 2-24181-0

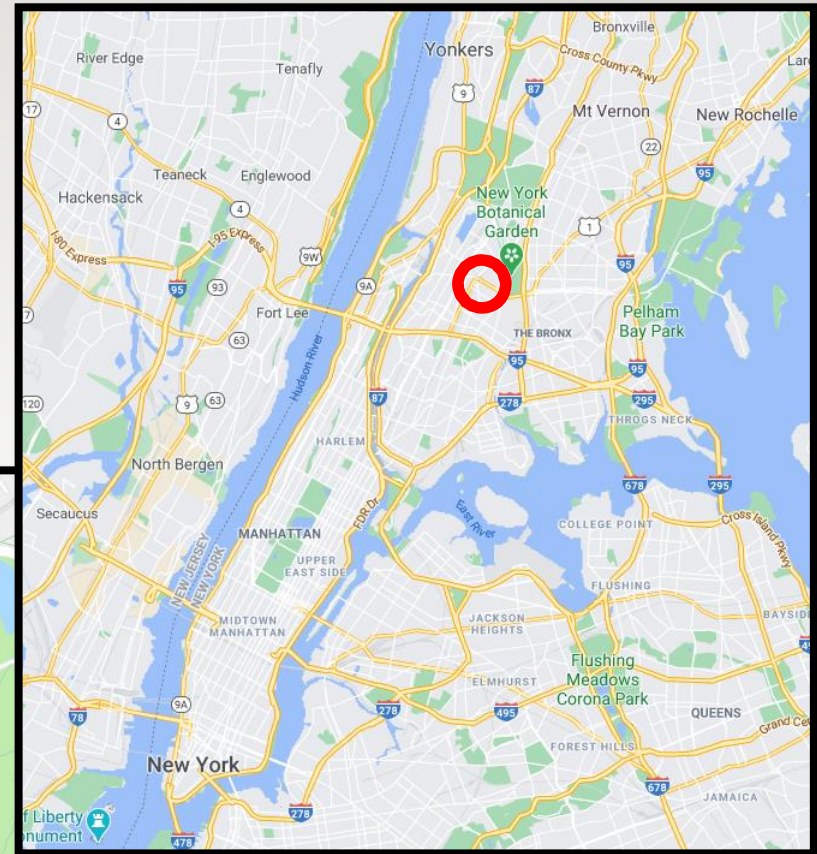
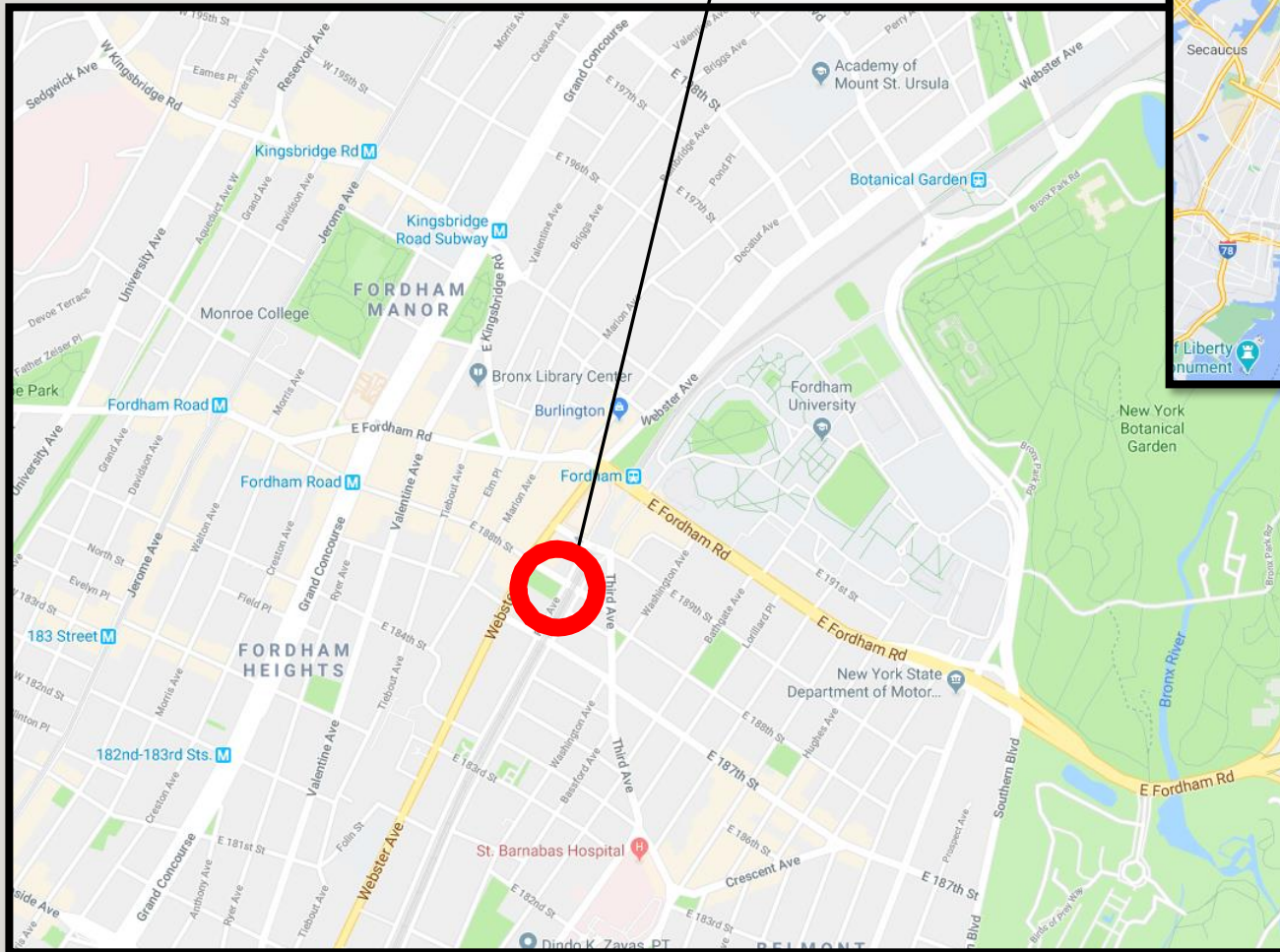

BRIDGE INFORMATION

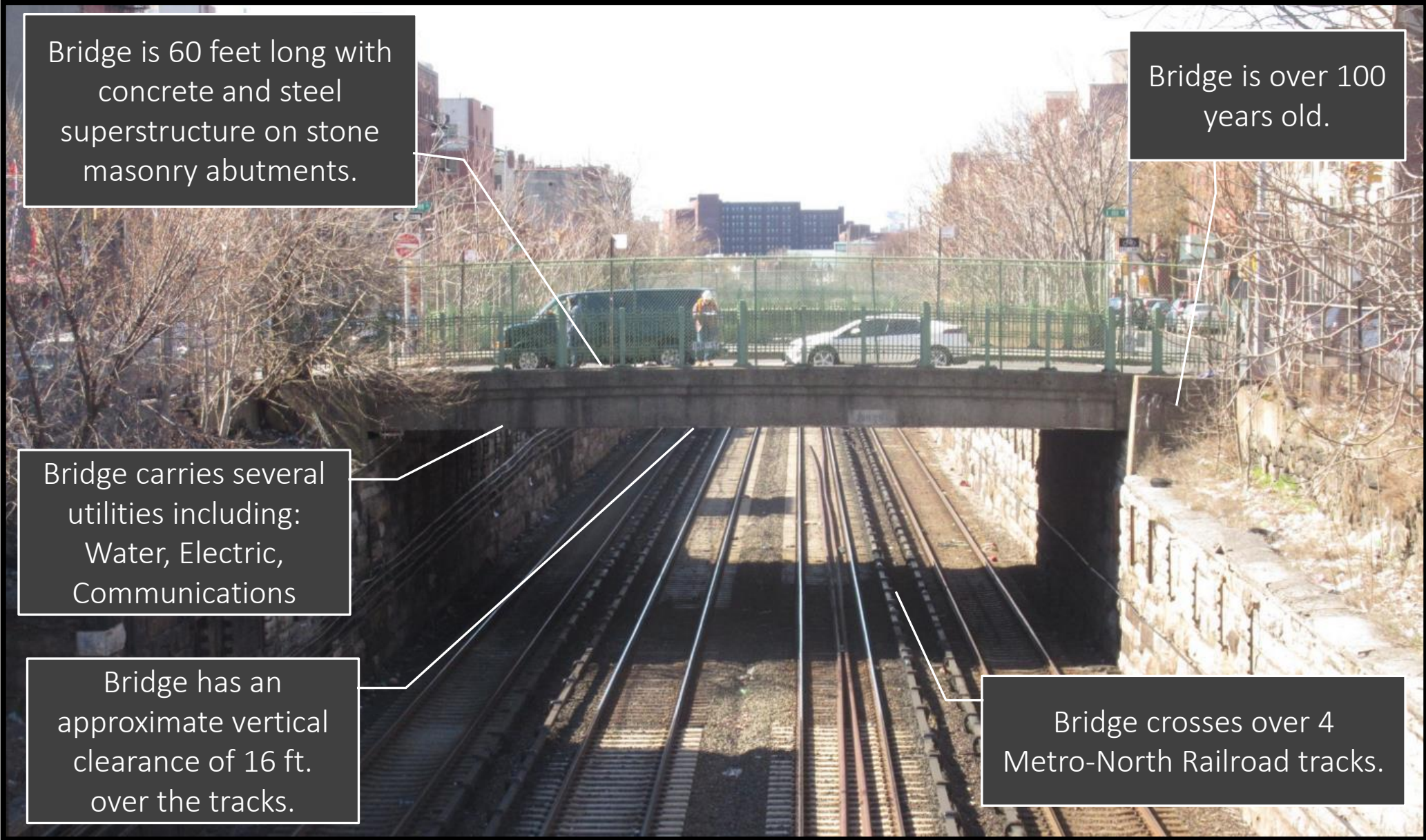

Bridge is 60 feet long with concrete and steel superstructure on stone masonry abutments.

Bridge is over 100 years old.

Bridge carries several utilities including: Water, Electric, Communications

Bridge has an approximate vertical clearance of 16 ft. over the tracks.

Bridge crosses over 4 Metro-North Railroad tracks.

2. EXISTING CONDITIONS

EXISTING ELEVATION

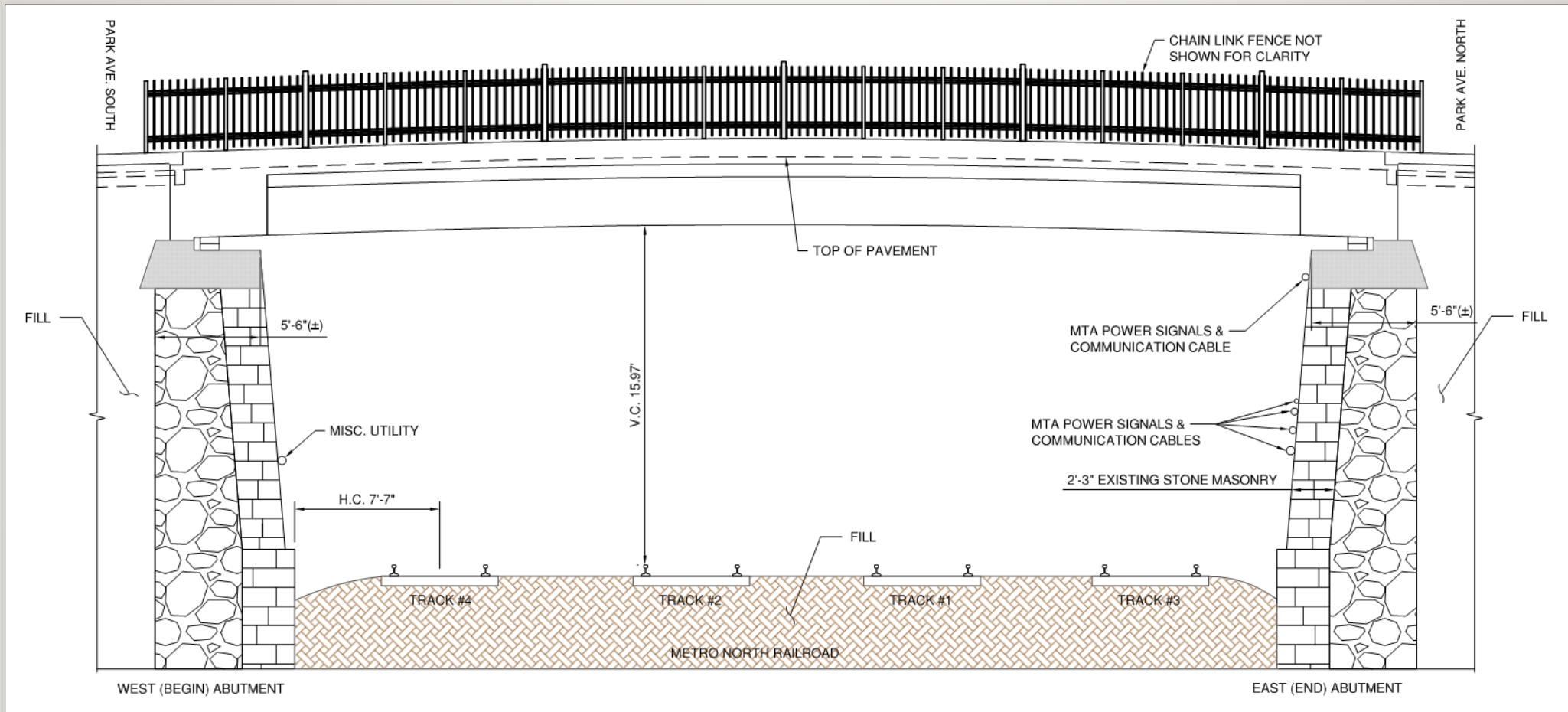

PHOTOGRAPHS OF EXISTING CONDITIONS



Deteriorated Underside of Deck
Corrosion of bottom flange of steel girders, cracking of structural deck and concrete encasements.



Deteriorated Steel Rocker Type
Bearing

PHOTOGRAPHS OF EXISTING CONDITIONS

Pot holes and patching in sidewalk



Deteriorated joints,
map cracking & settlement

EXISTING UTILITIES

Bridge carries several utilities including: Water, Con Edison (Electric), Communications (Verizon & Cablevision)

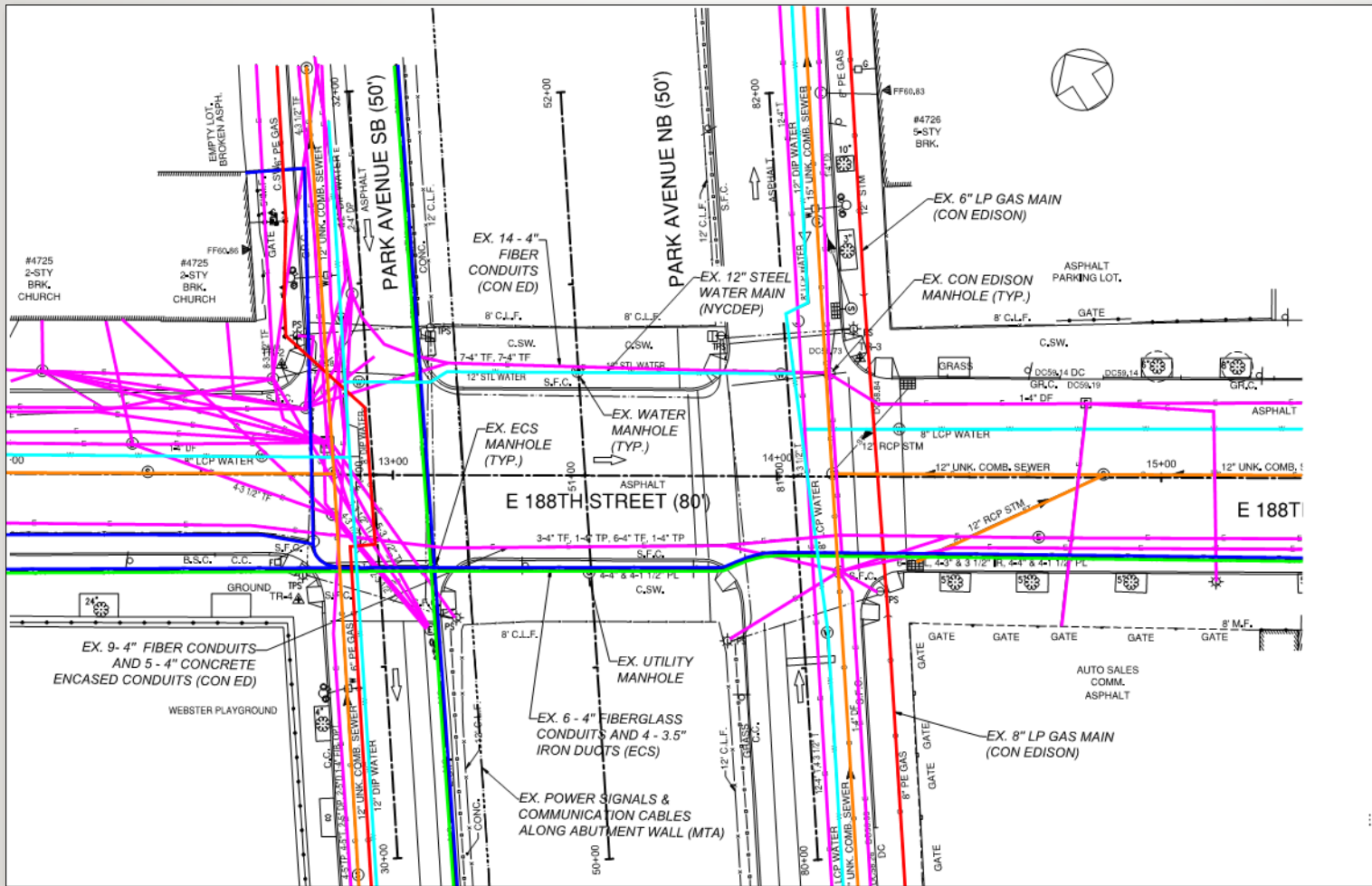

LEGEND:

- WATER
- ELECTRIC
- SEWER
- GAS
- TELEPHONE
- CABLE
- FIRE

3. PROPOSED BRIDGE

PROPOSED WORK – BRIDGE REPLACEMENT

Construct new abutments behind the existing and replace the superstructure.

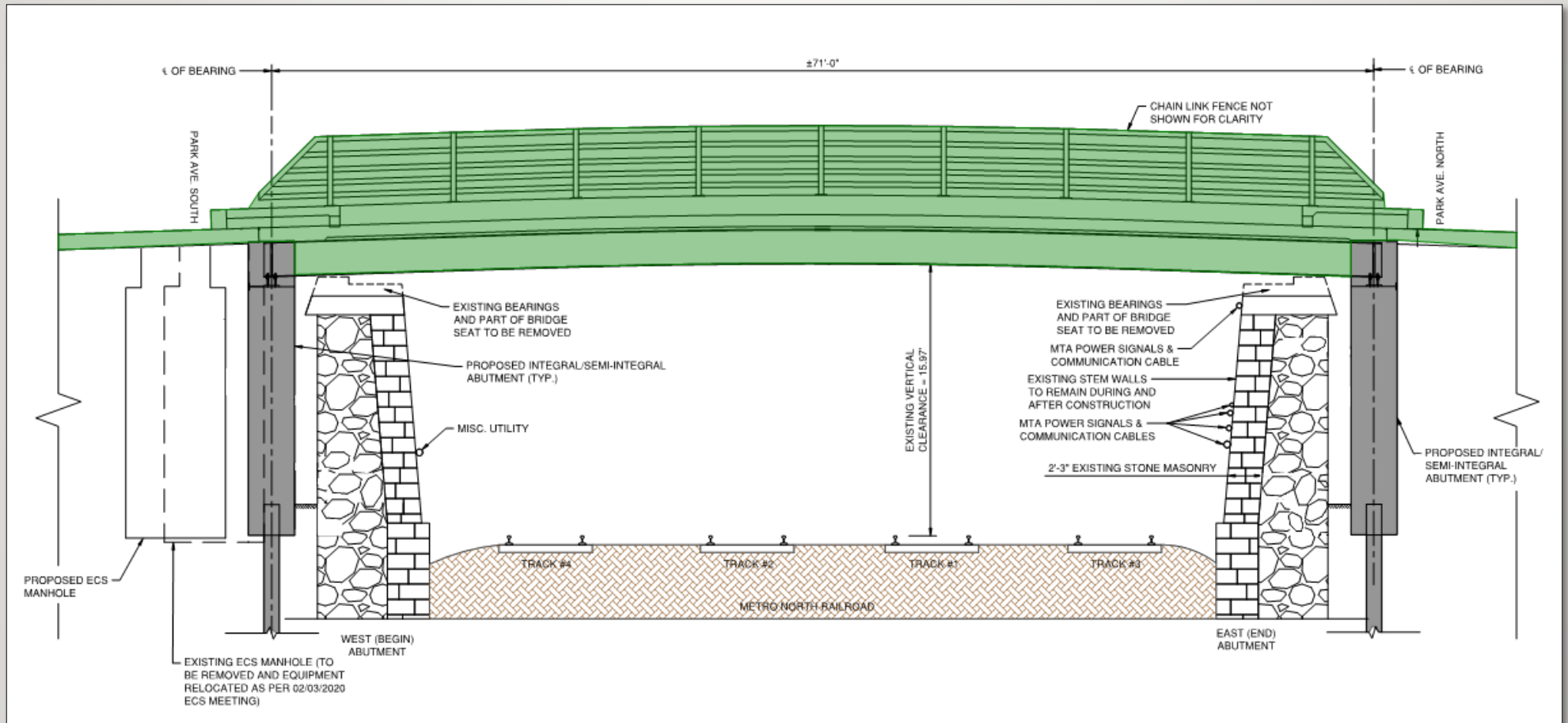

BRIDGE REPLACEMENT ADVANTAGES

Reduced amount of Night Work

Reduced Construction Duration

75-year design life

BUDGET & SCHEDULE

Construction Cost

Approximately \$23M*

Construction Start

Late 2022

Construction
Duration

24 to 30 Months*

*Numbers are based on Engineer's Estimate

TYPICAL CONSTRUCTION STAGING

Stage 1 – Replace North side

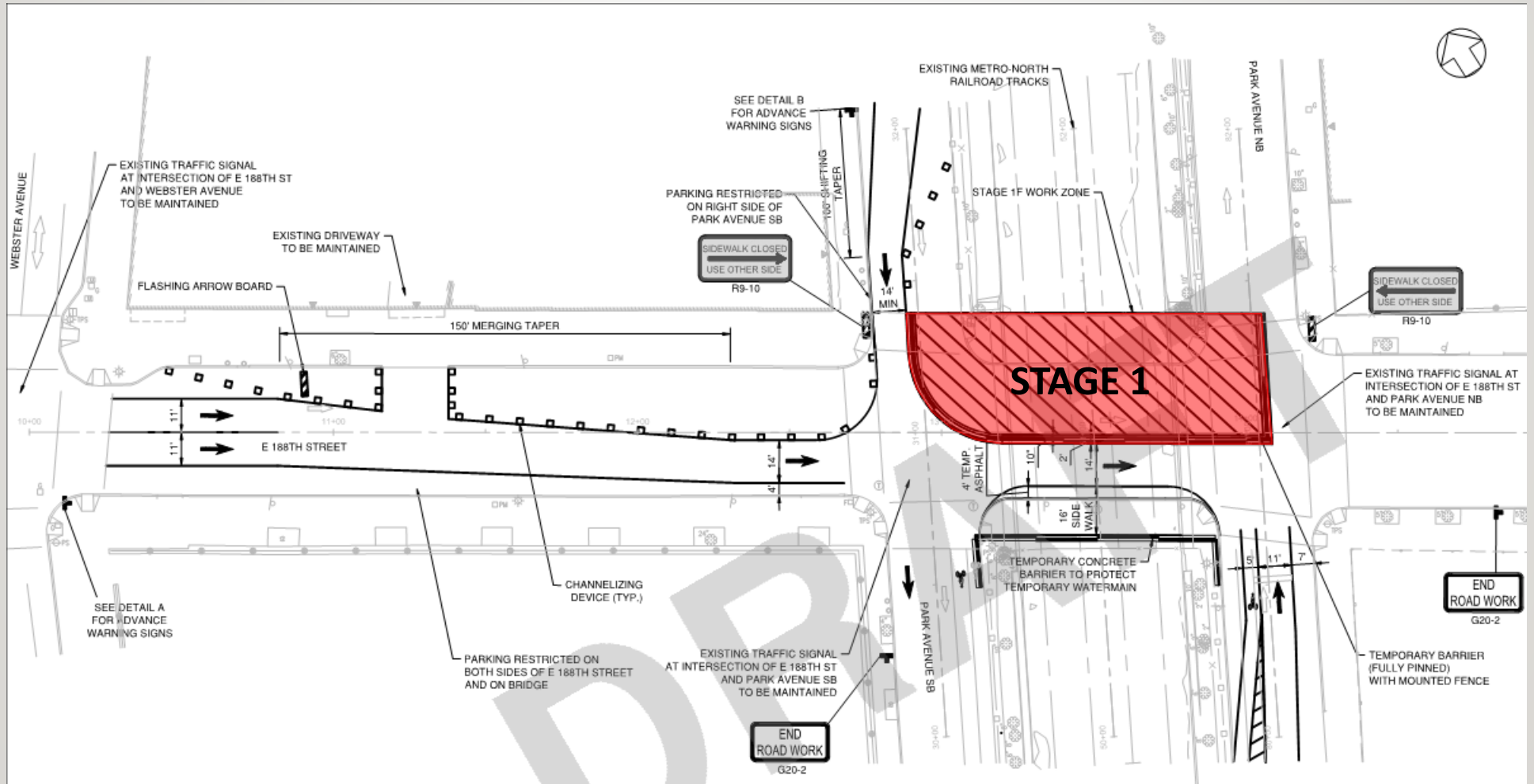

TYPICAL CONSTRUCTION STAGING – STAGE 1

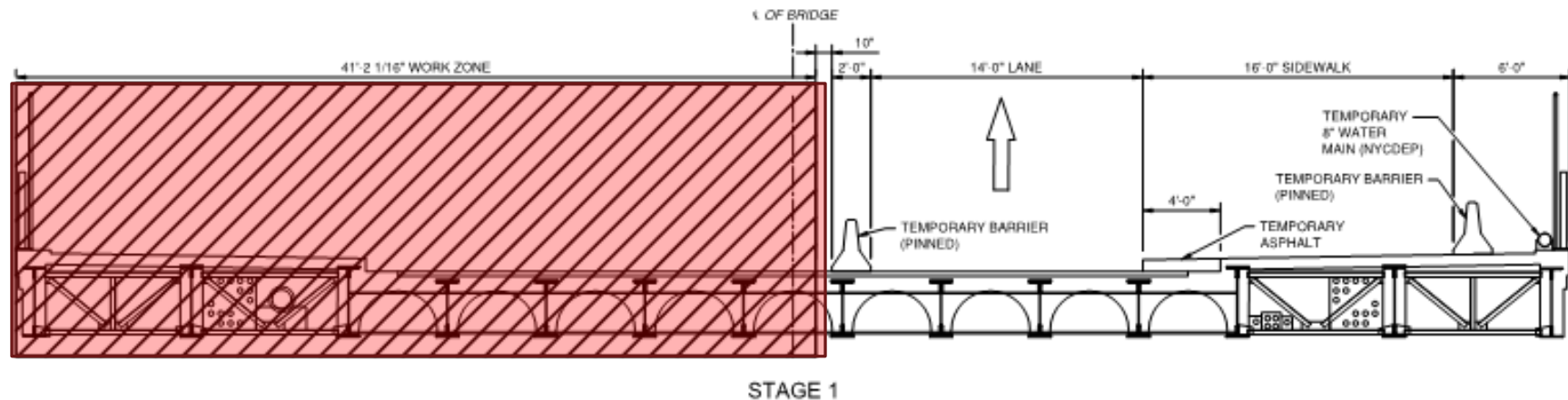
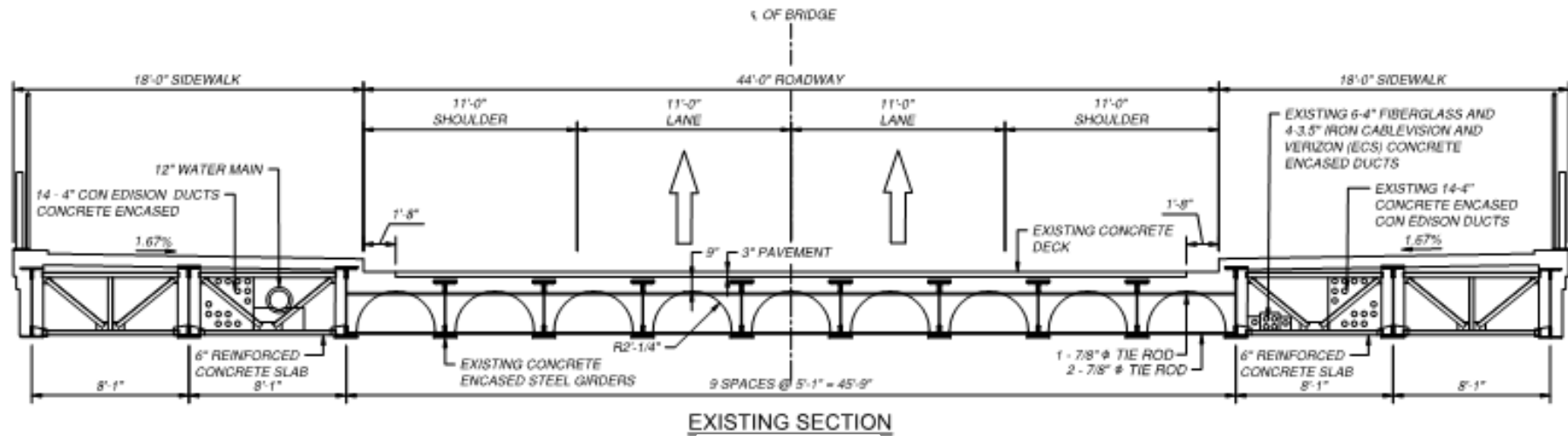

TYPICAL CONSTRUCTION STAGING

Stage 2 – Replace South side

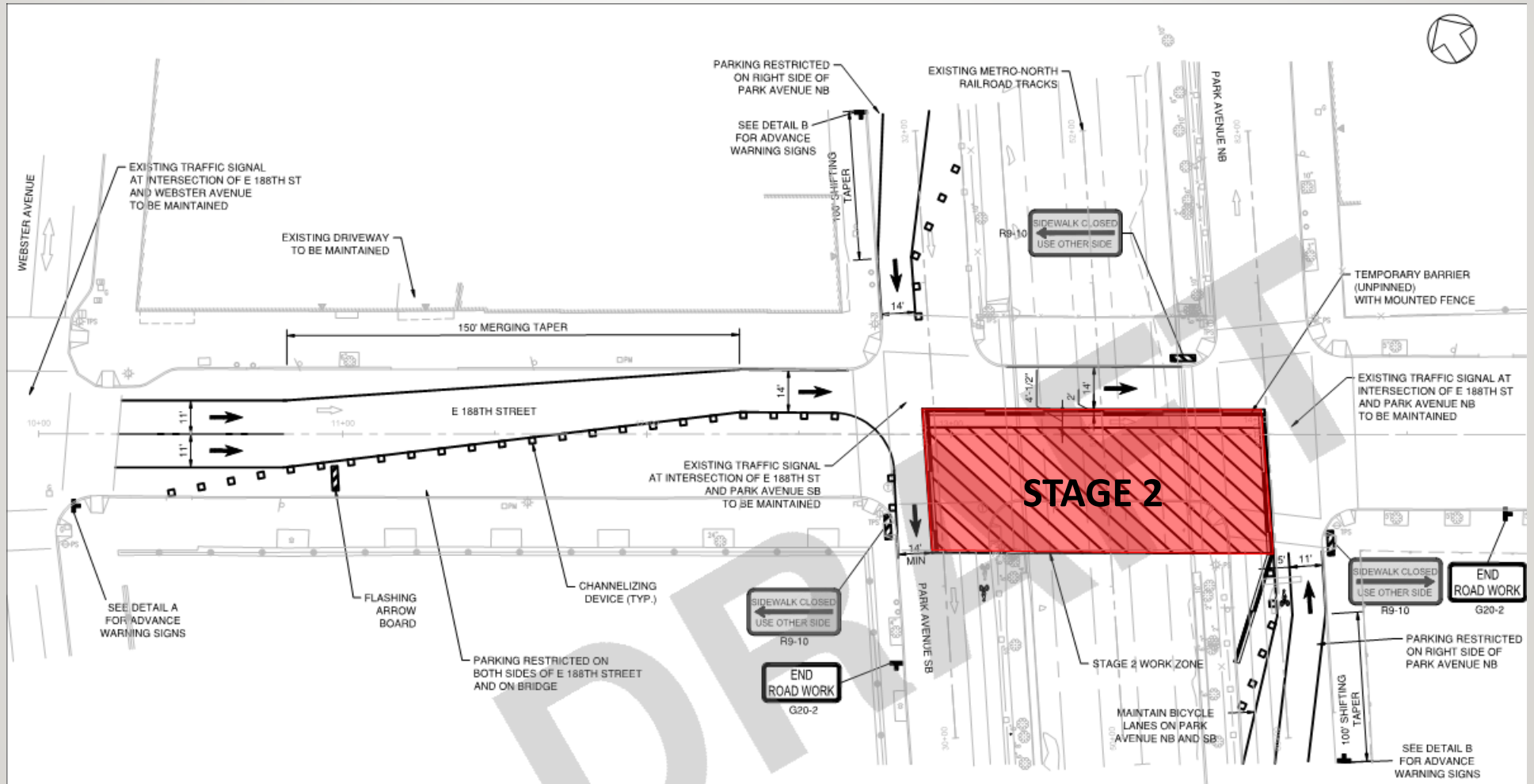

TYPICAL CONSTRUCTION STAGING – STAGE 2

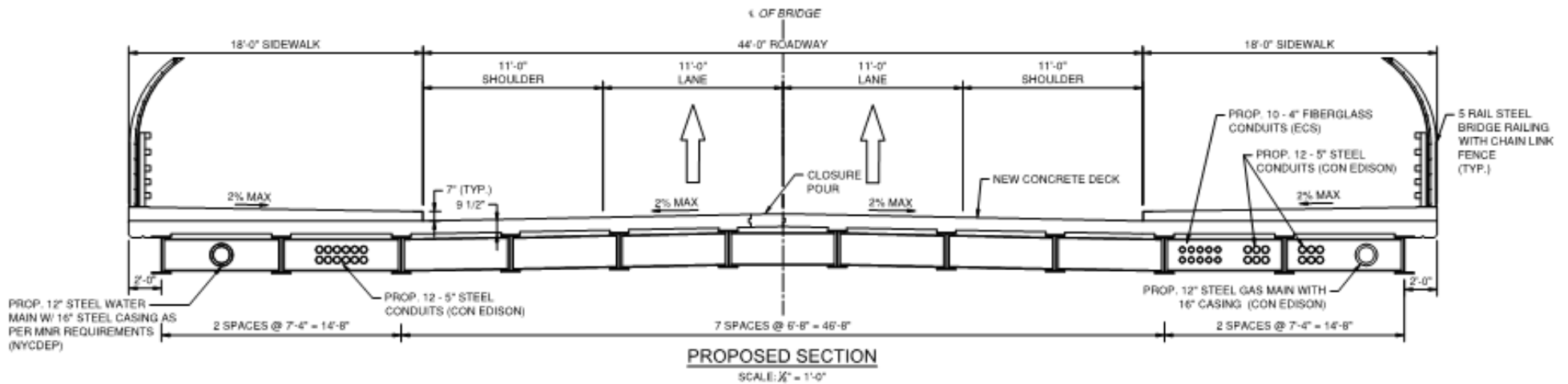
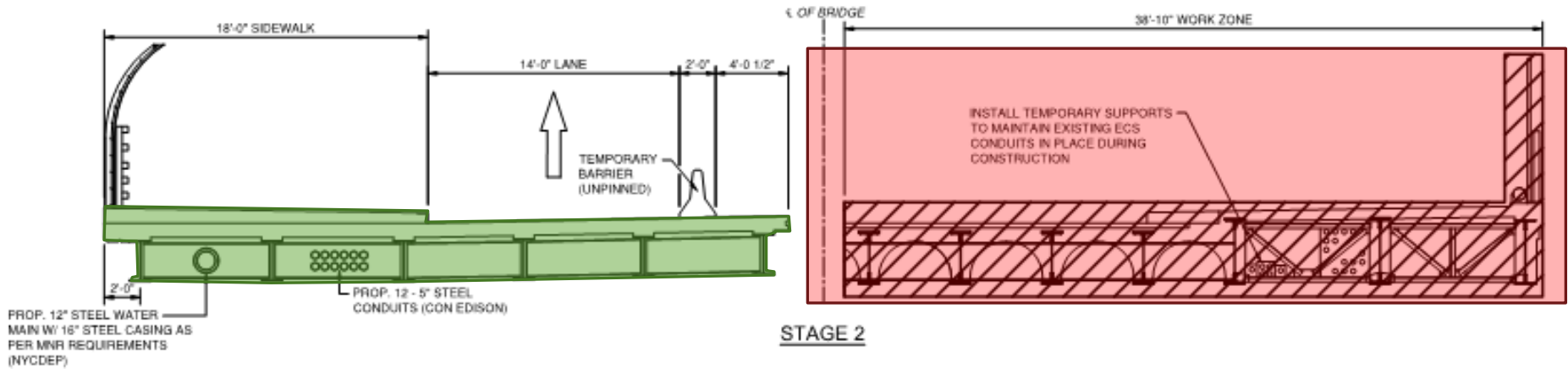

4. COMMUNITY OUTREACH & STAKEHOLDER COORDINATION

COMMUNITY COORDINATION

Parking within the project limits may be temporarily impacted to accommodate construction.

Night work may be necessary for removal/replacement of existing structure due to MNR requirements. Night work will be minimized to the greatest extent possible.

Traffic Enforcement Agents will be requested to assist with project related traffic as deemed necessary.

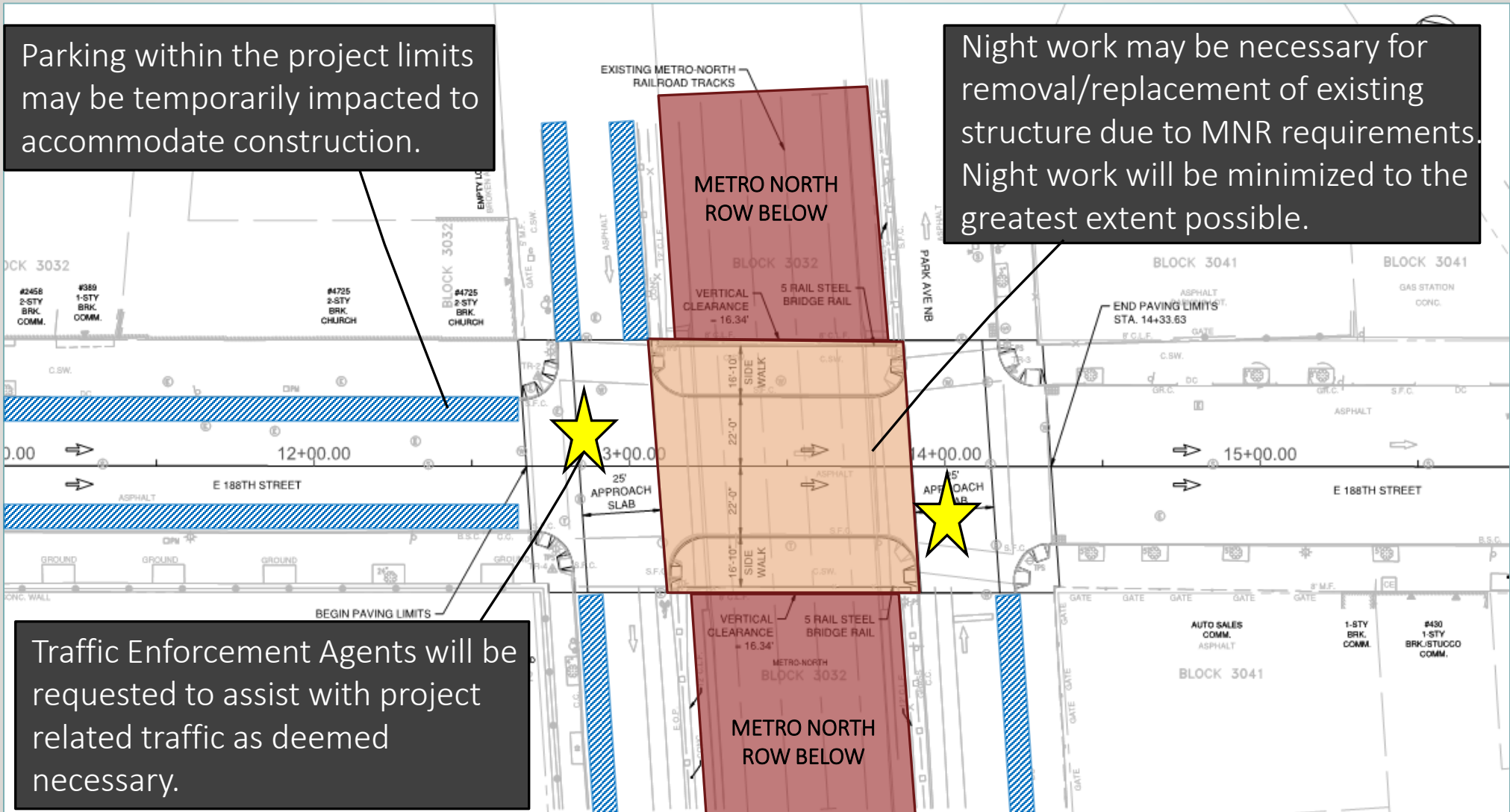

OUTREACH DURING CONSTRUCTION

A community liaison will be assigned to coordinate with:

- Community Board 6
- Elected Officials
- Local Businesses in the area
- NYPD
- MTA Metro-North Railroad
- Utilities; Verizon, NYCDEP (Water), Con Ed, FDNY, Cablevision etc.
- Public Information Meetings
- Contact Database
- Newsletters

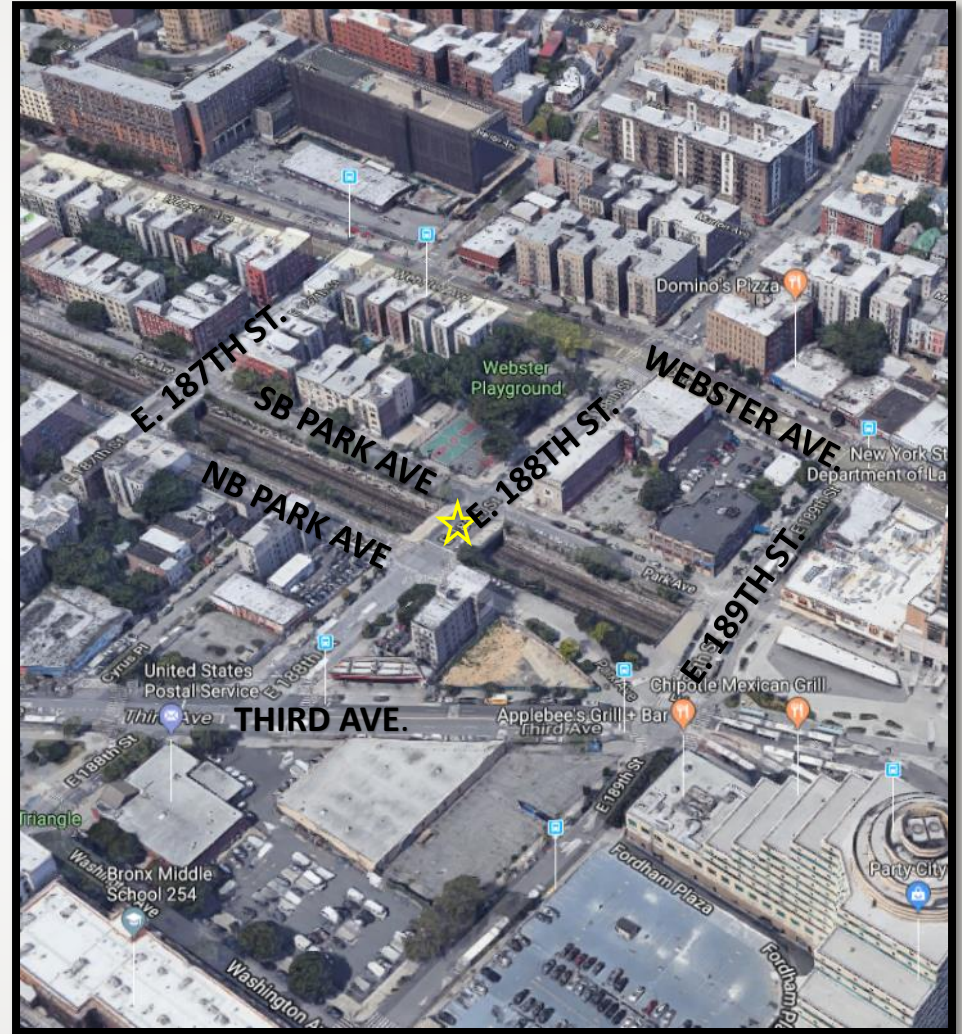

THANK YOU!

