

REHABILITATION OF EAST 183RD STREET BRIDGE
OVER METRO NORTH RAILROAD HARLEM LINE
BOROUGH OF THE BRONX, NY

Community Board BX6
January 21st, 2021

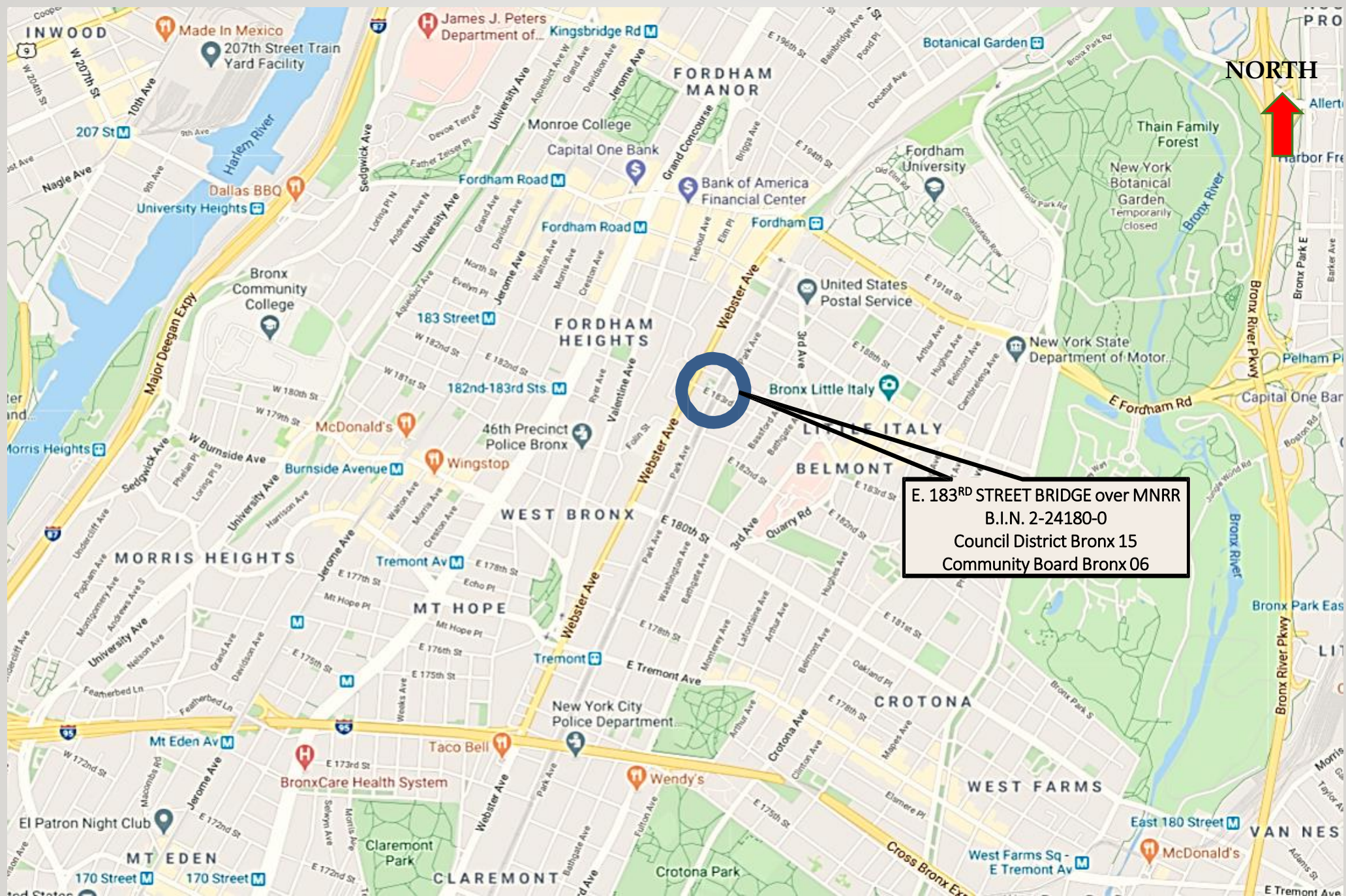

GENERAL LOCATION

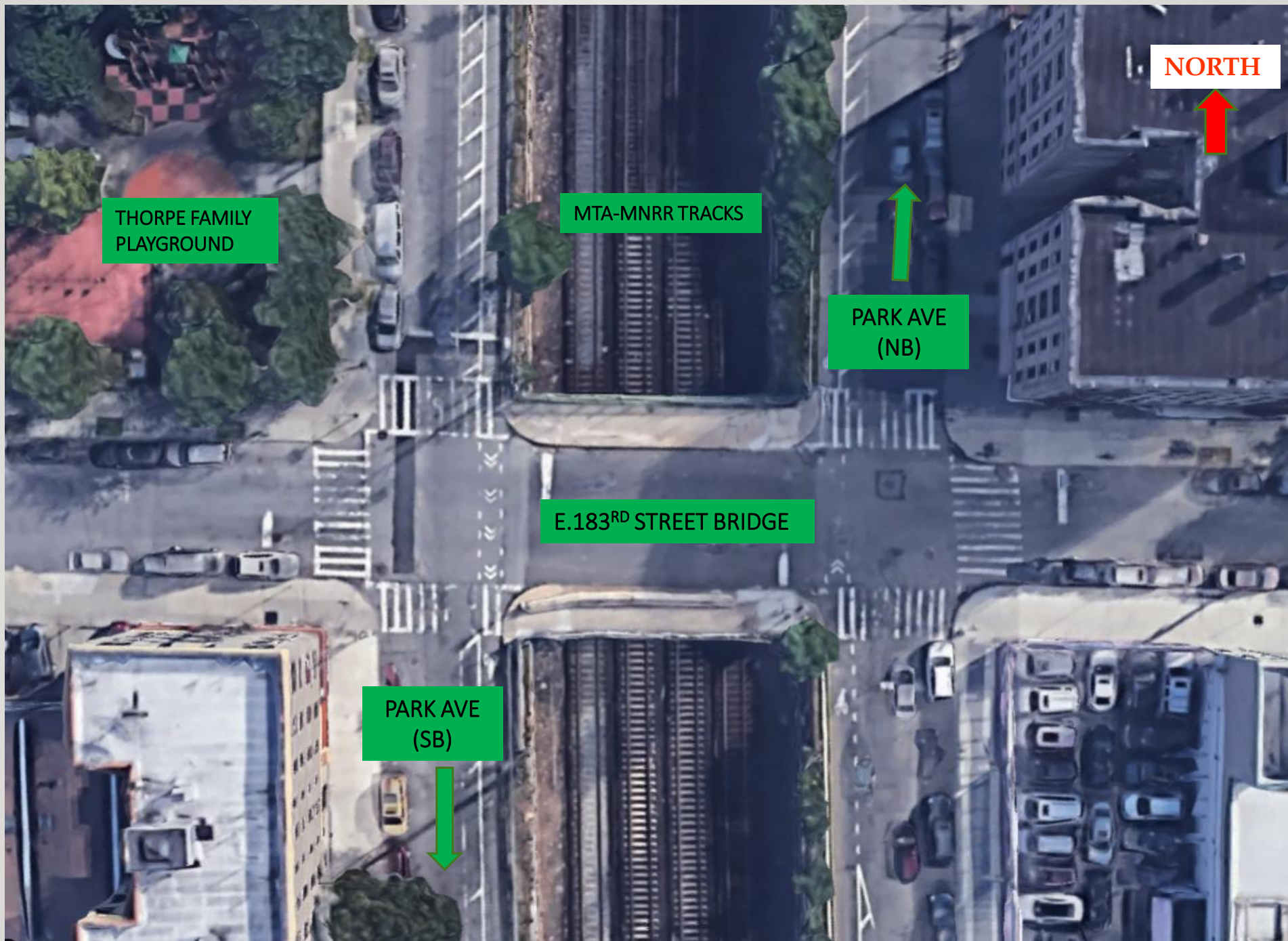

LOCATION MAP

Bridge Information

- Original bridge built in 1896. Bridge was again reconstructed in 1936.
- Bridge is 64 feet long and supported on original (1896) granite stone block retaining walls.
- Bridge spans over MNRR – Harlem Line (4 active tracks - 15.49 feet vertical clearance).
- Bridge has two vehicular traffic lanes and two sidewalks.



PROJECT MAXIMUM LIMITS
+/- 200 FEET BEYOND ABUTMENTS
+/- 50 FEET BEYOND EITHER FASCIA



Need for the Project

Structural Issues with the Existing Bridge

- Extensive deterioration of deck with cracking and spalls.
- Deteriorated bridge concrete frequently drop on MNRR traffic (safety issue).
- Corrosion in the visible bottom portion of steel girders.
- Presence of poor pavement surface, sidewalk spalls, and potholes.
- Missing railing at south sidewalk and non-standard pedestrian fence.
- Presence of lead paint on bridge and existing railings

Improved Conditions with Proposed Bridge

- New sidewalks with ADA ramps.
- Increased safety standards with standard pedestrian fence, railing, crosswalk signs.
- Increased truck carrying and seismic load capacity.
- Improved lighting and less maintenance.
- New bridge with 75 years service life.
- Improved safety for MNRR train traffic (no debris falling).

Photographs of Existing Bridge



DETERIORATED CONCRETE BELOW DECK
(DEBRIS FALL ON MNRR TRAINS)



CORROSION AT GIRDER
(VISIBLE BOTTOM FLANGE)

Photographs of Existing Bridge



NO TRAFFIC RAILING AT SOUTH SIDEWALK



DETERIORATED PAVEMENT
SPALLED SIDEWALKS

Photographs of Existing Bridge



DETERIORATED BEARINGS



ABUTMENT STONE JOINTS IN POOR CONDITION

Project Details

Reconstructed Bridge Features:

- New steel railing, fence, and sidewalk
- New concrete deck and steel girders
- New bridge placed on new micro piles

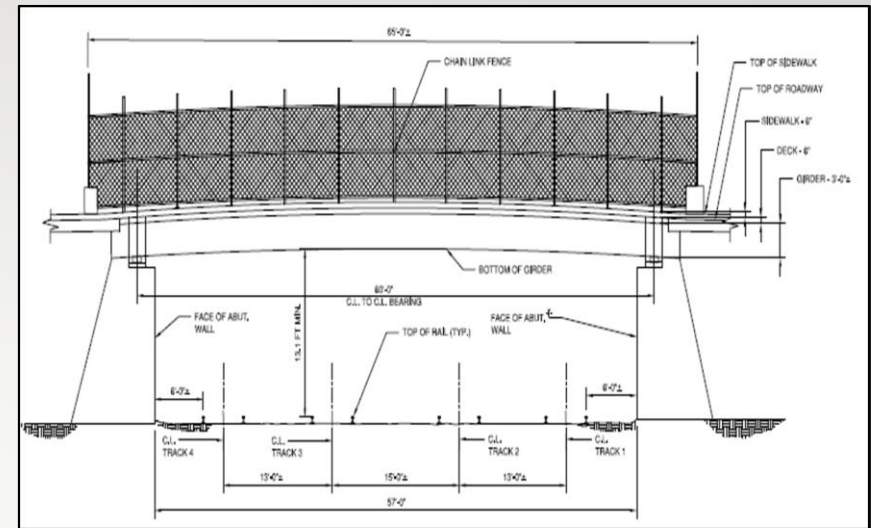

Existing Bridge Elevation

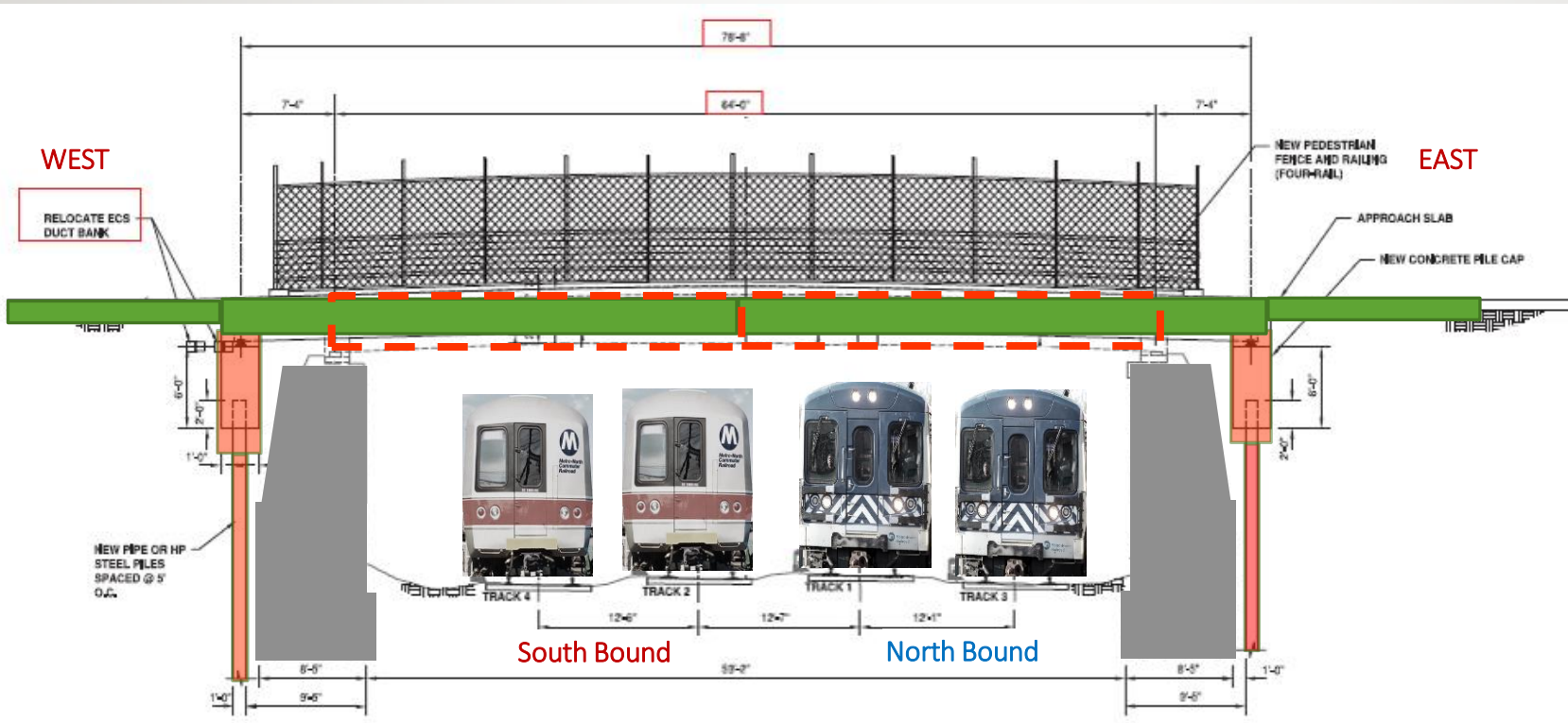

Proposed Bridge Elevation

LEGEND:

- NEW GIRDERS / DECK
- NEW PILES
- EXISTING WALL (TO REMAIN)
- EXISTING GIRDERS (DEMOLISH)

Project Construction Staging

Key Stages

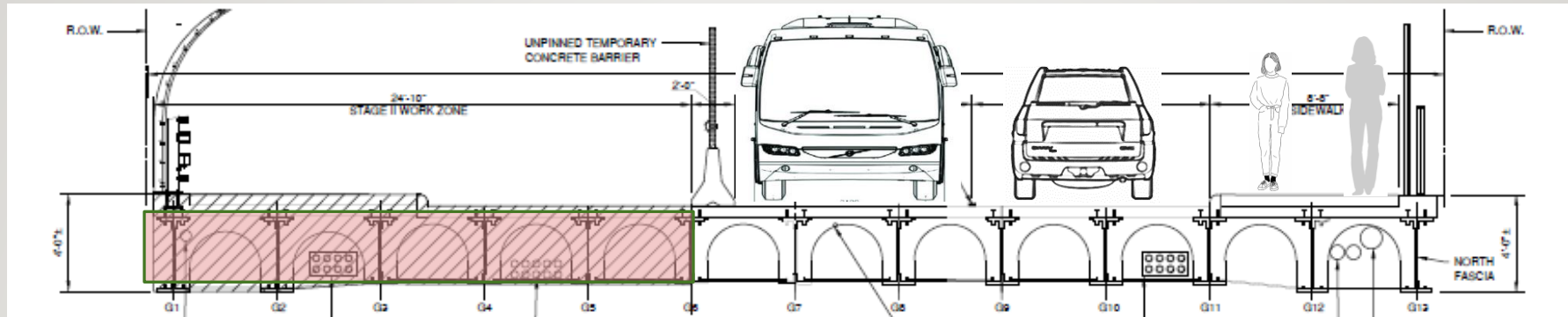

STAGE 1 (approx. 7 Months)

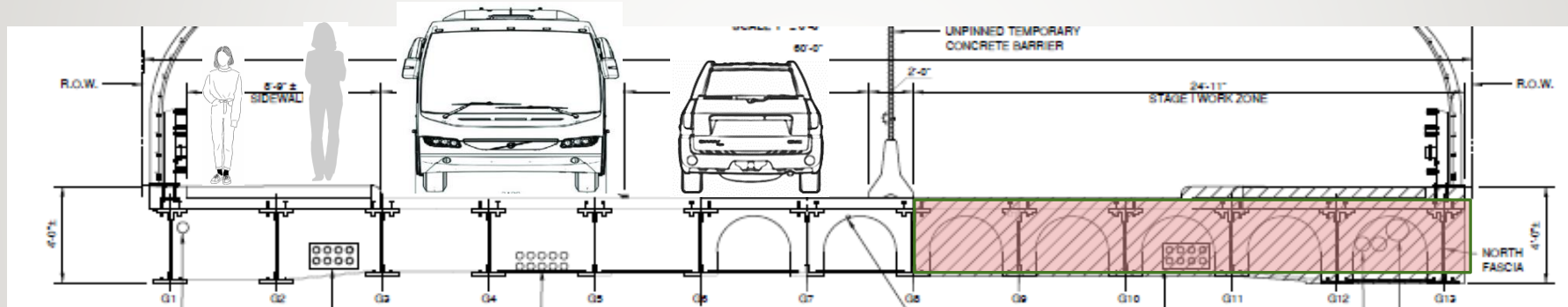

STAGE 2 (approx. 7 Months)

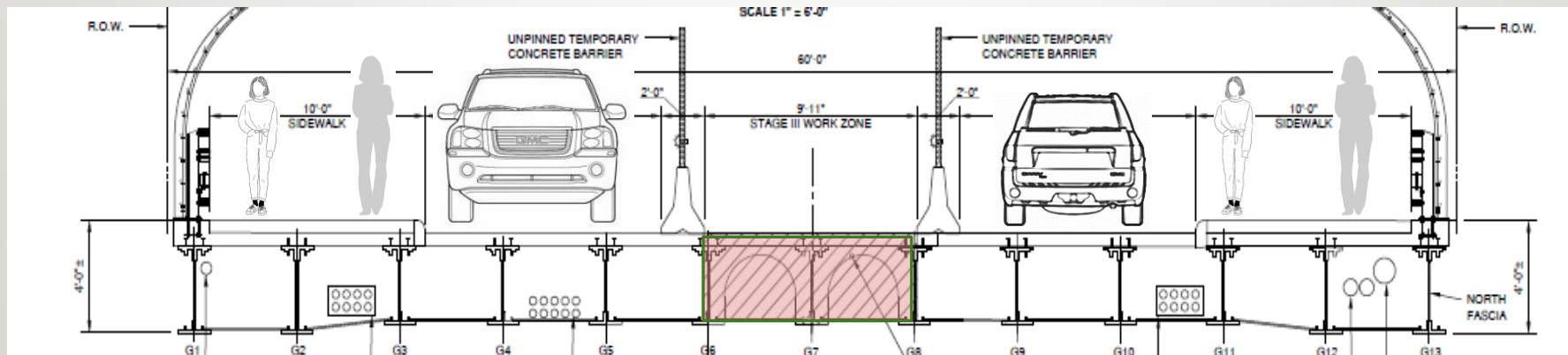

STAGE 3 (approx. 4 Months)

For Discussion Only



Indicates Construction Zone

Project Construction Staging

STAGE 1

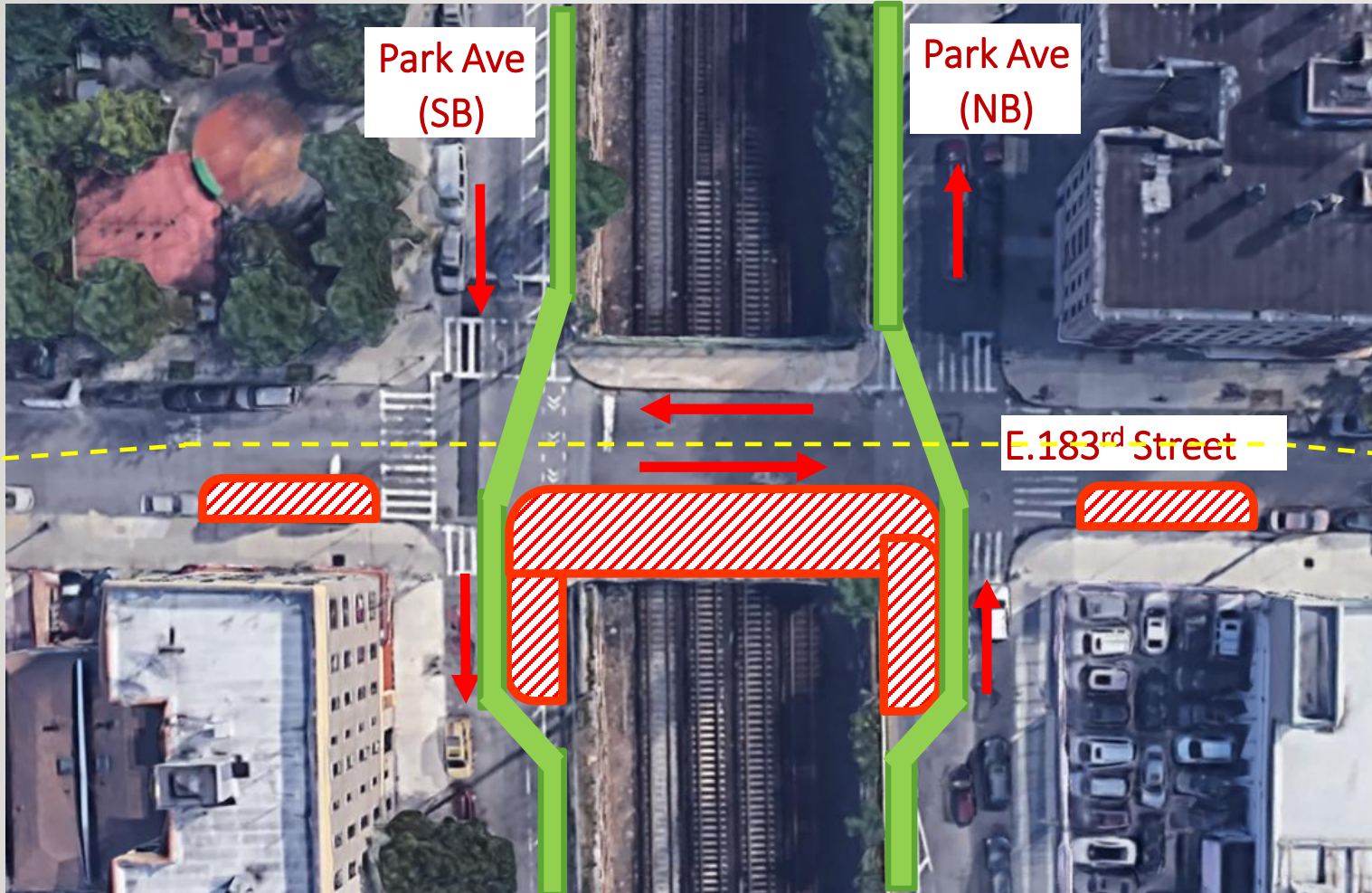

LEGEND

-  BIKE LANE
-  CONSTRUCTION ZONE
-  TRAFFIC DIRECTION

- Maintain 2 traffic lanes (EB & WB) of 11' width on 183rd Street.
- Maintain one way traffic lane on Park Avenue (NB & SB).
- Maintain one sidewalk.
- Maintain bike lane on Park Avenue (NB & SB).

Project Construction Staging

STAGE 2

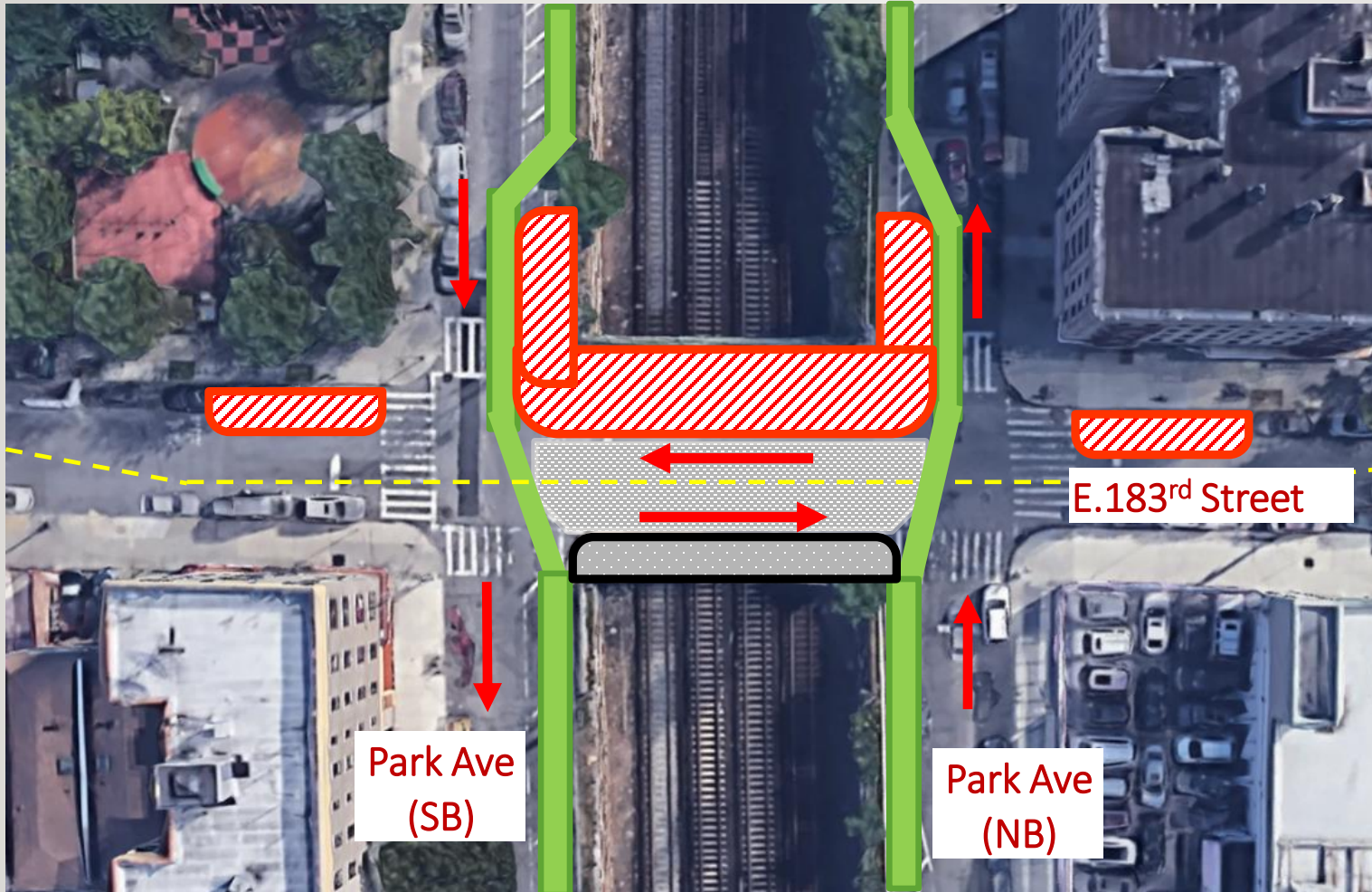

LEGEND

-  BIKE LANE
-  CONSTRUCTION ZONE
-  TRAFFIC DIRECTION
-  RECONSTRUCTED BRIDGE

- Maintain 2 traffic lanes (EB & WB) of 11' width on 183rd Street.
- Maintain one way traffic lane on Park Avenue (NB & SB).
- Maintain one sidewalk.
- Maintain bike lane on Park Avenue (NB & SB).

Project Construction Staging

STAGE 3

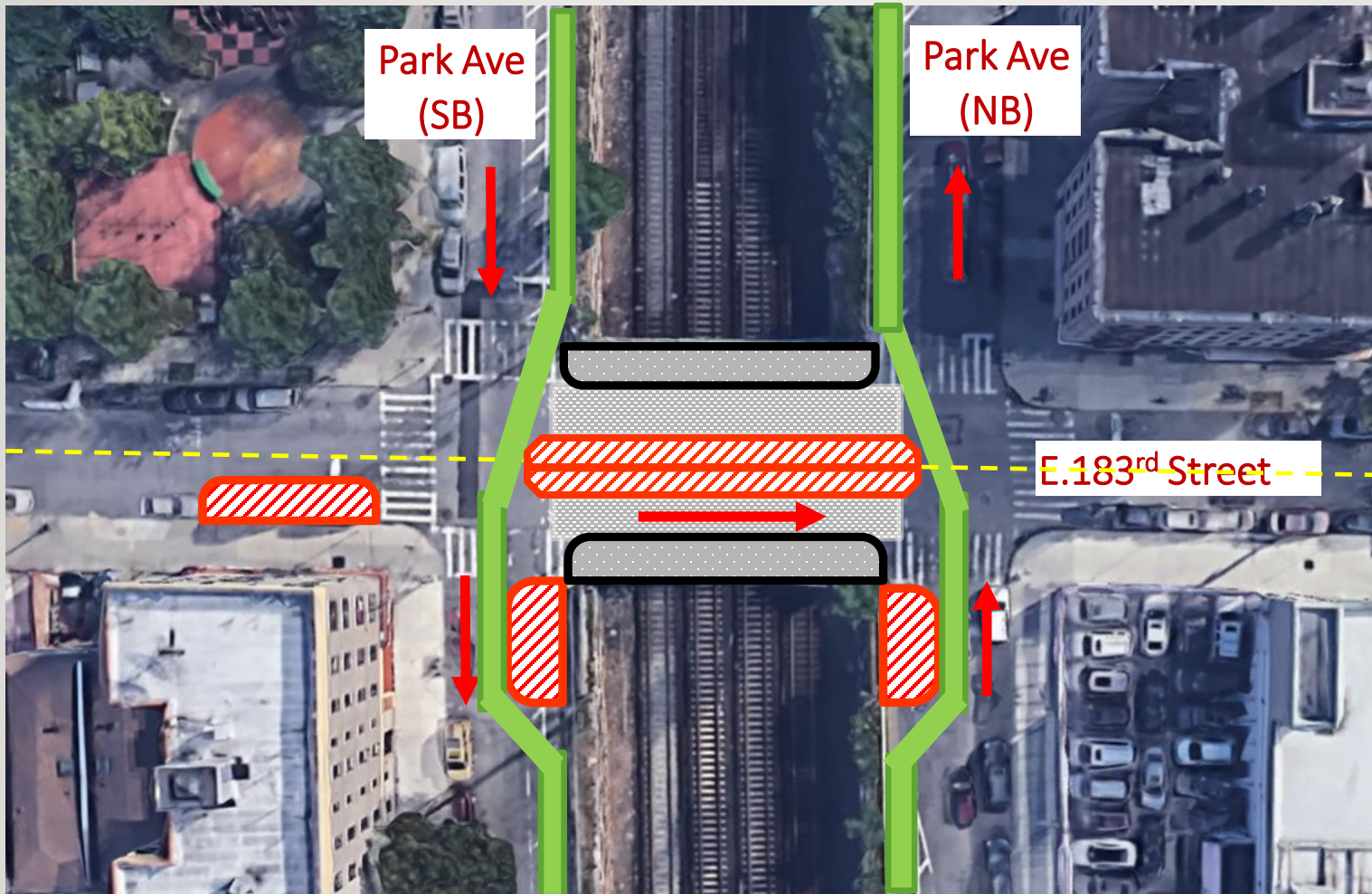

LEGEND

- BIKE LANE
- CONSTRUCTION ZONE
- TRAFFIC DIRECTION
- RECONSTRUCTED BRIDGE

- Maintain 2 traffic lanes (EB & WB) of 11' width on 183rd Street.
- Maintain one way traffic lane on Park Avenue (NB & SB).
- Maintain two sidewalk.
- Maintain bike lane on Park Avenue (NB & SB).

Project Construction Staging

Safety and Traffic Control Measures

- Provide fence and screen around construction staging perimeter to control dust, sound, and increase safety.
- Request to provide traffic agents during the rush hour to guide traffic movements.
- Provide signal optimization at adjacent intersections to relieve congestion.
- Provide adequate signs and temporary pavement markings specific to each stage.
- Suspend parking temporarily on Park Avenue (NB & SB) adjacent to bridge staging. Total ten (approx.) parking spots temporarily affected.



Budget and Schedule

Budget

Estimated Construction Cost - \$20 M

Schedule

Total Construction Duration - 18 Months (Tentatively, Spring, 2022 to Summer, 2023)

- Stage 1 (Approx. 7 Months)
- Stage 2 (Approx. 7 Months)
- Stage 3 (Approx. 3 Months)
- Stage 4 (Approx. 1 Month)

Community Outreach

Planned Outreach and Coordination

Stakeholders

- Bronx Community Board 6
- Elected Officials
- Civic + Community Groups
- Local Businesses in the area
- Metro North Rail Road (MNRR)
- NYC Department of Parks & Recreation (NYCDPR)

Coordinating Agencies

- Metro North Rail Road (MNRR)
- NYCDEP
- NYC Department of Sanitation (DSNY)
- NYPD, FDNY, FDNY Emergency Medical Services
- Utilities: Verizon (Telephone), Con Edison (Gas/Electric)

Outreach Strategy

- Community Outreach Notification Letter
- Stakeholder Meetings
- Social Media Notifications
- On-Site Information





THANK YOU!



NYCDOT



nyc_dot



nyc_dot



NYCDOT