

CROPSEY AVENUE

26th Ave to Bay 50th St
Brooklyn CB 13 May 22, 2019



PROJECT LOCATION

- Project limits: 26th Ave to Bay 50th St
- Request from Brooklyn Borough President Adams for continuation of 2018 markings project and safety improvements from Bay Pkwy to 26th Ave
- Residential and commercial land use
- B82, B6, X28 and X38 bus routes

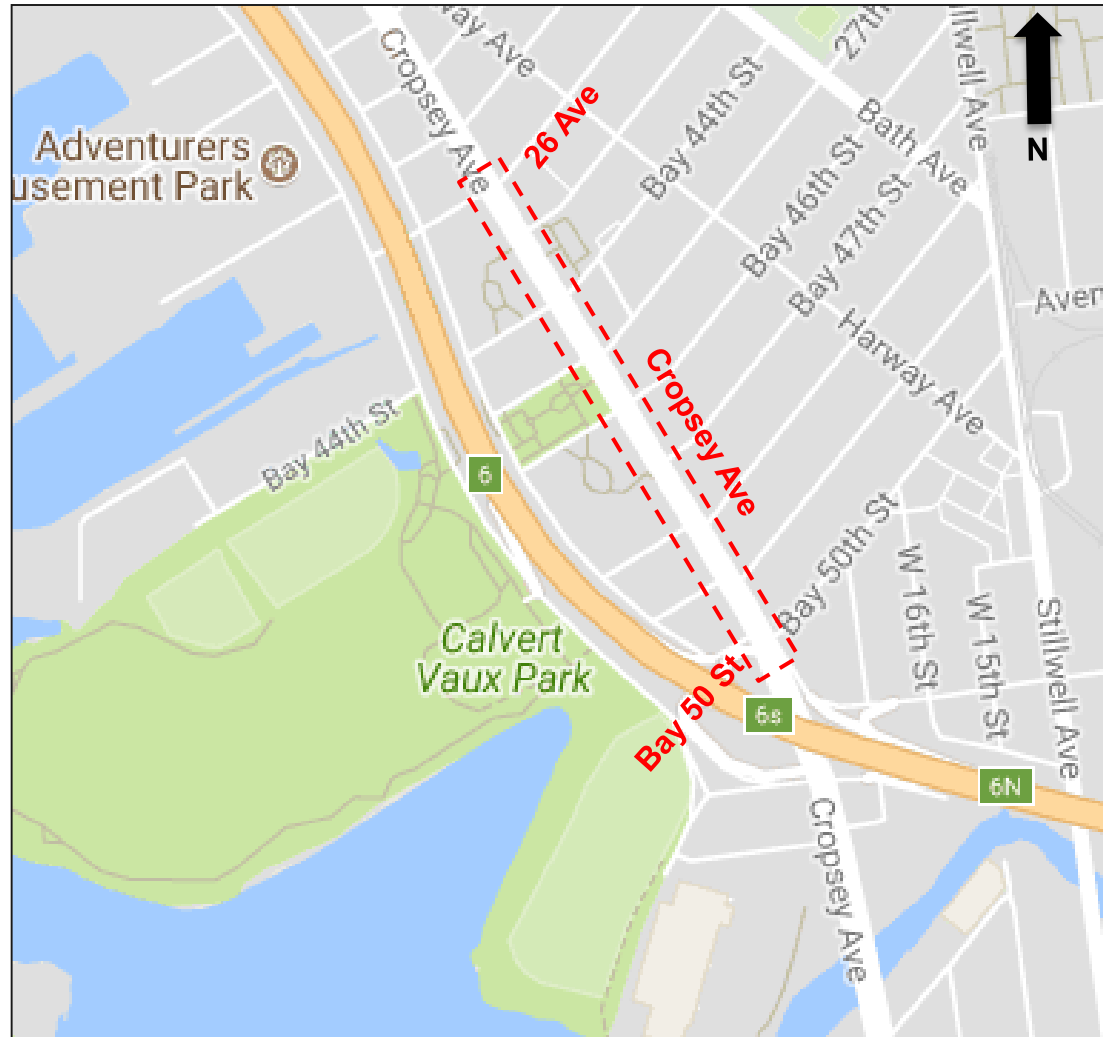

SAFETY DATA

- High crash corridor with 16.5 persons killed or seriously injured per mile
- 63% of pedestrian injuries were failure to yield crashes

Cropsey Ave - 26 Ave to Bay 50 St, BK

Injury Summary, 2013-2017 (5 Years)

	Total Injuries	Severe Injuries	Fatalities	KSI
Pedestrian	13	1	0	1
Bicyclist	6	0	0	0
Motor Vehicle Occupant	95	6	0	6
Total	114	7	0	7

Fatalities, 01/01/2013-4/8/2019 : None

Source: Fatalities: NYCDOT
Injuries: NYS DOT
KSI: Persons Killed or Severely Injured

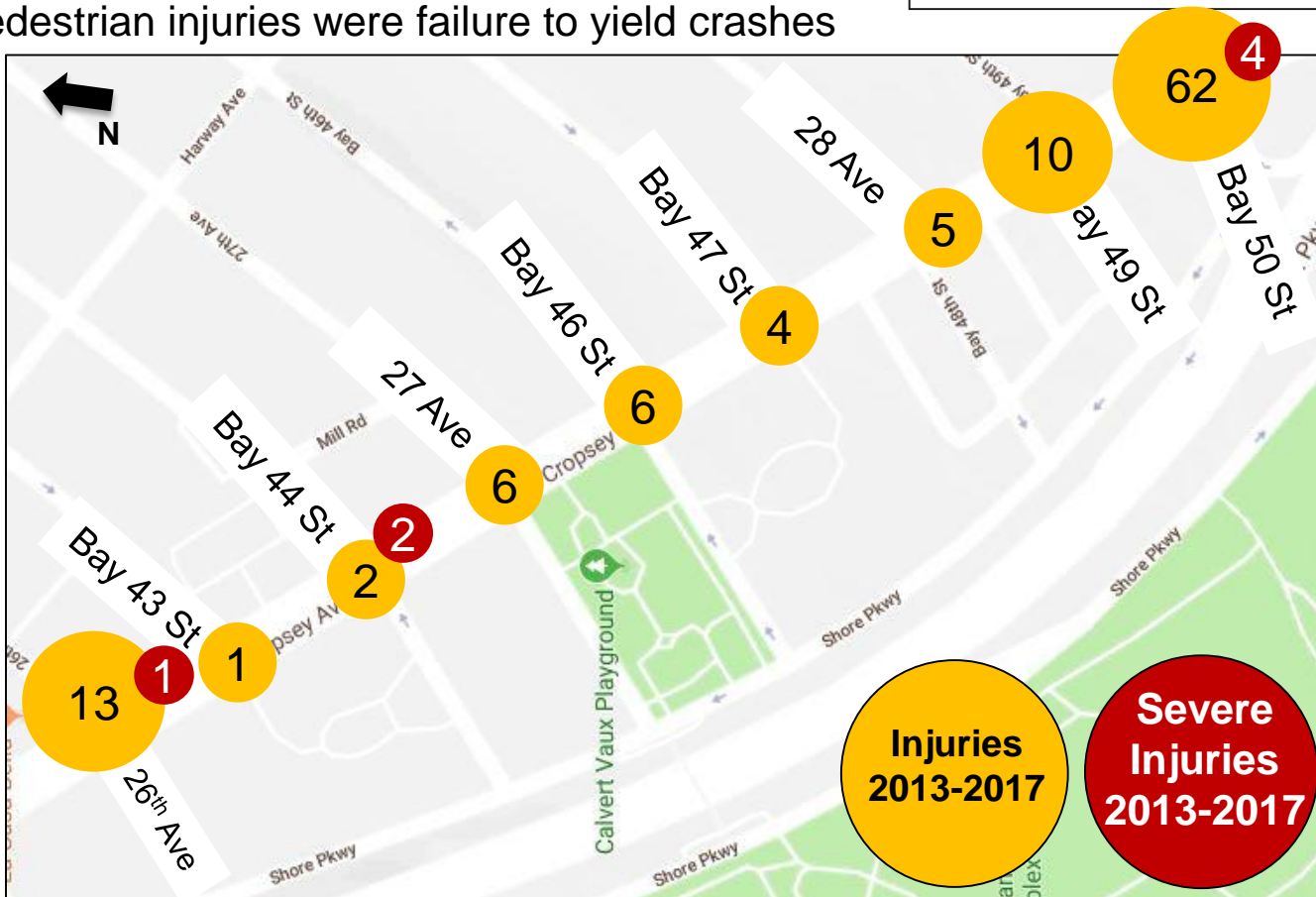

EXISTING CONDITIONS

Wide travel lanes encourage speeding, unpredictable vehicle movements

Cropsey Ave at Bay 44th St



EXISTING CONDITIONS



EXISTING CONDITIONS

Angled approach encourages fast, overlapping left turns

Cropsey Ave at 26th Ave



PROPOSAL

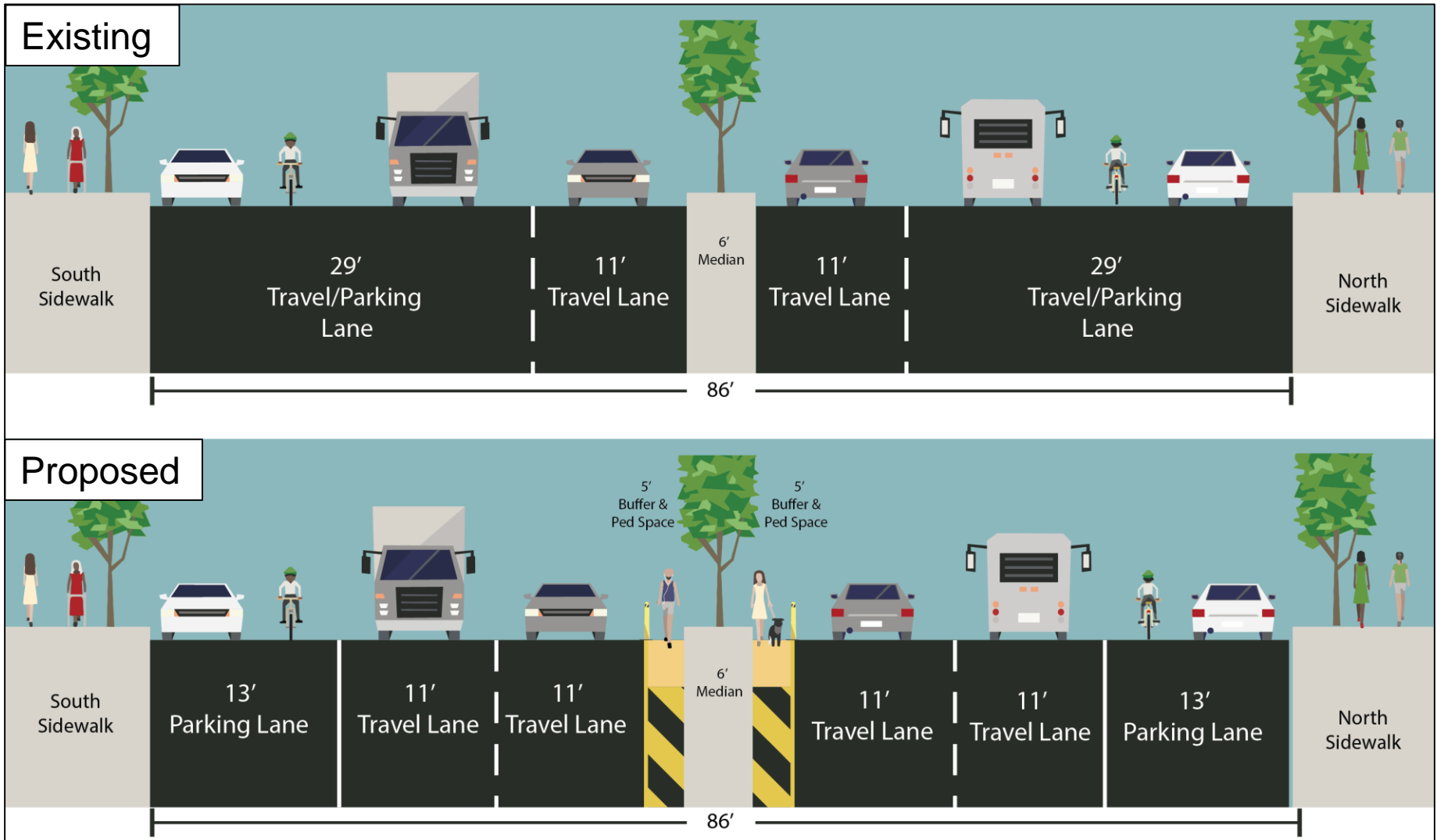

PROPOSAL

Example: 2018 improvements on Cropsey Ave from Bay Pkwy to 26th Ave

Cropsey Ave at 24th Ave



PROPOSAL

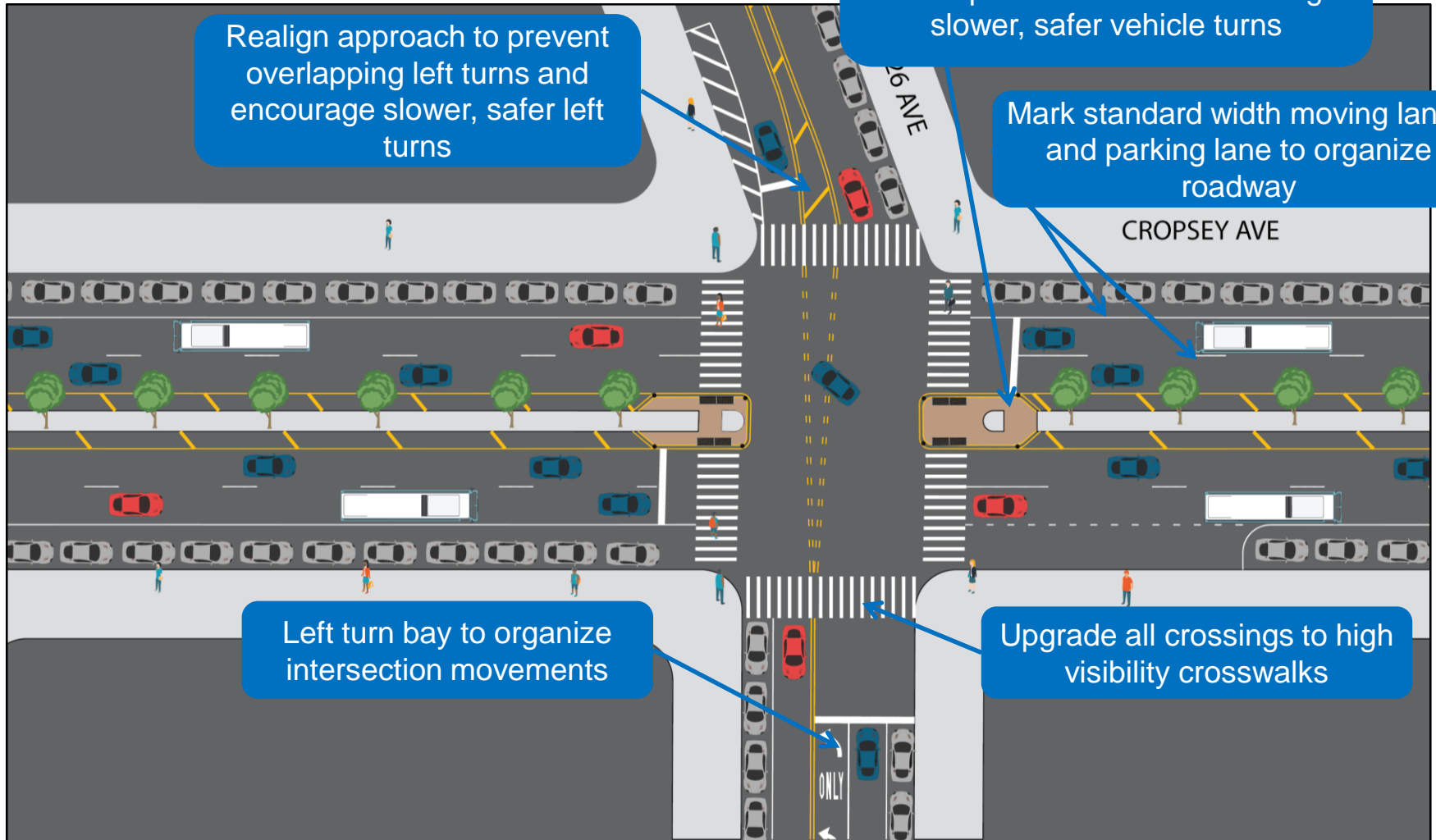

SUMMARY

- Expanded median tips shorten crossing distances and provide refuge for pedestrians
- Expanded median tips encourage slower, safer turns by vehicles
- New markings and left turn bay at 26th Ave discourages speeding and better organizes traffic at intersection
- Improved markings clarify roadway and discourage speeding on Cropsey Ave



THANK YOU!

Questions?



NYC DOT



NYC DOT



nyc_dot



NYC DOT