

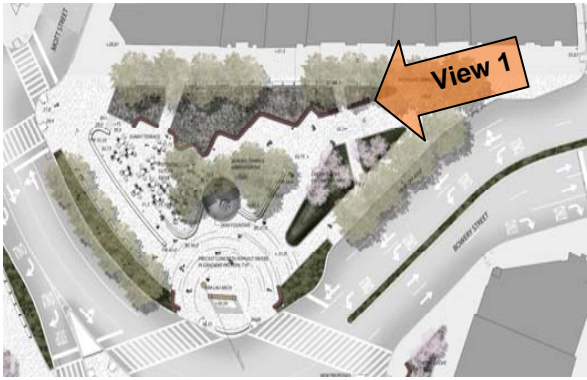



Section A at Chatham Square



**Stantec | Thomas Balsley Associates
DDC**

**Reconstruction of
Chatham Square & Park Row**

**Chatham Square
View 1: Existing Condition**



**Stantec | Thomas Balsley Associates
DDC**

**Reconstruction of
Chatham Square & Park Row**

**Chatham Square
Photomontage
View 1**







Stantec | Thomas Balsley Associates
DDC

Reconstruction of
Chatham Square & Park Row

Chatham Square
View 3: Existing Condition



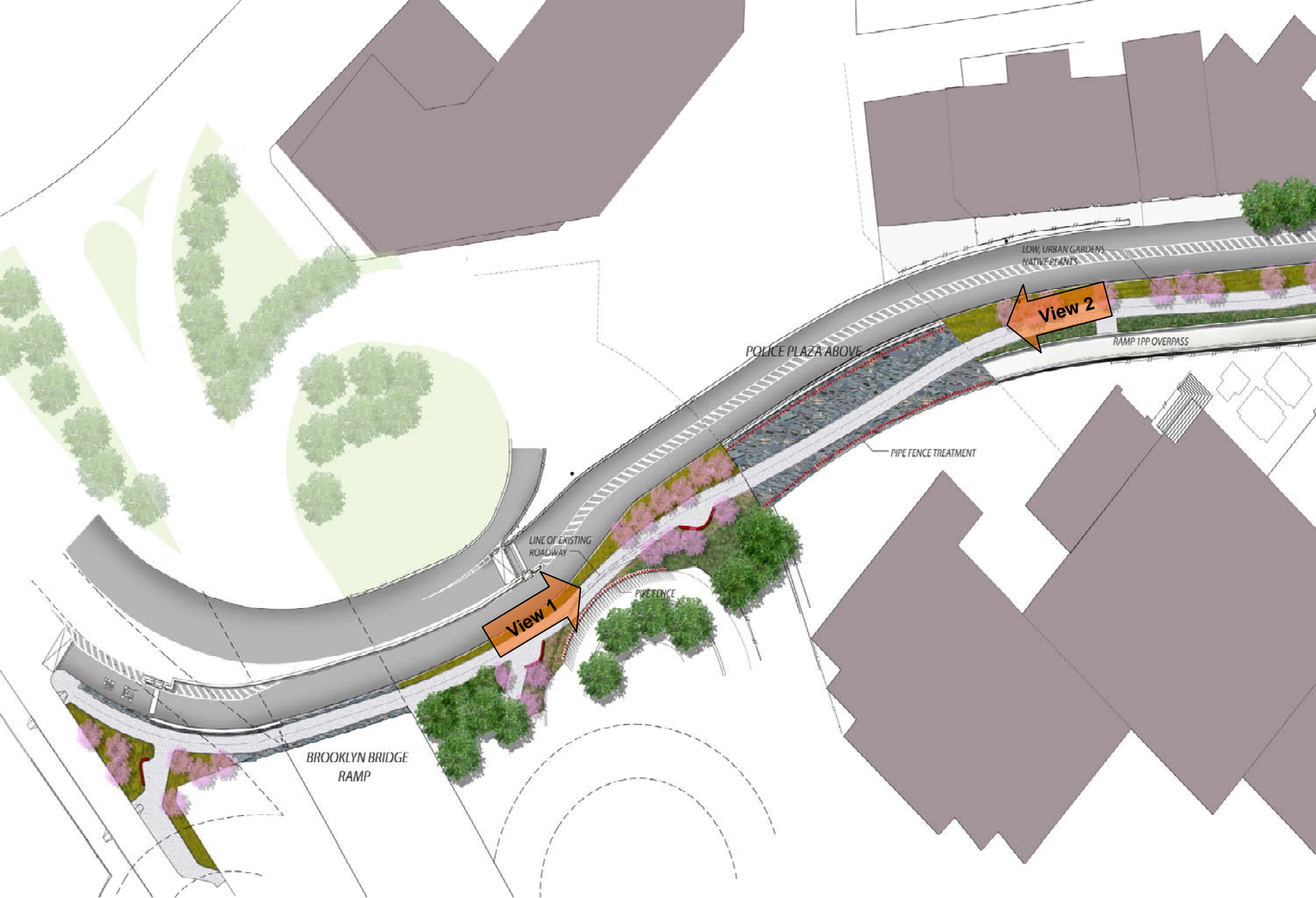



Rubble Treatment



Wall Treatment



View 1: Looking North Toward Police Plaza Overpass





View 2: Police Plaza Tunnel

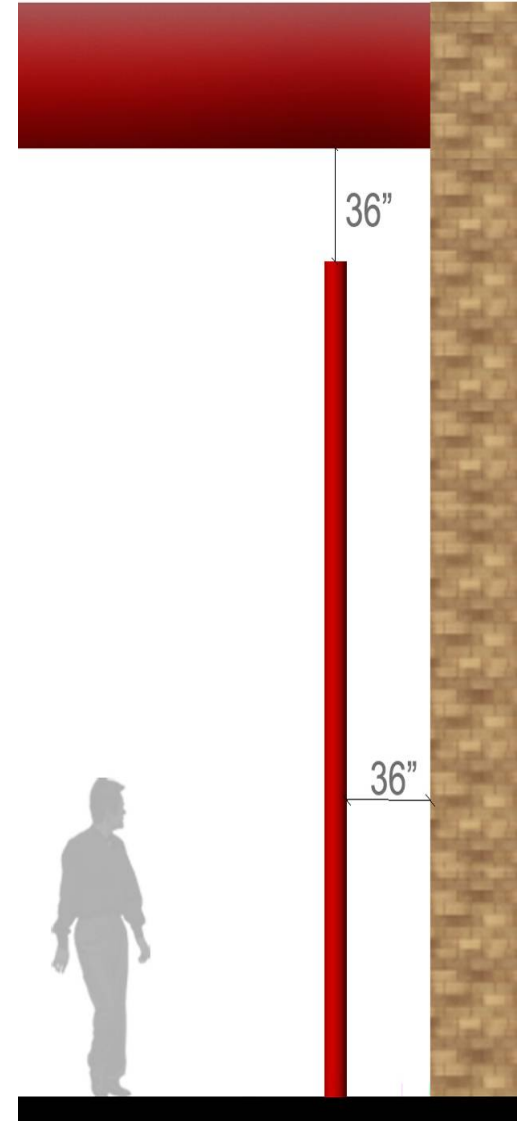

Section of Wall Treatment

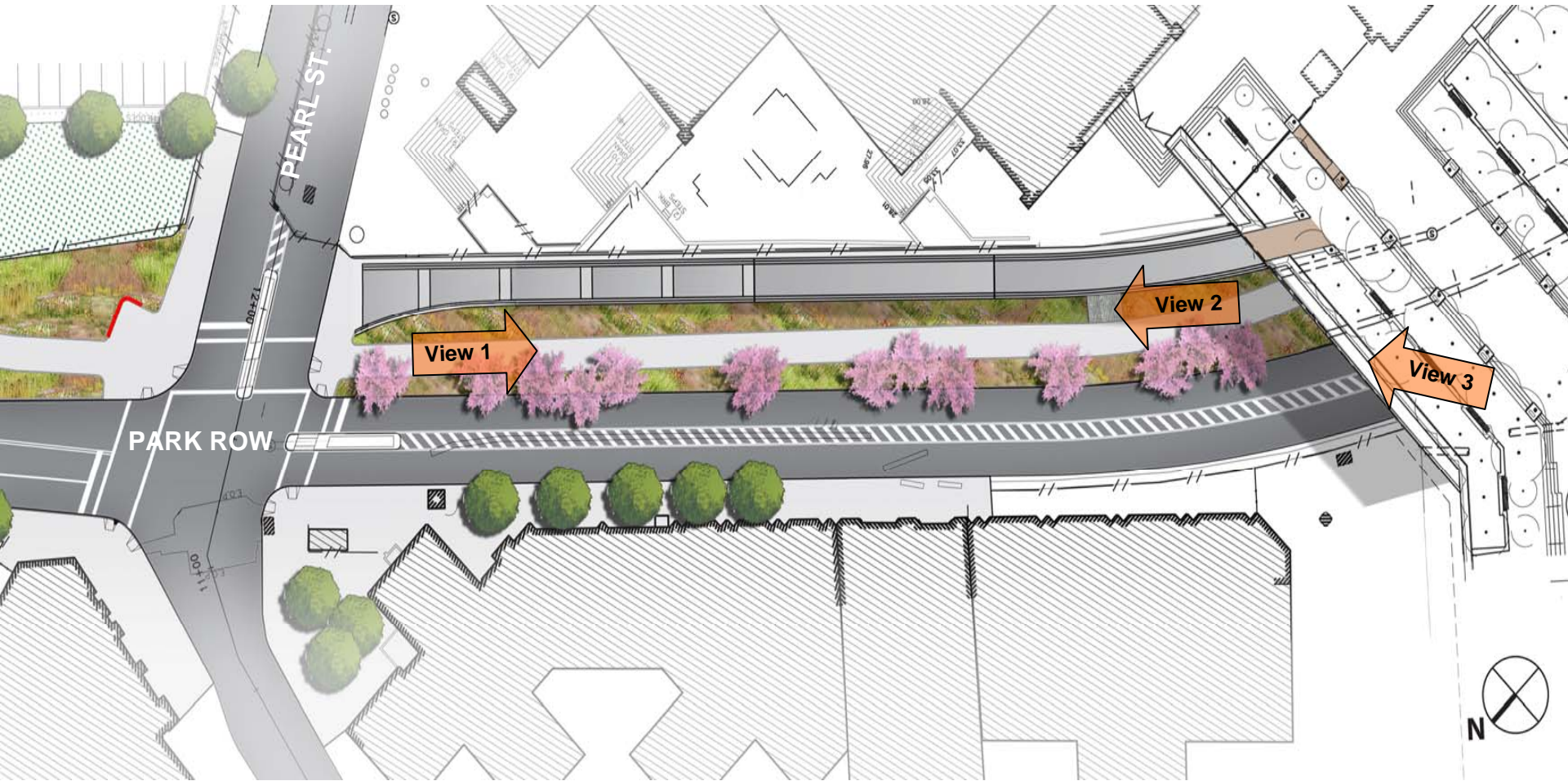



Stantec | TBA | WAI | CSA Group
DDC | DOT

Park Row
Pedestrian Ramp

Park Row Pedestrian Ramp
View 1





**Stantec | TBA | WAI | CSA Group
DDC | DOT**

**Park Row
Pedestrian Ramp**

**Park Row Pedestrian Ramp
View 3**

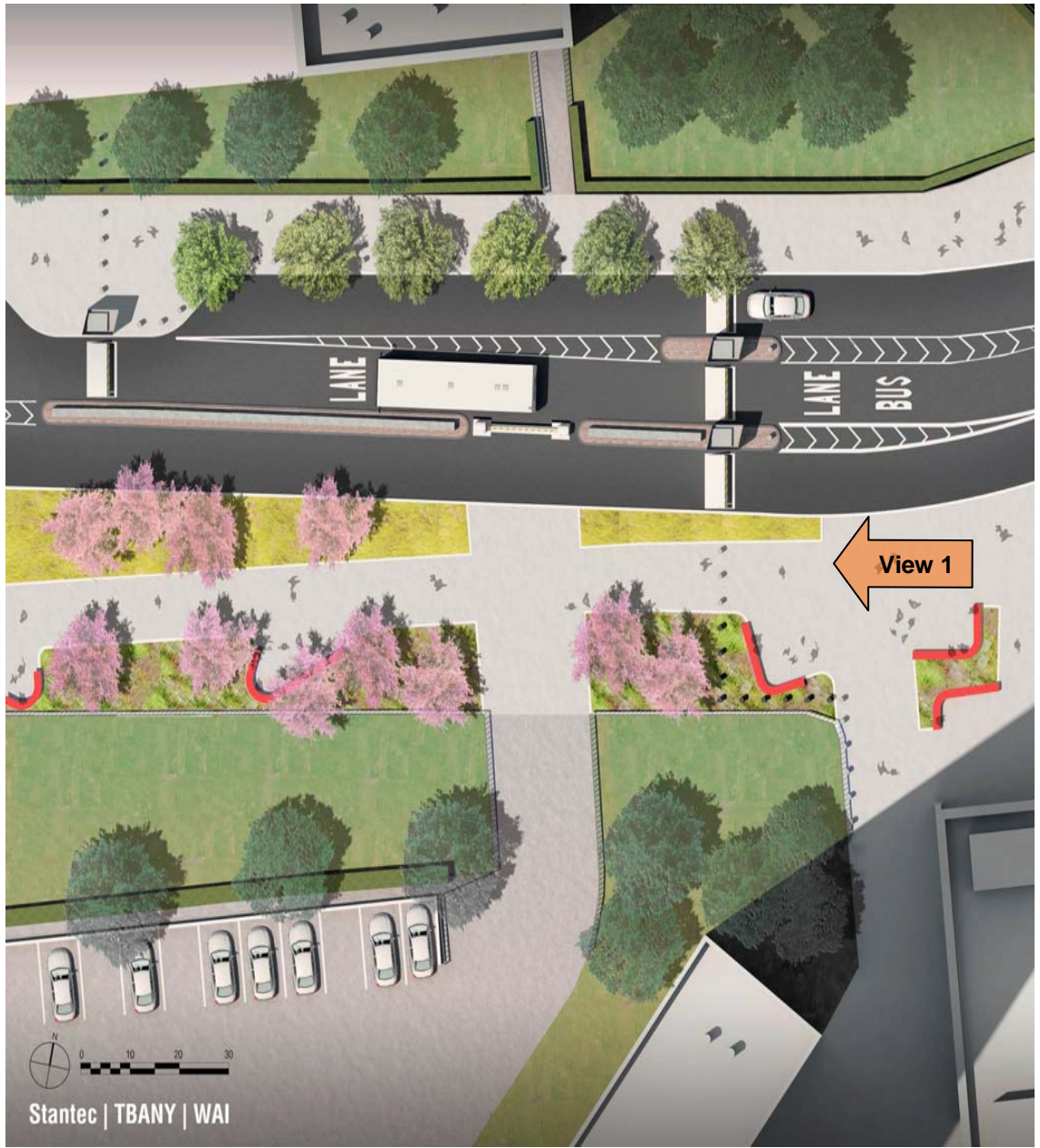



Stantec | TBA | WAI

Stantec | TBA | WAI
DDC

Reconstruction of
Chatham Square & Park Row

View 1: Security Elements at
Park Row & Worth Street



Stantec
50 WEST 29th STREET
NEW YORK, NY
THOMAS BALSLEY ASSOCIATES
311 W. 23rd STREET
NEW YORK, NY



Stantec
50 WEST 29th STREET
NEW YORK, NY
THOMAS BALSLEY ASSOCIATES
311 W. 23rd STREET
NEW YORK, NY

Stantec | Thomas Balsley Associates
DDC

Reconstruction of
Chatham Square & Park Row

Aerial Perspective





Stantec

50 WEST 23rd STREET
NEW YORK, NY

THOMAS BALSLEY ASSOCIATES
31 W. 27th STREET NEW YORK, NY

TBA

**Stantec | Thomas Balsley Associates
DDC**

**Reconstruction of
Chatham Square & Park Row**

Aerial Perspective