



# Broadway Vision Update

CB5 Transportation & Environment Committee

March 25, 2024



# Public Realm Feedback Loop



Community Partnership +  
Engagement



Open Streets

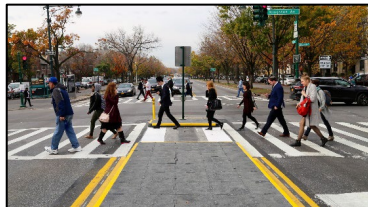

Crossings + Intersections

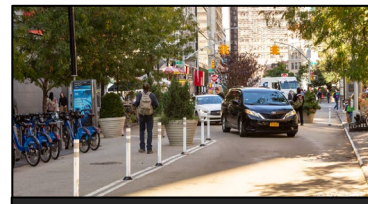

Dynamic Curb + Corridor  
Strategies



Premier Public Spaces

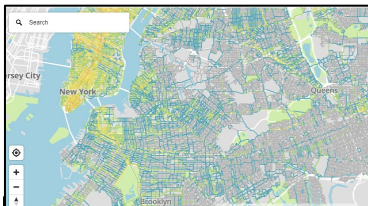

Comprehensive Planning +  
Policy



Equity Focused Maintenance



Programming + Concessions

---

# The Corridor



# Broadway Vision

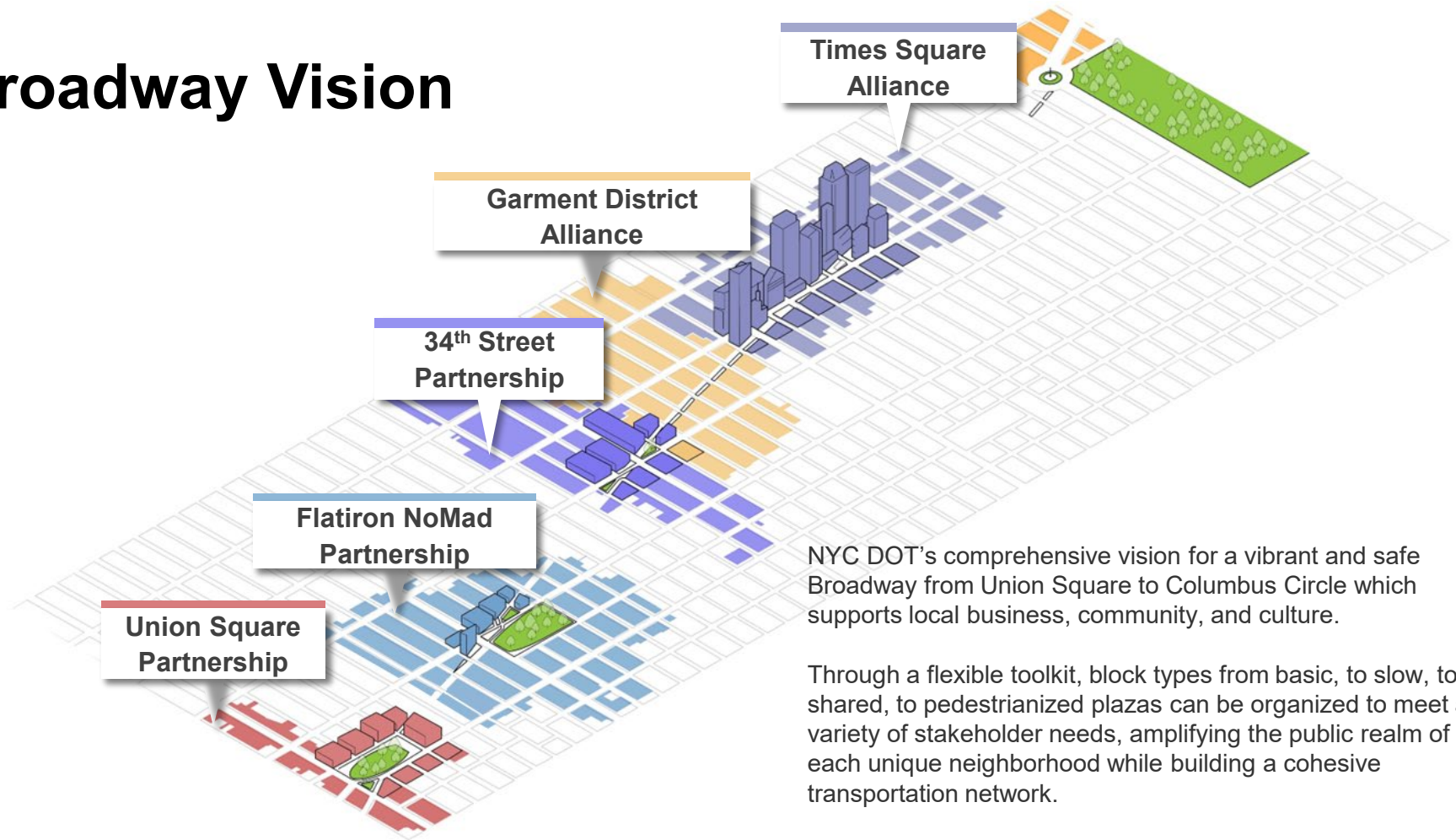

NYC DOT's comprehensive vision for a vibrant and safe Broadway from Union Square to Columbus Circle which supports local business, community, and culture.

Through a flexible toolkit, block types from basic, to slow, to shared, to pedestrianized plazas can be organized to meet a variety of stakeholder needs, amplifying the public realm of each unique neighborhood while building a cohesive transportation network.



# Broadway Vision

2024 Planning

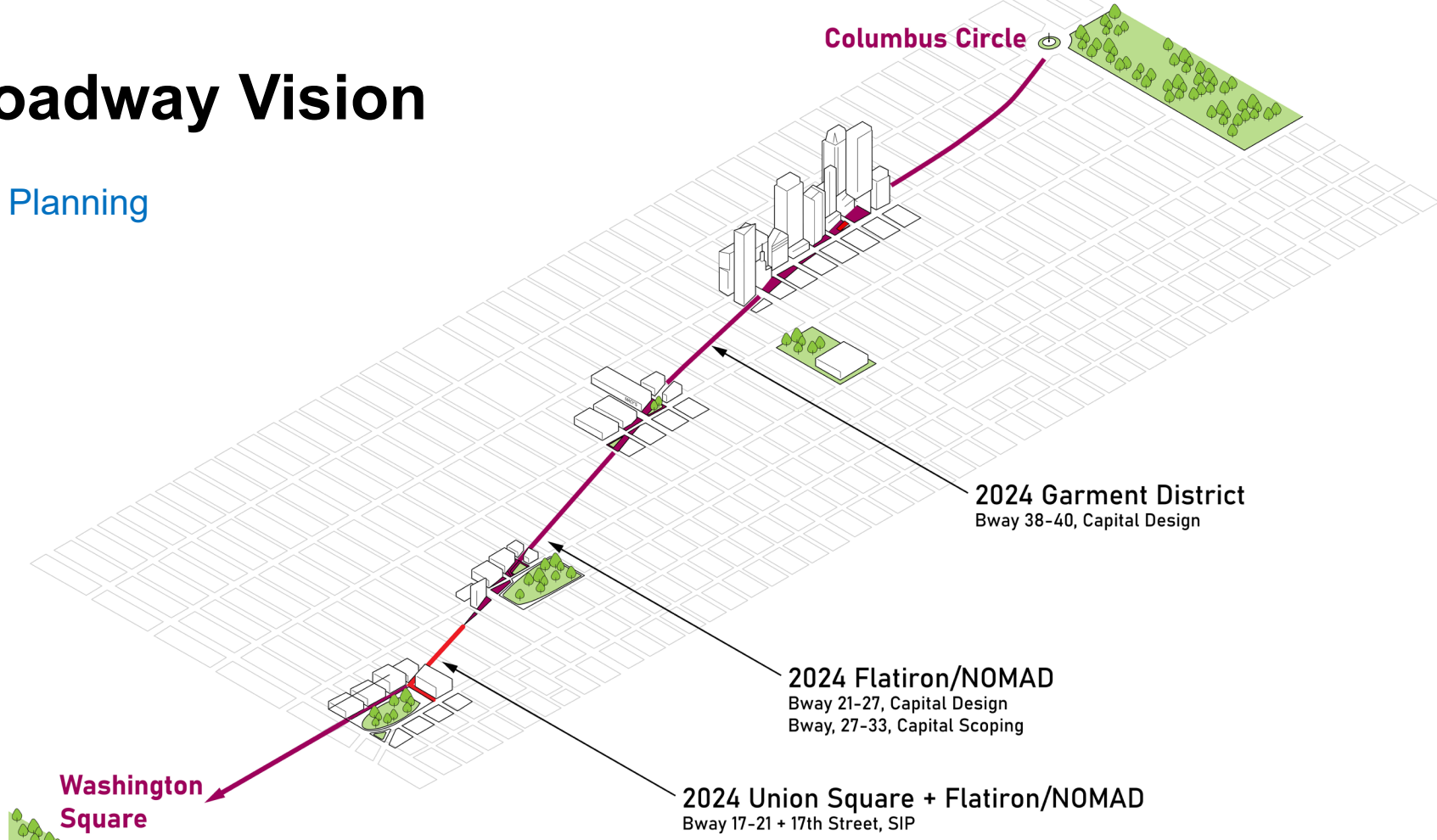



# 2021 Flatiron

21<sup>st</sup> – 23<sup>rd</sup> Shared Streets





# 2023 Flatiron/NoMad

25<sup>th</sup> – 27<sup>th</sup> NoMad Plaza





# 2023 Flatiron/NoMad

## 27<sup>th</sup>-32<sup>nd</sup> Shared Streets





# Corridor Proposal

## Broadway, 17<sup>th</sup>-21<sup>st</sup> Streets

### Project Goals

- Prioritize Pedestrians and Cyclists
- Maintain Necessary Vehicular Access
- Create Additional Public Space
- Formalize Two-Way Bike Connection

DRAFT Design, details still in development

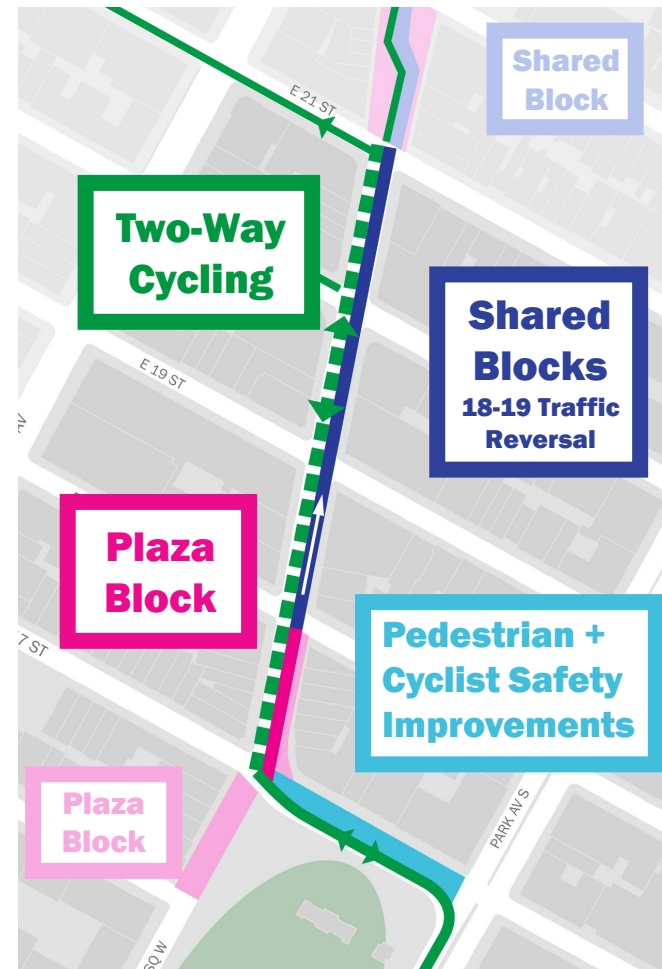

---

# Project Background

# Safety Data

2018-2022



# Pedestrian Mobility Plan

## Broadway – Global Corridor

- Large groups of people moving in all directions; attractions that draw people from around the world
- Suggested sidewalk width of 25'+, clear path of 15'
  - Current sidewalk width ~13' total

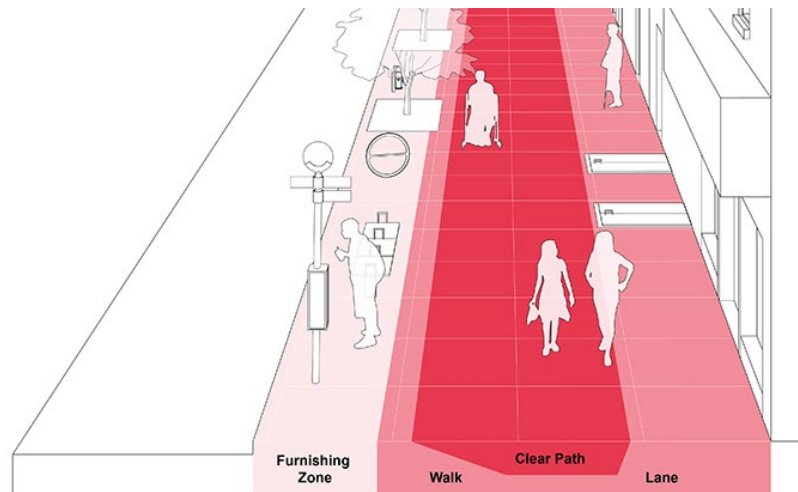

## 17<sup>th</sup> Street – Regional Corridor

- Groups of people passing each other; concentration of pedestrian destinations
- Suggested width of 20'+, clear path of 12'
  - Current width ~17' total

Corridor Category	Sidewalk Width	Furnishing Zone	Walk Lane	Clear Path
Baseline Street	8' +	3'	5'	4'
Community Connector	10' +	2'	8'	5'
Neighborhood Corridor	15' +	3'	12'	8'
Regional Corridor	20' +	5'	15'	12'
Global Corridor	25' +	5'	20'	15'



# 17<sup>th</sup> Street Congestion

- Cyclists turn through pedestrian crossing at 17<sup>th</sup> Street and Broadway
- Many pedestrians cross mid-block on 17<sup>th</sup> Street to access the Park and GreenMarket



Photo Credit: Liz Ligon (2023)

# Traffic Volumes

Weekday Morning 9:00-10:00am  
Feb 2024

- Volumes are on the decline on Broadway so we need to prioritize the delivery or pick-up/drop-off needs
- During the morning weekday peak there are at least 13 times as many pedestrians as vehicles
- The lowest vehicular volumes are on the 17-18 block with under a car a minute accessing that block





# Traffic Volumes

Weekday Afternoon 5:00-6:00pm  
Feb 2024

- Volumes are on the decline on Broadway so we need to prioritize the delivery or pick-up/drop-off needs
- During the weekday afternoon peak there are at least 12 times as many pedestrians as vehicles
- The lowest vehicular volumes are on the 17-18 block with about a car a minute accessing that block



# Traffic Volumes

Weekend 12:30-1:30pm  
Feb 2024

- Volumes are on the decline on Broadway so we need to prioritize the delivery or pick-up/drop-off needs
- During the weekend peak there are at least 20 times as many pedestrians as vehicles
- The lowest vehicular volumes are on the 17-18 block with a car a minute accessing that block





# Public Engagement

## DOT Public Survey

- Open 8 weeks: Aug. 21<sup>st</sup> – Oct. 12<sup>th</sup>

## On-Street Public Sessions with Street Ambassadors

- Mon. 8/21, 11a-5p at Broadway & 20<sup>th</sup> St
- Wed. 8/23, 12-6p at Union Square Greenmarket
- Fri. 8/25, 11a-5p at Broadway & 17<sup>th</sup> St.

## Union Square Partnership Community Opinion Survey

- Summer 2023



# Public Survey Results

- **396** survey responses
- **69%** use the corridor everyday or several times a week
- **51%** bike or scooter when on the corridor
- **61%** of cyclists experience conflicts with vehicles
- **64%** of pedestrians think sidewalks are too crowded



# Public Survey Results – Visioning

Which amenities and traffic calming elements would you like to see?

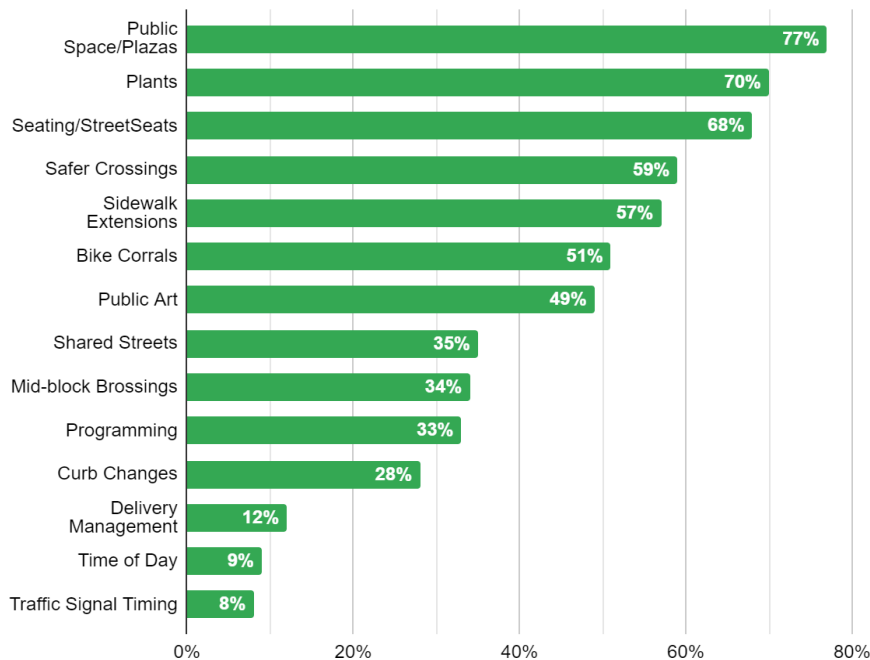

91%

would like to see a Plaza Block

89%

would like to see two-way cycling on the corridor

# Public Survey Results – Experience

## Pedestrian Experience

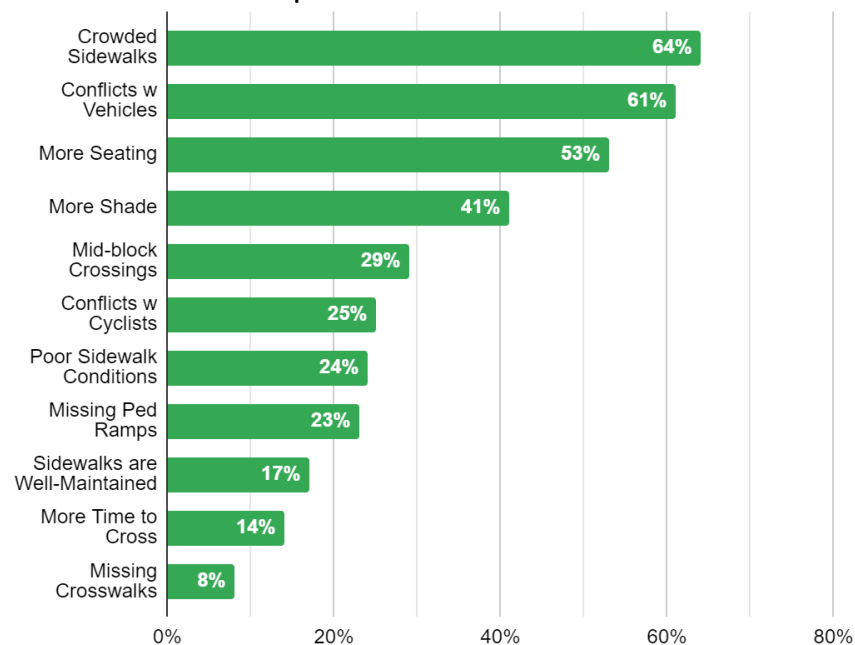

## Cyclist Experience

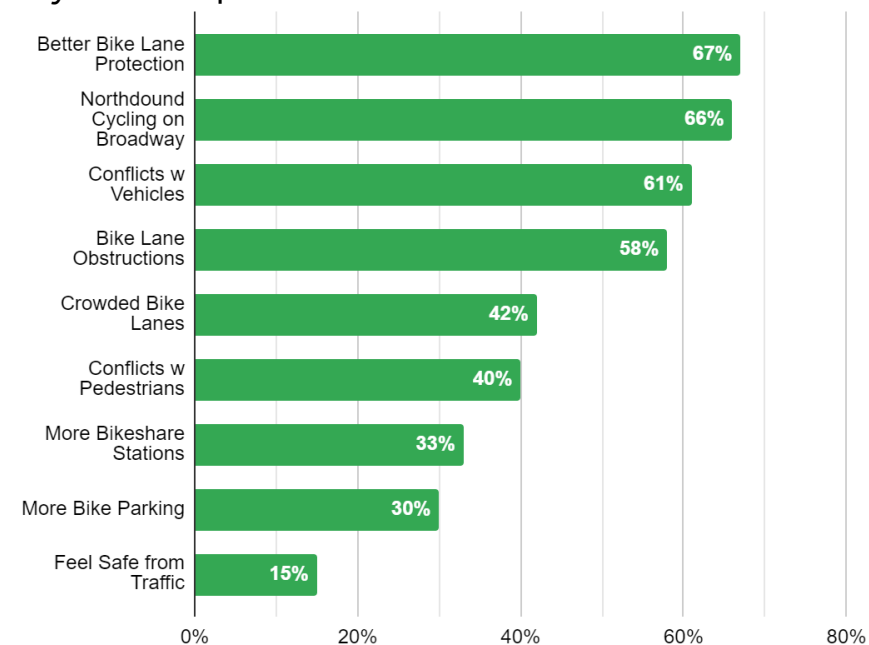



# Stakeholder Coordination

- Flatiron/NoMad BID + Union Square Partnership: ongoing coordination
- Greenmarket: 2/29, 3/19
- Stakeholder walkthroughs: 3/7, 3/11
  - Included adjacent building owners and management, and Paragon Sports and other commercial establishments
- Parks: 3/8
- FDNY: 3/19, 3/26
- DSNY: 4/5-4/11



---

# The Proposal

3

# Corridor Proposal

## Broadway, 17<sup>th</sup>-21<sup>st</sup> Streets

### Project Goals

- Prioritize Pedestrians and Cyclists
- Maintain Necessary Vehicular Access
- Create Additional Public Space
- Formalize Two-Way Bike Connection

DRAFT Design, details still in development

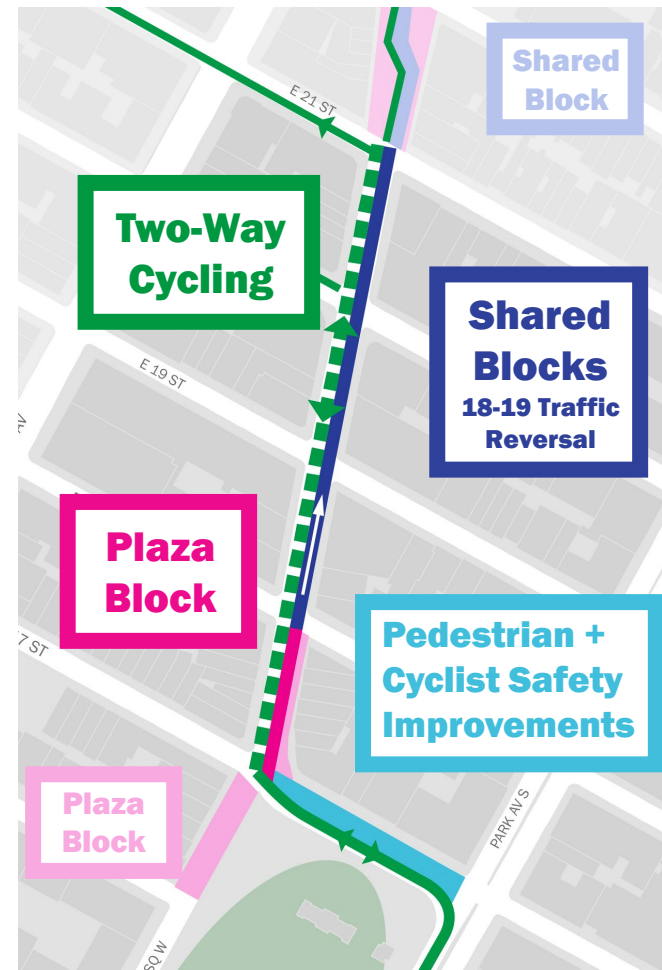

# Shared Block

## Broadway, 20<sup>th</sup> – 21<sup>st</sup> Street

- Increase pedestrian circulation space and public space
- Maintain southbound vehicular access
- Maintain curb access for loading
- Make connection to bike lane on 21<sup>st</sup> St.



DRAFT Design, details still in development



# Shared Block

## Broadway, 19<sup>th</sup> – 20<sup>th</sup> Street

- Increase pedestrian circulation space and public space
- Remove CitiBike from this block (relocate to 18-19)
- Maintain southbound vehicular access
- Maintain curb access for loading

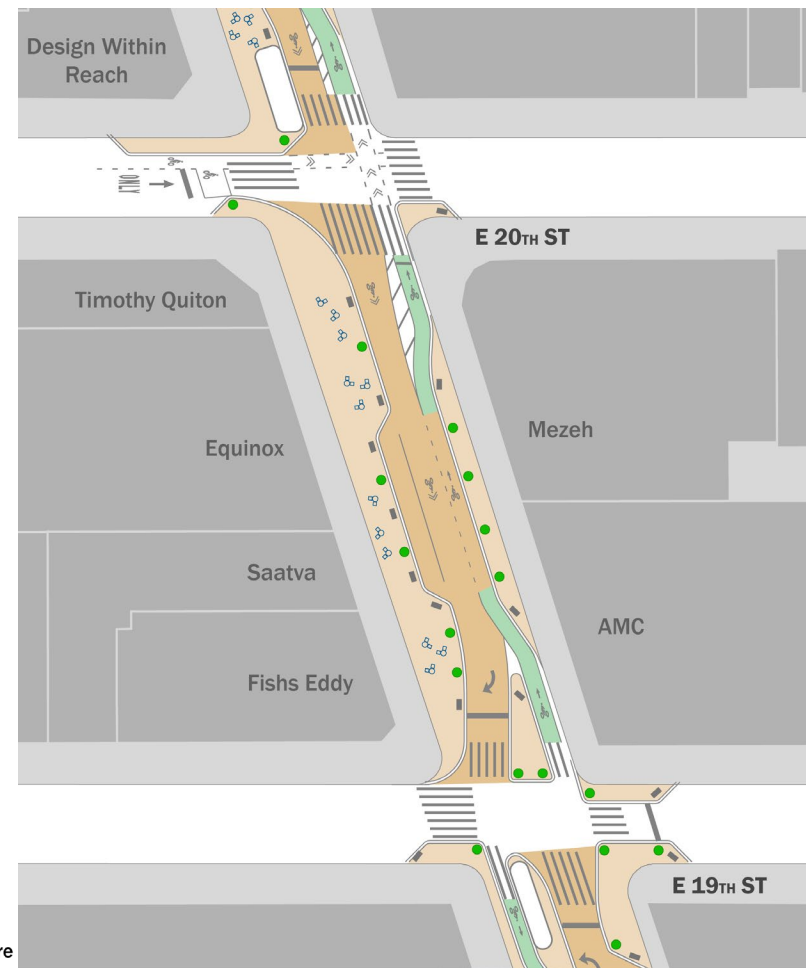

DRAFT Design, details still in development

# Shared Block

## Broadway, 18<sup>th</sup> – 19<sup>th</sup> Street

- Reversal to northbound only for vehicles
- Relocate and expand CitiBike station from east side of 19<sup>th</sup> – 20<sup>th</sup> to west side of 18<sup>th</sup> – 19<sup>th</sup>
  - Reduce maintenance needs where there is limited BID coverage
- Maintain curb access for loading

DRAFT Design, details still in development

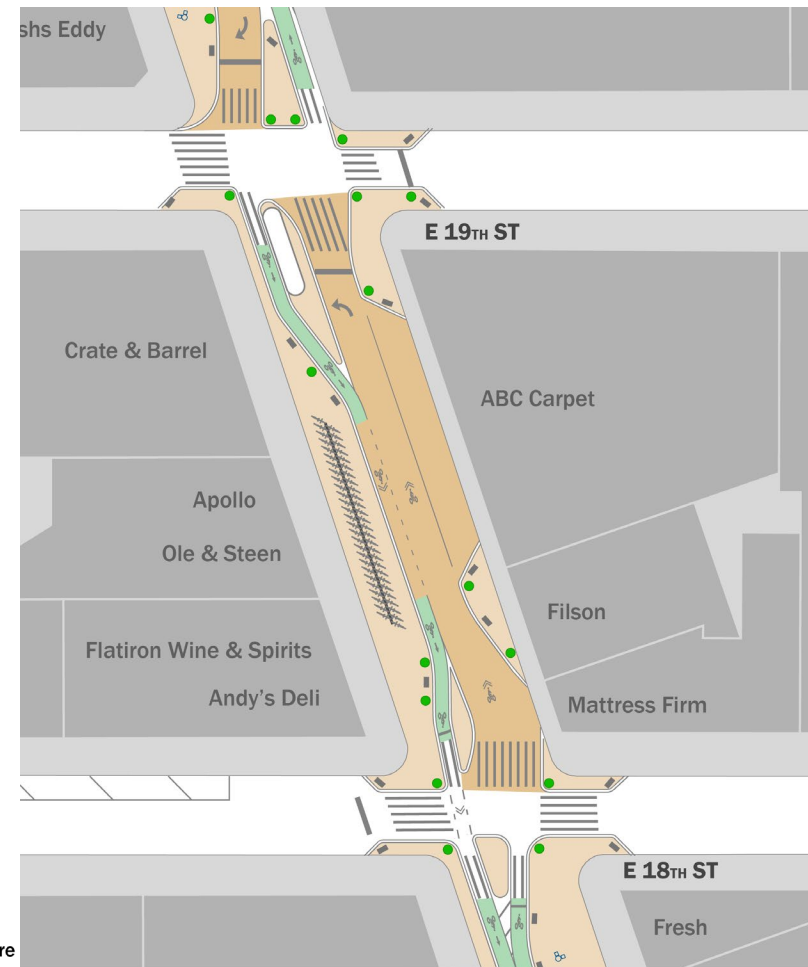
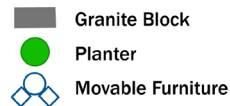

# Plaza Block

## Broadway, 17<sup>th</sup>-18<sup>th</sup> Street

- Formalize northbound bike connection with 2-way bike path through the plaza
- Calm bike traffic with pinches and mid-block pedestrian crossing
- Protects and guides contraflow cyclists through the intersection
- Expand public and programmable space

DRAFT Design, details still in development

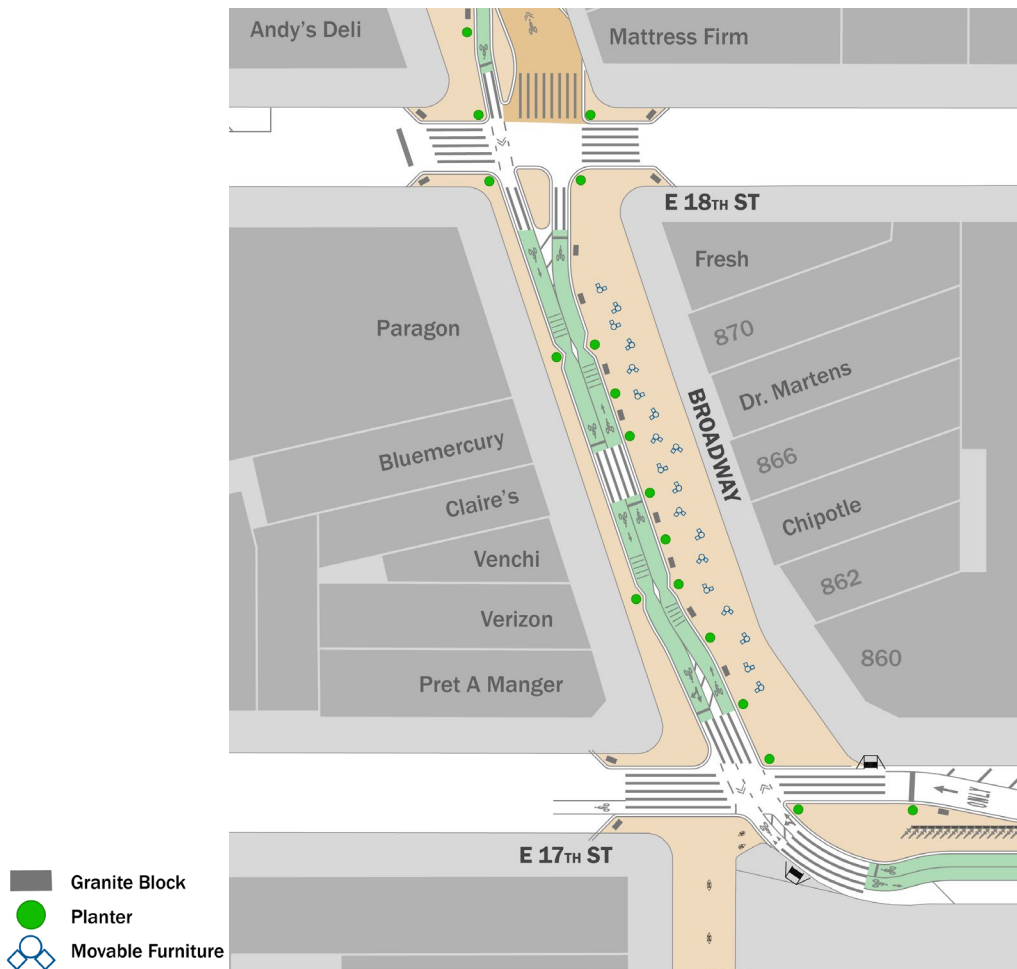



# 17<sup>th</sup> Street Improvements

## E. 17<sup>th</sup> Street, Broadway – Park Ave S

- Clarify intersection and bike connections at Broadway & E. 17<sup>th</sup> St
- Create more pedestrian circulation space
- Add mid-block crossing through the bike lane
- Relocate and extend CitiBike
- Maintain GreenMarket parking

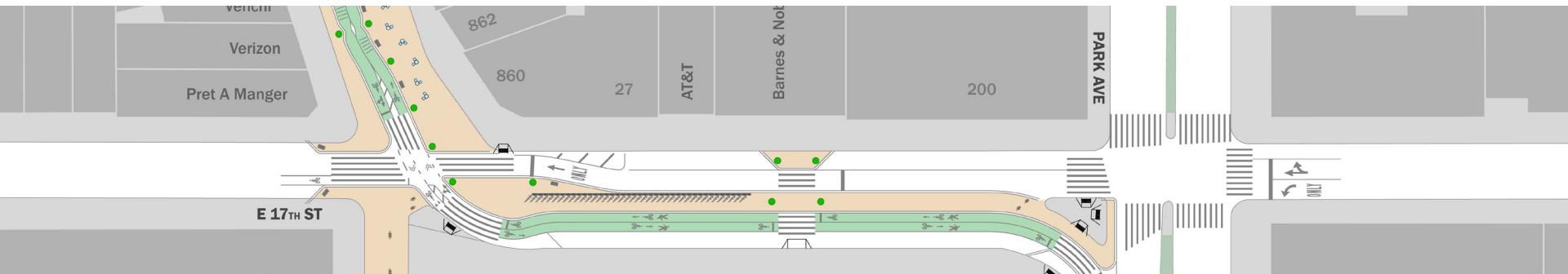

---

# Operations

# 4

# Traffic Network Changes

## Broadway, 17<sup>th</sup>-19<sup>th</sup> Streets

### FDNY

- Westbound access: northbound Broadway to 19<sup>th</sup> St.
- Eastbound access unchanged

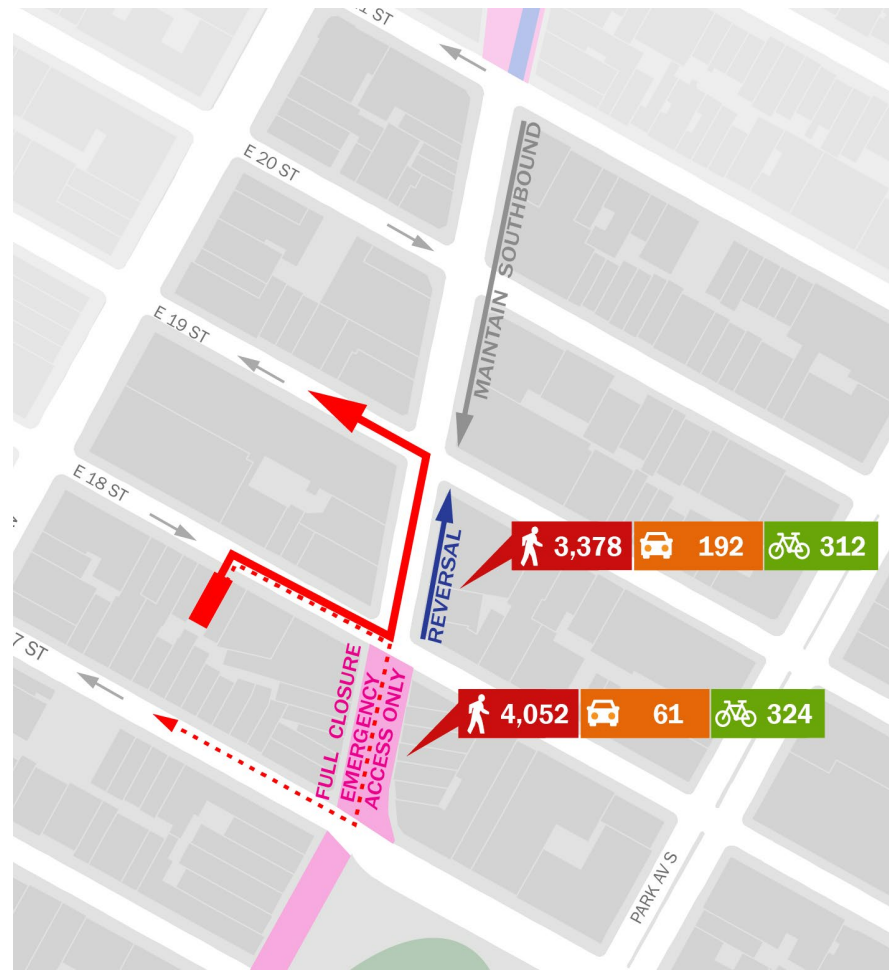

DRAFT Design, details still in development



# Traffic Network Changes

## Broadway, 17<sup>th</sup>-19<sup>th</sup> Streets

### 18<sup>th</sup> Street:

- Southbound vehicles on Broadway use 5<sup>th</sup> Ave to loop around to

### 17<sup>th</sup> Street:

- No vehicle access on Broadway, 17<sup>th</sup>-18<sup>th</sup>
- Plaza re-routes



DRAFT Design, details still in development

# Curb Management

## Existing

### Broadway

- 710 Linear Feet of Parking
- ~35 parking spots

### Numbered Streets

- Commercial Metered Parking



DRAFT Design, details still in development

# Curb Management

## Proposed

### Broadway

- 200 Linear Feet of Parking (-510 LF)
- ~10 parking spots (-25 spots)

### Numbered Streets

- **+1,335** Linear Feet of additional evening All Vehicle Metered Marking
- **+67** All Vehicle Metered Parking spots

DRAFT Design, details still in development

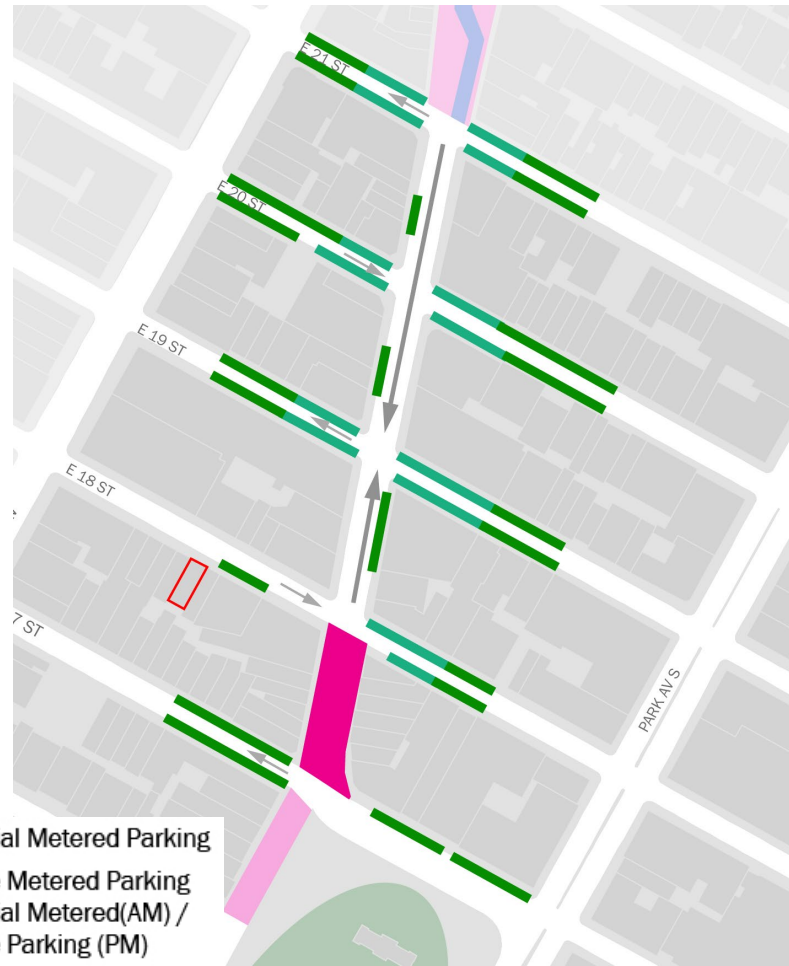
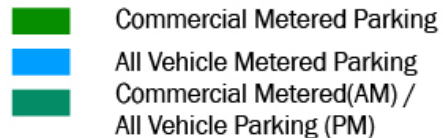



# Project Schedule

Early March	Stakeholder outreach + design scheme presentations Design development
Mid-March	Milling and repaving
Late March	CB TC
Early April	CB FB
Spring/Summer	Implementation
Late Summer	Post-implementation educational outreach about changes and how to use space

# Thank You!

Questions?



NYCDOT



nyc\_dot



nyc\_dot



NYCDOT