



Broadway at Flushing Ave and Graham Ave

Brooklyn CB 1

April 12, 2022

Project Background

Broadway at Flushing Ave and Graham Ave



Community and NYPD requests for safety improvements at Broadway, Flushing, and Graham Ave

Project Area

Broadway at Flushing Ave and Graham Ave

- Intersection of three major vehicular corridors
- Mixed commercial and residential uses
- Multi-Modal transit hub with access to the bus lines B43, B57, B46, J and M trains
- Within the Graham Ave BID
- Adjacent to Woodhull Hospital

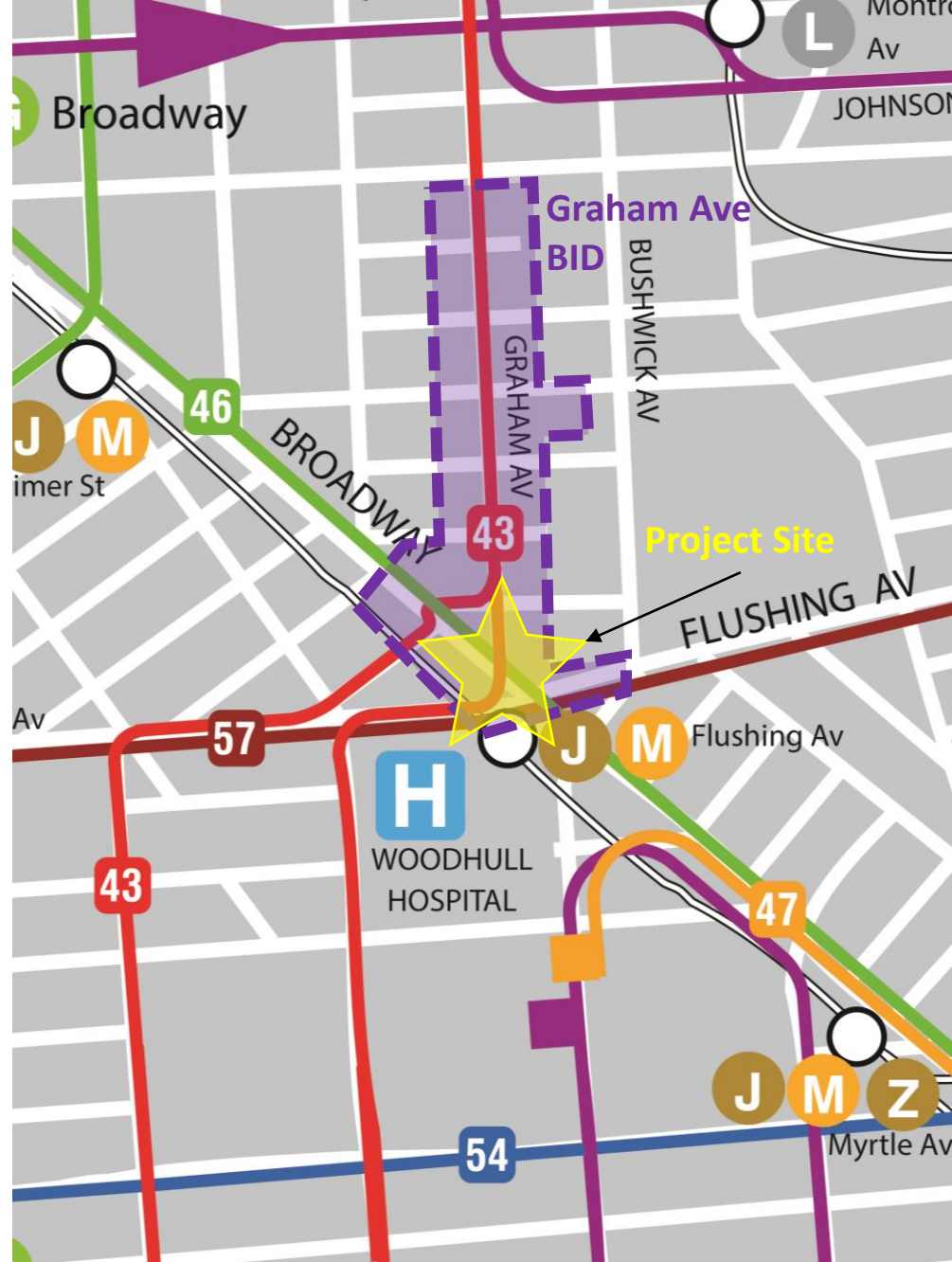

Safety Data

- Broadway, Flushing, and Graham Ave are all Vision Zero Priority Corridors
- Pedestrian fatalities in 2014 and 2021

Broadway, Flushing Ave and Graham Ave, BK Injury Summary, 2015-2019 (5 years)

| | Total Injuries | Severe Injuries | Fatalities | KSI |
|------------------------|----------------|-----------------|------------|-----|
| Pedestrian | 26 | 2 | 2* | 4* |
| Bicyclists | 5 | 1 | 0 | 1 |
| Motor Vehicle Occupant | 32 | 0 | 0 | 0 |
| Total | 78 | 3 | 0 | 3 |

KSI: Killed or Severely Injured

* Includes data from 2014-2021

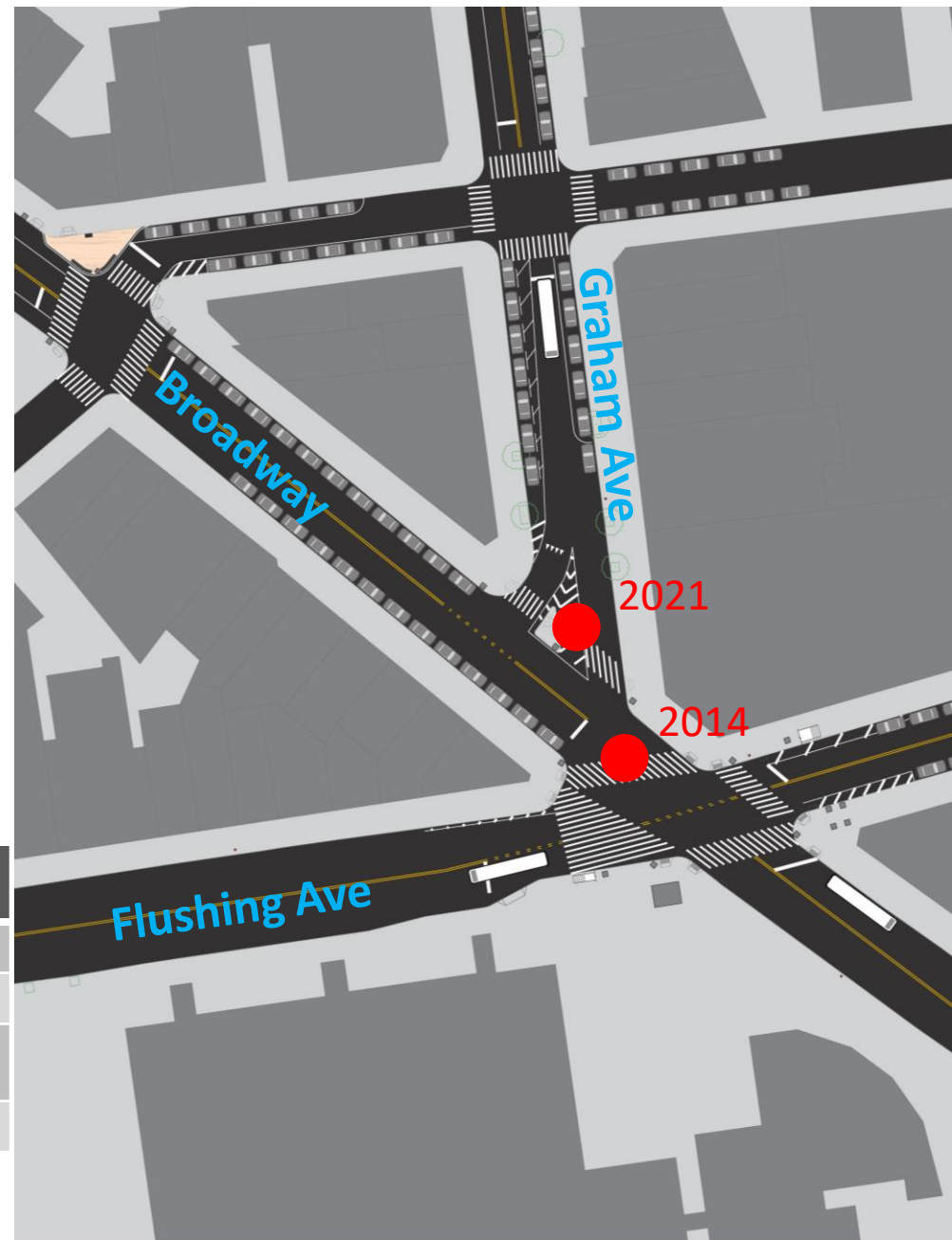

● Location of pedestrian fatality

Existing Conditions



Existing Conditions

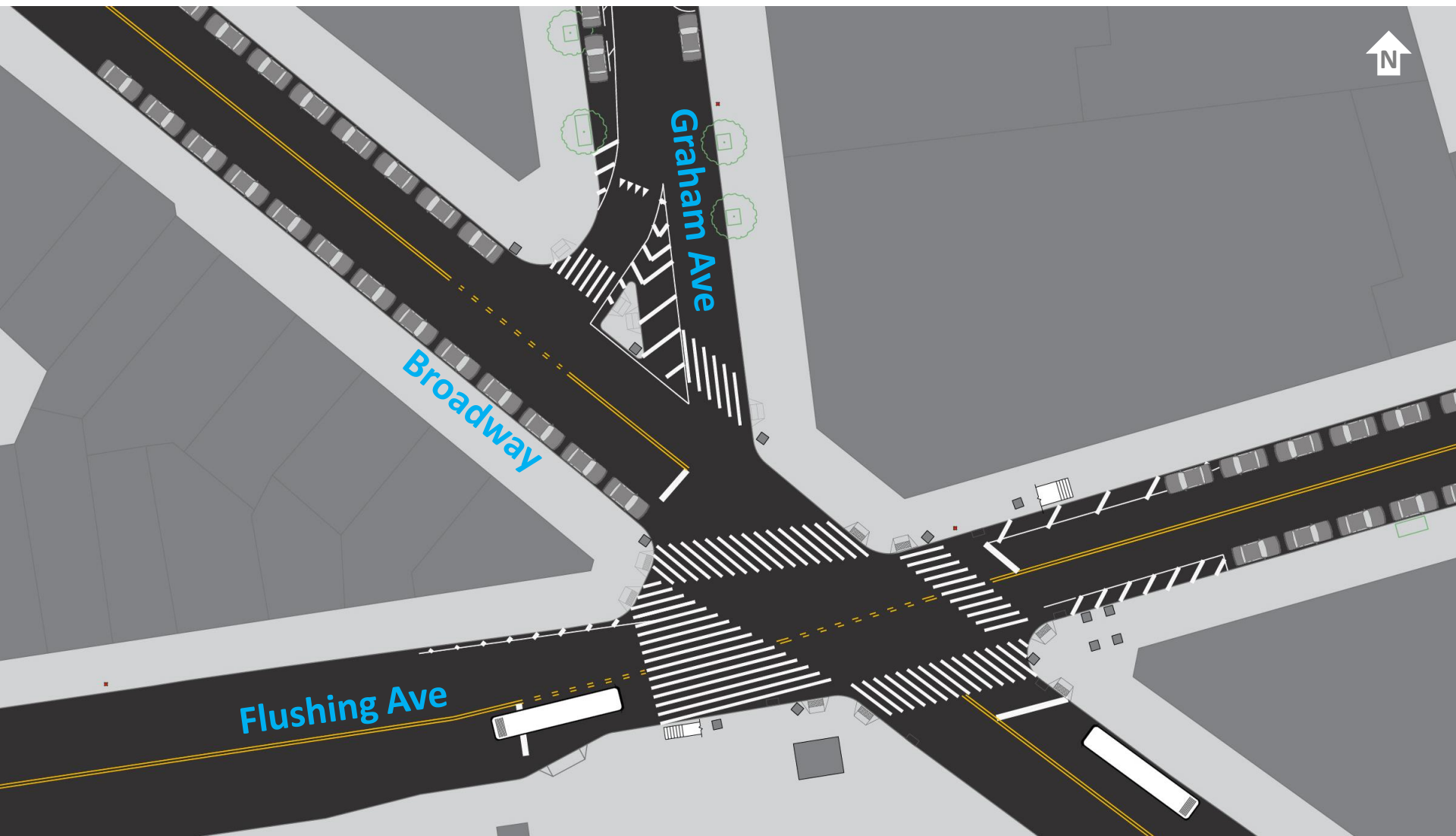

Existing Conditions

Graham Ave is not part of the signalized intersection

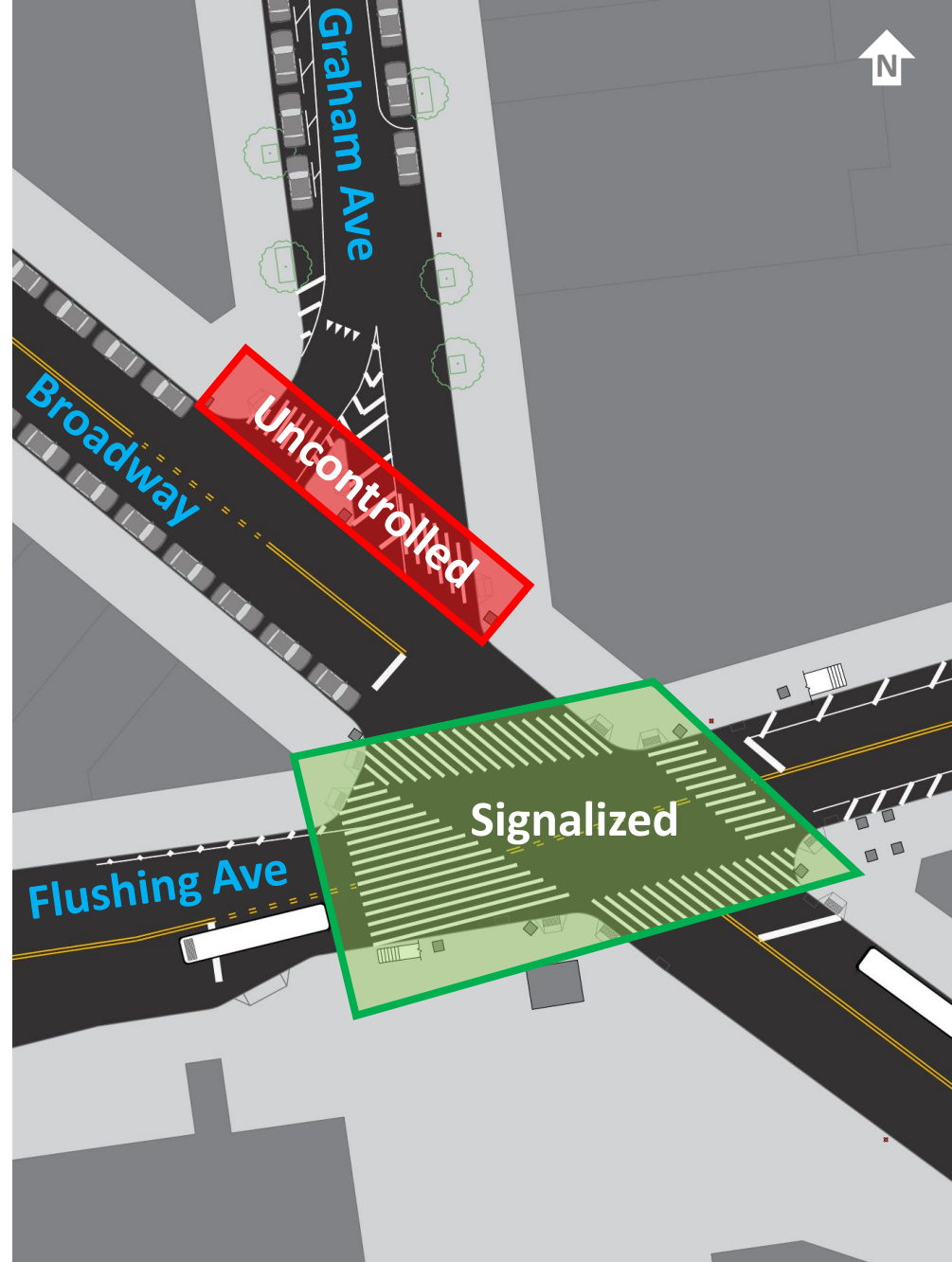

Existing Conditions

- Left turns from westbound Flushing Ave to northbound Graham Ave are direct, creating conflict point with pedestrians on Broadway
- Recessed crosswalk limits both driver and pedestrian visibility

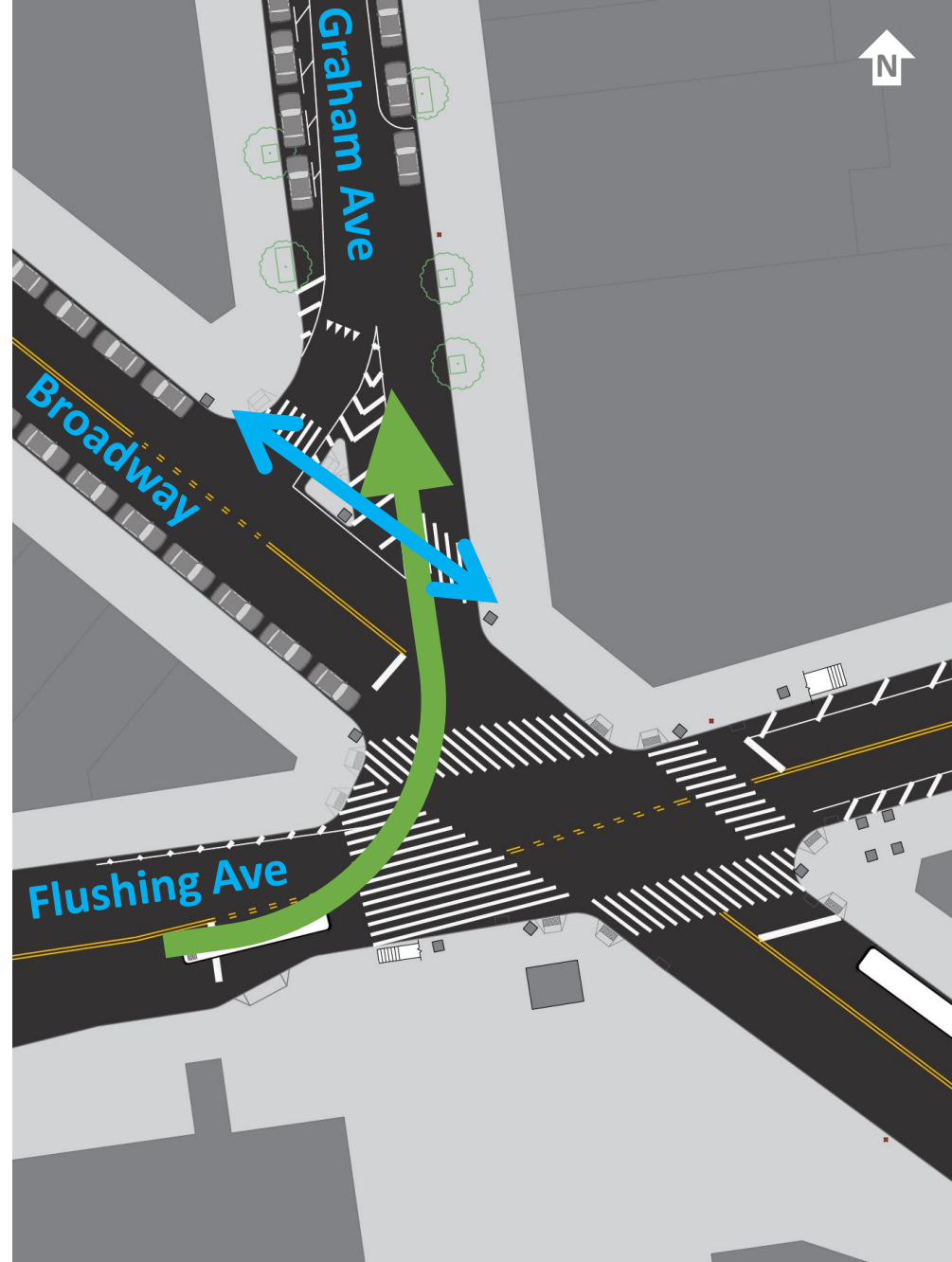
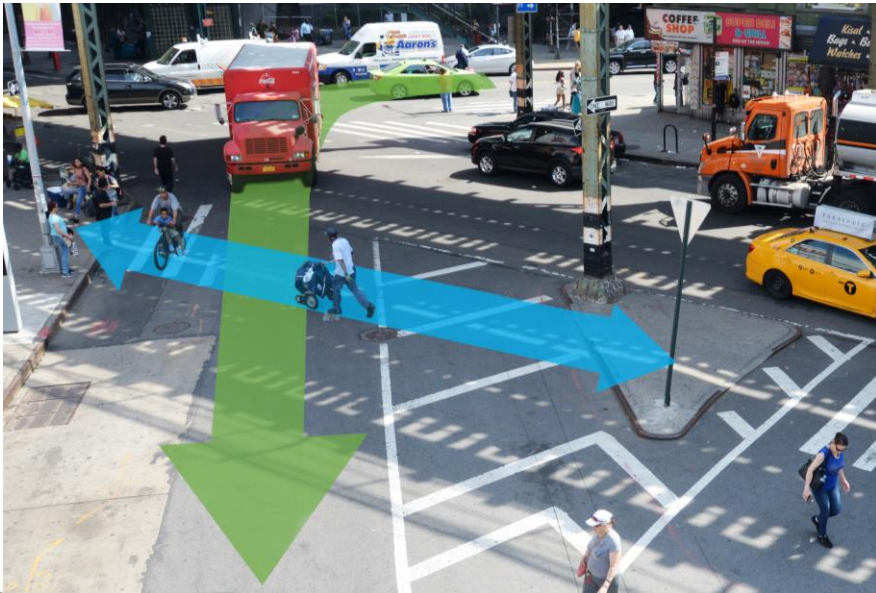

Existing Conditions

Wide slip lane

- Multiple vehicles making the soft left turn at the same time

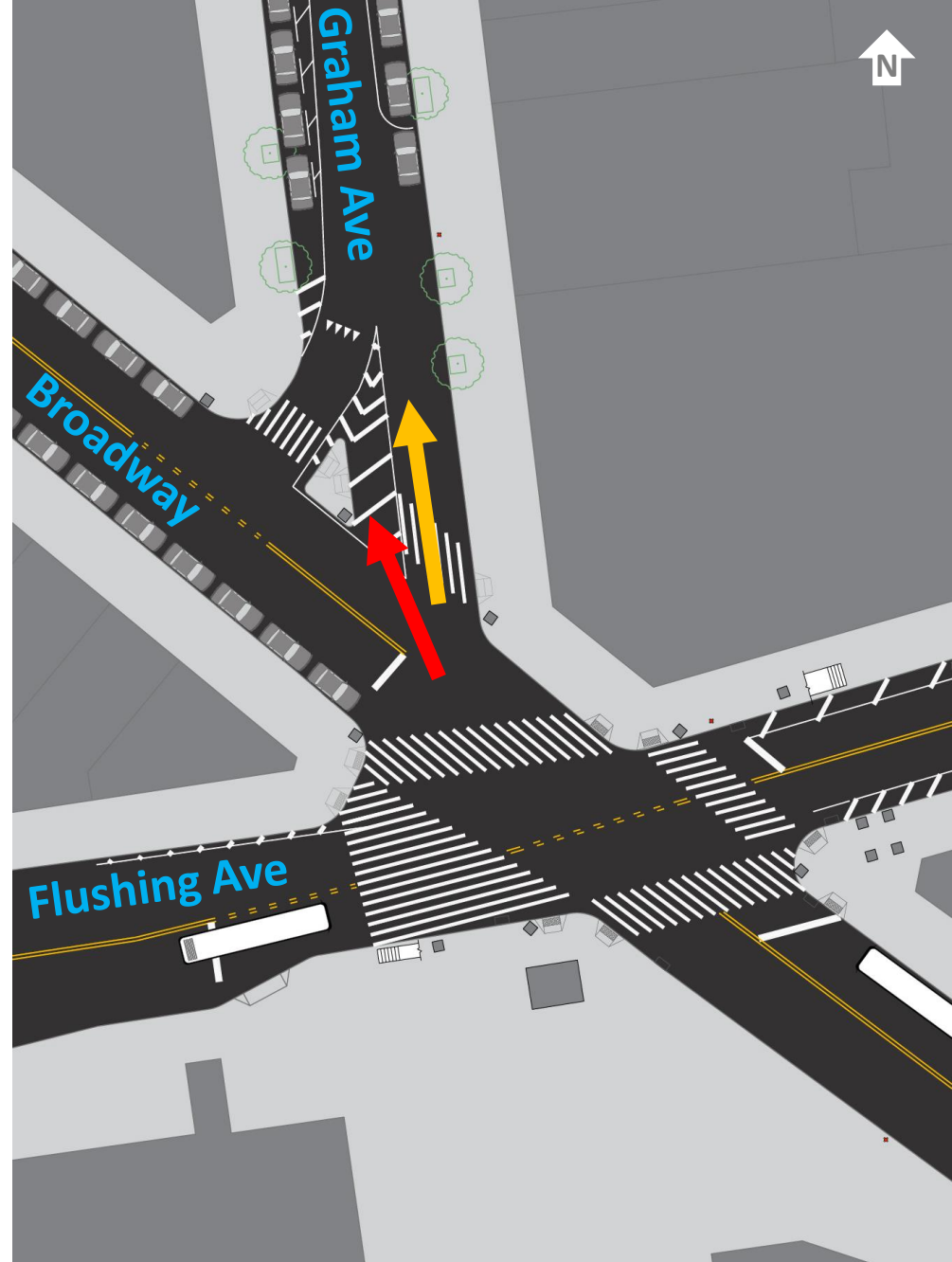
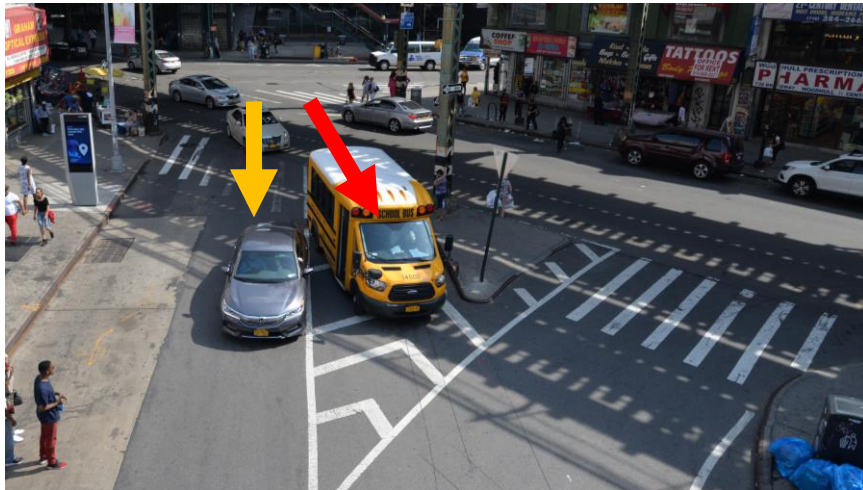

Existing Conditions

Pedestrian desire lines

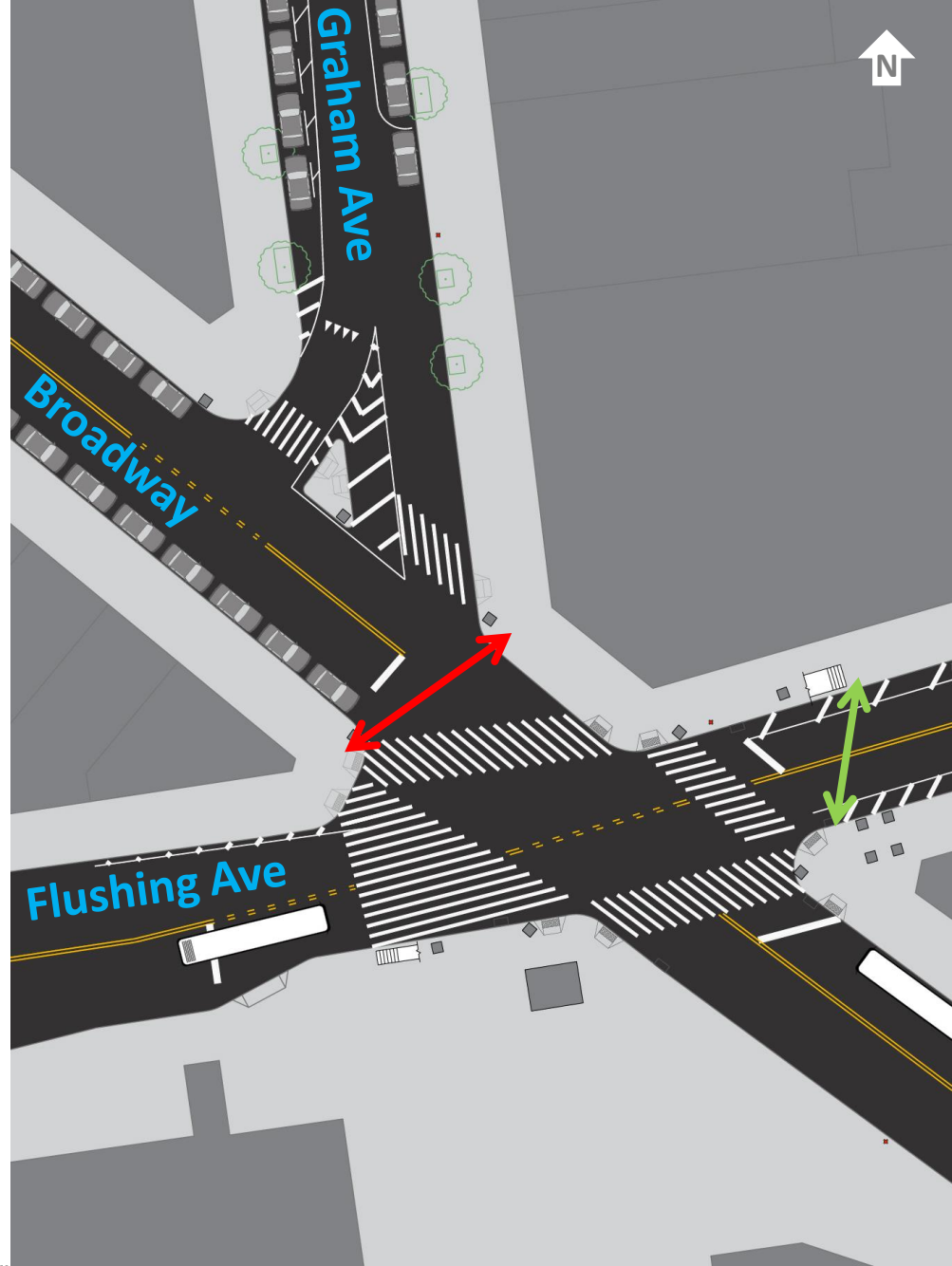
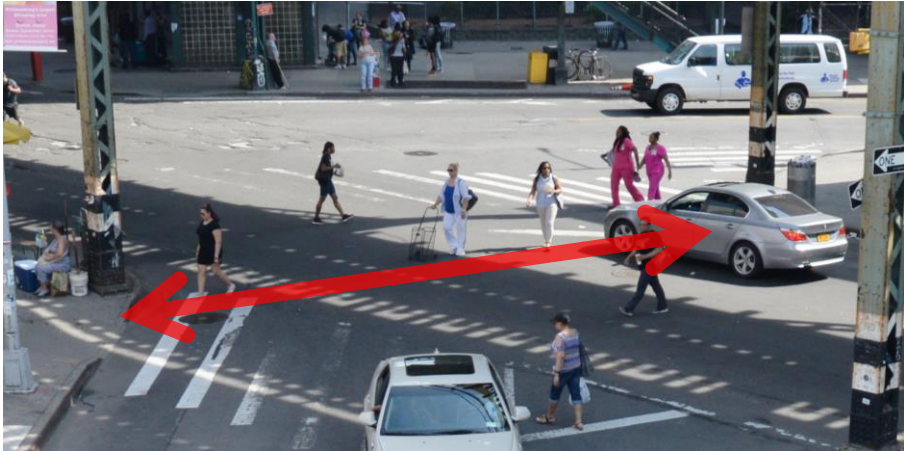

Proposed Design

2

Toolkit



Concrete Sidewalk Extensions



Traffic Regulations



Curb Regulations



Street Markings



Hoop Racks



Planters



City Bench

Existing Conditions

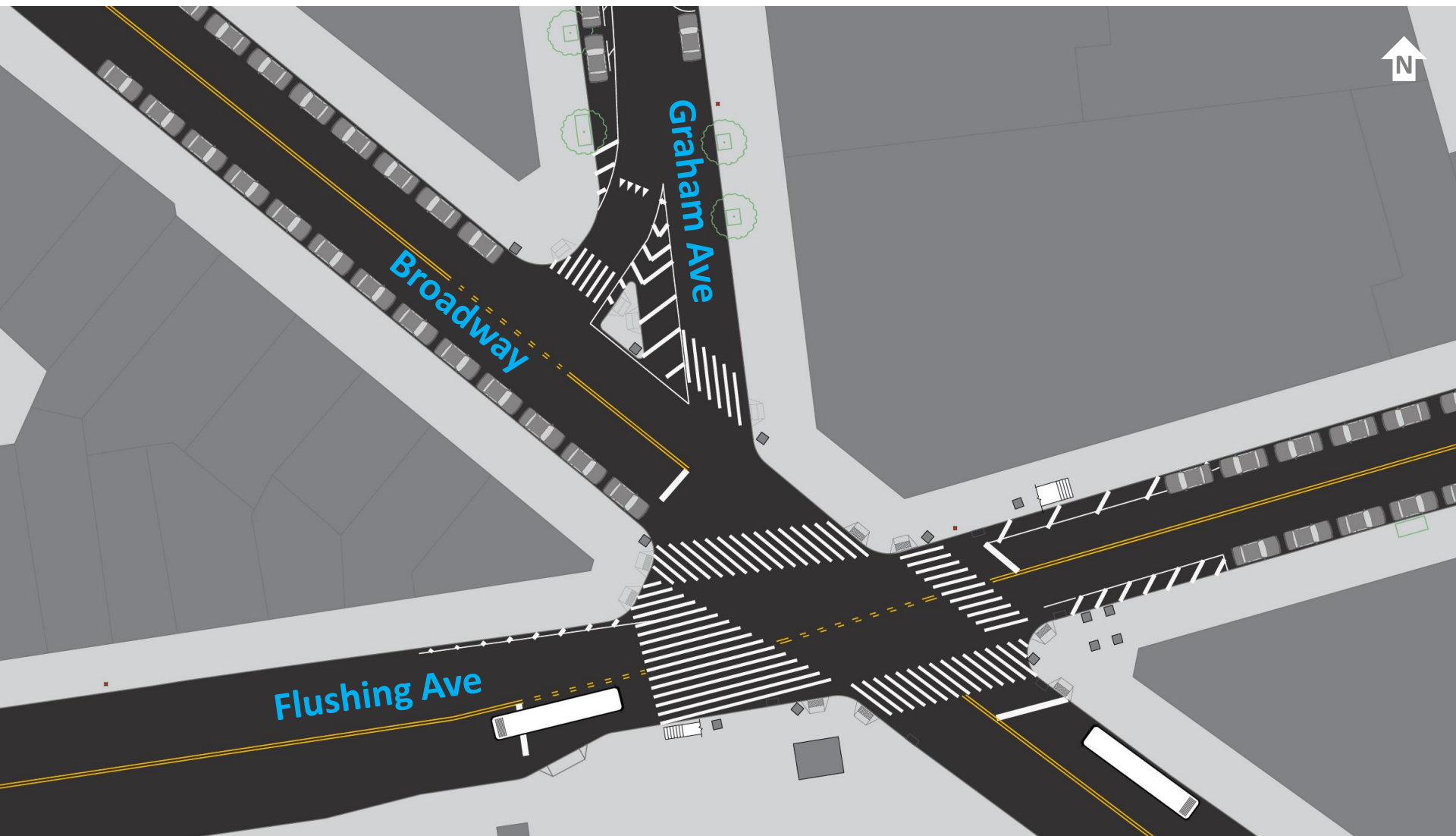

Proposed Design

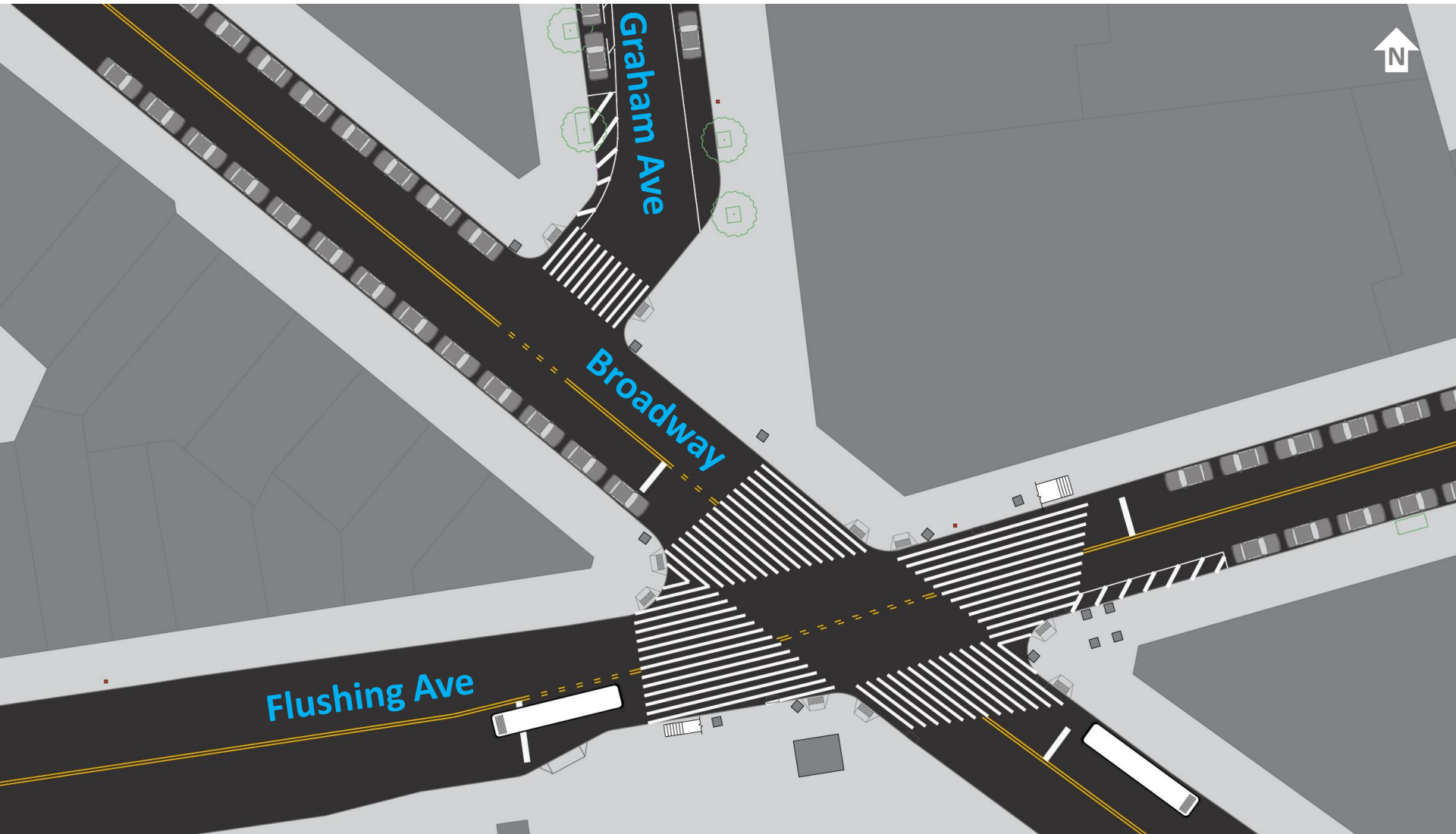

Proposed Design

1

Remove existing concrete to expand the northern slip of Graham Ave

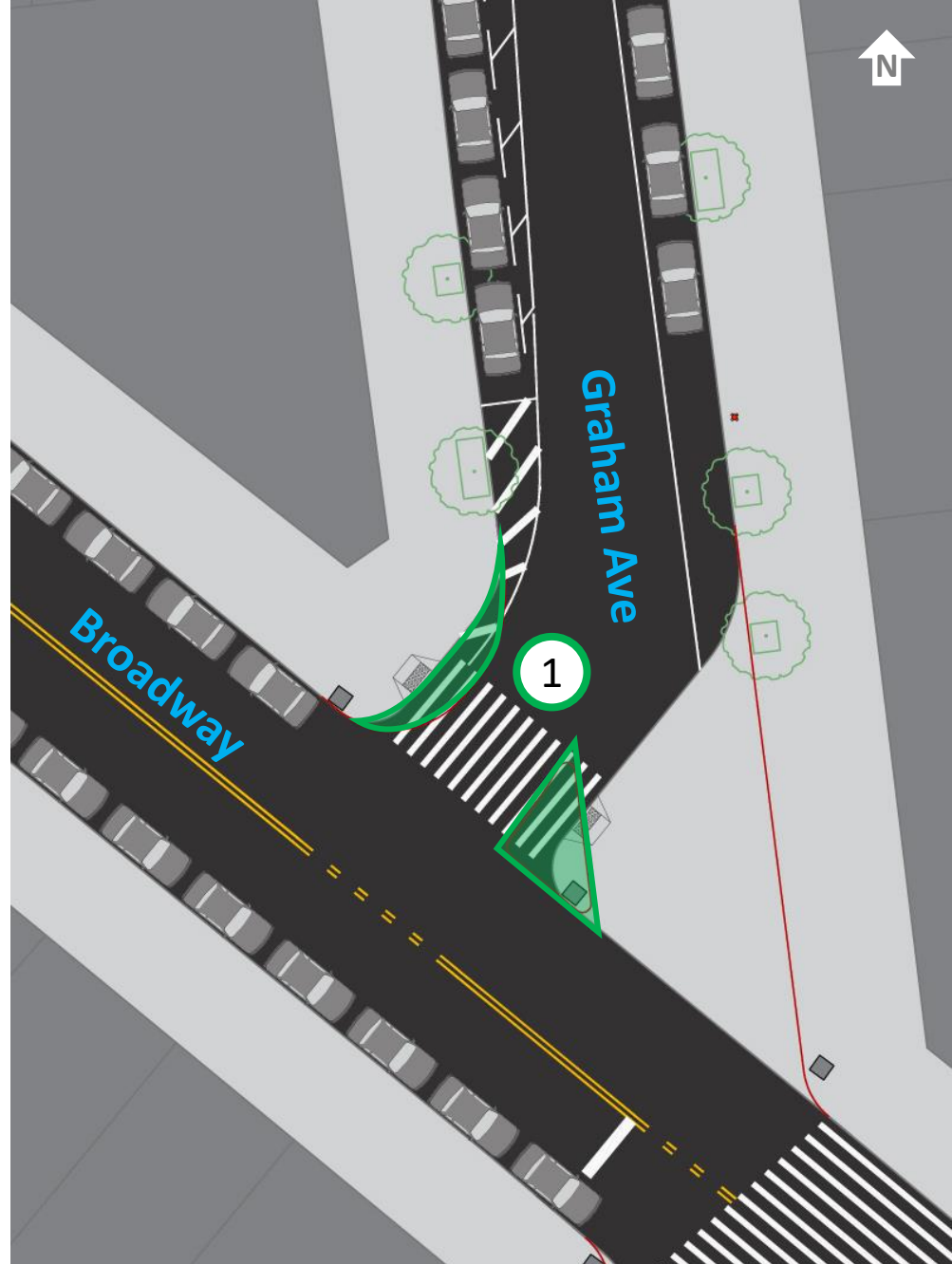

Proposed Design

1

Remove existing concrete to expand the northern slip of Graham Ave

2

Close the southern slip of Graham Ave with a concrete sidewalk extension

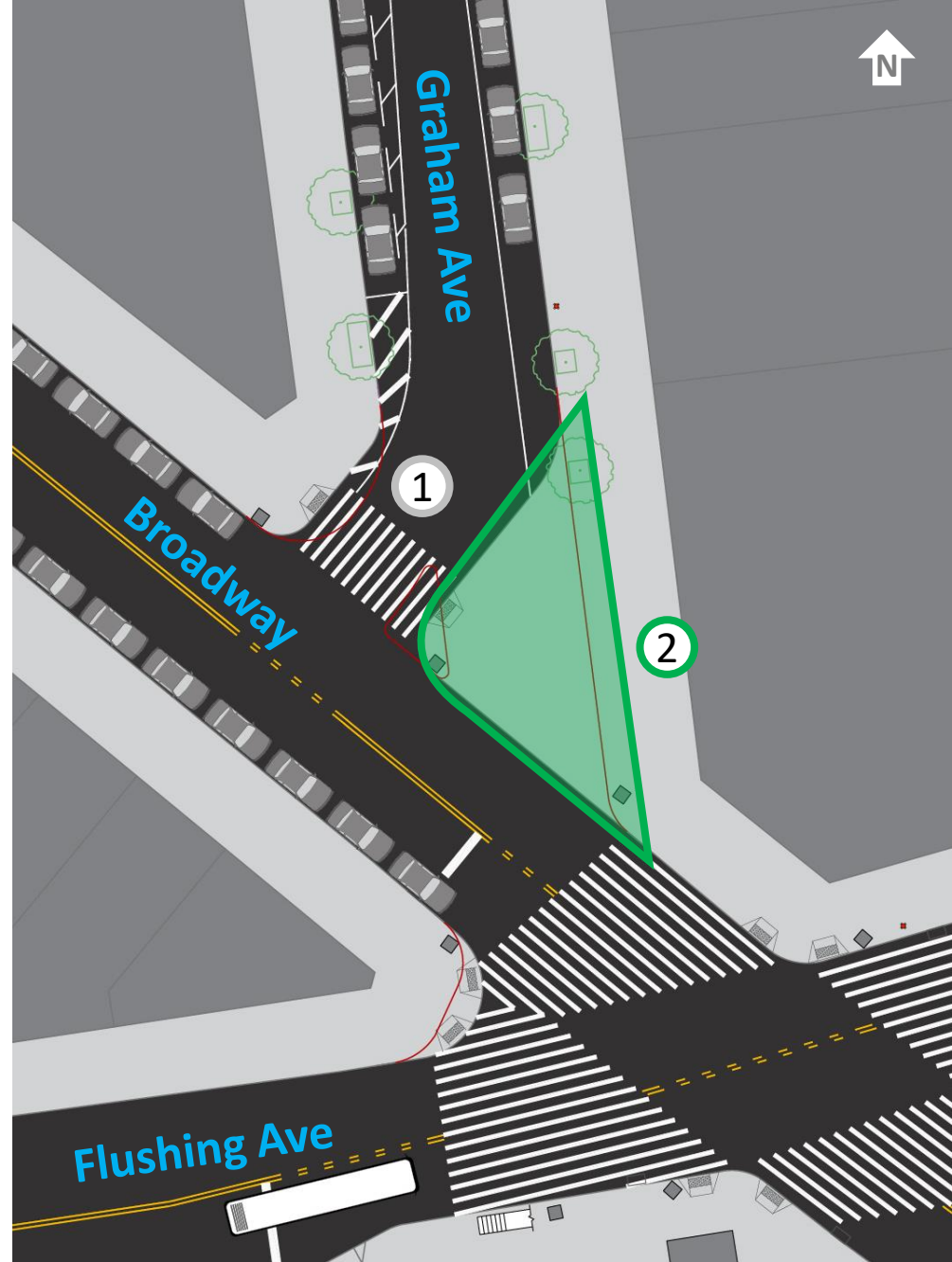

Proposed Design

1

Remove existing concrete to expand the northern slip of Graham Ave

2

Close the southern slip of Graham Ave with a concrete sidewalk extension

3

Build a concrete sidewalk extension on the NW corner of Broadway and Flushing Ave

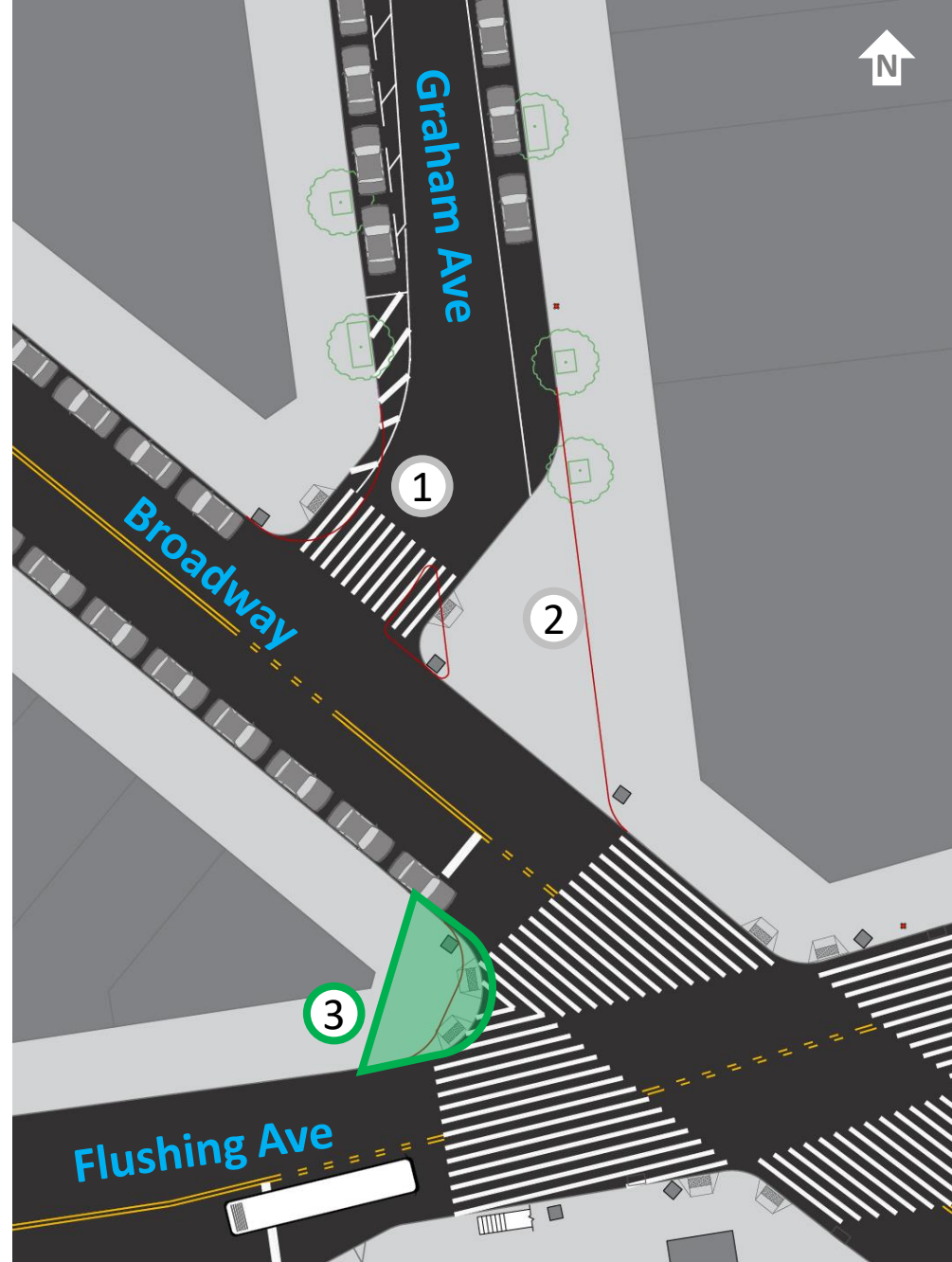

Proposed Design

1

Remove existing concrete to expand the northern slip of Graham Ave

2

Close the southern slip of Graham Ave with a concrete sidewalk extension

3

Build a concrete sidewalk extension on the NW corner of Broadway and Flushing Ave

4

Flare crosswalks to accommodate pedestrian desire lines

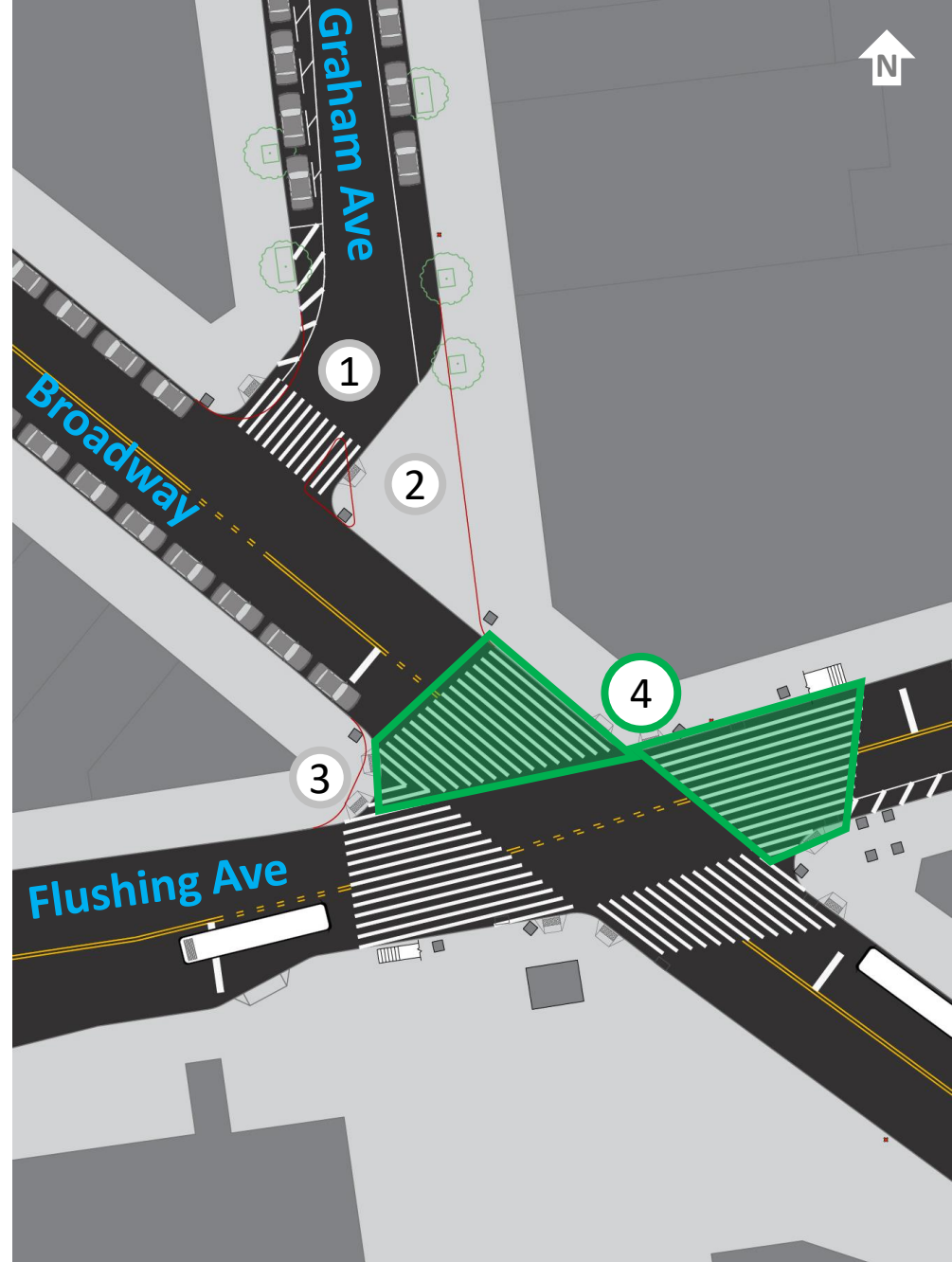

Proposed Design

1

Remove existing concrete to expand the northern slip of Graham Ave

2

Close the southern slip of Graham Ave with a concrete sidewalk extension

3

Build a concrete sidewalk extension on the NW corner of Broadway and Flushing Ave

4

Flare crosswalks to accommodate pedestrian desire lines

5

Combine B43 bus stop with the B57 stop on the south curb of Flushing Ave

*all proposed changes involving bus operations have been agreed upon by MTA

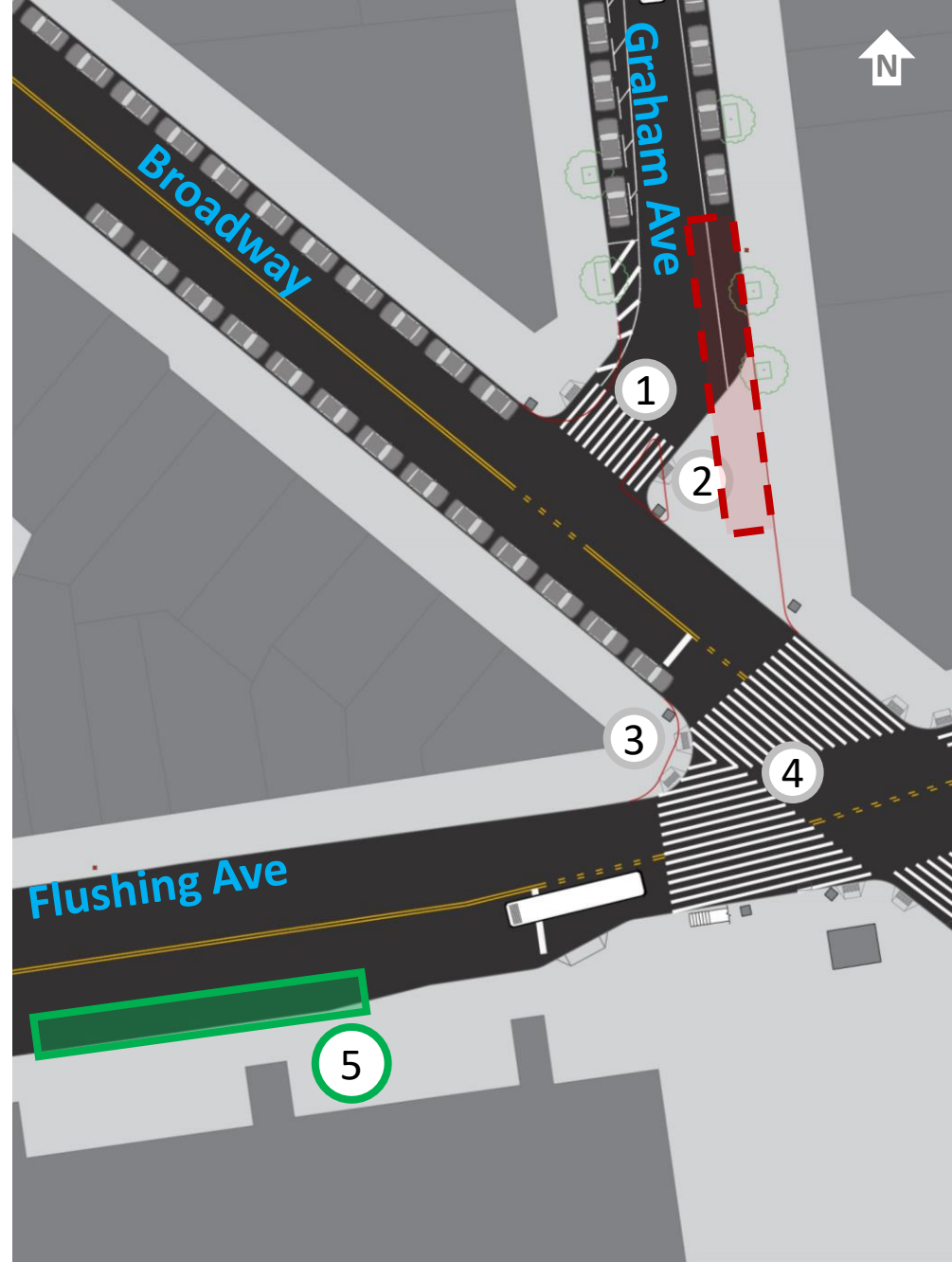

Graham Ave - Existing



Graham Ave – Proposed Rendering



Benefits

- Shorter, safer crossing distances
- Widened crossings to subway stairs
- Improved accessibility
- Clarified vehicular movements



Thank You!

Questions?



NYCDOT



nyc_dot



nyc_dot



NYCDOT