



2025 BQE Interim Repairs



Agenda

1. 2023/2024 Work
2. Ongoing Efforts
3. 2025 Efforts
 - Old Fulton Street
 - Joralemon Street
 - Columbia Heights
4. Timeline & Mitigations



2023/2024 Repairs: Grace Court & Clark Street

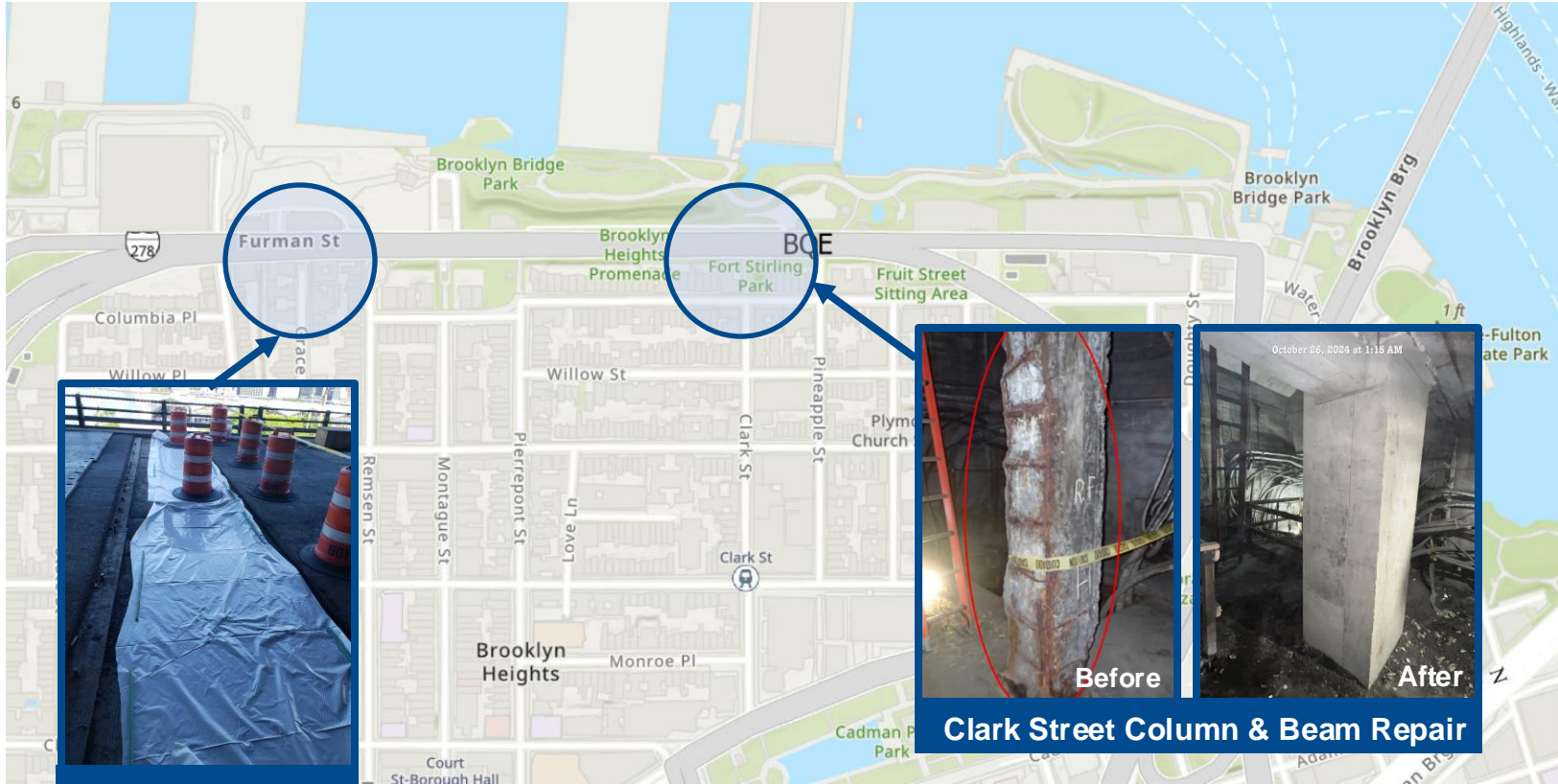

**QB Deck Joint
Near Grace Court**



Clark Street Column & Beam Repair

2023/2024 Repairs: Joralemon Street Garage



Ongoing Efforts: Truck Weight Limit Enforcement Using WIM



- Since implementation, 60% decrease in overweight vehicles on Queens-bound roadway
- Staten Island-bound
 - Warnings began **March 24th**
 - Violations begin **June 22nd**

Enforcement at BQE QB Aug 2023 – Oct 2024

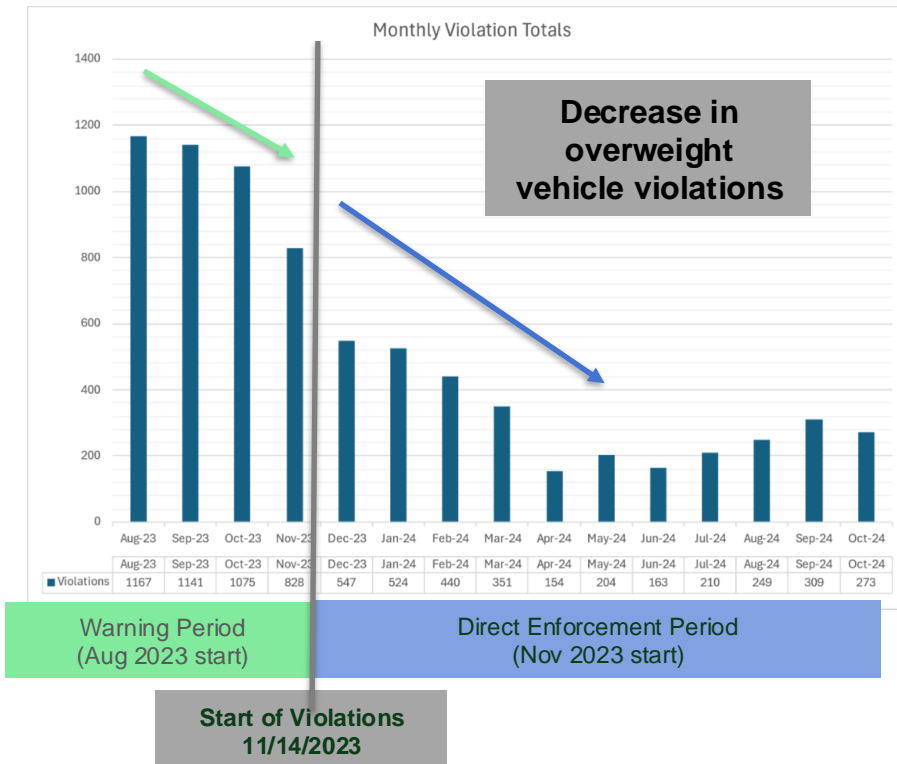

Safety First: Ongoing Inspections & Analysis



In-Person Inspections by DOT Engineers

Quarterly visual inspections detect any localized cracking, concrete spalling, steel corrosion, and other visible flags



Constant Monitoring via Sensors

Sensors and specialized instruments monitor changes in global stiffness, concrete cracking, and vibrations



Analysis and Modeling

DOT and outside engineering partners are using data from monitoring to assess structure's current condition and to model its future condition

2025: Structures with Planned Repairs



For discussion purposes only – subject to change and refinement



Old Fulton Street

Old Fulton Street Bridge

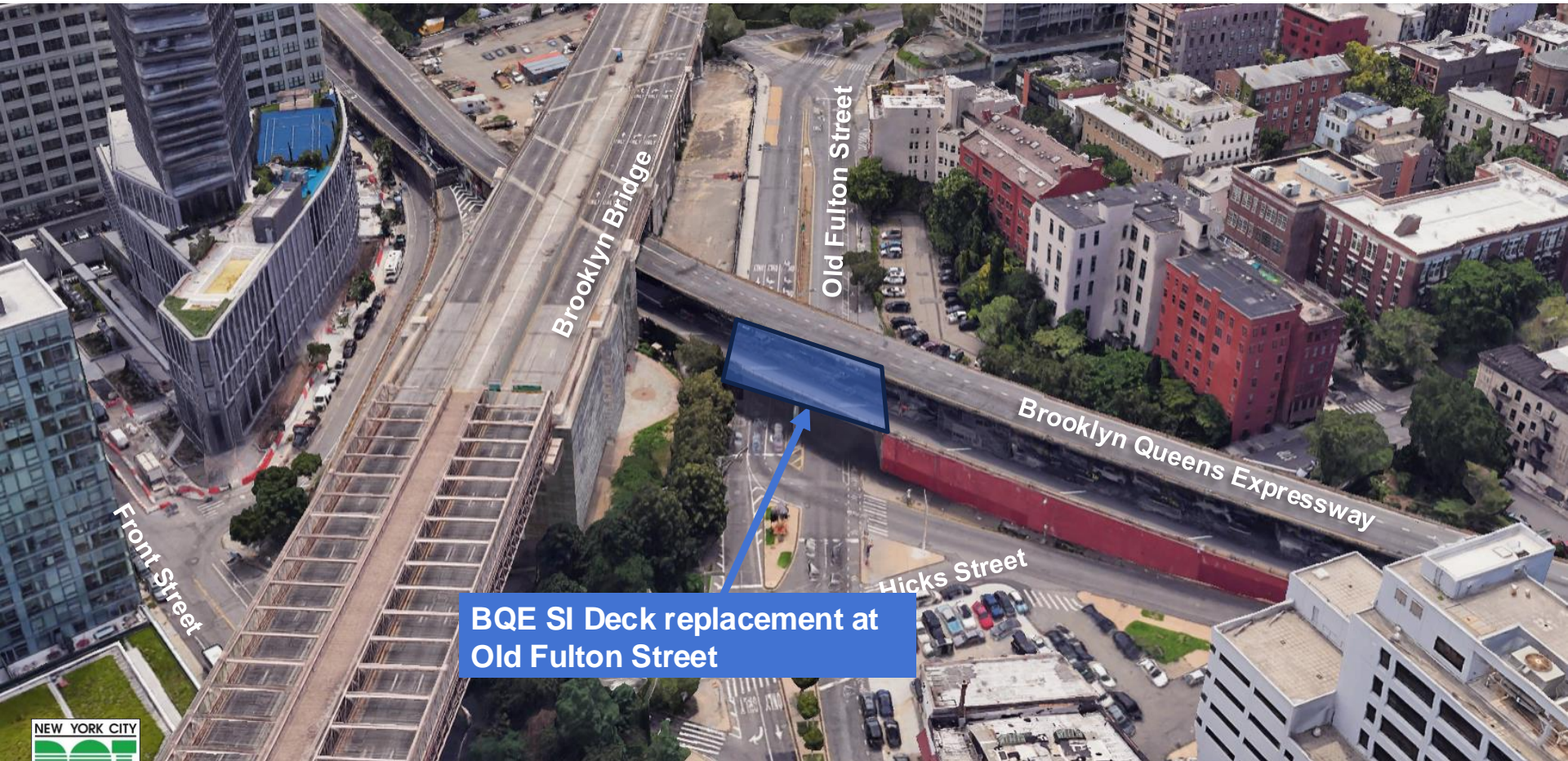

For discussion purposes only – subject to change and refinement

Old Fulton Street: At a Glance

Description:

Concrete deck replacement

Anticipated Duration:

2025 construction season

Start Date:

Early Summer (TBD)

Potential Impacts:

- **Old Fulton Street Closures**
- **BQE single lane closures**
- **Dust and noise**

Need:

- **Address through-holes reported in 2017 and February 2024**
- **Eliminate temporary steel plates currently in place**
- **Address additional potential areas identified during inspections**



Old Fulton Street: Construction Traffic Impacts

Local Streets

- Old Fulton Street lane closures during demolition of deck (overnight only)
- Brooklyn Bridge Off Ramp Traffic to be detoured
- Detour map to be shared when finalized

SIB BQE over Old Fulton

- Staged construction:
 - Maintaining two 11 ft lanes open for most of the construction
 - Night work maintaining one 12 ft wide lane open
 - 4 Weekends maintaining one lane open
 - Map with limits of lane closure to be shared when finalized



Old Fulton Street Construction Staging – Stage 1

Right Shoulder/Lane Deck Replacement

Work Zone:

- Continuous Closure of Right Shoulder Lane
- Overnight single lane closure between 1 am and 5 am.

Work:

- Remove concrete deck and barrier
- Place new reinforcement and concrete deck
- Place new steel railing

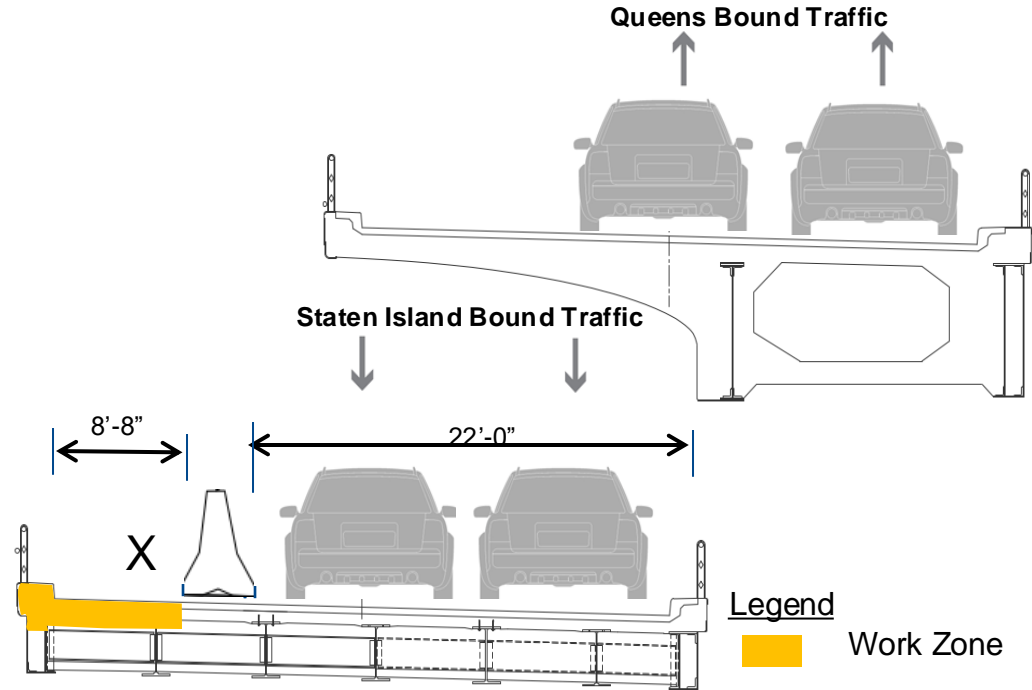

Old Fulton Street Construction Staging – Stage 2

Left Lane Deck Replacement

Work Zone:

- Shift 2 lanes to right, continuous closure of left side
- Overnight single lane closure between 1 am and 5 am.

Work:

- Remove concrete deck and barrier
- Place new reinforcement and concrete deck
- Place new steel railing

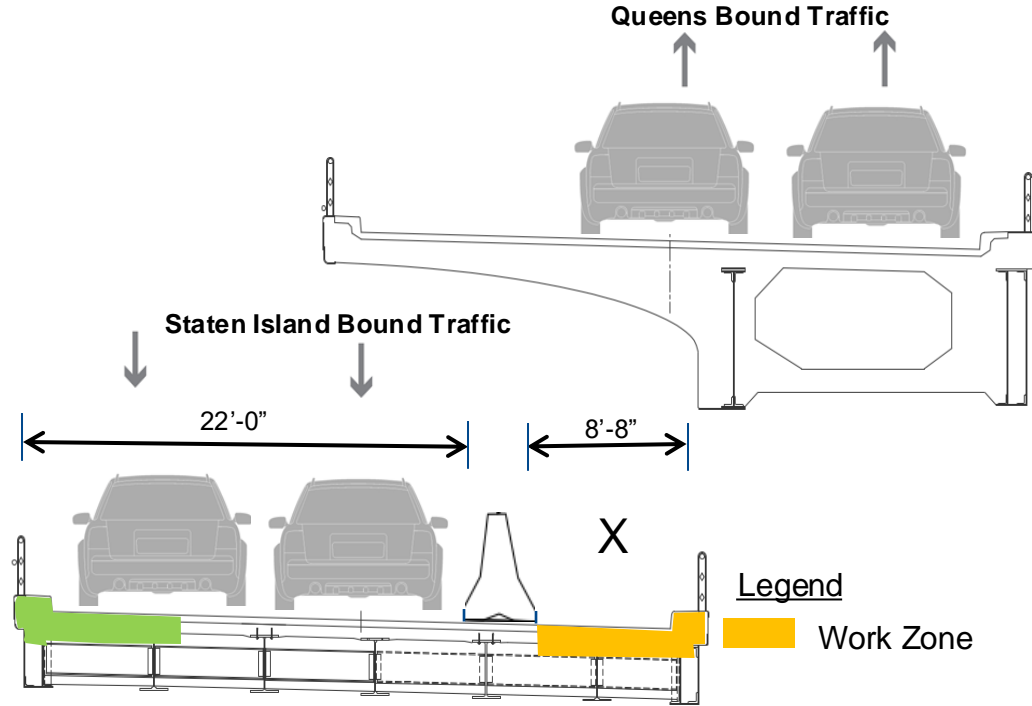

Old Fulton Street Construction Staging – Stage 3

Center Lane Deck Replacement

One 52-hour weekend closure of one lane (One lane available to traffic)

Work Zone:

- 1 lane open on right side of deck for 52-hour weekend
- Old Fulton lanes below closed to traffic overnight for demolition

Work:

- Remove concrete deck
- Place new reinforcement and concrete deck

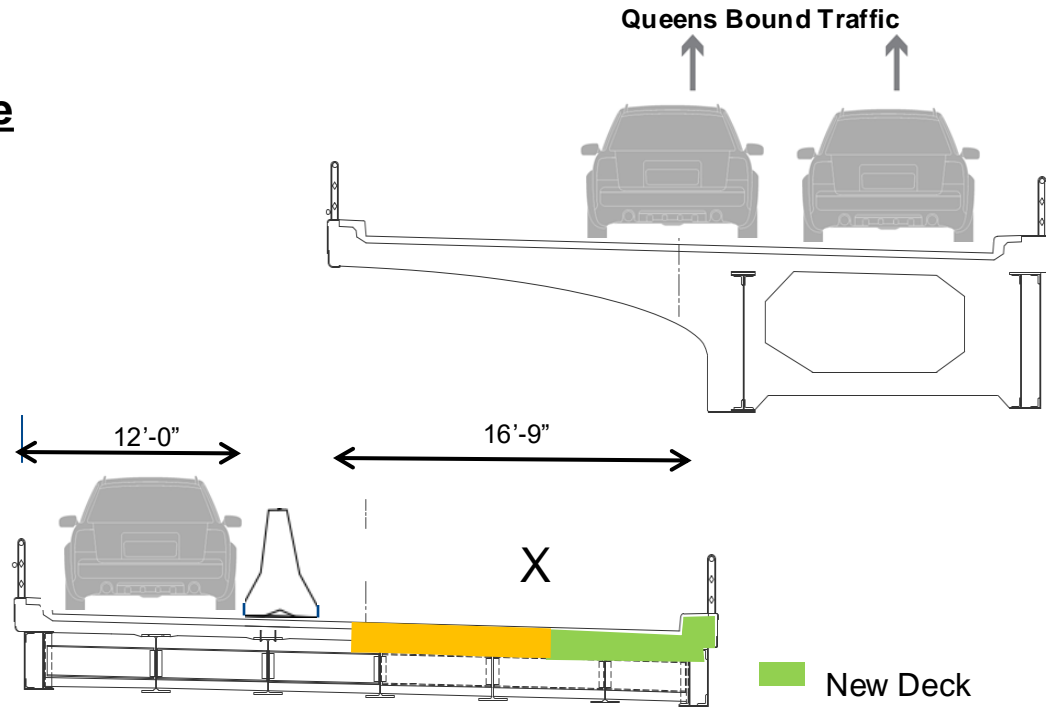

Old Fulton Street Construction Staging – Stage 4

Center Right Deck Replacement

One 52-hour weekend closure of one lane (One lane available to traffic)

Work Zone:

- 1 lane open on left side of deck for 52-hour weekend
- Old Fulton lanes below closed to traffic overnight for demolition

Work:

- Remove concrete deck
- Place new reinforcement and concrete deck

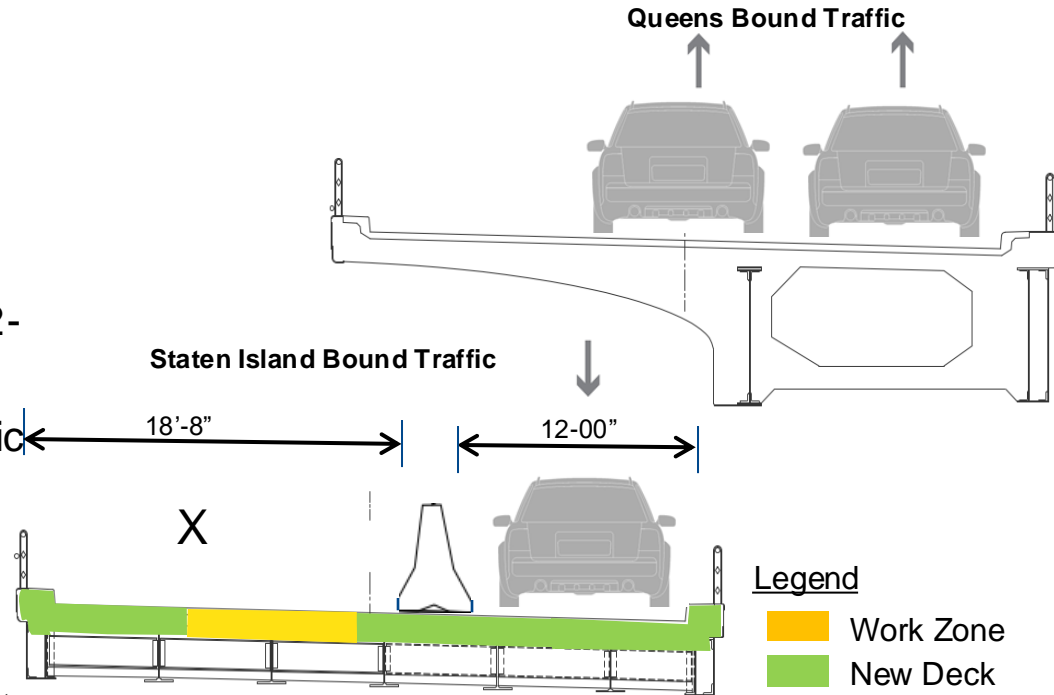

Old Fulton Street Construction Staging – Stage 5

Deck Finishing and Miscellaneous Work

Work Zone:

- BQE SIB: maintain one lane at night

Work:

- Pavement grooving
- Pavement striping

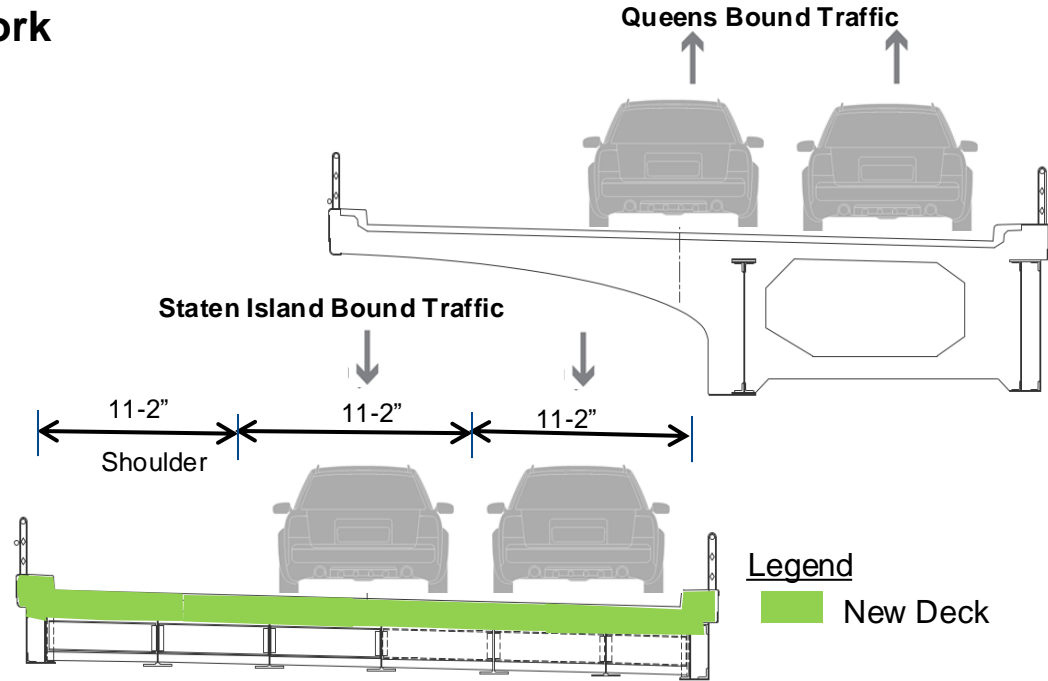



Joralemon St North Abutment

Joralemon Street: At a Glance

Description:

Repair of concrete abutment & deck joint

Anticipated Duration:

6 months

Start Date:

Early Summer (TBD)

Potential Impacts:

- **Furman Street Partial Closures**
- **Joralemon Street partial lane & north side sidewalk closures**
- **Limited nighttime BQE lane closures**
- **Dust and noise**

Need:

- **Repair spalled concrete and corroded steel to restore load-carrying capacity**



Joralemon Street: Construction Traffic Impacts

BQE: Limited nighttime lane closures.

Furman St.: shoulder closed for duration, partial closure for access during construction hours

Joralemon St: Partial lane and north sidewalk closure





Columbia Heights St Overpass

Columbia Heights: At a Glance

Description:

Repair of Columbia Heights deck joint, deteriorated concrete & cobblestone sidewalk

Anticipated Duration:

3-6 Weeks

Start Date:

Late Summer (TBD)

Potential Impacts:

- **3-week closure to through traffic on the bridge with additional partial closure**
- **Nighttime BQE lane Closures**
- **Temporary parking removal**
- **Temporary Citibike station removal**
- **Dust and noise**

Need:

- **Repair deteriorated and leaking deck joints, which currently have steel cover plates**
- **Address underdeck concrete spalling**
- **Address corrosion of reinforcing bars due to water leakage at joints**
- **Eliminate need for deck plates**
- **Repair sidewalk**



Columbia Heights Street: Work Plan & Traffic Impacts

Work Plan:

- Remove the asphalt
- Remove deteriorated concrete
- Repair deck joints
- Replace asphalt
- Remove sidewalk by sections and address local conditions as needed

Traffic Impacts to Local Streets:

- Columbia Heights partial and full closure (daytime)

Traffic Impacts to BQE:

- SIB and QB lane closures (overnight)



Columbia Heights Street: Through Traffic

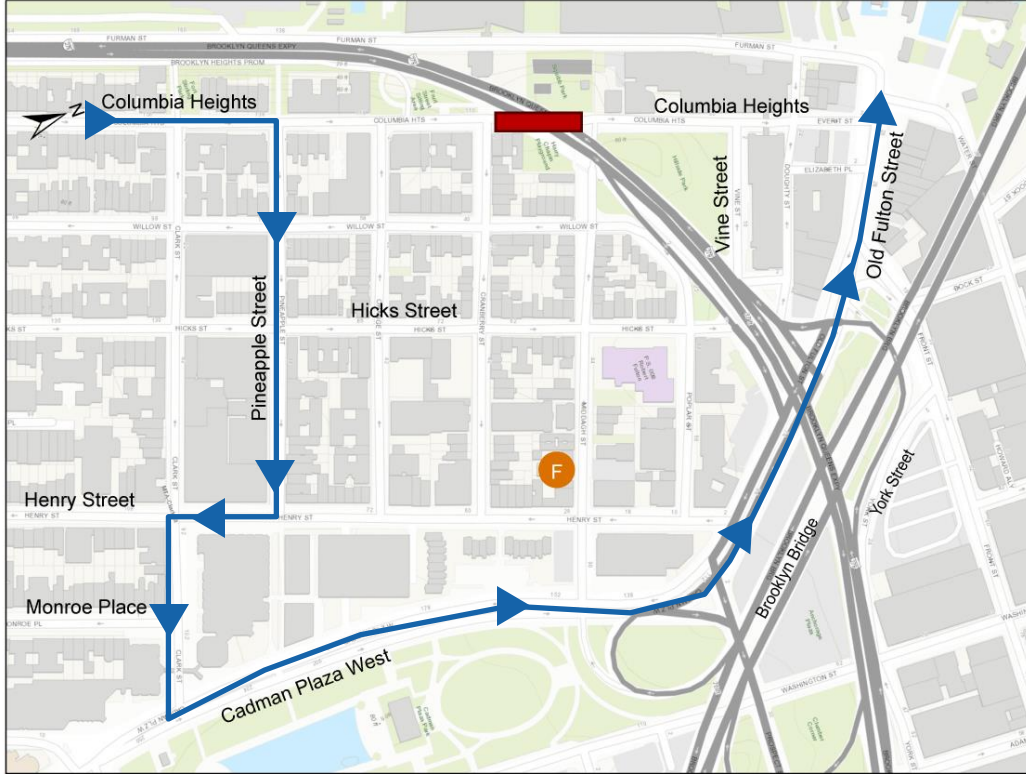

Construction Impacts

- Access to Columbia Heights residences maintained at all times
- Access to Harry Chapin Playground maintained at all times

 Closure  Detour Route  Fire Dept.



Columbia Heights Street: Local Traffic

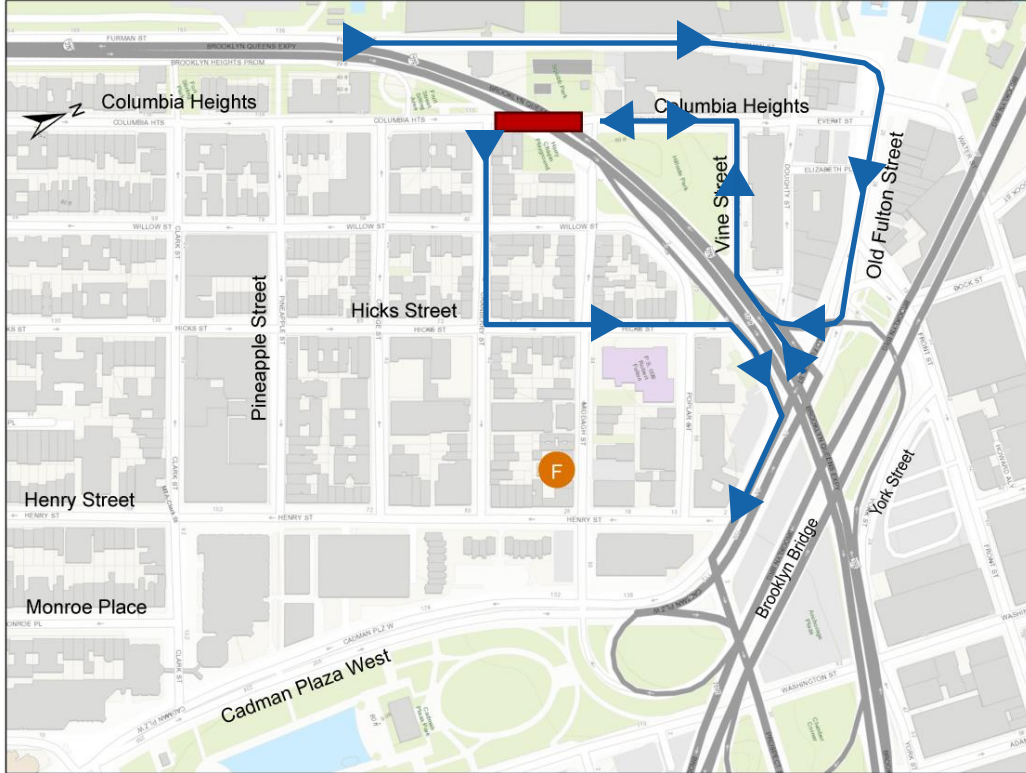

Construction Impacts

- Access to Columbia Heights Residences maintained at all times
- Access to Harry Chapin Playground maintained at all times
- Emergency Vehicle Access to be maintained at all times

 Closure  Detour Route  Fire Dept.





Timeline & Mitigations

Construction Timeline - Recap

- Overnight closures for Old Fulton Street between June – November 2025
 - Four non-consecutive weekends spread out over the construction season where only one lane available on SIB BQE
- Joralemon Street garage repairs will occur concurrently – limited overnight BQE single-lane closures needed
- Columbia Heights closed for through traffic approx. 3 weeks, additional work before and after

Additional schedule information will be shared as details are confirmed.



Mitigation measures

Staten Island Bound BQE – One Lane Closures

- Traffic agents at key locations
- VMS signs and media outreach informing travelers of closures/detours
- Encourage alternate modes of transportation

General Construction

- Noise mitigation
- Sound blankets and monitoring sound levels
- Dust mitigation



Next Steps

- Distribute one-pager to notification network
- Continue finalizing construction details
- Share updates as they become available
- Establish office-hours during construction period

Questions or Concerns?
Contact: Anita Navalurkar
(347) 647-0876
Anavalurkar.consultant@dot.nyc.gov



Thank you!
Questions?