



# BOSTON RD WARING AVE TO PELHAM PKWY N

Presentation to Bronx Community Board 11

May 1, 2017

# PROJECT AREA

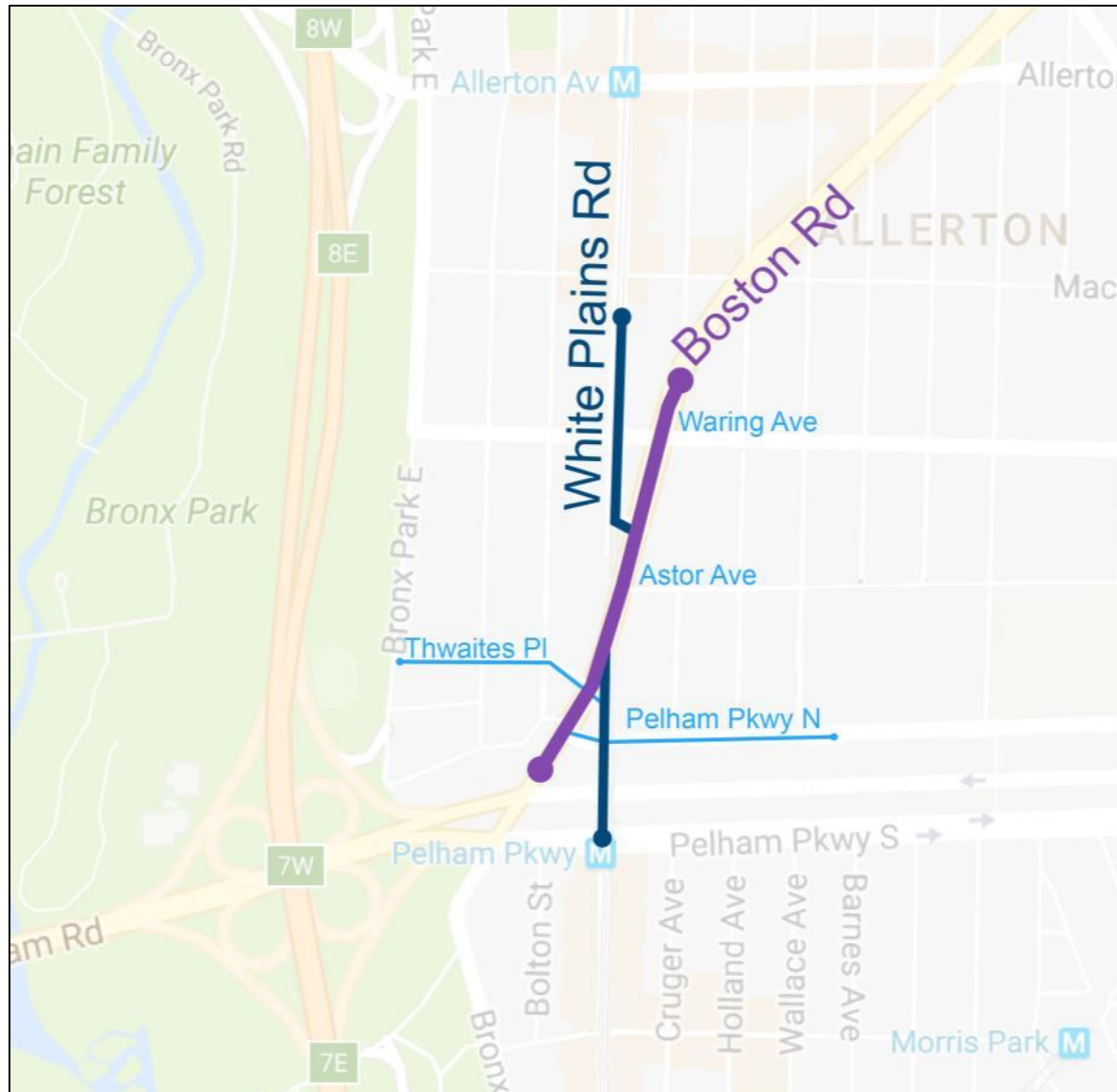

# PROJECT AREA

Central to transit,  
schools, park, retail,  
dense housing





# CRASH HISTORY

- Boston Road and White Plains Road are Vision Zero Priority Corridors
- Boston Road at Thwaites Place; Boston Road at Pelham Pkwy North are Vision Zero Priority Intersections
- 5 severe pedestrian injuries at Thwaites Pl and Boston Rd (4 in the north crosswalk)

Boston Rd - Waring Ave to Pelham Parkway North, BX  
Injury Summary, 2010-2014 (5 Years)

	Total Injuries	Severe Injuries	Fatalities	KSI
Pedestrian	49	10	1	11
Bicyclist	10	2	0	2
Motor Vehicle Occupant	178	2	0	2
Total	237	14	1	15

Fatalities, 01/01/2010-4/24/2017 : 1

Source: Fatalities: NYCDOT  
Injuries: NYSDOT  
KSI: Persons Killed or  
Severely Injured

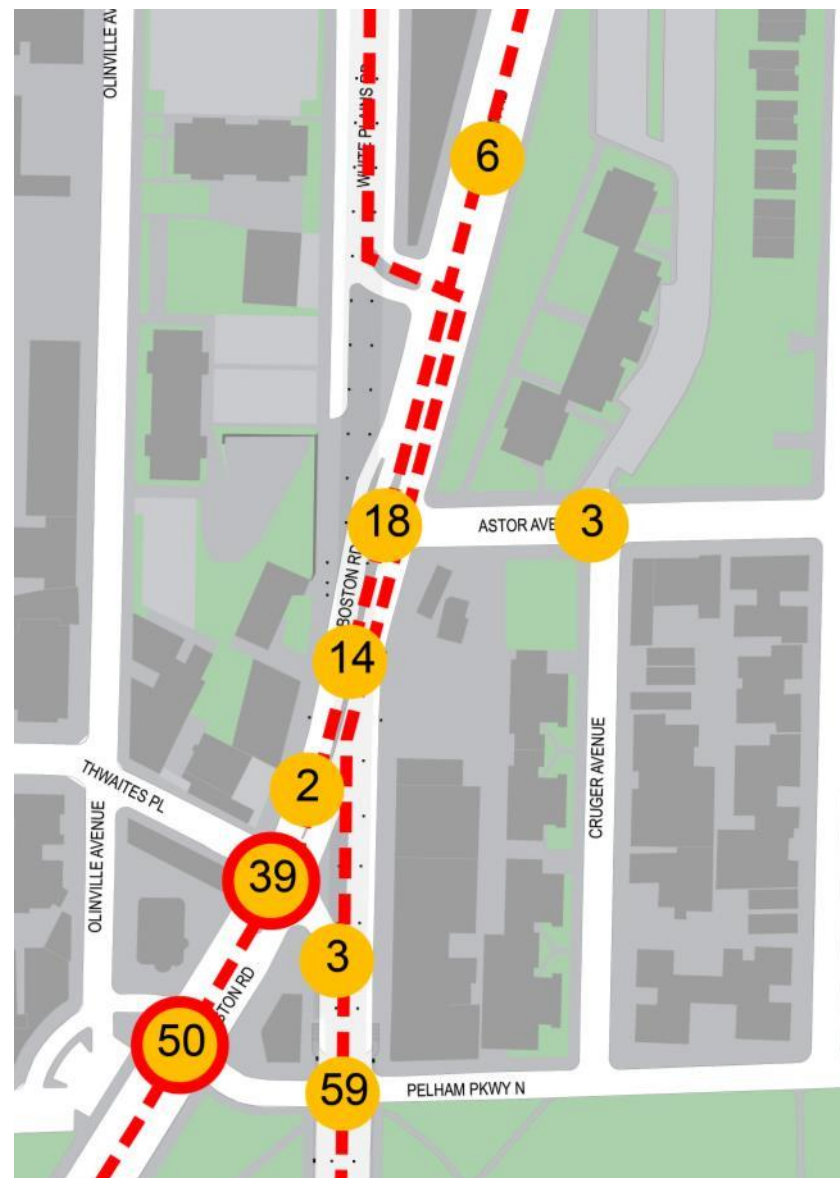

---

# EXISTING CONDITIONS

# 1

# EXISTING



Approximately 1000'  
between marked  
crosswalks on  
Boston Rd



Frequent midblock  
crossing

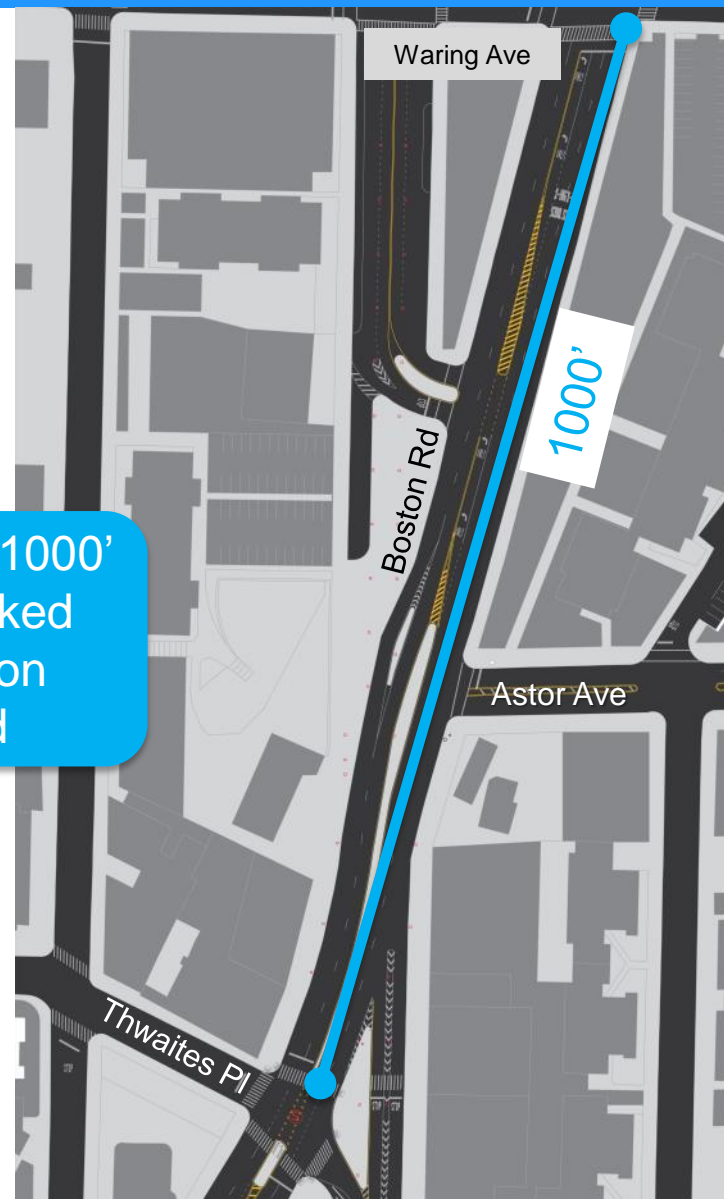

# EXISTING | BOSTON RD AND WHITE PLAINS

- Limited visibility for turning vehicles from White Plains Rd
- No pedestrian crossings
- Bus stop with no direct pedestrian access (BL60, 61, 62, Bx39)

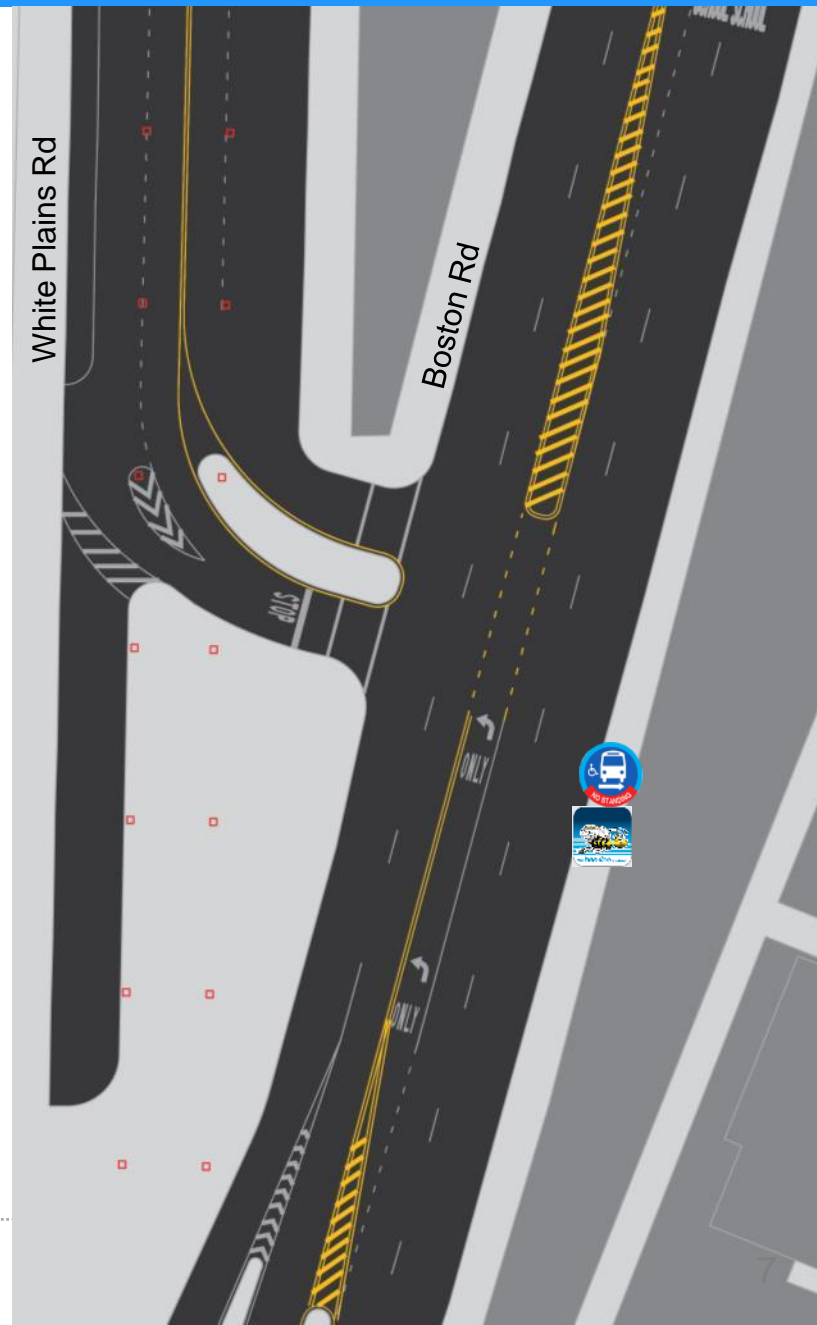



# EXISTING | BOSTON RD AND ASTOR AVE

- Limited access from Astor Ave
- No marked pedestrian crossing
- High pedestrian desire to cross mid-block

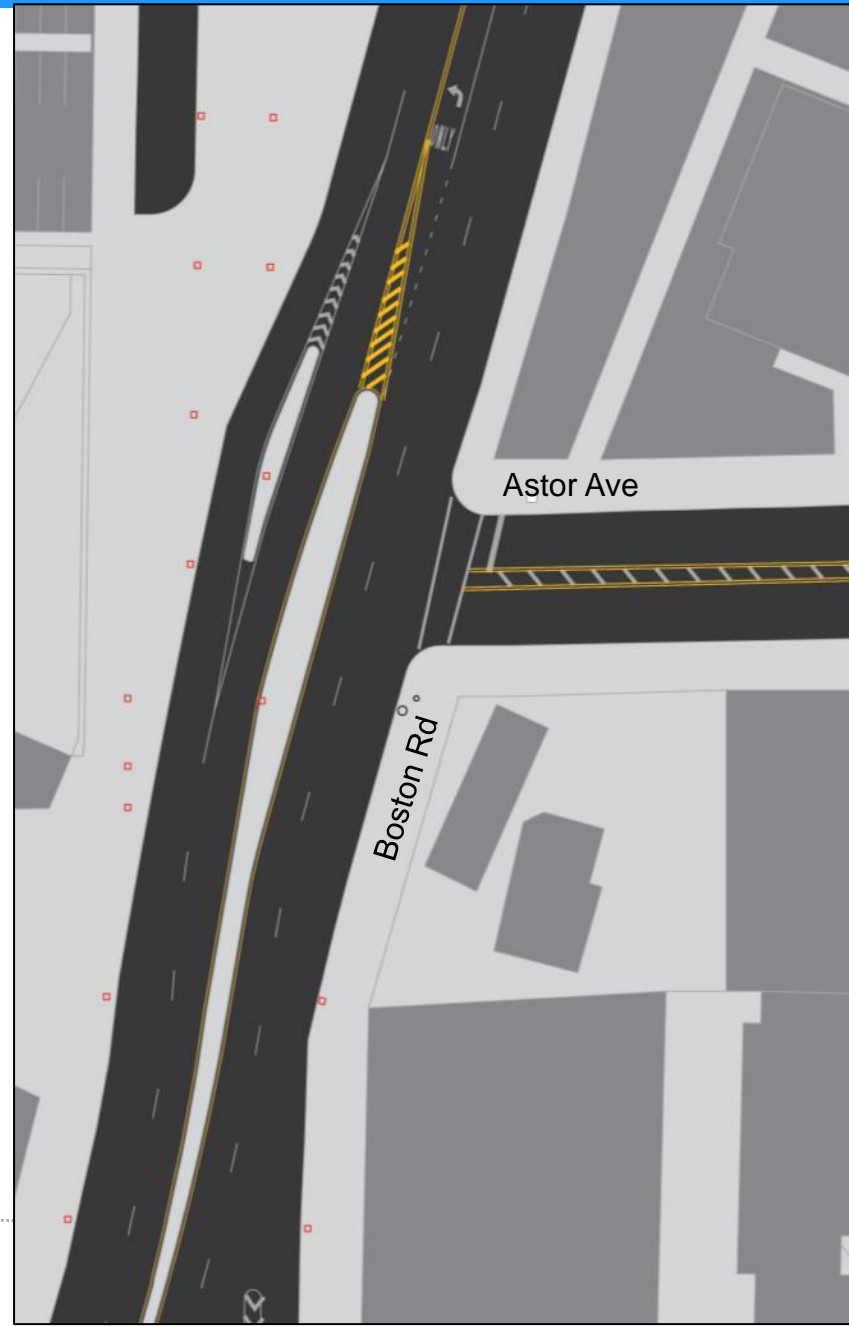



# EXISTING | BOSTON RD AND THWAITES PL

- North crosswalk at Thwaites Pl had 4 severe pedestrian injuries in 5 years
- Missing markings on White Plains Rd
- Bus Only left turns onto White Plains Rd
- Bus stop (BL60, 61, 62, Bx39) obstructs travel lane

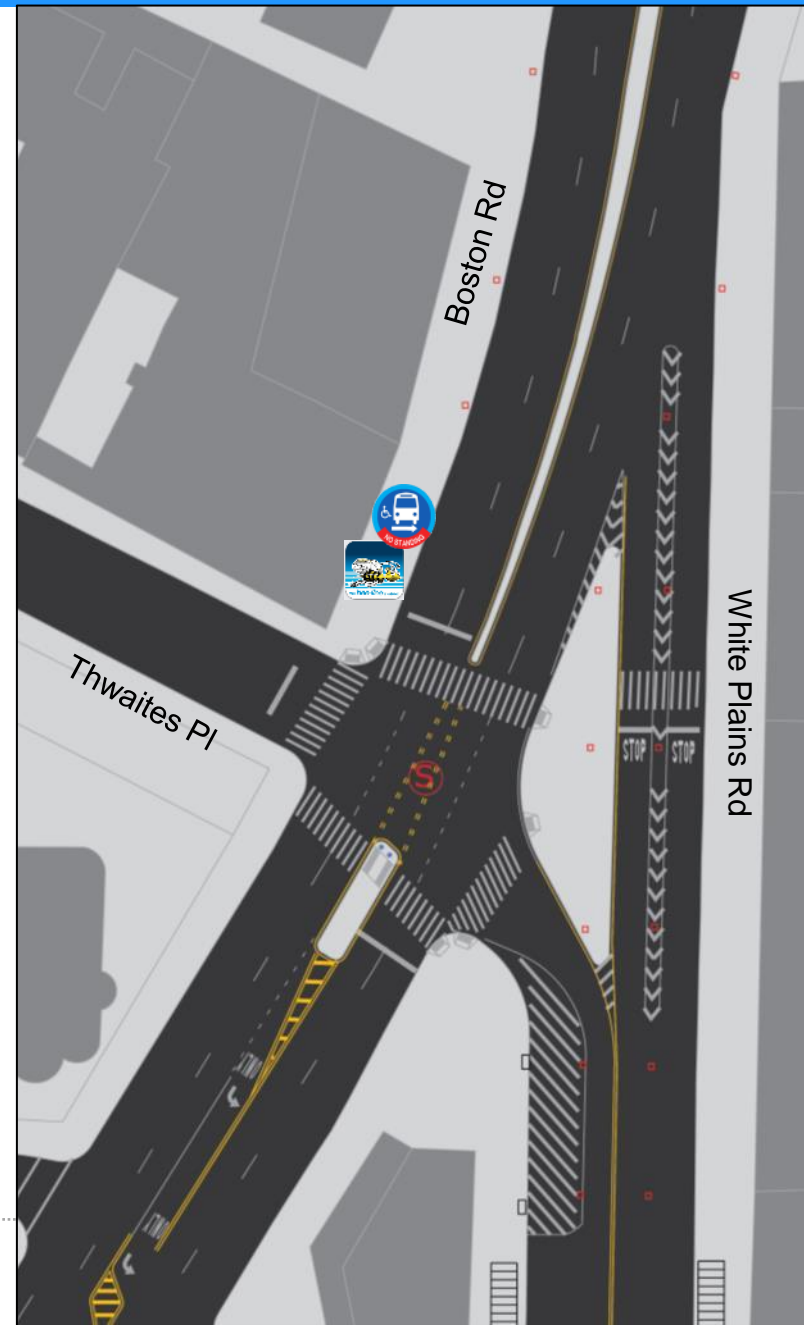

# EXISTING | BOSTON RD AND PELHAM PKWY N

Misalignment of left turn lanes

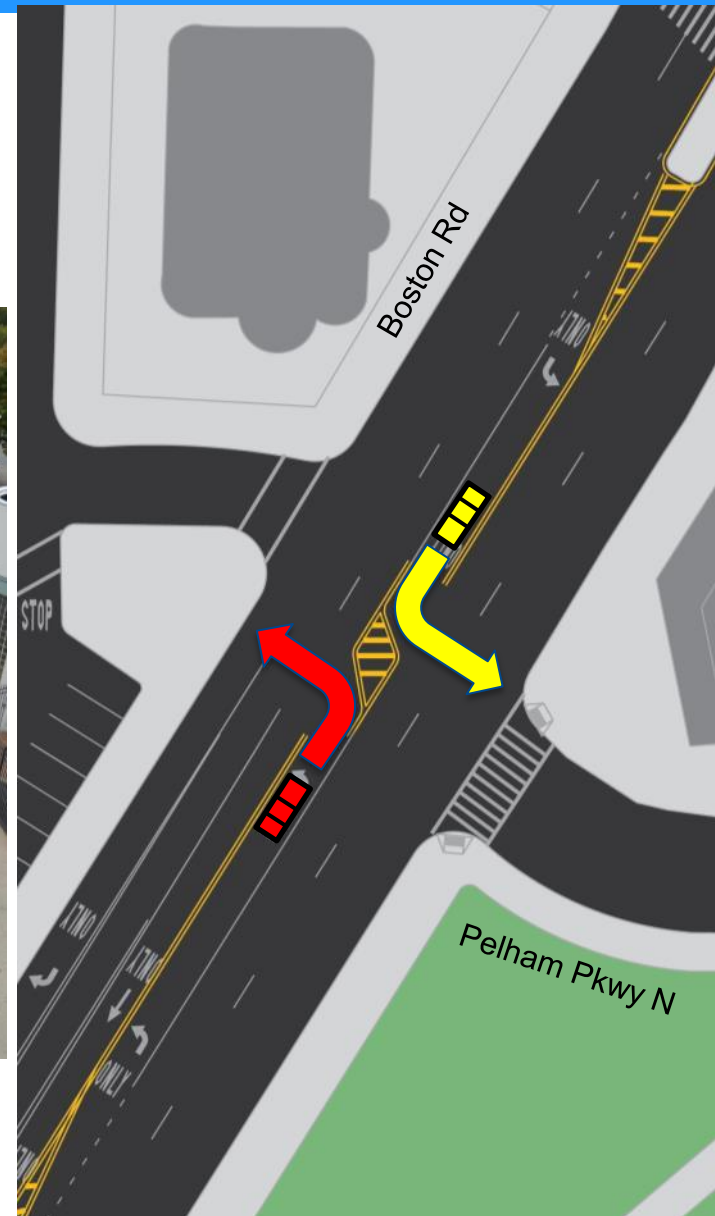
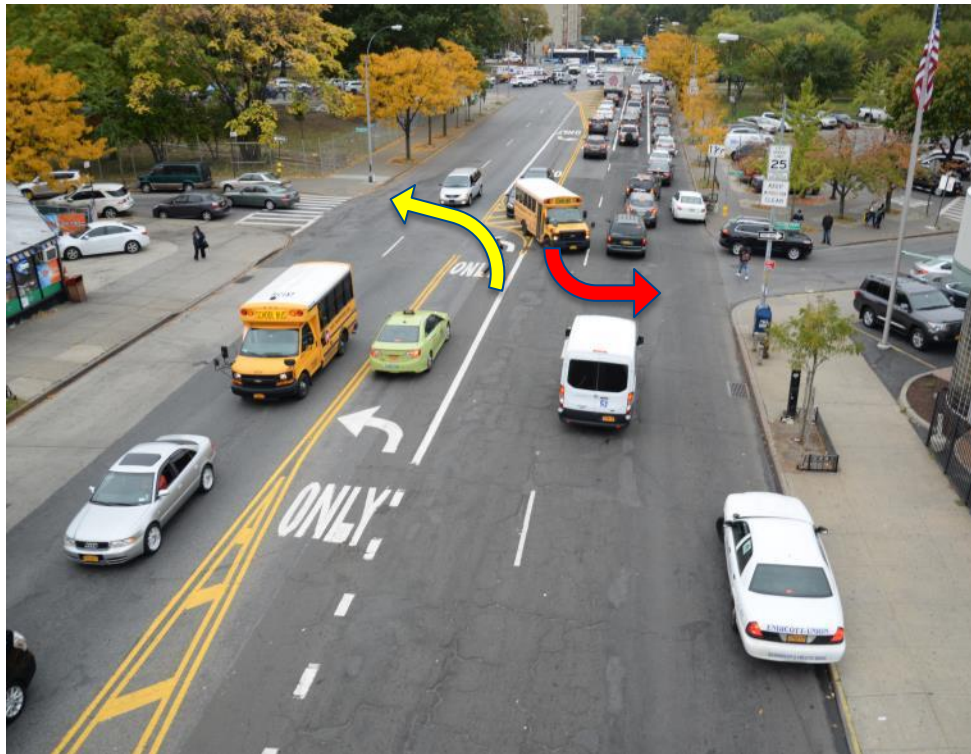

---

Proposal

2



# EXISTING | BOSTON RD AND WHITE PLAINS RD

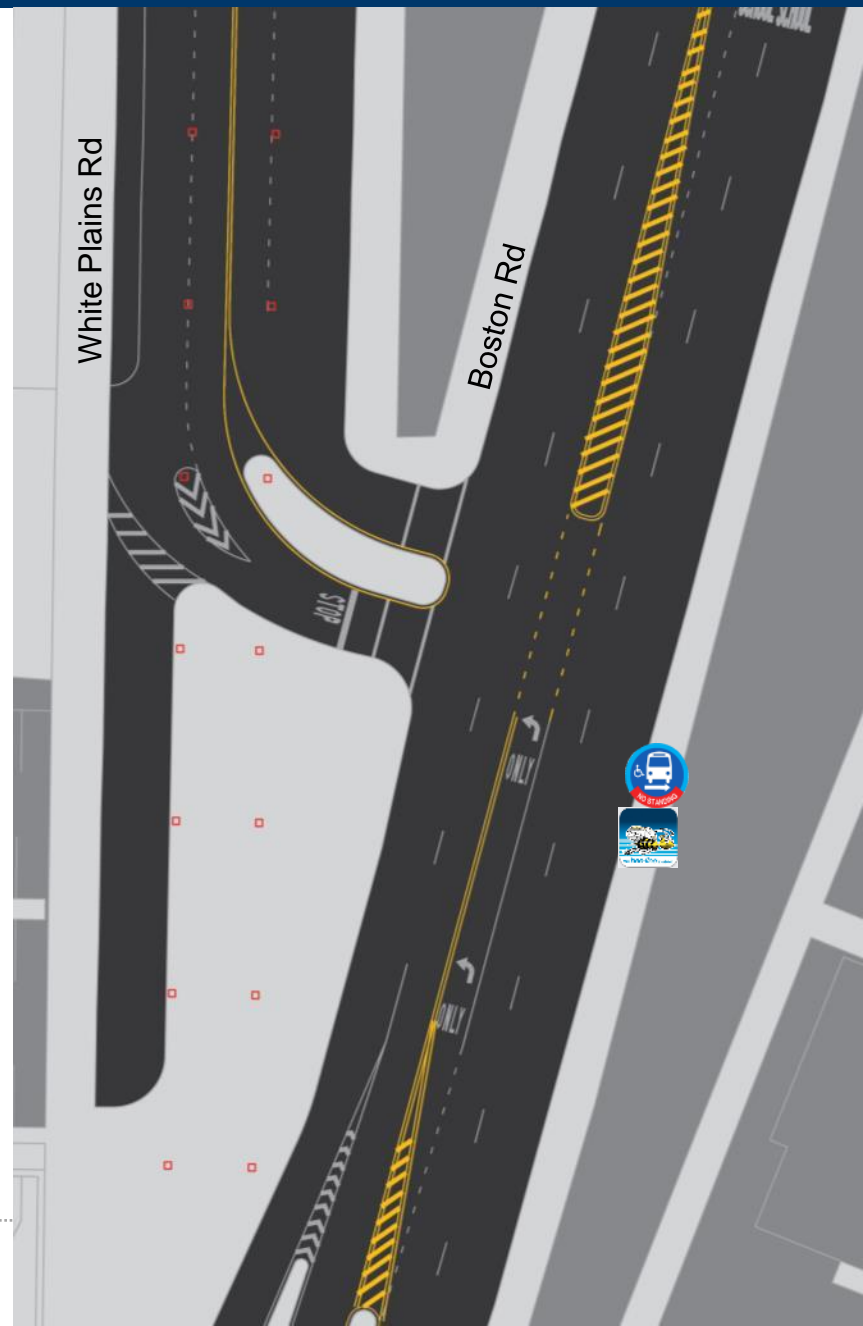

# PROPOSAL | BOSTON RD AND WHITE PLAINS RD

Install traffic signal at Boston Rd and White Plains Rd (under investigation) to reduce turning traffic at Waring Ave

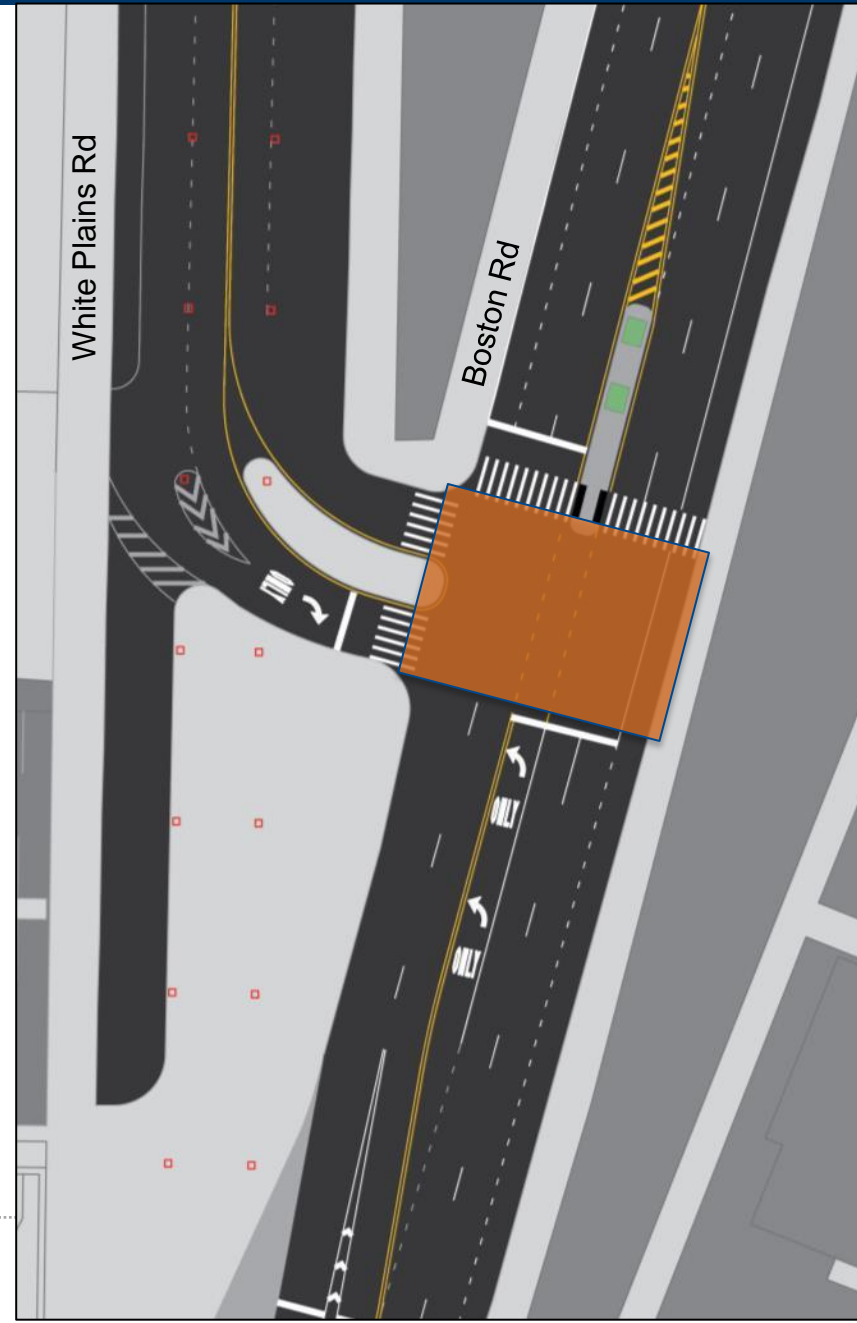

# PROPOSAL | BOSTON RD AND WHITE PLAINS RD



New pedestrian safety island and crosswalk on north leg of intersection

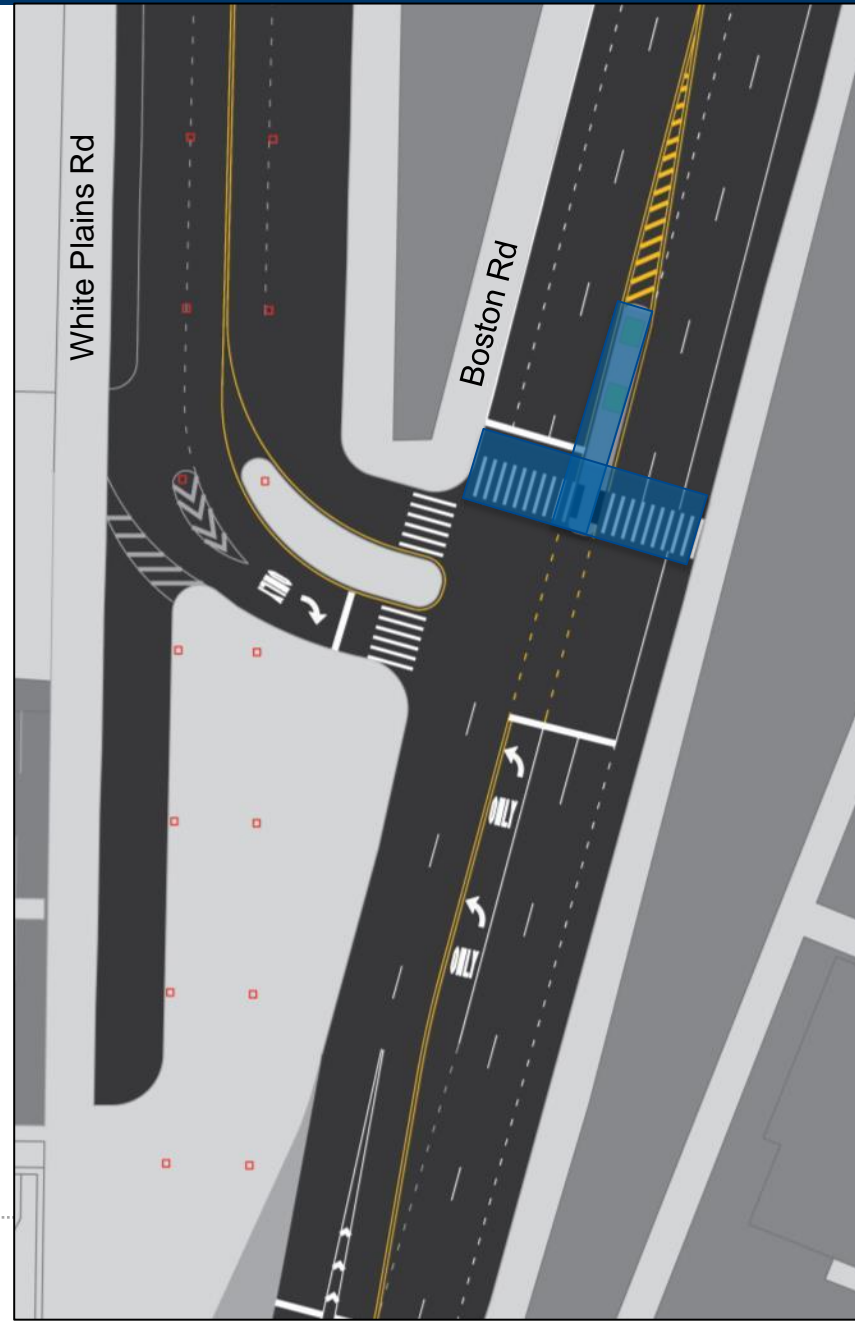



# PROPOSAL | BOSTON RD AND WHITE PLAINS RD



White Plains Rd traffic must turn right

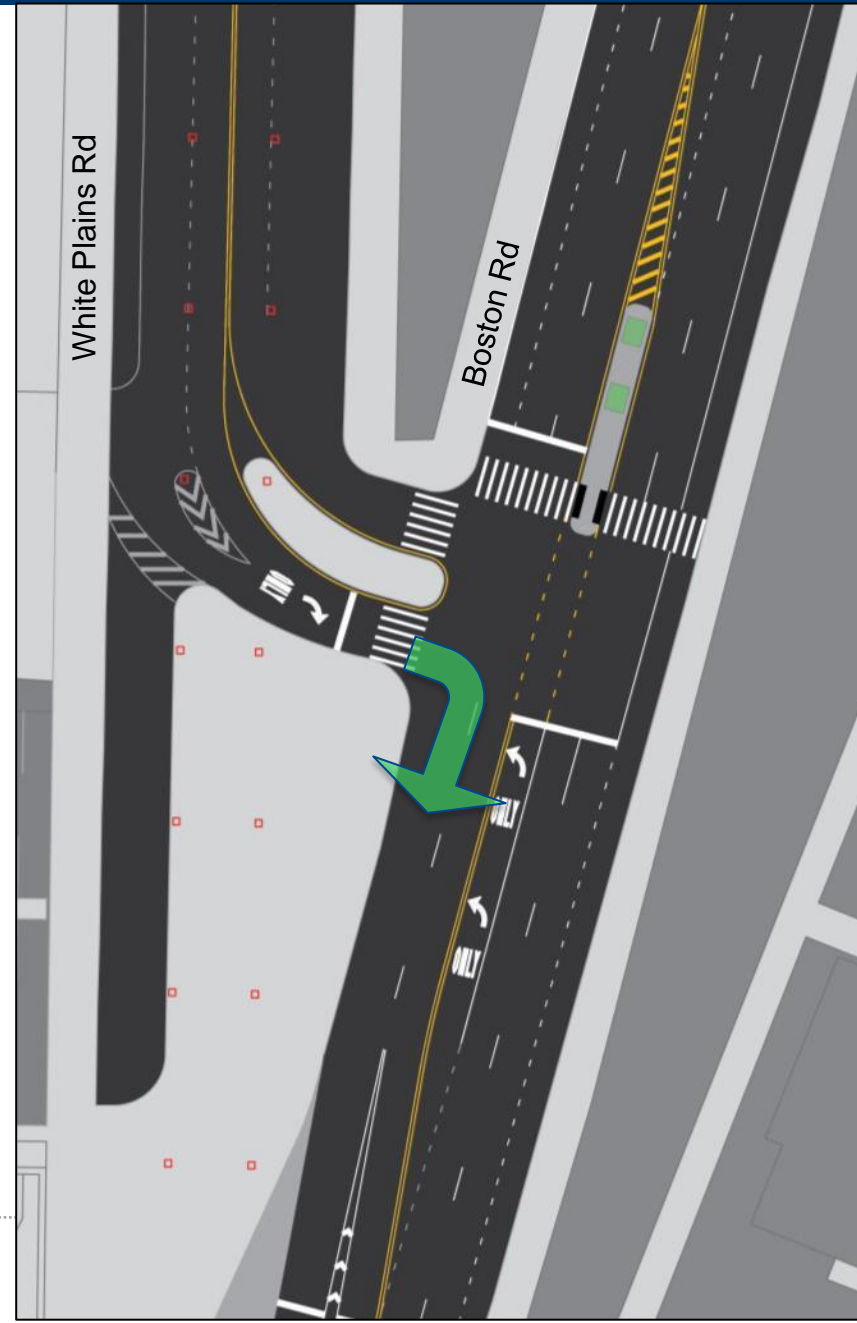

# EXISTING | BOSTON RD AND ASTOR AVE



# PROPOSAL | BOSTON RD AND ASTOR AVE

Install a traffic signal at Boston Rd and Astor Ave

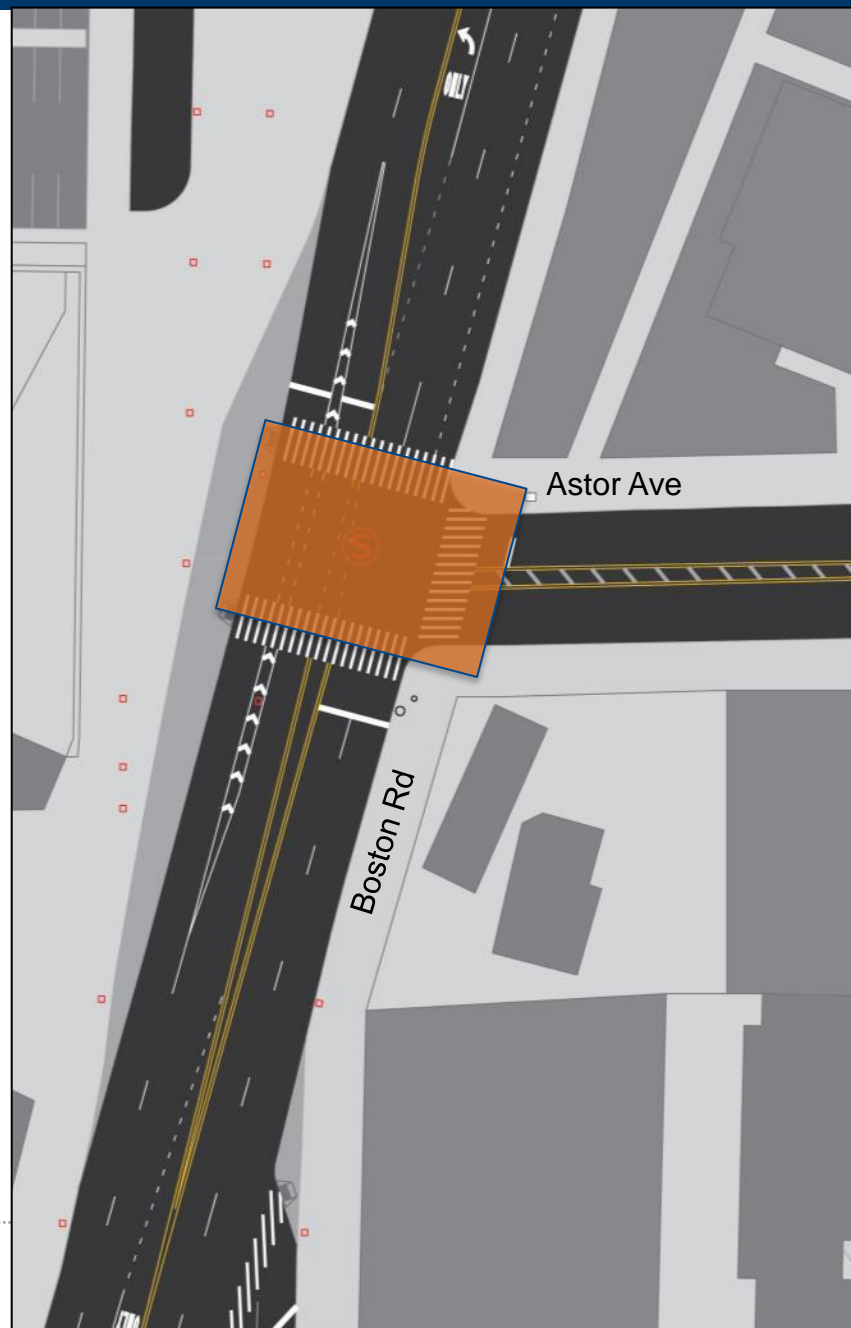
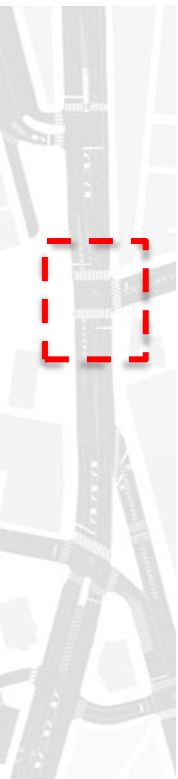



# PROPOSAL | BOSTON RD AND ASTOR AVE



Install new crosswalks across Boston Rd

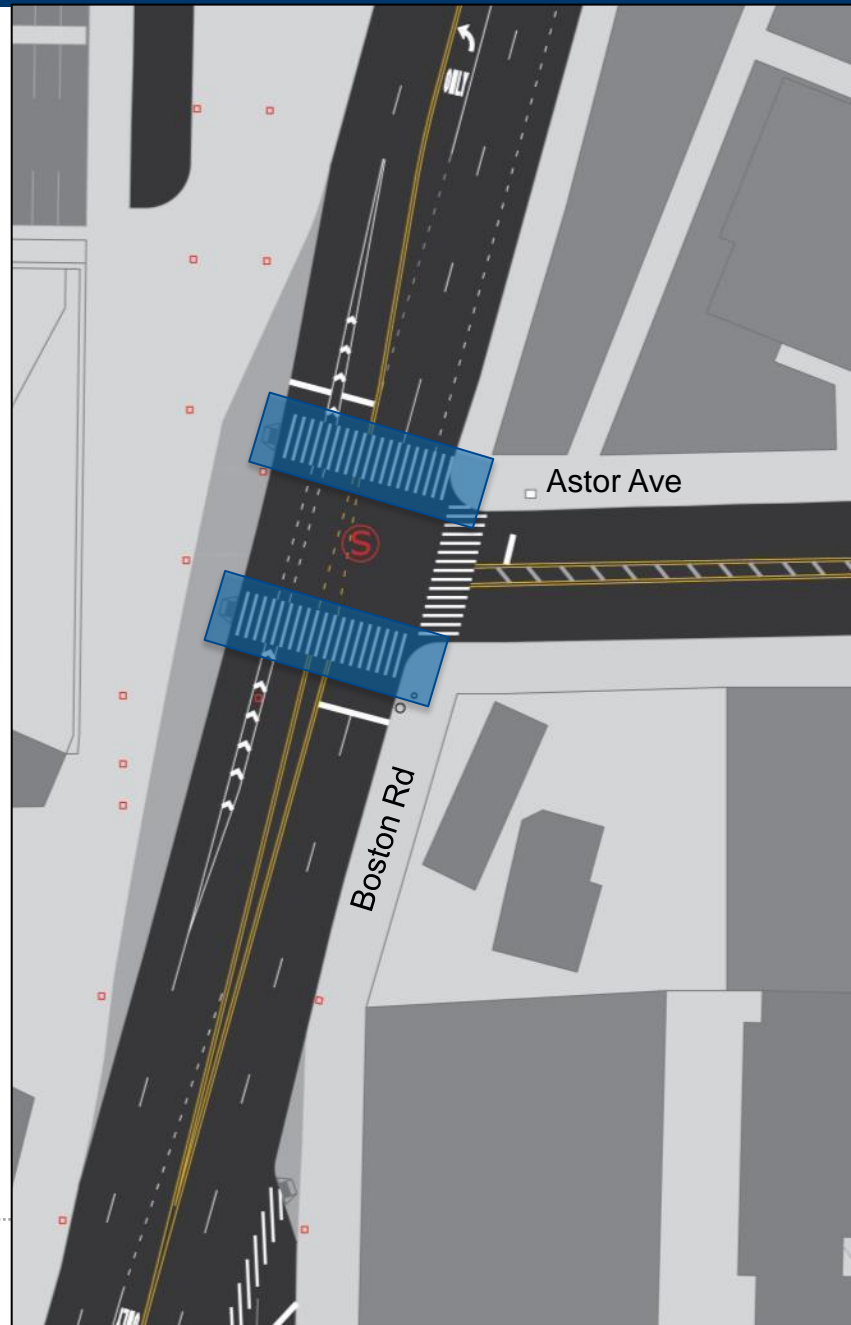

# PROPOSAL | BOSTON RD AND ASTOR AVE



Adjust misaligned roadway alignment



# PROPOSAL | BOSTON RD AND ASTOR AVE



Proposal facing south on Boston Rd at Astor Ave



# EXISTING | BOSTON RD AND THWAITES PL

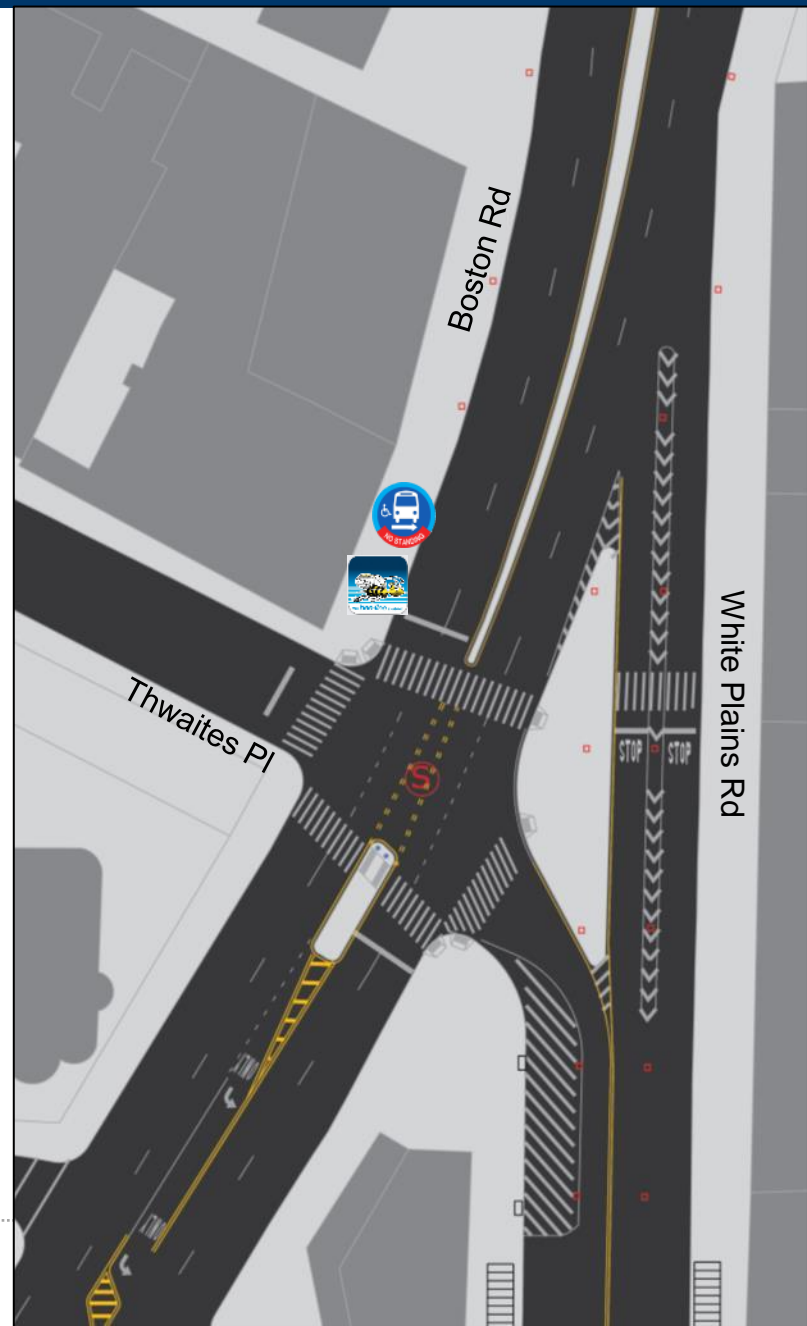
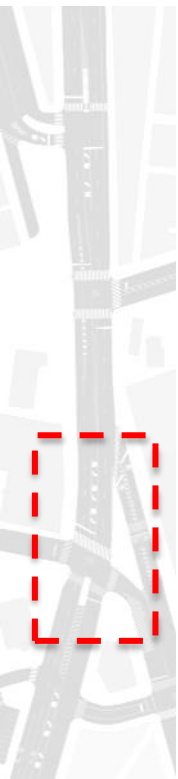

# PROPOSAL | BOSTON RD AND THWAITES PL

Add left turn lane on Boston Rd to White Plains Rd & allow all vehicles to turn

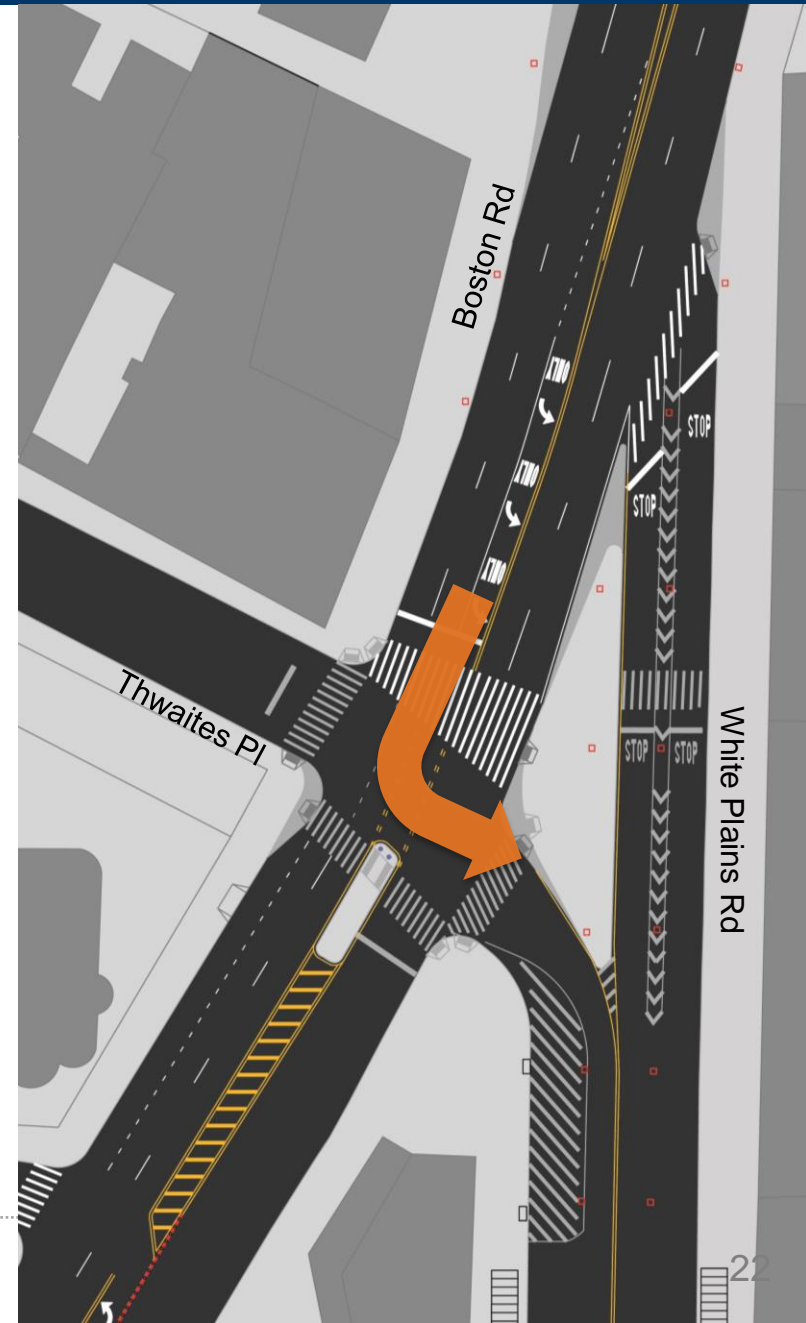
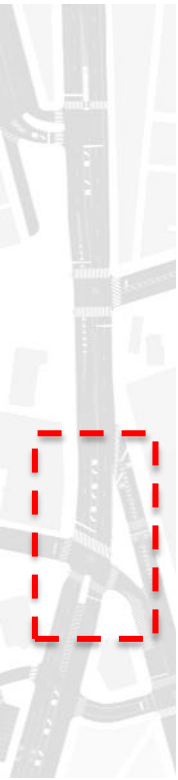

# PROPOSAL | BOSTON RD AND THWAITES PL

Create conflict free crosswalk by restrict low volume left turn from Thwaites Pl

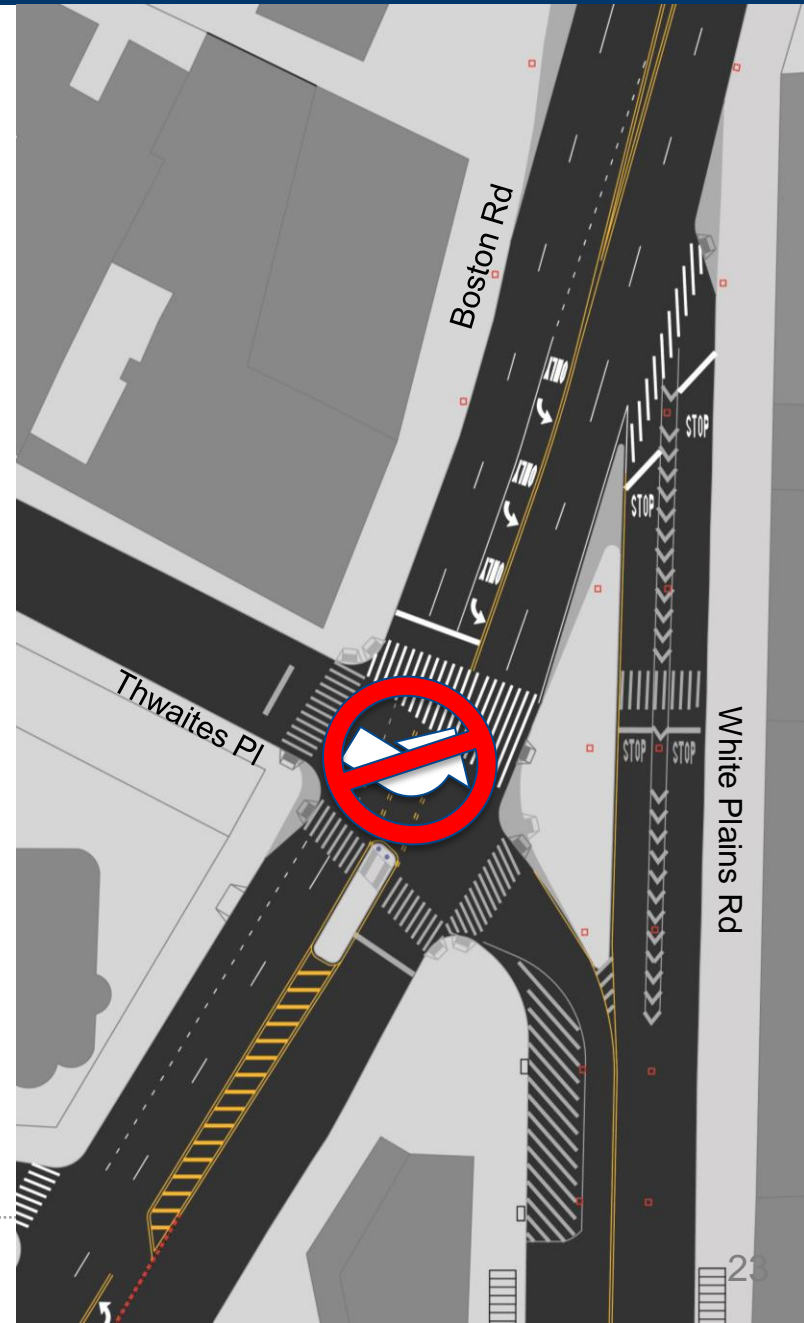

# PROPOSAL | BOSTON RD AND THWAITES PL

Extend large concrete triangle and  
build neckdowns

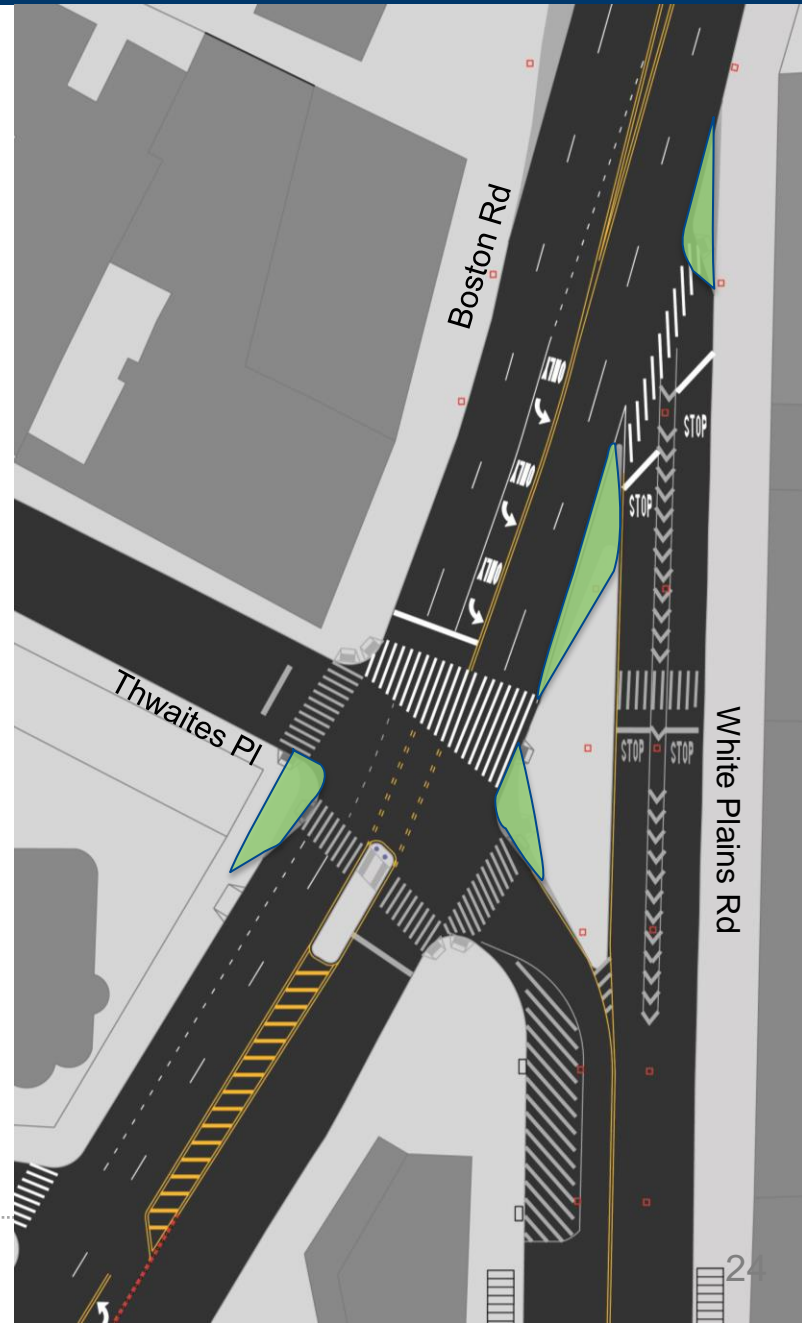



# PROPOSAL | BOSTON RD AND THWAITES PL



Add new crosswalk at White Plains Rd and Boston Rd

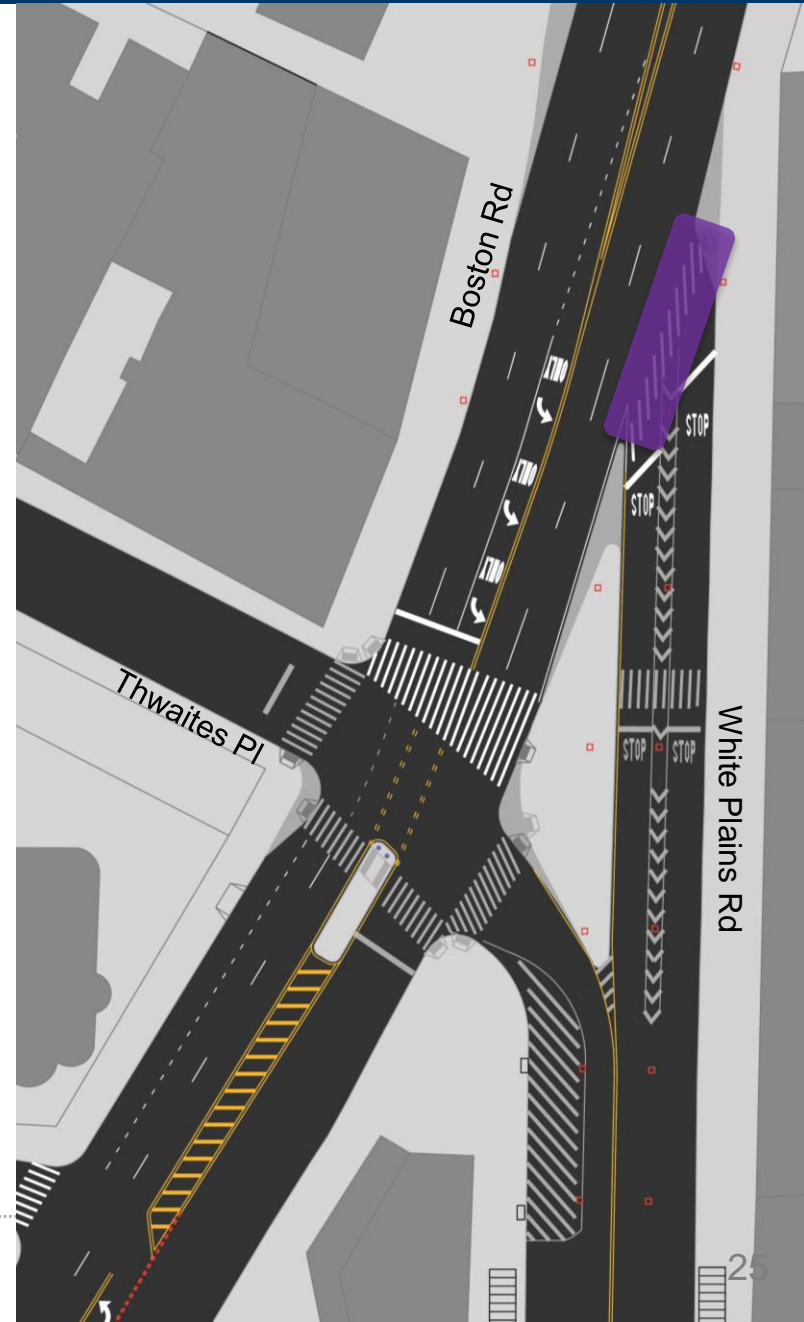

# PROPOSAL | BOSTON RD AND THWAITES PL

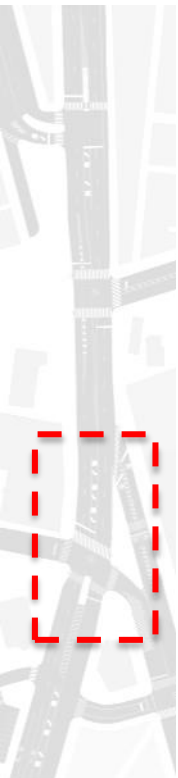

Relocate bus stop to south side of Thwaites Pl

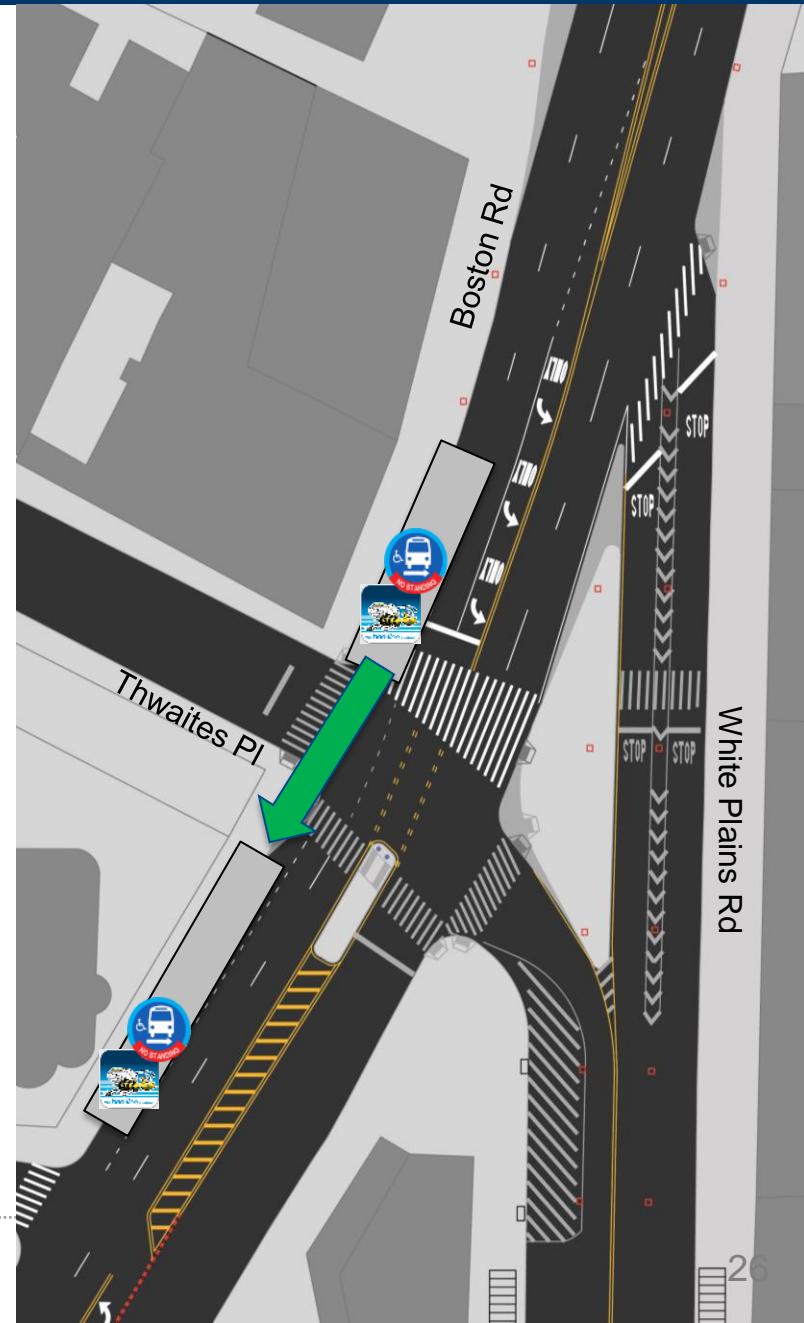

# PROPOSAL | BOSTON RD AND THWAITES PL



Proposal facing north on Boston Rd at Thwaites Pl

# EXISTING | BOSTON RD AND PELHAM PKWY N

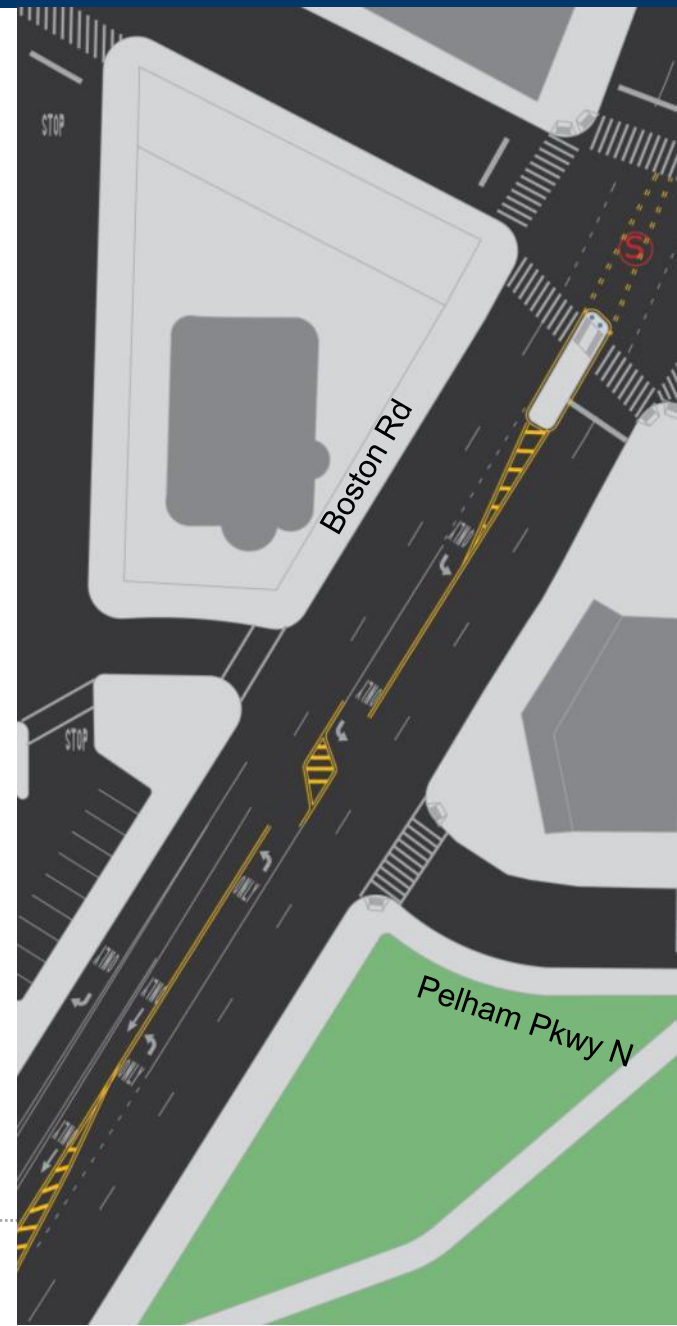



# PROPOSAL | BOSTON RD AND PELHAM PKWY N

Realign left turn lane on Boston Rd  
northbound at Pelham Pkwy N



# PROPOSAL | BOSTON RD AND PELHAM PKWY N

Restrict Southbound left onto Pelham Parkway North and install Qwik curb bollards (traffic will turn left at Thwaites PI)



# BENEFITS

---

- New crossings
- Reduces speeding / calm traffic
- Shortens pedestrian crossings
- Clarifies traffic movements
- Improved bus stop location





# SUMMARY

---

- Install new signals at Boston Rd at Astor Ave & Boston Rd at White Plains Rd
- Install 3 new crosswalks across Boston Rd at Astor Ave and White Plains Rd
- Mark left turn lane with exclusive left turn phase on Boston Rd southbound onto Thwaites Pl
- Restrict low volume left turn from Thwaites Pl onto Boston Rd
- Remove median on Boston Rd, Astor Ave to Thwaites Pl
- Widen sidewalk on Boston Rd at Astor Ave
- Realign left turn lane lane on Boston Rd at Pelham Pkwy N
- Construct neckdown on White Plains Rd at Boston Rd
- Extend concrete triangle on Boston Rd at Thwaites Pl/White Plains Rd
- Build neckdown on Boston Rd at Thwaites Pl
- Relocate Westchester Bee Line bus stop at Boston Rd at Thwaites Pl to far side of intersection



# THANK YOU!

## Questions?



NYC DOT



NYC DOT



nyc\_dot



NYC DOT