

34th Street Enhanced Bus Priority

Community Board 4 Transportation Planning Committee, May 21, 2025



Table of Contents

1. Background and Work to Date
2. Proposal
3. Traffic Analysis
4. Summary and Next Steps

Background and Work to Date

Why 34th Street?

- Study area: 12th Avenue to FDR Drive
- Central Business District Tolling Program began in January 2025
- 28,000 daily bus passengers on the M34/M34-A SBS and express buses
- Slow crosstown bus speeds
- Critical crosstown service with connections to
 - MTA Subway, PATH, LIRR, NJ Transit, and Amtrak
 - Numerous local and Express Bus Routes
- Complex street demands with heavy commercial and pedestrian activity
- Vision Zero Corridor

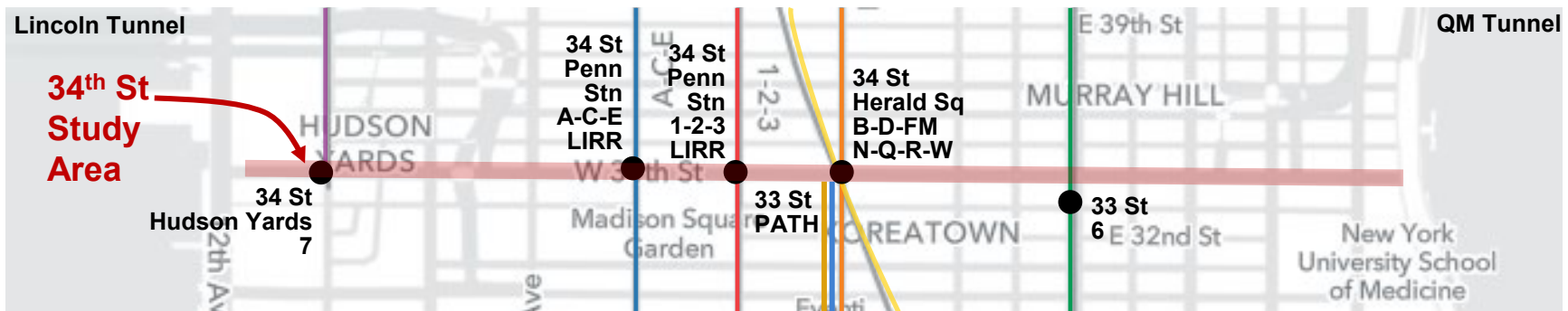

Existing Curbside and Offset Bus Lanes

Bus Lane Regulations vary along the corridor

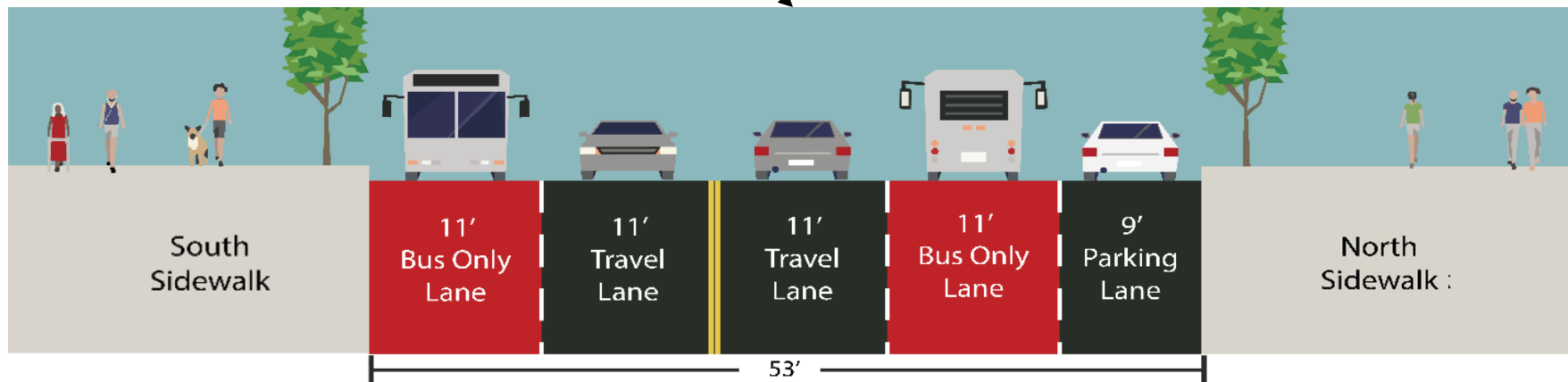
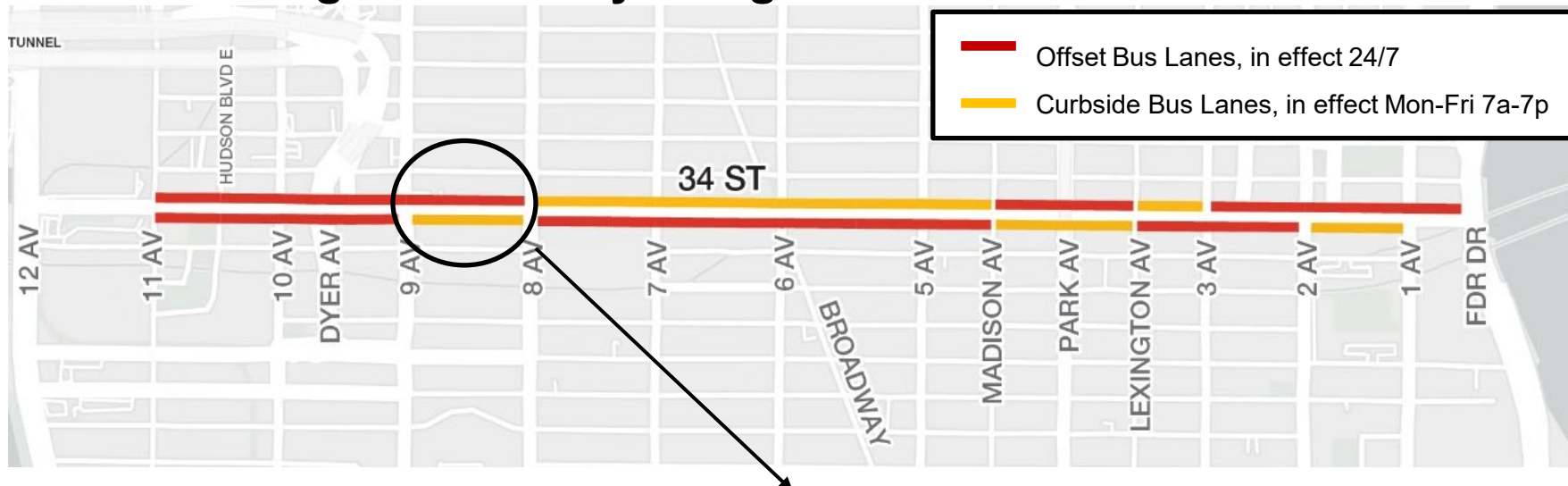

Bus Speeds on 34th St

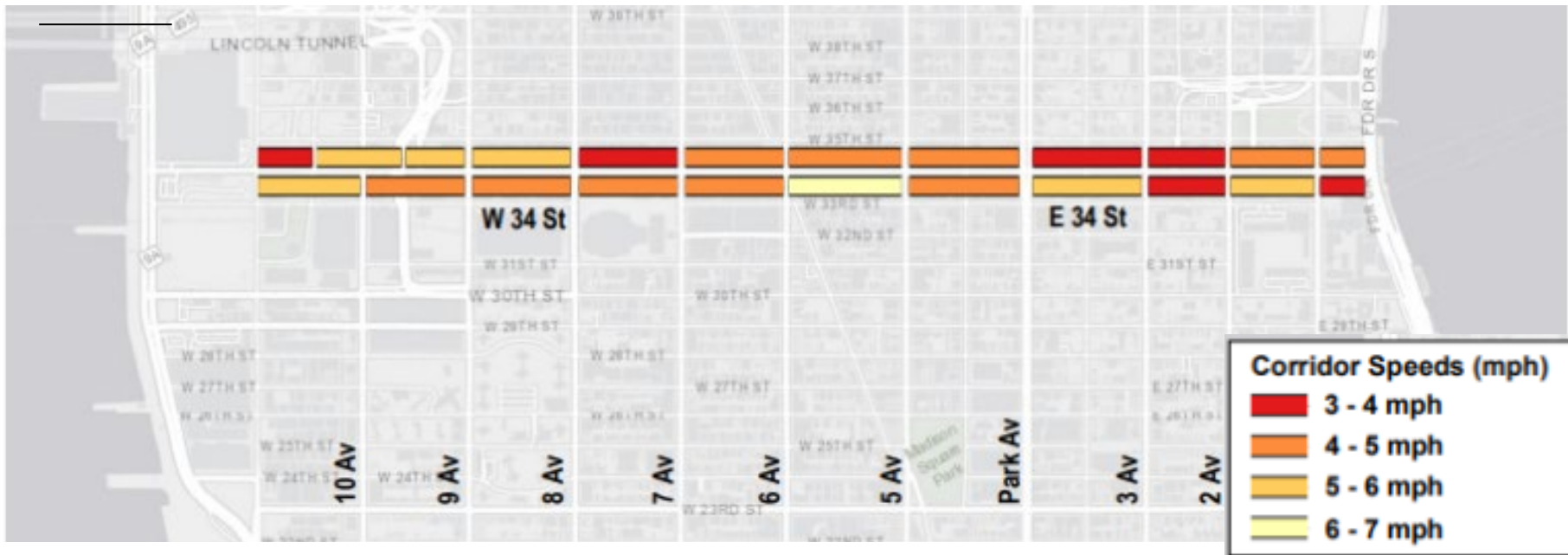

- Bus speeds improved after the launch of Select Bus Service, but the M34/M34A SBS is still one of the slowest buses. The current bus lane design is not working.
 - Average weekday peak hour bus speeds are only 5.0 mph, and as low as 3 mph
- On the average weekday, roadway congestion causes over 750 hours of passenger delay on the M34/M34A+.
- Weekday average bus peak speeds on the 14th St Busway are 15% faster than on 34 St

Work to Date

- Curbside bus lanes added to 34th Street (2008)
- M34/M34-A Select Bus Service launched (2011)
 - Upgraded many existing curbside bus lanes to offset bus lanes
 - Added eleven bus bulbs
- DOT on-street engagement (2024)
 - Pedestrian intercept survey – 200 surveyed
 - Merchant surveys –112 businesses visited from 2nd Ave to 9th Ave
- Existing conditions presentations to Community Boards 4, 5 & 6 (January – February 2025)
- In this meeting, we are presenting a **draft proposal**



34th Street Curbside and Offset Bus Lanes



2024 Pedestrian Intercept Surveys

Community Feedback

- DOT on-street engagement:
 - Overcrowding on sidewalks, long crossing distances, and vehicular congestion were primary concerns for pedestrians
 - Bus riders noted slow bus speeds and long wait times
 - Businesses noted a need for additional loading space on and around the corridor
- Community Board Feedback:
 - Request for a 24/7 14th Street style busway
 - Request for sidewalk widening, and other pedestrian safety elements
 - Request for design and regulations to facilitate deliveries



2024 Pedestrian Intercept Surveys



2024 Merchant Surveys

Proposal

Draft Proposal - Busway

- Busway between 3rd Av and 9th Av in both directions
- Maintain existing bus lanes on the rest of the corridor
- New pedestrian safety improvements
 - Painted pedestrian spaces
 - Hardened daylighting
 - Concrete median island
- Prioritize curb management for loading and delivery needs

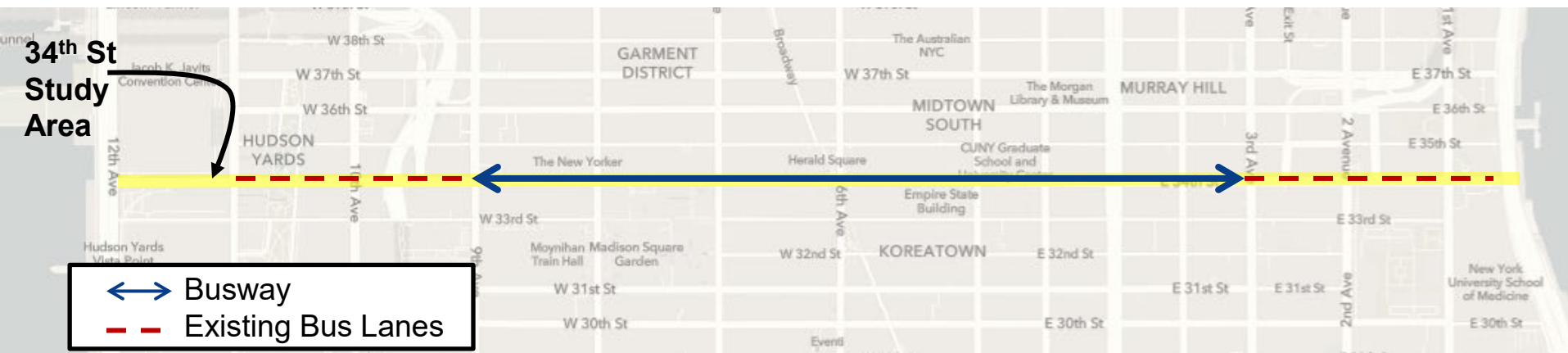

What is a Busway



- Buses, trucks, emergency vehicles, and Access-a-Ride are allowed to travel along the entire corridor
- Local access is allowed for other vehicles, including cars, taxis, and for-hire vehicles
 - Vehicles access the corridor from side streets
 - Must leave the corridor at the next required turn, using posted signage
- Makes bus service faster and more dependable
- Allows loading and deliveries, customer access to businesses

Why Busway?

SAFETY

Since the 14th Street Project changes, my experience as a pedestrian crossing 14th Street feels:



For those who walk...

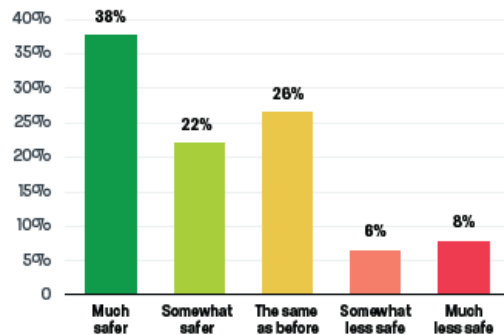

Respondents: 735



For those 62 and over who walk...

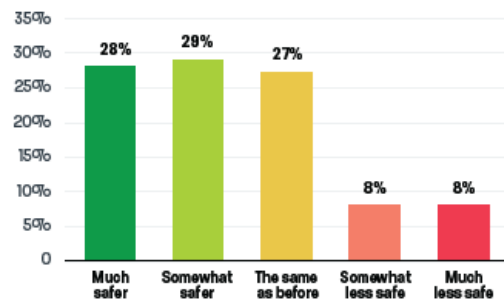

Respondents: 268

A Busway on 34th Street:

- Prioritizes truck and transit through traffic, improving bus speed and reliability
- Eliminates cut-through traffic
- Retains local access, parking, and loading
- Enhances the pedestrian experience

Case Study: 14th Street

- Pilot launched in October 2019, in conjunction with M14A/D Select Bus Service
- Bus speeds increased up to 24%
- Crashes along the corridor decreased by 42%
- Travel speeds for streets around the busway had minimal changes
- In post-implementation surveys, participants mentioned:
 - Faster, more frequent bus service
 - People feel safer crossing the street

9th Avenue – Eastbound Gateway

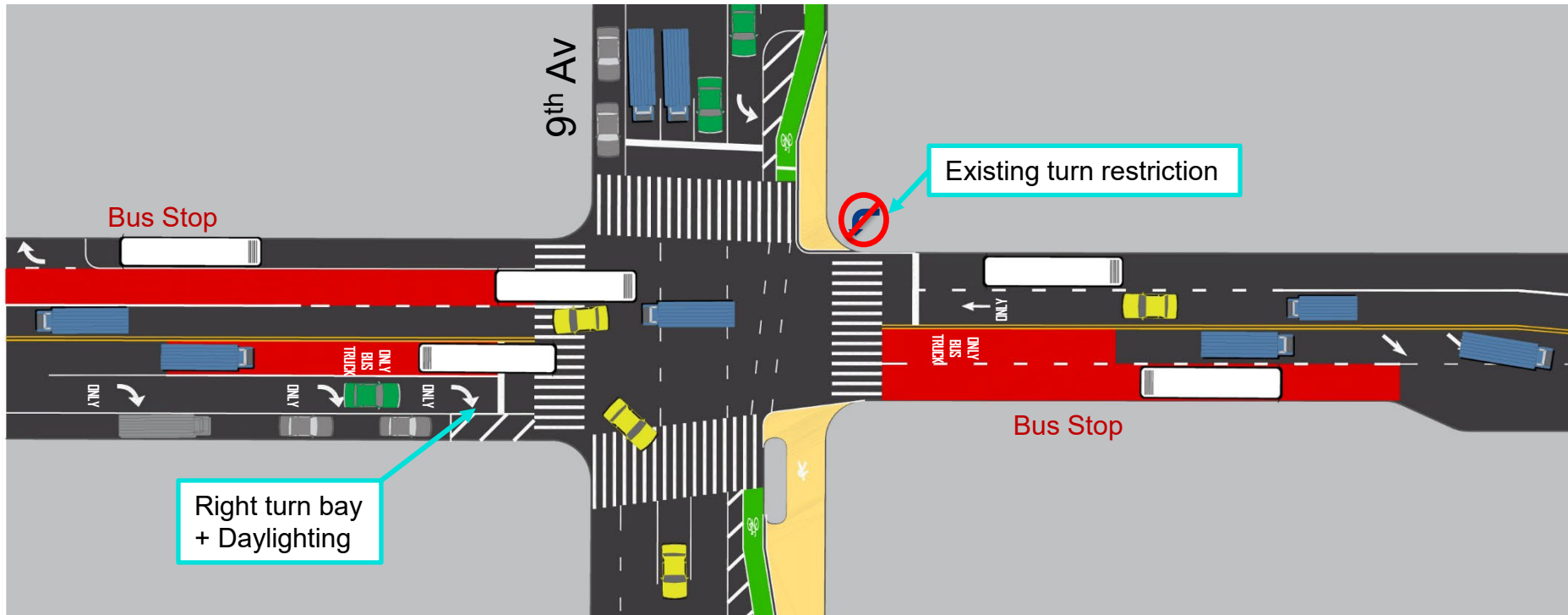

- Eastbound cars must turn right onto 9th Av
 - Buses and trucks may turn or continue straight
- All westbound traffic must continue straight
- Southbound traffic may access the busway via a left turn from 9th Av onto 34th St

8th Avenue

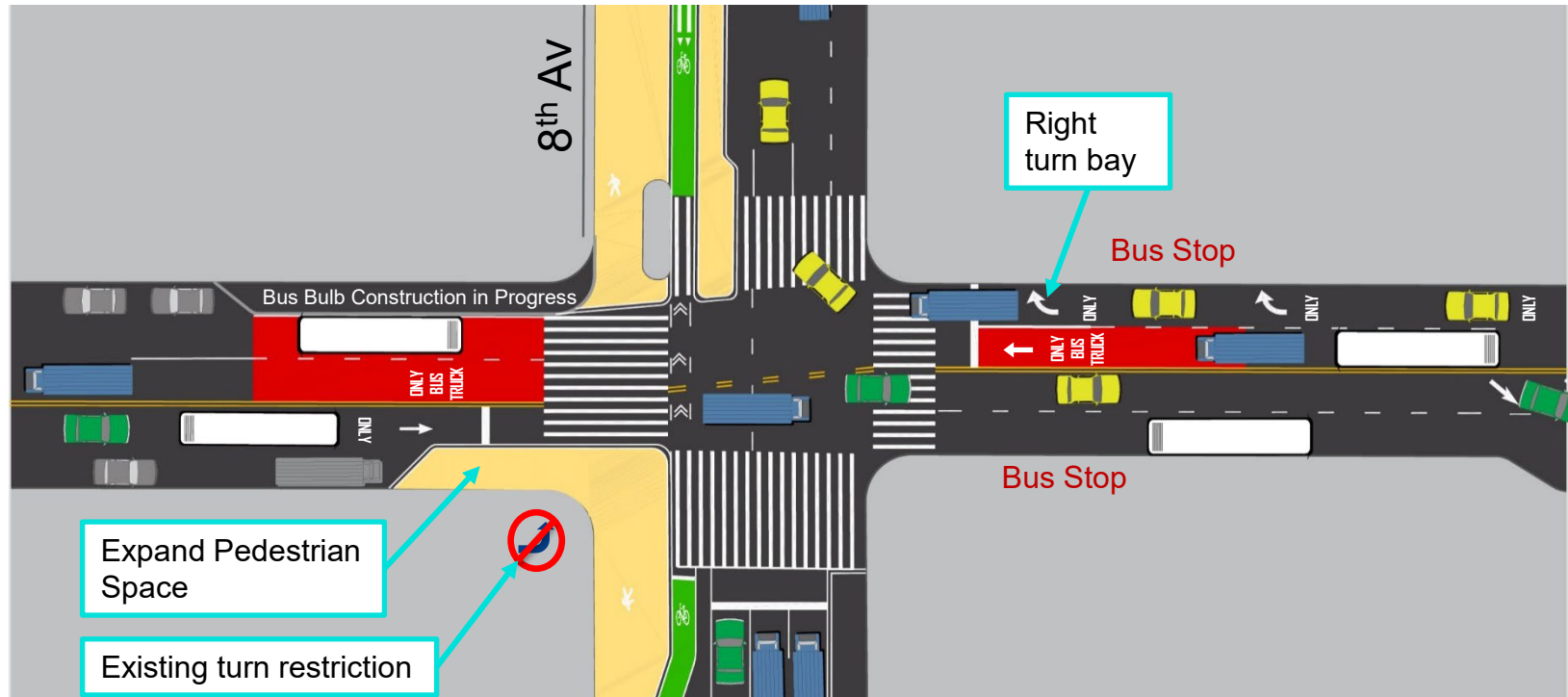

- All eastbound traffic must continue straight
- Westbound cars must turn right onto 8th Av
 - Buses and Trucks may turn or continue straight
- Northbound traffic may access the busway via a left or right turn from 8th Av onto 34th St

7th Avenue

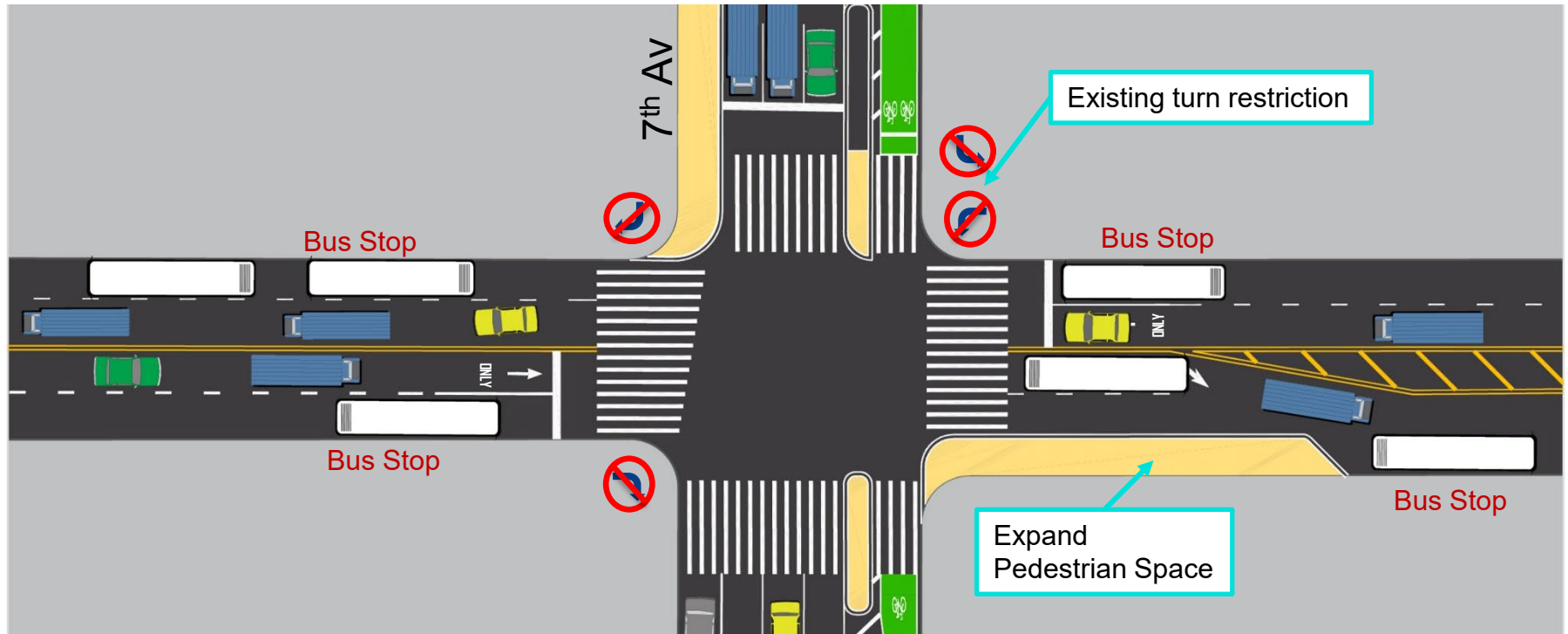

- All traffic in all directions must continue straight
 - Existing turn restrictions for all turns

6th Avenue/Broadway

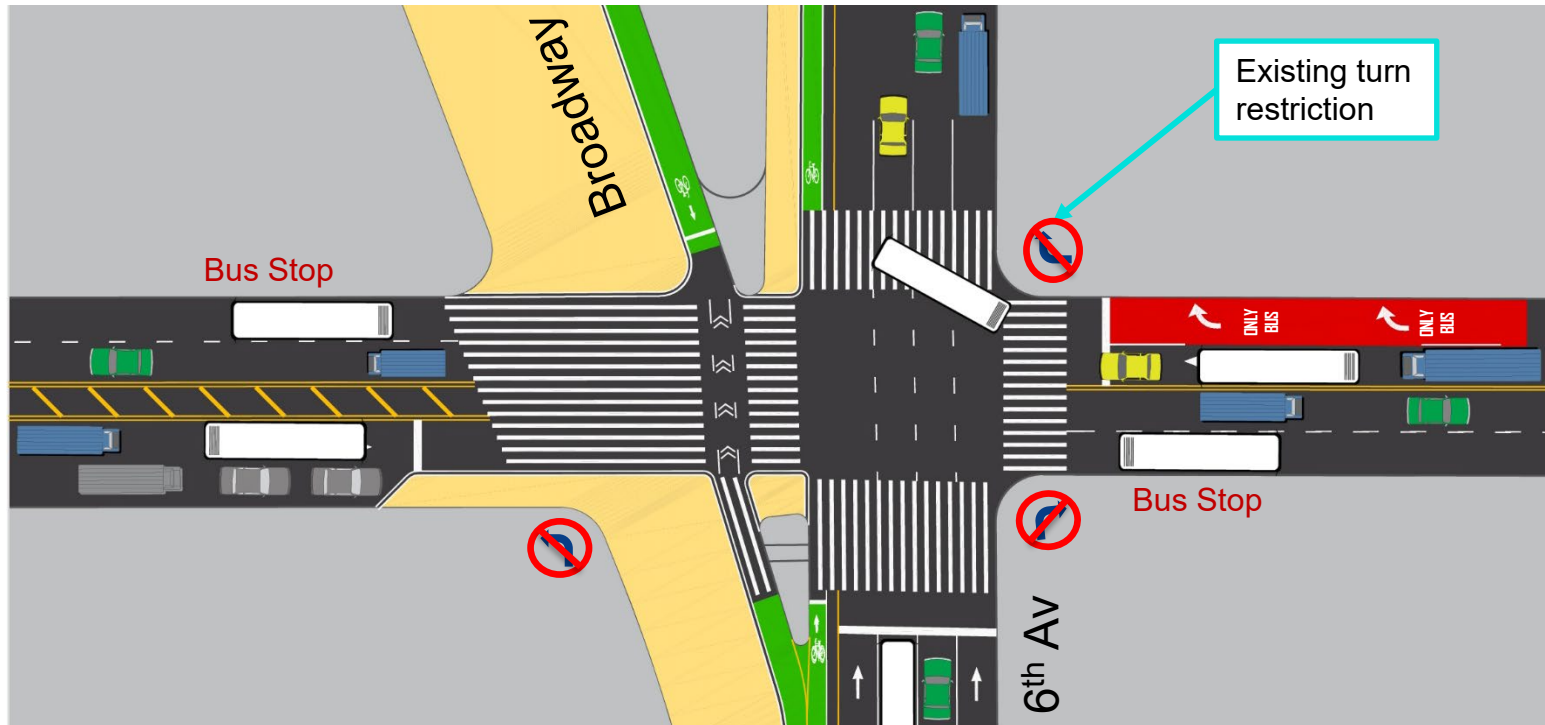

- All cars and trucks in all directions must continue straight
 - Existing turn restrictions
 - MTA buses traveling westbound may turn right

5th Avenue

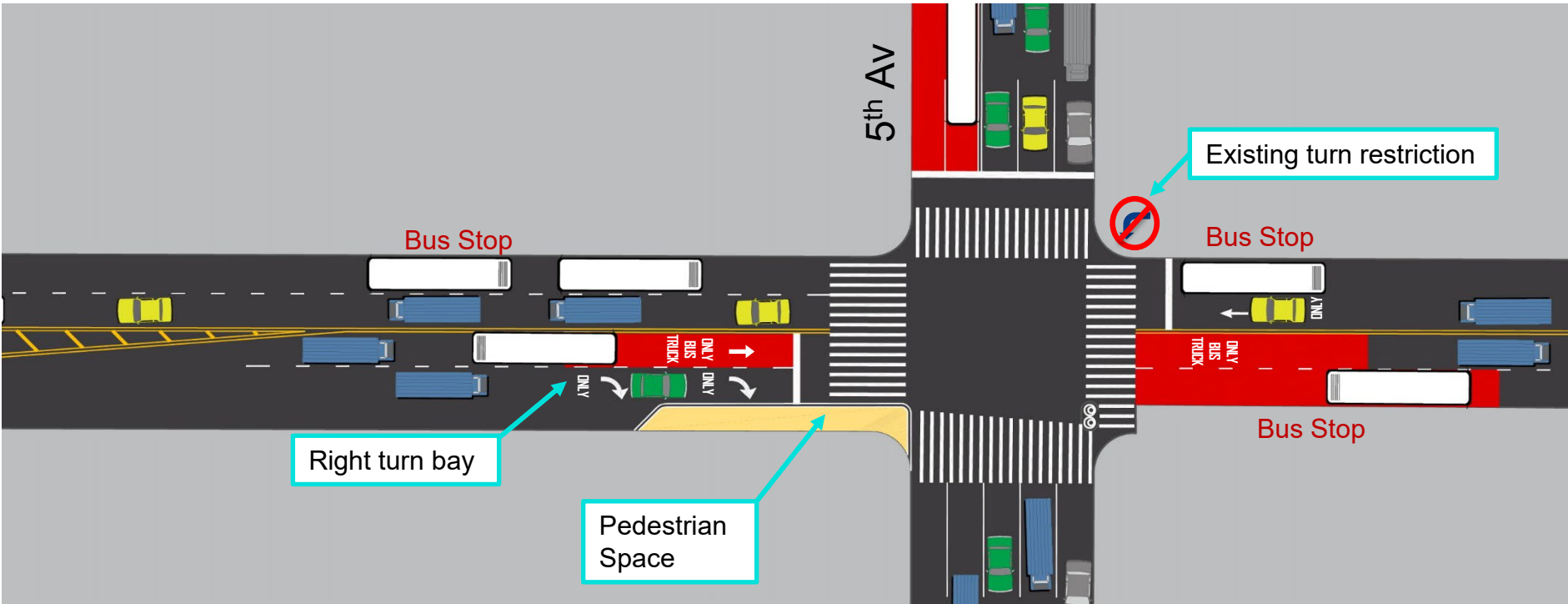

- Eastbound cars must turn right onto 5th Av
 - Buses and trucks may turn or continue straight
- All westbound traffic must continue straight
- Southbound traffic may access the busway via a left or right turn from 5th Av onto 34th St

Madison Avenue

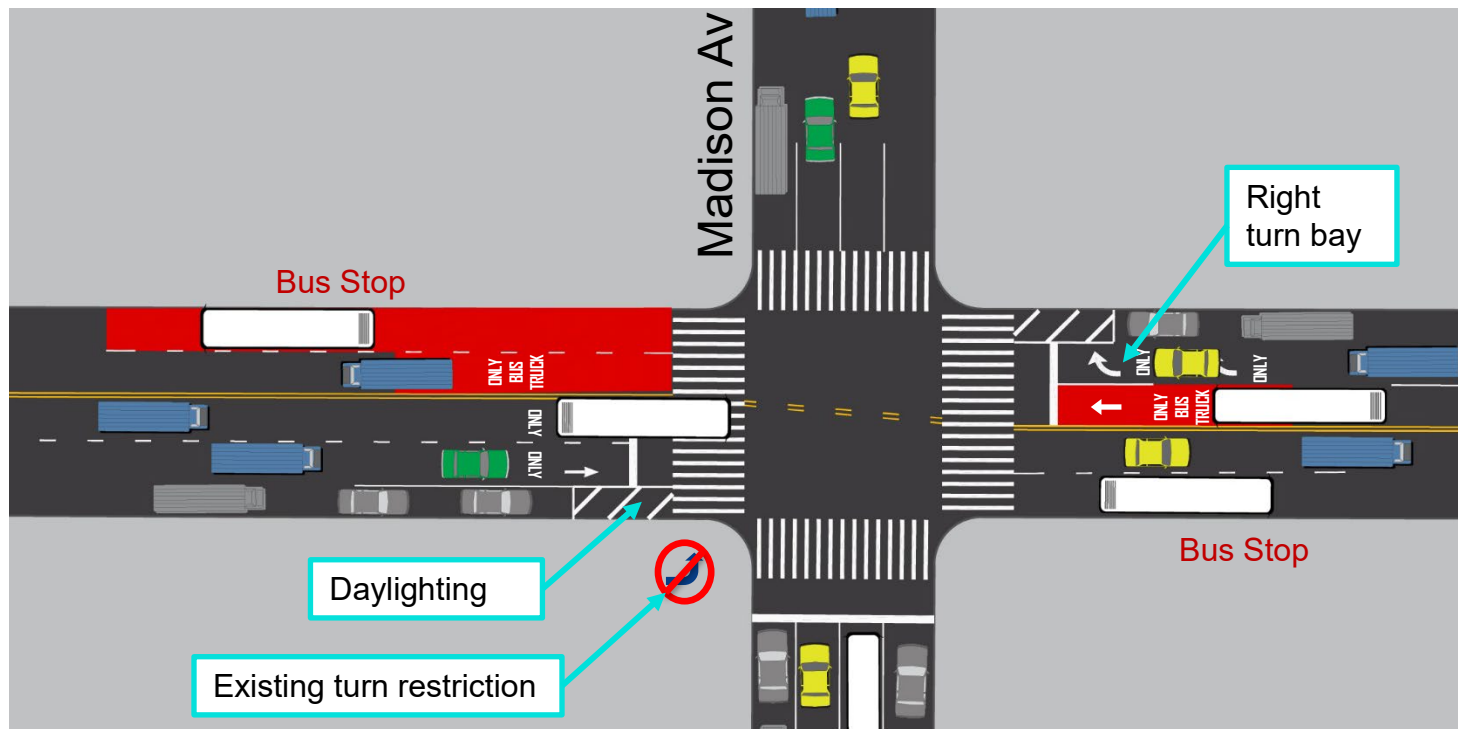

- All eastbound traffic, except authorized buses must continue straight
- Westbound cars must turn right onto Madison Av
 - Buses and Trucks may turn or continue straight
- Northbound traffic may access the busway via a left or right turn from Madison Av onto 34th St

Park Avenue

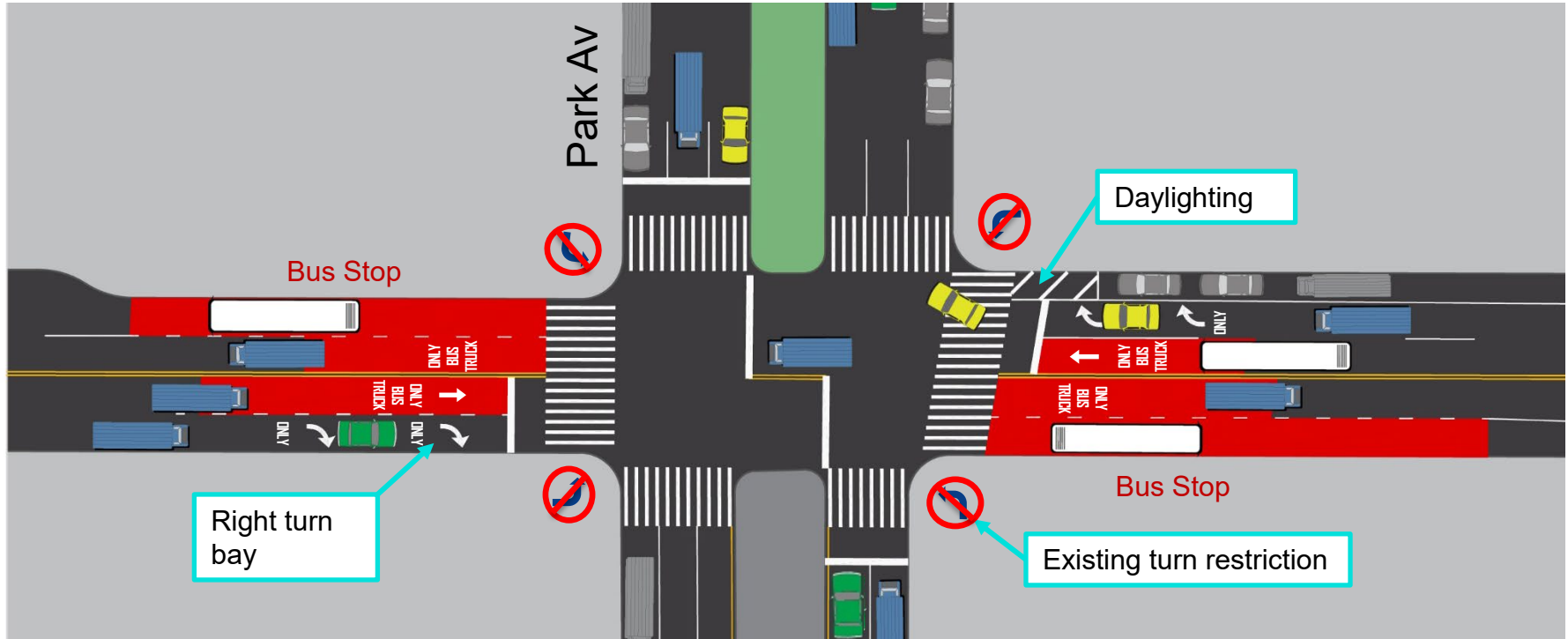

- East and westbound cars and trucks must turn right
 - Buses and trucks traveling east and westbound may continue straight
- Left turns are banned in all directions – existing turn restriction
- North and southbound vehicles may access the busway by turning right from Park Av onto 34th St

Lexington Avenue

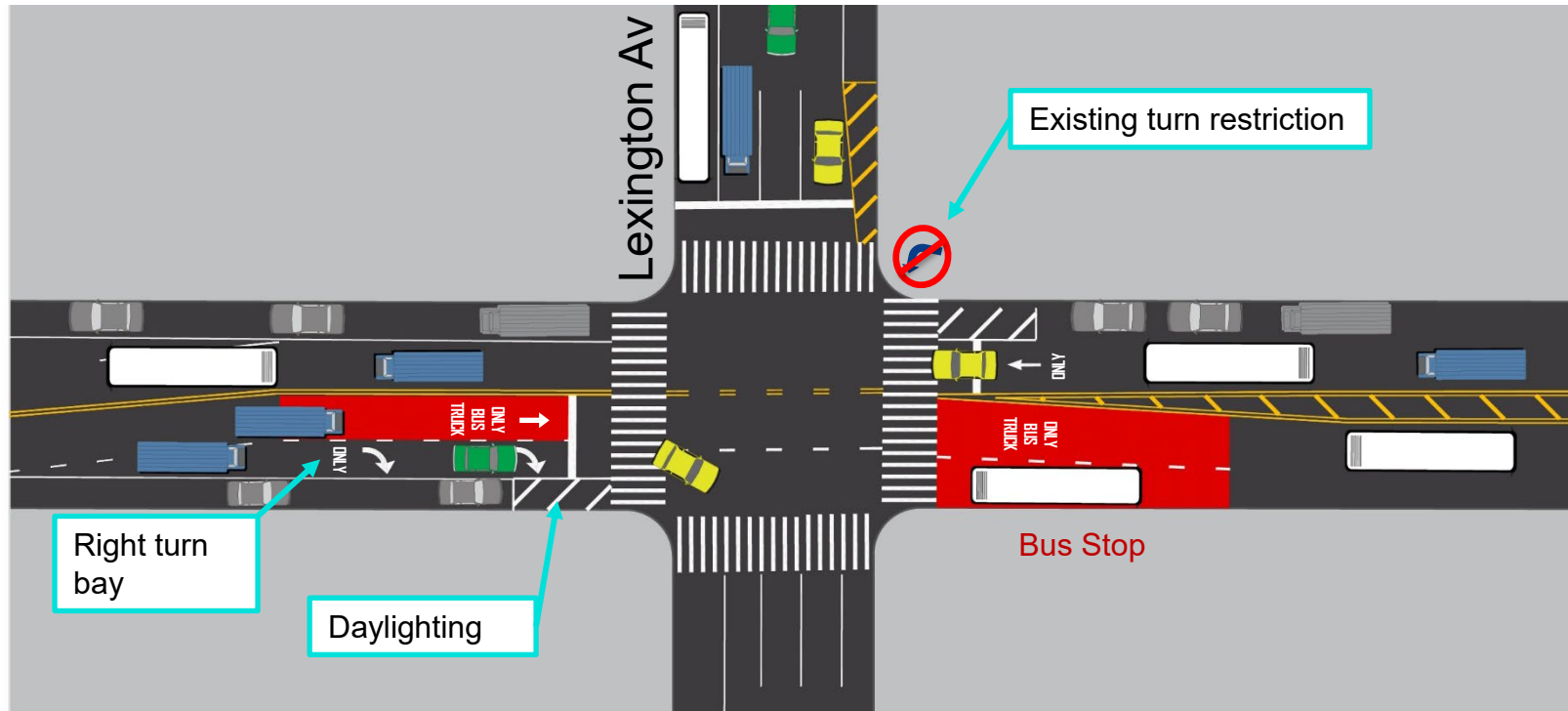

- Eastbound cars must turn right onto Lexington Av
 - Buses and Trucks may turn or continue straight
- All westbound traffic must continue straight – existing turn restriction
- Southbound traffic may access the busway via a left or right turn from Lexington Av onto 34th St

3rd Avenue – Westbound Gateway

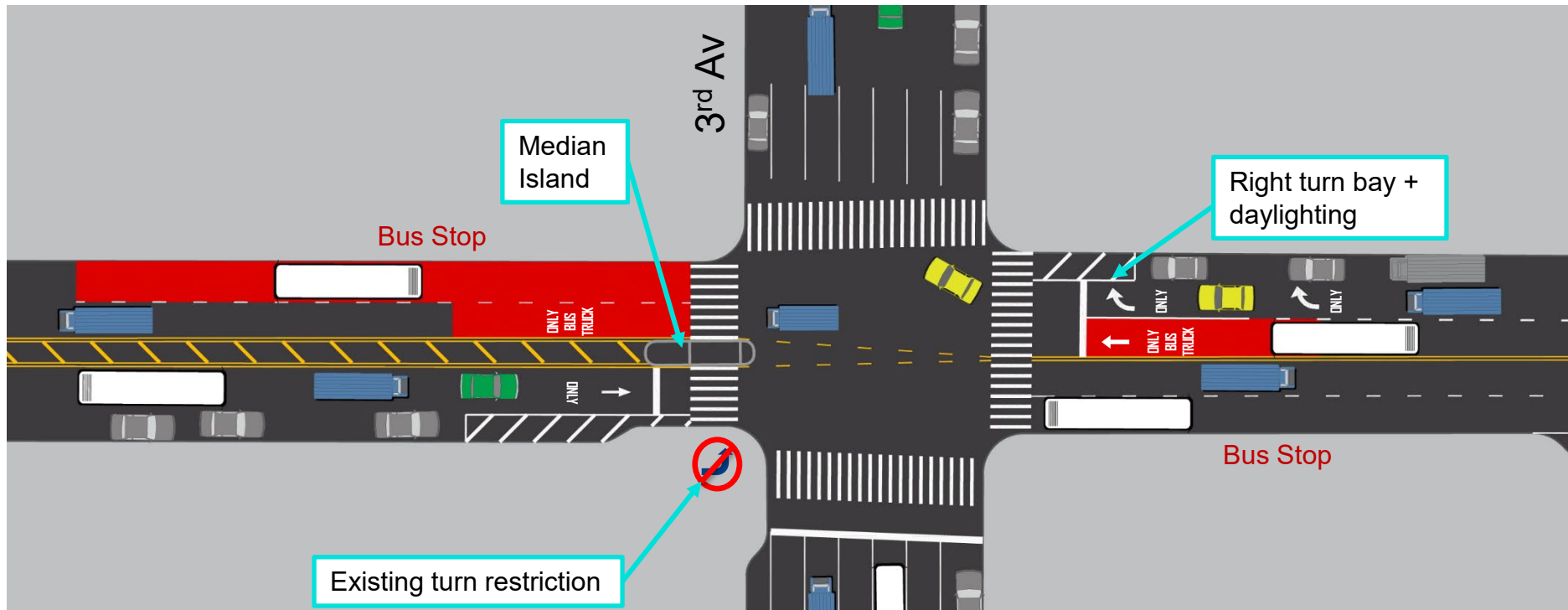

- All Eastbound traffic must continue straight – existing turn restriction
- Westbound cars must turn right onto 3rd Av
 - Buses and trucks may turn or continue straight
- Northbound traffic may access the busway via a left turn from 3rd Av onto 34th St

Upgrading Existing Mid-Block Crossings

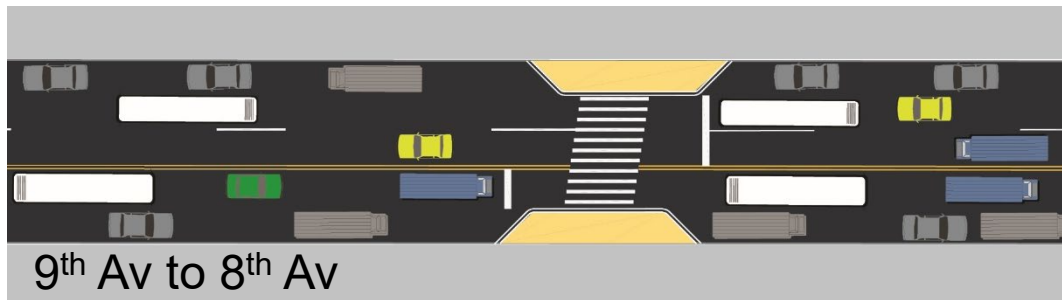

Painted pedestrian space to shorten crossing

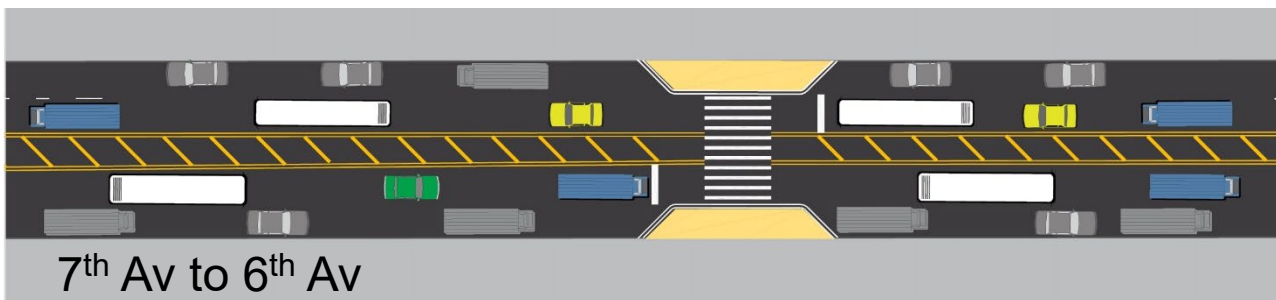
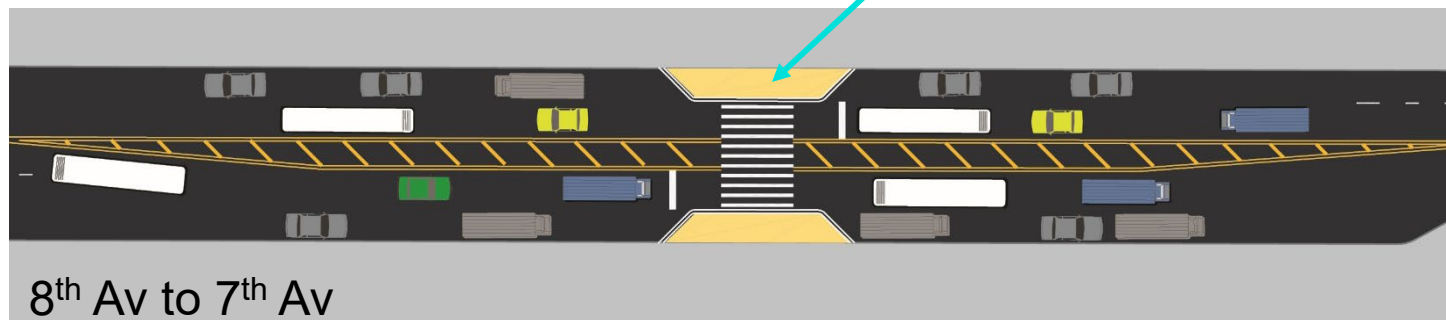

Busway Enforcement

- ACE on-bus and fixed-location cameras enforce illegal parking in bus stops, double parking, and violations of required turns on the busway
 - ACE cameras in effect on 34th Street (M34/M34A SBS route) since 8/10/20
- Data shows that camera enforcement is successful in changing driver behavior
 - The number of violations decreases over time as drivers adjust to busway violations
 - ~80% of violators don't get a second ticket
 - Human review by DOT process ensures violations are captured and issued according to program rules
- For new regulations, cameras issue **warnings only for the first 60 days**
 - Existing regulations will be enforced as usual
- Close coordination with NYPD for busway launch

Traffic Analysis

Traffic Analysis

- Traffic analysis work to date:
 - Data collection: Existing traffic and pedestrian volumes along 34th St
 - Development of existing conditions model
- Ongoing work:
 - Development of proposed condition models
 - Analysis of how the proposal would affect traffic patterns
 - Exploration of changes to signal timing to improve traffic flow
- Traffic analysis report will use dynamic traffic modeling to explore how a proposal would affect traffic patterns on Manhattan avenues and other crosstown streets between 66th St and 14th St
- DOT will provide results of the traffic analysis after completion

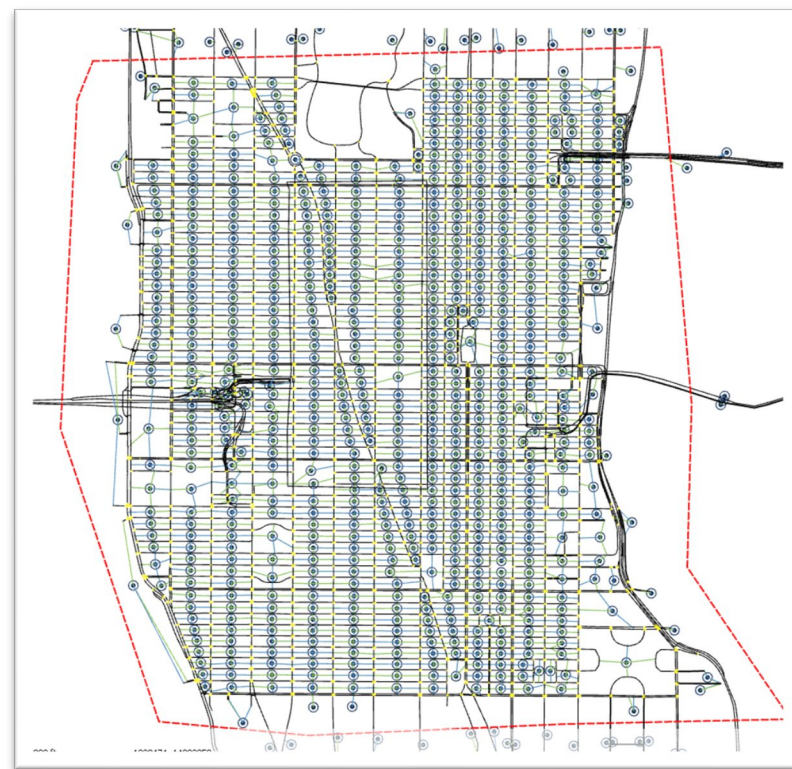

Example of Aimsun Traffic Model Network

Where are drivers who use 34th St going?

- Based on vehicle/app GPS data:
 - 29% of trips that use 34th St have destinations on or directly North and South of the project corridor
 - 24% of trips that use 34th St have destinations in other parts of Manhattan
 - 47% of trips that use 34th St have destinations in other boroughs or beyond the city limits

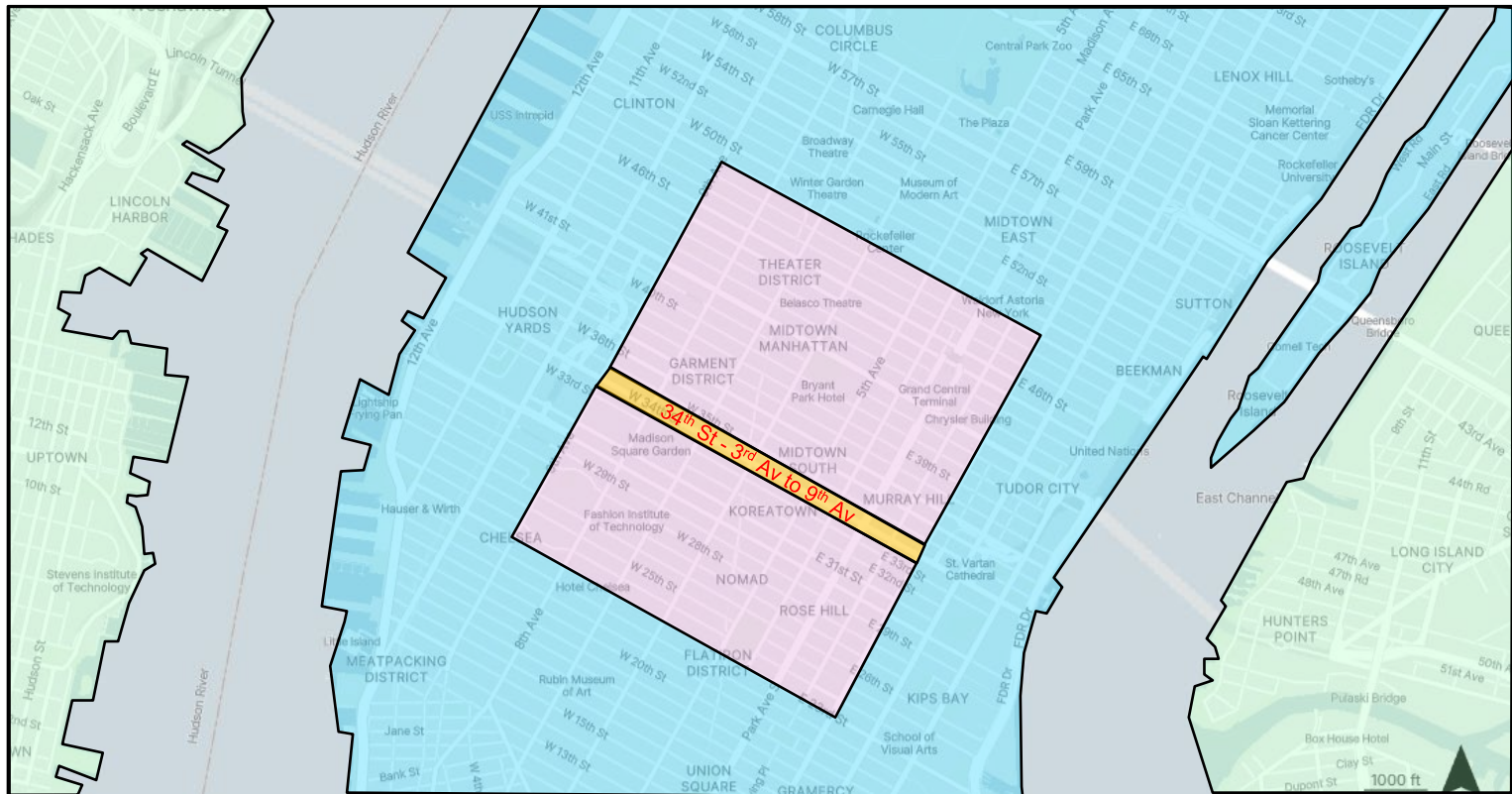

Where are drivers who use 34th St going?

- Based on vehicle/app GPS data:
 - 29% of trips that use 34th St have destinations on or directly North and South of the project corridor
 - 24% of trips that use 34th St have destinations in other parts of Manhattan
 - 47% of trips that use 34th St have destinations in other boroughs or beyond the city limits

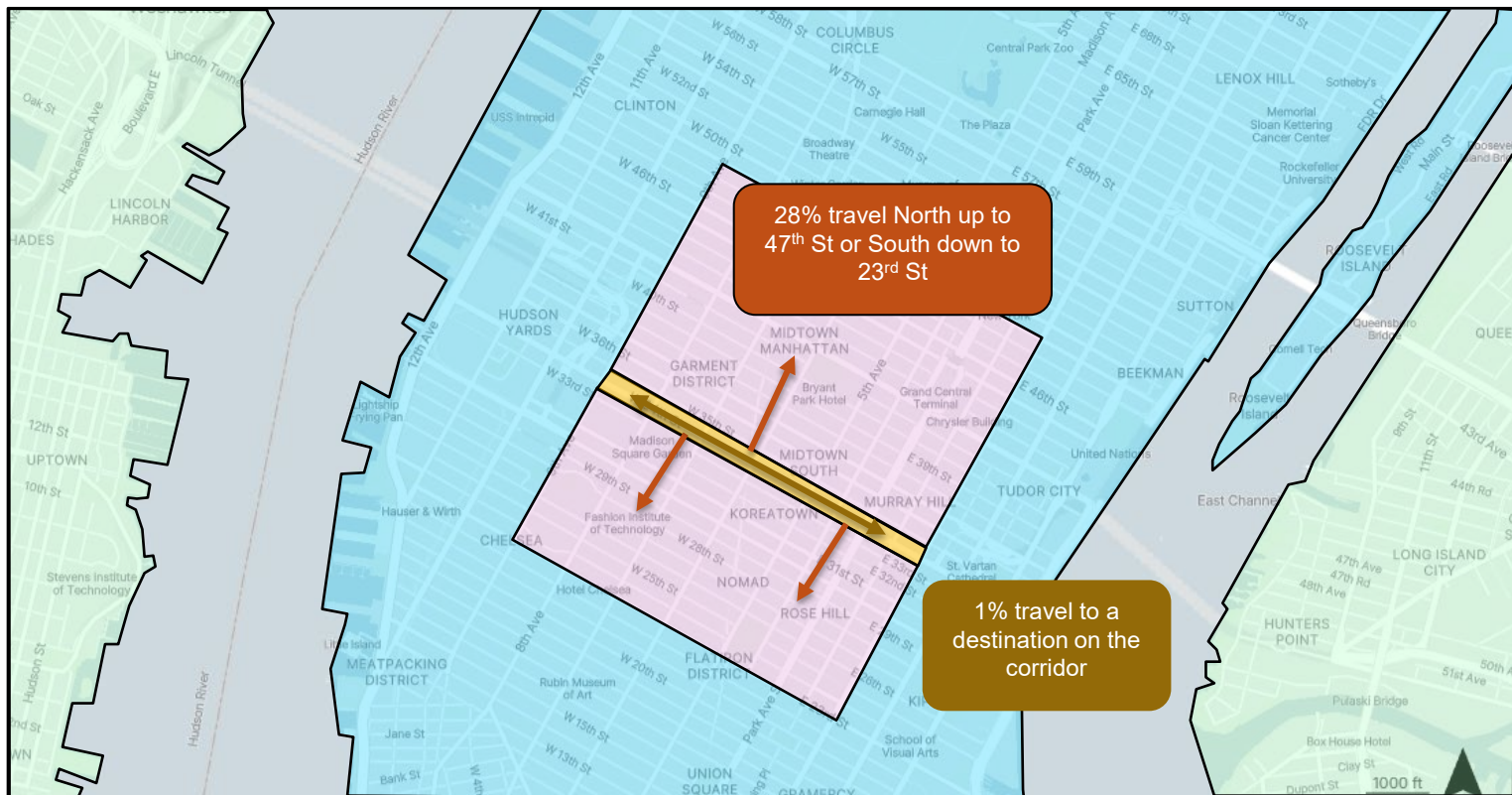

Where are drivers who use 34th St going?

- Based on vehicle/app GPS data:
 - 29% of trips that use 34th St have destinations on or directly North and South of the project corridor
 - 24% of trips that use 34th St have destinations in other parts of Manhattan
 - 47% of trips that use 34th St have destinations in other boroughs or beyond the city limits

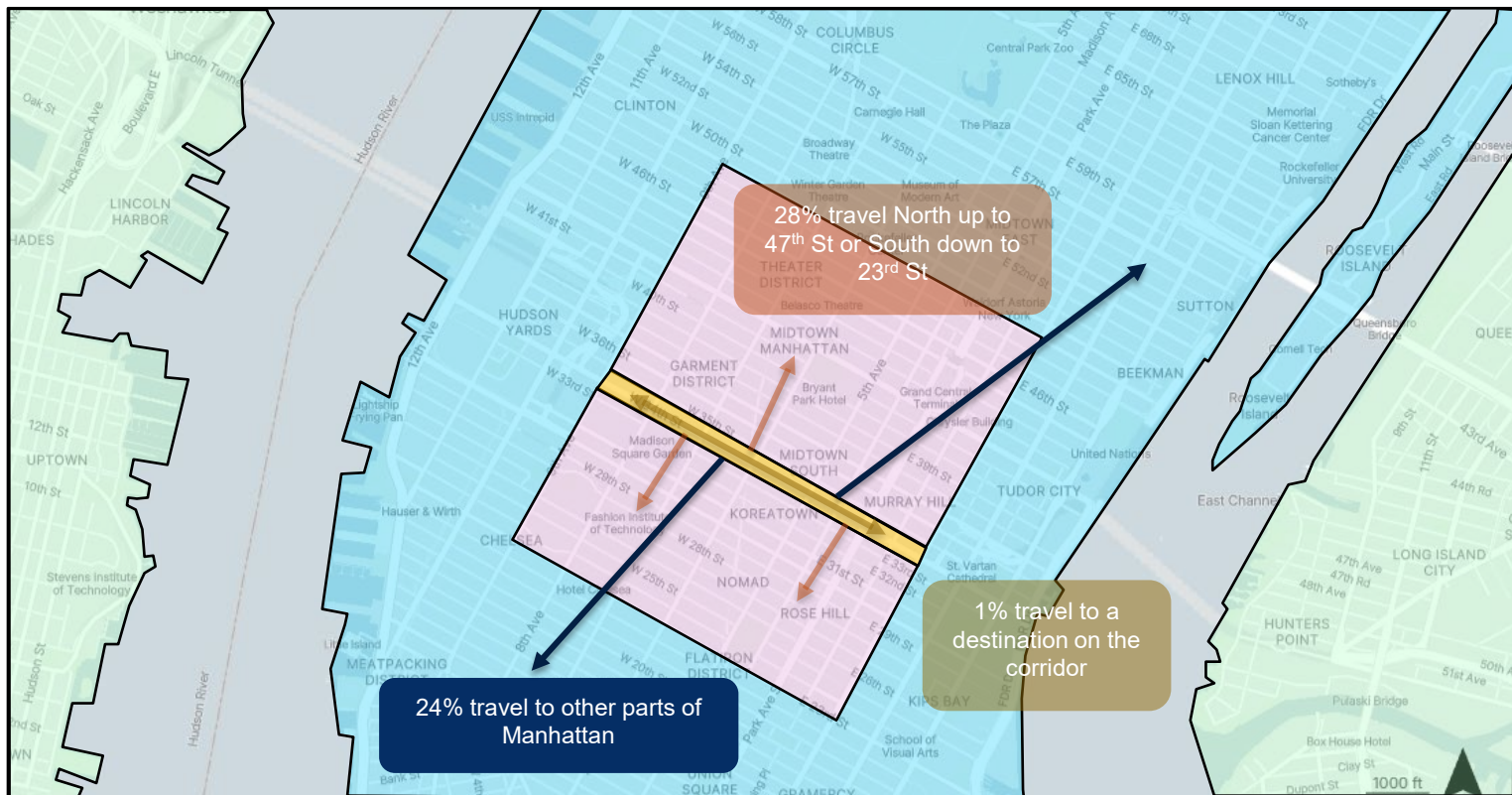

Where are drivers who use 34th St going?

- Based on vehicle/app GPS data:
 - 29% of trips that use 34th St have destinations on or directly North and South of the project corridor
 - 24% of trips that use 34th St have destinations in other parts of Manhattan
 - 47% of trips that use 34th St have destinations in other boroughs or beyond the city limits

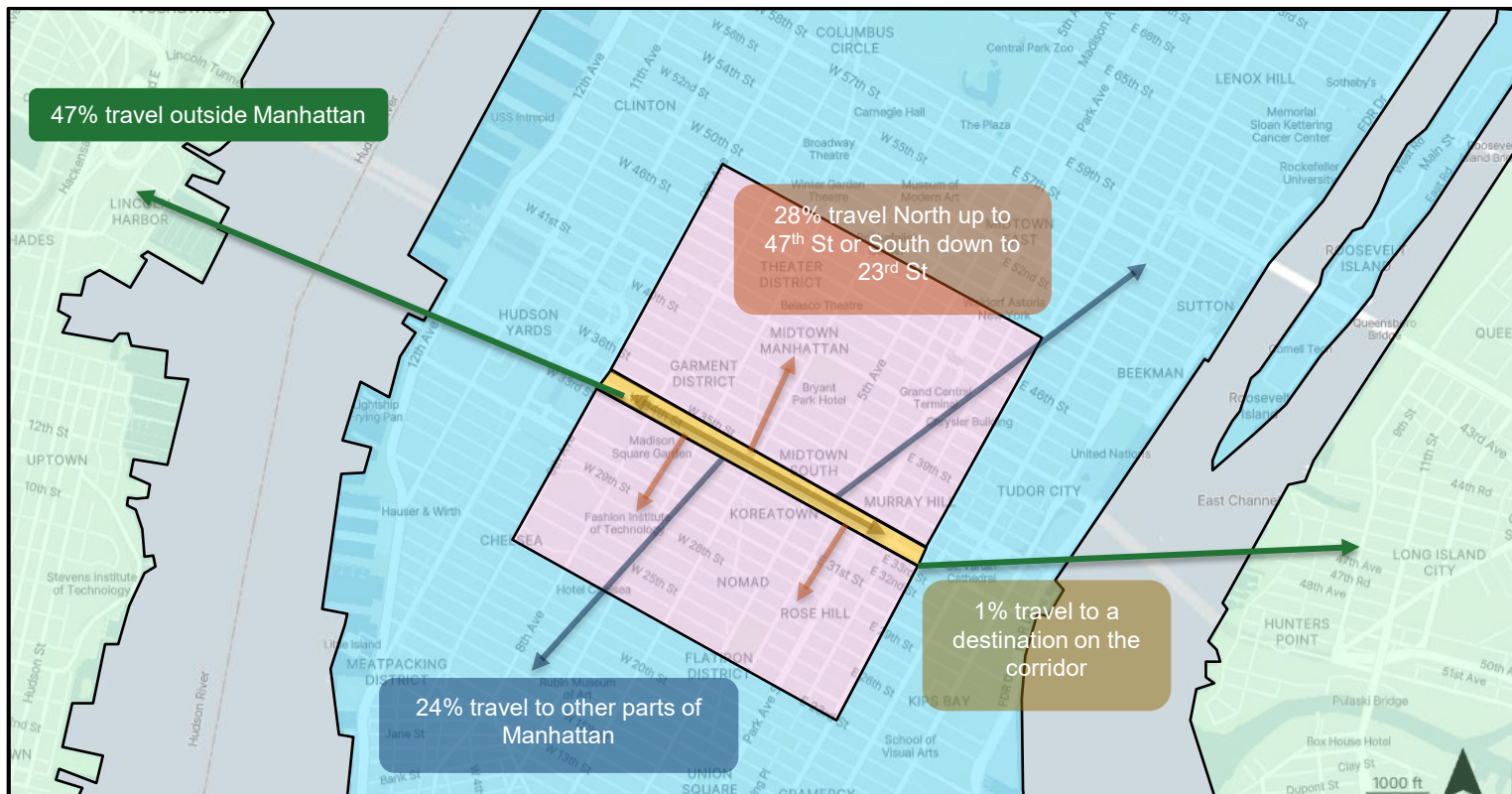

Summary and Next Steps

Summary

- Goals for 34th St:
 - Make bus service faster and more reliable
 - Increase safety on the corridor
 - Ensure access to businesses
- Proposal:
 - 14th St style busway between 3rd Av and 9th Av
- Ongoing work:
 - Finalize traffic analysis
 - Further develop design
 - Synthesize community feedback



Next Steps

Spring 2025

- Meet with Community Board to discuss draft proposal
- Feedback will help shape DOT's final proposal
- Site visits

Spring/Summer 2025

- Continue traffic analysis
- Refine proposal based on traffic analysis and community feedback

Summer 2025

- Share refined plan

Implementation in Summer/Fall 2025



Thank You!

Questions?



NYC DOT



NYC DOT



nyc_dot



NYC DOT