

Reconstruction of Empire Boulevard

2015



**VISION
ZERO**

Community Board 9 Transportation Committee
September 16, 2015 to Brooklyn CB 9

**NYC
DDC** Department of
Design and
Construction

NEW YORK CITY
DOT

NYC Environmental
Protection

RBA

Project Location

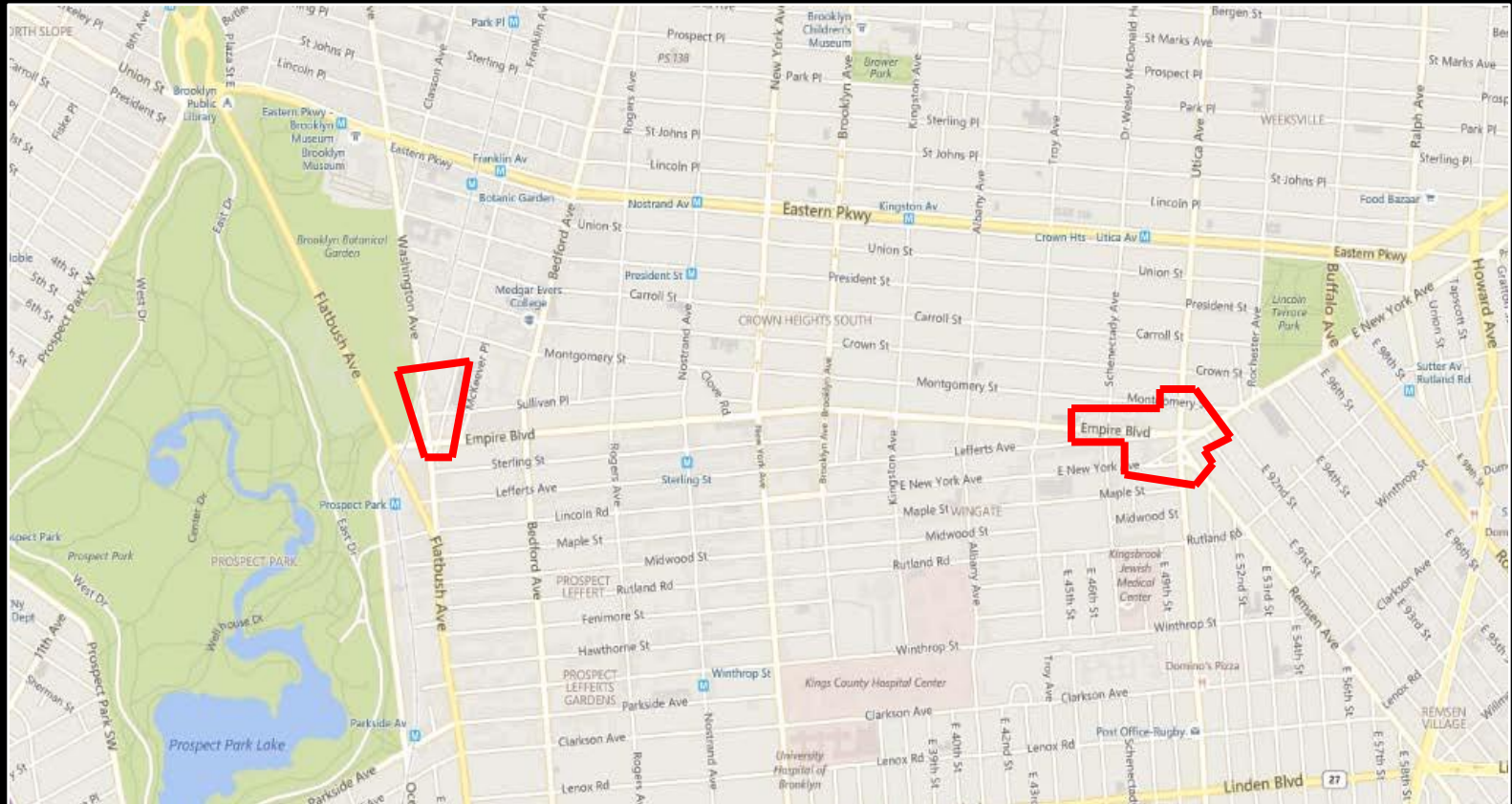

Project Location

Project Location

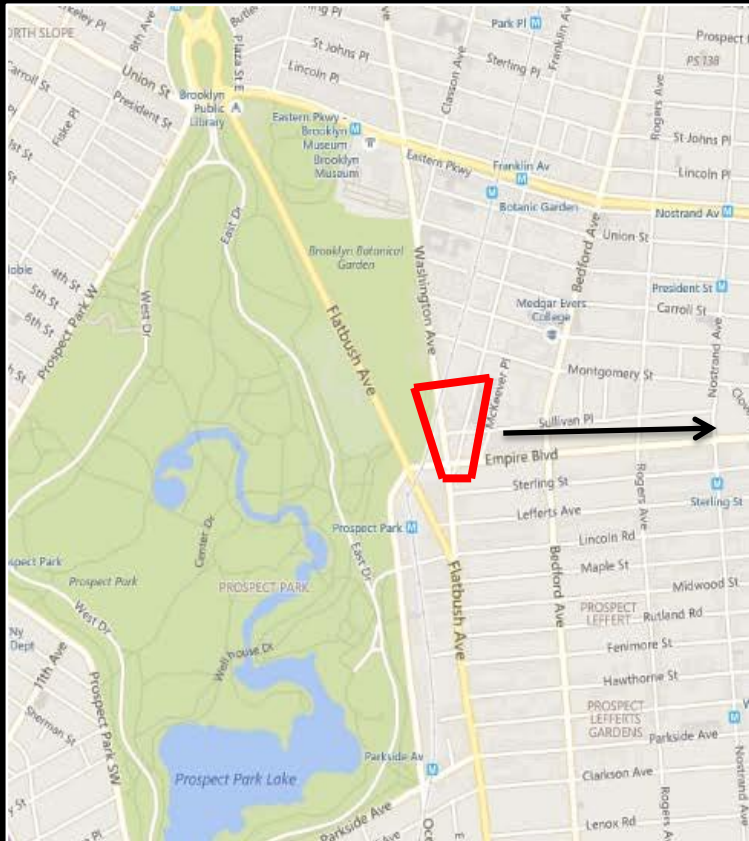

Project Location

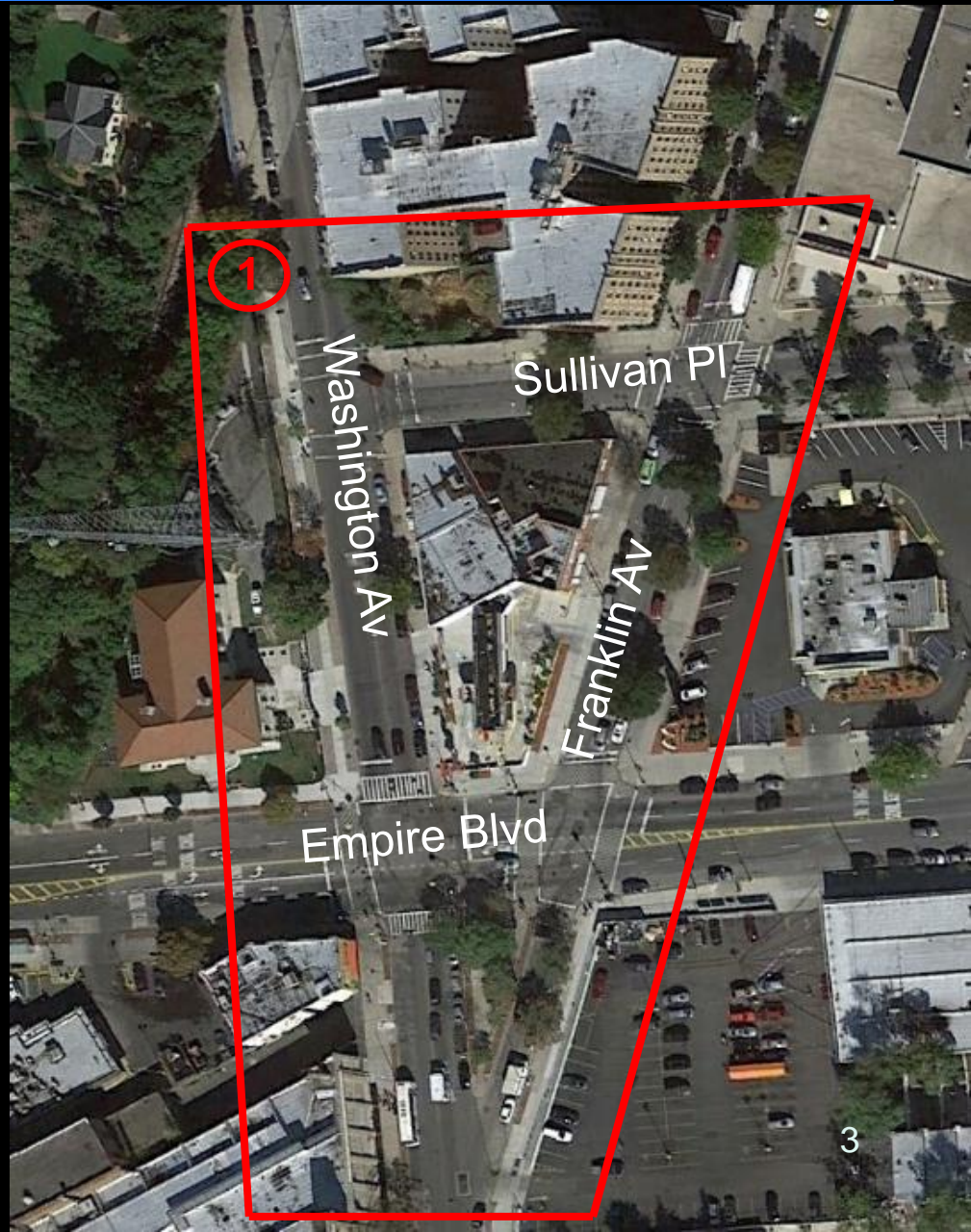

Project Location

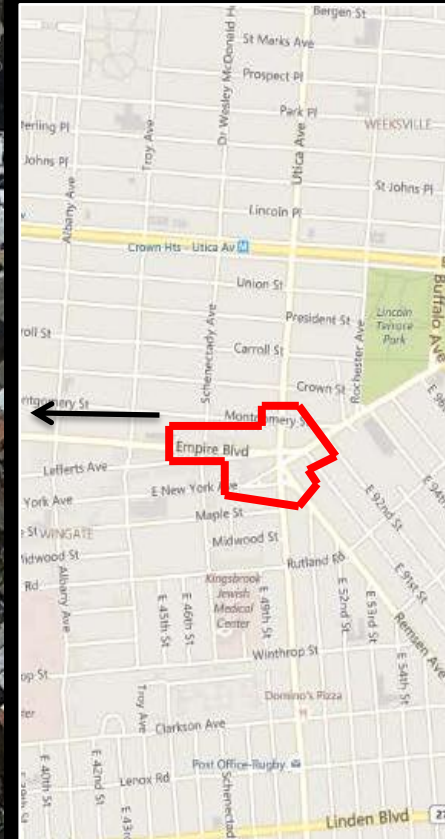

 Project Location

Need: Why Empire Boulevard?

■ Vision Zero Priority

- Most of Empire Blvd is in a Priority Area
- Project includes Vision Zero Priority Corridors:
 - Franklin Av
 - Schenectady Av
 - Utica Av
- 490 injuries project wide (2009-2013)
 - Ranks in top 10% of BK corridors

Local Schools

- P.S. 221 at Empire Blvd / Troy Ave
- P.S. 375 at Sullivan Pl / Franklin Ave
- I.S. 391 at Troy Ave / E New York Ave

Crashes with Injuries	Injuries	KSI
Pedestrian	65	5
Cyclists	34	6
Motor Vehicle Occupant	391	18
Total	490	29



Vision Zero Priority Area Map

Existing Conditions



Empire Blvd @ Franklin Ave, looking south

Existing Conditions



Utica Ave @ E New York Ave, looking east

Existing Conditions



E New York Ave @ Empire Blvd, looking west

Project Timeline

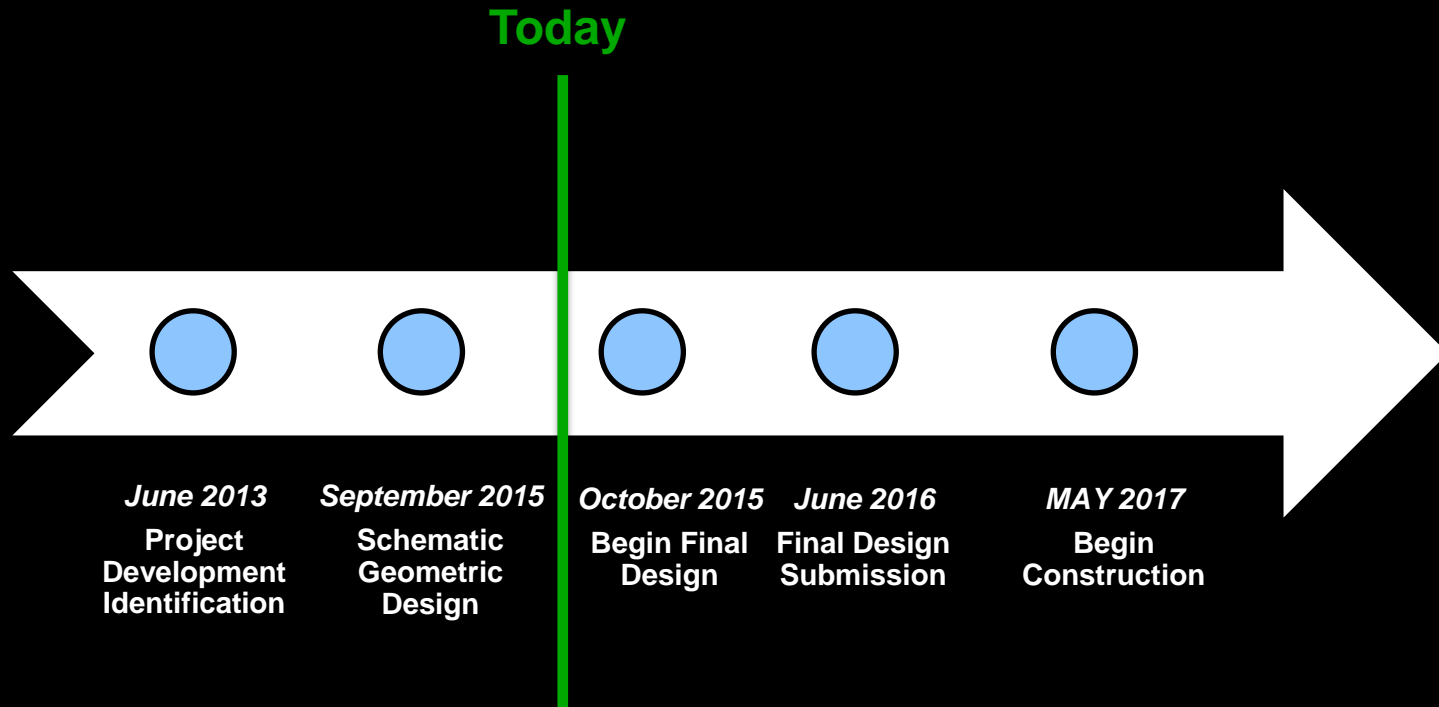

Schematic Design Proposals

- 1. Franklin Avenue**
- 2. Remsen Avenue**
- 3. Utica Avenue**
- 4. Schenectady Avenue**

1. Franklin Avenue – Existing Condition

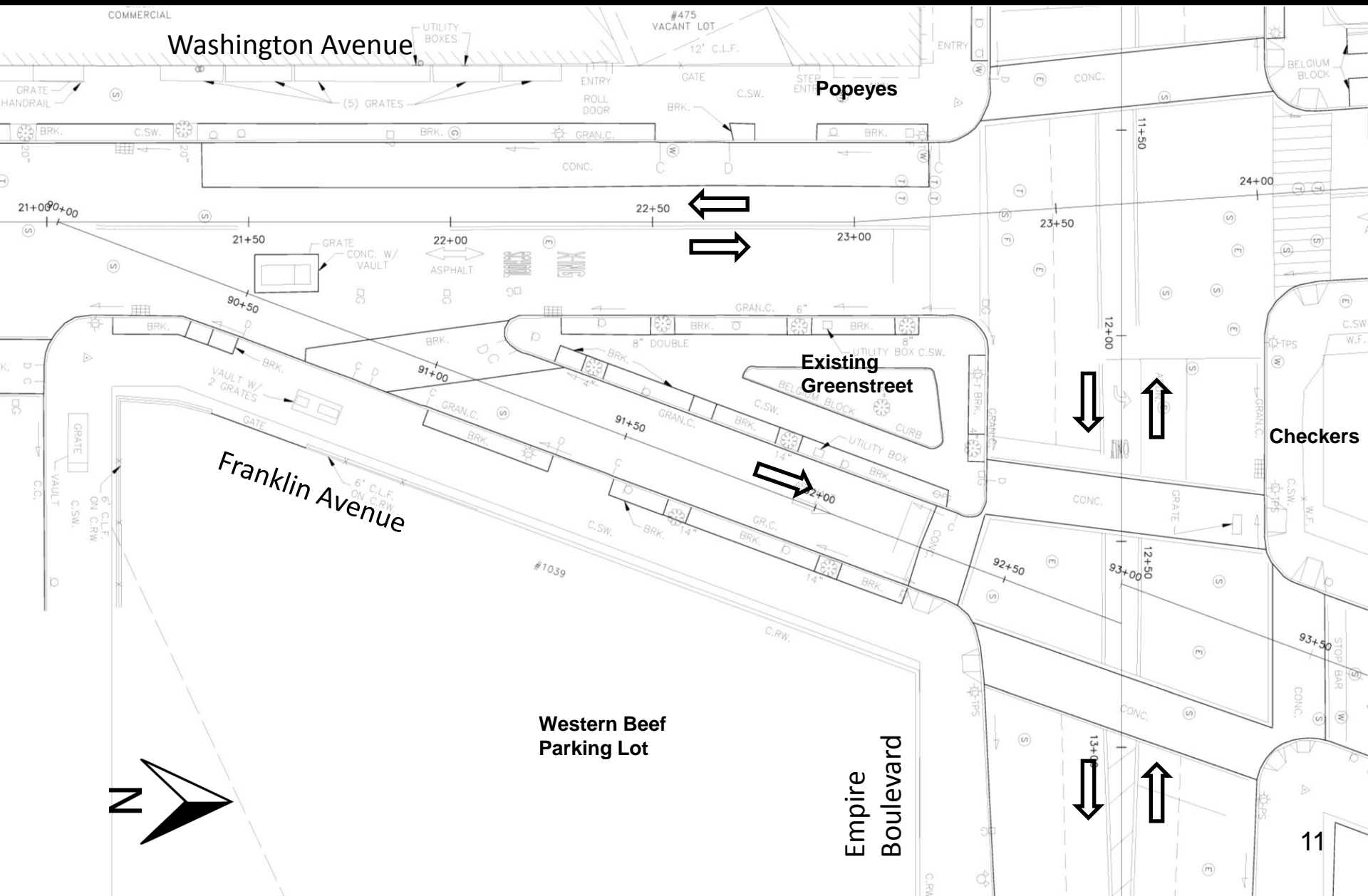

1. Franklin Avenue – Existing Condition

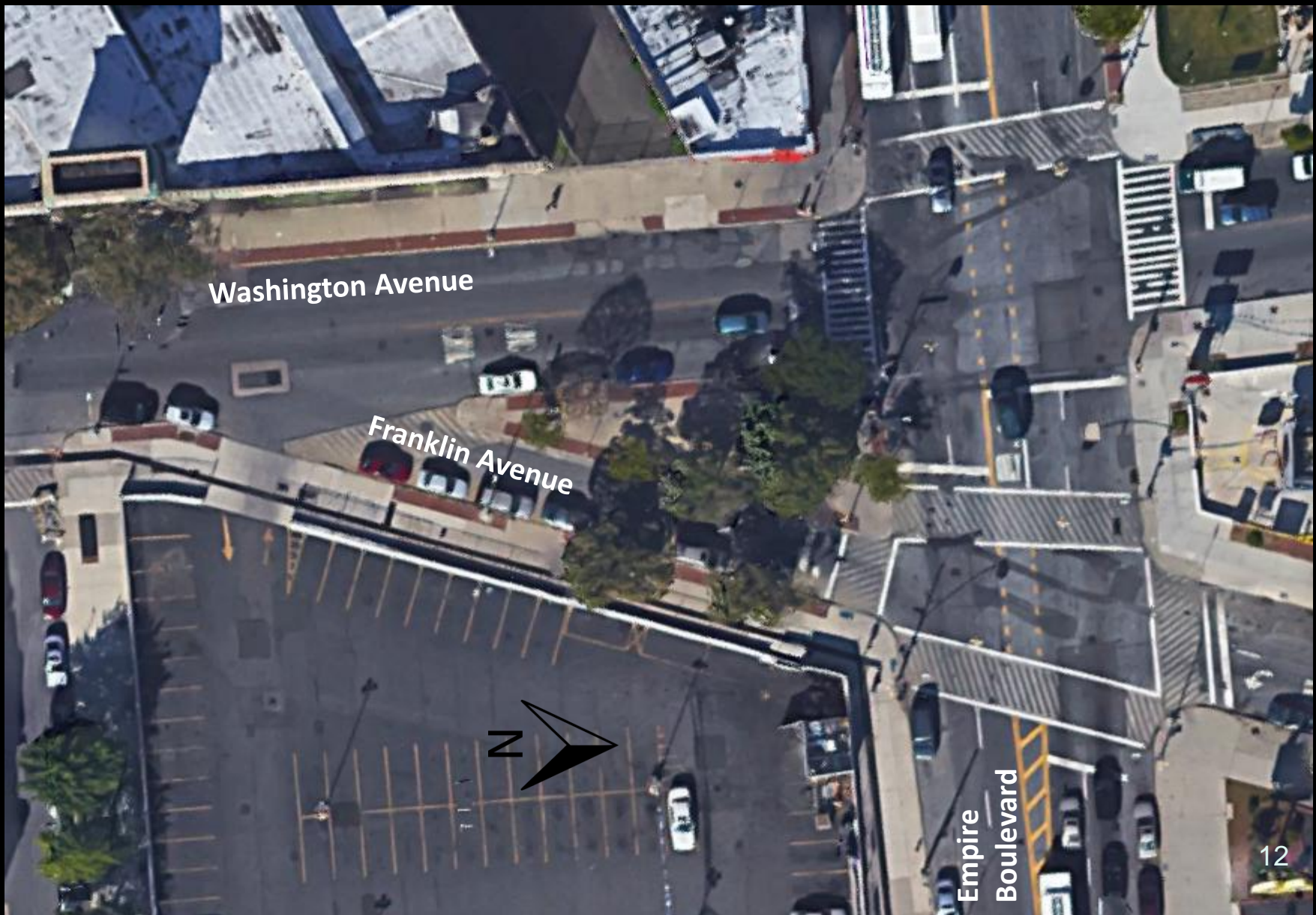

1. Franklin Avenue – Proposed Design

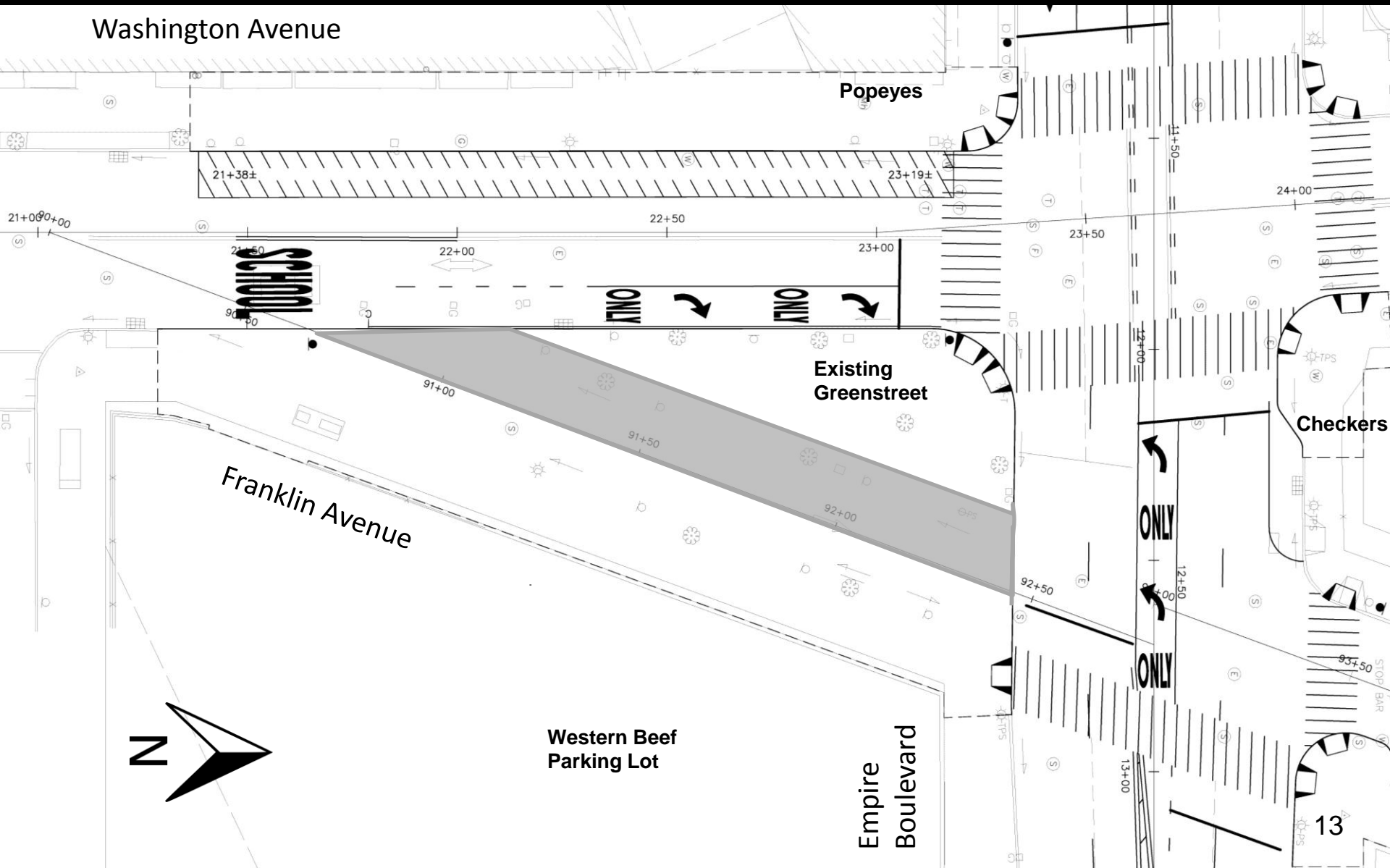

1. Franklin Avenue – Proposed Design

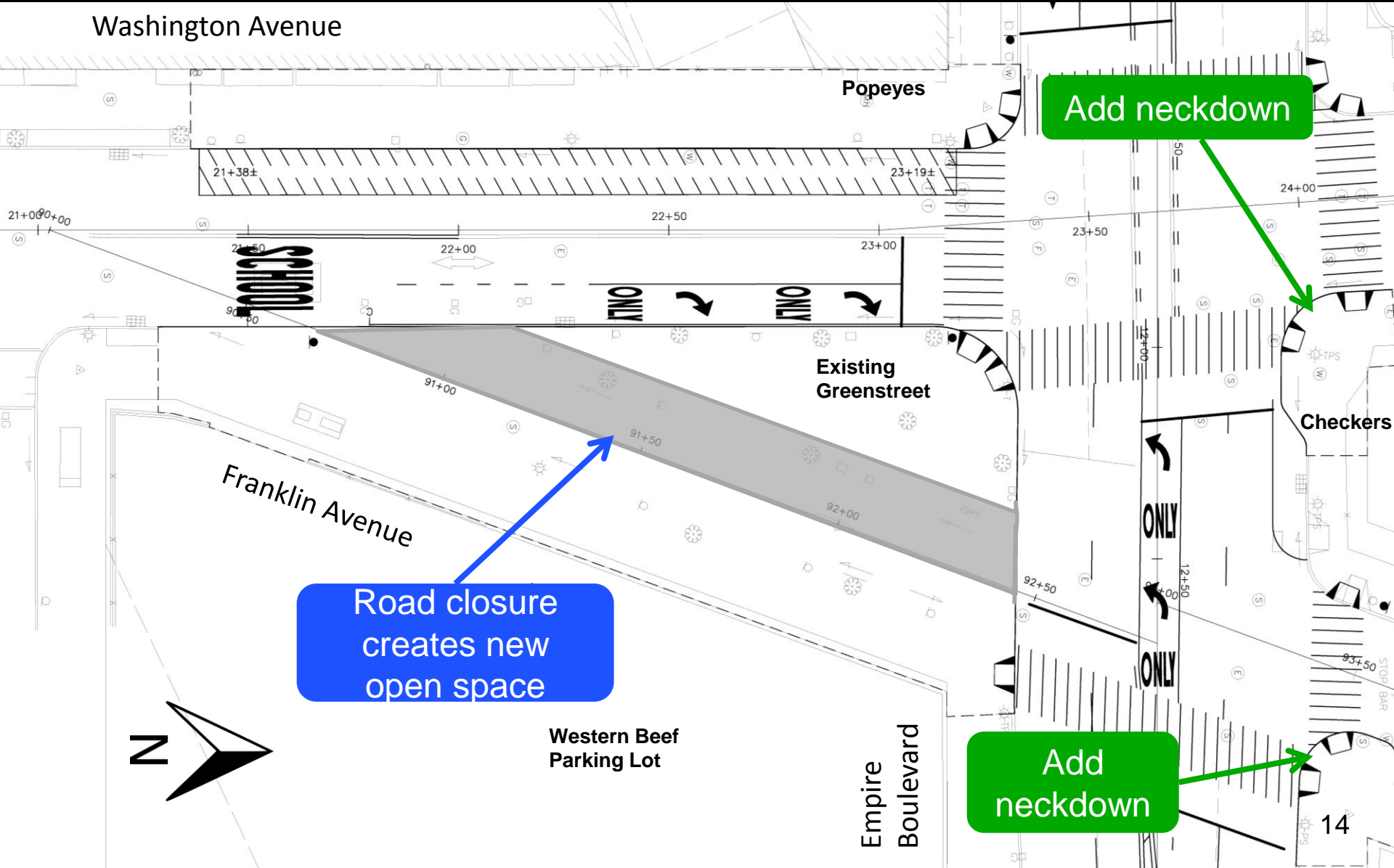

1. Franklin Avenue – Proposed Urban Design



2. Remsen Avenue – Existing Condition

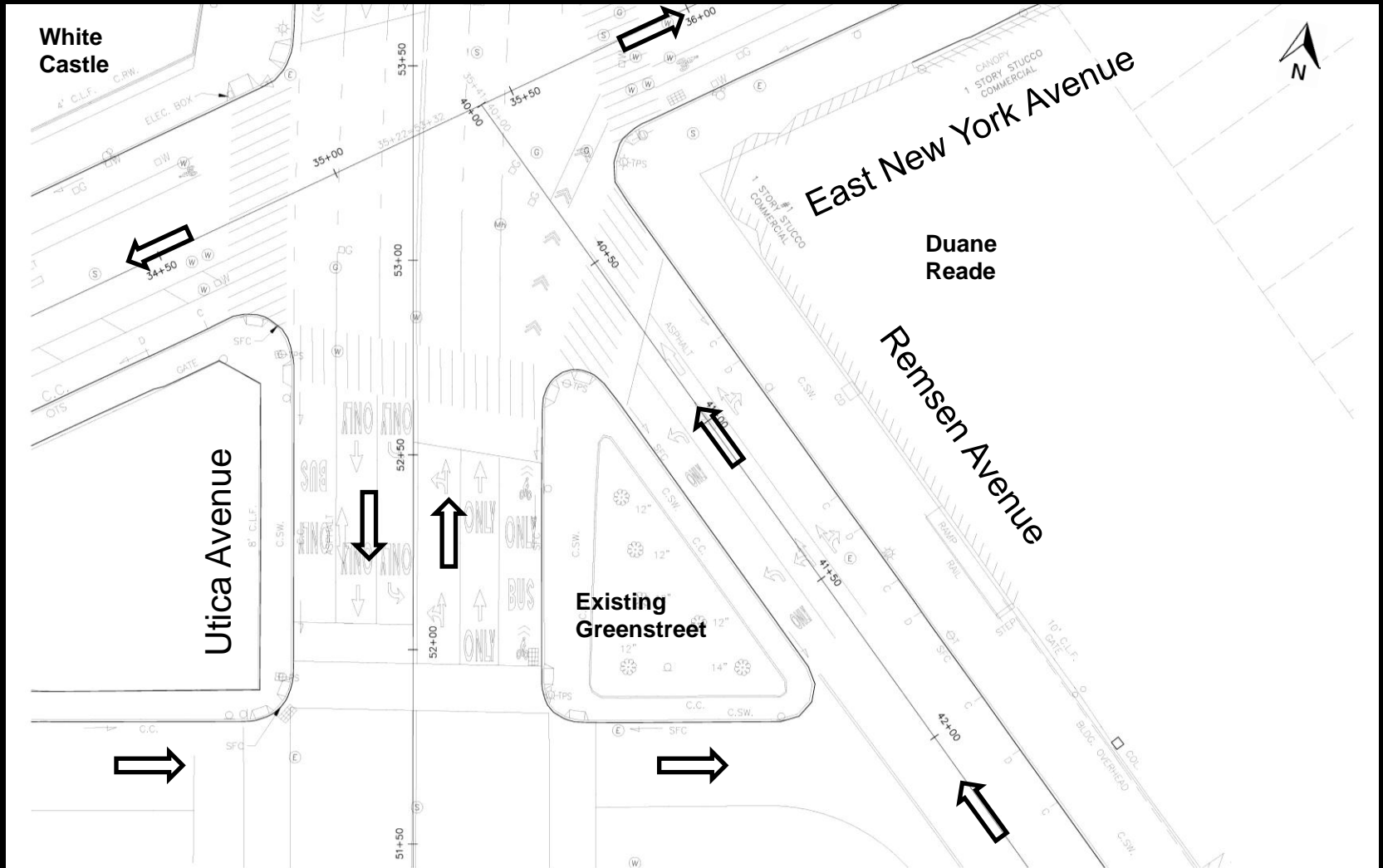

2. Remsen Avenue – Existing Condition

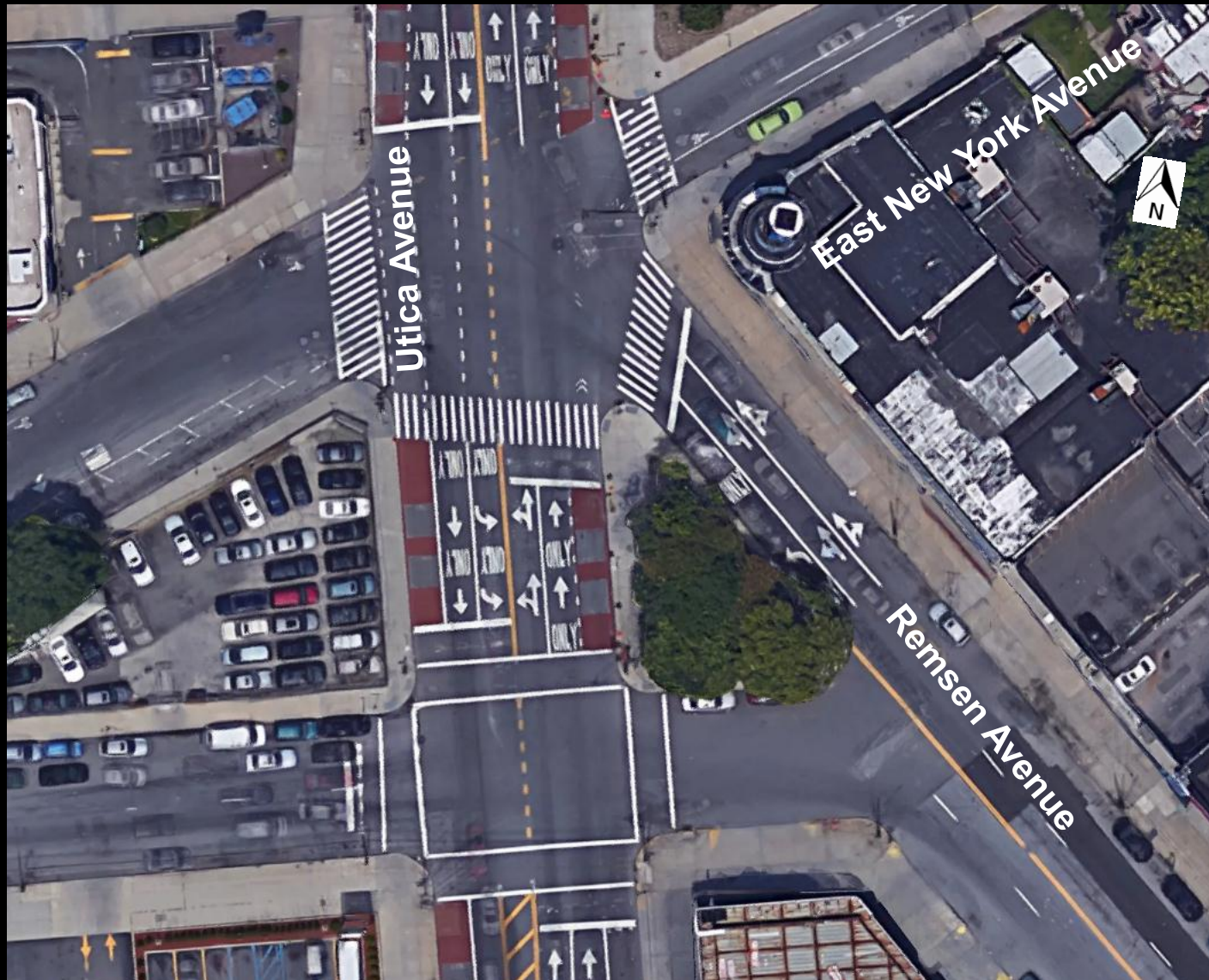

2. Remsen Avenue – Proposed Design

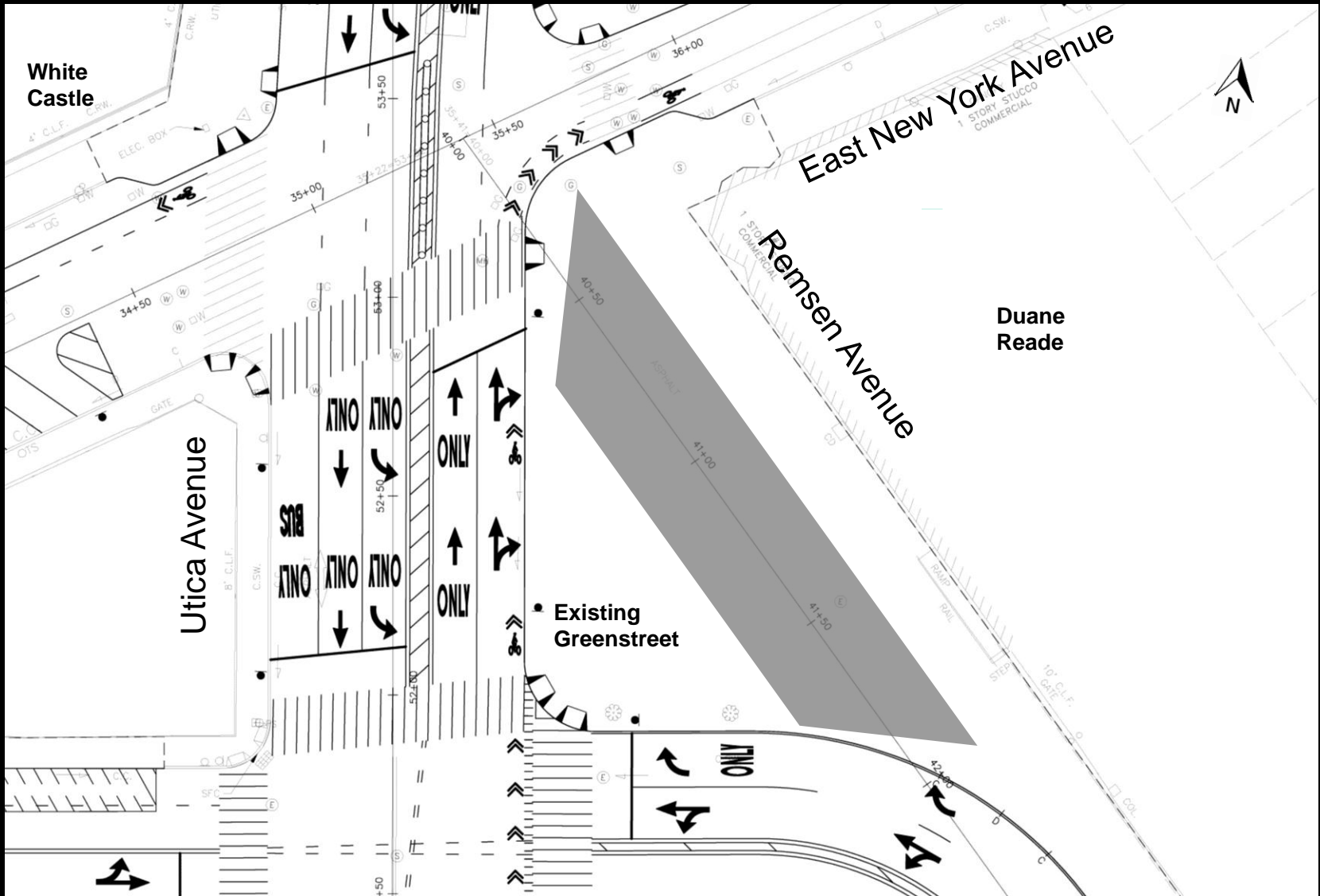

2. Remsen Avenue – Proposed Design

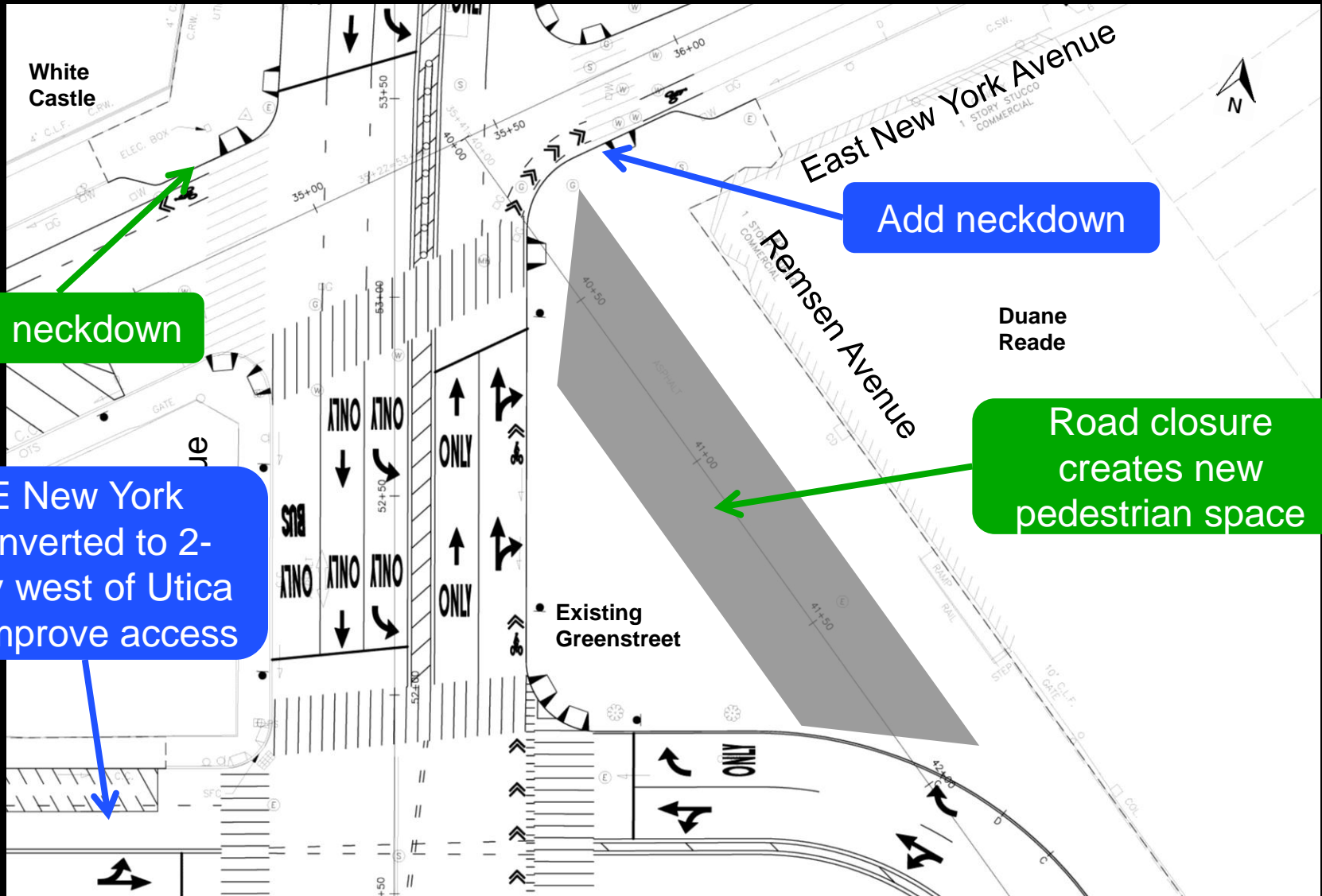

2. Remsen Avenue – Proposed Urban Design



3. Utica Avenue – Existing Condition

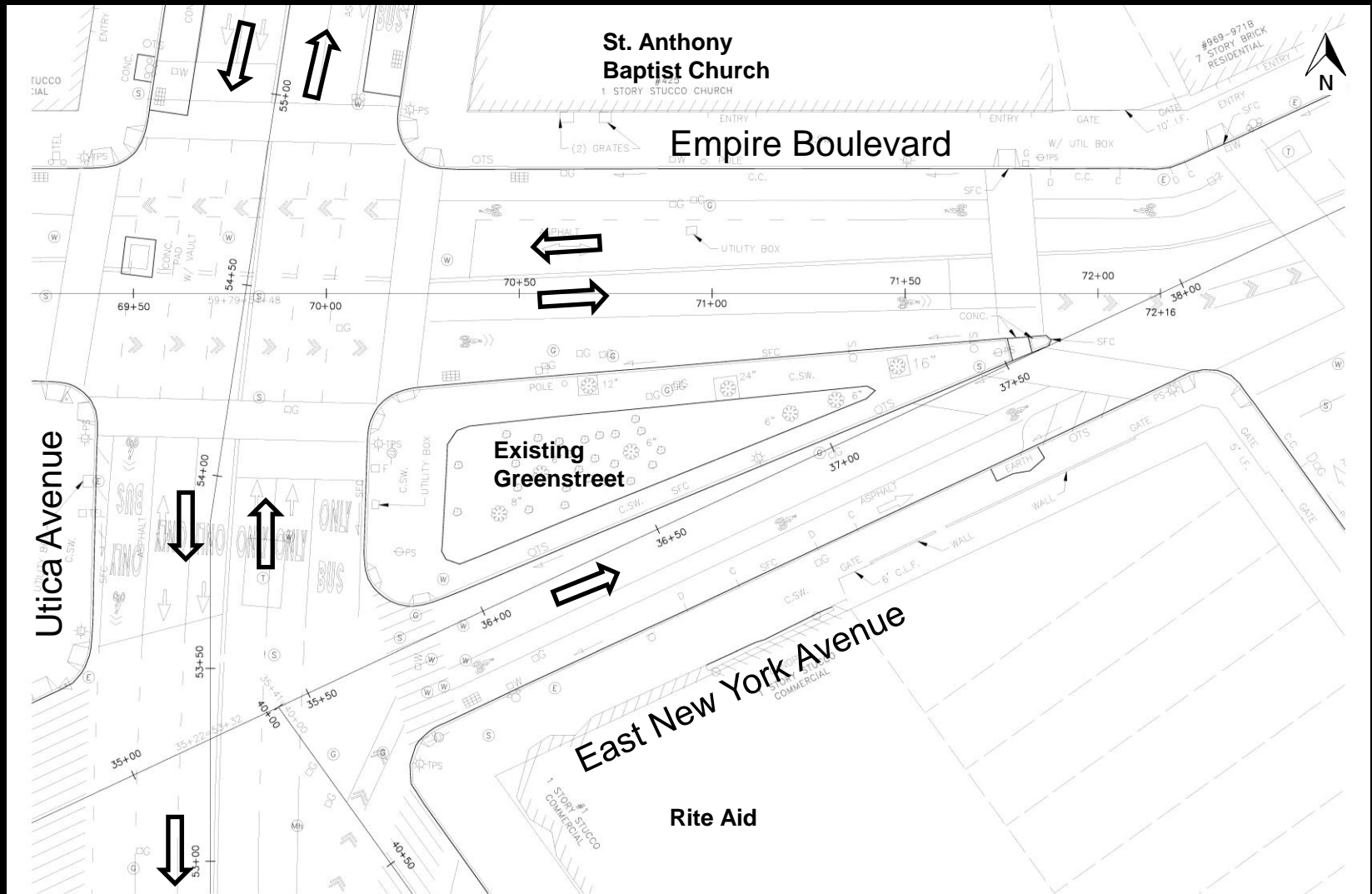

3. Utica Avenue – Existing Condition



3. Utica Avenue – Proposed Design

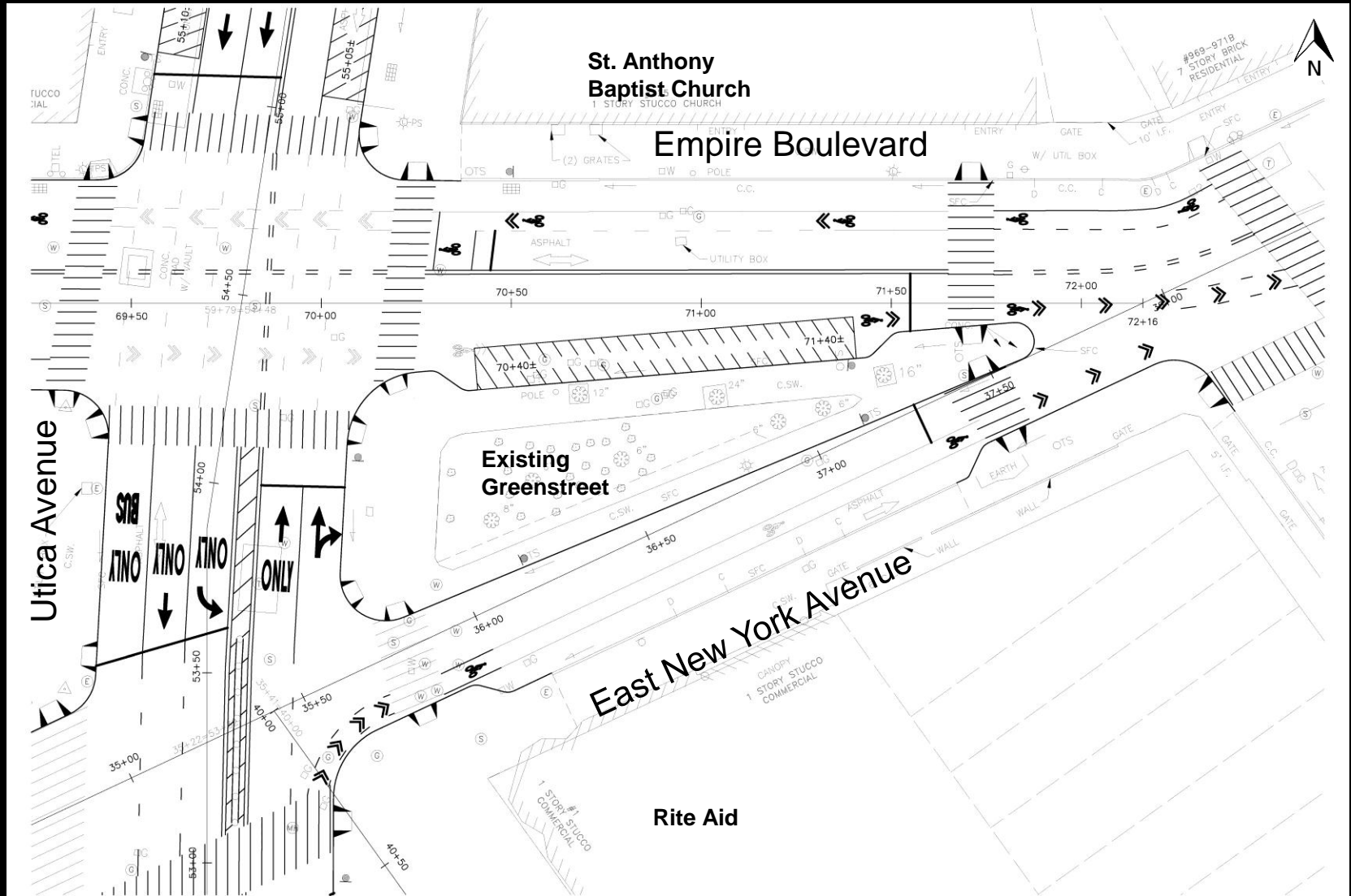

3. Utica Avenue – Proposed Design

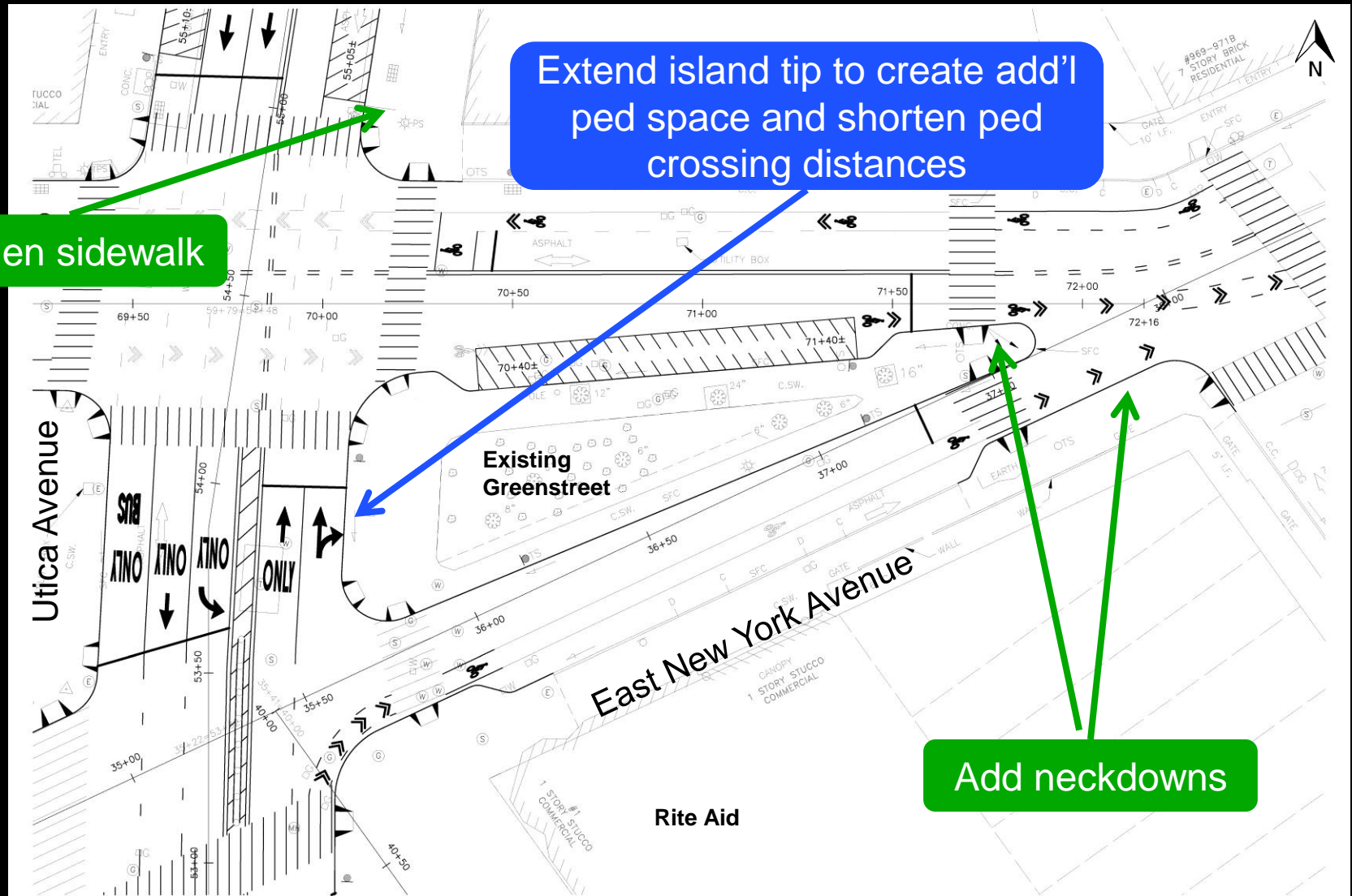

3. Utica Avenue – Proposed Urban Design

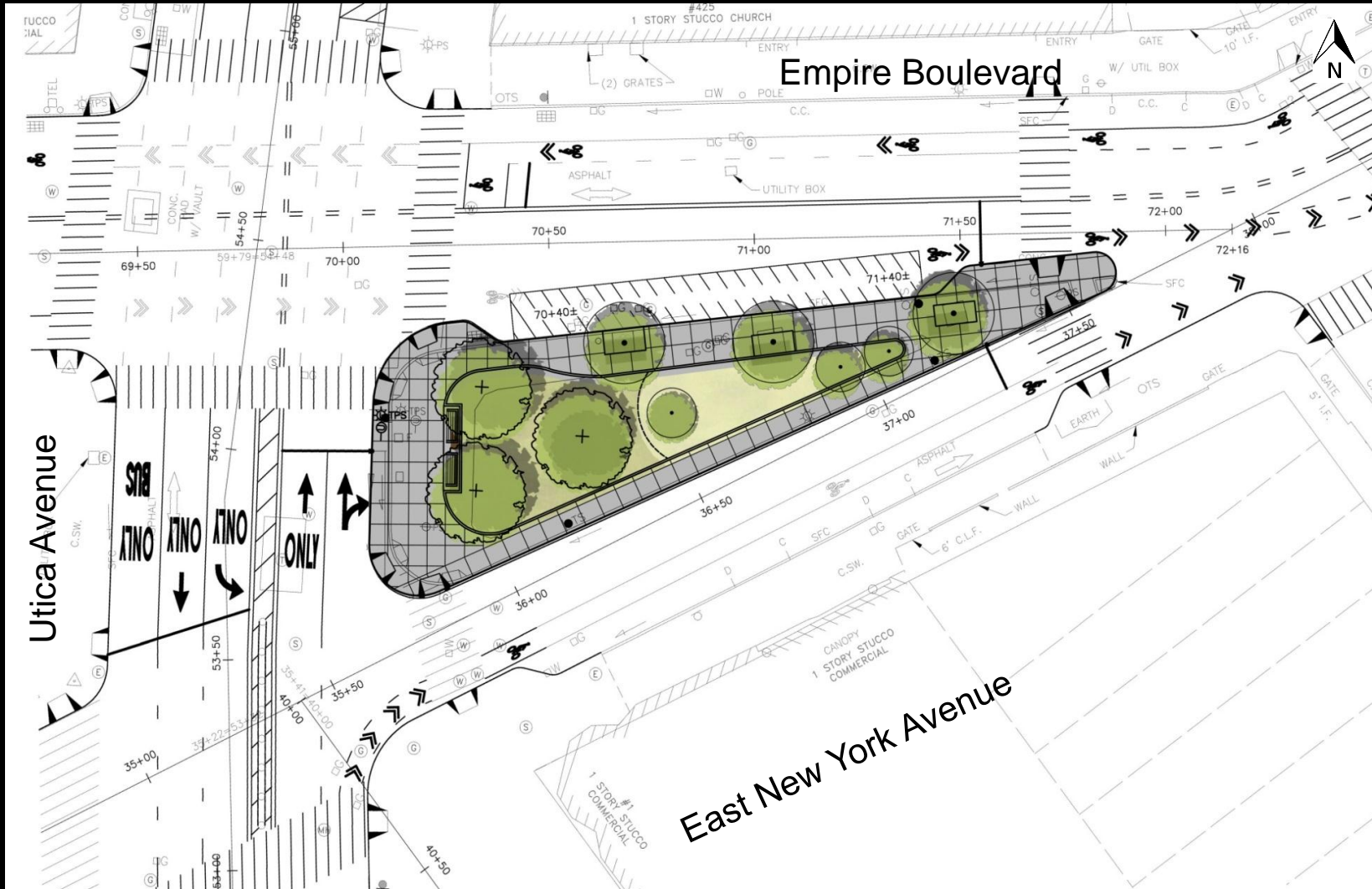

4. Schenectady Avenue – Existing Condition

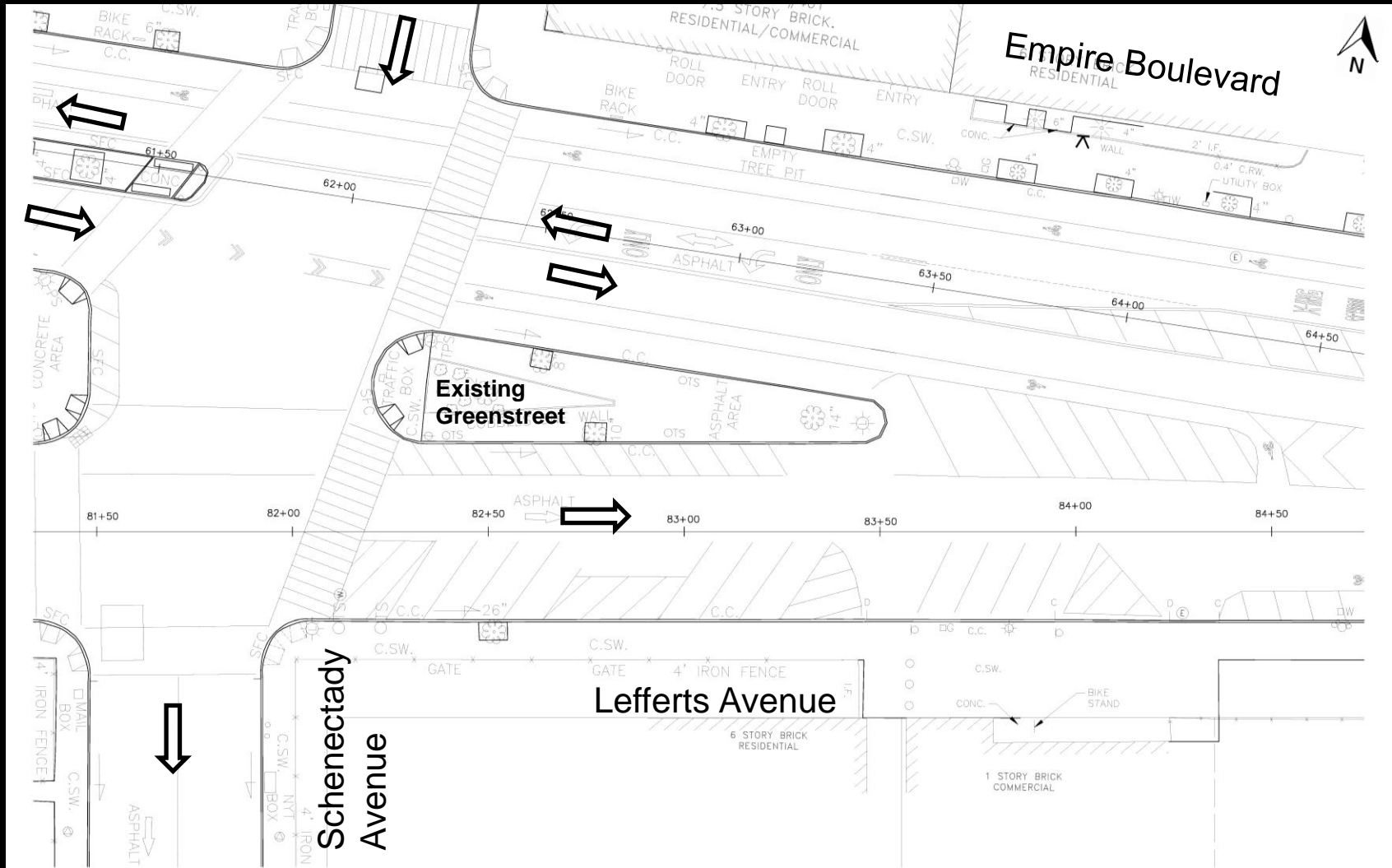

4. Schenectady Avenue – Existing Condition

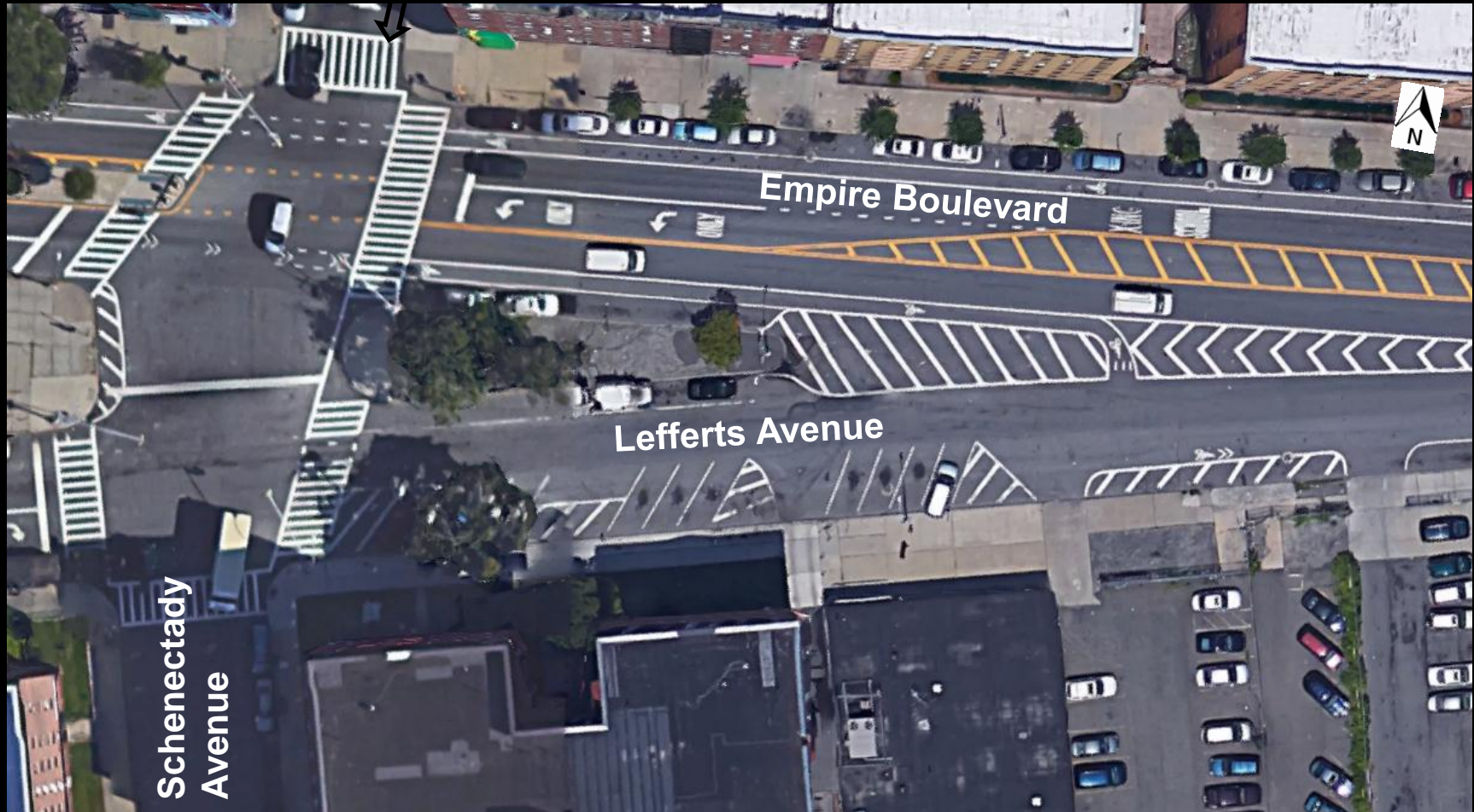

4. Schenectady Avenue – Proposed Design

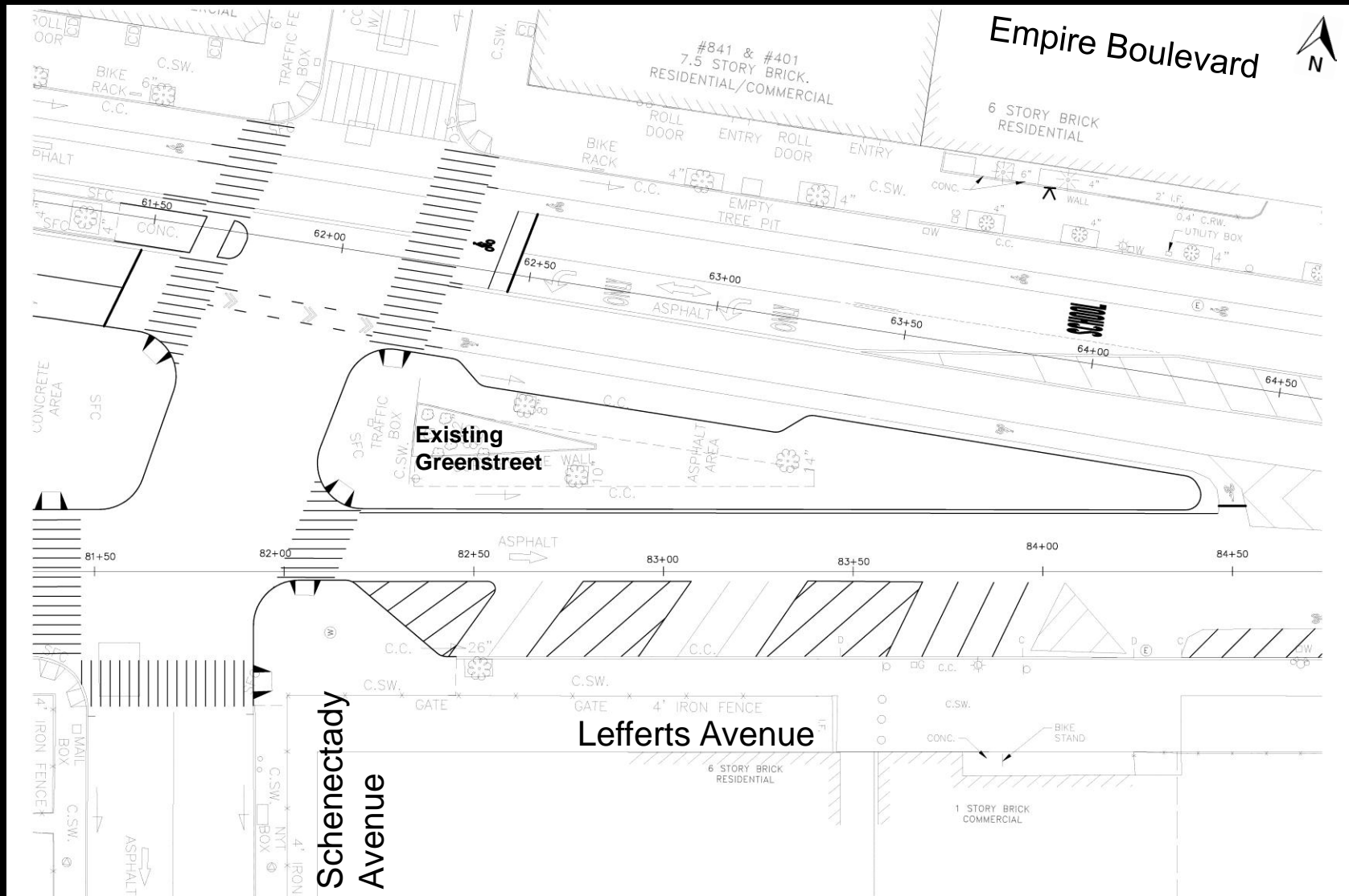

4. Schenectady Avenue – Proposed Design

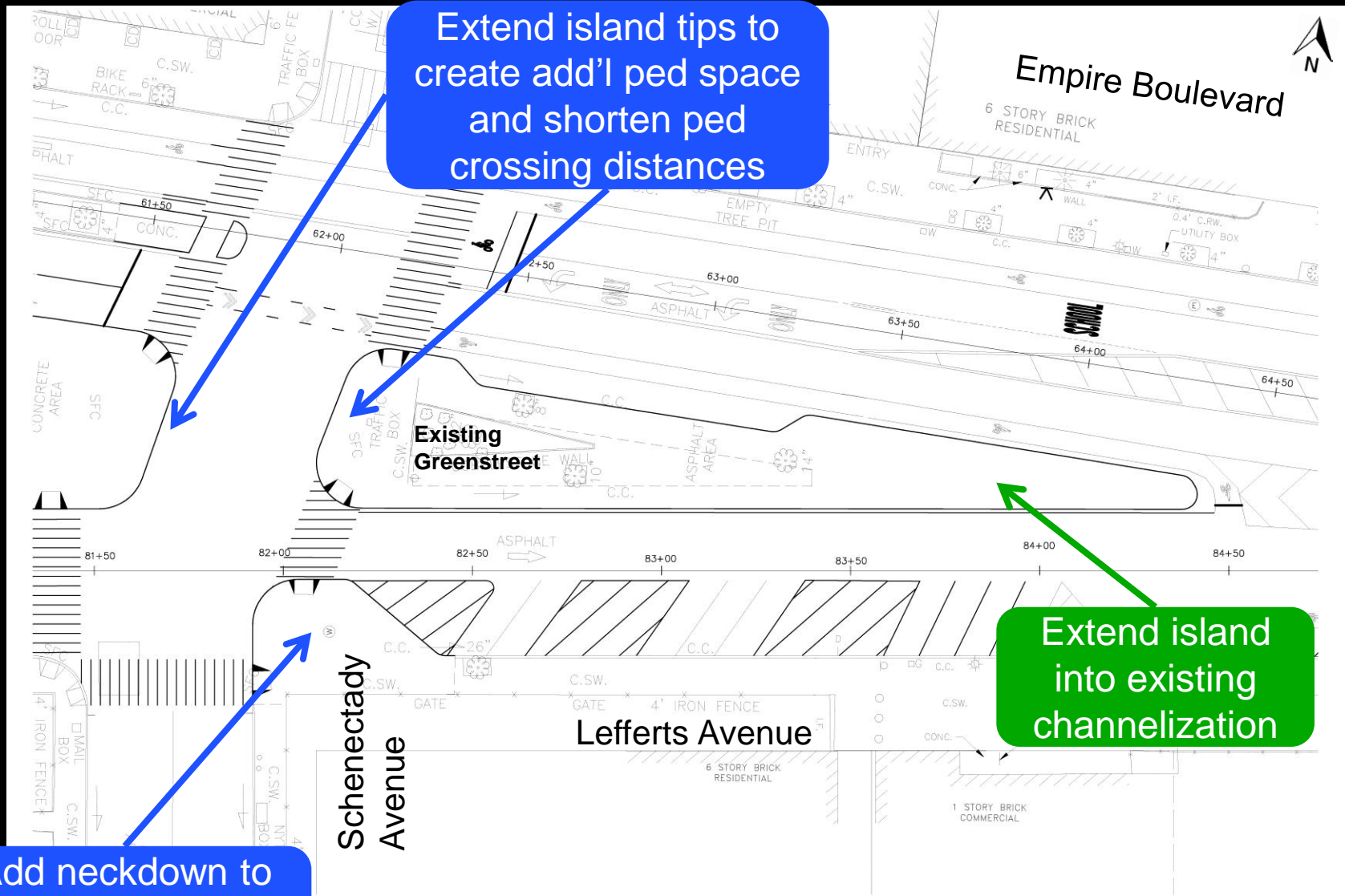

4. Schenectady Avenue – Prop Urban Design



Conclusion

- Improves pedestrian experience on Empire Blvd
- Shortens pedestrian crossing distances
- Clarifies and optimizes existing traffic circulation
- Creates new public spaces for the community
- Balances vehicle, pedestrian, and bicycle operations

Contact: Ronda Messer at
rmesser@dot.nyc.gov

Questions?

Thank
You