



DIVERSITY PLAZA - QUEENS COMMUNITY BOARD 3 TRANSPORTATION COMMITTEE MEETING

MAY 11, 2015



Department of
Design and
Construction



W Architecture and Landscape Architecture, LLC

NEIGHBORHOOD CONTEXT

WALKING RADIUS
3/8 MILE: 7.5 MINUTES

WALKING RADIUS
1/4 MILE: 5 MINUTES

37TH ROAD PLAZA

MTA SUBWAY 7 LINE

ROOSEVELT AVE (BELOW SUBWAY)

ROOSEVELT AVE (BELOW)

JACKSON HEIGHTS

ELMHURST

ODSIDE

BROADWAY

35TH AVE.

37TH AVE.

37TH RD.

76TH ST.

77TH ST.

41ST AVE.

78TH ST.

BROADWAY

72ND ST.

73RD ST.

74TH ST.

75TH ST.

BROOKLYN-QUEENS
EXPRESSWAY

SITE CONTEXT + CIRCULATION

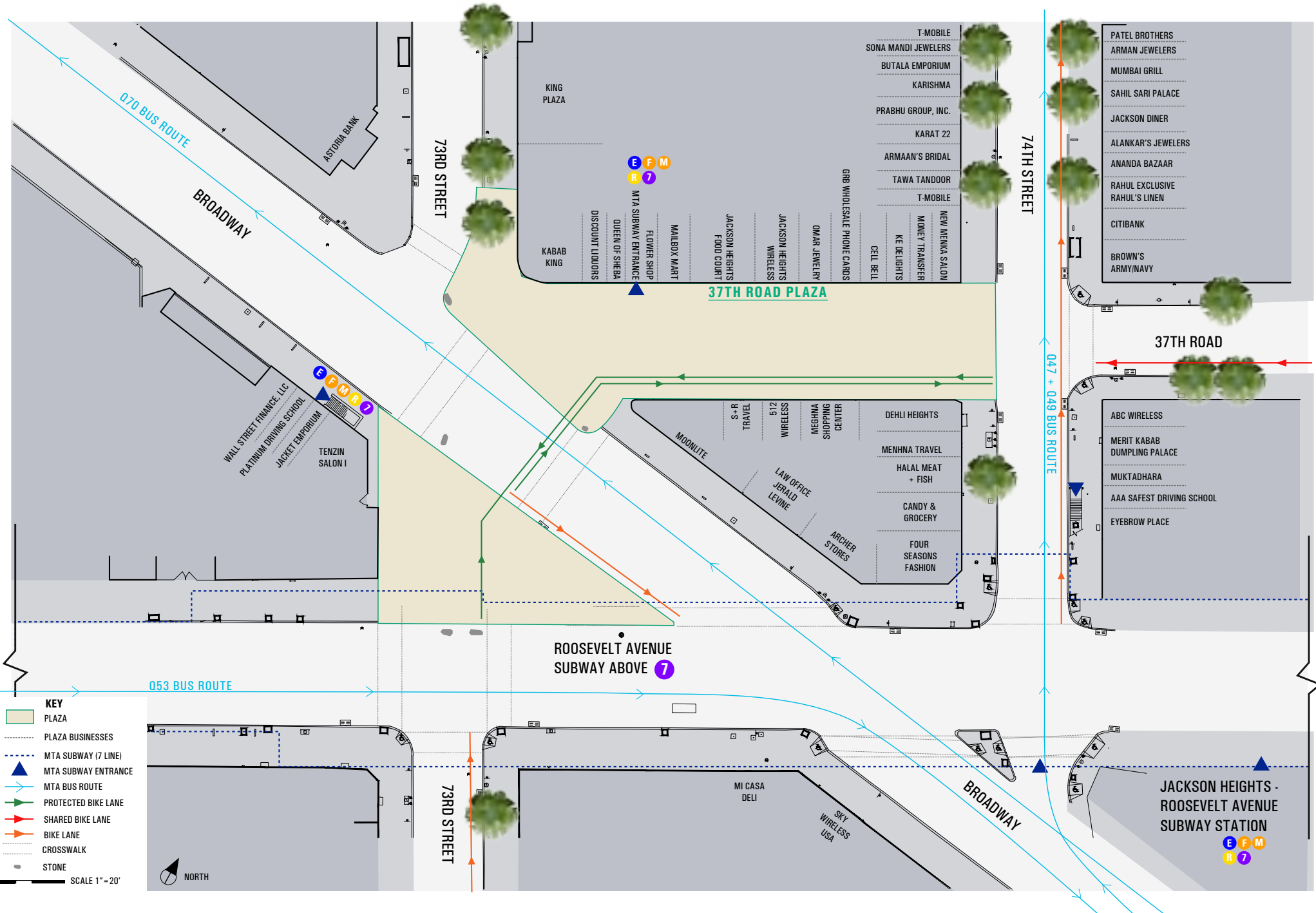

SHADE STUDY

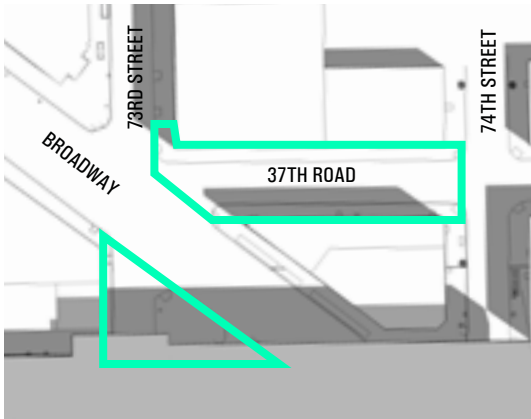

MARCH 21 @ 9 AM

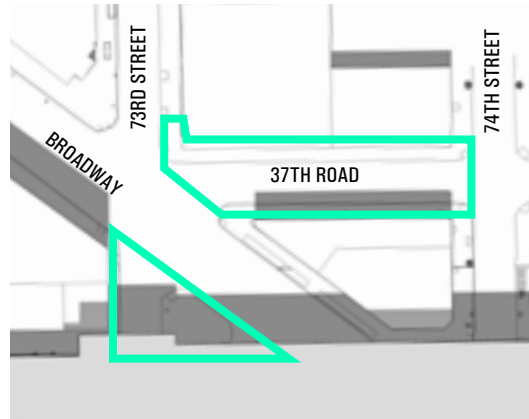

MARCH 21 @ 12 PM

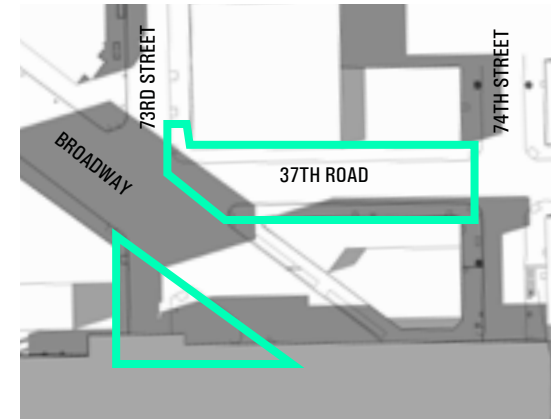

MARCH 21 @ 4 PM

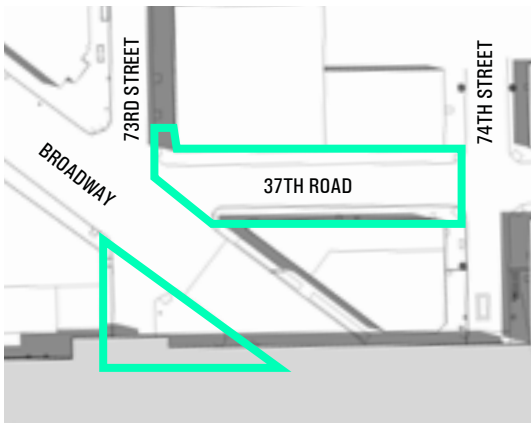

JUNE 21 @ 9 AM

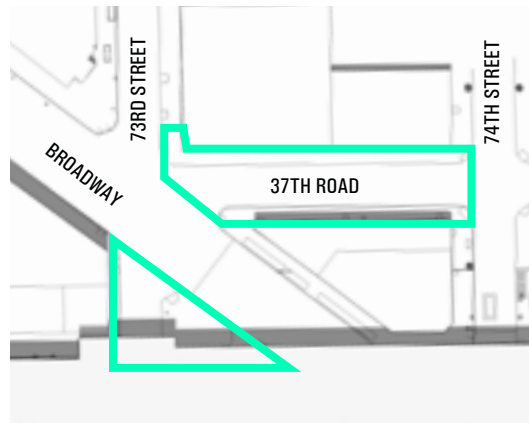

JUNE 21 @ 12 PM

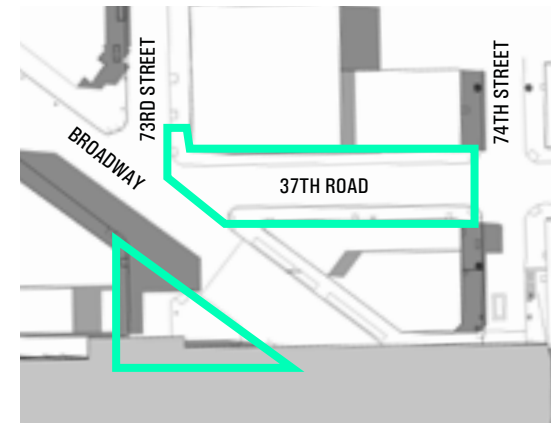

JUNE 21 @ 4 PM

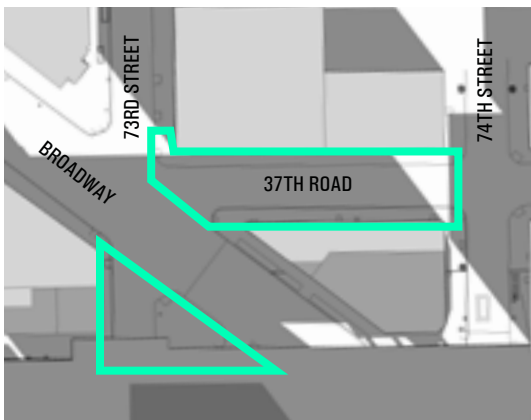

DECEMBER 21 @ 9 AM

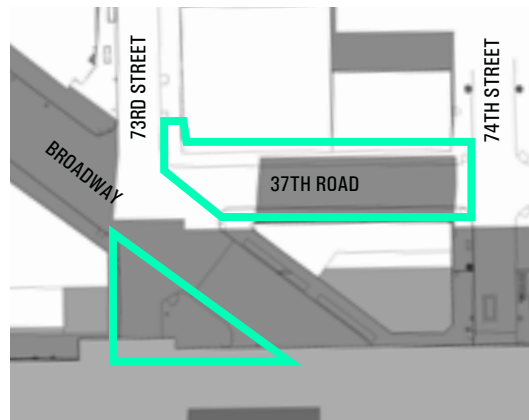

DECEMBER 21 @ 12 PM

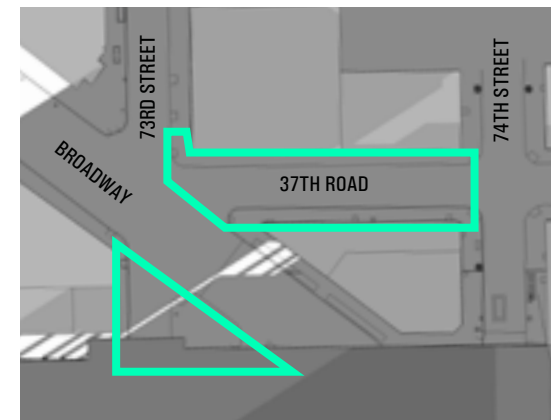

DECEMBER 21 @ 4 PM

FLACID EXPRESS
Worldwide Money Transmitter
Phone : 718-334-0303, 718-282-3506

DELHI HEIGHTS
SARI PALACE

Delhi Heights

HILLI DUMPLING HOUSE

COMMUNITY OUTREACH

PHONE CARDS

FAST FOOD - TAKE-OUT - CATERING - FREE DEL.

FEEDBACK FROM OCTOBER 18 MEETING

- MORE PERMANENT SEATING
- TREES AND VEGETATION
- SHADE STRUCTURES
- BETTER PAVING OPTIONS
- ACCESS TO GARBAGE CANS
- SPACE FOR PLAY/EVENTS
- JACKSON HEIGHTS SIGNAGE
- SPACE FOR ART
- FIRE TRUCK ACCESS
- STORMWATER DRAINAGE
- LOADING
- EASY ACCESS TO AND FROM RETAIL





FEEDBACK FROM MAY 9 COMMUNITY MEETING

- KEEP PLAZA OPEN FOR EVENTS
- MORE STABLE SEATING AND TABLES
- UMBRELLAS NEED TO BE MORE DURABLE
- KEEP NOISE AWAY FROM 73RD ST
- MORE TREES
- MORE PLAZA LIGHTING
- MORE COLOR IN PLANTED AREAS
- PROVIDE SPACE FOR NOTICES TO BE POSTED
- KEEP SPACE OPEN FOR TEMPOARY ART



The image is a detailed architectural site plan of an urban intersection. The central feature is a large, rectangular plaza with a checkered tile pattern, labeled "DIVERSITY PLAZA" in two locations. The plaza is bordered by a "ROADWAY" that runs diagonally from the bottom left towards the top right. To the left of the plaza, there is a "PARKING" area and a "1ST STY. BLOCK BLDG.". To the right, there is a "2STY. BRICK BLDG." and a "1ST STY. STUCCO BLDG.". The intersection is defined by "73rd STREET" running vertically on the left and "74th STREET" running vertically on the right. "ROOSEVELT AVENUE" runs horizontally across the bottom. The plan includes various building footprints with labels such as "1STY. BRICK BLDG.", "2STY. STUCCO BLDG.", "3STY. STUCCO BLDG.", "2STY. STONE BLDG.", "2STY. CONC. BLDG.", "2STY. BRICK BLDG.", "1STY. BRICK & STUCCO BLDG.", "1STY. BRICK BLDG.", "2STY. BRICK BLDG.", "1STY. STUCCO BLDG.", "2STY. BLOCK BLDG.", "2STY. BRICK BLDG.", "5STY. GLAS AND BRICK BLDG.", and "3STY. BLOCK BLDG.". The plan also shows street furniture, trees, and pedestrian crossings.

CONSTRAINTS AND SCHEMATIC LANDSCAPE / URBAN DESIGN

DIVERSITY PLAZA CONSTRAINTS

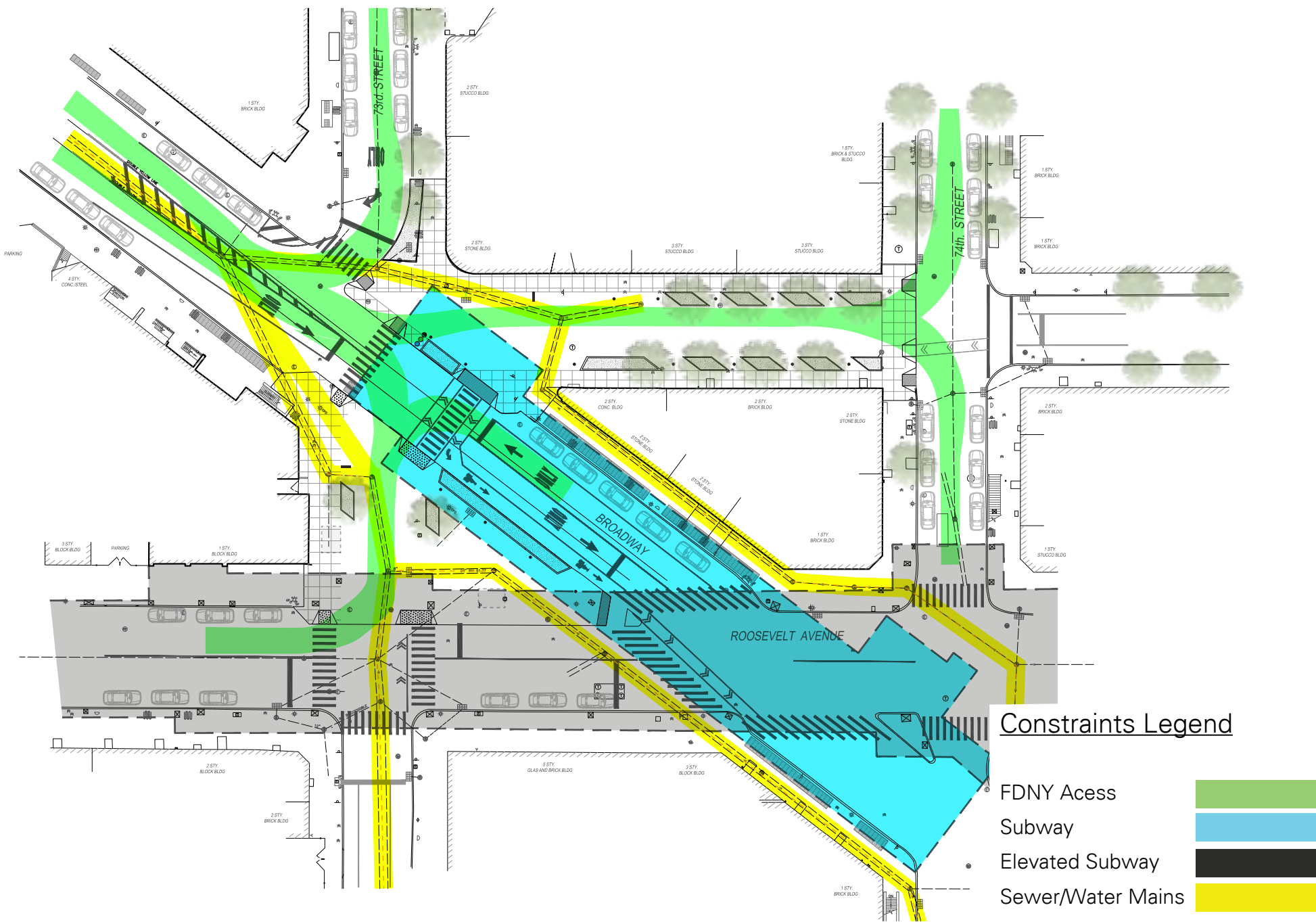

This architectural site plan illustrates the layout of the Diversity Plaza area. The plan is bounded by 73rd Street to the north, 74th Street to the east, Broadway to the south, and Roosevelt Avenue to the west. The central feature is the Diversity Plaza, which is a large, open space with a grid pattern of trees and planters. To the north of the plaza, there are several buildings, including a 1-story brick building, a 2-story stucco building, and a 3-story stone building. To the east of the plaza, there are more buildings, including a 1-story brick building, a 2-story brick building, and a 3-story brick building. To the south of the plaza, there is a large, white, rectangular building. To the west of the plaza, there is a 3-story block building and a 1-story block building. The plan also shows various streets, including Broadway, Roosevelt Avenue, 73rd Street, and 74th Street, with their respective traffic patterns and intersections. Landscaping elements, such as trees and planters, are distributed throughout the plaza and along the streets.

SCHEMATIC LANDSCAPE / URBAN DESIGN

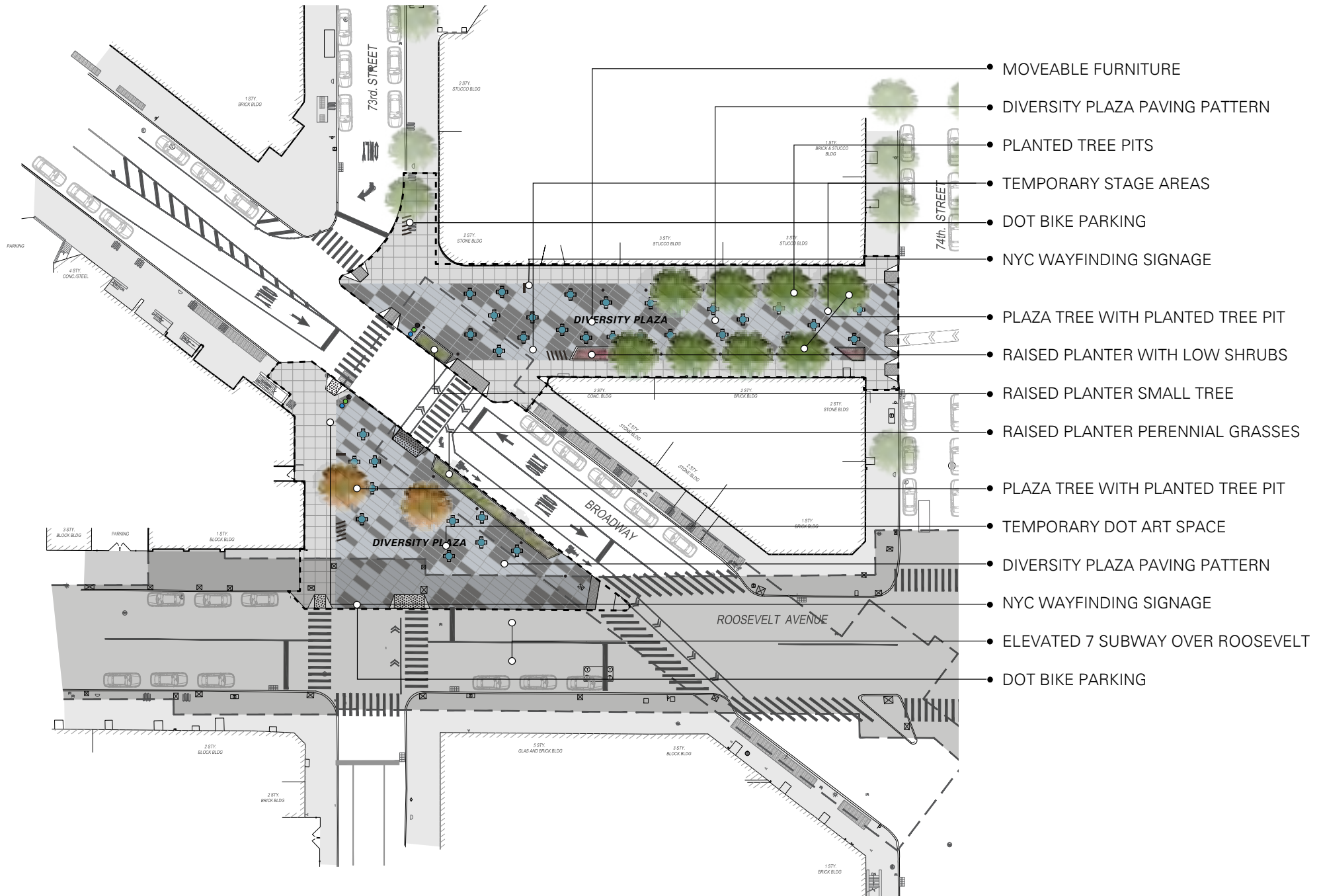

SCHEMATIC LANDSCAPE / URBAN DESIGN DIMENSIONS

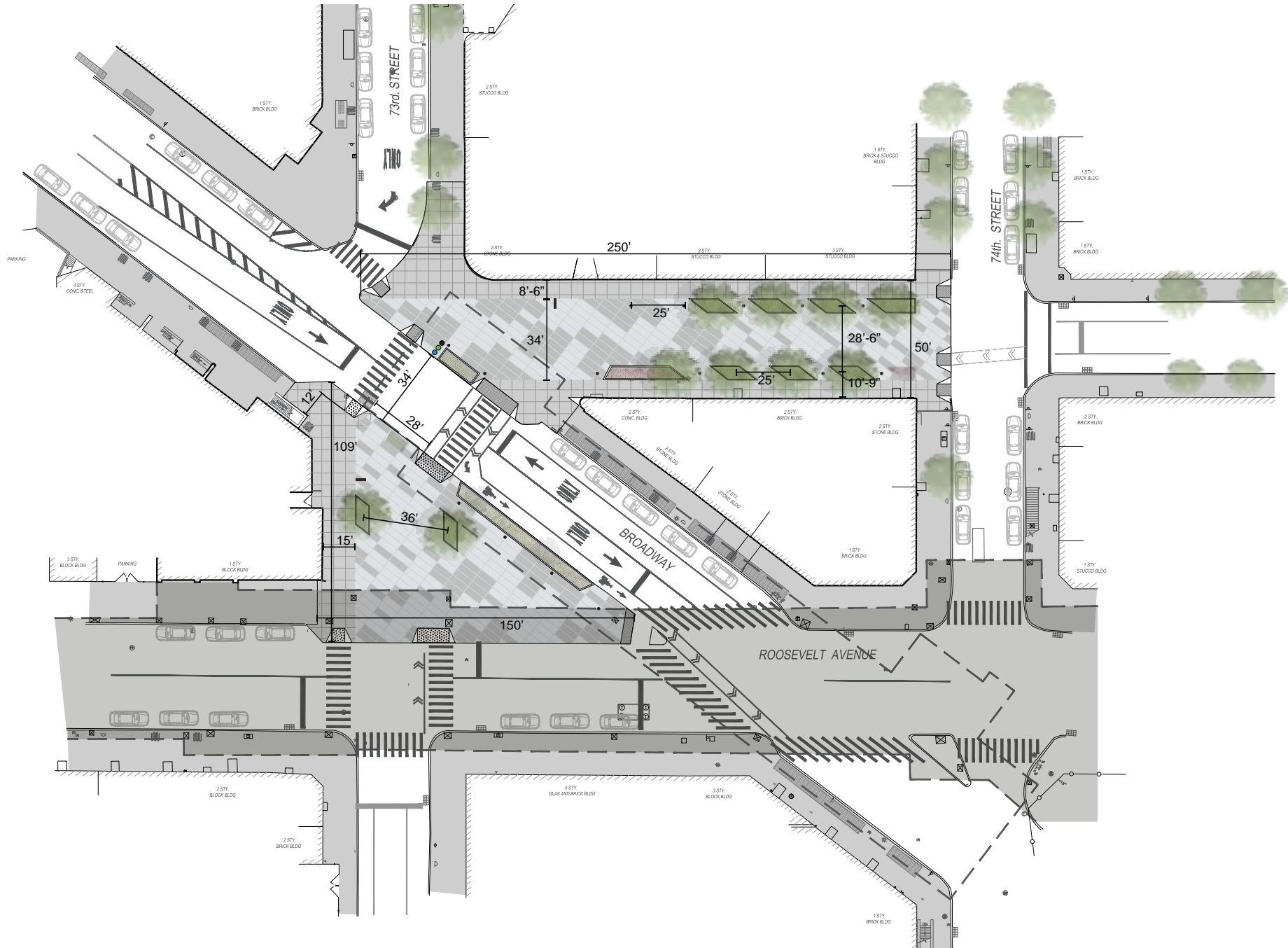



DIVERSITY PLAZA PLANTING

PLANTING



RAISED PLANTERS



TREES IN TREE PITS



PERENNIAL GRASSES FOR BROADWAY



COLORFUL PERENNIALS FOR PLAZA

TREE OPTIONS - *gleditsia triacanthos* - Honey Locust



TREE OPTIONS - *Liquidambar styraciflua* - Sweetgum



A photograph of a city plaza, likely in New York City, showing a mix of historic and modern architecture. On the left, a historic building with arched windows and doorways is visible. To the right, a modern brick building with large windows stands. The plaza is filled with people walking, sitting at outdoor tables, and standing near art displays. There are trees, a street lamp, and a fire hydrant in the foreground. The overall scene is a vibrant urban space.

DOT PLAZA STANDARDS / CONSIDERATIONS

PAVING



PIGMENTED CONCRETE: COOL BLACK



PIGMENTED CONCRETE: LANDMARK GREY

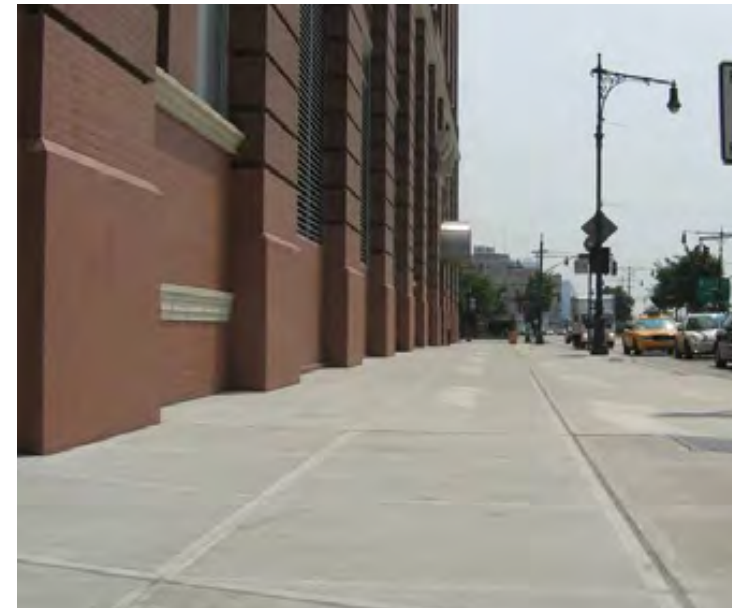

DOT STANDARD UNPIGMENTED CONCRETE

PAVING GRADIENT / PIGMENTS

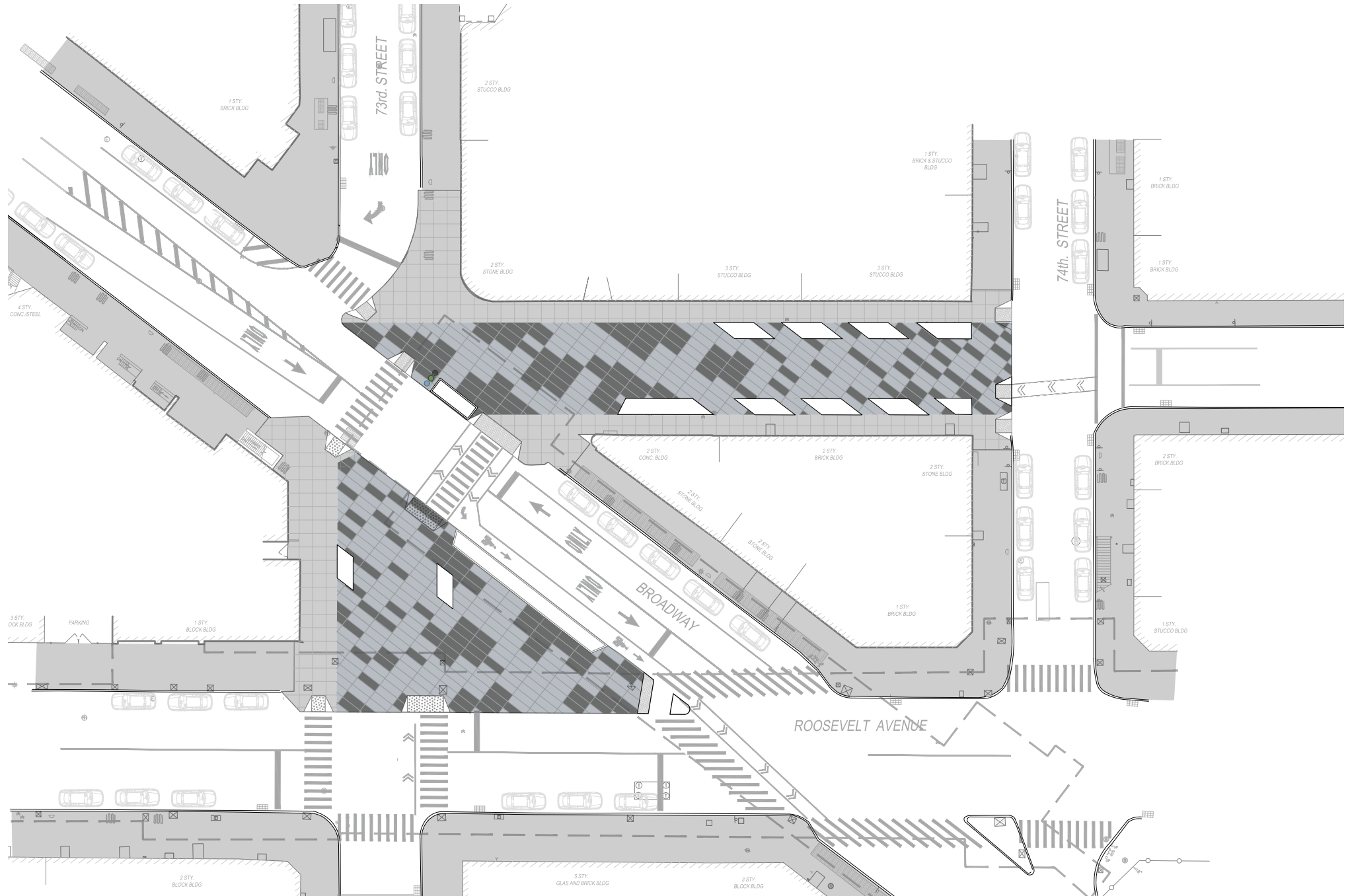

SITE FURNISHINGS



CEMUSA PUBLIC TOILET



DOT BIKE RACKS 'CityRack'



MOVEABLE FURNITURE



DOT PLAZA LIGHTING



WalkNYC Sign Family



WASTE RECEPTACLE

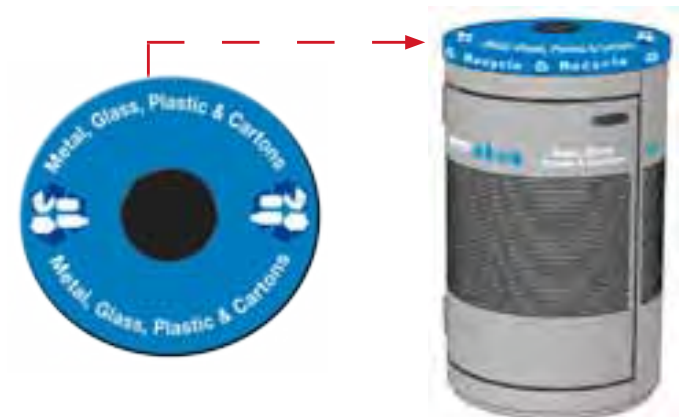
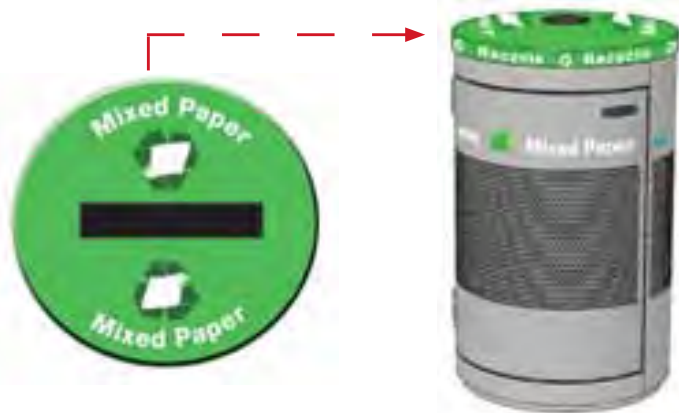

[illegible]



NEXT STEPS:

- A. COMMUNITY BOARD 3 TRANSPORTATION COMMITTEE, MONDAY, MAY 11 @ 7PM
FULL BOARD MEETING THURSDAY, MAY 21ST 7:45PM**
- B. PUBLIC DESIGN COMMISSION REVIEW (SPRING 2015)**
- C. DESIGN COMPLETE AND OUT TO BID (WINTER 2015)**
- D. CONSTRUCTION START (SUMMER 2016)**
- E. PLAZA COMPLETE 2017**