

# Edward L Grant Highway

## Safety Improvements

Spring  
2014



Commissioner Polly Trottenberg New York City Department of Transportation  
Presented to Bronx Community Board 4 Municipal Services Committee on April 2, 2014



# Agenda

- **Project background**
- **Existing conditions**
- **Design goals**
- **Proposed design**
- **Schedule**

# Vision Zero



- New York City's commitment to improve street safety in every neighborhood and in every borough
- **NYCDOT Action:** develop street designs and configurations that improve safety



[illegible]



# Project location

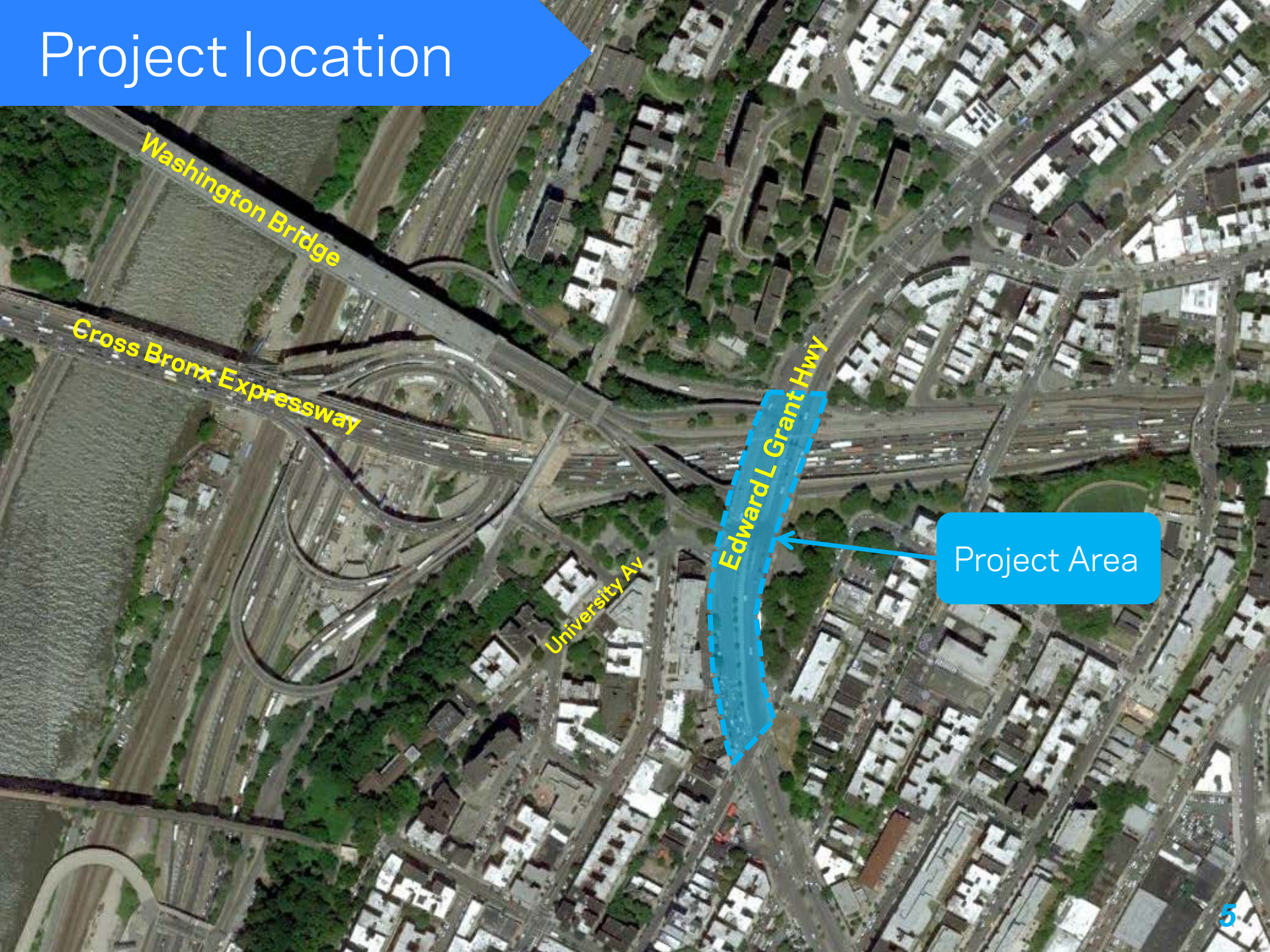



# Existing Conditions - Pedestrians

- **High pedestrian volumes near Washington Bridge**
- Long pedestrian crossings
- Lack of amenities at bus stops (shelters, seating)

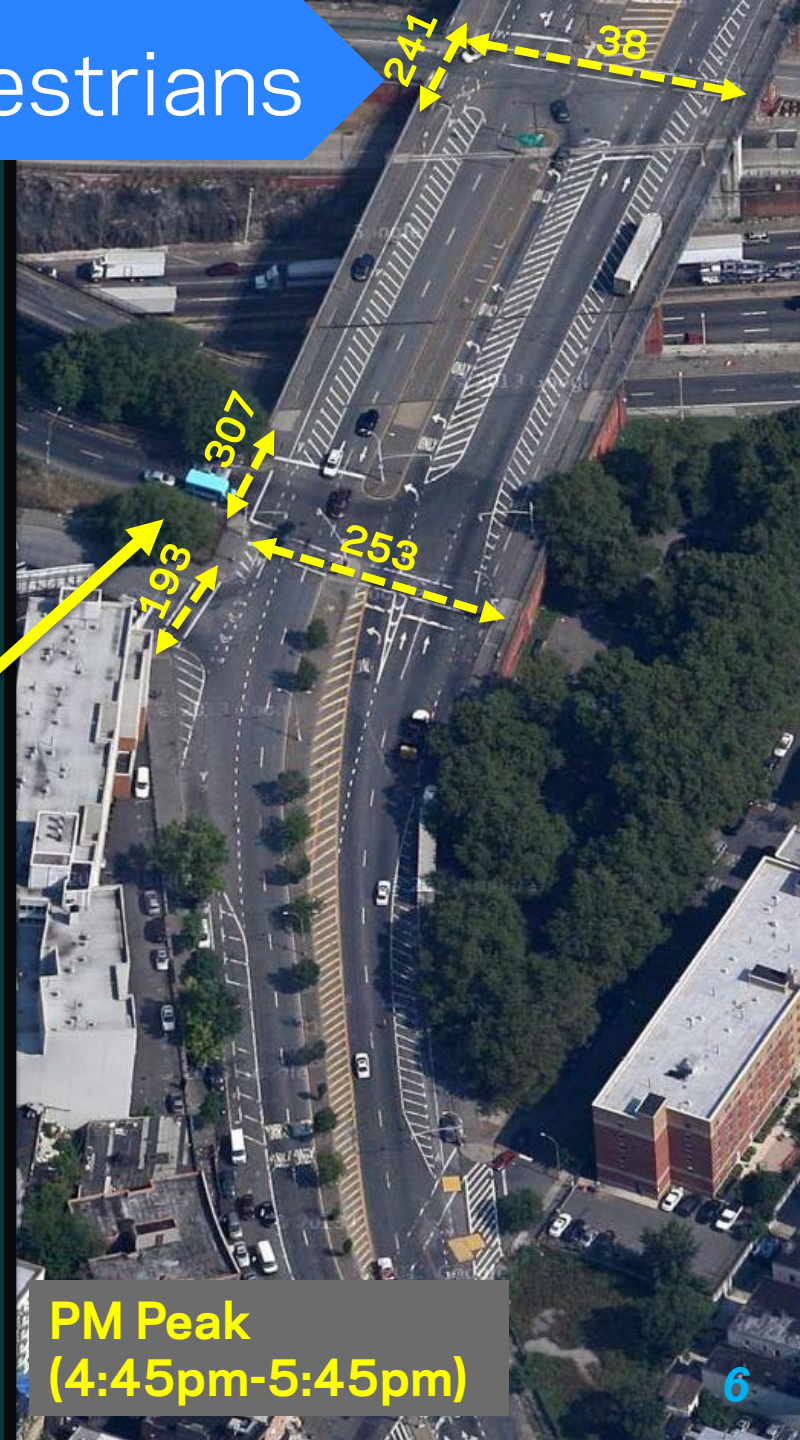



# Existing Conditions - Pedestrians

- High pedestrian volumes near Washington Bridge
- **Long pedestrian crossings**
- Lack of amenities at bus stops (shelters, seating)

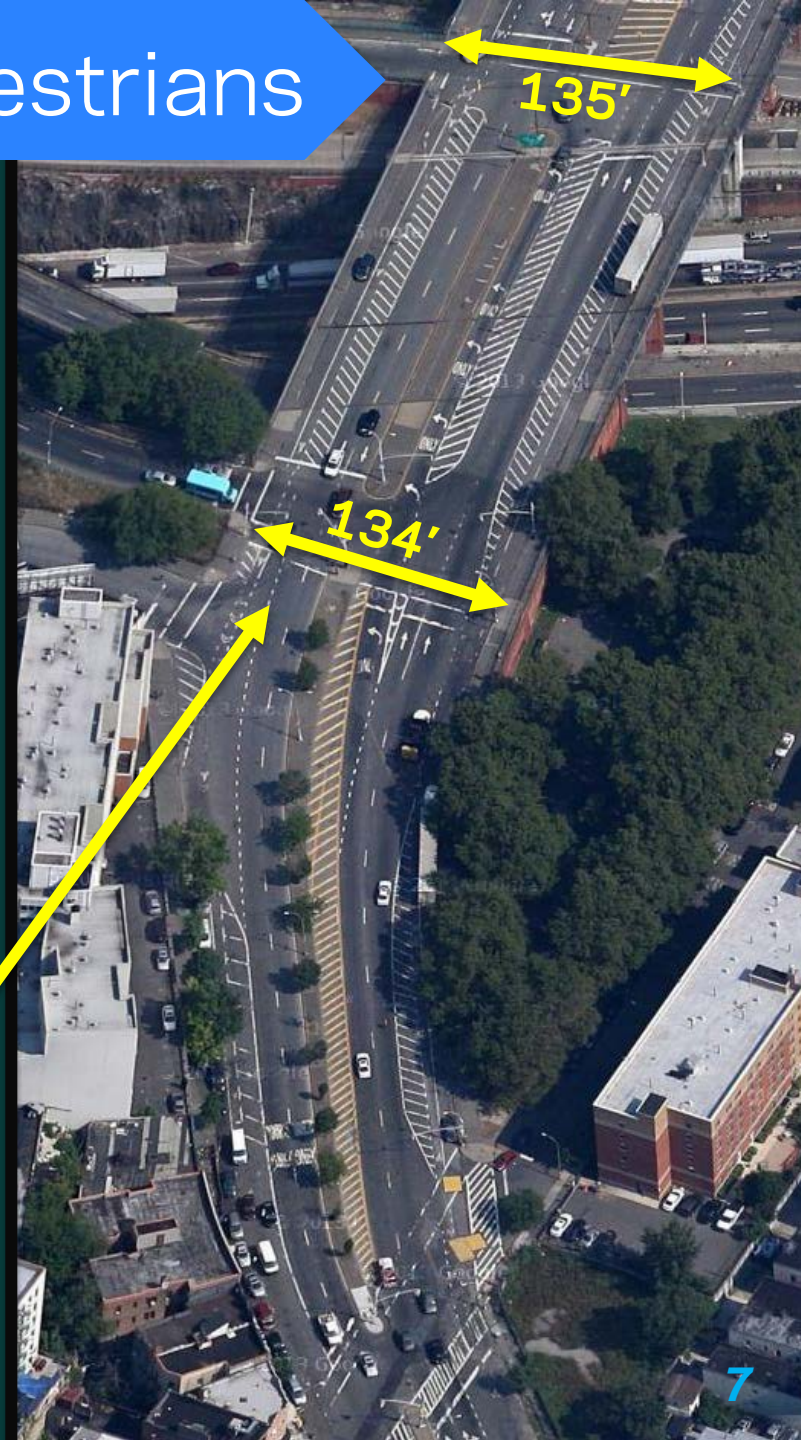



# Existing Conditions - Pedestrians

- Long pedestrian crossings
- High pedestrian volumes near Washington Bridge
- **Lack of amenities at bus stops (shelters, seating)**

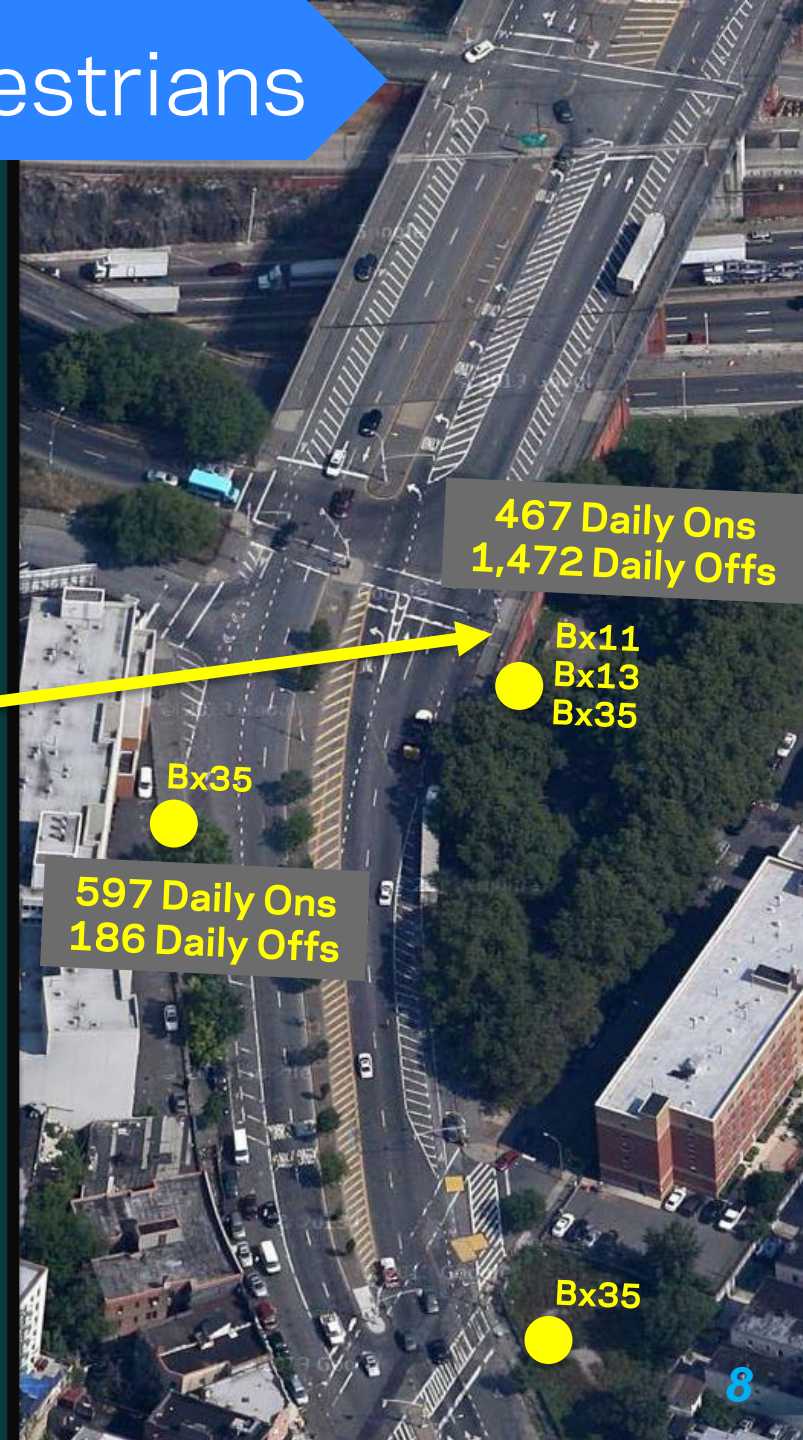



# Existing Conditions - Traffic

- **High crash corridor (top 10%)**
- Over 30 buses / hour must cross three lanes of traffic to make left-turn onto Bridge
- Poor curb alignment at the Bx35 bus stop



**2008-2012**  
**Motorist Injuries**  
**Pedestrian Injuries**



# Existing Conditions - Traffic

- High crash corridor (top 10%)
- **Over 30 buses / hour must cross three lanes of traffic to make left-turn onto Bridge**
- Poor curb alignment at the Bx35 bus stop

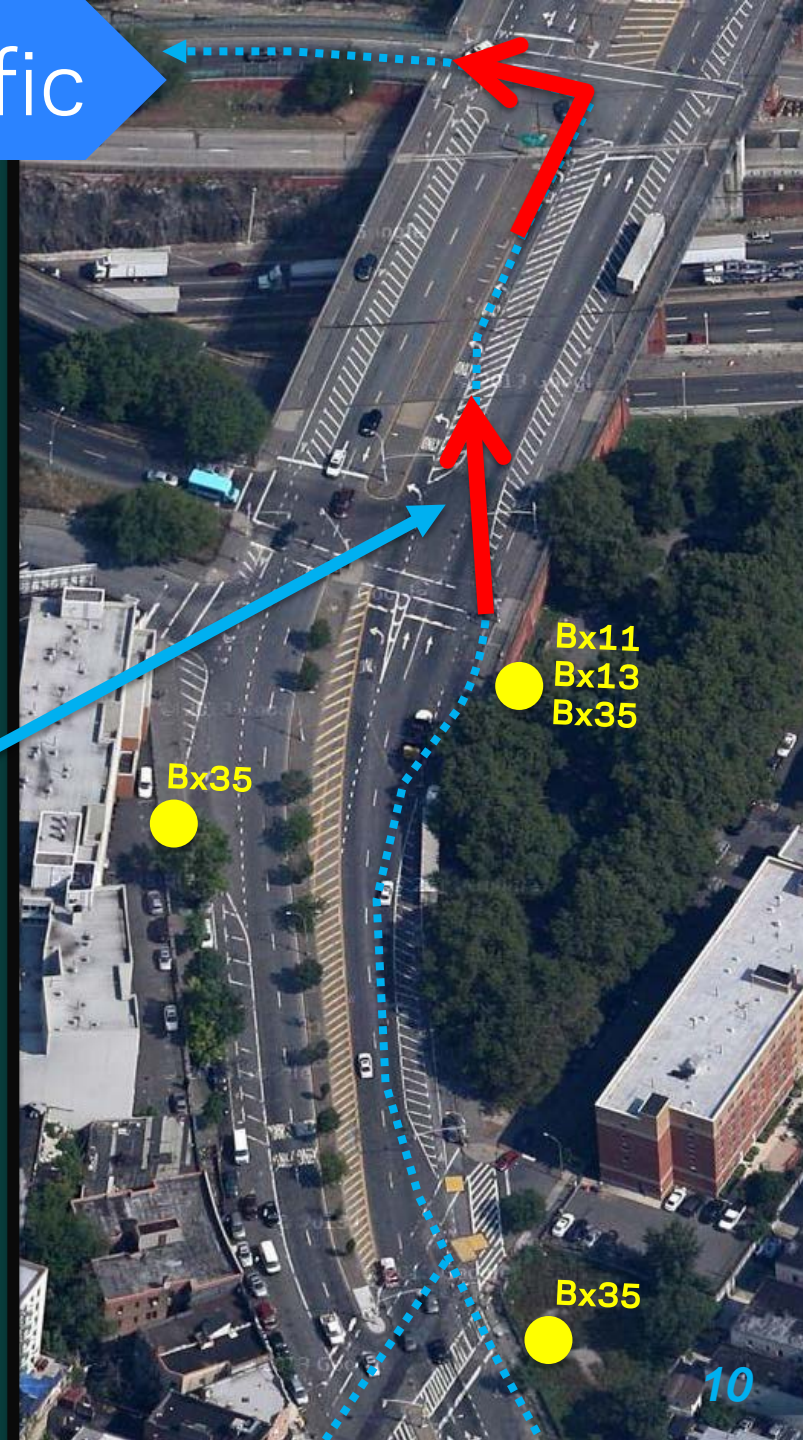



# Existing Conditions - Traffic

- High crash corridor (top 10%)
- Over 30 buses / hour must cross three lanes of traffic to make left-turn onto bridge
- **Poor curb alignment at the Bx35 bus stop**

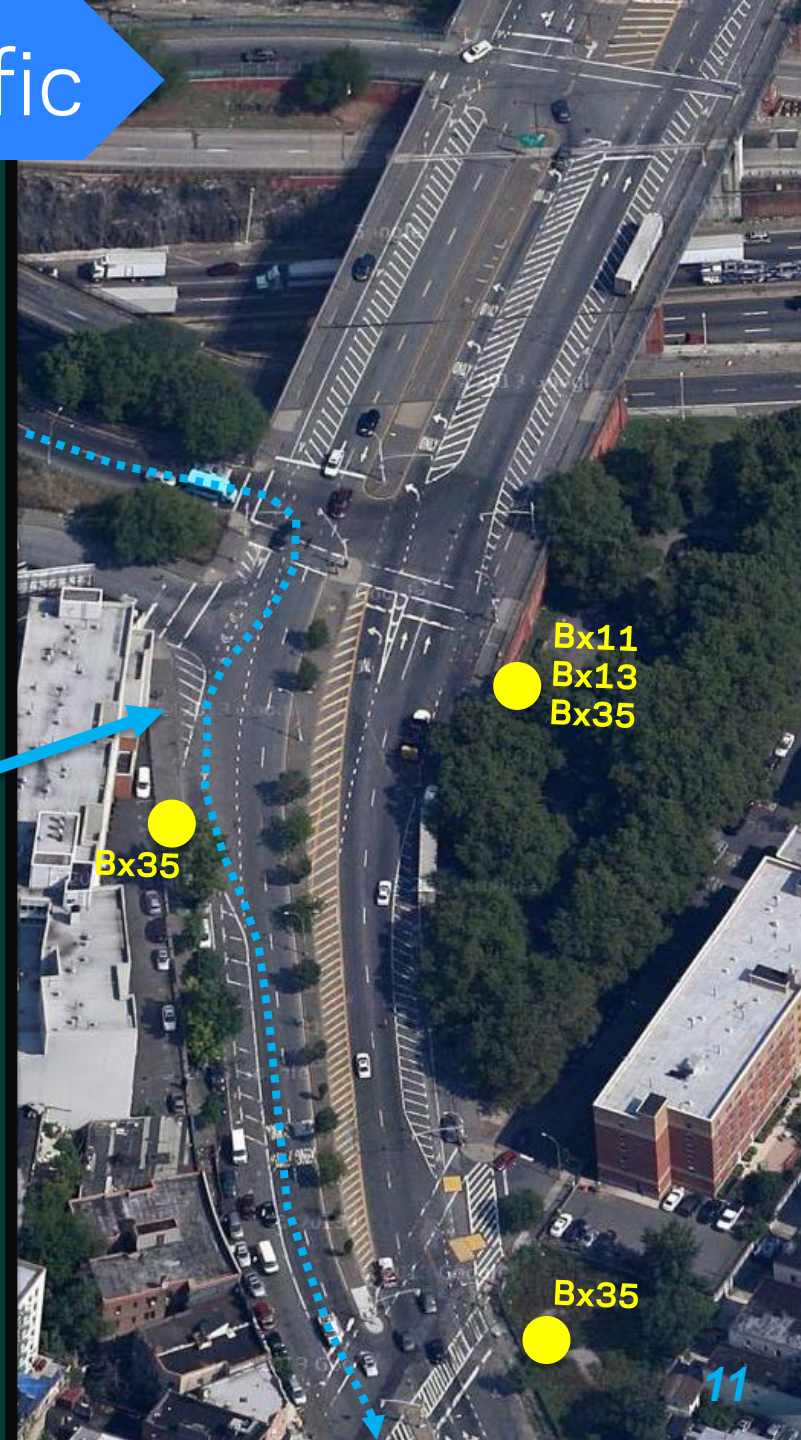



## Design goals

1. Improve pedestrian safety and circulation
2. Reduce conflicts between buses and general traffic approaching the Washington Bridge
3. Improve bus stop conditions



# Proposed

High-Visibility  
Crosswalks

Painted  
Pedestrian  
Refuge Island

Realigned  
left-turn lane

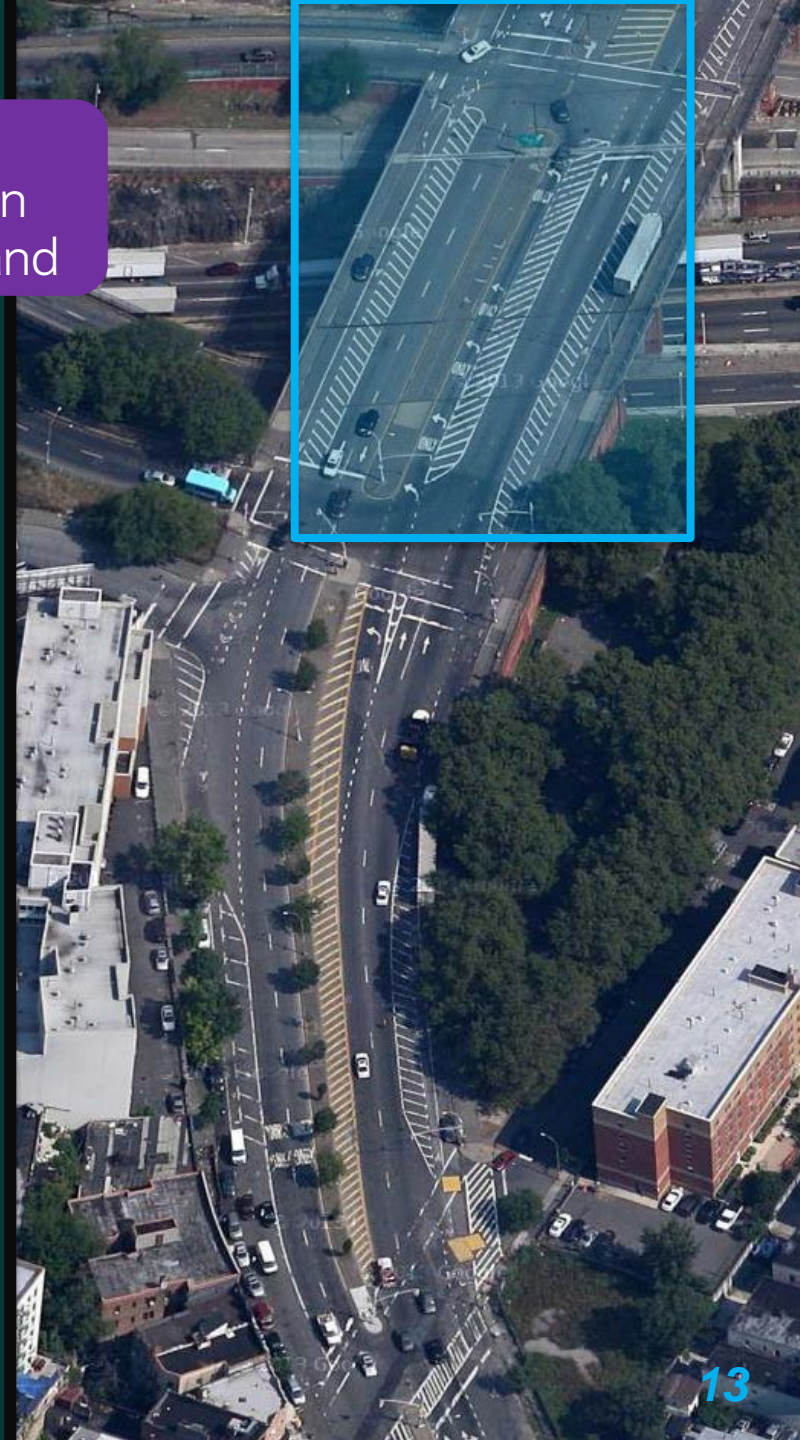
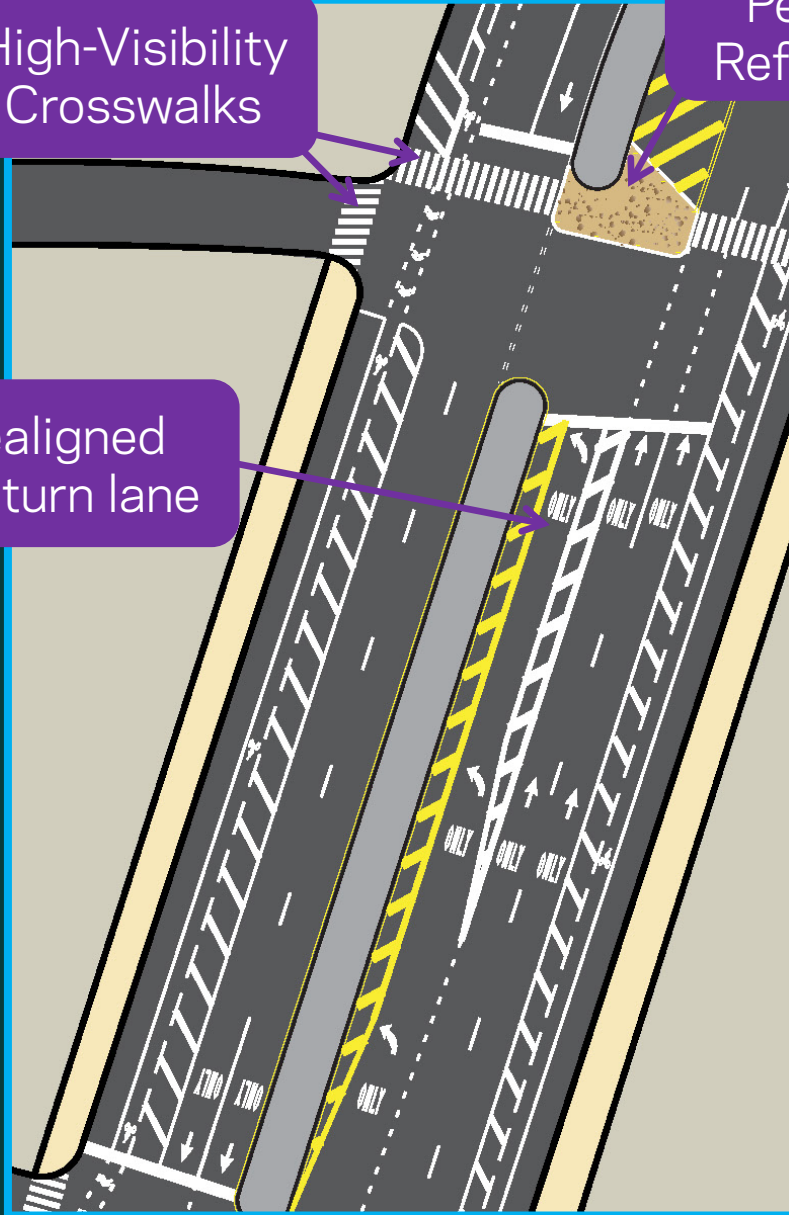



# Proposed

High-Visibility  
Crosswalks

Painted  
Pedestrian  
Refuge Island

Realigned  
left-turn lane

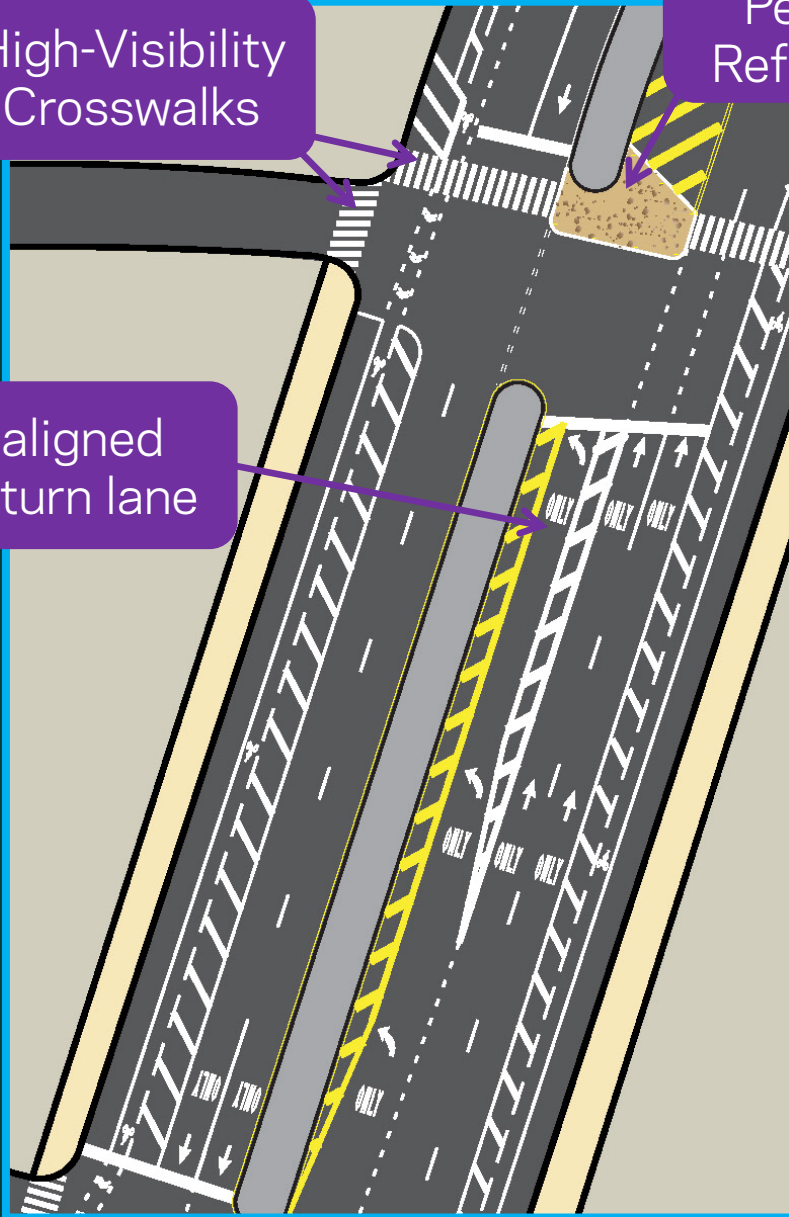

Adam Clayton Powell, Manhattan



4<sup>th</sup> Avenue, Brooklyn



# Proposed

Updated  
Bike  
Markings

Sidewalk  
Extensions

Bus  
Shelter

Bus Boarding  
Island

Bus  
Lane

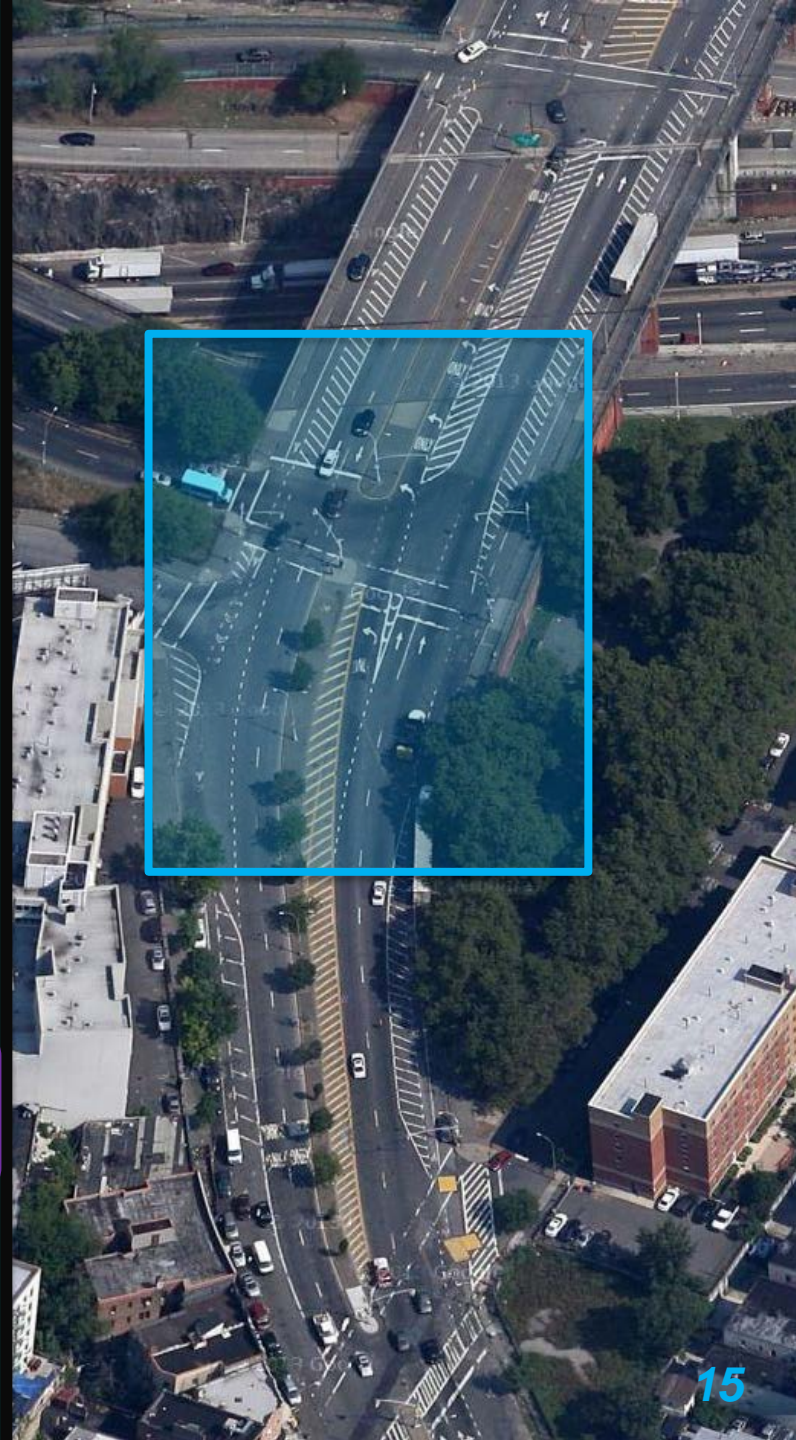
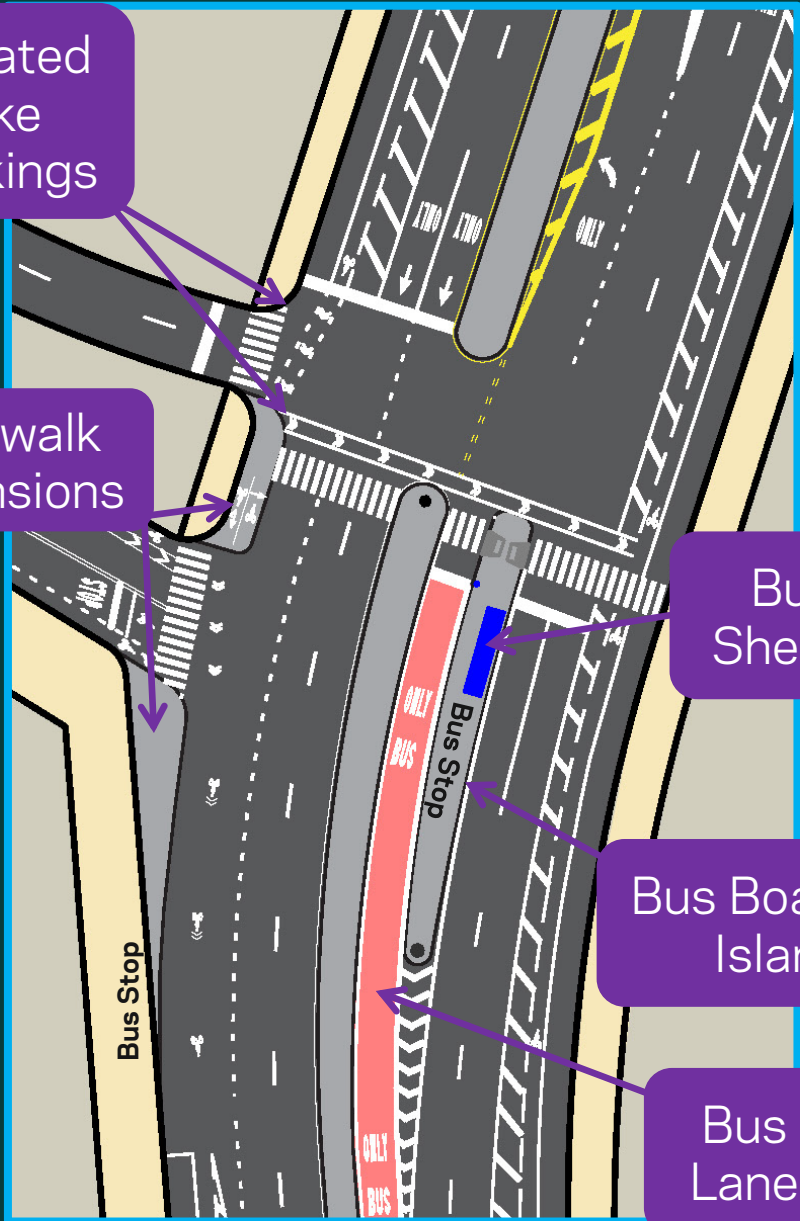



# Proposed

Updated  
Bike  
Markings

Sidewalk  
Extensions

Bus  
Shelter

Bus Boarding  
Island

Bus  
Lane



White Plains Rd / E Gun Hill Rd, Bronx



White Plains Rd / E Gun Hill Rd, Bronx

# Proposed

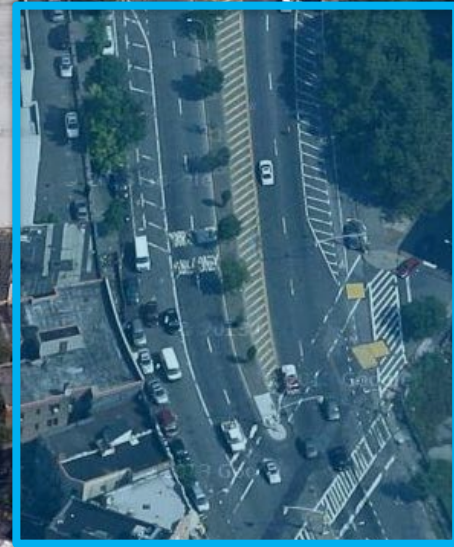
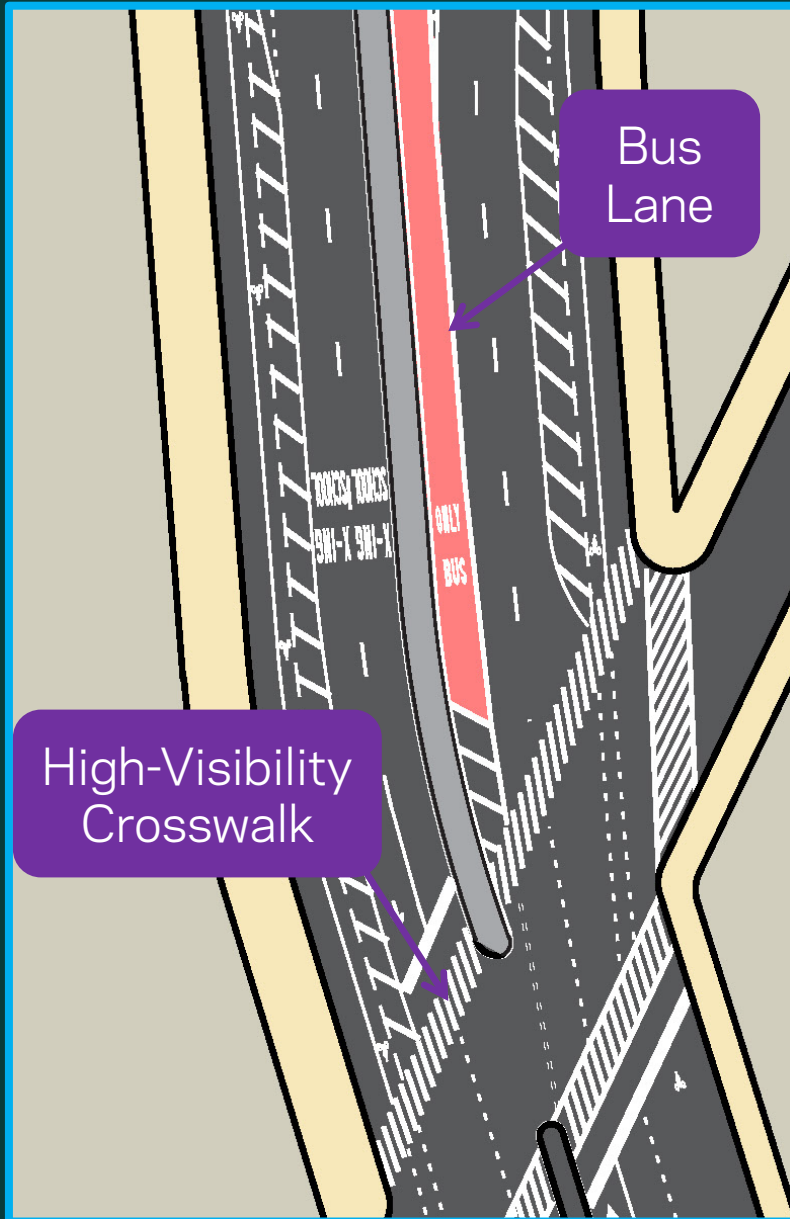



## **1. Pedestrian Safety**

- Painted pedestrian refuge island
- High-visibility crosswalks
- Shortened crossing distances

## **2. Traffic Safety**

- Eliminated 3-lane merge to get on Bridge
- Bus boarding island with bus lane

## **3. Bus Stop Conditions**

- Realigned curb at the Bx35 bus stop
- New bus shelter and seating at bus stops



## **Spring 2014**

- Present to Community Board
- Revise Design Plans

## **Summer 2014**

- Finalize Design Plans
- Start Construction (late summer)

## **Fall 2014**

- Complete Construction



[www.nyc.gov/dot](http://www.nyc.gov/dot)

Thank  
You

**Questions or comments?**

Contact the DOT Bronx Borough Office at 212-748-6680 or at [KKalb@dot.nyc.gov](mailto:KKalb@dot.nyc.gov)