

Safe Streets for Seniors Yorkville Senior Area

2013

Community Board 8 – November 6, 2013



Commissioner Janette Sadik-Khan New York City Department of Transportation
Office of Research, Implementation and Safety

Yorkville Senior Pedestrian Crashes 2006-2010

SSfS_Round1Areas

Senior Pedestrian Injuries

- 1
- 2
- 3

Residential Density Seniors (65+) per Sq Mi

- 0 - 6400
- 6401 - 16810
- 16820 - 73620

NYCHA Development

- ★ Senior Centers
- 🏠 Senior Housing
- 🏠 Nursing Home
- H Hospital
- 🏠 Health Center
- 🚶 Subway Station Entrance
- 🚉 Subway Station
- 🌊 Regional_Hydro
- 🌳 Parks (2004)

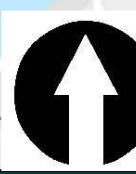
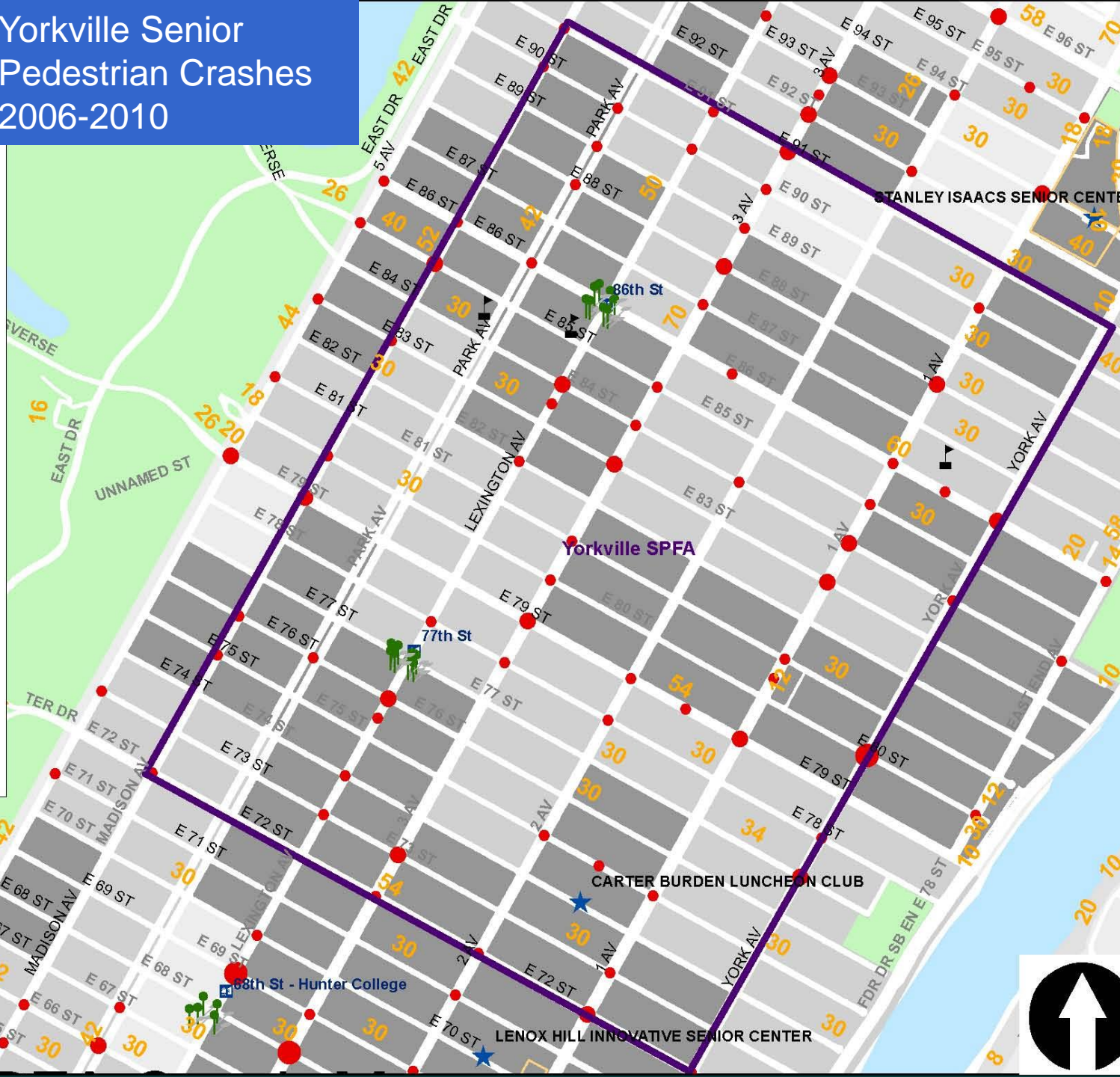

Safety Education Efforts in Yorkville

2012 – Outreach to Stanley Isaacs Center

2013-2014 – Outreach planned to Carter Burden Luncheon Club and Lenox Hill Center

Proposed Plan

4 Strategies for Yorkville Improvements

- 3 Neckdowns on 3rd and York Avenues
- 1 Pedestrian Safety Island
- Truck Loading Zones
- 1 Turn Ban



Neckdown Locations – York Ave

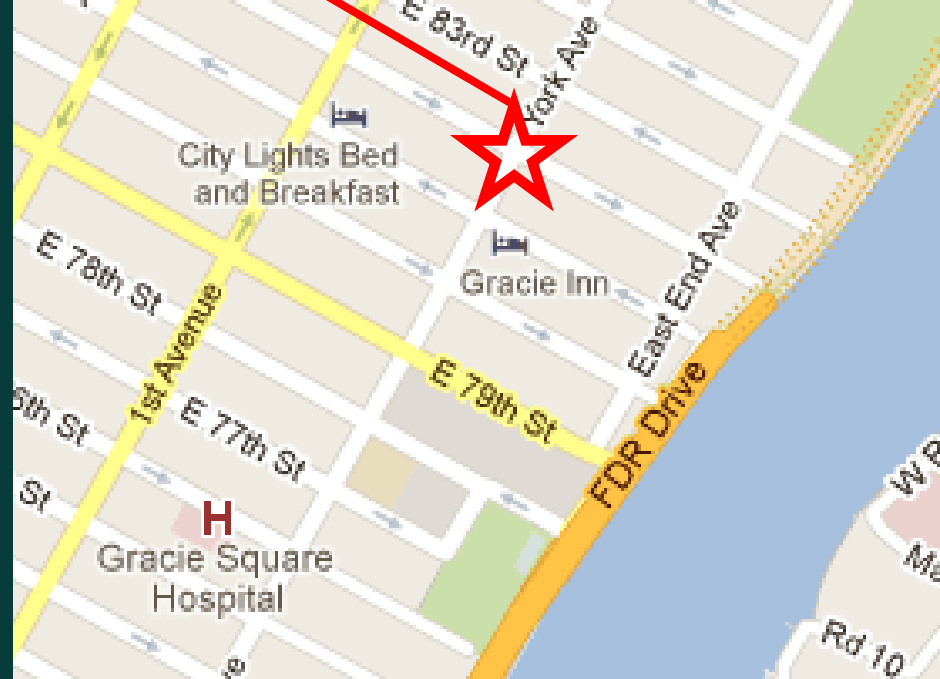
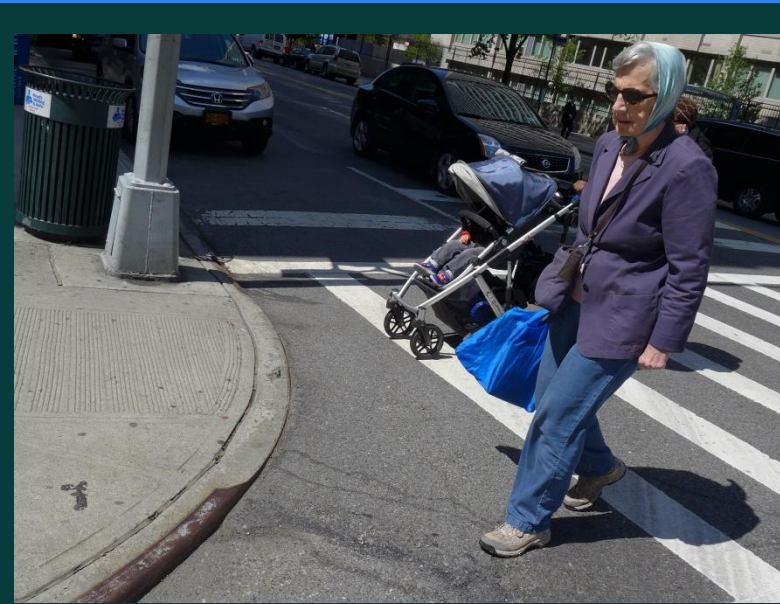

Propose to install on
SE corner/south crosswalk
E 82nd St and York Ave

Removes one parking space on EB 82nd St
(north curb) – to accommodate turning vehicles

Neckdown Locations – York Ave

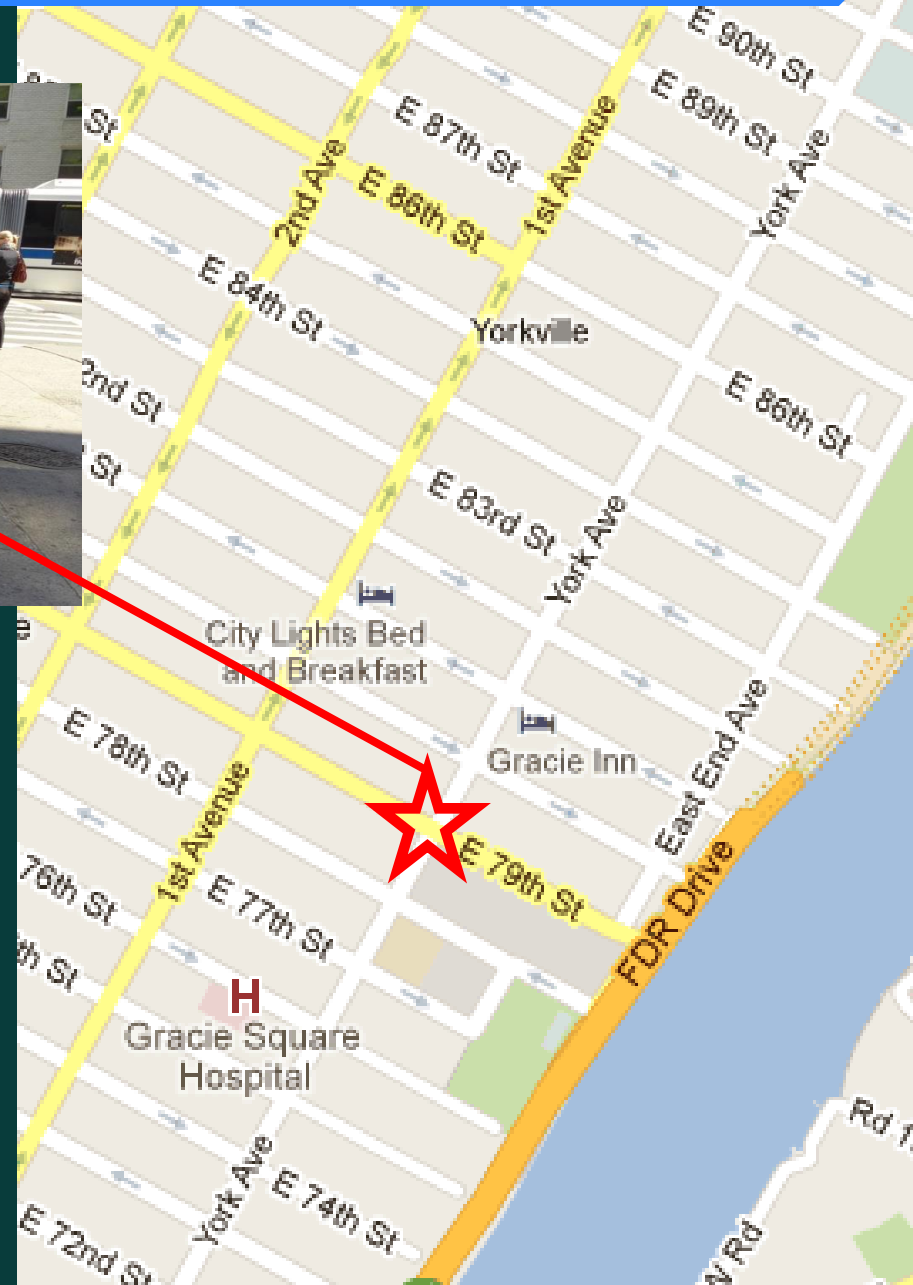
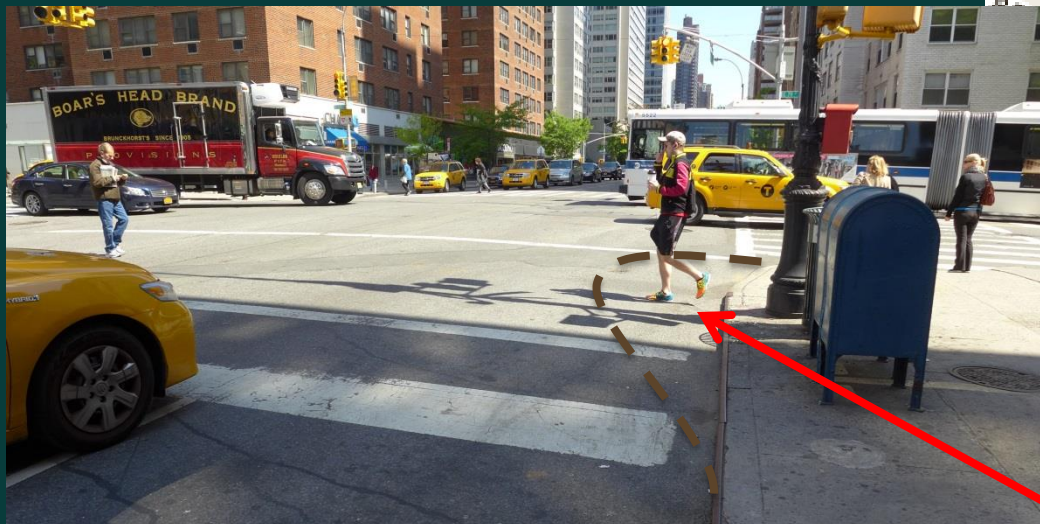

Propose to install on
SE corner/south crosswalk
E 79th St and York Ave

Neckdown Locations – 3rd Ave



Propose to install on
NE corner/north crosswalk
E 83rd St and 3rd Ave

Pedestrian Safety Island Location

E 86th St: Pedestrian safety island between 1st Ave and York Ave

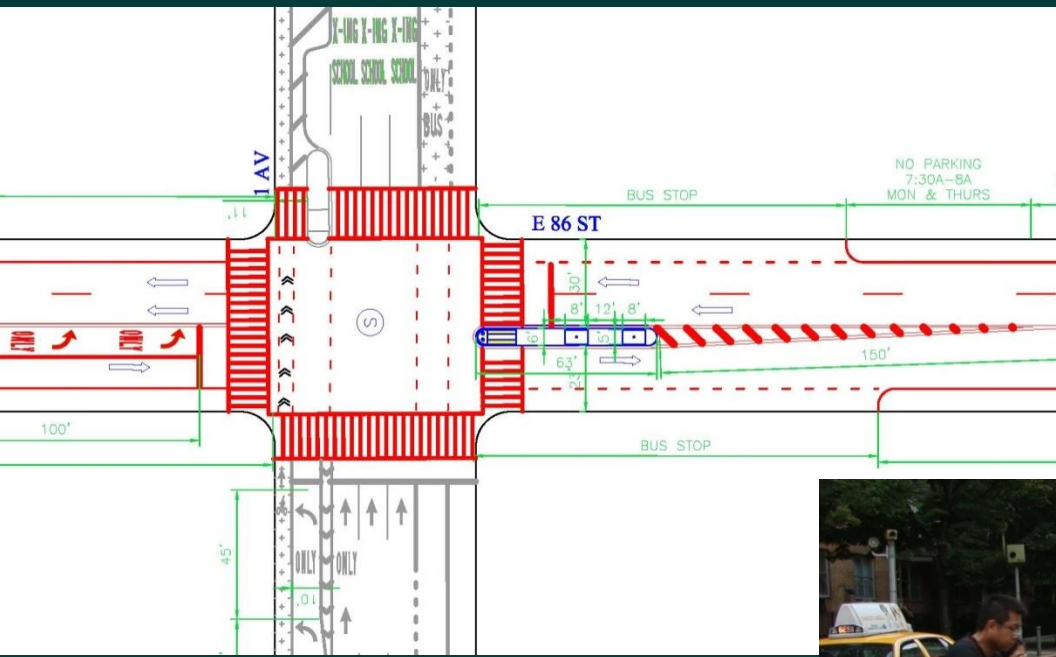

Existing



West End and W 66th St

Proposed Truck Loading Zone Locations

Lexington Ave:

E 83rd-84th St E/S Duane Reade,
D'Agostino – Extend hours past 10am

3rd Avenue:

E 82nd-83rd W/S – Food Emporium
E 83rd-84th E/S – Duane Reade, delis

York Ave:

E 79th-80th St W/S – D'Agostino –
relocate existing loading from E 80th St

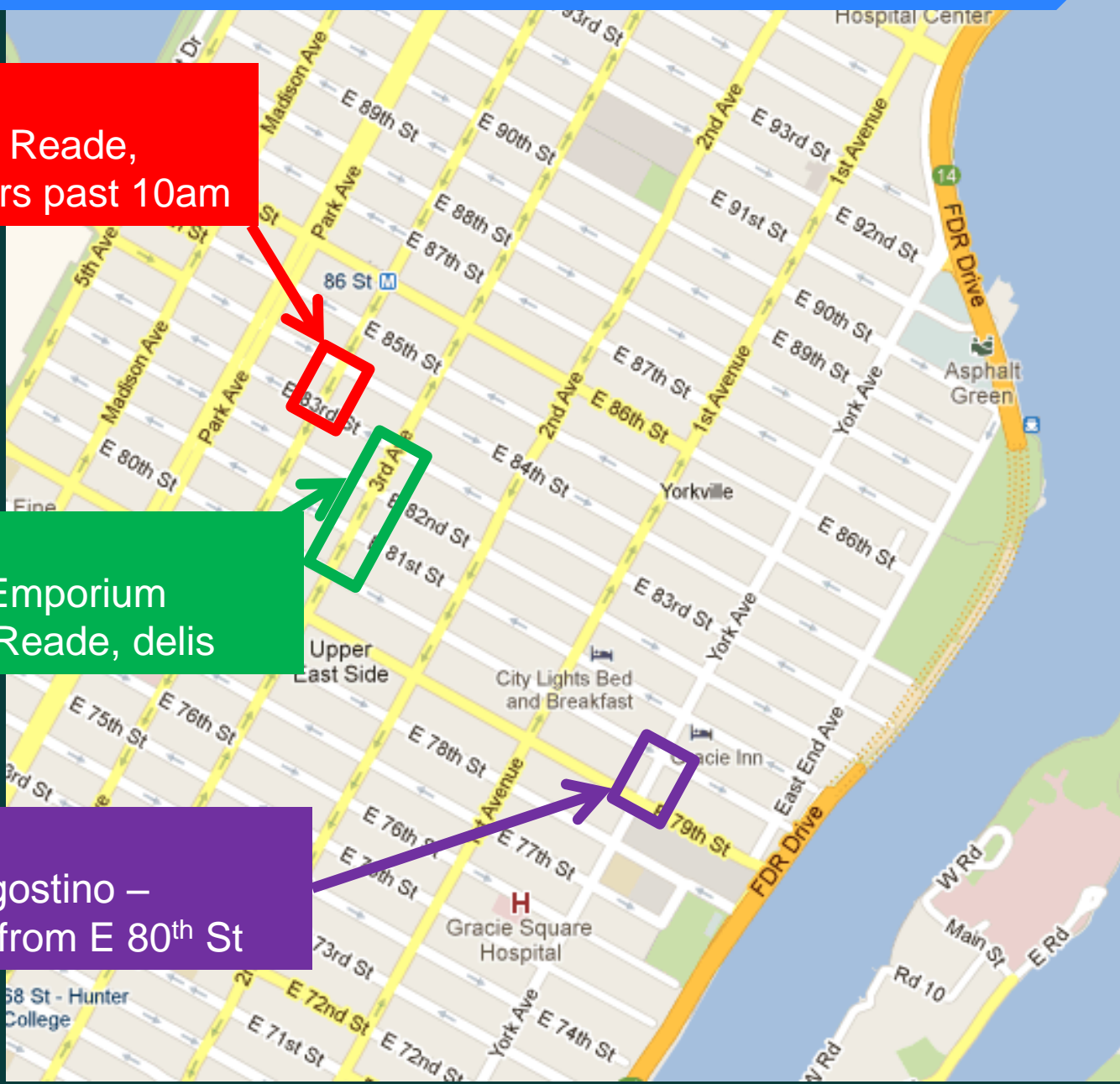

Loading Zones: Lexington Ave

Lexington Ave:

E 83rd-84th St E/S Duane Reade,
D'Agostino – Extend hours past 10am
to 1pm



Loading Zones: 3rd Ave

3rd Avenue:

E 82nd-83rd W/S – Food Emporium

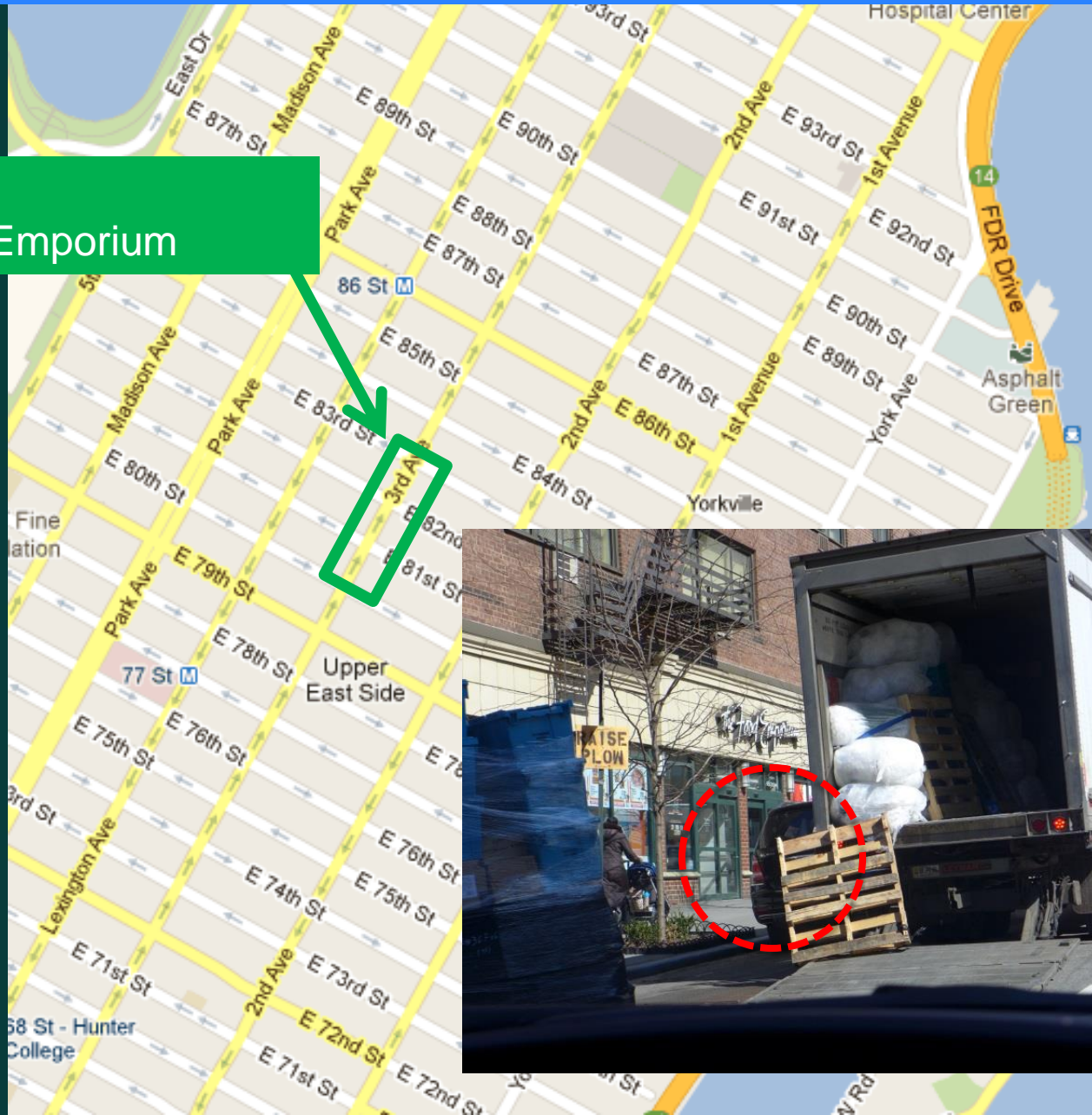

Loading Zones: 3rd Ave

3rd Avenue:

E 83rd-84th E/S – Duane Reade, deli and small business

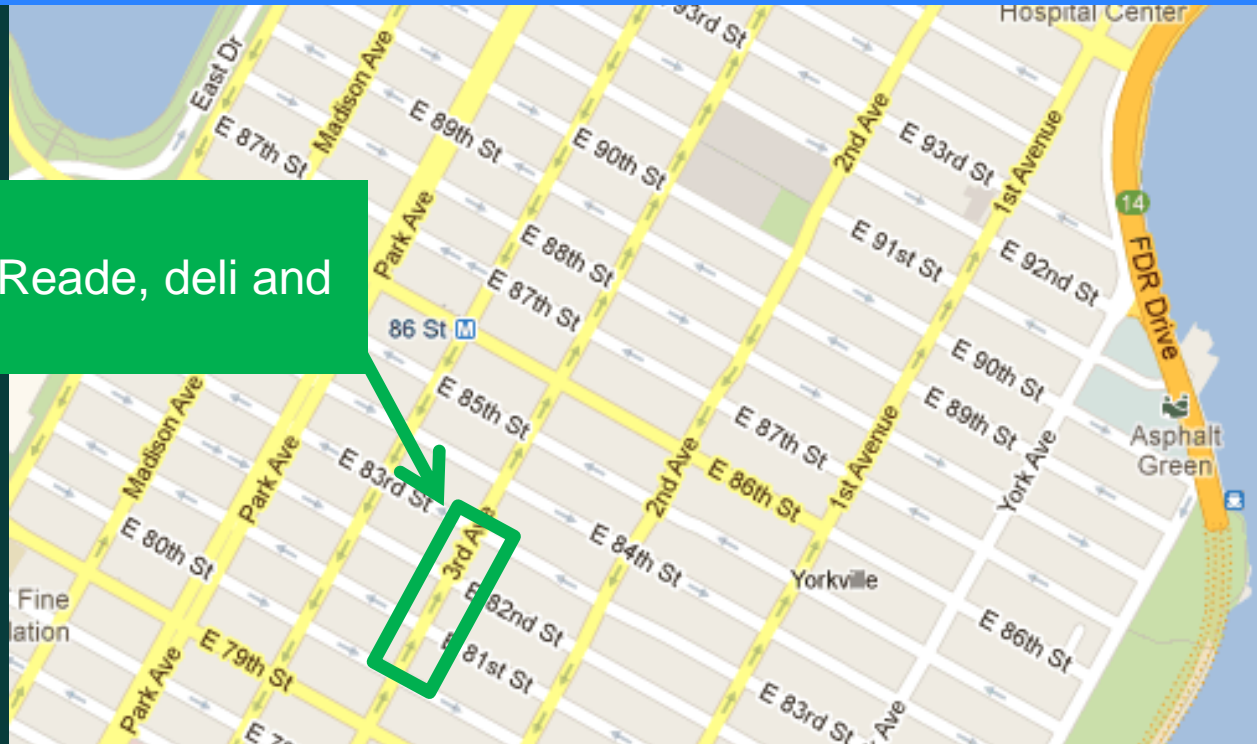

Loading Zones: York Ave

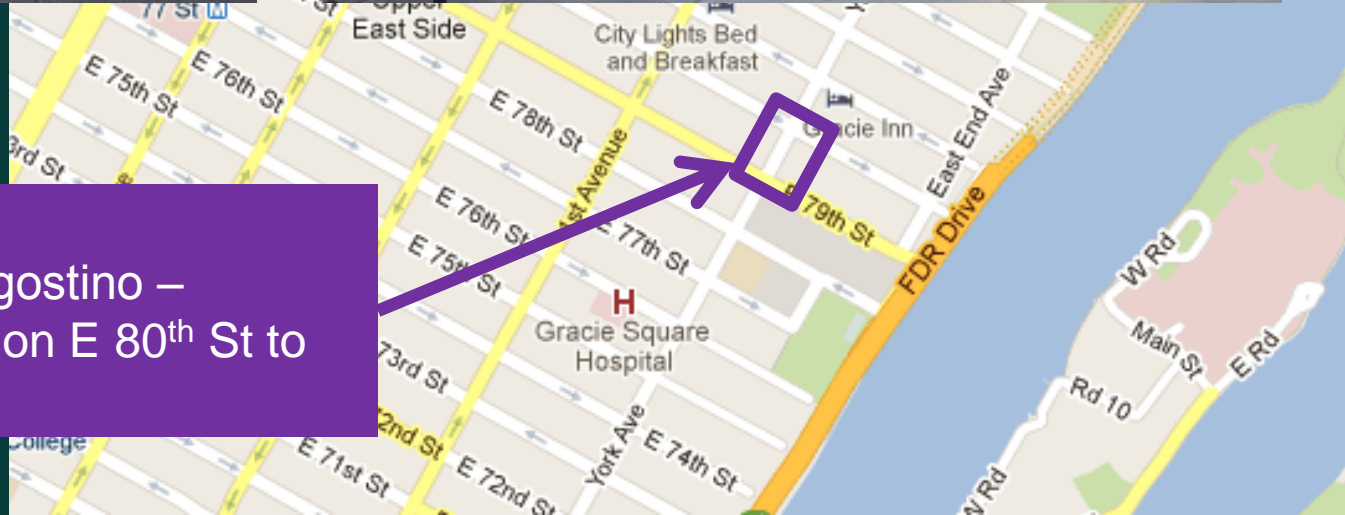

York Ave:
E 79th-80th St W/S – D’Agostino –
relocate existing loading on E 80th St to
York Ave

Turn Ban Proposal: WB Left 86th St to SB Lex Ave

- E 86th St on 4/5/6 has 10th highest ridership in Manhattan with 63,550 average weekday riders in 2012
- 19 pedestrians were hit crossing Lexington Ave and E 86th St in 5 years (2007-2011)
- Separated uptown/downtown platforms, means all commuters cross Lexington Ave in one direction

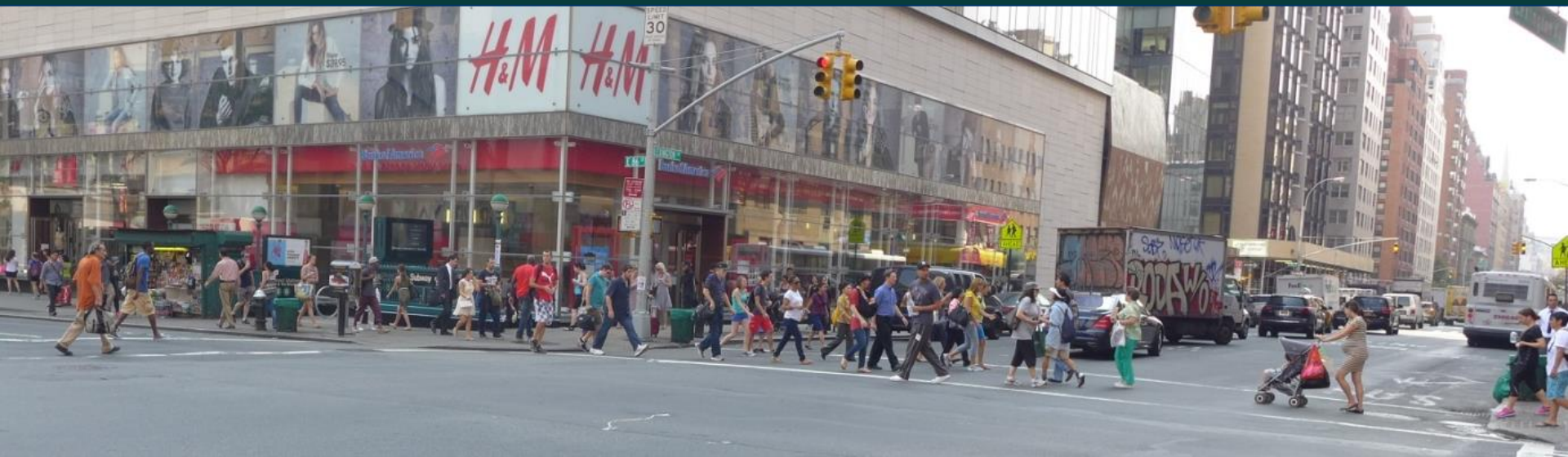

Turn Ban Proposal: WB Left 86th St to SB Lex Ave

- Almost 10 times more peds in south crosswalk than left turners
- Of the left turns, 10/hr are trucks
 - Alt routes: SB 2nd Ave, WB E 79th St
 - Fewer peds, buses at alternate routes



Completed Improvements in Yorkville



1st Avenue from E 72nd to 96th Street

- 27 Pedestrian Safety Islands shorten crossing distance for seniors



3rd Avenue at E 86th St and E 79th St

- Installed painted neckdowns to shorten crossing distance for seniors
- Added 7 second LPI for north and south crosswalks at E 86th St and 3rd Ave

Completed Improvements in Yorkville

Signal Timing Improvements

- Modified 140 signals in the area to accommodate slower walking speeds
- Added additional crossing time to 21 signals
- Installed countdown signals at 20 intersections in the area, 120 locations underway



Installed 2 CityBenches



Repaired Broken Pedestrian Ramps

- E 73rd and York Ave
- E 82nd and York Ave
- E 91st and Madison Ave

CityBench Possibilities

Currently Investigating Benches requested by seniors at the following locations:

- 1st Ave between E 77th and E 78th St
- 1st Ave between E 79th and E 80th St
- 1st Ave and E 86th St, SE corner
- 2nd Ave between E 88th and E 89th St
- 2nd Ave and E 90th St, NW corner
- 3rd Ave between E 88th and E 89th St



Benefits

3 Neckdowns, 1 Pedestrian Safety Refuge:

- Shorten crossing distances for pedestrians, and slow turning vehicles

4 Loading Zones

- Reduce vehicles swerving around loading trucks in moving lanes
- Increase visibility between pedestrians and drivers

1 Turn Ban

- Eliminate conflict between pedestrians and turning vehicles
- Better organizes and improves traffic flow on E 86th St

Questions?

**Thank
You**