

Slosson Ave / Todt Hill Rd

Traffic Calming

Staten Island Community Board 1 – June 14th

2011



Commissioner Janette Sadik-Khan New York City Department of Transportation
Office of Research, Implementation and Safety

Project Background

- Study area is Slosson Ave / Todt Hill Rd, from Windsor Rd to Tillman Rd
- St Teresa's School located at north end of study area
- Residential corridor with only a few traffic signals
- Local truck route

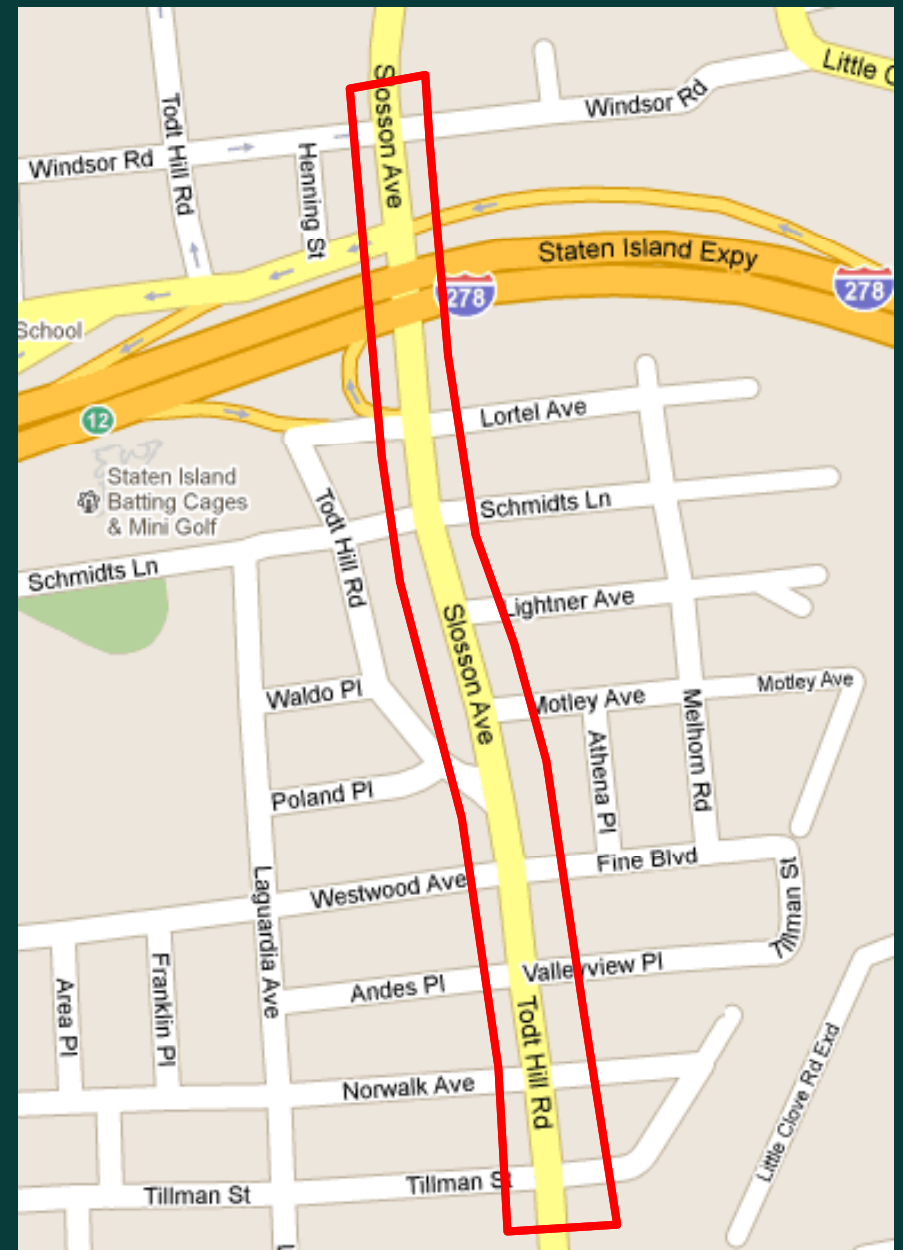

Project Background

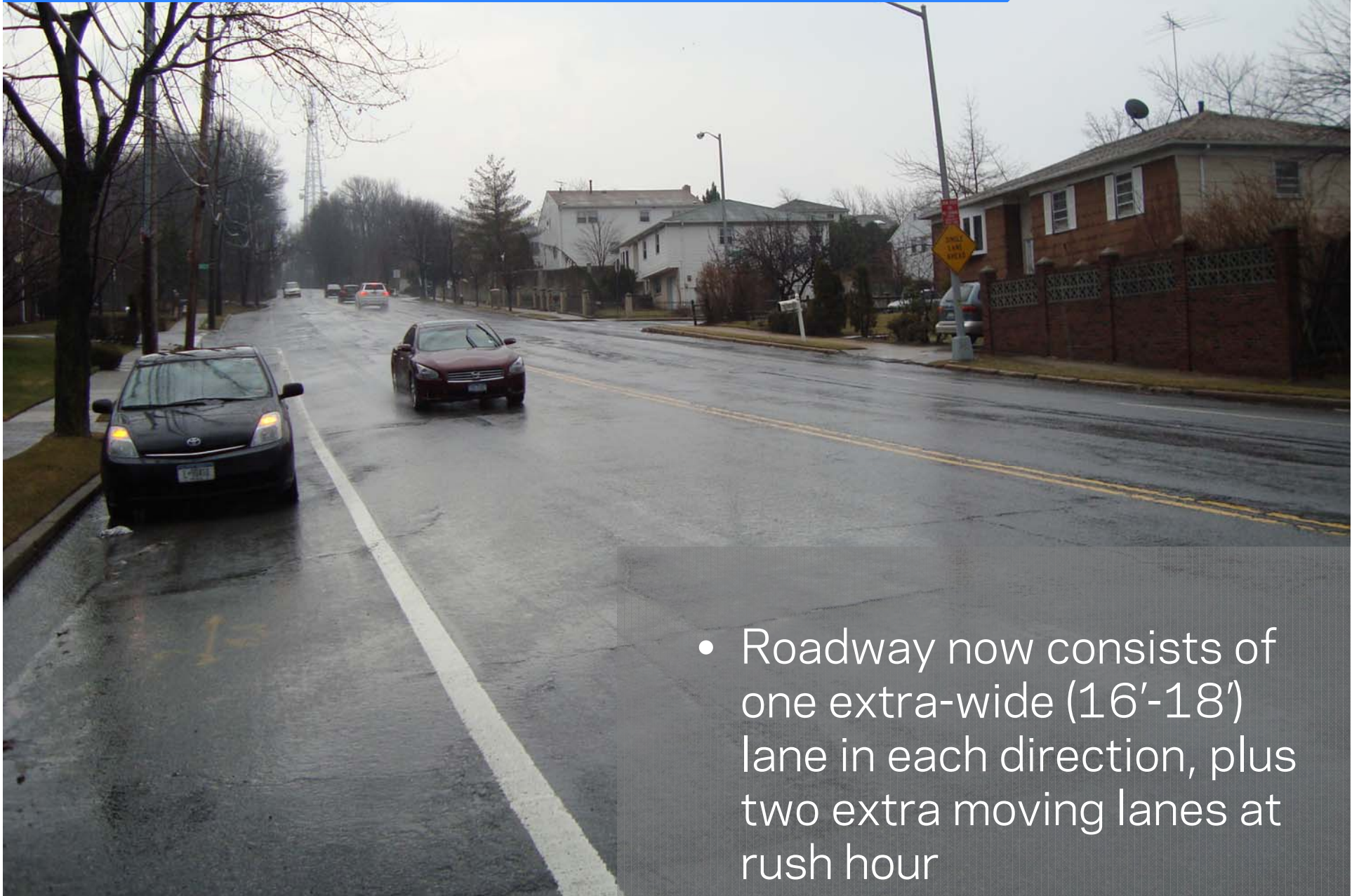

- Roadway now consists of one extra-wide (16'-18') lane in each direction, plus two extra moving lanes at rush hour

Need: Why Slosson Ave / Todt Hill Rd?

- Pedestrian fatality at Slosson Ave & Windsor Rd, May 2010
- Traffic calming and capacity improvement request from Borough President Molinaro
- High crash corridor
- ~75% of vehicles over the speed limit (@ Tillman St & @Westwood Ave)
- Vehicle congestion and intersection spillback at the SIE ramps

Slosson Ave: Lightner Ave to Tillman St 2005-2009

	Total Injuries	Avg Inj/Yr	Avg Inj/Mile/Yr	Severity Percentile of Boro Corridors
Pedestrian	0	0	0	92%
Bicyclist	0	0	0	N/A
Motor Veh Occupant	47	9.4	33.3	95%
Total	47	9.4	33.3	92%

Source Data: NYS Dept. of Motor Vehicles / NYS Dept. of Transportation

Fatalities (2005-Present):

1 Pedestrian

Ranks in 92nd Percentile for Staten Island corridors



Improvement Details

- Traffic calming (“Road Diet”) on Slosson Ave / Todt Hill Rd from Lightner Ave to Tillman St
 - Normalize one through travel lane in each direction from Lightner Ave to Tillman St
 - Install flush center median with turn bays
 - Restore on-street parking at rush hours
 - Narrower lanes will reduce speeding and discourage passing and weaving
- RT lane only for SB Slosson @ SI Expressway
- Expanded LT lane for NB Slosson Ave @ SI Expressway
- Signal timing & coordination improvements at Windsor Rd and SIE ramps



Example of similar traffic calming treatment – E. 180th St (Bronx)

Project Background

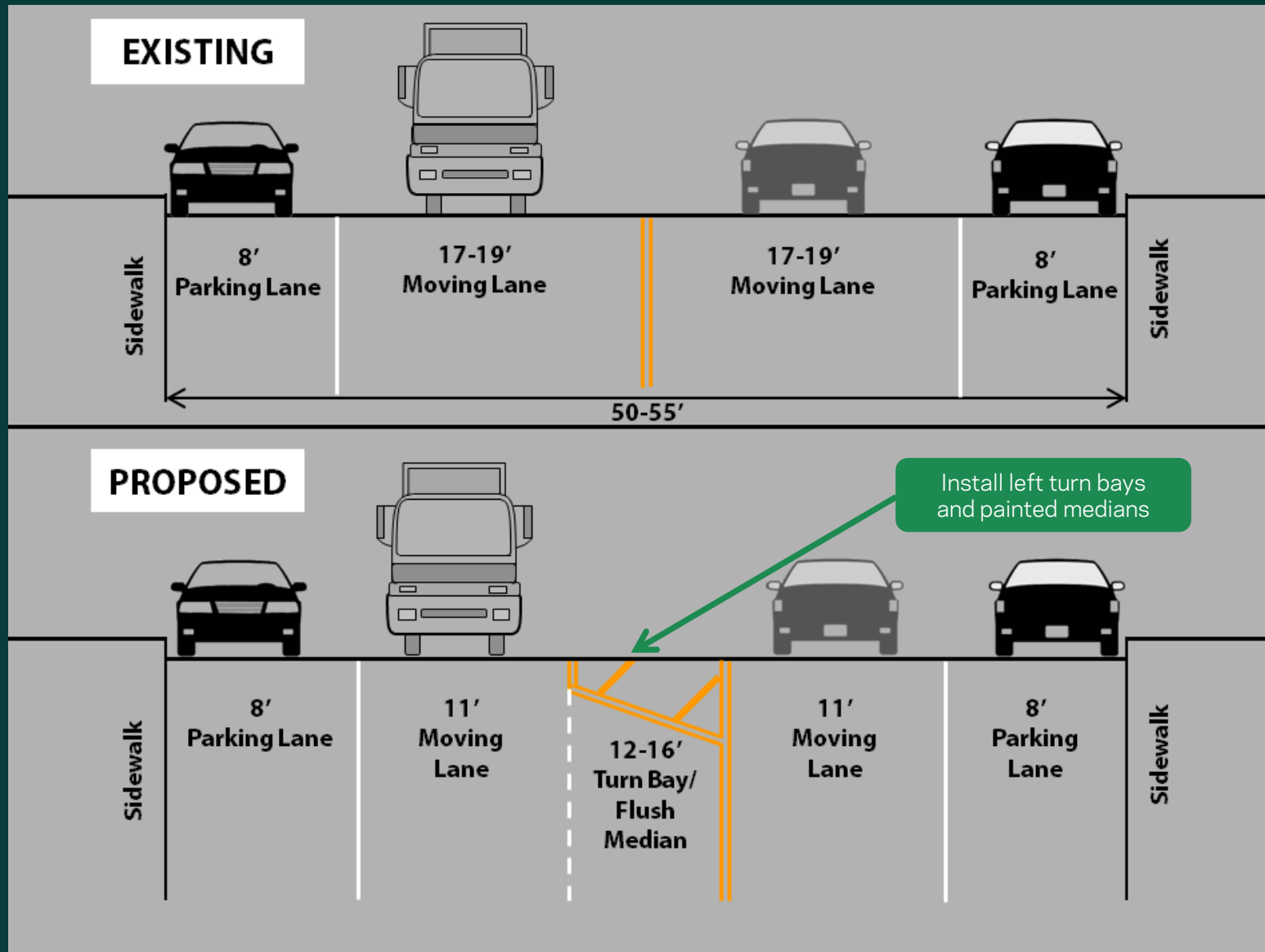

Improvement Details

- Add **guard rails** to protect pedestrians
 - @ NE corner of Slosson Ave & Windsor Rd
 - @ Entrance to St Theresa School

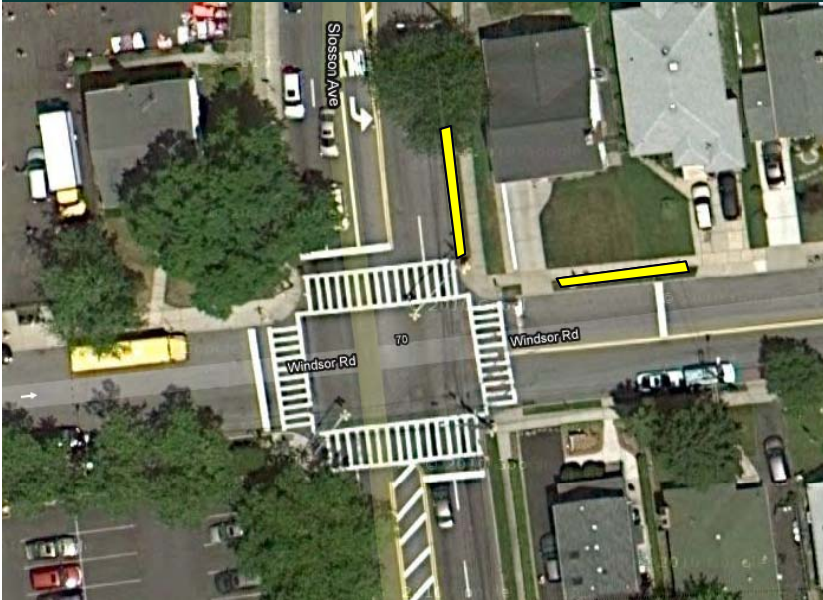

Improvement Details

- Future School Safety capital construction ~fiscal year 2012
 - School Safety project
 - Neckdown at Slosson Ave & Windsor Rd
 - Protect pedestrians
 - Discourage wrong way WB traffic on Windsor Rd



Benefits & Tradeoffs of Proposal

Overall Project Benefits

- Reduces speeding and calms traffic
- Simpler, safer turns
- Reduced vehicle congestion and spillback
- Provides protection for pedestrians

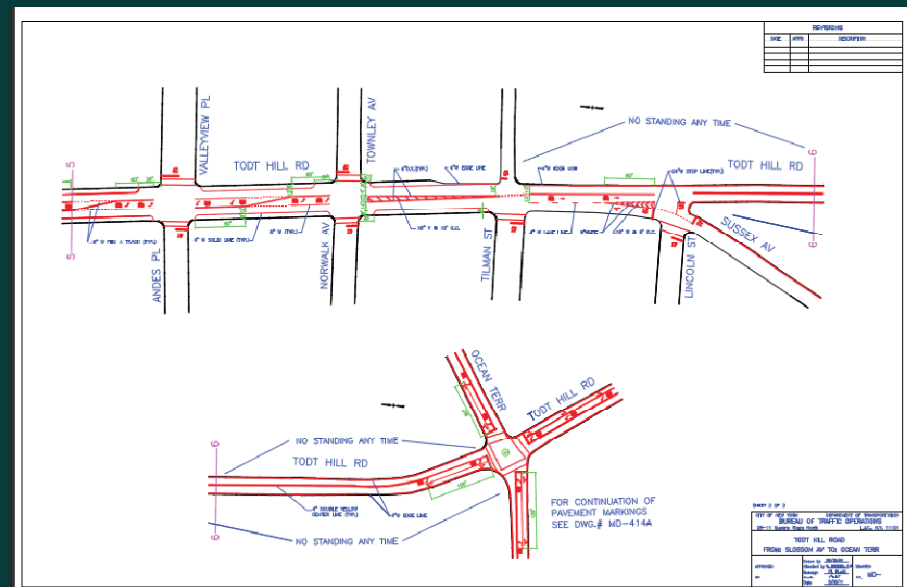
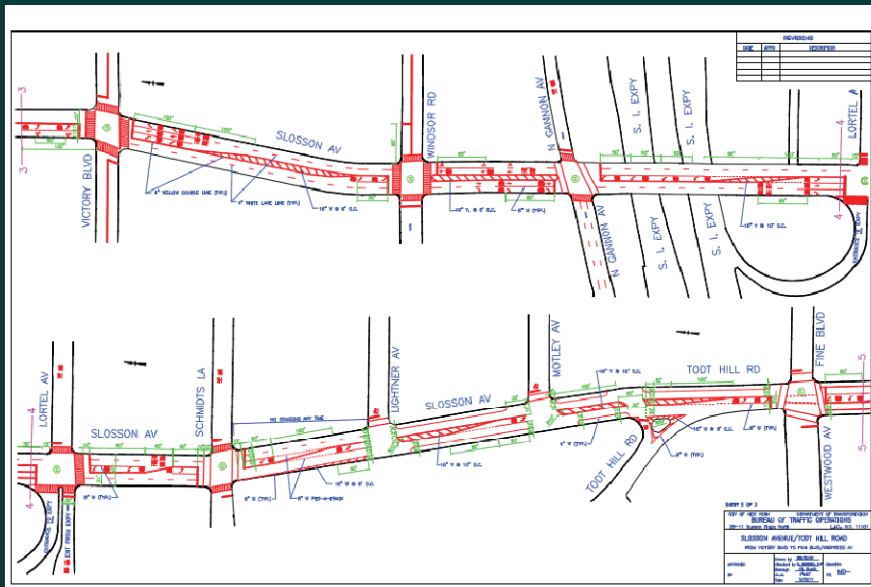

Questions?

**Thank
You**

Contact: Rob Viola at rviola@dot.nyc.gov