

Maspeth Bypass and Intersection Normalization, Queens



Commissioner Janette Sadik-Khan New York City Department of Transportation
Presented to Queens CB2 Board Meeting June 2, 2011

Project Context

- Concern about cut-through truck traffic on Grand and Flushing Avenues
- CB, Civic Groups and Elected Officials asked for Maspeth Bypass
- Desire for a safe bypass route to industrial areas without impacting Maspeth community

Project Area

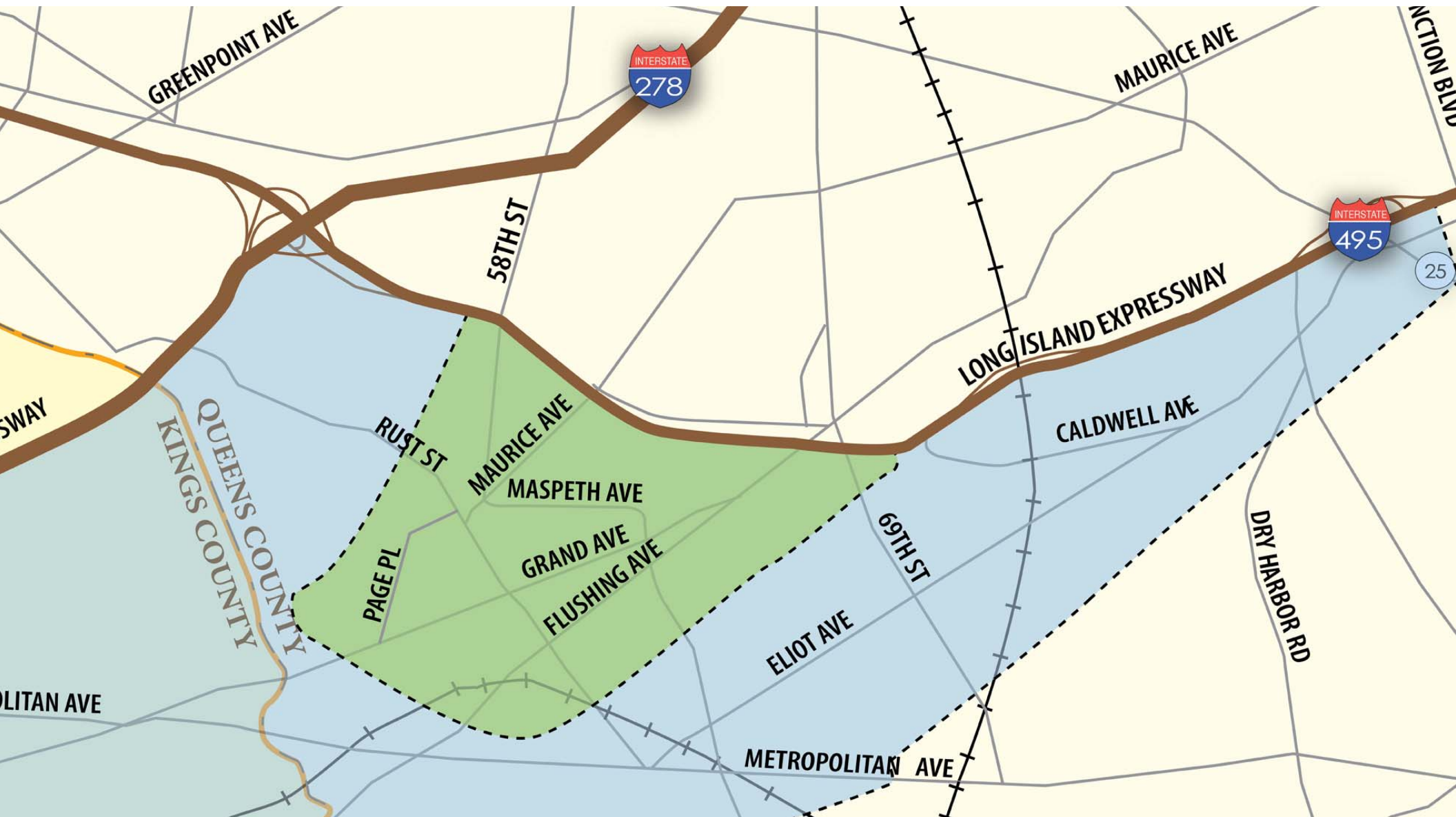

Problem – Large Trucks on Grand and Flushing Avenue

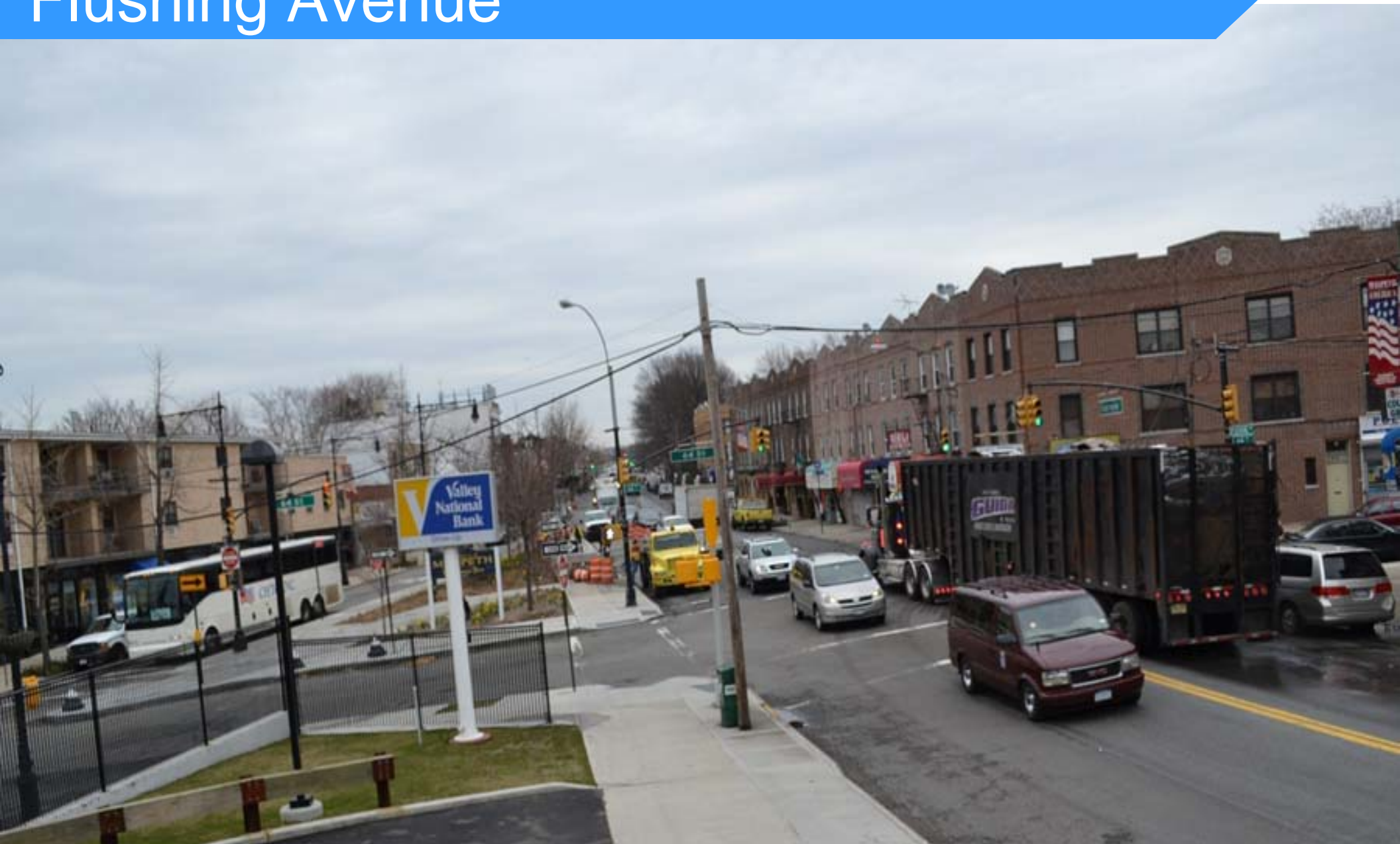

Problem – Large Trucks on Grand and Flushing Avenue



Truck Routes in Maspeth

Existing Truck Routes

Grand Avenue and Flushing Avenue were through truck routes in Queens but local truck routes in Brooklyn

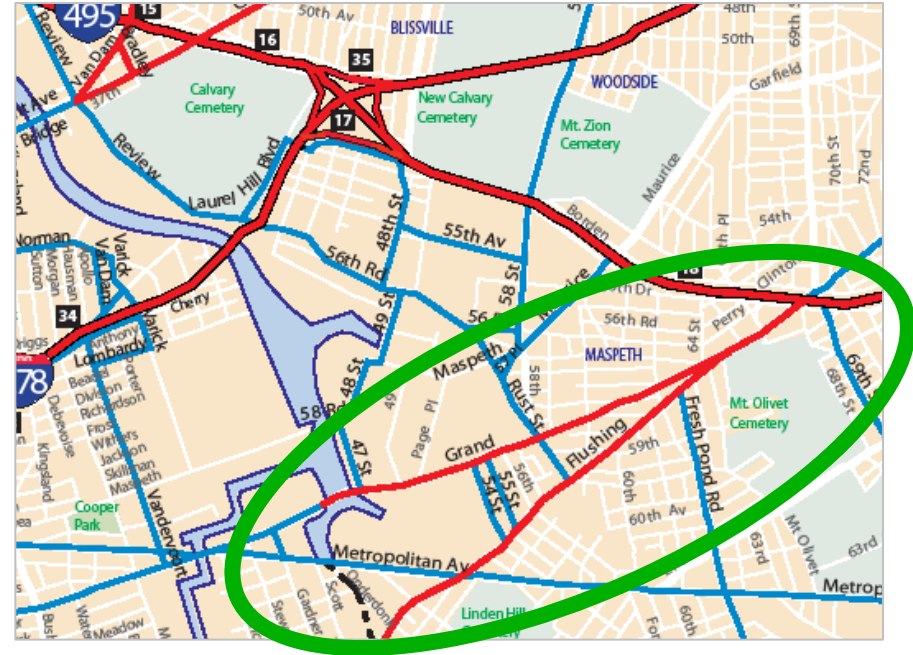

Truck Route Changes

Grand Avenue and Flushing Avenue became local truck routes in Queens and Brooklyn

Rule change effective March 25, 2011

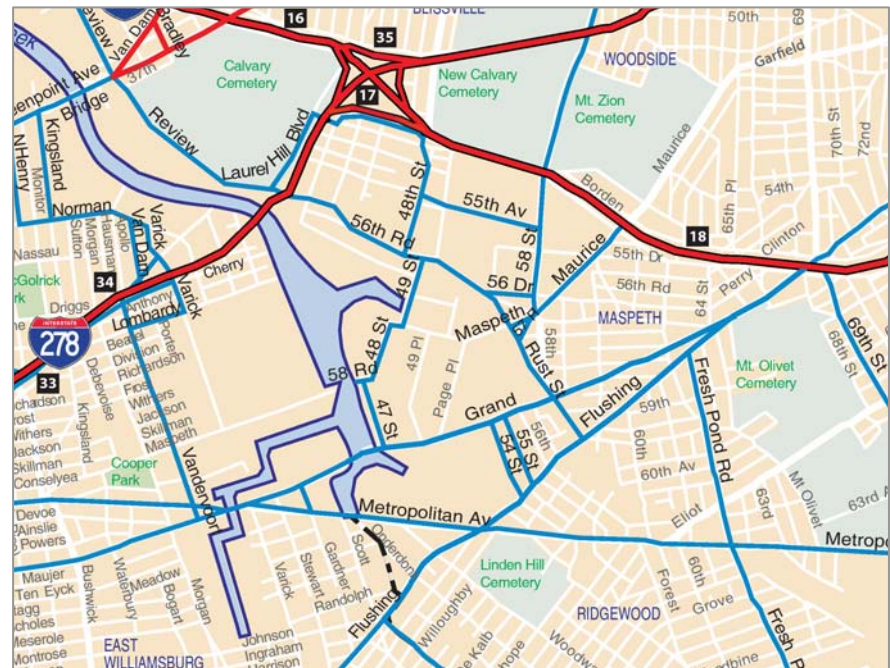

Community Proposed Maspeth Bypass

ROUTE A9 (6.42 Miles):

Queens-Midtown Expressway (QME)
Interchange 20 to the Brooklyn-Queens
Expressway (BQE) past Interchange 32
at the entrance ramp from Williamsburg
Place via 58th Street, Maspeth Avenue,
Rust St, Grand Avenue, Grand Street, left
onto Marcy Avenue, and Williamsburg
Street. (Stay Right on QME--Exit 18 to
Borden Avenue, left onto 58th Street).

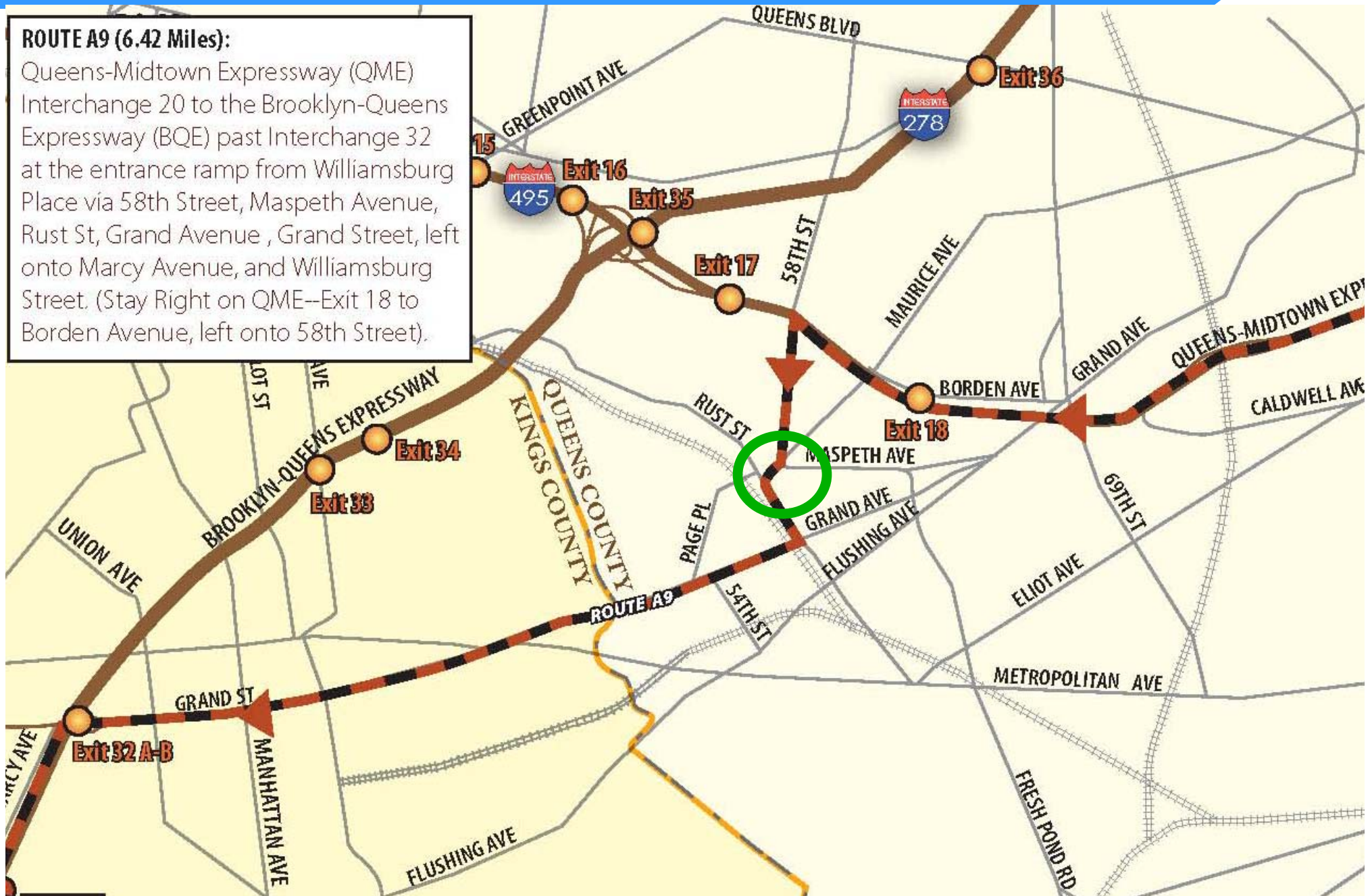

Five-Leg Intersection: Current condition



Maspeth Ave / 58th Street / Maspeth Ave



Maspeth Ave / 58th Street / Maspeth Ave



Maspeth Ave / 58th Street / Maspeth Ave



Looking Southbound

Maspeth Avenue at Rust Street



Looking southeast

2011.03.17 09:47

Five-Legged Intersection: Conflicts

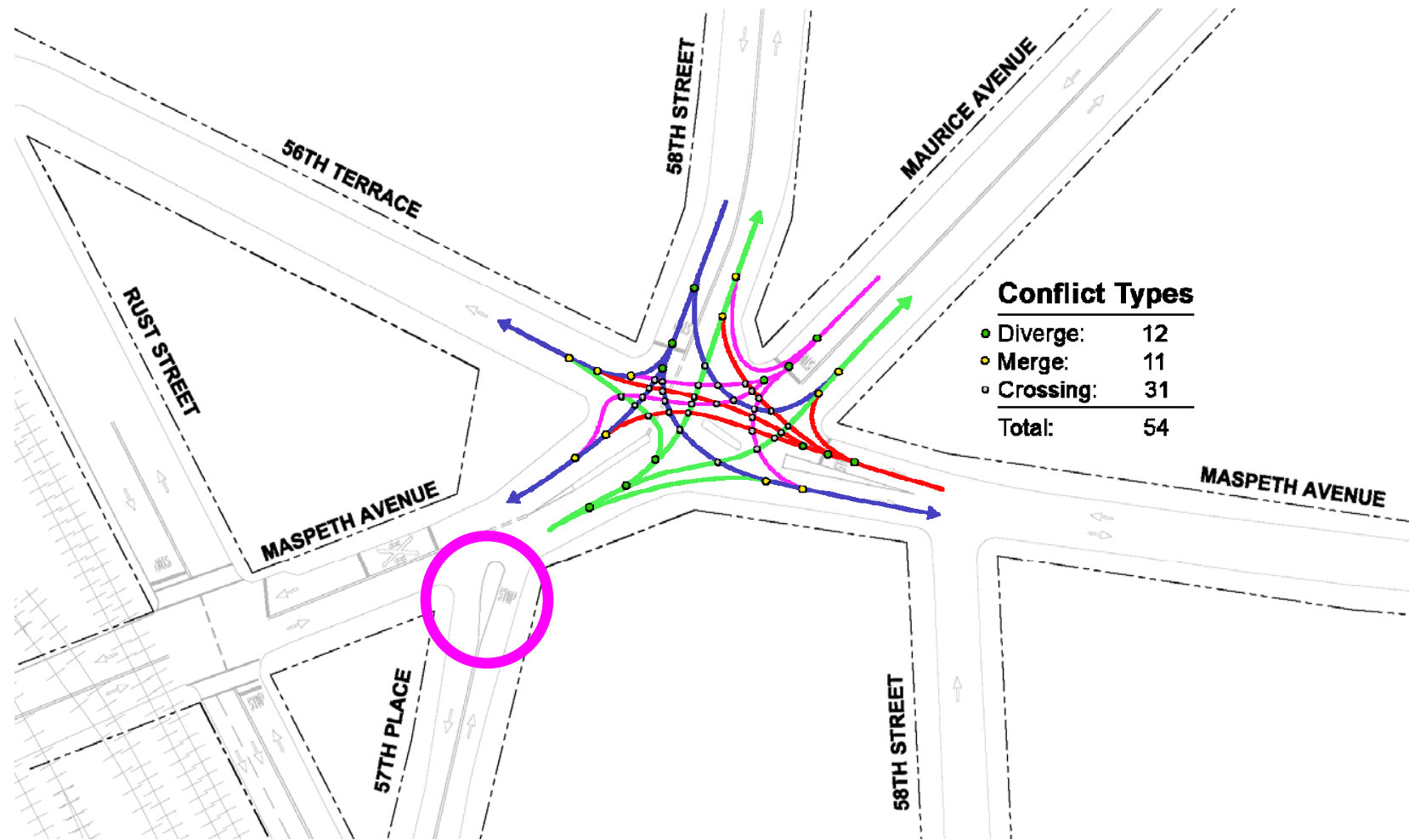

54 traffic conflict types

Five-Legged Intersection: Normalization

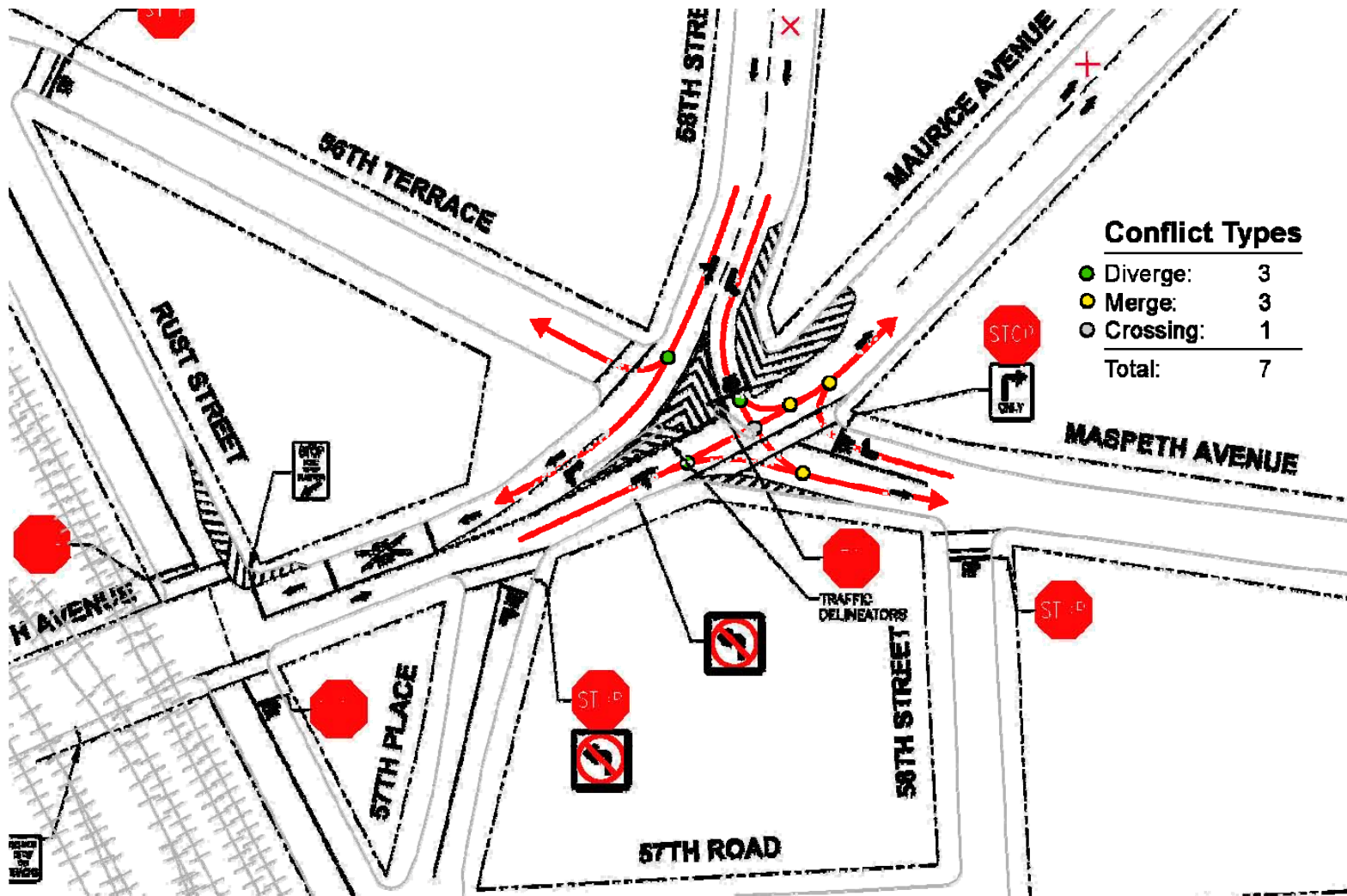

7 traffic conflict types

Five-Legged Intersection: Normalization

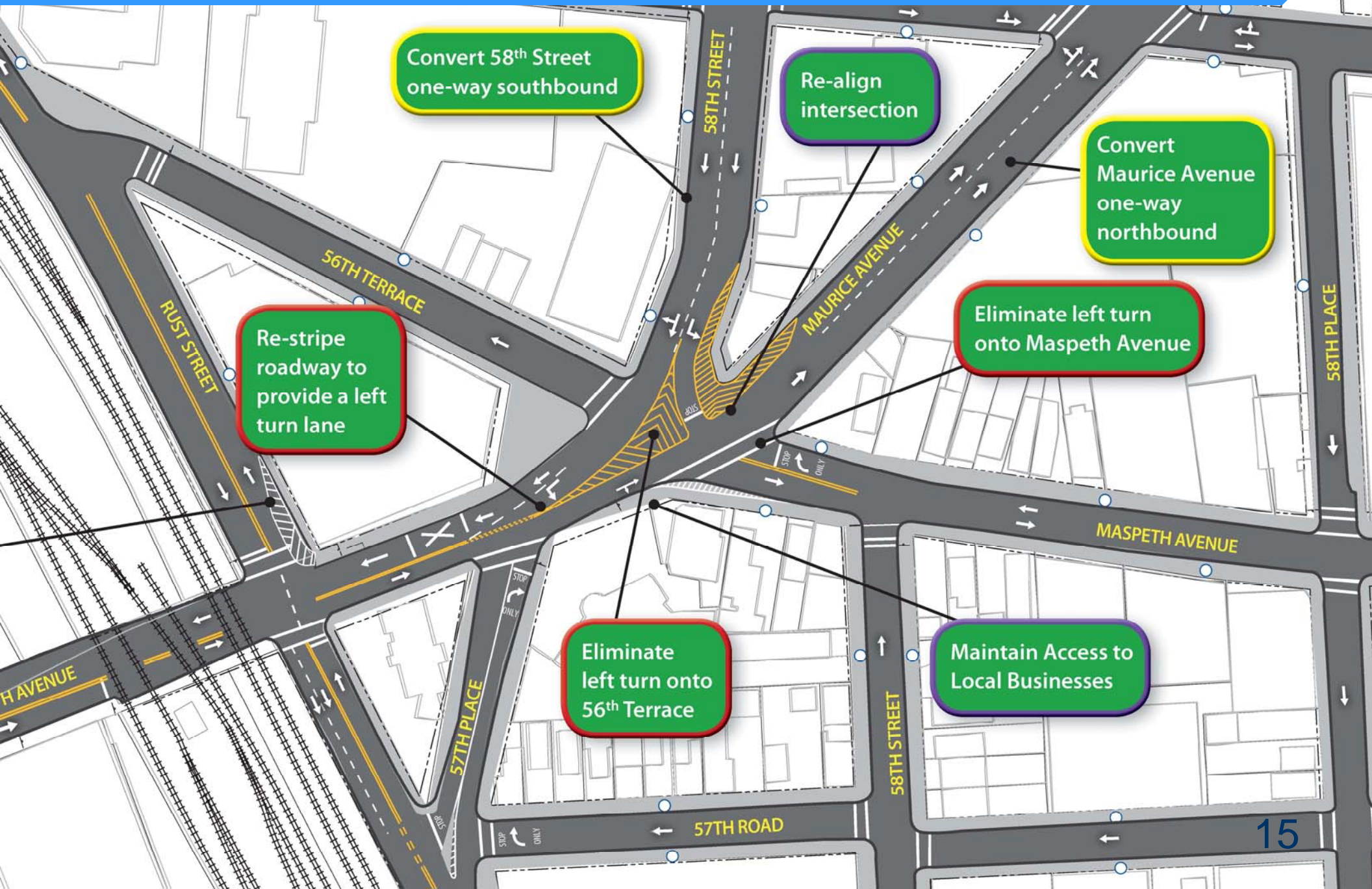

Five-Legged Intersection: Normalization



Normalize 55th Drive at Maurice Avenue

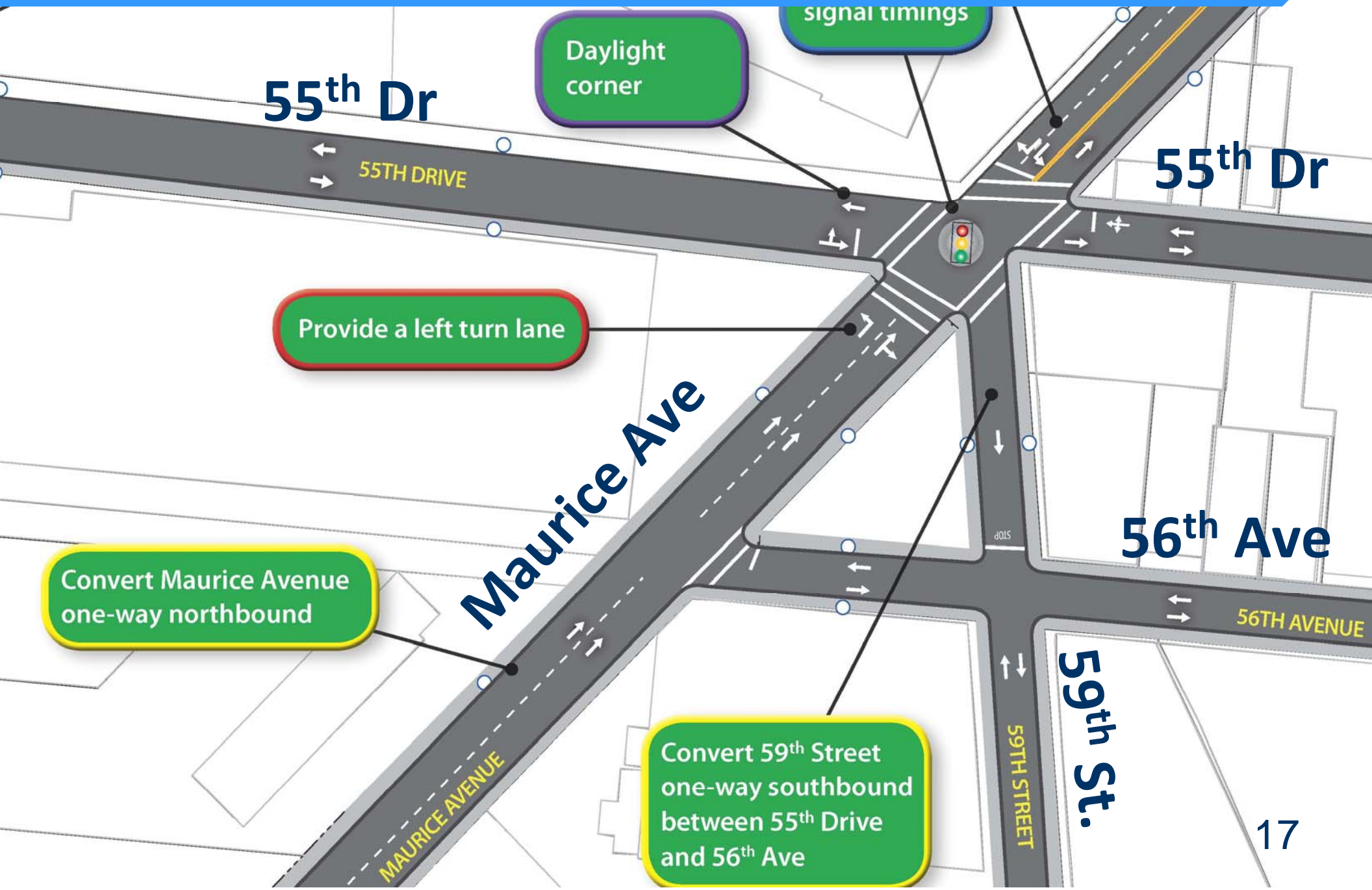

58th Street at 55th Drive

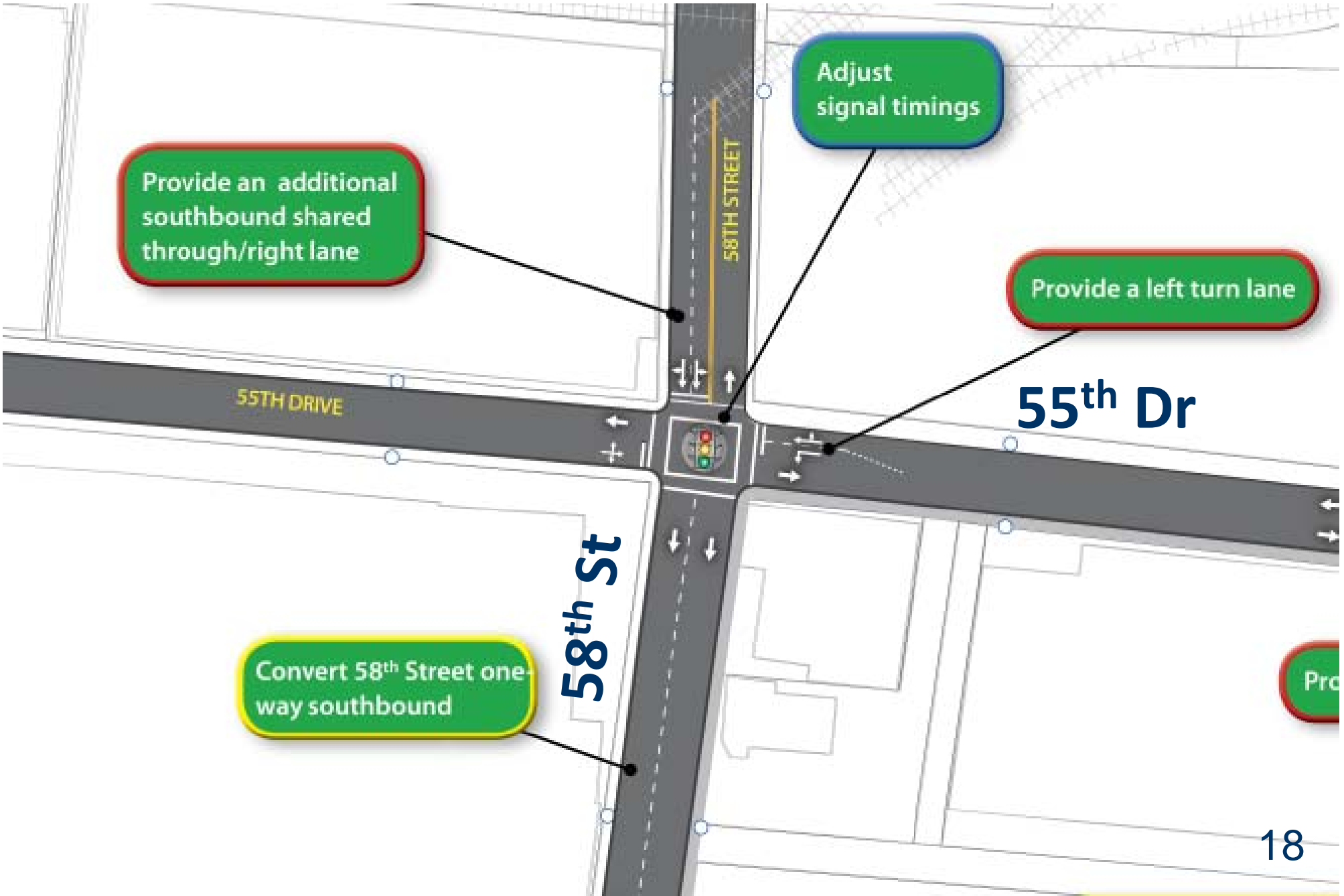

Provide an additional southbound shared through/right lane

Adjust signal timings

Provide a left turn lane

Convert 58th Street one-way southbound

Pro

Post Analysis Maspeth Bypass Route

Interchange 20 to the Brooklyn-Queens Expressway (BQE) past Interchange 32 at the entrance ramp from Williamsburg Place via Maurice Avenue, Maspeth Avenue, Page Place, Grand Avenue, Metropolitan Avenue, left onto Marcy Avenue, and Williamsburg Street. (Stay Right on QME--Exit 18 to Borden Avenue, left onto Maurice Avenue).

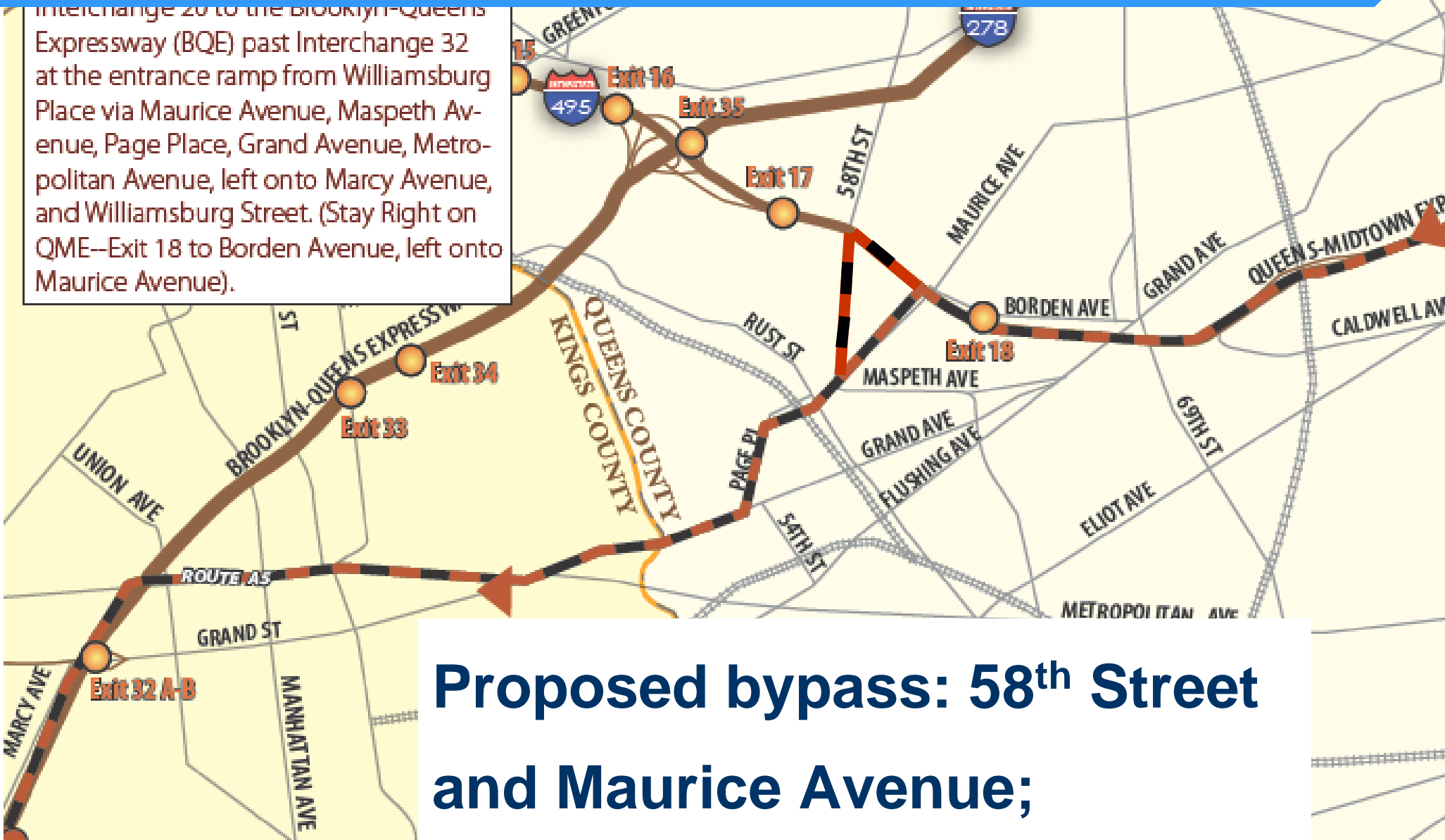

**Proposed bypass: 58th Street
and Maurice Avenue;**

Page Place not Rust Street

Q39 Bus Re-Route

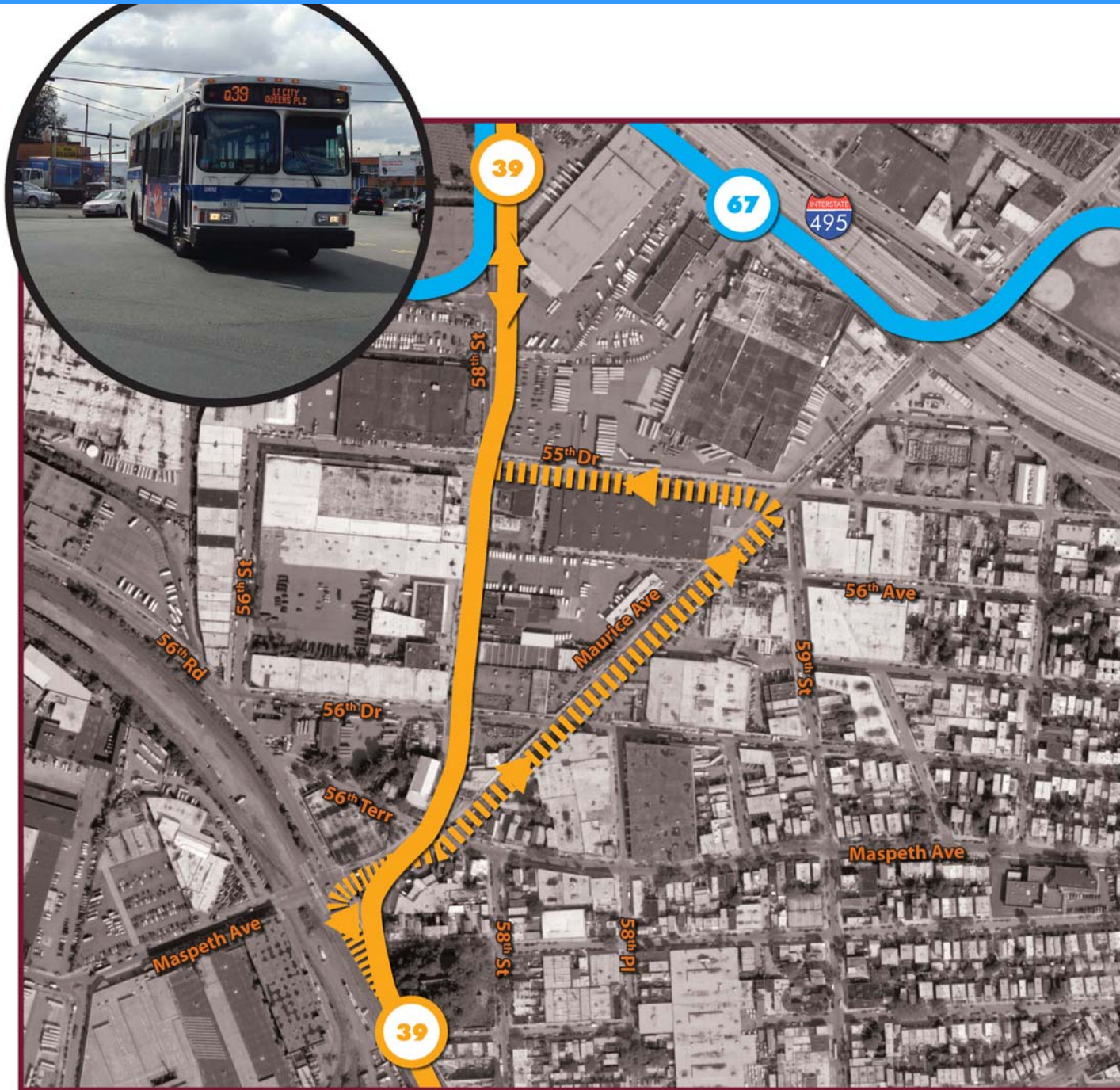

Outreach Briefings (Post Feb 2011)

- March 15 Maspeth Industrial Business Zone
- March 22 COMET Civic Group briefing
- March 22 Community Board 5 Trans. Committee
- March 23 Community Board 2 Trans. Committee
- March 24 Briefing for Petro, FDNY, Midtown Express
- March 25, 2011 Juniper Valley Civic Association
- April 5 Maspeth Industrial Business Zone members
- April 26 Community Board 5 Trans. Committee

Outreach Briefings (Post Feb 2011)

- May 11 Community Board 5 Board Meeting
- May 17 Community Board 2 Trans. Committee
- May 19 Open House Hosted by Petro
- May 24 Community Board 5 Trans. Committee
- May 26 Briefing for Coca Cola
- May 25 Meeting with Clinton Diner
- May 26 Open House Hosted by Petro

Changes to Plan within CB 2

- 57th Place two-way Maspeth Avenue and 57th Road
- 59th Street from Maurice to 56th Avenue (one block rather than 3 blocks)

One way conversions for approval

- Maurice Avenue one-way northbound between Maspeth Avenue and 55th Drive
- 58th Street one-way southbound between 55th Drive and 56th Terrace/Maspeth Avenue

Proposed Highway Truck Route Signage

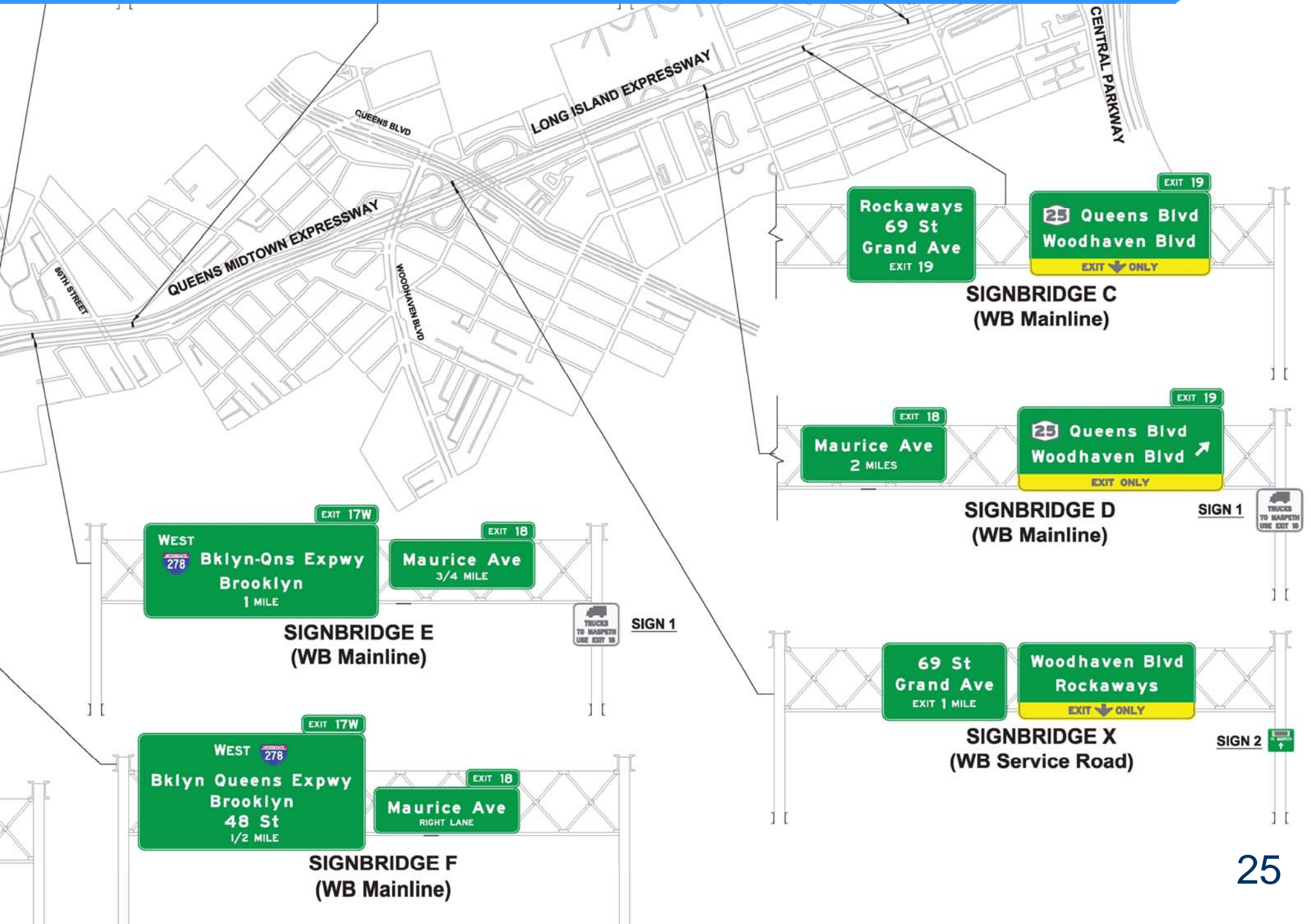

Highway Truck Route Signage

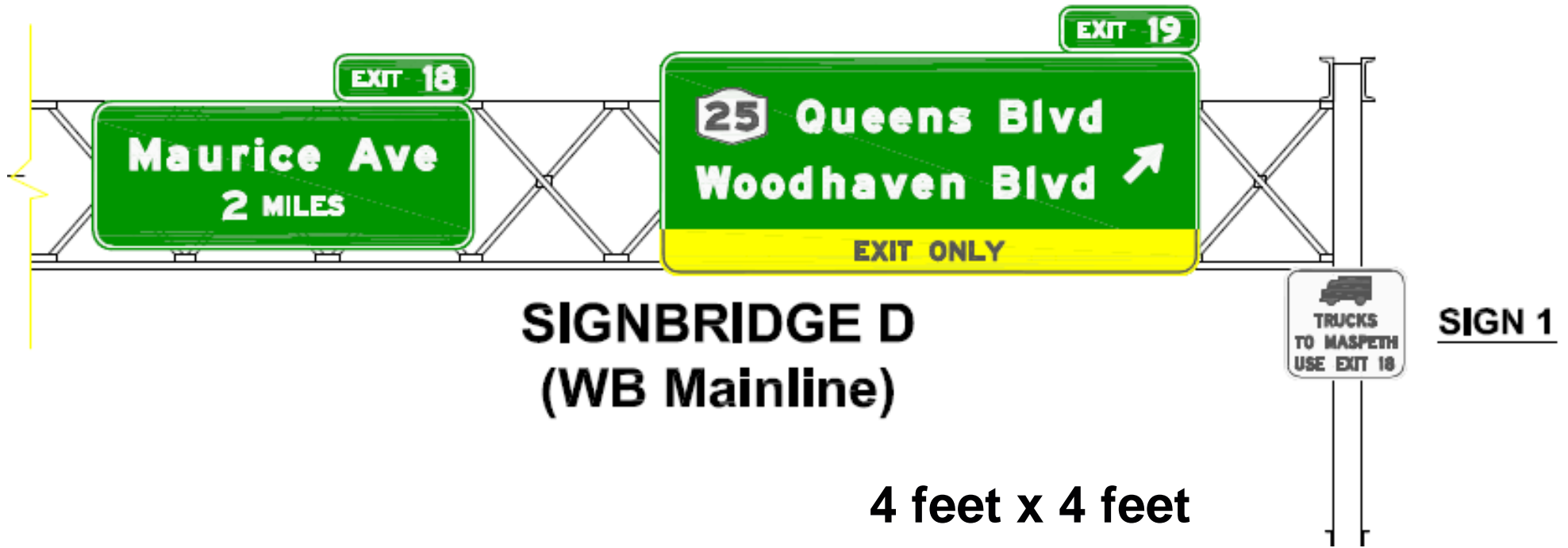

Questions?