

# Bx6 South Bronx Crosstown Select Bus Service

Manhattan Community Board 12 Meeting | April 3, 2017



+selectbusservice



# Agenda

- Project background
- 155<sup>th</sup> St viaduct proposal
- Bx6 service plan
- Questions and discussion

# Bx6 Background

The Bx6 South Bronx corridor was identified as a potential candidate for Select Bus Service in the 2009 Bus Rapid Transit Phase II Study.

- Serves nearly 25,000 daily riders, including 7,200 in Manhattan
- Connects to **1**, **C**, **4**, **B**, **D**, **2**, **5**, **6** subway lines, Metro-North, and 20 bus routes, including Bx41 SBS
- 76% of households within a quarter-mile of the route do not own a vehicle

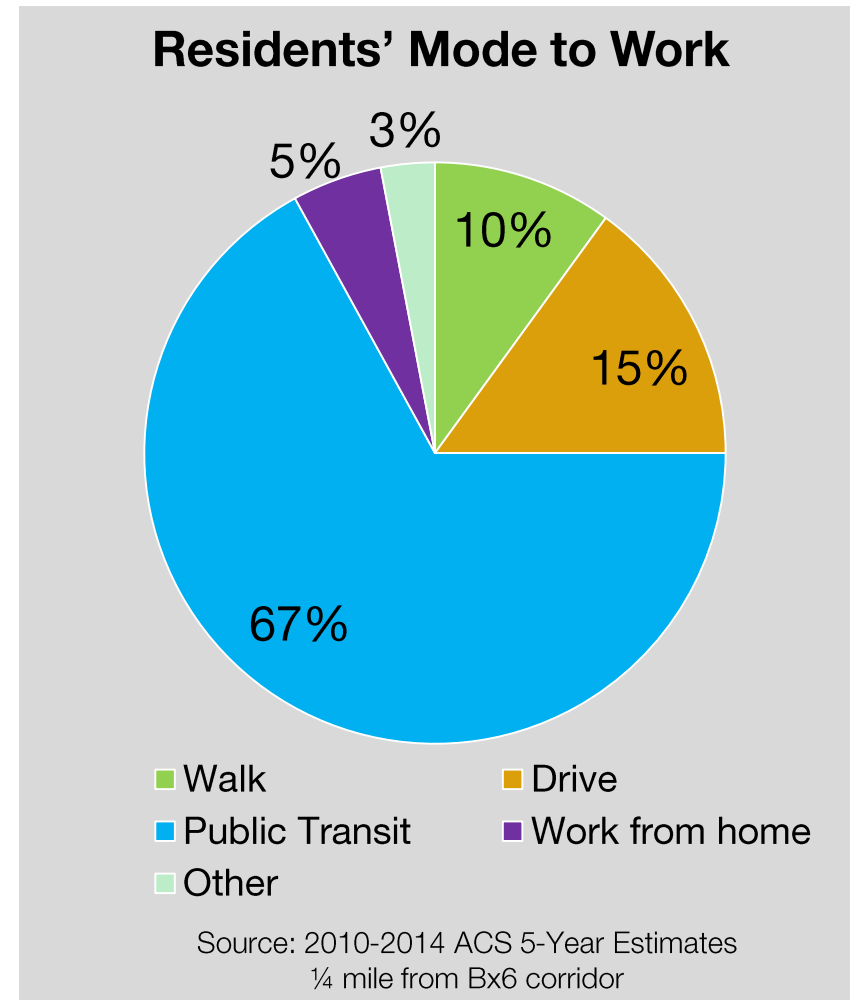

# Select Bus Service in New York City

Select Bus Service (SBS) is New York City's brand name for Bus Rapid Transit: an improved bus service that offers fast, frequent, and reliable service on high-ridership bus routes.

SBS has brought:

- 10-30% faster bus speeds
- About 10% increase in ridership
- More reliable service
- Customer satisfaction of 95%
- Safer streets / reduction in crashes

There are 12 Select Bus Service routes in operation serving all 5 boroughs.

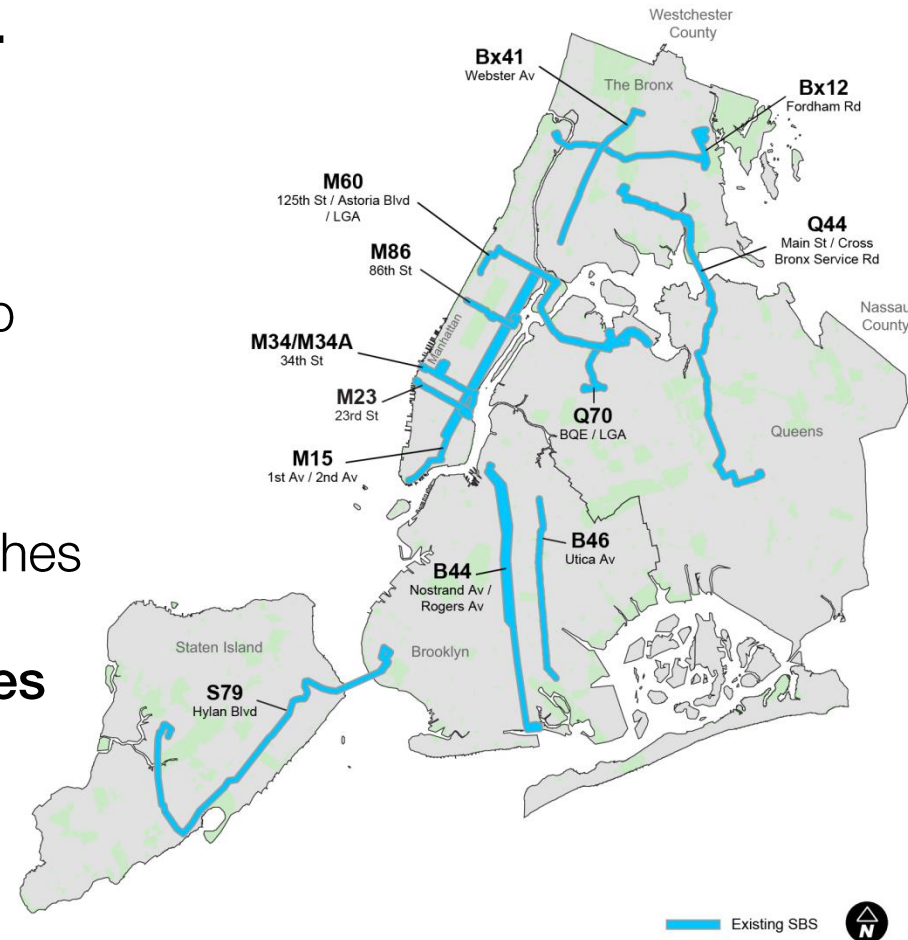



# Select Bus Service Features

Dedicated Bus Lanes



Signal Priority for Buses



- **Faster** bus rides
- **Reduced traffic conflicts** between buses and traffic
- **More reliable** bus service
- Buses spend **less time stopped** at red lights

Off-Board Fare Collection



All-Door Boarding



- **Quicker** bus boarding
- Buses spend **less time waiting** at bus stops

# Select Bus Service Features

Improved Station Amenities



Real-Time Passenger Information



- **More attractive, appealing** bus stops
- **Better trip information** for riders to **know when** the bus is coming
- **More comfortable wait** for the bus

Pedestrian Safety Improvements



- **Better visibility** for pedestrians, bus operators, and drivers
- **Clearer, shorter** pedestrian crossings

# Manhattan Data Collection & Community Engagement

## Previous Meetings

- **Manhattan/ Bronx On-street Outreach** (November 2015 – June 2016)
  - During AM peak at six locations
  - Received 578 individual comments and distributed over 1,300 Bx6 SBS information cards in English and Spanish
- **Traffic and Pedestrian Data Collection** (October 2015 – June 2016)
- **Online Feedback Portal** (launched November 2015)
  - Received 59 location-specific comments
- **Manhattan Community Board 9 TC Committee** (June 2016)
- **Manhattan Community Board 10 TC Committee** (June 2016)
- **Manhattan Community Board 12 TC Committee** (September 2016)

## Upcoming Meetings

- **Manhattan Community Board Meeting 9** (April 2017)
- **Manhattan Community Board Meeting 10** (April 2017)



# 155<sup>th</sup> St Viaduct Proposals



# 155<sup>th</sup> St / Harlem River Driveway / Edgecombe Av – Existing

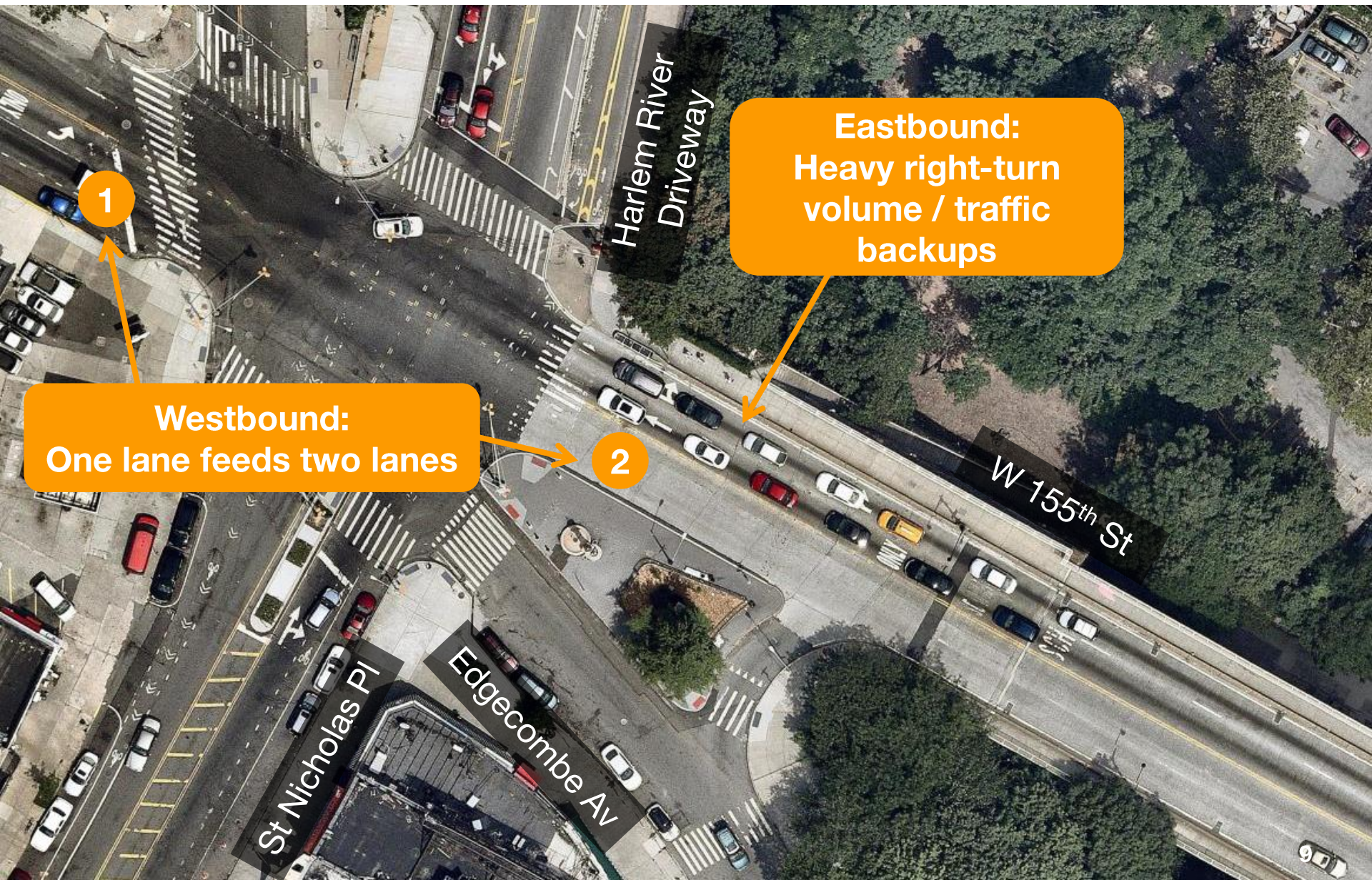

1

Westbound:  
One lane feeds two lanes

2

Eastbound:  
Heavy right-turn  
volume / traffic  
backups

Harlem River  
Driveway

W 155<sup>th</sup> St

St Nicholas Pl

Edgecombe Av



# 155<sup>th</sup> St / Harlem River Driveway / Edgecombe Av – Proposal

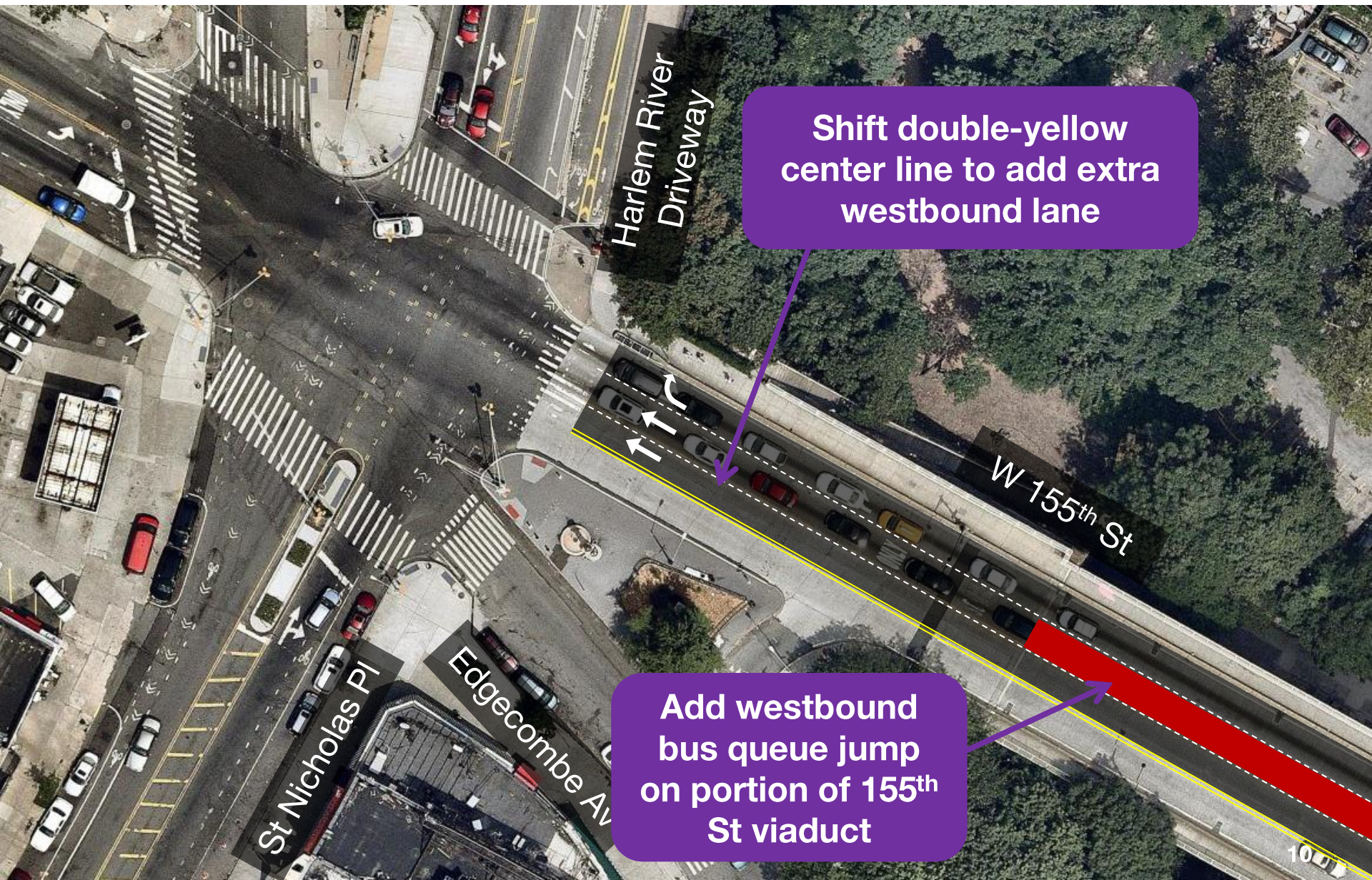

Shift double-yellow center line to add extra westbound lane

Add westbound bus queue jump on portion of 155<sup>th</sup> St viaduct



# Future 155<sup>th</sup> St Viaduct Bus Stops

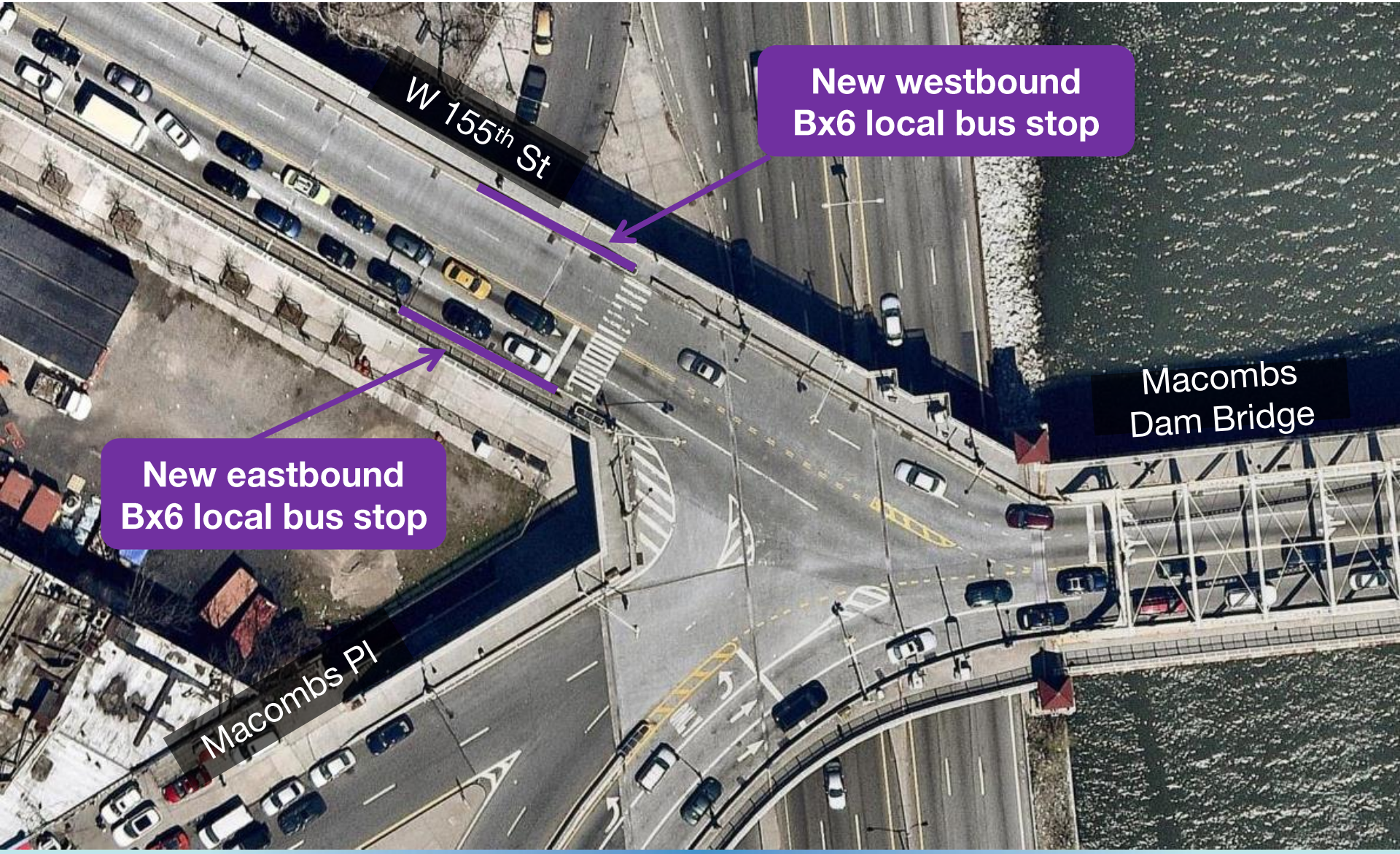

New westbound  
Bx6 local bus stop

Macombs  
Dam Bridge

New eastbound  
Bx6 local bus stop

Macombs Pl

W 155<sup>th</sup> St

# Bx6 Service Plan

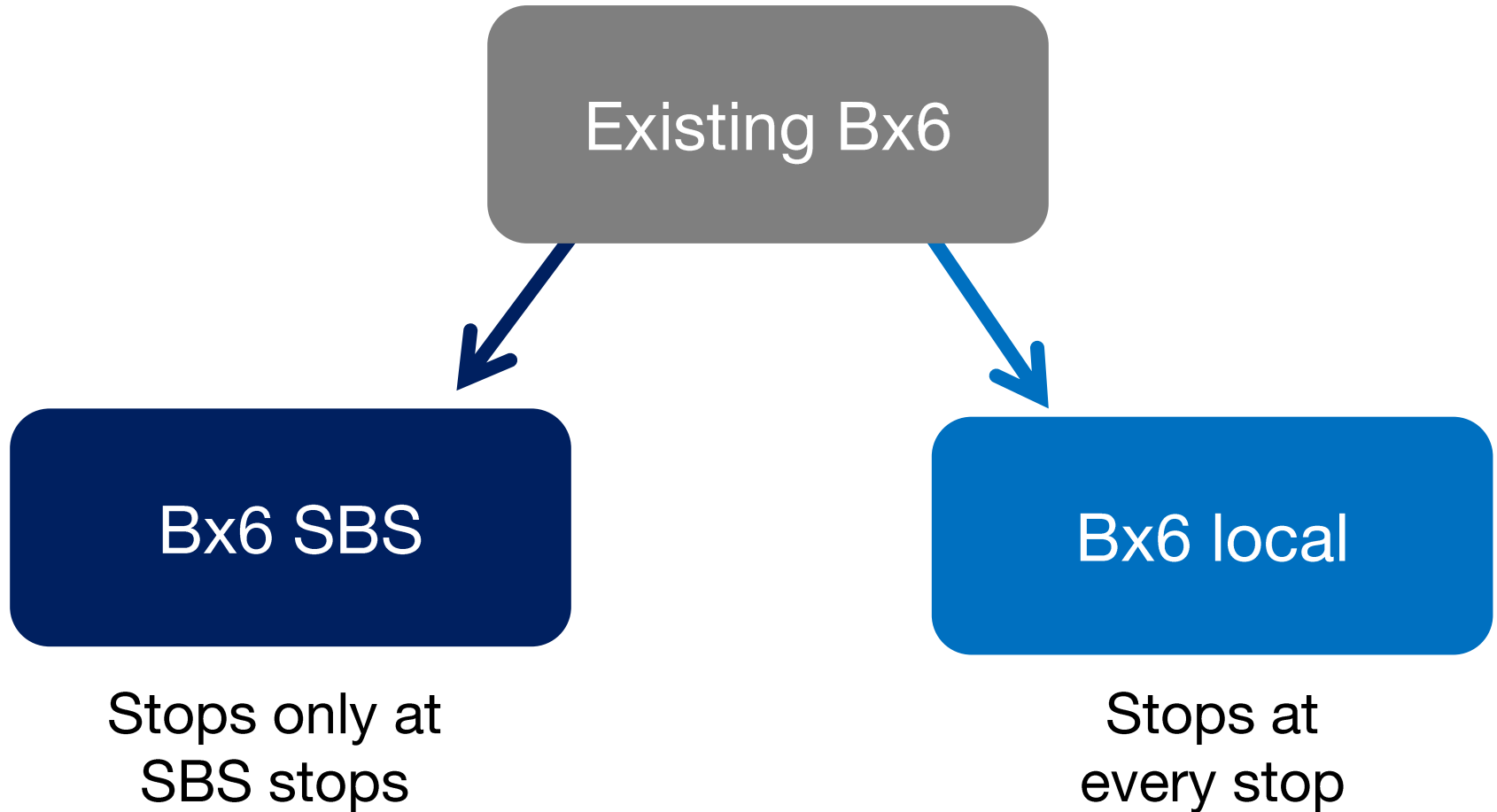



# Bx6 SBS Stops

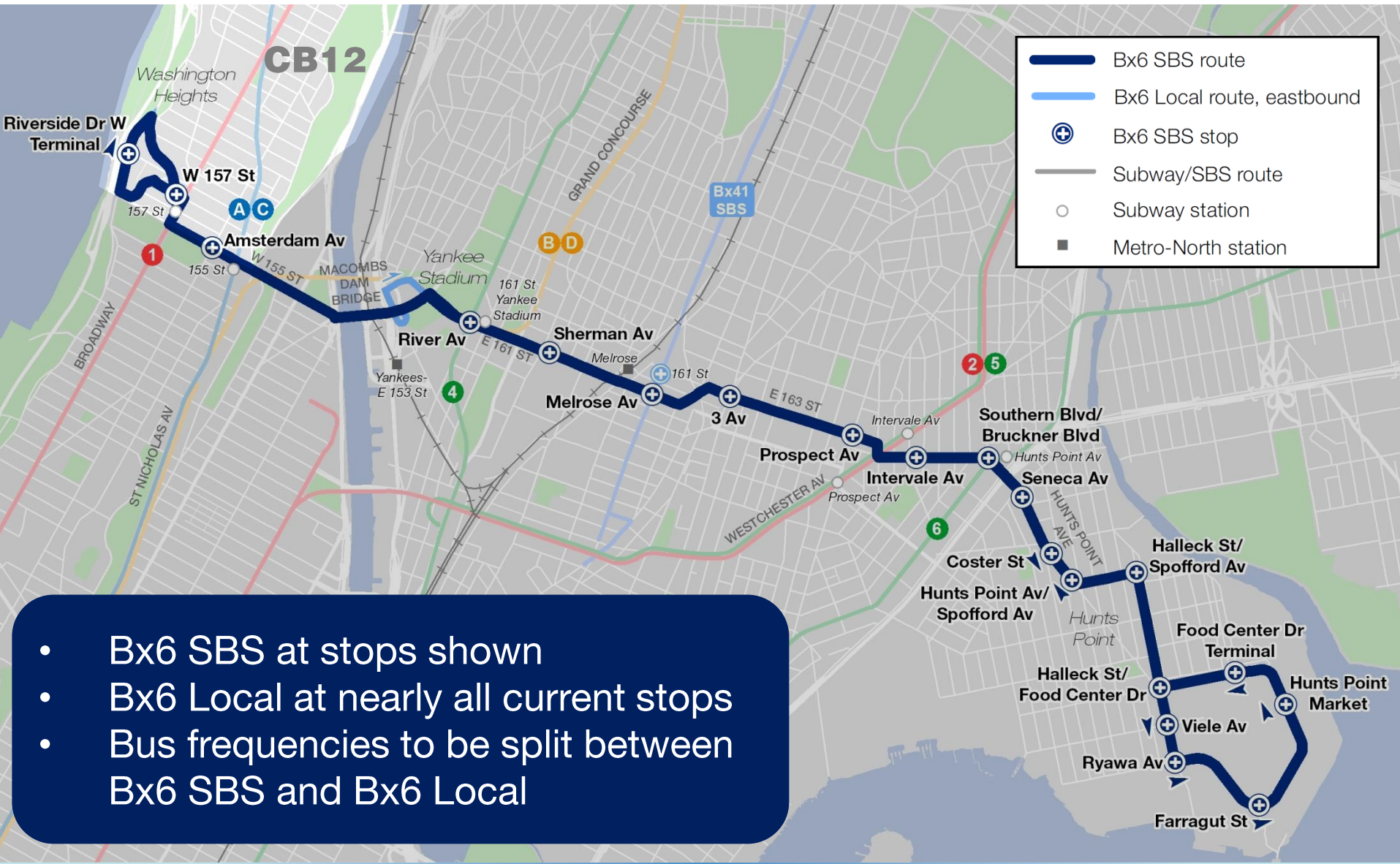

- Bx6 SBS at stops shown
- Bx6 Local at nearly all current stops
- Bus frequencies to be split between Bx6 SBS and Bx6 Local

# Manhattan Bx6 Bus Stops





# Next Steps

- Spring 2017
  - Meet with Manhattan Community Boards
  - Install fare machines at SBS stops
  - Implement street design
- Summer 2017
  - Launch Bx6 SBS service



# Questions and Discussion





# Appendix