

Long Island City Innovation Center

Community Board 2 Land Use Committee

September 26, 2018



City of New York

NYCEDC



TFC

New York Works
Creating Good Jobs

Development Team

Applicants:

- **Anable Ventures LLC (TF Cornerstone)**
- **NYC Economic Development Corporation**

Development Partners:

- **Greenpoint Manufacturing Design Center (GMDC)**
- **Coalition For Queens (C4Q)**
- **BJH Advisors**

Architects:

- Office Of Design And Architecture (ODA)
- Michael Arad, Handel Architects

Environmental Consultant:

- AKRF

Landscape Architects:

- Signe Nielsen, MNLA

Civil Engineer:

- Philip Habib + Associates

Land Use Counsel:

- Fried, Frank, Shriver & Jacobson, LLP



Long Island City Innovation Center

Connected Publicly Accessibly Open Space



New York Works
Creating Good Jobs

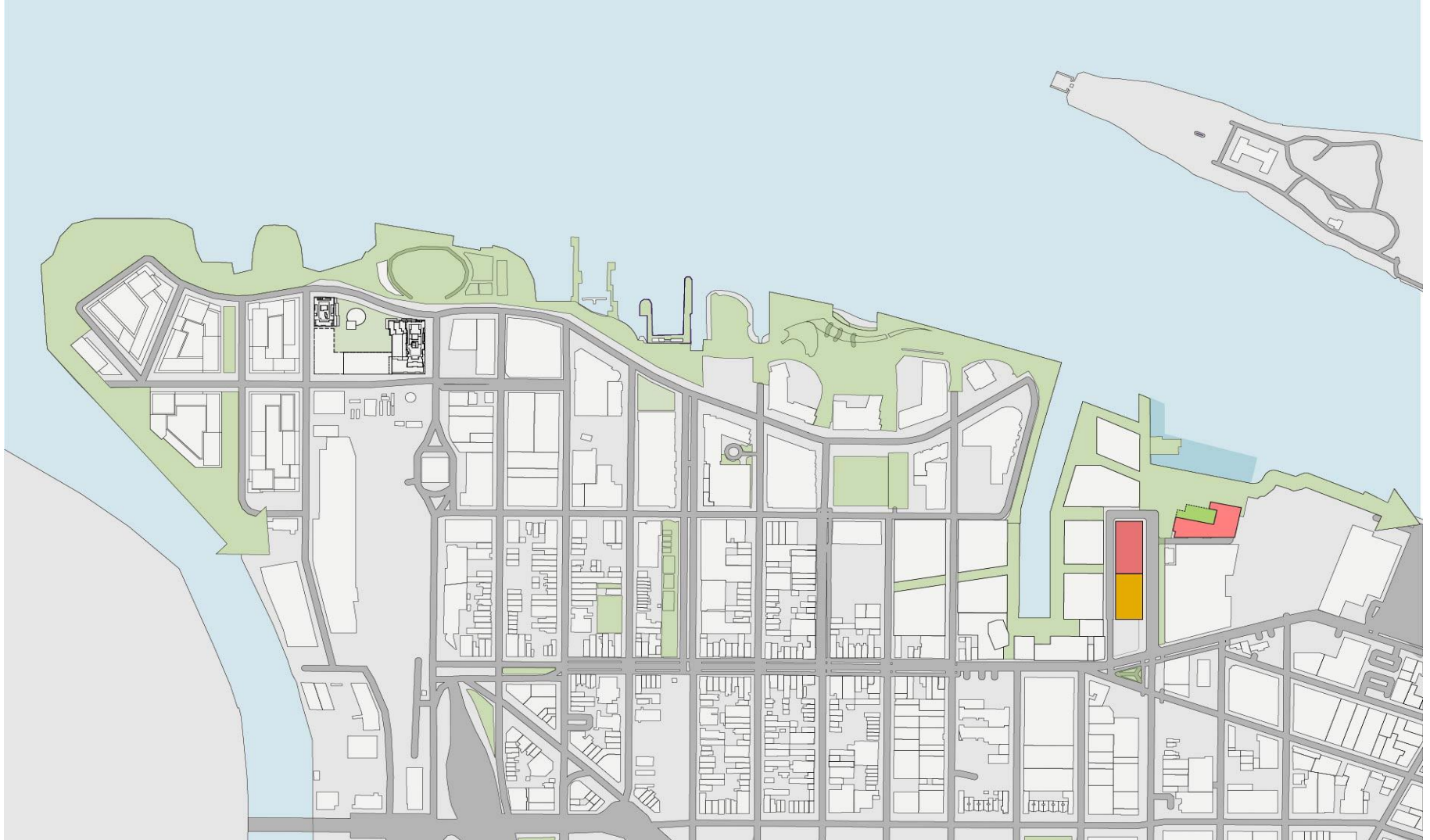

Waterfront Existing Conditions

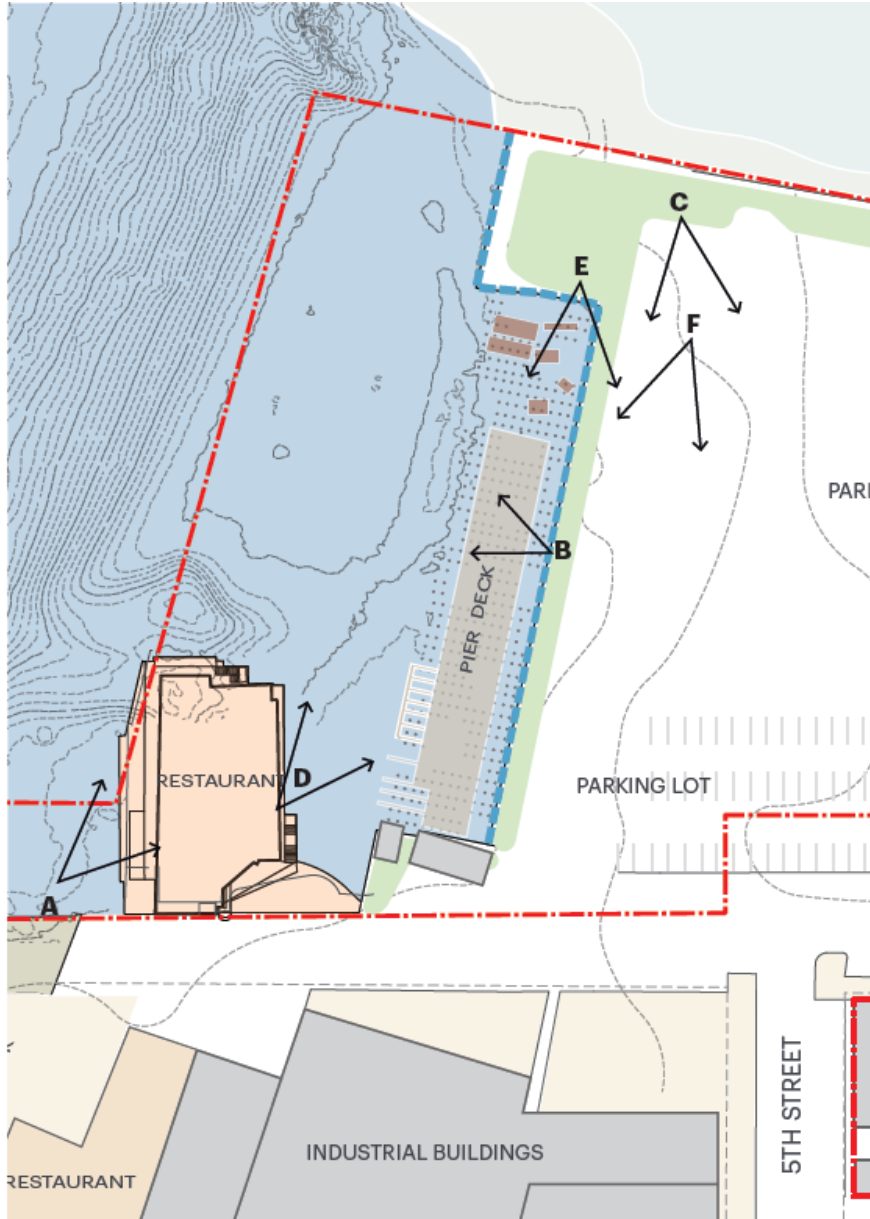

Open Space and Public Access

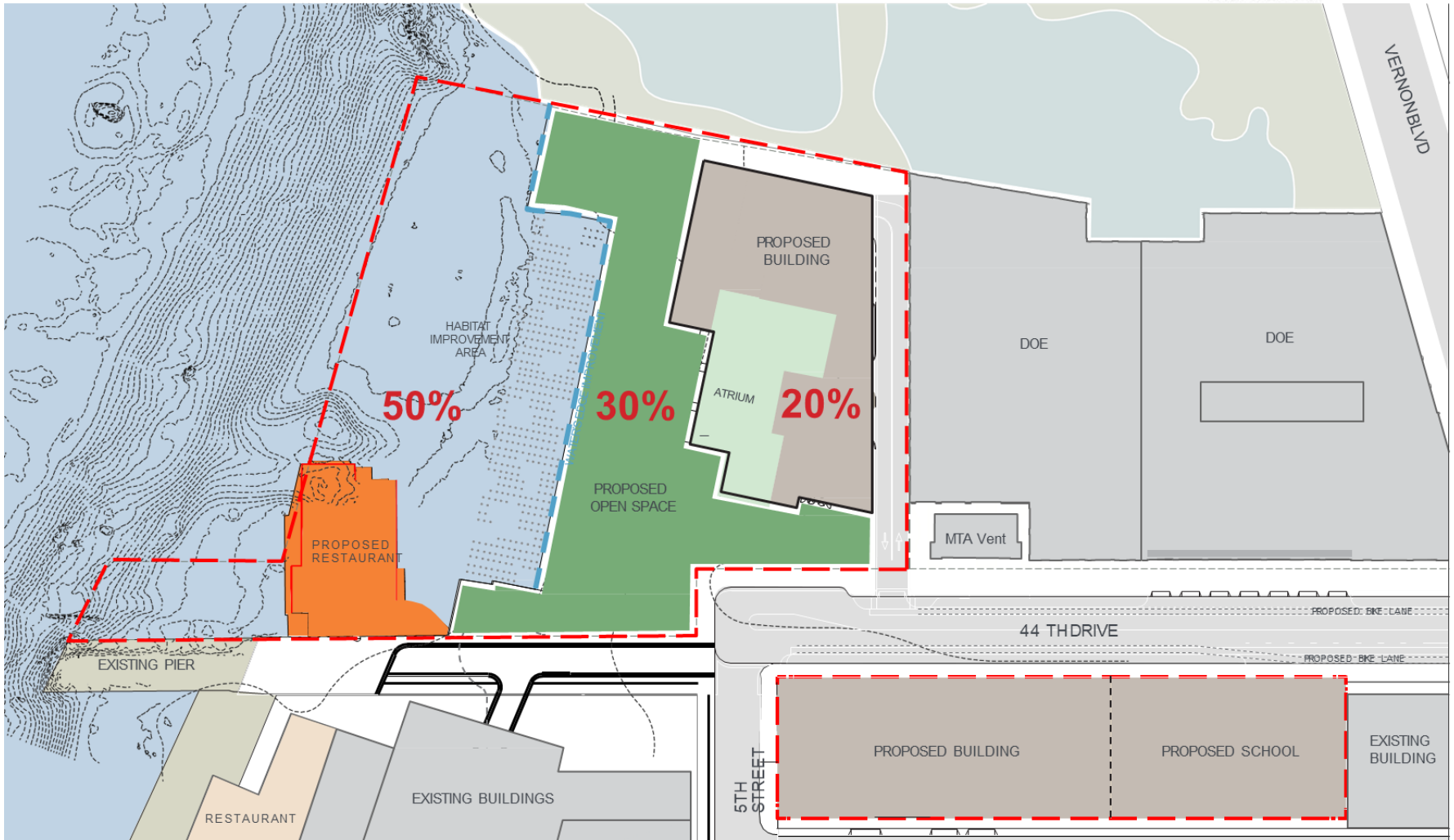

50% MARINE HABITAT (INCLUDING 16,000SF RETURNED TO RIVER)
30% OPEN SPACE
20% BUILDING AREA

Open Space Program Possibilities

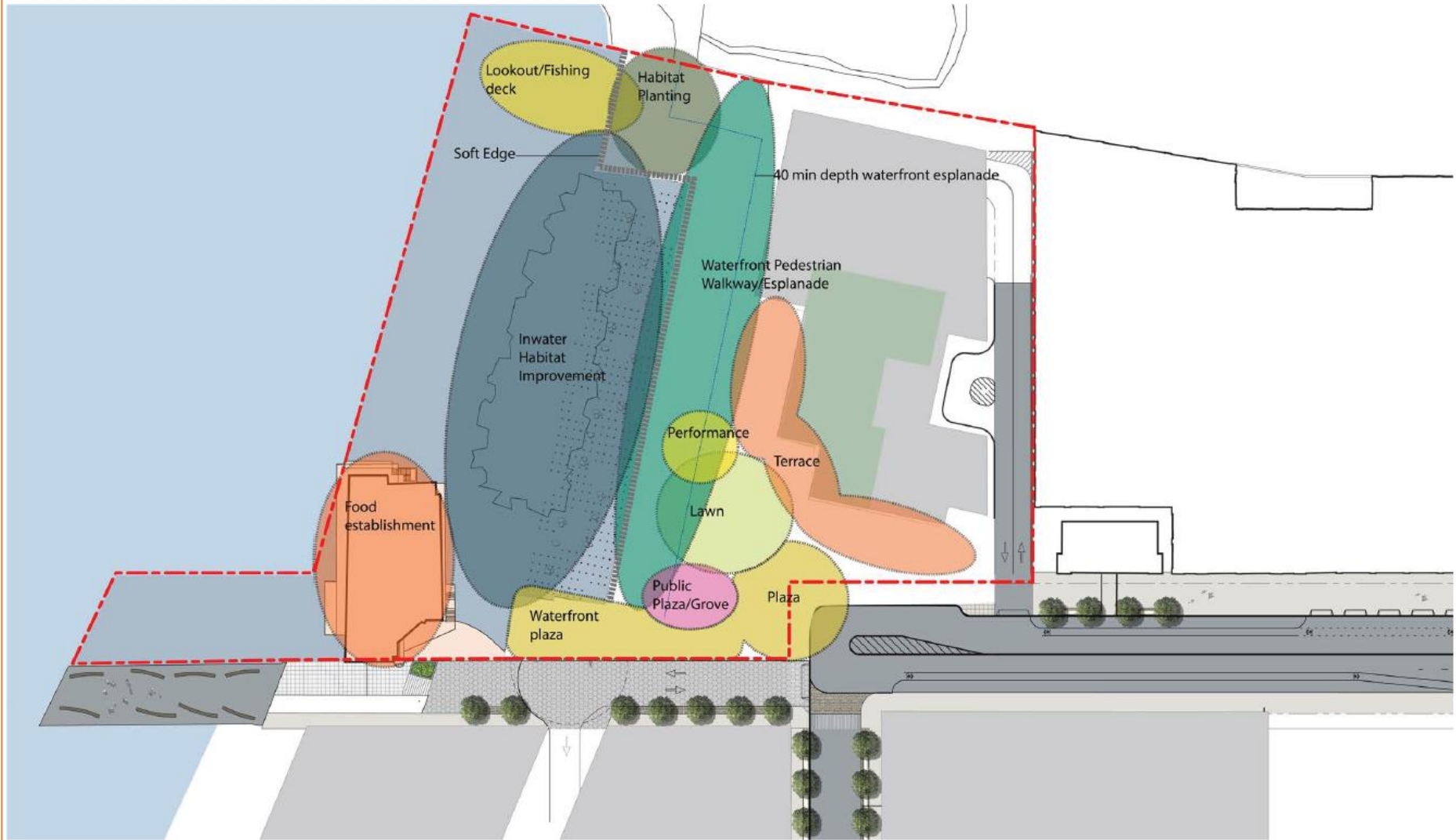

Open Space Community Engagement

Ongoing engagement with local stakeholders

- **CB 2 Land Use Committee briefings**
 - March 16, 2016
 - February 17, 2017
 - August 21, 2017
 - September 19, 2017
 - May 16, 2018
 - September 26, 2018**
- **Site Tour with CB Chair and Land Use Chair** – June 6, 2018
- **Public Community Meeting on Open Space Design** – June 25, 2018
- **Public Scoping Hearing** – September 17, 2018



Community Feedback: Open Space

Over 80+ Members Of The Community Attended



Community Feedback: Open Space

Input at the June 25, 2018 public meeting on open space design

GENERAL COMMENTS

- + PREFERENCE FOR A NATURAL LOOK AND FEEL TO THE SITE
- + PREFERENCE FOR PASSIVE RECREATION, GARDENS, ART INCLUSION, AND ACCESS TO THE WATER
- + STRONG COMMUNITY INTEREST IN LAND AND WATER HABITAT & ECOLOGICAL EDUCATION FOR CHILDREN
- + THE ANABLE BASIN SITE SHOULD BE A PUBLIC SPACE OPEN TO ALL
- + THE SITE SHOULD BE A DESTINATION FOR COMMUNITY MEMBERS, NOT JUST A CONNECTOR

SITE VISION

- + GREATER CONNECTIVITY TO SURROUNDING PARKS
- + WIDE PATHS THAT ACCOMMODATE STROLLERS
- + SOFT EDGE SHORELINE
- + ACCESS TO WATER
- + PIER(S) OFF THE SHORELINE
- + IN-WATER HABITAT DEVELOPMENT
- + MORE GREEN, LESS CONCRETE
- + PEDESTRIAN BRIDGE

WATER PROGRAMMING

- + PREFERENCE FOR "SOFT EDGE" SHORELINE
- + IN-WATER HABITAT AND WETLAND GROWTH
- + BOATING/BOATHOUSE
- + FISHING/PIER FOR FISHING
- + OUTDOOR EDUCATION FOR CHILDREN TO LEARN ABOUT HABITAT
- + STEPPED WATERFRONT TERRACE
- + DIFFERENT PIERS FOR DIFFERENT ACTIVITIES
- + WATER ACCESS FOR EXPERIENCE, NOT RECREATION

LAND PROGRAMMING

- + LAWN SPACE FOR PASSIVE AND ACTIVE RECREATION
- + AMPHITHEATER/PERFORMANCE SPACE
- + PLAYGROUND, ESPECIALLY FOR CHILDREN UNDER 2
- + GARDENS FOR HABITAT AND ECOLOGICAL EDUCATION
- + INCLUSION OF ART & SCULPTURE
- + SPORTS FIELDS OR COURTS
- + BOTANIC AND ENGLISH GARDENS

OTHER

- + PREFERENCE FOR SHADE ON SITE
- + USE OF RESILIENT MATERIALS
- + CONCERN ABOUT SHADE FROM NEARBY BUILDINGS
- + BOARDWALK OVER EXISTING PILES
- + MEANDERING ESPLANADE
- + "LIVING LAB" FOR SCHOOLCHILDREN



Long Island City Innovation Center

Proposed Open Space Elevations





Resilient Waterfront

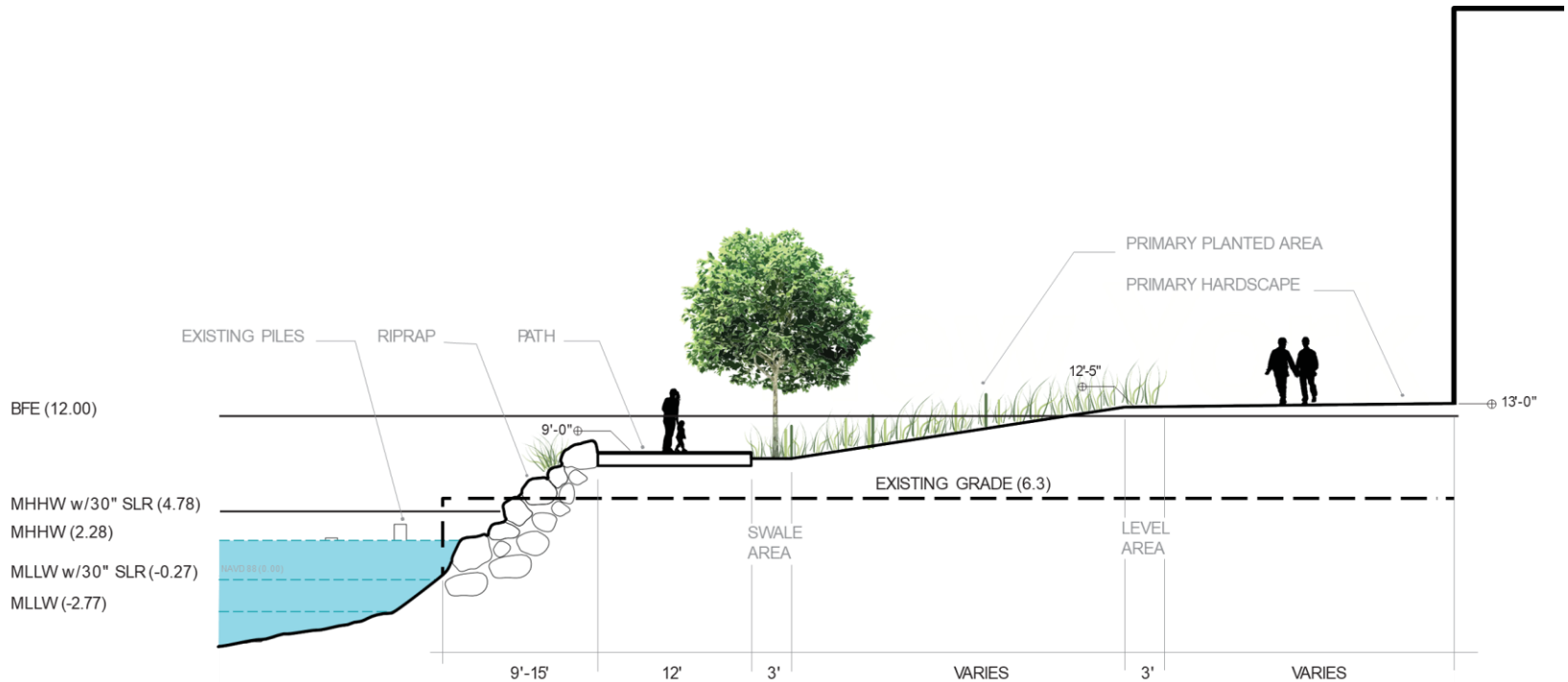

SLR: Sea level rise high estimate (90th percentile) in 2050, 30 inches.
Source: ORR Climate Resiliency Design Guideline / NPCC



Long Island City Innovation Center

Proposed Open Space Site Plan



Long Island City Innovation Center

Habitat Restoration and Publicly Accessibly Waterfront Open Space



New York Works
Creating Good Jobs





Long Island City Innovation Center

View northwest from the proposed public plaza



Long Island City Innovation Center Public Atrium Proposed at Waterfront Site



City of New York

New York Works
Creating Good Jobs





Long Island City Innovation Center Open Space Proposed at Waterfront Site



Thank You!

Further questions? Please contact:

Eleni Bourinaris, Queens Borough Director
Gov't & Community Relations, NYCEDC
ebourinaris@edc.nyc | (212) 312-3896

Appendix



Long Island City Innovation Center

Proposed Site Plan

