

# Community and Cultural Resources

Support the growth and maintenance of parks and open space, promote arts and cultural uses for all community members and develop strategies to recognize, interpret and celebrate the neighborhood's history.

## Connect parks and public areas through an open space green network

- Ennis Playground, located on 11th Street between 2nd and 3rd Avenues, is currently undergoing a \$2.7 million renovation by NYC Parks with new play areas, landscaped seating areas, a basketball court and a multipurpose turf field. Construction started in July 2018 and will take approximately one year. The project is funded by Council Member Lander and Borough President Adams.
- In April 2018, NYC Parks completed Phase I of a \$3 million renovation of St. Mary's Playground, located on Smith Street between Luquer and Huntington Streets. The project includes new ADA accessible play equipment, spray showers, seating and planting, and permeable pavers to manage storm water. Phase II, currently under construction, will include a skate park, turf field, running track, basketball court and fitness equipment. The project is funded by Council Member Lander and Borough President Adams.



- In November 2018, HPD, in collaboration with the designated development team and city agencies, held a public workshop to re-engage the community and collect feedback on the preliminary site planning for Public Place, a six-acre city-owned parcel at the intersection of 5th and Smith Streets. The workshop included a visioning activity for the development's public open space.



## Identify historic interpretation and placemaking strategies to reflect Gowanus' rich history

- The Landmarks Preservation Commission is actively evaluating historic resources in the area to identify properties eligible for landmark designation and has developed a framework to prioritize buildings. In the first half of 2019, LPC will identify and calendar properties that best reflect Gowanus' rich industrial past and the importance of the canal itself.
- The City, in collaboration with the Council Members and stakeholders such as Arts Gowanus, Old Stone House and the Gowanus Canal Conservancy will work together to develop strategies for historic interpretation. An initial meeting occurred in October 2018.

## Align zoning and land use to help facilitate efforts to preserve and adaptively reuse buildings

- On many blocks within Gowanus, contextual zoning districts would be mapped to support the existing scale and character of buildings, particularly along 3rd Ave south of Union Street and surrounding interior blocks, as well as blocks with loft-style, non-residential buildings, many of which have been renovated and contain studios and businesses.

## Assess existing school capacity and identify opportunities to meet future needs

- As noted in the Framework, SCA has identified needs for the construction of new school seats in District 15, including in the subdistrict that contains Gowanus and PS32 where construction is well underway. Special zoning regulations to promote schools and other community resources would be applied to support planning for a growing neighborhood.
- DOE is committed to learning environments that reflect the diversity of NYC and will engage community members, incorporate community input and make data related to school diversity more transparent. The D15 Diversity Plan process will create a community based middle school diversity plan for School District 15.

## Expand space opportunities for art and cultural uses and leverage new publicly accessible open space along the waterfront for programming

- DCP, NYC Parks, LPC and Council Member Lander held a meeting in October 2018 with Arts Gowanus and the Gowanus Canal Conservancy to discuss community-wide historic interpretation opportunities including initiatives anchored by the Old Stone House. The City will continue to examine opportunities for art and cultural uses within the Gowanus area.
- As part of the zoning proposal, a new floor area incentive would be created to support nonprofits, arts and cultural uses, repair services and light industrial uses. This incentive would apply to sites fronting Thomas Greene Playground and along the Gowanus Canal. Please see the zoning proposal sections for further details.

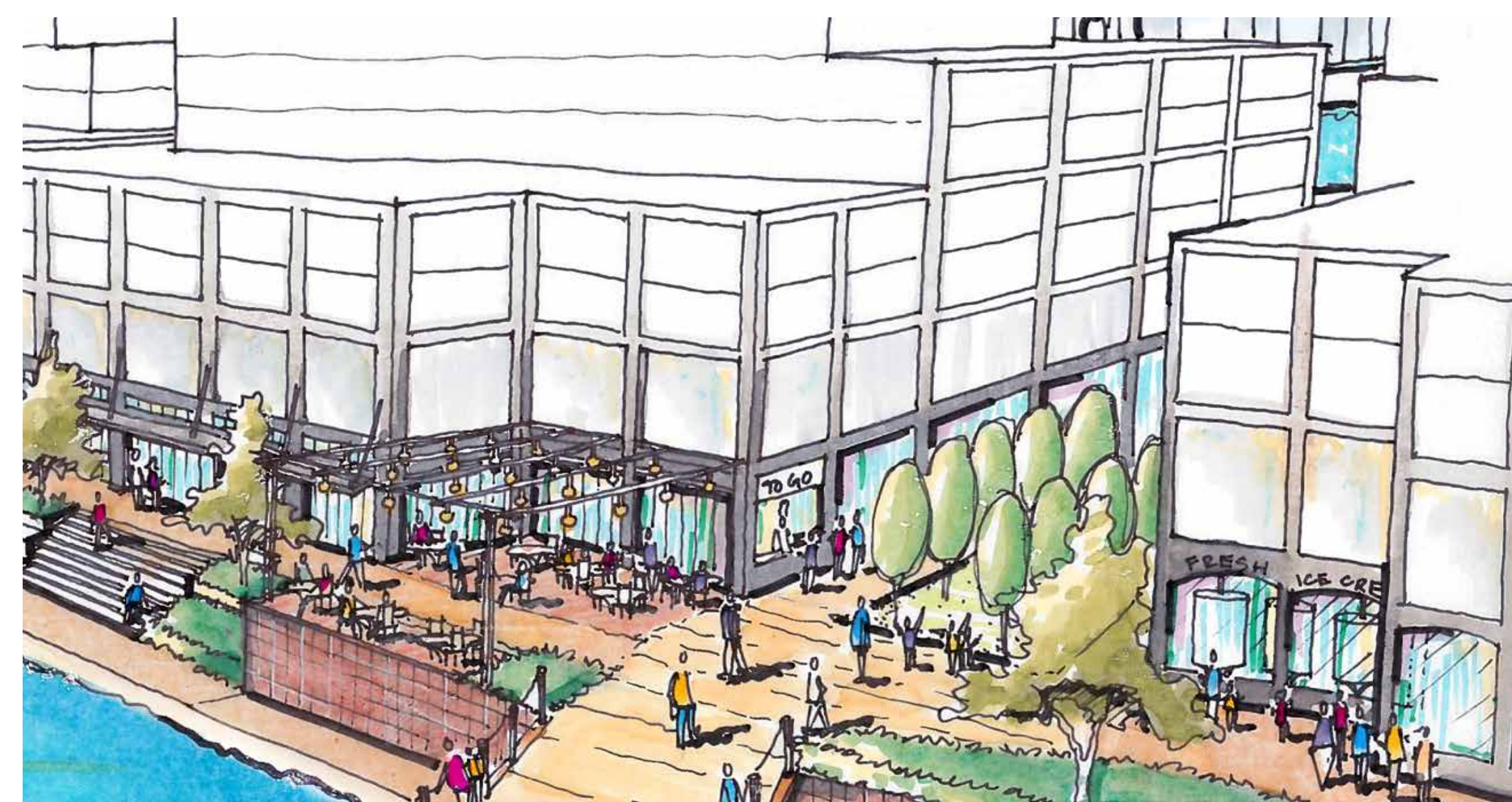

- DCLA is proceeding with a plan to activate the city-owned space at the former Degraw St firehouse for a cultural use. Currently, DCLA is working to identify an organization to operate the space and intends to finalize the plan later this year.



- In 2017, the Mayor pledged to add additional funds to renovate and reopen the Gowanus Houses Community Center. The Community Center will be operated in partnership with DYCD as a Cornerstone Program to provide engaging, high-quality, year-round programs for young people and adults. The administration has committed to provide \$4 million in funding for the project and is putting together a plan to meet with local stakeholders about programming, prior to the renovations being completed.

