Appendix J

Conceptual Analysis

Appendix J.1

Conceptual Analysis RWCDs Table

Appendix J.2

Traffic Volume Figures

Appendix J.3

Traffic LOS Tables

Appendix J.4

Pedestrian LOS Tables (Sidewalks, Corners, Crosswalks)

Appendix J.5

Parking Accumulation



Appendix J.1

Conceptual Analysis RWCDS Table



Appedix J.1: Conceptual Analysis RWCDS

	Site Data				With Action Scenario											
	Address	Block	Lot	Lot Area	Changes	Proposed Maximum FAR	Building Floor Area gsf (including mechanical)*	Usable Floor Area (gross square feet, excluding mechanical)	Commercial Floor Area gsf (Office, Retail and Hotel floor area)	Residential Floor Area gsf	Office Floor Area gsf (usable)	Retail Floor Area gsf	Hotel Floor Area gsf	# of Residential Units	# of hotel rooms, conversion or new construction	# of parking spaces, new construction
Conceptual Development Site 1 (Projected Site 10 in With Action Scenario)	111 EAST 48 STREET	1303	14	41,170	Develops as Office Building	21.6	1,022,663	933,736	933,736	-	892,566	41,170				
	TOTAL			41,170			1,022,663	933,736	933,736	-	892,566	41,170	-	-	-	-
Conceptual Development Site 2 (Projected Site 11 in With Action Scenario)	541 LEXINGTON AVENUE	1304	20	24,725	Develops as Office Building	23	653,976	597,109	597,109		572,384	24,725				
	TOTAL			24,725			653,976	597,109	597,109	-	572,384	24,725	-	-	-	-
Conceptual Development Site 3 (Projected Site 6 in With Action Scenario)	250 PARK AVENUE	1282	34	24,969	Develops as Office Building	27	775,287	707,871	707,871		682,902	24,969				
	TOTAL			24,969			775,287	707,871	707,871	-	682,902	24,969	-	-	-	-
Conceptual Development Site 4 (Projected Site 3 in With Action Scenario)	3 EAST 43 STREET	1278	8	5,690	Develops as Office Building	23	1,342,311	1,225,588	1,225,588	1,174,839	50,749					
	340 MADISON AVENUE	1278	14	32,500												
	14 EAST 44 STREET	1278	62	2,513												
	12 EAST 44 STREET	1278	63	2,513												
	10 EAST 44 STREET	1278	64	2,513												
	6 EAST 44 STREET	1278	65	5,020												
TOTAL			50,749			1,342,311	1,225,588	1,225,588	-	1,174,839	50,749	-	-	-	-	-
Conceptual Development Site 5 (Projected Site 15 in With Action Scenario)	235 EAST 42 STREET	1316	23	37,657	Develops as Office Building	21.6	1,895,739	1,730,892	1,730,892	1,654,574	76,318					
	801 2 AVENUE	1316	30	7,531												
	219 EAST 42 STREET	1316	12	31,130												
	TOTAL			76,318												
Conceptual Development Site 6 (Projected Site 2 in With Action Scenario)	7 EAST 40 STREET	1275	8	7,406	Develops as larger office and residential building	21.6	898,463	820,336	656,268	164,067	620,098	36,170		82		
	13 EAST 40 STREET	1275	11	2,450												
	15 EAST 40 STREET	1275	12	5,100												
	284 MADISON AVENUE	1275	14	4,735												
	290 MADISON AVENUE	1275	16	4,750												
	292 MADISON AVENUE	1275	59	9,250												
	22 EAST 41 STREET	1275	60	2,479												
	TOTAL			36,170												
TOTALS				254,101		6,588,439	6,015,532	5,851,465	164,067	5,597,364	254,101	-	82	-	-	

Appedix J.1: Conceptual Analysis RWCDS

	Site Data			With Action Scenario (Conceptual Analysis)											Increment								
	Address	Block	Lot	Changes	Proposed Maximum FAR	Building Floor Area gsf (including mechanical)*	Usable Floor Area (gross square feet, excluding mechanical)	Commercial Floor Area gsf (Office, Retail and Hotel floor area)	Residential Floor Area gsf	Office Floor Area gsf (usable)	Retail Floor Area gsf	Hotel Floor Area gsf	# of Residential Units	# of hotel rooms, conversion or new construction	# of parking spaces, new construction	Building Floor Area gsf (including mechanical)	Commercial Floor Area gsf (Office, Retail and Hotel floor area)	Residential Floor Area gsf	Office Floor Area gsf (usable)	Retail Floor Area gsf	Hotel Floor Area gsf	# of Residential Units	# of Hotel Rooms
Conceptual Development Site 1 (Projected Site 10 in With Action Scenario)	111 EAST 48 STREET	1303	14	Develops as hotel pursuant to hotel special permit.	21.6	933,736	933,736	933,736	-	-	41,170	892,566	-	1,373	-	-	-	-	-	-	-	-	-
	TOTAL					933,736	933,736	933,736	-	-	41,170	892,566	-	1,373	-	(88,927)	-	-	(892,566)	-	892,566	-	1,373
Conceptual Development Site 2 (Projected Site 11 in With Action Scenario)	541 LEXINGTON AVENUE	1304	20	Develops as hotel pursuant to hotel special permit, develops as larger building pursuant to transit special permit.	26	674,993	674,993	674,993	-	-	24,725	650,268	-	1,000	-	-	-	-	-	-	-	-	-
	TOTAL					674,993	674,993	674,993	-	-	24,725	650,268	-	1,000	-	21,016	77,884	-	(572,384)	-	650,268	-	1,000
Conceptual Development Site 3 (Projected Site 6 in With Action Scenario)	250 PARK AVENUE	1282	34	Develops as larger office building pursuant to transit improvement special permit and special permit to modify subdistrict regulations*	30	861,431	786,524	786,524	-	761,555	24,969	-	-	-	-	-	-	-	-	-	-	-	-
	TOTAL					861,431	786,524	786,524	-	761,555	24,969	-	-	-	-	86,143	78,652	-	78,652	-	-	-	-
Conceptual Development Site 4 (Projected Site 3 in With Action Scenario)	3 EAST 43 STREET	1278	8	Develops as an enlargement of existing structure on Lot 14 (pursuant to authorization permitting enlargements to use Qualifying Site regulations), that would have additional floor area pursuant to public concourse special permit.	26	1,517,395	1,385,448	1,385,448	-	1,334,699	50,749	-	-	-	-	175,084	159,859	-	159,859	-	-	-	-
	340 MADISON AVENUE	1278	14																				
	14 EAST 44 STREET	1278	62																				
	12 EAST 44 STREET	1278	63																				
	10 EAST 44 STREET	1278	64																				
	6 EAST 44 STREET	1278	65																				
TOTAL						1,517,395	1,385,448	1,385,448	-	1,334,699	50,749	-	-	-	-	175,084	159,859	-	159,859	-	-	-	
Conceptual Development Site 5 (Projected Site 15 in With Action Scenario)	235 EAST 42 STREET	1316	23	Develops as larger office building pursuant to public concourse special permit.	24.6	2,159,036	1,971,294	1,971,294	-	1,894,976	76,318	-	-	-	-	263,297	240,402	-	240,402	-	-	-	-
	801 2 AVENUE	1316	30																				
	219 EAST 42 STREET	1316	12																				
	TOTAL																						
Conceptual Development Site 6 (Projected Site 2 in With Action Scenario)	7 EAST 40 STREET	1275	8	Develops as smaller office building without wide street frontage pursuant to special permit to modify subdistrict regulations**	21.6	371,507	339,202	339,202	-	324,246	14,956	-	-	-	-	-	-	-	-	-	-	-	
	13 EAST 40 STREET	1275	11																				
	15 EAST 40 STREET	1275	12																				
	284 MADISON AVENUE	1275	14	Existing/no-action conditions (not part of development site)	-	102,079	102,079	102,079	-	102,079	-	-	-	-	-	-	-	-	-	-	-	-	
	290 MADISON AVENUE	1275	16		-	36,681	36,681	36,681	-	30,111	6,570	-	-	-	-	-	-	-	-	-	-		
	292 MADISON AVENUE	1275	59		-	170,230	170,230	170,230	-	164,420	5,810	-	-	-	-	-	-	-	-	-	-		
	22 EAST 41 STREET	1275	60		-	7,255	7,255	7,255	-	3,855	3,400	-	-	-	-	-	-	-	-	-	-		
TOTAL					687,752	655,447	655,447	-	624,711	30,736	-	-	-	-	(210,711)	(821)	(164,067)	4,613	(5,434)	-	(82)	-	
TOTALS				-	-	6,834,342	6,407,440	6,407,440	-	4,615,940	248,667	1,542,833	-	2,374	-	245,902	555,976	(164,067)	(981,423)	(5,434)	1,542,833	(82)	2,374

*modifies height and setback regulations

**modifies height and setback and qualifying site regulations relating to cleared wide street frontage and residential use

Appendix J.2

Traffic Volume Figures



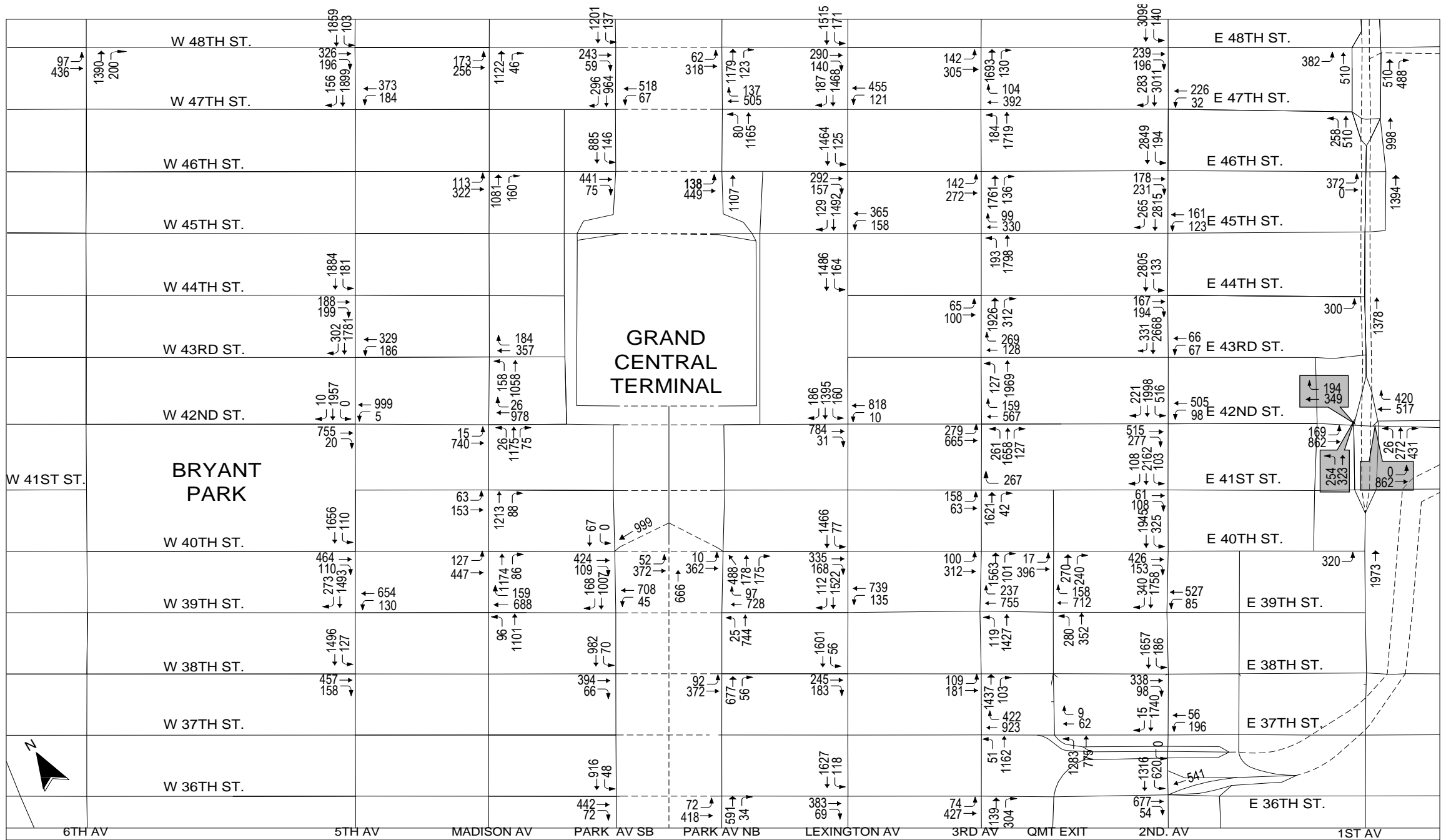

Greater East Midtown Rezoning
Manhattan, New York

2036 Conceptual Analysis Traffic Volumes
Weekday AM Peak Hour

Figure
1-a



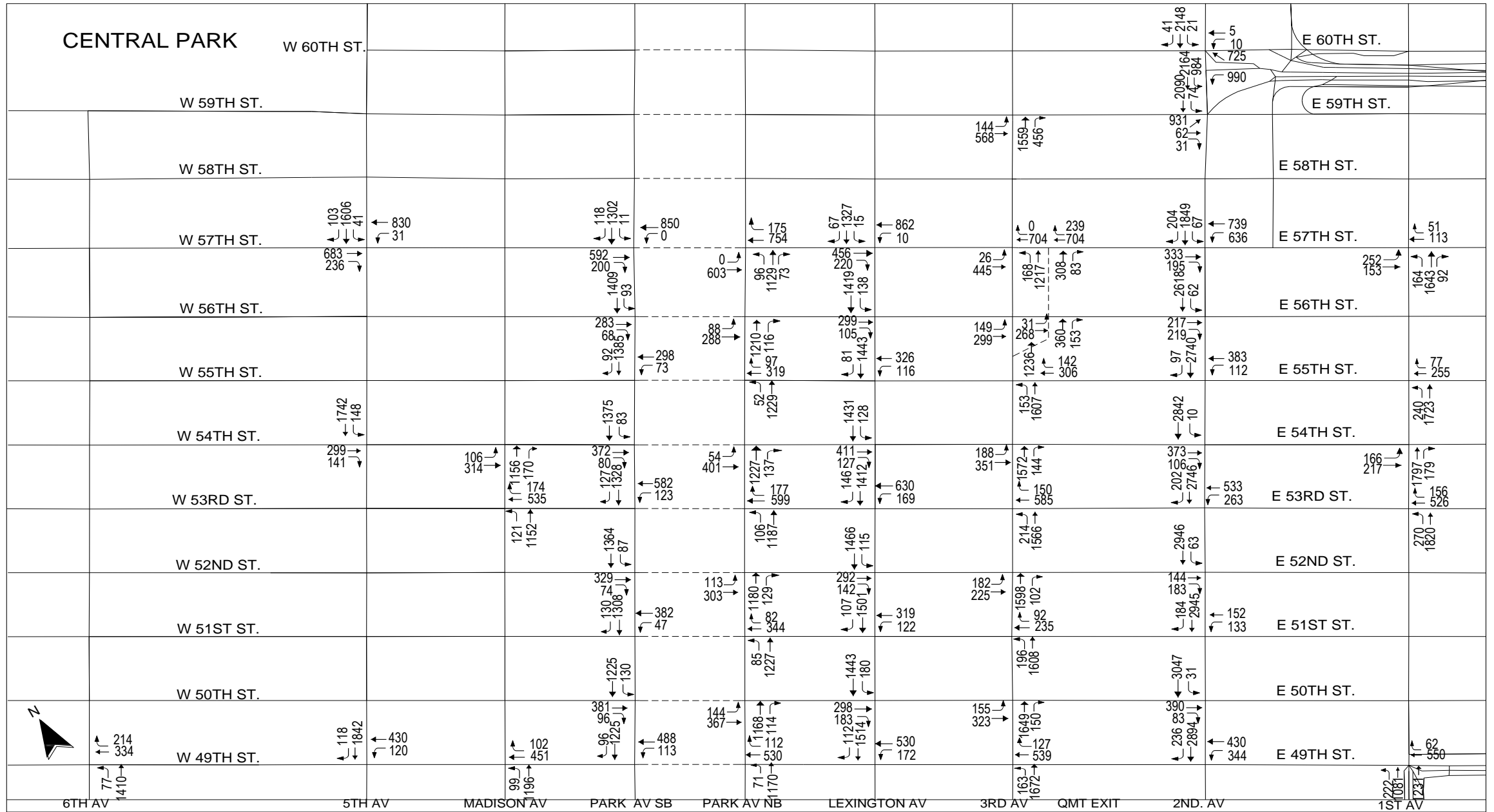

Greater East Midtown Rezoning
 Manhattan, New York

2036 Conceptual Analysis Traffic Volumes
 Weekday AM Peak Hour

Figure
1-b



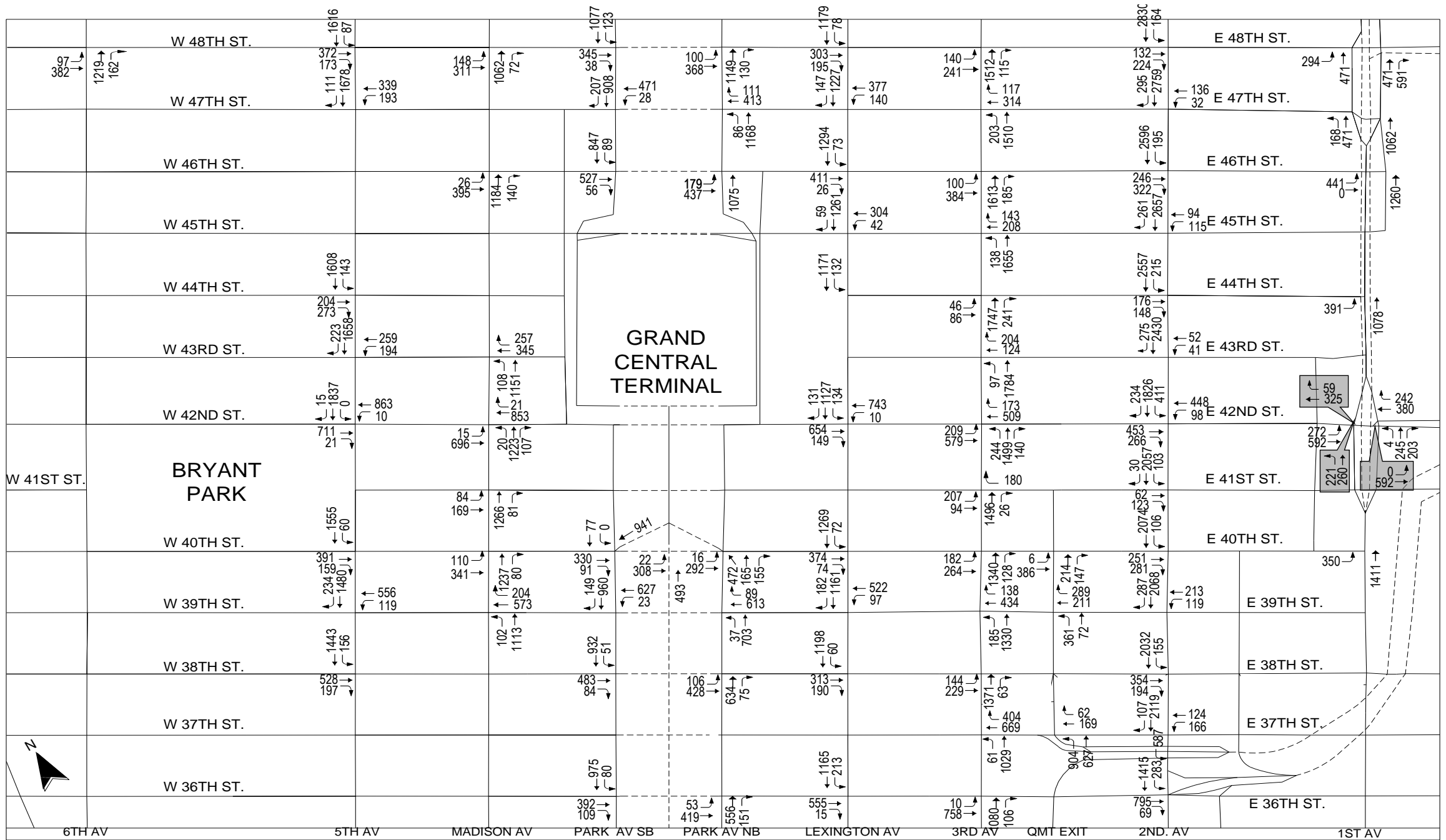

Greater East Midtown Rezoning
 Manhattan, New York

2036 Conceptual Analysis Traffic Volumes
 Weekday Midday Peak Hour

Figure
2-a



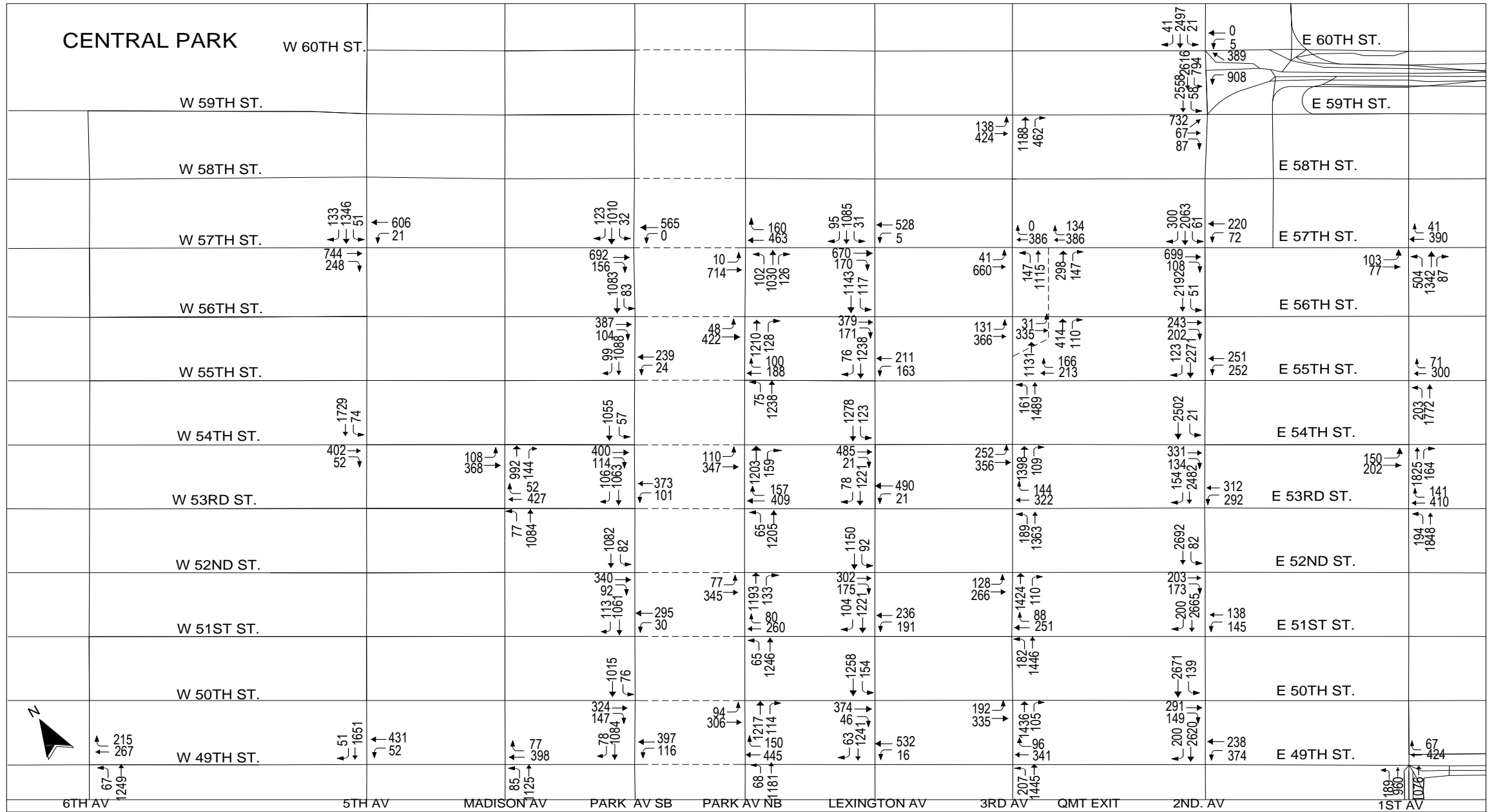

Greater East Midtown Rezoning
 Manhattan, New York

2036 Conceptual Analysis Traffic Volumes
 Weekday Midday Peak Hour

Figure
2-b



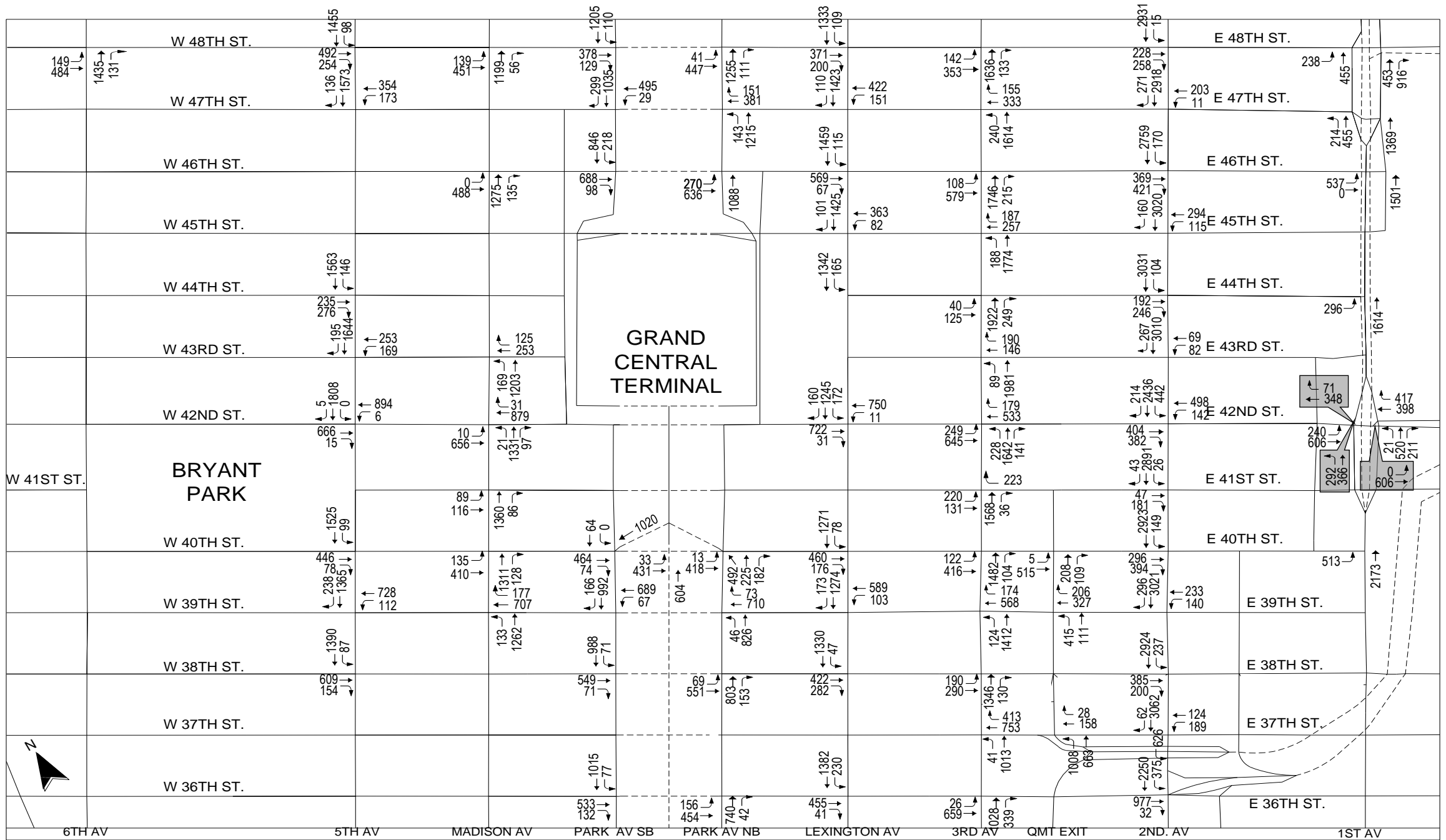

Greater East Midtown Rezoning
Manhattan, New York

2036 Conceptual Analysis Traffic Volumes
Weekday PM Peak Hour

Figure
3-a



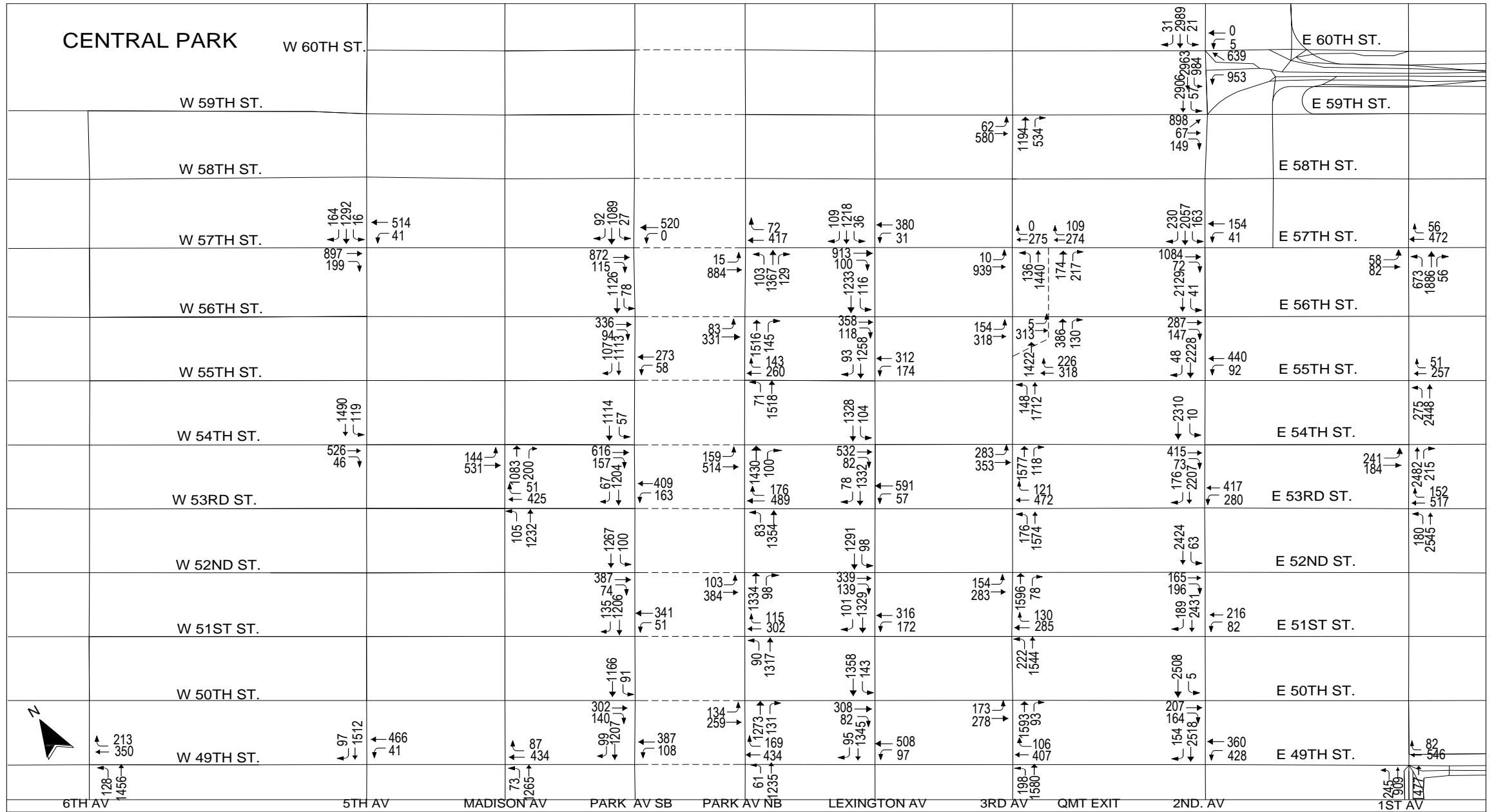

Greater East Midtown Rezoning
 Manhattan, New York

2036 Conceptual Analysis Traffic Volumes
 Weekday PM Peak Hour

Figure
3-b



Appendix J.3

Traffic LOS Tables

THIS APPENDIX HAS BEEN UPDATED FOR THE FEIS



Greater East Midtown Rezoning EIS
 2036 Conceptual Analysis Level of Service Tables

Intersection & Approach (Signalized Intersections)	AM Peak Hour				Midday Peak Hour				PM Peak Hour			
	Movt.	v/c Ratio	Delay (sec)	LOS	Movt.	v/c Ratio	Delay (sec)	LOS	Movt.	v/c Ratio	Delay (sec)	LOS
1st Avenue & East 40th Street												
Eastbound	L	1.15	104.8	F	L	1.03	80.2	F	L	1.37	196.5	F
Northbound	T	1.24	138.1	F	T	0.91	30.7	C	T	1.40	207.3	F
1st Avenue & East 42nd Street												
Eastbound (East Side)	T	1.33	178.9	F	T	0.87	26.8	C	T	0.76	16.6	B
Westbound (East Side)	TR	1.22	143.7	F	TR	0.78	42.2	D	TR	0.83	40.2	D
	R	1.18	155.5	F	R	1.52	295.6	F	R	1.34	212.3	F
Northbound (East Side)	LT	0.68	98.9	F	LT	0.48	21.4	C	LT	1.25	157.9	F
	R	1.66	326.9	F	R	0.49	22.6	C	R	1.37	205.7	F
Eastbound (West Side)	L	0.99	113.4	F	L	1.10	97.1	F	L	1.09	94.2	F
	T	0.81	74.6	E	T	0.51	21.8	C	T	0.49	16.0	B
Westbound (West Side)	TR	1.04	35.3	D	TR	0.71	8.4	A	TR	0.60	5.6	A
Northbound (West Side)	L	0.78	26.7	C	L	0.51	19.5	B	L	1.07	68.8	E
	T	0.75	82.0	F	T	0.50	26.2	C	T	0.93	87.0	F
1st Avenue & East 44th Street												
Eastbound	L	0.83	25.9	C	L	1.07	80.9	F	L	0.68	21.4	C
Northbound	T	0.71	1.8	A	T	0.55	1.1	A	T	0.82	3.1	A
1st Avenue & East 46th Street												
Eastbound	L	0.86	34.0	C	L	1.15	114.2	F	L	1.40	205.4	F
Northbound	T	0.72	2.5	A	T	0.66	2.7	A	T	0.98	61.3	E
1st Avenue & East 47th Street												
Northbound (East Side)	T	0.77	14.2	B	T	0.84	18.7	B	T	1.22	119.4	F
Northbound (West Side)	L	0.73	18.4	B	L	0.49	11.9	B	L	0.59	12.0	B
	T	0.74	17.8	B	T	0.74	16.8	B	T	0.71	16.4	B
1st Avenue & East 48th Street (East Side)												
Northbound	T	0.32	0.4	A	T	0.32	0.3	A	T	0.29	0.2	A
	R	0.71	4.6	A	R	0.92	17.2	B	R	1.41	196.3	F
1st Avenue & East 49th Street												
Westbound (East Side)	T	1.02	69.6	E	T	0.75	30.2	C	T	0.92	46.4	D
	R	0.20	16.9	B	R	0.19	16.8	B	R	0.22	17.1	B
Northbound (East Side)	T	1.01	80.5	F	T	0.94	69.1	E	T	1.25	141.9	F
Westbound (West Side)	T	1.02	23.7	C	T	0.75	7.2	A	T	0.92	14.9	B
Northbound (West Side)	LT	1.04	56.2	E	LT	0.94	31.9	C	LT	1.10	76.7	E
1st Avenue & East 53rd Street												
Westbound	TR	0.80	31.6	C	TR	0.61	25.3	C	TR	0.72	28.2	C
Northbound	L	0.73	34.0	C	L	0.62	27.8	C	L	0.65	29.4	C
	T	0.81	25.4	C	T	0.86	26.7	C	T	1.10	77.6	E
1st Avenue & East 54th Street												
Eastbound	LT	1.12	103.2	F	LT	1.13	107.1	F	LT	1.23	144.7	F
Northbound	T	1.02	64.1	E	TR	0.95	13.0	B	T	1.08	53.5	D
	R	0.79	18.7	B					R	0.82	12.0	B
1st Avenue & East 55th Street												
Westbound	TR	0.83	43.1	D	TR	1.01	74.1	E	TR	0.73	34.7	C
Northbound	L	1.19	118.0	F	L	0.97	40.8	D	L	1.10	65.3	E
	T	1.05	60.8	E	T	0.77	5.5	A	T	1.00	46.6	D
1st Avenue & East 57th Street												
Eastbound	LT	1.20dl	58.3	E	LT	1.06dl	39.5	D	LT	0.58	33.4	C
Westbound	TR	0.39	30.2	C	TR	0.77	40.1	D	TR	0.88	48.3	D
Northbound	L	0.38	21.4	C	L	1.03	65.8	E	L	1.03	67.1	E
	T	1.39	198.6	F	TR	0.82	9.5	A	T	0.90	13.4	B
	R	0.23	9.1	A					R	0.15	7.6	A

Intersection & Approach (Signalized Intersections)	AM Peak Hour				Midday Peak Hour				PM Peak Hour			
	Movt.	v/c Ratio	Delay (sec)	LOS	Movt.	v/c Ratio	Delay (sec)	LOS	Movt.	v/c Ratio	Delay (sec)	LOS
2nd Avenue & East 36th Street												
Eastbound	TR	1.34	182.1	F	TR	0.98	44.1	D	TR	1.75	363.0	F
Southbound	L	1.74	355.2	F	L	0.31	6.6	A	L	0.84	15.3	B
	T	1.20	111.0	F	T	0.80	11.3	B	T	1.13	74.6	E
South-Westbound	L	1.14	116.3	F								
2nd Avenue & East 37th Street												
Westbound	LT	1.00dl	45.4	D	LT	0.40	17.1	B	LT	0.49	19.2	B
Southbound	T	1.28	139.3	F	TR	1.12	67.9	E	T	1.28	138.6	F
	R	0.10	3.3	A					R	0.35	4.5	A
2nd Avenue & East 38th Street												
Eastbound	TR	1.17	125.8	F	TR	0.82	34.6	C	TR	1.14	112.6	F
Southbound	LT	1.32	159.8	F	LT	1.13	68.5	E	LT	1.30	146.9	F
2nd Avenue & East 39th Street												
Westbound	L	0.26	23.8	C	L	0.32	24.5	C	L	0.38	25.8	C
	T	1.01	94.8	F	T	0.40	25.1	C	T	0.44	25.9	C
Southbound	T	1.27	142.6	F	TR	1.24	125.5	F	T	1.28	141.4	F
	R	1.18	103.7	F					R	0.87	20.7	C
2nd Avenue & East 40th Street												
Eastbound	T	0.86	45.3	D	T	0.60	21.8	C	T	1.18	106.3	F
	R	0.60	36.6	D	R	1.06	85.4	F	R	1.41	209.6	F
Southbound	LT	1.16	92.1	F	LT	1.17	96.0	F	LT	1.19	95.1	F
2nd Avenue & East 41st Street												
Eastbound	TR	0.58	46.2	D	TR	0.61	31.1	C	TR	1.02	86.3	F
Southbound	LT	1.30	152.6	F	LT	1.23	118.6	F	LT	1.26	132.8	F
	R	0.78	18.6	B	R	0.17	8.4	A	R	0.21	5.5	A
2nd Avenue & East 42nd Street												
Eastbound	TR	1.38	202.0	F	TR	1.07	76.5	E	TR	1.19	110.6	F
Westbound	LT	2.07dl	162.5	F	LT	1.18dl	116.0	F	LT	2.01dl	192.9	F
Southbound					L	1.40	206.4	F				
	LT	1.21	122.4	F	T	1.16	98.5	F	LT	1.20	108.0	F
	R	0.79	28.3	C	R	1.10	78.9	E	R	0.90	23.8	C
2nd Avenue & East 43rd Street												
Westbound	LT	0.34	25.6	C	LT	0.25	23.4	C	LT	0.38	25.7	C
Southbound	T	1.17	95.0	F	TR	1.53	260.9	F	T	1.17	89.4	F
	R	1.21	117.1	F					R	1.30	156.5	F
2nd Avenue & East 44th Street												
Eastbound	TR	1.10	80.4	F	TR	1.10	75.2	E	TR	1.29	159.0	F
Southbound					L	0.56	8.7	A				
	LT	1.22	116.9	F	T	1.21	111.1	F	LT	1.17	85.2	F
2nd Avenue & East 45th Street												
Westbound	LT	1.00	92.3	F	LT	0.74	44.2	D	LT	1.09	86.8	F
Southbound	T	1.21	111.9	F	TR	1.49	240.6	F	T	1.16	84.6	F
	R	1.25	135.9	F					R	1.07	60.5	E
2nd Avenue & East 46th Street												
Eastbound	TR	0.86dr	37.5	D	T	0.60	32.3	C	TR	1.28dr	86.9	F
					R	1.29	176.5	F				
Southbound					L	0.60	10.9	B				
	LT	1.21	109.2	F	T	1.25	132.4	F	LT	1.15	77.6	E
2nd Avenue & East 47th Street												
Westbound	LT	0.82	64.3	E	LT	0.54	54.9	D	LT	0.62	26.1	C
Southbound	T	1.24	123.9	F	TR	1.55	266.3	F	T	1.18	90.8	F
	R	1.11	71.8	E					R	1.26	134.1	F

Intersection & Approach (Signalized Intersections)	AM Peak Hour				Midday Peak Hour				PM Peak Hour			
	Movt.	v/c Ratio	Delay (sec)	LOS	Movt.	v/c Ratio	Delay (sec)	LOS	Movt.	v/c Ratio	Delay (sec)	LOS
2nd Avenue & East 48th Street												
Eastbound	TR	1.12	100.6	F	TR	1.15	113.5	F	TR	1.23	147.2	F
Southbound	L	0.49	11.0	B	L	1.34	175.5	F				
	T	1.55	269.3	F	T	1.39	196.9	F	LT	1.12	70.3	E
2nd Avenue & East 49th Street												
Westbound	L	0.89	92.6	F	L	1.07	99.8	F	L	1.22	135.4	F
	T	0.40	23.5	C	T	0.23	20.1	C	T	0.40	18.4	B
Southbound	T	1.34	170.9	F	TR	1.22	118.0	F	T	0.95	48.4	D
	R	1.07	60.5	E					R	0.55	2.4	A
2nd Avenue & East 50th Street												
Eastbound	TR	1.22	148.0	F	TR	1.36	206.9	F	TR	1.17	116.6	F
Southbound	L	0.09	8.0	A	L	0.60	11.2	B				
	T	1.62	300.4	F	T	1.38	193.3	F	LT	1.16	83.8	F
2nd Avenue & East 51st Street												
Westbound	LT	1.40	235.1	F	LT	0.74	38.9	D	LT	0.73	38.0	D
Southbound	T	1.62	299.3	F	TR	1.40	196.4	F	T	1.12	64.2	E
	R	0.97	31.5	C					R	1.02	38.6	D
2nd Avenue & East 52nd Street												
Eastbound	TR	0.85	40.6	D	TR	0.94	46.5	D	TR	0.92	51.9	D
Southbound	L	0.16	7.2	A	L	0.18	7.3	A	L	0.22	2.0	A
	T	1.56	270.2	F	T	1.38	190.1	F	T	1.35	173.0	F
2nd Avenue & East 53rd Street												
Westbound	LT	1.09	84.8	F	LT	1.15dl	87.5	F	LT	0.98	65.6	E
Southbound	T	1.54	262.2	F	TR	1.38	193.5	F	T	1.45	220.7	F
	R	0.70	20.2	C					R	0.69	12.1	B
2nd Avenue & East 54th Street												
Eastbound	TR	0.63	27.8	C	TR	0.61	25.0	C	TR	0.57	31.6	C
Southbound	L	0.02	8.2	A	L	0.06	8.1	A	L	0.05	1.1	A
	T	1.65	312.3	F	T	1.47	232.6	F	T	1.51	244.9	F
2nd Avenue & East 55th Street												
Westbound	L	0.32	17.9	B	L	0.78	24.9	C	L	0.35	27.7	C
	T	0.94	37.5	D	T	1.08	77.4	E	T	1.09	87.6	F
Southbound	T	1.68	325.1	F	TR	1.70	336.1	F	T	1.50	243.6	F
	R	0.44	12.0	B					R	0.26	3.5	A
2nd Avenue & East 56th Street												
Eastbound	T	0.76	31.5	C	T	0.52	11.8	B	T	0.65	27.1	C
	R	0.90	46.8	D	R	0.58	15.8	B	R	0.48	24.3	C
Southbound	L	0.11	2.2	A	L	0.33	4.5	A	L	0.11	1.5	A
	T	1.57	275.6	F	T	1.48	238.3	F	T	1.36	179.0	F
2nd Avenue & East 57th Street												
Eastbound	T	0.57	54.2	D	TR	1.20	134.8	F	T	1.24	139.7	F
	R	1.42	258.7	F					R	0.31	23.6	C
Westbound	L	1.21	148.8	F								
	LT	1.15	111.4	F	LT	0.79	37.4	D	LT	0.88dl	23.5	C
Southbound	L	0.52	40.1	D	L	0.22	21.6	C	L	0.60	16.7	B
	T	1.25	147.7	F	TR	1.47	237.0	F	T	1.10	69.5	E
	R	1.10	111.5	F					R	0.82	26.2	C
2nd Avenue & East 59th Street												
Eastbound	L	1.15	91.1	F	L	1.16	102.5	F	L	1.42	213.4	F
	TR	0.40	271.7	F	TR	0.51	339.2	F	TR	0.76	298.5	F
Southbound	L	1.08	66.4	E	L	1.09	63.9	E	L	1.10	62.6	E
	LT	1.35	180.3	F	LT	1.20	108.2	F	LT	1.17	92.1	F

Intersection & Approach (Signalized Intersections)	AM Peak Hour				Midday Peak Hour				PM Peak Hour			
	Movt.	v/c Ratio	Delay (sec)	LOS	Movt.	v/c Ratio	Delay (sec)	LOS	Movt.	v/c Ratio	Delay (sec)	LOS
2nd Avenue & East 60th Street												
Westbound	LT	0.02	14.2	B	LT	0.01	14.2	B	LT	0.02	14.2	B
Southbound	L	0.05	14.6	B					L	0.07	14.9	B
	T	1.07	81.7	F	LTR	1.13	91.0	F	T	1.11	82.8	F
	R	0.14	16.0	B					R	0.12	15.7	B
Westbound (Bridge Exit)	L	1.42	222.7	F	L	1.30	168.6	F	L	1.18	119.1	F
	T	1.27	159.7	F	T	0.70	29.5	C	T	1.02	69.4	E
Tunnel Exit Street & East 37th Street												
Westbound	TR	0.18	9.1	A	TR	0.62	44.3	D	TR	0.51	48.7	D
North-Westbound	L	0.34	0.2	A	L	0.22	0.1	A	L	0.25	0.1	A
	R	0.74	23.6	C	R	0.52	12.1	B	R	0.52	12.1	B
Tunnel Exit Street & East 39th Street												
Westbound	TR	0.91	74.6	E	TR	0.93dr	33.8	C	TR	0.64	28.6	C
Northbound					L	1.13	122.4	F				
	LT	0.36	11.0	B	T	0.13	19.9	B	LT	1.17dl	13.7	B
Tunnel Exit Street & East 40th Street												
Eastbound	LT	1.07	93.8	F	LT	0.96	81.9	F	LT	1.31	160.9	F
Northbound	TR	0.27	13.0	B	TR	0.24	7.0	A	TR	0.24	12.1	B
3rd Avenue & East 36th Street												
Eastbound	LT	1.21	131.3	F	LT	0.71	22.5	C	LT	1.69	335.7	F
Northbound	TR	0.88	54.7	D	TR	1.00	81.8	F	TR	0.58	20.0	C
	R	1.12	136.7	F	R	0.57	45.9	D	R	1.18	156.7	F
3rd Avenue & East 37th Street												
Westbound	TR	0.70	18.3	B	TR	0.59	16.7	B	TR	0.58	16.6	B
	R	1.08	129.5	F	R	0.94	90.6	F	R	1.12	138.7	F
Northbound	LT	1.05	65.6	E	LT	1.02	60.8	E	LT	0.62	6.0	A
3rd Avenue & East 38th Street												
Eastbound	LT	0.36	31.9	C	LT	0.47	31.9	C	LT	0.77	39.1	D
Northbound	T	1.06	64.5	E	T	1.08	71.3	E	T	0.72	12.5	B
	R	0.61	12.6	B	R	0.43	13.1	B	R	0.46	11.8	B
3rd Avenue & East 39th Street												
Westbound	T	1.78	376.2	F	T	1.55	278.8	F	T	1.28	168.0	F
	R	1.27	167.4	F	R	0.87	44.9	D	R	0.57	33.6	C
Northbound	LT	1.34	175.4	F	LT	1.28	145.8	F	LT	1.12	78.9	E
3rd Avenue & East 40th Street												
Eastbound	LT	1.03	87.0	F	LT	1.03	104.1	F	LT	1.61	318.2	F
Northbound	T	1.25	133.9	F	T	1.22	117.4	F	T	1.22	121.9	F
	R	0.76	101.4	F	R	0.96	62.3	E	R	1.11	86.1	F
3rd Avenue & East 41st Street												
Eastbound					L	1.14	142.1	F				
	LT	0.78	69.5	E	T	0.32	40.5	D	LT	1.15	111.8	F
Westbound	R	1.08	116.4	F	R	1.12	131.1	F	R	0.89	71.6	E
Northbound	T	1.19	105.9	F	T	1.00	61.9	E	T	1.16	95.3	F
	R	0.34	12.9	B	R	0.31	14.2	B	R	0.31	14.1	B
3rd Avenue & East 42nd Street												
Eastbound	L	1.14	104.8	F	L	1.02	83.0	F	L	1.15	113.9	F
	T	1.12	81.3	F	T	1.17	118.2	F	T	1.08	77.9	E
Westbound	T	0.92	42.4	D	T	0.86	34.3	C	T	0.97	38.5	D
	R	1.29	171.8	F	R	1.25	149.0	F	R	1.28	160.9	F
Northbound	LT	1.28	152.5	F	LT	1.19	114.8	F	LT	1.12	85.4	F
	R	0.54	23.8	C	R	0.87	37.2	D	R	1.18	120.2	F
3rd Avenue & East 43rd Street												
Westbound	TR	0.61	19.5	B	TR	0.92	24.7	C	TR	0.84	20.9	C
	R	0.67	21.3	C								
Northbound	LT	1.13	74.1	E	LT	1.12	70.8	E	LT	1.09	65.0	E

Intersection & Approach (Signalized Intersections)	AM Peak Hour				Midday Peak Hour				PM Peak Hour			
	Movt.	v/c Ratio	Delay (sec)	LOS	Movt.	v/c Ratio	Delay (sec)	LOS	Movt.	v/c Ratio	Delay (sec)	LOS
3rd Avenue & East 44th Street												
Eastbound	LT	0.35	27.6	C	LT	0.29	27.1	C	LT	0.32	27.4	C
Northbound	T	1.06	64.1	E	T	1.11	68.7	E	T	1.23	118.3	F
	R	3.01	921.4	F	R	2.27	590.3	F	R	5.82	2183.0	F
3rd Avenue & East 45th Street												
Westbound	T	1.15	104.5	F	T	0.59	17.6	B	T	0.69	15.2	B
	R	0.82	57.7	E	R	0.70	36.5	D	R	0.88	45.4	D
Northbound	LT	1.16	94.0	F	LT	1.22	123.6	F	LT	1.20	105.0	F
3rd Avenue & East 46th Street												
Eastbound	L	0.65	40.3	D	L	0.39	28.1	C	L	0.40	41.9	D
	T	0.38	11.6	B	T	0.52	10.0	B	T	0.77	31.7	C
Northbound	T	1.08	68.5	E	T	1.17	104.3	F	T	1.23	116.5	F
	R	0.61	20.1	C	R	1.43	219.3	F	R	1.08	59.1	E
3rd Avenue & East 47th Street												
Westbound	T	1.35	187.0	F	T	1.16	102.0	F	T	1.09	80.7	F
	R	0.59	18.3	B	R	0.73	22.7	C	R	0.71	27.8	C
Northbound	LT	1.24	129.6	F	LT	1.24	127.7	F	LT	1.24	131.2	F
3rd Avenue & East 48th Street												
Eastbound	L	0.29	19.8	B	L	0.31	22.5	C	L	0.33	23.1	C
	T	0.54	23.9	C	T	0.42	24.0	C	T	0.54	25.2	C
Northbound	T	1.07	67.0	E	T	1.20	115.9	F	T	1.20	113.9	F
	R	0.76	23.7	C	R	1.04	62.9	E	R	1.24	142.8	F
3rd Avenue & East 49th Street												
Westbound	T	1.12	96.7	F	T	0.53	18.3	B	T	0.65	24.4	C
	R	0.57	42.3	D	R	0.45	39.9	D	R	0.57	49.2	D
Northbound	LT	1.15	89.5	F	LT	1.24	134.8	F	LT	1.26	143.8	F
3rd Avenue & East 50th Street												
Eastbound	L	0.28	12.9	B	L	0.42	7.6	A	L	0.85	44.1	D
	T	0.49	13.9	B	T	0.53	9.1	A	T	0.85	38.8	D
Northbound	T	1.19	109.5	F	T	1.23	124.2	F	T	1.18	104.6	F
	R	1.10	81.9	F	R	1.12	93.6	F	R	0.65	22.2	C
3rd Avenue & East 51st Street												
Westbound	T	0.78	24.3	C	T	0.82	25.7	C	T	1.16	117.2	F
	R	0.39	17.1	B	R	0.40	17.4	B	R	0.71	31.8	C
Northbound	LT	1.24	129.5	F	LT	1.19	112.8	F	LT	1.19	113.5	F
3rd Avenue & East 52nd Street												
Eastbound	LT	0.79	26.1	C	LT	0.86	18.9	B	LT	0.96	53.1	D
Northbound	T	1.18	104.4	F	T	1.15	90.5	F	T	1.20	110.9	F
	R	1.17	109.3	F	R	1.18	113.1	F	R	1.17	117.1	F
3rd Avenue & East 53rd Street												
Westbound	T	1.17	114.8	F	T	0.62	11.5	B	T	1.07	69.4	E
	R	1.02	119.9	F	R	0.75	32.5	C	R	0.84	112.4	F
Northbound	LT	1.15	93.3	F	LT	1.13	90.2	F	LT	1.22	127.6	F
3rd Avenue & East 54th Street												
Eastbound	L	0.97	65.3	E	L	1.27	159.7	F	L	1.07	102.9	F
	T	0.59	19.8	B	T	0.70	20.5	C	T	0.77	40.4	D
Northbound	T	1.11	84.0	F	T	1.11	80.5	F	T	1.16	103.8	F
	R	0.80	35.5	D	R	0.73	32.3	C	R	0.87	38.6	D
3rd Avenue & East 55th Street												
Westbound	T	1.08	81.2	F	T	0.91	26.8	C	T	1.24	144.5	F
	R	0.99	74.9	E	R	1.08	70.4	E	R	1.15	127.6	F
Northbound	LT	1.26	138.0	F	LT	1.27	144.0	F	LT	1.31	161.1	F

Intersection & Approach (Signalized Intersections)	AM Peak Hour				Midday Peak Hour				PM Peak Hour			
	Movt.	v/c Ratio	Delay (sec)	LOS	Movt.	v/c Ratio	Delay (sec)	LOS	Movt.	v/c Ratio	Delay (sec)	LOS
3rd Avenue & East 56th Street												
Eastbound (West Side)	LT	0.87	52.2	D	LT	0.98	106.5	F	LT	1.13	97.3	F
Northbound (West Side)	T	1.23	125.5	F	T	1.20	113.4	F	T	1.38	192.8	F
Eastbound (East Side)	LT	0.98	44.0	D	LT	0.91	23.7	C	LT	0.65	4.0	A
Northbound (East Side)	TR	0.58	14.4	B	TR	1.09	74.9	E	TR	1.25	135.0	F
3rd Avenue & East 57th Street												
Eastbound (West Side)	LT	1.11	113.7	F	LT	1.09	108.8	F	LT	1.37	209.8	F
Westbound (West Side)	TR	0.97	27.5	C	TR	0.89	30.0	C	TR	0.83	23.7	C
Northbound (West Side)	LT	1.08	64.6	E	LT	1.26	137.6	F	LT	1.26	137.8	F
Eastbound (East Side)	T	0.67	12.5	B	T	1.25	133.9	F	T	1.17	97.3	F
Westbound (East Side)	T	0.93	64.0	E	T	0.77	31.1	C	T	0.86	55.6	E
	R	0.77	20.4	C	R	0.58	25.9	C	R	0.75	54.7	D
Northbound (East Side)	TR	0.83	41.8	D	TR	1.08	68.5	E	TR	1.17	98.4	F
	R	0.33	26.4	C	R	1.11	87.7	F	R	1.16	97.5	F
3rd Avenue & East 59th Street												
Eastbound	LT	0.98	54.6	D	LT	1.08	90.9	F	LT	0.78	30.1	C
Northbound	T	0.75	9.7	A	T	0.69	8.6	A	T	0.60	5.8	A
	R	1.18	120.1	F	R	1.05	73.6	E	R	1.54	276.6	F
Lexington Avenue & East 36th Street												
Eastbound	TR	0.69	56.3	E	TR	0.75	48.8	D	TR	1.35	207.9	F
Southbound	LT	1.14	77.2	E	LT	1.09	61.9	E	LT	1.15	85.8	F
Lexington Avenue & East 38th Street												
Eastbound	T	0.48	39.1	D	T	0.66	45.3	D	T	0.80	47.0	D
	R	1.01	119.9	F	R	1.14	153.9	F	R	1.60	322.6	F
Southbound	L	0.16	1.2	A	L	0.17	1.8	A	L	0.13	1.0	A
	T	1.14	73.2	E	T	0.92	20.2	C	T	0.58	1.7	A
Lexington Avenue & East 39th Street												
Westbound	L	1.20	130.8	F	L	1.11	99.1	F	L	0.83	38.8	D
	T	2.00	468.9	F	T	1.66	321.2	F	T	1.52	260.7	F
Southbound	T	1.14	82.4	F	T	1.09	64.3	E	TR	1.08	59.4	E
	R	0.98	42.5	D	R	0.89	24.7	C				
Lexington Avenue & East 40th Street												
Eastbound	T	1.09	72.4	E	T	0.77	21.6	C	T	0.85	32.2	C
	R	1.10	89.5	F	R	0.54	34.8	C	R	1.27	163.0	F
Southbound	LT	1.25	131.6	F	LT	1.17	97.9	F	LT	0.92	56.8	E
Lexington Avenue & East 42nd Street												
Eastbound	T	0.96	38.3	D	T	1.10	77.9	E	T	1.22	130.1	F
	R	0.31	12.2	B	R	0.91	43.3	D	R	0.28	24.3	C
Westbound	LT	1.11	74.2	E	LT	0.96	51.8	D	LT	1.68	336.2	F
Southbound	L	0.70	21.1	C	L	0.50	22.8	C	L	1.12	93.7	F
	T	1.16	96.9	F	T	0.95	72.2	E	T	1.06	71.7	E
	R	1.28	156.6	F	R	0.70	27.0	C	R	1.34	183.2	F
Lexington Avenue & East 44th Street												
Southbound	LT	1.23	122.2	F	LT	1.21	111.8	F	LT	1.24	129.2	F
Lexington Avenue & East 45th Street												
Westbound	L	0.70	28.2	C								
	T	0.87	31.0	C	LT	0.91	49.0	D	LT	1.08	84.9	F
Southbound	T	1.10	64.2	E	T	1.08	62.7	E	T	1.09	63.2	E
	R	0.89	26.0	C	R	0.17	7.9	A	R	0.41	11.4	B
Lexington Avenue & East 46th Street												
Eastbound	T	0.74	58.8	E	T	1.00	69.1	E	T	1.33	180.4	F
	R	0.69	60.3	E	R	0.15	45.6	D	R	0.30	27.9	C
Southbound	LT	1.16	87.1	F	LT	1.12	69.4	E	LT	1.18	94.9	F

Intersection & Approach (Signalized Intersections)	AM Peak Hour				Midday Peak Hour				PM Peak Hour			
	Movt.	v/c Ratio	Delay (sec)	LOS	Movt.	v/c Ratio	Delay (sec)	LOS	Movt.	v/c Ratio	Delay (sec)	LOS
Lexington Avenue & East 47th Street												
Westbound	L	0.85	39.6	D	L	1.21	134.9	F	L	1.18	127.7	F
	T	0.87	19.5	B	T	1.35	184.0	F	T	1.29	160.4	F
Southbound	T	1.10	66.7	E	T	1.09	67.1	E	T	1.19	105.0	F
	R	1.32	170.3	F	R	1.79	377.4	F	R	1.19	115.6	F
Lexington Avenue & East 48th Street												
Eastbound	T	0.76	37.4	D	T	1.22	144.3	F	T	1.18	124.2	F
	R	1.07	119.6	F	R	1.21	153.5	F	R	1.24	165.2	F
Southbound	LT	1.21	116.3	F	LT	1.03	59.9	E	LT	1.11	71.2	E
Lexington Avenue & East 49th Street												
Westbound	L	0.56	34.8	C								
	T	0.51	30.6	C	LT	0.62	30.9	C	LT	0.75	38.4	D
Southbound	T	1.09	62.6	E	T	1.13	77.9	E	T	1.04	65.5	E
	R	0.77	20.4	C	R	0.41	13.6	B	R	0.40	13.9	B
Lexington Avenue & East 50th Street												
Eastbound	TR	1.07	71.9	E	TR	0.44	27.2	C	TR	0.39	24.8	C
Southbound	LT	1.34	173.6	F	LT	1.14	82.2	F	LT	1.23	119.6	F
Lexington Avenue & East 51st Street												
Westbound	L	0.67	45.1	D	L	1.08	100.1	F	L	1.03	71.7	E
	T	0.53	21.6	C	T	0.94	49.6	D	T	1.02	54.0	D
Southbound	T	1.11	70.5	E	T	1.20	112.6	F	T	1.00	59.9	E
	R	0.66	15.1	B	R	1.21	143.1	F	R	0.60	14.6	B
Lexington Avenue & East 52nd Street												
Eastbound	T	0.60	20.9	C	T	1.01	58.1	E	T	0.65	26.3	C
	R	0.83	53.8	D	R	0.99	74.1	E	R	0.97	57.1	E
Southbound	LT	1.26	137.7	F	LT	0.98	62.6	E	LT	1.11	77.9	E
Lexington Avenue & East 53rd Street												
Westbound	L	0.57	16.2	B	L	0.07	21.2	C	L	0.20	16.7	B
	T	1.22	123.5	F	T	0.87	40.2	D	T	0.96	45.2	D
Southbound	T	1.32	164.7	F	T	1.11	67.8	E	T	0.86	34.7	C
	R	0.97	85.8	F	R	0.80	94.5	F	R	0.53	21.0	C
Lexington Avenue & East 54th Street												
Eastbound	T	1.03	52.6	D	TR	1.07	72.1	E	TR	0.94	33.5	C
	R	0.49	12.3	B								
Southbound	LT	1.14	79.2	E	LT	1.16	88.1	F	LT	1.12	72.9	E
Lexington Avenue & East 55th Street												
Westbound	L	0.81	36.6	D	L	1.05	72.9	E	L	0.95	45.0	D
	T	0.64	16.1	B	T	0.88	30.5	C	T	0.86	23.4	C
Southbound	T	1.23	124.8	F	T	1.10	65.6	E	T	0.95	59.8	E
	R	0.36	12.3	B	R	0.62	16.4	B	R	0.56	12.5	B
Lexington Avenue & East 56th Street												
Eastbound	T	0.56	16.3	B	T	0.66	17.4	B	T	0.81	17.4	B
	R	0.77	55.0	D	R	1.09	84.9	F	R	0.93	44.9	D
Southbound	LT	1.25	139.1	F	LT	1.08	76.8	E	LT	1.08	74.8	E
Lexington Avenue & East 57th Street												
Eastbound	T	0.93	28.4	C	T	0.86	24.9	C	T	1.44	224.8	F
	R	0.84	91.1	F	R	0.68	20.6	C	R	0.62	37.2	D
Westbound	LT	0.97	53.2	D	LT	0.96	45.8	D	LT	1.56dl	95.8	F
Southbound	LT	1.20	125.4	F	LT	1.03	88.3	F	LT	1.06	85.3	F
	R	0.23	16.6	B	R	0.38	21.7	C	R	0.37	20.6	C
Park Avenue & East 36th Street												
Eastbound (West Side)	TR	0.61	25.5	C	TR	0.65	26.5	C	TR	1.04	97.0	F
Southbound (West Side)	LT	0.81	14.1	B	LT	0.78	9.9	A	LT	0.82	12.3	B
Eastbound (East Side)	LT	0.57	10.5	B	LT	0.55	9.8	A	LT	0.72	40.1	D
Northbound (East Side)	TR	0.50	16.5	B	TR	0.66	19.7	B	TR	0.60	18.3	B

Intersection & Approach (Signalized Intersections)	AM Peak Hour				Midday Peak Hour				PM Peak Hour			
	Movt.	v/c Ratio	Delay (sec)	LOS	Movt.	v/c Ratio	Delay (sec)	LOS	Movt.	v/c Ratio	Delay (sec)	LOS
Park Avenue & East 38th Street												
Eastbound (West Side)	TR	0.63	25.9	C	TR	0.65	26.4	C	TR	1.07	84.6	F
Southbound (West Side)	LT	0.95	28.5	C	LT	0.74	10.5	B	LT	0.75	6.3	A
Eastbound (East Side)	L	0.35	9.1	A	L	0.25	8.3	A	L	0.24	7.9	A
	T	0.37	7.3	A	T	0.44	7.8	A	T	0.52	11.1	B
Northbound (East Side)	TR	0.74	12.4	B	TR	0.76	19.0	B	TR	0.94	65.1	E
Park Avenue & East 39th Street												
Westbound (East Side)	TR	1.72	345.8	F	TR	1.46	230.4	F	TR	1.42	216.3	F
Northbound (East Side)	LT	0.65	74.2	E	LT	0.57	41.5	D	LT	0.98	79.2	E
Westbound (West Side)	LT	1.55	272.9	F	LT	1.16	98.6	F	LT	1.24	129.9	F
Southbound (West Side)	T	0.72	69.0	E	T	0.64	64.3	E	T	0.88	67.4	E
	R	1.18	111.9	F	R	0.53	19.1	B	R	1.31	166.8	F
Park Avenue & East 40th Street												
Eastbound (West Side)	TR	1.26	167.3	F	TR	1.31	187.3	F	TR	1.49	260.5	F
Southbound (West Side)	T	1.17	113.0	F	T	1.20	124.9	F	T	1.28	159.7	F
Eastbound (Tunnel Exit)	LT	1.36	191.8	F	LT	1.45	225.5	F	LT	1.74	354.1	F
Northbound (Tunnel Exit)	T	0.83	16.4	B	T	0.73	17.5	B	T	0.89	21.7	C
Eastbound (East Side)	LT	1.45	226.6	F	LT	1.36	182.3	F	LT	1.60	287.6	F
Northbound (East Side)	TR	1.08	78.8	E	TR	0.83	31.2	C	TR	1.11	74.1	E
Park Avenue & East 46th Street												
Eastbound (West Side)	T	0.39	25.6	C	T	0.94	62.2	E	T	1.25	144.6	F
	R	0.30	27.9	C	R	0.33	29.7	C	R	0.40	24.1	C
Southbound (West Side)	L	0.47	27.6	C	L	0.32	16.3	B	L	0.77	76.9	E
	T	1.11	73.7	E	T	1.15	88.1	F	T	1.24	126.0	F
Eastbound (East Side)	L	0.57	24.0	C	L	0.97	59.6	E	L	0.95	23.8	C
	T	0.86	32.4	C	T	1.27	153.7	F	T	1.35	173.9	F
Northbound (East Side)	T	0.81	27.8	C	T	0.86	34.9	C	T	0.92	56.8	E
Park Avenue & East 47th Street												
Westbound (East Side)	T	1.02	43.4	D	T	1.52	259.7	F	T	1.10	68.6	E
	R	0.50	16.3	B	R	0.91	39.8	D	R	0.81	19.4	B
Northbound (East Side)	L	0.12	241.3	F	L	0.16	95.0	F	L	0.27	98.3	F
	T	0.91	30.6	C	T	1.03	65.5	E	T	1.09	65.5	E
Westbound (West Side)	LT	1.10	71.4	E	LT	1.56	271.0	F	LT	1.13	90.4	F
Southbound (West Side)	TR	1.03	61.3	E	TR	1.01	58.5	E	TR	1.13	82.9	F
Park Avenue & East 48th Street												
Eastbound (West Side)	T	0.61	22.5	C	T	0.62	21.6	C	T	0.66	36.4	D
	R	0.27	15.3	B	R	0.28	18.6	B	R	0.45	32.5	C
Southbound (West Side)	L	0.41	119.1	F	L	0.27	100.9	F	L	0.24	94.3	F
	T	1.21	108.3	F	T	1.16	95.1	F	T	1.06	62.2	E
Eastbound (East Side)	LT	0.87	35.3	D	LT	0.96	43.4	D	LT	1.03	61.1	E
Northbound (East Side)	TR	1.01	53.0	D	TR	0.97	42.2	D	TR	1.08	64.4	E
Park Avenue & East 49th Street												
Westbound (East Side)	T	1.10	89.2	F	T	0.91	34.0	C	T	1.03	84.6	F
	R	0.73	37.7	D	R	0.48	11.2	B	R	0.64	15.9	B
Northbound (East Side)	L	0.22	16.1	B	L	0.21	15.5	B	L	0.19	110.0	F
	T	1.00	61.2	E	T	1.04	63.3	E	T	1.11	65.1	E
Westbound (West Side)	LT	1.20	110.8	F	LT	0.97	33.9	C	LT	1.10	71.4	E
Southbound (West Side)	TR	1.01	68.1	E	TR	0.99	58.3	E	TR	0.99	65.0	E
Park Avenue & East 50th Street												
Eastbound (West Side)	T	0.74	19.4	B	T	0.84	19.7	B	T	0.92	43.0	D
	R	0.33	13.0	B	R	0.75	18.1	B	R	0.65	27.9	C
Southbound (West Side)	L	0.17	82.8	F	L	0.23	13.6	B	L	0.20	16.2	B
	T	0.98	63.4	E	T	1.10	62.2	E	T	1.11	72.8	E
Eastbound (East Side)	LT	0.96	42.3	D	LT	1.09	80.3	F	LT	1.21	128.2	F
Northbound (East Side)	TR	1.02	53.1	D	TR	0.91	42.7	D	TR	0.95	60.6	E

Intersection & Approach (Signalized Intersections)	AM Peak Hour				Midday Peak Hour				PM Peak Hour			
	Movt.	v/c Ratio	Delay (sec)	LOS	Movt.	v/c Ratio	Delay (sec)	LOS	Movt.	v/c Ratio	Delay (sec)	LOS
Park Avenue & East 51st Street												
Westbound (East Side)	T	0.70	25.6	C	T	1.16	115.0	F	T	0.72	28.6	C
	R	0.68	45.2	D	R	0.74	36.7	D	R	0.60	28.4	C
Northbound (East Side)	L	0.14	30.4	C	L	0.21	29.7	C	L	0.17	14.6	B
	T	0.96	40.2	D	T	1.08	65.9	E	T	1.12	73.6	E
Westbound (West Side)	LT	0.87	28.8	C	LT	1.09	71.3	E	LT	0.86	28.3	C
Southbound (West Side)	T	0.84	30.4	C	TR	1.08	61.7	E	TR	0.92	46.4	D
	R	1.34	180.7	F								
Park Avenue & East 52nd Street												
Eastbound (West Side)	TR	0.81	26.3	C	TR	1.02	63.5	E	TR	0.81	26.4	C
Southbound (West Side)	L	0.17	155.1	F	L	0.24	178.3	F	L	0.18	86.8	F
	T	1.18	98.4	F	T	1.03	66.2	E	T	1.07	65.0	E
Eastbound (East Side)	LT	0.86	25.4	C	LT	0.97	38.4	D	LT	1.12	88.9	F
Northbound (East Side)	TR	0.98	36.3	D	TR	1.04	59.2	E	TR	1.11	69.1	E
Park Avenue & East 53rd Street												
Westbound (East Side)	T	1.21	123.4	F	T	0.76	41.4	D	T	0.87	54.0	D
	R	1.10	83.1	F	R	0.64	39.2	D	R	0.54	33.5	C
Northbound (East Side)	L	0.18	17.4	B	L	0.20	17.5	B	L	0.17	27.2	C
	T	0.95	34.5	C	T	1.09	62.6	E	T	1.16	89.4	F
Westbound (West Side)	LT	1.15	81.8	F	LT	1.11	85.7	F	LT	1.06	61.5	E
Southbound (West Side)	TR	1.08	60.6	E	TR	0.97	43.8	D	TR	0.92	37.7	D
Park Avenue & East 54th Street												
Eastbound (West Side)	TR	0.93	34.8	C	TR	0.62	18.5	B	TR	0.85	25.5	C
Southbound (West Side)	L	0.31	12.9	B	L	0.22	10.8	B	L	0.15	12.1	B
	T	1.18	97.5	F	T	1.03	59.2	E	T	1.03	59.2	E
Eastbound (East Side)	L	0.33	10.2	B	L	0.34	10.5	B				
	T	1.01	47.8	D	T	0.65	16.5	B	LT	0.92	22.0	C
Northbound (East Side)	T	0.87	20.8	C	TR	1.02	59.6	E	TR	1.00	60.2	E
	R	0.65	16.6	B								
Park Avenue & East 55th Street												
Westbound (East Side)	TR	0.97	82.1	F	TR	1.11	109.5	F	TR	1.21	147.2	F
Northbound (East Side)	L	0.21	685.0	F	L	0.29	140.9	F	L	0.15	157.9	F
	T	1.09	68.0	E	T	1.15	86.5	F	T	1.16	91.3	F
Westbound (West Side)	LT	0.92	30.0	C	LT	1.06	70.6	E	LT	1.16	100.8	F
Southbound (West Side)	T	1.01	59.0	E	TR	1.10	61.9	E	TR	1.17	95.0	F
	R	0.56	14.1	B								
Park Avenue & East 56th Street												
Eastbound (West Side)	TR	0.72	29.2	C	TR	1.36	191.8	F	TR	1.34	175.8	F
Southbound (West Side)	L	0.14	155.4	F	L	0.18	146.0	F	L	0.17	17.8	B
	T	1.06	65.5	E	T	1.04	65.0	E	T	1.07	70.8	E
Eastbound (East Side)	LT	0.65	15.0	B	LT	1.16	92.8	F	LT	1.15	87.3	F
Northbound (East Side)	TR	1.03	59.0	E	TR	0.96	60.9	E	TR	1.08	62.1	E
Park Avenue & East 57th Street												
Eastbound (West Side)	T	0.74	33.3	C	T	1.20	127.9	F	T	1.38	203.4	F
	R	0.61	31.5	C	R	1.08	97.9	F	R	0.44	29.4	C
Westbound (West Side)	T	1.07	61.7	E	T	1.19	104.3	F	T	0.76	13.4	B
Southbound (West Side)	LTR	0.91	78.9	E	LTR	0.98	88.8	F	LTR	0.77	72.7	E
Eastbound (East Side)	LT	1.17	107.1	F	LT	1.22	118.1	F	LT	1.04	34.9	C
Westbound (East Side)	T	0.76	44.0	D	T	1.17	129.1	F	T	0.52	30.4	C
	R	0.61	40.9	D	R	1.03	97.7	F	R	0.25	26.2	C
Northbound (East Side)	L	0.18	686.1	F	L	0.29	686.0	F	L	0.17	10.1	B
	T	0.98	35.2	D	T	1.07	55.1	E	T	1.15	84.6	F
	R	0.26	11.6	B	R	0.70	21.2	C	R	0.41	9.9	A

Intersection & Approach (Signalized Intersections)	AM Peak Hour				Midday Peak Hour				PM Peak Hour			
	Movt.	v/c Ratio	Delay (sec)	LOS	Movt.	v/c Ratio	Delay (sec)	LOS	Movt.	v/c Ratio	Delay (sec)	LOS
Madison Avenue & East 39th Street												
Westbound	T	1.28	151.1	F	T	1.43	218.9	F	T	1.53	260.7	F
	R	1.24	146.6	F	R	1.46	243.1	F	R	1.24	141.3	F
Northbound	LT	1.11	89.9	F	LT	1.01	86.8	F	LT	1.02	85.3	F
Madison Avenue & East 40th Street												
Eastbound	L	0.97	58.0	E	L	0.73	40.3	D	L	1.20	127.4	F
	T	0.92	29.1	C	T	0.68	22.3	C	T	0.84	15.0	B
Northbound	TR	1.19	103.3	F	TR	1.11	68.1	E	TR	1.14	81.3	F
Madison Avenue & East 41st Street												
Eastbound	L	0.45	50.9	D	L	0.49	49.5	D	L	0.53	51.1	D
	T	0.30	29.4	C	T	0.33	28.5	C	T	0.22	27.5	C
Northbound	TR	1.21	112.6	F	TR	1.20	110.1	F	TR	1.21	114.3	F
Madison Avenue & East 42nd Street												
Eastbound	LT	1.58	288.5	F	LT	1.20	114.9	F	LT	1.23	127.8	F
Westbound	T	1.54	266.2	F	T	1.25	144.7	F	T	1.27	157.9	F
	R	0.31	23.1	C	R	0.23	25.1	C	R	0.18	28.8	C
Northbound	LT	1.24	126.3	F	LT	1.21	116.4	F	LT	1.23	126.0	F
	R	0.56	17.2	B	R	0.75	98.2	F	R	0.43	13.8	B
Madison Avenue & East 43rd Street												
Westbound	T	0.79	38.5	D	T	1.30	185.5	F	T	0.56	29.4	C
	R	0.98	126.5	F	R	1.57	308.2	F	R	0.67	44.5	D
Northbound	L	1.51	257.1	F	L	1.31	169.4	F	L	1.78	374.2	F
	T	1.07	62.3	E	T	1.13	80.1	F	T	1.23	121.0	F
Madison Avenue & East 46th Street												
Eastbound	LT	1.01	81.9	F	LT	0.92	95.6	F	LT	1.10	86.4	F
Northbound	T	1.01	58.9	E	T	1.17	95.9	F	T	1.13	74.8	E
	R	1.06	113.5	F	R	0.79	57.1	E	R	0.88	173.9	F
Madison Avenue & East 48th Street												
Eastbound	L	1.10	114.4	F	L	0.96	80.0	E	L	0.74	26.2	C
	T	0.76	27.7	C	T	0.74	26.0	C	T	0.91	16.0	B
Northbound	T	1.13	77.9	E	T	1.00	68.0	E	T	1.20	110.9	F
	R	0.59	20.3	C	R	0.73	29.3	C	R	0.76	30.8	C
Madison Avenue & East 49th Street												
Westbound	TR	0.62	9.4	A	TR	1.11	79.2	E	TR	1.16	94.0	F
Northbound	L	0.54	12.0	B	L	0.29	10.6	B	L	0.23	11.8	B
	T	1.09	59.7	E	T	1.05	64.3	E	T	1.10	61.3	E
Madison Avenue & East 53rd Street												
Westbound	TR	1.18	109.7	F	TR	0.85	41.6	D	TR	0.95	49.0	D
Northbound	L	0.53	11.8	B	L	0.18	9.9	A	L	0.58	13.0	B
	T	1.02	55.8	E	T	0.98	65.9	E	T	1.12	74.1	E
Madison Avenue & East 54th Street												
Eastbound	LT	0.58	30.8	C	LT	1.16	114.2	F	LT	0.75	32.1	C
Northbound	T	1.04	63.3	E	T	1.15	90.1	F	T	1.02	58.9	E
	R	1.08	70.1	E	R	0.93	42.6	D	R	0.74	18.6	B
5th Avenue & 38th Street												
Eastbound	T	0.44	18.2	B	T	0.58	22.8	C	T	0.52	19.4	B
	R	1.06	126.3	F	R	1.06	120.1	F	R	1.04	120.8	F
Southbound	LT	1.40	194.8	F	LT	1.37	182.3	F	LT	1.26	133.1	F
5th Avenue & 39th Street												
Westbound	L	1.16	121.6	F	L	0.93	60.2	E	L	0.90	61.0	E
	T	0.67	29.7	C	T	1.39	208.1	F	T	0.90	41.0	D
Southbound	T	1.32	171.1	F	T	1.14	93.2	F	T	1.28	147.8	F
	R	1.35	184.0	F	R	1.06	63.3	E	R	1.15	92.2	F

Intersection & Approach (Signalized Intersections)	AM Peak Hour				Midday Peak Hour				PM Peak Hour			
	Movt.	v/c Ratio	Delay (sec)	LOS	Movt.	v/c Ratio	Delay (sec)	LOS	Movt.	v/c Ratio	Delay (sec)	LOS
5th Avenue & 40th Street												
Eastbound	TR	1.58	300.4	F	TR	1.35	203.6	F	TR	1.31	179.1	F
Southbound	LT	1.53	262.7	F	LT	1.10	67.8	E	LT	1.52	254.6	F
5th Avenue & 42nd Street												
Eastbound	T	1.13	104.8	F	T	0.73	28.6	C	T	0.71	27.9	C
	R	0.21	23.8	C	R	0.17	21.9	C	R	0.15	21.5	C
Westbound	LT	1.47	233.9	F	LT	1.38	190.7	F	LT	1.04	58.2	E
Southbound	LT	1.50	247.2	F	LT	1.52	256.6	F	LT	1.50	244.1	F
	R	0.05	13.8	B	R	0.11	14.1	B	R	0.03	2.2	A
5th Avenue & 43rd Street												
Westbound	L	0.65	30.3	C	L	0.89	31.1	C	L	0.74	32.2	C
	T	0.68	25.0	C	T	0.69	13.1	B	T	0.61	27.7	C
Southbound	T	1.26	143.0	F	T	1.19	110.2	F	T	1.37	182.3	F
	R	2.27	592.1	F	R	1.91	432.4	F	R	2.20	561.5	F
5th Avenue & 44th Street												
Eastbound	T	0.42	24.2	C	T	0.43	23.5	C	T	0.46	23.5	C
	R	0.88	106.2	F	R	1.18	144.7	F	R	1.39	229.8	F
Southbound	LT	1.43	214.2	F	LT	1.43	214.2	F	LT	1.55	263.5	F
5th Avenue & 47th Street												
Westbound	L	1.02	105.0	F	L	0.99	70.8	E	L	1.14	106.4	F
	T	0.66	34.3	C	T	0.56	34.7	C	T	1.08	67.4	E
Southbound	T	1.44	219.5	F	T	1.47	235.8	F	T	1.39	193.1	F
	R	0.88	26.6	C	R	1.03	57.8	E	R	1.16	97.1	F
5th Avenue & 48th Street												
Eastbound	T	0.60	17.6	B	T	0.70	20.4	C	T	1.25	147.0	F
	R	1.06	89.3	F	R	0.99	89.3	F	R	1.24	156.8	F
Southbound	LT	1.44	220.9	F	LT	1.32	167.6	F	LT	1.33	164.9	F
5th Avenue & 49th Street												
Westbound	LT	0.58	27.9	C	LT	0.52	23.3	C	LT	1.11	95.4	F
Southbound	T	1.44	217.5	F	T	1.49	241.3	F	T	1.41	200.2	F
	R	0.63	16.8	B	R	0.37	11.7	B	R	0.72	9.8	A
5th Avenue & 54th Street												
Eastbound	TR	0.53	23.9	C	TR	1.08	97.7	F	TR	0.95	55.5	E
Southbound	LT	1.44	218.1	F	LT	1.41	207.0	F	LT	1.47	229.9	F
5th Avenue & 57th Street												
Eastbound	T	1.13	105.4	F	T	1.19	129.9	F	T	1.42	223.1	F
	R	0.85	144.2	F	R	1.07	126.9	F	R	0.78	48.0	D
Westbound	LT	1.16	120.7	F	LT	0.79	89.4	F	LT	1.66dl	161.1	F
Southbound	LT	1.52	261.2	F	LT	1.06	84.0	F	LT	1.52	264.6	F
	R	0.43	22.3	C	R	0.38	18.5	B	R	0.66	32.7	C
6th Avenue & West 48th Street												
Eastbound	L	0.33	22.5	C	L	0.33	22.7	C	L	0.58	29.8	C
	T	1.19	136.4	F	T	1.08	94.8	F	T	1.07	89.3	F
Northbound	TR	0.90dr	31.8	C	TR	0.77	36.3	D	T	0.72	20.8	C
									R	1.13	148.2	F

Intersection & Approach (Signalized Intersections)	AM Peak Hour				Midday Peak Hour				PM Peak Hour			
	Movt.	v/c Ratio	Delay (sec)	LOS	Movt.	v/c Ratio	Delay (sec)	LOS	Movt.	v/c Ratio	Delay (sec)	LOS
6th Avenue & West 49th Street												
Westbound	T	0.82	36.5	D	T	0.56	23.0	C	T	1.05	78.9	E
	R	0.70	32.4	C	R	0.62	29.8	C	R	0.92	55.1	E
Northbound	LT	1.06	48.9	D	LT	1.07	51.3	D	LT	0.89	13.2	B

Intersection & Approach (Unsignalized Intersections)	AM Peak Hour				Midday Peak Hour				PM Peak Hour			
	Movt.	v/c Ratio	Delay (sec)	LOS	Movt.	v/c Ratio	Delay (sec)	LOS	Movt.	v/c Ratio	Delay (sec)	LOS
1st Avenue & East 48th Street (West Side)												
Eastbound	L	0.92	48.8	E	L	0.61	21.0	C	L	0.52	18.0	C
Northbound	T	0.34	0.0	A	T	0.32	0.0	A	T	0.32	0.0	A

Appendix J.4

Pedestrian LOS Tables (Sidewalks, Corners, Crosswalks)



2036 Conceptual Analysis: Sidewalk Analysis

Location	Sidewalk	Effective Width (ft)	Two-way Peak Hour Volume	PHF	SFP	LOS
Weekday AM Peak Hour						
E 40th Street between 5th Avenue and Madison Avenue	North	9	1,924	0.82	60.1	C
Madison Avenue between E 40th Street and E 41st Street	West	9	2,962	0.90	42.0	C
Weekday Midday Peak Hour						
E 40th Street between 5th Avenue and Madison Avenue	North	9	2,152	0.94	61.1	C
Madison Avenue between E 40th Street and E 41st Street	West	9	4,219	0.91	28.8	D
Weekday PM Peak Hour						
E 40th Street between 5th Avenue and Madison Avenue	North	9	1,992	0.95	67.1	C
Madison Avenue between E 40th Street and E 41st Street	West	9	2,913	0.97	46.1	C

2036 Conceptual Analysis: Corner Analysis

Location	Corner	Weekday AM Peak Hour		Weekday Midday Peak Hour		Weekday PM Peak Hour	
		SFP	LOS	SFP	LOS	SFP	LOS
Madison Avenue and E 40th Street	Northwest	24.1	C	23.7	D	29.5	C

Appendix J.5

Parking Accumulation



Conceptual Analysis - Net Incremental Weekday Hourly Parking Accumulation by Land Use

Time Period	Office	Local Retail	Destination Retail	Hotel	Residential	Total
12 AM - 1 AM	0	0	0	-80	-25	-105
1 AM - 2 AM	0	0	0	-77	-25	-102
2 AM - 3 AM	0	0	0	-77	-25	-102
3 AM - 4 AM	0	0	0	-77	-25	-102
4 AM - 5 AM	0	0	0	-77	-25	-102
5 AM - 6 AM	0	0	0	-77	-25	-102
6 AM - 7 AM	0	0	0	-77	-25	-102
7 AM - 8 AM	59	1	0	-78	-23	-41
8 AM - 9 AM	794	1	1	-90	-18	688
9 AM - 10 AM	1,343	2	2	-99	-15	1,233
10 AM - 11 AM	1,292	3	5	-104	-14	1,182
11 AM - 12 PM	1,270	3	8	-110	-14	1,157
12 PM - 1 PM	1,259	3	10	-103	-14	1,155
1 PM - 2 PM	1,267	3	11	-109	-14	1,158
2 PM - 3 PM	1,297	3	10	-117	-14	1,179
3 PM - 4 PM	1,351	3	10	-126	-15	1,223
4 PM - 5 PM	964	3	9	-133	-17	826
5 PM - 6 PM	125	3	8	-106	-20	9
6 PM - 7 PM	21	3	7	-117	-23	-109
7 PM - 8 PM	7	2	8	-102	-25	-110
8 PM - 9 PM	1	1	6	-93	-26	-111
9 PM - 10 PM	1	1	0	-88	-25	-111
10 PM - 11 PM	1	1	0	-84	-25	-107
11 PM - 12 AM	1	1	0	-80	-25	-103