

---

# Appendix I

## Alternatives

### Appendix I.1

Lesser Density Alternative RWCDs

### Appendix I.2

Lesser Density Alternative Traffic Volume Figures

### Appendix I.3

Lesser Density Alternative Traffic LOS Tables

### Appendix I.4

Lesser Density Alternative Subway LOS Tables

### Appendix I.5

Lesser Density Alternative Pedestrian LOS Tables (Sidewalks, Corners, Crosswalks)

### Appendix I.6

Lesser Density Alternative Parking Accommodation



---

# Appendix I.1

## Lesser Density Alternative RWCDs



Appendix I.1: Lower Density Alternative - Projected Sites

	Site Data				Existing Condition							No Action Scenario											With Action Scenario																																																																																							
	Address	Block	Lot	Lot Area	Building Area gsf	Commercial Area gsf (Office, Retail and Hotel floor area)	Residential Area gsf	Office Area gsf (usable)	Retail Area gsf	Hotel Area gsf	# of Residential Units	Parking sf	Changes	Building Floor Area gsf (including mechanical)*	Commercial Floor Area gsf (Office, Retail and Hotel floor area)	Residential Floor Area gsf	Office Floor Area gsf (usable)	Retail Floor Area gsf	Hotel Floor Area gsf	# of Residential Units	# of hotel rooms, conversion or new construction	Parking sf	Mechanical gsf	Changes	Proposed Maximum FAR	Zoning Square Feet	Building Floor Area gsf (including mechanical)*	Usable Floor Area (gross square feet, excluding mechanical)	Commercial Floor Area gsf (Office, Retail and Hotel floor area)	Residential Floor Area gsf	Office Floor Area gsf (usable)	Retail Floor Area gsf	Hotel Floor Area gsf	# of Residential Units	# of hotel rooms, conversion or new construction	Parking sf	Mechanical gsf	Retail Breakdown Neighborhood retail	Retail Breakdown Destination retail																																																																							
Project Site 1	266 MADISON AVENUE	869	16	14,220	217,317	217,317	205,317	12,000					no change	217,317	217,317		205,317	12,000							Develops as Office Building	18	602,460	692,829	632,583	632,583	599,113	33,470							60,246	33,470																																																																						
	274 MADISON AVENUE	869	58	5,370	91,212	91,212	85,212	6,000					no change	91,212	91,212		85,212	6,000																																																																																												
	278 MADISON AVENUE	869	61	6,480	74,186	74,186	68,186	6,000					no change	74,186	74,186		68,186	6,000																																																																																												
	16 EAST 40 STREET	869	64	7,400	89,423	89,423	83,423	7,000					no change	89,423	89,423		83,423	7,000																																																																																												
	TOTAL			33,470	472,138	472,138	442,138	31,000						472,138	472,138		442,138	31,000																										602,460	692,829	632,583	632,583	599,113	33,470										60,246	33,470																																																		
Project Site 2	7 EAST 40 STREET	1275	8	7,406	79,738	79,738	73,188	6,550					no change	79,738	79,738		73,188	6,550							Develops as Mixed Office/Residential Building	18	651,060	748,719	683,613	546,890	136,723	510,720	36,170																																																																													
	13 EAST 40 STREET	1275	11	2,450	11,951	11,951	11,951						no change	11,951	11,951		11,951																																																																																													
	15 EAST 40 STREET	1275	12	5,100	57,643	57,643	51,292	6,351					no change	57,643	57,643		51,292	6,351																																																																																												
	284 MADISON AVENUE	1275	14	4,735	102,079	102,079	102,079						no change	102,079	102,079		102,079																																																																																													
	290 MADISON AVENUE	1275	16	4,750	36,681	36,681	30,111	6,570					no change	36,681	36,681		30,111	6,570																																																																																												
	292 MADISON AVENUE	1275	59	9,250	170,230	170,230	164,420	5,810					no change	170,230	170,230		164,420	5,810																																																																																												
	22 EAST 41 STREET	1275	60	2,479	7,255	7,255	3,855	3,400					no change	7,255	7,255		3,855	3,400																																																																																												
	TOTAL			36,170	465,577	465,577	436,896	28,681						465,577	465,577		436,896	28,681																															651,060	748,719	683,613	546,890	136,723	510,720	36,170												68					65,106	36,170																																					
Project Site 3	3 EAST 43 STREET	1278	8	5,690	36,616	36,616	36,616						no change	36,616	36,616		36,616								Develops as Office Building	21.6	1,096,178.40	1,260,605	1,150,987	1,150,987	1,100,238	50,749																																																																														
	340 MADISON AVENUE	1278	14	32,500	558,124	558,124	533,524	24,600					no change	558,124	558,124		533,524	24,600																																																																																												
	14 EAST 44 STREET	1278	62	2,513	11,550	11,550	5,400	4,750					Develops as residential building	94,991	7,539	87,452		7,539			44																																																																																									
	12 EAST 44 STREET	1278	63	2,513	17,668	17,668	12,868	4,800					Develops as residential building	94,991	7,539	87,452		7,539			44																																																																																									
	10 EAST 44 STREET	1278	64	2,513	16,629	16,629	13,329	3,300					Develops as residential building	94,991	7,539	87,452		7,539			44																																																																																									
	6 EAST 44 STREET	1278	65	5,020	62,918	62,918				62,918			no change	62,918	62,918					62,918																																																																																										
TOTAL			50,749	703,505	703,505	601,737	37,450		62,918				752,649	665,197	87,452	570,140	32,139	62,918	44							1,096,178.40	1,260,605	1,150,987	1,150,987	1,100,238	50,749																																																																															
Project Site 4	7 EAST 44 STREET	1279	9	8,133	110,999	110,999	104,999	6,000					no change	110,999	110,999		104,999	6,000							Develops as Office Building	21.6	1,071,360	1,232,064	1,124,928	1,124,928	1,075,328	49,600																																																																														
	346 MADISON AVENUE	1279	17	13,125	122,600	122,600	50,325	72,275					no change	122,600	122,600		50,325	72,275																																																																																												
	352 MADISON AVENUE	1279	57	18,800	380,766	380,766	344,482	36,284					no change	380,766	380,766		344,482	36,284																																																																																												
	10 EAST 45 STREET	1279	63	4,522	15,023	15,023		15,023					no change	15,023	15,023			15,023																																																																																												
	6 EAST 45 STREET	1279	65	5,020	79,280	79,280	74,280	5,000					no change	79,280	79,280		74,280	5,000																																																																																												
	TOTAL			49,600	708,668	708,668	574,086	134,582						708,668	708,668		574,086	134,582																																																	1,071,360	1,232,064	1,124,928	1,124,928	1,075,328	49,600																																						
Project Site 5	9 EAST 45 STREET	1281	9	2,513	18,933	18,933	14,833	4,100					no change	18,933	18,933		14,833	4,100							Develops as Office Building	21.6	737,510	848,137	774,386	774,386	740,242	34,144																																																																														
	366 MADISON AVENUE	1281	56	6,025	84,518	84,518	78,589	5,929					no change	84,518	84,518		78,589	5,929																																																																																												
	18 EAST 46 STREET	1281	59	6,025	87,016	87,016	77,716	9,300					no change	87,016	87,016		77,716	9,300																																																																																												
	360 MADISON AVENUE	1281	7501	19,581	323,029	323,029	318,943		4,086				no change	323,029																																																																																																

# Appendix I.1: Lower Density Alternative - Projected Sites

	Site Data				Increment							
	Address	Block	Lot	Lot Area	Building Floor Area gsf (including mechanical)*	Commercial Floor Area gsf (Office, Retail and Hotel floor area)	Residential Floor Area gsf	Office Floor Area gsf (usable)	Retail Floor Area gsf	Hotel Floor Area gsf	# of Residential Units	Parking sf
Projected Site 1	266 MADISON AVENUE	869	16	14,220								
	274 MADISON AVENUE	869	58	5,370								
	278 MADISON AVENUE	869	61	6,480								
	16 EAST 40 STREET	869	64	7,400								
	<b>TOTAL</b>			<b>33,470</b>	<b>220,691</b>	<b>160,445</b>	<b>-</b>	<b>156,975</b>	<b>2,470</b>	<b>-</b>	<b>-</b>	<b>-</b>
Projected Site 2	7 EAST 40 STREET	1275	8	7,406								
	13 EAST 40 STREET	1275	11	2,450								
	15 EAST 40 STREET	1275	12	5,100								
	284 MADISON AVENUE	1275	14	4,735								
	290 MADISON AVENUE	1275	16	4,750								
	292 MADISON AVENUE	1275	59	9,250								
	22 EAST 41 STREET	1275	60	2,479								
<b>TOTAL</b>			<b>36,170</b>	<b>283,142</b>	<b>81,313</b>	<b>136,723</b>	<b>73,824</b>	<b>7,489</b>	<b>-</b>	<b>68</b>	<b>-</b>	
Projected Site 3	3 EAST 43 STREET	1278	8	5,690								
	340 MADISON AVENUE	1278	14	32,500								
	14 EAST 44 STREET	1278	62	2,513								
	12 EAST 44 STREET	1278	63	2,513								
	10 EAST 44 STREET	1278	64	2,513								
	6 EAST 44 STREET	1278	65	5,020								
	<b>TOTAL</b>			<b>50,749</b>	<b>507,956</b>	<b>485,790</b>	<b>(87,452)</b>	<b>530,098</b>	<b>18,610</b>	<b>(62,918)</b>	<b>(44)</b>	<b>-</b>
Projected Site 4	7 EAST 44 STREET	1279	9	8,133								
	346 MADISON AVENUE	1279	17	13,125								
	352 MADISON AVENUE	1279	57	18,800								
	10 EAST 45 STREET	1279	63	4,522								
	6 EAST 45 STREET	1279	65	5,020								
	<b>TOTAL</b>			<b>49,600</b>	<b>523,396</b>	<b>416,260</b>	<b>-</b>	<b>501,242</b>	<b>(84,982)</b>	<b>-</b>	<b>-</b>	<b>-</b>
Projected Site 5	9 EAST 45 STREET	1281	9	2,513								
	366 MADISON AVENUE	1281	56	6,025								
	18 EAST 46 STREET	1281	59	6,025								
	360 MADISON AVENUE	1281	7501	19,581								
	<b>TOTAL</b>			<b>34,144</b>	<b>334,641</b>	<b>260,890</b>	<b>-</b>	<b>250,161</b>	<b>14,815</b>	<b>(4,086)</b>	<b>-</b>	<b>-</b>
Projected Site 6	250 PARK AVENUE	1282	34	24,969								
	<b>TOTAL</b>			<b>24,969</b>	<b>273,231</b>	<b>210,808</b>	<b>-</b>	<b>195,839</b>	<b>14,969</b>	<b>-</b>	<b>-</b>	<b>-</b>
Projected Site 7	300 PARK AVENUE	1285	36	34,050								
	<b>TOTAL</b>			<b>34,050</b>	<b>255,140</b>	<b>176,825</b>	<b>-</b>	<b>174,861</b>	<b>1,964</b>	<b>-</b>	<b>-</b>	<b>-</b>
Projected Site 8	363 LEXINGTON AVENUE	1295	20	10,419								
	355 LEXINGTON AVENUE	1295	23	14,044								
	<b>TOTAL</b>			<b>24,463</b>	<b>162,797</b>	<b>118,764</b>	<b>-</b>	<b>120,301</b>	<b>(1,537)</b>	<b>-</b>	<b>-</b>	<b>-</b>
Projected Site 9	485 LEXINGTON AVENUE	1301	23	46,125								
	<b>TOTAL</b>			<b>46,125</b>	<b>401,956</b>	<b>345,494</b>	<b>-</b>	<b>325,011</b>	<b>20,483</b>	<b>-</b>	<b>-</b>	<b>(43,168)</b>
Projected Site 10	111 EAST 48 STREET	1303	14	41,170								
	<b>TOTAL</b>			<b>41,170</b>	<b>424,608</b>	<b>350,502</b>	<b>-</b>	<b>736,943</b>	<b>41,170</b>	<b>(427,611)</b>	<b>-</b>	<b>-</b>
Projected Site 11	541 LEXINGTON AVENUE	1304	20	24,725								
	<b>TOTAL</b>			<b>24,725</b>	<b>296,673</b>	<b>243,267</b>	<b>-</b>	<b>536,038</b>	<b>22,785</b>	<b>(315,556)</b>	<b>-</b>	<b>-</b>
Projected Site 12	575 LEXINGTON AVENUE	1306	23	32,625								
	<b>TOTAL</b>			<b>32,625</b>	<b>225,976</b>	<b>155,506</b>	<b>-</b>	<b>142,881</b>	<b>12,625</b>	<b>-</b>	<b>-</b>	<b>(34,874)</b>
Projected Site 13	866 3 AVENUE	1307	7501	25,100								
	154 EAST 53 STREET	1307	43	5,020								
	<b>TOTAL</b>			<b>30,120</b>	<b>546,113</b>	<b>519,656</b>	<b>-</b>	<b>520,093</b>	<b>5,167</b>	<b>-</b>	<b>-</b>	<b>(38,602)</b>
Projected Site 14	914 3 AVENUE	1310	33	1,912								
	916 3 AVENUE	1310	34	1,875								
	918 3 AVENUE	1310	35	1,875								
	920 3 AVENUE	1310	36	2,375								
	922 3 AVENUE	1310	37	2,375								
	924 3 AVENUE	1310	38	2,375								
	926 3 AVENUE	1310	39	2,300								
	928 3 AVENUE	1310	40	1,912								
	159 EAST 55 STREET	1310	133	1,508								
	164 EAST 56 STREET	1310	140	1,010								
	<b>TOTAL</b>			<b>19,517</b>	<b>113,199</b>	<b>242,791</b>	<b>(160,820)</b>	<b>242,791</b>	<b>-</b>	<b>-</b>	<b>(80)</b>	<b>-</b>
Projected Site 15	235 EAST 42 STREET	1316	23	37,657								
	801 2 AVENUE	1316	30	7,531								
	219 EAST 42 STREET	1316	12	31,130								
	<b>TOTAL</b>			<b>76,318</b>	<b>465,913</b>	<b>328,540</b>	<b>-</b>	<b>282,942</b>	<b>45,598</b>	<b>-</b>	<b>-</b>	<b>-</b>
Projected Site 16	214 EAST 45 STREET	1318	43	1,674								
	711 3 AVENUE	1318	1	38,666								
	210 EAST 45 STREET	1318	44	1,672								
	212 EAST 45 STREET	1318	143	1,672								
	<b>TOTAL</b>			<b>43,684</b>	<b>355,407</b>	<b>320,843</b>	<b>(2,270)</b>	<b>303,444</b>	<b>17,399</b>	<b>-</b>	<b>(6)</b>	<b>(41,797)</b>
<b>TOTALS</b>			<b>601,899</b>	<b>5,390,837</b>	<b>4,417,694</b>	<b>(113,820)</b>	<b>5,093,444</b>	<b>139,025</b>	<b>(810,171)</b>	<b>(62)</b>	<b>(158,441)</b>	



# Appendix I.1: Lower Density Alternative - Potential Sites

	Site Data				With Action Scenario															Increment											
	Address	Block	Lot	Lot Area	Changes	Proposed Maximum FAR	Zoning Square Feet	Building Floor Area gsf (including mechanical)*	Usable Floor Area (gross square feet, excluding mechanical)	Commercial Floor Area gsf (Office, Retail and Hotel floor area)	Residential Floor Area gsf	Office Floor Area gsf (usable)	Retail Floor Area gsf	Hotel Floor Area gsf	# of Residential Units	# of hotel rooms, conversion or new construction	Parking sf	Mechanical gsf	Retail Breakdown - Neighborhood retail	Retail Breakdown - Destination retail	Building Floor Area gsf (including mechanical)*	Commercial Floor Area gsf (Office, Retail and Hotel floor area)	Residential Floor Area gsf	Office Floor Area gsf (usable)	Retail Floor Area gsf	Hotel Floor Area gsf	# of Residential Units	Parking sf			
Potential Site C	413 MADISON AVENUE	1284	21	11,675	Develops as Office Building	18	366,102.00	421,017	384,407	384,407		364,068	20,339					36,610	20,339												
	425 MADISON AVENUE	1284	52	6,484																											
	423 MADISON AVENUE	1284	152	2,180																											
	TOTAL			20,339																											
Potential Site D	410 MADISON AVENUE	1284	14	7,164	Develops as Office Building	16	346,080.00	397,992	363,384	363,384		341,754	21,630					34,608	21,630												
	418 MADISON AVENUE	1284	17	3,275																											
	422 MADISON AVENUE	1284	55	1,750																											
	424 MADISON AVENUE	1284	56	4,375																											
	22 EAST 49 STREET	1284	59	2,553																											
	20 EAST 49 STREET	1284	60	2,513																											
TOTAL			21,630			346,080.00	397,992	363,384	363,384	-	341,754	21,630	-	-	-	-	34,608	21,630	-	192,790	158,182	-	160,991	(2,809)	-	-	-				
Potential Site E	350 PARK AVENUE	1287	33	27,925	Develops as Office Building	23	642,275	738,616	674,389	674,389		646,464	27,925					64,228	27,925												
	TOTAL			27,925																											
Potential Site F	400 PARK AVENUE	1290	36	12,552	Develops as Office Building	23	558,141.00	641,862	586,048	586,048		561,781	24,267					55,814	24,267												
	410 PARK AVENUE	1290	37	11,715																											
	TOTAL			24,267																											
Potential Site I	141 EAST 45 STREET	1300	26	2,008	Develops as Office Building	16	747,248.00	859,335	784,610	784,610		737,907	46,703					74,725	23,352	23,352											
	730 3 AVENUE	1300	33	38,168																											
	158 EAST 46 STREET	1300	42	3,314																											
	154 EAST 46 STREET	1300	44	3,213																											
	TOTAL			46,703																											
Potential Site J	155 EAST 50 STREET	1305	33	10,744	Develops as Office Building	16	332,560.00	382,444	349,188	349,188		328,403	20,785					33,256	20,785												
	830 3 AVENUE	1305	40	10,041																											
	TOTAL			20,785																											
Potential Site N	845 3 AVENUE	1325	1	21,100	Develops as Office Building	16	337,600.00	388,240.00	354,480.00	354,480.00		333,380.00	21,100					33,760.00	21,100												
	TOTAL			21,100																											
																					986,170.90	657,745.30	(4,575.00)	857,443.30	(16,289.00)	(183,409.00)	(7.00)	-			

---

## Appendix I.2

### Lesser Density Alternative Traffic Volume Figures



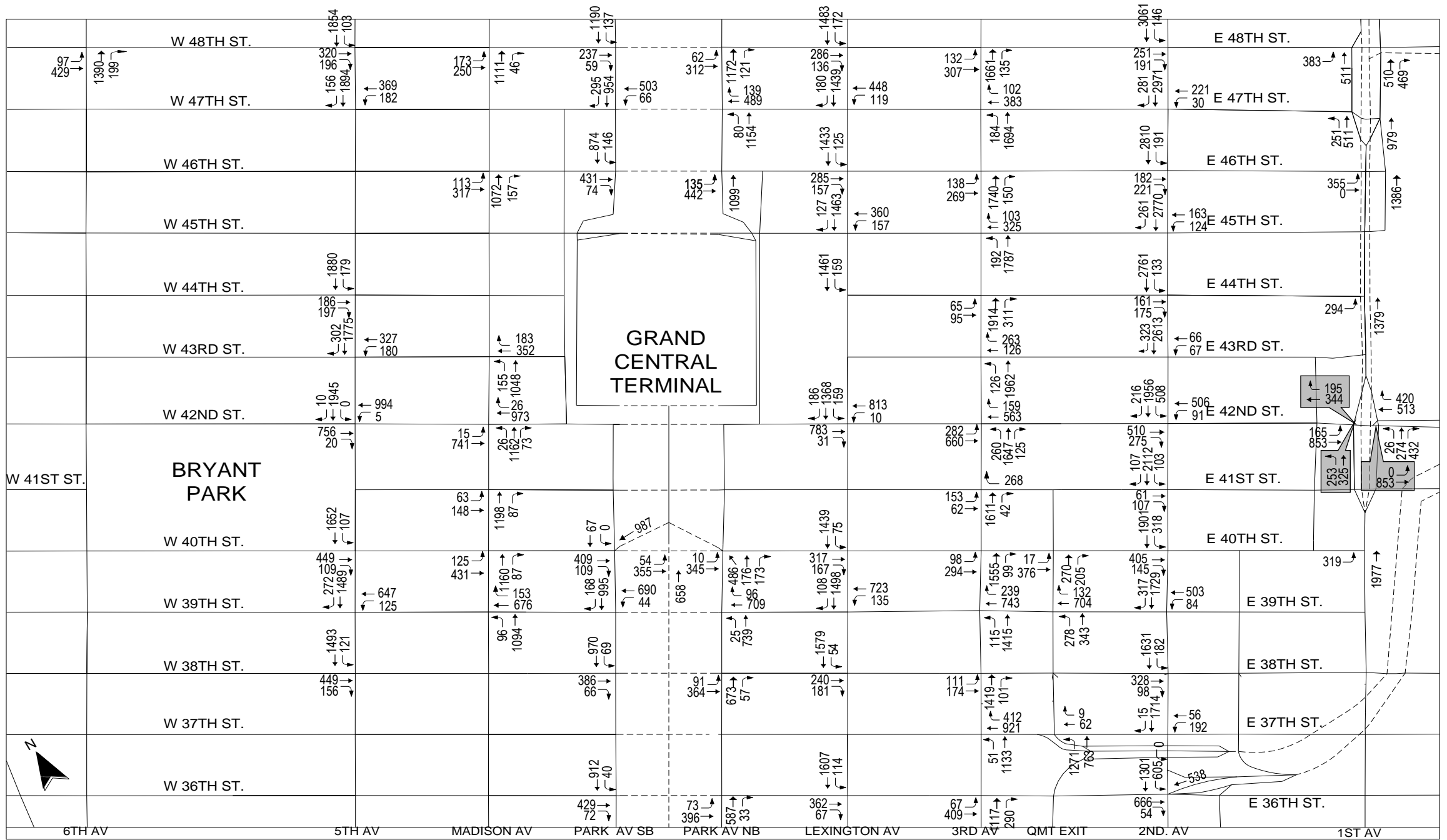

Greater East Midtown Rezoning  
Manhattan, New York

2036 Lesser Density Alternative Traffic Volumes  
Weekday AM Peak Hour

Figure  
1-a





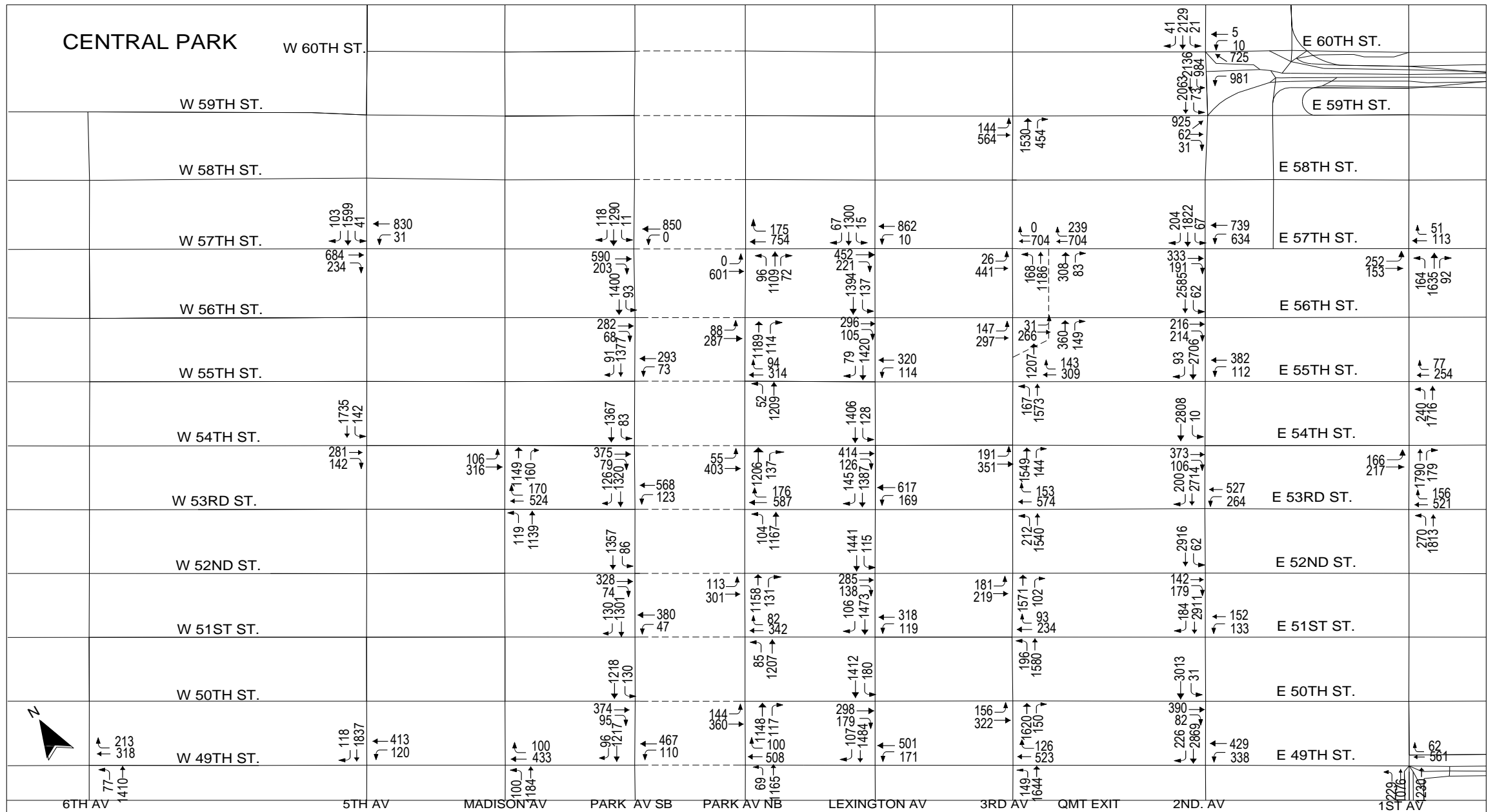

**Greater East Midtown Rezoning**  
 Manhattan, New York

**2036 Lesser Density Alternative Traffic Volumes**  
 Weekday AM Peak Hour

**Figure**  
 1-b



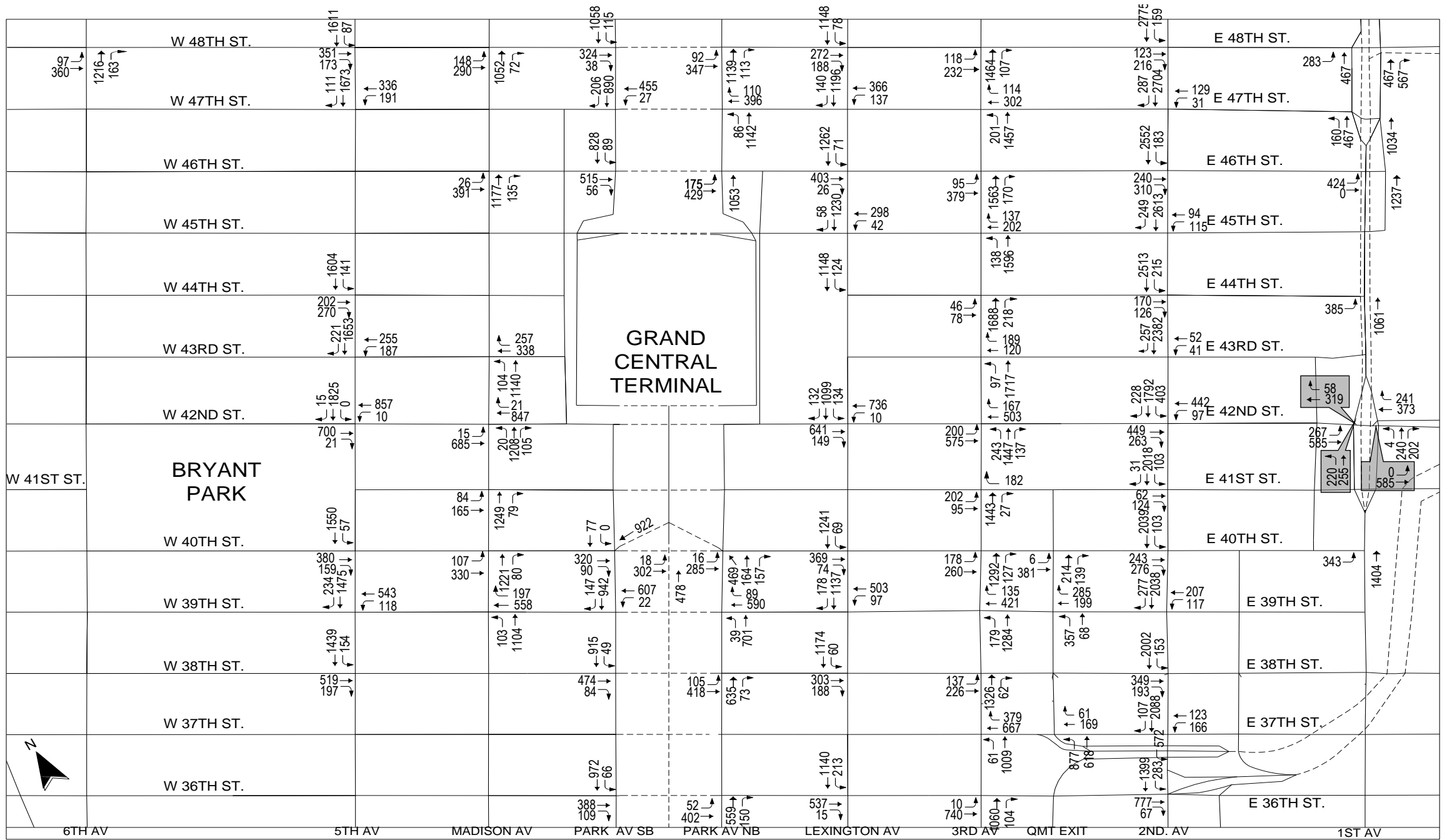

**Greater East Midtown Rezoning**  
 Manhattan, New York

**2036 Lesser Density Alternative Traffic Volumes**  
 Weekday Midday Peak Hour

**Figure**  
**2-a**



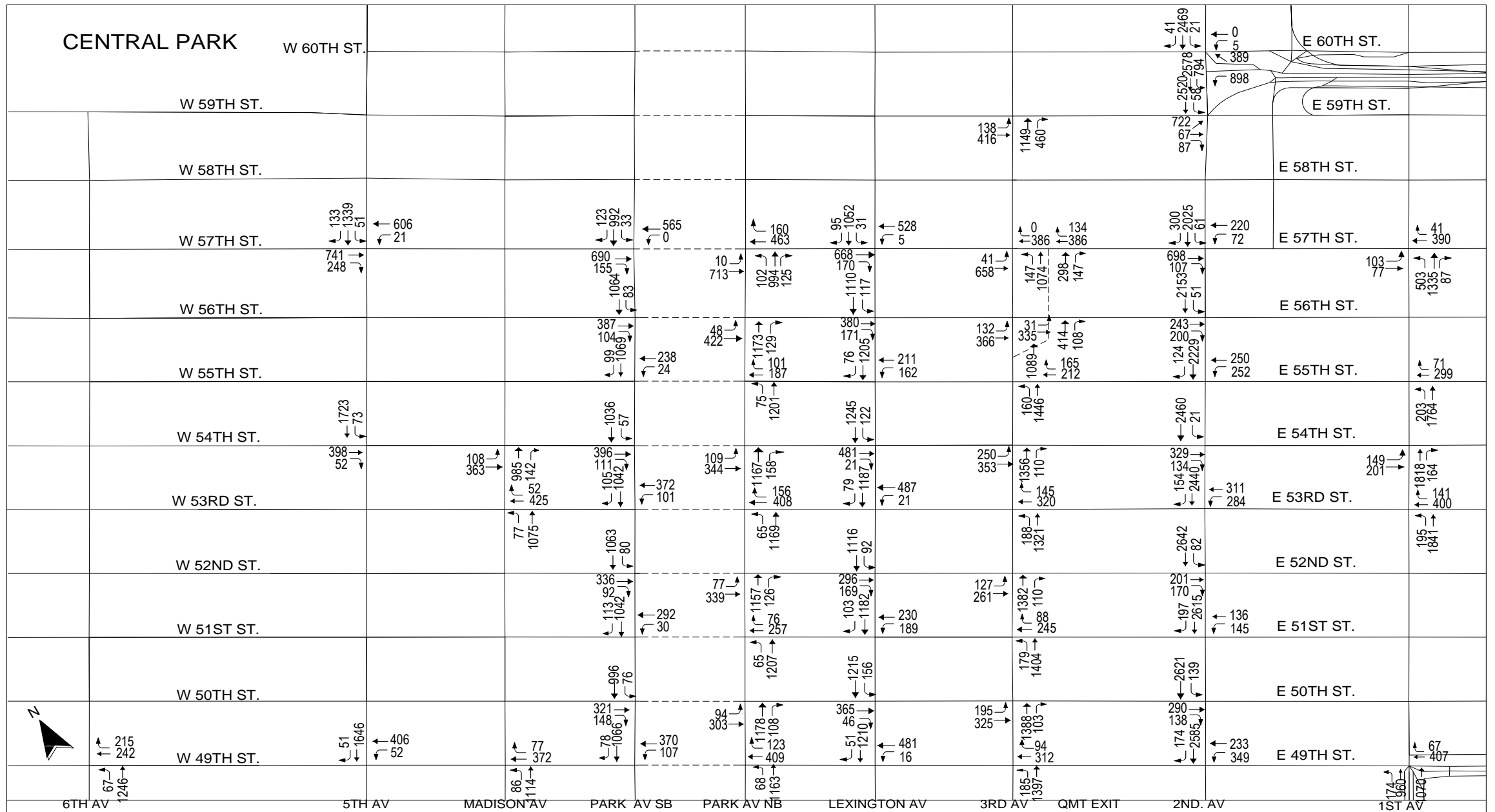

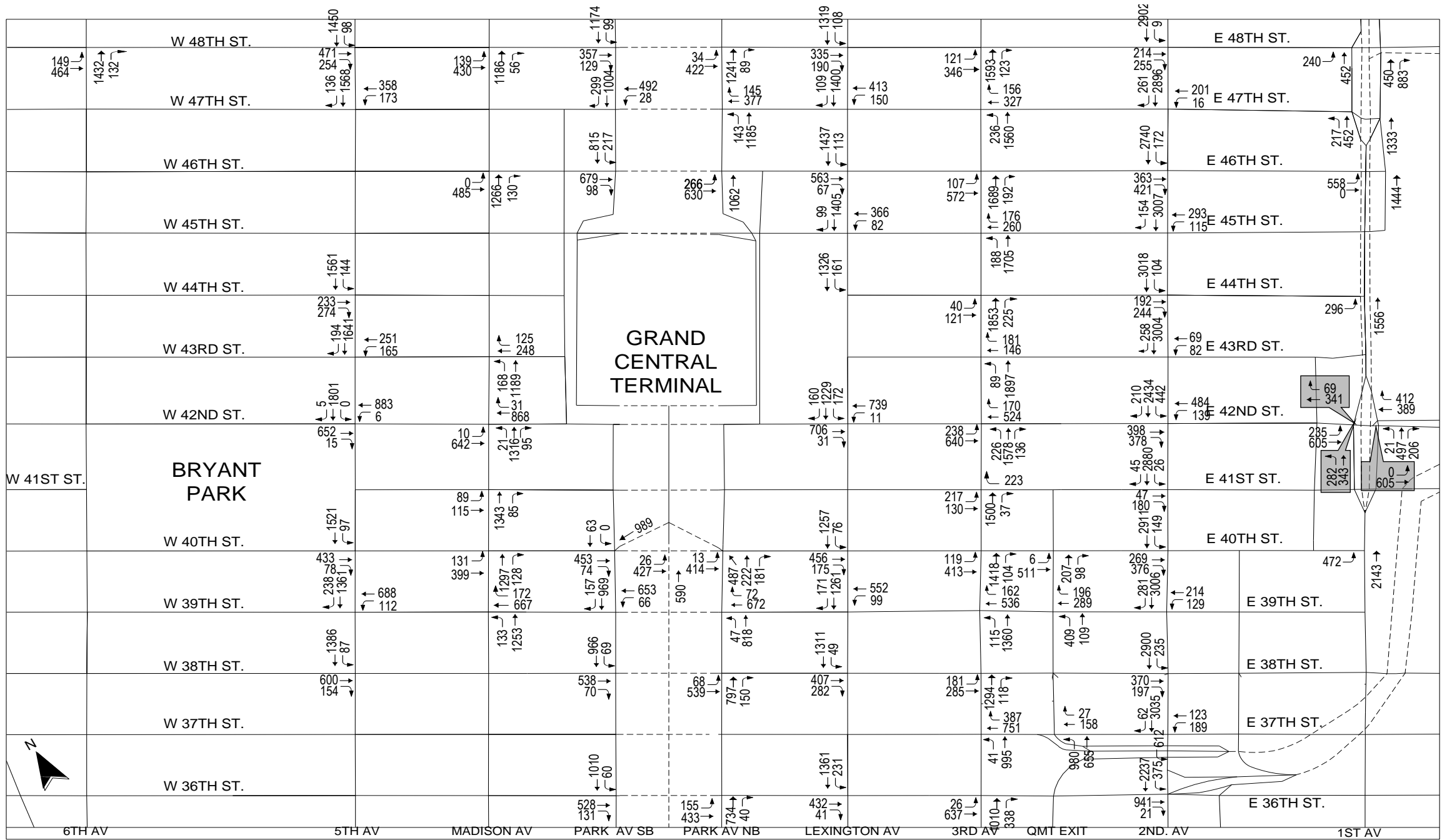

Greater East Midtown Rezoning  
Manhattan, New York

2036 Lesser Density Alternative Traffic Volumes  
Weekday PM Peak Hour

Figure  
3-a



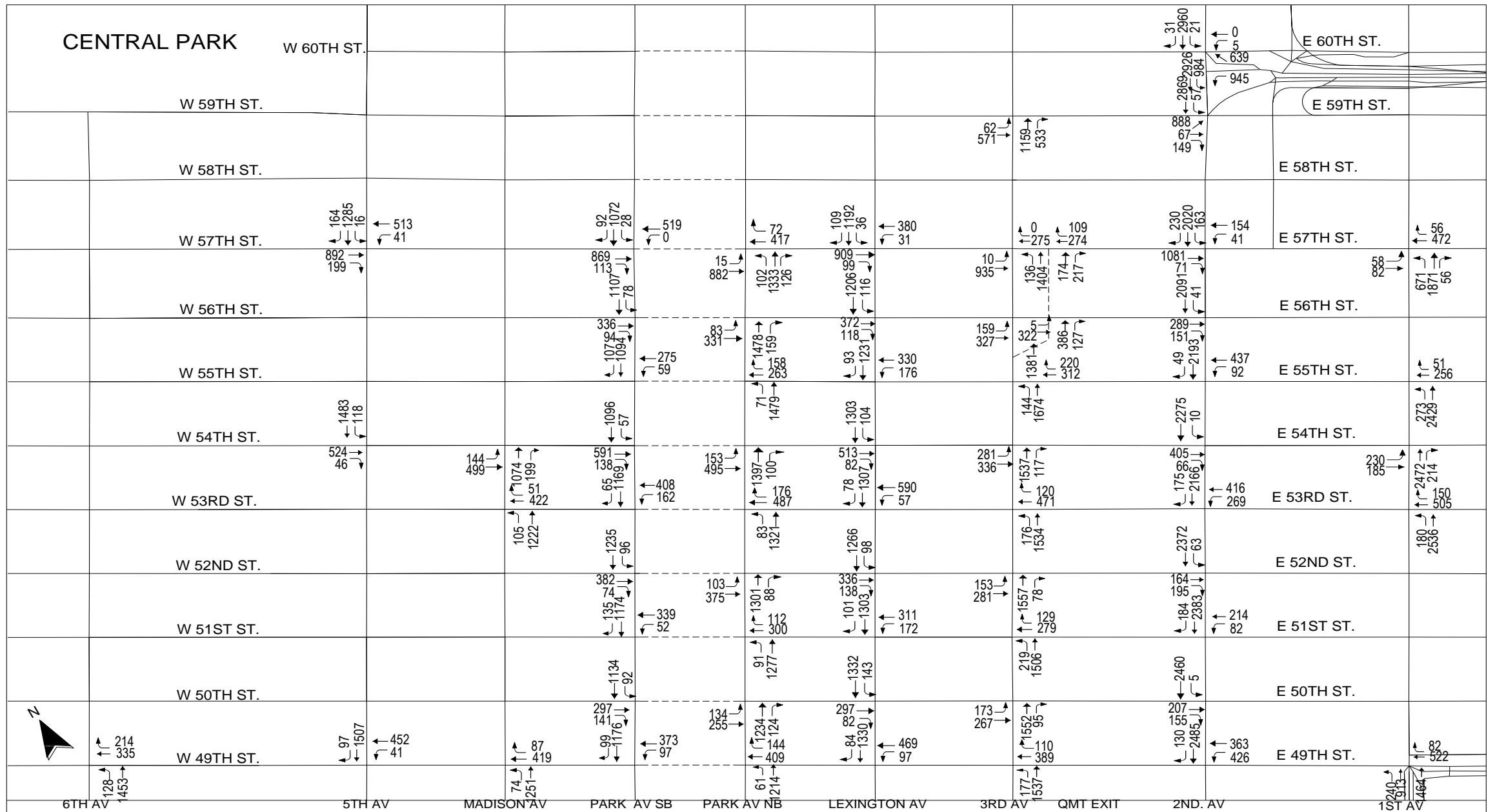

**Greater East Midtown Rezoning**  
 Manhattan, New York

**2036 Lesser Density Alternative Traffic Volumes**  
 Weekday PM Peak Hour

**Figure**  
**3-b**



---

## Appendix I.3

Lesser Density Alternative Traffic LOS Tables

*THIS APPENDIX HAS BEEN UPDATED FOR THE FEIS*



Greater East Midtown Rezoning EIS  
 2036 Lower Density Alternative Level of Service Tables

Intersection & Approach (Signalized Intersections)	AM Peak Hour				Midday Peak Hour				PM Peak Hour			
	Movt.	v/c Ratio	Delay (sec)	LOS	Movt.	v/c Ratio	Delay (sec)	LOS	Movt.	v/c Ratio	Delay (sec)	LOS
<b>1st Avenue &amp; East 40th Street</b>												
Eastbound	L	1.14	104.7	F	L	1.01	75.4	E	L	1.26	153.4	F
Northbound	T	1.24	139.1	F	T	0.91	30.2	C	T	1.38	198.8	F
<b>1st Avenue &amp; East 42nd Street</b>												
Eastbound (East Side)	T	1.32	172.3	F	T	0.86	25.9	C	T	0.76	16.6	B
Westbound (East Side)	TR	1.21	141.3	F	TR	0.77	41.3	D	TR	0.82	39.8	D
	R	1.18	153.3	F	R	1.52	295.6	F	R	1.30	197.2	F
Northbound (East Side)	LT	0.68	98.3	F	LT	0.47	21.3	C	LT	1.20	137.5	F
	R	1.66	328.2	F	R	0.49	22.6	C	R	1.33	193.0	F
Eastbound (West Side)	L	0.96	114.2	F	L	1.08	95.2	F	L	1.07	93.5	F
	T	0.80	74.6	E	T	0.50	21.8	C	T	0.49	15.9	B
Westbound (West Side)	TR	1.03	33.5	C	TR	0.69	8.4	A	TR	0.59	5.5	A
Northbound (West Side)	L	0.77	26.6	C	L	0.51	19.4	B	L	1.03	55.7	E
	T	0.75	82.0	F	T	0.49	25.2	C	T	0.87	88.5	F
<b>1st Avenue &amp; East 44th Street</b>												
Eastbound	L	0.82	25.1	C	L	1.05	78.1	E	L	0.68	21.3	C
Northbound	T	0.71	1.8	A	T	0.54	1.1	A	T	0.79	2.9	A
<b>1st Avenue &amp; East 46th Street</b>												
Eastbound	L	0.82	31.9	C	L	1.11	98.4	F	L	1.44	224.6	F
Northbound	T	0.72	2.4	A	T	0.65	2.5	A	T	0.94	59.5	E
<b>1st Avenue &amp; East 47th Street</b>												
Northbound (East Side)	T	0.76	13.6	B	T	0.82	17.4	B	T	1.19	105.2	F
Northbound (West Side)	L	0.71	17.3	B	L	0.46	11.4	B	L	0.60	12.3	B
	T	0.74	17.9	B	T	0.73	16.6	B	T	0.70	16.2	B
<b>1st Avenue &amp; East 48th Street (East Side)</b>												
Northbound	T	0.32	0.4	A	T	0.31	0.3	A	T	0.29	0.2	A
	R	0.68	4.3	A	R	0.88	13.5	B	R	1.36	173.0	F
<b>1st Avenue &amp; East 49th Street</b>												
Westbound (East Side)	T	1.04	76.2	E	T	0.72	28.5	C	T	0.88	40.7	D
	R	0.20	16.9	B	R	0.19	16.8	B	R	0.22	17.1	B
Northbound (East Side)	T	1.01	80.4	F	T	0.93	66.7	E	T	1.24	137.1	F
Westbound (West Side)	T	1.04	31.4	C	T	0.72	6.1	A	T	0.88	12.2	B
Northbound (West Side)	LT	1.04	57.0	E	LT	0.93	29.7	C	LT	1.09	75.0	E
<b>1st Avenue &amp; East 53rd Street</b>												
Westbound	TR	0.79	31.3	C	TR	0.60	25.0	C	TR	0.70	27.6	C
Northbound	L	0.73	33.9	C	L	0.62	27.9	C	L	0.64	29.3	C
	T	0.81	25.0	C	T	0.86	26.4	C	T	1.10	76.0	E
<b>1st Avenue &amp; East 54th Street</b>												
Eastbound	LT	1.12	103.2	F	LT	1.12	103.0	F	LT	1.19	129.8	F
Northbound	T	1.01	64.1	E	TR	0.95	12.7	B	T	1.07	53.2	D
	R	0.79	18.8	B					R	0.81	11.8	B
<b>1st Avenue &amp; East 55th Street</b>												
Westbound	TR	0.83	42.7	D	TR	1.00	73.5	E	TR	0.72	34.5	C
Northbound	L	1.19	118.4	F	L	0.97	41.2	D	L	1.09	60.8	E
	T	1.05	60.9	E	T	0.77	5.4	A	T	0.99	43.0	D
<b>1st Avenue &amp; East 57th Street</b>												
Eastbound	LT	1.20dl	58.2	E	LT	1.06dl	39.4	D	LT	0.58	33.3	C
Westbound	TR	0.39	30.2	C	TR	0.77	40.1	D	TR	0.87	48.2	D
Northbound	L	0.38	21.4	C	L	1.03	65.4	E	L	1.03	66.5	E
	T	1.38	195.6	F	TR	0.81	9.5	A	T	0.89	12.9	B
	R	0.23	9.1	A					R	0.15	7.6	A

Intersection & Approach (Signalized Intersections)	AM Peak Hour				Midday Peak Hour				PM Peak Hour			
	Movt.	v/c Ratio	Delay (sec)	LOS	Movt.	v/c Ratio	Delay (sec)	LOS	Movt.	v/c Ratio	Delay (sec)	LOS
<b>2nd Avenue &amp; East 36th Street</b>												
Eastbound	TR	1.32	173.8	F	TR	0.96	39.2	D	TR	1.66	321.9	F
Southbound	L	1.70	336.0	F	L	0.31	6.5	A	L	0.84	15.3	B
	T	1.18	105.1	F	T	0.79	11.2	B	T	1.12	71.5	E
South-Westbound	L	1.14	113.9	F								
<b>2nd Avenue &amp; East 37th Street</b>												
Westbound	LT	0.99dl	44.7	D	LT	0.40	24.2	C	LT	0.49	19.2	B
Southbound	T	1.26	130.6	F	TR	1.11	60.6	E	T	1.27	133.5	F
	R	0.10	3.3	A					R	0.35	4.5	A
<b>2nd Avenue &amp; East 38th Street</b>												
Eastbound	TR	1.14	116.1	F	TR	0.81	34.0	C	TR	1.11	102.4	F
Southbound	LT	1.30	149.6	F	LT	1.11	60.6	E	LT	1.29	141.7	F
<b>2nd Avenue &amp; East 39th Street</b>												
Westbound	L	0.25	23.7	C	L	0.31	24.4	C	L	0.35	25.1	C
	T	0.96	70.2	E	T	0.39	25.0	C	T	0.40	25.2	C
Southbound	T	1.25	132.8	F	TR	1.22	115.3	F	T	1.27	138.4	F
	R	1.09	67.8	E					R	0.82	16.3	B
<b>2nd Avenue &amp; East 40th Street</b>												
Eastbound	T	0.82	43.3	D	T	0.58	20.9	C	T	1.07	61.3	E
	R	0.57	36.4	D	R	1.04	80.0	F	R	1.34	179.1	F
Southbound	LT	1.14	80.1	F	LT	1.15	86.2	F	LT	1.18	92.9	F
<b>2nd Avenue &amp; East 41st Street</b>												
Eastbound	TR	0.58	46.0	D	TR	0.61	31.3	C	TR	1.01	83.4	F
Southbound	LT	1.27	139.3	F	LT	1.20	108.2	F	LT	1.25	130.5	F
	R	0.75	17.2	B	R	0.18	8.4	A	R	0.21	5.4	A
<b>2nd Avenue &amp; East 42nd Street</b>												
Eastbound	TR	1.37	196.1	F	TR	1.05	70.5	E	TR	1.18	103.8	F
Westbound	LT	1.87dl	154.1	F	LT	1.13dl	105.9	F	LT	1.93dl	177.7	F
Southbound					L	1.30	163.3	F				
	LT	1.19	110.3	F	T	1.14	88.8	F	LT	1.20	107.4	F
	R	0.75	27.1	C	R	1.02	49.4	D	R	0.85	20.4	C
<b>2nd Avenue &amp; East 43rd Street</b>												
Westbound	LT	0.34	25.0	C	LT	0.25	23.3	C	LT	0.38	25.6	C
Southbound	T	1.14	84.0	F	TR	1.49	239.8	F	T	1.16	88.4	F
	R	1.17	101.5	F					R	1.24	130.3	F
<b>2nd Avenue &amp; East 44th Street</b>												
Eastbound	TR	1.01	49.2	D	TR	0.98	36.0	D	TR	1.29	155.2	F
Southbound					L	0.55	8.7	A				
	LT	1.20	108.1	F	T	1.19	101.2	F	LT	1.16	82.9	F
<b>2nd Avenue &amp; East 45th Street</b>												
Westbound	LT	1.02	96.2	F	LT	0.74	43.9	D	LT	1.09	86.3	F
Southbound	T	1.19	103.0	F	TR	1.46	226.3	F	T	1.15	82.2	F
	R	1.23	125.6	F					R	1.02	43.4	D
<b>2nd Avenue &amp; East 46th Street</b>												
Eastbound	TR	0.66	37.7	D	T	0.58	32.1	C	TR	1.28dr	86.7	F
					R	1.23	156.4	F				
Southbound					L	0.56	10.3	B				
	LT	1.19	101.5	F	T	1.23	122.4	F	LT	1.14	74.6	E
<b>2nd Avenue &amp; East 47th Street</b>												
Westbound	LT	0.79	62.8	E	LT	0.51	54.4	D	LT	0.64	26.7	C
Southbound	T	1.22	116.4	F	TR	1.52	251.4	F	T	1.17	86.4	F
	R	1.10	65.6	E					R	1.20	108.3	F



Intersection & Approach (Signalized Intersections)	AM Peak Hour				Midday Peak Hour				PM Peak Hour			
	Movt.	v/c Ratio	Delay (sec)	LOS	Movt.	v/c Ratio	Delay (sec)	LOS	Movt.	v/c Ratio	Delay (sec)	LOS
<b>2nd Avenue &amp; East 48th Street</b>												
Eastbound	TR	1.13	102.6	F	TR	1.10	96.0	F	TR	1.19	130.3	F
Southbound	L	0.51	11.2	B	L	1.28	149.2	F				
	T	1.53	260.9	F	T	1.36	184.6	F	LT	1.10	63.5	E
<b>2nd Avenue &amp; East 49th Street</b>												
Westbound	L	0.87	92.5	F	L	0.98	101.1	F	L	1.19	124.9	F
	T	0.40	23.5	C	T	0.23	19.9	B	T	0.40	18.8	B
Southbound	T	1.33	165.7	F	TR	1.19	102.1	F	T	0.94	48.4	D
	R	1.02	44.2	D					R	0.46	1.9	A
<b>2nd Avenue &amp; East 50th Street</b>												
Eastbound	TR	1.21	147.1	F	TR	1.32	192.6	F	TR	1.13	105.5	F
Southbound	L	0.09	8.0	A	L	0.60	11.2	B				
	T	1.61	292.5	F	T	1.36	181.6	F	LT	1.14	73.4	E
<b>2nd Avenue &amp; East 51st Street</b>												
Westbound	LT	1.40	235.0	F	LT	0.73	38.7	D	LT	0.73	37.7	D
Southbound	T	1.60	290.8	F	TR	1.37	184.6	F	T	1.10	55.7	E
	R	0.97	30.5	C					R	0.97	27.1	C
<b>2nd Avenue &amp; East 52nd Street</b>												
Eastbound	TR	0.83	39.7	D	TR	0.93	45.9	D	TR	0.91	52.3	D
Southbound	L	0.15	7.2	A	L	0.18	7.3	A	L	0.21	1.9	A
	T	1.54	263.0	F	T	1.35	178.3	F	T	1.32	159.4	F
<b>2nd Avenue &amp; East 53rd Street</b>												
Westbound	LT	1.08	82.7	F	LT	1.12dl	82.4	F	LT	0.96	60.9	E
Southbound	T	1.52	254.1	F	TR	1.36	183.4	F	T	1.42	208.5	F
	R	0.69	19.9	B					R	0.68	11.8	B
<b>2nd Avenue &amp; East 54th Street</b>												
Eastbound	TR	0.63	27.8	C	TR	0.61	25.2	C	TR	0.55	31.3	C
Southbound	L	0.02	8.3	A	L	0.06	8.2	A	L	0.05	1.1	A
	T	1.63	303.3	F	T	1.45	221.4	F	T	1.48	234.4	F
<b>2nd Avenue &amp; East 55th Street</b>												
Westbound	L	0.32	18.0	B	L	0.78	25.0	C	L	0.35	27.7	C
	T	0.94	37.1	D	T	1.07	76.3	E	T	1.08	85.6	F
Southbound	T	1.66	315.8	F	TR	1.67	324.0	F	T	1.48	232.8	F
	R	0.43	11.9	B					R	0.27	3.6	A
<b>2nd Avenue &amp; East 56th Street</b>												
Eastbound	T	0.76	31.2	C	T	0.52	11.7	B	T	0.65	27.0	C
	R	0.88	43.8	D	R	0.57	15.7	B	R	0.49	24.3	C
Southbound	L	0.11	2.2	A	L	0.33	4.5	A	L	0.11	1.5	A
	T	1.55	266.5	F	T	1.45	226.3	F	T	1.34	167.8	F
<b>2nd Avenue &amp; East 57th Street</b>												
Eastbound	T	0.57	54.2	D	TR	1.19	133.6	F	T	1.24	138.3	F
	R	1.39	247.8	F					R	0.30	23.4	C
Westbound	L	1.21	147.7	F								
	LT	1.15	111.0	F	LT	0.79	37.4	D	LT	0.88dl	23.6	C
Southbound	L	0.52	39.9	D	L	0.22	21.5	C	L	0.60	16.7	B
	T	1.24	139.7	F	TR	1.44	227.0	F	T	1.08	68.6	E
	R	1.10	110.1	F					R	0.82	26.5	C
<b>2nd Avenue &amp; East 59th Street</b>												
Eastbound	L	1.14	87.9	F	L	1.15	95.6	F	L	1.41	206.6	F
	TR	0.40	271.6	F	TR	0.51	272.3	F	TR	0.76	298.6	F
Southbound	L	1.08	66.3	E	L	1.09	63.8	E	L	1.10	62.6	E
	LT	1.34	173.5	F	LT	1.19	100.8	F	LT	1.16	85.9	F

Intersection & Approach (Signalized Intersections)	AM Peak Hour				Midday Peak Hour				PM Peak Hour			
	Movt.	v/c Ratio	Delay (sec)	LOS	Movt.	v/c Ratio	Delay (sec)	LOS	Movt.	v/c Ratio	Delay (sec)	LOS
<b>2nd Avenue &amp; East 60th Street</b>												
Westbound	LT	0.02	14.2	B	LT	0.01	14.2	B	LT	0.02	14.2	B
Southbound	L	0.05	14.6	B					L	0.07	14.9	B
	T	1.06	82.1	F	LTR	1.12	85.9	F	T	1.10	78.4	E
	R	0.14	16.0	B					R	0.12	15.7	B
Westbound (Bridge Exit)	L	1.41	217.0	F	L	1.28	162.3	F	L	1.17	115.3	F
	T	1.27	159.7	F	T	0.70	29.5	C	T	1.02	69.4	E
<b>Tunnel Exit Street &amp; East 37th Street</b>												
Westbound	TR	0.18	9.0	A	TR	0.61	42.9	D	TR	0.50	48.6	D
North-Westbound	L	0.33	0.2	A	L	0.21	0.1	A	L	0.24	0.1	A
	R	0.73	23.2	C	R	0.51	12.0	B	R	0.51	12.0	B
<b>Tunnel Exit Street &amp; East 39th Street</b>												
Westbound	TR	0.87	74.5	E	TR	0.92dr	33.4	C	TR	0.59	27.3	C
Northbound					L	1.12	118.0	F				
	LT	0.36	10.8	B	T	0.12	20.0	B	LT	1.16dl	13.6	B
<b>Tunnel Exit Street &amp; East 40th Street</b>												
Eastbound	LT	1.02	97.9	F	LT	0.94	82.9	F	LT	1.31	158.3	F
Northbound	TR	0.25	13.0	B	TR	0.23	7.0	A	TR	0.23	12.3	B
<b>3rd Avenue &amp; East 36th Street</b>												
Eastbound	LT	1.14	105.9	F	LT	0.70	22.5	C	LT	1.64	311.7	F
Northbound	TR	0.86	43.1	D	TR	0.98	65.1	E	TR	0.57	19.9	B
	R	1.09	126.1	F	R	0.56	45.6	D	R	1.15	148.0	F
<b>3rd Avenue &amp; East 37th Street</b>												
Westbound	TR	0.69	18.1	B	TR	0.57	16.4	B	TR	0.56	16.4	B
	R	1.05	121.2	F	R	0.88	78.9	E	R	1.05	118.5	F
Northbound	LT	1.03	66.1	E	LT	1.00	60.8	E	LT	0.61	5.8	A
<b>3rd Avenue &amp; East 38th Street</b>												
Eastbound	LT	0.36	31.9	C	LT	0.46	31.9	C	LT	0.74	38.3	D
Northbound	T	1.05	65.5	E	T	1.05	71.8	E	T	0.69	11.4	B
	R	0.60	13.0	B	R	0.42	12.8	B	R	0.42	10.1	B
<b>3rd Avenue &amp; East 39th Street</b>												
Westbound	T	1.75	363.5	F	T	1.51	258.3	F	T	1.20	138.7	F
	R	1.29	174.6	F	R	0.86	43.8	D	R	0.53	31.4	C
Northbound	LT	1.33	168.8	F	LT	1.23	126.2	F	LT	1.08	69.7	E
<b>3rd Avenue &amp; East 40th Street</b>												
Eastbound	LT	0.98	86.8	F	LT	1.00	105.6	F	LT	1.59	307.6	F
Northbound	T	1.25	131.0	F	T	1.18	97.2	F	T	1.17	97.7	F
	R	0.73	101.9	F	R	0.95	58.2	E	R	1.08	71.7	E
<b>3rd Avenue &amp; East 41st Street</b>												
Eastbound					L	1.11	133.3	F				
	LT	0.75	67.1	E	T	0.33	40.3	D	LT	1.13	104.8	F
Westbound	R	1.08	115.9	F	R	1.13	134.2	F	R	0.89	68.3	E
Northbound	T	1.18	102.7	F	T	0.96	62.5	E	T	1.11	72.6	E
	R	0.33	12.8	B	R	0.31	14.1	B	R	0.30	14.0	B
<b>3rd Avenue &amp; East 42nd Street</b>												
Eastbound	L	1.15	109.6	F	L	0.98	75.8	E	L	1.10	95.3	F
	T	1.12	78.2	E	T	1.16	116.0	F	T	1.07	74.7	E
Westbound	T	0.91	42.3	D	T	0.85	33.9	C	T	0.95	37.0	D
	R	1.29	172.0	F	R	1.20	128.6	F	R	1.21	133.7	F
Northbound	LT	1.26	145.8	F	LT	1.15	99.6	F	LT	1.08	73.9	E
	R	0.50	23.3	C	R	0.83	40.4	D	R	1.05	69.8	E
<b>3rd Avenue &amp; East 43rd Street</b>												
Westbound	TR	0.59	19.2	B	TR	0.85	21.0	C	TR	0.81	19.8	B
	R	0.65	20.6	C								
Northbound	LT	1.12	71.7	E	LT	1.08	62.2	E	LT	1.05	63.3	E

Intersection & Approach (Signalized Intersections)	AM Peak Hour				Midday Peak Hour				PM Peak Hour			
	Movt.	v/c Ratio	Delay (sec)	LOS	Movt.	v/c Ratio	Delay (sec)	LOS	Movt.	v/c Ratio	Delay (sec)	LOS
<b>3rd Avenue &amp; East 44th Street</b>												
Eastbound	LT	0.35	27.5	C	LT	0.27	26.9	C	LT	0.31	27.3	C
Northbound	T	1.05	63.8	E	T	1.07	64.5	E	T	1.19	97.8	F
	R	2.21	564.4	F	R	1.79	377.1	F	R	2.89	867.8	F
<b>3rd Avenue &amp; East 45th Street</b>												
Westbound	T	1.13	98.9	F	T	0.58	17.5	B	T	0.70	15.5	B
	R	0.85	62.4	E	R	0.68	36.2	D	R	0.83	40.9	D
Northbound	LT	1.15	90.4	F	LT	1.18	107.3	F	LT	1.15	85.7	F
<b>3rd Avenue &amp; East 46th Street</b>												
Eastbound	L	0.63	40.0	D	L	0.37	28.7	C	L	0.39	41.8	D
	T	0.37	11.7	B	T	0.52	10.3	B	T	0.76	31.2	C
Northbound	T	1.07	68.0	E	T	1.14	87.7	F	T	1.19	97.8	F
	R	0.66	21.3	C	R	1.28	153.3	F	R	0.94	22.8	C
<b>3rd Avenue &amp; East 47th Street</b>												
Westbound	T	1.32	173.1	F	T	1.12	83.5	F	T	1.07	76.5	E
	R	0.57	18.1	B	R	0.70	22.2	C	R	0.71	28.7	C
Northbound	LT	1.22	123.2	F	LT	1.20	109.9	F	LT	1.19	112.2	F
<b>3rd Avenue &amp; East 48th Street</b>												
Eastbound	L	0.28	19.7	B	L	0.26	21.3	C	L	0.29	21.9	C
	T	0.55	24.0	C	T	0.40	23.4	C	T	0.53	24.1	C
Northbound	T	1.05	66.2	E	T	1.16	98.7	F	T	1.17	99.9	F
	R	0.78	24.2	C	R	0.95	43.4	D	R	1.10	84.9	F
<b>3rd Avenue &amp; East 49th Street</b>												
Westbound	T	1.08	86.1	F	T	0.48	17.2	B	T	0.62	23.3	C
	R	0.56	42.4	D	R	0.44	39.7	D	R	0.59	50.3	D
Northbound	LT	1.12	77.7	E	LT	1.19	109.7	F	LT	1.21	121.3	F
<b>3rd Avenue &amp; East 50th Street</b>												
Eastbound	L	0.29	12.9	B	L	0.43	7.7	A	L	0.83	41.5	D
	T	0.49	13.9	B	T	0.51	8.4	A	T	0.82	35.4	D
Northbound	T	1.17	99.8	F	T	1.19	105.4	F	T	1.15	90.8	F
	R	1.09	78.9	E	R	1.09	82.4	F	R	0.65	22.3	C
<b>3rd Avenue &amp; East 51st Street</b>												
Westbound	T	0.78	24.2	C	T	0.81	25.2	C	T	1.14	109.4	F
	R	0.40	17.1	B	R	0.40	17.5	B	R	0.70	31.4	C
Northbound	LT	1.22	121.1	F	LT	1.16	97.9	F	LT	1.16	101.3	F
<b>3rd Avenue &amp; East 52nd Street</b>												
Eastbound	LT	0.78	25.7	C	LT	0.84	21.2	C	LT	0.95	52.0	D
Northbound	T	1.16	95.6	F	T	1.12	75.1	E	T	1.17	97.5	F
	R	1.15	97.9	F	R	1.16	104.5	F	R	1.13	99.2	F
<b>3rd Avenue &amp; East 53rd Street</b>												
Westbound	T	1.15	105.8	F	T	0.61	11.4	B	T	1.06	69.6	E
	R	1.04	119.6	F	R	0.76	32.7	C	R	0.83	93.1	F
Northbound	LT	1.13	85.1	F	LT	1.10	77.1	E	LT	1.20	115.3	F
<b>3rd Avenue &amp; East 54th Street</b>												
Eastbound	L	0.99	68.9	E	L	1.26	155.9	F	L	1.07	102.9	F
	T	0.59	19.8	B	T	0.69	20.4	C	T	0.73	39.5	D
Northbound	T	1.10	78.4	E	T	1.07	76.5	E	T	1.13	90.9	F
	R	0.79	35.2	D	R	0.74	32.2	C	R	0.85	37.9	D
<b>3rd Avenue &amp; East 55th Street</b>												
Westbound	T	1.09	85.6	F	T	0.90	26.5	C	T	1.21	133.5	F
	R	0.99	74.8	E	R	1.07	68.3	E	R	1.12	111.9	F
Northbound	LT	1.24	131.3	F	LT	1.23	128.7	F	LT	1.28	147.3	F

Intersection & Approach (Signalized Intersections)	AM Peak Hour				Midday Peak Hour				PM Peak Hour			
	Movt.	v/c Ratio	Delay (sec)	LOS	Movt.	v/c Ratio	Delay (sec)	LOS	Movt.	v/c Ratio	Delay (sec)	LOS
<b>3rd Avenue &amp; East 56th Street</b>												
Eastbound (West Side)	LT	0.86	51.6	D	LT	0.98	106.6	F	LT	1.16	111.0	F
Northbound (West Side)	T	1.20	112.5	F	T	1.15	92.9	F	T	1.34	175.1	F
Eastbound (East Side)	LT	0.98	42.8	D	LT	0.91	23.8	C	LT	0.67	4.1	A
Northbound (East Side)	TR	0.57	14.3	B	TR	1.08	74.3	E	TR	1.23	123.0	F
<b>3rd Avenue &amp; East 57th Street</b>												
Eastbound (West Side)	LT	1.10	110.7	F	LT	1.09	109.1	F	LT	1.36	207.7	F
Westbound (West Side)	TR	0.97	27.5	C	TR	0.89	30.1	C	TR	0.83	23.7	C
Northbound (West Side)	LT	1.06	60.1	E	LT	1.22	118.9	F	LT	1.23	125.1	F
Eastbound (East Side)	T	0.66	12.4	B	T	1.24	132.3	F	T	1.17	94.6	F
Westbound (East Side)	T	0.93	64.0	E	T	0.77	31.1	C	T	0.86	55.7	E
	R	0.77	20.4	C	R	0.58	25.8	C	R	0.75	54.8	D
Northbound (East Side)	TR	0.83	42.0	D	TR	1.08	68.6	E	TR	1.17	98.4	F
	R	0.33	26.3	C	R	1.11	87.7	F	R	1.15	94.7	F
<b>3rd Avenue &amp; East 59th Street</b>												
Eastbound	LT	0.98	53.5	D	LT	1.07	86.8	F	LT	0.77	29.6	C
Northbound	T	0.74	9.5	A	T	0.67	8.4	A	T	0.58	5.8	A
	R	1.17	118.7	F	R	1.04	72.6	E	R	1.54	275.6	F
<b>Lexington Avenue &amp; East 36th Street</b>												
Eastbound	TR	0.66	55.3	E	TR	0.73	47.6	D	TR	1.29	184.2	F
Southbound	LT	1.12	69.8	E	LT	1.07	54.6	D	LT	1.13	80.4	F
<b>Lexington Avenue &amp; East 38th Street</b>												
Eastbound	T	0.47	38.8	D	T	0.63	44.4	D	T	0.77	44.2	D
	R	1.00	117.8	F	R	1.13	150.9	F	R	1.60	322.9	F
Southbound	L	0.15	1.2	A	L	0.17	2.0	A	L	0.14	1.0	A
	T	1.13	65.8	E	T	0.90	17.7	B	T	0.57	1.7	A
<b>Lexington Avenue &amp; East 39th Street</b>												
Westbound	L	1.20	130.9	F	L	1.11	99.1	F	L	0.80	37.3	D
	T	1.96	449.4	F	T	1.60	294.1	F	T	1.42	217.4	F
Southbound	T	1.12	74.3	E	T	1.07	63.6	E	TR	1.07	59.6	E
	R	0.93	35.6	D	R	0.87	23.4	C				
<b>Lexington Avenue &amp; East 40th Street</b>												
Eastbound	T	1.03	49.6	D	T	0.76	21.4	C	T	0.84	31.7	C
	R	1.09	87.2	F	R	0.54	34.9	C	R	1.26	160.5	F
Southbound	LT	1.22	120.6	F	LT	1.14	84.9	F	LT	0.91	46.5	D
<b>Lexington Avenue &amp; East 42nd Street</b>												
Eastbound	T	0.96	37.6	D	T	1.07	68.6	E	T	1.19	118.9	F
	R	0.31	12.2	B	R	0.91	43.4	D	R	0.28	24.3	C
Westbound	LT	1.10	70.9	E	LT	0.95	51.2	D	LT	1.63	316.2	F
Southbound	L	0.69	20.8	C	L	0.50	22.7	C	L	1.10	83.6	F
	T	1.14	86.7	F	T	0.92	64.4	E	T	1.04	71.2	E
	R	1.25	141.3	F	R	0.70	27.0	C	R	1.28	159.6	F
<b>Lexington Avenue &amp; East 44th Street</b>												
Southbound	LT	1.21	111.6	F	LT	1.17	96.4	F	LT	1.22	120.0	F
<b>Lexington Avenue &amp; East 45th Street</b>												
Westbound	L	0.69	28.1	C								
	T	0.86	30.7	C	LT	0.89	48.5	D	LT	1.09	87.8	F
Southbound	T	1.07	63.3	E	T	1.06	61.4	E	T	1.08	62.6	E
	R	0.88	25.3	C	R	0.17	7.9	A	R	0.40	11.3	B
<b>Lexington Avenue &amp; East 46th Street</b>												
Eastbound	T	0.72	58.6	E	T	0.98	64.9	E	T	1.32	174.6	F
	R	0.69	60.7	E	R	0.15	45.5	D	R	0.30	27.9	C
Southbound	LT	1.14	76.6	E	LT	1.09	60.0	E	LT	1.16	86.2	F

Intersection & Approach (Signalized Intersections)	AM Peak Hour				Midday Peak Hour				PM Peak Hour			
	Movt.	v/c Ratio	Delay (sec)	LOS	Movt.	v/c Ratio	Delay (sec)	LOS	Movt.	v/c Ratio	Delay (sec)	LOS
<b>Lexington Avenue &amp; East 47th Street</b>												
Westbound	L	0.84	39.1	D	L	1.18	125.4	F	L	1.18	125.3	F
	T	0.85	19.2	B	T	1.31	165.8	F	T	1.26	149.2	F
Southbound	T	1.07	66.0	E	T	1.06	65.8	E	T	1.17	96.0	F
	R	1.30	163.2	F	R	1.66	323.0	F	R	1.18	112.8	F
<b>Lexington Avenue &amp; East 48th Street</b>												
Eastbound	T	0.76	37.1	D	T	1.10	101.9	F	T	1.07	87.1	F
	R	1.04	112.1	F	R	1.16	143.0	F	R	1.18	148.7	F
Southbound	LT	1.19	106.3	F	LT	1.01	58.6	E	LT	1.10	65.4	E
<b>Lexington Avenue &amp; East 49th Street</b>												
Westbound	L	0.59	36.0	D								
	T	0.48	30.7	C	LT	0.56	30.1	C	LT	0.70	38.2	D
Southbound	T	1.07	61.7	E	T	1.10	65.1	E	T	1.03	65.9	E
	R	0.79	21.6	C	R	0.34	13.4	B	R	0.39	14.2	B
<b>Lexington Avenue &amp; East 50th Street</b>												
Eastbound	TR	1.05	69.0	E	TR	0.43	27.5	C	TR	0.38	25.0	C
Southbound	LT	1.32	162.7	F	LT	1.12	69.9	E	LT	1.21	112.5	F
<b>Lexington Avenue &amp; East 51st Street</b>												
Westbound	L	0.66	44.7	D	L	1.07	99.9	F	L	1.03	71.8	E
	T	0.52	21.6	C	T	0.92	48.6	D	T	1.01	50.0	D
Southbound	T	1.09	63.5	E	T	1.16	96.0	F	T	0.98	59.9	E
	R	0.64	14.4	B	R	1.19	137.6	F	R	0.58	14.0	B
<b>Lexington Avenue &amp; East 52nd Street</b>												
Eastbound	T	0.59	20.2	C	T	0.99	53.9	D	T	0.64	26.2	C
	R	0.80	50.4	D	R	0.96	68.9	E	R	0.96	55.4	E
Southbound	LT	1.24	129.0	F	LT	0.95	63.1	E	LT	1.09	72.2	E
<b>Lexington Avenue &amp; East 53rd Street</b>												
Westbound	L	0.58	16.4	B	L	0.07	21.2	C	L	0.19	16.7	B
	T	1.19	112.0	F	T	0.87	40.0	D	T	0.96	44.8	D
Southbound	T	1.30	154.2	F	T	1.08	62.2	E	T	0.84	26.4	C
	R	0.95	86.1	F	R	0.81	94.3	F	R	0.48	18.2	B
<b>Lexington Avenue &amp; East 54th Street</b>												
Eastbound	T	1.04	54.4	D	TR	1.06	69.3	E	TR	0.91	32.1	C
	R	0.48	12.1	B								
Southbound	LT	1.12	71.6	E	LT	1.13	75.5	E	LT	1.10	65.9	E
<b>Lexington Avenue &amp; East 55th Street</b>												
Westbound	L	0.80	36.9	D	L	1.05	71.1	E	L	0.96	47.0	D
	T	0.63	16.6	B	T	0.88	30.5	C	T	0.91	26.3	C
Southbound	T	1.21	115.8	F	T	1.07	63.5	E	T	0.93	60.0	E
	R	0.34	12.3	B	R	0.63	16.4	B	R	0.53	12.1	B
<b>Lexington Avenue &amp; East 56th Street</b>												
Eastbound	T	0.55	16.0	B	T	0.66	17.4	B	T	0.84	19.2	B
	R	0.77	55.1	E	R	1.09	84.9	F	R	0.93	45.6	D
Southbound	LT	1.23	130.3	F	LT	1.05	77.5	E	LT	1.05	74.1	E
<b>Lexington Avenue &amp; East 57th Street</b>												
Eastbound	T	0.92	27.9	C	T	0.86	24.9	C	T	1.43	221.8	F
	R	0.84	88.2	F	R	0.68	20.1	C	R	0.61	34.5	C
Westbound	LT	0.97	53.4	D	LT	0.96	51.6	D	LT	1.56dl	96.4	F
	Southbound	LT	1.18	115.3	F	LT	1.00	88.6	F	LT	1.04	86.3
	R	0.23	16.6	B	R	0.38	21.7	C	R	0.37	20.5	C
<b>Park Avenue &amp; East 36th Street</b>												
Eastbound (West Side)	TR	0.60	25.1	C	TR	0.64	26.3	C	TR	1.03	81.8	F
Southbound (West Side)	LT	0.79	13.2	B	LT	0.76	9.5	A	LT	0.80	11.5	B
Eastbound (East Side)	LT	0.55	9.5	A	LT	0.53	8.9	A	LT	0.69	26.9	C
Northbound (East Side)	TR	0.50	16.5	B	TR	0.66	19.8	B	TR	0.59	18.1	B

Intersection & Approach (Signalized Intersections)	AM Peak Hour				Midday Peak Hour				PM Peak Hour			
	Movt.	v/c Ratio	Delay (sec)	LOS	Movt.	v/c Ratio	Delay (sec)	LOS	Movt.	v/c Ratio	Delay (sec)	LOS
<b>Park Avenue &amp; East 38th Street</b>												
Eastbound (West Side)	TR	0.62	25.7	C	TR	0.64	26.1	C	TR	1.04	77.4	E
Southbound (West Side)	LT	0.94	25.6	C	LT	0.73	10.2	B	LT	0.74	6.2	A
Eastbound (East Side)	L	0.35	9.0	A	L	0.24	8.2	A	L	0.23	8.1	A
	T	0.36	7.3	A	T	0.42	7.7	A	T	0.51	10.5	B
Northbound (East Side)	TR	0.74	12.2	B	TR	0.75	18.6	B	TR	0.93	56.2	E
<b>Park Avenue &amp; East 39th Street</b>												
Westbound (East Side)	TR	1.68	326.8	F	TR	1.41	210.5	F	TR	1.36	186.6	F
Northbound (East Side)	LT	0.64	74.3	E	LT	0.57	43.3	D	LT	0.97	79.0	E
Westbound (West Side)	LT	1.51	255.1	F	LT	1.12	82.5	F	LT	1.18	102.4	F
Southbound (West Side)	T	0.71	68.9	E	T	0.62	55.9	E	T	0.86	67.3	E
	R	1.18	111.9	F	R	0.52	18.9	B	R	1.23	132.8	F
<b>Park Avenue &amp; East 40th Street</b>												
Eastbound (West Side)	TR	1.23	153.5	F	TR	1.28	175.6	F	TR	1.46	248.9	F
Southbound (West Side)	T	1.16	107.8	F	T	1.18	115.4	F	T	1.24	143.8	F
Eastbound (Tunnel Exit)	LT	1.34	184.0	F	LT	1.41	205.2	F	LT	1.69	330.7	F
Northbound (Tunnel Exit)	T	0.82	16.0	B	T	0.72	17.1	B	T	0.87	20.5	C
Eastbound (East Side)	LT	1.39	197.9	F	LT	1.33	169.8	F	LT	1.58	280.3	F
Northbound (East Side)	TR	1.06	72.2	E	TR	0.83	31.3	C	TR	1.09	71.4	E
<b>Park Avenue &amp; East 46th Street</b>												
Eastbound (West Side)	T	0.38	25.2	C	T	0.92	56.2	E	T	1.23	138.3	F
	R	0.30	27.8	C	R	0.33	29.9	C	R	0.40	24.1	C
Southbound (West Side)	L	0.47	27.7	C	L	0.32	16.3	B	L	0.77	76.9	E
	T	1.10	69.0	E	T	1.12	77.5	E	T	1.19	105.2	F
Eastbound (East Side)	L	0.55	23.4	C	L	0.91	46.1	D	L	0.93	21.5	C
	T	0.85	31.2	C	T	1.25	144.9	F	T	1.33	168.3	F
Northbound (East Side)	T	0.81	27.5	C	T	0.85	33.0	C	T	0.90	47.1	D
<b>Park Avenue &amp; East 47th Street</b>												
Westbound (East Side)	T	0.98	41.3	D	T	1.46	232.4	F	T	1.09	68.3	E
	R	0.50	16.9	B	R	0.90	38.6	D	R	0.77	18.3	B
Northbound (East Side)	L	0.12	33.3	C	L	0.16	94.9	F	L	0.27	98.3	F
	T	0.90	26.7	C	T	1.00	57.4	E	T	1.06	65.8	E
Westbound (West Side)	LT	1.06	59.5	E	LT	1.50	246.9	F	LT	1.13	87.6	F
Southbound (West Side)	TR	1.02	60.7	E	TR	0.99	53.7	D	TR	1.11	72.6	E
<b>Park Avenue &amp; East 48th Street</b>												
Eastbound (West Side)	T	0.60	22.1	C	T	0.58	20.8	C	T	0.63	35.7	D
	R	0.27	15.4	B	R	0.28	19.2	B	R	0.45	32.9	C
Southbound (West Side)	L	0.41	119.1	F	L	0.25	97.5	F	L	0.22	52.6	D
	T	1.20	103.5	F	T	1.14	86.2	F	T	1.03	62.4	E
Eastbound (East Side)	LT	0.85	34.6	C	LT	0.90	33.6	C	LT	0.95	42.8	D
Northbound (East Side)	TR	1.00	50.0	D	TR	0.94	35.8	D	TR	1.03	62.1	E
<b>Park Avenue &amp; East 49th Street</b>												
Westbound (East Side)	T	1.06	80.5	F	T	0.84	25.8	C	T	0.97	62.4	E
	R	0.64	30.5	C	R	0.39	10.0	B	R	0.54	12.7	B
Northbound (East Side)	L	0.21	15.3	B	L	0.21	15.3	B	L	0.19	109.9	F
	T	1.00	53.4	D	T	1.02	47.9	D	T	1.09	59.8	E
Westbound (West Side)	LT	1.16	93.3	F	LT	0.91	24.6	C	LT	1.04	53.1	D
Southbound (West Side)	TR	1.00	68.1	E	TR	0.97	54.6	D	TR	0.97	64.8	E
<b>Park Avenue &amp; East 50th Street</b>												
Eastbound (West Side)	T	0.72	19.3	B	T	0.83	19.1	B	T	0.90	41.0	D
	R	0.32	13.2	B	R	0.75	18.0	B	R	0.65	27.9	C
Southbound (West Side)	L	0.17	82.6	F	L	0.23	13.5	B	L	0.20	16.5	B
	T	0.97	59.0	E	T	1.08	61.4	E	T	1.08	67.0	E
Eastbound (East Side)	LT	0.95	40.3	D	LT	1.08	78.0	E	LT	1.19	122.8	F
Northbound (East Side)	TR	1.00	45.9	D	TR	0.88	30.3	C	TR	0.92	50.6	D

Intersection & Approach (Signalized Intersections)	AM Peak Hour				Midday Peak Hour				PM Peak Hour			
	Movt.	v/c Ratio	Delay (sec)	LOS	Movt.	v/c Ratio	Delay (sec)	LOS	Movt.	v/c Ratio	Delay (sec)	LOS
<b>Park Avenue &amp; East 51st Street</b>												
Westbound (East Side)	T	0.70	25.3	C	T	1.15	110.1	F	T	0.71	28.7	C
	R	0.68	45.1	D	R	0.70	34.9	C	R	0.58	28.1	C
Northbound (East Side)	L	0.14	32.5	C	L	0.21	31.7	C	L	0.17	15.5	B
	T	0.94	38.5	D	T	1.04	66.7	E	T	1.09	65.1	E
Westbound (West Side)	LT	0.87	28.6	C	LT	1.08	67.9	E	LT	0.86	28.6	C
Southbound (West Side)	T	0.84	28.5	C	TR	1.06	61.1	E	TR	0.90	36.9	D
	R	1.25	138.0	F								
<b>Park Avenue &amp; East 52nd Street</b>												
Eastbound (West Side)	TR	0.81	26.0	C	TR	1.01	61.4	E	TR	0.80	26.2	C
Southbound (West Side)	L	0.17	103.3	F	L	0.24	178.3	F	L	0.18	86.3	F
	T	1.17	95.6	F	T	1.02	66.8	E	T	1.05	65.5	E
Eastbound (East Side)	LT	0.86	25.1	C	LT	0.96	36.1	D	LT	1.09	80.8	F
Northbound (East Side)	TR	0.97	30.2	C	TR	1.00	45.4	D	TR	1.07	62.5	E
<b>Park Avenue &amp; East 53rd Street</b>												
Westbound (East Side)	T	1.19	112.5	F	T	0.76	41.2	D	T	0.87	53.2	D
	R	1.09	80.8	F	R	0.63	39.2	D	R	0.54	33.5	C
Northbound (East Side)	L	0.18	16.5	B	L	0.20	21.6	C	L	0.17	18.9	B
	T	0.94	30.5	C	T	1.06	64.1	E	T	1.13	76.6	E
Westbound (West Side)	LT	1.13	73.6	E	LT	1.11	85.1	F	LT	1.05	59.7	E
Southbound (West Side)	TR	1.07	60.3	E	TR	0.95	37.4	D	TR	0.89	29.0	C
<b>Park Avenue &amp; East 54th Street</b>												
Eastbound (West Side)	TR	0.94	36.2	D	TR	0.61	18.4	B	TR	0.80	22.5	C
Southbound (West Side)	L	0.31	13.7	B	L	0.22	10.8	B	L	0.15	11.9	B
	T	1.17	95.5	F	T	1.01	53.0	D	T	1.01	58.3	E
Eastbound (East Side)	L	0.33	10.3	B	L	0.34	10.5	B				
	T	1.02	49.5	D	T	0.64	15.3	B	LT	0.89	18.7	B
Northbound (East Side)	T	0.86	19.1	B	TR	0.99	51.4	D	TR	0.98	60.7	E
	R	0.64	16.6	B								
<b>Park Avenue &amp; East 55th Street</b>												
Westbound (East Side)	TR	0.96	70.8	E	TR	1.11	109.5	F	TR	1.27	172.8	F
Northbound (East Side)	L	0.21	331.9	F	L	0.29	123.2	F	L	0.15	157.9	F
	T	1.07	68.7	E	T	1.11	71.6	E	T	1.13	78.2	E
Westbound (West Side)	LT	0.91	29.1	C	LT	1.05	69.5	E	LT	1.17	99.4	F
Southbound (West Side)	T	1.00	56.6	E	TR	1.08	61.3	E	TR	1.15	87.0	F
	R	0.54	13.7	B								
<b>Park Avenue &amp; East 56th Street</b>												
Eastbound (West Side)	TR	0.72	29.1	C	TR	1.36	191.8	F	TR	1.34	175.9	F
Southbound (West Side)	L	0.14	155.3	F	L	0.18	145.8	F	L	0.17	17.4	B
	T	1.05	65.5	E	T	1.02	65.0	E	T	1.05	71.1	E
Eastbound (East Side)	LT	0.65	14.9	B	LT	1.16	92.8	F	LT	1.15	87.3	F
Northbound (East Side)	TR	1.01	50.4	D	TR	0.94	55.8	E	TR	1.07	62.2	E
<b>Park Avenue &amp; East 57th Street</b>												
Eastbound (West Side)	T	0.74	33.2	C	T	1.20	126.7	F	T	1.38	201.0	F
	R	0.61	31.6	C	R	1.08	96.5	F	R	0.43	29.2	C
Westbound (West Side)	T	1.07	61.7	E	T	1.19	104.3	F	T	0.76	13.3	B
Southbound (West Side)	LTR	0.91	78.4	E	LTR	0.96	87.9	F	LTR	0.77	72.5	E
Eastbound (East Side)	LT	1.16	105.8	F	LT	1.22	117.5	F	LT	1.04	34.2	C
Westbound (East Side)	T	0.76	44.0	D	T	1.17	129.1	F	T	0.52	30.4	C
	R	0.60	40.8	D	R	1.03	97.7	F	R	0.25	26.2	C
Northbound (East Side)	L	0.18	686.1	F	L	0.29	686.1	F	L	0.17	10.1	B
	T	0.96	34.1	C	T	1.03	42.6	D	T	1.12	71.5	E
	R	0.26	11.7	B	R	0.69	21.3	C	R	0.40	9.9	A

Intersection & Approach (Signalized Intersections)	AM Peak Hour				Midday Peak Hour				PM Peak Hour			
	Movt.	v/c Ratio	Delay (sec)	LOS	Movt.	v/c Ratio	Delay (sec)	LOS	Movt.	v/c Ratio	Delay (sec)	LOS
<b>Madison Avenue &amp; East 39th Street</b>												
Westbound	T	1.26	141.7	F	T	1.39	202.3	F	T	1.45	221.7	F
	R	1.19	128.5	F	R	1.42	221.9	F	R	1.21	127.3	F
Northbound	LT	1.11	87.5	F	LT	1.00	86.7	F	LT	1.01	85.4	F
<b>Madison Avenue &amp; East 40th Street</b>												
Eastbound	L	0.96	55.6	E	L	0.71	40.0	D	L	1.17	113.5	F
	T	0.89	27.5	C	T	0.65	22.0	C	T	0.82	14.3	B
Northbound	TR	1.18	98.5	F	TR	1.10	62.1	E	TR	1.13	76.4	E
<b>Madison Avenue &amp; East 41st Street</b>												
Eastbound	L	0.45	50.8	D	L	0.49	49.5	D	L	0.53	50.8	D
	T	0.29	29.4	C	T	0.32	28.3	C	T	0.21	27.4	C
Northbound	TR	1.19	105.3	F	TR	1.18	102.0	F	TR	1.19	105.8	F
<b>Madison Avenue &amp; East 42nd Street</b>												
Eastbound	LT	1.58	286.6	F	LT	1.18	105.9	F	LT	1.19	113.5	F
Westbound	T	1.53	262.9	F	T	1.24	141.4	F	T	1.26	151.4	F
	R	0.31	23.1	C	R	0.23	25.2	C	R	0.18	28.8	C
Northbound	LT	1.23	120.2	F	LT	1.20	110.0	F	LT	1.22	120.1	F
	R	0.54	16.5	B	R	0.73	93.6	F	R	0.42	13.8	B
<b>Madison Avenue &amp; East 43rd Street</b>												
Westbound	T	0.77	37.6	D	T	1.27	174.6	F	T	0.55	29.1	C
	R	0.97	126.2	F	R	1.53	293.1	F	R	0.67	44.5	D
Northbound	L	1.39	201.0	F	L	1.10	85.5	F	L	1.61	298.2	F
	T	1.06	61.7	E	T	1.12	74.9	E	T	1.21	114.8	F
<b>Madison Avenue &amp; East 46th Street</b>												
Eastbound	LT	1.00	81.8	F	LT	0.91	49.9	D	LT	1.09	86.2	F
Northbound	T	1.00	63.6	E	T	1.16	92.9	F	T	1.12	71.2	E
	R	1.04	90.5	F	R	0.76	17.1	B	R	0.85	175.2	F
<b>Madison Avenue &amp; East 48th Street</b>												
Eastbound	L	1.10	114.5	F	L	0.96	80.2	F	L	0.74	26.5	C
	T	0.74	26.5	C	T	0.69	23.4	C	T	0.86	14.4	B
Northbound	T	1.11	72.6	E	T	0.99	68.1	E	T	1.19	104.8	F
	R	0.59	20.3	C	R	0.72	29.2	C	R	0.76	30.8	C
<b>Madison Avenue &amp; East 49th Street</b>												
Westbound	TR	0.60	9.4	A	TR	1.06	63.3	E	TR	1.13	87.4	F
Northbound	L	0.54	12.0	B	L	0.30	10.6	B	L	0.23	11.8	B
	T	1.08	59.2	E	T	1.04	64.4	E	T	1.08	60.7	E
<b>Madison Avenue &amp; East 53rd Street</b>												
Westbound	TR	1.15	97.7	F	TR	0.85	41.6	D	TR	0.95	48.7	D
Northbound	L	0.52	11.6	B	L	0.18	9.8	A	L	0.58	13.0	B
	T	1.01	55.0	E	T	0.97	65.8	E	T	1.12	69.8	E
<b>Madison Avenue &amp; East 54th Street</b>												
Eastbound	LT	0.59	30.6	C	LT	1.15	108.7	F	LT	0.72	31.2	C
Northbound	T	1.04	62.8	E	T	1.14	86.8	F	T	1.01	58.5	E
	R	1.02	48.8	D	R	0.92	41.5	D	R	0.74	18.4	B
<b>5th Avenue &amp; 38th Street</b>												
Eastbound	T	0.43	18.1	B	T	0.57	22.6	C	T	0.51	19.3	B
	R	1.04	123.0	F	R	1.06	120.1	F	R	1.04	120.8	F
Southbound	LT	1.39	190.6	F	LT	1.37	179.7	F	LT	1.26	131.7	F
<b>5th Avenue &amp; 39th Street</b>												
Westbound	L	1.11	105.6	F	L	0.92	59.3	E	L	0.90	60.9	E
	T	0.66	29.5	C	T	1.36	194.0	F	T	0.85	39.5	D
Southbound	T	1.31	169.5	F	T	1.14	91.5	F	T	1.28	146.1	F
	R	1.34	179.9	F	R	1.06	63.3	E	R	1.15	92.1	F



Intersection & Approach (Signalized Intersections)	AM Peak Hour				Midday Peak Hour				PM Peak Hour			
	Movt.	v/c Ratio	Delay (sec)	LOS	Movt.	v/c Ratio	Delay (sec)	LOS	Movt.	v/c Ratio	Delay (sec)	LOS
<b>5th Avenue &amp; 40th Street</b>												
Eastbound	TR	1.53	280.3	F	TR	1.33	194.4	F	TR	1.27	165.5	F
Southbound	LT	1.52	258.2	F	LT	1.09	67.6	E	LT	1.51	249.6	F
<b>5th Avenue &amp; 42nd Street</b>												
Eastbound	T	1.14	105.3	F	T	0.72	28.2	C	T	0.69	27.4	C
	R	0.21	23.8	C	R	0.17	21.9	C	R	0.15	21.5	C
Westbound	LT	1.46	230.2	F	LT	1.37	186.6	F	LT	1.03	53.7	D
Southbound	LT	1.49	243.0	F	LT	1.51	252.2	F	LT	1.50	241.6	F
	R	0.05	14.0	B	R	0.11	14.1	B	R	0.03	2.2	A
<b>5th Avenue &amp; 43rd Street</b>												
Westbound	L	0.62	29.4	C	L	0.86	25.7	C	L	0.72	35.3	D
	T	0.67	25.5	C	T	0.67	12.7	B	T	0.60	28.9	C
Southbound	T	1.26	140.8	F	T	1.19	108.6	F	T	1.36	180.8	F
	R	2.08	506.0	F	R	1.85	405.1	F	R	2.02	479.0	F
<b>5th Avenue &amp; 44th Street</b>												
Eastbound	T	0.42	24.1	C	T	0.42	23.4	C	T	0.46	23.4	C
	R	0.86	95.7	F	R	1.15	134.9	F	R	1.35	210.5	F
Southbound	LT	1.43	210.8	F	LT	1.42	209.8	F	LT	1.54	260.8	F
<b>5th Avenue &amp; 47th Street</b>												
Westbound	L	1.01	105.4	F	L	0.98	69.0	E	L	1.14	106.4	F
	T	0.65	34.2	C	T	0.55	34.6	C	T	1.09	72.0	E
Southbound	T	1.44	217.8	F	T	1.47	233.7	F	T	1.38	190.8	F
	R	0.87	25.9	C	R	1.03	57.7	E	R	1.14	89.2	F
<b>5th Avenue &amp; 48th Street</b>												
Eastbound	T	0.59	17.5	B	T	0.66	20.1	C	T	1.19	126.2	F
	R	1.06	89.3	F	R	0.99	92.9	F	R	1.24	158.7	F
Southbound	LT	1.44	218.9	F	LT	1.32	165.9	F	LT	1.32	162.6	F
<b>5th Avenue &amp; 49th Street</b>												
Westbound	LT	0.57	27.7	C	LT	0.50	23.1	C	LT	1.09	90.2	F
Southbound	T	1.43	215.8	F	T	1.48	239.3	F	T	1.40	197.8	F
	R	0.63	16.9	B	R	0.37	11.7	B	R	0.72	9.8	A
<b>5th Avenue &amp; 54th Street</b>												
Eastbound	TR	0.51	23.6	C	TR	1.07	94.8	F	TR	0.95	54.9	D
Southbound	LT	1.42	212.2	F	LT	1.41	204.7	F	LT	1.47	226.7	F
<b>5th Avenue &amp; 57th Street</b>												
Eastbound	T	1.13	105.9	F	T	1.19	127.6	F	T	1.41	219.6	F
	R	0.84	141.8	F	R	1.07	126.4	F	R	0.78	47.3	D
Westbound	LT	1.16	121.3	F	LT	0.79	88.8	F	LT	1.66d	158.3	F
Southbound	LT	1.51	258.3	F	LT	1.05	84.3	F	LT	1.51	261.2	F
	R	0.43	22.3	C	R	0.38	18.5	B	R	0.66	32.7	C
<b>6th Avenue &amp; West 48th Street</b>												
Eastbound	L	0.33	22.5	C	L	0.33	22.7	C	L	0.58	29.9	C
	T	1.17	129.0	F	T	1.02	77.2	E	T	1.03	76.4	E
Northbound	TR	0.89dr	31.6	C	TR	0.76	36.1	D	T	0.72	20.8	C
									R	1.12	147.5	F

Intersection & Approach (Signalized Intersections)	AM Peak Hour				Midday Peak Hour				PM Peak Hour			
	Movt.	v/c Ratio	Delay (sec)	LOS	Movt.	v/c Ratio	Delay (sec)	LOS	Movt.	v/c Ratio	Delay (sec)	LOS
<b>6th Avenue &amp; West 49th Street</b>												
Westbound	T	0.78	32.7	C	T	0.51	20.3	C	T	1.00	68.5	E
	R	0.70	31.7	C	R	0.62	29.8	C	R	0.93	56.8	E
Northbound	LT	1.06	49.0	D	LT	1.06	50.4	D	LT	0.89	13.2	B

Intersection & Approach (Unsignalized Intersections)	AM Peak Hour				Midday Peak Hour				PM Peak Hour			
	Movt.	v/c Ratio	Delay (sec)	LOS	Movt.	v/c Ratio	Delay (sec)	LOS	Movt.	v/c Ratio	Delay (sec)	LOS
<b>1st Avenue &amp; East 48th Street (West Side)</b>												
Eastbound	L	0.92	48.8	E	L	0.61	21.0	C	L	0.52	18.0	C
Northbound	T	0.34	0.0	A	T	0.32	0.0	A	T	0.32	0.0	A

---

## Appendix I.4

### Lesser Density Alternative Subway LOS Tables

*THIS APPENDIX HAS BEEN UPDATED FOR THE FEIS*



Lesser Density Alternative Subway Stair Analysis  
at the Grand Central 42nd Street Subway Station

Peak Period	Stairway	Effective Width (ft.)	No-Action							Lesser Density Alternative									
			15-Minute Pedestrian Volumes		Surging Factor Up	Surging Factor Down	Friction Factor	V/C Ratio	LOS	Effective Width (ft.)	15-Minute Pedestrian Volumes		Surging Factor Up	Surging Factor Down	Friction Factor	V/C Ratio	LOS	WIT (in.)	WIT for Significant Impact (in.)
			Down	Up							Down	Up							
PM	KC	10.25	1694	185	0.95	1.0	1.0	1.23	D	10.25	1803	190	0.95	1.0	1.0	1.30	D	7.41	6
<b>Notes:</b> Methodology based on <i>CEQR Technical Manual</i> guidelines.																			

Lesser Density Alternative Subway Escalator Analysis  
at the Grand Central 42nd Street Subway Station

Peak Period	Escalator	No-Action							Lesser Density Alternative						
		Width (in.)	Treads Per Minute	Guideline Capacity	15-Minute Pedestrian Volumes	Surging Factor	V/C Ratio	LOS	Width (in.)	Treads Per Minute	Guideline Capacity	15-Minute Pedestrian Volumes	Surging Factor	V/C Ratio	LOS
AM	E203	32	90	750	687	0.80	1.15	D	32	90	750	731	0.80	1.22	D
	E204	32	90	750	687	0.80	1.15	D	32	90	750	731	0.80	1.22	D
	E205	40	90	945	782	0.80	1.03	D	40	90	945	826	0.80	1.09	D
	E206	40	90	945	782	0.80	1.03	D	40	90	945	826	0.80	1.09	D
	E208	40	90	945	853	0.75	1.20	D	40	90	945	924	0.75	1.30	D
	E210	40	90	945	853	0.75	1.20	D	40	90	945	924	0.75	1.30	D
	E255	40	90	945	913	0.95	1.02	D	40	90	945	1029	0.95	1.15	D
E256	40	90	945	912	0.95	1.02	D	40	90	945	1030	0.95	1.15	D	
PM	E204	32	90	750	724	1.00	0.97	C	32	90	750	858	1.00	1.14	D
	E206	40	90	945	1047	1.00	1.11	D	40	90	945	1146	1.00	1.21	D
	E208	40	90	945	731	0.75	1.03	D	40	90	945	737	0.75	1.04	E
	E256	40	90	945	1063	1.00	1.12	D	40	90	945	1104	1.00	1.17	D

Notes:

Methodology based on *CEQR Technical Manual* guidelines.

Mitigated Lesser Density Alternative Escalator Analysis  
at the Grand Central 42nd Street Subway Station

Peak Period	Escalator	Lesser Density Alternative							Mitigated Lesser Density Alternative						
		Width (in.)	Treads Per Minute	Guideline Capacity	15-Minute Pedestrian Volumes	Surging Factor	V/C Ratio	LOS	Width (in.)	Treads Per Minute	Guideline Capacity	15-Minute Pedestrian Volumes	Surging Factor	V/C Ratio	LOS
AM	E203	32	90	750	731	0.80	1.22	D	32	100	825	731	0.80	1.11	D
	E204	32	90	750	731	0.80	1.22	D	32	100	825	731	0.80	1.11	D
	E205	40	90	945	826	0.80	1.09	D	40	100	1050	826	0.80	0.98	C
	E206	40	90	945	826	0.80	1.09	D	40	100	1050	826	0.80	0.98	C
	E208	40	90	945	924	0.75	1.30	D	40	100	1050	924	0.75	1.17	D
	E210	40	90	945	924	0.75	1.30	D	40	100	1050	924	0.75	1.17	D
	E256	40	90	945	1030	0.95	1.15	D	40	100	1050	1030	0.95	1.03	D
PM	E204	32	90	750	858	1.00	1.14	D	32	100	825	858	1.00	1.04	D
	E206	40	90	945	1146	1.00	1.21	D	40	100	1050	1146	1.00	1.09	D
	E208	40	90	945	737	0.75	1.04	D	40	100	1050	737	0.75	0.94	C
	E256	40	90	945	1104	1.00	1.17	D	40	100	1050	1104	1.00	1.05	D

Notes:  
Methodology based on *CEQR Technical Manual* guidelines.

Lesser Density Alternative Subway Stair Analysis at the 42nd  
Street Bryant Park-Fifth Avenue Station

Peak Period	Fare Control Area	Stairway	No-Action								Lesser Density Alternative									
			Width (ft.)	Effective Width (ft.)	15-Minute Pedestrian Volumes		Surging Factor	Friction Factor	V/C Ratio	LOS	Width (ft.)	Effective Width (ft.)	15-Minute Pedestrian Volumes		Surging Factor	Friction Factor	V/C Ratio	LOS	WIT (in.)	WIT for Significant Impact (in.)
					Down	Up							Down	Up						
PM	N502	MB20	10.00	8.75	1161	146	0.9	0.9	1.12	D	10.00	8.75	1241	148	0.9	0.9	1.19	D	6.46	7

**Notes:**  
 Methodology based on *CEQR Technical Manual* guidelines.  
 Surging factors only apply to pedestrian volumes in the up direction. The surge factor for pedestrians moving downward is 1.0.

Lesser Density Alternative Subway Escalator Analysis  
at the Lexington Avenue- 53rd Street Station

Peak Period	Escalator	No-Action							Lesser Density Alternative						
		Width (in.)	Treads Per Minute	Guideline Capacity	15-Minute Pedestrian Volumes	Surging Factor	V/C Ratio	LOS	Width (in.)	Treads Per Minute	Guideline Capacity	15-Minute Pedestrian Volumes	Surging Factor	V/C Ratio	LOS
AM	E243 (UP)	40	90	945	709	0.75	1.00	C	40	90	945	796	0.75	1.12	D
	E244 (UP)	40	90	945	771	0.75	1.09	D	40	90	945	796	0.75	1.12	D
	E254X (UP)	24	90	480	281	0.75	0.78	C	40	90	945	751	0.75	1.06	D
PM	E244 (DOWN)	40	90	945	1036	1.00	1.10	D	40	90	945	1207	1.00	1.28	D
	E269 (DOWN)	40	90	945	925	1.00	0.98	C	40	90	945	1130	1.00	1.20	D
	E246 (DOWN)	40	90	945	870	1.00	0.92	C	40	90	945	961	1.00	1.02	D
<b>Notes:</b> Methodology based on <i>CEQR Technical Manual</i> guidelines.															



Mitigated Lesser Density Alternative Subway Escalator Analysis  
at the Lexington Avenue-53rd Street Station

Peak Period	Escalator	Lesser Density Alternative							Mitigated Lesser Density Alternative						
		Width (in.)	Treads Per Minute	Guideline Capacity	15-Minute Pedestrian Volumes	Surging Factor	V/C Ratio	LOS	Width (in.)	Treads Per Minute	Guideline Capacity	15-Minute Pedestrian Volumes	Surging Factor	V/C Ratio	LOS
AM	E243 (UP)	40	90	945	796	0.75	1.12	D	40	100	1050	796	0.75	1.01	D
	E244 (UP)	40	90	945	796	0.75	1.12	D	40	100	1050	796	0.75	1.01	D
	E254X (UP)	40	90	945	751	0.75	1.06	D	40	100	1050	751	0.75	0.95	C
PM	E244 (DOWN)	40	90	945	1207	1.00	1.28	D	40	100	1050	1207	1.00	1.15	D
	E269 (DOWN)	40	90	945	1130	1.00	1.20	D	40	100	1050	1130	1.00	1.08	D
	E246 (DOWN)	40	90	945	961	1.00	1.02	D	40	100	1050	961	1.00	0.92	C

Notes:

Methodology based on *CEQR Technical Manual* guidelines.

---

## Appendix I.5

Lesser Density Alternative Pedestrian LOS Tables (Sidewalks,  
Corners, Crosswalks)

*THIS APPENDIX HAS BEEN UPDATED FOR THE FEIS*



## 2036 Lower Density Alternative Condition: Sidewalk Analysis

Location	Sidewalk	Effective Width (ft)	Two-way Peak Hour Volume	PHF	SFP	LOS
Weekday AM Peak Hour						
E 39th Street between 5th Avenue and Madison Avenue	North	5	1,072	0.85	61.9	C
E 40th Street between 5th Avenue and Madison Avenue	South	5.5	1,417	0.77	46.1	C
	North	9	1,830	0.82	63.3	C
Madison Avenue between E 40th Street and E 41st Street	West	13	2,807	0.90	65.1	C
41st Street between 5th Avenue and Madison Avenue	South	6	1,016	0.92	85.4	C
E 43rd Street between 5th Avenue and Madison Avenue	North	4	2,300	0.94	23.7	D
E 44th Street between 5th Avenue and Madison Avenue	South	5.5	1,428	0.84	50.1	C
	North	4.5	1,590	0.90	39.2	D
Madison Avenue between E 44th Street and E 45th Street	West	11	1,596	0.96	89.7	C
E 45th Street between 5th Avenue and Madison Avenue	South	5.5	1,723	0.93	46.0	C
	North	4.5	1,333	0.89	46.4	C
E 46th Street between 5th Avenue and Madison Avenue	South	4	1,986	0.88	26.6	D
E 53rd Street between 5th Avenue and Madison Avenue	South	5.5	933	0.89	64.1	C
	North	10.5	638	0.81	127.0	B
Vanderbilt Avenue between E 43rd Street and E 44th Street	East	4	1,407	0.80	34.7	D
E 43rd Street between Madison Avenue and Vanderbilt Avenue	North	3.5	1,567	0.79	26.1	D
Vanderbilt Avenue between E 44th Street and E 45th Street	East	9.5	1,899	0.89	69.8	C
Park Avenue between E 40th Street and E 41st Street	East	12	2,077	0.86	77.7	C
	West	9	3,482	0.93	36.7	D
Park Avenue between E 46th Street and E 47th Street	West	7	1,701	0.79	50.4	C
Park Avenue between E 49th Street and E 50th Street	West	7	2,078	0.83	43.2	C
E 40th Street between Lexington Avenue and 3rd Avenue	North	8	943	0.88	117.3	B
E 41st Street between Lexington Avenue and 3rd Avenue	South	7.5	1,905	0.92	56.6	C
E 42nd Street between Lexington Avenue and 3rd Avenue	North	9	3,026	0.84	38.0	D
Lexington Avenue between E 42nd Street and E 43rd Street	West	6.5	3,619	0.92	24.0	D
Lexington Avenue between E 43rd Street and E 44th Street	East	10	3,864	0.96	38.0	D
	West	7	5,067	0.91	17.2	E
E 43rd Street between Lexington Avenue and 3rd Avenue	North	7.5	1,591	0.84	61.9	C
	South	7.5	2,328	0.93	46.4	C

Note: SFP = square feet per pedestrian; Shading denotes significant adverse impact

## 2036 Lower Density Alternative Condition: Sidewalk Analysis

Location	Sidewalk	Effective Width (ft)	Two-way Peak Hour Volume	PHF	SFP	LOS
<b>Weekday AM Peak Hour</b>						
Lexington Avenue between E 44th Street and E 45th Street	East	4.5	2,566	0.84	21.2	E
	West	5	2,846	0.86	21.8	E
E 44th Street between Lexington Avenue and 3rd Avenue	North	5.5	1,342	0.82	52.1	C
	South	12	1,871	0.87	87.6	C
Lexington Avenue between E 45th Street and E 46th Street	East	6	2,734	0.98	32.5	D
	West	9	2,120	0.91	60.1	C
Lexington Avenue between E 46th Street and E 47th Street	East	13	1,956	0.85	89.3	C
	West	5.5	1,697	0.91	45.7	C
E 46th Street between Lexington Avenue and 3rd Avenue	North	5	909	0.85	73.3	C
Lexington Avenue between E 47th Street and E 48th Street	East	4.5	1,730	0.88	34.7	D
E 47th Street between Lexington Avenue and 3rd Avenue	South	4	659	0.88	83.7	C
Lexington Avenue between E 48th Street and E 49th Street	East	3	1,921	0.90	19.8	E
	West	13	912	0.64	143.6	B
E 48th Street between Park Avenue and Lexington Avenue	North	6.5	1,440	0.83	58.1	C
Lexington Avenue between E 49th Street and E 50th Street	East	11	2,284	0.90	68.0	C
	West	5	990	0.93	73.6	C
E 49th Street between Lexington Avenue and 3rd Avenue	North	6	540	0.89	156.2	B
E 49th Street between Park Avenue and Lexington Avenue	South	6	489	0.90	174.1	B
Lexington Avenue between E 50th Street and E 51st Street	East	6	2,984	0.87	35.6	D
	West	5	3,329	0.89	21.5	E
E 50th Street between Lexington Avenue and 3rd Avenue	North	5	346	0.82	188.4	B
	South	5.5	512	0.76	117.2	B
Lexington Avenue between E 51st Street and E 52nd Street	East	5	3,180	0.74	16.6	E
	West	10.5	1,902	0.91	79.3	C
E 51st Street between Lexington Avenue and 3rd Avenue	North	3.5	1,322	0.85	34.2	D
3rd Avenue between E 42nd Street and E 43rd Street	East	7.5	2,416	0.88	41.8	C
3rd Avenue between E 43rd Street and E 44th Street	East	8.5	3,214	0.89	35.8	D
3rd Avenue between E 44th Street and E 45th Street	East	4.5	2,729	0.87	20.3	E
3rd Avenue between E 51st Street and E 52nd Street	West	8.5	2,496	0.87	46.0	C
E 52nd Street between Lexington Avenue and 3rd Avenue	South	7.5	815	0.79	114.5	B
	North	7.5	959	0.57	70.3	C
3rd Avenue between E 52nd Street and E 53rd Street	East	6	3,275	0.89	23.6	D
	West	9	1,749	0.87	70.2	C
3rd Avenue between E 53rd Street and E 54th Street	West	7.5	1,881	0.85	52.8	C
3rd Avenue between E 55th Street and 56th Street	West	9	1,400	0.77	78.1	C
E 42nd Street between 3rd Avenue and 2nd Avenue	North	10.5	2,471	0.86	56.7	C
2nd Avenue between E 42nd Street and E 43rd Street	West	7	1,264	0.95	82.5	C
E 43rd Street between 3rd Avenue and 2nd Avenue	South	16.5	824	0.69	219.7	B

Note: SFP = square feet per pedestrian; Shading denotes significant adverse impact

## 2036 Lower Density Alternative Condition: Sidewalk Analysis

Location	Sidewalk	Effective Width (ft)	Two-way Peak Hour Volume	PHF	SFP	LOS
<b>Weekday Midday Peak Hour</b>						
E 39th Street between 5th Avenue and Madison Avenue	North	5	1,162	0.96	64.3	C
E 40th Street between 5th Avenue and Madison Avenue	South	5.5	2,621	0.91	28.5	D
	North	9	2,004	0.94	65.7	C
Madison Avenue between E 40th Street and E 41st Street	West	13	4,036	0.91	45.0	C
E 41st Street between 5th Avenue and Madison Avenue	South	6	1,633	0.95	54.4	C
E 43rd Street between 5th Avenue and Madison Avenue	North	4	1,666	0.89	32.2	D
E 44th Street between 5th Avenue and Madison Avenue	South	5.5	1,917	0.98	43.1	C
	North	4.5	1,278	0.94	51.7	C
Madison Avenue between E 44th Street and E 45th Street	West	11	2,714	0.81	50.8	C
E 45th Street between 5th Avenue and Madison Avenue	South	5.5	2,317	0.91	32.6	D
	North	4.5	1,708	0.94	37.8	D
E 46th Street between 5th Avenue and Madison Avenue	South	4	2,255	0.93	24.5	D
E 53rd Street between 5th Avenue and Madison Avenue	South	5.5	1,105	0.91	66.7	C
	North	10.5	1,057	0.81	121.5	B
Vanderbilt Avenue between E 43rd Street and E 44th Street	East	4	1,252	0.94	46.2	C
E 43rd Street between Madison Avenue and Vanderbilt Avenue	North	3.5	1,400	0.96	36.5	D
Vanderbilt Avenue between E 44th Street and E 45th Street	East	9.5	1,655	0.95	85.9	C
Park Avenue between E 40th Street and E 41st Street	East	12	1,300	0.91	132.9	B
	West	9	2,588	0.99	53.4	C
Park Avenue between E 46th Street and E 47th Street	West	7	1,706	0.57	35.4	D
Park Avenue between E 49th Street and E 50th Street	West	7	2,043	0.87	46.1	C
E 40th Street between Lexington Avenue and 3rd Avenue	North	8	1,055	0.95	113.2	B
E 41st Street between Lexington Avenue and 3rd Avenue	South	7.5	1,726	0.93	62.9	C
E 42nd Street between Lexington Avenue and 3rd Avenue	North	9	2,605	0.95	51.1	C
Lexington Avenue between E 42nd Street and E 43rd Street	West	6.5	3,245	0.96	28.6	D
Lexington Avenue between E 43rd Street and E 44th Street	East	10	3,477	0.94	41.7	C
	West	7	3,332	0.97	30.7	D
E 43rd Street between Lexington Avenue and 3rd Avenue	North	7.5	1,611	0.93	67.4	C
	South	7.5	1,856	0.85	53.6	C
<b>Note:</b> SFP = square feet per pedestrian; Shading denotes significant adverse impact						

## 2036 Lower Density Alternative Condition: Sidewalk Analysis

Location	Sidewalk	Effective Width (ft)	Two-way Peak Hour Volume	PHF	SFP	LOS
Weekday Midday Peak Hour						
Lexington Avenue between E 44th Street and E 45th Street	East	4.5	2,969	0.93	20.0	E
	West	5	2,741	0.94	25.1	D
E 44th Street between Lexington Avenue and 3rd Avenue	North	5.5	1,133	0.87	66.0	C
	South	12	1,862	0.88	89.6	C
Lexington Avenue between E 45th Street and E 46th Street	East	6	2,976	0.96	28.9	D
	West	9	2,372	0.91	53.8	C
Lexington Avenue between E 46th Street and E 47th Street	East	13	2,388	0.94	80.4	C
	West	5.5	2,194	0.89	33.9	D
E 46th Street between Lexington Avenue and 3rd Avenue	North	5	958	0.92	75.1	C
Lexington Avenue between E 47th Street and E 48th Street	East	4.5	1,644	0.88	36.6	D
E 47th Street between Lexington Avenue and 3rd Avenue	South	4	837	0.93	69.9	C
Lexington Avenue between E 48th Street and E 49th Street	East	3	1,650	0.98	26.3	D
	West	13	453	0.74	338.2	B
E 48th Street between Park Avenue and Lexington Avenue	North	6.5	1,051	0.94	91.1	B
Lexington Avenue between E 49th Street and E 50th Street	East	11	1,805	0.90	86.2	C
	West	5	708	0.61	67.4	C
E 49th Street between Lexington Avenue and 3rd Avenue	North	6	972	0.81	78.8	C
E 49th Street between Park Avenue and Lexington Avenue	South	6	826	0.87	99.9	B
Lexington Avenue between E 50th Street and E 51st Street	East	6	2,081	0.91	43.6	C
	West	5	2,376	0.83	26.5	D
E 50th Street between Lexington Avenue and 3rd Avenue	North	5	996	0.92	72.3	C
	South	5.5	799	0.81	78.8	C
Lexington Avenue between E 51st Street and E 52nd Street	East	5	2,829	0.92	24.4	D
	West	10.5	1,953	0.89	75.3	C
E 51st Street between Lexington Avenue and 3rd Avenue	North	3.5	1,114	0.89	43.1	C
3rd Avenue between E 42nd Street and E 43rd Street	East	7.5	2,871	0.90	35.9	D
3rd Avenue between E 43rd Street and E 44th Street	East	8.5	3,005	0.93	40.4	C
3rd Avenue between E 44th Street and E 45th Street	East	4.5	2,557	0.84	21.2	E
3rd Avenue between E 51st Street and E 52nd Street	West	8.5	2,634	0.90	44.2	C
E 52nd Street between Lexington Avenue and 3rd Avenue	South	7.5	2,080	0.89	49.6	C
	North	7.5	1,411	0.88	73.2	C
3rd Avenue between E 52nd Street and E 53rd Street	East	6	1,967	0.92	43.4	C
	West	9	2,280	0.88	54.1	C
3rd Avenue between E 53rd Street and E 54th Street	West	7.5	2,356	0.93	45.6	C
3rd Avenue between E 55th Street and 56th Street	West	9	1,360	0.77	80.5	C
E 42nd Street between 3rd Avenue and 2nd Avenue	North	10.5	2,469	0.88	58.4	C
2nd Avenue between E 42nd Street and E 43rd Street	West	7	1,621	0.95	64.0	C
E 43rd Street between 3rd Avenue and 2nd Avenue	South	16.5	1,024	0.80	205.2	B

Note: SFP = square feet per pedestrian; Shading denotes significant adverse impact

## 2036 Lower Density Alternative Condition: Sidewalk Analysis

Location	Sidewalk	Effective Width (ft)	Two-way Peak Hour Volume	PHF	SFP	LOS
Weekday PM Peak Hour						
E 39th Street between 5th Avenue and Madison Avenue	North	5	1,184	0.88	57.8	C
E 40th Street between 5th Avenue and Madison Avenue	South	5.5	1,835	0.93	42.7	C
	North	9	1,875	0.95	71.4	C
Madison Avenue between E 40th Street and E 41st Street	West	13	2,727	0.97	72.2	C
E 41st Street between 5th Avenue and Madison Avenue	South	6	1,348	0.96	66.9	C
E 43rd Street between 5th Avenue and Madison Avenue	North	4	2,780	0.87	17.2	E
E 44th Street between 5th Avenue and Madison Avenue	South	5.5	1,609	0.89	46.9	C
	North	4.5	2,037	0.94	31.3	D
Madison Avenue between E 44th Street and E 45th Street	West	11	2,419	0.96	68.6	C
E 45th Street between 5th Avenue and Madison Avenue	South	5.5	1,999	0.90	37.9	D
	North	4.5	1,990	0.94	32.0	D
E 46th Street between 5th Avenue and Madison Avenue	South	4	1,558	0.95	10.9	F
53rd Street between 5th Avenue and Madison Avenue	South	5.5	1,159	0.92	55.5	C
	North	10.5	809	0.86	126.9	B
Vanderbilt Avenue between E 43rd Street and E 44th Street	East	4	1,512	0.90	36.2	D
E 43rd Street between Madison Avenue and Vanderbilt Avenue	North	3.5	2,178	0.86	19.3	E
Vanderbilt Avenue between E 44th Street and E 45th Street	East	9.5	2,711	0.93	50.3	C
Park Avenue between E 40th Street and E 41st Street	East	12	2,341	0.84	67.8	C
	West	9	3,185	0.91	39.3	D
Park Avenue between E 46th Street and E 47th Street	West	7	1,555	0.92	64.9	C
Park Avenue between E 49th Street and E 50th Street	West	7	1,958	0.91	50.4	C
E 40th Street between Lexington Avenue and 3rd Avenue	North	8	891	0.90	127.2	B
E 41st Street between Lexington Avenue and 3rd Avenue	South	7.5	833	0.87	123.7	B
E 42nd Street between Lexington Avenue and 3rd Avenue	North	9	3,538	0.95	36.8	D
Lexington Avenue between E 42nd Street and E 43rd Street	West	6.5	4,591	0.91	17.8	E
Lexington Avenue between E 43rd Street and E 44th Street	East	10	3,123	0.95	46.9	C
	West	7	6,355	1.00	14.3	E
E 43rd Street between Lexington Avenue and 3rd Avenue	North	7.5	1,389	0.94	79.4	C
	South	7.5	1,715	0.89	60.7	C

Note: SFP = square feet per pedestrian; Shading denotes significant adverse impact

## 2036 Lower Density Alternative Condition: Sidewalk Analysis

Location	Sidewalk	Effective Width (ft)	Two-way Peak Hour Volume	PHF	SFP	LOS
<b>Weekday PM Peak Hour</b>						
Lexington Avenue between E 44th Street and E 45th Street	East	4.5	2,581	0.91	22.9	E
	West	5	3,601	0.93	17.9	E
E 44th Street between Lexington Avenue and 3rd Avenue	North	5.5	1,013	0.91	77.5	C
	South	12	2,251	0.92	76.7	C
Lexington Avenue between E 45th Street and E 46th Street	East	6	2,606	0.98	34.0	D
	West	9	2,706	0.95	49.2	C
Lexington Avenue between E 46th Street and E 47th Street	East	13	2,351	0.84	73.3	C
	West	5.5	1,276	0.71	47.4	C
E 46th Street between Lexington Avenue and 3rd Avenue	North	5	943	0.89	73.8	C
Lexington Avenue between E 47th Street and E 48th Street	East	4.5	1,815	0.88	32.9	D
E 47th Street between Lexington Avenue and 3rd Avenue	South	4	811	0.96	74.2	C
Lexington Avenue between E 48th Street and E 49th Street	East	3	2,470	0.82	12.2	E
	West	13	1,039	0.89	175.6	B
E 48th Street between Park Avenue and Lexington Avenue	North	6.5	1,670	0.95	57.9	C
Lexington Avenue between E 49th Street and E 50th Street	East	11	2,918	0.91	53.3	C
	West	5	1,507	0.76	38.5	D
E 49th Street between Lexington Avenue and 3rd Avenue	North	6	677	0.86	120.1	B
E 49th Street between Park Avenue and Lexington Avenue	South	6	627	0.92	138.9	B
Lexington Avenue between E 50th Street and E 51st Street	East	6	3,361	0.89	32.9	D
	West	5	2,510	0.92	31.2	D
E 50th Street between Lexington Avenue and 3rd Avenue	North	5	946	0.90	74.8	C
	South	5.5	688	0.89	103.1	B
Lexington Avenue between E 51st Street and E 52nd Street	East	5	2,961	0.96	20.8	E
	West	10.5	2,143	0.95	73.3	C
E 51st Street between Lexington Avenue and 3rd Avenue	North	3.5	1,274	0.93	39.0	D
3rd Avenue between E 42nd Street and E 43rd Street	East	7.5	2,484	0.95	44.5	C
3rd Avenue between E 43rd Street and E 44th Street	East	8.5	3,071	0.92	38.9	D
3rd Avenue between E 44th Street and E 45th Street	East	4.5	2,484	0.94	24.9	D
3rd Avenue between E 51st Street and E 52nd Street	West	8.5	2,684	0.89	43.6	C
E 52nd Street between Lexington Avenue and 3rd Avenue	South	7.5	812	0.80	116.6	B
	North	7.5	1,069	0.92	101.8	B
3rd Avenue between E 52nd Street and E 53rd Street	East	6	3,072	0.97	28.1	D
	West	9	2,249	0.93	57.7	C
3rd Avenue between E 53rd Street and E 54th Street	West	7.5	2,126	0.91	49.9	C
3rd Avenue between E 55th Street and 56th Street	West	9	1,448	0.77	74.7	C
E 42nd Street between 3rd Avenue and 2nd Avenue	North	10.5	2,689	0.85	51.9	C
2nd Avenue between E 42nd Street and E 43rd Street	West	7	1,293	0.95	80.6	C
E 43rd Street between 3rd Avenue and 2nd Avenue	South	16.5	1,039	0.94	236.0	B

Note: SFP = square feet per pedestrian; Shading denotes significant adverse impact



## 2036 Lower Density Alternative Condition: Corner Analysis

Location	Corner	Weekday AM Peak Hour		Weekday Midday Peak Hour		Weekday PM Peak Hour	
		SFP	LOS	SFP	LOS	SFP	LOS
5th Avenue and 42nd Street	Northeast	77.3	A	107.2	A	66.4	A
	Southeast	60.8	A	90.4	A	44.9	B
	Southwest	55.4	B	94.2	A	49.1	B
	Northwest	64.5	A	118.1	A	60.1	A
5th Avenue and 43rd Street	Northeast	36.0	C	36.1	C	21.1	D
	Southeast	31.8	C	35.2	C	24.8	C
	Southwest	39.3	C	36.6	C	26.4	C
	Northwest	36.0	C	32.9	C	17.0	D
5th Avenue and 44th Street	Northwest	47.6	B	36.7	C	22.9	D
	Southeast	38.9	C	35.0	C	27.3	C
	Southwest	51.7	B	37.6	C	32.2	C
5th Avenue and 45th Street	Southeast	43.1	B	34.1	C	31.9	C
Madison Avenue and E 40th Street	Southwest	39.1	C	33.5	C	47.7	B
	Northwest	36.9	C	35.7	C	45.7	B
Madison Avenue and E 41th Street	Southwest	43.2	B	24.5	C	35.6	C
	Northwest	66.7	A	53.6	B	61.8	A
Madison Avenue and E 42nd Street	Northeast	12.8	E	25.9	C	14.8	E
	Southwest	119.7	A	166.9	A	105.0	A
	Northwest	13.9	E	24.4	C	11.6	E
Madison Avenue and E 43rd Street	Northeast	4.9	F	13.6	E	10.0	E
	Southwest	19.2	D	24.1	C	16.6	D
	Northwest	37.2	C	41.1	B	18.9	D
Madison Avenue and E 44th Street	Southwest	41.3	B	32.5	C	29.0	C
	Northwest	52.1	B	52.3	B	40.9	B
Madison Avenue and E 45th Street	Northeast	7.4	F	7.8	F	4.5	F
	Southeast	13.9	E	16.2	D	11.3	E
	Southwest	35.5	C	27.3	C	22.8	D
	Northwest	52.0	B	44.6	B	42.0	B
Madison Avenue and E 46th Street	Southwest	48.2	B	36.7	C	45.6	B
Madison Avenue and E 53rd Street	Southwest	44.1	B	49.0	B	44.0	B
	Northwest	94.1	A	113.0	A	100.3	A
Vanderbilt Avenue and E 43rd Street	Northwest	UNSIGNALIZED		UNSIGNALIZED		UNSIGNALIZED	
Park Avenue Northbound and E 41st Street	Northeast	Plaza		Plaza		Plaza	
	Southeast	74.9	A	97.7	A	62.2	A
Park Avenue Southbound and E 46th Street	Southwest	41.4	B	55.1	B	49.6	B
	Northwest	33.0	C	30.4	C	23.7	D

Note: SFP = square feet per pedestrian

## 2036 Lower Density Alternative Condition: Corner Analysis

Location	Corner	Weekday AM Peak Hour		Weekday Midday Peak Hour		Weekday PM Peak Hour	
		SFP	LOS	SFP	LOS	SFP	LOS
Park Avenue Southbound and E 47th Street	Southwest	23.1	D	24.0	D	28.7	C
Park Avenue Southbound and E 48th Street	Northwest	29.7	C	29.1	C	29.7	C
Park Avenue Northbound and E 48th Street	Northeast	20.5	D	29.9	C	24.8	C
Park Avenue Southbound and E 49th Street	Southwest	26.2	C	36.4	C	26.1	C
	Northwest	14.8	E	34.3	C	29.4	C
Park Avenue Northbound and E 49th Street	Northeast	25.9	C	32.3	C	28.6	C
	Southeast	41.8	B	40.5	B	29.6	C
Park Avenue Southbound and E 50th Street	Southwest	22.7	D	33.4	C	25.3	C
	Northwest	28.2	C	37.9	C	30.0	C
Lexington Avenue and E 41st Street	Southeast	51.8	B	41.8	B	62.9	A
	Southwest	6.5	F	11.2	E	15.4	D
Lexington Avenue and E 42nd Street	Northeast	28.7	C	32.7	C	17.7	D
	Southeast	15.9	D	33.5	C	20.5	D
	Southwest	17.9	D	32.4	C	16.1	D
	Northwest	13.2	E	29.1	C	20.3	D
Lexington Avenue and E 43rd Street	Northeast	51.4	B	48.8	B	38.3	C
	Southeast	27.5	C	23.1	D	14.0	E
Lexington Avenue and E 44th Street	Northeast	24.6	C	27.2	C	28.6	C
	Southeast	58.4	B	68.3	A	65.8	A
Lexington Avenue and E 45th Street	Northeast	23.0	D	11.2	E	21.2	D
	Southeast	15.7	D	10.5	E	21.2	D
	Southwest	11.0	E	10.5	E	16.7	D
	Northwest	34.1	C	22.2	D	28.0	C
Lexington Avenue and E 46th Street	Northeast	46.2	B	31.8	C	35.1	C
	Southeast	19.4	D	13.4	E	20.9	D
	Southwest	27.0	C	25.6	C	33.0	C
	Northwest	28.9	C	24.7	C	25.7	C
Lexington Avenue and E 47th Street	Northeast	40.7	B	25.7	C	43.6	B
	Southeast	78.4	A	56.2	B	62.2	A
	Southwest	34.7	C	24.7	C	38.9	C
	Northwest	34.4	C	20.8	D	39.6	C
Lexington Avenue and E 48th Street	Northeast	33.5	C	38.1	C	27.5	C
	Southeast	31.5	C	30.4	C	25.6	C
	Southwest	31.7	C	38.8	C	44.6	B
	Northwest	42.2	B	67.4	A	50.8	B
Lexington Avenue and E 49th Street	Northeast	66.9	A	86.9	A	59.1	B
	Southeast	31.6	C	34.5	C	25.1	C
	Southwest	72.7	A	81.4	A	55.9	B
	Northwest	24.4	C	46.4	B	28.4	C
Lexington Avenue and E 50th Street	Northeast	13.8	E	18.3	D	18.3	D
	Southeast	29.2	C	43.0	B	30.5	C
	Southwest	10.0	E	25.8	C	11.3	E
	Northwest	14.7	E	31.2	C	19.2	D

Note: SFP = square feet per pedestrian

## 2036 Lower Density Alternative Condition: Corner Analysis

Location	Corner	Weekday AM Peak Hour		Weekday Midday Peak Hour		Weekday PM Peak Hour	
		SFP	LOS	SFP	LOS	SFP	LOS
		Lexington Avenue and E 51st Street	Northeast	10.3	E	25.8	C
	Southeast	24.0	C	27.4	C	25.8	C
	Southwest	28.1	C	20.5	D	39.6	C
	Northwest	42.0	B	51.9	B	56.3	B
Lexington Avenue and E 52nd Street	Northeast	107.4	A	131.8	A	141.9	A
	Southeast	26.7	C	25.4	C	36.0	C
	Southwest	60.0	A	44.4	B	66.1	A
	Northwest	366.0	A	369.6	A	440.8	A
Lexington Avenue and E 53rd Street	Southeast	177.5	A	81.9	A	159.1	A
3rd Avenue and E 42nd Street	Northeast	76.8	A	70.3	A	60.4	A
	Southeast	40.6	B	57.7	B	29.2	C
	Southwest	28.9	C	56.3	B	40.8	B
	Northwest	56.1	B	62.7	A	69.6	A
3rd Avenue and E 43rd Street	Northeast	22.4	D	16.0	D	14.4	E
	Southeast	15.3	D	21.1	D	18.1	D
	Southwest	9.4	E	11.2	E	17.1	D
	Northwest	10.0	E	7.1	F	7.0	F
3rd Avenue and E 44th Street	Northeast	37.0	C	42.9	B	31.5	C
	Southeast	30.8	C	48.5	B	41.3	B
3rd Avenue and E 45th Street	Northeast	39.6	C	27.4	C	35.4	C
	Southeast	37.6	C	35.5	C	44.3	B
3rd Avenue and E 48th Street	Northwest	127.9	A	124.1	A	107.5	A
3rd Avenue and E 49th Street	Southwest	371.0	A	312.8	A	286.9	A
	Northwest	352.7	A	294.5	A	264.1	A
3rd Avenue and E 51st Street	Northwest	21.7	D	29.1	C	26.8	C
3rd Avenue and E 52nd Street	Northeast	80.9	A	96.4	A	91.6	A
	Southwest	44.9	B	32.6	C	46.3	B
	Northwest	41.8	B	34.5	C	43.3	B
3rd Avenue and E 53rd Street	Southeast	24.3	C	20.5	D	24.4	C
	Southwest	33.6	C	21.5	D	27.8	C
	Northwest	29.5	C	23.8	D	30.1	C
3rd Avenue and E 54th Street	Southwest	72.9	A	64.6	A	63.6	A
	Northwest	292.0	A	231.2	A	241.7	A
3rd Avenue and E 55th Street	Southwest	86.7	A	63.9	A	82.2	A
	Northwest	83.8	A	61.0	A	71.2	A
3rd Avenue and E 56th Street	Southwest	42.0	B	26.7	C	44.0	B
2nd Avenue and E 42nd Street	Northeast	87.1	A	38.5	C	57.4	B
	Southwest	6.8	F	17.7	D	15.1	D
	Northwest	123.2	A	76.7	A	104.0	A
2nd Avenue and E 43rd Street	Southeast	52.4	B	42.0	B	63.4	A
	Southwest	47.2	B	30.4	C	52.3	B
	Northwest	58.4	B	33.4	C	47.4	B

Note: SFP = square feet per pedestrian

## 2036 Lower Density Alternative: Crosswalk Analysis

Location	Crosswalk	Crosswalk Length (ft)	Crosswalk Width (ft)	Two-way Peak Hour Volume	SFP	LOS
<b>Weekday AM Peak Hour</b>						
5th Avenue and 42nd Street	North	55	25	2,426	17.8	D
5th Avenue and 43rd Street	East	34	20	2,561	24.0	D
Madison Avenue and E 41st Street	West	34	16	2,400	22.6	D
Madison Avenue and E 43rd Street	North	54	13	2,172	8.9	E
	West	33.5	12	1,740	16.8	D
Madison Avenue and E 45th Street	South	54	13	1,912	12.2	E
Madison Avenue and E 53rd Street	North	55	15	1,330	13.7	E
	South	54	14.5	757	21.8	D
	West	35	14.5	1,036	34.7	C
Vanderbilt Avenue and E 43rd Street	North	33.5	13.5	881	UNSIGNALIZED	
Park Avenue Southbound and E 46th Street	West	30.5	14	2,127	15.2	D
Park Avenue Southbound and E 50th Street	West	30	14	2,455	12.4	E
Lexington Avenue and E 42nd Street	North	51	20	2,479	15.5	D
	East	60	13	1,908	22.1	D
	West	60	15	2,107	19.2	D
Lexington Avenue and E 43rd Street	East	34	14	1,782	30.5	C
	South	40	13.5	1,054	16.1	D
Lexington Avenue and E 44th Street	East	37	14	2,523	43.3	B
Lexington Avenue and E 45th Street	East	36	15.5	1,687	24.7	C
	West	41	10.5	2,041	14.4	E
Lexington Avenue and E 46th Street	East	32	14	1,943	21.4	D
	West	32	14	1,932	21.1	D
Lexington Avenue and E 47th Street	East	28	10	1,302	20.0	D
	South	52.5	14.5	729	16.6	D
Lexington Avenue and E 48th Street	North	50.5	13.5	791	38.3	C
	East	34	12	1,343	24.5	C
	West	30	12	1,493	16.0	D
Lexington Avenue and E 49th Street	East	30	12	1,619	20.7	D
	South	51	14	513	49.4	B
	West	30	10.5	1,502	15.4	D
Lexington Avenue and E 50th Street	North	51.5	12	1,415	17.7	D
	East	34	12	2,694	15.2	D
	West	34	16	2,769	18.2	D
Lexington Avenue and E 51st Street	North	51	14	1,915	13.0	E
Lexington Avenue and E 52nd Street	East	35.5	15	1,958	18.7	D
	West	34	18	1,652	29.0	C
3rd Avenue and E 42nd Street	North	69.5	20	1,228	9.7	E
	East	59	18	1,039	26.3	C
	South	70	20	2,536	17.5	D
	West	59	15	1,038	21.8	D
3rd Avenue and E 43rd Street	East	34	15	2,724	13.4	E
	South	70.5	15.5	1,898	18.1	D
3rd Avenue and E 44th Street	East	35	15.5	2,894	9.7	E
3rd Avenue and E 52nd Street	West	41	12.5	1,240	21.7	D
3rd Avenue and E 53rd Street	West	35.5	13.5	1,413	17.2	D
3rd Avenue and E 54th Street	West	33	16	682	51.5	B
3rd Avenue and E 55th Street	West	34	11.5	419	53.2	B
2nd Avenue and E 42nd Street	West	60	20	1,127	54.7	B

**Note:** SFP = square feet per pedestrian; Significant Adverse Impacts highlighted

## 2036 Lower Density Alternative: Crosswalk Analysis

Location	Crosswalk	Crosswalk Length (ft)	Crosswalk Width (ft)	Two-way Peak Hour Volume	SFP	LOS
Weekday Midday Peak Hour						
5th Avenue and 42nd Street	North	55	25	1,451	39.0	C
5th Avenue and 43rd Street	East	34	20	3,165	20.7	D
Madison Avenue and E 41st Street	West	34	16	2,648	15.0	E
Madison Avenue and E 43rd Street	North	54	13	1,347	17.0	D
	West	33.5	12	2,061	16.8	D
Madison Avenue and E 45th Street	South	54	13	2,089	11.3	E
Madison Avenue and E 53rd Street	North	55	15	1,241	24.2	C
	South	54	14.5	1,040	27.7	C
	West	35	14.5	1,423	31.0	C
Vanderbilt Avenue and E 43rd Street	North	33.5	13.5	436	UNSIGNALIZED	
Park Avenue Southbound and E 46th Street	West	30.5	14	1,567	24.6	C
Park Avenue Southbound and E 50th Street	West	30	14	1,999	18.9	D
Lexington Avenue and E 42nd Street	North	51	20	2,082	24.8	C
	East	60	13	1,953	22.0	D
	West	60	15	1,442	35.3	C
Lexington Avenue and E 43rd Street	East	34	14	1,975	29.1	C
	South	40	13.5	1,321	15.9	D
Lexington Avenue and E 44th Street	East	37	14	2,381	53.4	B
Lexington Avenue and E 45th Street	East	36	15.5	1,956	28.4	C
	West	41	10.5	1,425	20.0	D
Lexington Avenue and E 46th Street	East	32	14	2,302	16.8	D
	West	32	14	2,141	22.7	D
Lexington Avenue and E 47th Street	East	28	10	1,806	15.1	D
	South	52.5	14.5	917	11.4	E
Lexington Avenue and E 48th Street	North	50.5	13.5	697	44.8	B
	East	34	12	1,298	28.9	C
	West	30	12	1,336	26.3	C
Lexington Avenue and E 49th Street	East	30	12	1,344	30.6	C
	South	51	14	744	39.7	C
	West	30	10.5	1,155	27.5	C
Lexington Avenue and E 50th Street	North	51.5	12	1,124	23.8	D
	East	34	12	2,187	16.3	D
	West	34	16	1,448	39.5	C
Lexington Avenue and E 51st Street	North	51	14	1,337	28.8	C
Lexington Avenue and E 52nd Street	East	35.5	15	1,502	30.0	C
	West	34	18	1,841	28.1	C
3rd Avenue and E 42nd Street	North	69.5	20	1,381	10.7	E
	East	59	18	936	41.5	B
	South	70	20	1,865	32.2	C
	West	59	15	1,100	26.1	C
3rd Avenue and E 43rd Street	East	34	15	2,352	16.7	D
	South	70.5	15.5	1,634	23.1	D
3rd Avenue and E 44th Street	East	35	15.5	1,788	19.4	D
3rd Avenue and E 52nd Street	West	41	12.5	1,325	24.2	C
3rd Avenue and E 53rd Street	West	35.5	13.5	2,044	13.6	E
3rd Avenue and E 54th Street	West	33	16	853	53.0	B
3rd Avenue and E 55th Street	West	34	11.5	591	51.9	B
2nd Avenue and E 42nd Street	West	60	20	1,113	52.9	B

Note: SFP = square feet per pedestrian; Significant Adverse Impacts highlighted

## 2036 Lower Density Alternative: Crosswalk Analysis

Location	Crosswalk	Crosswalk Length (ft)	Crosswalk Width (ft)	Two-way Peak Hour Volume	SFP	LOS
<b>Weekday PM Peak Hour</b>						
5th Avenue and 42nd Street	North	55	25	2,808	19.0	D
5th Avenue and 43rd Street	East	34	20	3,714	14.7	E
Madison Avenue and E 41st Street	West	34	16	2,636	20.3	D
Madison Avenue and E 43rd Street	North	54	13	2,455	8.5	E
	West	33.5	12	2,504	11.7	E
Madison Avenue and E 45th Street	South	54	13	2,723	8.9	E
Madison Avenue and E 53rd Street	North	55	15	1,114	21.3	D
	South	54	14.5	1,100	20.9	D
	West	35	14.5	1,434	30.8	C
Vanderbilt Avenue and E 43rd Street	North	33.5	13.5	896	UNSIGNALIZED	
Park Avenue Southbound and E 46th Street	West	30.5	14	2,307	14.0	E
Park Avenue Southbound and E 50th Street	West	30	14	2,219	16.4	D
Lexington Avenue and E 42nd Street	North	51	20	3,025	14.1	E
	East	60	13	1,889	19.6	D
	West	60	15	1,868	21.7	D
Lexington Avenue and E 43rd Street	East	34	14	2,086	23.4	D
	South	40	13.5	1,661	10.4	E
Lexington Avenue and E 44th Street	East	37	14	2,068	57.4	B
Lexington Avenue and E 45th Street	East	36	15.5	1,533	34.6	C
	West	41	10.5	2,063	14.5	E
Lexington Avenue and E 46th Street	East	32	14	1,977	19.7	D
	West	32	14	1,935	22.9	D
Lexington Avenue and E 47th Street	East	28	10	1,403	19.0	D
	South	52.5	14.5	776	11.3	E
Lexington Avenue and E 48th Street	North	50.5	13.5	1,008	32.4	C
	East	34	12	1,525	20.7	D
	West	30	12	1,383	24.8	C
Lexington Avenue and E 49th Street	East	30	12	1,823	17.9	D
	South	51	14	586	44.1	B
	West	30	10.5	1,930	13.5	E
Lexington Avenue and E 50th Street	North	51.5	12	1,267	23.8	D
	East	34	12	2,875	15.8	D
	West	34	16	2,776	18.2	D
Lexington Avenue and E 51st Street	North	51	14	1,733	18.7	D
Lexington Avenue and E 52nd Street	East	35.5	15	1,675	24.4	C
	West	34	18	1,743	31.7	C
3rd Avenue and E 42nd Street	North	69.5	20	1,537	9.5	E
	East	59	18	1,097	30.7	C
	South	70	20	2,996	14.9	E
	West	59	15	1,019	28.7	C
3rd Avenue and E 43rd Street	East	34	15	2,574	15.5	D
	South	70.5	15.5	1,468	23.4	D
3rd Avenue and E 44th Street	East	35	15.5	2,575	13.9	E
3rd Avenue and E 52nd Street	West	41	12.5	1,340	25.4	C
3rd Avenue and E 53rd Street	West	35.5	13.5	1,592	18.5	D
3rd Avenue and E 54th Street	West	33	16	833	43.5	B
3rd Avenue and E 55th Street	West	34	11.5	510	42.9	B
2nd Avenue and E 42nd Street	West	60	20	961	49.6	B

Note: SFP = square feet per pedestrian; Significant Adverse Impacts highlighted

---

# Appendix I.6

## Lesser Density Alternative Parking Accumulation



**Lesser Density Alternative - Net Incremental Weekday Hourly Parking Accumulation by Land Use**

<b>Time Period</b>	<b>Office</b>	<b>Local Retail</b>	<b>Destination Retail</b>	<b>Hotel</b>	<b>Residential</b>	<b>Total</b>
12 AM - 1 AM	0	0	0	-80	-12	-92
1 AM - 2 AM	0	0	0	-83	-12	-95
2 AM - 3 AM	0	0	0	-83	-12	-95
3 AM - 4 AM	0	0	0	-83	-12	-95
4 AM - 5 AM	0	0	0	-83	-12	-95
5 AM - 6 AM	0	0	0	-83	-12	-95
6 AM - 7 AM	0	0	0	-83	-12	-95
7 AM - 8 AM	53	1	0	-82	-11	-39
8 AM - 9 AM	722	1	1	-69	-8	647
9 AM - 10 AM	1,222	2	2	-59	-7	1,160
10 AM - 11 AM	1,176	3	5	-53	-7	1,124
11 AM - 12 PM	1,155	3	8	-47	-7	1,112
12 PM - 1 PM	1,146	3	10	-55	-7	1,097
1 PM - 2 PM	1,153	3	11	-48	-7	1,113
2 PM - 3 PM	1,180	3	10	-39	-7	1,147
3 PM - 4 PM	1,230	3	10	-29	-7	1,207
4 PM - 5 PM	878	3	9	-22	-8	860
5 PM - 6 PM	114	3	8	-51	-10	64
6 PM - 7 PM	20	3	7	-39	-11	-20
7 PM - 8 PM	7	1	8	-56	-12	-52
8 PM - 9 PM	1	0	6	-66	-13	-71
9 PM - 10 PM	1	0	0	-71	-12	-82
10 PM - 11 PM	1	0	0	-75	-12	-86
11 PM - 12 AM	1	0	0	-80	-12	-91