

# ISAACS HOUSES

## DEVELOPMENT INFORMATION



Total Buildings: **4**



Buildings benefiting from FEMA funding: **4**



Property Size: **3.49 acres**

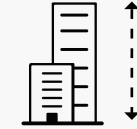

Building heights: **24 stories**

### Legend

- Existing Funded Buildings
- Annex Buildings

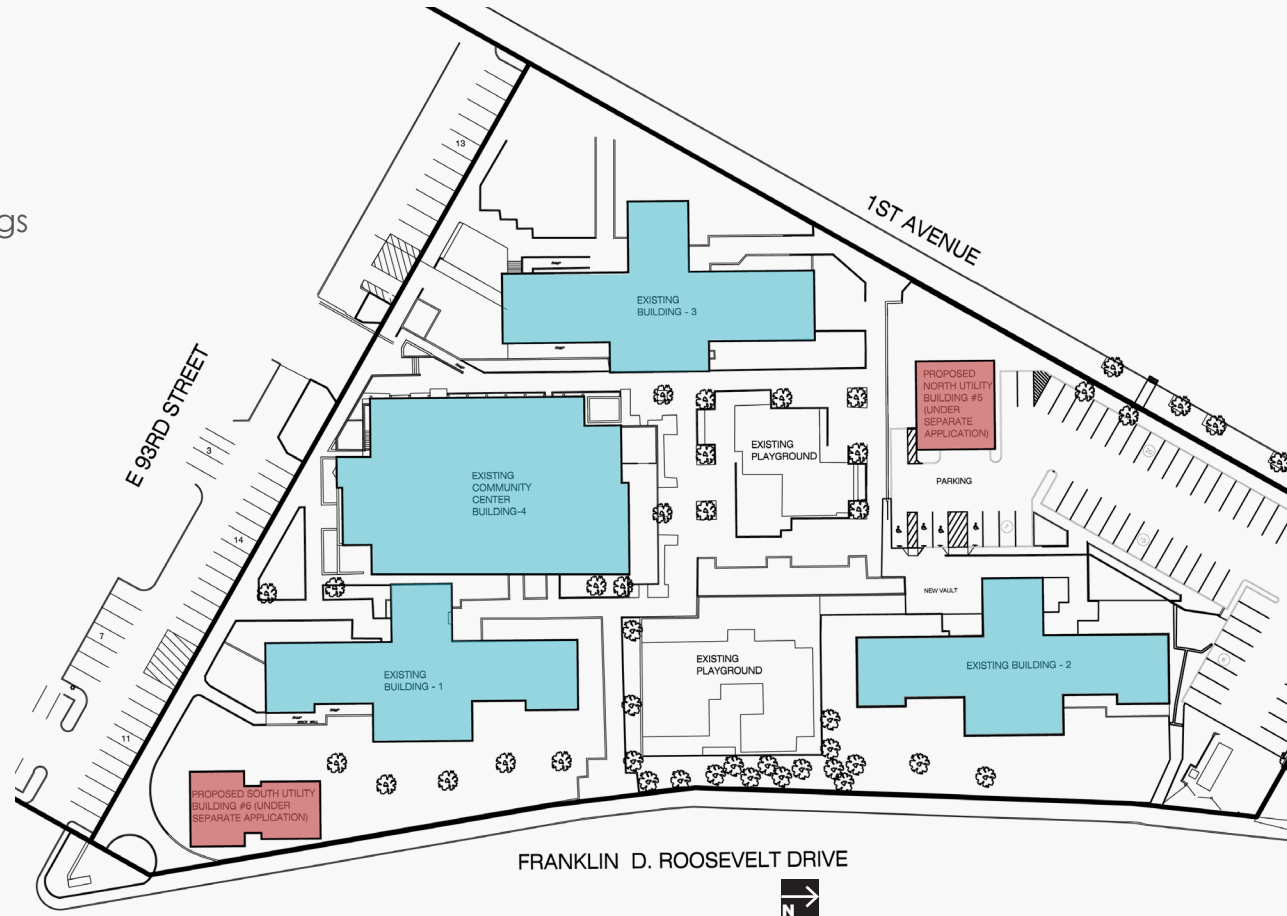

**RECOVERY & RESILIENCE**

NYCHA'S SUPERSTORM SANDY RECOVERY PROGRAM

[tinyurl.com/SANDYRECOVERY](http://tinyurl.com/SANDYRECOVERY)  
 (212) 306-8532 — [disaster.recovery@nycha.nyc.gov](mailto:disaster.recovery@nycha.nyc.gov)  
 Capital Projects Division Recovery and Resilience



# PROJECT SCOPE

- **Resiliency**
  - Wet flood proof areas below the FEMA flood level in Building #2
- **Safety**
  - Install upgraded door security access systems per funding availability
  - Replace exterior site lighting fixtures and bulbs
- **Development Improvements**
  - Restore one (1) playground
  - Resurface site pavement affected by construction
  - Partially replace underground electrical wiring system
  - Resurface and reprogram on-site parking lot
- **Building Improvements**
  - Construct two new MEP Annexes above the FEMA flood level to serve all buildings and house the new ventilation fans, electric unit heaters, exhaust system for generators, intake and discharge louvers, sound attenuators, full back-up power generators, new electrical/distribution system, new current transformer cabinet, and automatic transfer switches
  - Repair/replace mechanical, electrical and plumbing equipment at building 2 including new condensate vacuum pump and new instantaneous hot water heater in new underground water-proofed vault, replace damaged heating valves, pipe insulation and new unit heater
  - Replace sump pump and sewage ejector pump, new back water valves, and house trap on sanitary mains and floor drains
  - Replace and/or repair doors, door frames, hardware damaged by water
  - Repair/replace MEP at buildings 1, 3 and 4 with new ventilation fans, electric unit heaters and toilet exhaust fans along with associated ductwork in building 3
  - Install new electrical equipment room including main distribution boards in building 3
  - Install new water-tight pull boxes in building 1 cellar
- **Energy**
  - Install full backup power generators at MEP annexes to service buildings 1, 2, 3 and 4
  - Implement additional sitewide energy and sustainability measures (awaiting HUD approval)



**RECOVERY** — & — **RESILIENCE**

NYCHA'S SUPERSTORM SANDY RECOVERY PROGRAM

NYCHA's Recovery & Resilience Department  
Questions/Problems, 疑问/家里的问题,  
Вопросы / проблемы, Preguntas/Problemas  
(212) 306-8532 — [disaster.recovery@nycha.nyc.gov](mailto:disaster.recovery@nycha.nyc.gov)

