

HAMMEL

DEVELOPMENT INFORMATION



Total Buildings: **14**



Buildings benefiting from FEMA funding: **14**



Property Size: **14.16 acres**

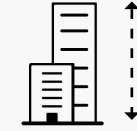

Building heights: **7 stories**

Legend

- Renovated Boiler Annex
- Electrical Rooms
- Back-up Generators
- Renovated Community Center

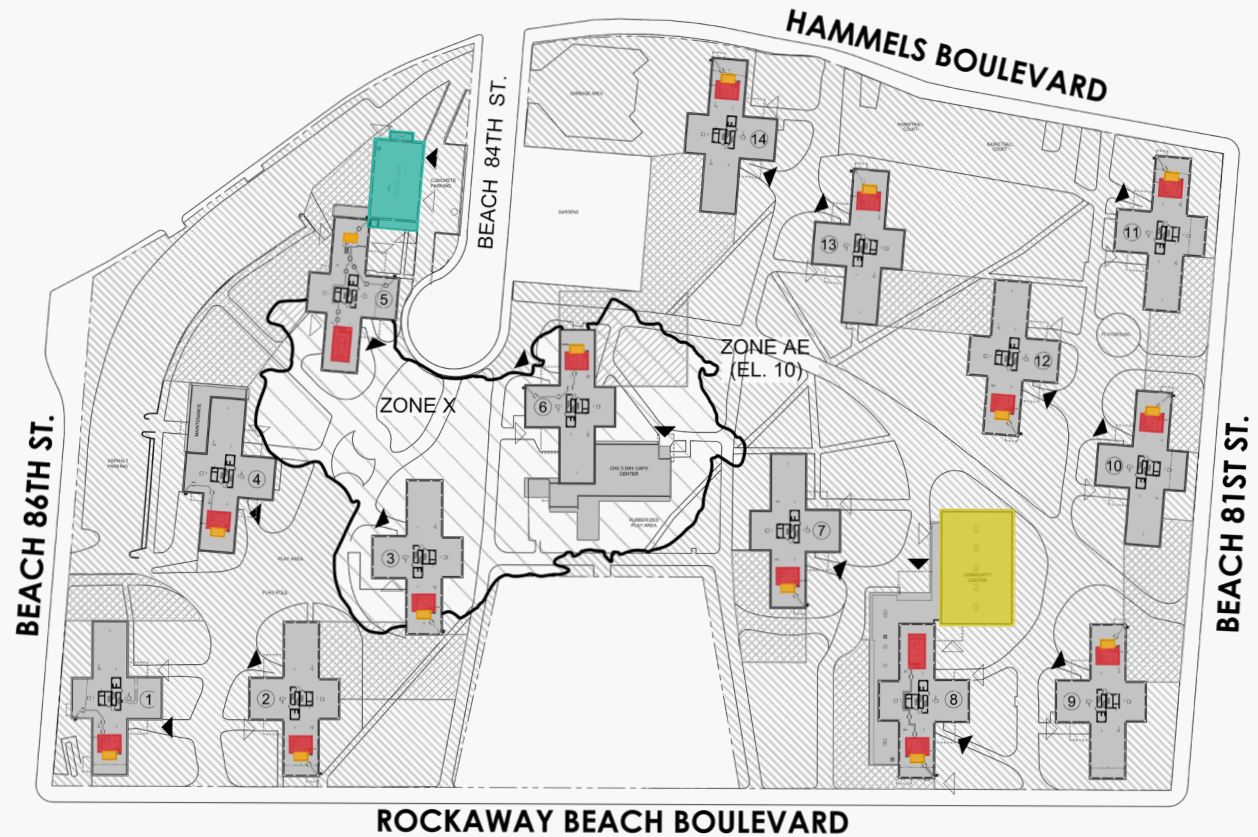

RECOVERY & RESILIENCE

NYCHA'S SUPERSTORM SANDY RECOVERY PROGRAM

tinyurl.com/SANDYRECOVERY
 (212) 306-8532 — disaster.recovery@nycha.nyc.gov
 Capital Projects Division Recovery and Resilience



PROJECT SCOPE

- **Resiliency**
 - Dry flood proof all building areas below the FEMA flood level
 - Install new boilers at existing boiler room above FEMA flood elevation
- **Safety**
 - Install new security cameras per funding availability
 - Install upgraded door security access systems per funding availability
 - Replace exterior site lighting fixtures and interior stairwell lighting fixtures
- **Development Improvements**
 - Restore four (4) playgrounds
 - Resurface site pavement affected by construction
- **Building Improvements**
 - Replace first floor doors, door frames, and hardware damaged by water
 - Replace and elevate the electrical conduits and plumbing pipes damaged by below ground water
 - Install new mechanical, electrical, and plumbing systems located above the FEMA flood level
 - Replace roofs on all 14 buildings
 - Reconfigure crawl spaces to prevent water infiltration
 - Remove hazardous materials and clean building crawl spaces
- **Energy**
 - Install full backup power generators on the roofs of all 14 buildings
 - Implement additional sitewide energy and sustainability measures (awaiting HUD approval)



RECOVERY — & — **RESILIENCE**

NYCHA'S SUPERSTORM SANDY RECOVERY PROGRAM

NYCHA's Recovery & Resilience Department
Questions/Problems, 疑问/家里的问题,
Вопросы / проблемы, Preguntas/Problemas
(212) 306-8532 — disaster.recovery@nycha.nyc.gov

