

# THE CITY OF NEW YORK MANHATTAN COMMUNITY BOARD 3

59 East 4th Street - New York, NY 10003

Phone (212) 533-5300

[www.cb3manhattan.org](http://www.cb3manhattan.org) - [mn03@cb.nyc.gov](mailto:mn03@cb.nyc.gov)

Andrea Gordillo, Board Chair

Susan Stetzer, District Manager

## Community Board 3 Liquor License Application Questionnaire

**NOTE: ALL ITEMS MUST BE SUBMITTED FOR APPLICATION TO BE CONSIDERED.**

**The following items and questionnaire package are due by date listed in email invite:**

- ☐ Schematics, floor plans or architectural drawings of the inside of the premise.
- ☐ A proposed food and or drink menu.

**The following items are due by noon Friday before the meeting:**

- ☐ Petition in support of proposed business or change in business with signatures from residential tenants at location and in buildings adjacent to, across the street from and behind proposed location. Petition must give proposed hours and method of operation. For example: restaurant, sports bar, combination restaurant/bar. (petition provided)
- ☐ Notice of proposed business to block or tenant association if one exists. You can find community groups and contact information on the CB 3 website:  
<https://www1.nyc.gov/site/manhattancb3/resources/community-groups.page>  
(this is not required but strongly suggested if a relevant group exists)
- ☐ Proof of conspicuous posting of notices at the site for 7 days prior to the meeting (please include newspaper with date in photo or a timestamped photo).

Check which you are applying for:

- ☒ new liquor license    ☐ alteration of an existing liquor license    ☐ corporate change

Check if either of these apply:

- ☐ sale of assets    ☐ upgrade (change of class) of an existing liquor license

Today's Date: October 2025

Is location currently licensed? ☒ Yes ☐ No    Type of license: On premises liquor

If alteration, describe nature of alteration: \_\_\_\_\_

Previous or current use of the location: Tavern

Corporation and trade name of current license: Owlings Inc d/b/a Kind Regards

### **APPLICANT:**

Premise address: 152 Ludlow Street

Cross streets: Stanton and Rivington

Name of applicant and all principals: Small Town Creative LLC

Michael Bray

Trade name (DBA): Kind Regards

**PREMISE:**

Type of building and number of floors: 7 story mixed use

Does premise have a valid Certificate of Occupancy, including for any back/side yard or roof use?

☒ Yes ☐ No What is maximum NUMBER of people permitted 74

What is the zoning designation (check zoning using map: <http://gis.nyc.gov/doitt/nycitymap/> - please give specific zoning designation, such as R8 or C2): C4-4A

**PROPOSED METHOD OF OPERATION:**

What are the proposed days/hours of operation? (Specify days and hours each day and hours of outdoor space, if applicable) 7 days a week

5:00pm-4:00am

Will any other business besides food or alcohol service be conducted at premise, i.e., retail? ☐ Yes ☒ No

If yes, please describe what type: \_\_\_\_\_

Number of indoor tables? 12 Total number of indoor seats? 29

How many stand-up bars/bar seats are located on the premise (number, length, and location) \_\_\_\_\_

Two/22 stools - First floor: approximately 20'X4' / Cellar: approximately 22'X6'

(A **stand-up bar** is any bar or counter -with seating or not- where you can order, pay for, and receive alcohol)

Does premise have a full kitchen? ☐ Yes ☒ No

Does it have a food preparation area? ☒ Yes ☐ No (If any, show on diagram)

Is food available for sale? ☒ Yes ☐ No If yes, describe type of food and submit a menu \_\_\_\_\_

New American

What are the hours the kitchen will be open? All hours of operation

Will a manager or principal always be on site? ☒ Yes ☐ No If yes, which? \_\_\_\_\_

How many employees will there be? 20-23

Do you have or plan to install ☐ French doors ☐ accordion doors or ☐ windows?

Will there be TVs/monitors? ☐ Yes ☒ No (If Yes, how many?) \_\_\_\_\_

Will premise have music? ☒ Yes ☐ No

If Yes, what type of music? ☒ Live musician ☒ DJs ☒ Streaming services/playlists

If other type, please describe \_\_\_\_\_

What will be the music volume? ☒ Background (conversational) ☐ Entertainment (live music venue level) Please describe your sound system: lpad generated small speakers

Will you host any promoted events, scheduled performances, or any event at which a cover fee is charged? If Yes, what type of events or performances are proposed and how often? \_\_\_\_\_

If promoted events, please explain the nature in which you plan to promote? Social media / online ads / outside promoters? \_\_\_\_\_

How do you plan to manage vehicular traffic and crowds on the sidewalk caused by your establishment? Please attach plans. (Please do not answer "we do not anticipate congestion.") Security will ensure that traffic and crowds are not an issue for our neighbors

Will there be security personnel? ☒ Yes ☐ No (If Yes, how many and when) 4-5, Thursday-Saturday

How do you plan to manage noise inside and outside your business so neighbors will not be affected? Please attach plans. Security will control these premises, as it has for the entire operation of these premises

Is sound proofing installed? ☒ Yes ☐ No and management and security will monitor the interior of the premises, so as not to disturb my neighbors

If not, do you plan to install sound proofing? ☐ Yes ☐ No

Are there current plans to use the Open Restaurants program for the sale or consumption of alcoholic beverages outdoors? (includes roof & yard) ☐ Yes ☒ No If Yes, describe and show on diagram:

#### APPLICANT HISTORY:

Has this corporation or any principal been licensed for sale of alcohol previously? ☒ Yes ☐ No  
Owlings Inc 0340-22-103830/116 Ave C Rest 0340-22-104089/

If yes, please indicate name of establishment: Gale Dinners LLC 0340-24-115330

Address: 152 Ludlow Street/116 Avenue C/85 Orchard Street Community Board # 3

Dates of operation: 2005-present/2021-Present/2023-Present

Has any principal had work experience similar to the proposed business? ☒ Yes ☐ No If Yes, please attach explanation of experience or resume. Note: failure to disclose previous experience or information hampers the ability to evaluate this application.

Does any principal have other businesses in this area? ☐ Yes ☒ No If Yes, please give trade name, address and describe the business \_\_\_\_\_

Has any principal had SLA reports or action within the past 5 years? ☐ Yes ☐ No If Yes, attach list of violations and dates of violations and outcomes, if any.

Attach a separate diagram that indicates the location (**name and address**) and total number of establishments selling/serving beer, wine (B/W) or liquor (OP) for 2 blocks in each direction. Please indicate whether establishments have On-Premise (OP) licenses. Please label streets and avenues and identify your location. Use letters to indicate **Bar**, **Restaurant**, etc. The diagram must be submitted with the questionnaire to the Community Board before the meeting.

**LOCATION:**

How many licensed establishments are within 1 block? See attached

How many On-Premise (OP) liquor licenses are within 500 feet? See attached

Is the premise within 200 feet on the same street of any school or place of worship? ☐ Yes ☒ No

**COMMUNITY OUTREACH:**

Please see the Community Board website to find block associations or tenant associations in the immediate vicinity of your location for community outreach. Applicants are encouraged to reach out to community groups, but it is not required. Also use provided petitions, which clearly state the name, address, license for which you are applying, and the hours and method of operation of your establishment at the top of each page. (Attach additional sheets of paper as necessary)

***We are including the following questions to be able to prepare stipulations and have the meeting be faster and more efficient. Please answer per your business plan; do not plan to negotiate at the meeting.***

1. My license type is: ☐ beer & cider ☐ wine, beer & cider ☒ liquor, wine, beer & cider
2. ☐ I will operate a full-service restaurant, specifically a (type of restaurant) \_\_\_\_\_ restaurant, or  
☒ I will operate a Tavern \_\_\_\_\_,  
☐ with a kitchen open and serving food during all hours of operation OR ☒ with less than a full-service kitchen but serving food during all hours of operation OR ☐ Other \_\_\_\_\_
3. My hours of operation will be:  
Mon 5:00pm-4:00am; Tue 5:00pm-4:00am; Wed 5:00pm-4:00am;  
Thu 5:00pm-4:00am; Fri 5:00pm-4:00am; Sat 5:00pm-4:00am;  
Sun 5:00pm-4:00am. (I understand opening is "no later than" specified opening hour, and all patrons are to be cleared from business at specified closing hour.)
4. ☒ I will not use outdoor space for commercial use (including Open Restaurants) OR  
☐ I will close all outdoor dining allowed under the temporary Open Restaurants program and any other subsequent uses by 10:00 P.M. all days and not have any speakers or TV monitors outdoors
5. ☒ I will employ a doorman/security personnel: \_\_\_\_\_
6. ☐ I will install soundproofing, \_\_\_\_\_

7. ☒ I will close any front or rear façade doors and windows at 10:00 P.M. every night or when amplified sound is playing, including but not limited to DJs, live music and live nonmusical performances, or during unamplified performances or televised sports. ☐ I will have a closed fixed façade with no open doors or windows except my entrance door, which will close by 10:00 P.M. or when amplified sound is playing, including but not limited to DJs, live music and live nonmusical performances, or during unamplified performances or televised sports.
8. I will not have ☐ DJs, ☐ live music, ☒ third-party promoted events, ☐ any event at which a cover fee is charged, ☐ scheduled performances, ☐ more than \_\_\_\_\_ DJs per \_\_\_\_\_, ☐ more than \_\_\_\_\_ private parties per \_\_\_\_\_
9. ☐ I will play ambient recorded background music only.
10. ☒ I will not apply for an alteration to the method of operation or for any physical alterations of any nature without first coming before CB 3.
11. ☒ I will not seek a change in class to a full on-premises liquor license without first obtaining approval from CB 3.
12. ☒ I will not participate in pub crawls or have party buses come to my establishment.
13. ☒ I will not have unlimited drink specials, including boozy brunches, with food.
14. ☐ I will not have a happy hour or drink specials with or without time restrictions OR ☒ I will have happy hour and it will end by 7:00pm.
15. ☐ I will not have wait lines outside. ☐ I will have a staff person responsible for ensuring no loitering, noise or crowds outside.
16. ☒ I will conspicuously post this stipulation form beside my liquor license inside of my business.
17. ☒ Residents may contact the manager/owner at the number below. Any complaints will be addressed immediately. I will revisit the above-stated method of operation if necessary in order to minimize my establishment's impact on my neighbors.

Name: Michael Bray

Phone Number: (646) 379-6244

Menu 152 Ludlow

**FOOD**

*Pinxcho*

2 pieces per order 12

- Sardine, preserved tomato, black garlic
- Pickled crab,crème fraiche, dill
- Mussels, fennel

*Pressed Francesinha 14*

Roasted pork, cheese, potato

*Valentina Roll 14*

Mortadella, provolone hot roasted peppers

*House Caesar 17*

Vegan miso, croissant breadcrumb

*Roasted Carrots 14*

Black Olive tapenade, raddichio, toasts

Marcona almonds

Olives

Bread and butter

All 7 each

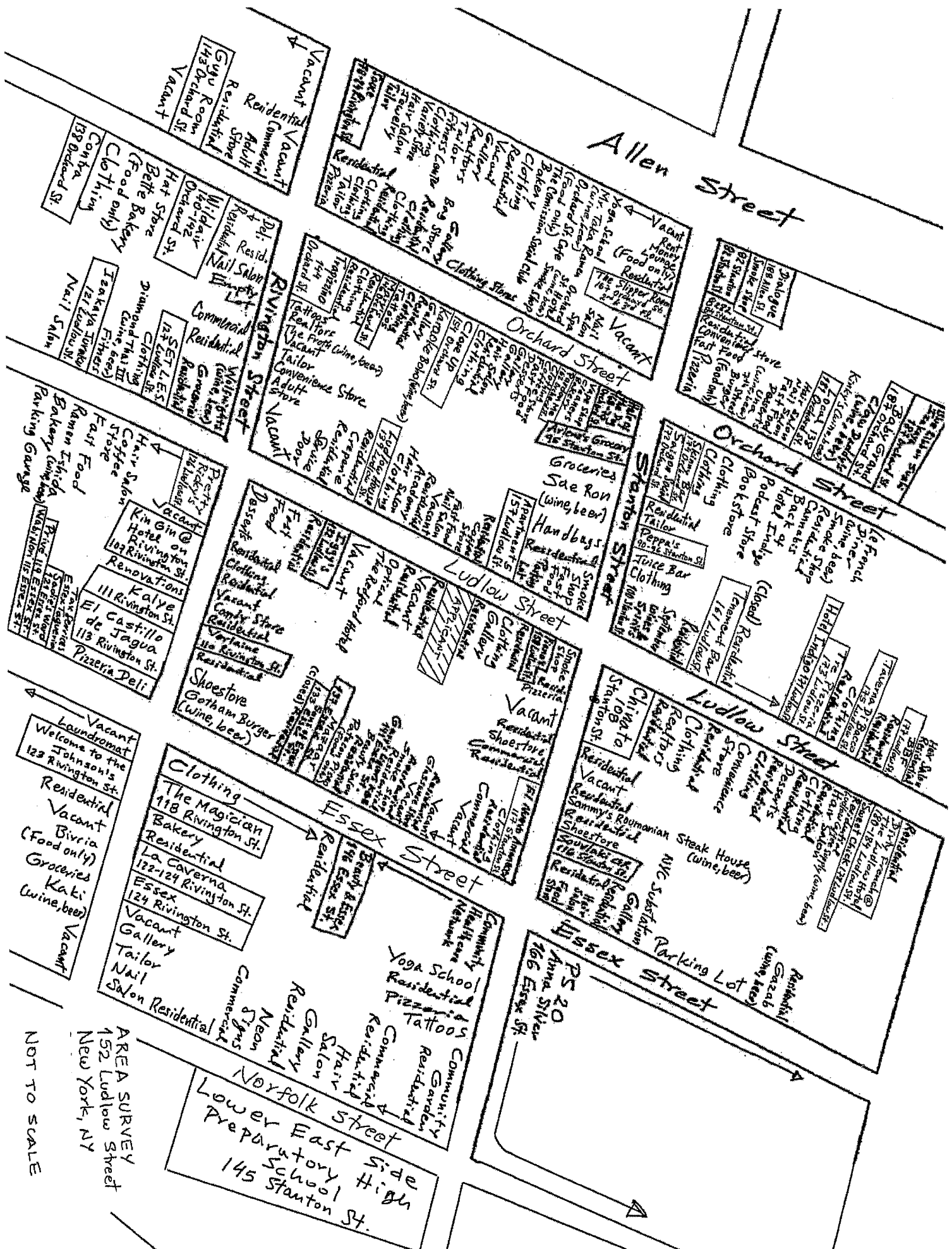

# Landess-Simon, Inc.

Legal & Commercial Photography

45 Lawlins Park  
Wyckoff, NJ 07481  
Phone: (201) 848-5652  
E-mail: landess@att.net  
landessphotographers.com

Re: 152 Ludlow Street

1. Dirty French @ The Ludlow Hotel - 180-184 Ludlow Street - (441')
2. Souvlaki GR - 116 Stanton Street - (218')
3. Beauty & Essex - 146 Essex Street - (264')
4. Piano's - 158 Ludlow Street - (85')
5. Local 138 - 181 Orchard Street - (410')
6. Iggy's - 132 Ludlow Street - (222')
7. Verlaine - 110 Rivington Street - (308')
8. Sweet Chick - 178 Ludlow Street - (365')
9. Sons of Essex - 133 Essex Street - (261')
10. Mazaar - 137 Essex Street - (229')
11. BBF - 177 Ludlow Street - (420')
12. Apartment 5 - 157 Ludlow Street - (58')
13. Arlene's Grocery - 95 Stanton Street - (206')
14. Hair of the Dog - 168-70 Orchard Street - (243')
15. Close Up - 154 Orchard Street - (245')
16. Taverna Di Bacco - 175 Ludlow Street - (392')
17. Tenement Bar - 161 Ludlow Street - (219')
18. Sauce - 78-84 Rivington Street - (450')
19. The Slipper Room - 167 Orchard Street - (323')
20. 82 Stanton - 82 Stanton Street - (403')
21. Blue Ribbon Sushi Izakaya - 187 Orchard Street - (484')
22. Tre Pizzeria - 173 Ludlow Street - (357')
23. Hotel Indigo - 171 Ludlow Street - (334')
24. Peppa's - 90-96 Stanton Street - (205')
25. Saigon Social - 172 Orchard Street - (280')
26. Skinny Bar - 174 Orchard Street - (315')
27. 8282 - 84 Stanton Street - (373')
28. Baby Grand - 187 Orchard Street - (475')

/Next Page

# Landess-Simon, Inc.

## Legal & Commercial Photography

45 Lawlins Park  
Wyckoff, NJ 07481  
Phone: (201) 848-5652  
E-mail: landess@att.net  
landessphotographers.com

Re: 152 Ludlow Street

---

29. Trapizzino - 144 Orchard Street - (350')
30. Ludlow House - 139 Ludlow Street - (160')
31. Pretty Ricky's - 126 Ludlow Street - (331')
32. El Nuevo Amanecer - 117 Stanton Street - (215')
33. Chinato - 108 Stanton Street - (170')
34. Dialogue - 188 Allen Street - (468')
35. Pardon Me - 162 Orchard Street - (225')
36. Mary's - 146 Orchard Street - (295')
37. The Magician - 118 Rivington Street - (395')
38. La Caverna - 122-124 Rivington Street - (425')
39. Essex - 124 Rivington Street - (437')
40. Welcome to the Johnson's - 123 Rivington Street - (455')
41. Kin Gin @ Hotel on Rivington - 107 Rivington Street - (338')
42. Kalye - 111 Rivington Street - (351')
43. El Castillo de Jagua - 113 Rivington Street - (359')
44. Sadie's Ward - 121 Essex Street - (435')
45. Prive' - 119 Essex Street - (452')
46. Wabi Nori - 115 Essex Street - (497')
47. Set L.E.S. - 127 Ludlow Street - (424')
48. Izakaya Iuraku - 121 Ludlow Street - (475')
49. Contra - 138 Orchard Street - (496')
50. Wildair - 140-142 Orchard Street - (463')
51. Gugu Room - 143 Orchard Street - (482')

## Schools & Churches

1. P.S. 20 Anna Silver - 166 Essex Street - (352')
2. Lower East Side Preparatory High School - 145 Stanton Street - (485')

Smoke Shop
Fast Food
Parking Lot
Apartment 5 157 Ludlow St.
Residential
Coffee Store
Fast Food
Nail Salon
Vacant
Residential
Academy
Hair Salon
Clothing
Ludlow House 139 Ludlow St.
Residential
Creperie
Residential
Service Door
Vacant

Ludlow Street

NOT TO SCALE

BLOCK PLOT  
152 Ludlow Street  
New York, NY

Stanton Street
Smoke Shop
Piano's 158 Ludlow St.
Residential
Clothing
Gallery
Residential
APPLICANT
Residential
Vacant
Residential
Optical
The Redford Hotel
Vacant
Iggy's 132 Ludlow St.
Residential
Fast Food
Desserts
Rivington Street

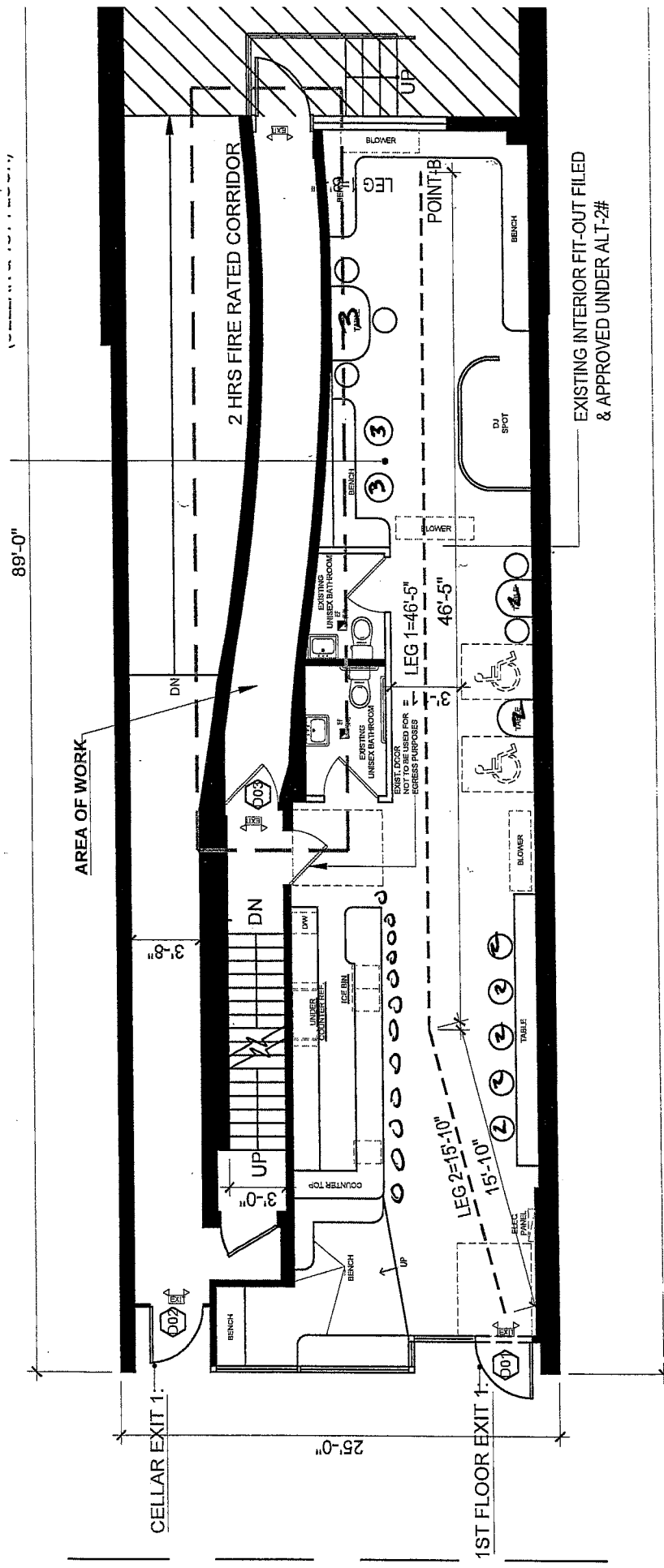

152 Ludlow St  
 MC  
 10 Tables  
 23 Seats  
 12 Barstools

1 PROPOSED FIRST FLOOR PLAN  
 PA-102 SCALE: 1/8" = 1'-0"

EXISTING INTERIOR FIT-OUT FILED  
 & APPROVED UNDER ALT-2#

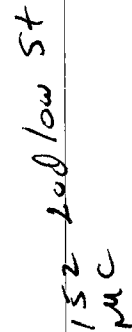

SCALE: 1/8" = 1'-0"

1  
PA-101