

HELBRAUN || LEVEY

CRYBABY HOSPITALITY LLC
153 BOWERY
NEW YORK, NY 10002

MANHATTAN COMMUNITY BOARD 3



THE CITY OF NEW YORK MANHATTAN COMMUNITY BOARD 3

59 East 4th Street - New York, NY 10003

Phone (212) 533-5300

www.cb3manhattan.org - mn03@cb.nyc.gov

Andrea Gordillo, Board Chair

Susan Stetzer, District Manager

Community Board 3 Liquor License Application Questionnaire

NOTE: ALL ITEMS MUST BE SUBMITTED FOR APPLICATION TO BE CONSIDERED.

The following items and questionnaire package are due by date listed in email invite:

- ☒ Schematics, floor plans or architectural drawings of the inside of the premise.
- ☒ A proposed food and or drink menu.

The following items are due by noon Friday before the meeting:

- ☒ Petition in support of proposed business or change in business with signatures from residential tenants at location and in buildings adjacent to, across the street from and behind proposed location. Petition must give proposed hours and method of operation. For example: restaurant, sports bar, combination restaurant/bar. (petition provided)
- ☒ Notice of proposed business to block or tenant association if one exists. You can find community groups and contact information on the CB 3 website:
<https://www1.nyc.gov/site/manhattancb3/resources/community-groups.page>
(this is not required but strongly suggested if a relevant group exists)
- ☒ Proof of conspicuous posting of notices at the site for 7 days prior to the meeting (please include newspaper with date in photo or a timestamped photo).

Check which you are applying for:

- ☒ new liquor license ☐ alteration of an existing liquor license ☐ corporate change

Check if either of these apply:

- ☐ sale of assets ☐ upgrade (change of class) of an existing liquor license

Today's Date: 05/03/2025

Is location currently licensed? ☐ Yes ☒ No Type of license: N/A

If alteration, describe nature of alteration: N/A

Previous or current use of the location: HARDWARE STORE

Corporation and trade name of current license: N/A

APPLICANT:

Premise address: 153 BOWERY NEW YORK, NY 10002

Cross streets: BROOME AND DELANCEY STREETS

Name of applicant and all principals: JEFFREY ROGERS AND CAMERON MASCIA

Trade name (DBA): PENDING

PREMISE:

Type of building and number of floors: MIXED-USE 6 FLOORS

Does premise have a valid Certificate of Occupancy, including for any back/side yard or roof use?

☒ Yes ☐ No What is maximum NUMBER of people permitted <74

What is the zoning designation (check zoning using map: <http://gis.nyc.gov/doitt/nycitymap/> - please give specific zoning designation, such as R8 or C2): C6-1G

PROPOSED METHOD OF OPERATION:

What are the proposed days/hours of operation? (Specify days and hours each day and hours of outdoor space, if applicable) 4PM - 2AM MONDAY - FRIDAY ; 12PM - 2AM SATURDAY - SUNDAY

Will any other business besides food or alcohol service be conducted at premise, i.e., retail? ☐ Yes ☒ No

If yes, please describe what type: N/A

Number of indoor tables? 16 Total number of indoor seats? 64

How many stand-up bars/bar seats are located on the premise (number, length, and location) 1
LOCATED ON THE GROUND FLOOR, APPROX 40 FEET.

(A *stand-up bar* is any bar or counter -with seating or not- where you can order, pay for, and receive alcohol)

Does premise have a full kitchen? ☐ Yes ☒ No

Does it have a food preparation area? ☒ Yes ☐ No (If any, show on diagram)

Is food available for sale? ☒ Yes ☐ No If yes, describe type of food and submit a menu _____

FRENCH CUISINE

What are the hours the kitchen will be open? 2AM DAILY

Will a manager or principal always be on site? ☒ Yes ☐ No If yes, which? _____

How many employees will there be? 8

Do you have or plan to install ☐ French doors ☐ accordion doors or ☐ windows?

Will there be TVs/monitors? ☐ Yes ☒ No (If Yes, how many?) _____

Will premise have music? ☒ Yes ☐ No

If Yes, what type of music? ☒ Live musician ☒ DJs ☒ Streaming services/playlists

If other type, please describe N/A

What will be the music volume? ☒ Background (conversational) ☐ Entertainment (live music venue level) Please describe your sound system: 5 SMALL SONOS STYLE SPEAKERS.

Will you host any promoted events, scheduled performances, or any event at which a cover fee is charged? If Yes, what type of events or performances are proposed and how often? YES.

If promoted events, please explain the nature in which you plan to promote? Social media / online ads / outside promoters? NO OUTSIDE PROMOTERS. EVENTS PROMOTED ON OWN SOCIAL MEDIA.

How do you plan to manage vehicular traffic and crowds on the sidewalk caused by your establishment? Please attach plans. (Please do not answer "we do not anticipate congestion.") THERE WILL BE SECURITY PERSONNEL TO ENSURE THERE IS NOT PEDESTRIAN CONGESTION.

Will there be security personnel? ☒ Yes ☐ No (If Yes, how many and when) DAILY, NUMBER TO BE DETERMINED

How do you plan to manage noise inside and outside your business so neighbors will not be affected? Please attach plans. SIGNIFICANT SOUNDPROOFING WILL BE INSTALLED DURING BUILDOUT.

Is sound proofing installed? ☐ Yes ☒ No

If not, do you plan to install sound proofing? ☒ Yes ☐ No

Are there current plans to use the Open Restaurants program for the sale or consumption of alcoholic beverages outdoors? (includes roof & yard) ☐ Yes ☒ No If Yes, describe and show on diagram: N/A

APPLICANT HISTORY:

Has this corporation or any principal been licensed for sale of alcohol previously? ☒ Yes ☐ No

If yes, please indicate name of establishment: JUPITERBAR

Address: 2126 2ND AVENUE SUITE A, SEATTLE, WA Community Board # N/A

Dates of operation: _____

Has any principal had work experience similar to the proposed business? ☒ Yes ☐ No If Yes, please attach explanation of experience or resume. Note: failure to disclose previous experience or information hampers the ability to evaluate this application.

Does any principal have other businesses in this area? ☐ Yes ☒ No If Yes, please give trade name, address and describe the business N/A

Has any principal had SLA reports or action within the past 5 years? ☐ Yes ☒ No If Yes, attach list of violations and dates of violations and outcomes, if any.

Attach a separate diagram that indicates the location (name and address) and total number of establishments selling/serving beer, wine (B/W) or liquor (OP) for 2 blocks in each direction. Please indicate whether establishments have On-Premise (OP) licenses. Please label streets and avenues and identify your location. Use letters to indicate Bar, Restaurant, etc. The diagram must be submitted with the questionnaire to the Community Board before the meeting.

LOCATION:

How many licensed establishments are within 1 block? 2

How many On-Premise (OP) liquor licenses are within 500 feet? 14

Is the premise within 200 feet on the same street of any school or place of worship? ☐ Yes ☒ No

COMMUNITY OUTREACH:

Please see the Community Board website to find block associations or tenant associations in the immediate vicinity of your location for community outreach. Applicants are encouraged to reach out to community groups, but it is not required. Also use provided petitions, which clearly state the name, address, license for which you are applying, and the hours and method of operation of your establishment at the top of each page. (Attach additional sheets of paper as necessary)

We are including the following questions to be able to prepare stipulations and have the meeting be faster and more efficient. Please answer per your business plan; do not plan to negotiate at the meeting.

1. My license type is: ☐ beer & cider ☐ wine, beer & cider ☒ liquor, wine, beer & cider
2. ☐ I will operate a full-service restaurant, specifically a (type of restaurant) _____ restaurant, or
☒ I will operate a BAR/TAVERN,
☐ with a kitchen open and serving food during all hours of operation OR ☒ with less than a full-service kitchen but serving food during all hours of operation OR ☐ Other _____
3. My hours of operation will be:
Mon 4PM - 2AM; Tue 4PM - 2AM; Wed 4PM - 2AM;
Thu 4PM - 2AM; Fri 4PM - 2AM; Sat 12PM - 2AM;
Sun 12PM - 2AM. (I understand opening is "no later than" specified opening hour, and all patrons are to be cleared from business at specified closing hour.)
4. ☒ I will not use outdoor space for commercial use (including Open Restaurants) OR
☒ I will close all outdoor dining allowed under the temporary Open Restaurants program and any other subsequent uses by 10:00 P.M. all days and not have any speakers or TV monitors outdoors
5. ☒ I will employ a doorman/security personnel: _____
6. ☒ I will install soundproofing, _____

7. ☐ I will close any front or rear façade doors and windows at 10:00 P.M. every night or when amplified sound is playing, including but not limited to DJs, live music and live nonmusical performances, or during unamplified performances or televised sports. ☒ I will have a closed fixed façade with no open doors or windows except my entrance door, which will close by 10:00 P.M. or when amplified sound is playing, including but not limited to DJs, live music and live nonmusical performances, or during unamplified performances or televised sports.
8. I will not have ☐ DJs, ☐ live music, ☒ third-party promoted events, ☐ any event at which a cover fee is charged, ☐ scheduled performances, ☐ more than _____ DJs per _____, ☐ more than _____ private parties per _____
9. ☐ I will play ambient recorded background music only.
10. ☒ I will not apply for an alteration to the method of operation or for any physical alterations of any nature without first coming before CB 3.
11. ☒ I will not seek a change in class to a full on-premises liquor license without first obtaining approval from CB 3.
12. ☒ I will not participate in pub crawls or have party buses come to my establishment.
13. ☒ I will not have unlimited drink specials, including boozy brunches, with food.
14. ☒ I will not have a happy hour or drink specials with or without time restrictions OR ☐ I will have happy hour and it will end by _____.
15. ☒ I will not have wait lines outside. ☒ I will have a staff person responsible for ensuring no loitering, noise or crowds outside.
16. ☒ I will conspicuously post this stipulation form beside my liquor license inside of my business.
17. ☒ Residents may contact the manager/owner at the number below. Any complaints will be addressed immediately. I will revisit the above-stated method of operation if necessary in order to minimize my establishment's impact on my neighbors.

Name: ALAN AYSSEH

Phone Number: 203-943-9817

Crybaby Food Menu

Cold

Oyster \$3 (with caviar \$15)

Shrimp Cocktail \$15

Deviled Duck Egg, Golden Daurenki Caviar \$25

Cheese & Meat

Comté \$7

Nutty, Semi-Hard

Comté Reserve \$10

Nutty, Semi-Hard

Comté 3 Year \$13

Nutty, Semi-Hard

Morbier \$7

Bleu cheese, Semi-Soft

Gruyere \$6

Nutty, Semi-Hard

Tete de Moine \$7

Creamy, Semi-Hard

Cancoillotte \$13 (with Caviar \$50)

Creamy, Soft

Shaved Jambon \$12 (with chips \$15)

Savoury Shaved French Ham

Saucison \$15

Dried French Sausage

Choux

Gougeres \$10

Gruyère Cheese Savoury Cream Puff

Comté Custard \$25

Savoury Cream Puff with Whipped Comté Custard

Sweet Cream \$15

Cream Puff, Sweet Custard

Small Plates

Bleu Cheese Olives \$12

Gordal olives stuffed with Morbier

Braised Cabbage \$13

Red Wine Braised Cabbage

Gratin Jurassien \$18 (with truffle \$40)

Potato, Mix of Jurassien Cheese

Large Plates

Poulet au Vin Jaune \$28

Braised Cornish Hen, Shallot, Oyster Mushroom, Cream, Butter, Vin Jaune

Chevreuril \$30

Venison Shank, Roasting Vegetables, Red Wine Reduction

Mushrooms & Polenta \$25

Wild Mushroom Ragu, Whipped Polenta

Dessert

Comte Cheesecake \$18

Graham Cracker Crust, Comté Custard

Cocktails - \$15

Meetcute

Gin, Verjus, Green Chartreuse, Cucumber Soda

Emerald City

Vodka, Pistachio Milk, Pandan, Coco Lopez, Lime

Dimples

La Gritona Tequila, Cointreau, Lime, Cilantro, Mint

Casablanca

Szechuan pepper infused Mezcal, Umeshu, Granada Vallet Liqueur, Grenadine

Catch Flights

Rum, Campari, Pineapple, Lemon, Barolo Chinato

Wines By The Glass

Sparkling

Cremant du Jura - \$15

Cremant du Jura Rosé - \$18

Ponson 1er Cru Champagne - \$20

Ponson Rose Champagne - \$20

Pertois-Moriset L'Assemblage 1.5L - \$22

Lagille L'Inattendue - \$33

White

'23 L'Effet Papillon Grenache Blanc - \$10

'23 La Femme Soleil Macabeo/Grenache Gris - \$15

'23 Acid Test - \$12

Vino de Pasta \$15

Domaine du Pelican Savagnin Ouillé \$25

Rolet Jura Chardonnay \$20

Rosé

'23 L'Effet Papillon Rosé \$10

Marsannay Rosé \$25

'22 Rolet Trouseau Rosé \$22

Calabretta Rosato \$12

Red

'23 L'Effet Papillon Rouge \$10

'22 Pelaverga \$18

'23 Puzta Zweigelt \$15

Rolet Trouseau \$22

Jura Pinot Noir \$22

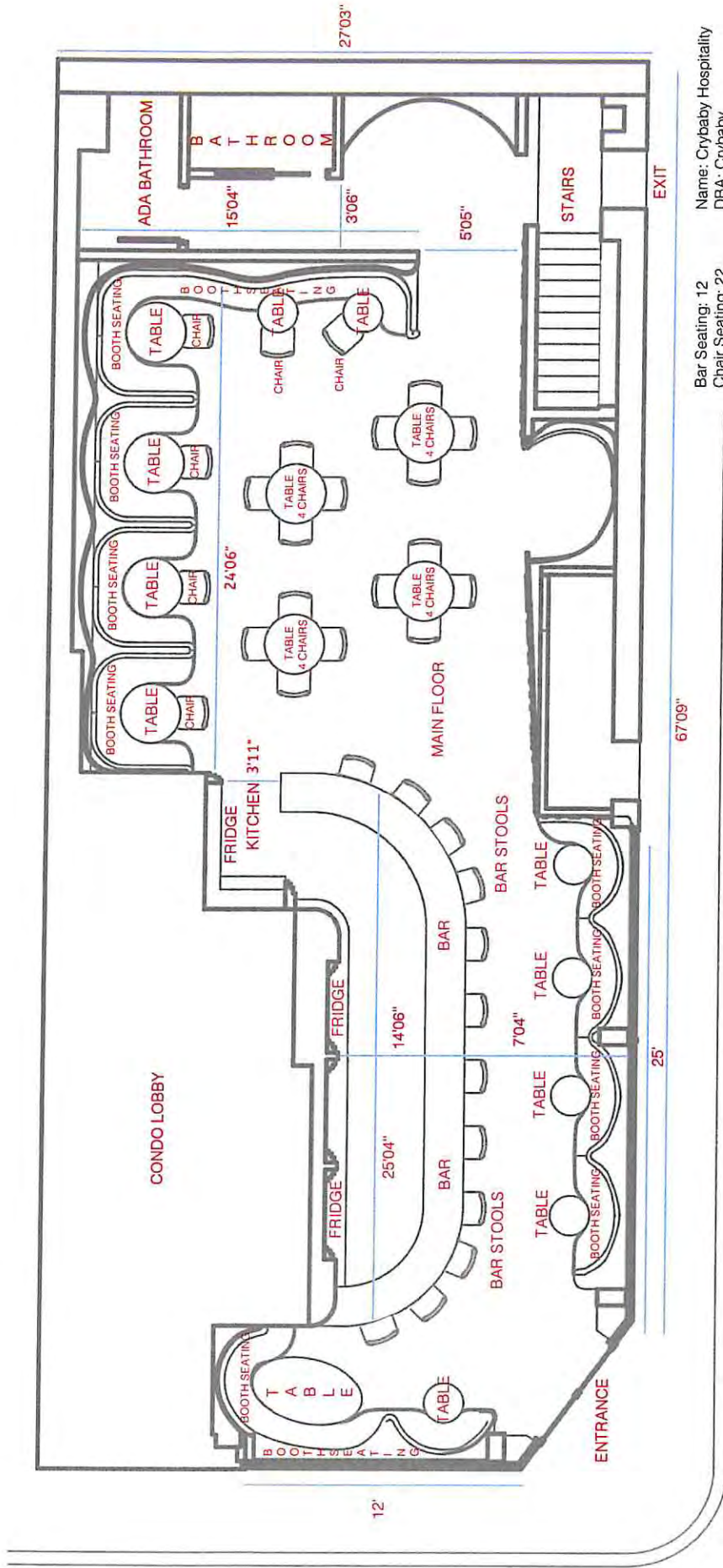

Name: Crybaby Hospitality
 DBA: Crybaby
 Address: 153 Bowery
 New York, NY 10002

Bar Seating: 12
 Chair Seating: 22
 Booth Seating: 40
 Total: 74

B R O O M E S T R E E T

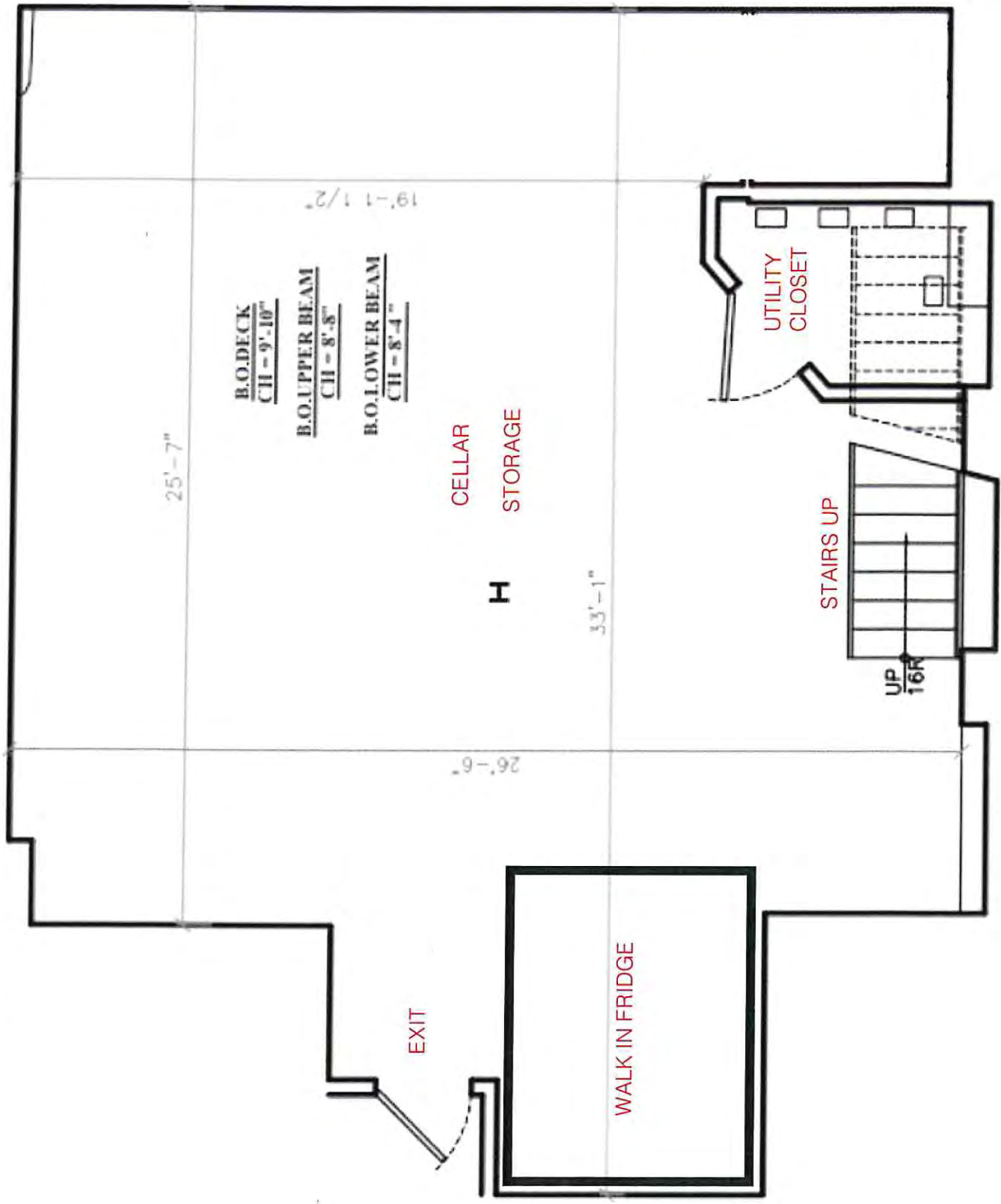

HELBRAUN | LEVEY

NEIGHBORHOOD MAP

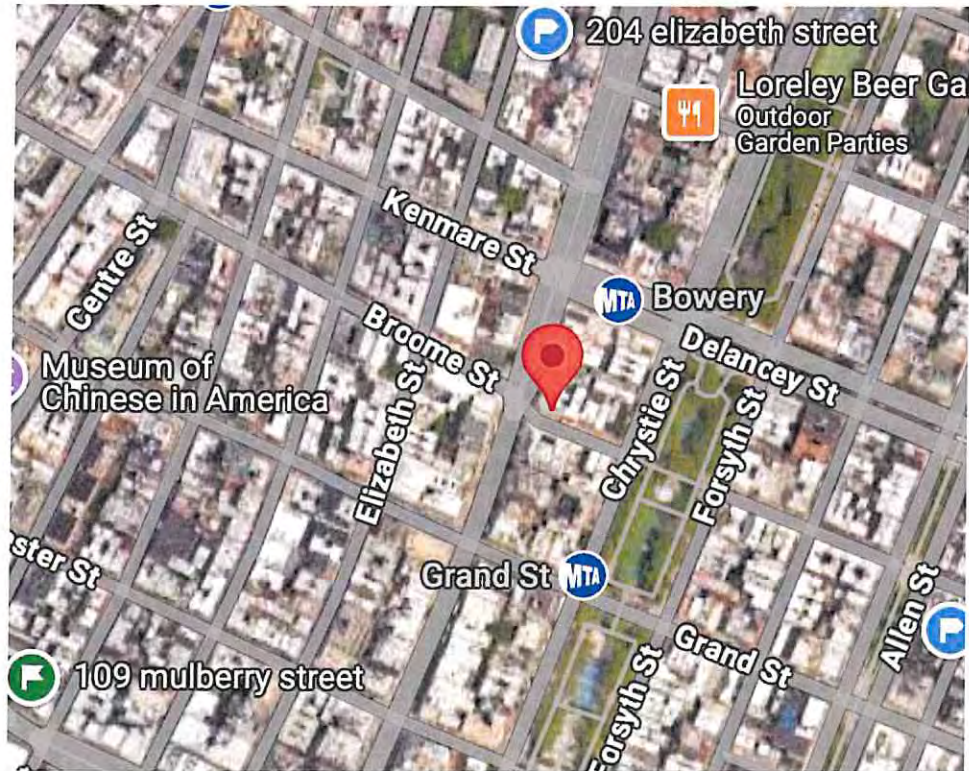

HELBRAUN | LEVEY

500 FOOT MAP



GREEN MARTINI=OP LICENSE
PINK MARTINI=INACTIVE OP LICENSE
GREEN WINE=RW/TW LICENSE
PINK WINE=INACTIVE RW/TW LICENSE

This report is for informational purposes only in aid of identifying establishments potentially subject to 500 and 200 foot rules. Distances are approximated using industry standard GIS techniques and do not reflect actual distances between points of entry. The NYS Liquor Authority makes no representation as to the accuracy of the information and disclaims any liability for errors.

Proximity Report For:

Location **153 Bowery, New York, New York, 10002**

Geocode **Latitude: 40.71946
longitude: -73.99418**

Report Generated On **5/14/2025**

8 Closest Liquor Stores

Name	Address	Distance
WINE-O INC License ID: 0100-21-113695 Legacy Serial No.: 1262156	171 ELIZABETH ST SPRING & KENMARE STREETS NEW YORK, New York 10012	564 ft
R & S 49 LIQUOR CORP License ID: 0100-21-114049 Legacy Serial No.: 1297191	92 ELIZABETH ST NEW YORK, New York 10013	578 ft
SA VINO ITALIANO INC. License ID: 0100-23-124962 Legacy Serial No.: 1199593	200 GRAND ST MOTT & MULBERRY STREETS NEW YORK, New York 10013	696 ft
OCEAN WINE & SPIRIT INC License ID: 0100-22-118080 Legacy Serial No.: 1296083	273 GRAND ST NEW YORK, New York 10002	716 ft
GROTTA AZZURRA IMPORTS INC License ID: 0100-21-115652 Legacy Serial No.: 1259856	177 MULBERRY ST STORE 1A NEW YORK, New York 10013	821 ft
YI DING FA CORP License ID: 0100-22-115857 Legacy Serial No.: 1339668	101 ALLEN ST NEW YORK, New York 10002	955 ft
EL CORRAL SOHO INC License ID: 0100-22-116619 Legacy Serial No.: 1235206	406 BROOME ST, STORE H AKA 199 LAFAYETTE ST & CLEVELAND PL NEW YORK, New York 10013	1,083 ft
ORANGE GLOU LLC License ID: 0091-21-121837 Legacy Serial No.: 1330686	264 BROOME ST NEW YORK, New York 10002	1,114 ft

Schools within 500 feet

Name	Address	Distance
------	---------	----------

No Schools within 500 feet

Churches within 500 feet	
Name	Distance
Mt Olive Community Services	220 ft
Cc Fellowship Trading Co	310 ft
Chinese Evangelical Church	381 ft
Holy Trinity Ukrainian Orthodox Church	410 ft
C3 Downtown	429 ft

Pending On Premises Liquor Licenses within 750 feet		
Name	Address	Distance
Casa Thirteen LLC Application ID: NA-0340-24-138713	1 Delancey St New York, New York 10002	232 ft
Cuernavaca LLC Application ID: NA-0340-25-110094	110 Forsyth St New York, NY 10002	520 ft
174 Mott Hospitality LLC and 174 Mott LLC Application ID: NA-0340-24-115691	174 Mott St New York, New York 10012	555 ft
189 DRINKS LLC Application ID: NA-0340-22-136741	171 CHRYSTIE ST NEW YORK, New York 10002	648 ft
Delta Charlie NYC LLC Application ID: NA-0370-25-105550	5 Spring St New York, New York 10012	652 ft
Gammon Cafe LLC Application ID: NA-0370-25-102517	7 Spring St New York, NY 10012	666 ft
Yves LLC Application ID: NA-0340-23-150133	105 107 Eldridge St South Store New York, New York 10002	715 ft
Super Dac Biet LLC Application ID: NA-0340-25-111589	137 Eldridge St New York, NY 10002	727 ft

Active On Premises Liquor Licenses within 750 feet		
Name	Address	Distance
BOWERY RESTAURANT GROUP LLC License ID: 0340-22-106549 Legacy Serial No.: 1268378	146 BOWERY NEW YORK, New York 10013	79 ft
TLS CHRYSTIE LLC License ID: 0370-24-119240 Legacy Serial No.: 6027596	131 CHRYSTIE ST BASEMENT STORE BROOME & DELANCEY NEW YORK, New York 10002	229 ft
133 GROUP INC License ID: 0340-24-102268 Legacy Serial No.: 6010232	133 CHRYSTIE ST NEW YORK, New York 10002	236 ft
CHERRY LANE INC License ID: 0340-22-106010 Legacy Serial No.: 1149860	349 BROOME ST BOWERY & ELIZABETH NEW YORK, New York 10013	246 ft
PIACERE ENTERPRISES LLC License ID: 0340-25-108774 Legacy Serial No.: 6058335	351 BROOME ST NEW YORK, New York 10013	273 ft

Active On Premises Liquor Licenses within 750 feet		
Name	Address	Distance
CK 139 Inc License ID: 0340-24-123184 Legacy Serial No.: 6031642	139 Chrystie St New York, New York 10002	279 ft
ESSEX HOSPITALITY LLC License ID: 0340-23-131302 Legacy Serial No.: 1318858	115 DELANCEY ST NEW YORK, New York 10002	295 ft
MM 130 BOWERY REST CORP License ID: 0340-22-110563 Legacy Serial No.: 1121708	130 BOWERY NEW YORK, New York 10013	308 ft
183 BOWERY LLC License ID: 0370-25-110241 Legacy Serial No.: 6059824	183 Bowery New York, New York 10002	395 ft
10 DELANCEY COCINA INC License ID: 0370-24-121743 Legacy Serial No.: 6030166	10 DELANCEY ST NEW YORK, New York 10002	404 ft
EGG SHOP LES LLC, THE License ID: 0340-22-106541 Legacy Serial No.: 1279953	151 ELIZABETH ST A / B - AB - ELIZABETH STREET NEW YORK, NY 10012	411 ft
153 ELIZABETH HOTEL LLC License ID: 0343-23-122842 Legacy Serial No.: 1232135	153 ELIZABETH ST AKA 40 KENMAR NEW YORK, New York 10012	424 ft
JUICERIE NOLITA LLC License ID: 0340-24-109612 Legacy Serial No.: 6017710	19 Kenmare St EAST UNIT New York, NY 10012	465 ft
OSIB BOWERY ST OPERATOR LLC & OSIB BCRE BOWERY ST License ID: 0343-22-126822 Legacy Serial No.: 1310647	185 187 189 191 BOWERY NEW YORK, New York 10003	467 ft
TOKANA CAFE BAR RESTORANT INC License ID: 0340-21-118913 Legacy Serial No.: 1287602	163 ELIZABETH ST NEW YORK, New York 10012	493 ft
DIXON PLACE LLC License ID: 0340-21-118304 Legacy Serial No.: 1217964	161 CHRYSTIE ST NEW YORK, New York 10002	561 ft
Broome Bistro and Cafe LLC License ID: 0340-24-139557 Legacy Serial No.: 6048443	303 305 Broome St New York, NY 10002	568 ft
100 FORSYTH RESTAURANT LLC License ID: 0340-22-113726 Legacy Serial No.: 1313086	100 FORSYTH ST BASEMENT NEW YORK, New York 10002	576 ft
AGOODLOOK LLC License ID: 0340-22-113442 Legacy Serial No.: 1294253	174 ELIZABETH ST NEW YORK, New York 10012	585 ft
ROOT NOLITA LLC License ID: 0370-23-137957 Legacy Serial No.: 1321558	173 MOTT ST BASEMENT, AKA 371 BROOME ST NEW YORK, New York 10013	597 ft
SANUK LLC AND UNCLE BOONS LLC License ID: 0340-23-129831 Legacy Serial No.: 1316704	52 KENMARE ST AKA 186 MOTT ST NEW YORK, New York 10012	603 ft
ROOT NOLITA LLC License ID: 0340-22-108729 Legacy Serial No.: 1312295	371 BROOME ST GROUND FLOOR NEW YORK, New York 10013	622 ft

Active On Premises Liquor Licenses within 750 feet		
Name	Address	Distance
LSMC LLC License ID: 0340-23-128551 Legacy Serial No.: 1345195	151 MOTT ST NEW YORK, New York 10013	626 ft
AINSLIE BOWERY LLC License ID: 0340-22-110402 Legacy Serial No.: 1338113	199 BOWERY NEW YORK, New York 10002	636 ft
WALLABOUT ENTERTAINMENT LLC License ID: 0340-24-132010 Legacy Serial No.: 6040753	167 171 CHRYSTIE ST NEW YORK, NY 10002	665 ft
TWELVE SPRING ST REST CORP License ID: 0340-23-133781 Legacy Serial No.: 1215096	12 SPRING ST AKA176ELIZABETHST BOWERY & ELIZABETH ST NEW YORK, New York 10012	666 ft
14 SPRING STREET CAFE LLC License ID: 0340-21-119467 Legacy Serial No.: 1270562	14 SPRING STREET NEW YORK, New York 10012	690 ft
Sip Champagne LLC License ID: 0370-24-131778 Legacy Serial No.: 6040484	207 Bowery New York, NY 10002	698 ft
18 FRONT INC License ID: 0340-22-107087 Legacy Serial No.: 1151149	18 SPRING STREET MOTT & ELIZABETH NEW YORK, New York 10013	720 ft
TTBEL HOLDINGS INC License ID: 0370-23-138320 Legacy Serial No.: 1322687	51 53 DELANCEY ST NEW YORK, New York 10002	740 ft
MARI MAKAN LLC License ID: 0340-22-104236 Legacy Serial No.: 1303337	20 SPRING ST NEW YORK, New York 10012	741 ft

The following undersigned residents of the premises and surrounding buildings support the issuance of an on-premises license to the following applicant/establishment:

Crybaby

4PM-2AM Monday thru Friday
12PM-2AM Saturday thru Sunday

NAME
153 Bowery New York, NY 1002

ADDRESS

Regarding the interior space: This will be a BAR

Regarding the outside space: There will be NO OUTSIDE SPACE

The outside area(s) will be operating until:

DATE	NAME	ADDRESS	#	SIGNATURE
	Sophia Semeritsidis	111 Chrystie St Apt 9	#	<i>[Signature]</i>
	Jonathan Patton	149 Elizabeth St	#	<i>[Signature]</i>
	Leonhard Brenningmeier	138 Bowery	# 6G	<i>[Signature]</i>
	Ashley Corcoran	138 Bowery	# 6D	<i>[Signature]</i>
	JULIA DANSEN	138 Bowery	# 30F	<i>[Signature]</i>
	NILAN MEEHAN	138 Bowery	# 84	<i>[Signature]</i>
	map work	138 Bowery	# 8B	<i>[Signature]</i>
	MAUSA TRANIPOUR	138 Bowery	# 6B	<i>[Signature]</i>
	Gita Trani pour	138 Bowery	# 6B	<i>[Signature]</i>
	Indy Trani pour	138 Bowery	# 6B	<i>[Signature]</i>
	Raz Danon	138 Bowery	#	<i>[Signature]</i>
	Jack Sharkey	45 Mott St	# 1	<i>[Signature]</i>
	LUNA MELLO	45 MOTT ST	# 1	<i>[Signature]</i>
	Indra Fonseca	138 Bowery St	#	<i>[Signature]</i>
	Andres Ponce	138 Bowery St	#	<i>[Signature]</i>

PLEASE NOTE: signatures should be from residents of upstairs and adjoining buildings, and within two-block area of proposed property

PETITION SIGNATURES IN SUPPORT OF NYSLA LICENSE

The following undersigned residents of the premises and surrounding buildings support the issuance of an on-premises license to the following applicant/establishment:

Crybaby









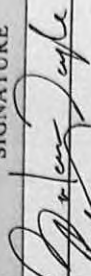

4PM-2AM Monday thru Friday
12PM-2AM Saturday thru Sunday

NAME
153 Bowery New York, NY 1002
ADDRESS

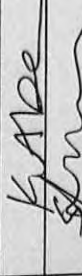
Regarding the interior space: This will be a BAR

Regarding the outside space: There will be NO OUTSIDE SPACE

The outside area(s) will be operating until:

DATE	NAME	ADDRESS	SIGNATURE
	Brendan Doyle	32 Gramercy Park South # 6A	
	Benjamin Rosenberg	413 Grand St. #807	
	Sean Johnson	107 Eldridge St # 2B	
	NANUK SKTEN	107 Eldridge St #	
	MELISSA ABLE	210 E BRO ADWAY # H306	
	KEN ABLE	210 E BROADWAY # H306	
	Skyler Trotta	203 Grand St. # 29	
	COLUM GUTER	203 Grand St. # 29	
	Jenny Jasky	330 Broome St. # 2	
	Michael Lubin	330 Broome St. # 2	
	Alan Aysch	153 Bowery 4 # 4	
		#	
		#	
		#	
		#	

PLEASE NOTE: signatures should be from residents of upstairs and adjoining buildings, and within two-block area of proposed property

The following undersigned residents of the premises and surrounding buildings support the issuance of an on-premises license to the following applicant/establishment:

4PM-2AM Monday thru Friday
12PM-2AM Saturday thru Sunday

NAME
153 Bowery New York, NY 1002

Regarding the interior space: This will be a BAR

Regarding the outside space: There will be NO OUTSIDE SPACE

The outside area(s) will be operating until:

[illegible]

PLEASE NOTE: signatures should be from residents of upstairs and adjoining buildings, and within two-block area of proposed property



Monday, May 12, 2025

Community Support

We are collecting signatures to exemplify to the community board that Crybaby is a desired neighborhood addition and a benefit to the city. Signing represents support in Crybaby being granted a liquor license with these specific stipulations of location & hours.

CRYBABY

A lush velvet-clad hideaway pouring small production wines and expressive cocktails, complemented by sweet and savory plates.

4PM-2AM Monday thru Friday

12PM-2AM Saturday thru Sunday

Find us in the near future at 153 Bowery, New York NY 10002

*Local signatures are a necessity, but additional ones are still a bonus!
The more the merrier to show how folks look forward to attending our beautiful upcoming space.*

Thank you all so much – we can't wait to serve you!

Petition signatures in support of NYSLA license, bar with no outside space

Name

Hugo Steiner

Address

153 Bowery Apt 5
New York, NY, 10002

Signature

A handwritten signature in black ink, appearing to be 'H. Steiner'.



Sunday, May 11, 2025

Community Support

We are collecting signatures to exemplify to the community board that Crybaby is a desired neighborhood addition and a benefit to the city. Signing represents support in Crybaby being granted a liquor license with these specific stipulations of location & hours.

CRYBABY

A lush velvet-clad hideaway pouring small production wines and expressive cocktails, complemented by sweet and savory plates.

4PM-2AM Monday thru Friday

12PM-2AM Saturday thru Sunday

Find us in the near future at 153 Bowery, New York NY 10002

*Local signatures are a necessity, but additional ones are still a bonus!
The more the merrier to show how folks look forward to attending our beautiful upcoming space.*

Thank you all so much – we can't wait to serve you!

Petition signatures in support of NYSLA license, bar with no outside space

Name

Jake Belanger

Address

179 Mott street
New York, Ny, 10012

E-mail (optional - provide if you would like updates on Crybaby's opening & future events)

hello@stele.shop

Signature

A handwritten signature in black ink, appearing to be 'Jake Belanger'.



Monday, May 12, 2025

Community Support

We are collecting signatures to exemplify to the community board that Crybaby is a desired neighborhood addition and a benefit to the city. Signing represents support in Crybaby being granted a liquor license with these specific stipulations of location & hours.

CRYBABY

A lush velvet-clad hideaway pouring small production wines and expressive cocktails, complemented by sweet and savory plates.

4PM-2AM Monday thru Friday

12PM-2AM Saturday thru Sunday

Find us in the near future at 153 Bowery, New York NY 10002

*Local signatures are a necessity, but additional ones are still a bonus!
The more the merrier to show how folks look forward to attending our beautiful upcoming space.*

Thank you all so much – we can't wait to serve you!

Petition signatures in support of NYSLA license, bar with no outside space

Name

Ana Stjepanovic

Address

299 Grand st
New york, Ny, 10002

Signature

A handwritten signature in black ink, appearing to be 'A S', written over a faint horizontal line.



Sunday, May 11, 2025

Community Support

We are collecting signatures to exemplify to the community board that Crybaby is a desired neighborhood addition and a benefit to the city. Signing represents support in Crybaby being granted a liquor license with these specific stipulations of location & hours.

CRYBABY

A lush velvet-clad hideaway pouring small production wines and expressive cocktails, complemented by sweet and savory plates.

4PM-2AM Monday thru Friday

12PM-2AM Saturday thru Sunday

Find us in the near future at 153 Bowery, New York NY 10002

*Local signatures are a necessity, but additional ones are still a bonus!
The more the merrier to show how folks look forward to attending our beautiful upcoming space.*

Thank you all so much – we can't wait to serve you!

Petition signatures in support of NYSLA license, bar with no outside space

Name

Victoria Shiverskikh

Address

153 Bowery, 3
New York, NY, 10002

E-mail (optional - provide if you would like updates on Crybaby's opening & future events)

shiverskikhv@gmail.com

Signature



Sunday, May 11, 2025

Community Support

We are collecting signatures to exemplify to the community board that Crybaby is a desired neighborhood addition and a benefit to the city. Signing represents support in Crybaby being granted a liquor license with these specific stipulations of location & hours.

CRYBABY

A lush velvet-clad hideaway pouring small production wines and expressive cocktails, complemented by sweet and savory plates.

4PM-2AM Monday thru Friday

12PM-2AM Saturday thru Sunday

Find us in the near future at 153 Bowery, New York NY 10002

*Local signatures are a necessity, but additional ones are still a bonus!
The more the merrier to show how folks look forward to attending our beautiful upcoming space.*

Thank you all so much – we can't wait to serve you!

Petition signatures in support of NYSLA license, bar with no outside space

Name

Adam Goldman

Address

153 Bowery, 3
New York, NY, 10002

E-mail (optional - provide if you would like updates on Crybaby's opening & future events)

aygoldman@hotmail.com

Signature

A handwritten signature in black ink, appearing to read 'Adam Goldman'.



Sunday, May 11, 2025

Community Support

We are collecting signatures to exemplify to the community board that Crybaby is a desired neighborhood addition and a benefit to the city. Signing represents support in Crybaby being granted a liquor license with these specific stipulations of location & hours.

CRYBABY

A lush velvet-clad hideaway pouring small production wines and expressive cocktails, complemented by sweet and savory plates.

4PM-2AM Monday thru Friday

12PM-2AM Saturday thru Sunday

Find us in the near future at 153 Bowery, New York NY 10002

*Local signatures are a necessity, but additional ones are still a bonus!
The more the merrier to show how folks look forward to attending our beautiful upcoming space.*

Thank you all so much – we can't wait to serve you!

Petition signatures in support of NYSLA license, bar with no outside space

Name

Paige Boatwright

Address

62 Forsyth St Apt 16
New York, NY, 10002

E-mail (optional - provide if you would like updates on Crybaby's opening & future events)

boatwrightpaige@gmail.com

Signature

A handwritten signature in black ink, appearing to read 'Paige Boatwright'.

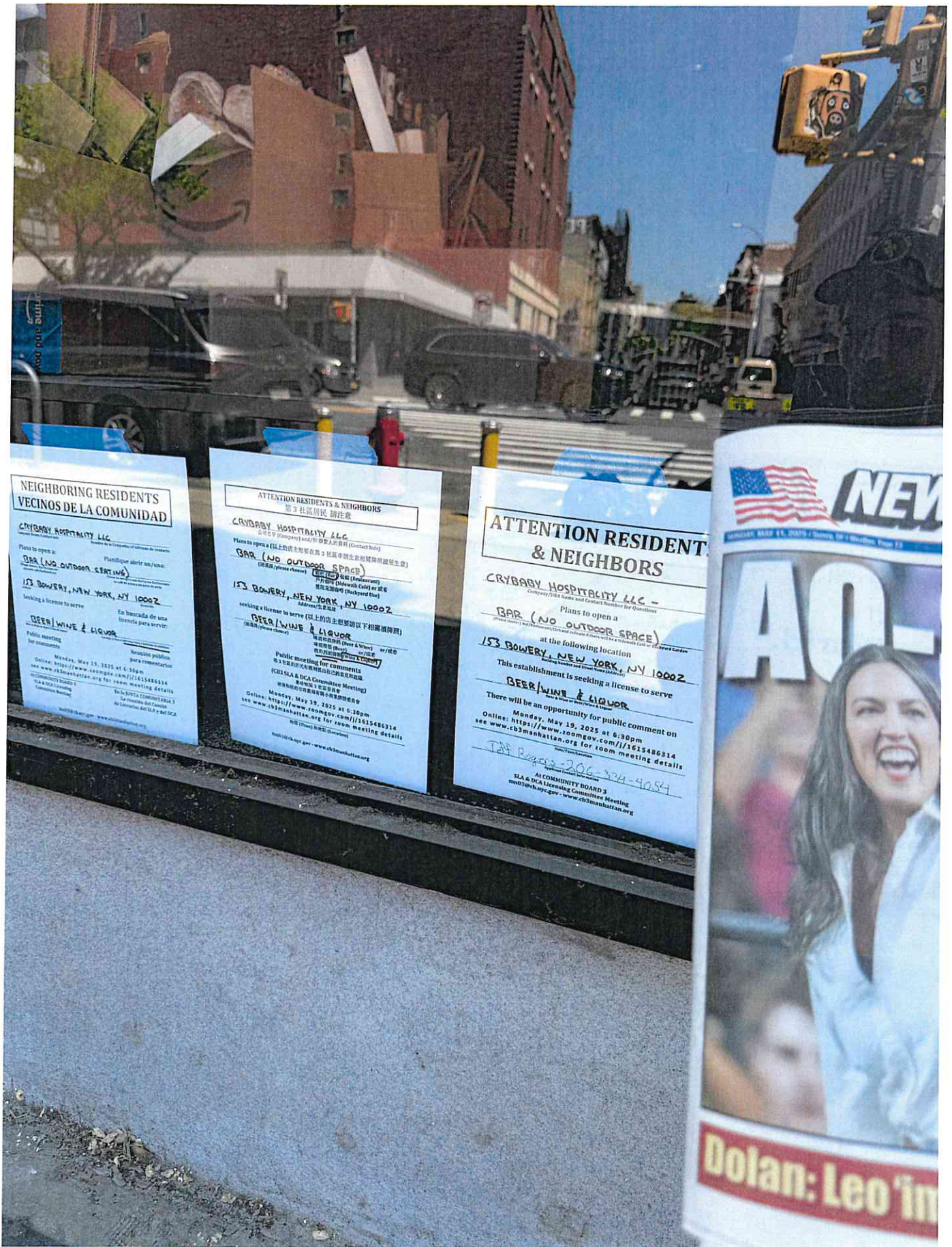

NEIGHBORING RESIDENTS
VECINOS DE LA COMUNIDAD

CRYBABY HOSPITALITY LLC
Company/Compañía

Plans to open a: **BAR (NO OUTDOOR SEATING)**
Planned to open a: **BAR (NO OUTDOOR SEATING)**

153 BOWERY, NEW YORK, NY 10002
Address/Dirección

Seeking a license to serve: **BEER/WINE & LIQUOR**
Buscando una licencia para servir: **BEER/WINE & LIQUOR**

Public meeting for comments: **Monday, May 19, 2025 at 6:30pm**
Reunión pública para comentarios: **Monday, May 19, 2025 at 6:30pm**

Online: <https://www.loomgov.com/j/1615486314>
See www.cb3manhattan.org for room meeting details

SLA & DCA Licensing Committee Meeting
Comunidad de la Ciudad de Nueva York

ATTENTION RESIDENTS & NEIGHBORS
第3 社區居民 請注意

CRYBABY HOSPITALITY LLC
公司/Compañía

Plans to open a (以上) 的店生意和飲料 (Contact Info)
Planned to open a (以上) 的店生意和飲料 (Contact Info)

BAR (NO OUTDOOR SPACE)
(酒廊) (酒吧) (酒廊) (酒吧)

153 BOWERY, NEW YORK, NY 10002
Address/地址

Seeking a license to serve (以上) 的店生意和飲料 (以下) 的店生意和飲料
Buscando una licencia para servir (以上) 的店生意和飲料 (以下) 的店生意和飲料

BEER/WINE & LIQUOR
(酒廊) (酒吧) (酒廊) (酒吧)

Public meeting for comments: **Monday, May 19, 2025 at 6:30pm**
Reunión pública para comentarios: **Monday, May 19, 2025 at 6:30pm**

Online: <https://www.loomgov.com/j/1615486314>
See www.cb3manhattan.org for room meeting details

SLA & DCA Licensing Committee Meeting
Comunidad de la Ciudad de Nueva York

ATTENTION RESIDENT & NEIGHBORS

CRYBABY HOSPITALITY LLC -
Company/SLA Name and Contact Number for Questions

Plans to open a: **BAR (NO OUTDOOR SPACE)**
Planned to open a: **BAR (NO OUTDOOR SPACE)**

at the following location: **153 BOWERY, NEW YORK, NY 10002**
at the following location: **153 BOWERY, NEW YORK, NY 10002**

This establishment is seeking a license to serve: **BEER/WINE & LIQUOR**
This establishment is seeking a license to serve: **BEER/WINE & LIQUOR**

There will be an opportunity for public comment on: **Monday, May 19, 2025 at 6:30pm**
There will be an opportunity for public comment on: **Monday, May 19, 2025 at 6:30pm**

Online: <https://www.loomgov.com/j/1615486314>
See www.cb3manhattan.org for room meeting details

Taf Bays - 206-374-4054

SLA & DCA Licensing Committee Meeting
Comunidad de la Ciudad de Nueva York

NEW YORK TIMES
MONDAY, MAY 19, 2025 • 10th Floor • 10th Floor • Page 10

AO-

Dolan: Leo in