

HELBRAUN || LEVEY

50 HST HOSPITALITY LLC  
50 BOWERY  
NEW YORK, NY 10013

MANHATTAN COMMUNITY BOARD 3



THE CITY OF NEW YORK  
MANHATTAN COMMUNITY BOARD 3  
59 East 4th Street - New York, NY 10003  
Phone (212) 533-5300  
www.cb3manhattan.org - mn03@cb.nyc.gov

Andrea Gordillo, Board Chair

Susan Stetzer, District Manager

**Community Board 3 Liquor License Application Questionnaire**

NOTE: ALL ITEMS MUST BE SUBMITTED FOR APPLICATION TO BE CONSIDERED.

**The following items and questionnaire package are due by date listed in email invite:**

- ☒ Schematics, floor plans or architectural drawings of the inside of the premise.
- ☒ A proposed food and or drink menu.

**The following items are due by noon Friday before the meeting:**

- ☐ Petition in support of proposed business or change in business with signatures from residential tenants at location and in buildings adjacent to, across the street from and behind proposed location. Petition must give proposed hours and method of operation. For example: restaurant, sports bar, combination restaurant/bar. (petition provided)
- ☐ Notice of proposed business to block or tenant association if one exists. You can find community groups and contact information on the CB 3 website:  
<https://www1.nyc.gov/site/manhattancb3/resources/community-groups.page>  
(this is not required but strongly suggested if a relevant group exists)
- ☐ Proof of conspicuous posting of notices at the site for 7 days prior to the meeting (please include newspaper with date in photo or a timestamped photo).

Check which you are applying for:

- ☒ new liquor license    ☐ alteration of an existing liquor license    ☐ corporate change

Check if either of these apply:

- ☐ sale of assets    ☐ upgrade (change of class) of an existing liquor license

Today's Date: 8/27/24

Is location currently licensed? ☒ Yes ☐ No    Type of license: FULL LIQUOR - HOTEL

If alteration, describe nature of alteration: \_\_\_\_\_

Previous or current use of the location: BAR/CLUB WITHIN HOTEL (BASEMENT LEVEL)

Corporation and trade name of current license: BRIDGEVIEW HOTEL LLC

**APPLICANT:**

Premise address: 50 BOWERY - BASEMENT LEVEL

Cross streets: CANAL AND BAYARD

Name of applicant and all principals: ISAIAH TRUSTY

Trade name (DBA): PENDING

**PREMISE:**

Type of building and number of floors: COMMERCIAL/HOTEL - 22 FLOORS

Does premise have a valid Certificate of Occupancy, including for any back/side yard or roof use?

☒ Yes ☐ No What is maximum NUMBER of people permitted 128

What is the zoning designation (check zoning using map: <http://gis.nyc.gov/doitt/nycitymap/> - please give specific zoning designation, such as R8 or C2): C6-1G

**PROPOSED METHOD OF OPERATION:**

What are the proposed days/hours of operation? (Specify days and hours each day and hours of outdoor space, if applicable) ALL DAYS 5PM-4AM

Will any other business besides food or alcohol service be conducted at premise, i.e., retail? ☐ Yes ☒ No

If yes, please describe what type: \_\_\_\_\_

Number of indoor tables? 15 Total number of indoor seats? 65

How many stand-up bars/bar seats are located on the premise (number, length, and location) \_\_\_\_\_  
1 BAR - 8 SEATS

(A **stand-up bar** is any bar or counter -with seating or not- where you can order, pay for, and receive alcohol)

Does premise have a full kitchen? ☐ Yes ☒ No

Does it have a food preparation area? ☒ Yes ☐ No (If any, show on diagram)

Is food available for sale? ☒ Yes ☐ No If yes, describe type of food and submit a menu \_\_\_\_\_

SEE ATTACHED

What are the hours the kitchen will be open? DURING ALL HOURS OF OPERATION

Will a manager or principal always be on site? ☒ Yes ☐ No If yes, which? MANAGER

How many employees will there be? 22

Do you have or plan to install ☐ French doors ☐ accordion doors or ☐ windows?

Will there be TVs/monitors? ☐ Yes ☒ No (If Yes, how many?) \_\_\_\_\_

Will premise have music? ☒ Yes ☐ No

If Yes, what type of music? ☒ Live musician ☒ DJs ☒ Streaming services/playlists

If other type, please describe \_\_\_\_\_

What will be the music volume? ☒ Background (conversational) ☒ Entertainment (live music venue level) Please describe your sound system: 8 SPEAKERS, 110 WATTAGE

Will you host any promoted events, scheduled performances, or any event at which a cover fee is charged? If Yes, what type of events or performances are proposed and how often? \_\_\_\_\_

NO PROMOTED OR SCHEDULED BUT MAY HAVE COVER FEE

If promoted events, please explain the nature in which you plan to promote? Social media / online ads / outside promoters? \_\_\_\_\_

How do you plan to manage vehicular traffic and crowds on the sidewalk caused by your establishment? \_\_\_\_\_

Please attach plans. (Please do not answer "we do not anticipate congestion.") \_\_\_\_\_

**WILL HAVE SECURITY ON SITE**

Will there be security personnel? ☒ Yes ☐ No (If Yes, how many and when) 8 - ALL DAYS OF OPERATIONS

How do you plan to manage noise inside and outside your business so neighbors will not be affected? \_\_\_\_\_

Please attach plans. SOUNDPROOFING ALREADY INSTALLED, CELLAR LOCATION WITH NO OPEN FACADE.

Is sound proofing installed? ☒ Yes ☐ No

If not, do you plan to install sound proofing? ☐ Yes ☐ No

Are there current plans to use the Open Restaurants program for the sale or consumption of alcoholic beverages outdoors? (includes roof & yard) ☐ Yes ☒ No If Yes, describe and show on diagram: \_\_\_\_\_

#### **APPLICANT HISTORY:**

Has this corporation or any principal been licensed for sale of alcohol previously? ☐ Yes ☒ No

If yes, please indicate name of establishment: \_\_\_\_\_

Address: \_\_\_\_\_ Community Board # \_\_\_\_\_

Dates of operation: \_\_\_\_\_

Has any principal had work experience similar to the proposed business? ☒ Yes ☐ No If Yes, please attach explanation of experience or resume. Note: failure to disclose previous experience or information hampers the ability to evaluate this application.

Does any principal have other businesses in this area? ☐ Yes ☒ No If Yes, please give trade name, address and describe the business \_\_\_\_\_

Has any principal had SLA reports or action within the past 5 years? ☐ Yes ☒ No If Yes, attach list of violations and dates of violations and outcomes, if any.

Attach a separate diagram that indicates the location (name and address) and total number of establishments selling/serving beer, wine (B/W) or liquor (OP) for 2 blocks in each direction. Please indicate whether establishments have On-Premise (OP) licenses. Please label streets and avenues and identify your location. Use letters to indicate Bar, Restaurant, etc. The diagram must be submitted with the questionnaire to the Community Board before the meeting.

**LOCATION:**

How many licensed establishments are within 1 block? 5

How many On-Premise (OP) liquor licenses are within 500 feet? 6

Is the premise within 200 feet on the same street of any school or place of worship? ☐ Yes ☒ No

**COMMUNITY OUTREACH:**

Please see the Community Board website to find block associations or tenant associations in the immediate vicinity of your location for community outreach. Applicants are encouraged to reach out to community groups, but it is not required. Also use provided petitions, which clearly state the name, address, license for which you are applying, and the hours and method of operation of your establishment at the top of each page. (Attach additional sheets of paper as necessary)

***We are including the following questions to be able to prepare stipulations and have the meeting be faster and more efficient. Please answer per your business plan; do not plan to negotiate at the meeting.***

1. My license type is: ☐ beer & cider ☐ wine, beer & cider ☒ liquor, wine, beer & cider

2. ☐ I will operate a full-service restaurant, specifically a (type of restaurant) \_\_\_\_\_ restaurant, or

☒ I will operate a BAR WITH LIMITED FOOD MENU,

☐ with a kitchen open and serving food during all hours of operation OR ☒ with less than a full-service kitchen but serving food during all hours of operation OR ☐ Other \_\_\_\_\_

3. My hours of operation will be:

Mon \_\_\_\_\_; Tue \_\_\_\_\_; Wed \_\_\_\_\_;

Thu \_\_\_\_\_; Fri \_\_\_\_\_; Sat \_\_\_\_\_;

Sun \_\_\_\_\_. (I understand opening is "no later than" specified opening hour, and all patrons are to be cleared from business at specified closing hour.)

4. ☒ I will not use outdoor space for commercial use (including Open Restaurants) OR

☐ I will close all outdoor dining allowed under the temporary Open Restaurants program and any other subsequent uses by 10:00 P.M. all days and not have any speakers or TV monitors outdoors

5. ☒ I will employ a doorman/security personnel: 8 - all days of operation

6. ☐ I will install soundproofing, PREVIOUSLY INSTALLED

7. ☐ I will close any front or rear façade doors and windows at 10:00 P.M. every night or when amplified sound is playing, including but not limited to DJs, live music and live nonmusical performances, or during unamplified performances or televised sports. ☒ I will have a closed fixed façade with no open doors or windows except my entrance door, which will close by 10:00 P.M. or when amplified sound is playing, including but not limited to DJs, live music and live nonmusical performances, or during unamplified performances or televised sports.
8. I will not have ☐ DJs, ☐ live music, ☒ third-party promoted events, ☐ any event at which a cover fee is charged, ☒ scheduled performances, ☐ more than \_\_\_\_\_ DJs per \_\_\_\_\_, ☒ more than \_\_\_\_\_ private parties per \_\_\_\_\_
9. ☐ I will play ambient recorded background music only.
10. ☒ I will not apply for an alteration to the method of operation or for any physical alterations of any nature without first coming before CB 3.
11. ☐ I will not seek a change in class to a full on-premises liquor license without first obtaining approval from CB 3.
12. ☒ I will not participate in pub crawls or have party buses come to my establishment.
13. ☒ I will not have unlimited drink specials, including boozy brunches, with food.
14. ☐ I will not have a happy hour or drink specials with or without time restrictions OR ☐ I will have happy hour and it will end by \_\_\_\_\_.
15. ☐ I will not have wait lines outside. ☒ I will have a staff person responsible for ensuring no loitering, noise or crowds outside.
16. ☒ I will conspicuously post this stipulation form beside my liquor license inside of my business.
17. ☒ Residents may contact the manager/owner at the number below. Any complaints will be addressed immediately. I will revisit the above-stated method of operation if necessary in order to minimize my establishment's impact on my neighbors.

Name: Isaiah Trusty

Phone Number: (215) 796-1695

# HELBRAUN | LEVEY

## NNEIGHBORHOOD MAP



# HELBRAUN | LEVEY

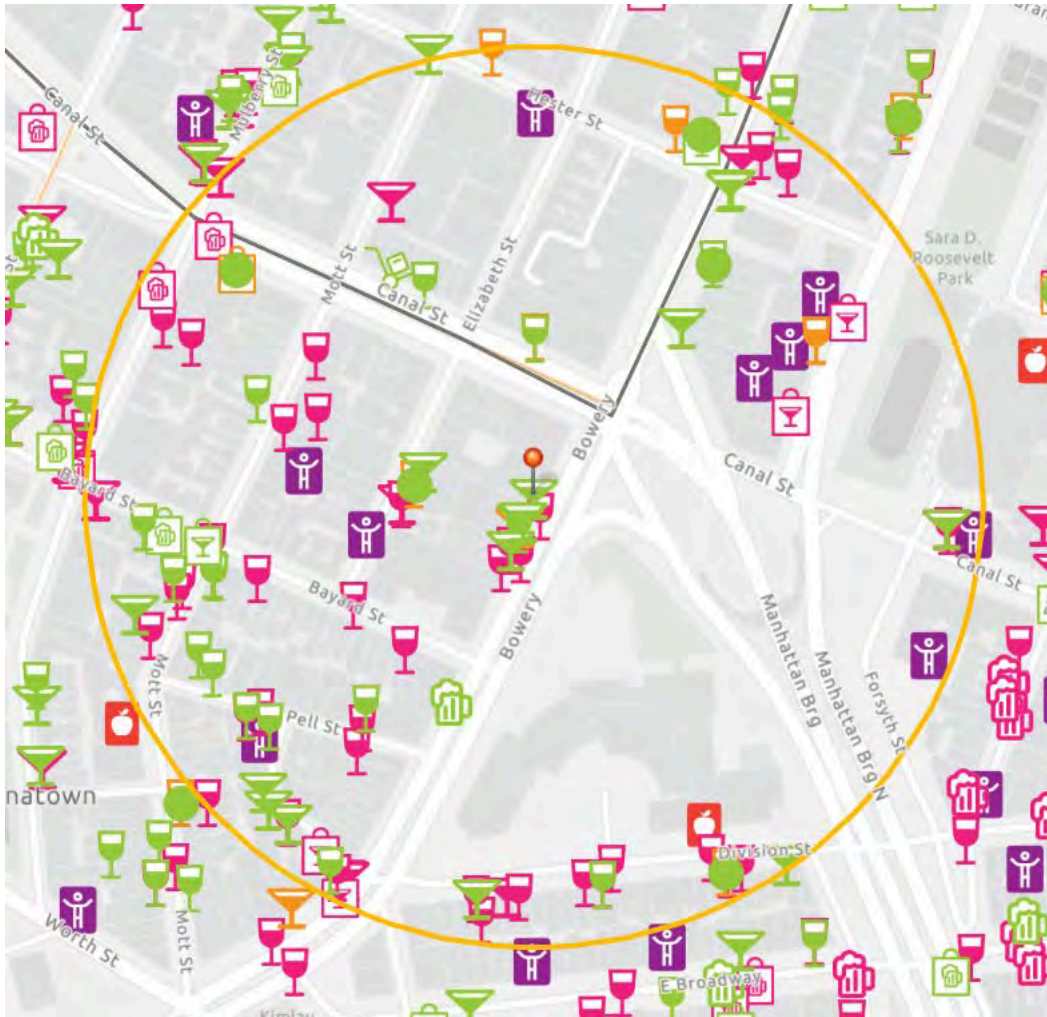

GREEN MARTINI=OP LICENSE

PINKK MARTINI=INACTIVE OP LICENSE

GREEN WINE=RW/TW LICENSE

PINK MARTINI=INACTIVE RW/TW LICENSE

This report is for informational purposes only in aid of identifying establishments potentially subject to 500 and 200 foot rules. Distances are approximated using industry standard GIS techniques and do not reflect actual distances between points of entry. The NYS Liquor Authority makes no representation as to the accuracy of the information and disclaims any liability for errors.

Proximity Report For:	
Location	50 Bowery, New York, New York, 10013
Geocode	Latitude: 40.71583 longitude: -73.99655
Report Generated On	8/21/2024

8 Closest Liquor Stores		
Name	Address	Distance
MARKS WINE & SPIRITS LTD License ID: 0100-23-125353 Legacy Serial No.: 1023591	53 MOTT STREET NEW YORK, New York 10013	559 ft
Century Wines Inc License ID: 0100-21-114295 Legacy Serial No.: 1335358	90 BOWERY ST NEW YORK, New York 10013	654 ft
CHIN KONG INC License ID: 0100-21-114840 Legacy Serial No.: 1023498	17 23 EAST BROADWAY STORE #104 NEW YORK, New York 10002	900 ft
R & S 49 LIQUOR CORP License ID: 0100-21-114049 Legacy Serial No.: 1297191	92 ELIZABETH ST NEW YORK, New York 10013	966 ft
SA VINO ITALIANO INC. License ID: 0100-23-124962 Legacy Serial No.: 1199593	200 GRAND ST MOTT & MULBERRY STREETS NEW YORK, New York 10013	1,212 ft
OCEAN WINE & SPIRIT INC License ID: 0100-22-118080 Legacy Serial No.: 1296083	273 GRAND ST NEW YORK, New York 10002	1,231 ft
CAFE MERENDA LLC License ID: 0091-22-101715 Legacy Serial No.: 1314328	83 HENRY ST STORE #2 NEW YORK, New York 10002	1,284 ft
WALKER LIQUOR CORP License ID: 0100-22-117918 Legacy Serial No.: 1023593	101 105 LAFAYETTE STREET NEW YORK, New York 10013	1,429 ft

Schools within 500 feet		
Name	Address	Distance
No Schools within 500 feet		

Churches within 500 feet	
Name	Distance
Trust In God Baptist Church	287 ft
Eastern States Buddhist Temple	388 ft
Mahayana Buddhist Temple	417 ft
Buddhist Cultural Center of USA	496 ft
American Mind In Mind Buddhist Associate	496 ft
The American Buddhist Confederation	496 ft

Pending On Premises Liquor Licenses within 750 feet		
Name	Address	Distance
Kaiseki NYC LLC Application ID: NA-0340-23-142262	14-18 Elizabeth St #16B a/k/a 46-48 Bowery New York, New York 10013.0	58 ft

Active On Premises Liquor Licenses within 750 feet		
Name	Address	Distance
BRIDGEVIEW HOTEL LLC&JOIE DE VIVRE HOSPITALITY LLC License ID: 0343-23-101628 Legacy Serial No.: 1300384	50 BOWERY LOBBY LEVEL NEW YORK, New York 10013	4 ft
CANAL ARCADE LLC License ID: 0340-22-112493 Legacy Serial No.: 1322840	48A BOWERY ST NEW YORK, New York 10013	47 ft
TORAJI NY INC License ID: 0340-24-119227 Legacy Serial No.: 6027583	48 BOWERY NEW YORK, NY 10013	50 ft
BOWERY GYOKAI LLC License ID: 0340-22-113309 Legacy Serial No.: 1322562	44 BOWERY NEW YORK, New York 10013	99 ft
MUSASHIYA NYC LLC License ID: 0340-22-111176 Legacy Serial No.: 1339198	16 ELIZABETH ST 15, 16 & 17 AKA 46 BOWERY NEW YORK, New York 10013	189 ft
BOWERY ST HOLG CORP, BOWERY ST ASSO LLC&LOWER EAST License ID: 0343-22-118778 Legacy Serial No.: 1346716	141 151 BOWERY NEW YORK, New York 10002	374 ft
93 BOWERY HOLDINGS LLC & KITCHEN 93 INC License ID: 0343-22-127105 Legacy Serial No.: 1255629	93 BOWERY NEW YORK, New York 10002	605 ft
CITYVIEW CHINATOWN LLC License ID: 0340-22-115031 Legacy Serial No.: 1291356	93 BOWERY 18TH FL NEW YORK, New York 10002	607 ft
BLUE AGAVE NY INC License ID: 0340-23-138179 Legacy Serial No.: 1335436	11 DOYERS ST NEW YORK, New York 10013	669 ft
HAKKA CUISINE LLC License ID: 0340-22-108429 Legacy Serial No.: 1334417	11 DIVISION ST NEW YORK, NY 10002	676 ft

Active On Premises Liquor Licenses within 750 feet		
Name	Address	Distance
8 TUXEDOS INC License ID: 0340-23-129176 Legacy Serial No.: 1306506	5 DOYERS ST NEW YORK, New York 10013	684 ft
APOTHEKE LLC License ID: 0370-24-116108 Legacy Serial No.: 6024400	9 DOYERS STREET BOWERY & PELL STREETS NEW YORK, New York 10013	686 ft
TIME CAFE LLC License ID: 0370-24-107990 Legacy Serial No.: 6016039	105 CANAL ST NEW YORK, NY 10002	692 ft
TEA BISTRO INC License ID: 0340-22-104421 Legacy Serial No.: 1281439	45 MOTT ST GFL & CELLAR FL NEW YORK, New York 10013	695 ft
SUN YUE TUNG CORP License ID: 0340-23-132447 Legacy Serial No.: 1139260	55 79 DIVISION ST AKA 88 E BWY NEW YORK, New York 10002	744 ft

## BITES

<b>Chips &amp; Guacamole</b> Homemade Tortilla Chips	\$14
<b>Tuna Tartare Tacos</b> Avocado, Cucumber, & Eel Sauce Dressing	\$24
<b>Wagyu Sliders</b> Parmesan & truffle Aioli	\$32
<b>Pork/Chicken/Vegatable Dumplings</b> Served with Soy Sauce	\$24
<b>Chicken Tenders</b> Served with BBQ Sauce or Honey Mustard	\$22
<b>Miniature Margherita Pizza</b> Add Pepperoni +5	\$18
<b>Hand Cut Truffle Fries</b>	\$18
<b>Charcuterie Board</b>	\$25
<b>Popcorn</b>	\$12

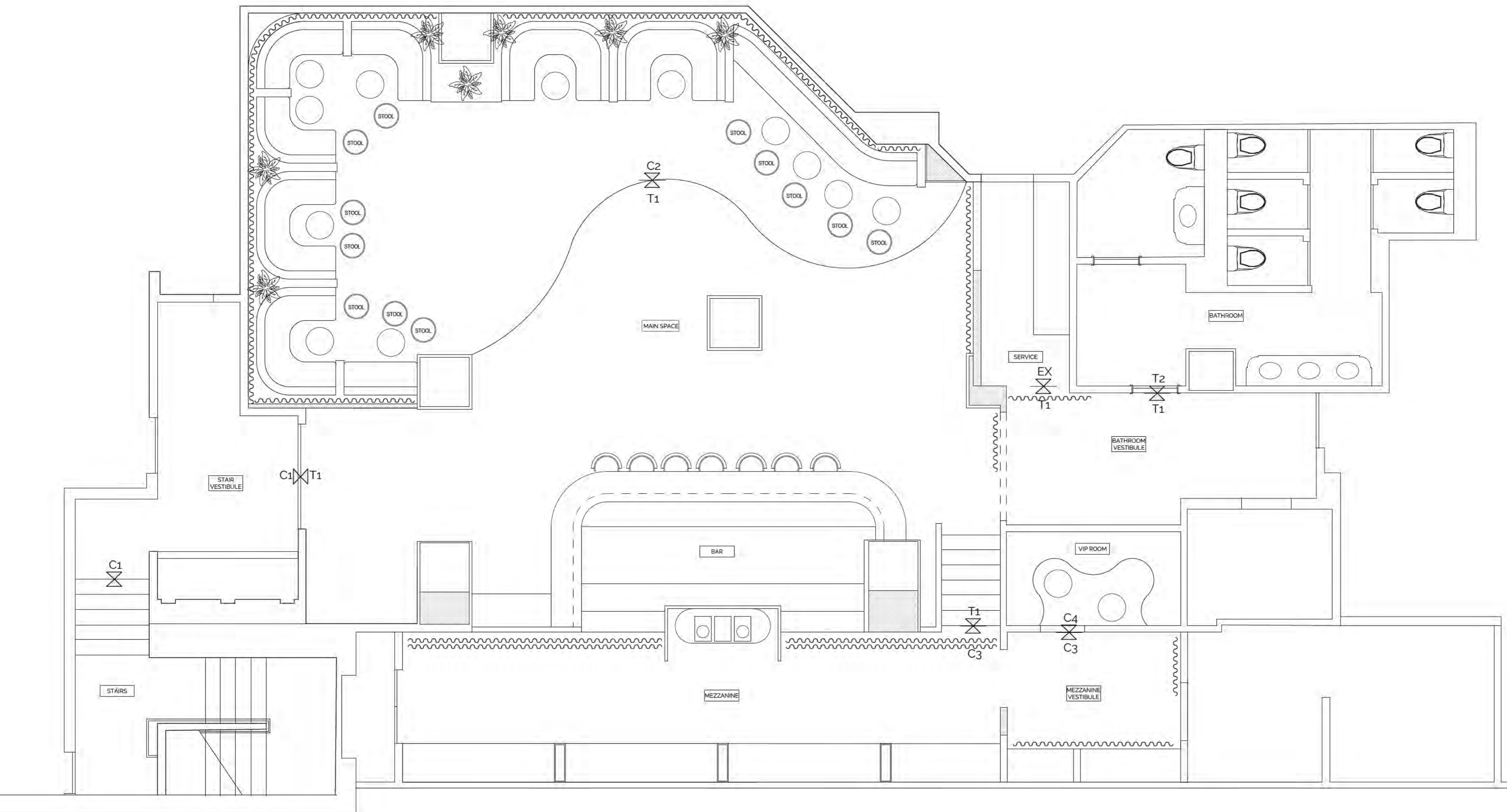

## Exhibit A

