



THE CITY OF NEW YORK MANHATTAN COMMUNITY BOARD 3

59 East 4th Street - New York, NY 10003

Phone (212) 533-5300

www.cb3manhattan.org - mn03@cb.nyc.gov

Tareake Dorill, Board Chair

Susan Stetzer, District Manager

Community Board 3 Liquor License Application Questionnaire

NOTE: ALL ITEMS MUST BE SUBMITTED FOR APPLICATION TO BE CONSIDERED.

The following items and questionnaire package are due by date listed in email invite:

☒ Schematics, floor plans or architectural drawings of the inside of the premise.

☒ A proposed food and or drink menu.

The following items are due by noon Friday before the meeting:

☒ Petition in support of proposed business or change in business with signatures from residential tenants at location and in buildings adjacent to, across the street from and behind proposed location. Petition must give proposed hours and method of operation. For example: restaurant, sports bar, combination restaurant/bar. (petition provided)

☒ Notice of proposed business to block or tenant association if one exists. You can find community groups and contact information on the CB 3 website:

<https://www1.nyc.gov/site/manhattancb3/resources/community-groups.page>

(this is not required but strongly suggested if a relevant group exists)

☒ Proof of conspicuous posting of notices at the site for 7 days prior to the meeting (please include newspaper with date in photo or a timestamped photo).

Check which you are applying for:

☒ new liquor license ☐ alteration of an existing liquor license ☐ corporate change

Check if either of these apply:

☐ sale of assets ☐ upgrade (change of class) of an existing liquor license

Today's Date: 03/30/2023

Is location currently licensed? ☐ Yes ☒ No Type of license: _____

If alteration, describe nature of alteration: _____

Previous or current use of the location: Previously operated as a restaurant- Stackleather LLC- Serial #1304706

Corporation and trade name of current license: _____

APPLICANT: The Soho Pig Collective LLC

Premise address: 42 Avenue B, New York, NY 10009

Cross streets: East 3rd Street & East 4th Street

Name of applicant and all principals: Sherry Grimes, Shavonne Hylton, Dorothy Grimes

Trade name (DBA): Pig & Butter Ave B

PREMISE:

Type of building and number of floors: Mixed use, multi-unit building- 6 floors (including the basement)

Does premise have a valid Certificate of Occupancy, including for any back/side yard or roof use?

☒ Yes ☐ No What is maximum NUMBER of people permitted 75

What is the zoning designation (check zoning using map: <http://gis.nyc.gov/doitt/nycitymap/> - please give specific zoning designation, such as R8 or C2): R7A with C1-5 commercial overlay

PROPOSED METHOD OF OPERATION:

What are the proposed days/hours of operation? (Specify days and hours each day and hours of outdoor space, if applicable) Sunday: 10am-10pm; Monday-Tuesday: Closed; Wednesday: 2pm-10pm;
Thursday: 2pm-11pm; Friday: 2pm-1am; Saturday: 10am-2am

Will any other business besides food or alcohol service be conducted at premise, i.e., retail? ☐ Yes ☒ No

If yes, please describe what type: _____

Number of indoor tables? 6 Total number of indoor seats? 25 (14 table seats, 9 bar seats, 2 counter seats)

How many stand-up bars/bar seats are located on the premise (number, length, and location) _____
1 Bar- 14' x 4'- Ground Floor

*(A **stand-up bar** is any bar or counter -with seating or not- where you can order, pay for, and receive alcohol)*

Does premise have a full kitchen? ☐ Yes ☒ No

Does it have a food preparation area? ☒ Yes ☐ No (If any, show on diagram)

Is food available for sale? ☒ Yes ☐ No If yes, describe type of food and submit a menu _____
See attached menu

What are the hours the kitchen will be open? All hours of open operation

Will a manager or principal always be on site? ☒ Yes ☐ No If yes, which? _____

How many employees will there be? 3

Do you have or plan to install ☐ French doors ☐ accordion doors or ☐ windows? N/A

Will there be TVs/monitors? ☐ Yes ☒ No (If Yes, how many?) _____

Will premise have music? ☒ Yes ☐ No

If Yes, what type of music? ☐ Live musician ☐ DJs ☒ Streaming services/playlists

If other type, please describe _____

What will be the music volume? ☒ Background (conversational) ☐ Entertainment (live music venue level) Please describe your sound system: Simple speakers with volume control

Will you host any promoted events, scheduled performances, or any event at which a cover fee is charged? If Yes, what type of events or performances are proposed and how often? No

If promoted events, please explain the nature in which you plan to promote? Social media / online ads / outside promoters? N/A

How do you plan to manage vehicular traffic and crowds on the sidewalk caused by your establishment?

Please attach plans. (Please do not answer "we do not anticipate congestion.")

Will implement a text message "readiness" system to prevent crowding while waiting for a table and will have a principal or employee responsible for insuring no traffic or crowds form on the sidewalk.
Will there be security personnel? ☐ Yes ☒ No (If Yes, how many and when)

How do you plan to manage noise inside and outside your business so neighbors will not be affected?

Please attach plans. Simple speakers with volume control- background , recroded music only

Is sound proofing installed? ☐ Yes ☒ No

If not, do you plan to install sound proofing? ☐ Yes ☒ No

Are there current plans to use the Open Restaurants program for the sale or consumption of alcoholic beverages outdoors? (includes roof & yard) ☐ Yes ☒ No If Yes, describe and show on diagram:

N/A

APPLICANT HISTORY:

Has this corporation or any principal been licensed for sale of alcohol previously? ☒ Yes ☐ No

If yes, please indicate name of establishment: The Bedstuy Restaurant Group LLC d/b/a Pig & Butter (Serial #1336228)

Address: 134 Ludlow Street, New York, NY 10002 Community Board # 3

Dates of operation: 01/2022- Present

Has any principal had work experience similar to the proposed business? ☒ Yes ☐ No If Yes, please attach explanation of experience or resume. Note: failure to disclose previous experience or information hampers the ability to evaluate this application.

Does any principal have other businesses in this area? ☐ Yes ☒ No If Yes, please give trade name, address and describe the business

Has any principal had SLA reports or action within the past 5 years? ☐ Yes ☒ No If Yes, attach list of violations and dates of violations and outcomes, if any.

Attach a separate diagram that indicates the location (**name and address**) and total number of establishments selling/serving beer, wine (B/W) or liquor (OP) for 2 blocks in each direction. Please indicate whether establishments have On-Premise (OP) licenses. Please label streets and avenues and identify your location. Use letters to indicate Bar, Restaurant, etc. The diagram must be submitted with the questionnaire to the Community Board before the meeting.

EXPERIENCE OF APPLICANT PRINCIPALS

Sherry Grimes

Applicant principal Sherry Grimes is a graduate of the French Culinary Institute and has been a chef for the last 13 years. She began as a Sauté Chef Superfine in DUMBO for the first 3 years, turned an 8 x 10 truck container into a from scratch take-out restaurant in the original DeKalb Market in 2011, owned and operated a restaurant in NJ, a food truck in Los Angeles, and has owned and operated a catering company in Santa Barbara, California and in NYC for the past 13 years. Ms. Grimes is the current chef and owner of Pig & Butter on the Lower East Side, where she has operated with a liquor license since January 2022.

Dr. Shavonne Hylton

Applicant principal Dr. Shavonne Hylton is an environmental scientist and computer engineer who has assisted Ms. Grimes in all of her business endeavors from their inception. Dr. Hylton also designs all the drink menus and designs and executes all of the party and event catering.

LOCATION:

How many licensed establishments are within 1 block? 2 on the same block as Applicant

How many On-Premise (OP) liquor licenses are within 500 feet? 11

Is the premise within 200 feet on the same street of any school or place of worship? ☐ Yes ☒ No

COMMUNITY OUTREACH:

Please see the Community Board website to find block associations or tenant associations in the immediate vicinity of your location for community outreach. Applicants are encouraged to reach out to community groups, but it is not required. Also use provided petitions, which clearly state the name, address, license for which you are applying, and the hours and method of operation of your establishment at the top of each page. (Attach additional sheets of paper as necessary)

We are including the following questions to be able to prepare stipulations and have the meeting be faster and more efficient. Please answer per your business plan; do not plan to negotiate at the meeting.

1. My license type is: ☐ beer & cider ☐ wine, beer & cider ☒ liquor, wine, beer & cider
2. ☐ I will operate a full-service restaurant, specifically a (type of restaurant) _____ restaurant, or
☒ I will operate a Small bar serving food _____,
☐ with a kitchen open and serving food during all hours of operation OR ☒ with less than a full-service kitchen but serving food during all hours of operation OR ☐ Other _____
3. My hours of operation will be:
Mon Closed ; Tue Closed ; Wed 2pm-10pm ;
Thu 2pm-11pm ; Fri 2pm-1am ; Sat 10am-2am ;
Sun 10am-10pm . (I understand opening is "no later than" specified opening hour, and all patrons are to be cleared from business at specified closing hour.)
4. ☒ I will not use outdoor space for commercial use (including Open Restaurants) OR
☐ My sidewalk café hours or other outside hours (including Open Restaurants) will be _____
5. ☐ I will employ a doorman/security personnel: N/A
6. ☐ I will install soundproofing, N/A

7. ☒ I will close any front or rear façade doors and windows at 10:00 P.M. every night or when amplified sound is playing, including but not limited to DJs, live music and live nonmusical performances, or during unamplified performances or televised sports. ☐ I will have a closed fixed façade with no open doors or windows except my entrance door, which will close by 10:00 P.M. or when amplified sound is playing, including but not limited to DJs, live music and live nonmusical performances, or during unamplified performances or televised sports.
8. I will not have ☒ DJs, ☒ live music, ☒ third-party promoted events, ☒ any event at which a cover fee is charged, ☐ scheduled performances, ☐ more than _____ DJs per _____, ☐ more than _____ private parties per _____
9. ☒ I will play ambient recorded background music only.
10. ☒ I will not participate in pub crawls or have party buses come to my establishment.
11. ☒ I will not have unlimited drink specials, including boozy brunches, with food.
12. ☐ I will not have a happy hour or drink specials with or without time restrictions OR ☒ I will have happy hour and it will end by 9pm.
13. ☒ I will not have wait lines outside. ☒ I will have a staff person responsible for ensuring no loitering, noise or crowds outside.
14. ☒ I will conspicuously post this stipulation form beside my liquor license inside of my business.
15. ☒ Residents may contact the manager/owner at the number below. Any complaints will be addressed immediately. I will revisit the above-stated method of operation if necessary in order to minimize my establishment's impact on my neighbors.

Name: Sherry Grimes

Phone Number: 917-407-8161

The Soho Pig Collective LLC d/b/a Pig & Butter Ave B- Ground Floor Diagram
42 Avenue B, New York, NY 10009

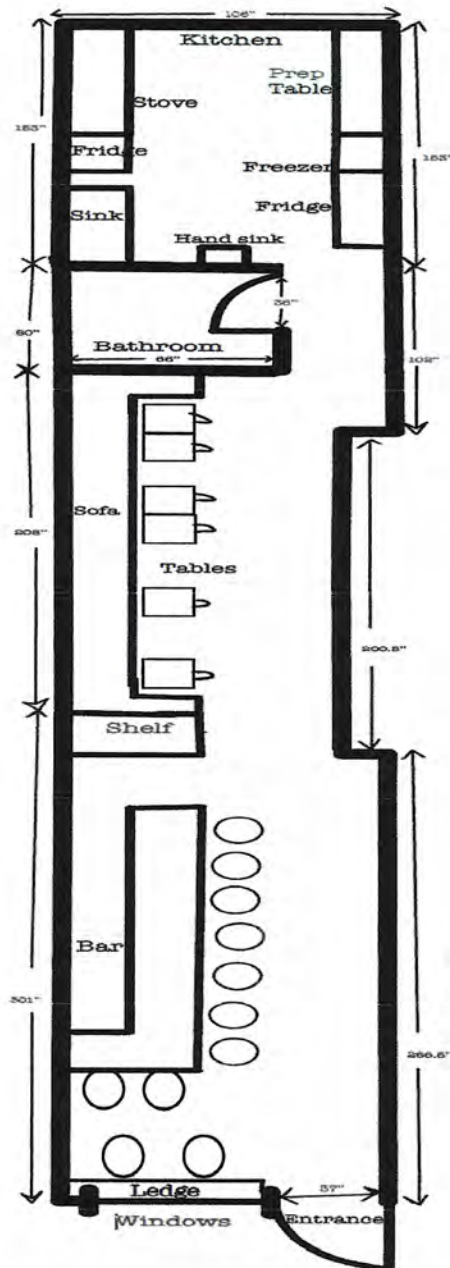

Seating:

-6 Tables

-25 Total Seats

14 Table Seats, 9 Bar Seats, 2 Counter Seats

The Soho Pig Collective LLC d/b/a Pig & Butter Ave B- Basement Diagram
42 Avenue B, New York, NY 10009





TM

BRUNCHY STUFF

DEILED EGGS

Toasted Capers | Truffle Oil | Sweet Smokey Paprika | Dill

ROAST PORK & SHRIMP TOAST

Duck Sauce

BACON, EGG & CHEESE on BRIOCHE

Chives | Columbian Aji

KOREAN SHORT RIBS OF BEEF & CHEESY GRITS

Columbian Aji | Wasabi Microgreens

Runny Fried Egg \$4

SWEET POTATO MOFONGO

Chorizo | Garlic Mojo

Vegan Chorizo add \$4 / Runny Fried Egg \$4

CRÈME ANGLAISE CHALLAH FRENCH TOAST

Berry Compote | Buttery Maple Syrup

BAQ

34TH STREET KOREAN FRIED CHICKEN

Charred Pineapple Salsa | Chipotle Crema | Sweet Pickled Red Onion | Columbian Aji

Runny Fried Egg \$4

SMOKED NECKBONE BAO

Collard Green Cabbage Slaw | Southern Pepper Sauce

KOREAN SHORT RIBS OF BEEF

Japanese Black Garlic Aioli Cabbage Slaw | Cilantro | Mexican Siracha

SWEET STUFF

GRILLED CHEESE

Brie | Ice Cream | Honey | Thyme | Cinnamon

BURNT SALTED CARAMEL POT DE CREME

Chantilly Cream

CONCOCTIONS MAISON

\$13

SPARKLING MOJITO

Rum | Mint | Lime | Bitters |
Simple Syrup | Prosecco

*Add a flavor +2

Passion fruit | Guava |
Strawberry | Mango | Yuzu

**Make it an Old Cuban +2

Rum | Mint | Lime | Bitters |
Champagne | Simple Syrup

ESPRESSO MARTINI

Espresso | Vodka | Kahlua |
Creme de Cacao

MARGARITA

Tequila | Lime Juice |
Cointreau

*Add a flavor +2

Grapefruit Ginger |

Passionfruit | Guava |

Strawberry | Mango | Yuzu

GIN TONICS

"The Bronx Tonic"

Gin | Tonic | Blood Orange |
Lime

"The Queens Tonic"

Gin | Tonic | Plum Yuzu

"The Manhattan Tonic"

Gin | Tonic | Elderflower |
Bitters

"The Brooklyn Tonic"

Gin | Tonic | Blackberry | Lime

"The Staten Island Tonic"

Gin | Tonic | Roasted
Pineapples | Lime

KCBC BEER

\$9

MARBLE OF DOOM

5.5%

Blackberry Pomegranate Sour

THIS IS YOUR BRAIN ON HOPS

8.5%

Double Dry Hopped Double IPA

VAMPIRE SQUID

12%

Imperial Stout

INFINITE MACHINE

4.8%

Pilsner

DOC'S CIDER

\$10

RASPBERRY

Fresh raspberries are added to
Doc's Draft Hard Apple Cider
and re-fermented to create a
delicious spin on a traditional
cider.

APPLE

Semi-dry and wonderfully
effervescent with a remarkably
fresh apple nose. Crisp and
fruit-forward.

PEAR

Dry finish. Intense aroma of
ripened pear enhances light,
crisp taste and clean, dry
finish.

SATURDAYS & SUNDAYS ONLY!

*Unlimited Classic Mimosas, Red, or White Sangria

-20-

*Must purchase an entree

75 minutes

WINE/ROSÉ

Glass | Bottle
12 | 40

RED

Malbec | Tempranillo | Syrah

WHITE

Pinot Grigio | Sancerre |
Chardonnay

ROSÉ

Grapefruit

brandy | pineapple | orange |
apple

Grapefruit Rosé

Grapefruit rosé | sauvignon
blanc | gin | rum | triple sec |
brandy | pineapple | orange |
apple

Prosecco

Prosecco | sauvignon blanc | gin
| rum | triple sec | apricot
liqueur | brandy | pineapple |
orange | apple

BELLINIS

\$13.00

Peach

Peach Puree | Prosecco

Blood Orange

Blood Orange Puree | Prosecco

Apple

Apple Puree | Prosecco |
Camomile Liqueur

Strawberry

Strawberry Puree | Prosecco

SPRITZES

\$13.00

Aperol

Aperol | Prosecco | Soda Water

Mediterranean

Orgeat | Cava | Gin | Lemon
Juice

MIMOSAS

\$12.00

Lychee Rosé

Sparkling Rose | Lychee syrup

Pineapple Orange Creamsicle

Sparkling Moscato | Orange
Sherbet | Pineapple Juice

Classic Orange juice | Prosecco

BRUNCH LIBATIONS

MARY WITH A KICK \$14.00

Vodka | Deviled Egg | Sweet
Smoked Paprika | Truffle Oil
| Toasted Capers | Candied Bacon
| Smokey Salt Tajin Rim

"SMOKEY MARY" TOMATILLO BLOODY MARY \$14.00

Vodka | Deviled Egg | Sweet
Smoked Paprika | Truffle Oil
| Toasted Capers | Candied Bacon
| Smokey Salt Tajin Rim

SANGRIA

\$13.00/glass | \$40.00/carafe
*Make it a sangrita [+ Tequila]
\$15.00/glass | \$50.00/carafe

Red

Tempranillo | gin | rum | triple
sec | apricot liqueur | brandy |
cinnamon | pineapple | orange |
apple

White

Sauvignon blanc | gin | rum |
triple sec | apricot liqueur |

SATURDAYS & SUNDAYS ONLY!

*Unlimited Classic Mimosas, Red, or White Sangria

-20-

*Must purchase an entree
75 minutes





This report is for informational purposes only in aid of identifying establishments potentially subject to 500 and 200 foot rules. Distances are approximated using industry standard GIS techniques and do not reflect actual distances between points of entry. The NYS Liquor Authority makes no representation as to the accuracy of the information and disclaims any liability for errors.

Proximity Report For:

Location **42 Ave B, New York, New York, 10009**

Geocode **Latitude: 40.72294
longitude: -73.98291**

Report Generated On **3/30/2023**

8 Closest Liquor Stores

Name	Address	Distance
DISCOVERY WINES LLC Ser #: 1254572	16 AVE B NEW YORK, NY 10009	373 ft
NIZGA CORP Ser #: 1023551	58 AVENUE A NEW YORK, NY 10009	699 ft
EAST HOUSTON STREET WINE & LIQUOR INC Ser #: 1266928	250 E HOUSTON ST STORE #13 NEW YORK, NY 10002	775 ft
SFDW INC Ser #: 1339790	24 AVENUE C NEW YORK, NY 10009	842 ft
TURTLE DOVE LLC Ser #: 1271455	28 30 CLINTON ST STORE B NEW YORK, NY 10002	1,012 ft
EAST VILLAGE WINE CORP Ser #: 1260885	100 AVENUE C NEW YORK, NY 10009	1,149 ft
JCCSM INC Ser #: 1336591	45 1ST AVE NEW YORK, NY 10003	1,470 ft
VIJAYA GROUP INC Ser #: 1326346	100 STANTON ST NEW YORK, NY 10002	1,506 ft

Schools within 500 feet

Name	Address	Distance
CONNELLY CTR EDUCATION/HOLY CHILD MIDDLE SCHOOL	220 E 4TH ST NEW YORK, NY 10009	308 ft
NEW AMSTERDAM SCHOOL	62 AVE B NEW YORK, NY 10009	340 ft

Churches within 500 feet

Name	Distance
Emanuel Spanish Baptist Church	256 ft
Most Holy Redeemer Church	378 ft

Pending On Premises Liquor Licenses within 750 feet

Name	Address	Distance
BOOK CLUB BAR LLC Ser #: 1346476	197 E 3RD ST NEW YORK, NY 10009	106 ft
GAMA LOUNGE LLC Ser #: 1340562	50 AVENUE B NEW YORK, NY 10009	109 ft
51 AVENUE B LLC Ser #: 1351945	51 AVENUE B NEW YORK, NY 10004	126 ft
OYSTER CITY LLC Ser #: 1350376	200 E 3RD ST NEW YORK, NY 10003	137 ft

Active On Premises Liquor Licenses within 750 feet

Name	Address	Distance
EAST COAST FISH MARKET INC Ser #: 1336397	45 AVENUE B NEW YORK, NY 10009	80 ft
AH BUSINESS MANAGEMENT LLC Ser #: 1334462	34 AVENUE B NEW YORK, NY 10009	133 ft
TD AB LLC Ser #: 1317712	29 AVENUE B STORE 2 NEW YORK, NY 10009	168 ft
GOSLING INC Ser #: 1309866	234 E 4TH ST WESTERLY STORE NEW YORK, NY 10009	178 ft
BECAF LLC Ser #: 1188694	29 AVENUE B A/K/A 33 AVE #3 CORNER OF AVE B & E. 3 ST. NEW YORK, NY 10009	186 ft
GALMAC LLC Ser #: 1304609	28-30 AVENUE B NEW YORK, NY 10009	206 ft
B M POST LLC Ser #: 1329963	217 E 3RD ST NEW YORK, NY 10009	250 ft
25 B GROUP REST AVE LLC Ser #: 1245111	25 AVENUE B NEW YORK, NY 10009	256 ft
GERMAT OF NY INC Ser #: 1338768	192 E 2ND ST NEW YORK, NY 10009	370 ft

AND ANOTHER ONE INC Ser #: 1345607	190 E 2ND ST NEW YORK, NY 10009	373 ft
GREAT CABIN LLC, THE Ser #: 1311376	205 E 4TH ST NEW YORK, NY 10009	443 ft
DESMO 916 CORP Ser #: 1229027	545 E 5TH ST AKA 76 AVE B AVENUES A & B NEW YORK, NY 10009	562 ft
THUNDERBOLT CORP Ser #: 1024675	531 E 5TH STREET NEW YORK, NY 10009	630 ft
MAPLE VIEW HOLDINGS CORP Ser #: 1138797	2 4 CLINTON ST EAST HOUSTON & STANTON STREETS NEW YORK, NY 10002	634 ft
THAI TOMPKINS INC Ser #: 1337933	50 AVENUE A NEW YORK, NY 10009	659 ft
STERLING PARKSIDE CORP Ser #: 1024140	317 E HOUSTON STREET NEW YORK, NY 10002	667 ft
DEROSSI 5TH STREET LLC Ser #: 1330870	511 E 5TH ST NEW YORK, NY 10009	668 ft
RAGUBOY CORP Ser #: 1140962	156 EAST 2ND STREET AVENUE A & AVENUE B NEW YORK, NY 10009	682 ft
CAVAN SLIGO NYC INC Ser #: 1322172	269 E HOUSTON ST NEW YORK, NY 10002	700 ft
COBART INC Ser #: 1345517	321 E HOUSTON ST NEW YORK, NY 10002	706 ft
ROLO REST LLC Ser #: 1225341	32 AVENUE A E 2ND STREET & E 3RD STREET NEW YORK, NY 10009	709 ft
TTBK INC Ser #: 1305169	188 SUFFOLK ST NEW YORK, NY 10002	730 ft
ILLB INC Ser #: 1314604	43 AVENUE A 141 E 3RD ST GND FL NEW YORK, NY 10009	749 ft

Certificate of Occupancy

CO Number: 104001571F

This certifies that the premises described herein conforms substantially to the approved plans and specifications and to the requirements of all applicable laws, rules and regulations for the uses and occupancies specified. No change of use or occupancy shall be made unless a new Certificate of Occupancy is issued. *This document or a copy shall be available for inspection at the building at all reasonable times.*

A. Borough: Manhattan Address: 42 AVENUE B Building Identification Number (BIN): 1004997	Block Number: 00399 Lot Number(s): 36 Building Type: Altered	Certificate Type: Final Effective Date: 04/08/2016
<i>For zoning lot metes & bounds, please see BISWeb.</i>		
B. Construction classification: 3 (Prior to 1968 Code) Building Occupancy Group classification: RES (Prior to 1968 Code) Multiple Dwelling Law Classification: OL		
No. of stories: 5 Height in feet: 58 No. of dwelling units: 12		
C. Fire Protection Equipment: None associated with this filing.		
D. Type and number of open spaces: None associated with this filing.		
E. This Certificate is issued with the following legal limitations: None		
Borough Comments: None		



Borough Commissioner



Commissioner

Certificate of Occupancy

CO Number: 104001571F

Permissible Use and Occupancy						
All Building Code occupancy group designations are 1968 designations, except RES, COM, or PUB which are 1938 Building Code occupancy group designations.						
Floor From To	Maximum persons permitted	Live load lbs per sq. ft.	Building Code occupancy group	Dwelling or Rooming Units	Zoning use group	Description of use
CEL		OG	COM			STORAGE, BOILER ROOM
001		75	COM		6	STORES
002		40	RES	3	2	THREE(3) APARTMENTS
003		40	RES	3	2	THREE(3) APARTMENTS
004		40	RES	3	2	THREE(3) APARTMENTS
005		40	RES	3	2	THREE(3) APARTMENTS
RO F		40	RES		2	ROOF TERRACE
END OF SECTION						



Borough Commissioner



Commissioner

END OF DOCUMENT

104001571/000 4/11/2016 12:06:53 PM

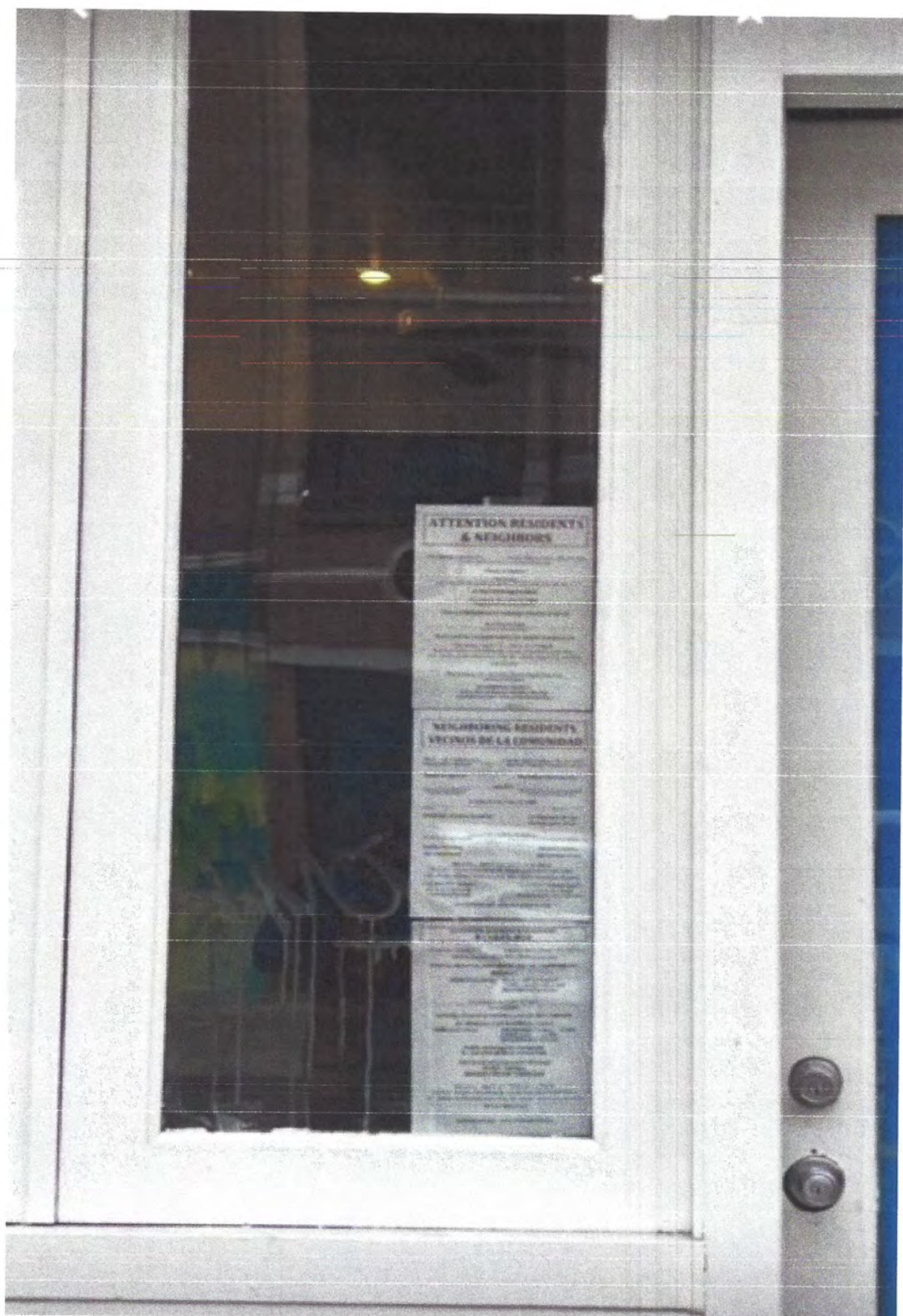

From: Kimberly Summers kimberly@ds-lawoffices.com 

Subject: 42 Avenue B- CB3 Application

Date: March 30, 2023 at 7:27 PM

To:

Cc: mhannay@igc.org, franklin.douglas@gmail.com, ayoharrington@gmail.com, friendsoftheles@gmail.com, info@gohproductions.org, ck@wingflix.com, info@evccnyc.org, dakota@fabnyc.org, andrew@gvshp.org

KS

Good evening,

My office represents The Soho Pig Collective LLC, d/b/a Pig & Butter Ave B, who intends to open a "bar/tavern" at 42 Avenue B (Similar to their other location at 134 Ludlow Street serving all day brunch and cocktails- <https://www.pigandbutter.com/>) . Attached to this email is a complete copy of their CB3 Application. The intended hours of operation for this location are as follows: Sunday: 10am-10pm; Monday-Tuesday: Closed; Wednesday: 2pm-10pm; Thursday: 2pm-11pm; Friday- 2pm-1am; and Saturday 10am-2am. They are not seeking to use any outdoor space and are scheduled to appear before the Community Board on Monday, April 17th at 6:30pm.

If you have any questions or comments on this application please do not hesitate to reach out. Also, if you know anyone who might have a interest in this location/application, we would greatly appreciate it if you could forward it to their attention (we tried to be as inclusive with the outreach as possible so my apologies if technically you are outside the area that would be interested in this application). Thank you!

Best regards,

Kimberly A. Summers, Esq.
DIPASQUALE & SUMMERS
555 Fifth Avenue, 14th Floor
New York, New York 10017
(t) 646.383.4607
(f) 646.606.2388
www.DS-LawOffices.com

Follow us on: [Facebook](#) [Twitter](#) [LinkedIn](#)

This e-mail is confidential and is intended only for the person(s) named above. Its contents may also be protected by privilege, and all rights to privilege are expressly claimed and not waived. If you have received this e-mail in error, please call us immediately and destroy the entire e-mail. If this e-mail is not intended for you, any reading, distribution, copying, or disclosure of this e-mail is strictly prohibited.



Soho Pig
Collect...ted.pdf