



THE CITY OF NEW YORK
MANHATTAN COMMUNITY BOARD 3

59 East 4th Street - New York, NY 10003

Phone (212) 533-5300

www.cb3manhattan.org - info@cb3manhattan.org

Jamie Rogers, Board Chair

Susan Stetzer, District Manager

Community Board 3 Liquor License Application Questionnaire

Please bring the following items to the meeting:

NOTE: ALL ITEMS MUST BE SUBMITTED FOR APPLICATION TO BE CONSIDERED.

- Photographs of the inside and outside of the premise.
- Schematics, floor plans or architectural drawings of the inside of the premise.
- A proposed food and or drink menu.
- Petition in support of proposed business or change in business with signatures from residential tenants at location and in buildings adjacent to, across the street from and behind proposed location. Petition must give proposed hours and method of operation. For example: restaurant, sports bar, combination restaurant/bar. (petition provided)
- Notice of proposed business to block or tenant association if one exists. You can find community groups and contact information on the CB 3 website:
http://www.nyc.gov/html/mancb3/html/communitygroups/community_group_listings.shtml
- Photographs of proof of conspicuous posting of meeting with newspaper showing date.
- If applicant has been or is licensed anywhere in City, letter from applicable community board indicating history of complaints and other comments.

Check which you are applying for:

- new liquor license
- alteration of an existing liquor license
- corporate change

Check if either of these apply:

- sale of assets
- upgrade (change of class) of an existing liquor license

Today's Date: _____

If applying for sale of assets, you must bring letter from current owner confirming that you are buying business or have the seller come with you to the meeting.

Is location currently licensed? Yes No Type of license: _____

If alteration, describe nature of alteration: _____

Previous or current use of the location: French Style Cafe

Corporation and trade name of current license: Downtown Cafe LLC, Cafe Henrie

APPLICANT:

Premise address: 110 Forsyth St

Cross streets: Broome + Delancy Streets

Name of applicant and all principals: Downtown Cafe LLC

Omar Pringle, Andre Sarawa + Brett Robinson

Trade name (DBA): Cafe Henrie

PREMISE:

Type of building and number of floors: Mixed Use, 6 Floors

Will any outside area or sidewalk cafe be used for the sale or consumption of alcoholic beverages? (includes roof & yard) Yes No If Yes, describe and show on diagram: _____

Does premise have a valid Certificate of Occupancy and all appropriate permits, including for any back or side yard use? Yes No What is maximum NUMBER of people permitted? _____

Do you plan to apply for Public Assembly permit? Yes No

What is the zoning designation (check zoning using map: <http://gis.nyc.gov/doitt/nycitymap/> - please give specific zoning designation, such as R8 or C2): C4-4A

PROPOSED METHOD OF OPERATION:

Will any other business besides food or alcohol service be conducted at premise? Yes No If yes, please describe what type: _____

What are the proposed days/hours of operation? (Specify days and hours each day and hours of outdoor space) 7am TO 2am, 7 days a week

Number of tables? 20 Total number of seats? 40

How many stand-up bars/ bar seats are located on the premise? 1, 10 seats
(A stand up bar is any bar or counter (whether with seating or not) over which a patron can order, pay for and receive an alcoholic beverage)

Describe all bars (length, shape and location): Rectangular, 10' in length

Does premise have a full kitchen Yes No?

Does it have a food preparation area? Yes No (If any, show on diagram)

Is food available for sale? Yes No If yes, describe type of food and submit a menu

Cafe style, see attached menu

What are the hours kitchen will be open? all open hours

Will a manager or principal always be on site? Yes No If yes, which? Both

How many employees will there be? 10

Do you have or plan to install French doors accordion doors or windows?

Will there be TVs/monitors? Yes No (If Yes, how many?) _____

Will premise have music? Yes No

If Yes, what type of music? Live musician DJ Juke box Tapes/CDs/iPod
If other type, please describe _____

What will be the music volume? Background (quiet) Entertainment level
Please describe your sound system: IPOD

Will you host any promoted events, scheduled performances or any event at which a cover fee is charged? If Yes, what type of events or performances are proposed and how often? NO

How do you plan to manage vehicular traffic and crowds on the sidewalk caused by your establishment? Please attach plans. (Please do not answer "we do not anticipate congestion.")

Will there be security personnel? Yes No (If Yes, how many and when) _____

How do you plan to manage noise inside and outside your business so neighbors will not be affected? Please attach plans.

Do you have sound proofing installed? Yes No
If not, do you plan to install sound-proofing? Yes No

APPLICANT HISTORY:

Has this corporation or any principal been licensed previously? Yes No

If yes, please indicate name of establishment: applicant

Address: 110 Forsyth St Community Board # 3

Dates of operation: 3/11/16 To Present

If you answered "Yes" to the above question, please provide a letter from the community board indicating history of complaints or other comments.

Has any principal had work experience similar to the proposed business? Yes No If Yes, please attach explanation of experience or resume. applicant

Does any principal have other businesses in this area? Yes No If Yes, please give trade name and describe type of business _____

Has any principal had SLA reports or action within the past 3 years? Yes No If Yes, attach list of violations and dates of violations and outcomes, if any.

Attach a separate diagram that indicates the location (**name and address**) and total number of establishments selling/serving beer, wine (B/W) or liquor (OP) for 2 blocks in each direction. Please indicate whether establishments have On-Premise (OP) licenses. Please label streets and avenues and identify your location. Use letters to indicate Bar, Restaurant, etc. The diagram must be submitted with the questionnaire to the Community Board before the meeting.

LOCATION:

How many licensed establishments are within 1 block? 3

How many On-Premise (OP) liquor licenses are within 500 feet? 12

Is premise within 200 feet of any school or place of worship? Yes No

COMMUNITY OUTREACH:

Please see the Community Board website to find block associations or tenant associations in the immediate vicinity of your location for community outreach. Applicants are encouraged to reach out to community groups. Also use provided petitions, which clearly state the name, address, license for which you are applying, and the hours and method of operation of your establishment at the top of each page. (Attach additional sheets of paper as necessary).

We are including the following questions to be able to prepare stipulations and have the meeting be faster and more efficient. Please answer per your business plan; do not plan to negotiate at the meeting.

1. I agree to close any doors and windows at 10:00 P.M. every night?
2. I will not have DJs, live music, promoted events, any event at which a cover fee is charged, scheduled performances, more than ____ DJs/ promoted events per ____, more than ____ private parties per ____
3. I will play ambient recorded background music only.
4. I will not apply for an alteration to the method of operation agreed to by this stipulation without first coming before CB 3.
5. I will not seek a change in class to a full on-premise liquor license. Or my business plan is to seek an upgrade at a later date.
6. I will not participate in pub crawls or have party buses come to my establishment.
7. I will not have a happy hour. Or Happy hour will end by 7 PM.
8. I will not have wait lines outside. There will be a staff person outside to monitor sidewalk crowds and ensure no loitering.
9. Residents may contact the manager/owner at the following phone number. Any complaints will be addressed immediately and I will revisit the above-stated method of operation if necessary in order to minimize my establishment's impact on my neighbors.

Omar Pringle (202) 210-8019

Proximity Report for Location:

110 Forsyth St, New York, NY, 10002

June 1, 2017

* This report is for informational purposes only in aid of identifying establishments potentially subject to 500 and 200 foot rules. Distances are approximated using industry standard GIS techniques and do not reflect actual distances between points of entry. The NYS Liquor Authority makes no representation as to the accuracy of the information and disclaims any liability for errors.

Closest Liquor Stores

Name	Address	Approx. Distance
E L PARTNERS LLC	101 ALLEN ST	445 ft
OCEAN WINE & SPIRIT INC	273 GRAND ST	470 ft
R & S 49 LIQUOR CORP	92 ELIZABETH ST	950 ft
WINE O INC	171 ELIZABETH ST	975 ft
SA VINO ITALIANO INC.	200 GRAND ST	1180 ft
DELANCEY WINE INC	35 ESSEX ST	1305 ft
GROTTA AZZURRA IMPORTS INC	177 MULBERRY ST STORE 1A	1340 ft

Churches within 500 Feet

Name	Approx. Distance
Delancey Seventh Day Adventist Church	200 ft

Schools within 500 Feet

Name	Address	Approx. Distance
------	---------	------------------

On-Premise Licenses within 750 Feet

Name	Address	Approx. Distance
LA GENTE LLC	303 305 BROOME ST	70 ft
302 BROOME ART SPACE LLC	302 BROOME ST	95 ft
BIRDS AND BUBBLES NYC LLC	100B FORSYTH ST	270 ft
SAIGON SHACK CORP	139 CHRYSTIE ST	270 ft
TLS CHRYSTIE LLC	131 CHRYSTIE ST BASEMENT STORE	275 ft
DOKA INC	51 53 DELANCEY ST	280 ft
FAYS RESTAURANT & BAR INC	141 CHRYSTIE STREET	300 ft
ATTABOY COCKTAILS LLC	134 ELDRIDGE ST	305 ft
ELDRIDGE HOSPITALITY LLC	107 ELDRIDGE ST	345 ft
HERMES B NY LLC	95 ALLEN ST	390 ft
L E S VIXENS INC	105 107 ELDRIDGE ST	405 ft
SAMMY SCHMUL INC	155 157 CHRYSTIE STREET	490 ft
CONGEE VILLAGE INC	100 ALLEN ST	535 ft
DIXON PLACE LLC	161 CHRYSTIE ST	540 ft
BIG CANDY LLC	86 ALLEN ST	565 ft
BOWERY RESTAURANT GROUP LLC	146 BOWERY	570 ft
HILL AND DALE RESTAURANT GROUP LLC	115 ALLEN ST	585 ft

Name	Address	Approx. Distance
D C B DELANCEY CORP	1 3 DELANCEY ST	610 ft
XLR8 LLC	266 BROOME ST	620 ft
343 BROOME STREET RESTAURANT INC	343 BROOME ST	650 ft
MM 130 BOWERY REST. CORP.	130 BOWERY	655 ft
BARNORTH GROUP LLC	77 DELANCEY ST	665 ft
SAIGONNYC LTD	85 ORCHARD ST UNIT B	675 ft
ORCHARD 85 CORP	85 ORCHARD STREET	675 ft
TWO BIKES LLC	85 ORCHARD STREET	695 ft
GRAZ RESTAURANT LLC	79 ORCHARD STREET	705 ft
JOHANNGPRO LLC	96 ORCHARD ST	705 ft
COMPAS GROUP NEW YORK LLC	86 ORCHARD STREET	715 ft
NIKKI MAX ENTERPRISES LLC	75 ORCHARD STREET	725 ft
NORMAN'S CAY GROUP LLC	74 ORCHARD ST	750 ft
DELANCEY SQUARE HOSP LLC & 119 ORCHARD PROP INC.	119 ORCHARD ST AKA120 ALLEN ST	750 ft

Pending Licenses within 750 Feet

Name	Address	Approx. Distance
BESTE BAT LLC	135 137 ELDRIDGE ST	230 ft
LOWER EAST SIDE TENEMENT MUSEUM	103 ORCHARD ST	665 ft

Unmapped licenses within zipcode of report location

Name	Address

Downtown Cafe LLC

110 Folsyth St
Nj, Nj 10002

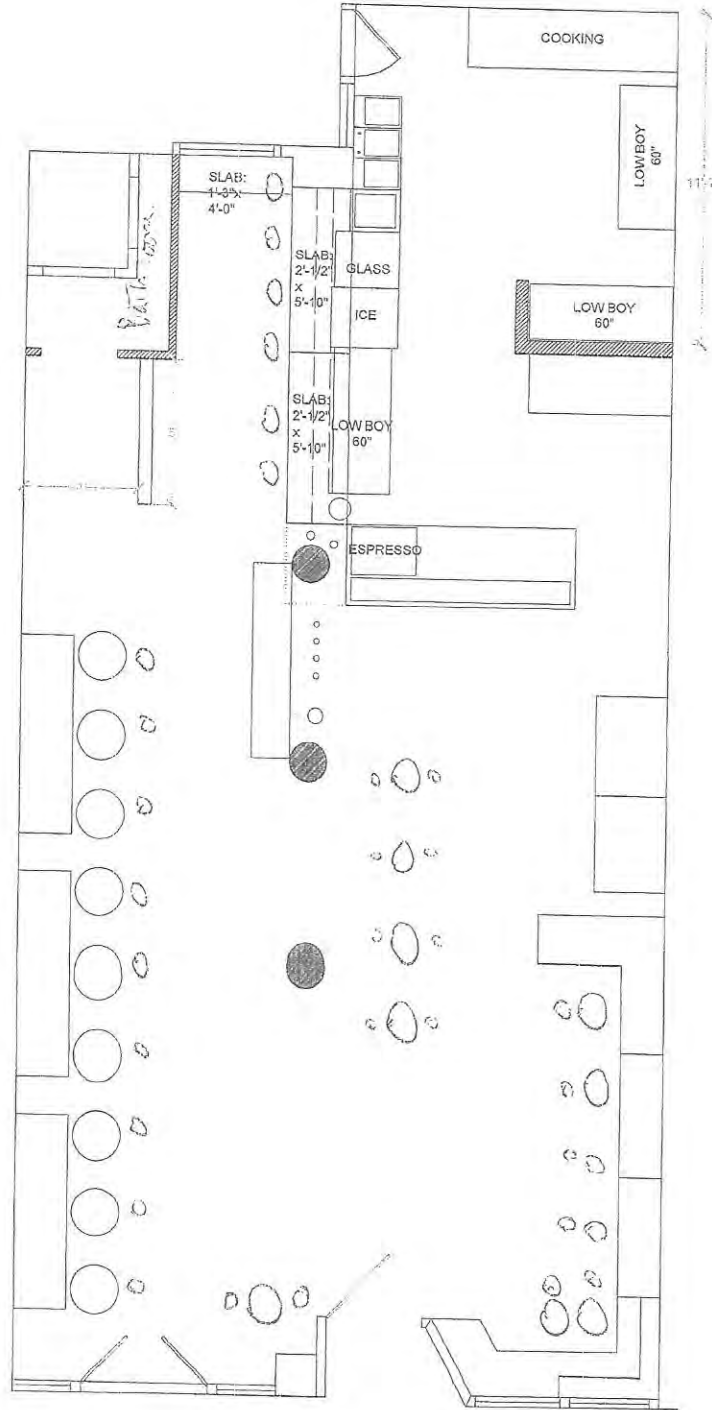

cafe andre

1/4" = 1'-0"

Downtown Cafe LLC
110 Forsyth St
N.Y., N.J. 10002

BREAKFAST
served all day

ASSORTED PASTRIES

PARFAIT granola, mixed berries, local honey 7

CHIA PUDDING almond milk, coconut, cocoa nibs, berries, corn flakes 9

LUNCH
11:30am-5pm

FRESH FRUIT 5

ACAI coconut, banana, berries, granola, black sesame, chia 9

TARTINE butter, jam 4

TARTINE prosciutto, butter, gruyere 8

SOUP seasonal 7

SAVORY BREAD PUDDING seasonal 8

THE HENRIETTA roasted shiitake, date purée, Jasper Hill brie, prosciutto
confetti 13

WATERCRESS pumpkin seed, gruyere, citrus 9

PURPLE CABBAGE beet, apple, radish 9

KALE quinoa, squash, pomegranate, pecan, maple vinaigrette 9

CHICKEN SANDWICH free range chicken breast, andouille pate, aioli 14

CHICKPEA CLUB avocado, cucumber, sprouts, lemony chermoula 14

Bacon 4

Avocado 3

Free Range chicken breast 6

COFFEE

by Counter Culture

Espresso 3 Double espresso 4 Americano 3 Drip Coffee 3 Iced coffee 4
Cappuccino 4 Latte 4

MATCHA TEA LATTE 5

CHAI TEA LATTE 4.50

HOUSE OF WARIS TEAS

Sencha Green Tea, Organic English Breakfast, Grand Earl Grey, Mystic Mint,
Chamomile Lavender

4

TOKU TEA

Hoji-cha Japanese hand-roasted green tea 3.5
Gift Box 15

HOUSE JUICE apple, ginger, lemon 6

SMOOTHIE chia, dates, banana, almond milk 9

BRUNCH

served all day saturday's and sundays only

Cast iron eggs

Baked sunny side free range eggs, toast, greens

Or

Baked Scrambled, goat cheese, herbs, toast, greens

\$8

Norwegian tartine

Smoked salmon, Cucumber, capers, creme fraiche, pickled onion, chives

\$13