



THE CITY OF NEW YORK MANHATTAN COMMUNITY BOARD 3

59 East 4th Street - New York, NY 10003
Phone: (212) 533-5300 - Fax: (212) 533-3659
www.cb3manhattan.org - info@cb3manhattan.org

Gigi Li, Board Chair

Susan Stetzer, District Manager

Community Board 3 Liquor License Application Questionnaire

Please bring the following items to the meeting:

NOTE: ALL ITEMS MUST BE SUBMITTED FOR APPLICATION TO BE CONSIDERED.

- Photographs of the inside and outside of the premise.
- Schematics, floor plans or architectural drawings of the inside of the premise.
- A proposed food and or drink menu.
- Petition in support of proposed business or change in business with signatures from residential tenants at location and in buildings adjacent to, across the street from and behind proposed location. Petition must give proposed hours and method of operation. For example: restaurant, sports bar, combination restaurant/bar. (petition provided)
- Notice of proposed business to block or tenant association if one exists. You can find community groups and contact information on the CB 3 website:
http://www.nyc.gov/html/mancb3/html/communitygroups/community_group_listings.shtml
- Photographs of proof of conspicuous posting of meeting with newspaper showing date.
- If applicant has been or is licensed anywhere in City, letter from applicable community board indicating history of complaints and other comments.

Check which you are applying for:

- new liquor license alteration of an existing liquor license corporate change

Check if either of these apply:

- sale of assets upgrade (change of class) of an existing liquor license

Today's Date: 3-30-2016

If applying for sale of assets, you must bring letter from current owner confirming that you are buying business or have the seller come with you to the meeting.

Is location currently licensed? Yes No Type of license: Eating Place Beer

If alteration, describe nature of alteration: _____

Previous or current use of the location: Pizzeria

Corporation and trade name of current license: Baker's Pizza LLC

APPLICANT:

Premise address: 201 Avenue A, New York, NY 10009

Cross streets: 12th and 13th Streets

Name of applicant and all principals: Jordan Baker

Trade name (DBA): Baker's Pizza

PREMISE:

Type of building and number of floors: Mixed Use, 4 Floors

Will any outside area or sidewalk cafe be used for the sale or consumption of alcoholic beverages?
(includes roof & yard) Yes No If Yes, describe and show on diagram: _____

Does premise have a valid Certificate of Occupancy and all appropriate permits, including for any
back or side yard use? Yes No What is maximum NUMBER of people permitted? 74

Do you plan to apply for Public Assembly permit? Yes No

What is the zoning designation (check zoning using map: <http://gis.nyc.gov/doitt/nycitymap/> -
please give specific zoning designation, such as R8 or C2):
R7A with C2-5 commercial overlay

PROPOSED METHOD OF OPERATION:

Will any other business besides food or alcohol service be conducted at premise? Yes No

If yes, please describe what type: _____

What are the proposed days/hours of operation? (Specify days and hours each day and hours of
outdoor space) Sunday - Thursday 12pm to 12am. Friday - Saturday 12pm - 2am.

***Applicant will agree to stop selling beer at 12am on Friday and Saturday.

Number of tables? 7 Total number of seats? 14

How many stand-up bars/ bar seats are located on the premise? 0 (all purchases are made at food counter/cash register)

(A **stand up bar** is any bar or counter (whether with seating or not) over which a patron can order,
pay for and receive an alcoholic beverage)

Describe all bars (length, shape and location): _____

Does premise have a full kitchen Yes No?

Does it have a food preparation area? Yes No (If any, show on diagram)

Is food available for sale? Yes No If yes, describe type of food and submit a menu

What are the hours kitchen will be open? All hours of open operation

Will a manager or principal always be on site? Yes No If yes, which? Principal

How many employees will there be? 4

Do you have or plan to install French doors accordion doors or windows?

Will there be TVs/monitors? Yes No (If Yes, how many?) _____

Will premise have music? Yes No

If Yes, what type of music? Live musician DJ Juke box Tapes/CDs/iPod

If other type, please describe _____

What will be the music volume? Background (quiet) Entertainment level

Please describe your sound system: Simple speakers with iPod

Will you host any promoted events, scheduled performances or any event at which a cover fee is charged? If Yes, what type of events or performances are proposed and how often? No

How do you plan to manage vehicular traffic and crowds on the sidewalk caused by your establishment? Please attach plans. (Please do not answer "we do not anticipate congestion.")

Will there be security personnel? Yes No (If Yes, how many and when) _____

How do you plan to manage noise inside and outside your business so neighbors will not be affected? Please attach plans.

Do you have sound proofing installed? Yes No
If not, do you plan to install sound-proofing? Yes No

APPLICANT HISTORY:

Has this corporation or any principal been licensed previously? Yes No
If yes, please indicate name of establishment: _____

Address: _____ Community Board # _____

Dates of operation: _____

If you answered "Yes" to the above question, please provide a letter from the community board indicating history of complaints or other comments.

Has any principal had work experience similar to the proposed business? Yes No If Yes, please attach explanation of experience or resume.

Does any principal have other businesses in this area? Yes No If Yes, please give trade name and describe type of business _____

Has any principal had SLA reports or action within the past 3 years? Yes No If Yes, attach list of violations and dates of violations and outcomes, if any.

Attach a separate diagram that indicates the location (**name and address**) and total number of establishments selling/serving beer, wine (B/W) or liquor (OP) for 2 blocks in each direction. Please indicate whether establishments have On-Premise (OP) licenses. Please label streets and avenues and identify your location. Use letters to indicate **Bar, Restaurant**, etc. The diagram must be submitted with the questionnaire to the Community Board before the meeting.

LOCATION:

How many licensed establishments are within 1 block? 7

How many On-Premise (OP) liquor licenses are within 500 feet? 13

Is premise within 200 feet of any school or place of worship? Yes No

COMMUNITY OUTREACH:

Please see the Community Board website to find block associations or tenant associations in the immediate vicinity of your location for community outreach. Applicants are encouraged to reach out to community groups. Also use provided petitions, which clearly state the name, address, license for which you are applying, and the hours and method of operation of your establishment at the top of each page. (Attach additional sheets of paper as necessary).

We are including the following questions to be able to prepare stipulations and have the meeting be faster and more efficient. Please answer per your business plan; do not plan to negotiate at the meeting.

1. I will close any front or rear facade doors and windows at 10:00 P.M. every night or during any amplified performances, including but not limited to DJs, live music and live nonmusical performances.
2. I will not have DJs, live music, promoted events, any event at which a cover fee is charged, scheduled performances, more than ____ DJs/ promoted events per ____, more than ____ private parties per _____.
3. I will play ambient recorded background music only.
4. I will not apply for an alteration to the method of operation agreed to by this stipulation without first coming before CB 3.
5. I will not seek a change in class to a full on-premise liquor license without first obtaining approval from CB 3.
6. I will not participate in pub crawls or have party buses come to my establishment.
7. I will not have a happy hour. I will have happy hour and it will end by _____.
8. I will not have wait lines outside. There will be a staff person outside to monitor sidewalk crowds and ensure no loitering.
9. Residents may contact the manager/owner at the following phone number. Any complaints will be addressed immediately and I will revisit the above-stated method of operation if necessary in order to minimize my establishment's impact on my neighbors.

Proximity Report for Location:

March 30, 2016

201 Avenue A, New York, NY, 10009

* This report is for informational purposes only in aid of identifying establishments potentially subject to 500 and 200 foot rules. Distances are approximated using industry standard GIS techniques and do not reflect actual distances between points of entry. The NYS Liquor Authority makes no representation as to the accuracy of the information and disclaims any liability for errors.

Closest Liquor Stores

Name	Address	Approx. Distance
AVENUE A WINES INC	196 AVENUE A	85 ft
CARMAD INC	224 226 1ST AVE	700 ft
BEE LIQUORS LLC	225 AVENUE B	825 ft
WINESHOP LLC	438 A E 9TH ST	895 ft
236 WINES & LIQUORS INC	279 1ST AVENUE	1190 ft
FUNG SING INC	138 1ST AVENUE	1255 ft
BRIX NYC LLC	649 E 9TH STREET, EAST STORE	1440 ft

Churches within 500 Feet

Name	Approx. Distance
------	------------------

Schools within 500 Feet

Name	Address	Approx. Distance
LEARNING PROJECT	420 E 12TH ST	455 ft
EAST SIDE COMM HS	420 E 12TH ST	455 ft

On-Premise Licenses within 750 Feet

Name	Address	Approx. Distance
MONOLITH INC	194 AVE A	110 ft
DBW RESTAURANT ASSOCIATES LLC	206 AVE A	125 ft
CALAB LLC	503 505 E 12TH STREET	145 ft
FRIDA & DIEGO CORP	211 AVENUE A	155 ft
LO ENG INC	212 AVENUE A	175 ft
FAT PANDA INC	219 AVENUE A NORTH	180 ft
HORSEBOX INC	218 AVENUE A	190 ft
TAVERN 211 CORP	211 AVENUE A	200 ft
KAITO CORP	432 E 13TH ST	245 ft
THE NORTHERN SPY FOOD CO LLC	511 E 12TH ST	255 ft
HUGHES MURRAY WALSH LLC	447 E 13TH ST	365 ft
510 EAST 11TH STREET CORP	510 E 11TH STREET	435 ft
GHD INC	432 E 13TH STREET, WEST STORE	435 ft
PATTY MC CARTHYS INC	169 AVENUE A	510 ft
SPT CORP	538 E 14TH STREET	530 ft
FLINDERS LANE LLC	162 AVE A	560 ft

Name	Address	Approx. Distance
HEARTH RESTAURANT INVESTORS LLC	403 E 12TH ST	645 ft
BEEP BEEP NYC LLC	201 1ST AVE	660 ft
CHITO INC	211 213 1ST AVENUE	680 ft
MACCG LLC	228 1ST AVE	730 ft

Pending Licenses within 750 Feet

Name	Address	Approx. Distance
AVE A HOSPITALITY LLC	200 AVENUE A	70 ft
CONVIVE PARTNERS LLC	196 AVENUE A	105 ft
AKINA SUSHI INC	424 A EAST 14TH ST	625 ft

Unmapped licenses within zipcode of report location

Name	Address
------	---------



18" PIZZA

\$17

TOPPINGS

\$2.5 EACH

Brussels Sprouts	Jalapeño	Bacon
Broccoli Rabe	Kale	BBQ Chicken
Caramelized Onion	Pineapple	Meatball
Fresh Garlic	Red Onion	Pepperoni
Green Pepper	Roasted Red Pepper	Sausage
Herbed Ricotta	Sautéed Mushroom	Speck

18" SPECIAL

\$20

MARGHERITA

Fresh Mozzarella, Tomato, Basil, EVOO

BAKER'S

Herbed Ricotta, Homemade Pork Sausage, Caramelized Onion

SUPREME

Pepperoni, Mushroom, Green Peppers, Red Onion

B&B

Brussels Sprouts, Bacon, White Truffle Oil

SPICY HAWAIIAN

Speck, Pineapple, Jalapeño

SPECK-TACULAR

Speck, Broccoli Rabe, Parmesan

MARKET VEGETABLE

EXTRA

SALADS \$6 / SMALL \$10 / LARGE

House Salad Romaine, Iceberg, Carrot, Sliced Almonds, Champagne Vinaigrette

Kale Caesar Homemade Croutons

SANDWICHES ON HOMEMADE FOCACCIA \$8

Meatball Parm Fresh Mozzarella, Mint, Lemon Zest

Speck & Broccoli Rabe Herbed Ricotta Spread

POLENTA FRIES \$5

Marinara or Labne Sauce

CORN NUGGETS \$5

Garlic Aioli

GARLIC KNOTS \$1.5 FOR 4

ZEPPOLIS \$3 FOR 4



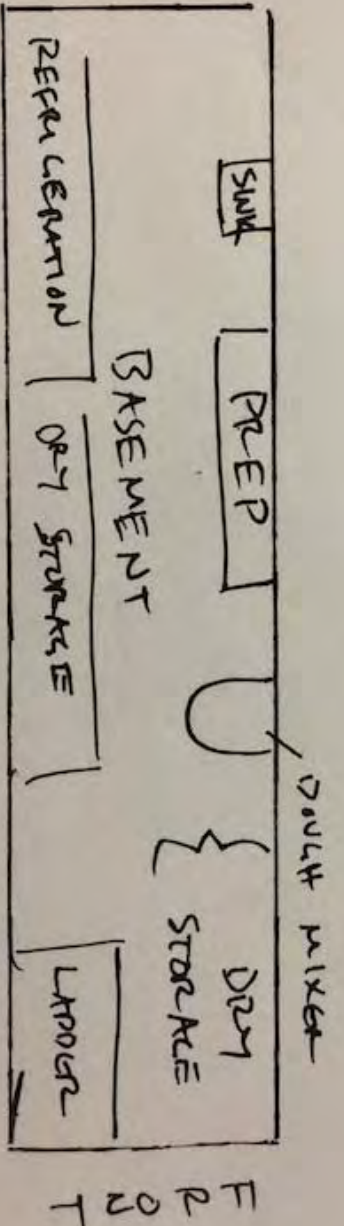
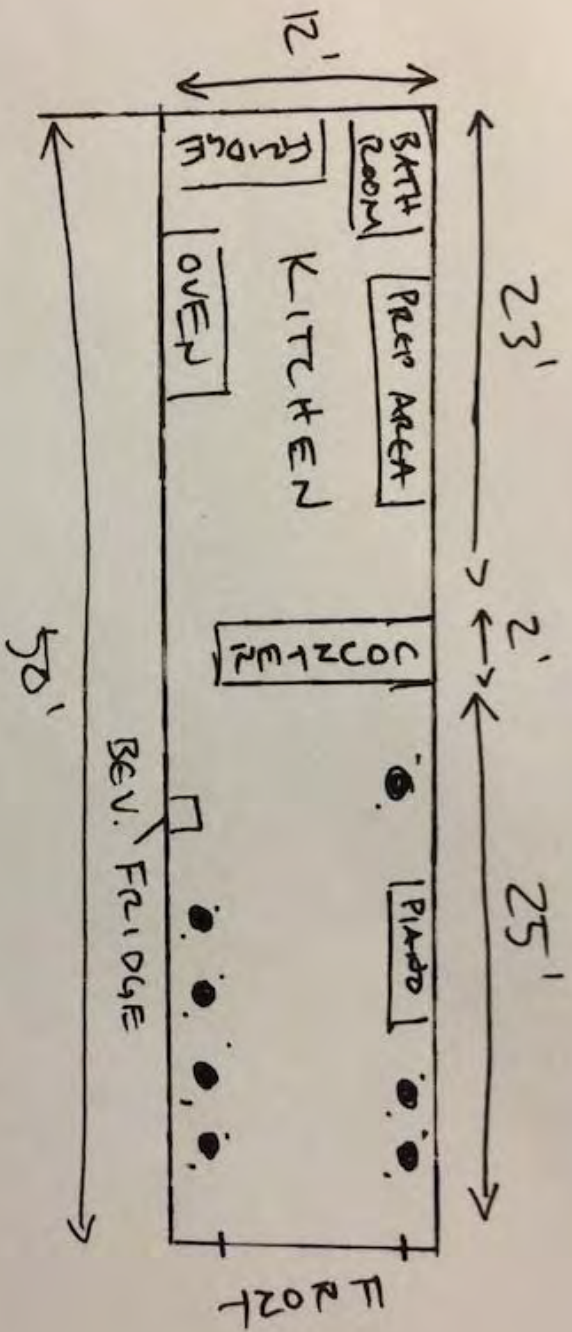

● = 2' TABLE
 w | 2 BMSSTOOLS