



# THE CITY OF NEW YORK MANHATTAN COMMUNITY BOARD 3

59 East 4th Street - New York, NY 10003  
Phone: (212) 533-5300 - Fax: (212) 533-3659  
www.cb3manhattan.org - info@cb3manhattan.org

Gigi Li, Board Chair

Susan Stetzer, District Manager

## Community Board 3 Liquor License Application Questionnaire

Please bring the following items to the meeting:

**NOTE: ALL ITEMS MUST BE SUBMITTED FOR APPLICATION TO BE CONSIDERED.**

- Photographs of the inside and outside of the premise.
- Schematics, floor plans or architectural drawings of the inside of the premise.
- A proposed food and or drink menu.
- Petition in support of proposed business or change in business with signatures from residential tenants at location and in buildings adjacent to, across the street from and behind proposed location. Petition must give proposed hours and method of operation. For example: restaurant, sports bar, combination restaurant/bar. (petition provided)
- Notice of proposed business to block or tenant association if one exists. E-mail the CB3 office at [info@cb3manhattan.org](mailto:info@cb3manhattan.org) to find block associations. This must be done promptly so that there is sufficient time to meet with residents if necessary.
- Photographs of proof of conspicuous posting of meeting with newspaper showing date.
- If applicant has been or is licensed anywhere in City, letter from applicable community board indicating history of complaints and other comments.

Check which you are applying for:

- new liquor license       alteration of an existing liquor license       corporate change

Check if either of these apply:

- sale of assets       upgrade (change of class) of an existing liquor license

Today's Date: 6/28/13

If applying for sale of assets, you must bring letter from current owner confirming that you are buying business or have the seller come with you to the meeting.

Type of license: On-Premises Liquor Is location currently licensed?  Yes  No

If alteration, describe nature of alteration: \_\_\_\_\_

Previous or current use of the location: Cafe

Corporation and trade name of current license: Shervin's World Inc

### APPLICANT:

Premise address: 131 E 7<sup>th</sup> Street

Cross streets: Avenue A & 1<sup>st</sup> Avenue

Name of applicant and all principals: Shervin Nassi - President

Trade name (DBA): \_\_\_\_\_

**PREMISE:**

Type of building and number of floors: Attached 5 Floor Mixed use building

Will any outside area or sidewalk cafe be used for the sale or consumption of alcoholic beverages?  
(includes roof & yard)  Yes  No If Yes, describe and show on diagram: \_\_\_\_\_

Does premise have a valid Certificate of Occupancy and all appropriate permits, including certificate of occupancy for back or side yard intended for commercial use?  Yes  No

Indoor Certificate of Occupancy 74 Outdoor Certificate of Occupancy 0  
(fill in maximum NUMBER of people permitted)

Do you plan to apply for Public Assembly permit?  Yes  No

Zoning designation (check zoning using map: <http://gis.nyc.gov/doitt/nycitymap/> - please give specific zoning designation, such as R8 or C2):

R7A & C1-5 commercial overlay

Is this premise wheel chair accessible?  Yes  No

**PROPOSED METHOD OF OPERATION:**

What type of establishment will this be (i.e.: restaurant, bar, performance space, club, hotel)?

Cafe

Will any other business besides food or alcohol service be conducted at premise?  Yes  No

If yes, please describe what type: \_\_\_\_\_

What are the proposed days/hours of operation? (Specify days and hours each day and hours of outdoor space) Monday - Sunday, 9am - 1am

Number of tables? 3 Number of seats at tables? 22 seats total

How many stand-up bars/ bar seats are located on the premise? 1

(A **stand up bar** is any bar or counter (whether with seating or not) over which a patron can order, pay for and receive an alcoholic beverage)

Describe all bars (length, shape and location): "L" shaped bar

Any food counters?  Yes  No If Yes, describe: \_\_\_\_\_



Does premise have a full kitchen?  Yes  No?

Does it have a food preparation area?  Yes  No (If any, show on diagram)

Is food available for sale?  Yes  No If yes, describe type of food and submit a menu

What are the hours kitchen will be open? 9am - 1am

Will a manager or principal always be on site?  Yes  No If yes, which? Principal

How many employees will there be? \_\_\_\_\_

Do you have or plan to install  French doors  accordion doors or  windows?

Will you agree to close any doors and windows at 10:00 P.M. every night?  Yes  No

Will there be TVs/monitors?  Yes  No (If Yes, how many?) \_\_\_\_\_

Will premise have music?  Yes  No

If Yes, what type of music?  Live musician  DJ  Juke box  Tapes/CDs/iPod

If other type, please describe \_\_\_\_\_

What will be the music volume?  Background (quiet)  Entertainment level

Please describe your sound system: \_\_\_\_\_

Will you host promoted events, scheduled performances or any event at which a cover fee is charged? If Yes, what type of events or performances are proposed? No

How do you plan to manage vehicular traffic and crowds on the sidewalk caused by your establishment? Please attach plans.

Will there be security personnel?  Yes  No (If Yes, how many and when) \_\_\_\_\_

How do you plan to manage noise inside and outside your business so neighbors will not be affected? Please attach plans.

Do you  have or  plan to install sound-proofing?

**APPLICANT HISTORY:**

Has this corporation or any principal been licensed previously?  Yes  No

If yes, please indicate name of establishment: Shervin's World Inc

Address: 131 E 7<sup>th</sup> Street Community Board # 3

Dates of operation: Monday - Sunday 9am - 1am

**If you answered "Yes" to the above question, please provide a letter from the community board indicating history of complaints or other comments.**

Has any principal had work experience similar to the proposed business?  Yes  No If Yes, please attach explanation of experience or resume.

Does any principal have other businesses in this area?  Yes  No If Yes, please give trade name and describe type of business \_\_\_\_\_

Has any principal had SLA reports or action within the past 3 years?  Yes  No If Yes, attach list of violations and dates of violations and outcomes, if any.

Attach a separate diagram that indicates the location (**name and address**) and total number of establishments selling/serving beer, wine (B/W) or liquor (OP) for 2 blocks in each direction. Please indicate whether establishments have On-Premise (OP) licenses. Please label streets and avenues and identify your location. Use letters to indicate **Bar, Restaurant**, etc. The diagram must be submitted with the questionnaire to the Community Board before the meeting.

**LOCATION:**

How many licensed establishments are within 1 block? 16

How many licensed establishments are within 500 feet? 25

Is premise within a 500 foot radius of 3 or more establishments with OP licenses?  Yes  No

How many On-Premise (OP) liquor licenses are within 500 feet? 25

Is premise within 200 feet of any school or place of worship?  Yes  No

If there is a school or place of worship within 200 feet of your premise on the same block, submit a block plot diagram or area map showing its location in proximity to your premise and indicate the distance and name and address of the school or house of worship.

**COMMUNITY OUTREACH:**

If there are block associations or tenant associations in the immediate vicinity of your location, you must contact them. Contact the CB 3 office at [info@cb3manhattan.org](mailto:info@cb3manhattan.org) to find block and tenant associations. **Please attach proof (copies of letters or email and poster) that you have advised these groups of your application with sufficient time for them to respond to your notice.**

**Please use provided petitions, which clearly state the name, address, license for which you are applying, and the hours and method of operation of your establishment at the top of each page.** (Attach additional sheets of paper as necessary).



## Proximity Report for Location:

June 20, 2013

131 E 7TH ST, New York, 10009

\* This report is for informational purposes only in aid of identifying establishments potentially subject to 500 and 200 foot rules. Distances are approximated using industry standard GIS techniques and do not reflect actual distances between points of entry. The NYS Liquor Authority makes no representation as to the accuracy of the information and disclaims any liability for errors.

### Closest Liquor Stores

Name	Address	Approx. Distance
WINESHOP LLC	438 A E 9TH ST	515 ft
FUNG SING INC	138 1ST AVENUE	730 ft
NIZGA CORP	58 AVENUE A	735 ft
TINTO FINO INC	85 1ST AVE	835 ft
BRIX NYC LLC	"649 E 9TH STREET, EAST STORE"	1240 ft
SAKAYA INC	324 E 9TH STREET (WEST STORE)	1330 ft
AVENUE A WINES INC	196 AVENUE A	1335 ft

### Churches within 500 Feet

Name	Approx. Distance
------	------------------

### Schools within 500 Feet

Name	Address	Approx. Distance
------	---------	------------------

### On-Premise Licenses within 750 Feet

Name	Address	Approx. Distance
YUCA BAR & RESTAURANT INC	111 AVENUE A	10 ft
SEVEN A CAFE INC	130 E 7TH STREET	20 ft
LE MIU CORP	107 AVE A	40 ft
ODESSA RESTAURANT INC	117 AVENUE A	90 ft
A H 103 CORP	103 AVENUE A	105 ft
119 AVENUE A RESTAURANT CORP	119 AVENUE A	115 ft
TOZZER LTD	112 AVENUE A	125 ft
MOONWALKERS RESTAURANT CORP	101 AVENUE A	135 ft
CORSICA ENTERTAINMENT INC	505 E 6TH STREET	230 ft
CIEN FUEGOS LLC	95 AVENUE A	235 ft
EAE CORP	94 96 AVENUE A	235 ft
RED MALBEC LLC	509 E 6TH ST	240 ft
THREE BEANS INC	93 AVENUE A	250 ft
FERBER ENTERPRISES INC	511 EAST 6TH STREET	250 ft
ALOUETTE CORPORATION	131 AVENUE A	265 ft
BA VICTORY CORP	513 E 6TH ST	275 ft
ELLSFRED INC	520 E 6TH ST	305 ft
ARROW 85 ASSOCIATES LLC	85 AVENUE A	310 ft

Name	Address	Approx. Distance
BOGGY DEPOT INC	85 AVENUE A	310 ft
CAFETASIA INC	85 AVENUE A	315 ft
LUDWIKA MICKEVICIUS	135 AVE A	340 ft
AVE A KARAOKE CORP	81 AVENUE A	345 ft
CHERRY TAVERN INC	441 E 6TH STREET	450 ft
WISHBONE PRODUCTIONS INC	141 AVENUE A	460 ft
CRAFTY NUANCE GROUP LLC	125 129 ST MARKS PL	480 ft
CORMAR INCORPORATED	507 E 5TH ST	485 ft
LITTLE HANDS PLAYCAFE INC	433 EAST 6TH ST	495 ft
511 E 5TH STREET LLC	511 E 5TH ST	510 ft
BUA NEW YORK LLC	122 SAINT MARKS PLACE	510 ft
CULLEN RESTAURANT INC	118 ST MARKS PLACE	520 ft
NEW STATFORD RESTAURANT INC	121 ST MARKS PLACE	530 ft
THUNDERBOLT CORP	531 E 5TH STREET	540 ft
CRIF DOGS ENTERPRISES INC	113 ST MARKS PLACE	570 ft
DESMO 916 CORP	545 E 5TH ST AKA 76 AVE B	595 ft
LOCO 151 INC	151 AVENUE A	610 ft
RIVKA INC	101 ST MARKS PLACE	640 ft
GETURDUN EZ LLC	120 1/2 1ST AVENUE	665 ft
1465 CDM INCORPORATED	126 1ST AVENUE	675 ft
JUSTIFIED LLC	102 1ST AVENUE	690 ft
ST MARKS ENTERPRISES INC	132 1ST AVENUE	700 ft
W C O U RADIO INC	115 1ST AVENUE	700 ft
FWC CAFE INC	111 1ST AVE NORTH STORE	700 ft
JEL & JHP INC	119 1ST AVE	705 ft
LGR FIRST CORPORATION	134 1ST AVE	710 ft
SADA TWO LLC	105 1ST AVE	715 ft
FTCCM LLC	103 1ST AVE	720 ft
AUGUST VAZAC RESTAURANT INC	108 AVENUE B	735 ft
MARRY THE KETCHUP INC	95 1ST AVE	735 ft
ANGIE CORP	99 1ST AVENUE	740 ft
CHEAPSHOTS INC	140 1ST AVENUE	745 ft

### Pending Licenses within 750 Feet

Name	Address	Approx. Distance
INSIANG LLC	111 1ST AVE NORTH STORE	680 ft

### Unmapped licenses within zipcode of report location

Name	Address
------	---------



NYC Department of Buildings  
280 Broadway, New York, NY 10007

Robert Limandri, Acting Commissioner

Dileep Khedekar, P.E.  
Deputy Borough Commissioner  
Manhattan Borough Office, 3<sup>rd</sup> Fl.  
Phone: (212) 566-0019  
Fax: (212) 568-5575  
E-mail: dileepk@buildings.nyc.gov

June 5, 2008

New York State Liquor Authority  
Division of Alcoholic Beverages Control  
105 West 125<sup>th</sup> Street – 5<sup>th</sup> Floor  
New York, NY 10027

RE: LETTER OF NO OBJECTION  
131 EAST 7<sup>TH</sup> STREET  
Block #: 435; Lot #: 37  
Manhattan

To Whom It May Concern:

The Department has No Objection to an Eating and Drinking Establishment, Use Group 6, Non- Place of Assembly, for less than Seventy-Five (75) persons on the First Floor of the above referenced premises.

However, any new construction must be filed with this department.

This is based upon department records; Block # 435 Lot # 37, Copies of HPD "I" Cards & Sanborn Map.

Sincerely,

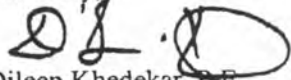
  
Dileep Khedekar, P.E.  
Deputy Borough Commissioner  
Manhattan

Dk/ks

Cc: Christopher M. Santulli, P.E., Borough Commissioner, Manhattan  
Ginio Topino, Plan Examiner  
LNO File  
Premises File



APPLICANT: SHERVIN'S WORLD INC  
131 EAST 7TH STREET  
NEW YORK, NY 10009

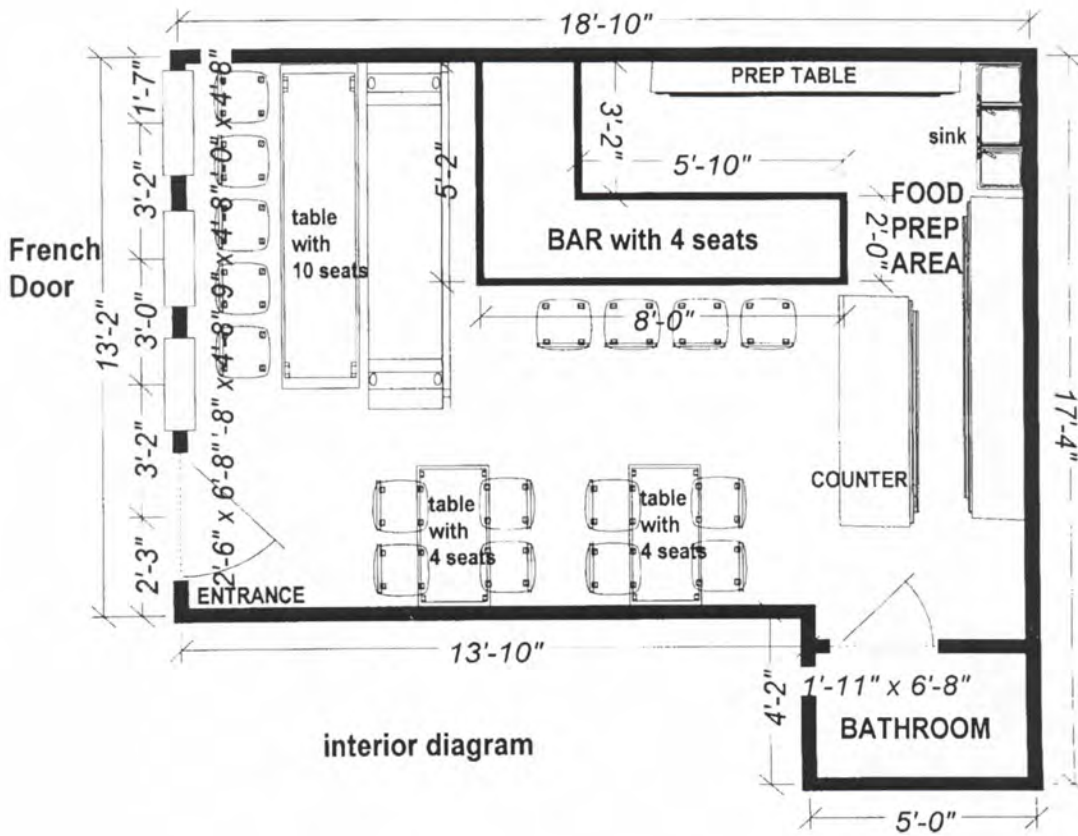



**APPLICANT: SHERVIN'S WORLD, INC**  
**131 E 7TH STREET, NEW YORK NY 10009**

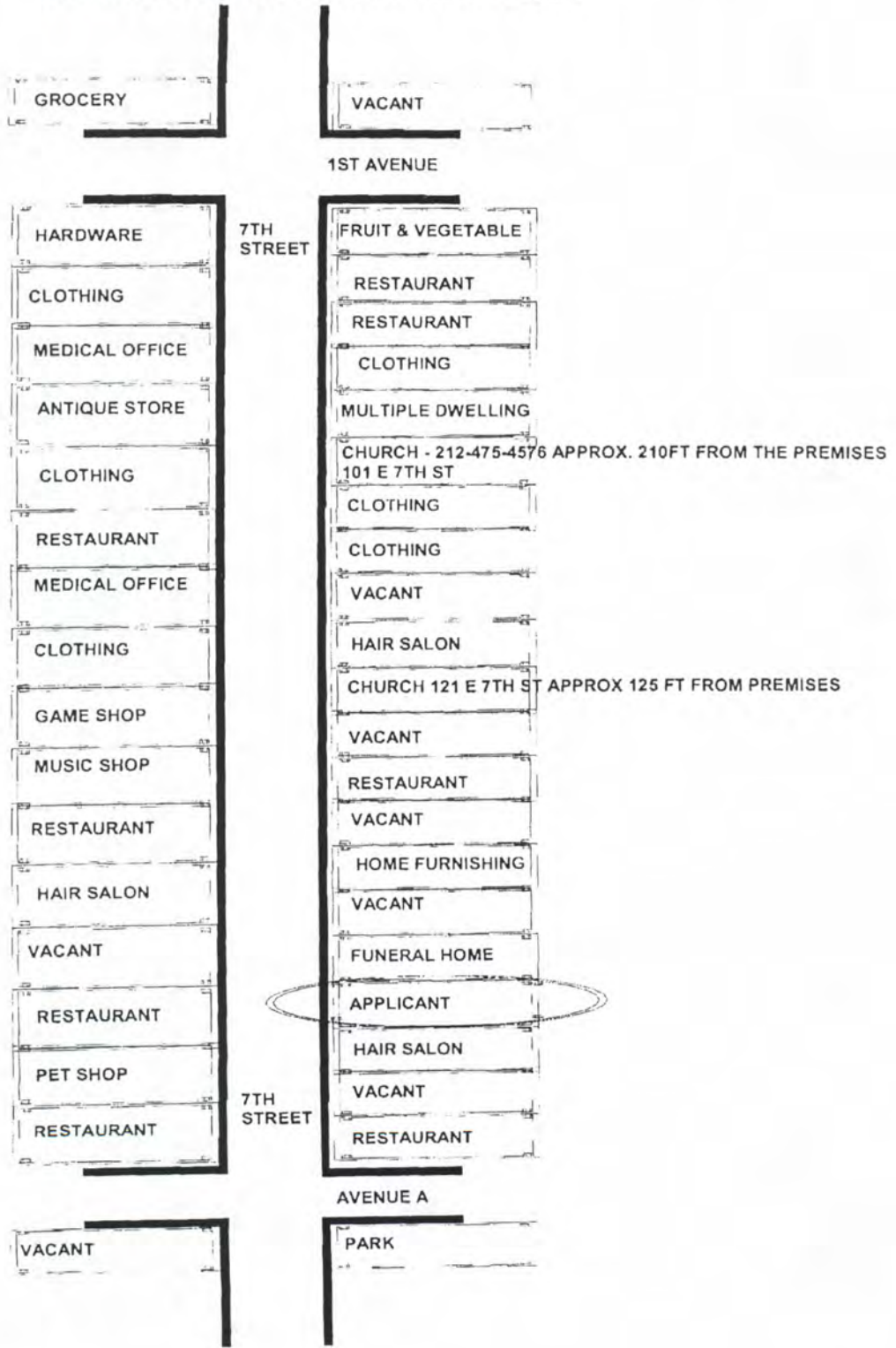









# ATTENTION RESIDENTS & NEIGHBORS

Shervin's World, Inc. (917) 591-1443

Company/DBA Name and Contact Number for Questions

Plans to open a

Cafe

Bar/Restaurant, Club/Grocery, etc. (Please check)  
Please indicate if there will be a Tobacco/Vaping/Vaporized Cigarette

at the following location

131 E. 2<sup>nd</sup> Street

Street Address (Not Box #)

This establishment is seeking a license to serve

Beer, Wine & Spirits

Beer & Wine or Spirits, Wine & Spirits

There will be an opportunity for public comment on

Monday, July 15, 2013 at 6:30pm

Rockwood Music Hall

185 Orchard Street (btwn Houston and Stanton Sts)

(917) 591-1443

Application Contact Number

AL COMMUNITY BOARD 3

SLA & DCA Licensing Committee Meeting

info@cb3manhattan.org - www.cb3manhattan.org

DAILY NEWS  
heart  
attack kills  
SHERVIN'S  
CAFE



**TEA**  
**GREEN\*** 2.50/3  
**PEPPERMINT\*** 2.50/3  
**BLACK MANGO\*** 2.50/3  
**CHAI TEA LATTE\*** 4/4.25  
**CHAI TEA** 3.25/3.50

**COFFEE**  
**DRIP\*** 2.50  
**ESPRESSO\*** 2.50  
**LATTE\*** 4/4.25  
**MACHIADO\*** 3/3.25  
**CAPPUCCINO\*** 4/4.25  
**AMERICANO\*** 2.75/3  
**CORTADO\*** 2.75/3

**CROISSANT** 3  
**CHOCOLATE CROISSANT** 3.25

**SANDWICHES**  
**MOZZARELLA TOMATO PESTO**  
**PRUSCIUTTO MOZZARELLA**  
**PESTO**  
**NUTELLA CREAM CHEESE**  
**JELLY CREAM CHEESE**  
 (All sandwiches served on croissants)

**JUICES** (WE MIX ALL JUICES)  
**MANGO**  
**GRAPE FRUIT**  
**FRUIT PUNCH**  
**PINEAPPLE**  
**COCONUT**

**FOOD**

**GUACAMOLE**-8  
**CHEESE PLATTER**-10  
**PROSCIUTTO WRAPPED DATES**-6  
**MEAT PLATTER**-10  
**SPINACH ARTICHOKE DIP**-7.5  
**HONEY CLOUD**-6.5 Ricetta Cheese Honey crushed black pepper on crisp lettuce

**DESSERT-**  
**CREPES\*\*** 4.50  
 Nutella  
 Peanut butter  
 add Banana or Strawberry .50c

