



THE CITY OF NEW YORK
 MANHATTAN COMMUNITY BOARD 3
 59 East 4th Street - New York, NY 10003
 Phone: (212) 533-5300 - Fax: (212) 533-3659
 www.cb3manhattan.org - info@cb3manhattan.org

#12

Gigi Li, Board Chair

Susan Stetzer, District Manager

Community Board 3 Liquor License Application Questionnaire

Please bring the following items to the meeting:

NOTE: ALL ITEMS MUST BE SUBMITTED FOR APPLICATION TO BE CONSIDERED.

- Photographs of the inside and outside of the premise.
- Schematics, floor plans or architectural drawings of the inside of the premise.
- A proposed food and or drink menu.
- Petition in support of proposed business or change in business with signatures from residential tenants at location and in buildings adjacent to, across the street from and behind your proposed location. Petition must give proposed hours and method of operation. For example: restaurant, sports bar, combination restaurant/bar. (petition provided)
- N/A Letter of notice of proposed business to block or tenant association if one exists. E-mail the CB3 office at info@cb3manhattan.org for help to find block associations.
- Photographs of proof of conspicuous posting of meeting with newspaper showing date.
- If applicant has been or is licensed anywhere in City, letter from applicable community board indicating history of complaints and other comments.

Check which you are applying for:

- new liquor license
- alteration of an existing liquor license
- corporate change
- upgrade of an existing liquor license
- sale of assets

Today's Date: _____

If applying for sale of assets, you must bring letter from current owner confirming that you are buying business or have the seller come with you to the meeting.

Type of license: On Premise liquor, beer, wine Is location currently licensed? Yes No

If alteration, describe nature of alteration: _____

Previous or current use of the location: Movie Theatre

Corporation and trade name of current license: Silver Cinemas Acquisition Co DBA Sunshine Theatre

APPLICANT:

Premise address: 143 E Houston Street Manhattan NY 10002-1018

Cross streets: Btwn Forsyth St and Eldridge St South of E Houston; Btwn 1st Ave & 2nd Ave N of E Houston

Name of applicant and all principals: Cinema Beverages Holding Company, LLC

Officer: William Schuyler Hansen Sole Member: WSH Holdco, Inc. Sole Shareholder: William Schuyler Hansen

Trade name (DBA): Sunshine Lounge

PREMISE:

Type of building and number of floors: Commercial Building, 3 Floors

Will any outside area or sidewalk cafe be used for the sale or consumption of alcoholic beverages?
(includes roof & yard) Yes No If Yes, describe and show on diagram: _____

Does premise have a valid Certificate of Occupancy and all appropriate permits, including certificate of occupancy for back or side yard intended for commercial use? Yes No

Indoor Certificate of Occupancy Yes Outdoor Certificate of Occupancy N/A
currently for Public Assembly only

Do you plan to apply for Public Assembly permit? Yes No Held by sublandlord Silver Cinemas Acquisition Co
Zoning designation (check zoning using map: <http://gis.nyc.gov/doitt/nycitymap/> - please give specific zoning designation, such as R8 or C2):

C6-2A

Is this premise wheel chair accessible? Yes No

PROPOSED METHOD OF OPERATION:

What type of establishment will this be (i.e.: restaurant, bar, performance space, club, hotel)?
Restaurant

Will any other business besides food or alcohol service be conducted at premise? Yes No

If yes, please describe what type: Movie theatre
Public Place of Assembly licenses held by Silver Cinemas Acquisition Co, the sublandlord.

What are the proposed days/hours of operation? (Specify days and hours each day and hours of outdoor space) Monday - Sunday 10 AM - 2 AM

No outdoor space

Number of tables? 30 Number of seats at tables? 82

Plus Tables at all auditorium seats per floor plan

How many stand-up bars/ bar seats are located on the premise? 3 bars 33 bar seats

(A stand up bar is any bar or counter (whether with seating or not) over which a patron can order, pay for and receive an alcoholic beverage)

1. 24'-0" "J" Shaped, Lower Level

2. 29'-2" Straight, Ground Floor

Describe all bars (length, shape and location): 3. 26'-6" "U" Shaped, Second Floor

Any food counters? Yes No If Yes, describe: all bars/counters serve both food and alcoholic beverages

Does premise have a full kitchen Yes No?

Does it have a food preparation area? Yes No (If any, show on diagram)

Is food available for sale? Yes No If yes, describe type of food and submit a menu

What are the hours kitchen will be open? 7 days per week 10 AM - 2 AM

Will a manager or principal always be on site? Yes No If yes, which? Manager

How many employees will there be? 50 (+ -) total employees of Silver Cinemas Acquisition Co

Do you have or plan to install French doors accordion doors or windows?

Will you agree to close any doors and windows at 10:00 P.M. every night? Yes No

Will there be TVs/monitors? Yes No (If Yes, how many?) 1 TV in bar area; 10 monitors through out for closed circuit

Will premise have music? Yes No

If Yes, what type of music? Live musician DJ Juke box Tapes/CDs/iPod

If other type, please describe _____

What will be the music volume? Background (quiet) Entertainment level

Please describe your sound system: Background sound system for lounge areas only

Will you host promoted events, scheduled performances or any event at which a cover fee is charged? If Yes, what type of events or performances are proposed? No cover charge
Private events only

How do you plan to manage vehicular traffic and crowds on the sidewalk caused by your establishment? Please attach plans. staff monitors sidewalk and provides crowd control as needed

Will there be security personnel? Yes No (If Yes, how many and when) _____
In-House security staff

How do you plan to manage noise inside and outside your business so neighbors will not be affected? Please attach plans.

Do you have or plan to install sound-proofing? Indicated on plans

APPLICANT HISTORY:

Has this corporation or any principal been licensed previously? Yes No Not in NY

If yes, please indicate name of establishment: See Attached list of locations serving liquor

Address: _____ Community Board # _____

Dates of operation: _____

If you answered "Yes" to the above question, please provide a letter from the community board indicating history of complaints or other comments. No Complaints

Has any principal had work experience similar to the proposed business? Yes No If Yes, please attach explanation of experience or resume.

Does any principal have other businesses in this area? Yes No If Yes, please give trade name and describe type of business _____

Has any principal had SLA reports or action within the past 3 years? Yes No If Yes, attach list of violations and dates of violations and outcomes, if any.

Attach a separate diagram that indicates the location (name and address) and total number of establishments selling/serving beer, wine (B/W) or liquor (OP) for 2 blocks in each direction. Please indicate whether establishments have On-Premise (OP) licenses. Please label streets and avenues and identify your location. Use letters to indicate Bar, Restaurant, etc. The diagram must be submitted with the questionnaire to the Community Board before the meeting.

LOCATION:

How many licensed establishments are within 1 block? 9

How many licensed establishments are within 500 feet? 24

Is premise within a 500 foot radius of 3 or more establishments with OP licenses? Yes No

How many On-Premise (OP) liquor licenses are within 500 feet? 21

Is premise within 200 feet of any school or place of worship? Yes No

If there is a school or place of worship within 200 feet of your premise on the same block, submit a block plot diagram or area map showing its location in proximity to your premise and indicate the distance and name and address of the school or house of worship.

COMMUNITY OUTREACH:

If there are block associations or tenant associations in the immediate vicinity of your location, you must contact them. Please attach proof (copies of letters and poster) that you have advised these groups of your application with sufficient time for them to respond to your notice. You may contact the Community Board at Info@cb3manhattan.org for any contact information.

Please use provided petitions, which clearly state the name, address, license for which you are applying, and the hours and method of operation of your establishment at the top of each page. (Attach additional sheets of paper as necessary).

LANDMARK THEATRES
 'SUNSHINE LOUNGE'
 CITY OF NEW YORK COMMUNITY BOARD 3
 LIQUOR LICENSE APPLICATION

FLOOR PLANS

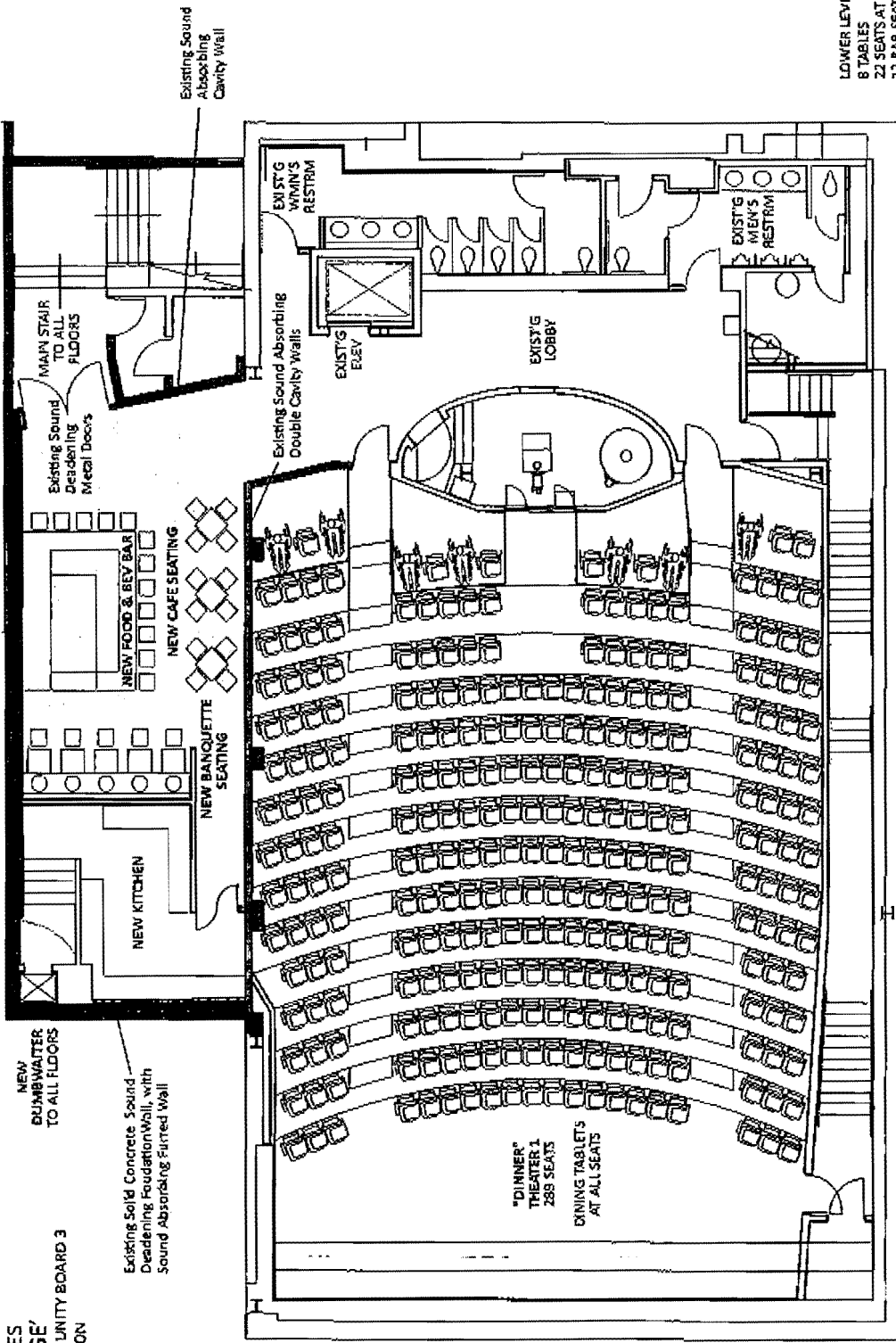

LOWER LEVEL SUMMARY
 8 TABLES
 22 SEATS AT TABLES
 12 BAR SEATS

LOWER LEVEL FLOOR PLAN



Rae|Architecture(s)

LANDMARK THEATRES
 'SUNSHINE LOUNGE'
 CITY OF NEW YORK COMMUNITY BOARD 3
 LIQUOR LICENSE APPLICATION

FLOOR PLANS

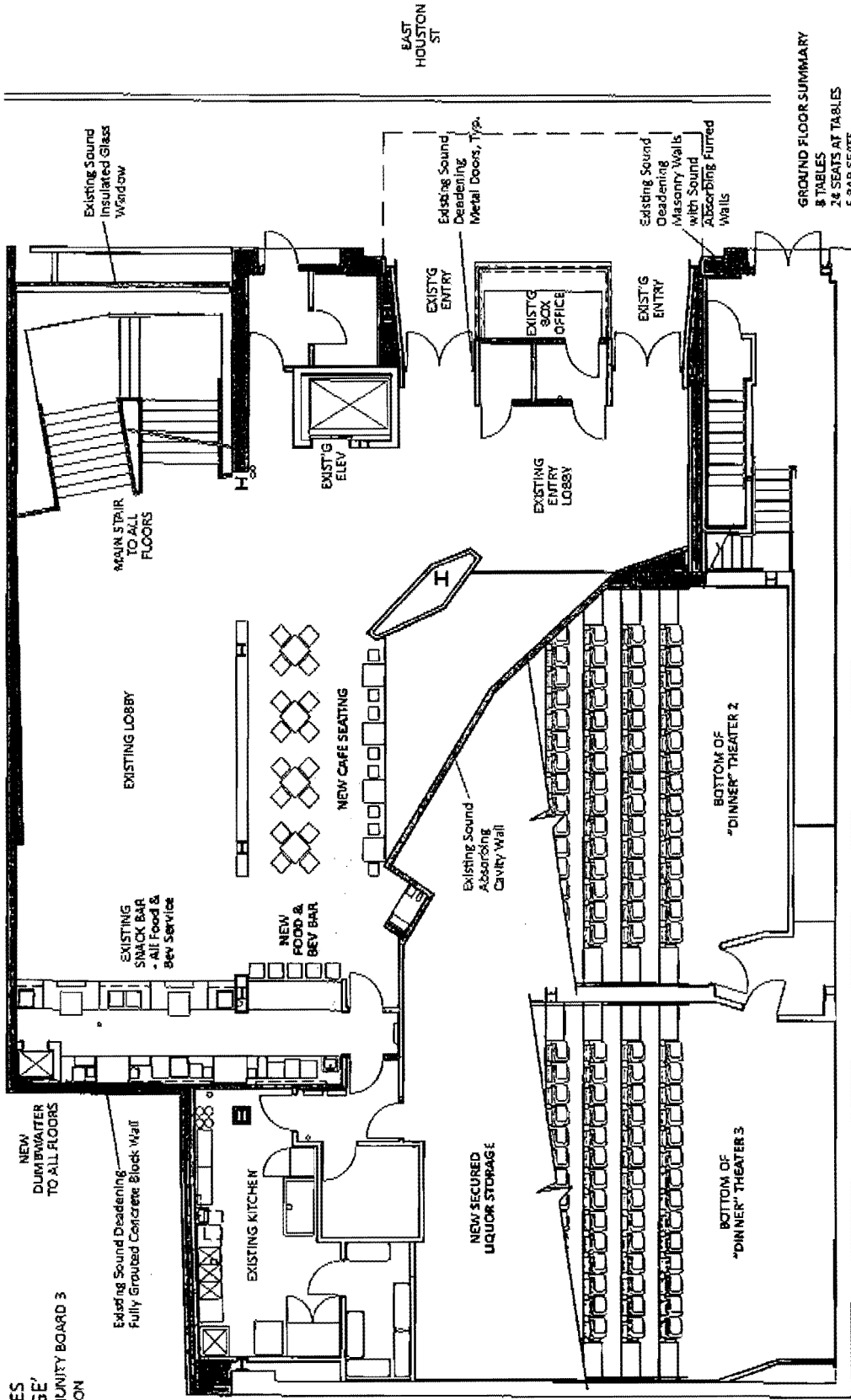

GROUND FLOOR SUMMARY
 8 TABLES
 24 SEATS AT TABLES
 5 BAR SEATS

GROUND FLOOR PLAN - ENTRY LEVEL

RaelArchitecture(s)



LANDMARK THEATRES
 'SUNSHINE LOUNGE'
 CITY OF NEW YORK COMMUNITY BOARD 3
 LIQUOR LICENSE APPLICATION

FLOOR PLANS

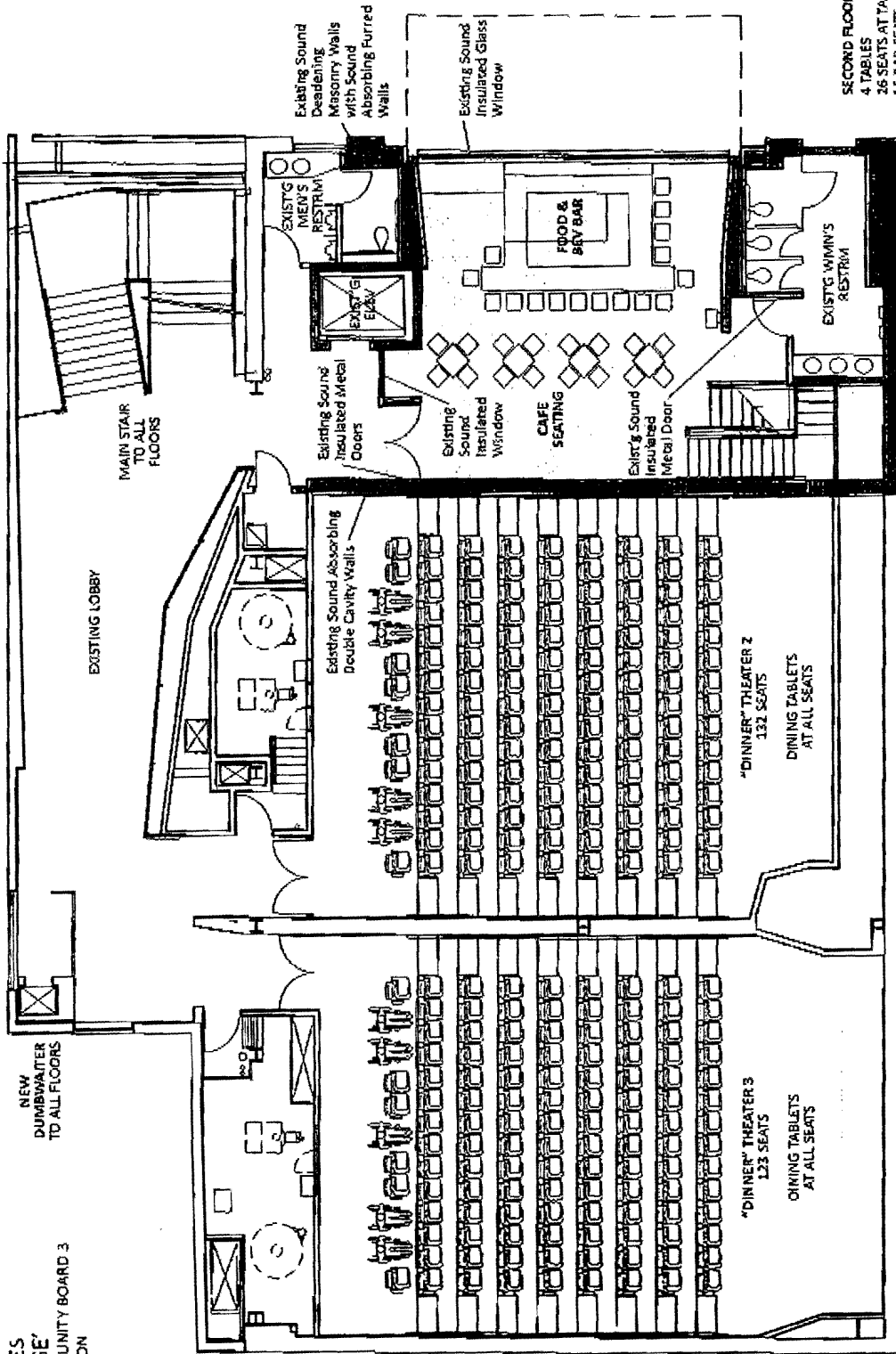

SECOND FLOOR SUMMARY
 4 TABLES
 26 SEATS AT TABLES
 16 BAR SEATS

SECOND FLOOR PLAN

Rae Architecture(s)

LANDMARK THEATRES
 'SUNSHINE LOUNGE'
 CITY OF NEW YORK COMMUNITY BOARD 3
 LIQUOR LICENSE APPLICATION

FLOOR PLANS

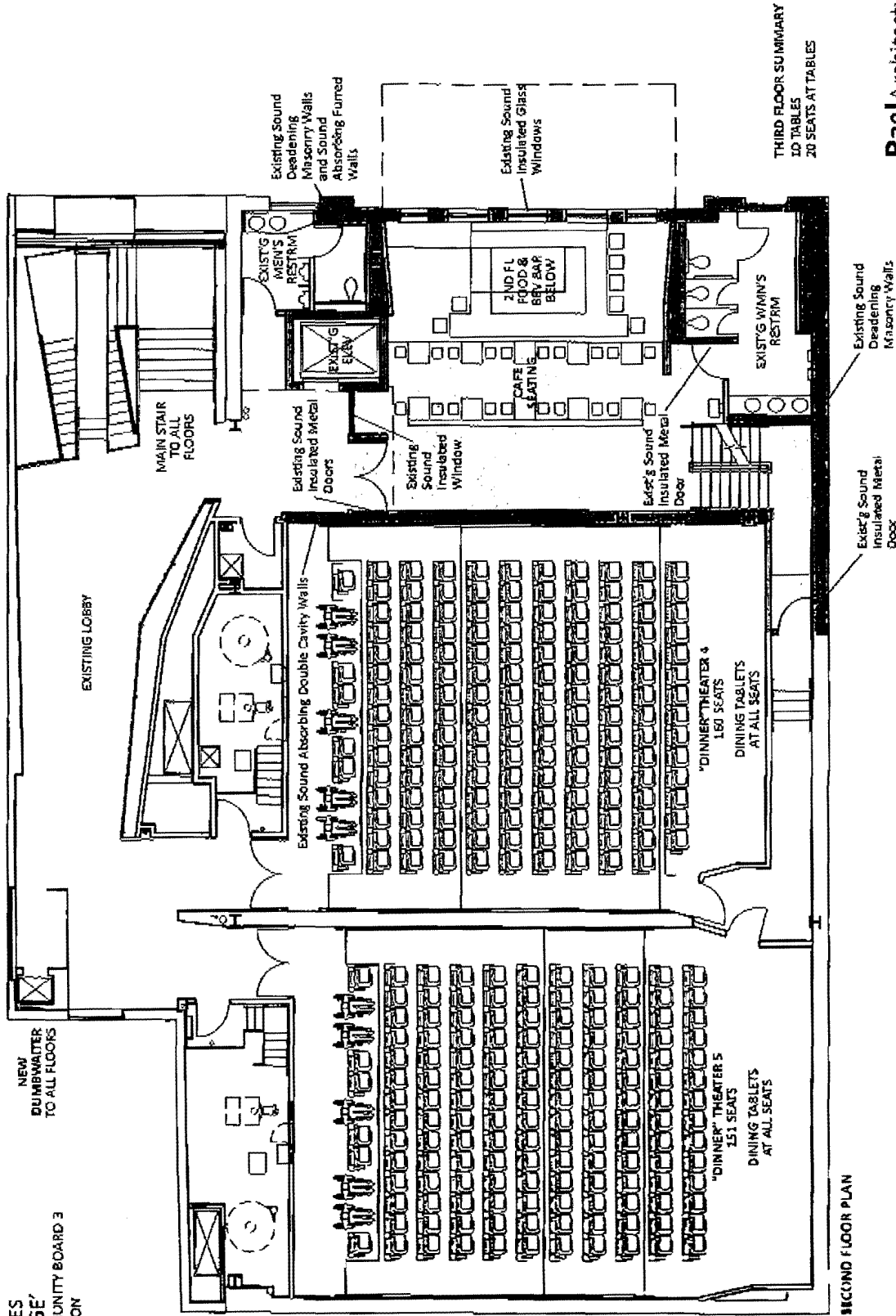

SECOND FLOOR PLAN

Rael Architecture(s)

