



THE CITY OF NEW YORK
MANHATTAN COMMUNITY BOARD 3

59 East 4th Street - New York, NY 10003
Phone: (212) 533-5300 - Fax: (212) 533-3659
www.cb3manhattan.org - info@cb3manhattan.org

2/31

Gigi Li, Board Chair

Susan Stetzer, District Manager

Community Board 3 Liquor License Application Questionnaire

Please bring the following items to the meeting:

NOTE: ALL ITEMS MUST BE SUBMITTED FOR APPLICATION TO BE CONSIDERED.

- Photographs of the inside and outside of the premise.
- Schematics, floor plans or architectural drawings of the inside of the premise.
- A proposed food and or drink menu.
- Petition in support of proposed business or change in business with signatures from residential tenants at location and in buildings adjacent to, across the street from and behind your proposed location. Petition must give proposed hours and method of operation. For example: restaurant, sports bar, combination restaurant/bar. (petition provided)
- Letter of notice of proposed business to block or tenant association if one exists. E-mail the CB3 office at info@cb3manhattan.org for help to find block associations.
- Photographs of proof of conspicuous posting of meeting with newspaper showing date.
- If applicant has been or is licensed anywhere in City, letter from applicable community board indicating history of complaints and other comments.

Check which you are applying for:

- new liquor license
- alteration of an existing liquor license
- corporate change
- upgrade of an existing liquor license
- sale of assets

If applying for sale of assets, you must bring letter from current owner confirming that you are buying business or have the seller come with you to the meeting.

Type of license: Tavern Wine Is location currently licensed? Yes No

If alteration, describe nature of alteration: _____

Previous or current use of the location: Grocery/Candy (licensed as a grocery store previously)

Corporation and trade name of current license: Has been closed for 12+ months

APPLICANT:

Name of applicant and all principals: Paul Typaldos and Andreas Typaldos

Trade name (DBA): Name of entity TBD

Premise address and cross streets: 139 East 12th St. btwn 3rd and 4th aves

PREMISE:

Type of building and number of floors: 3 sory residential space with commercial space on the ground floor.

Will any outside area or sidewalk cafe be used for the sale or consumption of alcoholic beverages?
(includes roof & yard) Yes No If Yes, describe and show on diagram: _____

Does premise have a valid Certificate of Occupancy and all appropriate permits, including certificate
of occupancy for back or side yard intended for commercial use? Yes No
Indoor Certificate of Occupancy Max. 74 Outdoor Certificate of Occupancy _____

Do you plan to apply for Public Assembly permit? Yes No
Zoning designation (check zoning using map: <http://gis.nyc.gov/doitt/nycitymap/> - please give
specific zoning designation, such as R8 or C2):

Is this premise wheel chair accessible? Yes No

PROPOSED METHOD OF OPERATION:

What type of establishment will this be (i.e.: restaurant, bar, performance space, club, hotel)?
Cafe

Will any other business besides food or alcohol service be conducted at premise? Yes No
If yes, please describe what type: _____

What are the proposed days/hours of operation? (Specify days and hours each day and hours of
outdoor space) Sun-Wed (7am-11pm) Thurs-Sat (7am-2am)

Number of tables? 5 Number of seats at tables? 10

How many stand-up bars/ bar seats are located on the premise? 1 th 3 seats

(A **stand up bar** is any bar or counter (whether with seating or not) over which a patron can order,
pay for and receive an alcoholic beverage)

Describe all bars (length, shape and location): 8 foot long counter, 3 bar seats in the evening.

Any food counters? Yes No If Yes, describe: _____

Does premise have a full kitchen Yes No?

Does it have a food preparation area? Yes No (If any, show on diagram)

Is food available for sale? Yes No If yes, describe type of food and submit a menu
Simple organic fare: sandwiches, paninis, salads etc.

What are the hours kitchen will be open? Sun-Wed (7am-11pm) Thurs-Sat (7am-2am)

Will a manager or principal always be on site? Yes No If yes, which? Initially, principal will be on site

How many employees will there be? 6

Do you have or plan to install French doors accordion doors or windows?

Will you agree to close any doors and windows at 10:00 P.M. every night? Yes No

Will there be TVs/monitors? Yes No (If Yes, how many?) _____

Will premise have music? Yes No

If Yes, what type of music? Live musician DJ juke box Tapes/CDs/iPod

If other type, please describe _____

What will be the music volume? Background (quiet) Entertainment level

Please describe your sound system: _____

Will you host promoted events, scheduled performances or any event at which a cover fee is charged? If Yes, what type of events or performances are proposed? No

How do you plan to manage vehicular traffic and crowds on the sidewalk caused by your establishment? Please attach plans.

Will there be security personnel? Yes No (If Yes, how many and when) _____

How do you plan to manage noise inside and outside your business so neighbors will not be affected? Please attach plans.

Do you have or plan to install sound-proofing?

APPLICANT HISTORY:

Has this corporation or any principal been licensed previously? Yes No

P.Typaldos has a minority interest in Gutter (Brooklyn) and two bars out of state (N.J. and PA)

If yes, please indicate name of establishment: Andreas Typaldos is a majority member in Greensquare Tavern (Restaurant)

Address: 5 West 21st St. New York, NY 10010 Community Board # 4

Dates of operation: _____

If you answered "Yes" to the above question, please provide a letter from the community board indicating history of complaints or other comments.

Has any principal had work experience similar to the proposed business? Yes No If Yes, please attach explanation of experience or resume.

Does any principal have other businesses in this area? Yes No If Yes, please give trade name and describe type of business _____

Has any principal had SLA reports or action within the past 3 years? Yes No If Yes, attach list of violations and dates of violations and outcomes, if any.

Attach a separate diagram that indicates the location (**name and address**) and total number of establishments selling/serving beer, wine (B/W) or liquor (OP) for 2 blocks in each direction. Please indicate whether establishments have On-Premise (OP) licenses. Please label streets and avenues and identify your location. Use letters to indicate Bar, Restaurant, etc. The diagram must be submitted with the questionnaire to the Community Board before the meeting.

LOCATION:

How many licensed establishments are within 1 block? None on immediate block

How many licensed establishments are within 500 feet? 17

Is premise within a 500 foot radius of 3 or more establishments with OP licenses? Yes No

How many On-Premise (OP) liquor licenses are within 500 feet? 13

Is premise within 200 feet of any school or place of worship? Yes No

If there is a school or place of worship within 200 feet of your premise on the same block, submit a block plot diagram or area map showing its location in proximity to your premise and indicate the distance and name and address of the school or house of worship.

COMMUNITY OUTREACH:

If there are block associations or tenant associations in the immediate vicinity of your location, you must contact them. **Please attach proof (copies of letters and poster) that you have advised these groups of your application with sufficient time for them to respond to your notice.** You may contact the Community Board at info@cb3manhattan.org for any contact information.

Please use provided petitions, which clearly state the name, address, license for which you are applying, and the hours and method of operation of your establishment at the top of each page. (Attach additional sheets of paper as necessary).

List of licenses within 500ft

Name	Address
WEBSTER HALL ENTERTAINMENT CORP	119 E 11TH STREET
FRIEND TRI NEW YORK INC	145 E 13TH S AKA 106 THIRD AVE
CORNER BILLIARDS CORP	110 E 11TH ST
E BROTHERS CORP	127 4TH AVE
MONTIEN 2000 CORP	90 3RD AVENUE
132 4TH AVENUE RESTAURANT LLC	132 4TH AVE
LONGFORD INC	98 3RD AVE
THIRD AVENUE RESTAURANT CORP	64 3RD AVENUE
HONEY JAR INC	60 3RD AVE
EAST COUNTY LOU TH INC	103 3RD AVENUE
3RD AVENUE HOSPITALITY LLC	55 3RD AVE
82ND STREET CAFE INC	1453 57 3RD AVE
56 THIRD AVE NEW YORK RESTAURANT LLC	56 3RD AVE

Beer/Wine

PIE INC.	124 4TH AVE
THINK FOURTH AVENUE LLC	121 123 4TH AVE
AROOJ CORP	92 3RD AVE
ASIAN CHEF EXPRESS INC.	96 3RD AVE

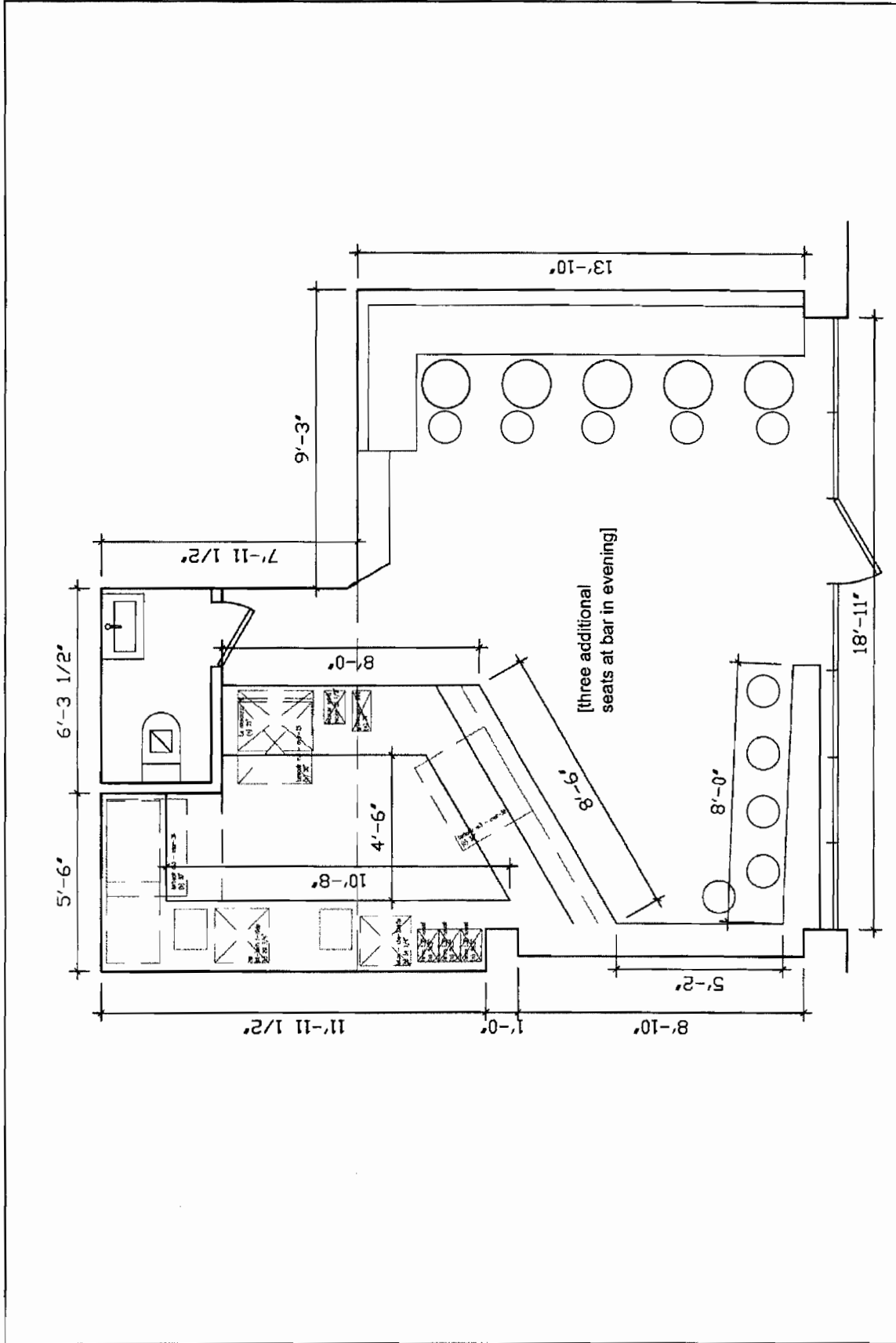

A-1

PLAN WITH EQUIPMENT & SEATING

10 JUNE 2012
 1/4" = 1'-0"

REFERENCED DRAWING: -
 R1209

tacet creations
 611 Broadway, #530
 New York, NY, 10012
 DRAWN BY: HK
 CHECKED BY: -
 +1 646.919.5147
 +1 718.732.2412

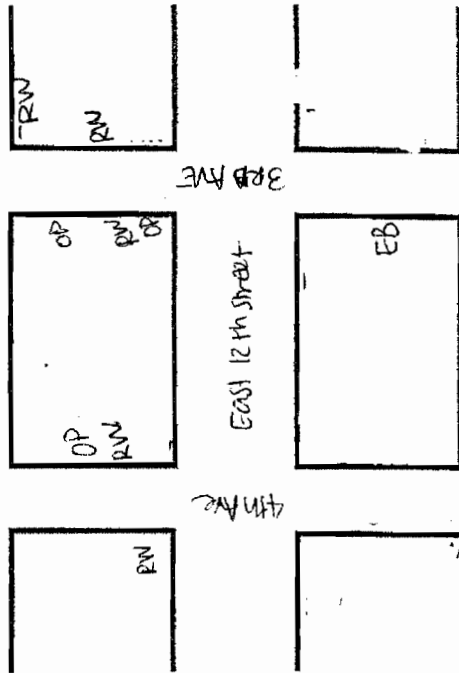

MORNING	PREPARATION	SIT DOWN	TO GO	DELIVERY
coffee / tea	on premises	yes	yes	yes
freshly squeezed juice/smoothies: <i>orange juice, grapefruit juice, banana, guanabana</i>	on premises	yes	yes	yes
bottled juices / water / etc.	off premises	yes	yes	yes
oatmeal	on premises	yes	yes	yes
baked goods: <i>media lunas, croissants, pain au chocolat, scones, cookies, biscotti</i>	off premises	yes	yes	yes
AFTERNOON	PREPARATION	SIT DOWN	TO GO	DELIVERY
coffee / tea	on premises	yes	yes	yes
freshly squeezed juice/smoothies: <i>orange juice, grapefruit juice, banana, guanabana</i>	on premises	yes	yes	yes
bottled juices / water / etc.	off premises	yes	yes	yes
baked goods: <i>media lunas, croissants, pain au chocolat, scones, cookies, biscotti</i>	off premises	yes	yes	yes
sandwiches: <i>pressed; cheese, ham, salami, vegetarian, etc.</i> <i>cold: cheese, ham, salami, vegetarian, etc.</i>	on premises	yes	yes	yes
cold "tapas": <i>bread, olive oil, salami, ham, cheese, dips</i>	on premises	yes	no	no
soup	off premises on premises (heat)	yes	yes	yes
gelato	off premises	yes	yes	maybe

EVENING / NIGHT	PREPARATION	SIT DOWN	TO GO	DELIVERY
coffee / tea	on premises	yes	yes	yes
bottled juices / water / etc.	off premises	yes	yes	yes
wine	off premises	yes	no	no
bottled beer	off premises	yes	yes	no
sandwiches:	on premises	yes	yes	yes
<i>pressed; cheese, ham, salami, vegetarian, etc.</i>				
<i>cold: cheese, ham, salami, vegetarian, etc.</i>				
cold "tapas":	on premises	yes	no	no
<i>bread, olive oil, salami, ham, cheese, dips</i>				
soup	off premises on premises (heat)	yes	yes	yes
gelato	off premises	yes	yes	maybe