



THE CITY OF NEW YORK
 MANHATTAN COMMUNITY BOARD NO. 3
 59 East 4th Street - New York, NY 10003
 Phone: (212) 533-5300 - Fax: (212) 533-3659
 www.cb3manhattan.org - info@cb3manhattan.org

Dominic Pisciotta, Board Chair

Susan Stetzer, District Manager

Community Board 3 Liquor License Application Questionnaire

Please complete and return (**with requested diagram**) to the Community Board office by fax or email. In addition, bring **6 copies (double sided)** plus supporting material requested to the meeting. Failure to complete and return this form on time will result in your item being placed at the end of the agenda. **Application must be complete to be heard, including petitions and all items on check list below. Use N/A for answer if appropriate.**

Conspicuously display the enclosed posters on the outside of your establishment for **7 days** prior to the meeting. Bring a photo with a newspaper showing date as proof of the posting.

Check which you are applying for: new liquor license upgrade of an existing liquor license
 alteration of an existing liquor license sale of assets of existing liquor licensed business

If applying for transfer, you must bring letter from current owner confirming that you are buying business.

Type of license: EATING PLACE SERVING BEER Is location currently licensed? Yes No

If alteration, describe nature of alteration: _____

Previous or current use of the location: Vacant for three years, hardware store prior

Corporation and trade name of current/previous license: _____

APPLICANT:

Name of applicant and all principals: ALPHABET CITY BEER Co., LLC

DAVID HITCHNER and ZACHARY MACK

Trade name (DBA): _____

Premises address: 96 AVENUE C, New York, NY 10009

Between what streets: 6th and 7th Streets

PREMISES:

Type of building and number of floors: Multi-unit apartment building

Prior use of premises: Hardware store

Any outside area or sidewalk cafe used for the sale or consumption of alcoholic beverages? (includes roof & yard) Yes No If Yes, describe and show on diagram: Backyard

Does premises have a valid Certificate of Occupancy and all appropriate permits? Yes No

Do you plan to apply for Public Assembly permit? Yes No

Zoning designation: Use Group 6 Maximum number of persons that can legally occupy the premises? currently 13 Number of tables? 7 Number of seats at tables? 23

* architect will be applying
BARS: for anew capacity

How many *stand-up bars/ bar seats are located on the premises (and how many seats)? 1 bar, 7 seats

How many service bars? 1 service bar

Describe all bars (length, shape and location): Approximately 23' L-shaped bar at mid-right of entrance

Any food counters? Yes No If Yes, describe: Cheese counter at the "L" of the bar

* A **stand up bar** is any bar or counter (whether seating or not) over which a member of the public can order, pay for and receive an alcoholic beverage.

KITCHEN:

Does premises have a full kitchen or food preparation area? (If any, show on diagram)

Is food available for sale? Yes No If yes, describe type of food and submit a menu The food is primarily small bites of cheese, meats, and pickles from local sources.

PROPOSED METHOD OF OPERATION:

What type of establishment will this be? (i.e.: restaurant, tavern, sports bar, etc.) Beer bar and store.

Will any other business besides food or alcohol service be conducted at said premises? Yes No

If yes, details: _____

What are the proposed days/hours of operation? (Specify days and hours each day) _____

SUNDAY - THURSDAY 12 PM - 12 AM; FRIDAY & SATURDAY 12 PM - 2 AM

Will the business employ a manager? Yes No

How many employees? 5

Will there be security personnel? Yes No (If Yes, how many?) _____

Do you have or plan to install French doors, accordion doors, or windows? none of these

Will there be TV's? Yes No (If Yes, how many?) _____

Will premises have music? Yes No

If Yes, what type of music? Explain in detail: Contemporary

Type of music/entertainment: Live musician Live DJ Juke box Tapes/CDs
Volume level: Background (quiet) Entertainment level

Do you have or plan to install sound-proofing? Please describe your sound system: Drop ceiling and add insulation

Will you host promoted events, scheduled performances or any event at which a cover fee is charged?

Cheese and beer pairing seminars and other food and beer related events
Do you have plans to manage or address vehicular traffic and crowd control on the sidewalk caused by your establishment? Yes No If "Yes" please attach plans.

Is this establishment wheel chair accessible? Yes No

Has this corporation or any principal been licensed previously? Yes No

If yes, please indicate name of establishment: ALPHABET CITY WINE CO.; IN VINO WINE BAR

Address: 100 AVENUE C; 215 EAST 4TH ST., NY, NY 10013 Community Board # 3

Dates: November 2007 -> present; October 2007 - present

If you answered "Yes" to the above question, please provide a letter from the community board indicating history of complaints or other comments.

Using the diagram below as an example, attach a separate similar diagram that indicates the location (name and address) and total number of establishments selling/serving beer, wine (B/W) or liquor (OP) for 2 blocks in each direction. Please indicate whether establishments have On-Premises (OP) licenses by circling the letter on diagram. Please label streets and avenues and identify your location near the middle of the diagram and indicate it with a [★]. Use the letters to indicate Bar, Restaurant, etc. The diagram must be submitted with the questionnaire to the Community Board before the meeting.

Bar (B) Hotel Restaurant (R) Sidewalk Café (S)
OP 3 B/W _____ HL _____ OP 1 B/W 3 OP _____ B/W 1

Example:

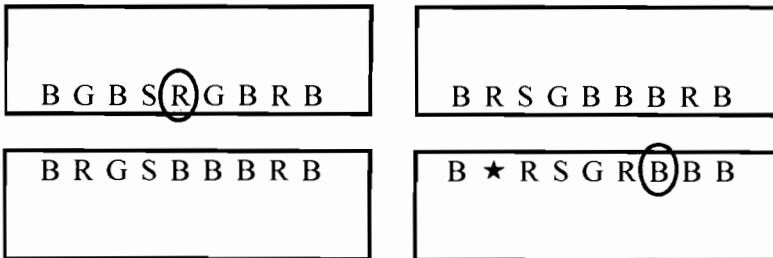

How many licensed establishments are within 1 block? 7 on-premise; 4 B off-premise; 1 wine

How many licensed establishments are within 500 feet? 8 on-premise; 4 beer off-premise; 1 wine

How many within 500 feet are On-Premises (OP) liquor licenses? 3 (4 if Vibrations is still valid) off.

If there are block associations or tenant associations in the immediate vicinity of your location, you must contact them. **Please attach proof (copies of letters and poster) that you have advised these groups of your application. Petitions should clearly state the name, address, license for which you are applying, and the hours and method of operation of your establishment at the top of each page.** (Attach additional sheets of paper as necessary). You may contact the Community Board at info@cb3manhattan.org for any contact information that is on file.

N/A re: Edwin Chan.

INFORMATION REGARDING NEARBY LOCATIONS:

Premises is within a 500 foot radius of three or more establishments with OP license. Yes No

Premises is within 200 feet of any school or place of worship? Yes No

If there is a school place of worship within 200 feet of your premises on the same block, submit a block plot diagram or area map showing its location in proximity to your applicant premises (8 1/2" x 11") and indicate the distance and name and address.

8th Street

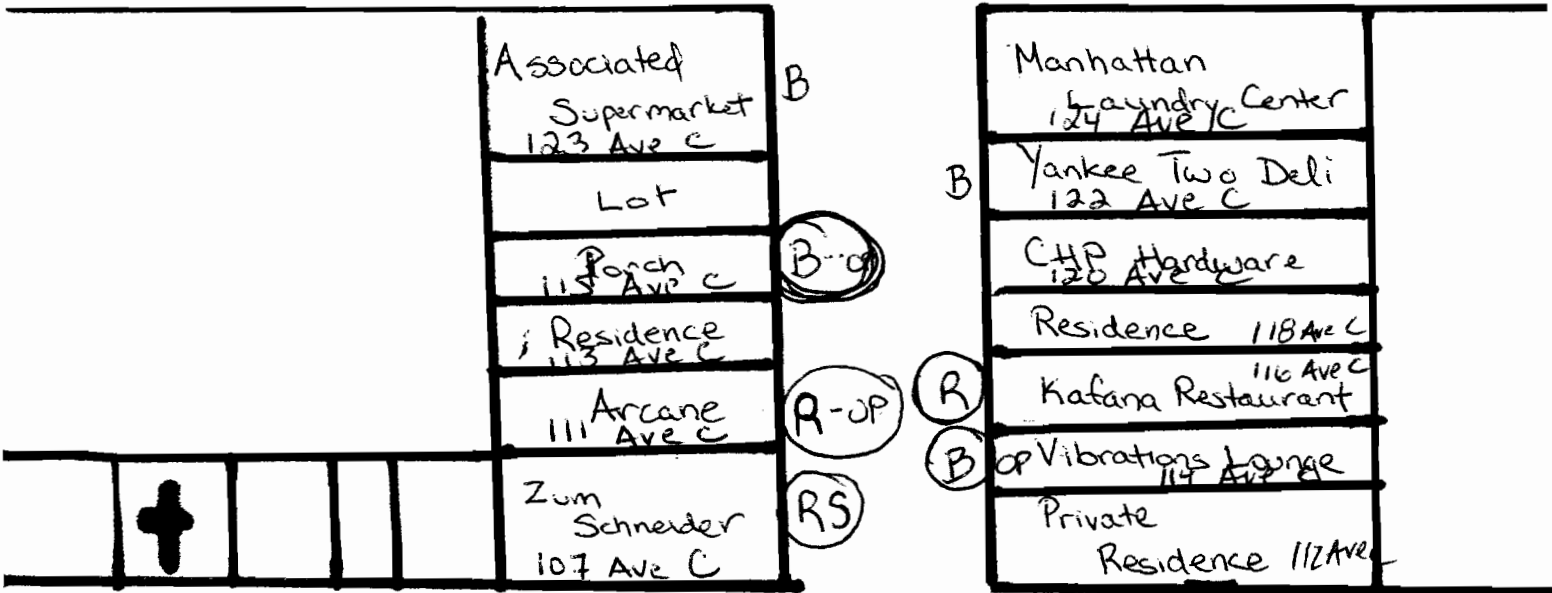

7th Street

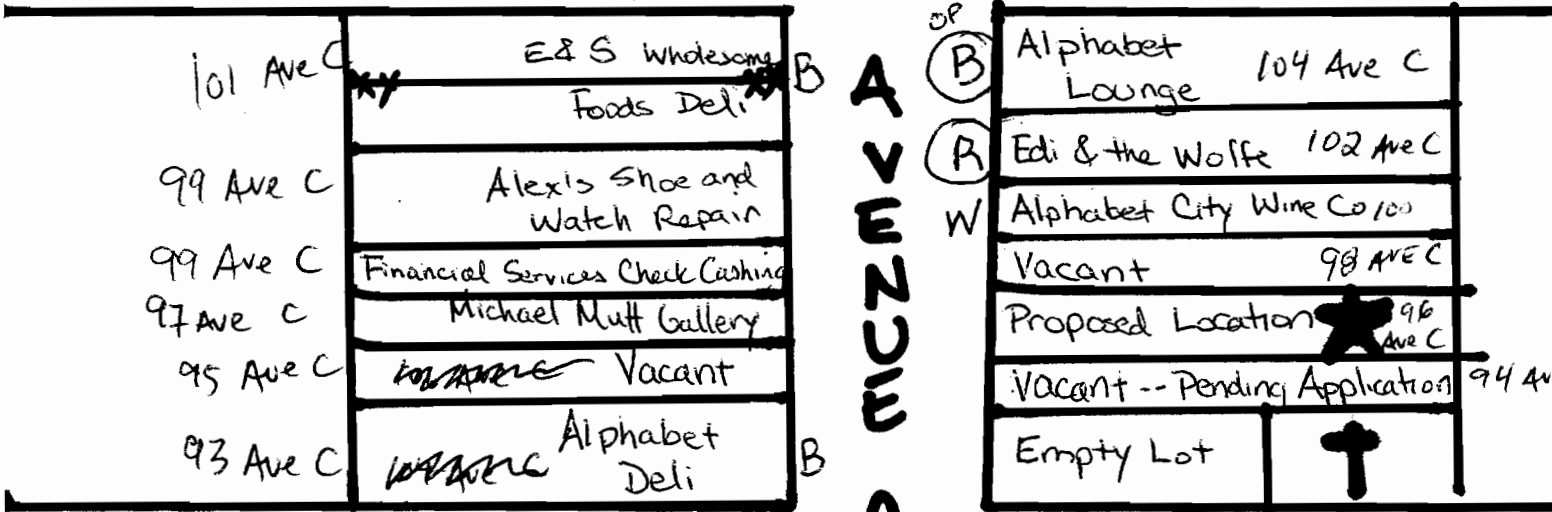

6th Street

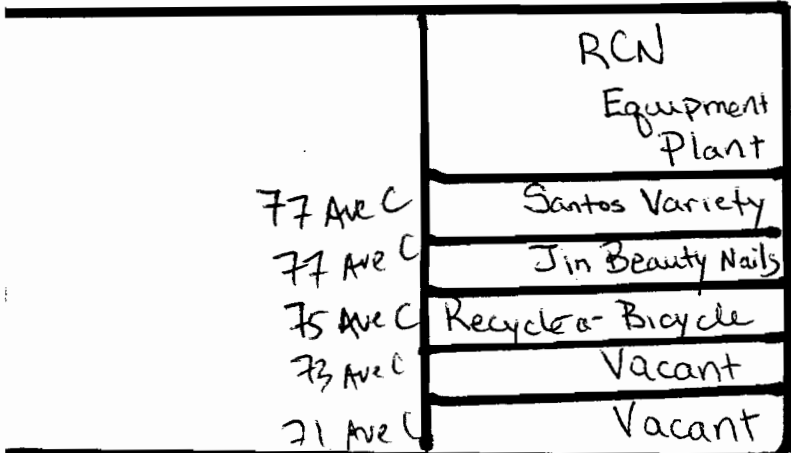

Street

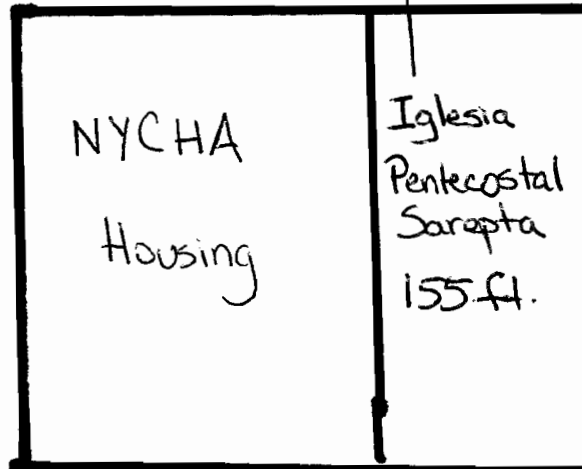

5th Street