



Eric Adams  
Mayor

Ydanis Rodriguez  
Commissioner

# COMMUNITY BOARD FEEDBACK PACKAGE

**Please review this application and provide the required feedback.**

## DINING OUT NYC

## COMMUNITY BOARD RECOMMENDATION FORM

This form is to be used by community boards during the cafe review process. Any comments from the community board should be recorded on this form and submitted to NYC DOT. For information pertaining to specific cafe design requirements, visit the Dining Out NYC website for program legislation, rules, and Setup Guides.

**Business Name:**

**Cafe Location:**

**Application Number:**

**CB Feedback Deadline (on date or next business day):**

NYCDOT Internal Use Only

### Roadway Cafe Setup Comments:

Comments related to the cafe's **physical footprint and dimensions**:

Comments related to **pedestrian flow** (i.e., visibility, safety , potential crowding):

Comments related to potential conflicts with **existing curb use** (i.e., planters, bike racks, bus stops):

Overall recommendation for the cafe setup:

Suggested modifications related to the above referenced application:

Community Board Authorizing Name

Date



# Outdoor Dining Application Portal

## Restaurant Details



### Food Service Establishment Permit(FSEP)

FSEP#: **50107195** Expiration Date: **11/30/2025**

DOHMH Status: **CURRENT**

Business Legal Name: **NONLA LLC**

Assumed Name: **NON LA**

Business Address: **128 E 4TH ST, NEW YORK, NY 10003**

Venue Type: **Restaurant (no bar)**

Last updated from DOHMH: **03/03/2025**

### Restaurant Information

Entity Type: **Limited Liability Corporation (LLC)**

Employer Identification Number: **85-3130306**

Phone: **(917) 388-3321**

Email Address: **nonlaviet2020@gmail.com**

### Emergency Contact Information

First Name: **Tommy**

Last Name: **Nguyen**

Phone: **(201) 772-4067**

Email Address: **tommyn4242@yahoo.com**

### DOS Information

DOS ID#: **5817905**

Process Name: **Maggie Nguyen**

DOS Address: **41 merivale lane, staten island , New York 10304**

### NYS Liquor Authority Information

Establishment serves alcohol : **No**

### User Information

Created By: **Tommy Nguyen**

Created On: **4/9/2024 3:49:30 PM**

FSEP #

5010719

A

20





NÓN  
LÁ

VIETNAMESE KITCHEN

128

FRIEND  
-OF-A-  
BARBER

VILLAGE CAFE & GRILL  
121 W 10TH ST NEW YORK, NY 10014  
TEL: (212) 255-1234

VILLAGE CAFE & GRILL  
121 W 10TH ST NEW YORK, NY 10014  
TEL: (212) 255-1234

SCHOOL BUS







  
**NÓN  
LÁ**  
VIETNAMESE KITCHEN  
128





  
**NÓN  
LÁ**  
VIETNAMESE KITCHEN  
128

128

130

**NÓN LÁ**  
VIETNAMESE KITCHEN

A

♿  
PLEASE USE  
SIDEWALK

NO  
SMOKE



## SECTION 1: Site Plan

- This Site Plan form is required to be uploaded in the "Sidewalk Site Plan" field of your online application.
- Refer to the [How to Apply](#) page in the Dining Out NYC website for more information about the application process.



### Setup Area Identification :

- ☐ Please check this box if you plan to have outdoor dining located partially within private property. If you are uncertain, please request records from your property owner/manager.
- ☐ Please check this box if all or part of your sidewalk cafe is in a sidewalk widening area, developed pursuant to the NYC Zoning Resolution. If so, indicate the property line in the site plan drawing below.

Applicant Name: \_\_\_\_\_

Restaurant Name: \_\_\_\_\_

FSEP Number: \_\_\_\_\_

Use the space below to draw or upload your Site Plan representing your cafe perimeters, furniture, and clearances.

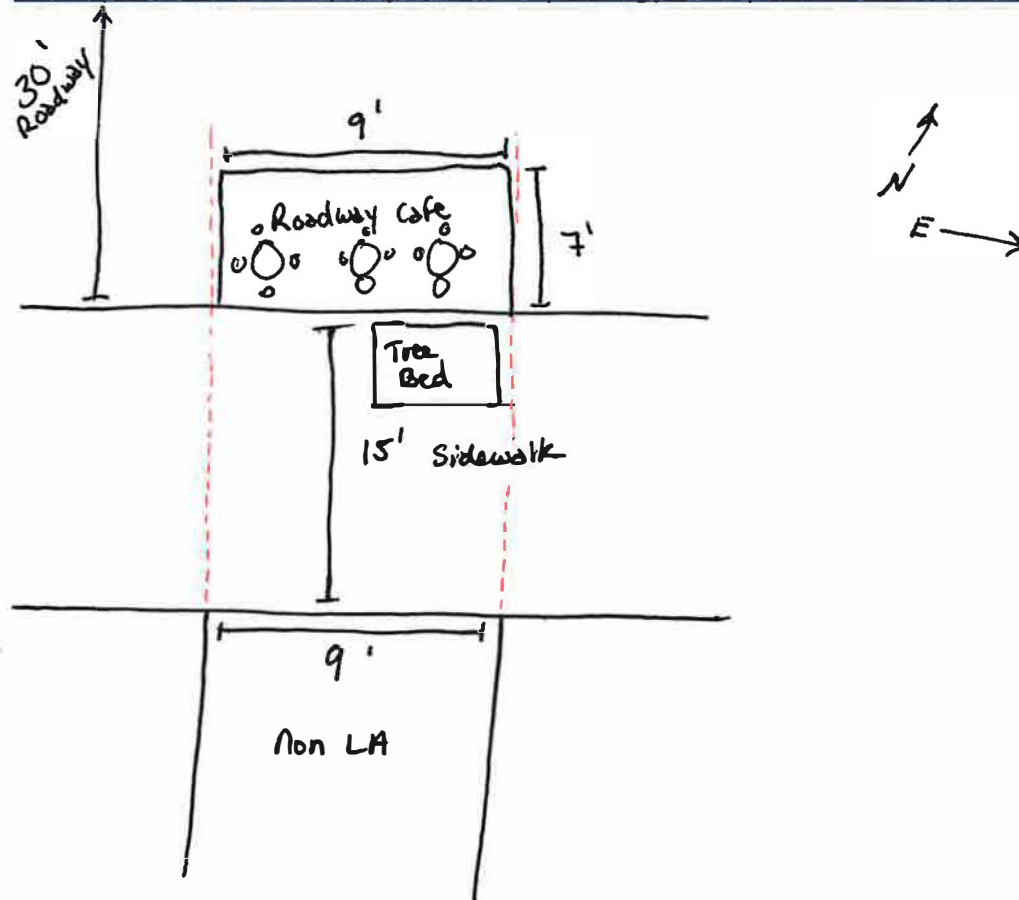

Length of sidewalk cafe: \_\_\_\_\_ feet

Width of sidewalk cafe: \_\_\_\_\_ feet

### Drawing Requirements

#### Food service establishment frontage shown by:

- Line representing the establishment's space facing the sidewalk
- Length
- Labels

#### Private Property shown as:

- Dashed line

#### Street names:

- Labels on each street

#### Sidewalk shown as:

- Line representing street curb
- Width measured from building line to curb line

#### Building entrances shown as:

- Label

#### Cafe perimeter shown as:

- Lines indicating perimeter
- Length and width

#### Set-up furniture (tables, chairs, etc.) shown as:

- Lines or symbols at approximate location within setup

#### Elements (in Section 2 of this form) within 15 feet of cafe perimeter, shown as:

- Lines or symbols
- Distance from cafe perimeter
- Labels

#### Utility coverings (water/gas valves, and pull boxes) shown as:

- Symbols representing the location within the setup

North arrow



## SECTION 2: Required Clearances

- Please provide distances from the following objects:
  - Only provide a distance if the listed object is within 15 feet of your proposed setup
  - Leave box blank if not applicable
  - Refer to the Setup Guides in the Dining Out NYC website for more information regarding clearances

### Elements with minimum 15 feet clearance from roadway cafe:

- ☐ R01: Subway Stair Open End \_\_\_\_\_ feet
- ☐ R02: Fire Hydrant \_\_\_\_\_ feet

### Elements with minimum 10 feet clearance from roadway cafe:

- ☐ R03: Subway Elevator Entrance \_\_\_\_\_ feet
- ☐ R04: FONY Curb Cut \_\_\_\_\_ feet
- ☐ R05: MTA Curb Cut \_\_\_\_\_ feet

### Elements with minimum 5 feet clearance from roadway cafe:

- ☐ R06: Curb Cut \_\_\_\_\_ feet
- ☐ R07: Emergency Exit Hatch \_\_\_\_\_ feet
- ☐ R08: Subway Stair Closed End \_\_\_\_\_ feet
- ☐ R09: Subway Elevator Non-Entry \_\_\_\_\_ feet
- ☐ R10: Bus Stop Pole \_\_\_\_\_ feet
- ☐ R11: Call/Bike/Bike Share Station \_\_\_\_\_ feet
- ☐ R12: Bike Corral \_\_\_\_\_ feet
- ☐ R13: Micromobility Station \_\_\_\_\_ feet
- ☐ R14: Damage Infrastructure \_\_\_\_\_ feet
- ☐ R15: Elevated Train Infrastructure \_\_\_\_\_ feet
- ☐ R16: Transformer Vault \_\_\_\_\_ feet
- ☐ R17: Vent Infrastructure \_\_\_\_\_ feet
- ☐ R18: Thermoplastic Marking \_\_\_\_\_ feet

### Elements with minimum 3 feet clearance from roadway cafe:

- ☐ R15: Elevated Train Infrastructure \_\_\_\_\_ feet
- ☐ R16: Transformer Vault \_\_\_\_\_ feet
- ☐ R17: Vent Infrastructure \_\_\_\_\_ feet

### Elements with minimum 1 foot and 6 inches clearance from roadway cafe:

- ☐ R17: Vent Infrastructure \_\_\_\_\_ feet

### Elements with minimum 6 inches clearance from roadway cafe:

- ☐ R18: Thermoplastic Marking \_\_\_\_\_ feet

### Roadway cafe distance from crosswalks:

- ☐ R19: Adjacent to non approaching side of crosswalk (min 8 foot distance) \_\_\_\_\_ feet
- ☐ R20: Adjacent to approaching (stripping) side of crosswalk (min 20 foot distance) \_\_\_\_\_ feet
- ☐ R21: No crosswalk present (maintain 20 feet from curb line of intersecting street) \_\_\_\_\_ feet

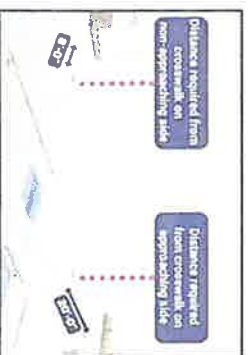

## SECTION 3: Material Requirements

- Please indicate which of the following materials will be part of your roadway cafe by checking the box next to the category. If applicable, please confirm the materials comply with the Dining Out NYC requirements. Refer to the Setup Guides in the Dining Out NYC website for more information regarding materials.

### Materials Checklist:

#### Barriers

- ☐ Maintained on all sides of the cafe except the side fronting the ground floor restaurant
- ☐ Not permanently affixed to the roadway
- ☐ 30-42 inches tall (excluding planting), and at least 4 inches in width
- ☐ Barriers are interconnected with each other
- ☐ Any cladding over the barriers is securely fastened or affixed
- ☐ Minimum 4 inches wide reflective strip on each barrier on the outward facing side
- ☐ Water-filled with a minimum of 150 pounds per linear foot of barrier length
- ☐ If your proposed barriers will utilize fill materials other than water please check this box. This may require additional information from the applicant and further review by the Dining Out NYC team, as well as supporting DOT units and City agencies

### Optional: Only check the material categories you intend to use in your roadway cafe:

#### Flooring

- ☐ Durable, lightweight, easily removable, mold resistant, elevated from the ground level to allow for drainage and removable to allow for cleaning
- ☐ Flush with the curb line (except if located on a slope, be flush to the greatest extent feasible) and compliant with applicable accessibility requirements
- ☐ Maintains a 6 inch covered channel between curb and base of flooring to allow for drainage

#### Furnishings

- ☐ Lightweight and easily movable

#### Vertical Screens/Slings

- ☐ Located between the barrier and 6 feet above the cafe base or floor
- ☐ Located on the roadway facing side, does not extend the beyond the perimeter of the roadway cafe and is not affixed to the outward facing side of barriers
- ☐ Easily removable, comprised of non opaque, fire-grade, and wind resistant materials
- ☐ If within 50 feet of any regulatory or warning signs, does not exceed 46 inches in height

#### Overhead Coverings/ Umbrellas

- ☐ Minimum of 7 feet and maximum of 10 feet from the base or floor of the roadway cafe
- ☐ Has a weighted base and any support structures are not affixed to the outward facing side of barriers, are of sufficient size and strength, made of durable materials, and free of defects
- ☐ Easily removable, comprised of fire-grade and wind resistant materials
- ☐ If within 50 feet of any regulatory or warning signs, does not exceed 46 inches in height

#### Lighting and Electrical Connections

- ☐ Any lighting is outdoor rated, properly secured, and lightweight
- ☐ At least 14 feet above sidewalk, and 18 feet above roadway
- ☐ Not attached to any City property, including street trees
- ☐ Electrical work complies with the applicable requirements set forth in the DOT's rules and the New York City Electrical Code

☐ Please check this box if you are submitting additional documents for review. Documents may include technical drawings prepared by a licensed professional.