

April 1, 2025
Public Hearing

The current proposal is:

Preservation Department – Item 4, LPC-25-04670

Ocean Parkway – Scenic Landmark Borough of Brooklyn

To testify virtually, please join Zoom

Webinar ID: 160 977 4343

Passcode: 525077

By Phone: 646-828-7666 (NY)

833-435-1820 (Toll-free)

833-568-8864 (Toll-free)

Note: If you want to testify virtually on an item, join the Zoom webinar at the agenda's "Be Here by" time (about an hour in advance). When the Chair indicates it's time to testify, "raise your hand" via the Zoom app if you want to speak (*9 on the phone). Those who signed up in advance will be called first.

Avenue U Pumping Station

Avenue U and Ocean Parkway, Brooklyn

Landmarks Preservation Commission

April 2025





NYC DEPARTMENT OF ENVIRONMENTAL PROTECTION

Our Mission

DEP's mission is to enrich the environment and protect public health for all New Yorkers by providing high quality drinking water, managing wastewater and stormwater, and reducing air, noise, and hazardous materials pollution.

DEP treats over a billion gallons of sewage every day at our 14 wastewater resource recovery facilities, and that wastewater is conveyed to treatment by 96 pump stations across the city through a network on 7,500 miles of sewers.



OVERVIEW

Avenue U Pumping Station

- The Avenue U Pumping Station was originally constructed between 1912 and 1915 and was last upgraded in 1987.
- The station serves residences and businesses in Gravesend and Sheepshead Bay, conveying sanitary sewage to the Owl's Head Wastewater Resource Recovery Facility for treatment.
- The station is located below ground on the eastern Ocean Parkway median within the Scenic Landmark.
- The proposed reconstruction project will upgrade the entire pump station to meet updated standards of safety, efficiency, and resiliency.

Project Neighborhood

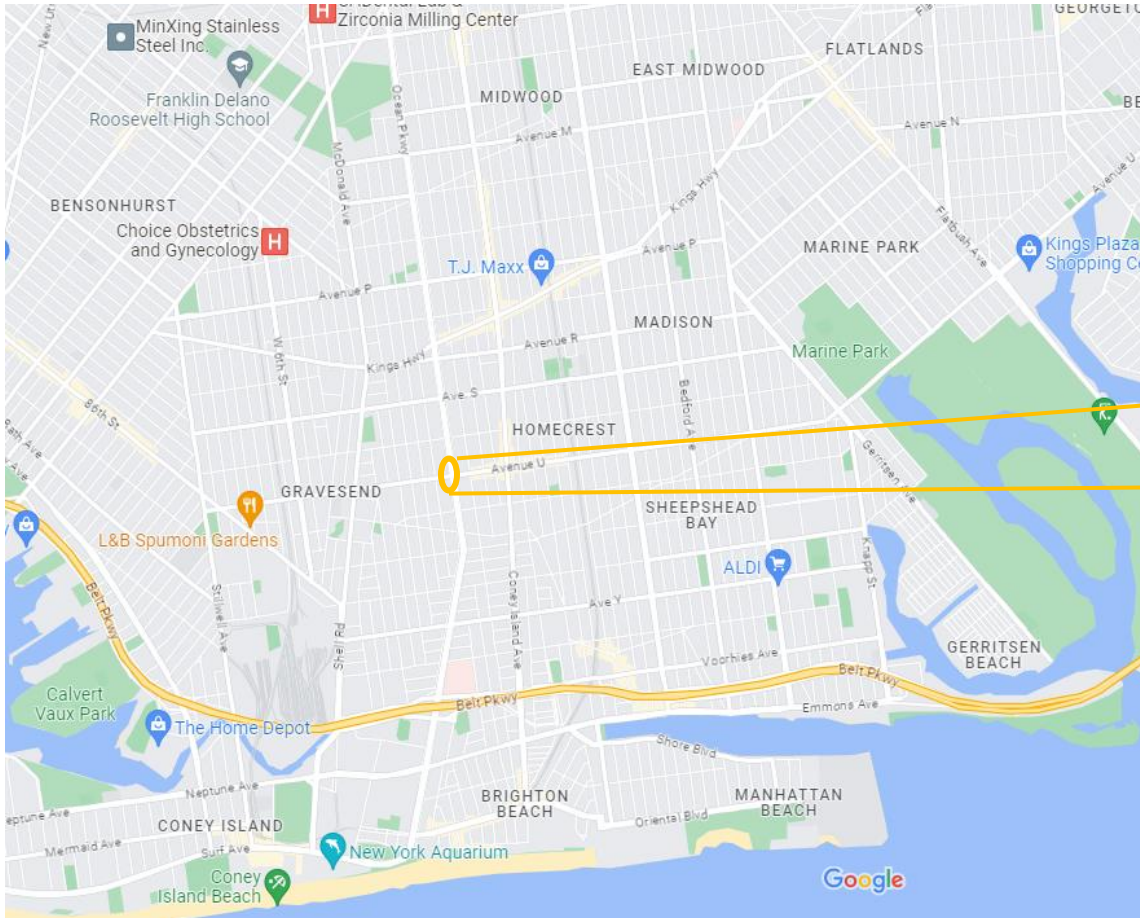

Gravesend/Sheepshead Bay



Avenue U and Ocean Parkway



Historic Site Photographs



1974

Est. Construction: 1913 - 1916



1978

Original Entrance
to the Pumping
Station

SOURCE

LPC Designation Photo Collection (Digital Archive)

<https://nyclandmarks.lunaimaging.com/luna/servlet>

Historic Site Photographs



Ocean Parkway South - 1974



Ocean Parkway North - 1974

Site Photographs



View northwest at air intake stack and flush hatches and vents on the median (May 2021)



Detail of flush hatches to station below (March 2025)

Site Photograph



Air vent stack destroyed in car accident on May 23, 2022.

Site Photographs



View northeast at the new synagogue and surrounding residential community (March 2025)



View east at the new synagogue and surrounding residential community (March 2025)

Proposed Work

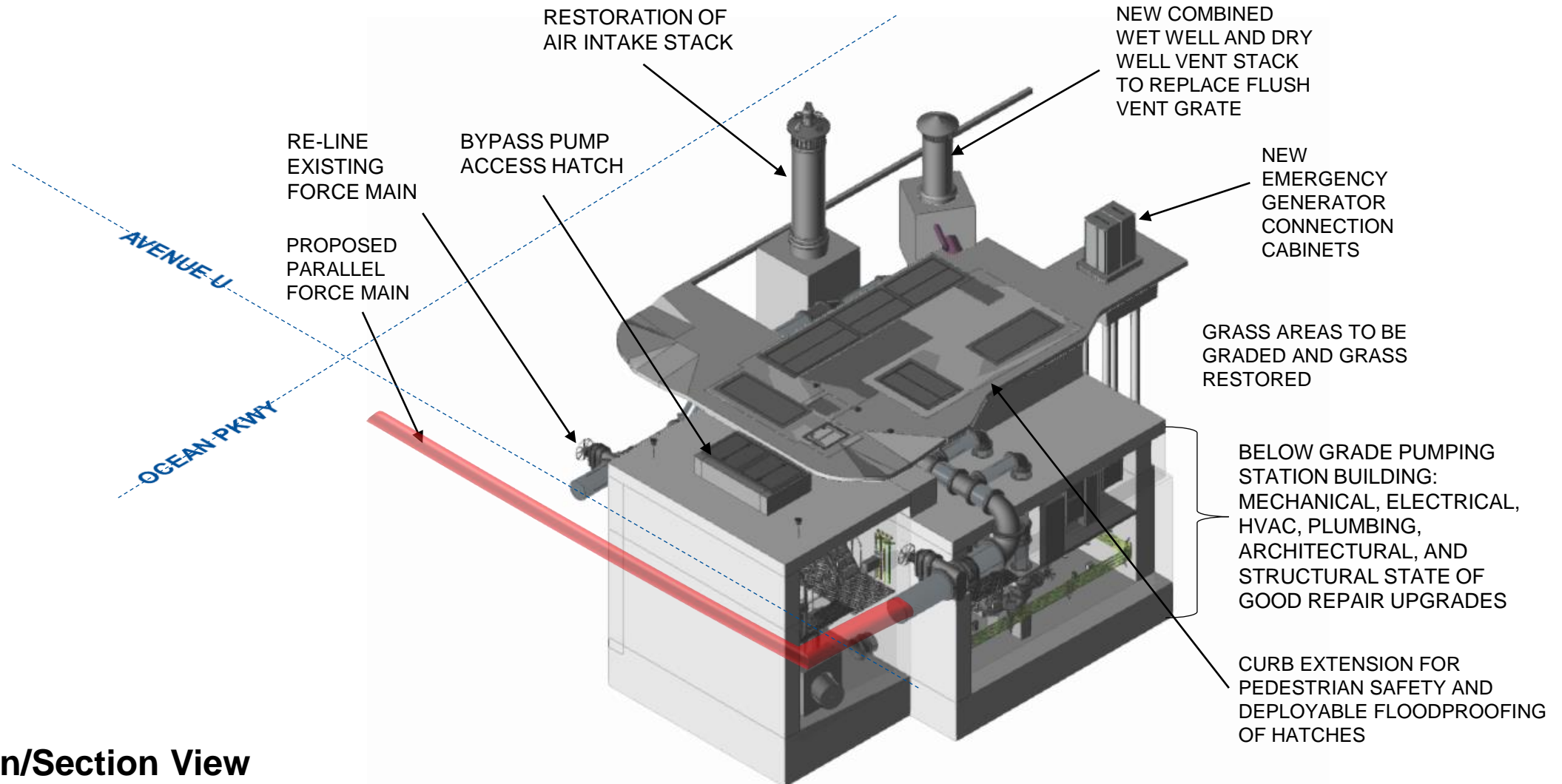

Axon/Section View

Plans

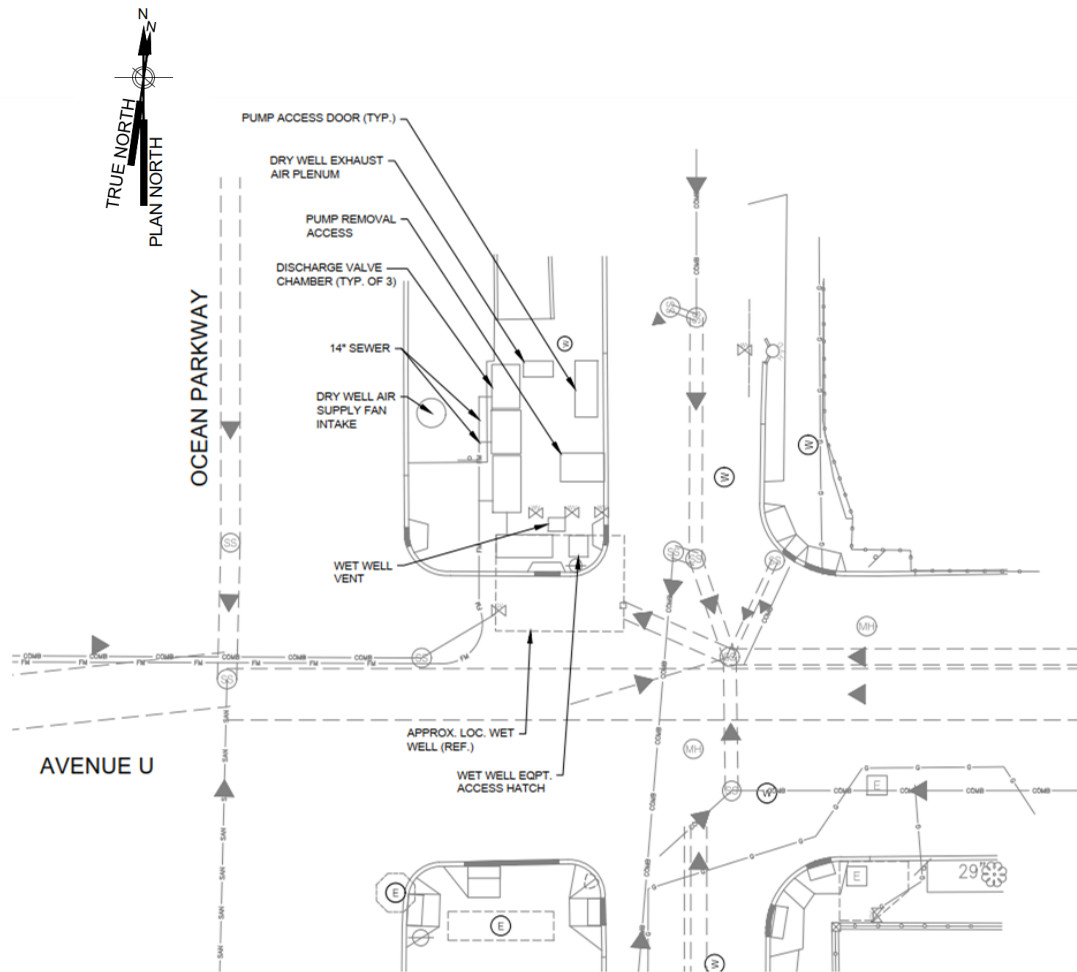

Existing Condition

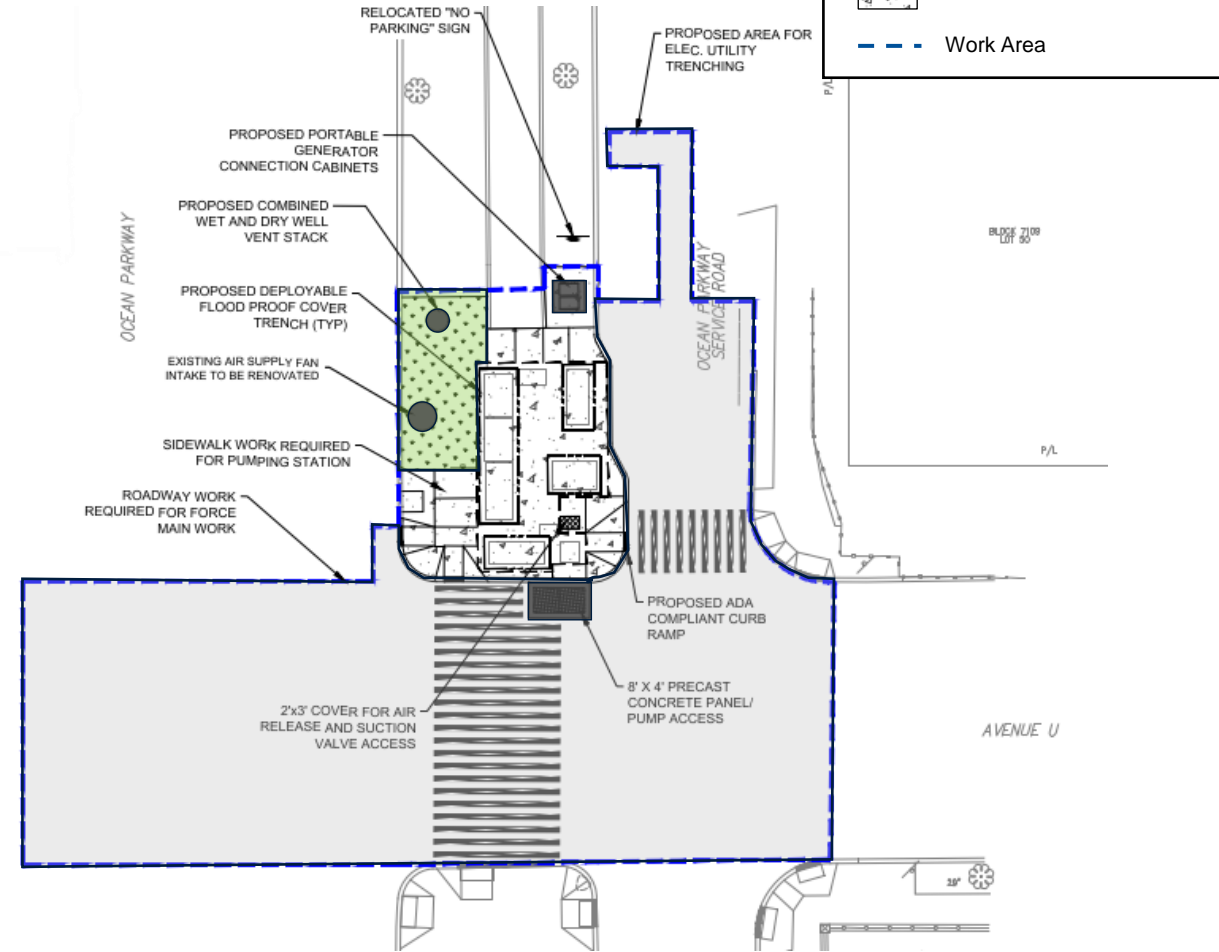

Proposed Condition

North Median



Existing Condition, Looking Northwest



Proposed Condition, Looking Northwest

Proposed Work

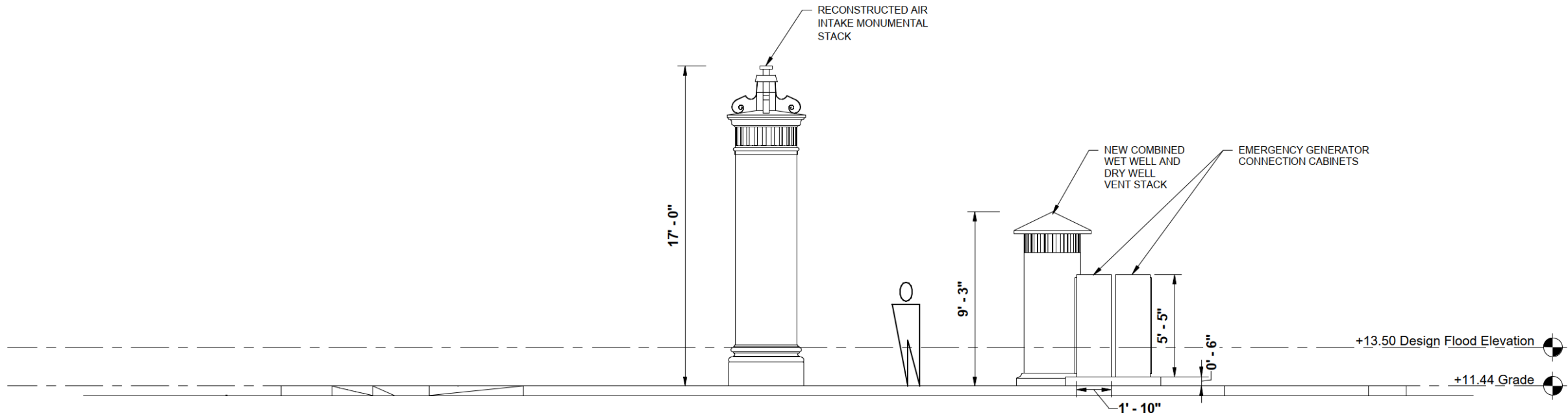

1

VIEW WEST ACROSS OCEAN PARKWAY SERVICE ROAD

SCALE: 1/4" = 1'-0"

Proposed West Elevation

Proposed Work

- Replicate the 1912 ornamental cast iron air intake stack, reusing salvaged crown.
- New 36" inner diameter ductile iron body with corrosion-preventing coating. The ornamental molding will be fiberglass.
- More economical and easier to replicate the molding with fiberglass than cast iron.

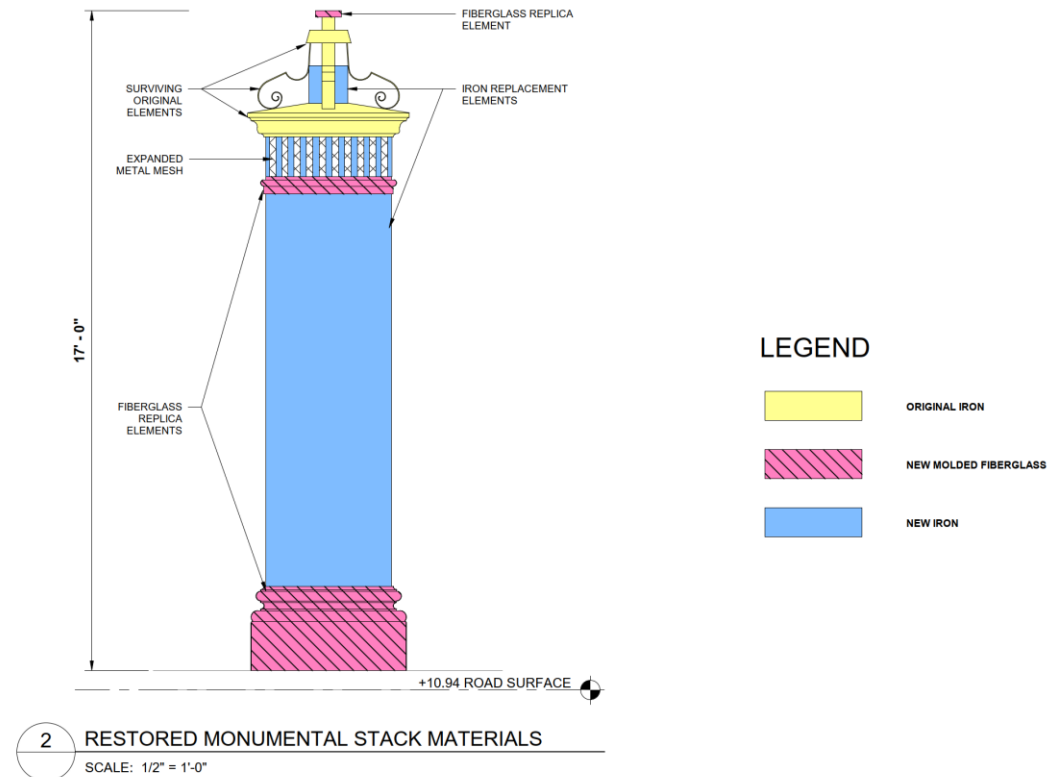
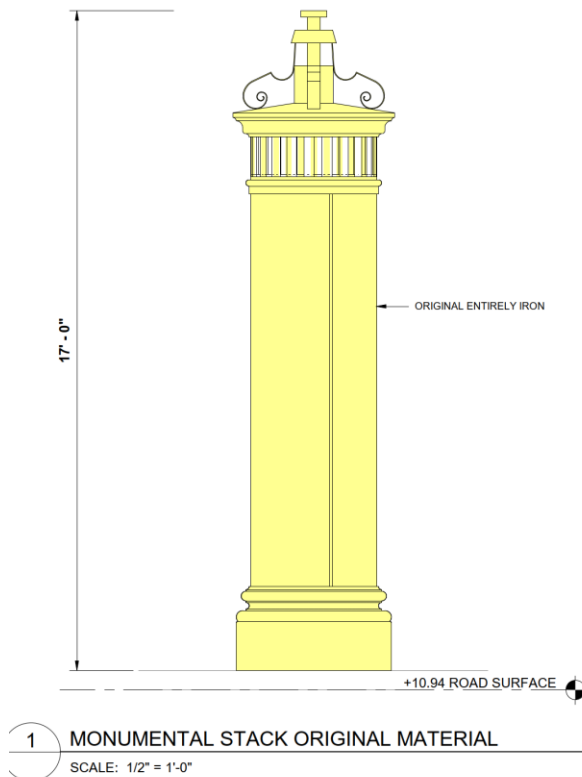

Proposed Work

1 Combined Vent Stack

- Simple, utilitarian style, 36" inner diameter ductile iron combined wet well and dry well vent stack.
- Expanded metal mesh screening material inside the stack to keep out birds and debris.

2 Generator Connection Cabinets

- Two emergency generator connection cabinets atop a 6" high concrete pad.
- Type 316 stainless steel, painted black. Each approximately 36" wide, 22" deep and 65" high.
- Each cabinet has a circuit breaker on the right section which feeds the MCCs inside the electrical room and Posi-lock connections to the portable generators on the right side.

3 CCTV camera on traffic light pole

- Monitor entrance access hatch and above grade features

1

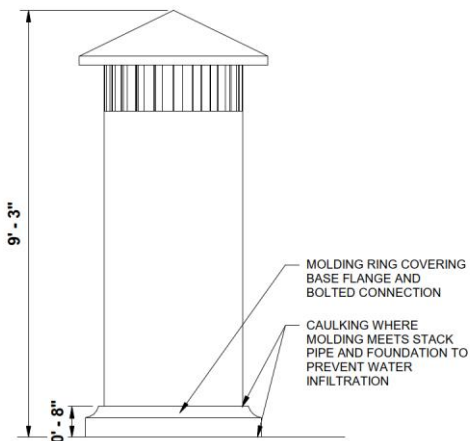

2

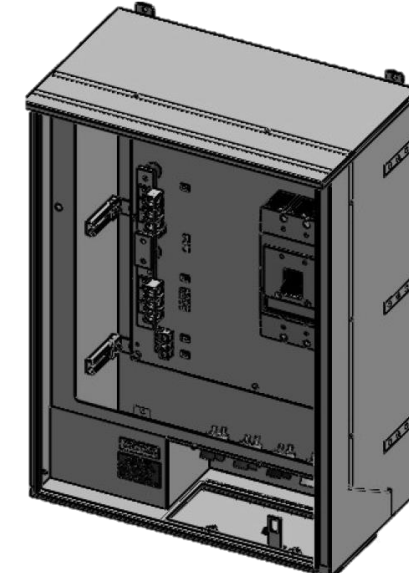
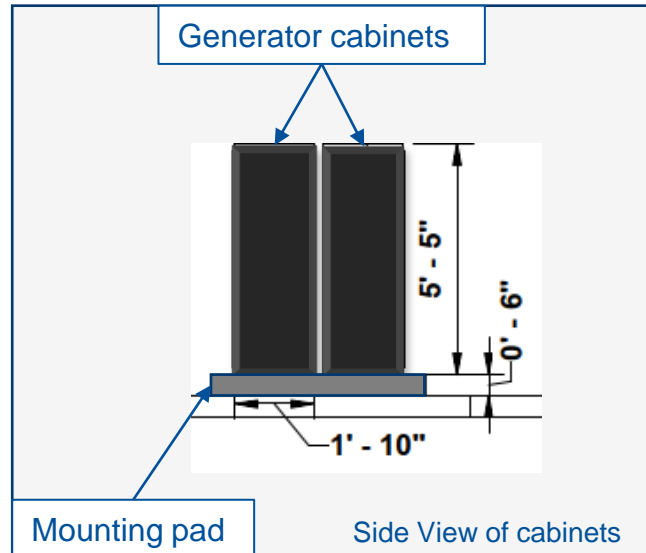

3



C1

COMBINED WET WELL AND DRY WELL VENT STACK

SCALE: 1/2" = 1'-0"



Q&A

NYC
Environmental
Protection

April 1, 2025
Public Hearing

The current proposal is:

Preservation Department – Item 4, LPC-25-04670

Ocean Parkway – Scenic Landmark Borough of Brooklyn

To testify virtually, please join Zoom

Webinar ID: 160 977 4343

Passcode: 525077

By Phone: 646-828-7666 (NY)

833-435-1820 (Toll-free)

833-568-8864 (Toll-free)

Note: If you want to testify virtually on an item, join the Zoom webinar at the agenda's "Be Here by" time (about an hour in advance). When the Chair indicates it's time to testify, "raise your hand" via the Zoom app if you want to speak (*9 on the phone). Those who signed up in advance will be called first.

APPENDICES

Plans

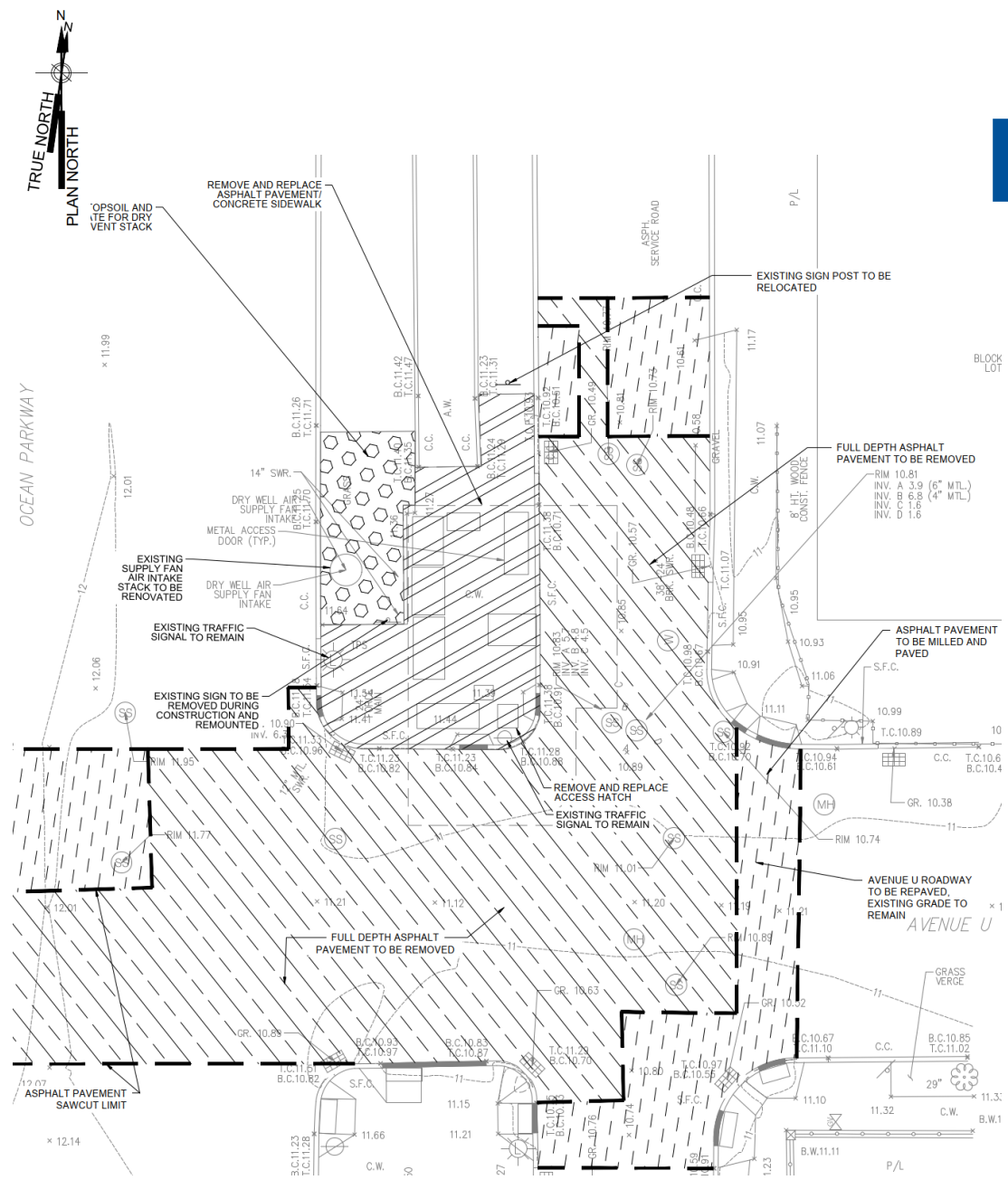

Demolition – Proposed Work

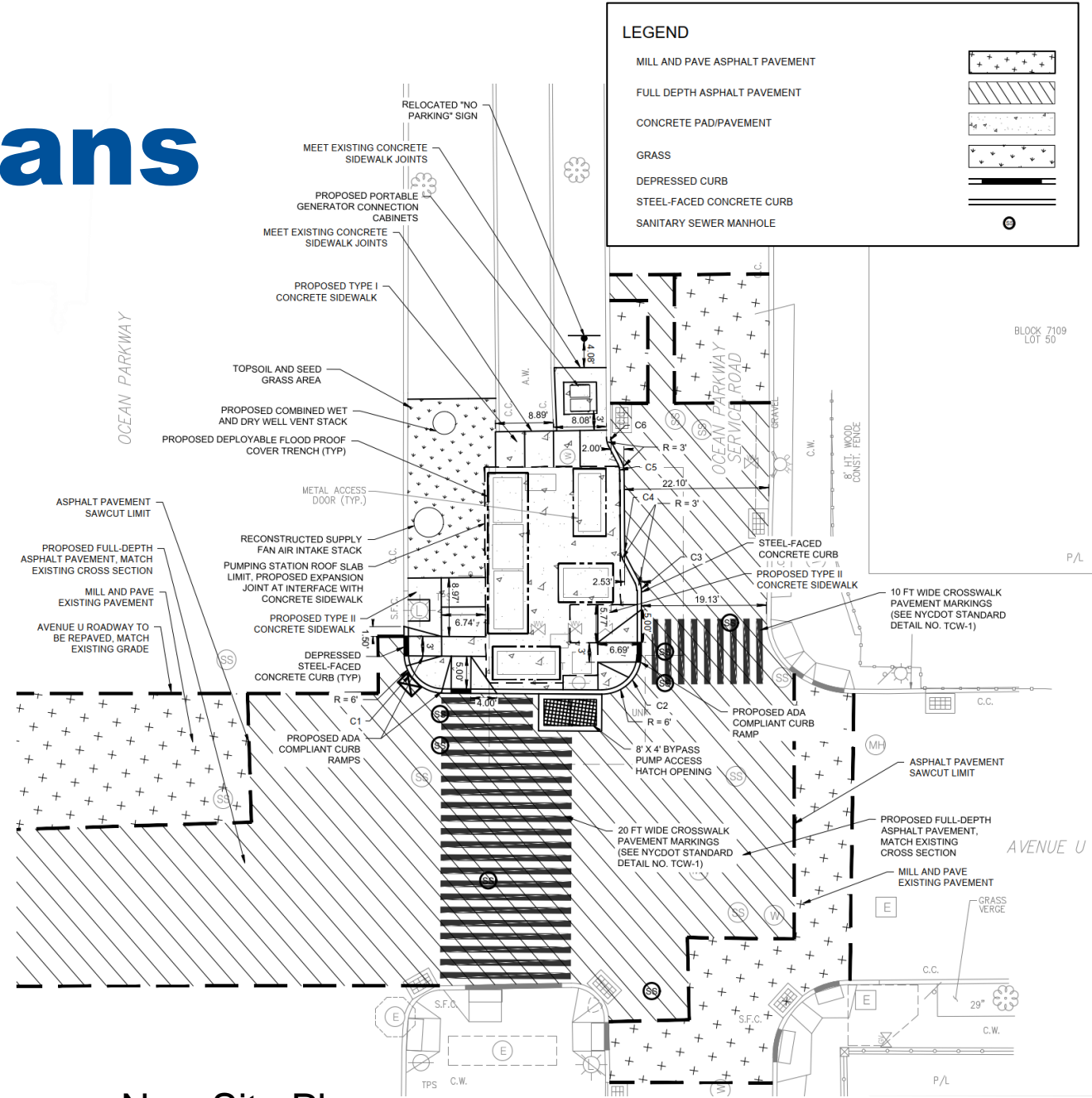

New Site Plan

LEGEND

- MILL AND PAVE ASPHALT PAVEMENT
- FULL DEPTH ASPHALT PAVEMENT
- CONCRETE PAD/PAVEMENT
- GRASS
- DEPRESSED CURB
- STEEL-FACED CONCRETE CURB
- SANITARY SEWER MANHOLE

Curb Extension Examples



Curb Extension Examples



Curb Extension Examples

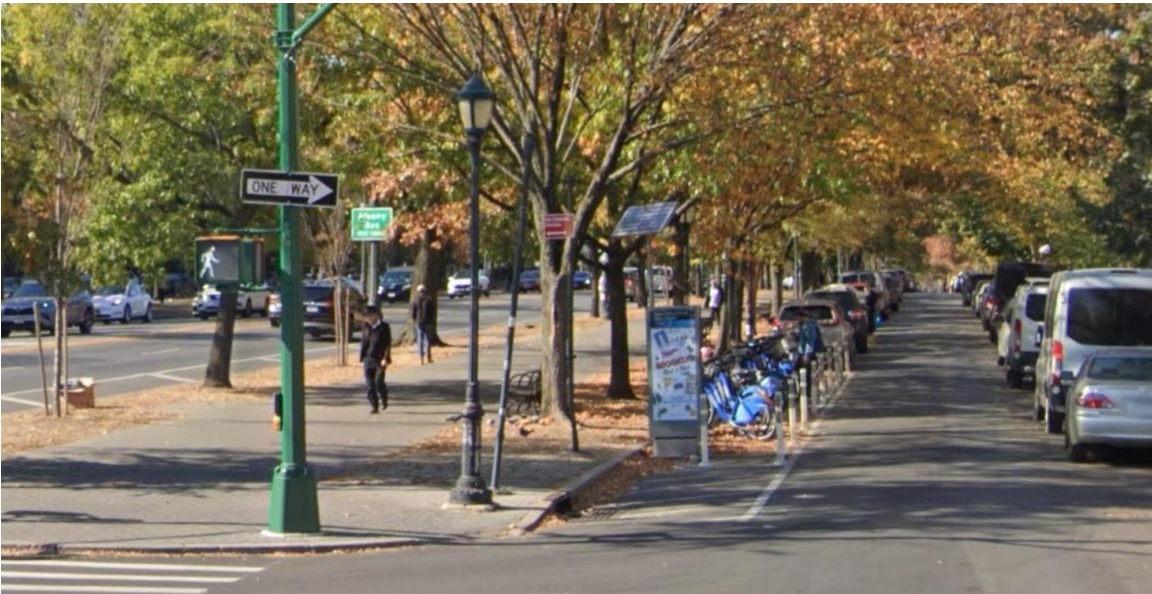

April 1, 2025
Public Hearing

The current proposal is:

Preservation Department – Item 4, LPC-25-04670

Ocean Parkway – Scenic Landmark Borough of Brooklyn

To testify virtually, please join Zoom

Webinar ID: 160 977 4343

Passcode: 525077

By Phone: 646-828-7666 (NY)

833-435-1820 (Toll-free)

833-568-8864 (Toll-free)

Note: If you want to testify virtually on an item, join the Zoom webinar at the agenda's "Be Here by" time (about an hour in advance). When the Chair indicates it's time to testify, "raise your hand" via the Zoom app if you want to speak (*9 on the phone). Those who signed up in advance will be called first.