

June 11, 2024  
Public Hearing

The current proposal is:

**Preservation Department – Item 3, LPC-24-10137**

**Soldiers' and Sailors' Monument, Riverside Park – Scenic  
Landmark  
Borough of Manhattan**

To testify virtually, please join Zoom

**Webinar ID:** 864 7055 3741

**Passcode:** 412825

By Phone: 1 646-558-8656 US (New  
York) 877-853-5257 (Toll free) US  
888 475 4499 (Toll free)

**Note:** If you want to testify virtually on an item, join the Zoom webinar at the agenda's "Be Here by" time (about an hour in advance). When the Chair indicates it's time to testify, "raise your hand" via the Zoom app if you want to speak (\*9 on the phone). Those who signed up in advance will be called first.



Parks

# Soldiers & Sailors Monument Reconstruction

## Project M071-323M

Located at Riverside Drive & W89<sup>th</sup> Street  
in the Borough of Manhattan

### Landmarks Preservation Commission Review

June 11, 2024

WXY architecture + urban design

NYC Parks

**Total Budget:** \$62.3M (Mayoral)  
FY 2023

**Project Size:** 25,000SF



# Project Goals

- The complete restoration of the Soldiers & Sailors Monument, its surrounding terraces, and all associated structures.
- ADA compliant accessibility to all exterior levels of the monument.\*

\*The monument's interior will remain inaccessible to all public.



NYC Parks

W X Y

abb

LERA  
1923  
2023  
100

 **McLaren**  
ENGINEERING GROUP

**Soldiers & Sailors Monument Reconstruction**  
**Riverside Park | Project Goals**





**Borough:** Manhattan



**Neighborhood:** Upper West Side | CB7

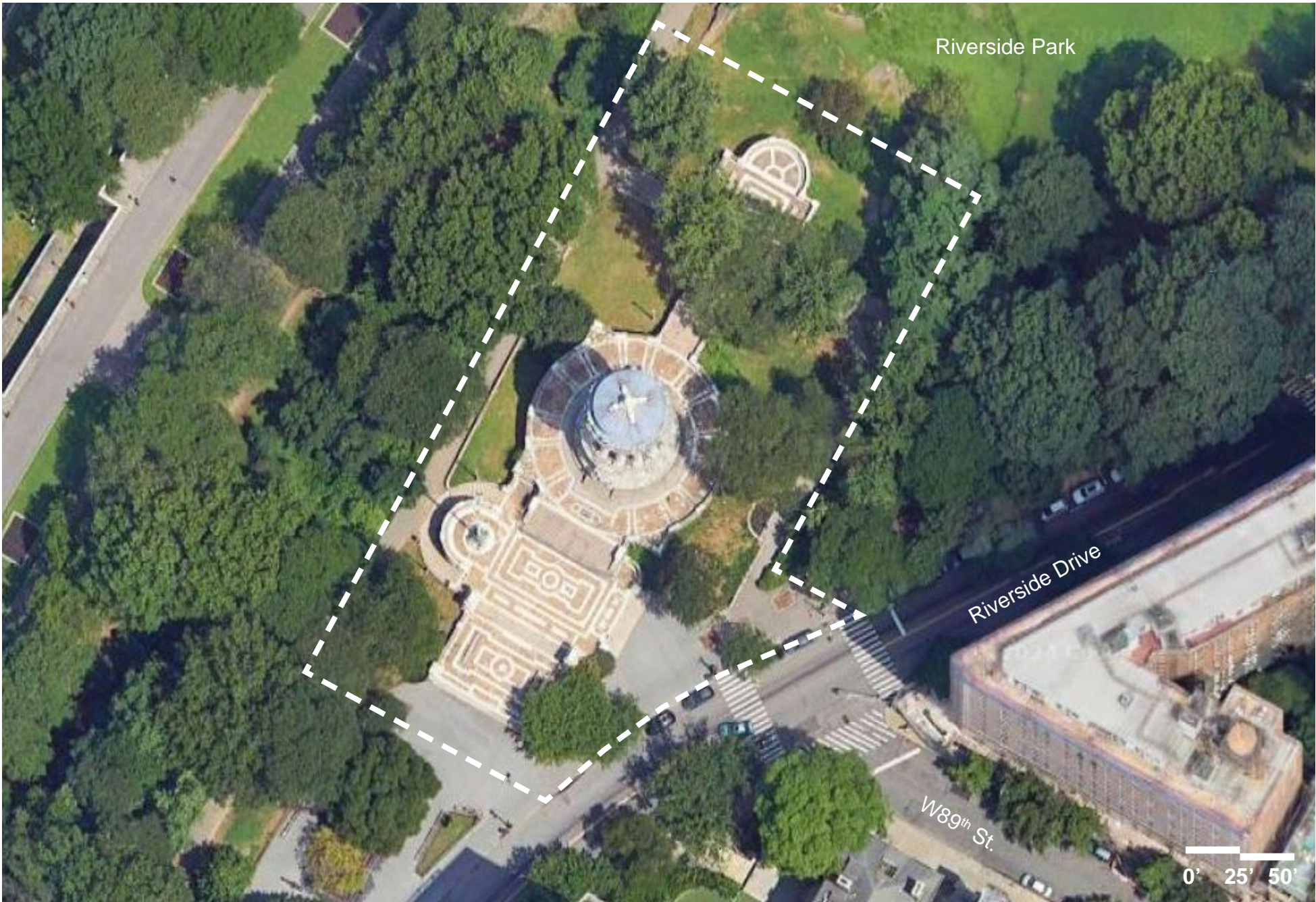

**Site:** Riverside Park



NYC Parks



# **Soldiers & Sailors Monument Reconstruction** **Riverside Park | Project Location**







1— Approaching the Monument from the South along Riverside Drive, c. 1935

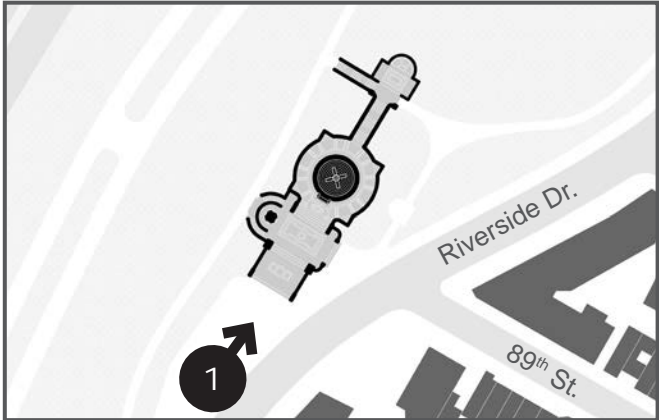

Photo Key



NYC Parks

W X Y

abb

LER  
1923  
2023  
100

MCLaren  
ENGINEERING GROUP

Soldiers & Sailors Monument Reconstruction  
Riverside Park | Historical Views





1— Aerial view from west, c. 1934

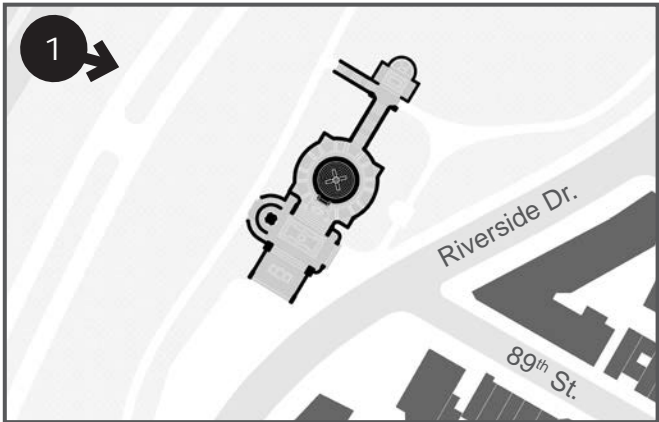

Photo Key



NYC Parks

W X Y

abb

LER A  
1923 100  
2023

MCLaren  
ENGINEERING GROUP

# Soldiers & Sailors Monument Reconstruction

## Riverside Park | Historical Views







1— View from he South Plaza, 1911



2— View from South Plaza, 2024

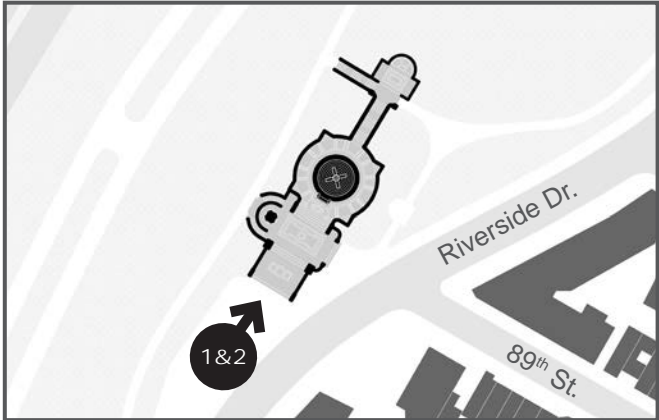

Photo Key



NYC Parks

W X Y

abb

LER A  
1923  
2023  
100

MCLaren  
ENGINEERING GROUP

# **Soldiers & Sailors Monument Reconstruction** **Riverside Park | Site Photos: Historic & Existing**



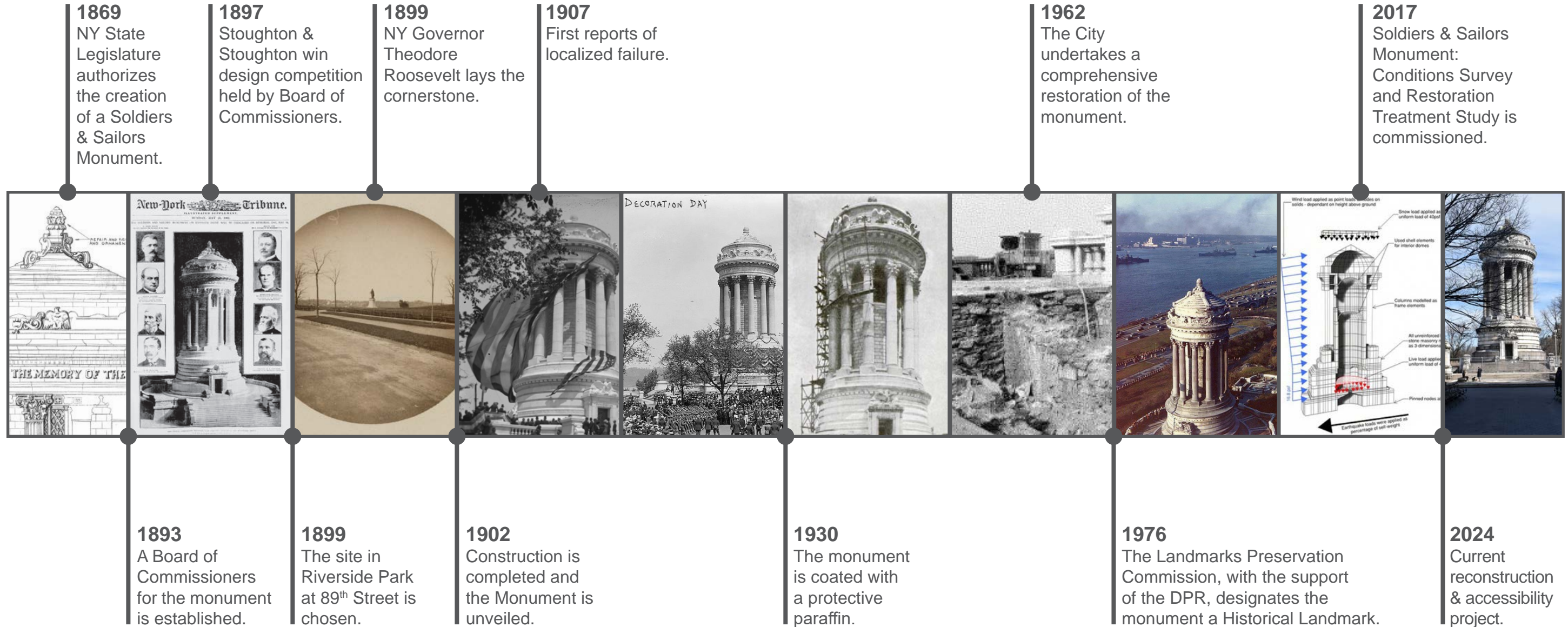

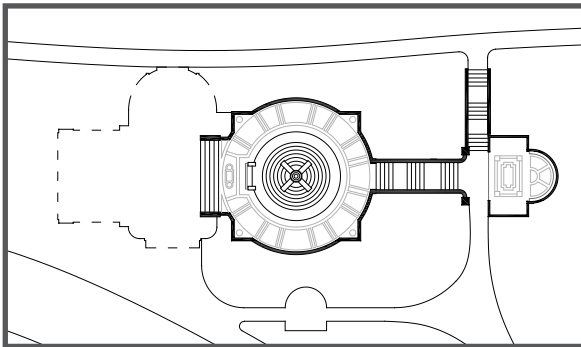

**1902**  
The Monument is opened shortly before the Upper & Lower Terraces are completed.

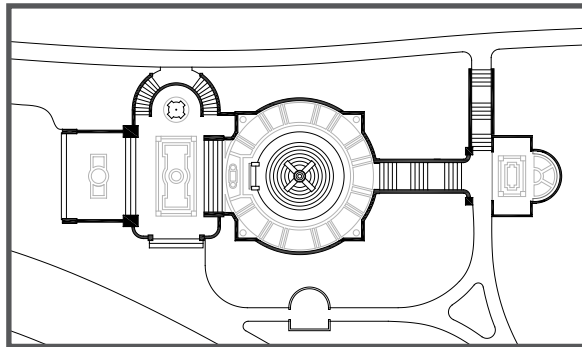

**1902**  
The Upper & Lower Terraces are completed.

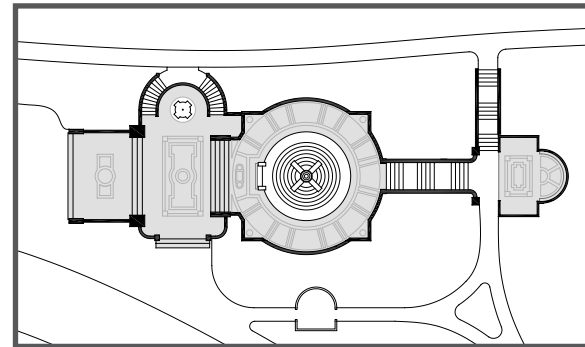

**1935**  
Original brick pavers are replaced with concrete.

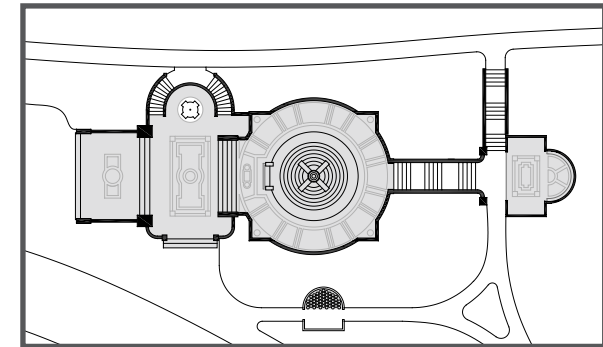
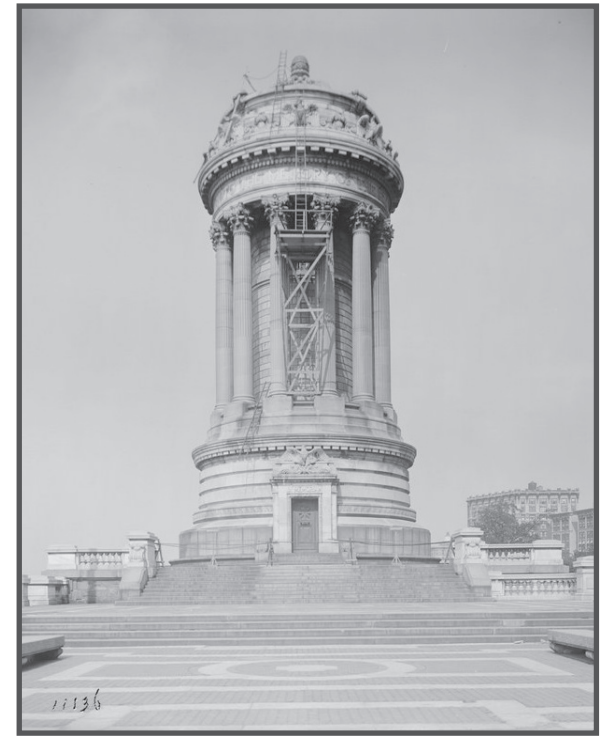

**1962**  
Last major restoration campaign—the terraces are repaved with Crab Orchard sandstone, balustrades are replaced, cannon balls are relocated, the side is regraded, and the flagpole is replaced.





**Terrace Reconstruction & Repaving**

- Rebuild sub-grade assembly
- Install new drainage
- Reset & replace existing materials



**Tower Exterior Repair**

- Remediate deteriorated mortar & masonry joints
- Repair & replace roofing and flashing
- Repair & restore corroded metal elements

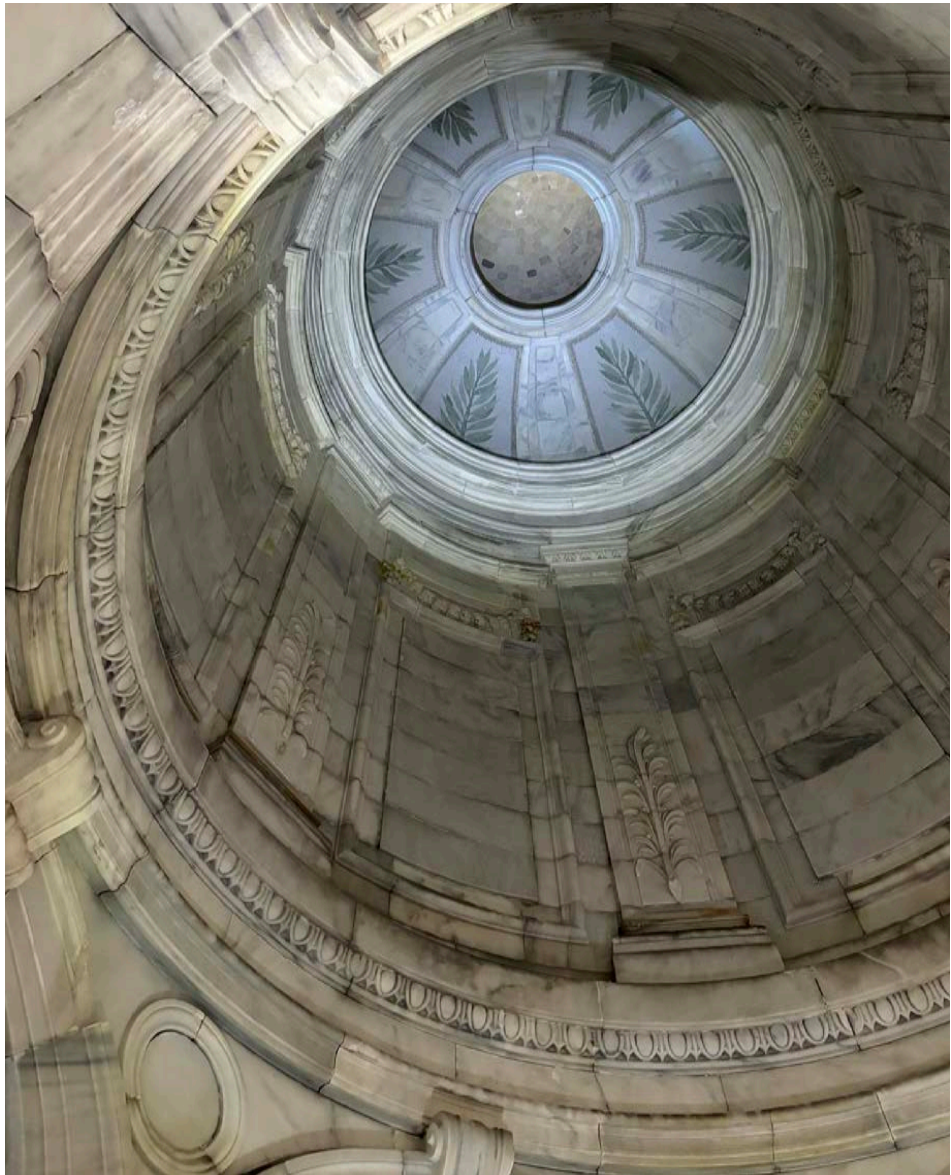

**Tower Interior Repair**

- Remediate deteriorated mortar & masonry joints
- Repair and restore mosaic tile floor
- Repair & restore corroded metal elements



NYC Parks

W X Y

abb

LERA  
1923  
2023  
100



# **Soldiers & Sailors Monument Reconstruction** **Riverside Park | Scope of Restoration**



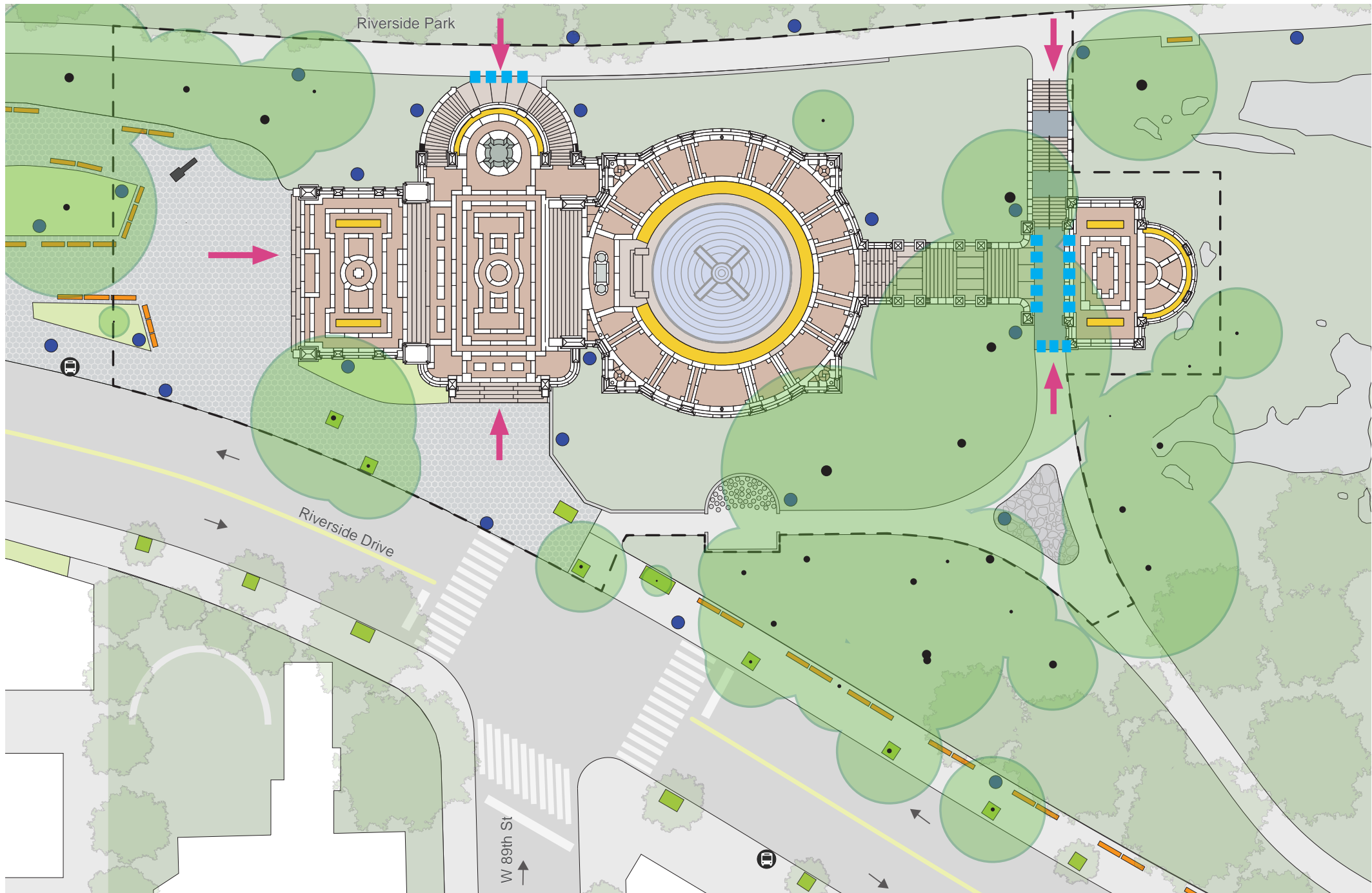

# Legend

- Project Limit
- Monument Access
- Tripping Hazard
- Existing Trees
- Open Lawn Area
- Rock Outcropping
- Tree pits
- Bluestone Pavers
- Planted Beds
- Asphalt Pavement
- Hexagonal Paver
- Granite Stairs
- Cobblestone
- Crab Orchard Pavers
- Marble Paving Bands
- Bronze Tablets
- Granite Benches
- Site Benches
- Cannon
- Cannonballs
- Lamp Posts
- Bus Stops



NYC Parks

W X Y

abb

LERA  
1923  
2023  
100



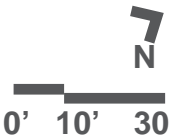

MCLaren  
ENGINEERING GROUP

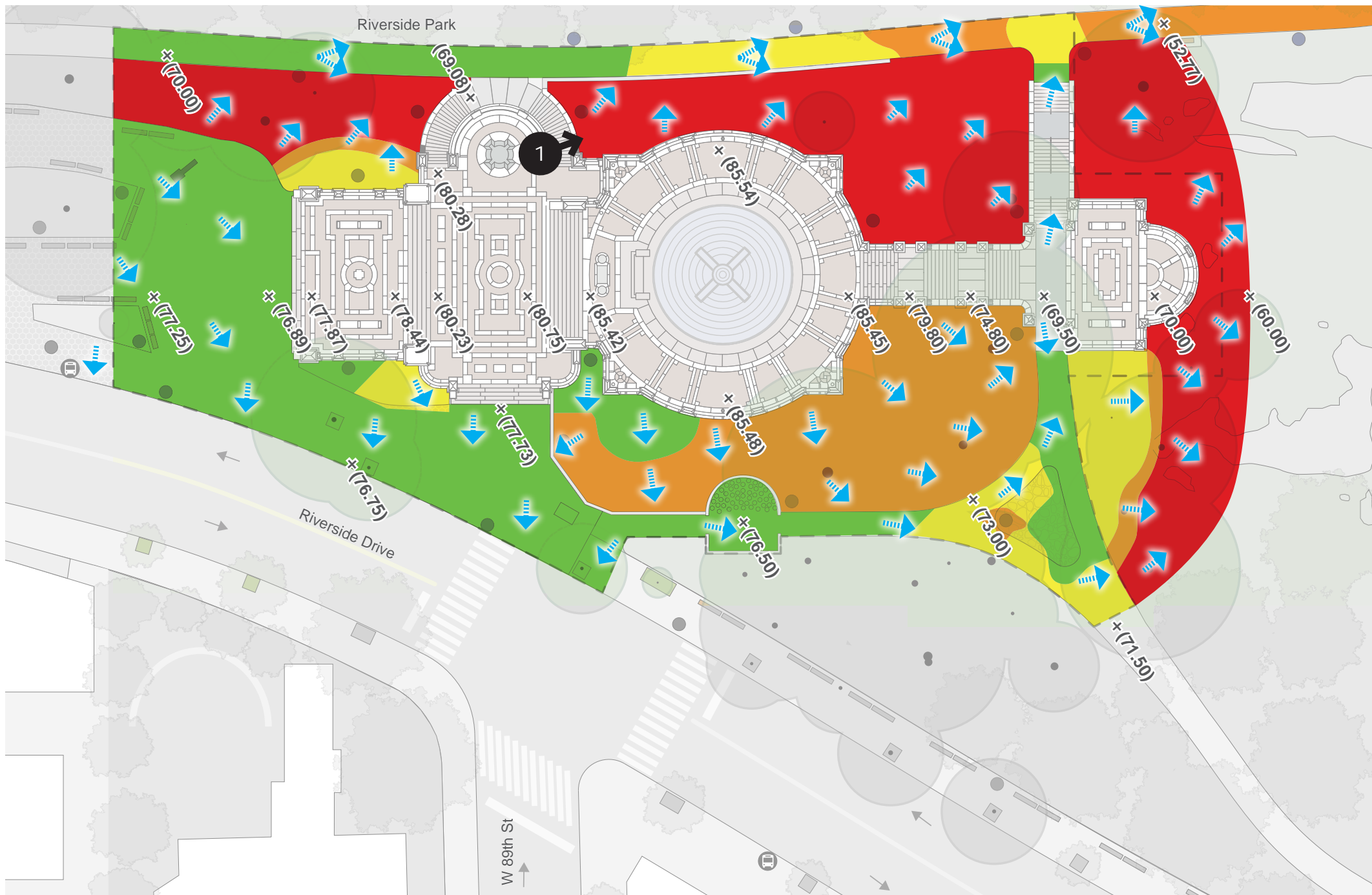
## Soldiers & Sailors Monument Reconstruction Riverside Park | Existing Conditions: Site





## Legend

- Project Limit
-  Stormwater Surface Flow
- x(60.00) Existing Spot Grade
-  Low Slopes  
≤5%
-  Moderate Slopes  
≥5%-10%
-  Steep Slopes  
≥10%-15%
-  Severe Slopes  
≥15%



Steep slopes on the west side of the monument



NYC Parks

W X Y

abb

LER A  
1923 100  
2023

MCLaren  
ENGINEERING GROUP

## Soldiers & Sailors Monument Reconstruction Riverside Park | Site Analysis - Slope Analysis

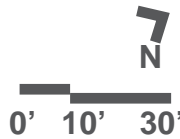



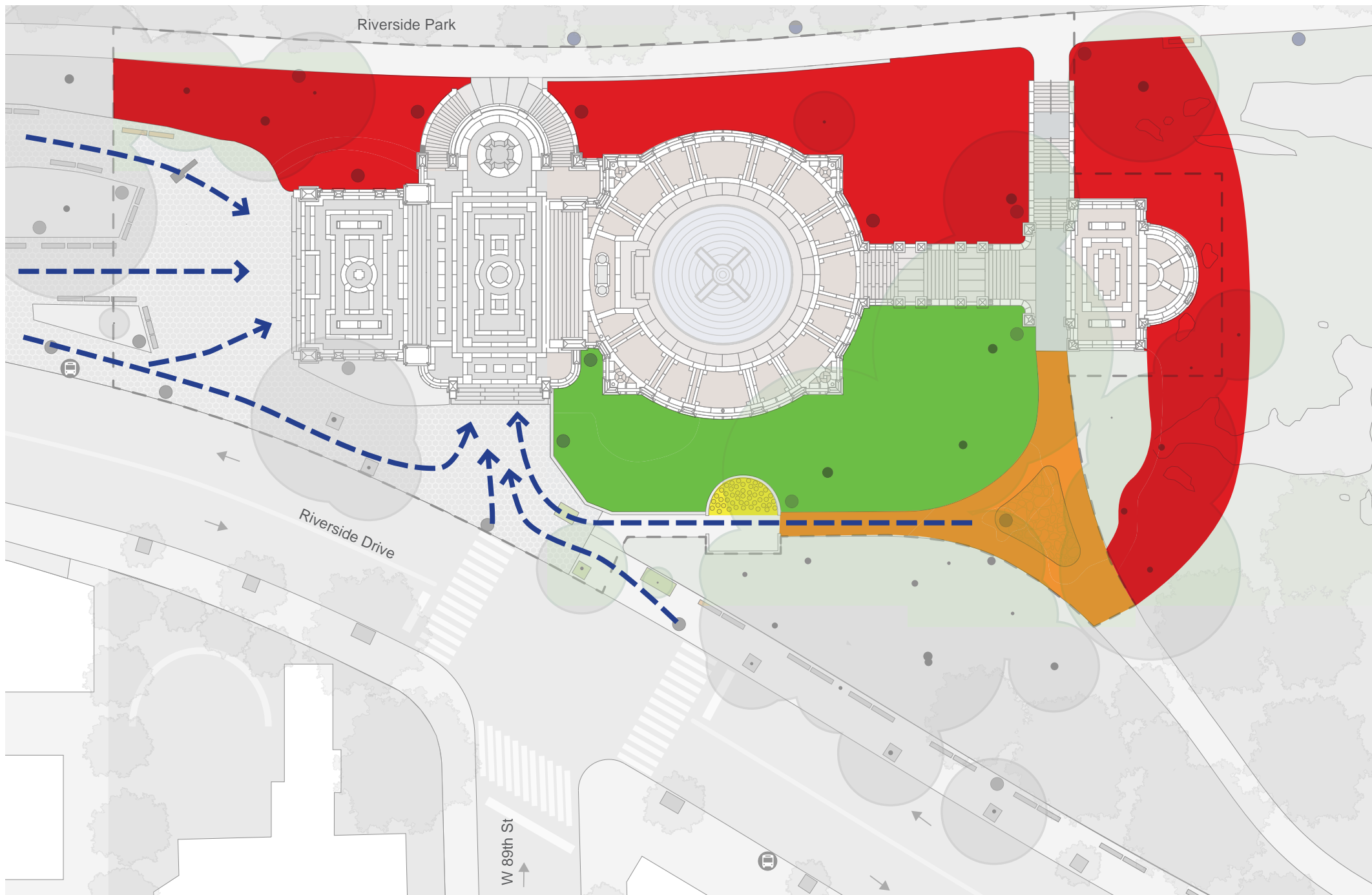

# Legend

- Project Limit
- Typical Site Approaches
- Site Area with Potential for Programming
- Cannonballs
- Regrading Recommended for Universal Access
- Soil Stabilization Recommended



NYC Parks

W X Y

abb

LERA  
1923  
2023  
100

MCLaren  
ENGINEERING GROUP

## Soldiers & Sailors Monument Reconstruction Riverside Park | Site Analysis

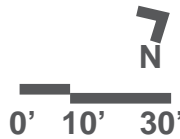



## Legend

- Project Limit
- ||||| Vegetative Screening
- ↗ ↖ Vistas
- Stormwater Ponding
- Open Landscape
- Major Critical Root Zones to Avoid
- Pavement in Poor Condition
- Empty Tree Pits



NYC Parks

W X Y

abb

LER A  
1923 100  
2023

MCLaren  
ENGINEERING GROUP

## Soldiers & Sailors Monument Reconstruction Riverside Park | Site Analysis - Surface Conditions

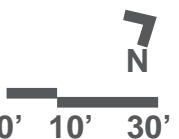

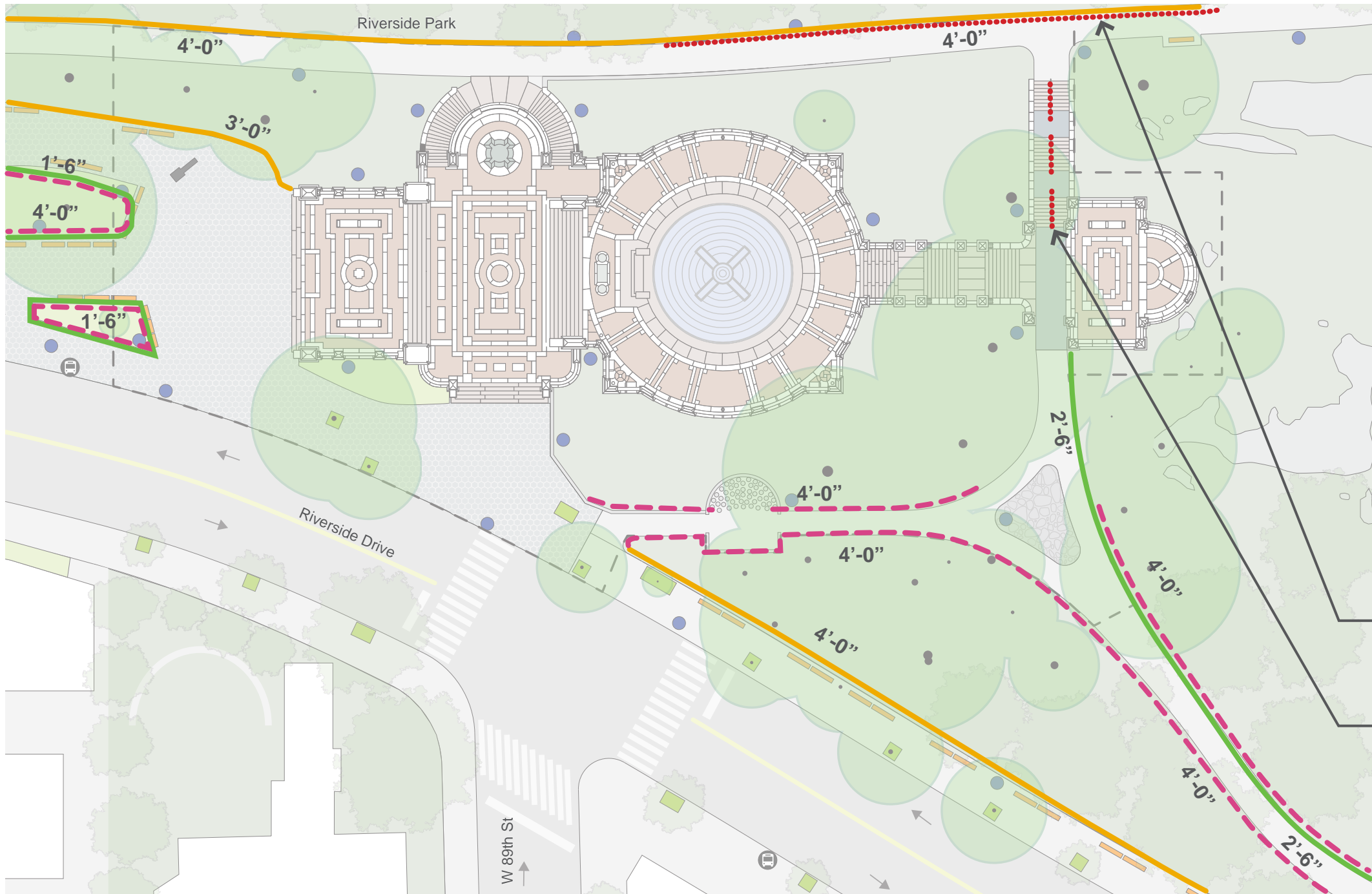

- ### Legend
- MEDIUM FENCES**  
FENCES 4' - 7'-6" HT. (x = HEIGHT)  
x' Steel
  - LOW FENCES**  
FENCES 2'-6" - 3'-6" HT. (x = HEIGHT)  
x' Steel
  - TEMPORARY RANGE FENCES**  
FENCES 4'-0" HT. (x = HEIGHT)  
x' Steel
  - HANDRAILS**  
TYPICAL HEIGHT, 2'-10"  
STEEL



## Soldiers & Sailors Monument Reconstruction Riverside Park | Existing Fence Diagram

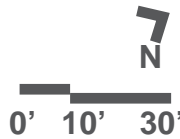





- Legend**
- Project Limit
  - Orange dashed rectangle Addition to Monument
  - Blue dashed rectangle Monument Terrace
  - Dark blue arrow Traditional Route Through Monument
  - Green arrow New Accessible Route Through Monument



W X Y

abb

LERA  
1923  
2023 100

MCLaren  
ENGINEERING GROUP

# **Soldiers & Sailors Monument Reconstruction** **Riverside Park | Schematic Design**

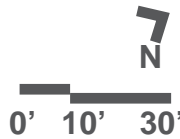

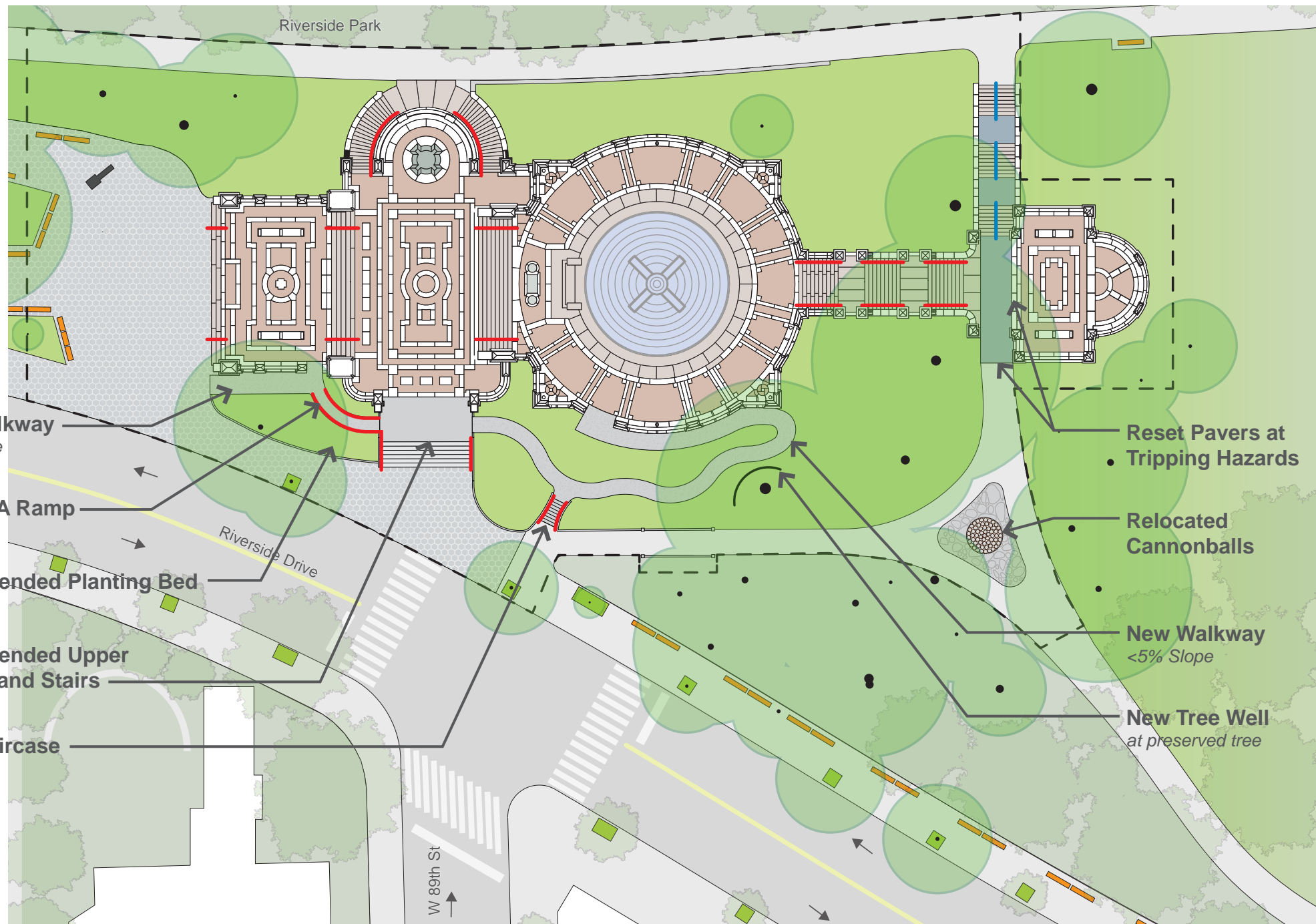

## Legend

- Project Limit
- Existing Trees
- Rock Outcropping
- Planted Beds
- Existing Asphalt Pavement
- Existing Hexagonal Paver
- New Bluestone Pavers
- New Brick Pavers
- Existing Marble Paving Bands
- Existing Bronze Tablets
- Existing Cannon
- Existing Cobblestone
- Relocated Cannonballs
- New Granite Terrace Extension
- New Walkways / Ramps
- New Handrail Locations
- Handrails to be Replaced for Code Compliance



NYC Parks

W X Y

abb

LER A  
1923 100  
2023

MCLaren  
ENGINEERING GROUP

## Soldiers & Sailors Monument Reconstruction Riverside Park | Proposed Plan - Site

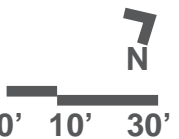

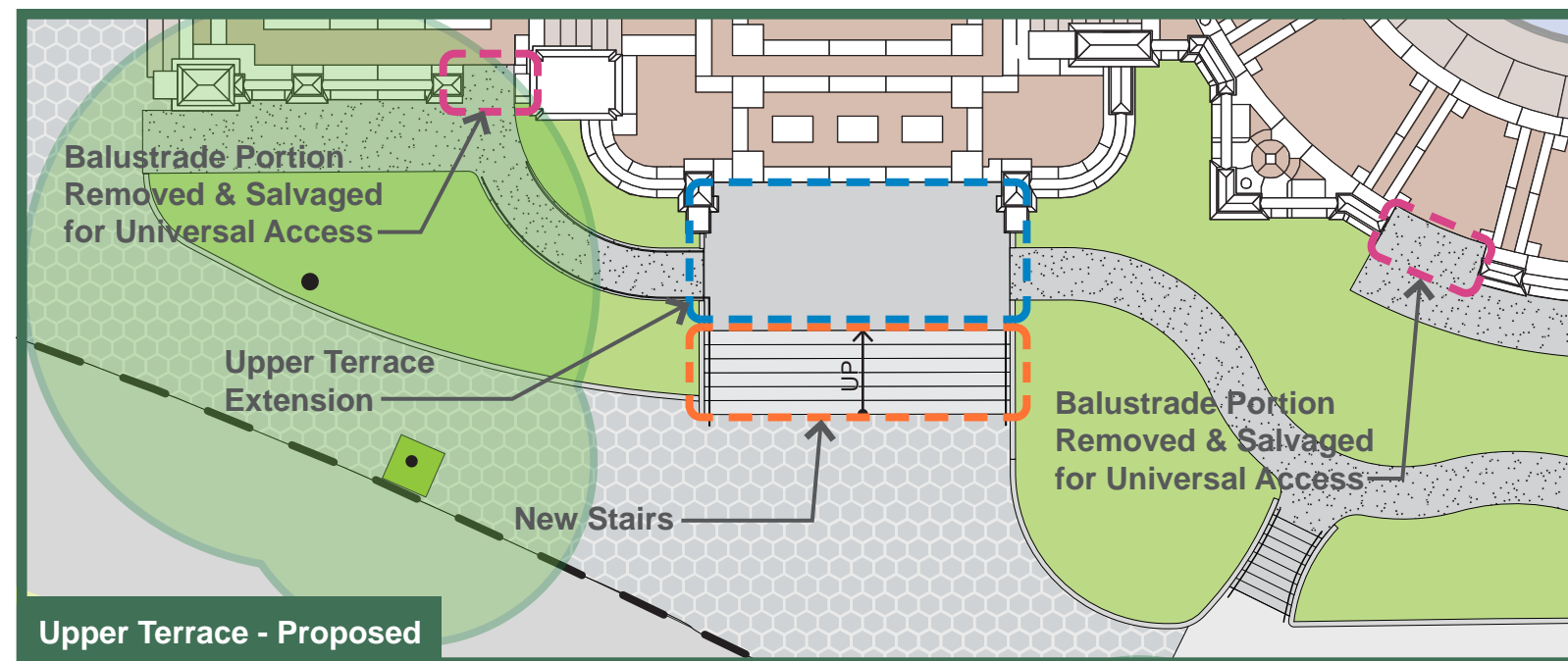
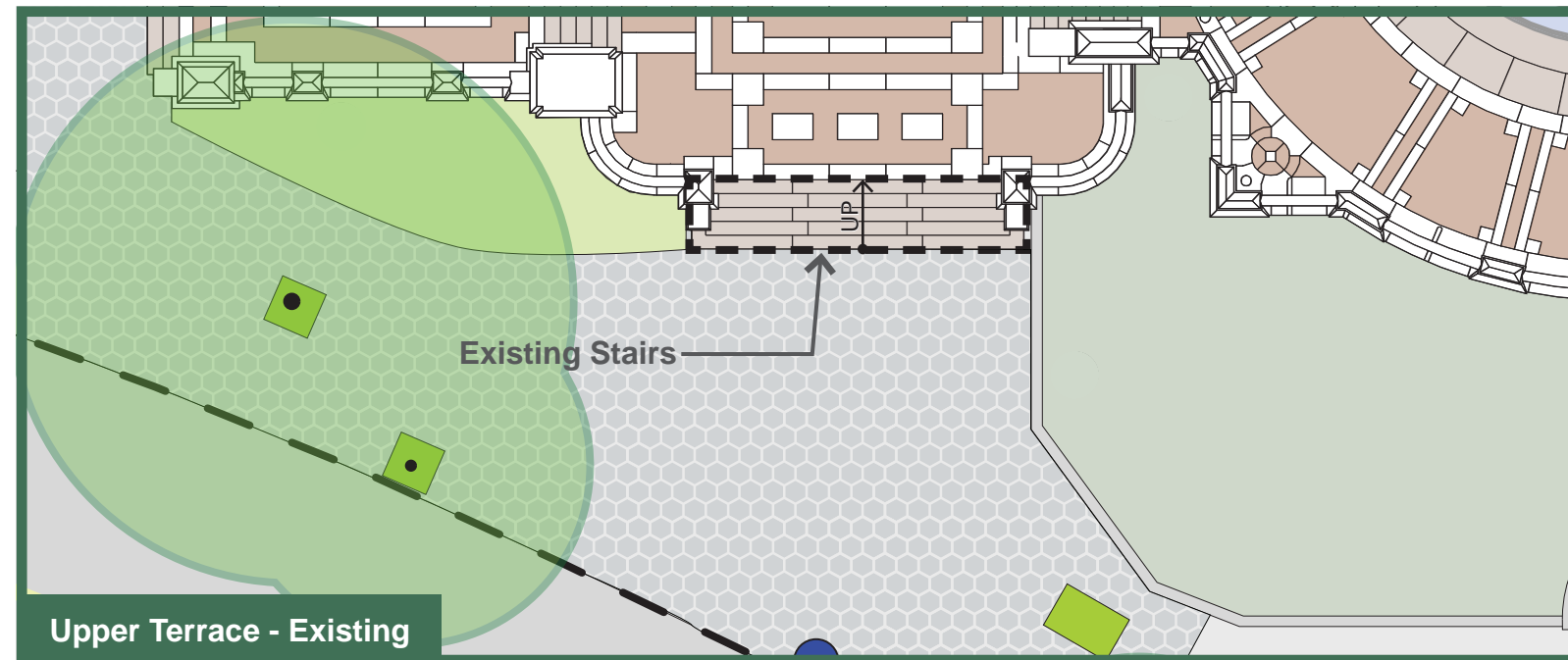



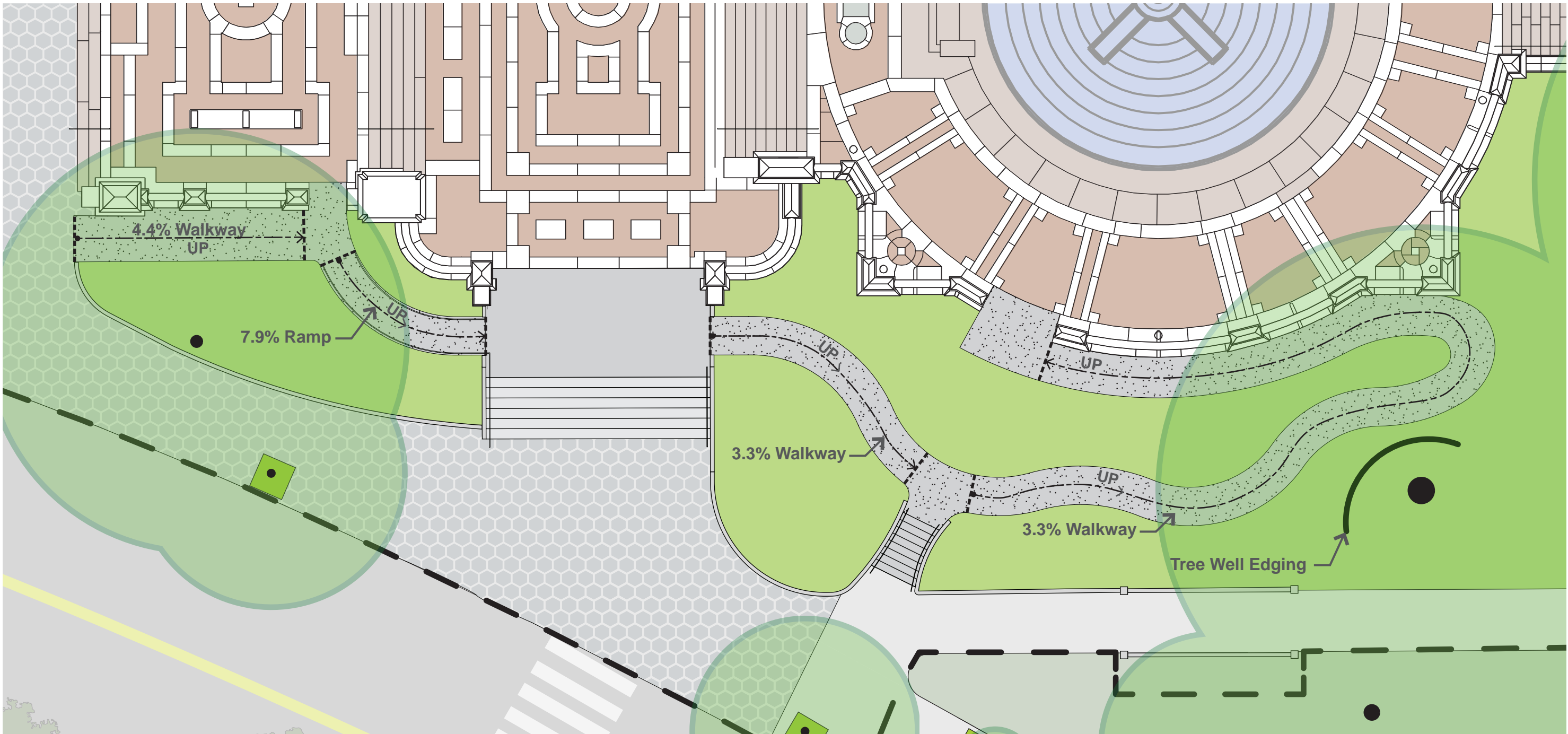

NYC Parks

W X Y

abb

LER A  
1923 100  
2023

MCLaren  
ENGINEERING GROUP

## Soldiers & Sailors Monument Reconstruction Riverside Park | Site Plan: Garden Walkway

7  
N

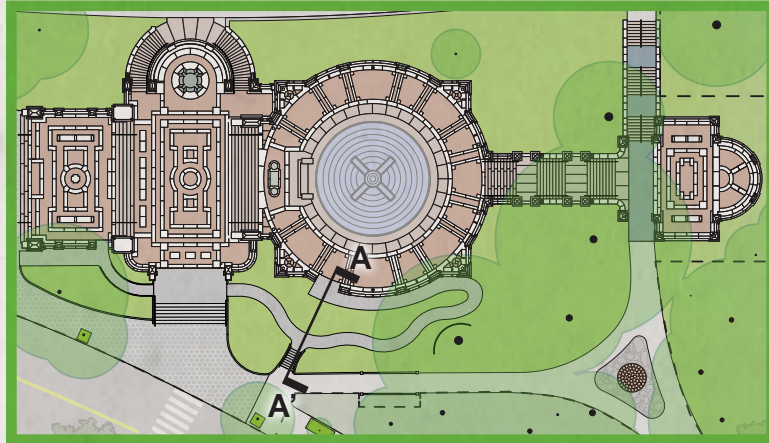

KEY PLAN

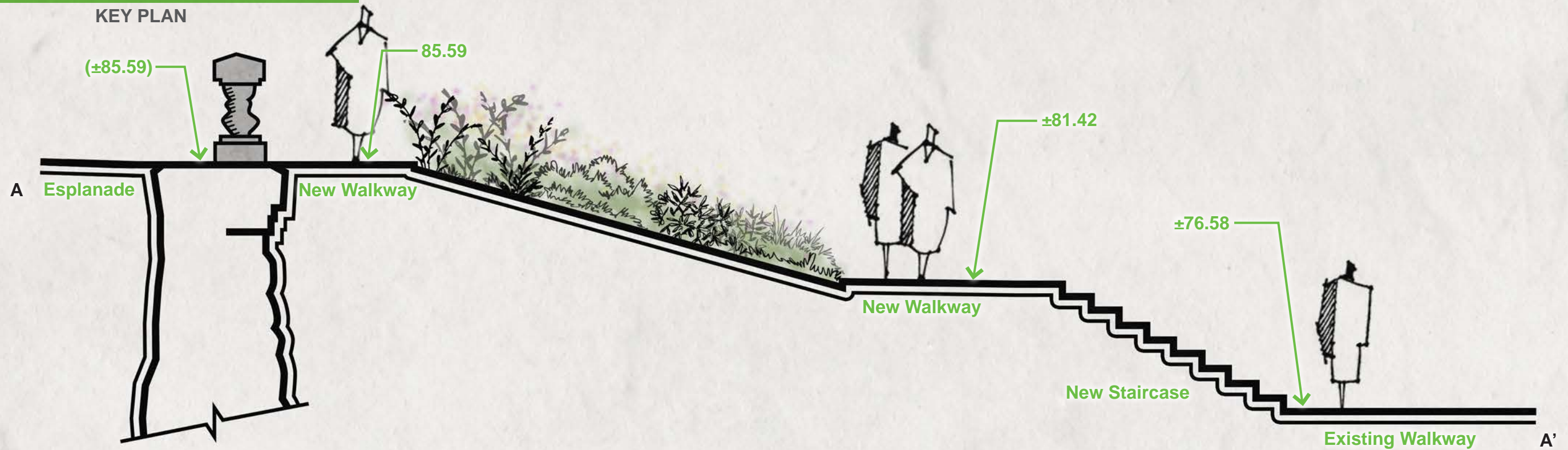

Note: All planted areas max slope 1:3  
All walkways shall be less than 5%



NYC Parks

W X Y

abb

LER A  
1923  
2023  
100

MCLaren  
ENGINEERING GROUP

## Soldiers & Sailors Monument Reconstruction Riverside Park | Garden Walkway: Section A-A'



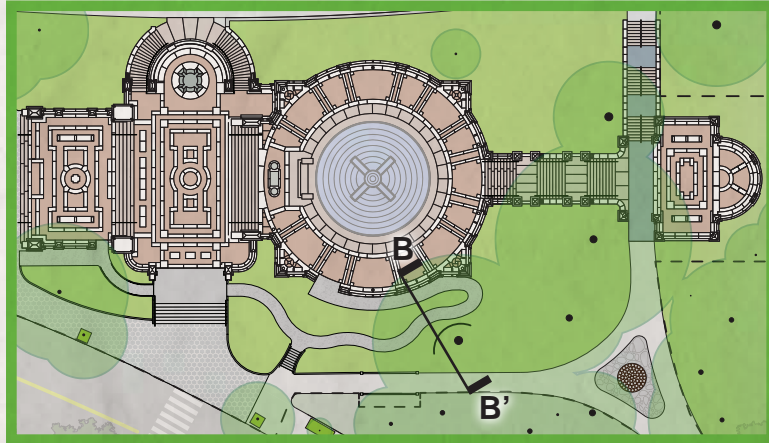

KEY PLAN

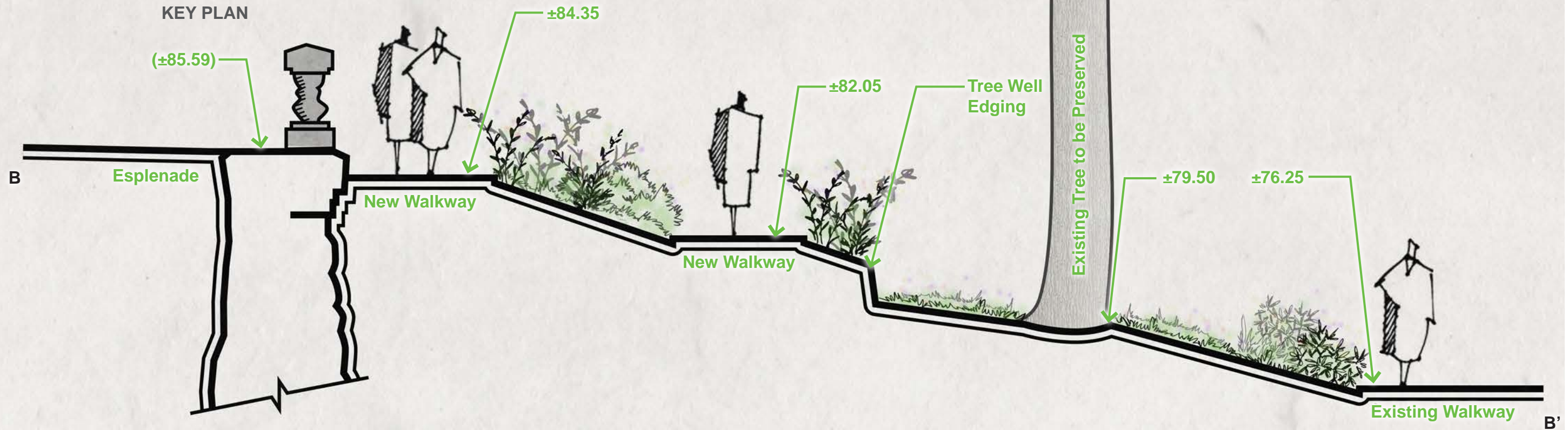

Note: All planted areas max slope 1:3  
All walkways shall be less than 5%



NYC Parks

W X Y

abb

LER A  
1923  
2023  
100

MCLaren  
ENGINEERING GROUP

**Soldiers & Sailors Monument Reconstruction**  
**Riverside Park | Garden Walkway: Section B-B'**





1962 Balustrade components to be removed and salvaged for use where needed in monument restoration

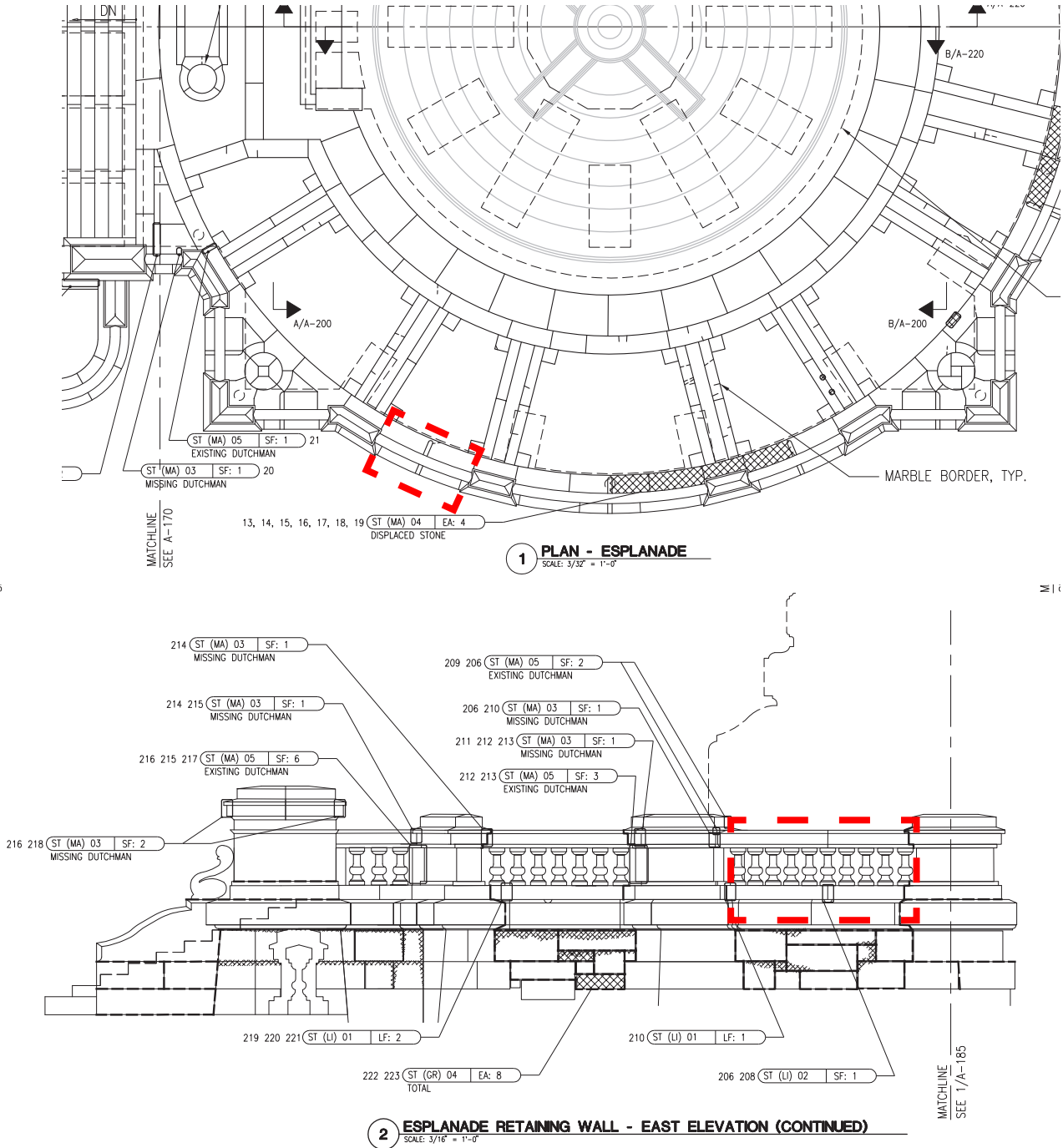

W X Y

abb

LER A  
1923  
2023  
100

MCLaren  
ENGINEERING GROUP

# Soldiers & Sailors Monument Reconstruction

## Riverside Park | Garden Walkway: Balustrade Impact at Upper Terrace









1962 Balustrade components to be removed and salvaged for use where needed in monument restoration

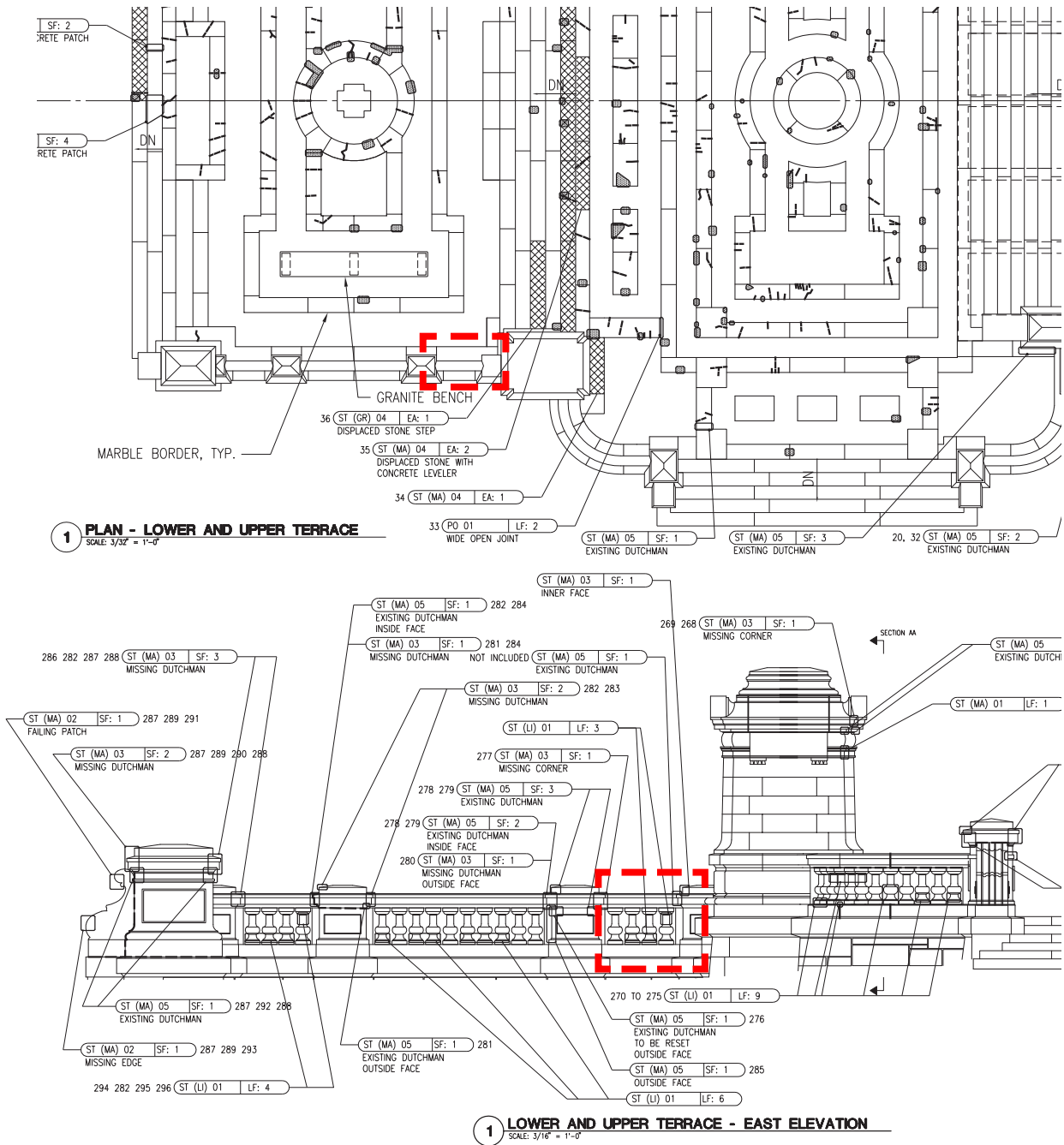







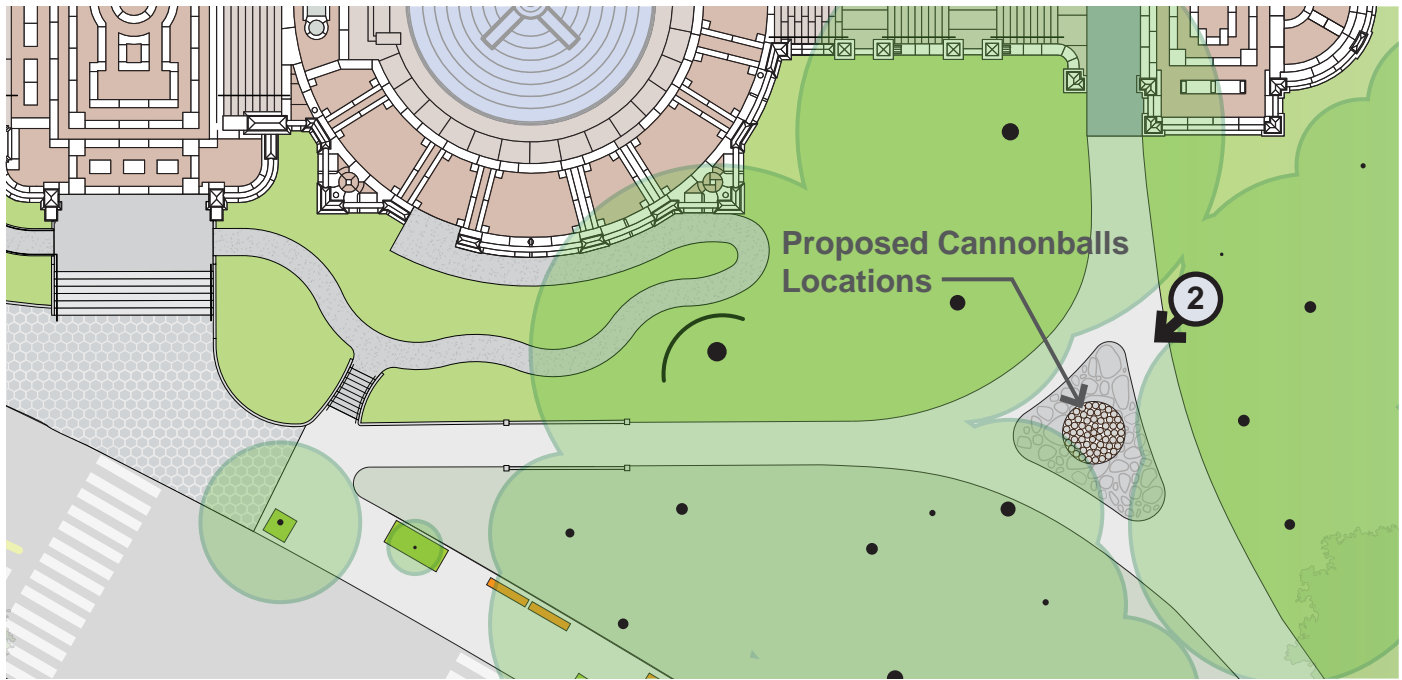
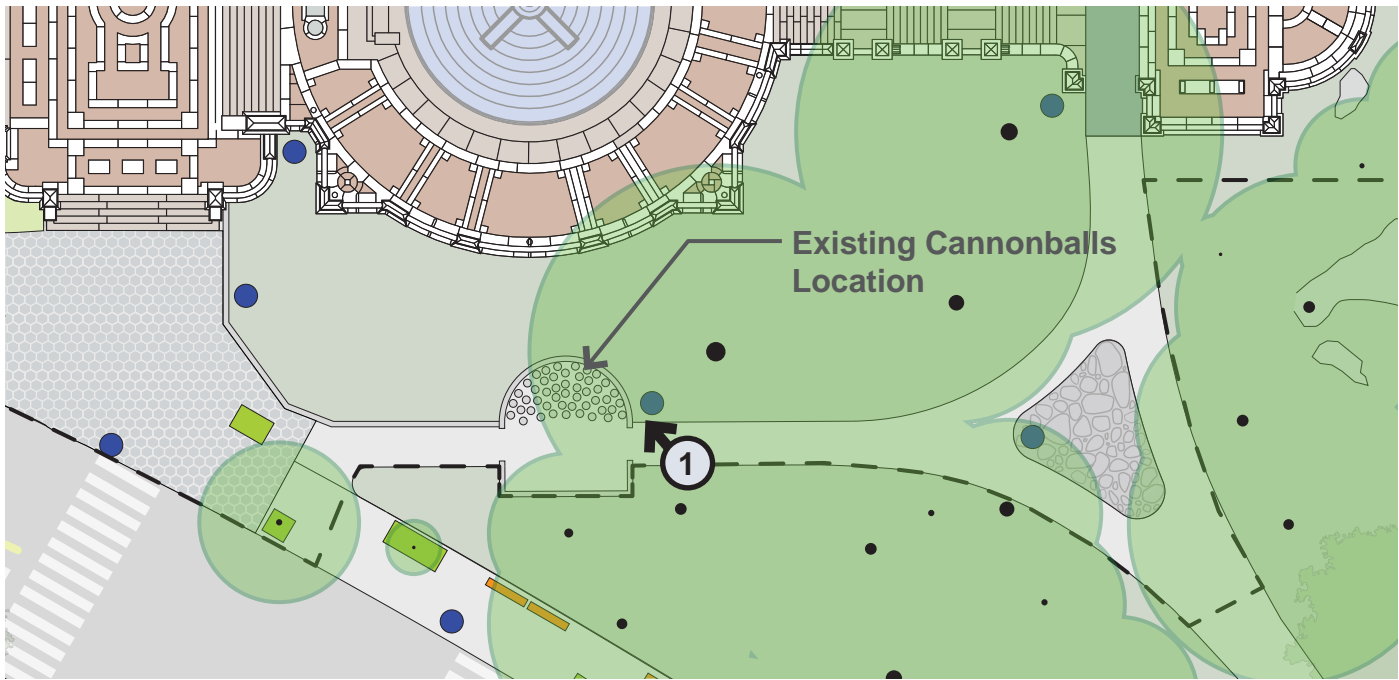

Existing Condition

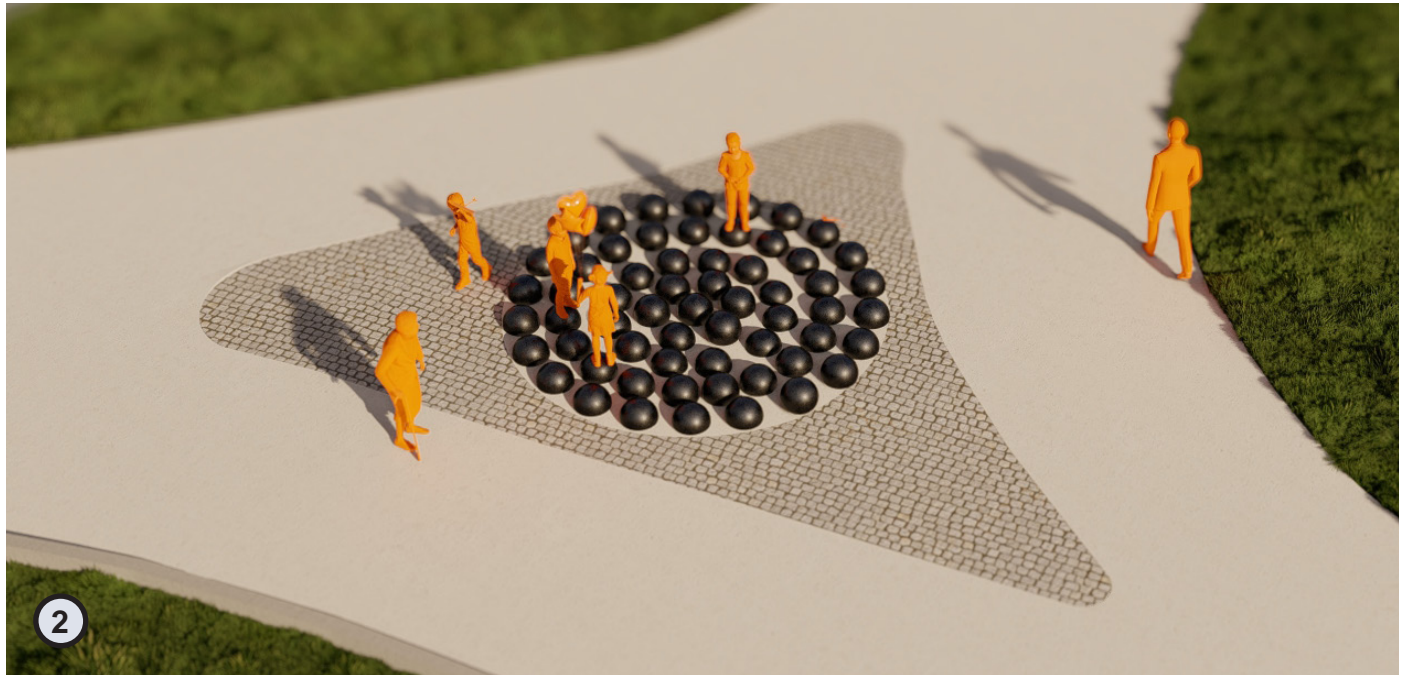

Proposed Rendering



NYC Parks



**Soldiers & Sailors Monument Reconstruction**  
**Riverside Park | Cannonballs Relocation**





Existing Conditions



Proposed Conditions



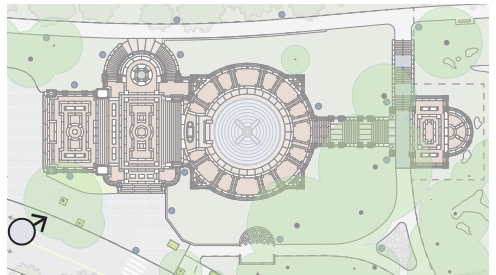

NYC Parks

W X Y

abb

LER A  
1923 100  
2023

MCLaren  
ENGINEERING GROUP

**Soldiers & Sailors Monument Reconstruction**  
Riverside Park | Monument Aerial - Existing



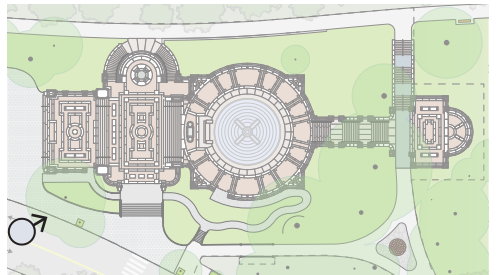

NYC Parks

W X Y

abb

LER  
1923  
2023  
100

**McLaren**  
ENGINEERING GROUP

**Soldiers & Sailors Monument Reconstruction**  
**Riverside Park | Monument Aerial - Proposed**



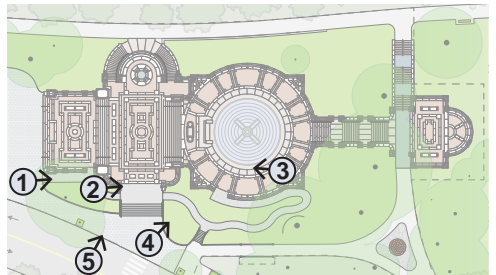
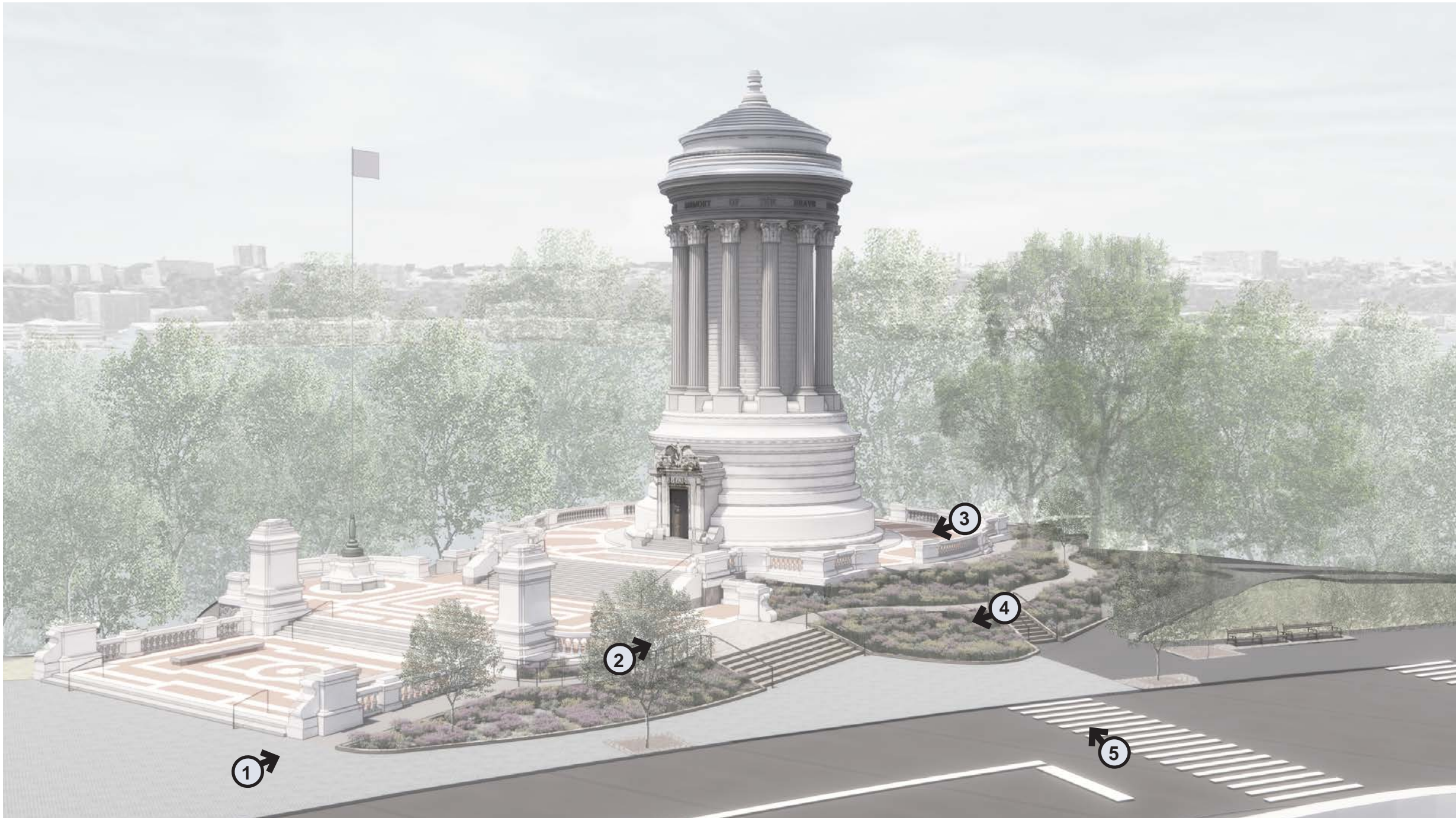

NYC Parks

W X Y

abb

LER A  
1923 100  
2023

MCLaren  
ENGINEERING GROUP

## Soldiers & Sailors Monument Reconstruction Riverside Park | Walkway Experience: Key Views



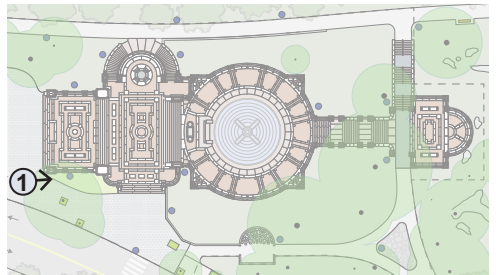

NYC Parks

W X Y

abb

LER A  
1923 2023  
100

MCLaren  
ENGINEERING GROUP

## Soldiers & Sailors Monument Reconstruction

### Riverside Park | Walkway Experience: Existing



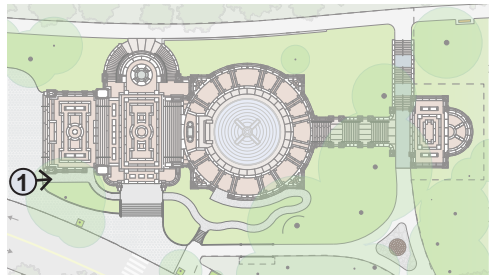

NYC Parks

W X Y

abb

LERA  
1923  
2023 100

**McLaren**  
ENGINEERING GROUP

**Soldiers & Sailors Monument Reconstruction**  
**Riverside Park | Walkway Experience: Proposed**



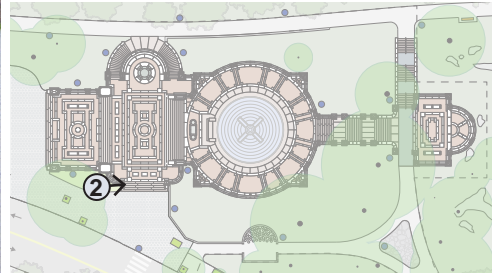

NYC Parks

W X Y

abb

LERA  
1923  
2023  
100

MCLaren  
ENGINEERING GROUP

## Soldiers & Sailors Monument Reconstruction

### Riverside Park | Walkway Experience: Existing



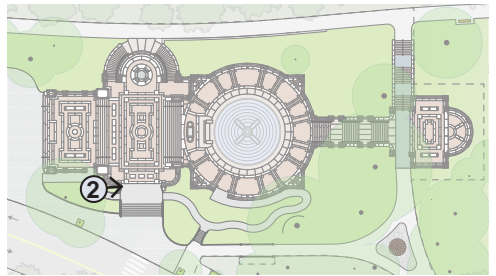

NYC Parks

W X Y

abb

LER A  
1923  
2023 100

MCLaren  
ENGINEERING GROUP

**Soldiers & Sailors Monument Reconstruction**  
**Riverside Park | Walkway Experience: Proposed**



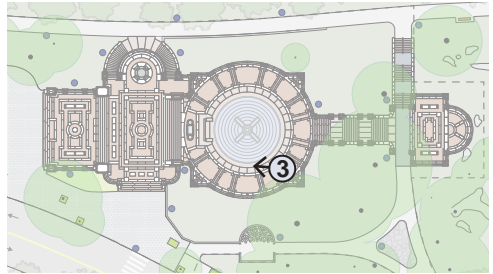

NYC Parks

W X Y

abb

LER A  
1923 100  
2023

MCLaren  
ENGINEERING GROUP

**Soldiers & Sailors Monument Reconstruction**  
**Riverside Park | Walkway Experience: Existing**



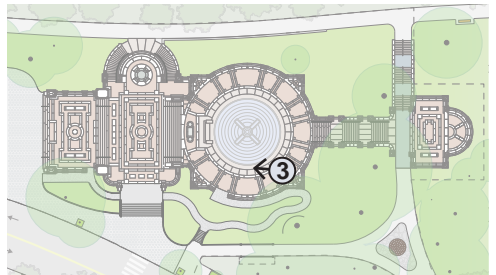

NYC Parks

W X Y

abb

LERA  
1923  
2023 100

**McLaren**  
ENGINEERING GROUP

## Soldiers & Sailors Monument Reconstruction Riverside Park | Walkway Experience: Proposed



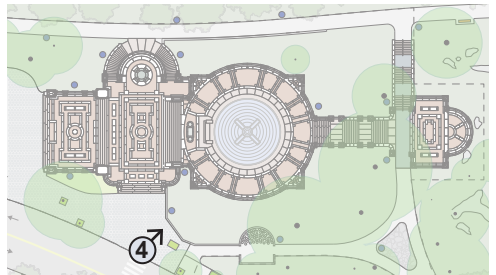

NYC Parks

W X Y

abb

LER A  
1923 100  
2023

**McLaren**  
ENGINEERING GROUP

## Soldiers & Sailors Monument Reconstruction Riverside Park | Walkway Experience: Existing



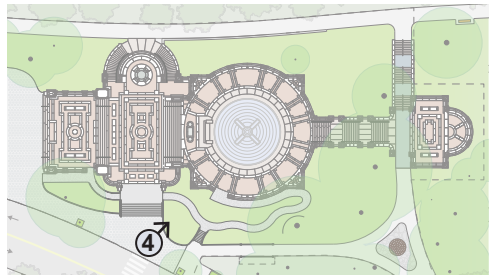



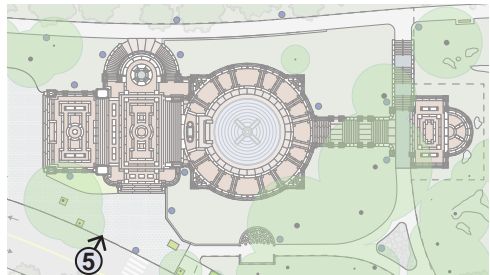

NYC Parks

W X Y

abb

LER  
1923  
2023  
100

 **McLaren**  
ENGINEERING GROUP

## Soldiers & Sailors Monument Reconstruction

### Riverside Park | Walkway Experience: Existing



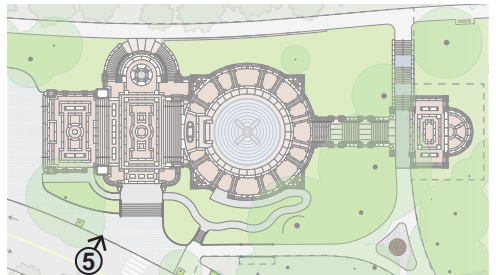

NYC Parks

W X Y

abb

LERA  
1923  
2023 100

**McLaren**  
ENGINEERING GROUP

## Soldiers & Sailors Monument Reconstruction Riverside Park | Walkway Experience: Proposed



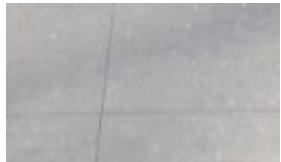
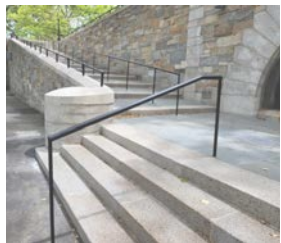
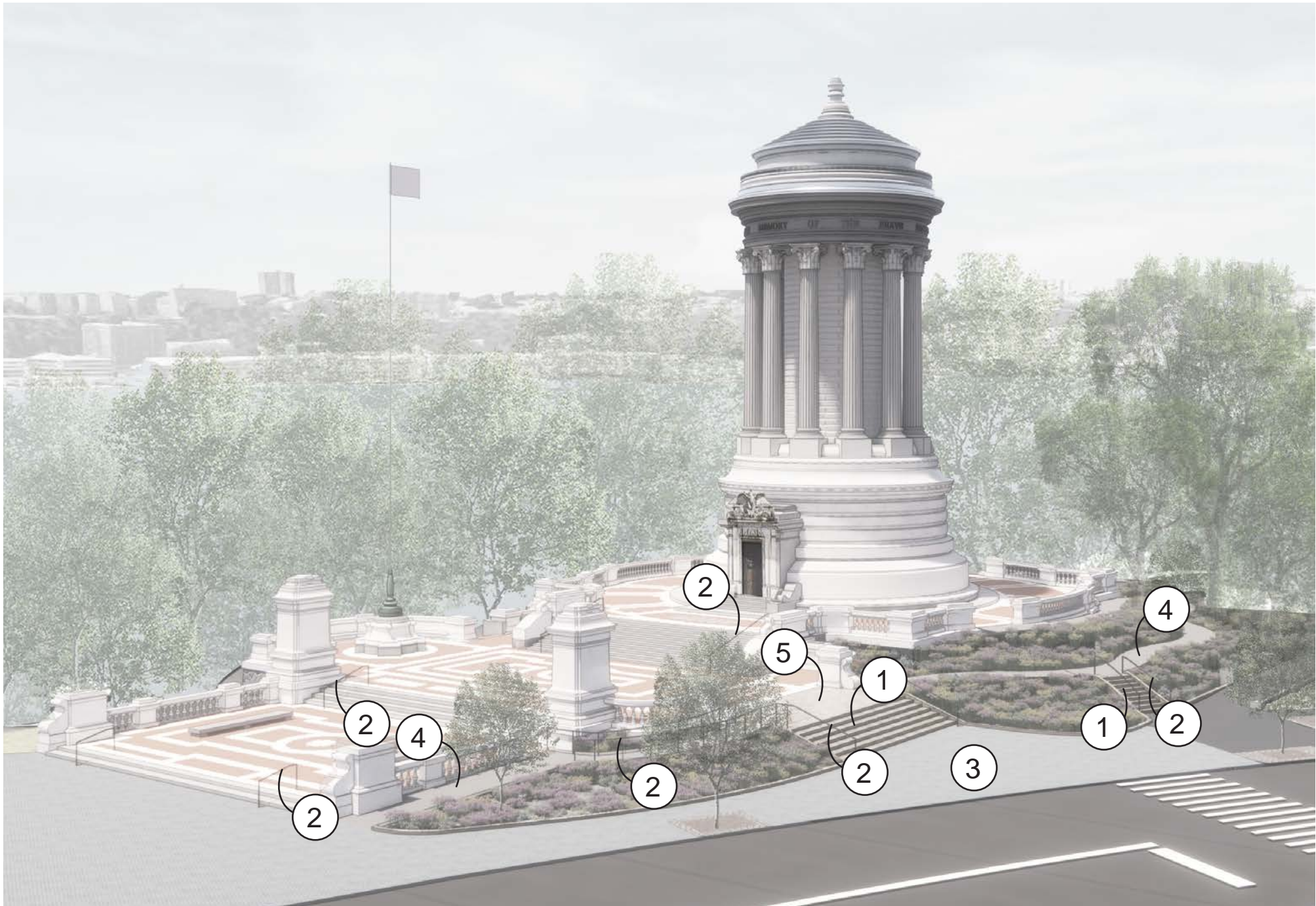

NYC Parks

W X Y

abb

LER A  
1923 100  
2023

MCLaren  
ENGINEERING GROUP

# **Soldiers & Sailors Monument Reconstruction** **Riverside Park | Restoration Palette**



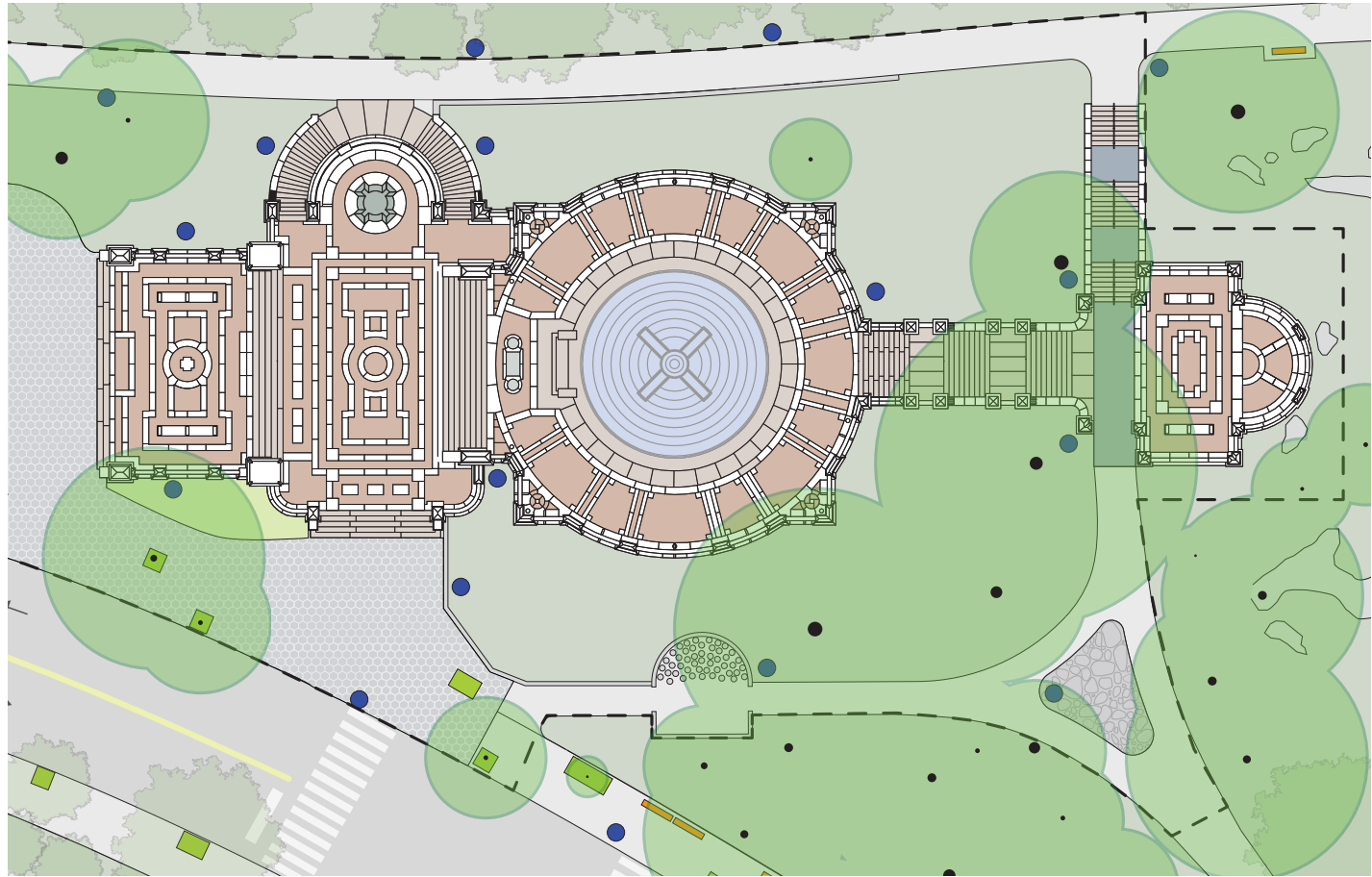

Existing Conditions

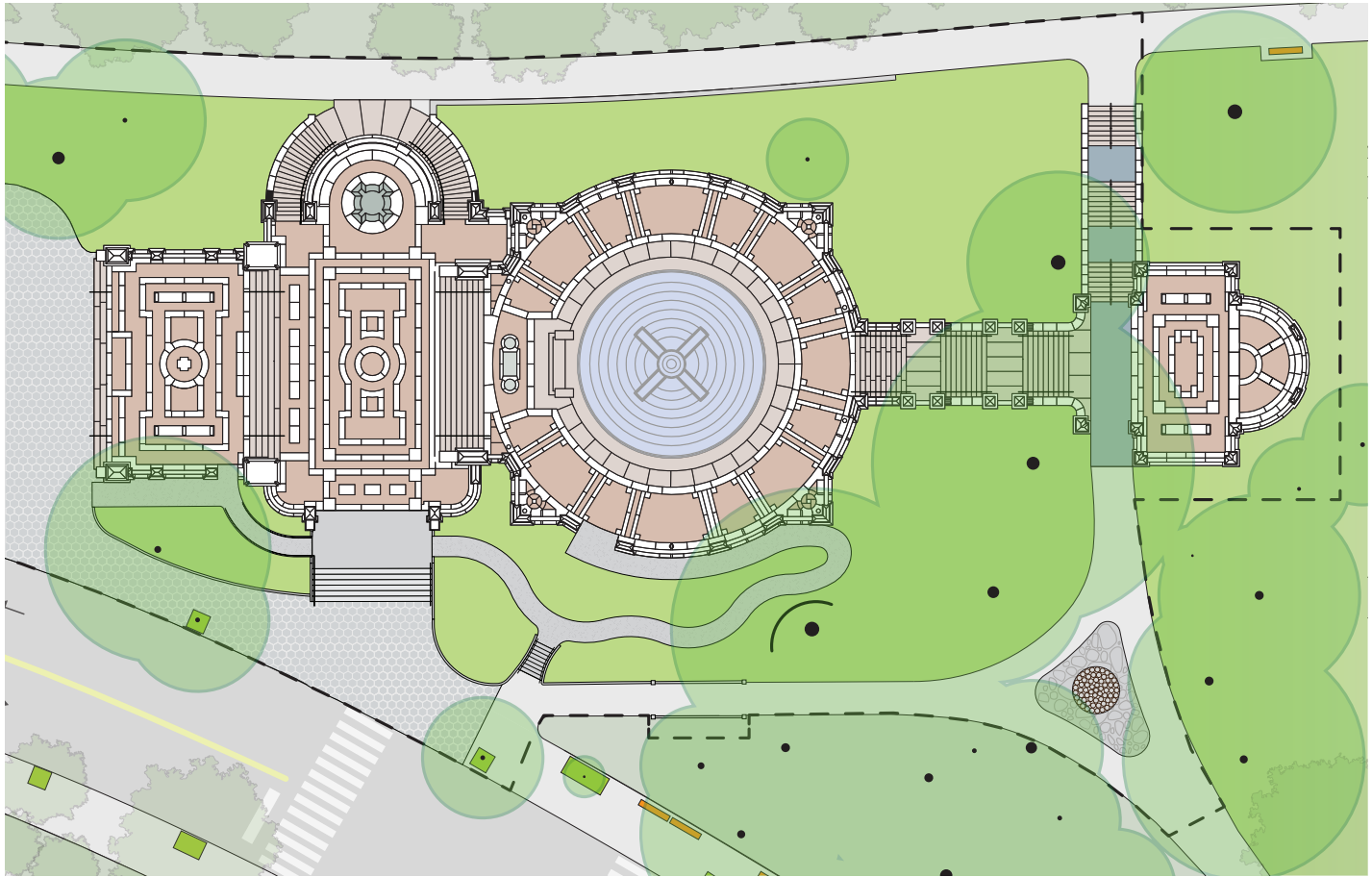

Proposed Conditions



NYC Parks

W X Y

abb

LER A  
1923 100  
2023



Soldiers & Sailors Monument Reconstruction  
Riverside Park | Before & After



**June 11, 2024**  
Public Hearing

The current proposal is:

**Preservation Department – Item 3, LPC-24-10137**

**Soldiers' and Sailors' Monument, Riverside Park – Scenic  
Landmark  
Borough of Manhattan**

**To testify virtually, please join Zoom**

**Webinar ID:** 864 7055 3741

**Passcode:** 412825

By Phone: 1 646-558-8656 US (New  
York) 877-853-5257 (Toll free) US  
888 475 4499 (Toll free)

**Note:** If you want to testify virtually on an item, join the Zoom webinar at the agenda's "Be Here by" time (about an hour in advance). When the Chair indicates it's time to testify, "raise your hand" via the Zoom app if you want to speak (\*9 on the phone). Those who signed up in advance will be called first.



# Appendix



NYC Parks

W X Y

abb

LERA  
1923  
2023  
100



**Soldiers & Sailors Monument Reconstruction**  
**Riverside Park**



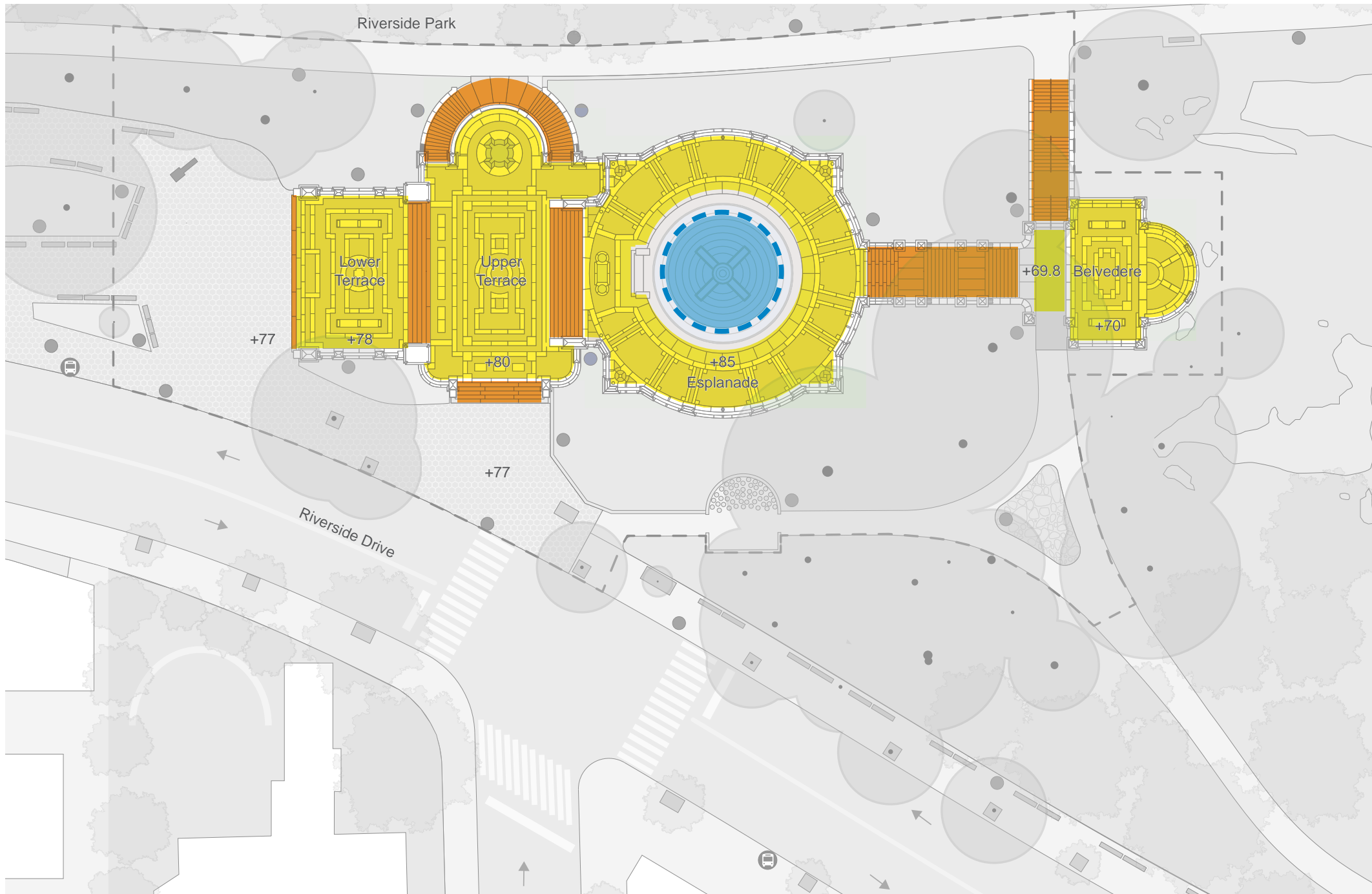

# Legend

- Project Limit
- Inaccessible Areas  
*Uneven Stone Paving*
- Access Barriers
- Monument interior closed to the public



NYC Parks

W X Y

abb

LER A  
1923 100  
2023

MCLaren  
ENGINEERING GROUP

## Soldiers & Sailors Monument Reconstruction

Riverside Park | Monument Plan: Universal Access Impediments

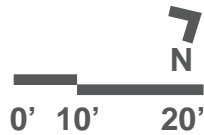





### Legend

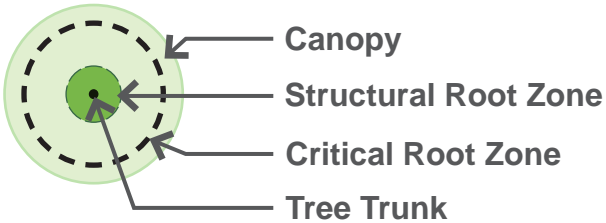

Stump Removal

### Park Tree Canopy Information

67.2% Parkland Canopy Cover  
3.6% Canopy Change 2010-2017

*Note: Canopy Information provided for extents of Riverside Park, localized site data not available.*

### Heat Vulnerability Index

Site is not in a high HVI area



NYC Parks

W X Y

abb

LER A  
1923 100  
2023

MCLaren  
ENGINEERING GROUP

## Soldiers & Sailors Monument Reconstruction Riverside Park | Tree Inventory



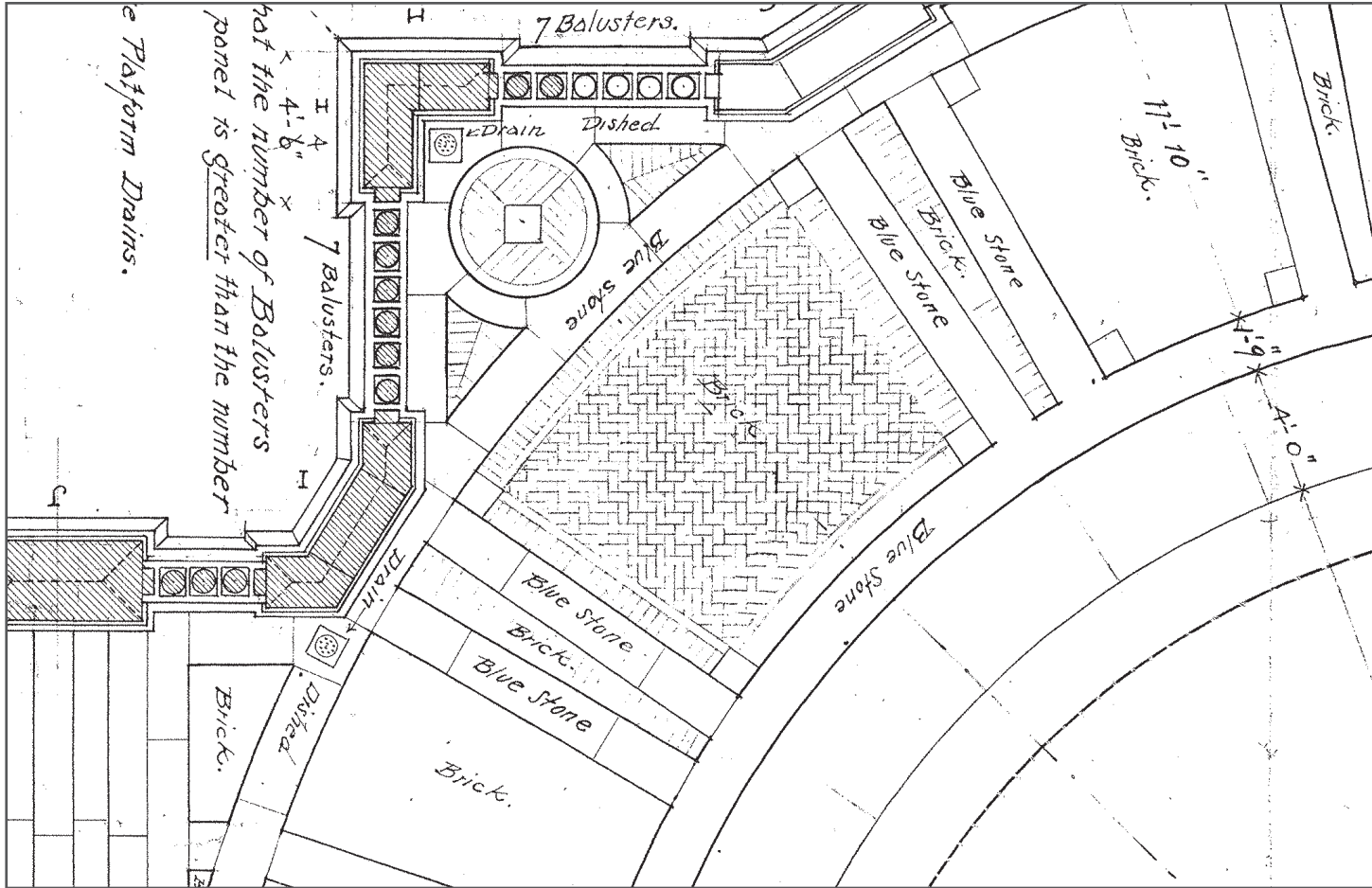

**1902**  
Terraces are completed in herringbone brick pavers.

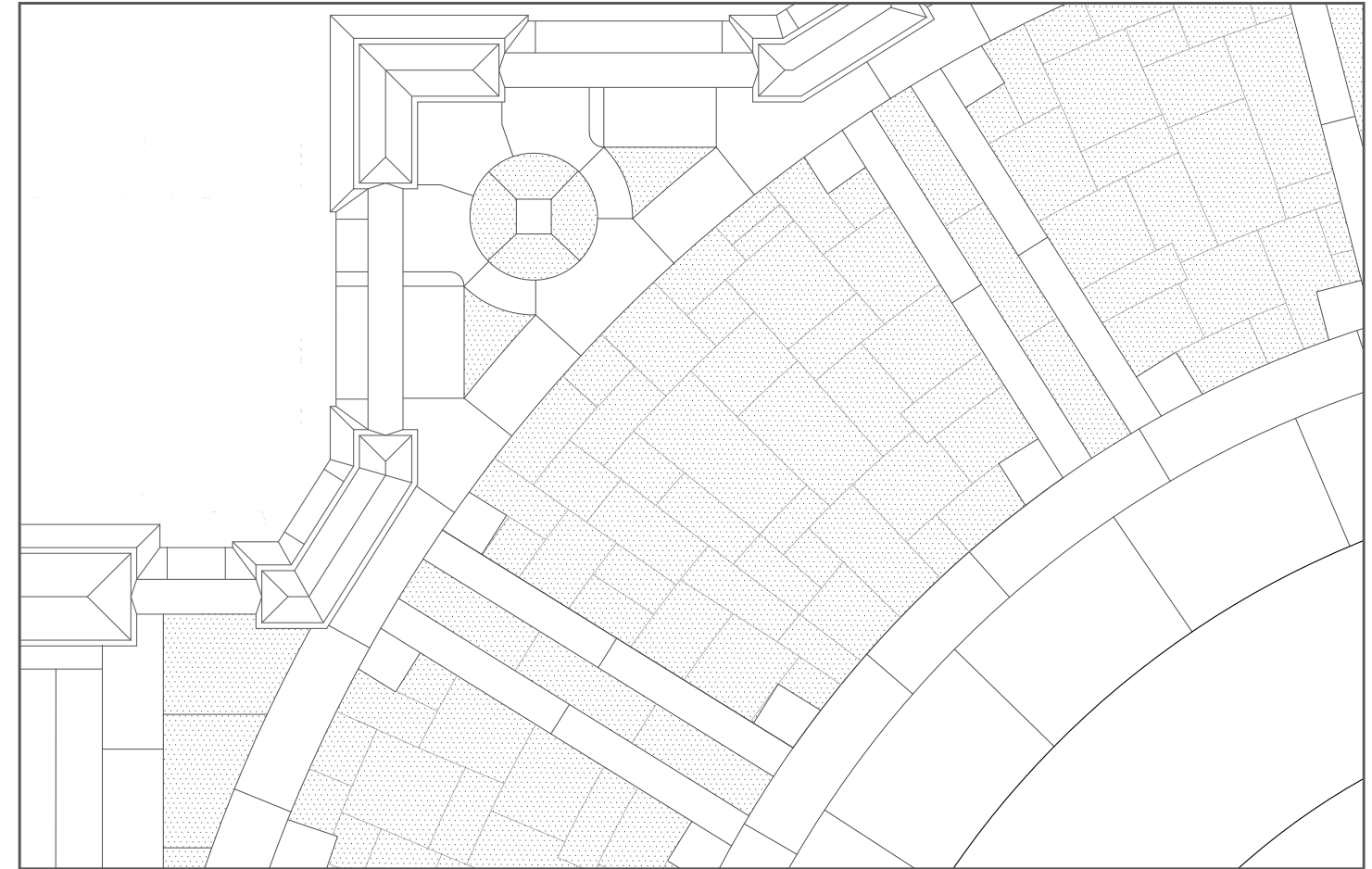

**1962**  
Last major restoration campaign—the terraces are repaved with Crab Orchard sandstone.



NYC Parks

W X Y

abb

LER A  
1923 100  
2023

MCLaren  
ENGINEERING GROUP

**Soldiers & Sailors Monument Reconstruction**  
**Riverside Park | Terrace Materials**



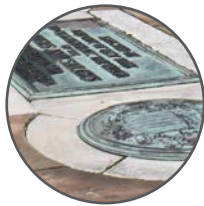

### Bronze

Bronze is featured at the flag post, the tablets, the door itself and the interior cover to the vault. On the drum, Bronze is also used as a screen detail.



### Crab Orchard Sandstone

Originally, the plazas featured a pattern of white marble banding with a brick field. In 1935 the brick was replaced by concrete.



During the 1962 restoration campaign, extensive work was conducted on the plazas. Additionally, the deteriorated original brick paving, most of which had already been replaced with concrete (as shown in period photographs), was replaced with the brownish-colored Crab Orchard sandstone.



### Marble

The marble used for the monument and plaza balustrade and piers was sourced from Dorset, Vermont



### Indiana Limestone

During the 1962 campaign, extensive work was done at the terraces and Belvedere—including the replacement of all of the original marble balustrades, their bases and railings, with Indiana limestone.



### Milford Pink Granite

Milford Pink Granite was only used on the north approach stair.



### Granite

The granite for the base and steps is reportedly quarried from the Lacasse Quarry located at Derby, Orleans County, Vermont.



NYC Parks

W X Y

abb

LER A  
1923 2023  
100

MCLaren  
ENGINEERING GROUP

## Soldiers & Sailors Monument Reconstruction Riverside Park | Monument Materials





1

2

3



4



NYC Parks

W X Y

abb

LER A  
1923 100  
2023

MCLaren  
ENGINEERING GROUP

**Soldiers & Sailors Monument Reconstruction**  
**Riverside Park | Restoration Palette**



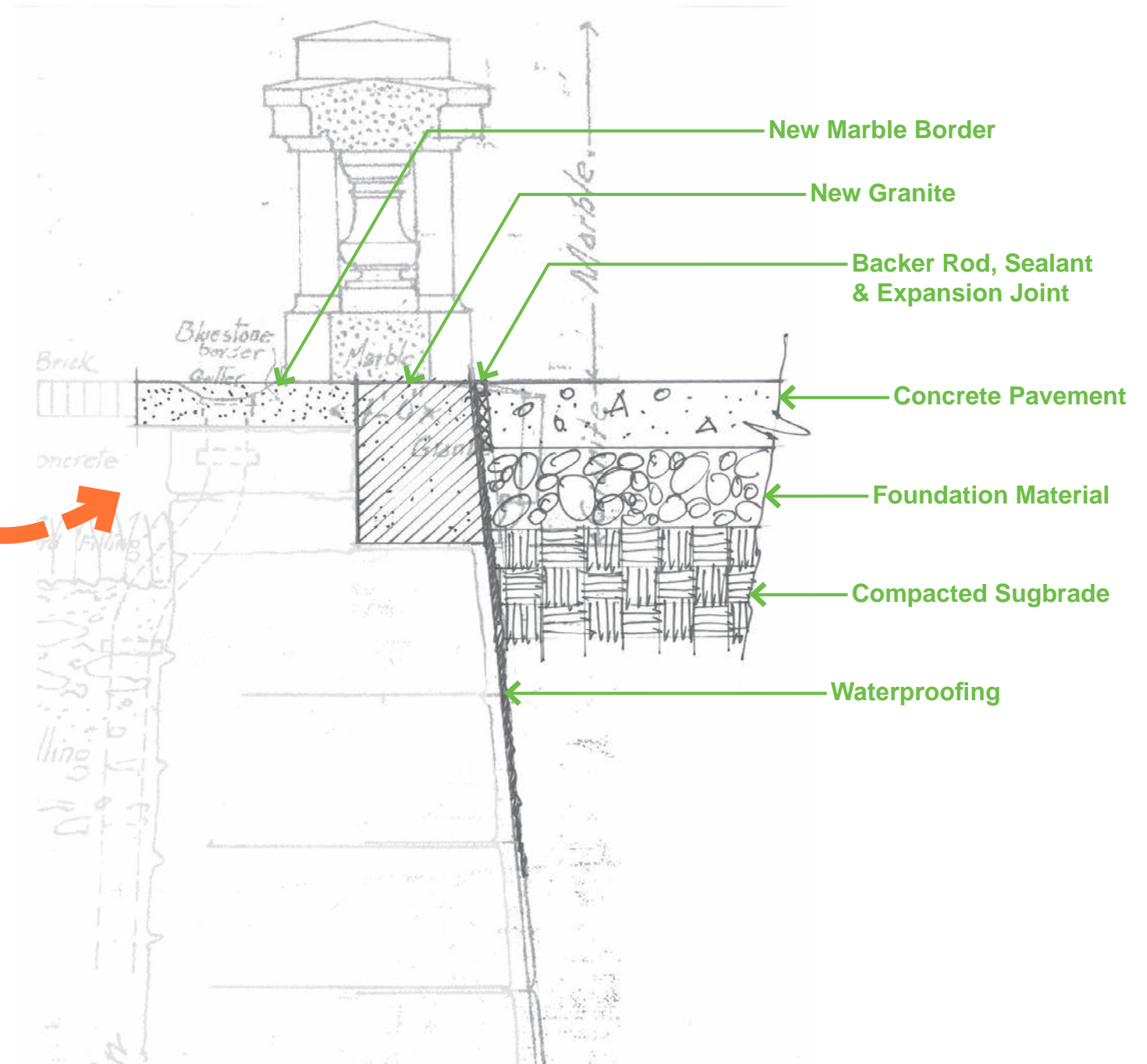
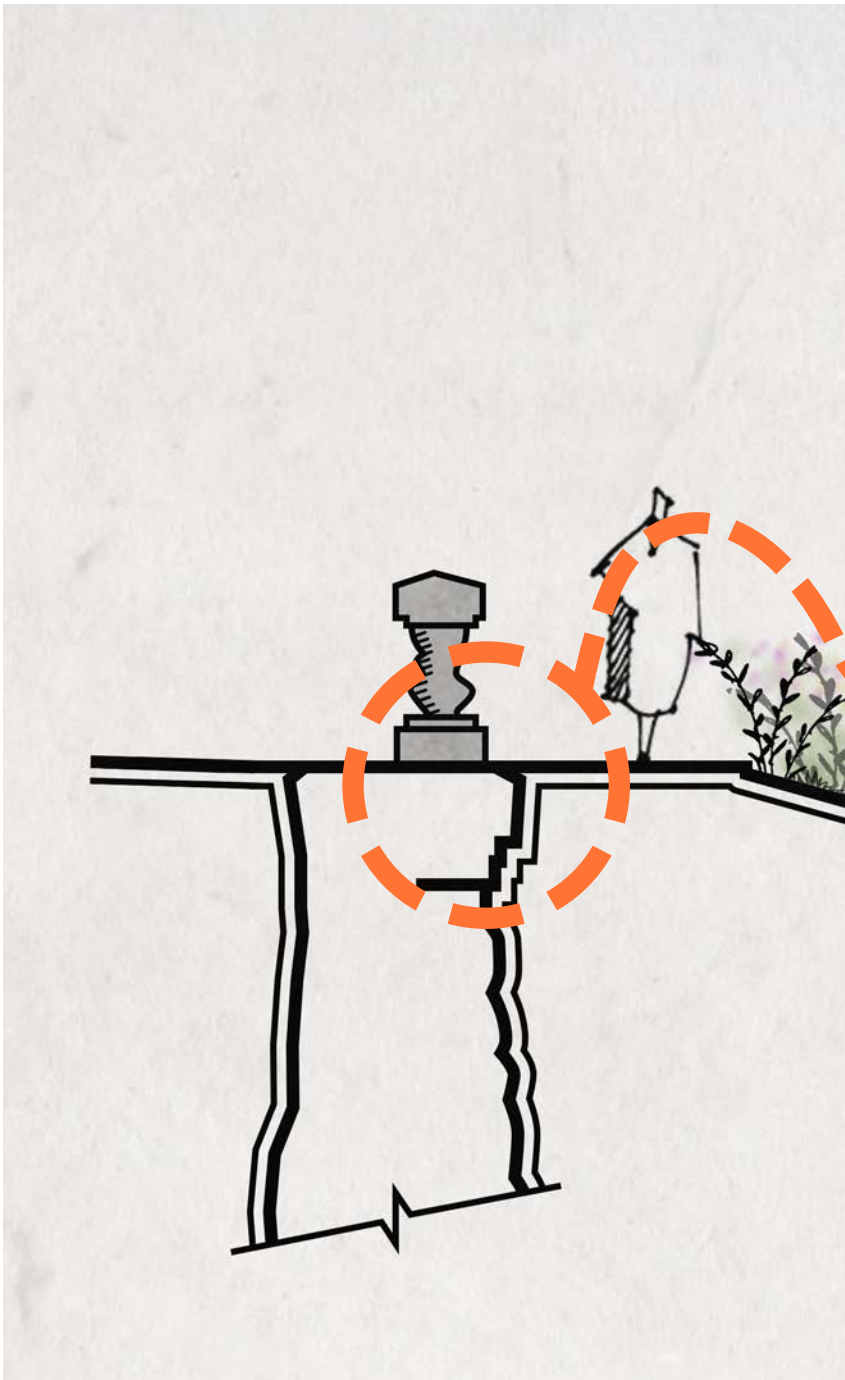



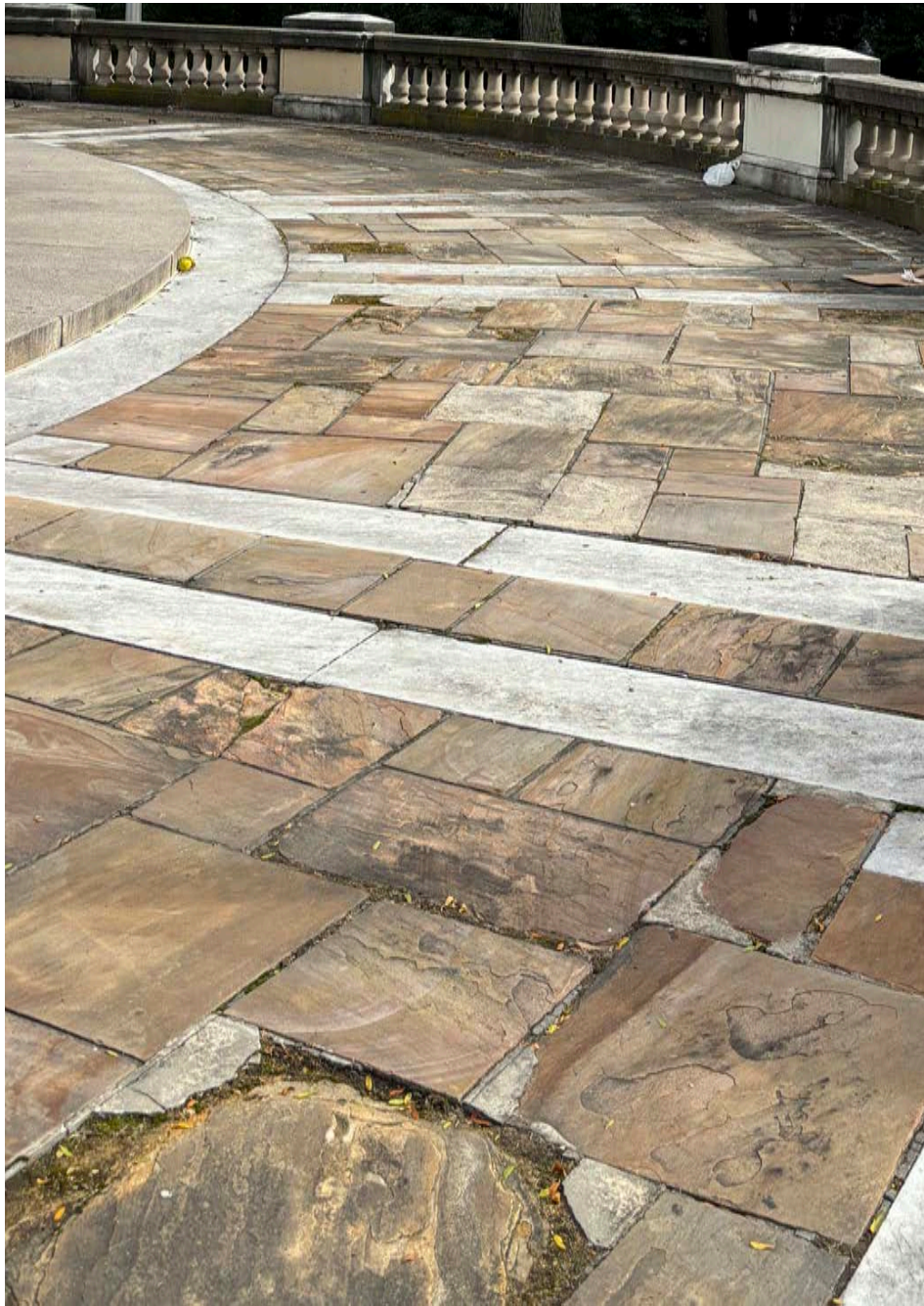

1— Deteriorated Crab Orchard paving



2— Evidence of water intrusion & damage



3— Deterioration of masonry elements



NYC Parks

W X Y

abb

LER A  
1923  
2023  
100

MCLaren  
ENGINEERING GROUP

## Soldiers & Sailors Monument Reconstruction

### Riverside Park | Monument Conditions: Existing





**Sweet Pepperbush**  
*Clethra alnifolia*



**Bayberry**  
*Morella pensylvanica*



**English Laurel**  
*Prunus laurocerasus* 'Otto Luyken'



**Northern Bayberry**  
*Myrica pensylvanica*



**Compact Inkberry**  
*Ilex glabra* 'Compacta'



**Lowbush Blueberry**  
*Vaccinium angustifolium*



**Northern Spicebush**  
*Lindera benzoin*



**Witch Alder**  
*Fothergilla gardenii*



**Red Osier Dogwood**  
*Cornus sericea*



NYC Parks



**Soldiers & Sailors Monument Reconstruction**

**Riverside Park | Plant Palette: Small Trees & Shrubs**





**Little Bluestem**  
*Schizachyrium scoparium*



**Palm Sedge**  
*Carex muskingumensis*



**Purple Love Grass**  
*Eragrostis spectabilis*



**Red Beauty Yarrow**  
*Achillea millefolium 'Red Beauty'*



**Blanket Flower**  
*Gaillardia spp.*



**Blue Star Aster**  
*Aster cordifolius*

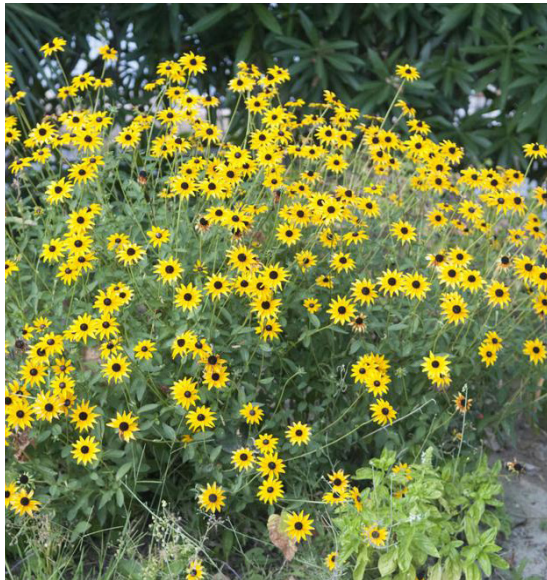

**Goldstrum Orange Coneflower**  
*Rudbeckia fulgida 'Goldstrum'*



**Walker's Low Catmint**  
*Nepeta x faassenii 'Walker's Low'*



**Decorative Onions**  
*Allium 'Globemaster'*



**Daffodils variety**  
*Narcissus spp.*





#### Before

Upon the site's opening in 1939, the *Nancy Brown Peace Carillon on Belle Isle, Detroit, MI* was predominantly surrounded by open lawn.



#### After

In 2021, an ecological 3 acre garden consisting of perennials, grasses, shrubs, and trees was added in front of and around the *Nancy Brown Peace Carillon*. Plants were selected based on their hardiness, durability, and ever-changing textures and colors for enjoyment in all four seasons.



NYC Parks

W X Y

abb

LER  
1923  
2023  
100



**Soldiers & Sailors Monument Reconstruction**

**Riverside Park | Design Precedent: Nancy Brown Peace Carillon**



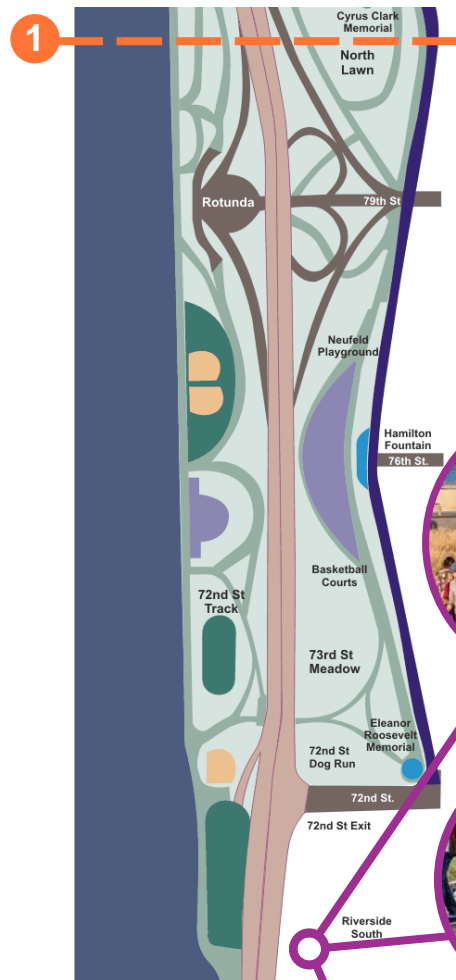

## Riverside Park South



## The Garden People



## 84th Street Hillside



Soldiers & Sailors Memorial



## RCTA & Compost Yard Landscape



## 135th Street Greenway

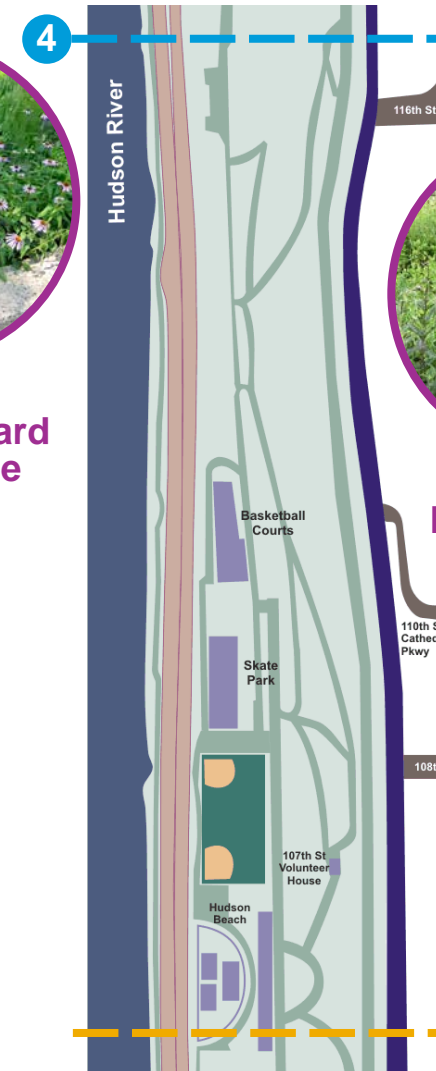

## 125th Street / Henry Hudson Parkway



## 119th Street Pollinator Meadow



NYC Parks

W X Y

abb

LER A  
1923 100  
2023

MCLaren  
ENGINEERING GROUP

Soldiers & Sailors Monument Reconstruction

Riverside Park | Design Precedent: Plant Palette within the Park



June 11, 2024  
Public Hearing

The current proposal is:

**Preservation Department – Item 3, LPC-24-10137**

**Soldiers' and Sailors' Monument, Riverside Park – Scenic  
Landmark  
Borough of Manhattan**

To testify virtually, please join Zoom

**Webinar ID:** 864 7055 3741

**Passcode:** 412825

By Phone: 1 646-558-8656 US (New  
York) 877-853-5257 (Toll free) US  
888 475 4499 (Toll free)

**Note:** If you want to testify virtually on an item, join the Zoom webinar at the agenda's "Be Here by" time (about an hour in advance). When the Chair indicates it's time to testify, "raise your hand" via the Zoom app if you want to speak (\*9 on the phone). Those who signed up in advance will be called first.