

The current proposal is:

Preservation Department – Item 1, LPC-21-09533

**Fort Greene Park,
Borough of Brooklyn**

How to Testify Via Zoom:

<https://us02web.zoom.us/j/87006785024?pwd=ZWw2eFIOMS8vMzRYa0FhNmpCdDRudz09>

Webinar ID: 870 0678 5024

Passcode: 132038

By Phone:
1 646-558-8656 (New York)

US 877-853-5257 (Toll free)

US 888-475-4499 (Toll free)

Note: If you want to testify on an item, join the Zoom webinar at the agenda’s “Be Here by” time (about an hour in advance). When the Chair indicates it’s time to testify, “raise your hand” via the Zoom app if you want to speak (*9 on the phone). Those who signed up in advance will be called first.



West Park Landscape Fort Greene Park

Landmarks Preservation Commission
Public Hearing
June 22, 2021

Parks

Project Goals:

- Reconstruct existing asphalt paths
- Reintroduce an historic connection to the upper monument plaza
- Improve accessibility and connectivity in the park
- Improve drainage by incorporating green infrastructure and mitigating erosion issues throughout

TOTAL BUDGET: \$3.75M - FY 2021
Mayor Funded

PROJECT SIZE: 3.0 acres (approximate)





FORT GREENE PARK | Site Location

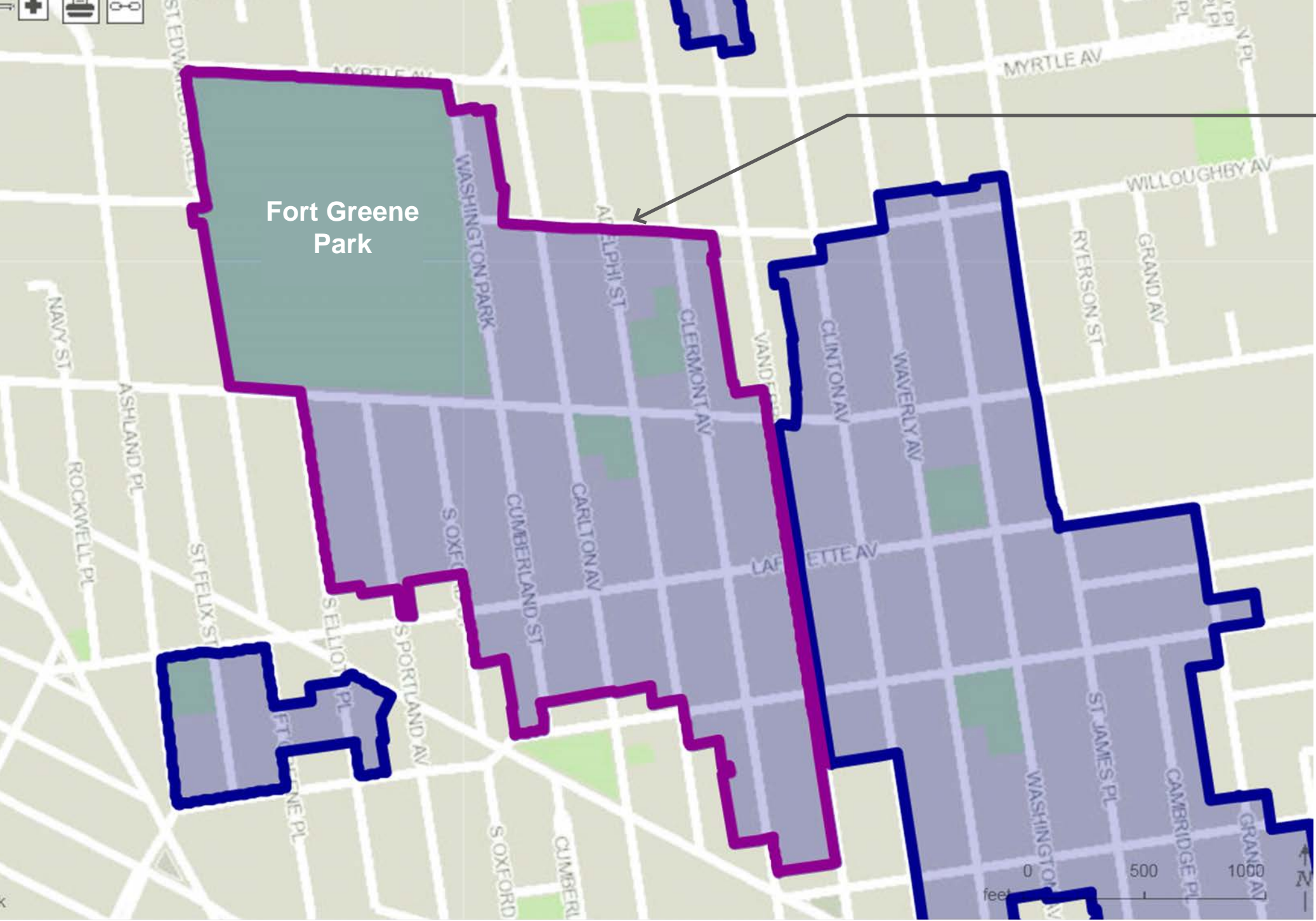

FORT GREENE HISTORIC DISTRICT



FORT GREENE PARK | Landmark District



FORT GREENE PARK | Existing Park Areas



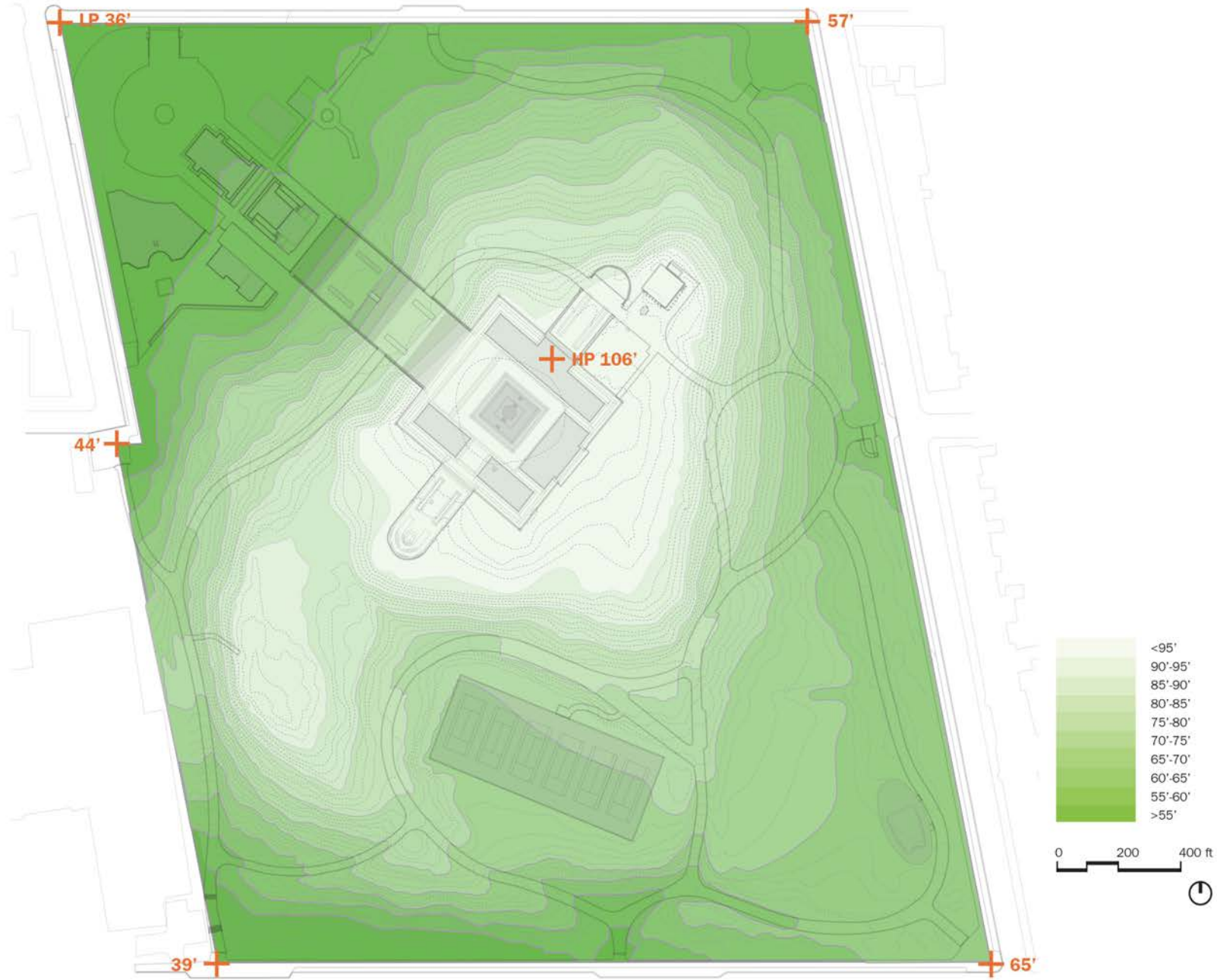

43



FORT GREENE PARK | Elevation and Topography



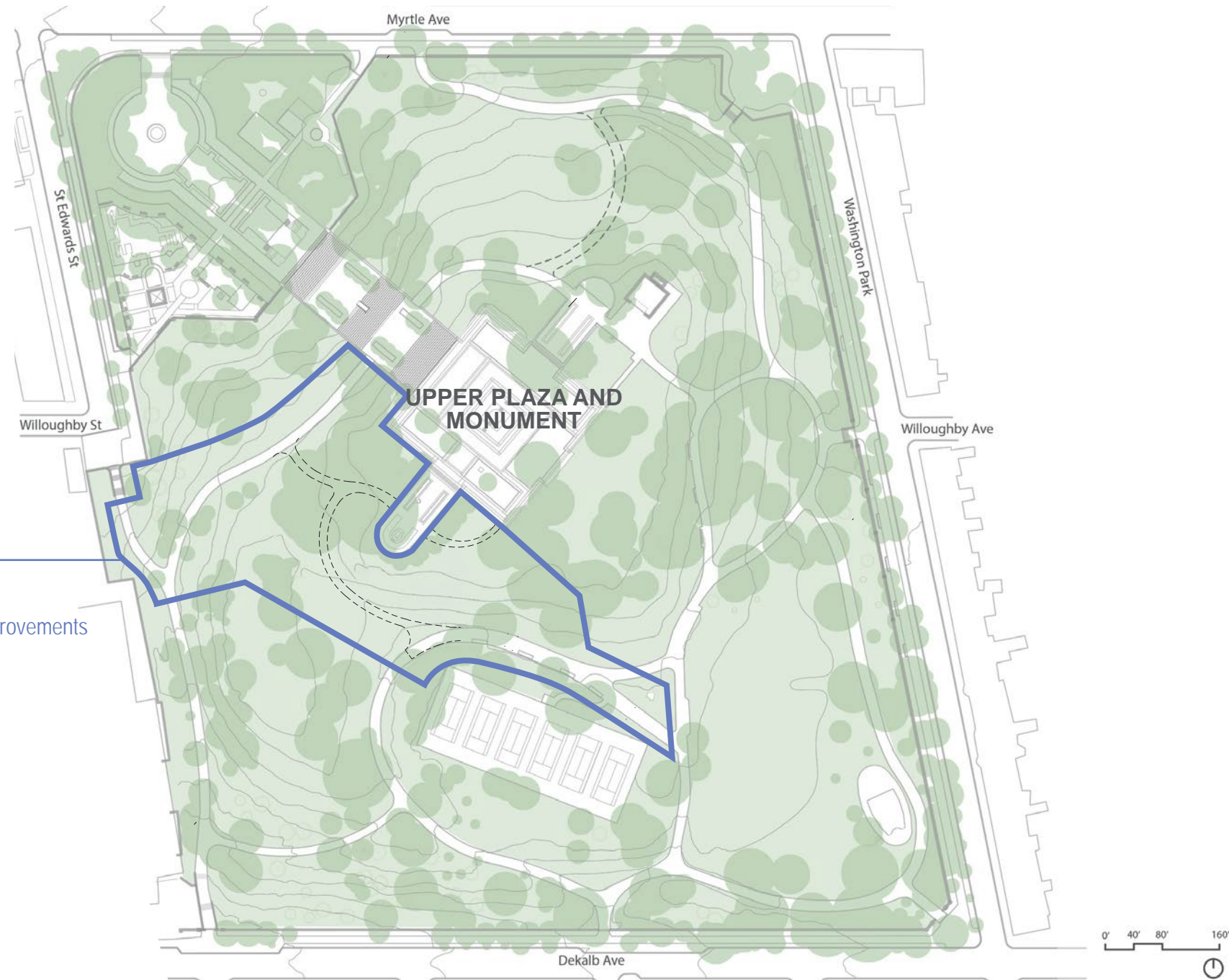

West Park Landscape

-Reintroduce an historic connection to the upper plaza and rehabilitate existing pathways to meet ADA standards and associated drainage infrastructure improvements



FORT GREENE PARK | West Park Landscape - Proposed Project Area





VIEW TOWARDS MONUMENT FROM UPPER TENNIS PATH



FORT GREENE PARK | West Park Landscape - Site Photo

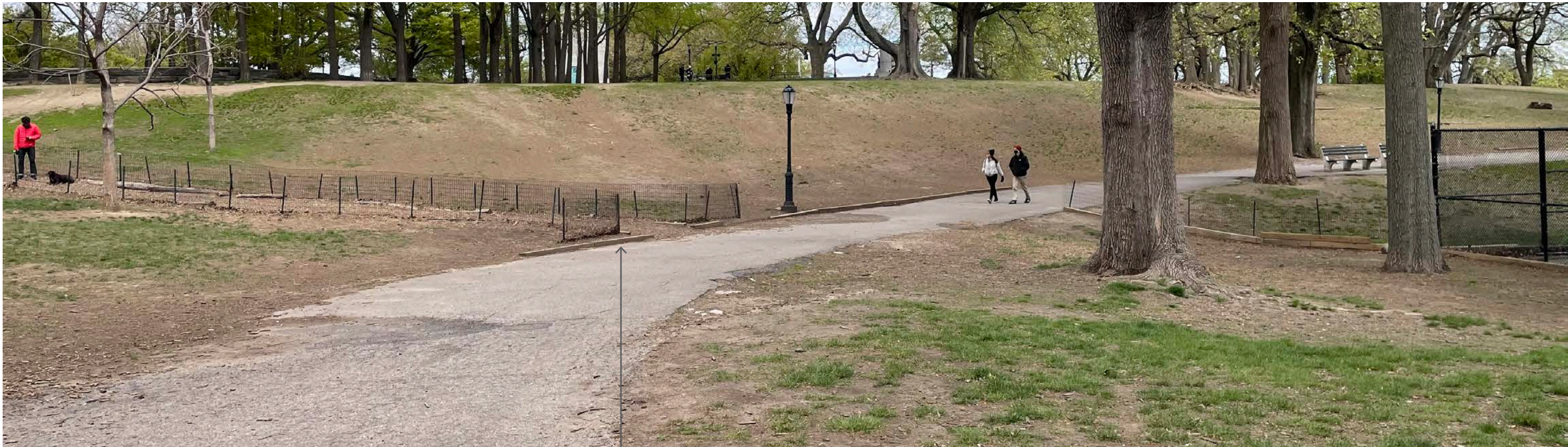

TEMPORARY PATH IN LOCATION OF PROPOSED PATH



FORT GREENE PARK | West Park Landscape - Site Photo



VIEW EAST OF UPPER TENNIS PATH



FORT GREENE PARK | West Park Landscape - Site Photo

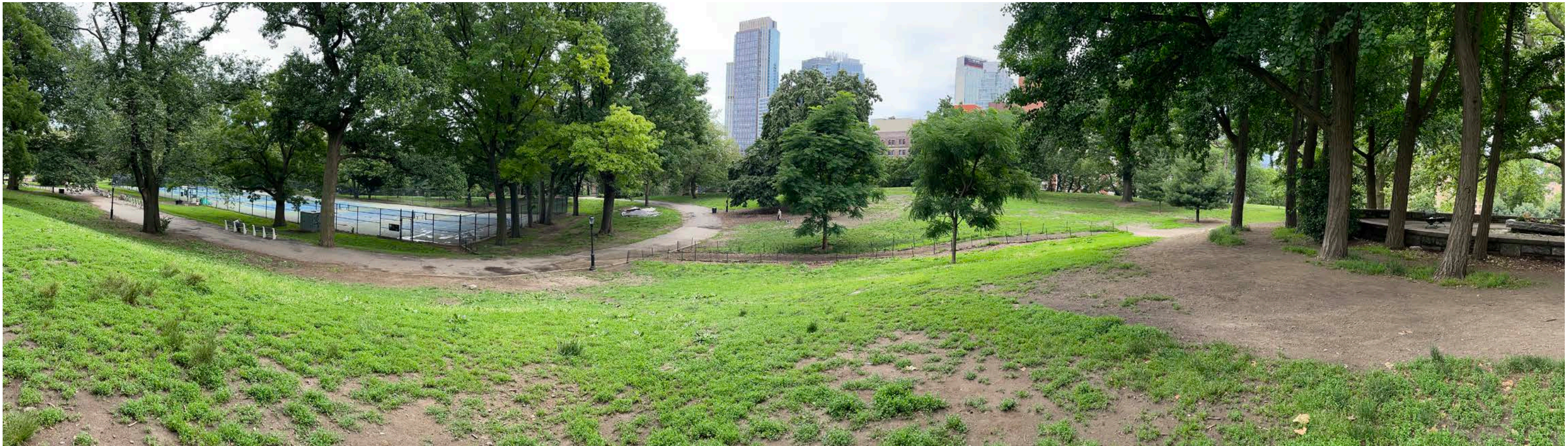

VIEW SOUTH TOWARDS TENNIS COURTS



FORT GREENE PARK | West Park Landscape - Site Photo



1- GULLY FROM WESTERN WING OF MONUMENT

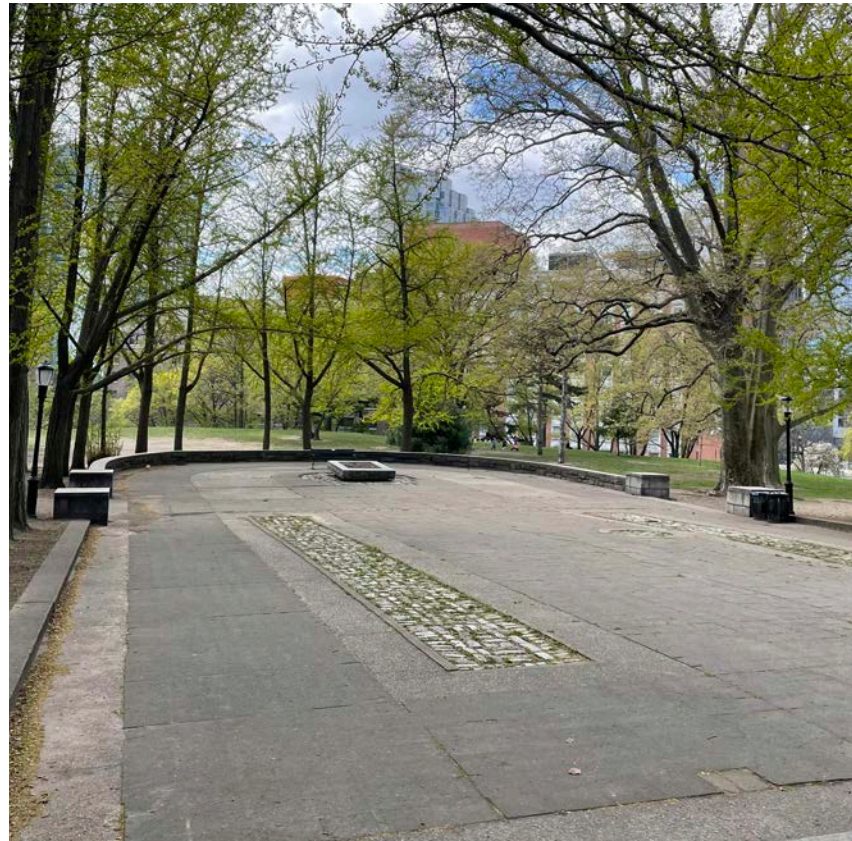

2- WESTERN WING OF MONUMENT

- Not included in this contract
- Accessible paths to connect to western wing



3- UPPER MONUMENT CONNECTION AREA



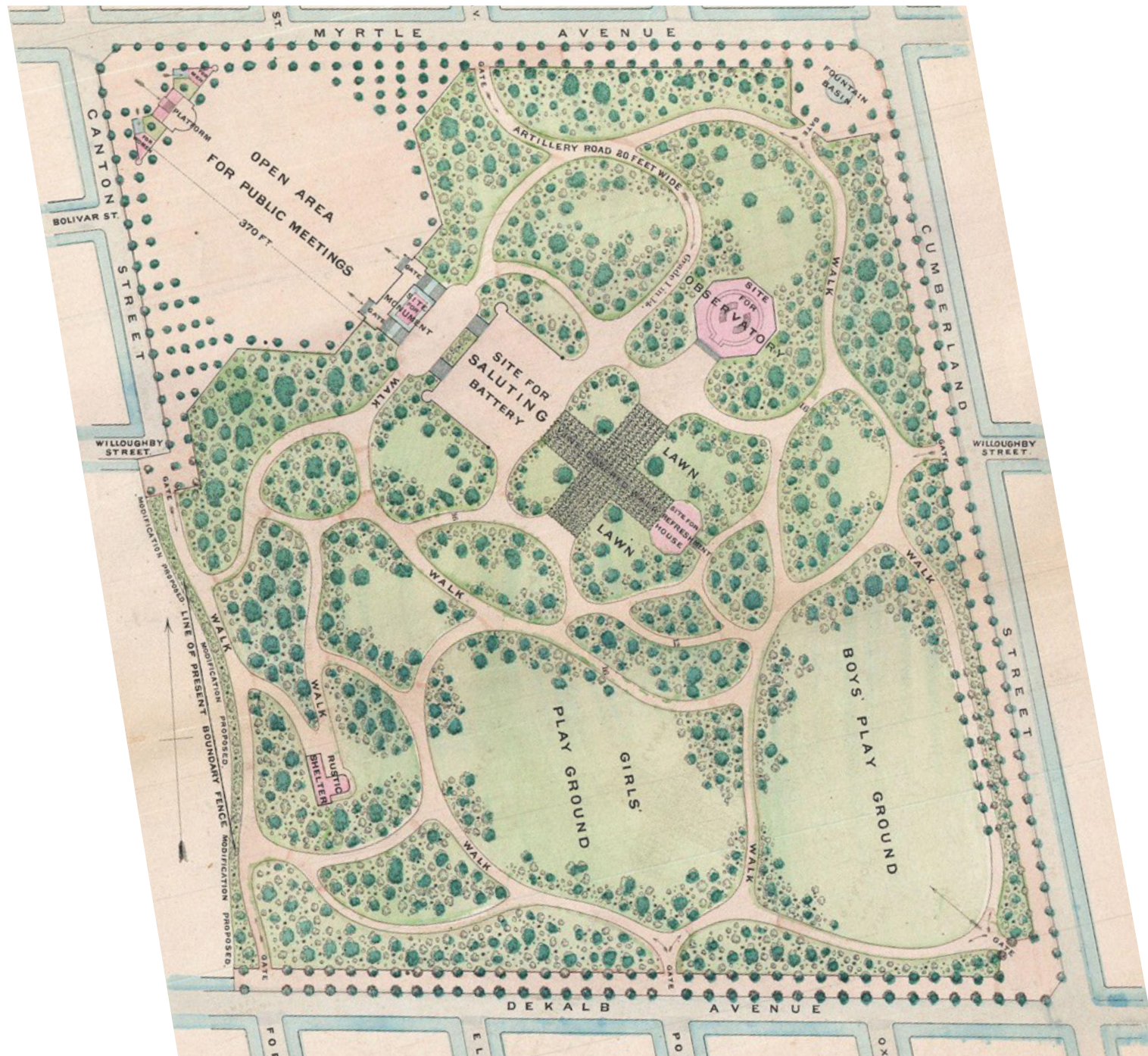

1867 Olmsted & Vaux Plan shows the original path system of the pastoral landscape. Primary, secondary, tertiary paths meander through the hilly landscape.

Park fully connected via circulation



1908 McKim, Mead, & White Monument and Monument Staircase constructed in the landscape.

The majority of the original Olmsted circulation system remains intact.

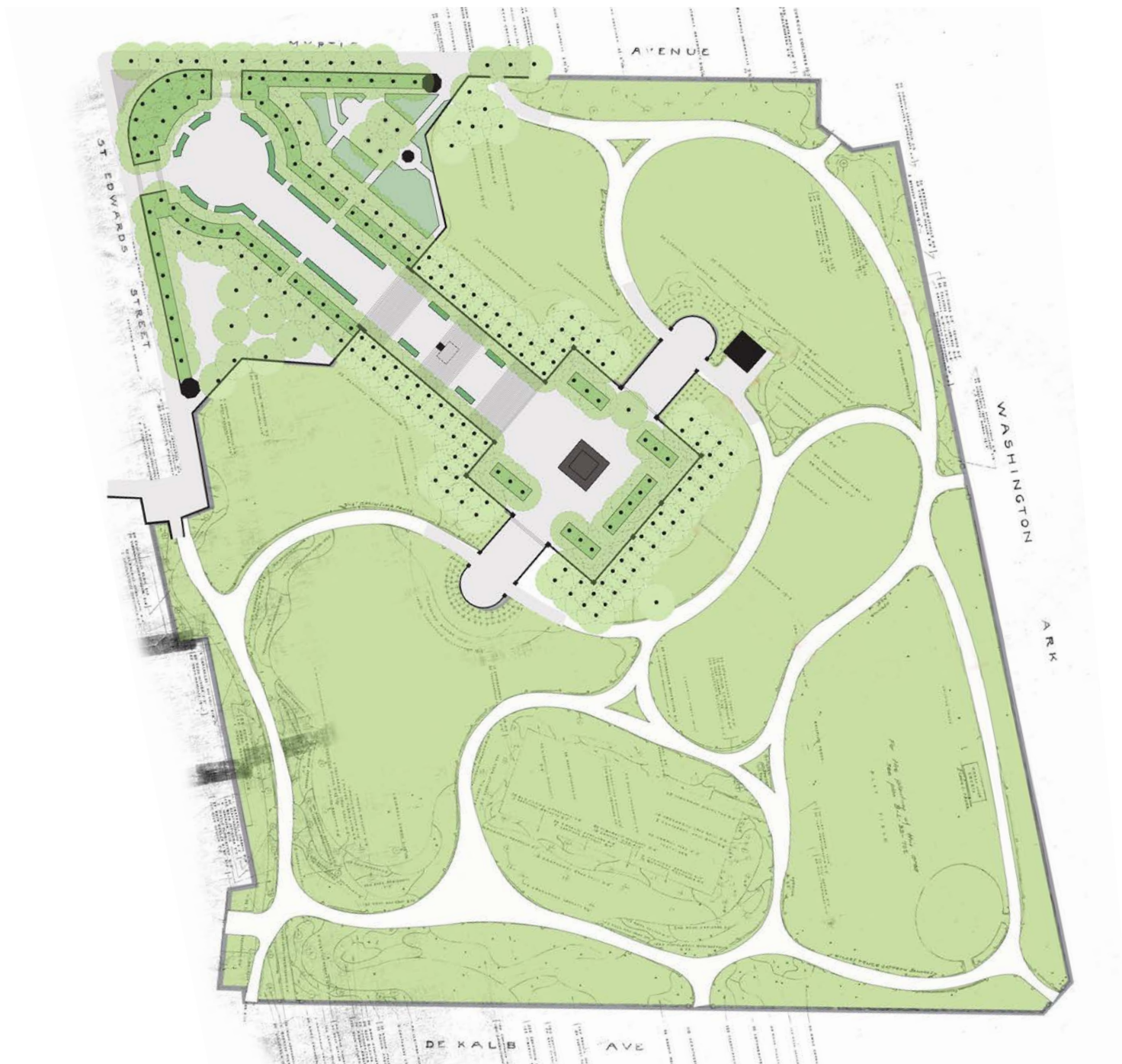

1936 Gilmore Clark Plan creates the new “wings” to the upper monument and alters the original Olmsted path system.

Park fully connected via circulation

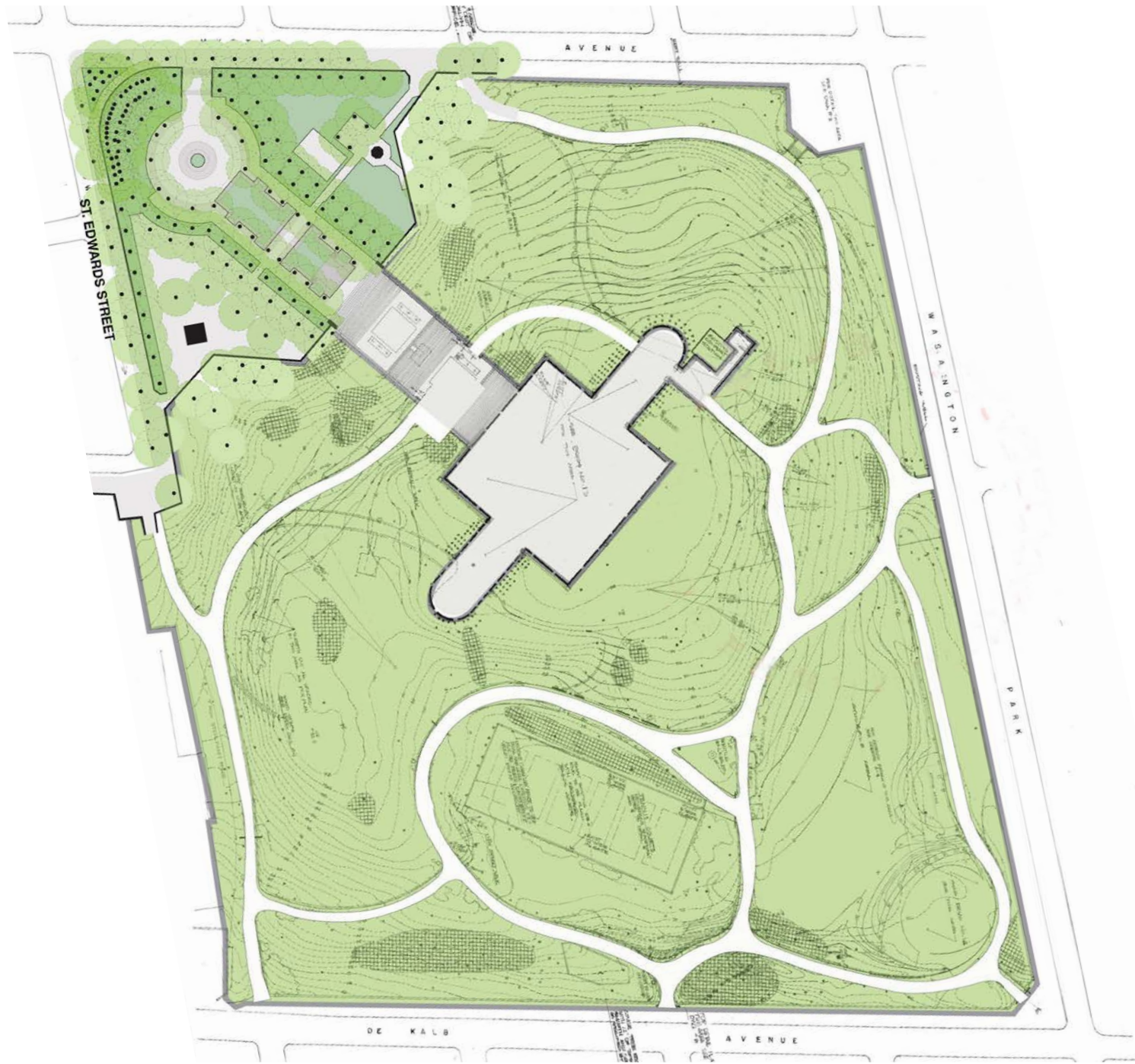



The 1972 plan removes much of the Gilmore Clarke path system. What remains is similar to the primary Olmsted path system. However, connections to the upper Monument Plaza were removed.

Besides the monument stair, only one location connects the lower portion of the park to the upper portion of the park.



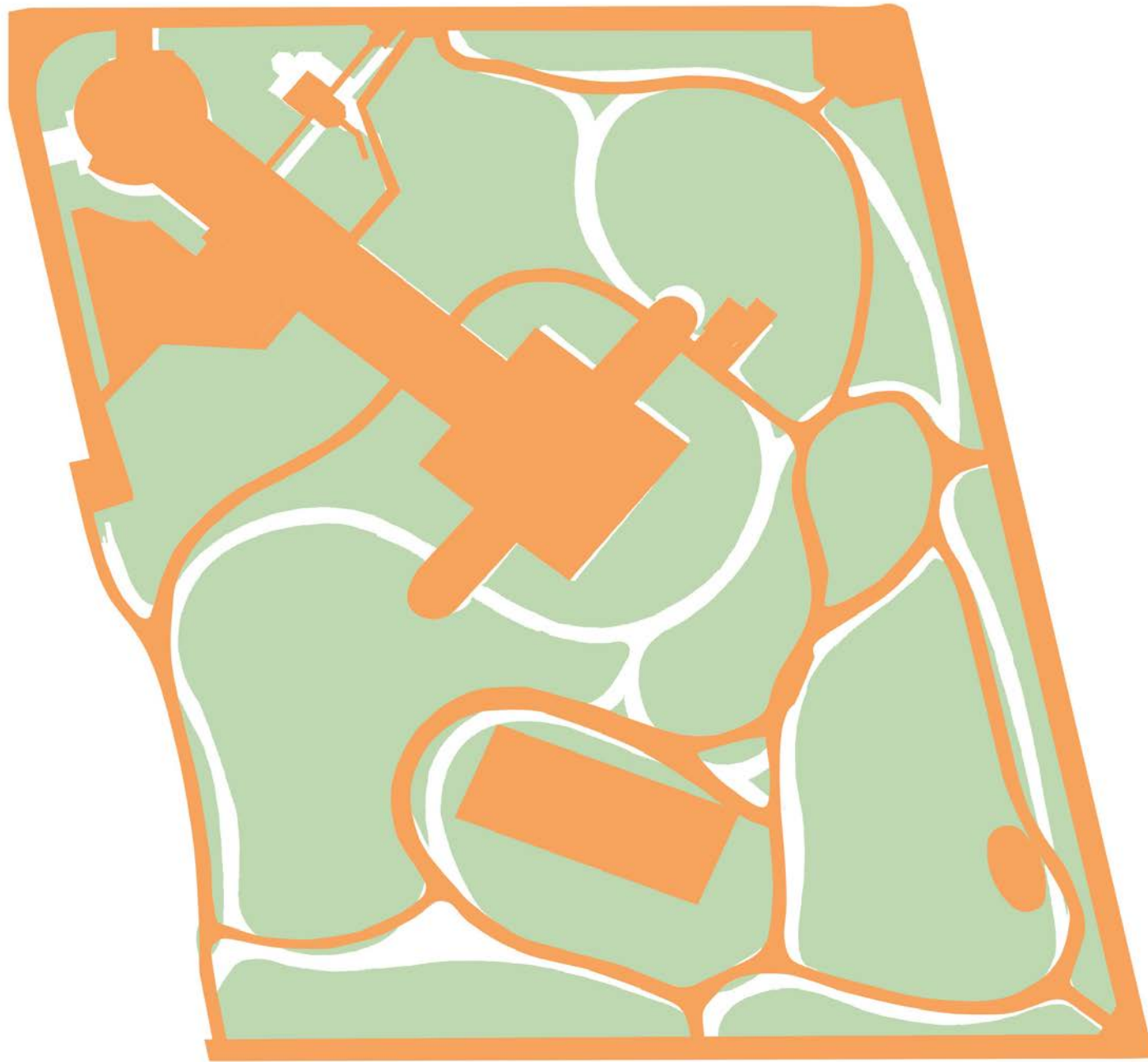

LEGEND

-  1867 Olmsted & Vaux Plan
-  Current Configuration



LEGEND

-  1936 Gilmore Clarke Plan
-  Current Configuration

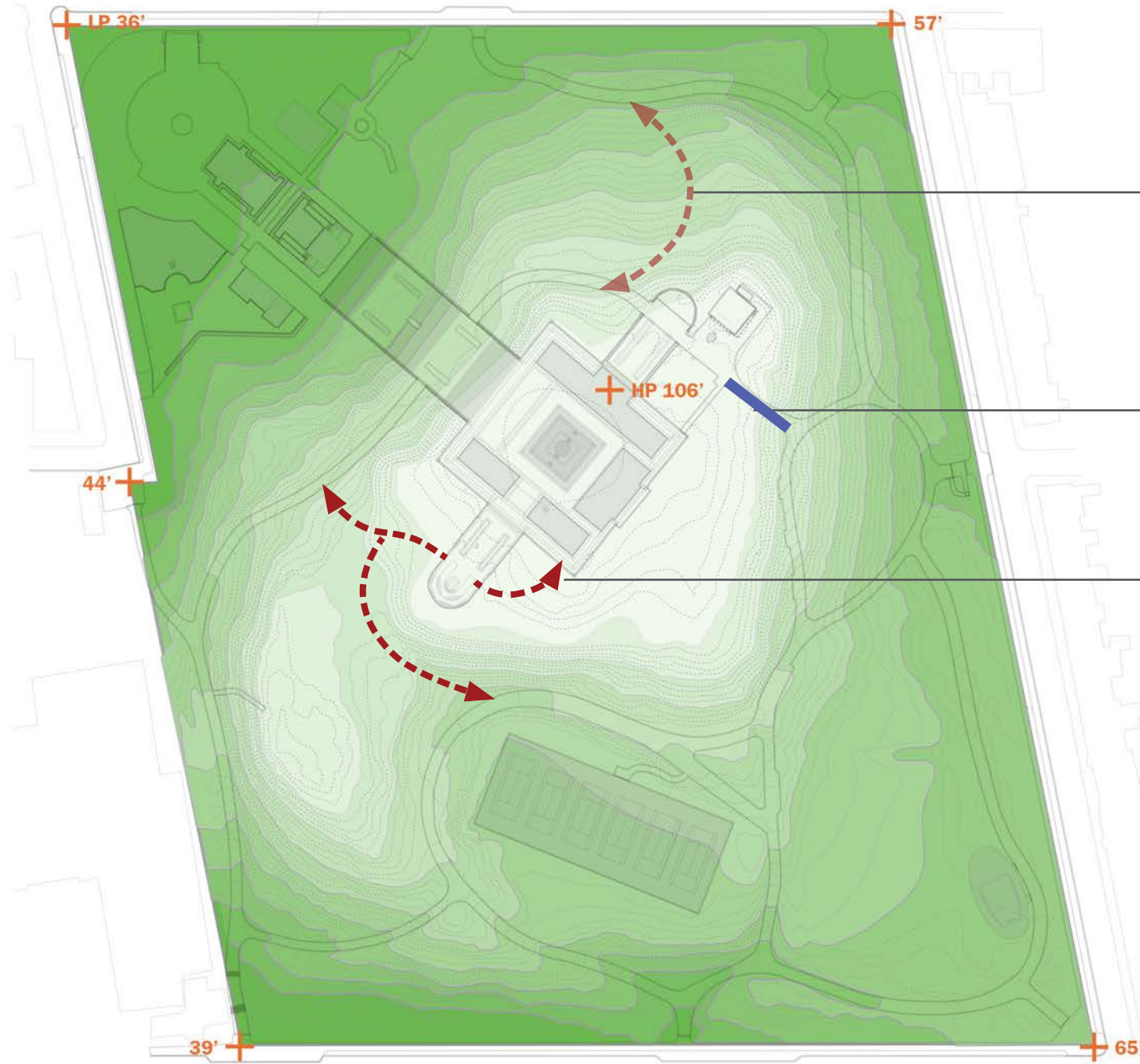

Re-establishes a connection in the northern section of the park in a previous phase

Only existing path up to monument from pastoral landscape. VERY STEEP

West Park Landscape will re-establish a connection to the upper monument from the west and south.

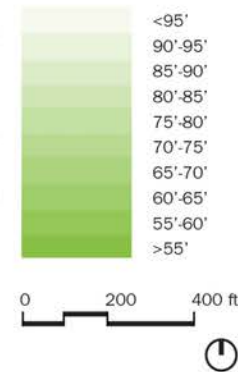

FORT GREENE PARK | Elevation, Topography, Connectivity, and Accessibility



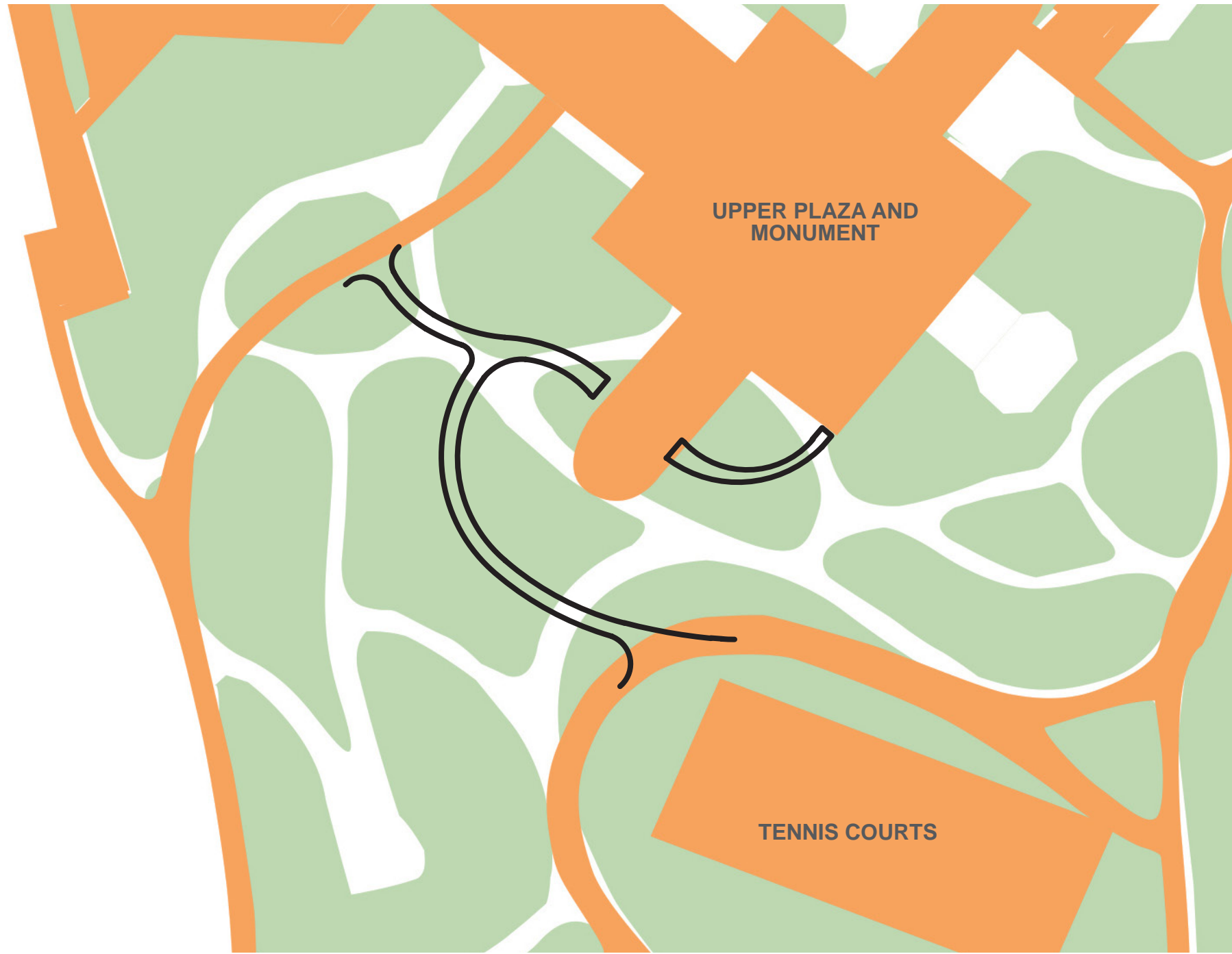

LEGEND

- 1867 Olmsted & Vaux Plan
- Current Configuration
- Proposed New ADA Paths





FORT GREENE PARK | West Park Landscape | Proposed ADA Connection - Olmsted & Vaux Comparison

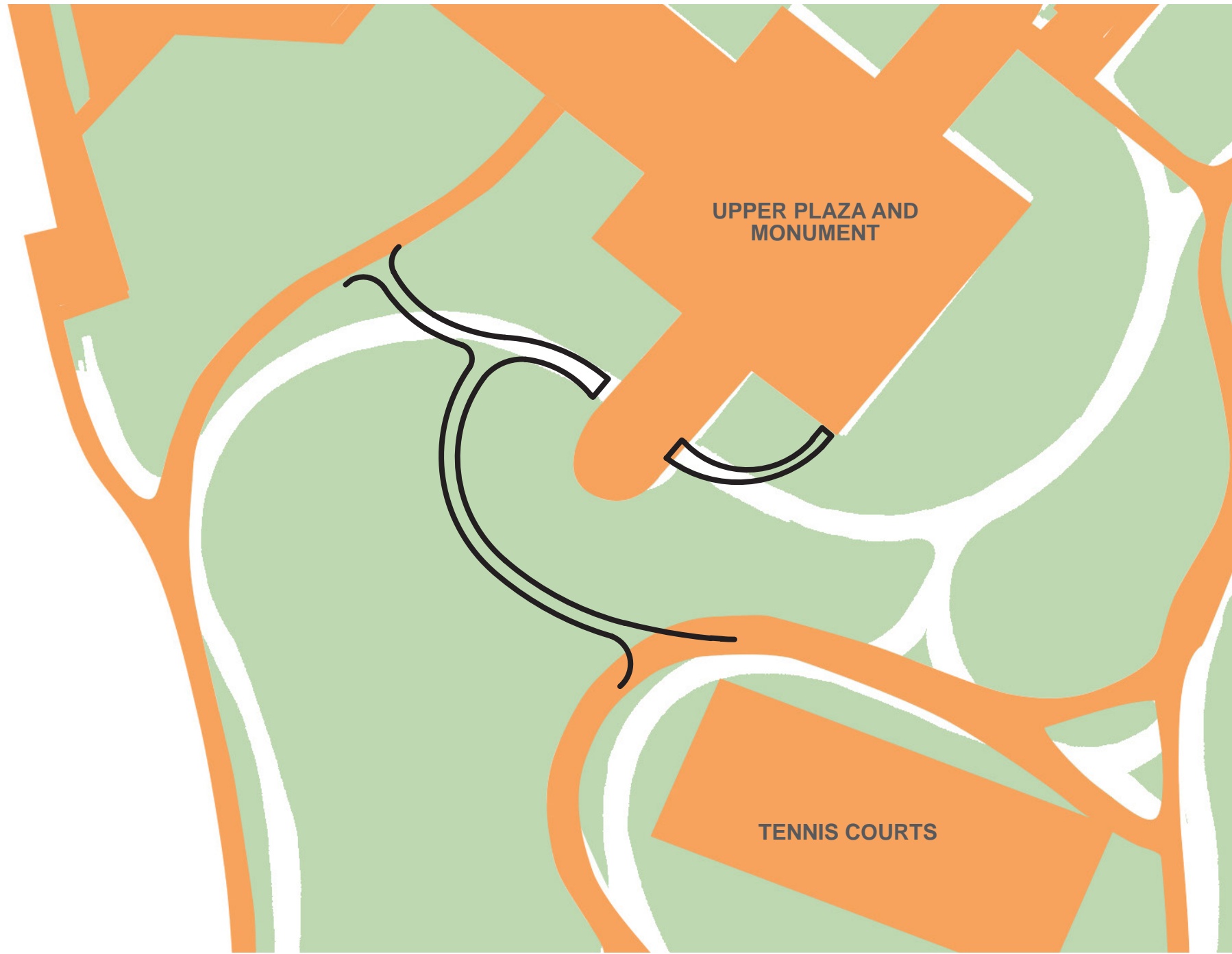



LEGEND

-  1936 Gilmore Clarke Plan
-  Current Configuration
-  Proposed New ADA Paths



FORT GREENE PARK | West Park Landscape | Proposed ADA Connection - Gilmore Clarke Comparison





The proposed reconstruction of the existing paths, infrastructure improvements, and the construction of a new accessible path will connect the upper monument with the rest of the park.

Proposed accessible path segment to connect the 'Western Wing' to the Upper Monument Plaza

Proposed Accessible path to connect to the 'Western Wing' of the Upper Monument Plaza

Existing paths to be reconstructed

LEGEND

- Existing Paths to be Reconstructed
- Proposed New ADA Compliant Paths





Proposed accessible path segment to connect the 'Western Wing' to the Upper Monument Plaza

Proposed Accessible path to connect to the 'Western Wing' of the Upper Monument Plaza. This configuration takes advantage of existing topography to achieve an ADA compliant route to the upper plaza area.



Temporary path in general location of proposed path

LEGEND

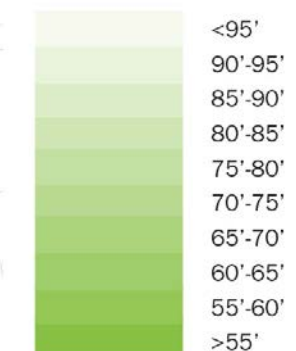





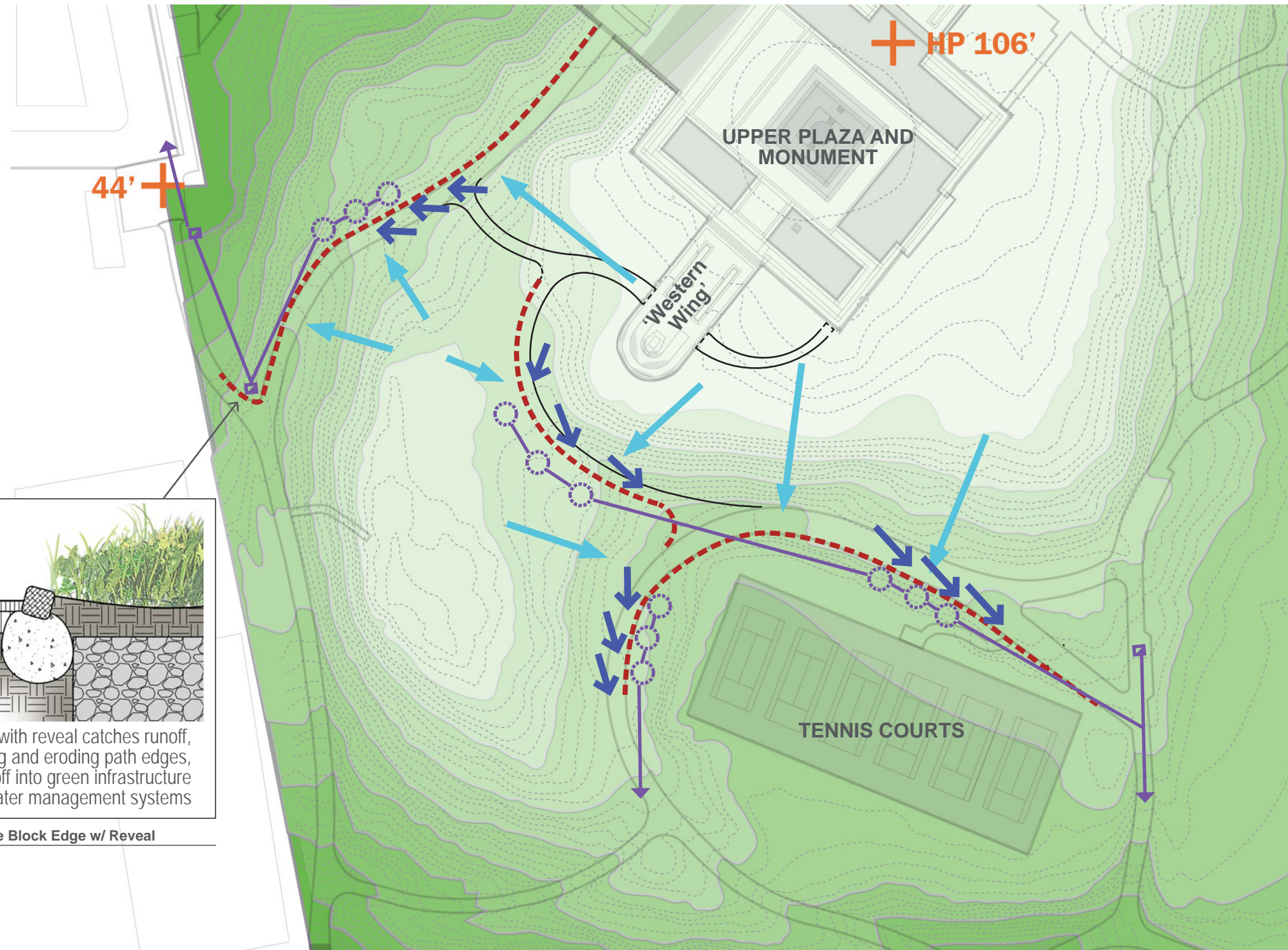

NYC Parks

FORT GREENE PARK | West Park Landscape - Existing Topography



LEGEND

-  Concentrated Flow
-  Overland Flow
-  Granite Block Edging w/ Reveal
-  Drainage Pipe
-  Catch Basin
-  Concrete Dry Well

LEGEND

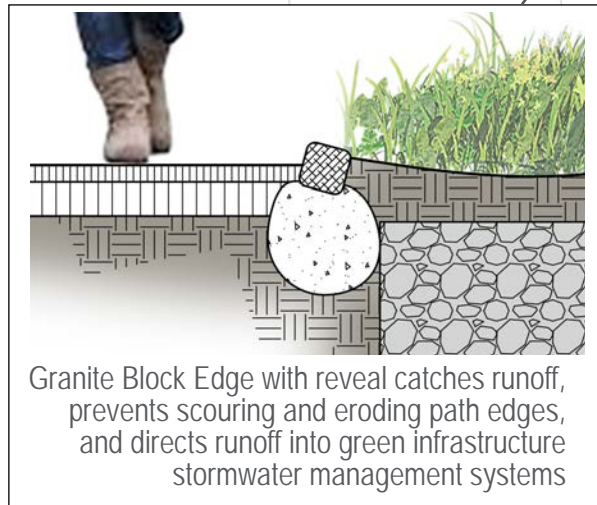
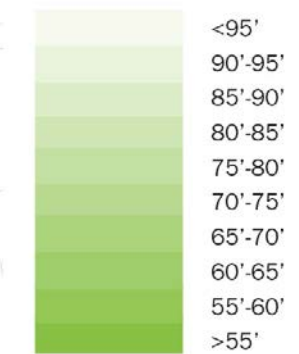

Typical Section - Granite Block Edge w/ Reveal





Granite Block Edging w/ Reveal (typ)

Entrance Plantings

Proposed Ornamental Tree (typ)

Handrail (typ)

Proposed Shade Tree (typ)

Existing Shade Tree (typ)

LEGEND

Reconstructed and new asphalt path

Granite Block Edging w/ Reveal
 -To be used on the downhill side of the path.
 -Flush granite block edging will be used on the uphill side of the path. Not shown.

Proposed Handrail
 -Exact lengths and location will be determined based on grading

Proposed Shade Tree
 -Locations shown are schematic only.
 -Exact number and final locations of shade trees will be determined in consultation with NYC Parks' Landscape Construction and Forestry Divisions

Proposed Ornamental Tree
 -Locations shown are schematic only.
 -Exact number and final locations of ornamental trees will be determined in consultation with NYC Parks' Landscape Construction and Forestry Divisions

Proposed Security Lighting

Proposed Bench
 -Exact locations shall be determined by existing and proposed grades.

NOTE:
 The layout shown is a schematic representation. The final layout of the paths may be slightly adjusted due to site topography and existing trees.





Asphalt Paths - Granite Block Edging - Plantings



Granite Block Edging

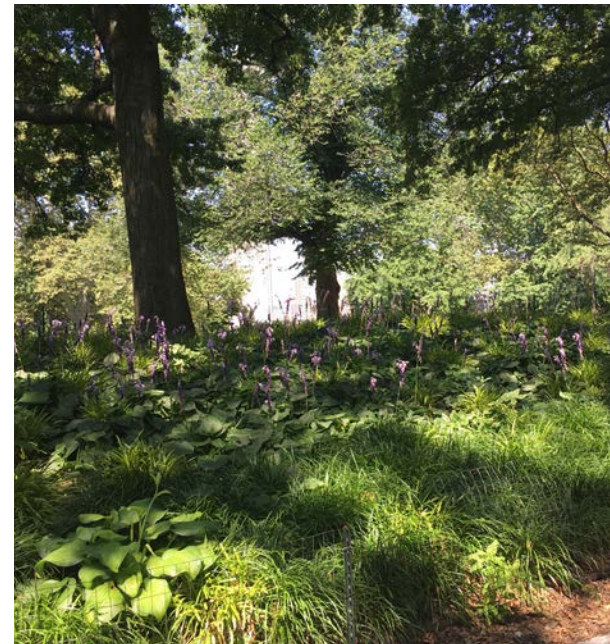

Plantings

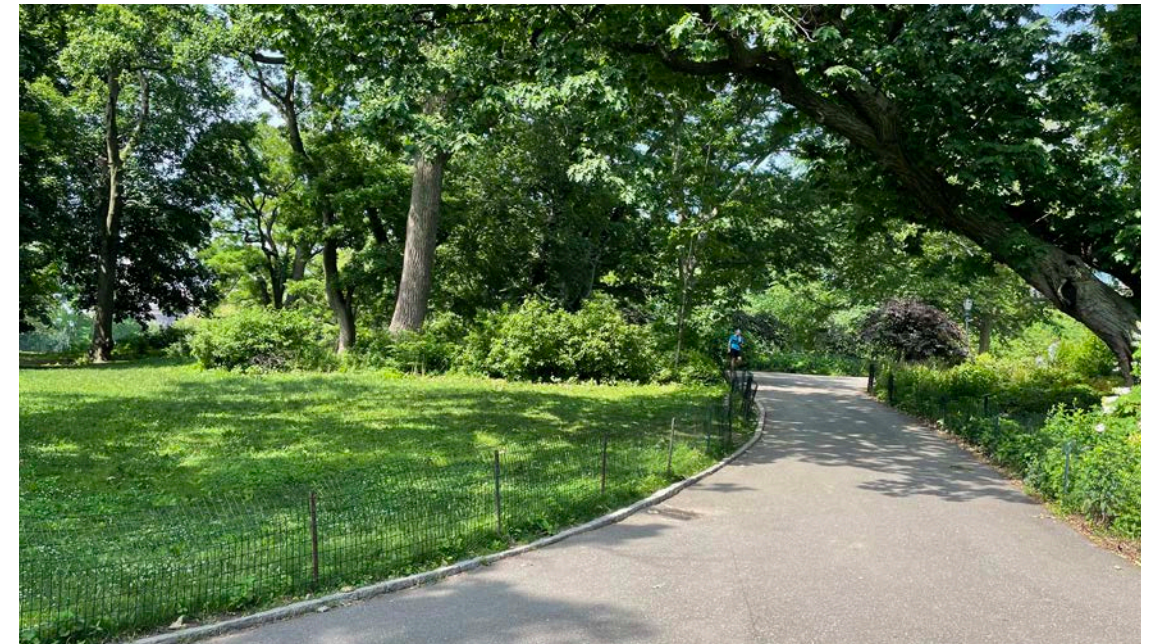

Trees, Lawn, Plantings, and Paths



FORT GREENE PARK | Willoughby Avenue Landscape Site Photos - Similar Treatment



Type B Lamppost w/ Riverside Luminaire



Accessible Drinking Fountain



Granite Block Edging & Asphalt



Settee Bench

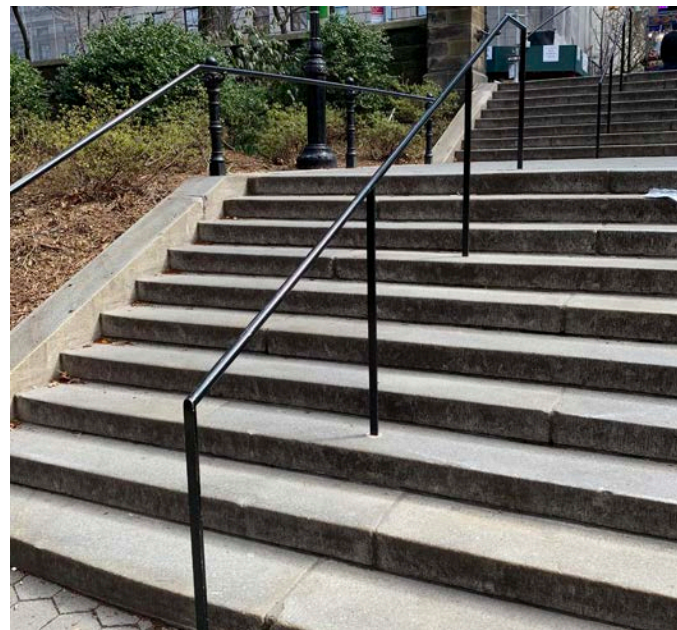

Handrail



SHADE TREES (types vary)



Types of shade trees shall be selected in consultation with NYC Parks Landscape Construction and Forestry Divisions

ORNAMENTAL TREES (types vary)



Witch Hazel 'Arnold's Promise'
-Hamamelis x intermedia

Red Bud
-Cercis Canadensis

Serviceberry
-Amelanchier Canadensis

SHRUBS & LAWN



Shrubs in select locations - Types vary

Lawn



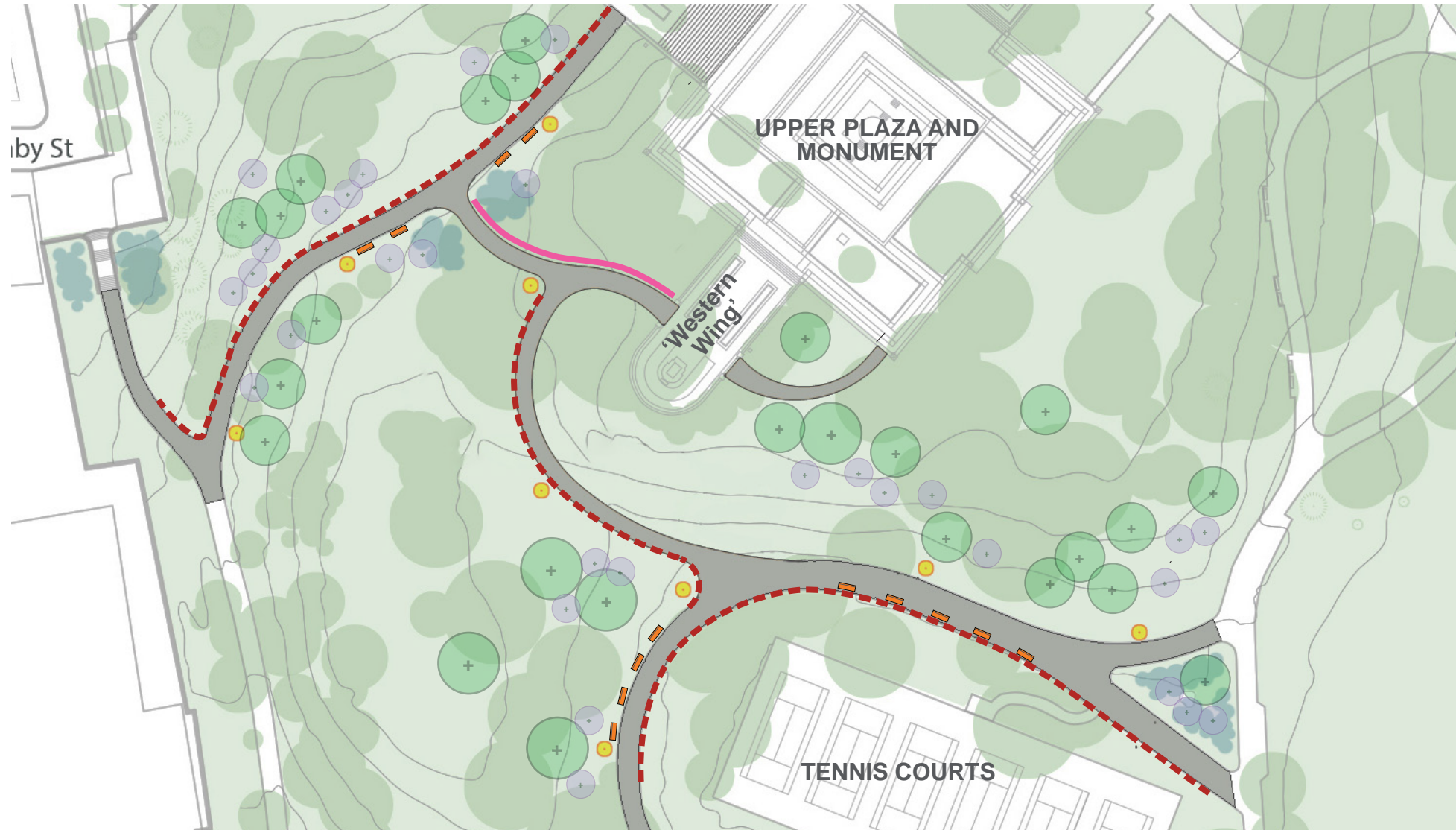

Thank You

APPENDIX



Legend

- Existing Tree
- Tree Removal due to poor condition



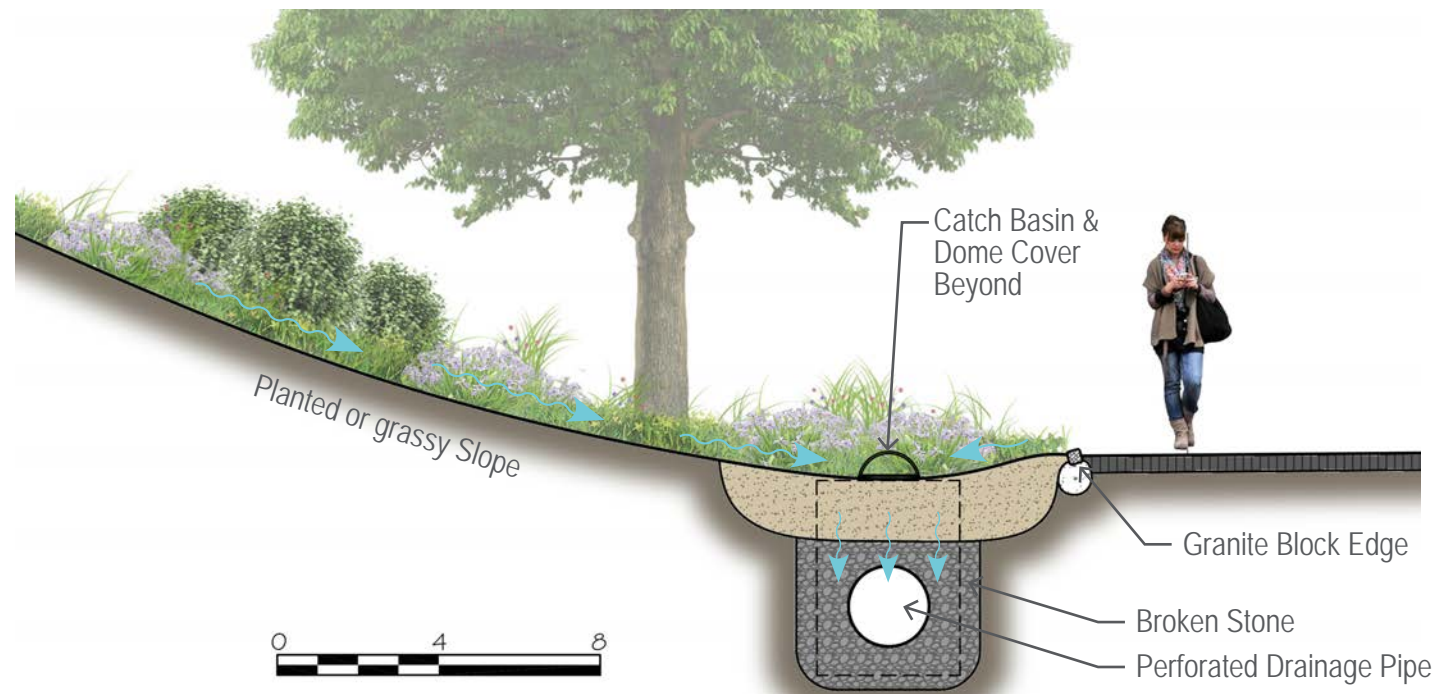

Typical Section - Retention and/or Detention Pipes

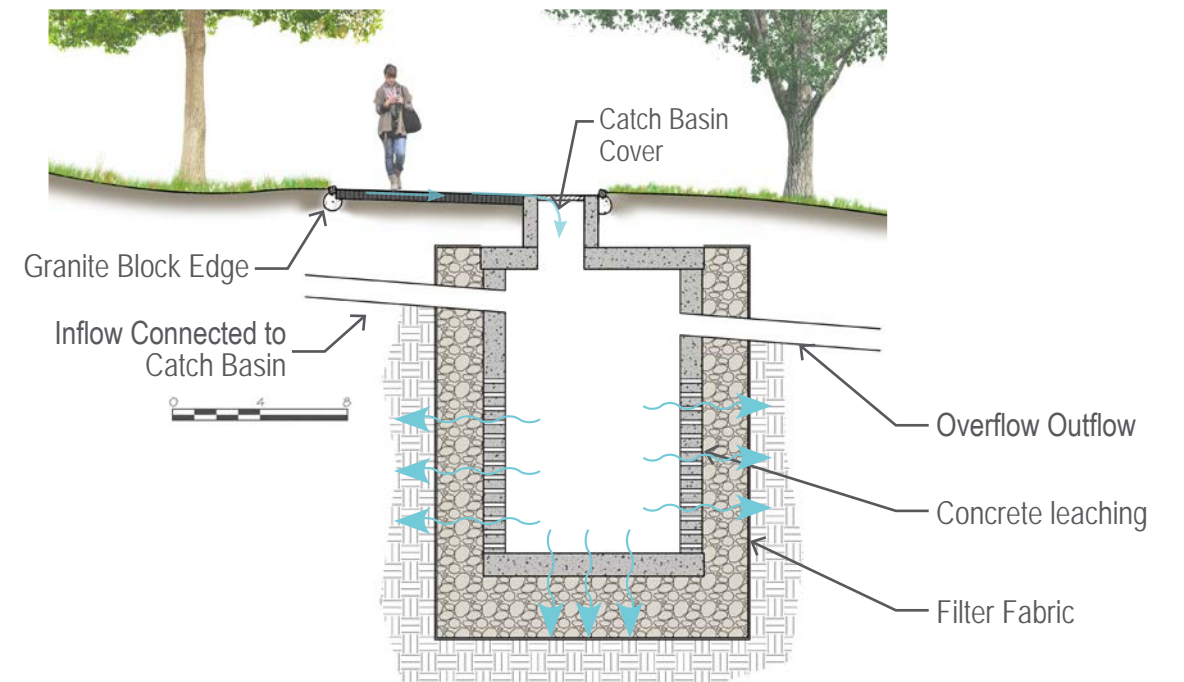

Typical Section - Concrete Dry Well

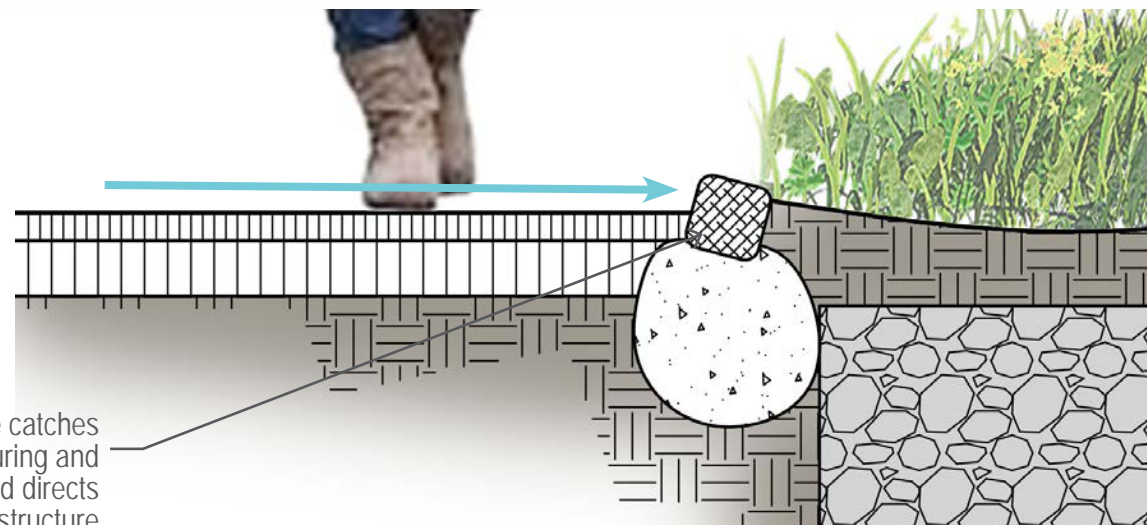

Granite Block Edge catches runoff, prevents scouring and eroding path edges, and directs runoff into green infrastructure stormwater management systems

Typical Section - Granite Block Edge

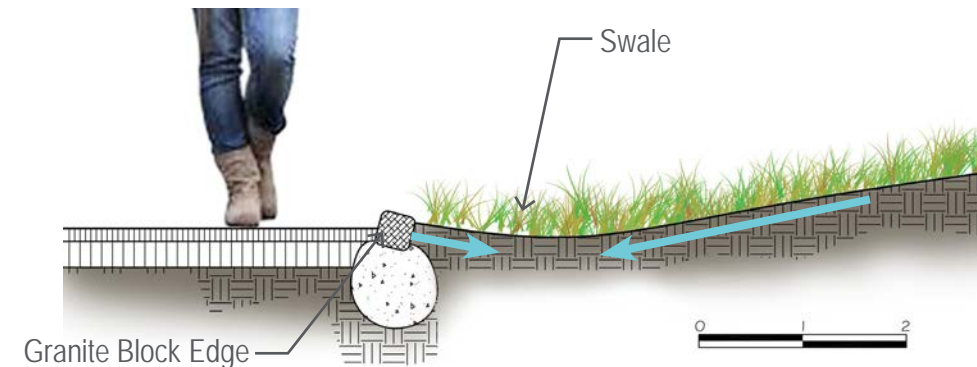

Typical Section - Swale

NOTE:

Details shown are 'typical' details. They are among many green infrastructure practices that may be used to mitigate stormwater and erosion problems throughout the park.

Final green infrastructure practices in this project will be selected based on specific conditions and percolation rates under the direction of NYC Parks' Civil Engineering and DEP Guidelines.



FORT GREENE PARK AREAS





Plaza



Circular Plaza Area



Existing Stair Entrance on Myrtle Avenue



FORT GREENE PARK | Lower Plaza



Monument Stair Landing



Upper Plaza & Prison Ship Martyrs' Monument



FORT GREENE PARK | Monument, Upper plaza, and Monument Stair



'The Oval' and sidewalks



Sidewalks



Olmsted Wall



Gilmore Clarke Wall



FORT GREENE PARK | Perimeter Walls and Sidewalks

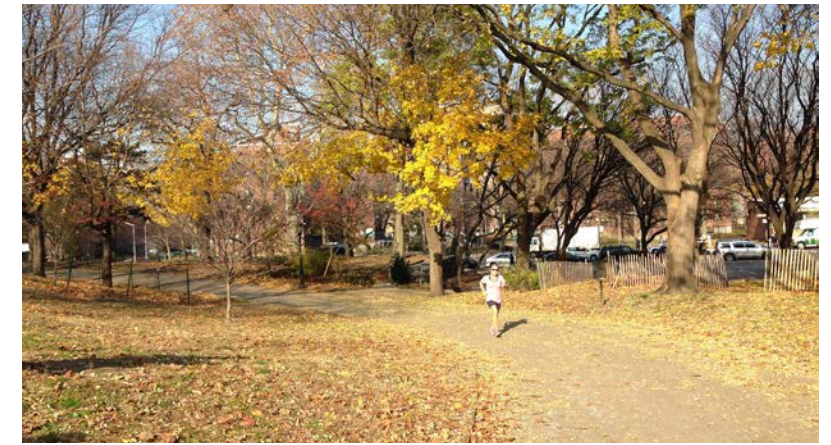

Typical Condition in the pastoral landscape



Typical Condition in the pastoral landscape



Typical Condition in the pastoral landscape



FORT GREENE PARK | Pastoral Landscape/Pleasure Grounds

PREVIOUSLY LPC APPROVED PROJECTS



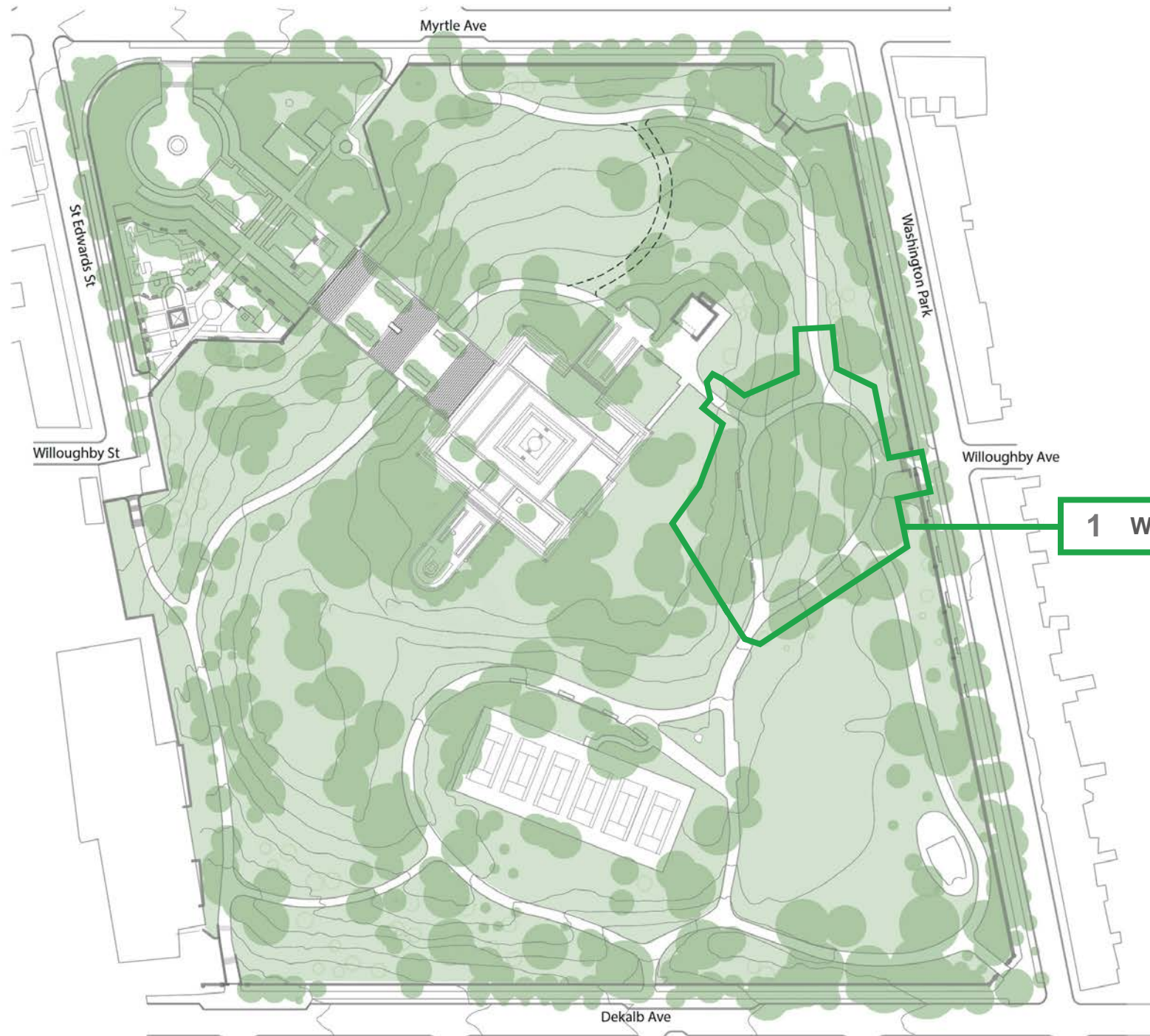

1 WILLOUGHBY AVENUE LANDSCAPE

FORT GREENE PARK PHASE 1:

- Mitigate Erosion and Storm Water problems
- Update and Improve Entrances and pavements



FORT GREENE PARK | Phase I: Willoughby Avenue Landscape - COMPLETED



FORT GREENE PARK PHASE 2a & 2b:

- Mitigate Erosion and Storm Water problems
- Update and Improve Entrances and pavements
- Improve connectivity and accessibility



FORT GREENE PARK | Phase II: Sites 2a & 2b | LPC Approved





FORT GREENE PARK: PARKS WITHOUT BORDERS

- Lower Plaza Reconstruction
- Myrtle Avenue and St. Edwards Street Sidewalks
- DeKalb and Willoughby Street Stair Reconstruction



FORT GREENE PARK | Parks Without Borders (PWB) | LPC Approved



The current proposal is:

Preservation Department – Item 1, LPC-21-09533

**Fort Greene Park,
Borough of Brooklyn**

How to Testify Via Zoom:

<https://us02web.zoom.us/j/87006785024?pwd=ZWw2eFIOMS8vMzRYa0FhNmpCdDRudz09>

Webinar ID: 870 0678 5024

Passcode: 132038

By Phone:
1 646-558-8656 (New York)

US 877-853-5257 (Toll free)

US 888-475-4499 (Toll free)

Note: If you want to testify on an item, join the Zoom webinar at the agenda’s “Be Here by” time (about an hour in advance). When the Chair indicates it’s time to testify, “raise your hand” via the Zoom app if you want to speak (*9 on the phone). Those who signed up in advance will be called first.