



Project # SANDTWOBRR | Borough: Manhattan | Date Issued: 03/05/2025  
The Brooklyn Bridge - Montgomery Coastal Resilience (BMCR) Project is an initiative to provide long-term flood protection on the south side of Manhattan.

## Daytime Parking Restrictions and Traffic Shift on Montgomery St., from South St. to Water St.

Starting March 10, 2025

Ongoing for about six (6) weeks

Monday - Friday, 7:00 am to 4:00 pm

Utility work in the intersection of South St. and Montgomery St. requires daytime closures of Montgomery St. and two-way alternating traffic in the north lane. Pedestrian access available on the south side of Montgomery St. Bicyclists must share the road. For your safety, please follow on-site signage and flaggers. Normal traffic pattern will resume after work hours.

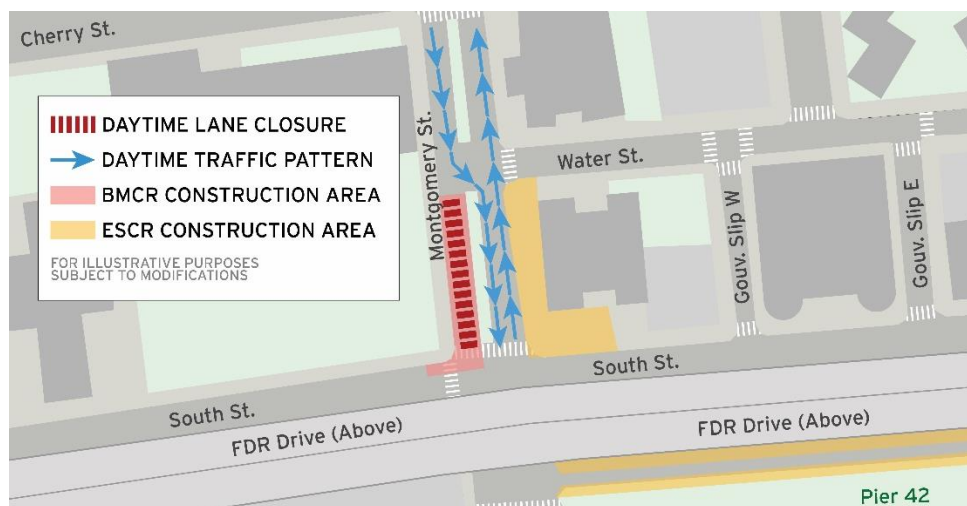

Questions? ¿Preguntas? 问题?

BMCR Community Construction Liaison (CCL) | Email: [bmcr.ccl@gmail.com](mailto:bmcr.ccl@gmail.com)  
Marsha Guido, 347-538-4266

PLEASE NOTE: Due to unforeseen conditions (weather, field conditions, etc.) it may become necessary to change some scheduled work locations and operations. During non-construction hours or emergency situations, please contact the New York City Government Services and Information Hotline at 311 or Universal Emergency Number 911.

