

East Side Coastal Resiliency

Community Board 3
Parks, Recreation, Waterfront and Resiliency
Committee

442 East Houston Street
(PS/MS 188, The Island School)

June 11, 2019



Mayor's Office of
Resiliency

PRESENTATION AGENDA

PROJECT OVERVIEW & SCHEDULE

DESIGN REVIEW

ENVIRONMENTAL REVIEW & APPROVALS

An aerial photograph of a city, likely New York City, showing a dense urban landscape with numerous buildings. A large body of water, the Hudson River, is visible on the right side of the image. A prominent bridge, the Triborough Bridge, spans the river. The image is overlaid with a semi-transparent teal gradient. The text "PROJECT OVERVIEW & SCHEDULE" is centered in the image in a bold, white, sans-serif font.

PROJECT OVERVIEW & SCHEDULE

PROJECT GOALS & ORIGIN

Provide a reliable, integrated flood protection system; minimize use of closure structures.

Improve waterfront open spaces and access.

Achieve implementation milestones and project funding allocations as established by HUD.

Respond quickly to the urgent need for increased flood protection and resiliency.



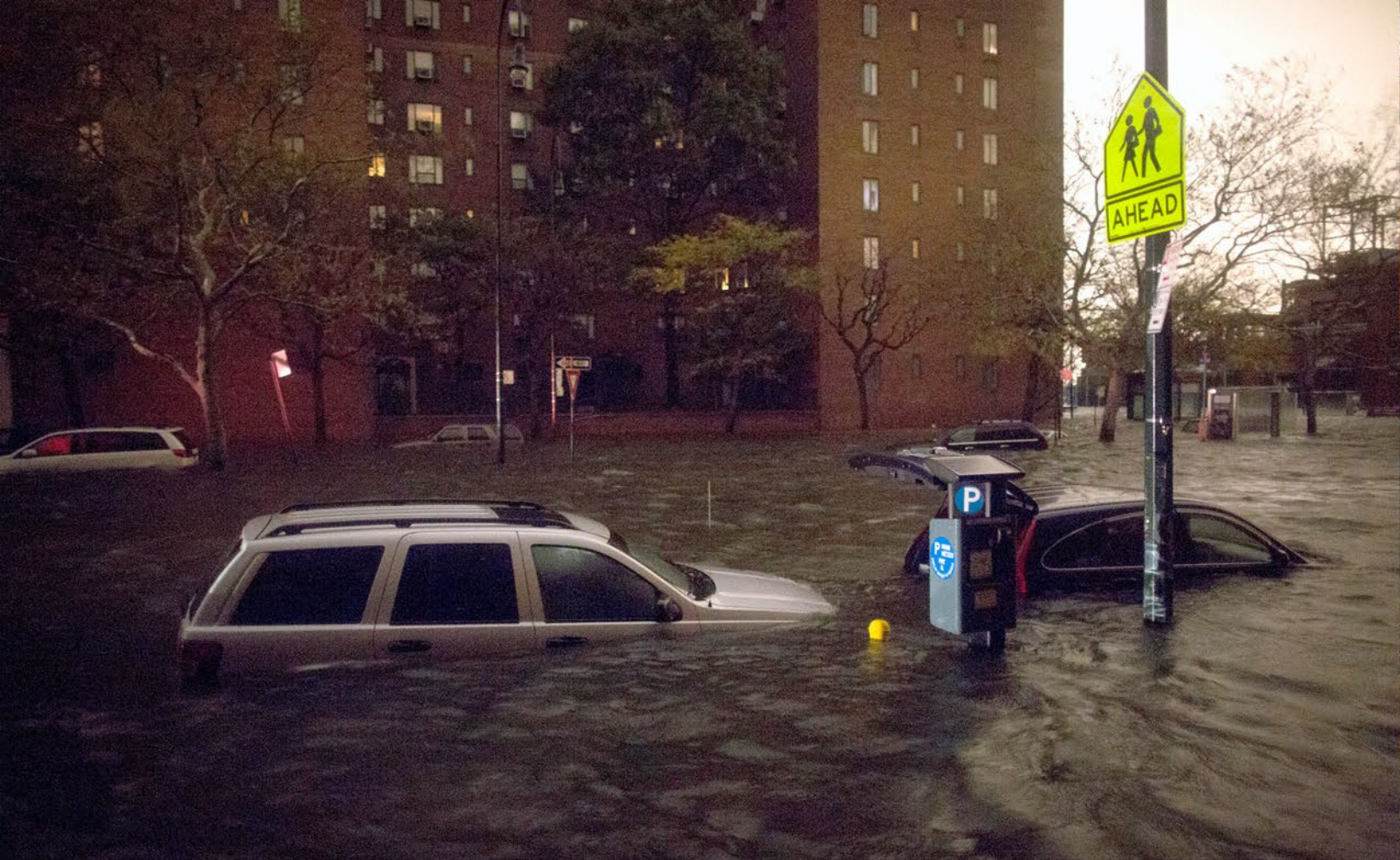

PROVIDE FLOOD PROTECTION



OVERALL PROJECT AREA

PROJECT AREA 1 AND 2



IMPROVED RESILIENCY FOR COMMUNITY

INTEGRATED FLOOD PROTECTION SYSTEM

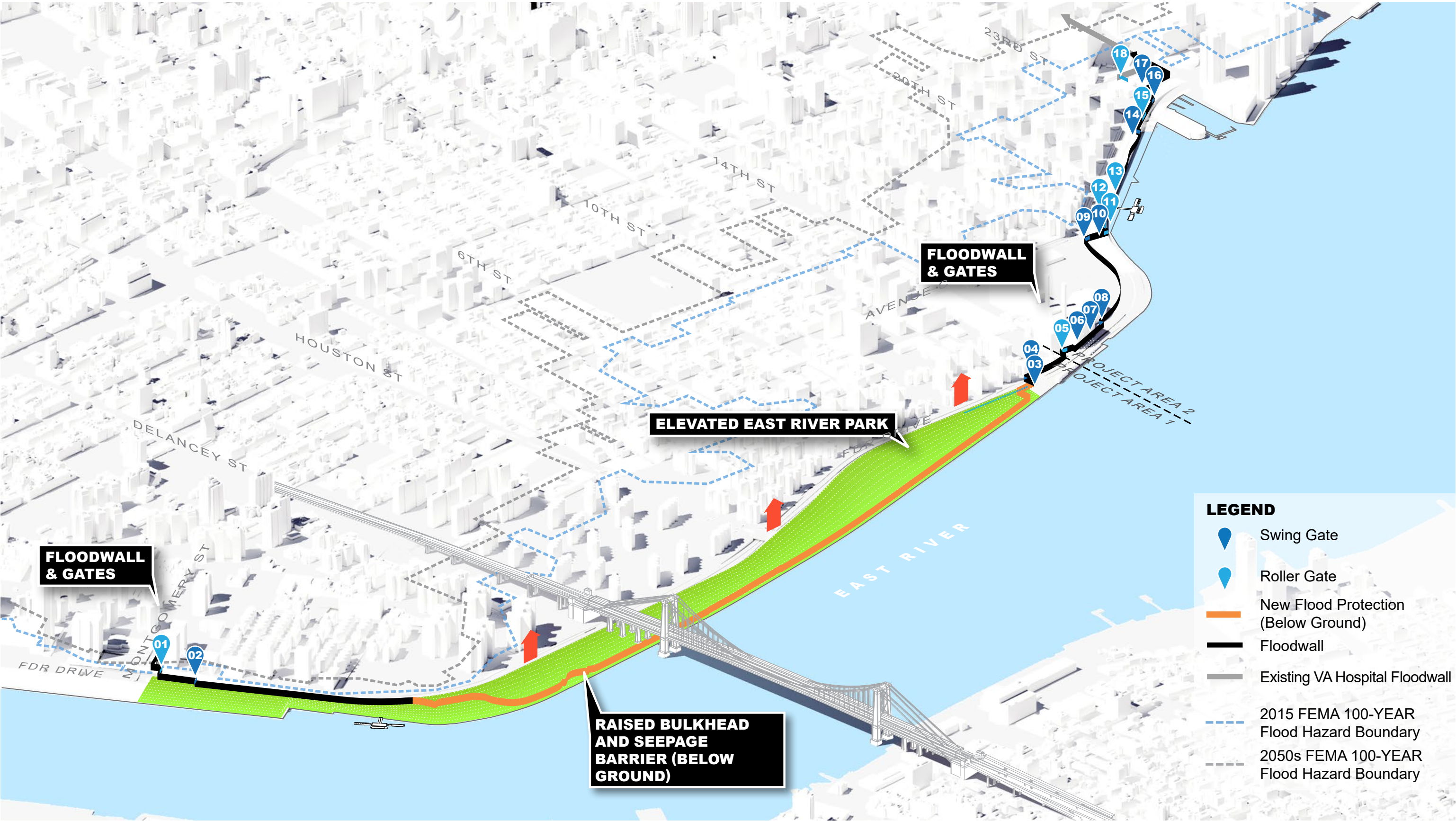

IMPROVED WATERFRONT ACCESS

REPLACING, IMPROVING AND CREATING NEW CONNECTIONS

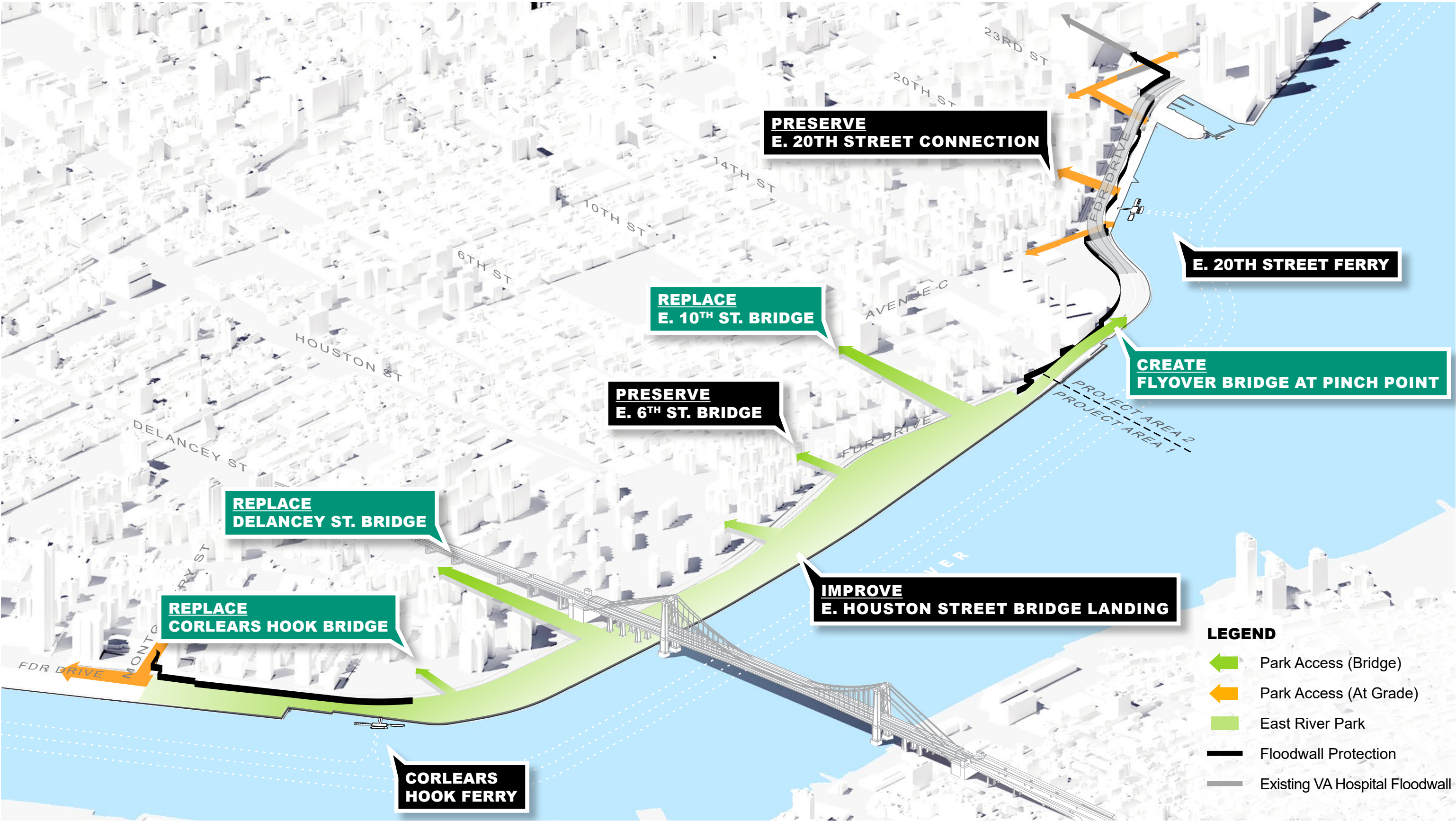

IMPROVED SCHEDULE

OPERABLE SYSTEMS FOR 2023 HURRICANE SEASON

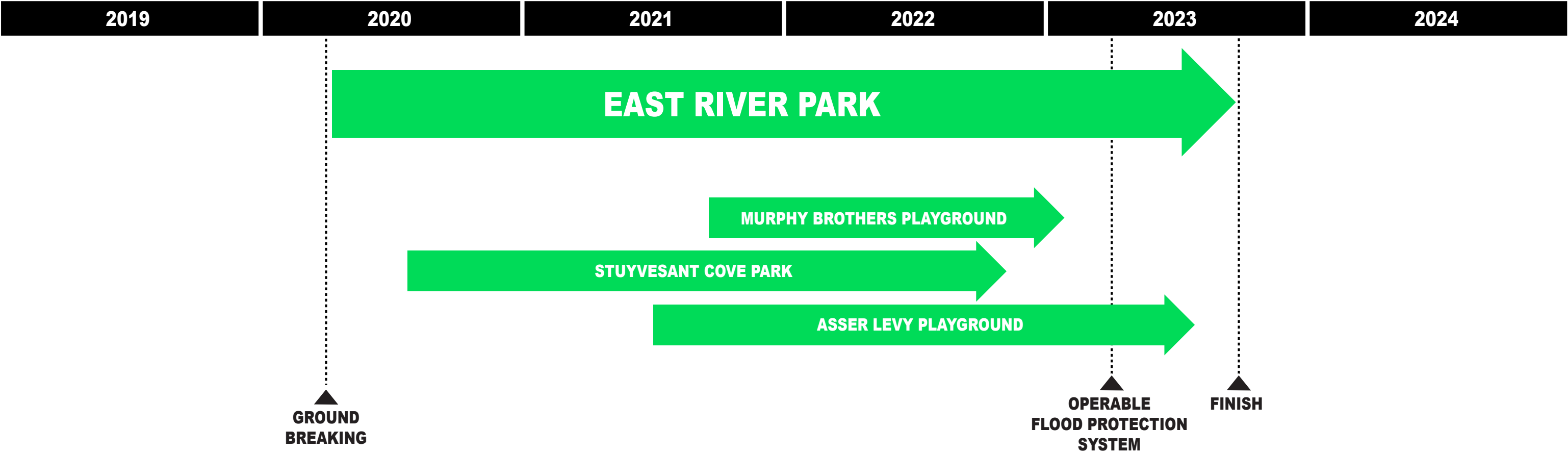

PROJECT SCHEDULE OVERVIEW

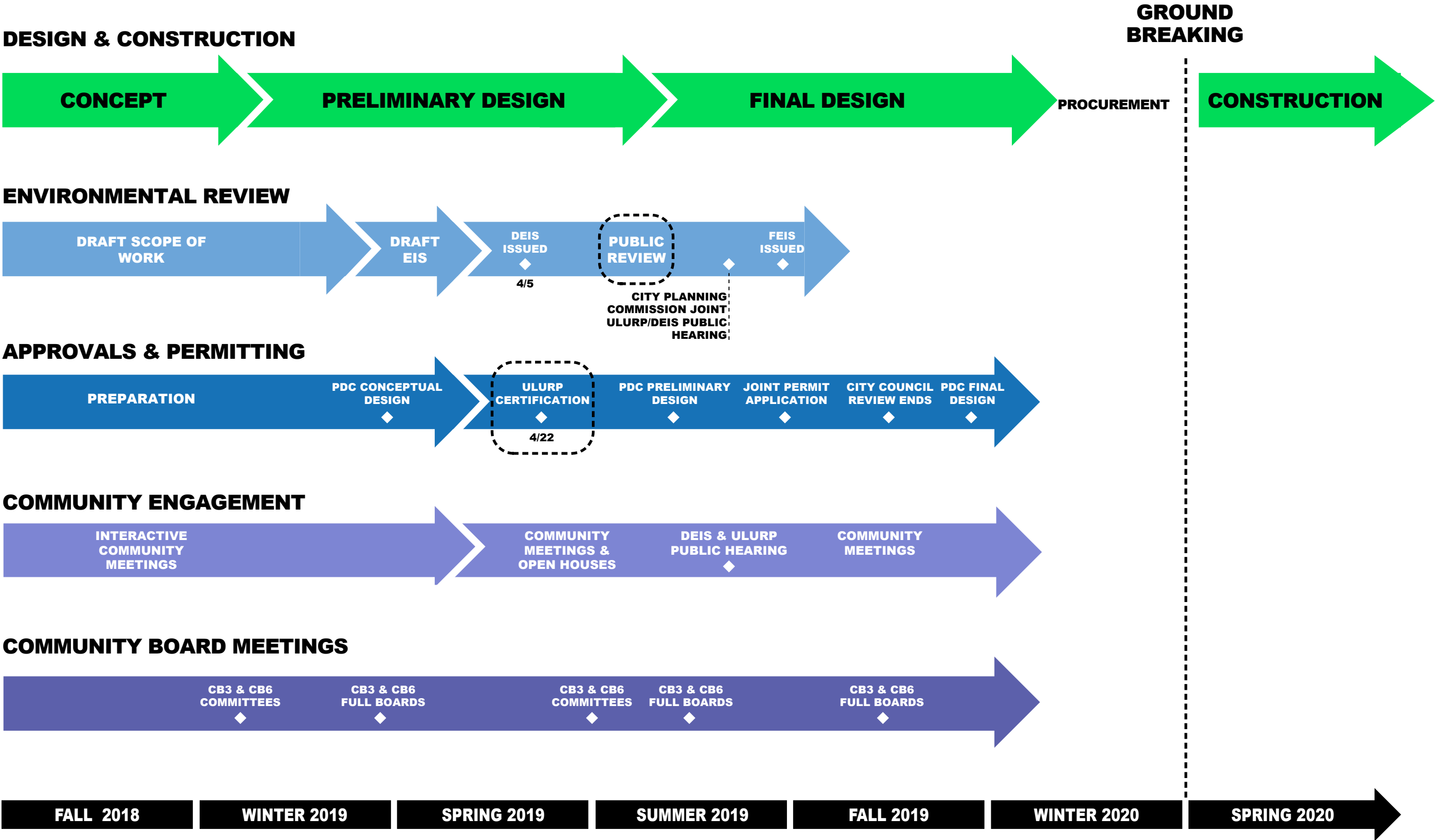

STAKEHOLDER & COMMUNITY ENGAGEMENT

MEETINGS TO DATE

STAKEHOLDER

- LUNGS
- LES READY!
- NYCHA Resident Association Leadership
- New Yorkers for Parks
- Lower East Side Power Partnership
- Regional Plan Association
- Gouverneur Gardens Co-Op Residents
- NYCHA Riis Residents
- NYCHA Baruch Residents
- East River Houses Board & Residents
- NYCHA LES II, V & Bracetti Plaza Residents
- East River Alliance
- Friends of Corlears Hook Park
- NYCHA Lillian Wald Residents
- GOLES
- Public School Athletic League (PSAL)
- Peter Stuyvesant Little League
- Waterside Plaza Tenants Association Leadership
- Waterside Plaza Management
- Stuyvesant Town- Peter Cooper Village Tenants Association
- Solar One
- Peter Cooper Village
- Stuyvesant Town
- Stuyvesant Town-Peter Cooper Village Management
- Design and Programming workshops for Murphy Brothers and Asser Levy Playgrounds
- Multiple Asser Levy Alignment Meetings
- VA Hospital
- NYU Langone
- Large-scale Public Engagement Meetings: Most recent meetings held 12/10/2018; 12/11/2018
- Project Open Houses 05/14/2019 & 05/15/2019
- Grand Street - Town Hall
- Project Open Houses 06/05/19 & 06/06/19
- Various other targeted Stakeholder Meetings

ELECTED OFFICIAL AND COMMUNITY BOARD MEETINGS

- Borough President Brewer
- Council Member Chin
- Council Member Rivera
- Council Member Powers
- Assembly Member Niou
- Assembly Member Epstein
- Senator Hoylman
- Senator Kavanaugh
- Representative Maloney
- Representative Velazquez
- CB3 Parks/Waterfront Committee
- CB3 Full Board
- CB6 Land Use/Waterfront Committee
- CB6 Full Board
- CB6 Working Group
- CB3/CB6 Joint Waterfront Task Force

An aerial photograph of a city, likely New York City, showing a dense urban grid. A large river, the Hudson River, flows along the right side of the image. A prominent suspension bridge, the George Washington Bridge, spans the river. Along the riverbank, there are several green sports fields, including baseball diamonds and soccer fields. The city buildings are visible in the background, and the overall scene is overlaid with a semi-transparent teal color.

DESIGN REVIEW

PROJECT AREA 1

EAST RIVER PARK OVERVIEW

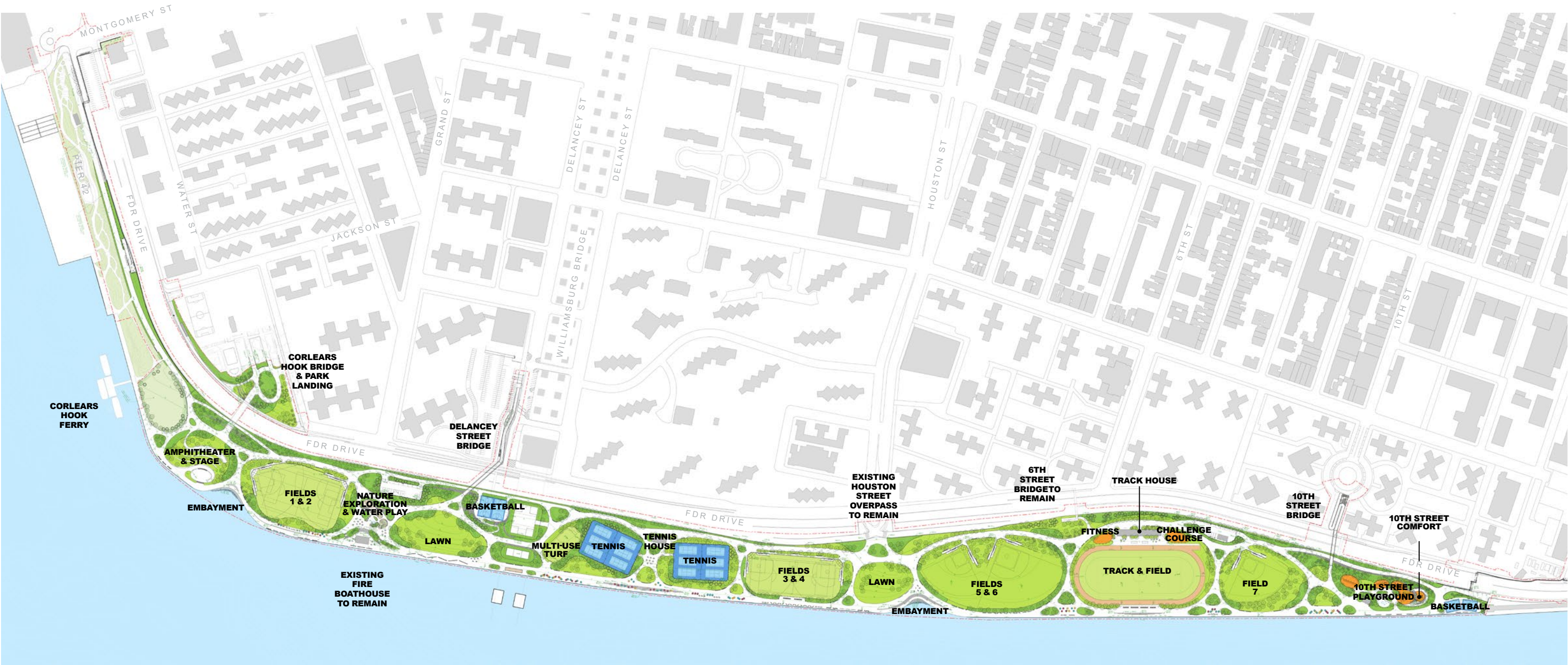

PIER 42 AREA

PRELIMINARY DESIGN

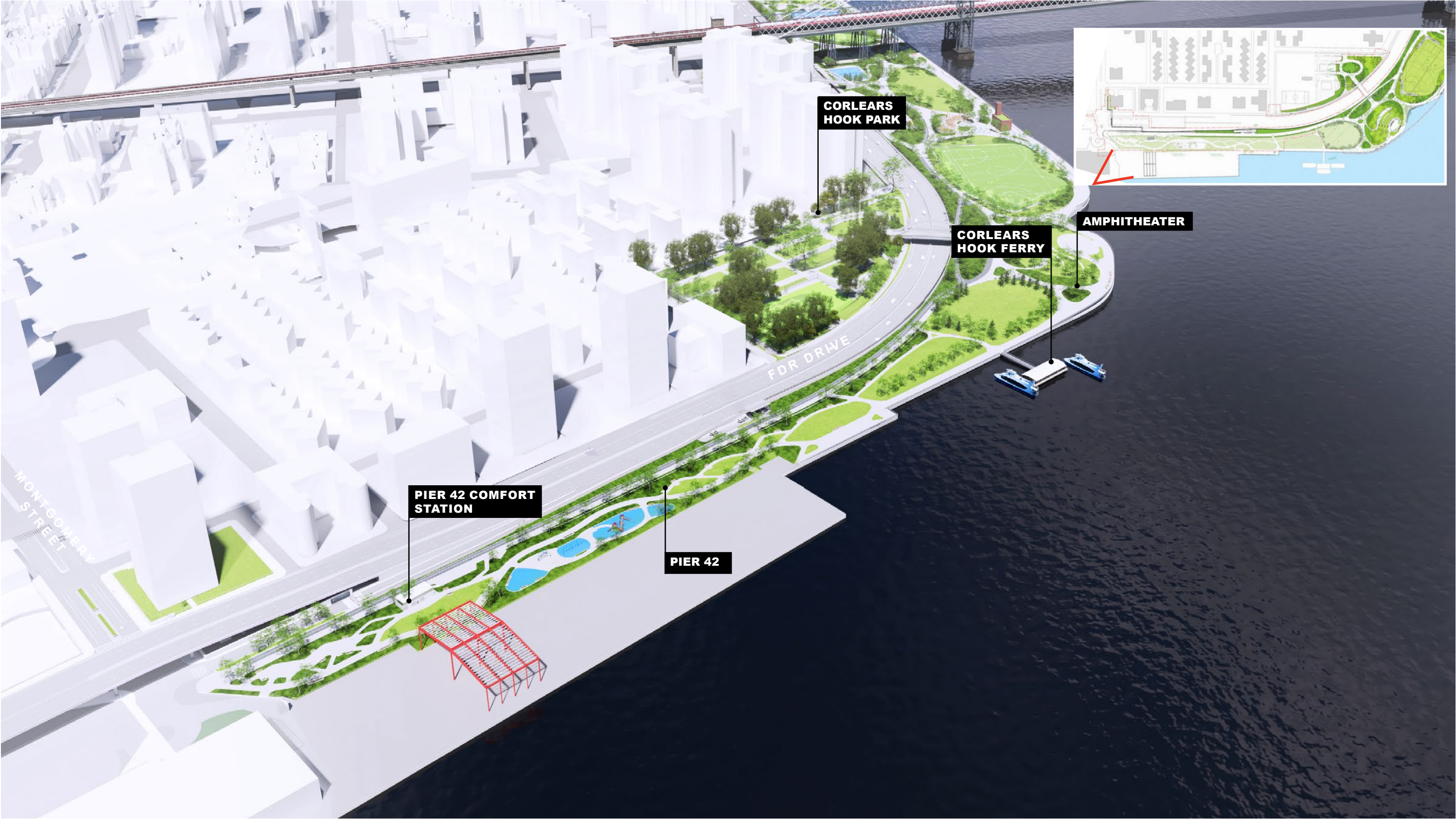

MONTGOMERY STREET

FLOOD GATE IN OPEN POSITION



FLOODWALL
TOP OF WALL: EL. +16.5
WALL HT: APPROX. 1.5'

FLOODWALL
TOP OF WALL: EL. +16.5
WALL HT: APPROX. 4.5'

**FLOOD GATE IN
OPEN POSITION**

**DESIGN TEAM IS STUDYING
FLOODWALL FINISHES**

MONTGOMERY STREET

FLOOD GATE IN CLOSED POSITION



CORLEARS HOOK TO DELANCEY STREET

PRELIMINARY DESIGN



AMPHITHEATER

PRELIMINARY DESIGN

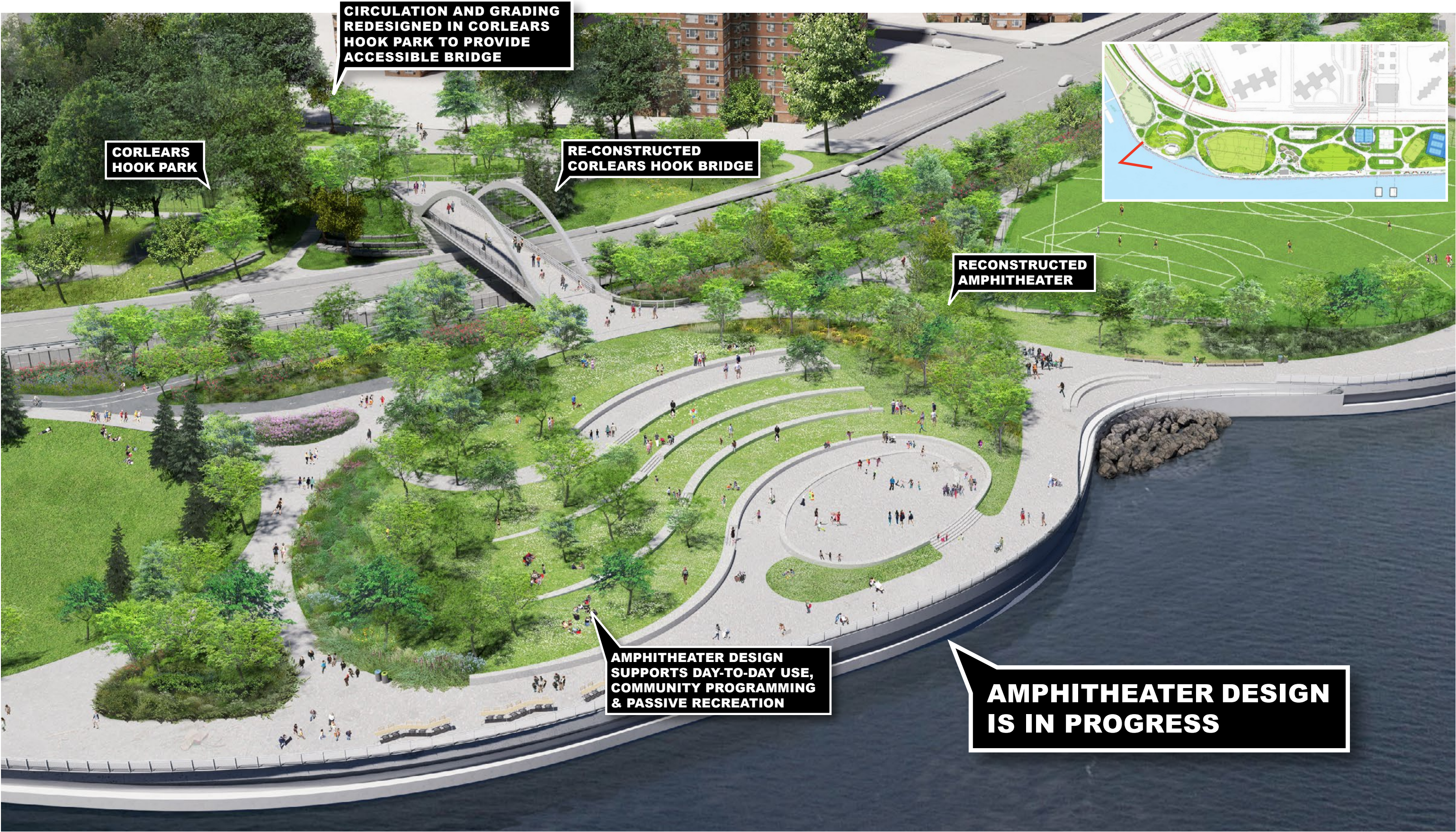

CIRCULATION AND GRADING
REDESIGNED IN CORLEARS
HOOK PARK TO PROVIDE
ACCESSIBLE BRIDGE

CORLEARS
HOOK PARK

RE-CONSTRUCTED
CORLEARS HOOK BRIDGE

RECONSTRUCTED
AMPHITHEATER

AMPHITHEATER DESIGN
SUPPORTS DAY-TO-DAY USE,
COMMUNITY PROGRAMMING
& PASSIVE RECREATION

AMPHITHEATER DESIGN
IS IN PROGRESS

AMPHITHEATER

PERSPECTIVE VIEW



**AMPHITHEATER DESIGN
IS IN PROGRESS**

NATURE EXPLORATION

PRELIMINARY DESIGN



DELANCEY BRIDGE

PRELIMINARY DESIGN



HOUSTON STREET

PRELIMINARY DESIGN

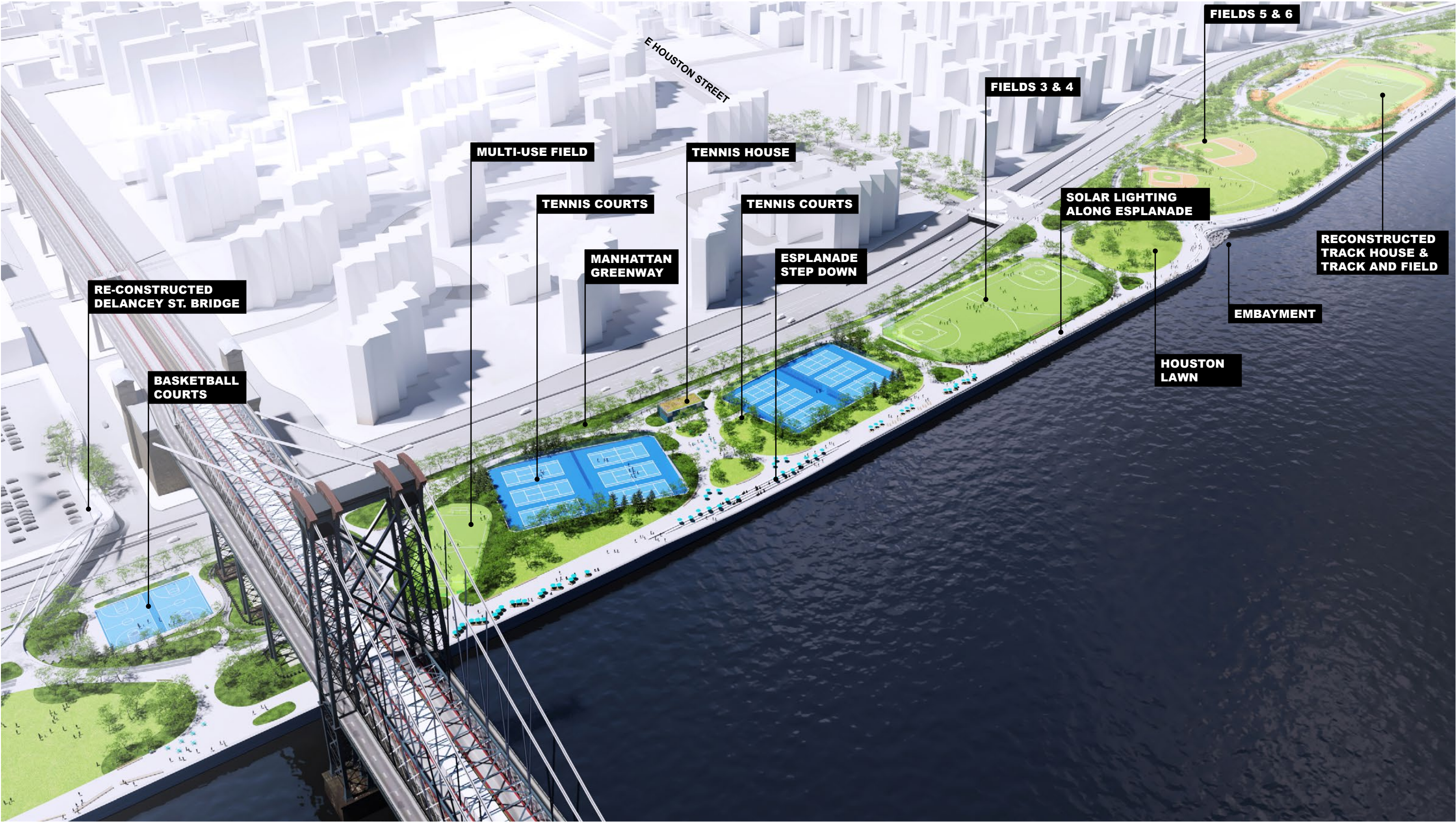

TENNIS HOUSE

PRELIMINARY DESIGN



FDR AT BARUCH HOUSES

PERSPECTIVE VIEW



HOUSTON STREET

PRELIMINARY DESIGN



HOUSTON STREET CONNECTION

PRELIMINARY DESIGN



ESPLANADE EMBAYMENT

PRELIMINARY DESIGN



TRACK & EAST 10TH STREET

PRELIMINARY DESIGN



TRACK HOUSE AND FITNESS AREA

PRELIMINARY DESIGN

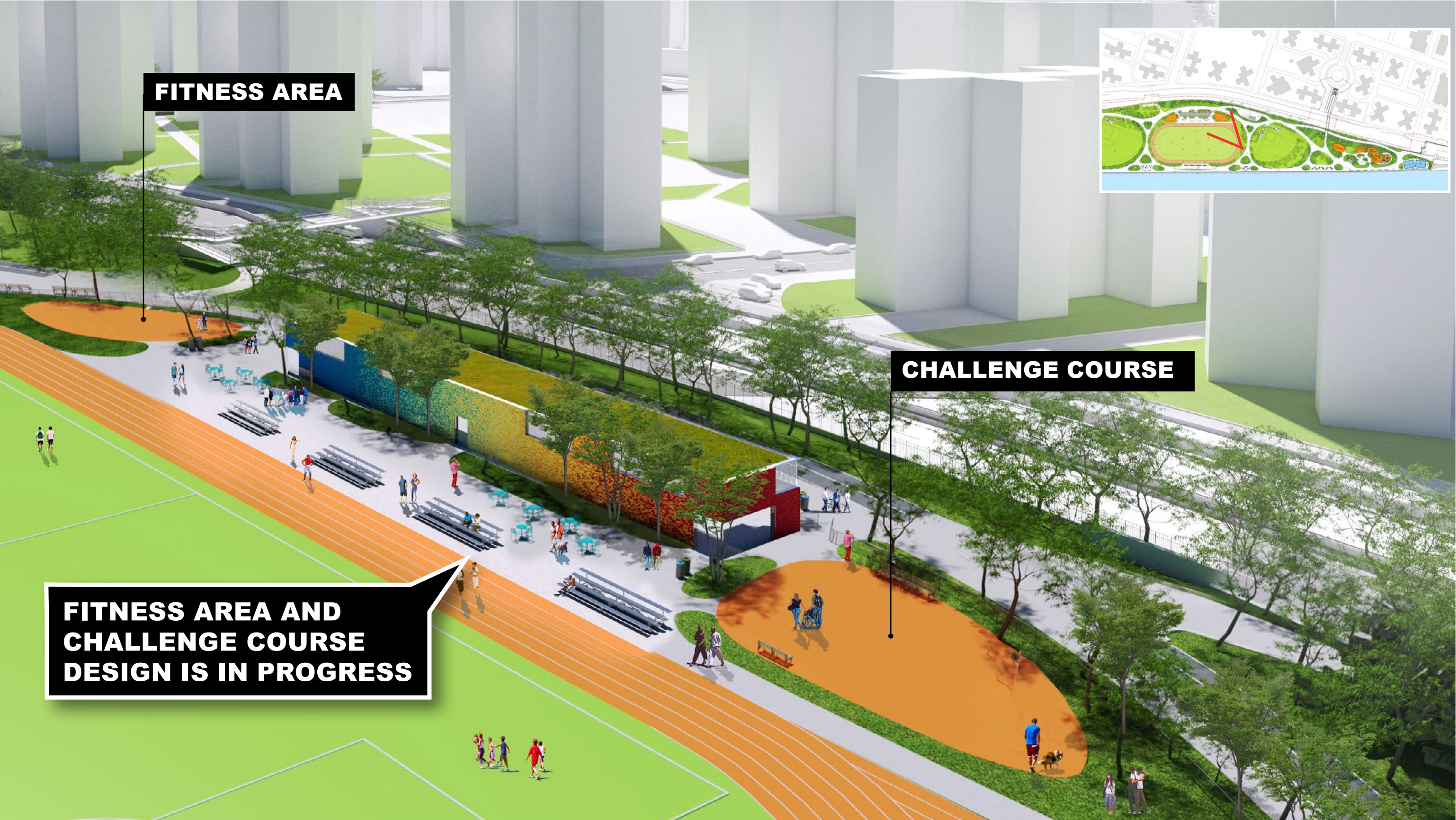

FITNESS AREA

CHALLENGE COURSE

**FITNESS AREA AND
CHALLENGE COURSE
DESIGN IS IN PROGRESS**

10TH STREET BRIDGE

PRELIMINARY DESIGN



FLYOVER BRIDGE

PRELIMINARY DESIGN



PROJECT AREA 2

PRELIMINARY DESIGN



MURPHY BROTHERS PLAYGROUND

PRELIMINARY DESIGN



STUYVESANT COVE PARK

PRELIMINARY DESIGN



ASSER LEVY PLAYGROUND

PRELIMINARY DESIGN



ENHANCING DRAINAGE INFRASTRUCTURE

INTERIOR DRAINAGE SYSTEM COMPONENTS AND DESIGN CRITERIA

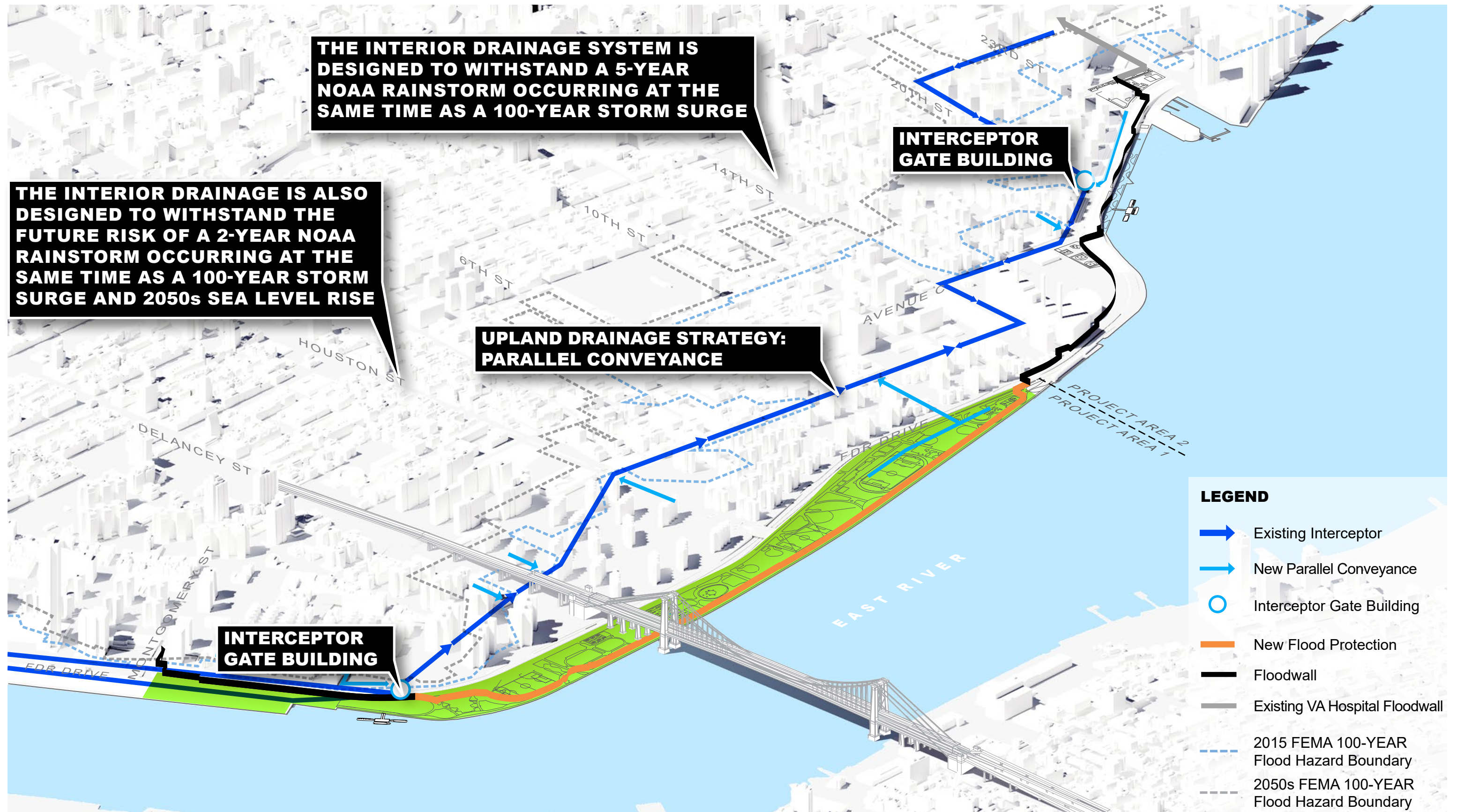

IMPROVED DRAINAGE

SOUTH INTERCEPTOR GATE CHAMBER BUILDING

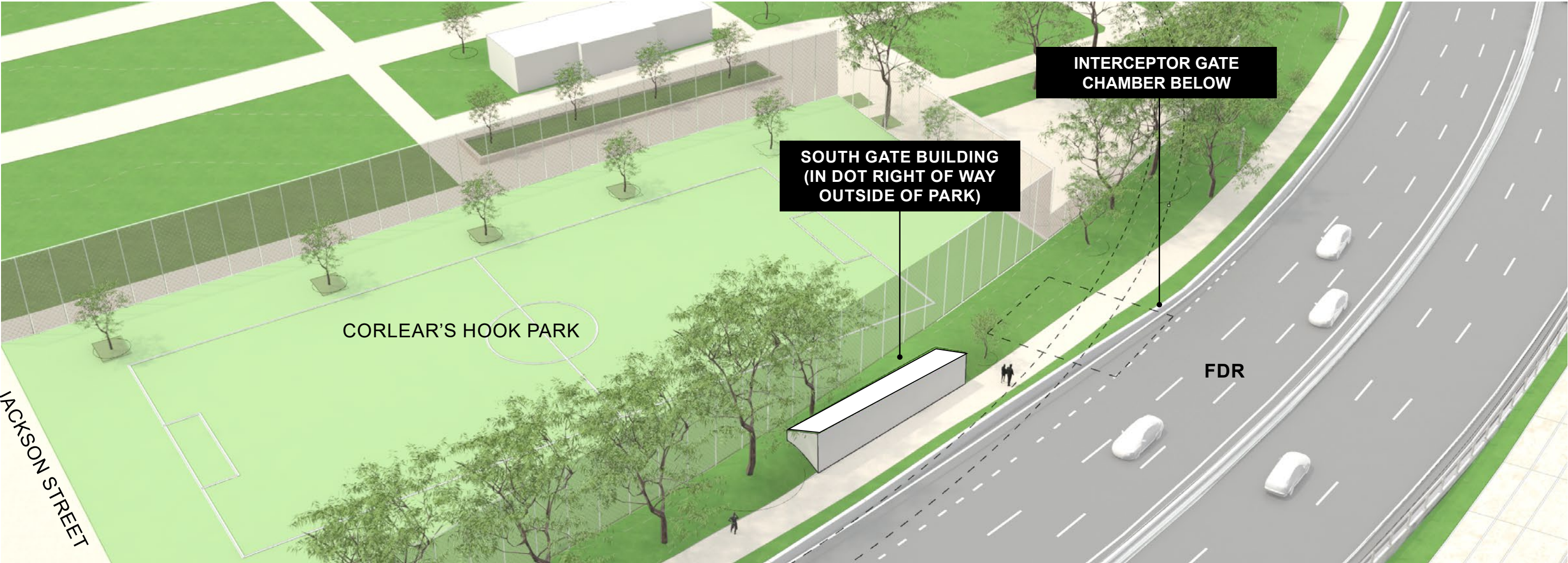

SOUTH GATE BUILDING

SITE PLAN

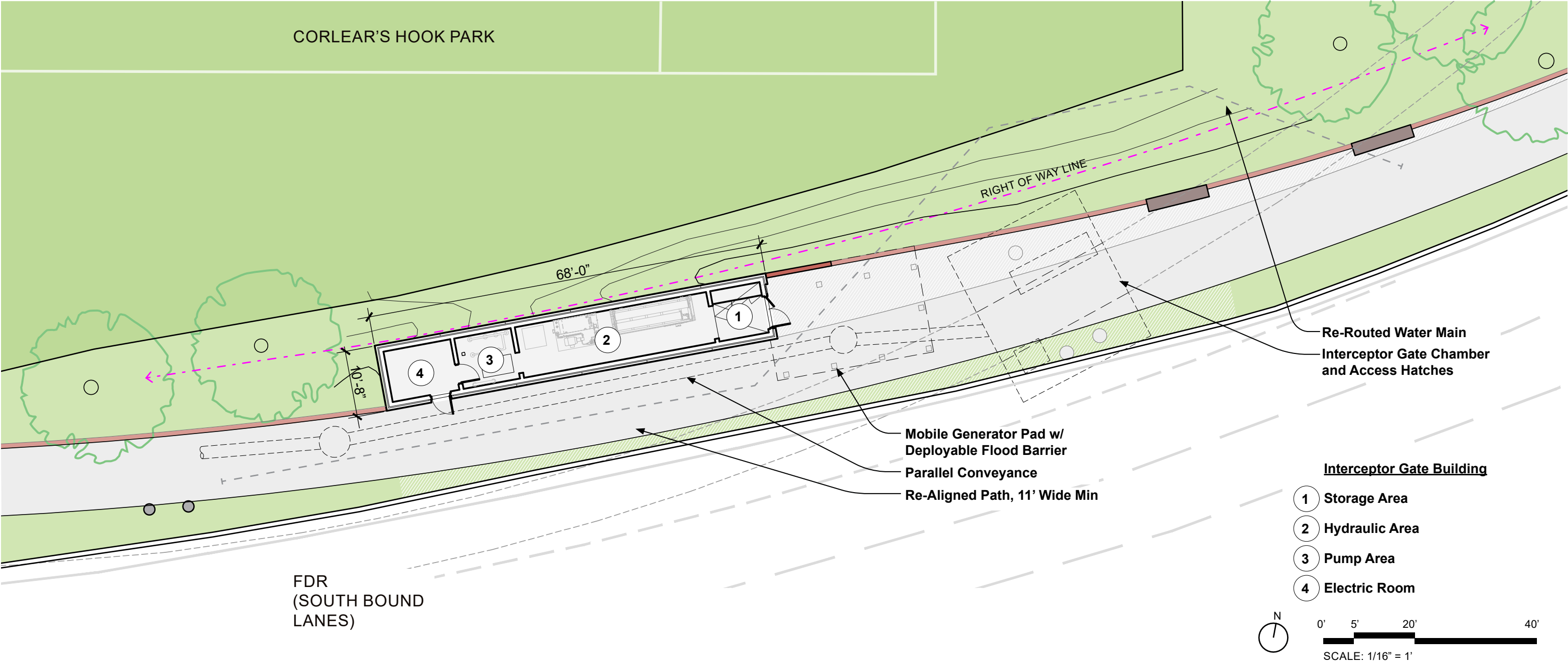

SOUTH GATE BUILDING

PERSPECTIVE VIEW FROM NORTH



An aerial photograph of a city, likely New York City, showing a dense urban area with a river and a bridge. The image is overlaid with a teal gradient. The text "ENVIRONMENTAL REVIEW & APPROVALS" is centered in white, bold, sans-serif font.

ENVIRONMENTAL REVIEW & APPROVALS

ENVIRONMENTAL REVIEW STANDARDS

COORDINATED ENVIRONMENTAL REVIEW UNDER 3 STATUTES:

Environmental Impact Statement (EIS) will satisfy requirements of all three statutes

- National Environmental Policy Act (NEPA)
- State Environmental Quality Review Act (SEQRA)
- City Environmental Quality Review (CEQR)

LEAD AGENCIES:

Environmental review coordinated by head agencies, with cooperating, involved and interested Federal, State and City agencies

- NEPA - NYC Office of Management and Budget
- SEQRA/CEQR - Department of Parks & Recreation

OVERVIEW OF EIS ALTERNATIVES

ALTERNATIVE 1: No Action Alternative

ALTERNATIVE 2: Flood Protection System on the West Side of East River Park – Baseline

ALTERNATIVE 3: Flood Protection System on the West Side of East River Park – Enhanced Park and Access

**ALTERNATIVE 4: Flood Protection System with a Raised East River Park
(Preferred Alternative)**

ALTERNATIVE 5: Flood Protection System East of FDR Drive

UNIFORM LAND USE REVIEW PROCEDURE

PROPOSED ACTIONS

ACQUISITION (EASEMENTS):

Project Area One

- Gouverneur Gardens Cooperative
- East River Housing Corporation
- NYCHA (Riis Houses and Baruch Houses)

Project Area Two

- Con Edison – For Operations & Maintenance of the Flood Protection System
 - Con Edison Power Station
 - Con Edison Office and Parking Lot
- VA Medical Center – For Operations & Maintenance of the Flood Protection System
 - VA Hospital
- Captain Patrick J. Brown Walk – For Construction of the Flyover Bridge

A zoning text amendment is necessary to acknowledge compliance of the proposed design with the City's Zoning regulations for a portion of the project area

City Map change (anticipated at a later date) for reconstruction of pedestrian bridges.

DEIS IMPACT ANALYSIS OVERVIEW

DEIS OPERATIONAL ANALYSES

- Land Use, Zoning, and Public Policy (Ch. 5.1)
- Socioeconomics (Ch. 5.2)
- Open Space (Ch. 5.3)
- Historic and Cultural Resources (Ch. 5.4)
- Urban Design and Visual Resources (Views)** (Ch. 5.5)
- Natural Resources (Ch. 5.6)
- Hazardous Materials (Ch. 5.7)
- Water and Sewer Infrastructure (Ch. 5.8)
- Transportation (Ch. 5.9)
- Neighborhood Character (Ch. 5.10)
- Environmental Justice (Ch. 5.11)

**Potential for Significant Adverse Effects*

***Unavoidable*

DEIS CONSTRUCTIONAL ANALYSES

- Socioeconomics (Ch. 6.1)
- Open Space** (Ch. 6.2)
- Historic and Cultural Resources (Ch. 6.3)
- Urban Design and Visual Resources (views) (Ch. 6.4)
- Natural Resources (Ch. 6.5)
- Hazardous Materials (Ch. 6.6)
- Water and Sewer Infrastructure (Ch. 6.7)
- Energy (Ch. 6.8)
- Transportation* (Ch. 6.9)
- Air Quality (Ch. 6.10)
- Greenhouse Gas Emissions (Ch. 6.11)
- Noise and Vibration** (Ch. 6.12)
- Public Health (Ch. 6.13)

DETOUR ROUTE DURING CONSTRUCTION

SOUTHBOUND CYCLISTS WISHING TO TRAVEL BEYOND 23RD STREET SHOULD USE THE PROTECTED BIKE LANES ON 2ND AVENUE

STUYVESANT COVE FERRY ACCESS WILL BE MAINTAINED ON 20TH STREET

NORTHBOUND CYCLISTS: ALLEN STREET OR CLINTON STREET TO DELANCEY STREET TO R

The map displays the Lower Manhattan area, highlighting the FDR Drive and the FDR Expressway. Key streets shown include E 1st St through E 34th St, and various cross streets like Bowery, Canal St, and Grand St. The map also indicates the locations of the Brooklyn Bridge, Manhattan Bridge, and Williamsburg Bridge. The FDR Drive is shown with a green line, and the FDR Expressway is shown with an orange line. The map includes callouts for 'SOUTHBOUND CYCLISTS WISHING TO TRAVEL BEYOND 23RD STREET SHOULD USE THE PROTECTED BIKE LANES ON 2ND AVENUE' and 'STUYVESANT COVE FERRY ACCESS WILL BE MAINTAINED ON 20TH STREET'. A third callout at the bottom right indicates 'NORTHBOUND CYCLISTS: ALLEN STREET OR CLINTON STREET TO DELANCEY STREET TO R'.

- [illegible]

- CONVENTIONAL BIKE LANE
 - SHARED LANE

NYC PARKS ANTICIPATED NEIGHBORHOOD IMPROVEMENTS

PARK UPGRADES



SPORTS COATING



RAIN GARDENS



TREE PLANTING



PAINTING



ASPHALT TO TURF



SOLAR FIELD LIGHTS

NYC PARKS ANTICIPATED NEIGHBORHOOD IMPROVEMENTS

MORE PROGRAMMING AND NEW PARK SPACES



ACCOMMODATING FIELD USERS



LAGUARDIA BATH HOUSE



MORE RECREATIONAL PROGRAMMING



PIER 42 PHASE 1: UPLAND PARK



MORE NEIGHBORHOOD PARK STAFF



PIER 35

NIGHT WORK CONSTRUCTION



NOTE: PRELIMINARY/IN-PROCESS AND SUBJECT TO CHANGE

NEXT STEPS: PUBLIC INPUT TO THE EIS/ULURP PROCESSES

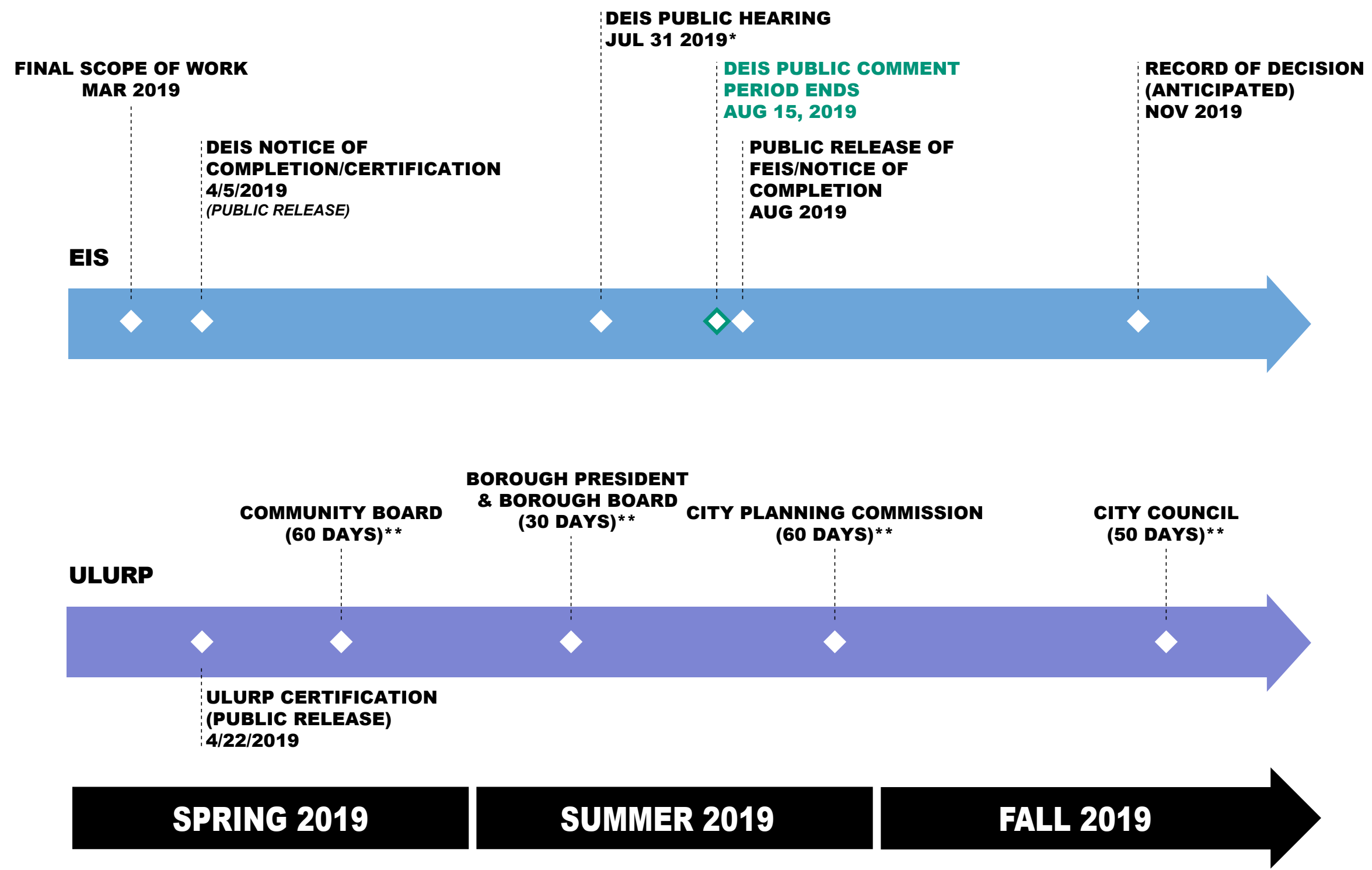

* DEIS COMMENT PERIOD EXTENDS 15 DAYS AFTER PUBLIC HEARING
** INCLUDES PUBLIC HEARING

Website

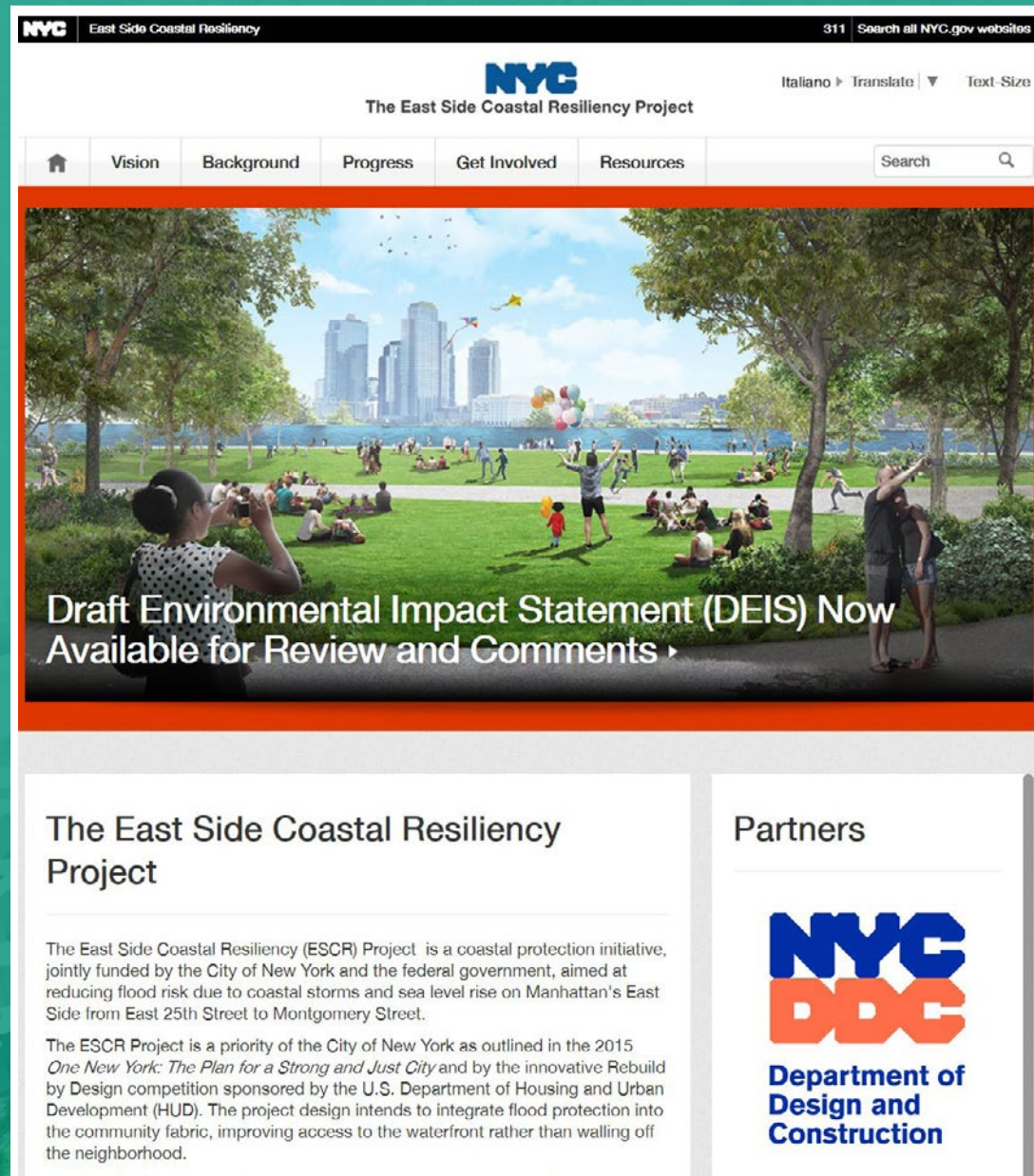

Visit Us!
www.nyc.gov/escr
Twitter: @NYClimate