



**Parks**

# Mount Prospect Park Skate Garden

Located near Eastern Parkway and Flatbush Avenue  
Borough of Brooklyn

PDC Preliminary Review  
March 23, 2026

EDC, NYC Parks, The Skatepark Project, Arcadis / MNLA

**Total**                      \$11.164m  
**Budget:**

**Project Size:**      Skate Garden Hardscape: 19,500 sf  
                                 Access Pathway:                      1,400 sf  
                                 Interior Planting:                      2,500 sf  
                                 Perimeter Planting:                      6,000 sf

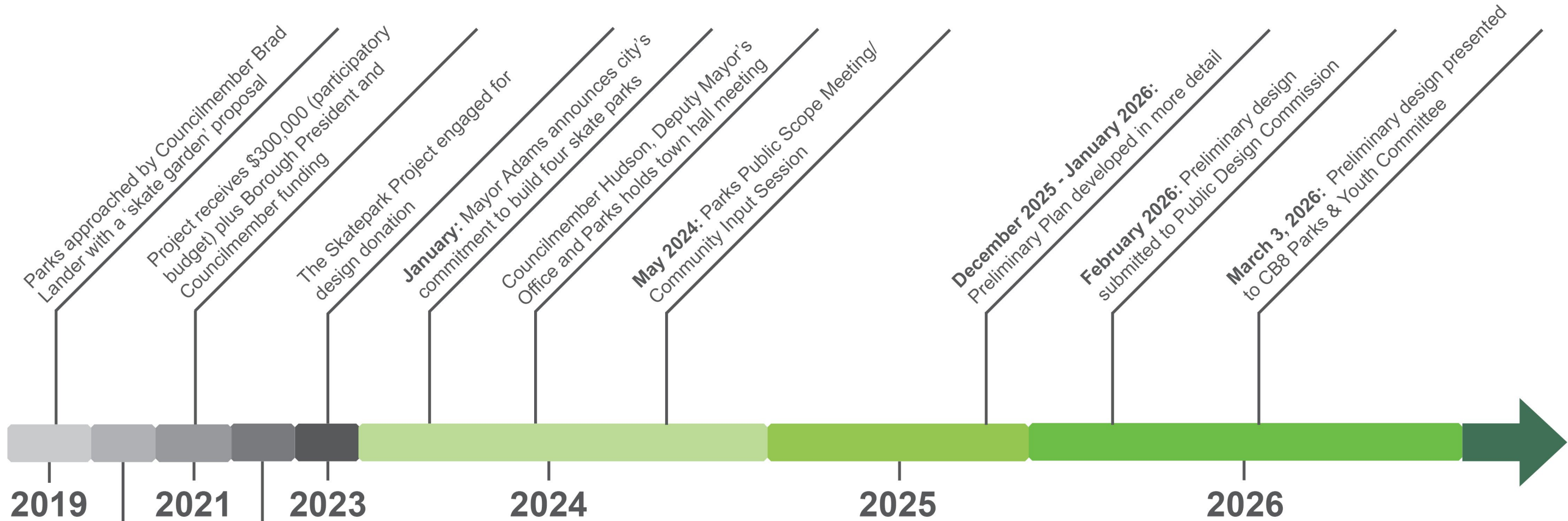

**Anticipated Schedule:**

- 2/27/26 - PDC Preliminary Submission
- 3/3/26 - CB8 Parks & Youth Committee Meeting
- 3/23/26 - PDC Preliminary Presentation
- 4/7/26 - CB8 Parks & Youth Committee Meeting
- 4/9/26 - CB8 Full Board Meeting
- Q3 2026 - PDC Final Review
- Q4 2026 - Contractor Procurement
- Q1 2027 - Anticipated Construction Start



**NOTE:**

**There are no skateparks within a 5-10 min walk.**

**The closest skate parks are located in:**

- **Brower Park**
- **Golconda Park**
- **Washington Park**

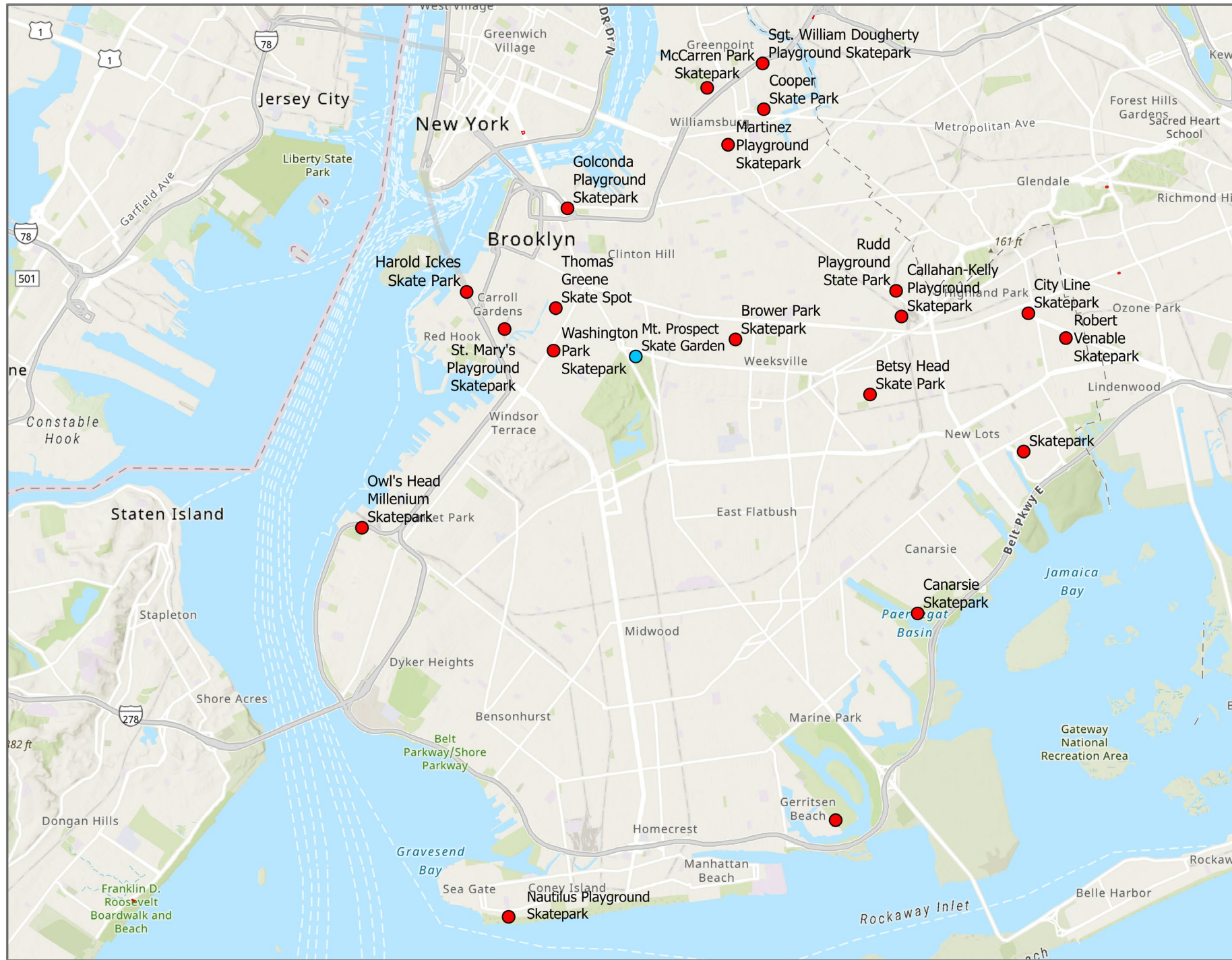

NYC Parks

## Mount Prospect Park Skate Garden | Brooklyn Skate Park Locations



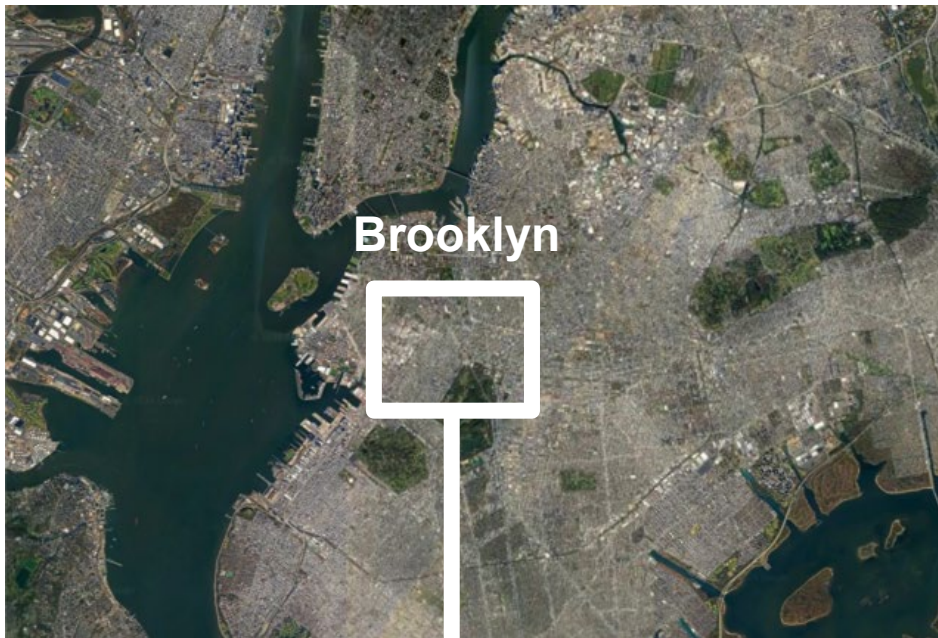

Brooklyn

City

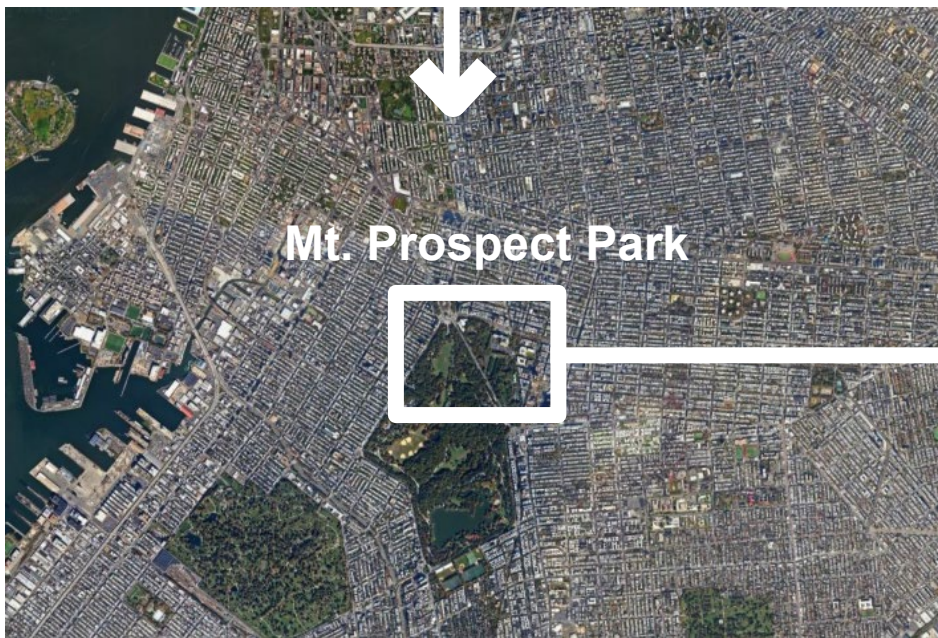

Mt. Prospect Park

Neighborhood

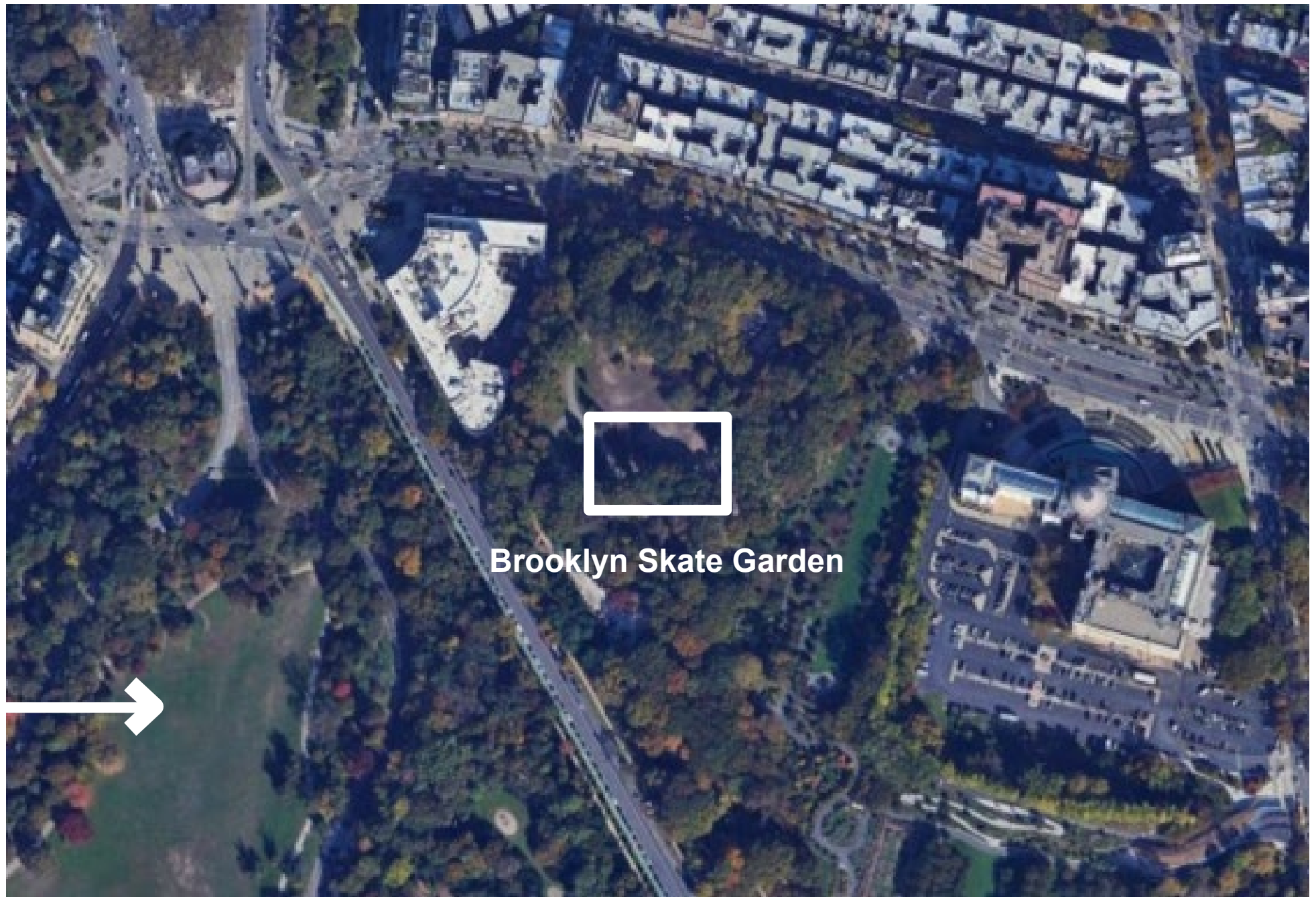

Brooklyn Skate Garden

Site



NYC Parks

# Mount Prospect Park Skate Garden | Location



# NYC Stormwater Flood Maps

- Area not included in analysis
- Future High Tides 2050 (Moderate) & 2080 (Extreme)
- National Wetlands Inventory
- Deep and Contiguous Flooding (1ft and greater)
- Nuisance Flooding (greater or equal to 4 in and less than 1 ft)

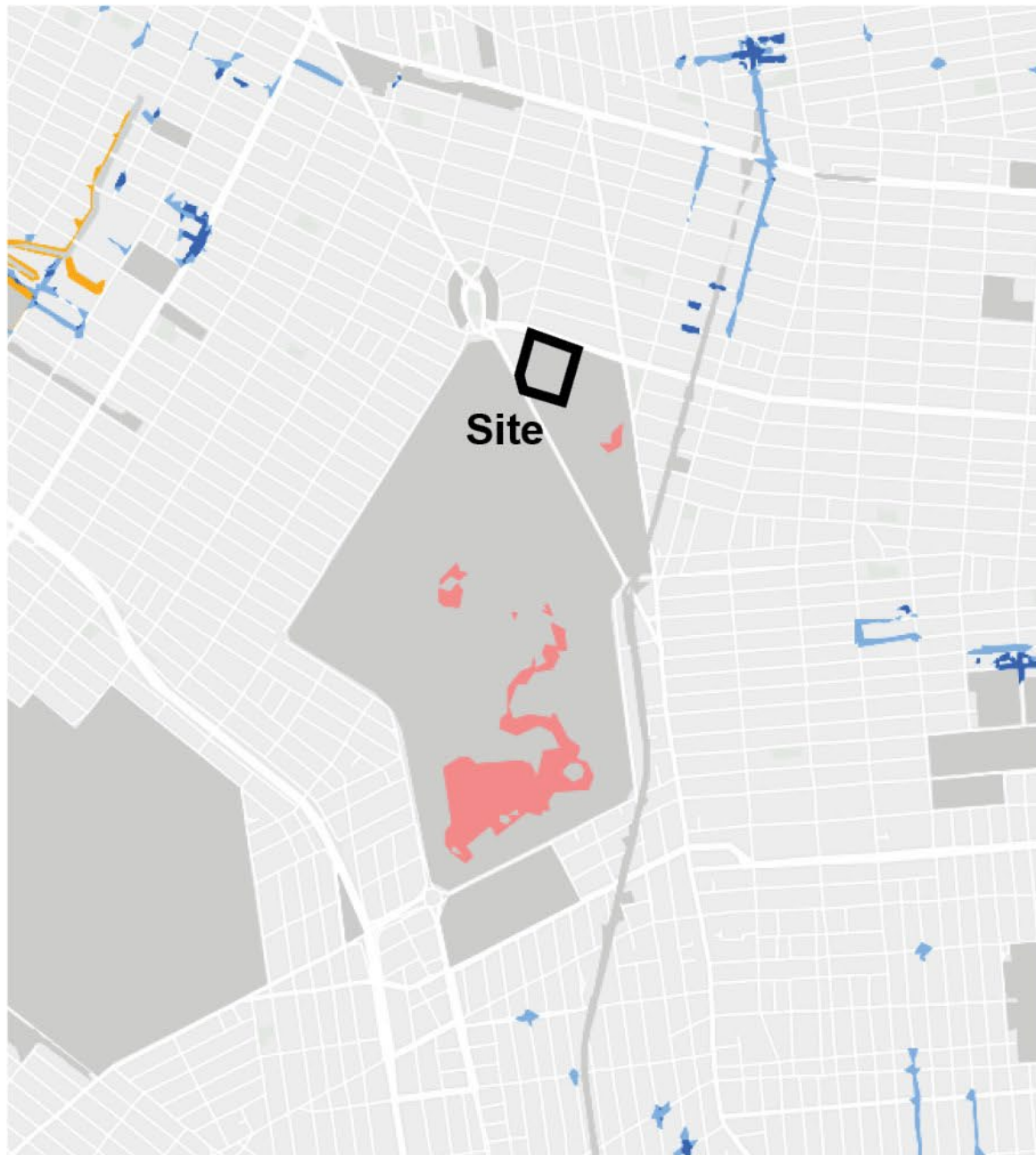

Moderate Flooding (10-year storm)

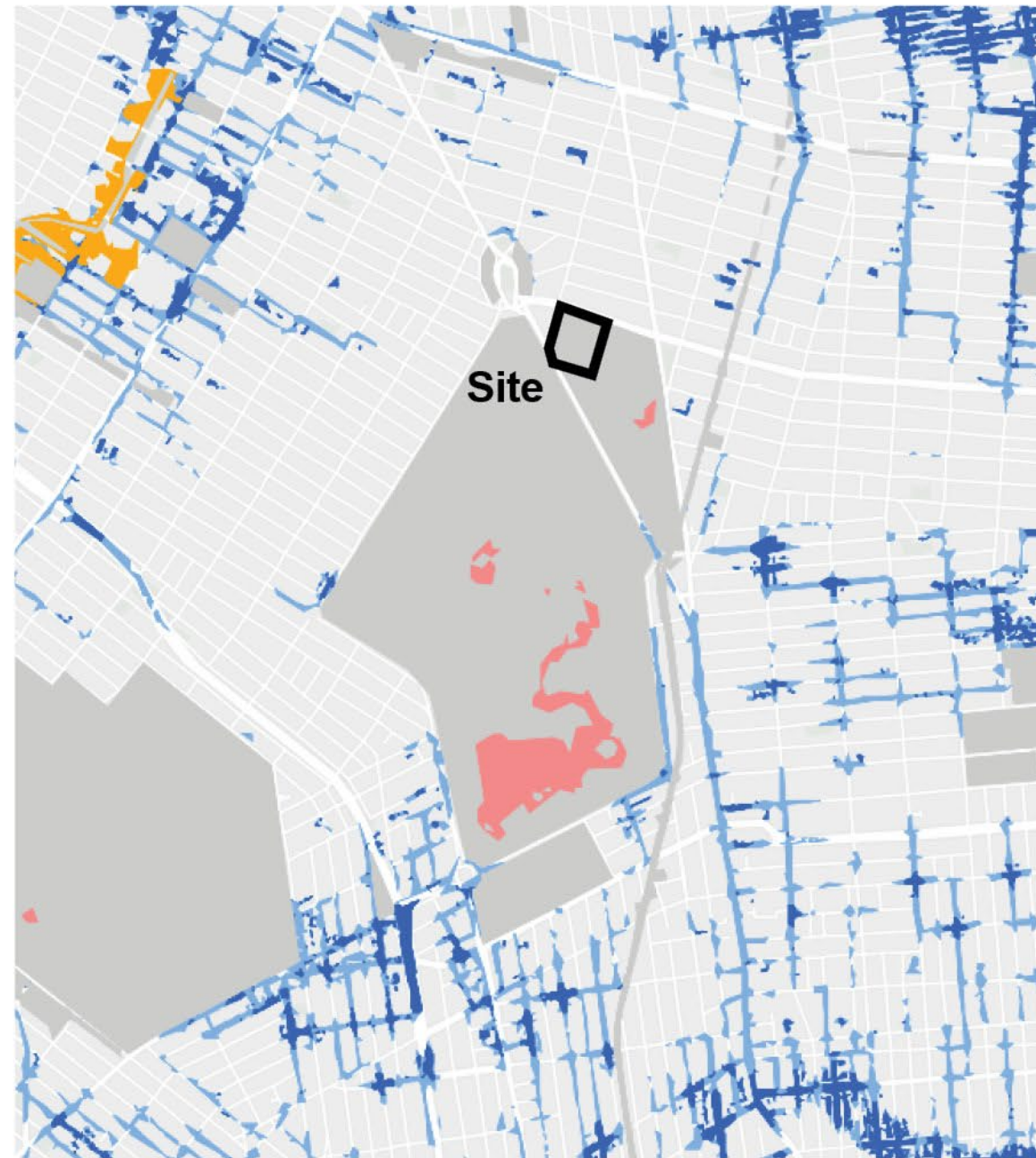

Extreme Flooding (100-year storm)



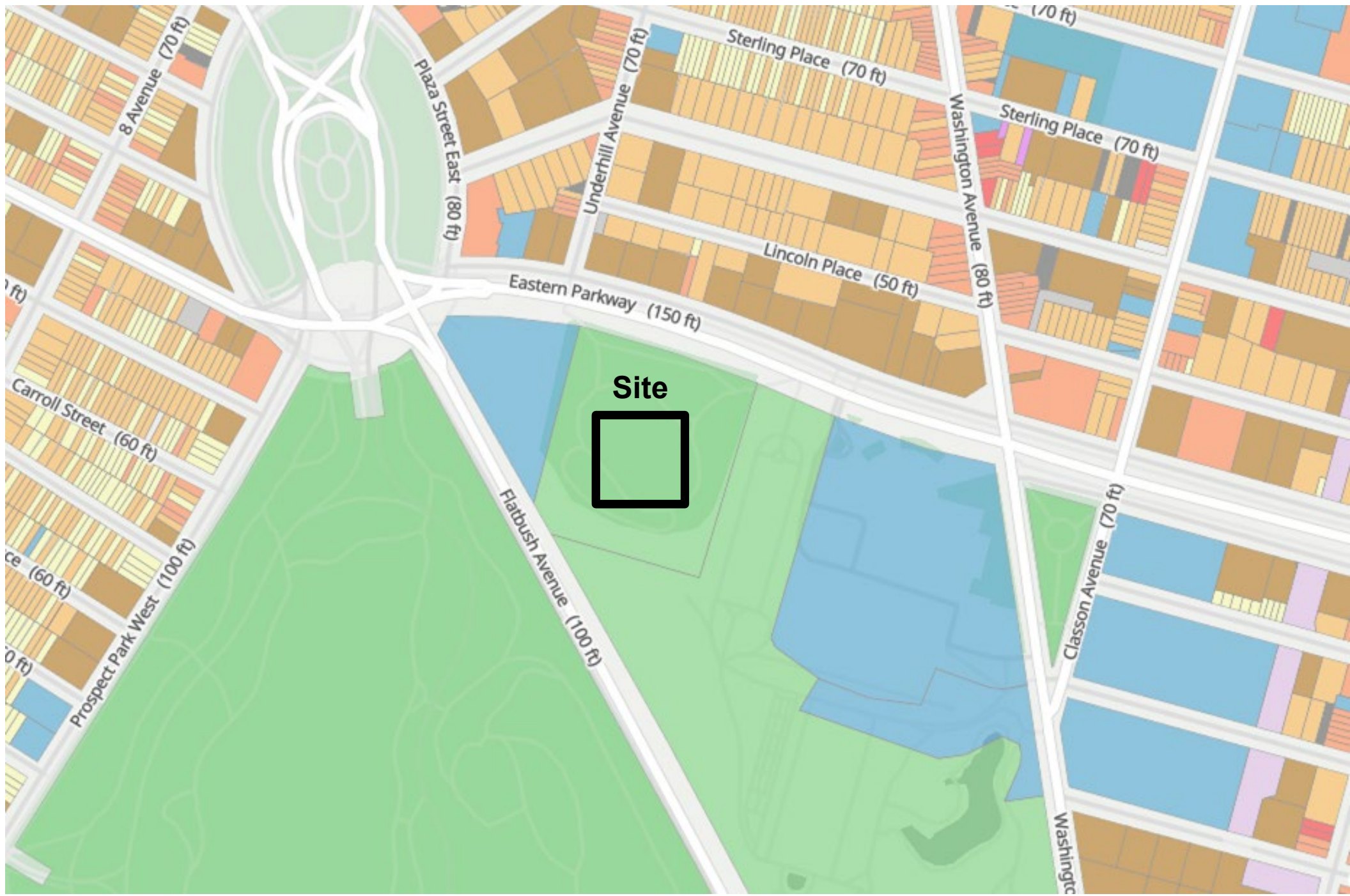

### Land Use Categories

- 1 & 2 Family Residential
- Multi-Family Residential (Walkup)
- Multi-Family Residential (Elevator)
- Mixed Use
- Commercial & Office
- Industrial & Manufacturing
- Transportation / Utilities
- Public Facilities & Institutions
- Open Space And Outdoor Recreation
- Parking
- Vacant Land
- Other



**Park Slope Playground**  
Playgrounds  
Spray Shower  
Basketball



**James Forten Playground**  
Handball  
Playgrounds  
Spray Shower

**Stroud Playground**  
Basketball  
Handball  
Playgrounds  
Spray Shower

**Dr. Ronald McNair Park**

**Jackie Robinson Playground**  
Basketball  
Handball  
Fitness Equipment  
Playgrounds  
Spray Shower





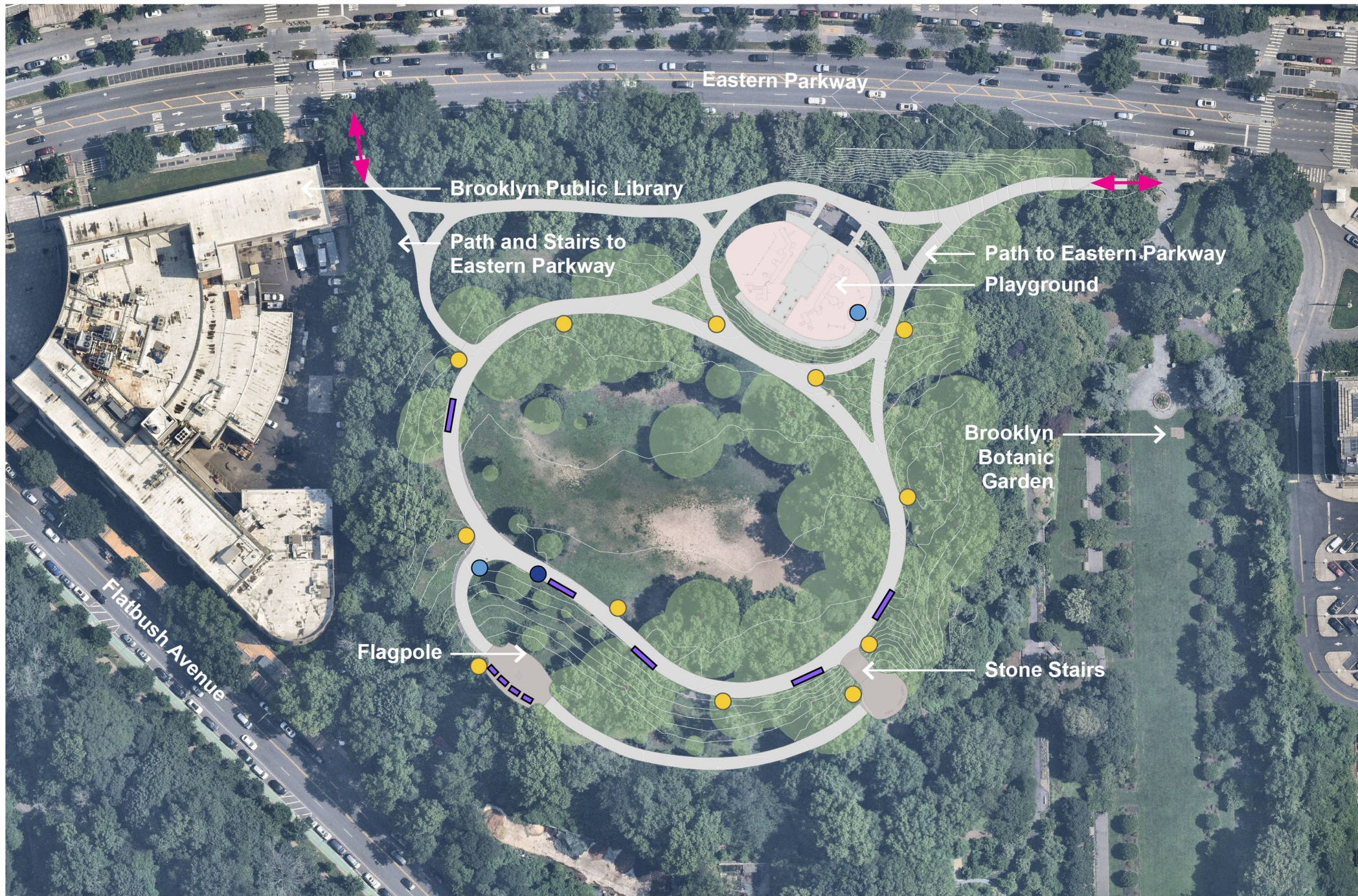

## Mount Prospect Park Skate Garden | Neighborhood Parks Context





### Legend

-  Play Equipment
-  Asphalt Pavement
-  Stone Pavers
-  Existing Parks Lightpole
-  Bench
-  Drinking Fountain
-  Dog Fountain
-  Tree
-  Skatepark Entrance

**Heat Vulnerability Index**  
 Site is not in high HVI area.

**Rat Mitigation Zone**  
 Site is not in a rat mitigation zone.



## Mount Prospect Park Skate Garden | Existing Conditions Diagram

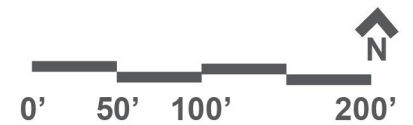

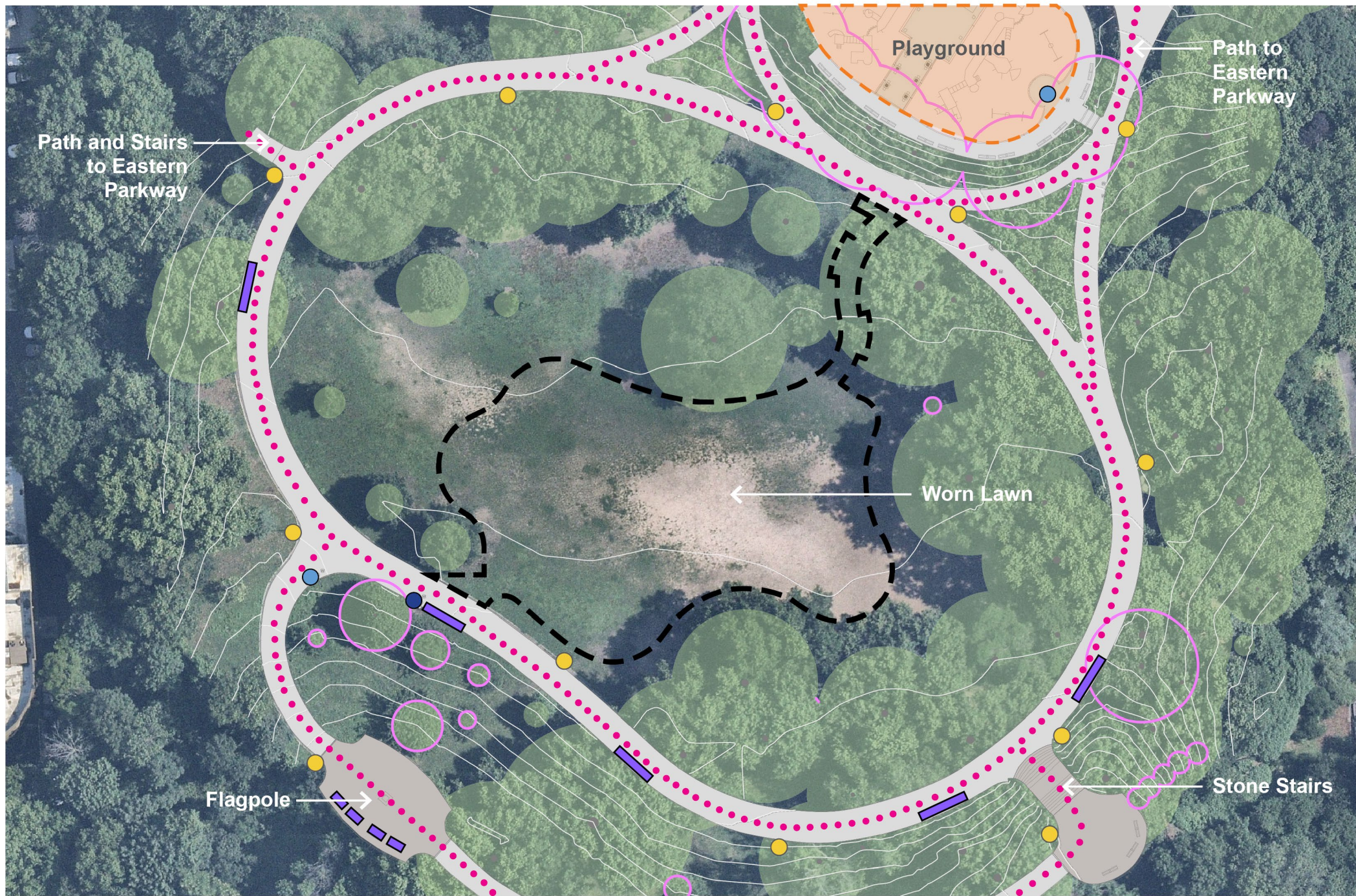

### Legend

- Skatepark Footprint
- Pedestrian Traffic
- Play Equipment
- Hardscape (Asphalt)
- Hardscape (Stone)
- Existing Parks Lightpole
- Bench
- Drinking Fountain
- Dog Fountain
- Tree
- Flowering Tree





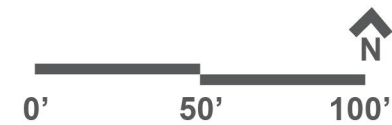

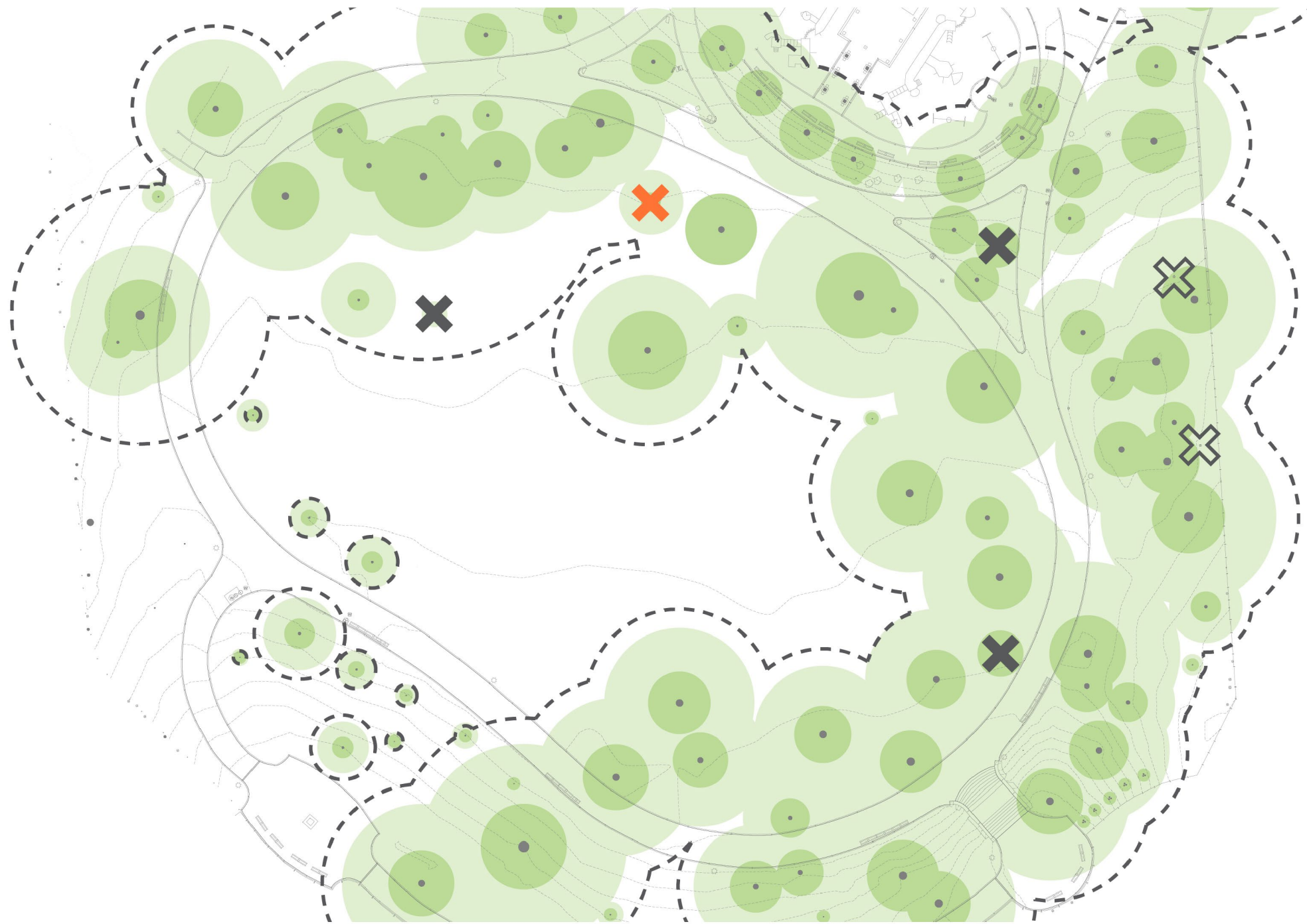

## Mount Prospect Park Skate Garden | Site Analysis Diagram

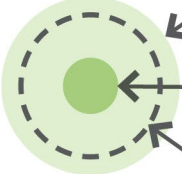



**Legend**

-  Canopy
-  Structural Root Zone
-  Critical Root Zone
-  Stump Removal
-  Tree Removal due to poor condition
-  Tree Removal due to design considerations

**19 new trees shall be planted in the proposed design**



**Mount Prospect Park Skate Garden | Existing Tree Inventory**

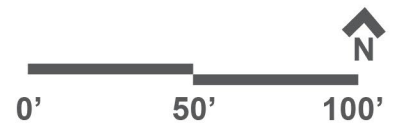



1 - View looking southeast within the Oval



2 - View toward flagpole from the Oval



## Mount Prospect Park Skate Garden | Existing Conditions Photos



1 - View east towards Stone Stairs



2 - View from Stone Stairs looking towards the Oval



Mount Prospect Park Skate Garden | Existing Conditions Photos



1 - View looking east to Stone Stairs



2 - View looking west towards the Library



## Mount Prospect Park Skate Garden | Existing Conditions Photos



1 - View looking north towards the playground



2 - View of path up to flagpole



Mount Prospect Park Skate Garden | Existing Conditions Photos



1 - View looking northwest across the playground



2 - View of playground facing the restroom building



Mount Prospect Park Skate Garden | Existing Conditions Photos (Playground)

# Action Sports Community Priorities

Community priorities were established during the Community Input Session and subsequent survey.

## Establish Skate Garden

Skate paths and garden elements interwoven into cohesive and durable design.

## Designed for Gradual Progression

Accessible and encouraging obstacles for engagement and longevity.

## Safety & Security of Skaters and Pedestrians

Delineate space to ensure proper usage for all patrons.

## Flow

Utilize basic flow principles to effectively connect strategically configured skatepark elements.

## Element Variety

Include tasteful balance of street and transition obstacles.

## Terrain Type Request

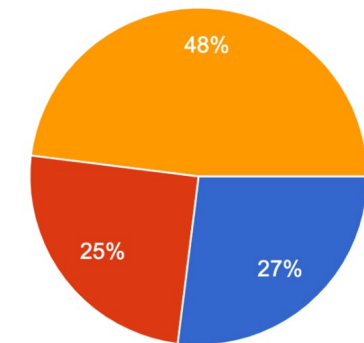

- A majority Street style park with some Transition style features integrated into the design
- A majority Transition style park with some Street features integrated into the design
- An even mix of both Street and Transition Style features.

## User Type

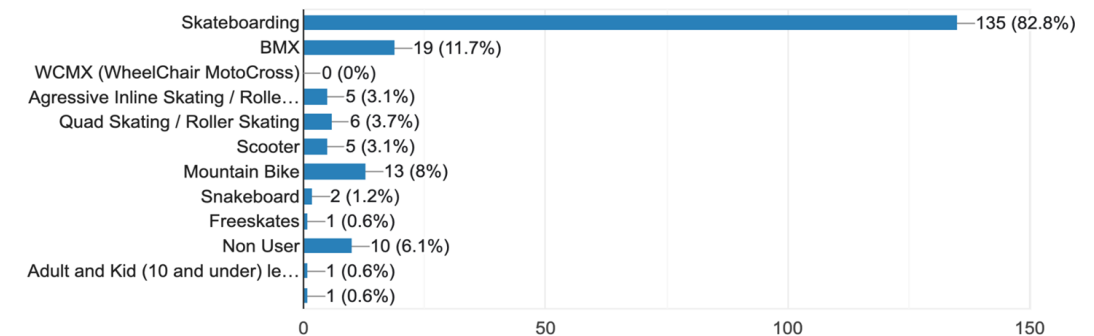

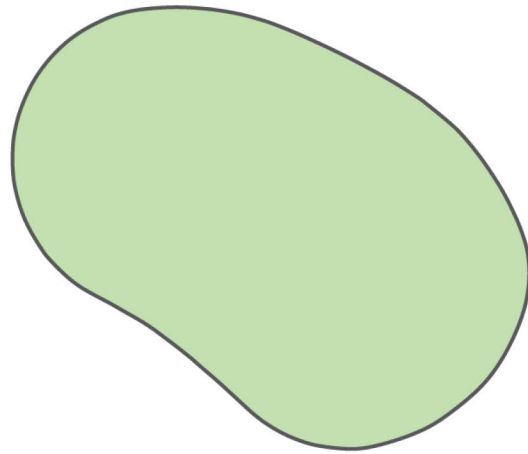

**97,187 SF  
TOTAL AREA**

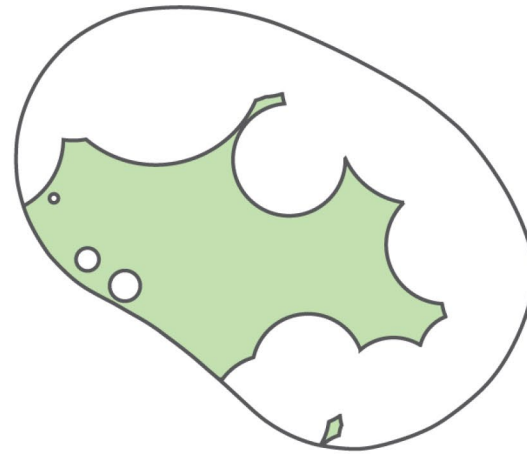

**33,402 SF  
AREA CLEAR OF TREE CRZ**

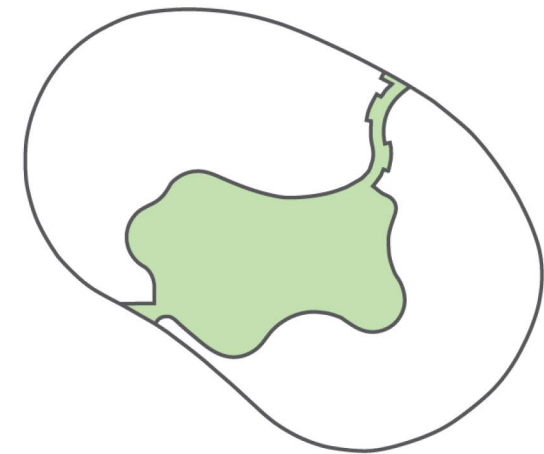

**20,900 SF  
PROPOSED SKATEPARK  
HARDSCAPE AND ACCESS PATHWAY**

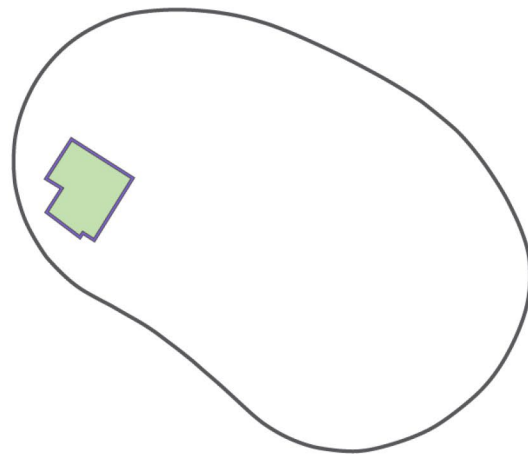

**3,200 SF  
PROPOSED GREEN  
INFRASTRUCTURE SYSTEM**

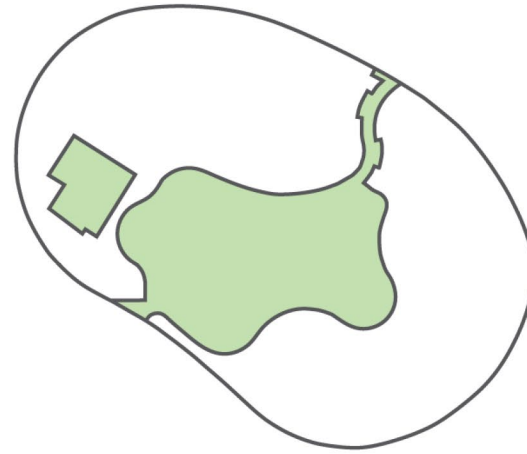

**24,100 SF  
PROPOSED DESIGN**



**Mount Prospect Park Skate Garden | Concept**



## The skate garden as a braid:

- The skate garden acts as a braid, weaving together the quiet, shady and active, sunny sides of the park
- The braid pulls a ribbon of flowering trees through the center of the skate garden, building upon an existing thread of flowering trees at Mount Prospect Park

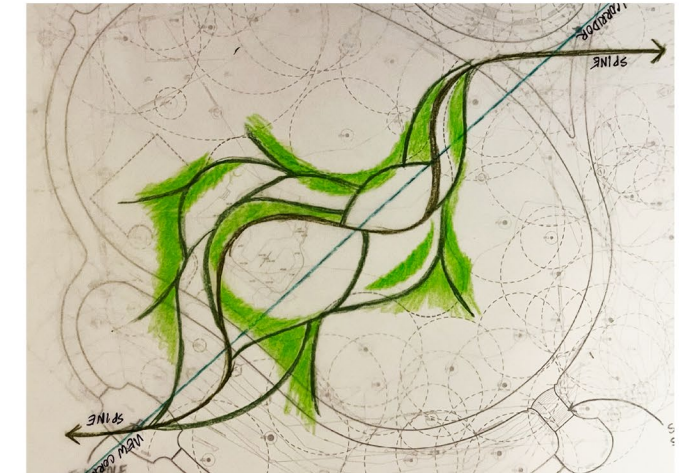



Shrub border between lawn and skatepark (Tribeca Section of Hudson River Park)



Skatepark interior plantings (Hunters Point South)

### The skate garden as a braid:

- The skate garden acts as a braid, weaving together the quiet, shady and active, sunny sides of the park
- The braid pulls a ribbon of flowering trees through the center of the skate garden, building upon an existing thread of flowering trees at Mount Prospect Park



Ribbon of flowering trees and low understory plantings under existing canopies to maintain views (Pumphouse Park)

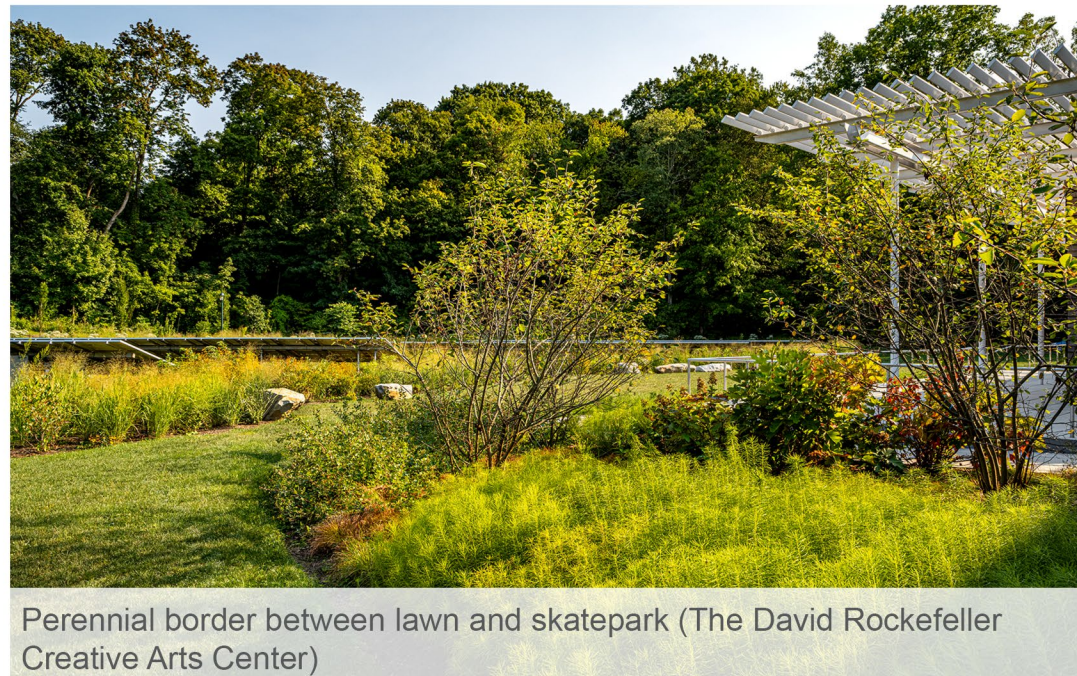

Perennial border between lawn and skatepark (The David Rockefeller Creative Arts Center)



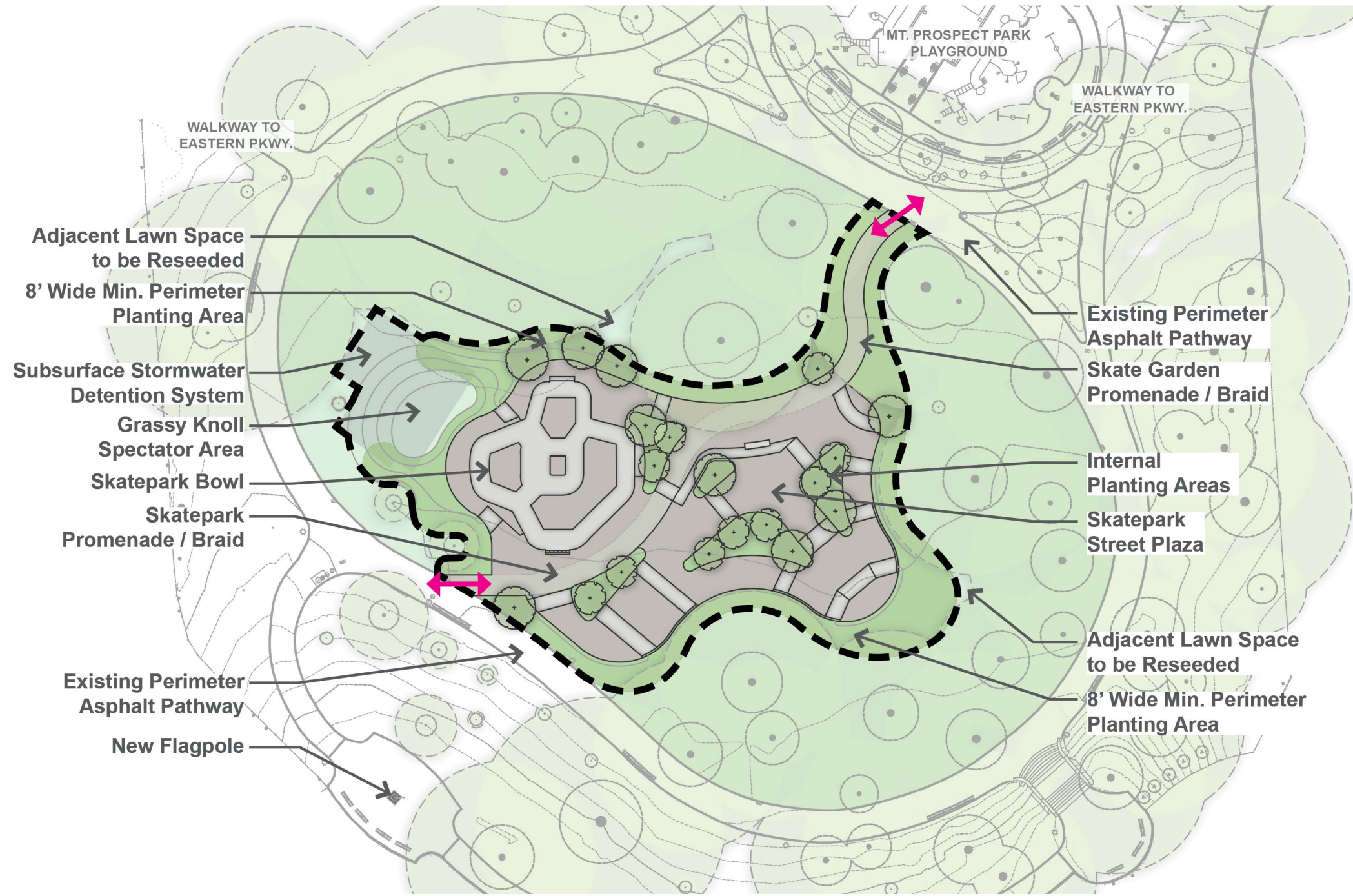

### Legend

- Project Limit
- ↔** Park Entrance
- Skatepark Flatwork
- Skatepark Feature
- Internal and Perimeter Planting Areas
- Re-Sodded Grass Field
- +** Proposed Tree Shade Tree
- Existing Tree

### Area Breakdown

Skatepark Hardscape: 20,000 SF  
 Interior Planting: 2,700 SF  
 Perimeter Planting: 11,300 SF

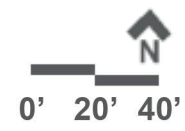

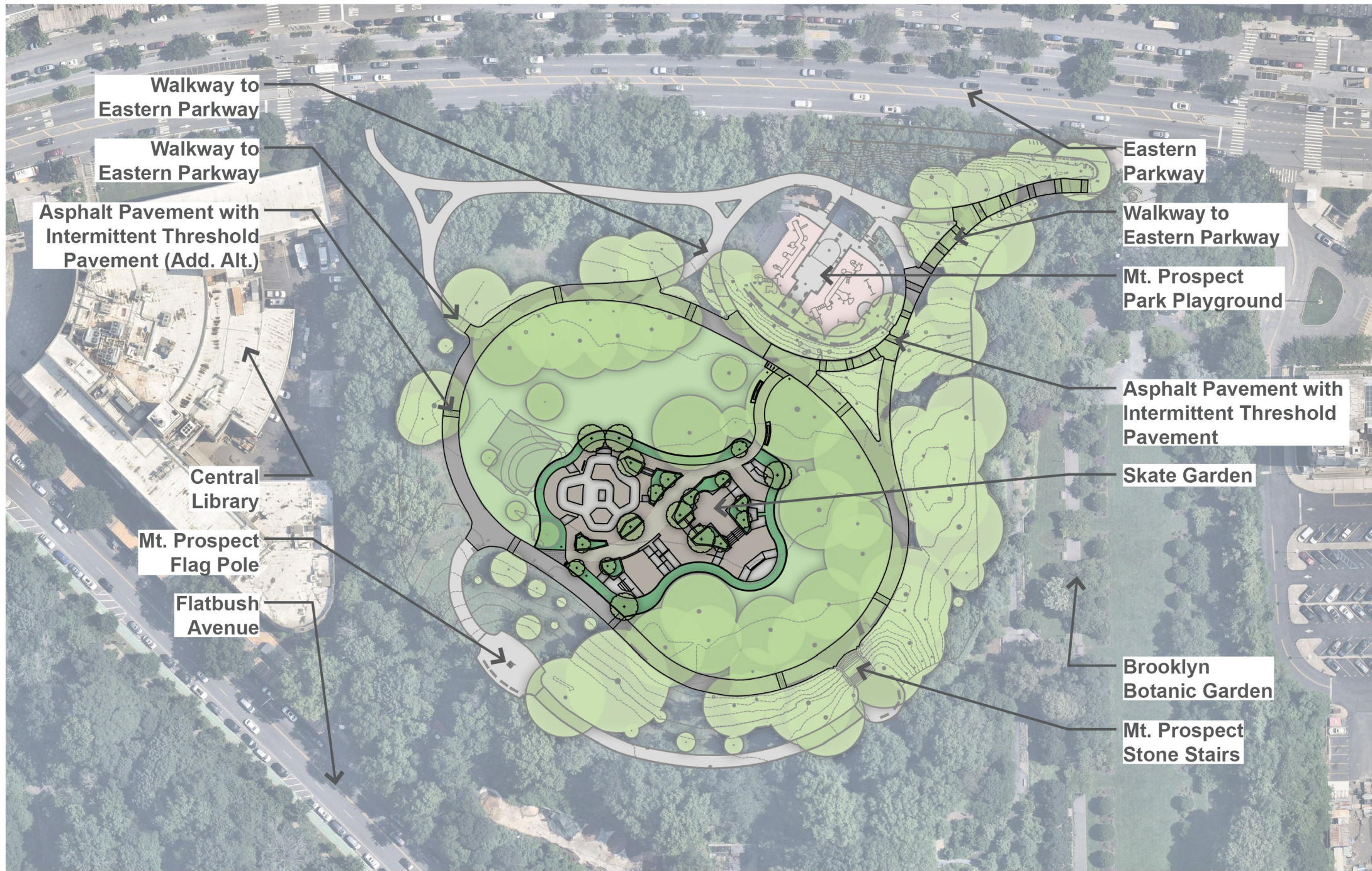

**Mount Prospect Park Skate Garden | Schematic Design**

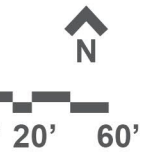

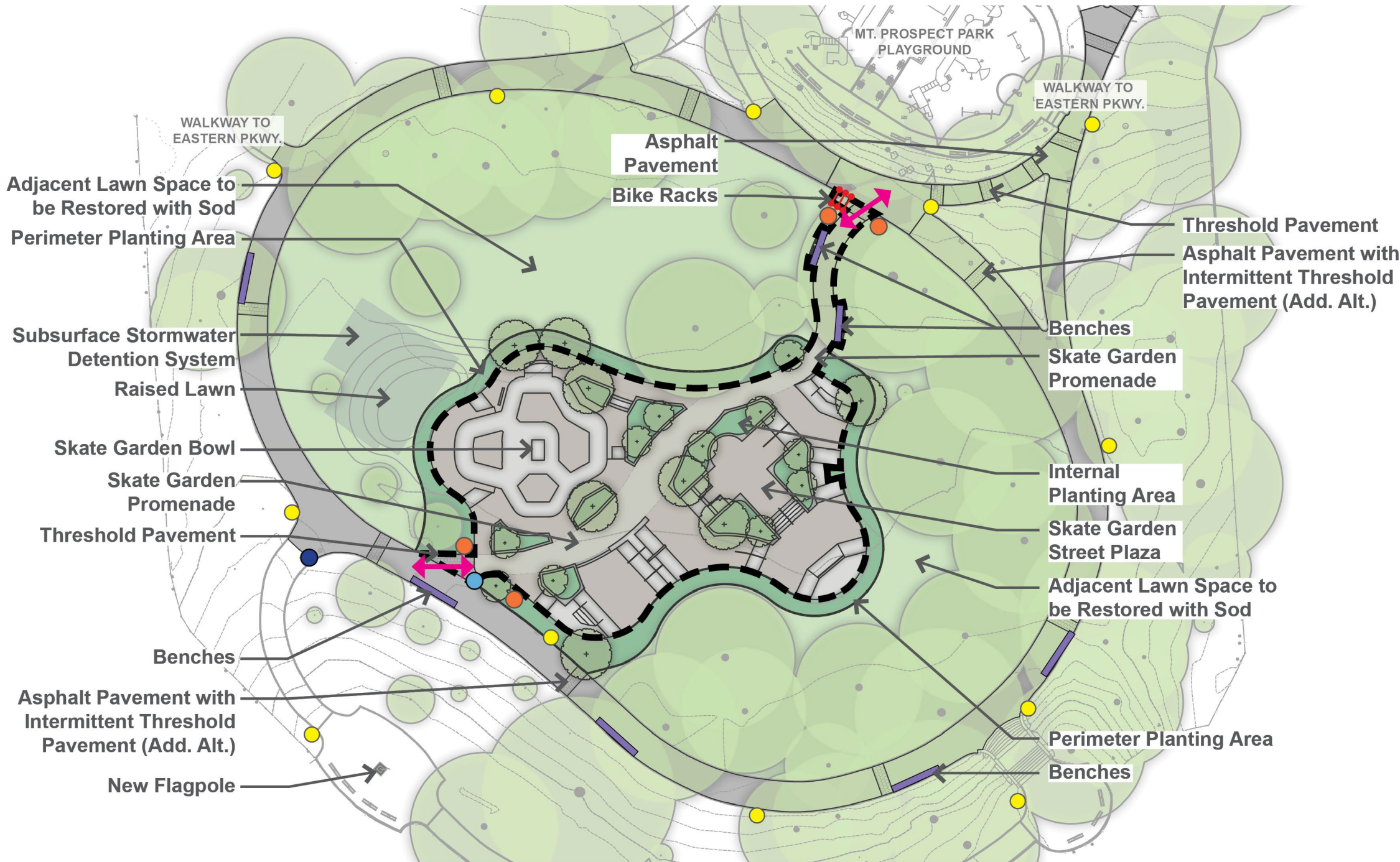

## Legend

- Skate Garden Pavement Limit Line
- Park Entrance
- Skate Garden Flatwork
- Skate Garden Feature
- Threshold Pavement
- Existing Parks Light Pole
- Pedestrian Scale Security Lighting
- Bike Rack
- Bottle Filler
- Existing Drinking Fountain to be Replaced
- Benches
- Internal and Perimeter Planting Area
- Lawn Space to be Restored with Sod
- Proposed Tree Shade Tree
- Existing Tree

## Area Breakdown

- Skate Garden Hardscape: 19,500 sf
- Access Pathway: 1,400 sf
- Interior Planting: 2,500 sf
- Perimeter Planting: 6,000 sf

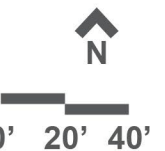

# Mount Prospect Park Skate Garden | Schematic Design

**Legend**

- General Park Users
- Active Skatepark Users
- Passive/Spectator Skatepark Users

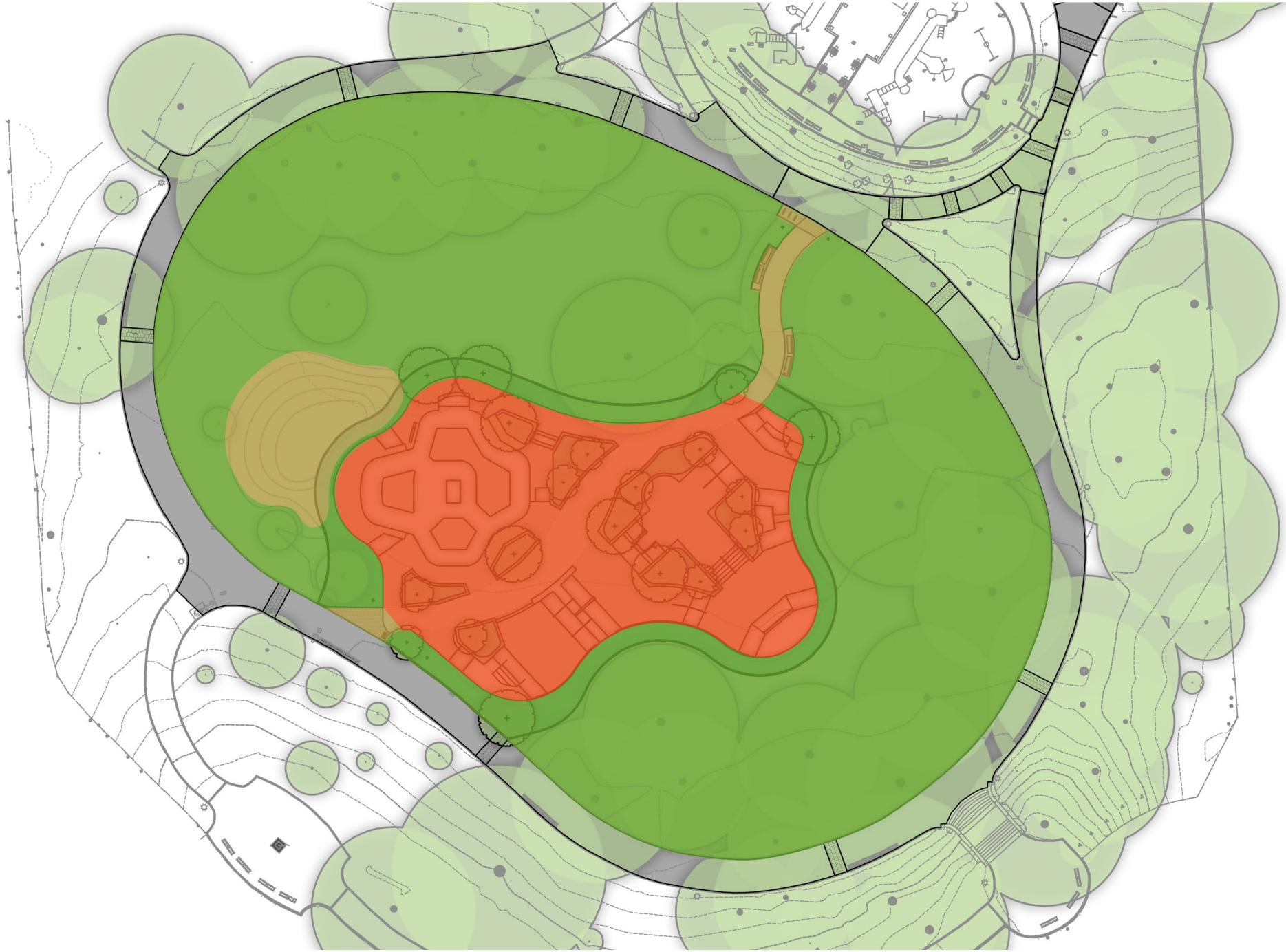

**Mount Prospect Park Skate Garden | Use Zone Diagram**

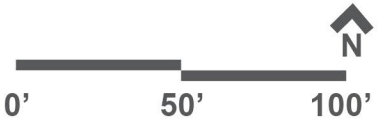

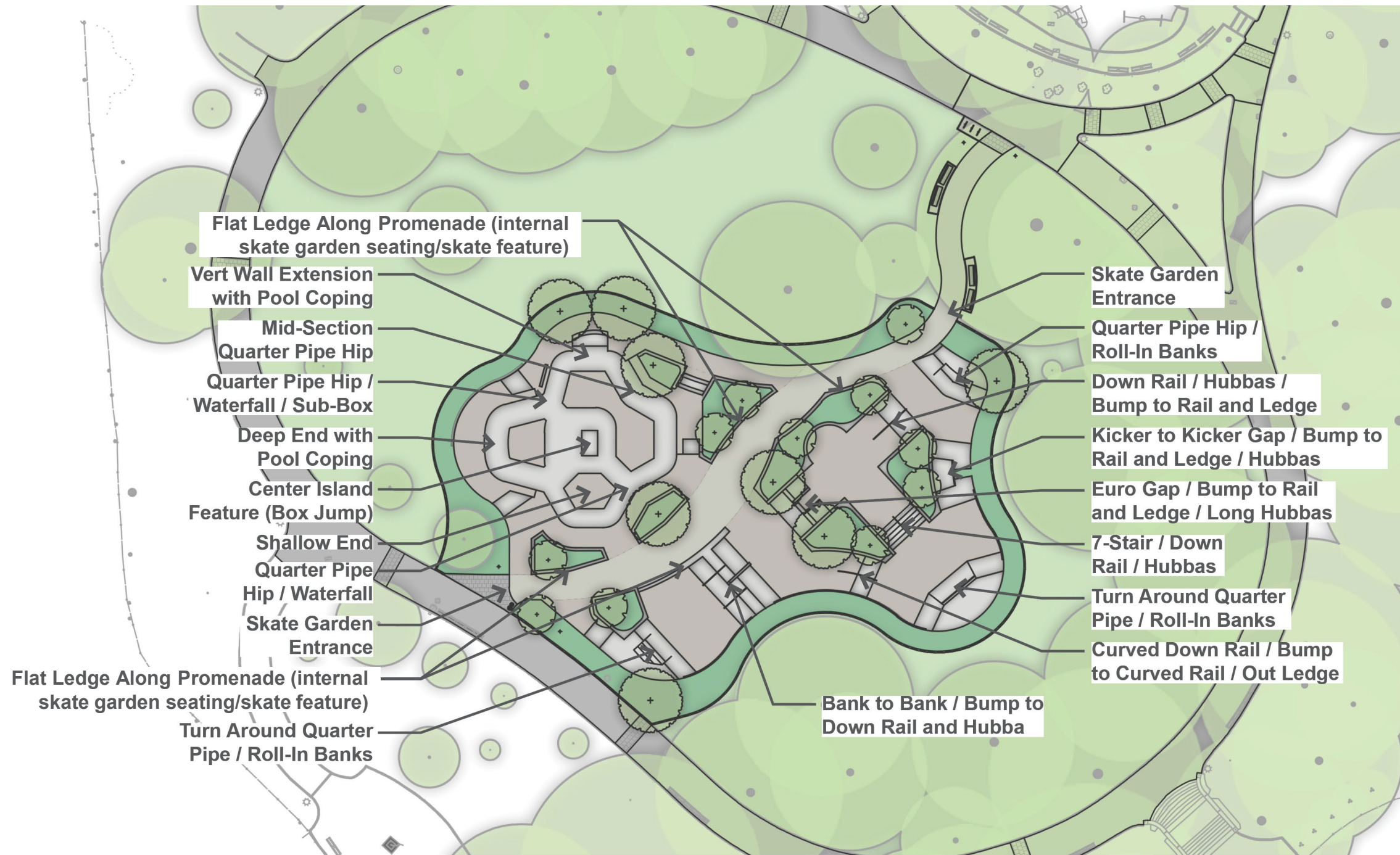

\*Specific Skate Garden features are still in development and are subject to change\*



## Mount Prospect Park Skate Garden | Enlargement Skate Garden Feature Plan

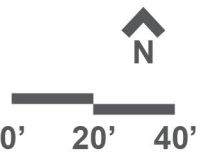

# Examples of Skate Elements

## STREET ELEMENTS

- Rails
- A-Frames
- Bank Ramps
- Ledges
- Flatbars
- Stair Sets
- Handrails
- Gaps
- Curbs
- Hips
- Wallrides



## TRANSITION ELEMENTS

- Quarter Pipes
- Bank Ramps
- Bowl Corners
- Hips
- Roll-Ins
- Gaps
- Launch Boxes
- Pool Coping
- Extensions
- Sub-Boxes
- Vert Walls



**Legend**

 **LOW PLANT RAIL**  
1' - 4" HT. **STEEL**

 **PROTECTIVE MEASURES BETWEEN ACTIVE SKATE AREAS AND PLANTING BEDS**  
1' - 4" HT.

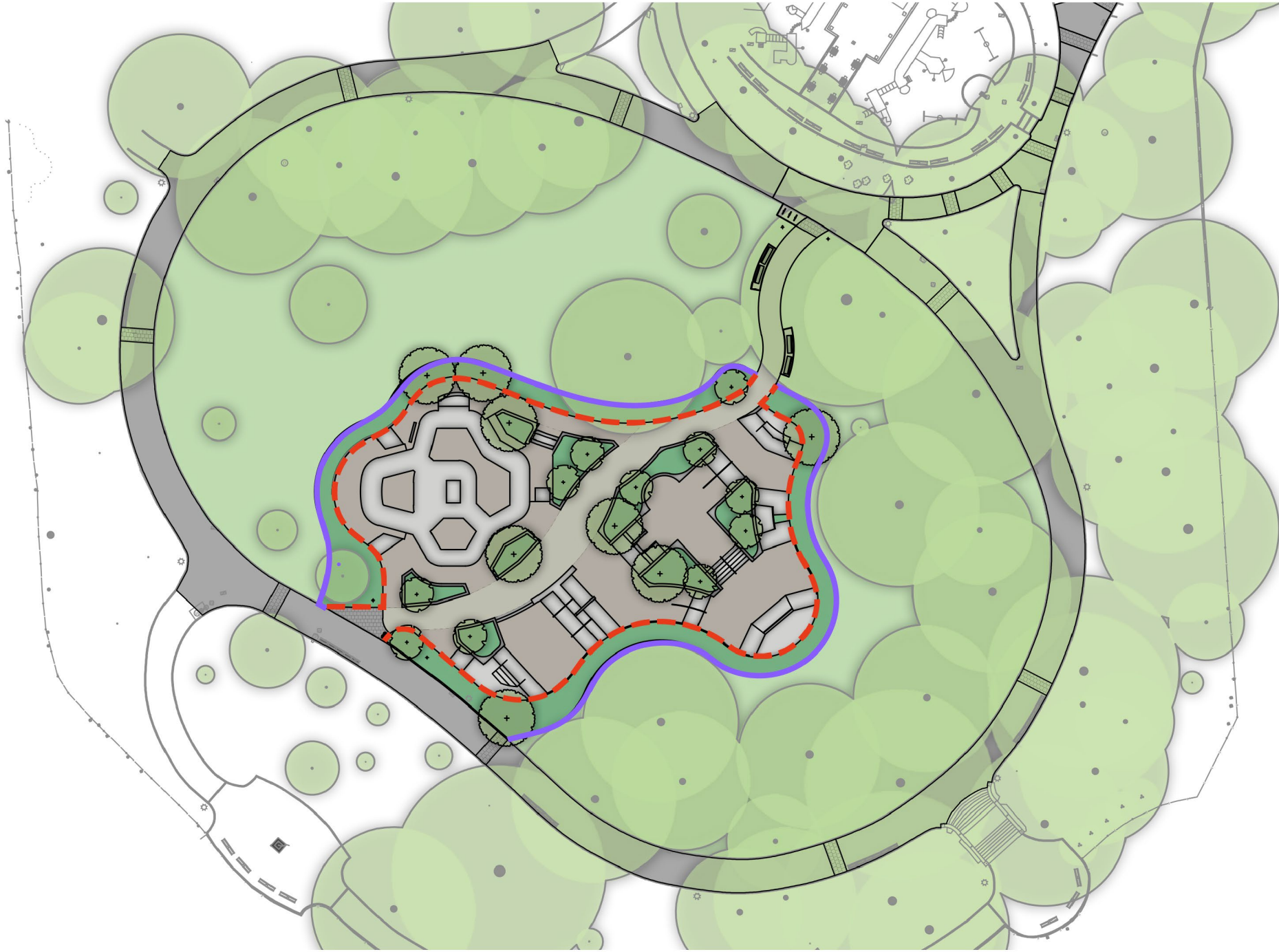

NYC Parks







**Mount Prospect Park Skate Garden | Proposed Fence Diagram**







### Legend

-  **Surface Stormwater Flow**
-  **Skateable Drain**  
*Exact locations to be determined during additional design*
-  **Stormwater Conveyance Pipes**
-  **Outlet Control Structure**
-  **Connection to Existing Drainage System**
-  **Existing Drainage Inlet**

Subsurface Stormwater Detention System

Pipe to Street Connection

MT. PROSPECT PARK PLAYGROUND

WALKWAY TO EASTERN PKWY.

WALKWAY TO EASTERN PKWY.



## Mount Prospect Park Skate Garden | Stormwater Management Plan

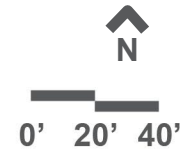



- Legend**
-  Skate Garden Pavement Limit Line
  -  Colored Skate Garden Concrete Flatwork
  -  Natural Gray Skate Garden Shotcrete Feature
  -  Threshold Pavement
  -  Asphalt Pavement
  -  Internal and Perimeter Planting Area
  -  Lawn Space to be Restored with Sod



**Mount Prospect Park Skate Garden | Pavement Plan**

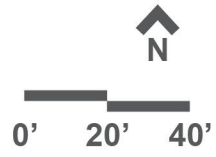



Existing Perimeter Pathway    Adjacent Lawn to be Restored    Grassy Knoll Spectator Area    Perimeter Planting    Skatepark Bowl Elements    Skatepark Promenade    Skatepark Street Elements    Perimeter Planting    Adjacent Lawn to be Restored    Existing Perimeter Pathway



NYC Parks

# Mount Prospect Park Skate Garden | Preliminary Design Section





Existing Grade



Grassy Knoll Spectator Area

Perimeter  
Planting

Skatepark  
Bowl Elements

Skatepark  
Promenade

Skatepark  
Street Elements

Perimeter  
Planting



NYC Parks

# Mount Prospect Park Skate Garden | Preliminary Design Section





# Mount Prospect Park Skate Garden | Preliminary Design Section





World's Fair Bench - Type 'A'

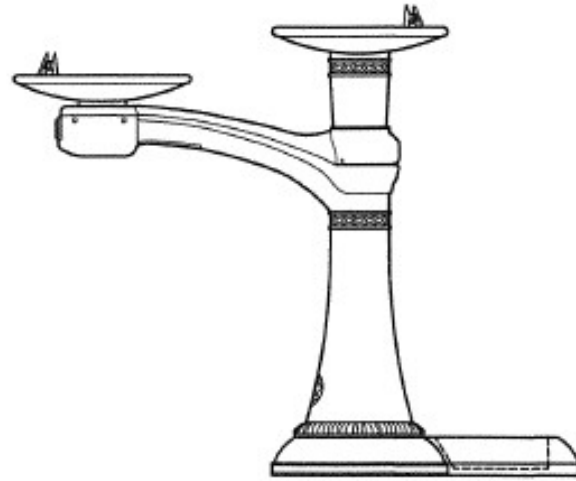

Drinking Fountain – Type 'E'  
Hi-Lo with Dog Bowl



Bottle Filler  
with Dog Bowl



DOT Bike Rack



Low Plant Rail (1' - 4" ht.) on Flush Curb



Decorative Bin



Light Pole - Type 'B'

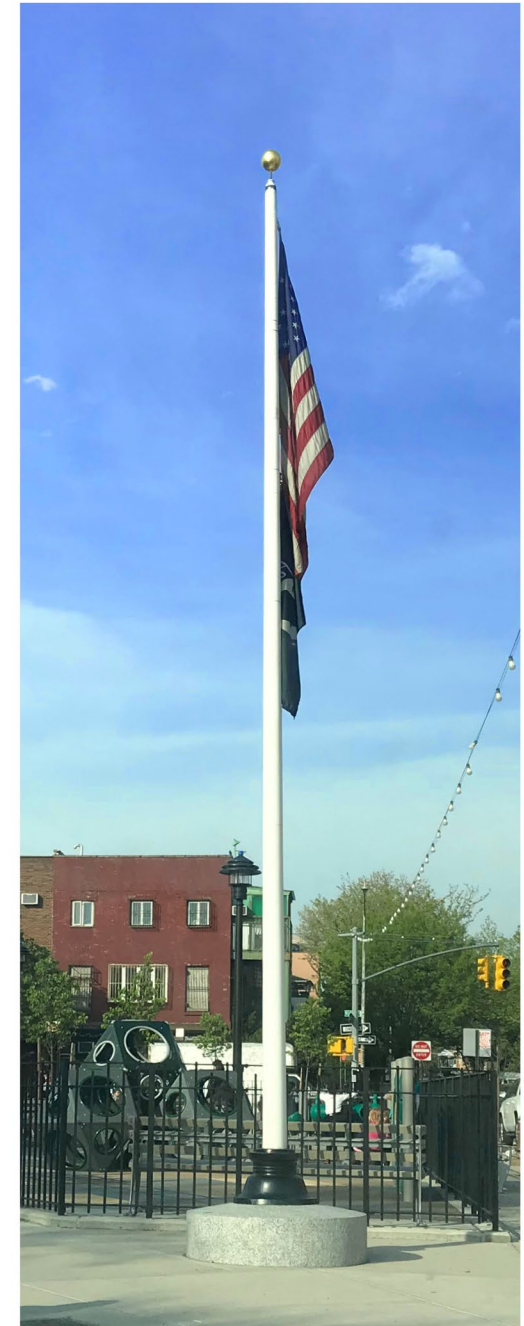

25' Standard Flag Pole



# Mount Prospect Park Skate Garden | Site Furnishings

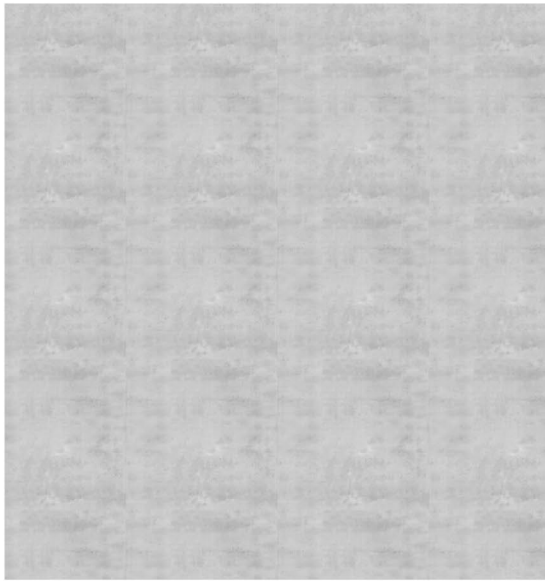

**Shotcrete and Walls**  
*Natural Gray*

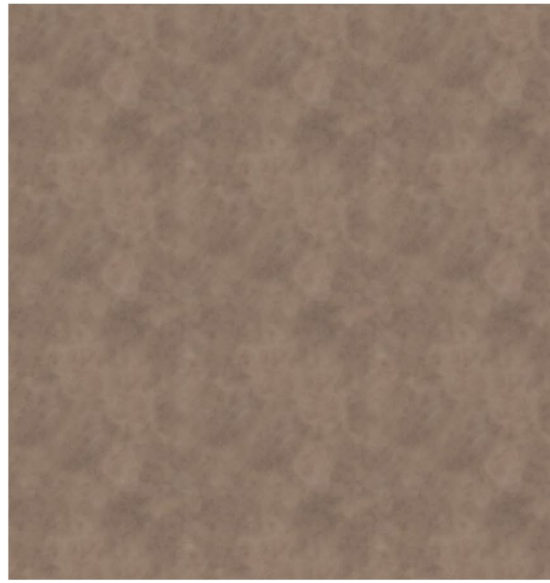

**Flatwork**  
*Davis Colors Adobe 61078*



**Flatwork**  
*Davis Colors Cocoa 6130*

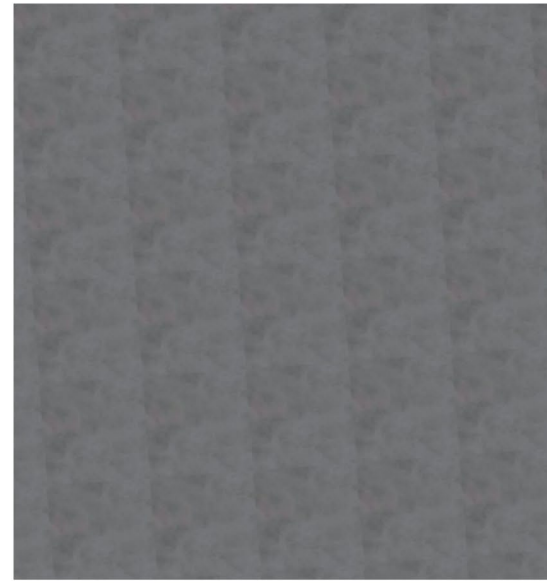

**Ledge Caps**  
*Davis Colors Graphite 8084*

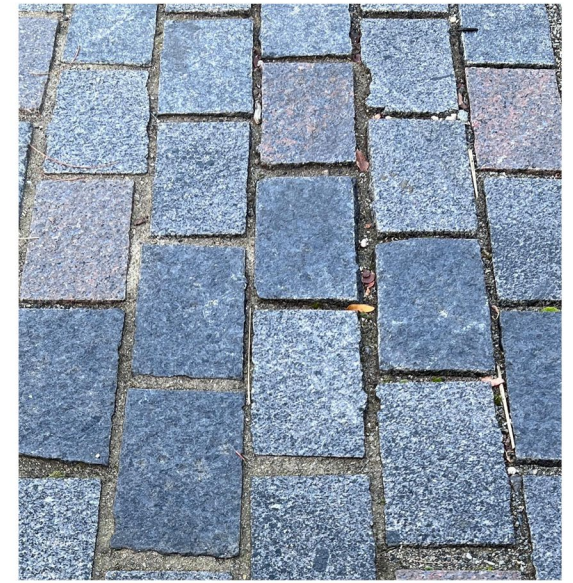

**Threshold Pavement**  
*Belgian Block*



**Restored Oval Path and Entrance to Eastern Parkway** *Asphalt Pavement and Intermittent Belgian Block\**



**Protective Edging for Street Elements**  
*Steel C-Channel\*\**



**Protective Edging for Transition Elements** *Steel Coping, Pool Coping and C-Channel (for vertical protection)\*\**

*\*(interval to be determined)  
\*\*colors of protective edging vary and will be determined in final design*



## Mount Prospect Park Skate Garden | Materials

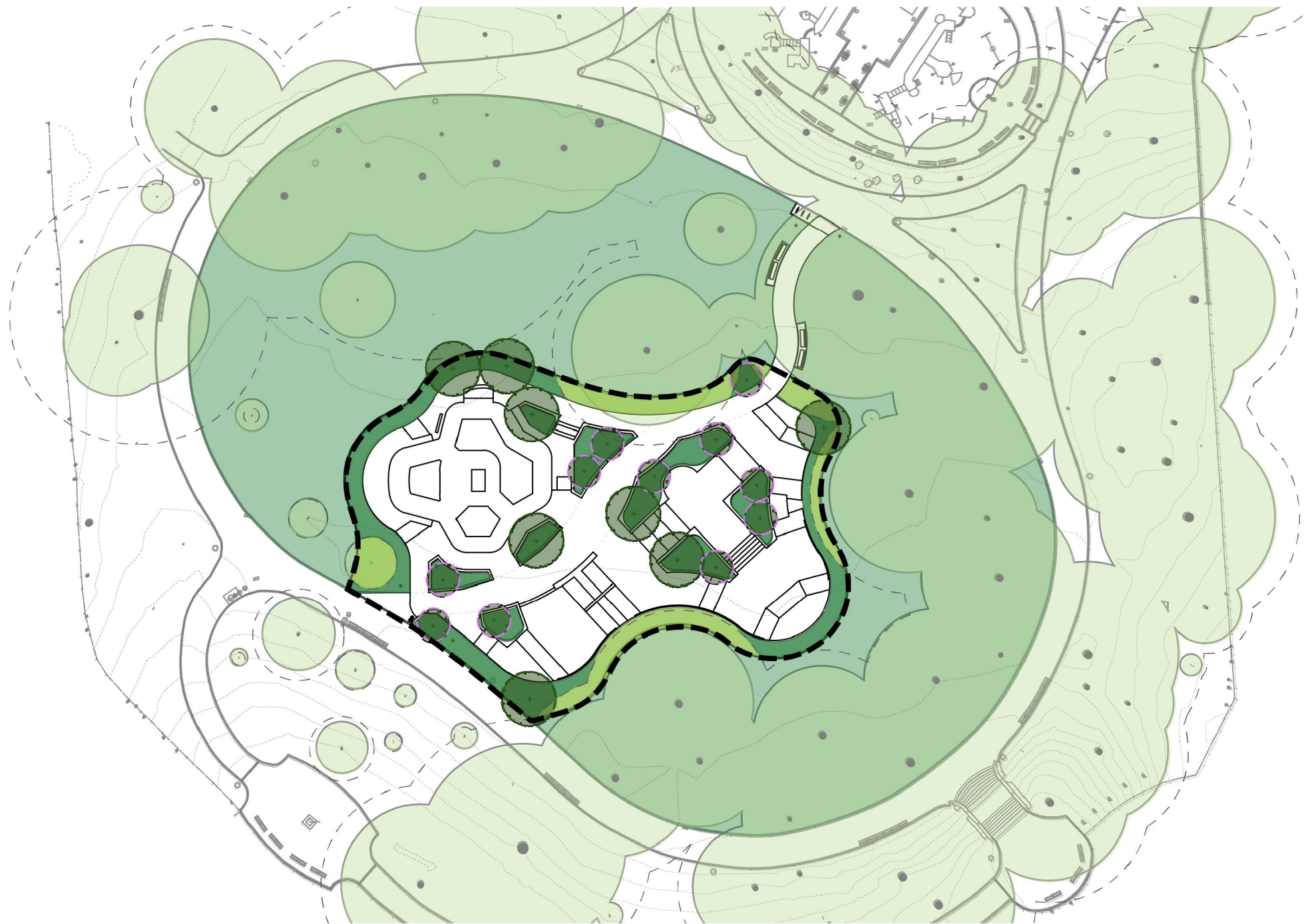

## Legend

- Planting Limit
- Perennials, Grasses and Groundcovers
- Shrubs
- Lawn to be restored
- Existing Tree Canopy
- Critical Root Zone
- Proposed Tree Shade Tree
- Proposed Tree Accent Flowering Tree



# Mount Prospect Park Skate Garden | Conceptual Planting Plan

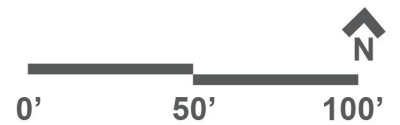



**Red Maple (N)**  
*Acer rubrum* 'October Glory'



**Black Gum (N)**  
*Nyssa sylvatica*



**Lacebark Elm**  
*Ulmus parvifolia* 'Frontier'



**Eastern Redbud (N)**  
*Cercis canadensis*



**Flowering Dogwood (N)**  
*Cornus florida* 'Cherokee Princess'



**Carolina Silverbell (N)**  
*Halesia carolina*



NYC Parks

## Mount Prospect Park Skate Garden | Shade and Flowering Trees



**Buttonbush (N)**  
*Cephalanthus occidentalis*



**Sweet Pepperbush (N)**  
*Clethra alnifolia* 'Ruby Spice'



**Oakleaf Hydrangea (N)**  
*Hydrangea quercifolia* 'Pee Wee'



**Shamrock Inkberry (N)**  
*Ilex glabra* 'Shamrock'



**Kallay's Compact Juniper**  
*Juniperus chinensis* 'Kallay's'



**Coastal Doghobble (N)**  
*Leucothoe axillaris*



**Fragrant Sumac (N)**  
*Rhus aromatica* 'Gro Low'

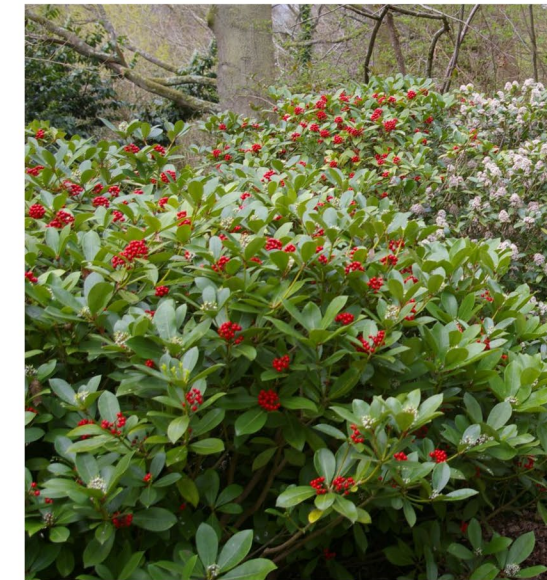

**Japanese Skimmia**  
*Skimmia japonica*





**Blue Star**  
*Amsonia hubrichtii*

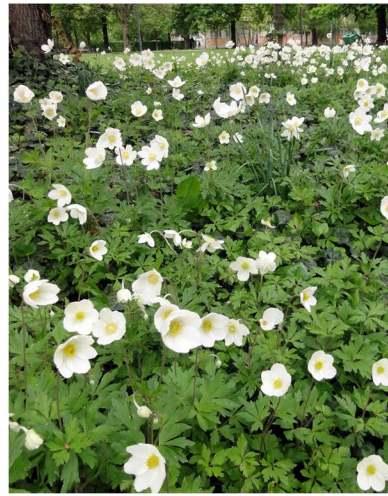

**White Windflower**  
*Anemone sylvestris*



**Lady Fern (N)**  
*Athyrium filix-femina*



**Feather Reed Grass**  
*Calamagrostis x acutiflora*  
'Karl Foerster'



**Pennsylvania Sedge (N)**  
*Carex pensylvanica*



**Tussock Sedge**  
*Carex stricta*



**Northern Sea Oats (N)**  
*Chasmanthium latifolium*

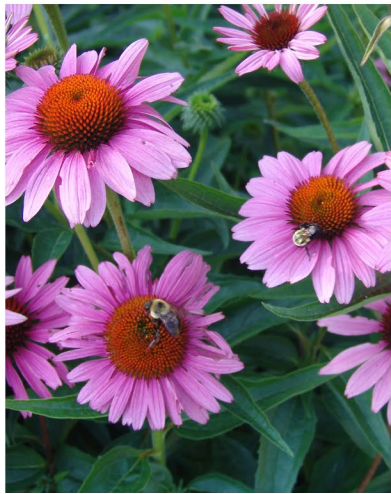

**Coneflower (N)**  
*Echinacea sp.*



**Lenten Rose**  
*Helleborus niger* 'Jacob'



**Blue Switch Grass (N)**  
*Panicum virgatum* 'Heavy Metal'



**Christmas Fern (N)**  
*Polystichum acrostichoides*



**Black-Eyed Susan (N)**  
*Rudbeckia fulgida*  
'Goldsturm'



**Meadow Sage**  
*Salvia nemorosa* 'May Night'



**Little Bluestem (N)**  
*Schizachyrium scoparium*



**Mount Prospect Park Skate Garden | Perennials and Grasses**

**NOTE: Planting with CRZs is limited to 1-gallon containers. These plants are intended for planting within CRZs.**

**Total Project Area: 97,187 SF**



**Existing Permeability: 100% (97,187 SF)**



**Proposed Permeability: 78% (76,291 SF)**

## Legend

 PLANTED AREA (76,290 SF)

SF of areas noted above are for proposed conditions.

## Sustainable Practices

- Reduce stormwater runoff with subsurface infrastructure
- Preserve existing tree canopy
- New trees added for shade and heat island mitigation
- Rehabilitate existing site features
- Use site appropriate resilient plant material

## DEP Unified Stormwater Rule (USWR) Requirement

USWR stormwater management and permitting is required for this project. USWR is required because more than 5,000 SF of impervious surface is being added and/or more than 20,000 SF is being disturbed.















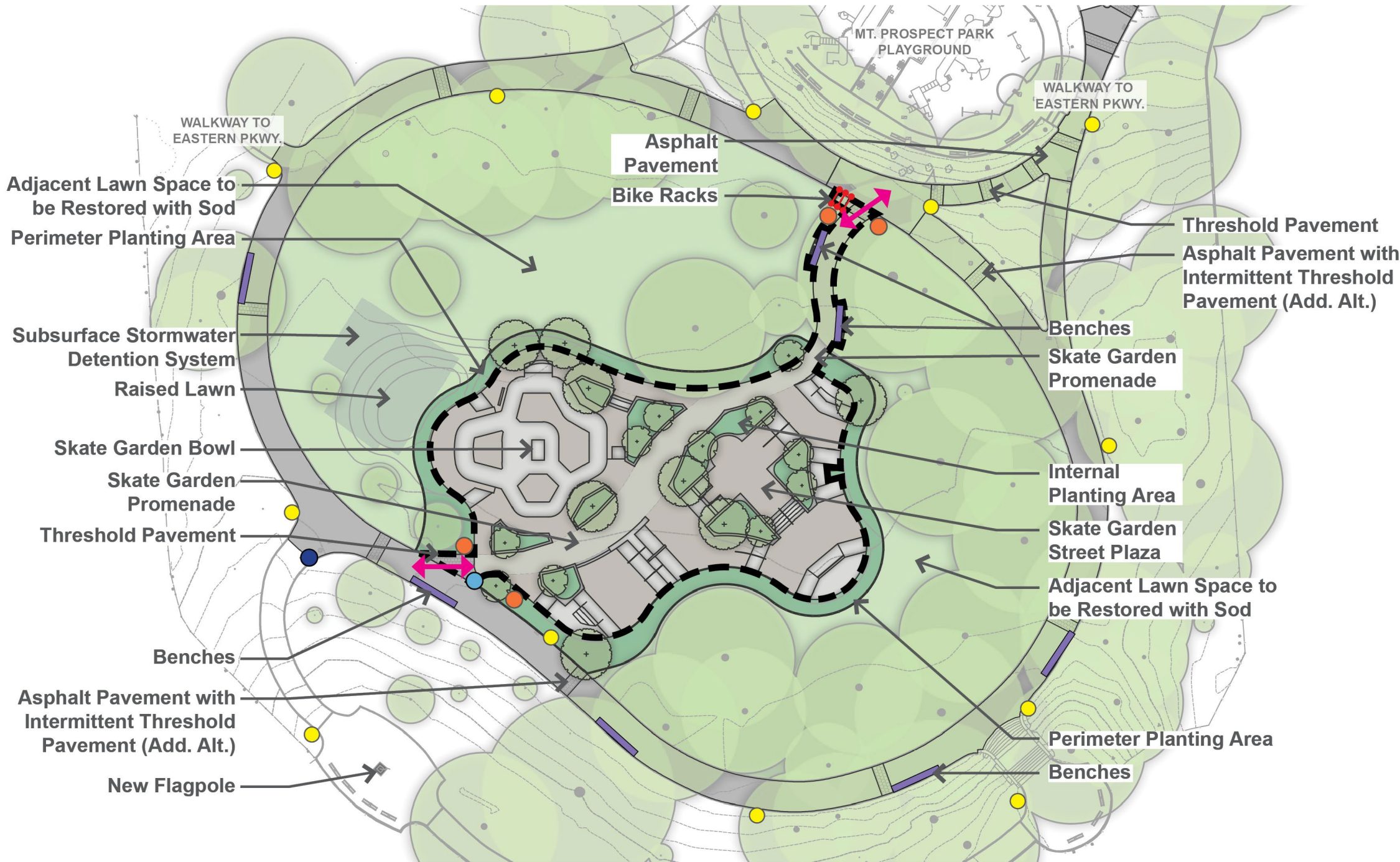









### Legend

-  Skate Garden Pavement Limit Line
-  Park Entrance
-  Skate Garden Flatwork
-  Skate Garden Feature
-  Threshold Pavement
-  Existing Parks Light Pole
-  Pedestrian Scale Security Lighting
-  Bike Rack
-  Bottle Filler
-  Existing Drinking Fountain to be Replaced
-  Benches
-  Internal and Perimeter Planting Area
-  Lawn Space to be Restored with Sod
-  Proposed Tree Shade Tree
-  Existing Tree

### Area Breakdown

- Skate Garden Hardscape: 19,500 sf
- Access Pathway: 1,400 sf
- Interior Planting: 2,500 sf
- Perimeter Planting: 6,000 sf



## Mount Prospect Park Skate Garden | Schematic Design