



# **Gowanus Canal “Owls Head” CSO Facility & “Head End” CSO Facility Demapping**

200319 PCK, 200320 MMK, 200321 PSK, 180039 MMK

**May 3, 2021  
CPC Review Session  
Certification**





# Summary of Proposal & Location

## Applicants

NYC Dept. of Citywide Administrative Services (DCAS)  
Dept. of Environmental Protection (DEP)  
Dept. of Sanitation (DSNY)

## Actions Requested

**Owls Head Site:** Site Selection and Acquisition (200319 PCK), Site Selection (200321 PSK), and City Map Amendment (200320 MMK)

**Head End Site:** City Map Amendment (180039 MMK)

## Proposed Project

New 4-million-gallon “Owls Head” CSO Facility and previously approved 8-million-gallon CSO “Head End” Facility





# Neighborhood Context



Illustrative view of the Head End CSO Facility design, which was approved as a prior site selection and acquisition application in 2018



- Gowanus Canal Superfund Designation (2010)
- EPA Record of Decision (2013) and Administrative Order (2014)
- Sewer outfall locations and exploration of CSO facility locations
- Additional local sewer infrastructure upgrades
  - High-Level Storm Sewers
  - Pumping station at head end of Canal



View of the Gowanus Canal, looking north from 9<sup>th</sup> Street



Example of High-Level Storm Sewer Installation



Example of local street storm drain



# Surrounding Area

## Area Map

### Gowanus CSO - Owls Head Facility

Borough: Brooklyn  
Block: 977 Lots: 1, 3, 16  
Block: 990 Lots: 1, 21

#### PROJECT INFORMATION

- Project Site
- 600' Radius

#### ZONING

- M2-1 Zoning Districts
- C2-4 Commercial Overlay District
- MX-11 Special Districts

#### PROPERTY DATA

- 990 Block Number
- Number of Building Stories
- Tax Lot
- Building Footprint

#### TRANSPORTATION INFORMATION

- Street Direction
- 60' Road Width
- Subway Lines

#### LAND USE

- One & Two Family Buildings
- Multi-Family Walk-Up Buildings
- Multi-Family Elevator Buildings
- Mixed Residential & Commercial Buildings
- Commercial & Office Buildings
- Industrial & Manufacturing
- Transportation & Utility
- Public Facilities & Institutions
- Parking Facilities
- Vacant Land

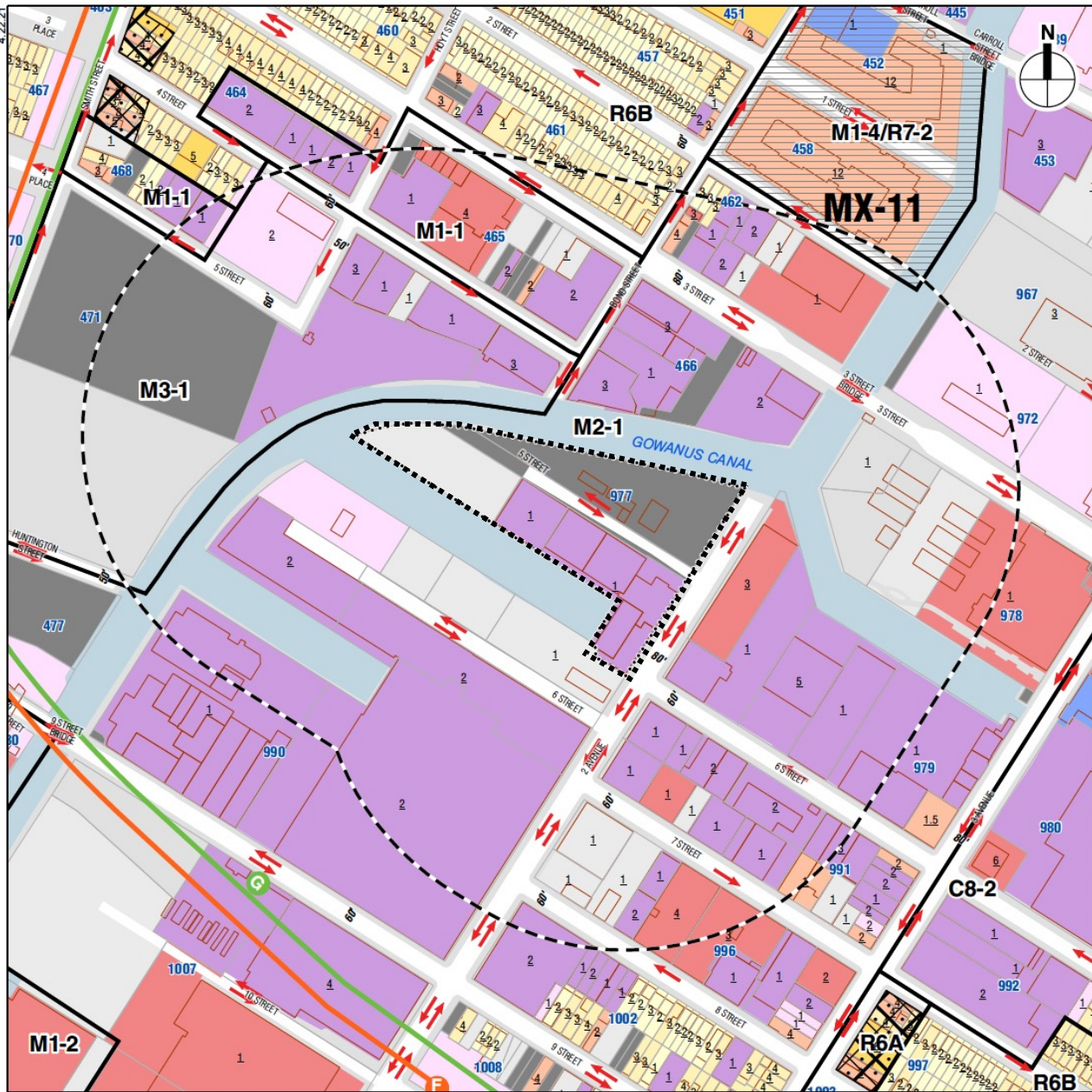
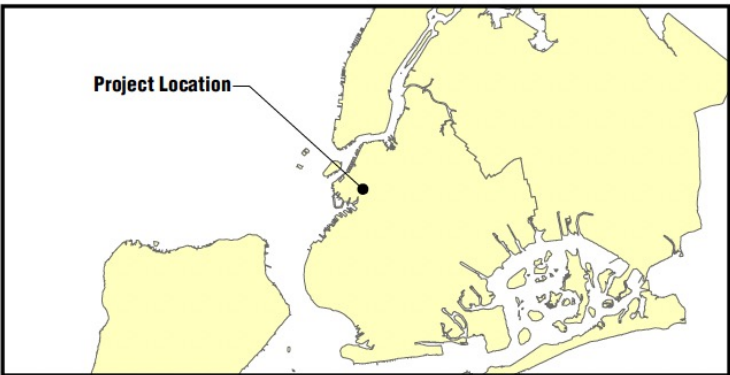



# Project Site - Birds Eye View





# Site Photo - View of DSNY Salt Lot looking west from 2nd Ave





# Site Photo - View of 5th St looking west from 2nd Ave





# Site Photo - View of 5th St looking east towards 2nd Ave





# Site Photo - View of the Project Site looking southwest along 2nd Ave





# Proposed Project – Preliminary Site Plan (For Illustrative Purposes)

## LEGEND:

- EXTENT OF PROPOSED CSO FACILITY
- PROPERTY USE - TBD
- TAX LOT LINE

## Preliminary Site Design Considerations

- 4-MG CSO Tank Facility
  - DSNY Salt and Plow Storage
  - Open Space and Composting Activities
  - Construction Staging Area
- EPA Order and Project Process

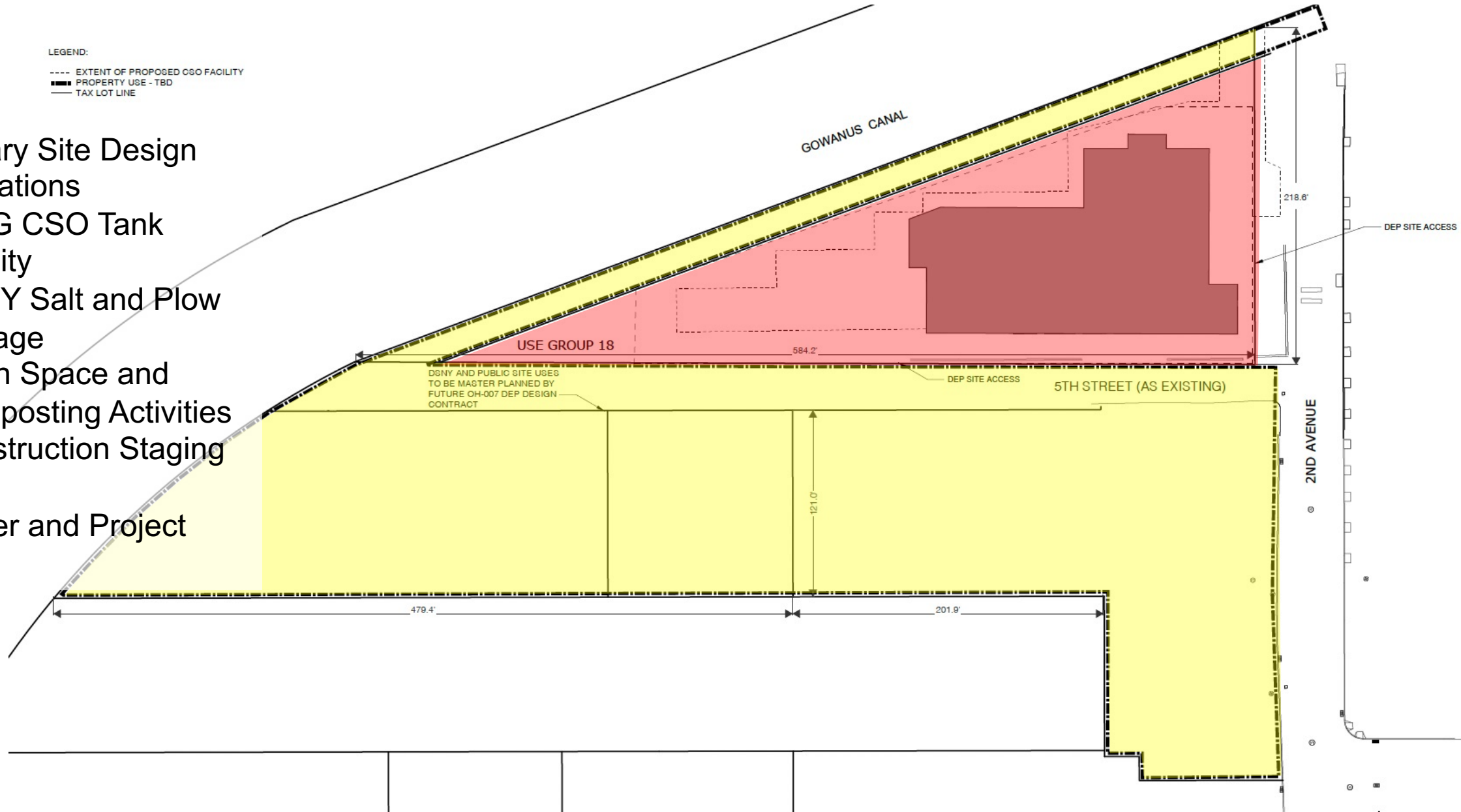





- 1. Site Selection and Acquisition** – Four privately owned lots
- 2. Site Selection** – City-owned lot
- 3. City Map Amendment** – Demap 5<sup>th</sup> St  
(between 2<sup>nd</sup> Ave and the Gowanus Canal)
- 4. City Map Amendment** – Demap Douglass St  
(between Nevins St and the Gowanus Canal)  
*Note: Action related to a previously approved Site Selection and Acquisition (C 180065 PCK) in 2018 for the “Head End” CSO Facility*



# Owls Head CSO Facility - Site Selection/Acquisition & Site Selection Actions

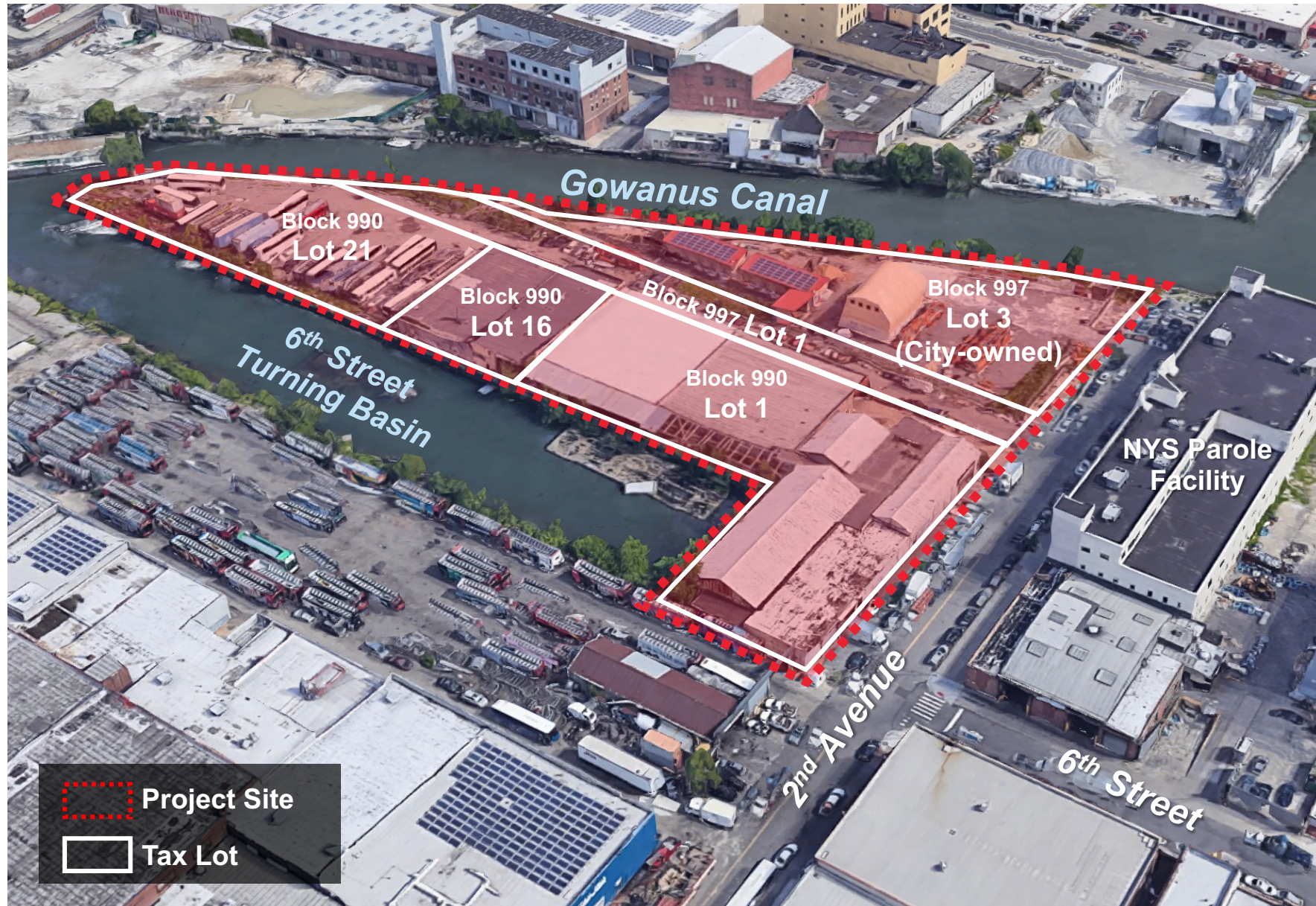

## Site Selection and Acquisition (200319 PCK)

- Privately owned lots (Block 997, Lot 1 and Block 990, Lots 1, 16 and 21)

## Site Selection (200321 PSK)

- City-owned lot (Block 997, Lot 3)



# Owls Head CSO Facility - City Map Amendment - 5<sup>th</sup> St Demapping

CITY OF NEW YORK  
BOROUGH OF BROOKLYN  
TOPOGRAPHICAL BUREAU

## APPLICATION MAP

SHOWING THE ELIMINATION OF:  
**5TH STREET**  
BETWEEN  
**THE GOWANUS CANAL**  
AND  
**2ND AVENUE**



CITY OF NEW YORK  
DEPARTMENT OF ENVIRONMENTAL PROTECTION  
59-17 JUNCTION BOULEVARD  
FLUSHING, NEW YORK 11373

PREPARED BY:







AKRF ENGINEERING, P.C.  
440 PARK AVENUE SOUTH  
NEW YORK, NY 10016  
Tel:(212)696-0670 Fax:(212)726-0942



WENDY HO, P.E.

PREPARED ON:  
APRIL 15, 2020

## LEGEND:

	Indicates street line hereby established
	Indicates street line heretofore established and hereby retained
	Indicates street line heretofore established and hereby eliminated
	Indicates roadway and sidewalk treatment hereby established or heretofore established and hereby retained
<b>471</b>	Indicates tax block number
<b>100</b>	Indicates roadway dimensions hereby established and hereby retained
<b>7.00</b>	Indicates elevation heretofore established and hereby retained
<u>1227.88</u>	Indicates dimension heretofore established
531.88	Indicates dimension heretofore established and hereby retained
<del>4618.99</del>	Indicates dimension heretofore established and hereby eliminated

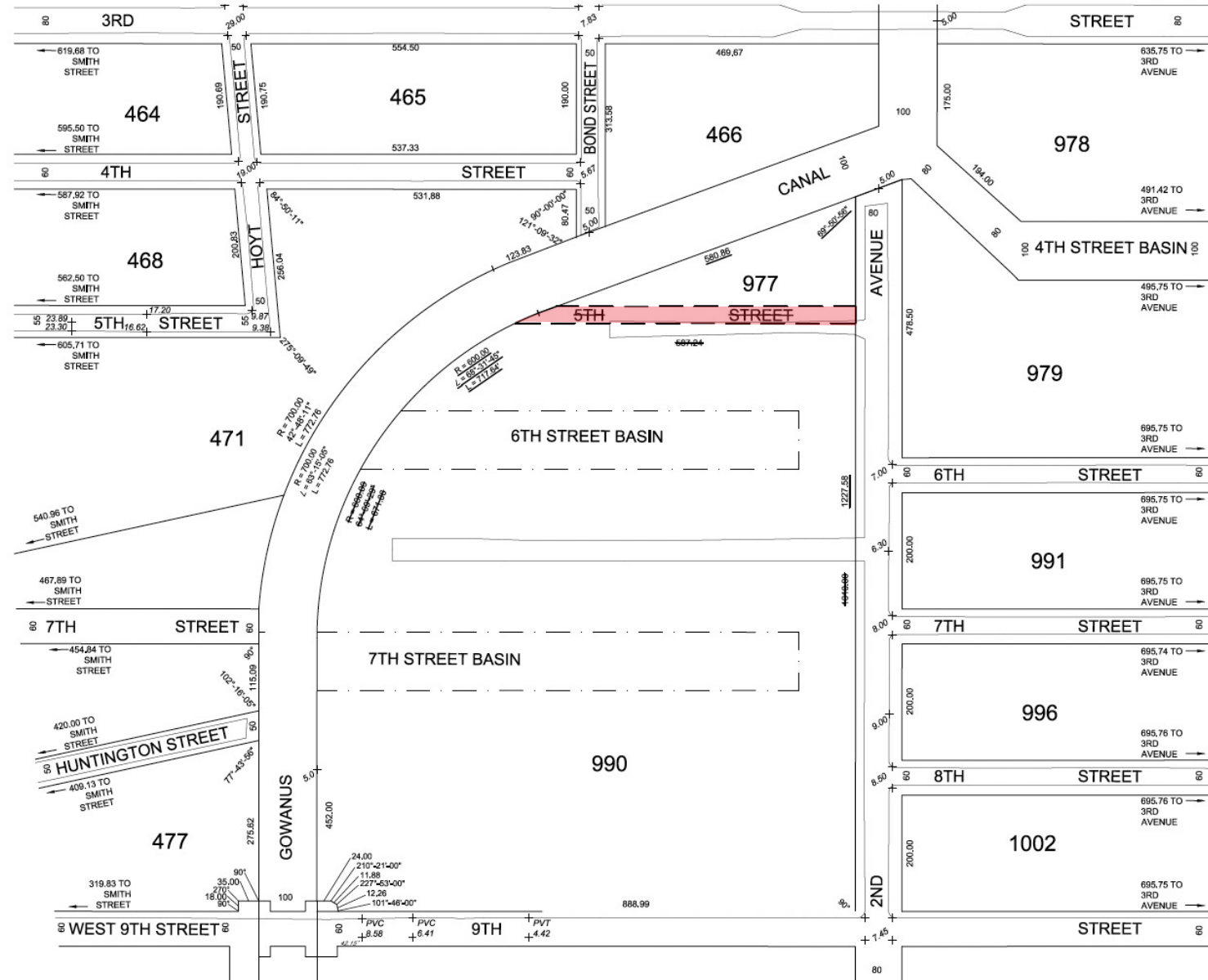

REFERENCE MAPS



# Head End CSO Facility - City Map Amendment - Douglass St Demapping



Illustrative View  
of Head End  
Facility Design

Secretary of the City Planning Commission,  
I this map is one of \_\_\_\_\_ similar maps  
Planning Commission on the \_\_\_\_\_ day  
(Cal. No. \_\_\_\_\_), and subsequently approved by  
(Res. \_\_\_\_\_), which  
I approval, and that this map was filed on the  
date of this certification and will take effect on the following day.

Date: New York, \_\_\_\_\_

Secretary, City Planning Commission

## REFERENCE MAPS

BP MAP FINAL SECTION NO. 24  
V-2  
N-424 - CP 6757  
L-890

## LEGEND

- Indicates street line hereby established
- Indicates street line heretofore established and hereby retained
- Indicates street line heretofore established and hereby eliminated
- PARK** Indicates park or park addition hereby established and hereby retained
- 411 Indicates tax block number
- 50 Indicates roadway dimensions hereby established and hereby retained
- 13.50 Indicates elevation heretofore established and hereby retained
- 460.00 Indicates dimension heretofore established
- 300 Indicates dimension heretofore established and hereby retained
- 200 Indicates dimension heretofore established and hereby eliminated
- 115' Indicates tie-in distance heretofore established and hereby retained

- Elevations are taken at top of curb unless otherwise noted.
- Elevations refer to the HIGHWAY datum of the borough of BROOKLYN, which is 2.56 feet (0.780 meters) above the U.S.C.&G. Mean Sea Level Survey datum at Sandy Hook, New Jersey.
- Easements not shown on this map but which appear on prior maps may or may not still be in force over the properties where they are located. Easements are not officially part of the city map and are shown for informational purposes only; to verify the existence of an easement, refer to the property records in the offices where such documents are registered.

CITY OF NEW YORK  
BOROUGH OF BROOKLYN  
OFFICE OF THE PRESIDENT  
TOPOGRAPHICAL BUREAU

MAP NO. N-2752  
SHOWING THE ELIMINATION OF  
DOUGLASS STREET  
BETWEEN  
THE GOWANUS CANAL  
AND NEVINS STREET

Dated: JULY 2, 2019

## SECTION 2 OF THE KINGS COUNTY LAND MAP

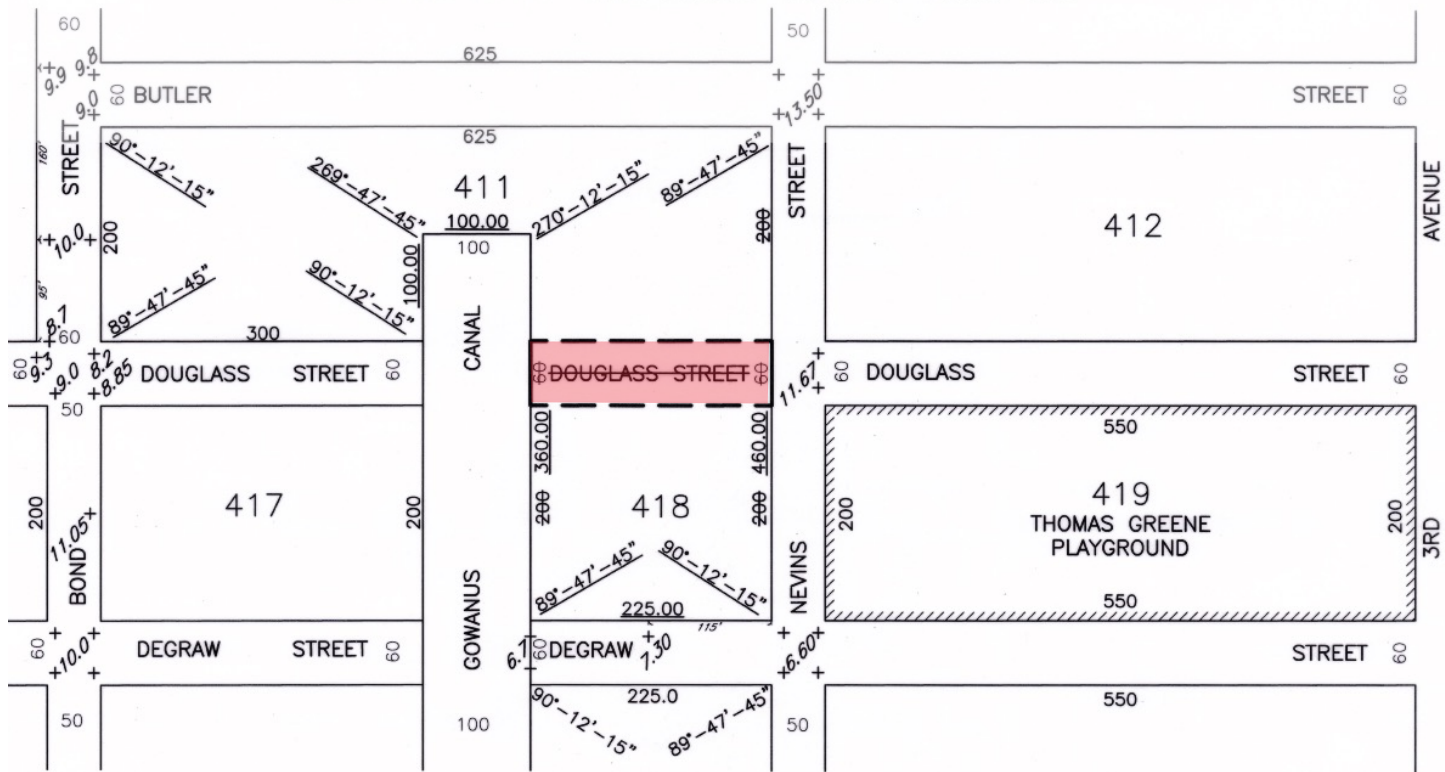





A Notice of Completion of a Final Environmental Impact Statement (FEIS), which analyzed **both** the Owls Head and Head End Facilities, was issued by DEP (Lead Agency) on February 1, 2018.

A Technical Memorandum to the FEIS related to the Owls Head Facility identified a potential significant adverse impact with respect to:

- Historic and Cultural Resources (Archaeological Resources)

No other significant adverse impacts were identified.









# **Gowanus Canal “Owls Head” CSO Facility & “Head End” CSO Facility Demapping**

200319 PCK, 200320 MMK, 200321 PSK, 180039 MMK

**May 3, 2021  
CPC Review Session  
Certification**





# APPENDIX



# Tax Map – Block 977



## NYC Digital Tax Map

Effective Date : 12-04-2008 13:16:02

End Date : Current

Brooklyn Block: 977



### Legend

- Streets
- Miscellaneous Text
- Possession Hooks
- Boundary Lines
- Lot Face Possession Hooks
- Regular
- Underwater
- Tax Lot Polygon
- Condo Number
- Tax Block Polygon
- Project Area

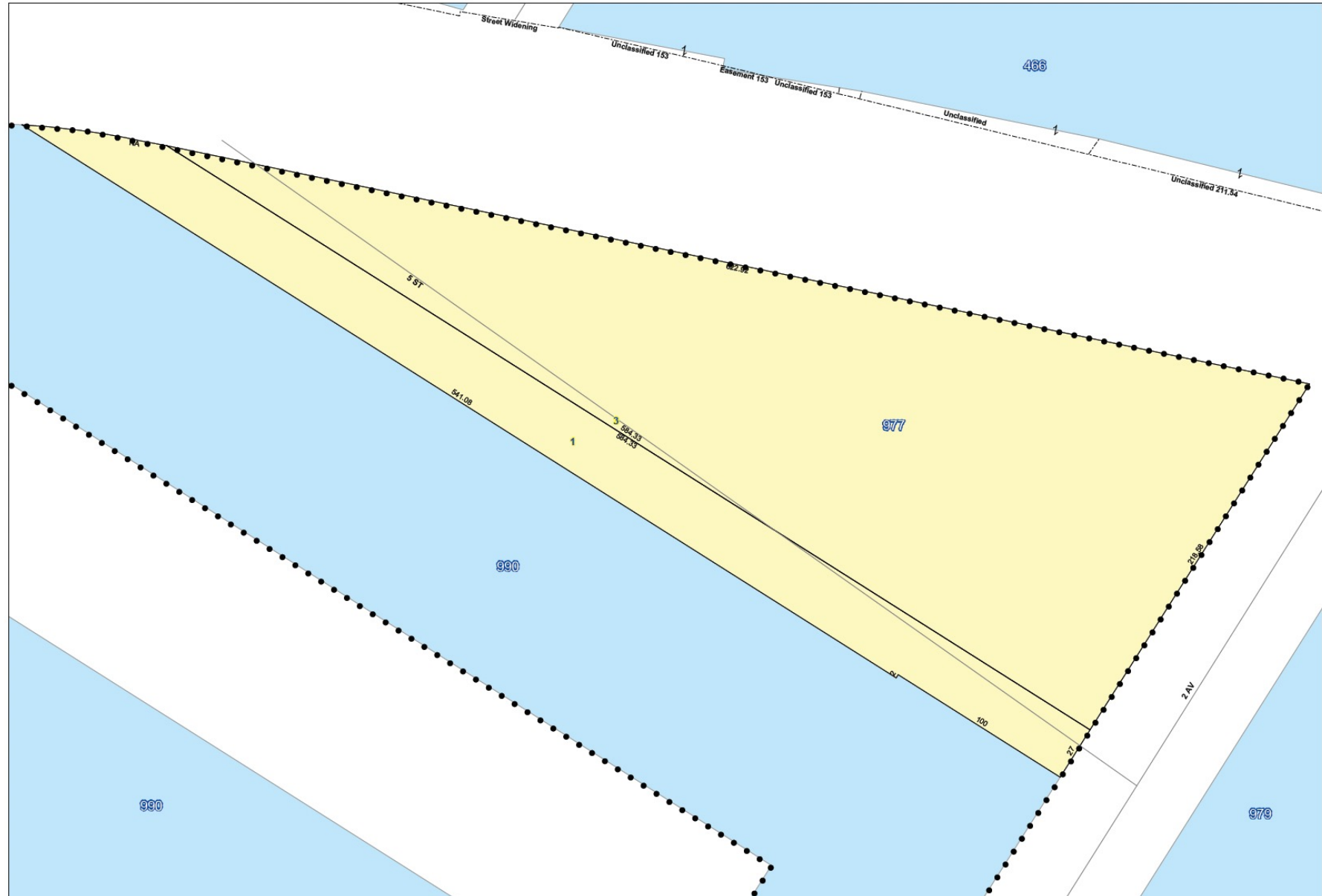



# Tax Map – Block 990



NYC Digital Tax Map

Effective Date : 07-22-2010 14:32:14  
End Date : Current  
Brooklyn Block: 990



Legend

- Streets
- Miscellaneous Text
- Possession Hooks
- Boundary Lines
- Lot Face Possession Hooks
- Regular
- Underwater
- Tax Lot Polygon
- Condo Number
- Tax Block Polygon
- Project Area

