

NYC Percent for Art

NYC Celebrates 40 Years of Public Art 1983-2023

The City of New York's Percent for Art program commissions permanent, site-specific artworks for a wide range of public facilities, making art broadly accessible and visible throughout New York City. In 1982, the Percent for Art law was initiated by Mayor Ed Koch and passed by the New York City Council requiring that one percent of the budget for eligible City-funded construction projects be spent on artwork for City facilities. Administered by the City's Department of Cultural Affairs, the program began in 1983. Since then, more than 370 Percent for Art projects have been completed with accumulated value of over \$65 million in today's dollars, and there are currently more than 100 new public art commissions in progress throughout the five boroughs.

40 years on from its establishment, Percent for Art has created a remarkable collection of site-specific artworks by a diverse roster of artists, done in a variety of media. These commissions have transformed and enriched the city's public realm, and continue to foster civic pride, social engagement, and sense of belonging and ownership in the communities they inhabit. These projects demonstrate how art that is integrated into its site enhances civic architecture and a wide range of public spaces.

www.nyc.gov/percent

Legend

- Percent for Art projects included in the 40th Anniversary Exhibit at City Hall Park
- Completed Percent for Art projects

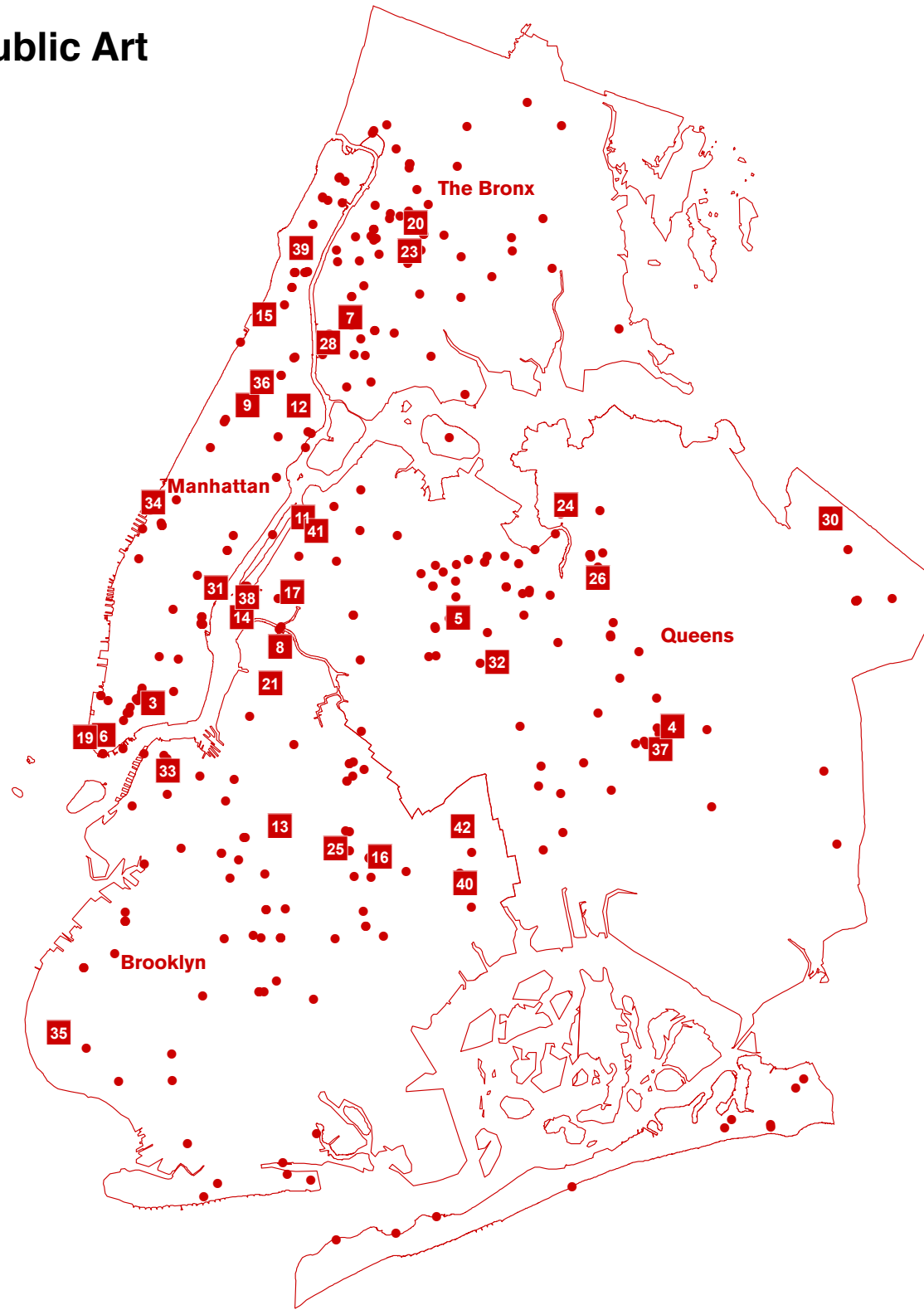
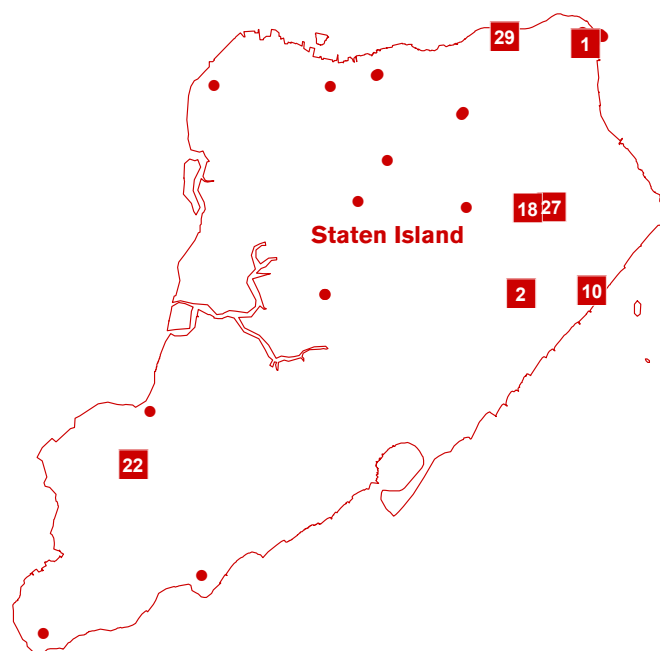

NYC Cultural Affairs

NYC DDC Department of Design and Construction

NYC DESIGN



1 THE PASSAGE: A MOVING MEMORIAL, 2016
by **Mary Miss**
Steel and glass
Photo courtesy of the Artist

Staten Island Courthouse
Central Ave & Hyatt St,
Staten Island, NY 10301

Dormitory Authority of the State of NY, Department of Citywide Administrative Services, Ennead Architects



2 NEW YORK CITY SEWER COVERS, 2000
by **Elizabeth Turk**
Cast iron
Photo courtesy of the Artist

Seguine Avenue Bluebelt
1941 Hylan Blvd,
Staten Island, NY 10305

Department of Environmental Protection, Department of Design and Construction



3 THE WRITINGS AT HELIN TEMPLE, 2015
by **Xu Bing**
Mixed media/carved stone, inscribed granite, bronze
Photo courtesy of DDC

Forsyth Plaza
Canal St & Forsyth St,
New York, NY 10002

Department of Transportation, Department of Design and Construction, URS, AECOM



4 TIME WILL TELL, 2015
by **Monika Bravo**
Ink on glass
Photo courtesy of the Artist

PS/IS 314
88-08 164th St,
Queens, NY 11432

Department of Education, School Construction Authority



5 COLLECTION OF NINE HUNDRED AND FIFTY-FIVE SHAPES, 2016
by **Alan McCollum**
Solid elm
Photo courtesy of Marpillero Pollak Architects

Elmhurst Library
86-07 Broadway
Queens, NY 11373

Queens Public Library, Department of Design and Construction, Marpillero Pollak Architects

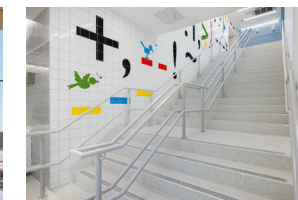

6 HAPPY PLACE, 2022
by **Bob Zoell**
Screenprinted ceramic pigment on porcelain tile
Photo courtesy of the Artist

Trinity Place Learning Center
28-42 Trinity Pl.
New York, NY 10006

Department of Education, School Construction Authority, Dattner Architects



7 ONE STONE, 2007
by **Cai Guo-Qiang**
White granite stone
Photo courtesy of DCLA

Bronx County Hall of Justice
265 E 161 St.
Bronx, NY 10451

Office of Court Administration, Dormitory Authority of the State of New York, Rafael Viñoly Architects



8 WATERFRONT NATURE WALK, 2007
by **George Trakas**
Steel, stone, concrete, wood, trees and plants
Photo courtesy of the Artist

Newtown Creek Nature Walk
329 Greenpoint Ave,
Brooklyn, NY 11222

Department of Environmental Protection, Department of Design and Construction, Quennel Rothschild & Partners, Greeley and Hansen



9 FREDERICK DOUGLASS MEMORIAL, 2011
by **Algernon Miller, Gabriel Koren**
Bronze and granite
Photo courtesy of DDC

Frederick Douglass Circle
110th St & Frederick Douglass Blvd., Manhattan, 10026

Department of Parks & Recreation, Department of Transportation, Department of Design and Construction, Quennel Rothschild & Partners

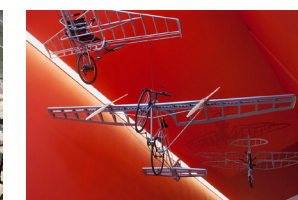

10 SKYCYCLES, 2015
by **Paul Villinski**
Bicycles, powder-coated steel and aluminum, carbon fiber, wood, leather, rubber
Photo courtesy of the Artist

Ocean Breeze Athletic Complex
625 Father Capodanno Blvd,
Staten Island, NY 10305

Department of Parks and Recreation, Department of Design and Construction, Sage and Coombe Architects



11 RAYMOND AND TOBY, 1991
by **John Ahearn**
Painted bronze
Photo courtesy of the Artist

Socrates Sculpture Park
32-01 Vernon Boulevard
Long Island City, NY 11106

Previously at:
44th Police Precinct, Bronx

New York Police Department, Department of General Services

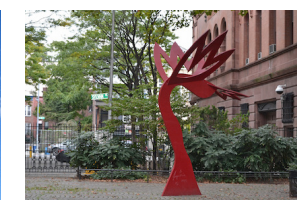

12 GROWTH, 1985
by **Jorge Luis Rodriguez**
Painted steel
Photo courtesy of DCLA

East Harlem Art Park
Sylvan Pl & E 120th St.
New York, NY 10035

Department of Parks and Recreation, Department of Housing Preservation and Development



13 MATHEMATICAL STAR, 2013

by Ellen Harvey
Marble, ceramic and glass mosaic
Photo courtesy of the Artist

Marcy Plaza
Fulton St & Marcy Ave
Brooklyn, NY 11216

Department of Transportation,
Economic Development
Corporation, MPFP



14 ALTERVIEW, 2013

by Natasha Johns-Messenger
Tinted glass and stainless steel
Photo courtesy of the Artist

Hunters Point Campus
1-50 51st Ave
Queens, NY 11101

Department of Education,
School Construction Authority,
FXFowle Architects



15 THE TOTALLY KID CAROUSEL, 1998

by Milo Mottola
Painted fiberglass on wood,
metal and foam armature
Photo courtesy of the Artist

Riverbank State Park
North River Wastewater
Treatment Plant
Riverside Dr. & W. 145th St.
New York, NY 10031

Department of Environmental
Protection, Richard Dattner P.C.



16 RESONANCES (Upcoming Project)

by Christopher Myers
Resin and steel
Rendering courtesy of the Artist

Brownsville Carnegie Library
61 Glenmore Ave
Brooklyn, NY 11212

Brooklyn Public Library,
Department of Design and
Construction, LTL Architects



17 SUNBATHER, 2016

by Ohad Meromi
Painted bronze
Photo courtesy of the Artist

Jackson Avenue Streetscape
Jackson Ave & Purves St
Queens, NY 11101

Department of Transportation,
Economic Development
Cooperation, AKRF

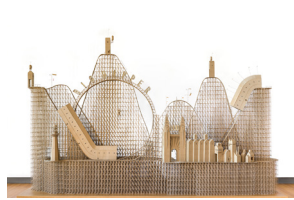

18 LATTICE, 2022

by Daniel Agdag
Cardboard, trace paper and
timber
Photo courtesy of the Artist

Lois and Richard Nicotra Early
College Charter School
45 Waverly Place,
Staten Island, NY 10304

Department of Education,
School Construction Authority



19 SETTINGS, 2010

by Jean Shin
Ceramic
Photo courtesy of the Artist

PS/IS 276 and Battery Park
City School
Battery Park City, Manhattan
55 Battery Pl.
New York, NY 10280

Department of Education,
School Construction Authority,
Dattner Architects



20 SOUND PLAYGROUND, 1992

by Bill and Mary Buchen
Bronze, concrete, steel
Photo courtesy of the Artist

PS 23
2151 Washington Ave.
Bronx, NY 10457

Department of Education,
School Construction Authority,
Perkins & Will



21 DOUBLE SUN, 2016

by Mary Temple
Stucco substrate and
commercial exterior latex paint
Photo courtesy of the Artist

McCarren Park Pool
Bayard St & Lorimer St.
Brooklyn, NY 11222

Department of Parks and
Recreation, Economic
Development Corporation,
Rogers Marvel Architects



22 FLOCK HOUSE, 2015

by Mary Mattingly
Stainless steel, wire mesh and
everyday objects
Photo courtesy of the Artist

PS 62 The Kathleen Grimm
School for Leadership &
Sustainability
644 Bloomingdale Rd.
Staten Island, NY 10309

Department of Education,
School Construction Authority



23 LOTUS, 2010

by Sanford Biggers
Galvanized steel
Photo courtesy of the Artist

Eagle Academy for Young Men
4143 3rd Ave.
Bronx, NY 10457

Department of Education,
School Construction Authority

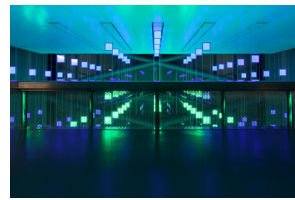

24 DIAMOND MATRIX, 2014

by Erwin Redi
410 suspended light panels with
acrylic and animated RGB-LEDs
Photo courtesy of the Artist

New Police Academy
130-30 28th Ave.
Queens, NY 11354

New York Police Department,
Department of Design and
Construction, Perkins + Will



25 SUGAR IN MY BOWL II, 2012

by Chakaia Booker
Rubber tires and stainless steel
Photo courtesy of Caples
Jefferson Architects

Weeksville Heritage Center
1696 Bergen Street,
Brooklyn, NY 11213

Department of Cultural Affairs,
Department of Design and
Construction, Caples Jefferson
Architects



26 WATER OFFERING (Upcoming Project)

by William Lamson
Stone
Rendering courtesy of the Artist

Queens Botanical Garden
New Education Center
43-50 Main St.
Queens, NY 11355

Department of Cultural Affairs,
Queens Botanical Garden,
Department of Design and
Construction, BSKS Architects



27 CABINET 1526-2013, 2013

by Penelope Umbrico
Photographs, metal, glass
Photo courtesy of the Artist

PS/IS 48
1050 Targee St.
Staten Island, NY 10304

Department of Education,
School Construction Authority,
Kliment Halsband Architects

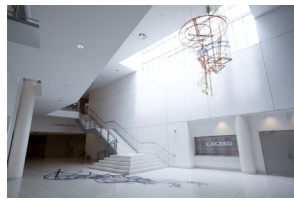

28 MOMENTUM AND ITS CONSERVATION, 2010

by Sarah Sze
Powder-coated steel and
aluminum, plastic, terrazzo tiles
Photo courtesy of the Artist

Mott Haven
Educational Campus
730 Concourse Village W.
Bronx, NY 10451

Department of Education,
School Construction Authority,
Perkins Eastman



29 THE HAWK AND THE HERON, 2022

by Tatiana Arocha
UV print on dibond hand-
painted with acrylic
Image courtesy of the Artist

Snug Harbor
Music Hall Addition
1000 Richmond Terrace,
Staten Island, NY 10301

Department of Cultural Affairs,
Department of Design and
Construction, Studio Joseph



30 A BIT OF EVERYTHING (Upcoming Project)

by Misha Kahn
Polylactic acid, automotive paint,
stainless steel
Rendering courtesy of the Artist

New Douglaston-Little Neck
Community Library
249-01 Northern Blvd.
Queens, NY 11362

Queens Public Library,
Department of Design and
Construction, BSKS Architects



31 THE PEACE CLOCK, 2016

by Lina Viste Grønli
Brass
Photo courtesy of DCLA

Trygve Lie Plaza
725 United Nations Plaza,
New York, NY 10017

Department of Parks and
Recreation, Royal Norwegian
Consulate General of NY



32 THE FORE (Upcoming Project)

by Katrín Sigurðardóttir
Bricks, paper
Rendering courtesy of Weiss/
Manfredi

New Rego Park
Community Library
91-41 63rd Dr.
Queens, NY 11374

Queens Public Library,
Department of Design and
Construction, Weiss/Manfredi

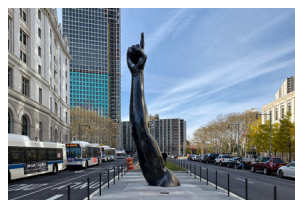

33 UNITY, 2019

by Hank Willis Thomas
Bronze, patina
Photo courtesy of DCLA

Brooklyn Bridge Gateway
Tillary St &
Brooklyn Bridge Blvd.
Brooklyn, NY 11201

Department of Transportation,
Department of Design and
Construction, Michael Baker
Engineering Inc.

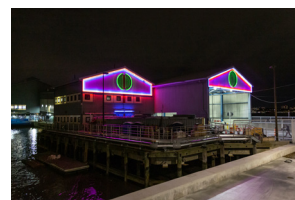

34 NEON, 1990

by Stephen Antonakos
Neon
Photo courtesy of DDC

West 59th Street Marine
Transfer Station
Pier 99
901 12th Ave.
New York, NY 10019

Department of Sanitation, NYC
Department of General Services,
Dattner Architects



35 NEPELOCOCCYGIA (CLOUD CUCKOO LAND), 2012

by Jeffrey Gibson
Ink on paper monotypes, acrylic
Photo courtesy of the Artist

PS 264 Bay Ridge Elementary
School for the Arts
371 89th St.
Brooklyn, NY 11209

Brooklyn Department of
Education, School Construction
Authority



36 SWING LOW: HARRIET TUBMAN MEMORIAL, 2007

by Alison Saar
Cast bronze
Photo courtesy of the Artist

Harriet Tubman Memorial
Frederick Douglass Blvd
& St Nicholas Ave.
New York, NY 10027

Department of Parks and
Recreation, Department of
Transportation, Department of
Design and Construction, URS,
Quennell Rothschild & Partners



37 KATUL KATUL, 2003

by Ursula von Rydingsvard
Polyester plastic, aluminum
Photo courtesy of the Artist

Queens County Family Court
151-20 Jamaica Ave.
Queens, NY 11432

Office of Court Administration,
Pei Cobb Freed & Partners,
Gruzen-Samton

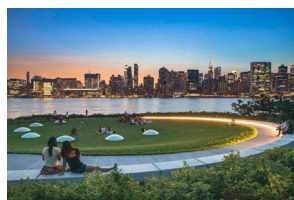

38 LUMINESCENCE, 2019

by Nobuho Nagasawa
Cement with integrated
phosphorus particles & pigment,
reflective silicon carbide grains
Photo courtesy of © David
Lloyd + SWA/Balsley

Hunters Point South
Waterfront Park
Center Blvd, Queens, NY 11101

Department of Parks and
Recreation, EDC, Thomas
Balsley Associates, Weiss/
Manfredi



39 THE SOURCE, 2015

by Ester Partegàs
Pigmented cast concrete,
ceramic tile, stainless steel and
fountain
Photo courtesy of the Artist
© Mark Woods

Plaza De Las Americas
651 W 175th St.
New York, NY 10033

Department of Transportation,
Department of Design and
Construction, RBA Group



40 COLORFUL COMPANIONS (Upcoming Project)

by Olalekan Jeyifous
Dye sublimation print on powder
coat over aluminum
Rendering courtesy of the Artist

Brooklyn Animal Care Center
2336 Linden Blvd.
Brooklyn, NY 11208

DOHMH, Department of Design
and Construction,
Smith-Miller + Hawkinson
Architects

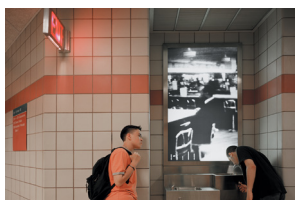

41 TRIBUTARIES, 1995

by Dennis Adams
Photographic lightboxes
Photo courtesy of the Artist

Long Island City High School
14-30 Broadway
Queens, NY 11106

Department of Education,
School Construction Authority,
Gruzen Samson Steinglass



42 URBAN POET (Upcoming Project)

by Alexandre Arrechea
Painted steel and aluminum
Image courtesy of the Artist

Atlantic Avenue
Safety Improvements
Atlantic Ave & Logan St.
Brooklyn, NY 11208

Department of Transportation,
Department of Design and
Construction, HDR