

Project ID: SANDR01  
Registration # 20201417161  
**CONSTRUCTION PHASING**

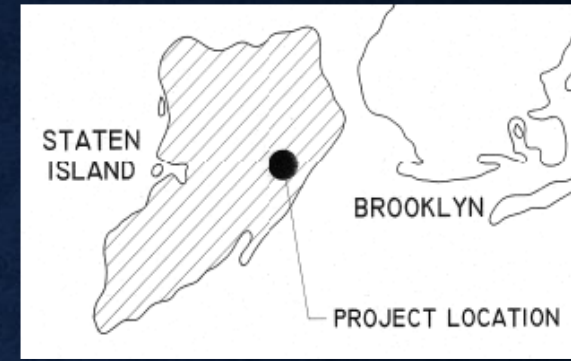

HYLAN BOULEVARD STAGING AND SEQUENCING

# PHASE 1

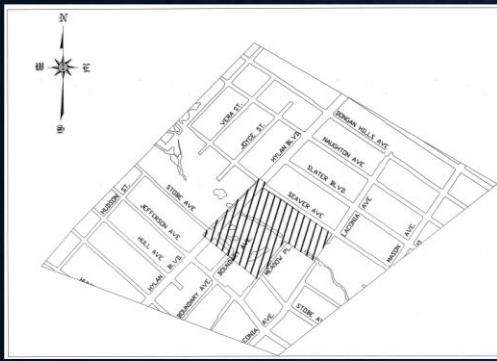
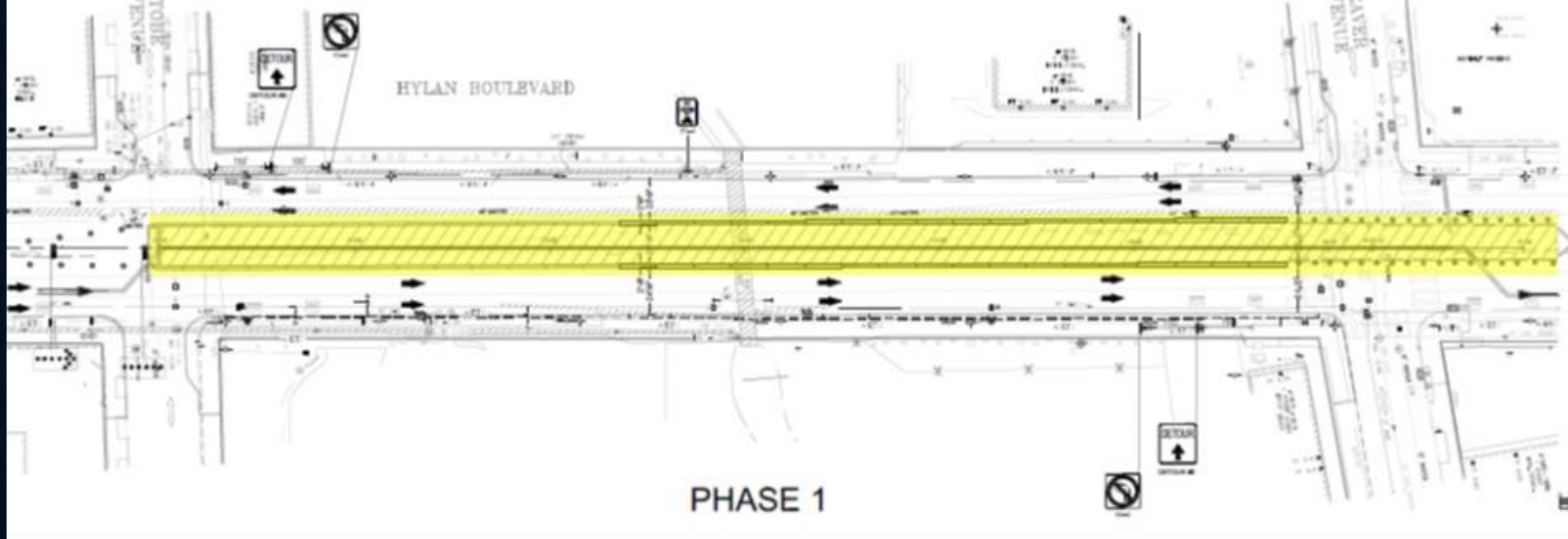

PHASE 1

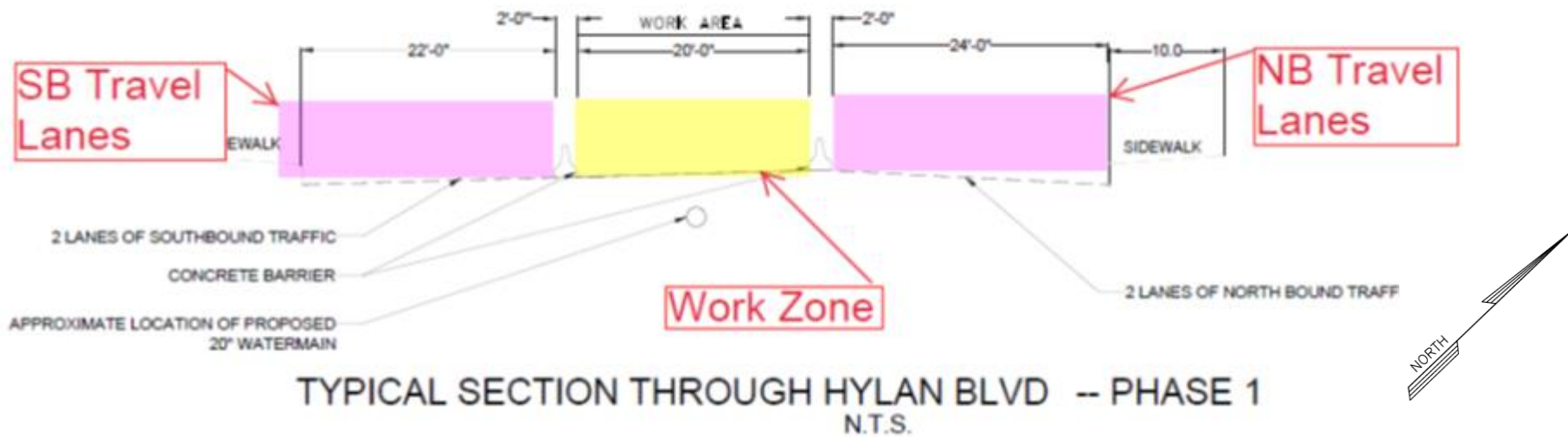

TYPICAL SECTION THROUGH HYLAN BLVD -- PHASE 1  
N.T.S.

- ~ 2 weeks
- WM In Center of Roadway
- 20" WM on Hylan Blvd
- 2 Lanes each direction on both sides of work zone
- NIGHT WORK
- Roadway is not raised during this phase

# PHASE 1

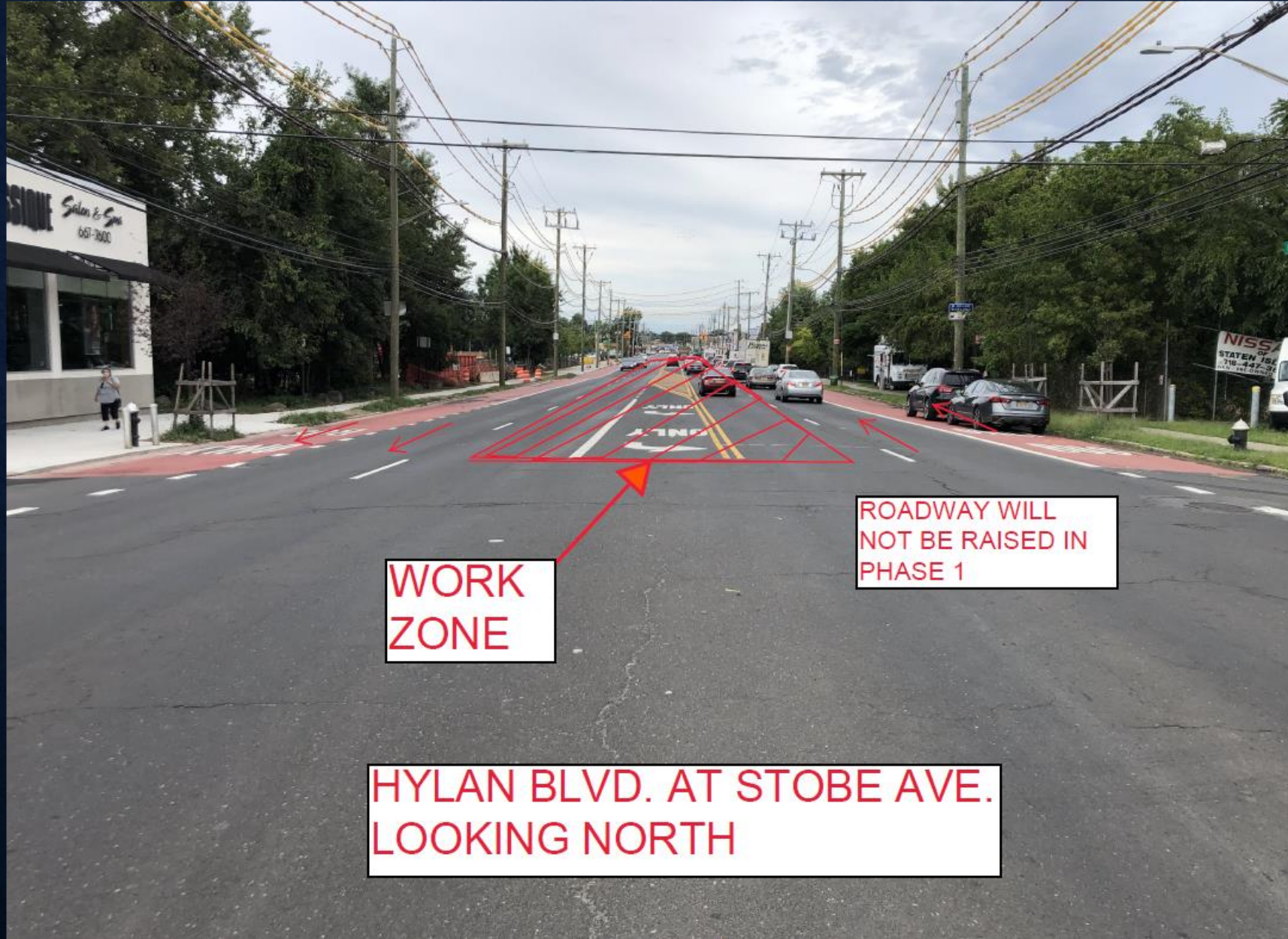

**WORK  
ZONE**

**ROADWAY WILL  
NOT BE RAISED IN  
PHASE 1**

**HYLAN BLVD. AT STOBE AVE.  
LOOKING NORTH**

# PHASE 2

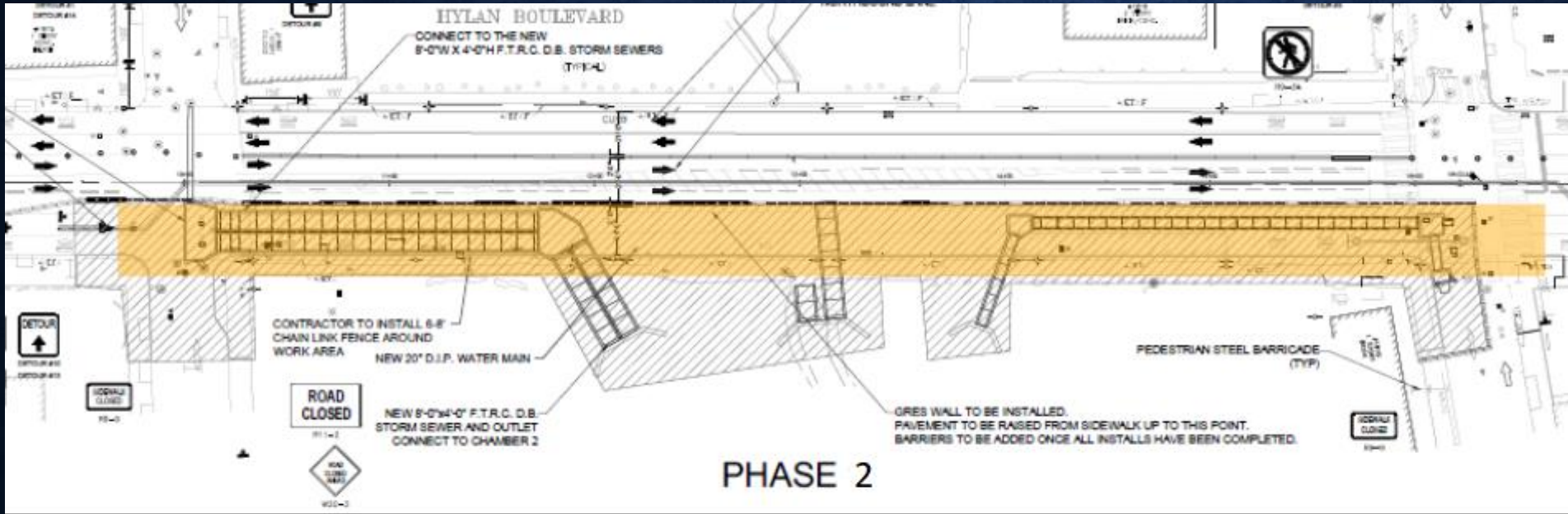

PHASE 2

SB Travel Lanes

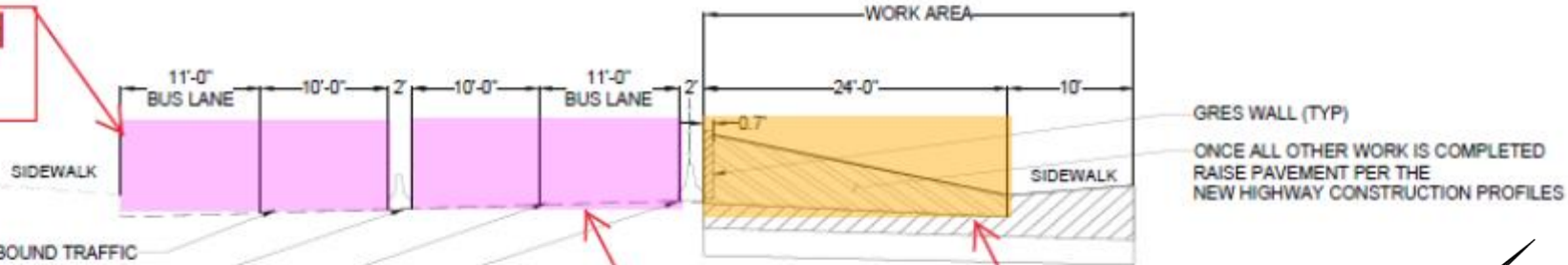

NB Travel Lanes

Work Zone

TYPICAL SECTION THROUGH HYLAN BLVD - PHASE 2  
N.T.S.

- ~ 6 months
- Work on East Side of Hylan Blvd.
- Work on DB & SB Sewers
- Work on East side of Culvert crossing Hylan Blvd.
- Work on Sanitary Sewer
- RAISE ROADWAY and SIDEWALKS
- Chambers
- 2 Lanes Each Way on West side of Work
- DAY & NIGHT WORK

# PHASE 2



AT HIGHEST POINT, NEW ROADWAY WILL BE ~5' HIGHER THAN EXISTING

TRAFFIC CAN NOT BE PUT ON RAISED ROADWAY UNTIL IT IS FULLY RAISED & READY TO MOVE TO NEXT PHASE

HYLAN BLVD. AT STOBE AVE. LOOKING NORTH

# PHASE 3

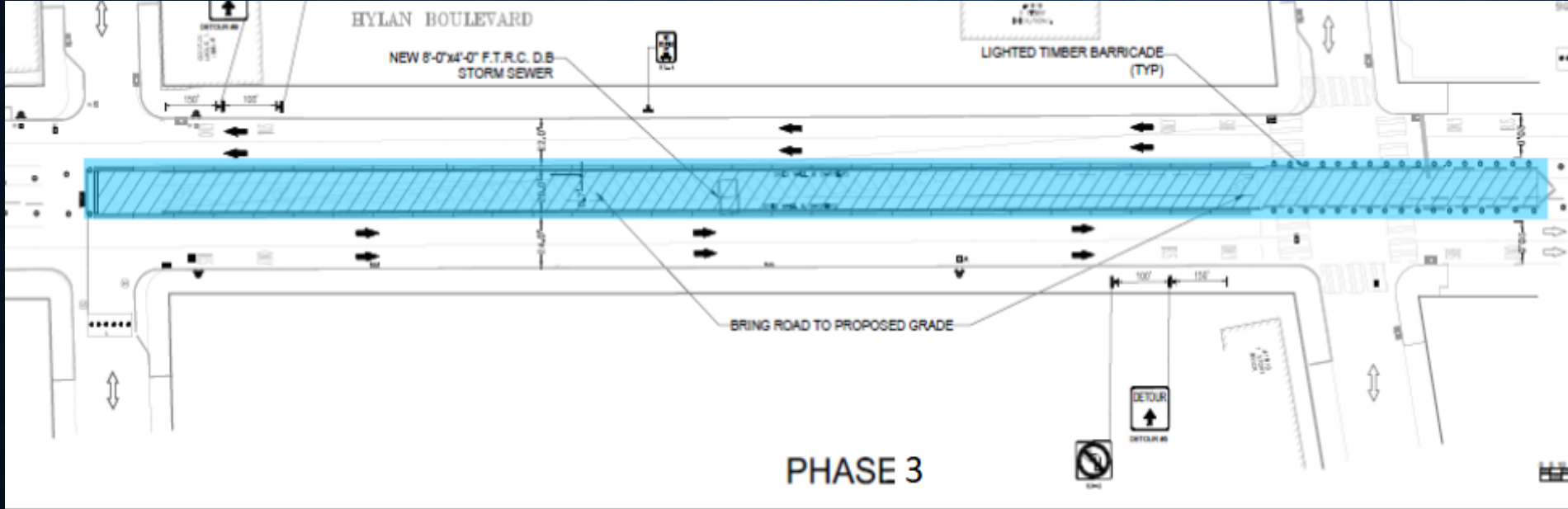

- ~ 5 weeks
- Complete WM work
- RAISE ROADWAY
- 2 Lanes Each way on both sides of the work zone
- DAY & NIGHT WORK

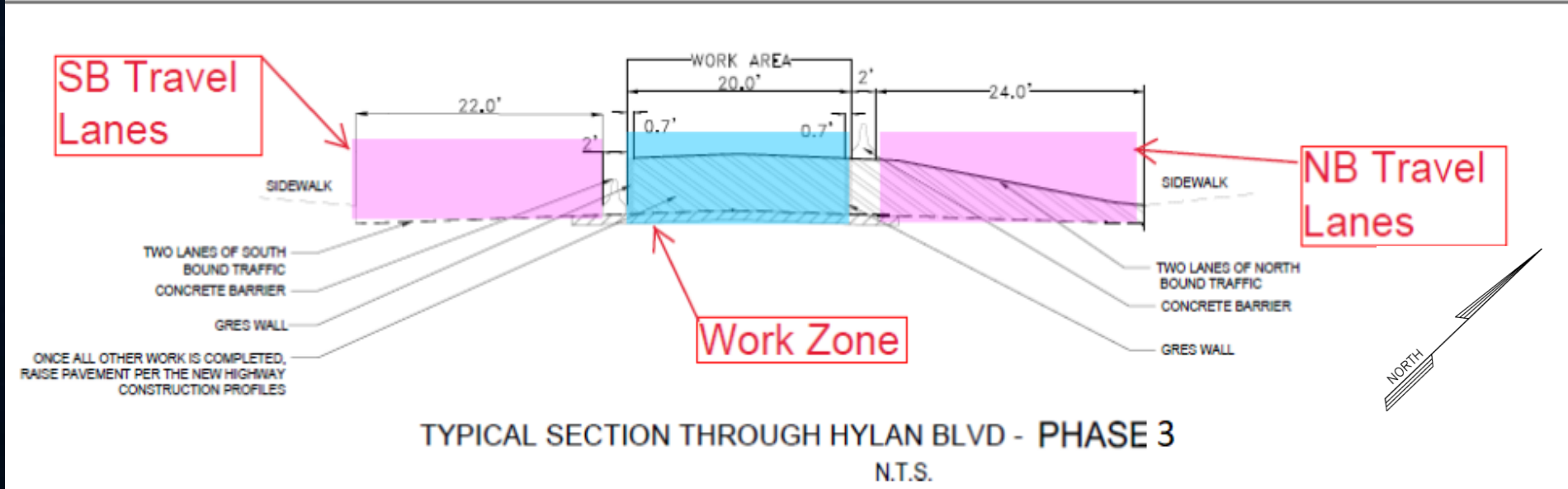

# PHASE 3



# PHASE 4

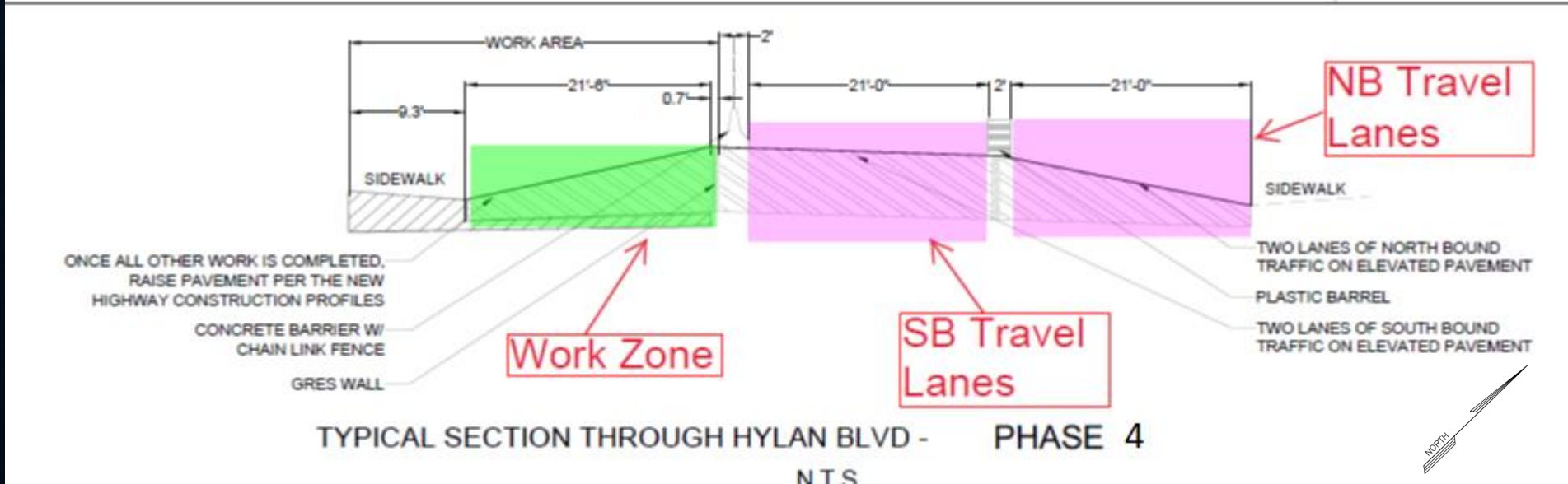
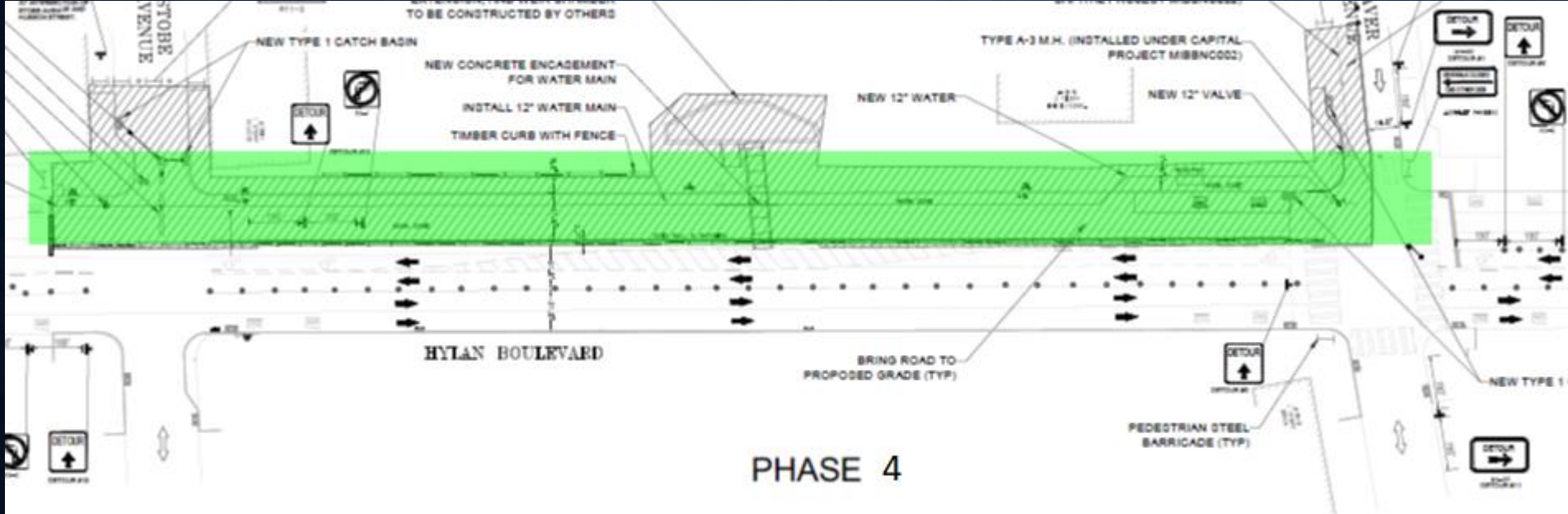

- ~ 2 months
- Work on Sewers & WM on West Side of Hylan Blvd.
- Complete Culvert Crossing Street
- RAISE ROADWAY and SIDEWALKS
- 2 Lanes Each Way on the East side of Hylan Blvd on RAISED ROADWAY
- DAY & NIGHT WORK



# PHASE 4



RAISED DURING THIS PHASE

PREVIOUSLY RAISED ON PHASE 2 & 3. TRAFFIC CAN TRAVEL ON THESE LANES

HYLAN BLVD. AT STOBE AVE. LOOKING NORTH

# PHASE 5

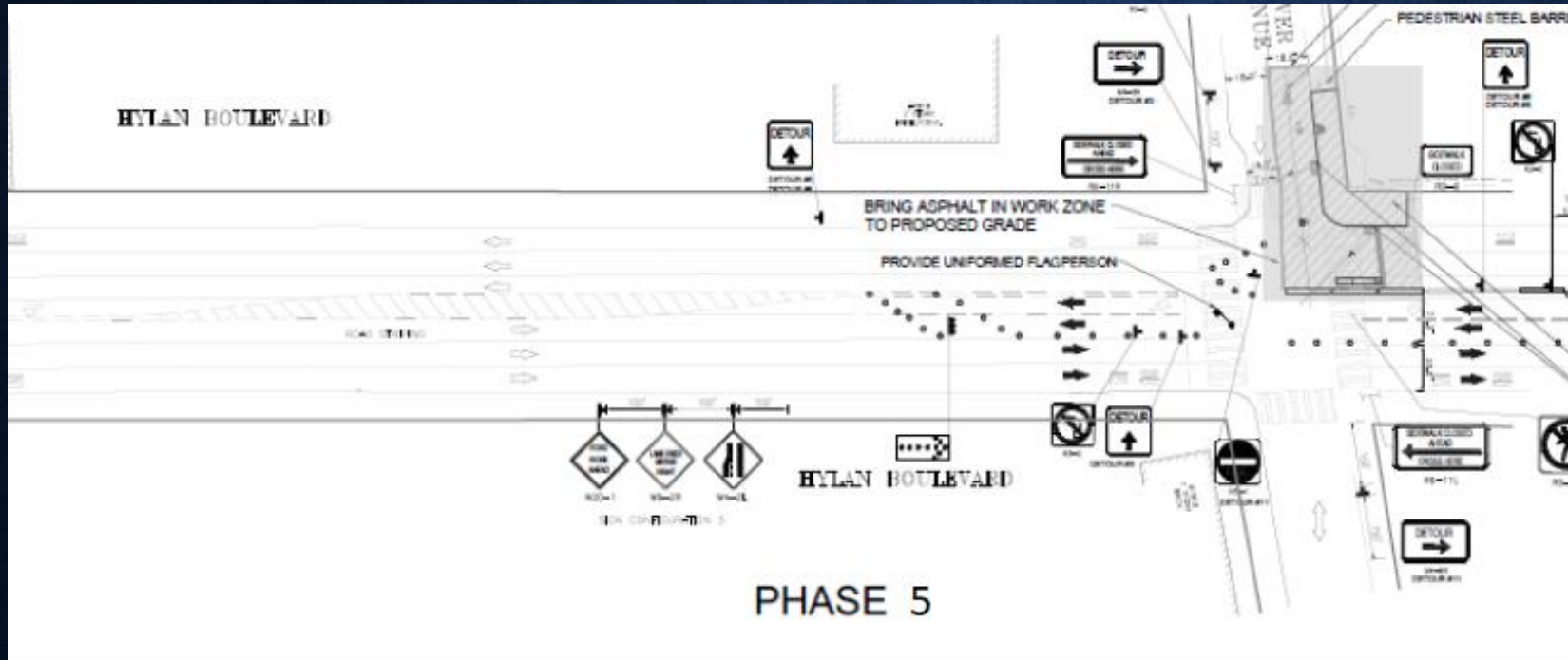

- ~ 6 weeks
- WM Work
- Sidewalk, Curb, & Ped Ramp Work
- Sewer work
- 2 Lanes Each Way on the East side of Hylan Blvd
- DAY & NIGHT WORK

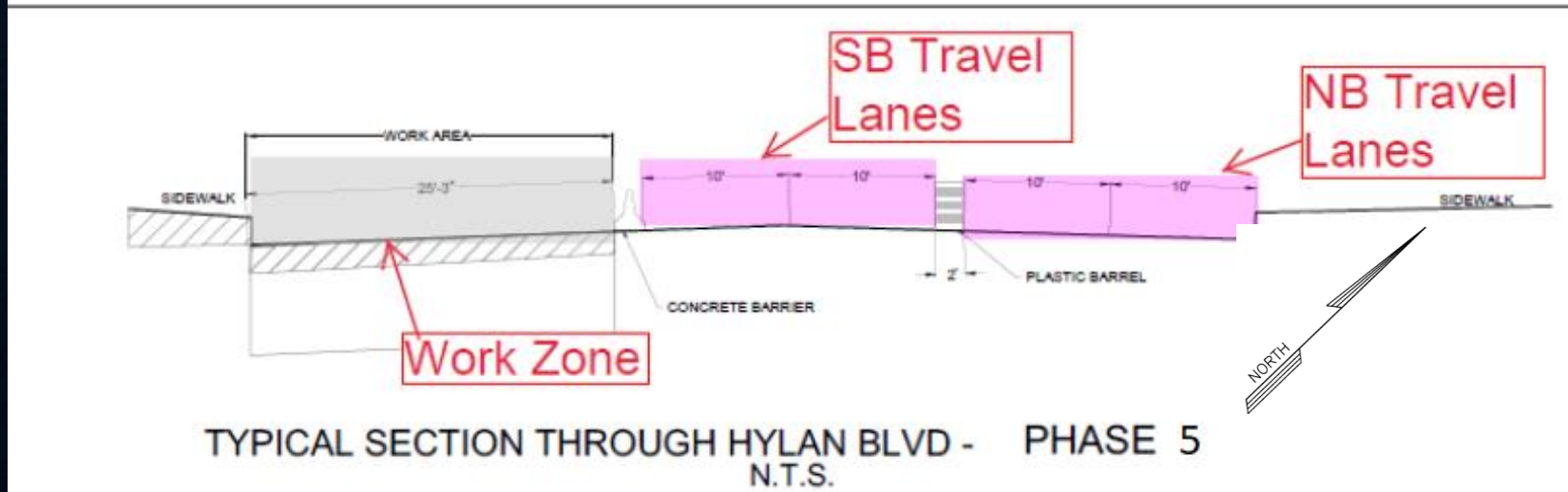

# PHASE 5



**WORK  
ZONE**

**HYLAN BLVD. & SEAVAR  
AVE.  
NW CORNER**

# PHASE 6

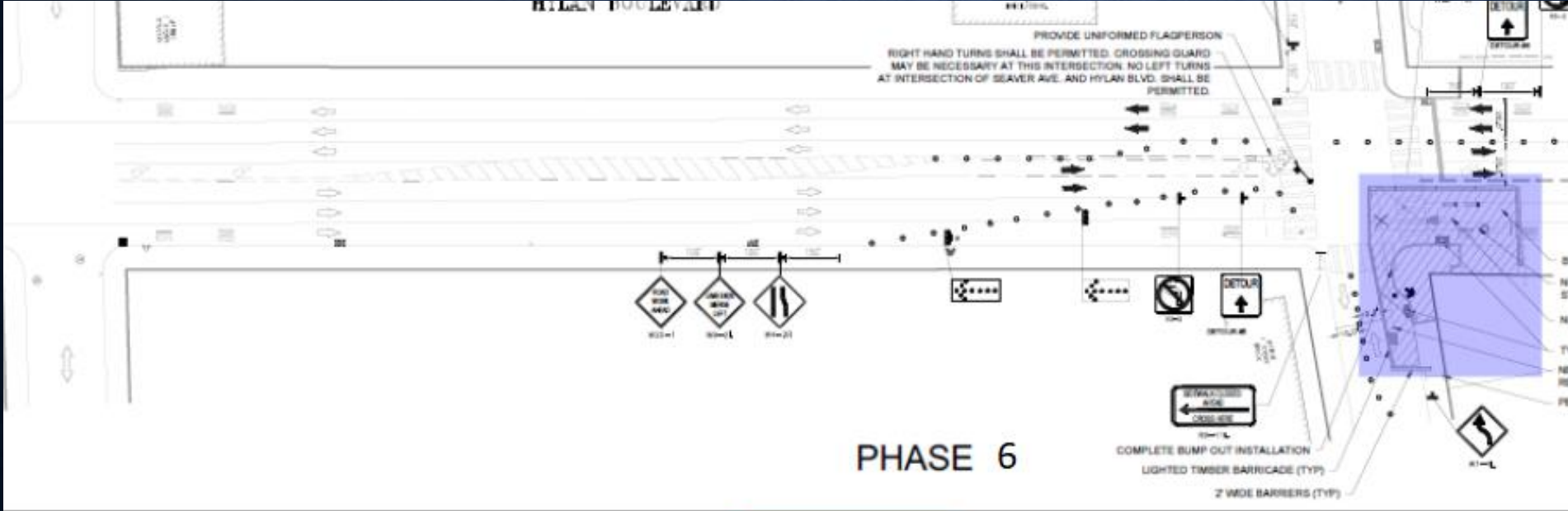

- ~ 5 weeks
- WM Work
- Sidewalk, Curb, & Ped Ramp Work
- Sewer Work
- 2 Lanes Each Way on the East side of Hylan Blvd.
- DAY & NIGHT WORK

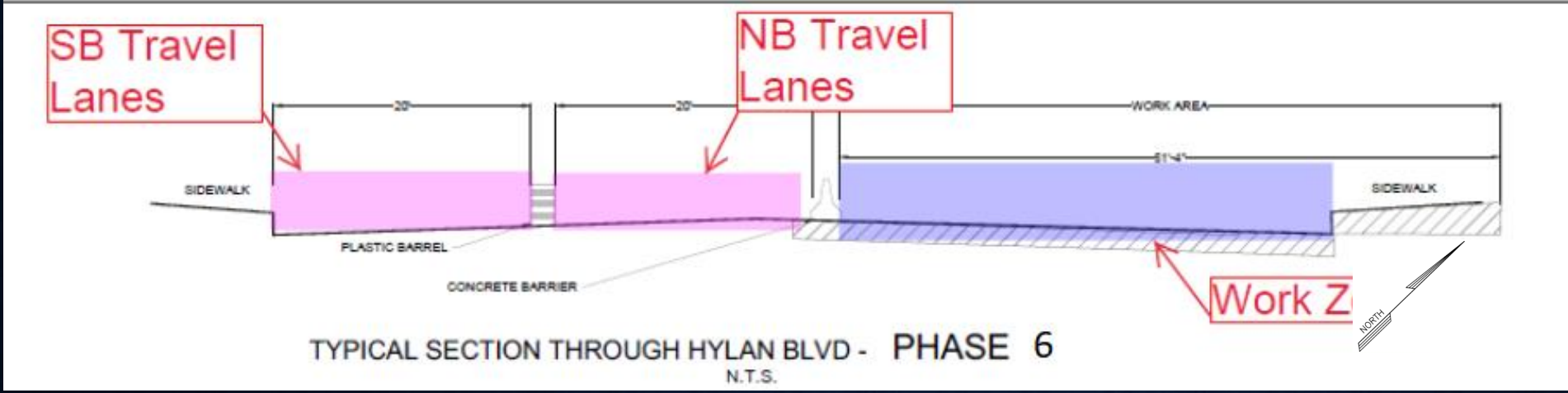

TYPICAL SECTION THROUGH HILAN BLVD - PHASE 6  
N.T.S.

# PHASE 6



**WORK  
ZONE**

**HYLAN BLVD. & SEAV  
AVE.  
NE CORNER**

# CONCLUSION

## KEY POINTS

- Project expected to conclude January 2022
- Phasing required as traffic can only travel on roadway before or after roadway is completely raised; no opening of work zone for traffic during off hours.
- Maintenance and Protection of Traffic measures will include concrete barriers on Hylan Blvd to separate the work zone from vehicular traffic.
- Dedicated bus lanes will be eliminated in the area of construction for the duration of the project. Existing signage (as listed below) will be removed.
  - Northbound Bus Lane M-F 6am – 9am (No Standing)
  - Southbound Bus Lane M-F 3pm – 7pm (No Standing)
- Contract DOT OCMC traffic stipulations allow for 4 lanes of traffic (2 in each direction) during daytime hours, 5am – 9pm.
- Day work to occur behind barriers isolating the work zone from traffic.